

2007  
WINNEBAGO  
Aspect®



Aspect





WEB SMARTSPACE

26A Cinnamon Spice with Sierra Maple

### Small in Size, Not Amenities.

Don't let its size fool you. The 2007 Aspect comes fully equipped with many of the same high-end amenities found in Class A motor homes, but in a sleek, easy-to-manuever package. Inside the Aspect, you'll encounter contemporary styling, including the hoop-base lounge chair that you can position in your favorite spot when you're not traveling (26A). Our SmartSpace™ design philosophy allows you to live large, making the most of available space by focusing on innovative features that increase functionality and comfort. Choose the available UltraLeather® package, shown here, for additional comfort.

Enhance movies and music with the available Deluxe Sound System with 5-Channel QSurround™ and an available 300-watt inverter that powers the entertainment center from the house batteries when 110-volt power is not available.

On the cover: 29H with Mineral Full-Body Paint



26A



## Fully Loaded.

It's easy to make yourself at home in a motor home full of features such as day/night pleated shades and heating and air-conditioning controlled by a residential-style, wall-mounted thermostat.

Cooks will appreciate the space-saving features in the galley, especially the slideout pantry (not available on the 29H) and double-bowl sink with cover. A water filtration system is available for clear, fresh drinking water. Other thoughtful touches include a skylight in the shower, vinyl floor covering in the galley and bath areas, and a child safety-seat tether in the dinette.

**WEB** Select a Key Feature

The **WEB** icon designates a Winnebago Industries Key Feature. For further in-depth information and photos, use the Search Window or click on the Key Features page at [winnebagoind.com](http://winnebagoind.com).



**29H Stormy Ridge with Washed Maple**

Choose the 29H floorplan and enjoy the abundant living space created by front and rear slideouts. You'll have plenty of hot water with the standard LP water heater or choose the available electric/LP water heater with EMS (energy management system). This system monitors the microwave and the electric water heater usage and temporarily postpones the electric operation of the water heater while the microwave is running to minimize the possibility of tripping a campground circuit breaker.



**Drawer Slides**



29H

### Dinner and a Movie.

Curl up on the rear sofa/queen bed and enjoy a movie on the 14-inch LCD TV.



29H

### Perfect for a Little R & R.

The sofa/queen bed converts into a lounge, creating a relaxing space to stretch out.



29H

### A Good Night's Sleep Awaits.

The sofa easily converts from a sofa to a comfortable queen-sized bed.



29H

### A Place for Everything.

The large wardrobe has plenty of room for your clothing, while the 14-inch LCD TV swivels and tucks out of the way when not in use.





**A Driver's Dash.**

You'll find all the controls, including power windows and door locks, positioned for a comfortable driving experience in the fully adjustable high-back cab seats. Choose the available Leather Laser-Wave dash appliqué and give your Aspect a distinct look and feel. The available rearview monitor mounts neatly between the visors for improved visibility when backing and maneuvering.



**Behind the Wheel.**

While you drive, listen to the radio or CDs on the RV Radio®. It even has a one-touch weather band so you can hear instant weather updates at the touch of a button. Large buttons and two convenient remotes make it easy to operate. Upgrade your RV Radio with the available Sirius® Satellite Radio package. Sirius brings you 120 channels of crystal clear programming, and a six-month subscription is complimentary with this package.\*

Once you've settled in at your campsite, use the touchpad controls of the available HWH® hydraulic leveling system to quickly level the Aspect.



**Exterior Entertainment Center.**  
Enjoy your favorite music with the available exterior entertainment center. It features an AM/FM stereo, CD player, 12-volt DC powerpoint, TV jack and removable table.



**TrueLevel™**  
Eliminate guesswork when it comes to tank levels with our exclusive TrueLevel™ holding tank monitoring system. It incorporates detector cells that determine liquid levels from outside the tank. No probes means no more corrosion or clogging, just accurate readings time after time.



**Storage.**  
The Aspect features convenient and spacious exterior storage for easy access to all your gear.

\*Sirius Satellite Radio service not available in Canada.

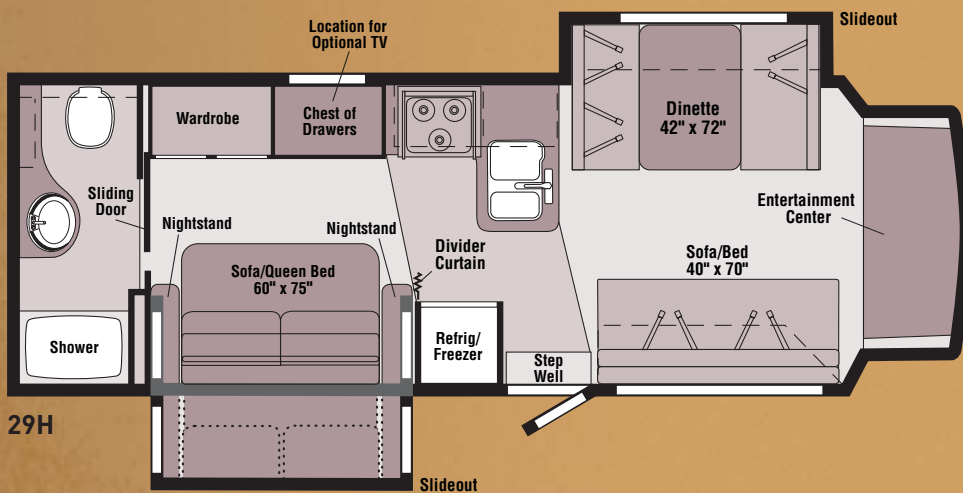
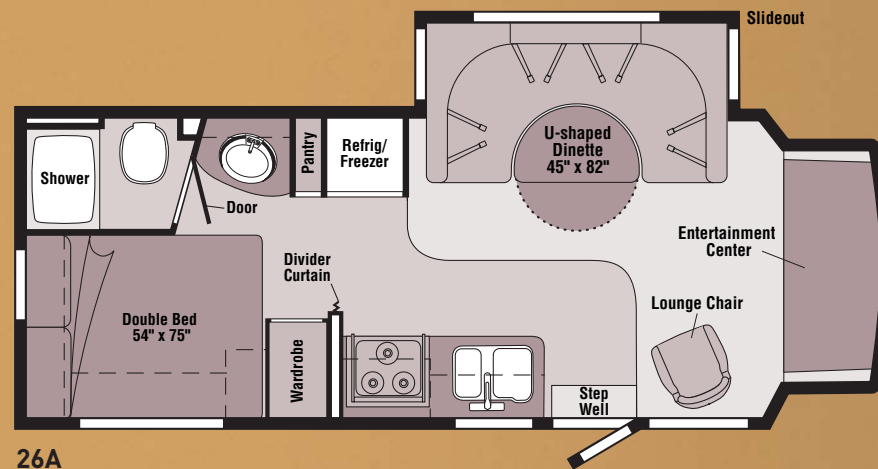
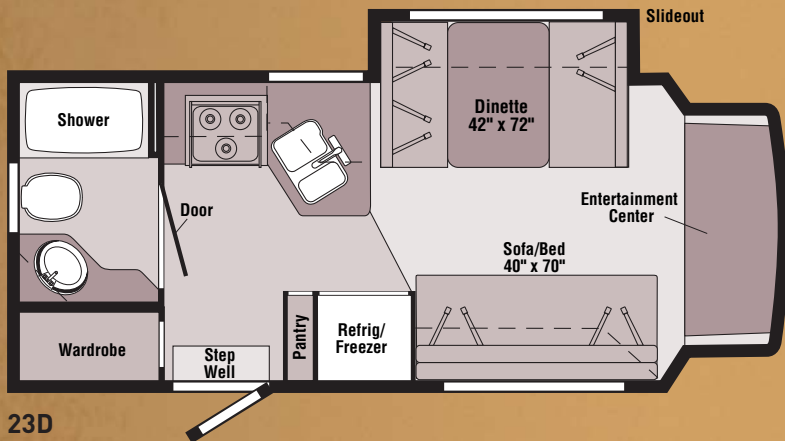

Note: Dimensions shown are for sleeping space only and may vary due to styling differences. Dashed lines denote overhead storage areas.





Cinnamon Spice



Stormy Ridge



Magic Moon



A-Main Fabric  
B-Carpet  
C-Accent



Sierra Maple



Washed Maple

Standard Graphics



Sandstone Beige Metallic



Spruce Green Metallic



Available Full-Body Paint



Mineral



Desert



WEIGHTS & MEASURES	23D	26A	29H
<b>Length</b>	23'8"	26'7"	29'11"
<b>Exterior Height<sup>1</sup></b>	10'3"	10'6"	10'5"
<b>Exterior Width</b>	7'11"	7'11"	7'11"
<b>Exterior Storage<sup>2</sup></b> (cu. ft.)	19.2	43	38.3
<b>Awning Length</b>	13'	17'	19'
<b>Interior Height</b>	6'5"	6'5"	6'5"
<b>Interior Width</b>	7'8"	7'8"	7'8"
<b>Freshwater Capacity w/Heater<sup>3</sup></b> (gal.)	33	43	39
<b>Holding Tank Capacity – Black/Gray<sup>3</sup></b> (gal.)	23/24	29/29	36/29
<b>LP Capacity<sup>4</sup></b> (gal.)	18	18	18
<b>Fuel Capacity</b> (gal.)	55	55	55
<b>GCWR<sup>5</sup></b> (lbs.)	18,500 <sup>A</sup> /20,000 <sup>B</sup>	20,000 <sup>B</sup>	20,000 <sup>B</sup>
<b>GVWR</b> (lbs.)	11,500 <sup>A</sup> /14,050 <sup>B</sup>	14,050 <sup>B</sup>	14,050 <sup>B</sup>
<b>GAWR – Front</b> (lbs.)	4,600 <sup>A</sup> /4,600 <sup>B</sup>	4,600 <sup>B</sup>	4,600 <sup>B</sup>
<b>GAWR – Rear</b> (lbs.)	7,800 <sup>A</sup> /9,450 <sup>B</sup>	9,450 <sup>B</sup>	9,450 <sup>B</sup>
<b>Wheelbase</b>	158" <sup>A</sup> /158" <sup>B</sup>	182" <sup>B</sup>	220" <sup>B</sup>

Standard - S	Optional - O	23D	26A	29H
--------------	--------------	-----	-----	-----

AUTOMOTIVE/CHASSIS			
<b>A - Ford® E350 Chassis</b> – 6.8L Super-Duty V10 SOHC Triton® engine, 305-hp, automatic transmission, Torqshift™ 5-speed with tow/haul feature, 4-wheel ABS, 130-amp. alternator, dual air bags (NA w/full-body paint)	S		
<b>B - Ford E450 Chassis</b> – 6.8L Super-Duty V10 SOHC Triton engine, 305-hp, automatic transmission, Torqshift, 5-speed with tow/haul feature, 4-wheel ABS, 130-amp. alternator, dual air bags	O	S	S
<b>Trailer Hitch<sup>5</sup></b> 5,000-lb. drawbar/350 lbs. maximum vertical tongue weight & wiring, 7-pin connector, <b>Wheels Liners</b> stainless steel	S	S	S
<b>Air Springs</b> auxiliary rear, <b>Wheels</b> stylized aluminum	O	O	O
CAB AREA & DRIVER CONVENIENCES			
<b>Beverage Holder, Cab Seats (Fabric)</b> armrest, fixed lumbar support, multiadjustable slide/recline, <b>Cruise Control, Curtain</b> cab divider, <b>Floor Mats</b> rubber, driver & passenger, <b>Power Door Locks</b> driver/passenger/main entry, <b>Power Cab Windows, Powerpoint</b> 12-volt DC/cigarette lighter, <b>Steering Wheel</b> tilt w/power-assist, <b>Sunvisors, Trim Panels</b> driver & passenger doors	S	S	S
<b>Cab Seats</b> UltraLeather®, <b>Instrument Panel</b> appliqué, <b>Leather Laser-Wave, Leveling Jacks</b> (front & rear) HWH® hydraulic, automatic, <b>Monitor System</b> rearview w/single camera, monitor, Audiovox®	O	O	O
ENTERTAINMENT			
<b>RV Radio® (Cab)</b> AM/FM/stereo/CD player w/weather band, speakers (4) w/remotes, <b>Radio Power Switch</b> main/auxiliary battery, <b>TV 24"</b> flat-face, color AC stereo w/remote, <b>Sony® TV Enhancement Package</b> 12-volt DC powerpoint, interior jack, coax wiring, cable input	S	S	S
<b>DVD</b> w/remote, 12-volt DC, <b>Entertainment Center (Exterior)</b> AM/FM radio w/CD player & remote, DC receptacle, AC duplex receptacle, TV jack, radio antenna, speakers (2), lockable compartment, removable TV table, <b>Satellite Radio</b> Sirius®, includes 6-month paid subscription (NA in Canada), <b>Satellite Dish Antenna</b> RV digital, manual, <b>Satellite System</b> King-Dome® RV digital, in-motion w/elevation sensing unit, <b>Deluxe Sound System</b> w/5-channel QSurround™ sound, amplifier, speaker system	O	O	O
<b>TV 14"</b> LCD stereo w/remote, 12-volt DC			O
INTERIOR			
<b>Ceiling</b> fabric, <b>Countertops</b> laminate, <b>Lights</b> ceiling, incandescent w/wall switches, <b>Powerpoint</b> 12-volt DC, <b>Shades</b> day/night pleated (lounge, dinette, & bedroom), <b>Mini Blinds</b> (galley & bath), <b>Roof Vent</b> nonpowered, lounge, powered, bath	S	S	S
<b>Roof Vent</b> powered ventilator fan, lounge, <b>Windows</b> dual-glazed/thermo-insulated	O	O	O
<b>Cupholder(s), Light</b> decorative dinette area	S		S
<b>Lights</b> halogen, <b>Lights</b> reading			S

1. The height of each model is measured to the top of the tallest standard feature and is based on the curb weight of a typically equipped unit. The actual height of your vehicle may vary by several inches depending on chassis or equipment variations. Please contact your dealer for further information.  
2. The load capacity of your motor home is designated by weight, not by volume, so you cannot necessarily use all available space when loading your motor home.  
3. Capacities are based on measurements prior to tank installation. Slight capacity variations can result due to installation applications.  
4. Capacities shown are tank manufacturer's listed water capacity (W.C.). Actual filled LP capacity is 80% of listing due to overfilling prevention device on tank.

Standard - S	Optional - O	23D	26A	29H
--------------	--------------	-----	-----	-----

FURNITURE			
<b>Dinette</b> w/access to storage below, <b>Sofa</b> w/throw pillow	S		S
<b>Chair</b> lounge, hoop-base, swivel/glider, <b>Dinette</b> U-shaped w/access to storage below, slideout baskets		S	
<b>UltraLeather Furniture Package</b> cab seats, dinette, sofa (NA 26A), lounge chair (26A only)	O	O	O
GALLEY			
<b>Faucet</b> single-control, Moen®, <b>Microwave/Convection Oven</b> Sharp® silver, <b>Range Top</b> 3-burner, drawer below, <b>Range Hood</b> vented w/light & fan, <b>Refrigerator/Freezer</b> large double-door, 2-way, Norcold®	S	S	S
<b>Countertop</b> flip-up extension		S	
<b>Pantry</b>	S	S	
<b>Range</b> 3-burner w/oven, w/drawer below, Magic Chef®, <b>Water Filtration System</b>	O	O	O
BATH			
<b>Cabinet</b> lavatory, <b>Cabinets</b> medicine, <b>Faucet</b> lavatory, single-control, <b>Faucet</b> shower, dual-control w/flexible showerhead, <b>Light</b> shower, <b>Shower Door</b> retractable, <b>Skylight</b>	S	S	S
BEDROOM			
<b>Bed</b> double, removable bed cover, pillows, pillow shams, throw pillow		S	
<b>Sofa/Bed</b> queen, split mattress			S
EXTERIOR			
<b>Awning</b> Rails w/rain gutters, <b>Door</b> entrance w/separate screen door, deadbolt lock, <b>Entrance Door Step</b> single, manual, <b>Ladder, Light</b> porch w/interior switch, <b>Mirrors</b> plate-mounted, manual adjust w/convex (NA w/full-body paint), <b>Mudflaps</b> rear, <b>Receptacle</b> AC duplex, <b>Running Boards</b> fiberglass w/front mud guard, <b>Sidewall Skin</b> 1-piece smooth fiberglass, <b>Storage Compartments</b> w/trunk liner	S	S	S
<b>Awning</b> patio, metal wrap, <b>Entrance Door Step</b> single, electric w/doorjamb switch, <b>Mirrors</b> plate-mounted, electric/remote w/defroster, white (silver w/deluxe graphics only), <b>Running Boards</b> fiberglass w/front wheel lips (w/full-body paint only)	O	O	O
SYSTEMS			
<b>HEATING/AC – Automotive Heater/Air Conditioner</b> blend air system, <b>Air Conditioner (Roof)</b> 13,500 BTU, ceiling-ducted w/wall thermostat	S	S	S
<b>AC Heat Pump</b>	O	O	O
<b>Furnace</b> 25,000 BTU, low-profile	S		
<b>Furnace</b> 30,000 BTU, low-profile		S	S
<b>ELECTRICAL – Auxiliary Start Circuit, Battery (1) (Coach)</b> Group 24 deep-cycle, <b>Battery (Coach)</b> disconnect system, <b>Battery Charge Control</b> automatic dual, <b>Electrical Distribution System</b> AC breaker panels, DC automotive fuses, 45-amp. converter/charger, <b>Generator Prep Kit, Monitor Panel</b> battery condition gauge, generator hourmeter gauge, generator start/stop switch, holding tank levels, LP tank level, water heater lights, water heater switch, water pump switch, water tank level, <b>Power Cord</b> 30-amp. 25', <b>Service Center (Electrical)</b> cable input, power cord, portable satellite dish hookup	S	S	S
<b>Batteries (2)</b> Group 24 deep-cycle, <b>Generator</b> 4,000-watt Onan® MicroQuiet™ gas, <b>Inverter</b> DC/AC, 300-watt	O	O	O
<b>PLUMBING/LP – Drain</b> water tank, 1" brass ball valve w/lever, <b>Service Compartment (Drainage/Water)</b> pressurized city water hookup/tank diverter fill, drainage valves, 10' sewer hose, <b>Tank</b> holding, heated compartment (26A & 29H only), <b>Tank LP</b> , permanent mount w/gauge, <b>TrueLevel™</b> holding tank monitoring system, <b>Water Heater</b> 6-gallon electronic ignition, LP gas, <b>Water System</b> <b>Winterization Package</b> water heater bypass valve & siphon tube, <b>Water Pump</b> demand, permanent magnet motor w/diaphragm	S	S	S
<b>Drainage System</b> heated, electric (requires second coach battery) (NA Canada)	O		
<b>Exterior Wash Station</b> w/lighted pump switch, <b>Water Heater</b> 6-gallon electronic ignition, 120 VAC/LP gas w/energy management system	O	O	O
SAFETY			
<b>Airbags</b> driver & passenger, <b>Assist Bar</b> interior, <b>Assist Handle</b> exterior, soft-touch, <b>Bumpers</b> front & rear, <b>Child-Seat Tether Anchor, Courtesy Lights</b> interior, <b>Detectors/Alarms</b> LP leak, smoke, carbon monoxide, <b>Fire Extinguisher</b> 10 BC, <b>Ground Fault Interrupter, Lights</b> high-mount brakelamps, <b>Seat Belts</b> cab, 3-point adjustable, <b>Seat Belts</b> lap (in selected areas), <b>Window</b> escape	S	S	S
WARRANTY <sup>6</sup>			
<b>12-month/15,000-mile basic limited warranty,<sup>7</sup> 36-month/36,000-mile limited warranty on structure,<sup>7</sup> 10-year limited parts &amp; labor warranty on roof skin<sup>7</sup></b>	S	S	S

5. Actual towing capacity is dependent on your particular loading and towing circumstances, which includes the GVWR, GAWR and GCWR, as well as adequate trailer brakes. Please refer to the Operator's Manual of your vehicle for further towing information.  
6. See separate chassis warranty.  
7. See your dealer for complete warranty information.  
Not all items available in combination. See dealer for details. NA – Not Available  
Winnebago Industries® continuing program of product improvement makes specifications, equipment, model availability and prices subject to change without notice. Comparisons to other motor homes are based on the most recent information available.



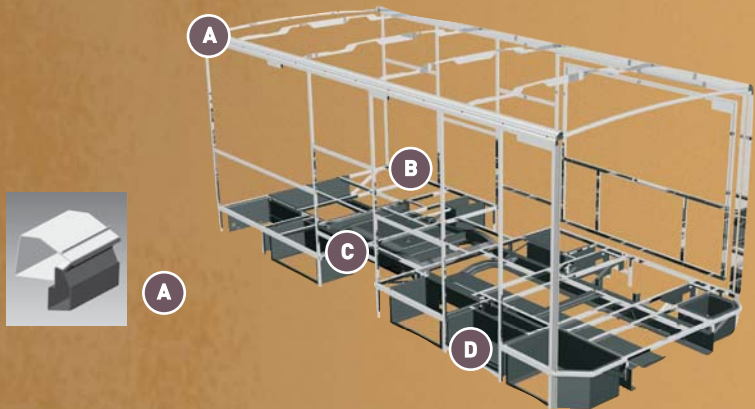

SUPERSTRUCTURE® is the term given to Winnebago Industries' structural motor home design and construction. Rather than a single component, it is the culmination of design integration that incorporates steel and aluminum substructures; welded tubular steel floor supports; interlocking joint technology; and Thermo-Panel® floor, roof and sidewalls to form a high-strength, durable vehicle body.

Thermo-Panel manufacturing combines a durable exterior panel with welded aluminum support substructures. The substructures are embedded in a high-density, block-foam insulation core to create a strong, durable, yet lightweight sidewall. Just another Winnebago Industries invention.

- A** Interlocking joint construction utilizes advanced extruded aluminum structural components to create integrated floor-to-sidewall and sidewall-to-roof joints. This design effectively distributes the weight of the walls and roof, making a stronger and more durable body than competitor designs that rely on screws to carry the weight.
- B** The foundation substructure assembly is precision-aligned to maximize strength and cross-coach support as well as durability.
- C** Tubular steel floor supports provide a stable base for the floor structure and storage compartments.
- D** Critical steel components are treated using an advanced electrodeposition coating process that provides superior corrosion protection.



One-year-old Winnebago Industries' fiberglass roof



One-year-old competitor's rubber roof

#### BUILT TO A HIGHER STANDARD.

The 2007 Aspect features a crowned, one-piece fiberglass roof skin backed with a 10-year limited parts-and-labor roof skin warranty. Fiberglass offers superior strength, attractiveness and durability compared to rubber roofs found on many competitive models. Over time, rubber roofs are susceptible to chalking, streaking and degradation, and have less puncture and tear resistance than fiberglass.



**Take a Tour** We're proud of our process, our state-of-the-art facilities and the people who make Winnebago Industries number one. We invite you to visit our factory in Forest City, Iowa, for a firsthand look at the dedication and technology behind every motor home we build.



**Recognized Quality** The Recreation Vehicle Dealer Association annually rates RV manufacturers and awards the Quality Circle award to manufacturers who provide exceptional products, service and support. Winnebago Industries is proud to be the only manufacturer to receive this award every year since its inception.



**Committed to Service** We back our motor homes with the industry's best service after the sale.

- 12-month/15,000-mile basic limited warranty
- 36-month/36,000-mile limited warranty on structure
- Standard 10-year limited parts-and-labor roof skin warranty
- Complimentary 24-hour roadside assistance program
- TripSaver Fast Track Parts. TripSaver guarantees that in-stock warranty parts ship directly to your dealer within 24 hours.
- National dealer service network



**WIT Club** Winnebago owners are like family. Joining the Winnebago-Itasca Travelers is a great way to meet and travel with other Winnebago enthusiasts. Members enjoy:

- Caravans and rallies
- Local and state group activities
- RV travel benefits



**Visit the Web** Visit us on the Web for more information on all of our motor homes and a host of Web-exclusive content. [winnebagoind.com](http://winnebagoind.com)

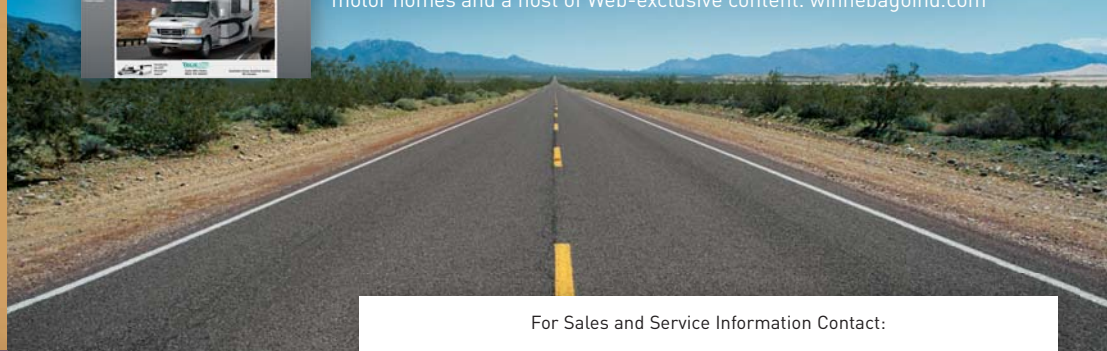

For Sales and Service Information Contact:

Built proudly by



NYSE listing: WGO