

A Fresh New Look, Inside and Out.

2006 WINNEBAGO VIEW™



A STRIKING NEW ADDITION TO WINNEBAGO'S LINEUP OF MOTOR HOMES.

A Mercedes-Benz® diesel engine. Cutting-edge interior design. An innovative approach to storage. Just a few of the things that set the 2006 Winnebago View apart.

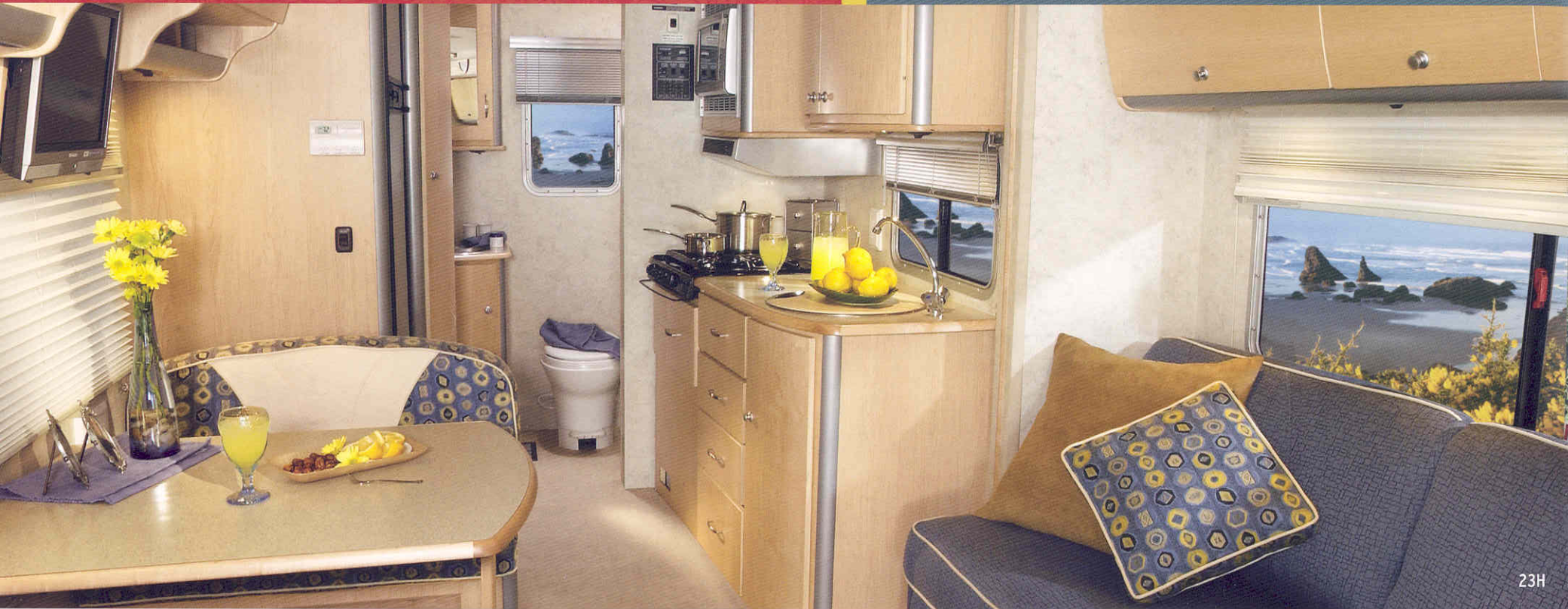

23H

INTRODUCING THE 2006 WINNEBAGO VIEW.

From the moment you lay eyes on the View, you know you've found a motor home like no other. Whether it's the exterior styling, cab, lounge or galley, you'll see innovations that maximize function and style at every turn. Check out the interior cabinetry featuring curved lines that not only look great, but also increase available storage space. A stainless steel galley sink is sized to accommodate large pans with ease. The View's interior climate is just as inviting, with day/night pleated shades, floor-ducted heat and ceiling-ducted air conditioning. Choose the available heat pump and take the chill off a cool morning without using LP.

The skylight — another unique View feature — opens as a fresh air vent complete with retractable screen and sun shade. The dinette features comfortable seating for four as well as a child-seat tether in the forward-facing seat (23J only), and it easily converts to a comfortable bed. A 15" LCD TV with DVD player is mounted above the dinette for your viewing pleasure. The TV even retracts into the overhead when not in use (23J only).

Don't let the open layout fool you; there's no shortage of available storage in the View. There are large overhead cabinets with handy open shelves below, easy-to-access under dinette storage, underbed storage in the 23J and even expandable storage in the rear wardrobe of the 23H.

On the cover: 23H with Vivid Blue/Bright Yellow Graphics.



23H

COMPACT SIZE. PACKED FULL OF FEATURES.



A NEW KIND OF MOTOR HOME.

The View differs from many Class C motor homes in that it gets its power from a 2.7 liter Mercedes-Benz diesel engine. The 5-cylinder turbo-diesel is remarkably quiet, delivering both consistent power and diesel fuel efficiency. An electronically controlled automatic transmission and power rack-and-pinion steering give the View excellent drivability and a tight turning radius. Four-wheel ABS disc brakes with automatic skid control provide added peace of mind on slippery roads. Getting in the View is a breeze too, thanks to cab doors that open nearly 90 degrees.

The living area is also easy to get to, thanks to the large opening provided by our exclusive cutaway chassis design, coupled with the spacious (49" x 75") overhead bunk that easily flips up and out of the way. Or you can choose the front overhead storage cabinet on the 23J floorplan.



NEW FOR THE KITCHEN AND BATH.

Modern design influences are also apparent in the galley's beautiful curved cabinet doors with satin nickel hardware. The full-extension drawer slides provide easy access to all your stored items. You'll appreciate the stylish functionality of the Sharp® microwave/convection oven and three-burner range top with storage below. Add the optional cold-water purification system to the galley sink for a refreshing drink of filtered water anytime.

Step into the bath area and you'll notice chrome fixtures; a stainless steel sink; and an innovative retractable shower door. A flexible showerhead makes showering easy, while the removable clothes rod gives you additional storage. More storage space is also available in the mirrored-door medicine cabinet, the vanity cabinet and the wardrobe.



THE BEST SEAT IN THE HOUSE.



THE COCKPIT OF YOUR DREAMS.

The cab of the View puts all controls within easy reach. State-of-the-art features include a flip-out key that is electronically encoded for anti-theft security. The power door lock remote is built into the handle, eliminating the need for a separate transmitter. A Sirius® satellite-ready, Clarion® AM/FM/CD in-dash radio with wireless remote allows you to enjoy your favorite music or talk radio. When parked, save the engine battery and run the radio on the house batteries by flipping the radio power switch. To make parking easier than ever, choose the available rearview monitor with one-way audio. Creative use of space, such as the storage designed into the driver and passenger doors, is just another example of what sets the View apart.



LOOKS AND FEELS GREAT.

Every driving experience should be as enjoyable as it is in the View. Once behind the wheel, you'll immediately notice the comfort of adjustable driver and passenger seats. These comfy seats come standard and allow you to slide, recline and dial in the adjustable lumbar support. A handy dash clip puts maps and directions at your fingertips. A plush carpet floor mat in the cab area can be removed for quick cleanup. And for your safety, driver and passenger airbags come standard. For a luxurious touch, choose the optional Brushed Aluminum appliqué for the instrument panel and beverage holder.

INNOVATIONS AREN'T LIMITED TO THE INTERIOR.

Be prepared to attract some attention the first time you pull into a campsite in the View. Consider it a small price to pay for owning the latest from the industry leader.

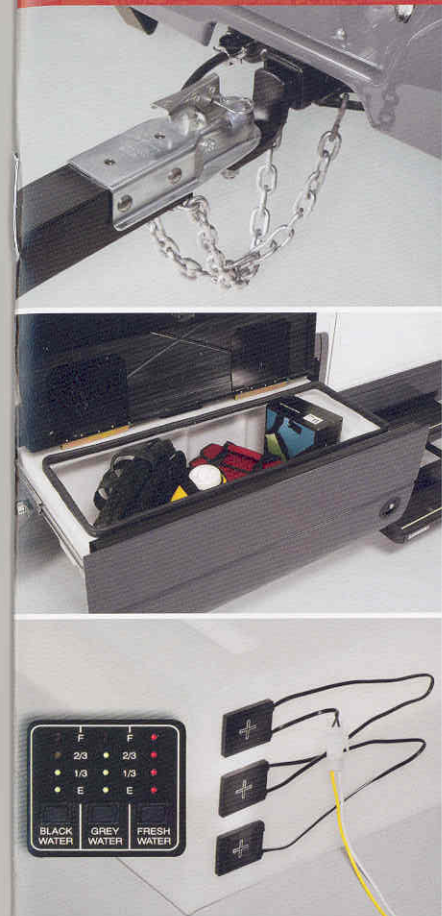

WINNEBAGO INNOVATIONS AND QUALITY THROUGHOUT.

Bring your favorite towable plaything along using the beefy 3,500-pound hitch with 350-pound vertical tongue weight. You can keep dirt and grime off your belongings with the sealed lid on our slideout storage bin. It even includes a drain plug for added versatility. Our innovative TrueLevel™ tank monitoring system uses Mirus™ detector cells on the water storage tanks to precisely determine liquid levels from outside the tank, putting an end to inaccurate tank-level readings. Versatile storage is made possible by our innovative mattress configuration. The rear mattress is made in two parts, allowing you to slide the outer mattress in, exposing a large underbed storage area that can be accessed from inside or outside the motor home, perfect for bikes, golf bags or other large items. The exterior service center houses many vital motor home utilities, including city water hookup and available exterior

shower with pump switch. Electrical center hookups can also be found here, including the power cord with QuickPort® service connection hatch, cable TV connection and a portable satellite dish hookup.

Keep you and your loved ones protected from the heat of the midday sun with the available exterior awning. Our fiberglass roof resists chalking and outlasts our competitors' rubber roofs. The contoured lower ABS valance panels and doors are rustproof and resist denting and chipping. Wheel covers and a spare tire cover come standard, or upgrade by choosing the available stylized aluminum wheels. Keep the windshield clean with the help of the built-in steps found on the front bumper. Reaching the roof is equally hassle-free, thanks to the rear fold-down exterior ladder. Choose the available Onan® MicroQuiet™ 3600 generator for power anywhere the road takes you.

FLOORPLANS TO FIT YOUR LIFE.

The View gives you the choice of two exciting floorplans that blend Winnebago quality construction with the latest in modern design and innovative features.

INTERIORS

23H

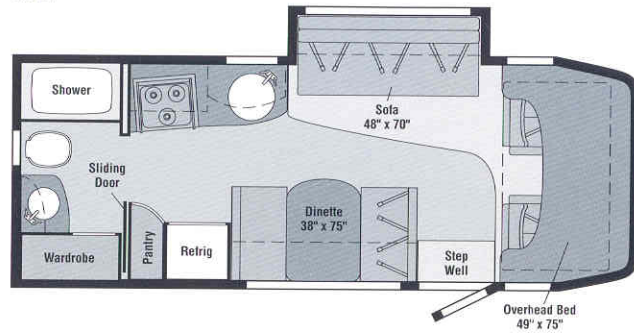

Note: Dimensions shown are for sleeping space only and may vary due to styling differences.

23J

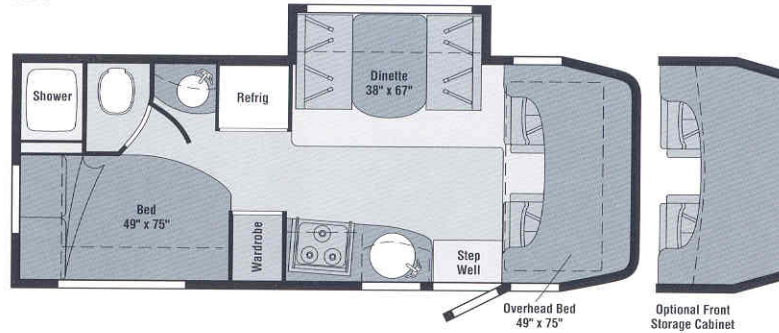

Storm Gray with Vivid Blue/Bright Yellow



ATTENTION TO DETAIL. INSIDE AND OUT.

We believe the same high standards we apply to construction should apply to interior design. That's why we design efficient floorplans based on customer input and why we select comfortable and durable fabrics in pleasing colors.



Storm Gray with Tomato Red/Bright Yellow



Butter Rum



Durango Denim



Honey Cherry



Washed Maple

2006 VIEW SPECIFICATIONS

	23H NEW	23J NEW
Length	24'2"	24'2"
Exterior Height^a	10'9"	10'9"
Exterior Width	7'6"	7'6"
Exterior Storage^b (cu. ft.)	12	25
Interior Height	6'8"	6'8"
Interior Width	7'3"	7'3"
Freshwater Capacity w/Heater^c (gal.)	34	34
Holding Tank Capacity^c - Black/Gray (gal.)	33 / 32	31 / 38
LP Capacity^d (gal.)	18	18
Fuel Capacity (gal.)	26.4	26.4
GCWR^e (lbs.)	13,700	13,700
GVWR (lbs.)	10,200	10,200
GAWR - Front (lbs.)	3,859	3,859
GAWR - Rear (lbs.)	7,056	7,056
Wheelbase	159"	159"

Standard - S Optional - 0

23H 23J

AUTOMOTIVE/CHASSIS

Chassis - Dodge® Sprinter 2.7L CDI 5-cylinder turbo-diesel, 154-hp, automatic 5-speed transmission w/tip shift, 4-wheel ABS w/skid control, 150-amp. alternator, dual rear wheels, Tire spare with cover, Tire Tool wrench, Tool Kit , Trailer Hitch ® 3,500-lb. drawbar/350 lbs. maximum vertical tongue weight & 6-pin wiring connector, Wheel Covers 16.0" (4)	S	S
Air Springs aux. rear, Wheels aluminum	0	0

CAB AREA & DRIVER CONVENIENCES

Beverage Holders , Cab Seats (fabric), armrest, adj. lumbar support, headrest vertical adj., 6-way adj. pedestal, Cigarette Lighter/12-Volt DC Powerpoint , Cruise Control , Curtain cab divider, Document Clip , Floor Mats carpet fitted, Glove Compartment , Hood Release , Light dome , Monitor System rear view, cable ready, Power Door Locks w/remote control, driver/passenger/main entry, Power Cab Windows , Sunvisors , Temperature outside gauge, Trim Panels driver & passenger doors, Windshield Wipers intermittent	S	S
Instrument Panel Appliqué Brushed Aluminum, Monitor System rearview w/single camera, 1-way audio	0	0

ENTERTAINMENT

DVD player, Radio (cab) AM/FM/stereo/CD player/remote/satellite ready/speakers (2) cab, (2) coach, Clarion, Radio Power Switch main/aux., battery, Satellite System Ready , TV 15" DC, LCD w/remote, TV Antenna (amplified) interior jack(s), coax wiring, cable input	S	S
Satellite Radio receiver includes 6-month paid Sirius subscription	0	0

INTERIOR

Bunk front overhead w/hinged 1-piece mattress, bunk ladder, privacy curtain, windows, storage trays, light, Ceiling fabric, Lights decorative overhead, dinette, Lights ceiling, incandescent w/wall switches, Light stepwell, Mini Blinds (galley & bath), Skylight w/bar handle, sliding screen, sliding pleated shade, Shades day/night pleated (lounges & dinette), 12-Volt DC Powerpoint , Windows tinted	S	S
Cabinet front overhead storage, accent lights		0

CABINetry

Washed Maple curved door w/hidden hinges, Honey Cherry curved door w/hidden hinges	0	0
--------------------------------------------------------------------------------------------------	---	---

COUNTERTOPS

Laminate w/quarter-round wood edge	S	S
-------------------------------------------	---	---

FLOORCOVERING

Carpeting w/pad, Vinyl galley, bath, Stepwell rubber tread	S	S
---------------------------------------------------------------------------------	---	---

a The height of each model is measured to the top of the tallest standard feature and is based on the curb weight of a typically equipped unit. The actual height of your vehicle may vary by several inches depending on chassis or equipment variations. Please check with your dealer for further information.

b The load capacity of your motor home is designated by weight, not by volume, so you cannot necessarily use all available space when loading your motor home.

c Capacities are based on measurements prior to tank installation. Slight capacity variations can result due to installation applications.

d Capacities shown are tank manufacturer's listed water capacity (W.C.). Actual filled LP capacity is 80% of listing due to overfilling prevention device on tank.

e Actual towing capacity is dependent on your particular loading and towing circumstances, which includes the GVWR, GAWR, and GCWR as well as adequate trailer brakes. Please refer to the Operator's Manual of your vehicle for further towing information.

Each and every part that goes into our motor homes is thought out. From the nap of the carpet we choose to the capacity of the refrigerator, no detail is too small to avoid our scrutiny.

Standard - S Optional - 0

23H 23J

FURNITURE

Dinette w/interior and exterior access to storage below front seat, Sofa w/access to storage below, throw pillow	S	
Dinette w/interior access to storage below both seats		S

GALLEY

Faucet dual-control, Microwave/Convection Oven , Range Top 3-burner, drawer below, Range Hood vented w/light & fan, Receptacle duplex, Refrigerator/Freezer large double-door, decorative insert panel, Norcold®, Sink single-bowl, stainless steel, round w/sink cover	S	S
Pantry	S	
Water Purification System	0	0

BATH

Cabinet lavatory, Cabinet medicine, Faucet (lavatory) dual-control, Faucet (shower) dual-control w/flexible showerhead, Light shower, Mirror , Roof Vent powered, Shower wall surround w/removable clothes rod, Shower Door retractable screen, Sink round, stainless steel, Skylight , Toilet w/foot-pedal flush & sprayer	S	S
Roof Vent powered ventilator fan	0	0
Wardrobe shelf, clothes rod	S	

BEDROOM

Bed angle split mattress, pillows, pillow shams, interior and exterior access to storage below, Lights reading, Privacy Curtain , Shades day/night, pleated, Wardrobe shelf, clothes rod		S
-----------------------------------------------------------------------------------------------------------------------------------------------------------------------------------------------------------------------------	--	---

EXTERIOR

Awning Rail w/rain gutter, Bumper front w/step grooves (2), Door entrance w/separate screen door, deadbolt lock, remote keyless entry, Entrance Door Steps double-electric w/doorjamb switch, Exterior Graphics Packages Storm Gray w/Vivid Blue/Bright Yellow or Storm Gray w/Tomato Red/Bright Yellow, Ladder hinged folding extension, Light porch w/interior switch, Mirrors electric remote w/defrost, folding extended arms, Mudflaps front & rear, Pullout Storage Drawer with sealed lid, Receptacle AC duplex, Sidewall Skin one-piece smooth fiberglass, Storage Compartments w/bottom trunk liner	S	S
Awning patio, box style	0	0

SYSTEMS

Automotive Heater/AC blend air system, AC (roof) 13,500 BTU, ceiling-ducted w/wall thermostat, Aux. Start Circuit , Batteries (coach) (2) Group 24 deep-cycle, Battery (coach) disconnect system, Battery Charge Control automatic dual, Drain water tank, 1" Electrical Distribution System AC breaker panel, DC automotive style fuses, 45-amp. converter/charger, Furnace 25,000 BTU, ducted in floor, Generator Prep Kit , Monitor Panel battery condition gauge, generator hourmeter gauge, generator start/stop switch, holding tank levels, LP tank level, water heater light(s), water heater switch, water pump switch, water tank level, Power Cord 30-amp., Service Compartment (drainage/water) city water hookup/tank diverter fill, drainage valves, 10' sewer hose, Service Center (electrical) cable input, power cord, portable satellite dish hookup, QuickPort service connection hatch, Tank LP , permanent mount w/gauge, TrueLevel holding tank monitoring system, Water Heater 6-gallon electronic ignition, LP gas, flush-mount door, Water System Winterization Package water heater bypass valve & siphon tube, Water Pump demand, Water Tank Fill gravity w/locking door	S	S
AC Heat Pump , Drainage System heated, 12-Volt electric, Exterior Wash Station w/lighted pump switch, Generator 3,600-watt Onan MicroQuiet, LP, Water Heater 6-gallon ignition, 120 Vac/LP	0	0

SLIDEOUT

Slideout Room dinette w/slideroom cover		S
Slideout Room sofa w/slideroom cover	S	

SAFETY

Airbags driver & passenger, Assist Bar interior, Bumpers front & rear, Detectors/Alarms LP leak, smoke, carbon monoxide, Fire Extinguisher 10 BC, Ground Fault Interrupter , Lamps daytime running, fog, Lights high-mount LED brake, Seat Belts cab, 3-point, adj. Seat Belts lap (in selected areas), Window escape	S	S
Child-Seat Tether Anchor		S

WARRANTY^f

12-month/15,000-mile basic warranty , ^g 36-month/36,000-mile warranty on structure , ^g 10-year limited parts & labor warranty on roof skin ^g	S	S
--------------------------------------------------------------------------------------------------------------------------------------------------------------------------------------------------------	---	---

^f See separate chassis warranty details provided in Owner's Manual.

^g See your dealer for complete warranty information.

Not all items available in combination. See dealer for details.

Winnebago Industries® continuing program of product improvement makes specifications, equipment, model availability, and prices subject to change without notice. Comparisons to other motor homes are based on the most recent information available.

NOT ALL MOTOR HOMES ARE CREATED EQUAL. As you take a closer look, you'll see that there is much more to the Winnebago View than a long list of standard features and compelling floorplans. Beneath it all you'll find a SuperStructure® foundation of strength and durability, and Winnebago Industries' recognized service and warranty support.



We are committed to service. We back our motor homes with the best after-the-sale service in the industry. This includes a 12-month/15,000-mile basic limited warranty; 36-month/36,000-mile warranty on structure; standard 10-year limited parts-and-labor roof skin warranty; and complimentary 24-hour Roadside Assistance Program. TripSaver Fast Track Parts guarantees that in-stock warranty parts ship directly to your dealer within 24 hours. Winnebago Industries has a nationwide dealer service network.



Certified quality. Recreation Vehicle Dealer Association members annually rate RV manufacturers on the quality of their products, and on their sales and service support. Winnebago Industries has achieved the coveted Quality Circle Award every year since its inception, the only RV manufacturer to do so.



Warning: Joining WIT has been known to cause excessive fun. Winnebago-Itasca Travelers (WIT) is a club for owners of Winnebago Industries motor homes. WIT is a great way to meet people and offers you caravans and rallies, local and state group activities, and other benefits for RVers.



Seat belts are your most important hookup. Always buckle up.

NYSE listing: WGO

Visit www.winnebagoind.com for virtual product tours and the latest product updates.

©2005 Winnebago Industries Inc., Forest City, IA 50436. Printed in USA.



A

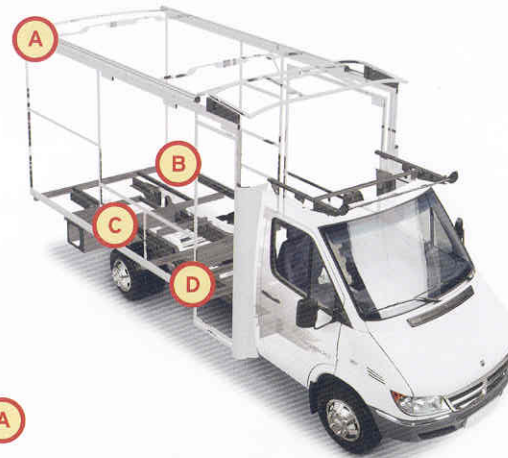

SUPERSTRUCTURE is the term given to Winnebago Industries' structural motor home design and construction. Rather than a single component, it is the culmination of design integration that incorporates steel and aluminum substructures; welded tubular aluminum floor supports; interlocking joint technology; and Thermo-Panel® floor, roof and sidewalls to form a high-strength, durable vehicle body.

Thermo-Panel manufacturing combines a durable fiberglass exterior panel with welded aluminum support substructures. The substructures are embedded in a high-density, block-foam insulation core to create a strong, durable, yet lightweight sidewall. Just another Winnebago Industries' invention.

- A Interlocking joint construction utilizes advanced extruded aluminum structural components to create integrated floor-to-sidewall and sidewall-to-roof joints. This design effectively distributes the weight of the walls and roof, making a stronger and more durable body than competitor designs that rely on screws to carry the weight.
- B The foundation substructure assembly is precision-aligned to maximize strength and cross-coach support as well as durability.
- C Tubular aluminum floor supports provide a stable base for the floor structure and storage compartments.
- D Critical steel components are treated using an advanced electrodeposition coating process that provides superior corrosion protection.



One-year-old Winnebago Industries fiberglass roof



One-year-old competitor's rubber roof

BUILT TO A HIGHER STANDARD.

The View features a crowned, one-piece fiberglass roof skin backed with a 10-year limited parts-and-labor roof skin warranty. Fiberglass offers superior strength, attractiveness and durability compared to rubber roofs found on many competitive models. Over time, rubber roofs are susceptible to chalking, streaking and degradation, and have less puncture and tear resistance than fiberglass.