

# WINNEBAGO CHIEFTAIN





# CHIEFTAIN. THE HIGH-STORAGE MOTOR HOME THAT KEEPS A LOW PROFILE.

To create a motor home that stores everything from scuba gear to fine china without compromising its handling and "drivability" is a challenge.

So Winnebago's engineers started fresh. Using a clean drawing board, their own imaginations, and the most advanced design computers in the industry, they developed the new Chieftain®—a unique high-storage, low-profile motor home.

By slightly raising the floor and placing extra-large storage compartments around the lower exterior, Chieftain can carry gear like a basement motor home. Yet its roof remains lower than other high-storage motor homes. And because Chieftain has a lower roof, its center of gravity is also lower.

Chieftain's unique new design allowed Winnebago engineers to place the furnace and its insulated central duct work under the floor, allowing even heat distribution and more efficient use of interior space. Some models have a unique multi-position bathroom door and folding bathroom wall that provides maximum space and flexibility.

The water system controls have been placed in a convenient single exterior compartment. For cold weather use, the holding tanks are located in a heated, insulated compartment. And the LP tank has been redesigned to maximize exterior storage space.

New design concepts like these and others make Chieftain the most innovative

and easy-to-operate Class A motor home you can own. And its sales record proves it. The sales success of 1989, Chieftain will continue to be the sales leader in 1990 as RVers discover its unbeatable value.

The 1990 Chieftain offers five popular floor plans, ranging from the efficient 25-foot model to the spacious 36-foot tag axle model. On the outside, each of the Chieftain models will sport attractive new graphic colors. Inside, the decor features luxurious appointments like hand-finished cabinetry, plush carpeting, brand name appliances and comfortable furniture.

The 1990 Chieftain models will offer these new options: vinyl floorcovering in the galley for easy clean-ups and, on the larger models, a Ford chassis option in addition to the standard Chevrolet chassis.

Winnebago is a conscientious builder of motor homes. From the assembly line to the test track, no other motor home manufacturer can match Winnebago's investment in outstanding engineering, construction, and product testing.

With great attention to detail and design quality, an extensive warranty, the best dealers, a long list of standard and optional features, and the highest resale value in the industry, the Winnebago Chieftain will continue to be the motor home industry's leader for 1990 and beyond.

Visit your nearest Winnebago dealer and check out the unbeatable Chieftain. You'll be glad you did.



1. The storage bays are wide and roomy and the two deep-cycle batteries pull out of a separate storage compartment for easy access. An extra deep rear storage bay will accommodate longer items like skis or golf clubs.
2. The storage compartments are lined with tough, wear-resistant carpet that protects your stored items. They feature insulated doors and convenient spring-loaded props inside the larger compartments for improved sidewall





appearance. The optional exterior accessory package includes handy, plastic pull-out drawers and a tool box. **3.** The extra-wide entrance door features a standard electric step for ease of entry and a heavy-duty screen door. **4.** There's a handy storage compartment in the stepwell. The steps are evenly spaced to avoid tripping, unlike some competitive

motor homes. **5.** For your convenience, the water connections are in a single compartment. A trap door allows connection of a water hose with the compartment door closed. An exterior faucet/drain gives you access to the fresh water tank for quick clean-ups and easier winterization.





6. From the cushioned vinyl ceiling to the wall-to-wall carpeting, the Chieftain's luxurious new interior is filled with quality features and materials built by Winnebago Industries, like oak cabinet doors and Stitchcraft furniture. 7. The optional Sony rearview TV monitor system eases backing up. It features a brighter, clearer picture, better low-light sensitivity and a rear-mounted microphone so you can hear an assistant's directions. 8. A unique new feature

developed exclusively by Winnebago Industries is the passenger seat on the 31-RQ model. It can be lowered or raised electrically and swivels for use with the lounge table. 9. Switches for the optional, heated, remote-control rear-view mirrors and driver's power window are conveniently located on the door below the window. 10. The optional 13-inch remote-control color television and remote control VCR with switching system offers multiple



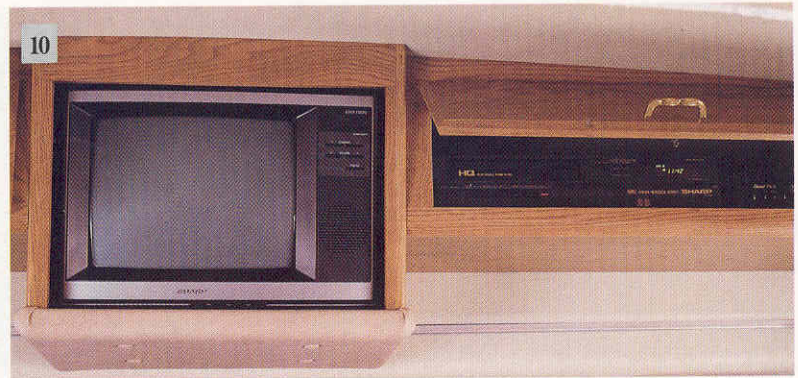
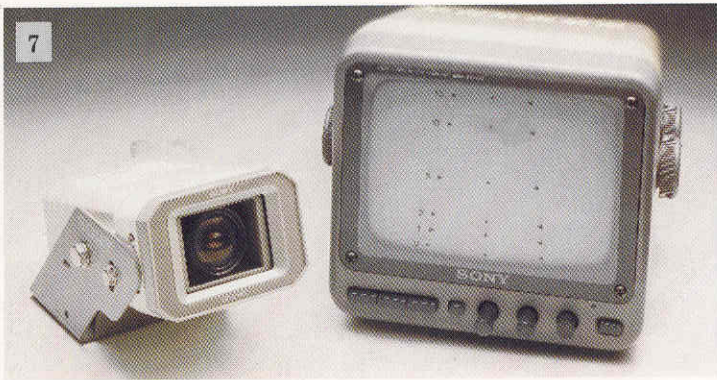

viewing choices. An optional TV/VCR inverter lets you use battery power when plug-ins are not available. **11.** Standard features in the cockpit include high-output blend air automotive heater/air conditioning, cruise control, a multi-position driver's seat, and a solid oak beverage tray. The angle of the Chevrolet chassis steering wheel is tilted 3° more toward the driver for increased comfort—a Winnebago Industries exclusive. New for 1990 with the

optional overhead bunk is a screened, tip-out window above the driver's door for extra ventilation. **12.** The extra wide driver's door includes an optional power window, a low mounted exterior latch, a courtesy light and a map pocket. Shown are radial tires and optional stainless steel wheel liners.



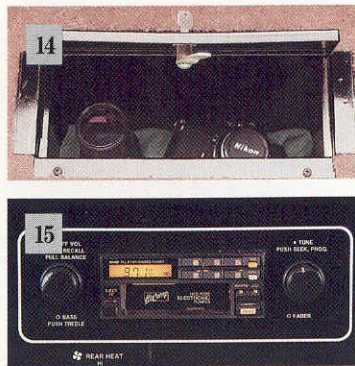

**13.** The lounge area couch easily folds out into a comfortable bed. **14.** The lock box is mounted in the floor and keeps your valuables secure and out of sight. **15.** The standard AM/FM/cassette stereo features an electronic tuner, auto-reverse tape and a quartz digital clock. **16.** For outstanding audio reproduction the optional Sony upgrade AM/FM cassette stereo features 36 watts of power plus extra-large, easy-to-read pushbuttons and digital station/clock display. **17.** The spacious living area offers plenty of seating for entertaining. The driver and passenger seats, which swivel

around to face the lounge area, have easy-to-operate armrest controls for the sliding and reclining mechanisms. **18.** The dinette seats four comfortably and converts to a bed at night. **19.** The large double door refrigerator/freezer is flush mounted, which allows more room in the aisle. The house 12V circuit breakers and the roof air switching system are conveniently located above the refrigerator. **20.** The optional microwave/browning oven offers quick cooking, defrosting and reheating. Also shown is the electronic monitor panel, which keeps



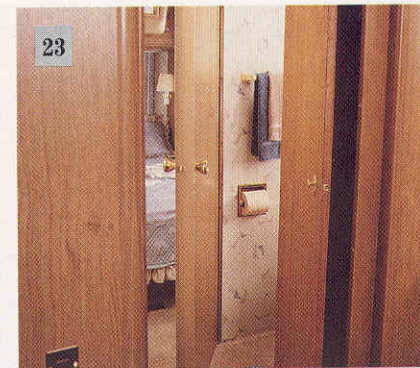

you informed about water and LP tank levels. **21.** The optional water purification system filters out particles and odors for clear, premium quality water. **22.** Every possible space within the galley is used to give you additional storage. The sturdy drawers can be removed for easy cleaning or transporting galley items. **23.** On some models a unique bi-fold door also functions as a solid wall allowing versatility, privacy and 25% more space in the bath area. **24.** The galley not only has the storage, appliances and features you need, it also has special touches like a microwave-

browning oven, knife rack, lever-operated stove vent door; deeper stainless steel sinks with a single-control faucet, and a new optional vinyl floor for easy cleanups. A spice rack, paper towel holder and silverware drawer are available as an optional package. **25.** The bath has all the features you'd expect in a fine bathroom including a shower with skylight and glass door; cabinetry with oak doors, pleated shades and numerous mirrors. There is also a convenient extra switch in the bath that activates the water pump without having to go into the galley.



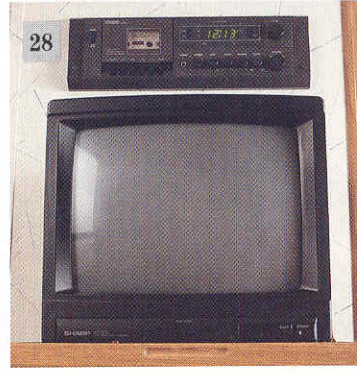

**26.** Even the space underneath the bed is used to give you additional storage. The bed lifts with easy-to-operate pneumatic assist cylinders for access to the storage area. **27.-28.** The framed bedroom mirror folds down to provide a shelf for a TV. Also shown is the optional bedroom AM/FM/cassette stereo. **29.** The optional central vacuum system is a convenient way to keep your home neat and tidy. **30.** The spacious full-height wardrobe is lighted and carpeted. **31.** Enjoy the comfort of a Sealy® innerspring mattress beneath you and the convenience of generous

overhead cabinets with oak doors. New for 1990 is an optional extra generator switch in the bedroom to start the generator without going forward to the cockpit. **32.** The reclining lounge chairs feature armrest controls for the sliding and reclining mechanisms. No more reaching underneath to recline the chairs. There's also a convenient pull-out table with magazine rack below. **33.** To facilitate windshield cleaning, an under-hood, long-handled brush and squeegee is included in the optional exterior accessory package. **34.** This weather-



33

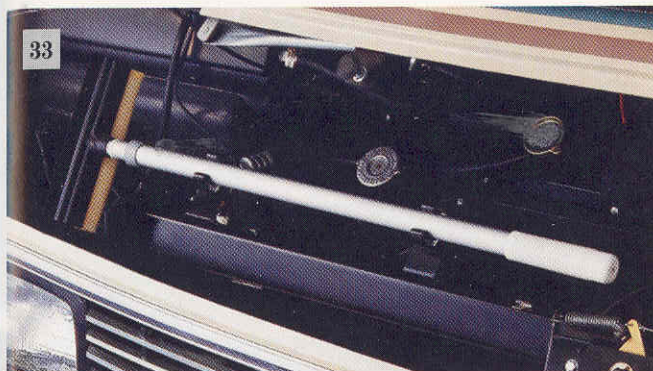

34

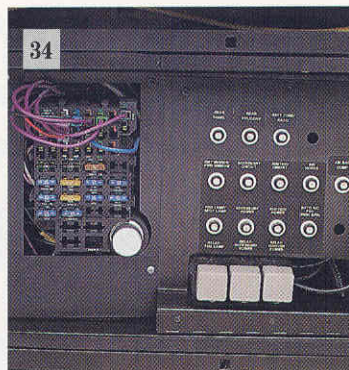

35

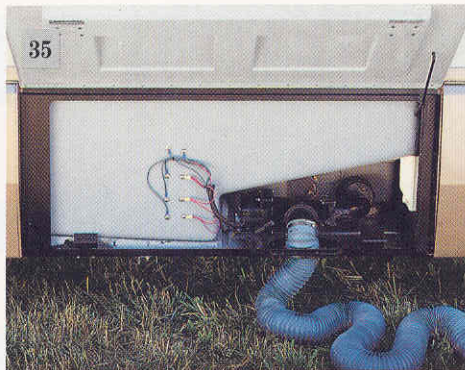

36



37



38



sealed, under-hood box neatly packages the 12 volt engine and accessory fuses and breakers and protects them from the elements. **35.** For cold weather use, the holding tank compartment is heated and insulated. It offers hose storage, valves at a comfortable height and a trap door that enables use of the sewer hose with the main access door closed. **36.** The optional Onan generator shown is stored in its own, easy-access, sound-insulated compartment. (Also available with the Kohler generator.) **37.** The single-piece fiberglass rear cap provides an attractive finish for the

separate insulated inner rear wall. **38.** The unique rear cap has three compartments not found on most other motor homes: one for your own odds and ends; one for the spare tire; and a lighted compartment with stand-up access to the electrical cord, cable TV hookup and optional garden hose/reel.



# CHIEFTAIN VERSUS OTHER HIGH-STORAGE MOTOR HOMES

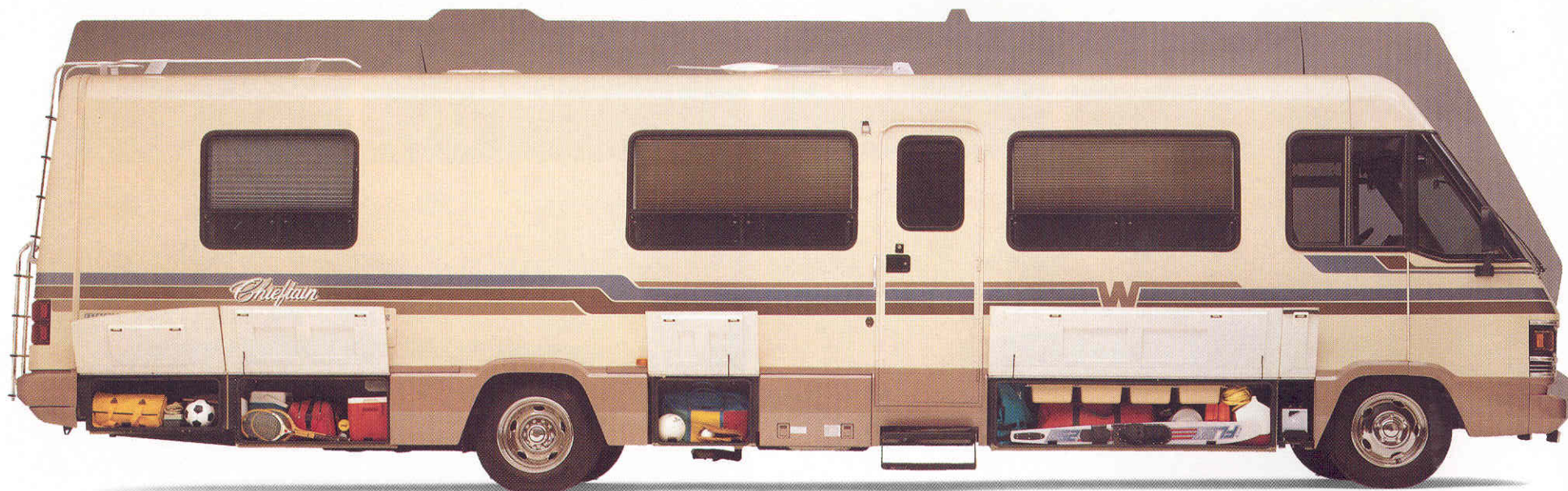

Most high-storage motor homes increase the storage space by substantially increasing the height, which may affect handling and stability.

Because the Chieftain was designed from the ground up as a high-storage, low-profile motor home, Winnebago's engineers were able to keep the roof height lower.

Chieftain has a lower center of gravity and sidewall center of mass than traditional motor homes.

Chieftain's smooth, single-piece sidewall, with no exposed wall to roof joint, improves Chieftain's looks and provides protection from leaks.

The exterior storage bays have up to twice the space of a standard motor home. And unlike many basement models, all the space is easily accessible.

Getting into a Chieftain isn't a major climb. There is one less entrance step than in most high-storage motor homes.

Because they designed Chieftain from the ground up, Winnebago's engineers were able to remove the front bulkhead that comes with the chassis and add a welded steel cab and dash structure. This improves weather sealing, overall quality and safety.

The clean aerodynamic front end, with no exposed fasteners, further enhances Chieftain's feel for the road.



For added durability and safety the Chieftain surrounds the driver and passenger with a solid framework of steel and aluminum, not wood like other competitive motor homes.

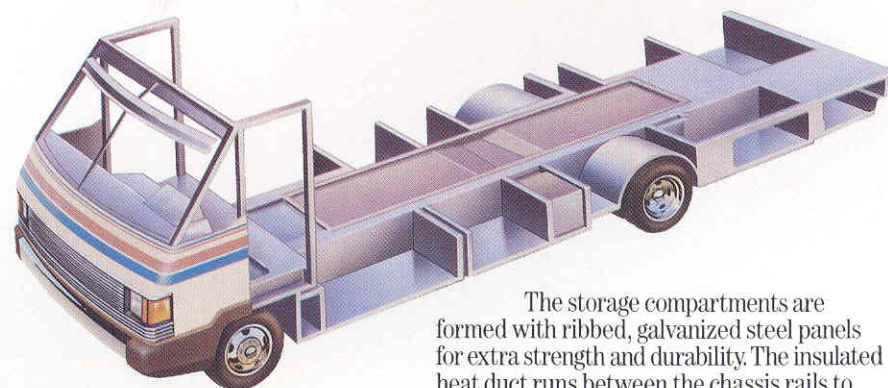

The storage compartments are formed with ribbed, galvanized steel panels for extra strength and durability. The insulated heat duct runs between the chassis rails to allow more even heat distribution and efficient use of interior space.



# WINNEBAGO'S UNBEATABLE QUALITY

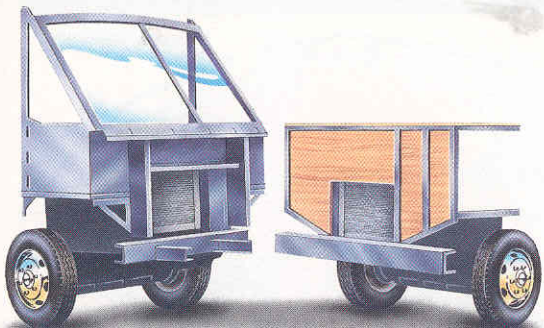

## CHIEFTAIN VS. COMPETITION

With the sidewalls and front cap removed, the Chieftain's all-metal cab structure is visible. The windshield is mounted in a solid framework of welded steel, not in fiberglass like some competitive motor homes.

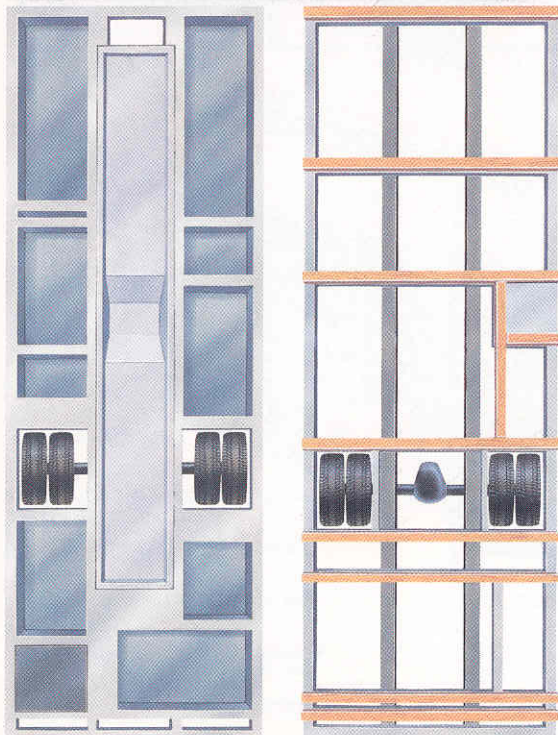

## CHIEFTAIN VS. COMPETITION

Chieftain uses an all-steel, welded framework to support its floor above the chassis. It's built to last years longer than the wood truss floor supports used by some competitive motor homes.



## CHIEFTAIN VS. COMPETITION

Every appliance in the Chieftain's galley is mounted to special steel brackets and firmly attached to steel laminated into the sidewall for better safety, durability and reduced vibration.



Winnebago Industries' test track is one-of-a-kind in the motor home industry. In a half mile of the track, a motor home encounters two-inch-high cobblestones, a high-crowned intersection, 3/4-inch chatter bumps, four-inch chuck holes, two-inch sine wave bumps and staggered six-inch high bumps. The track also tests the reliability of motor homes' brakes on 20 and 30 percent grades.



Over two-thirds of the world's new automobiles are primed using an electrostatic paint process, but only Winnebago Industries uses it to paint motor home parts. When electrically-charged metal parts are dipped into a charged paint tank, paint is attracted to the parts as if they were magnets. The resulting uniform coating of paint provides increased corrosion protection compared to the conventional painting methods used by other motor home manufacturers.



Winnebago joins the roof, floor and sidewalls of the Chieftain with an exclusive locking joint system that adds strength and durability. And the high-density foam in Chieftain's Thermo-Panel® sidewalls provides better insulation than the "bead board" used in many competitive motor homes.



To really put motor homes to a test, Winnebago Industries drops them on their tops. Doors must still open and close easily. Appliances and cabinets must stay firmly in place. The motor home must prove to be structurally sound in order to pass the drop test.



To simulate the ferocity of a thunderstorm, each Winnebago motor home is subjected to an exterior water leak test in this tunnel filled with high-pressure spray nozzles.

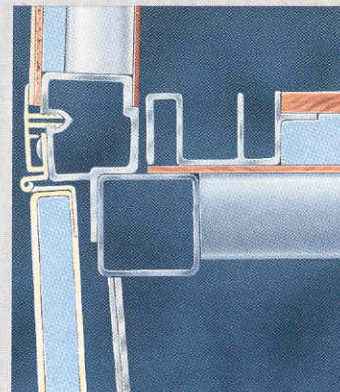



*Welded Aluminum Wall And Roof Structure*

*Tinted And Screened Tip-Out Windows*

*Locking-Joint Wall And Floor Construction*

*Single Piece Hood With Interior Release*

*U.L. Approved LP Regulator and Smoke Detector*

*Retracting Driver And Passenger Shoulder/Lap Seatbelts*

*Meets Or Exceeds All Applicable RVIA, Federal And State Safety Standards*

*Color Coordinated Graphics*

*Wraparound Corner Lights*

*Steel Mounted Windshield*

*Computer-Aided Design Helps Ensure Proper Balance And Weight Distribution*

*Ducted Radiator Airflow Meets Or Exceeds Engine Manufacturer's Specifications*

*Entrance Door Deadbolt Lock*

*Solid Oak Overhead Cabinet Doors*

*Crowned Roof Provides Strength And Excellent Water Runoff*

*Single-Piece Fiberglass Exterior Sidewall Skin*

*Flush-mounted Refrigerator and Stove Vents*

*Electric Entrance Step*

*Power Bathroom Vent*

*Symmetrical Side Window Design*



*Entry Step/Porch Lights*

*Integrated Bumpers*

*Electrostatically Painted Aluminum Trim*

*Aerodynamic Front End And Mirror Fairings*

*Articulated Pantographic Wipers Mounted In Steel*

*Welded-Steel Outriggers And Leveling Rails For A Firm Foundation*

*Low Driver's Door Latch Positioned For Easy Access*

*Automotive Cab Door With Optional Power Window And Electric Mirrors*

*Integrated Battery Compartment*

*Stain Resistant Upholstery Fabrics And Carpeting*

*Screened, Tip-out Vent Above Cab Door With Bunk Option*

*Steel Cab, Cab Floor And Front Cowl*

*Radial Tires*

*Optional Air Horns*

*Steel Tie-Downs For Appliances*

*Rotocast Plastic Rear Wheel Wells*

*Kohler or Onan Generator Option*

*Seamless Water And Holding Tanks*

*Sound-Insulated Steel Generator Compartment*

*Critical Steel Parts Are Primed And Rustproofed*

*Sealed Aluminum Underflooring Resists Corrosion*

*Lighted, Carpet-lined, Galvanized Steel Storage Compartments*

*Underfloor Furnace With Single, Central Insulated Duct*

*Integrated, Flush Front And Rear Running Lights*

*Unique Compartment Latches And Spring-Loaded Door Props*



# CHIEFTAIN FLOORPLANS

Dimensions shown are for sleeping space only and dotted lines denote overhead storage area. Shaded area indicates optional vinyl floor covering.

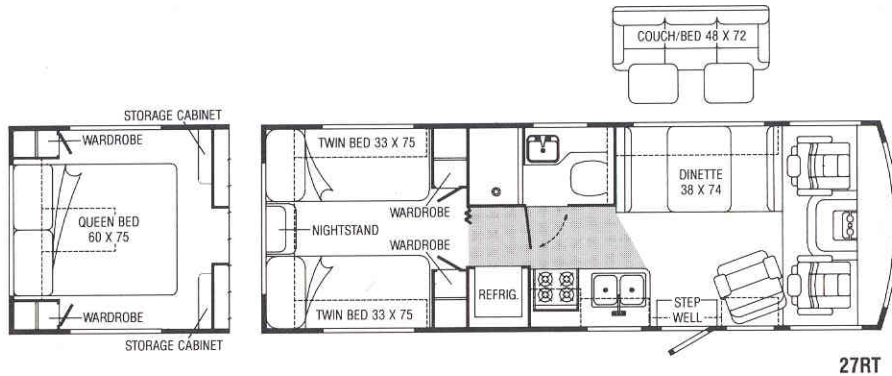

## MODEL 27RT—SPECIAL FEATURES

- Choice of convertible dinette or couch
- Complete side bath module
- Choice of walk-around queen bed or twin beds

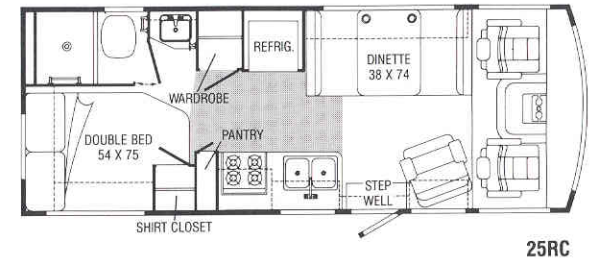

## MODEL 25RC—SPECIAL FEATURES

- Reclining lounge chair
- Fully equipped galley
- Full-length wardrobe
- Convenient pantry
- Corner double bed
- Permanent bathroom wall and door for added privacy

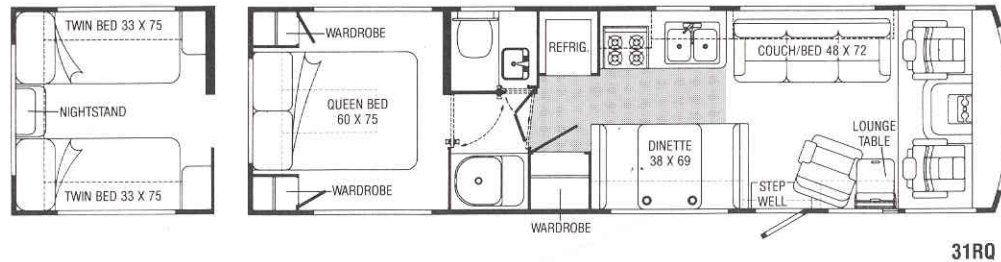

## MODEL 31RQ—SPECIAL FEATURES

- Passenger's seat lowers electrically and doubles as a second lounge chair
- Includes both convertible couch and dinette
- Cross-aisle bathroom features exclusive multi-position door and folding wall for added space, privacy and flexibility
- Choice of walk-around queen bed or twin beds

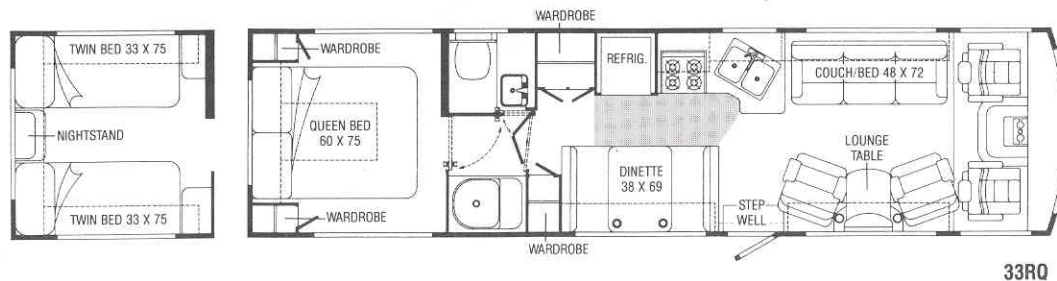

## MODEL 33RQ—SPECIAL FEATURES

- Two lounge chairs
- Convertible couch and dinette
- Plenty of wardrobe storage space

- Cross-aisle bathroom features exclusive multi-position door and folding wall for added space, privacy and flexibility
- Choice of walk-around queen bed or twin beds

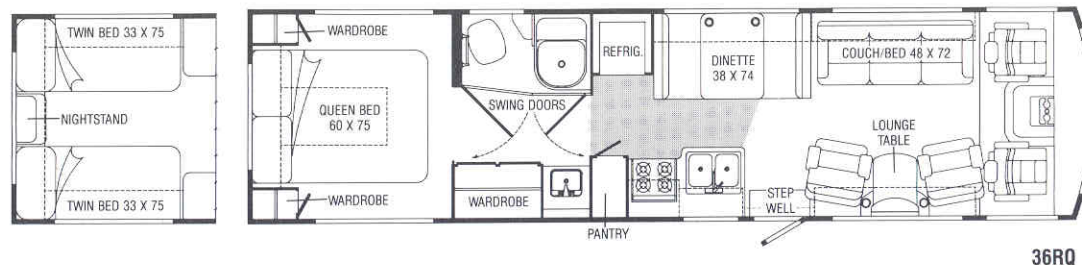

## MODEL 36RQ—SPECIAL FEATURES

- Two lounge chairs
- Convertible couch and dinette
- Spacious galley with pantry
- Cross-aisle bathroom features two swinging doors

- Bathroom includes full-length wardrobe and can be used as a dressing room
- Choice of walk-around queen bed or twin beds

for maximum privacy and flexibility



# UNDERFLOOR STORAGE CAPACITIES

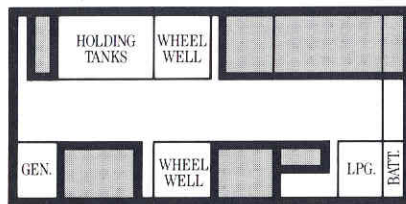

25RC: 49.28 cubic feet

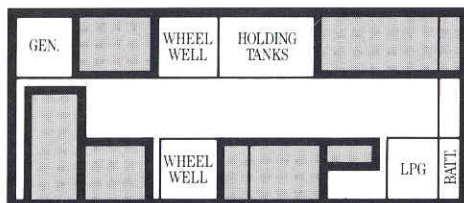

27RT: 68.0 cubic feet

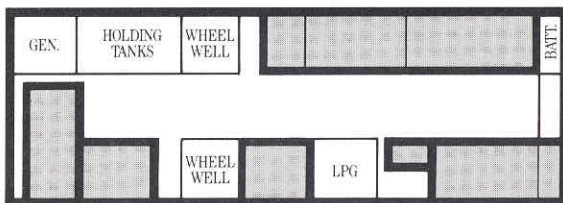

31RQ: 91.5 cubic feet

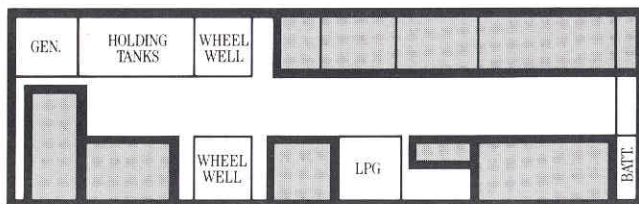

33RQ: 111.84 cubic feet

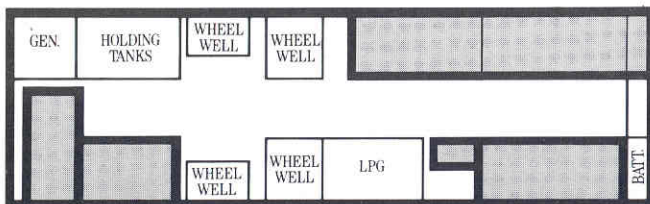

36RQ: 95.87 cubic feet

# SPECIFICATIONS:

SPECIFICATIONS	25RC	27RT	31RQ	33RQ	36RQ
Exterior Height w/Roof Air					
Chev.	10'6"	10'8"	10'8"	10'8"	10'8"
Ford	NA	NA	10'9.5"	10'9.5"	10'9.5"
Exterior Width	8'0"	8'0"	8'0"	8'0"	8'0"
Length	25'4"	28'3.5"	32'11"	35'3"	36'3"
Interior Height (Max.)	6'7"	6'7"	6'7"	6'7"	6'7"
Fuel Capacity (Gal.)					
Chev./Ford	60/NA	60/NA	78/75	78/75	78/75
Fresh Water Capacity (Gal. w/Heater)	47	41	47	51	54
Holding Tank Capacity (Gal.)					
Toilet, Lav./Shower, Galley	52/25	52/25	52/25	52/25	52/25
LP Capacity (Lbs.)	80	80	80	80	100
Sleeping Capacity					
STD/OPT	3/4	3/5	5/6	5/6	5/6
GVWR (Lbs.)					
Chev.	12,300	14,500	15,000	15,000	17,000
Ford	NA	NA	16,000	16,000	18,000
Wheelbase	137"	168"	200"	228"	200" + Tag

VARIABLE FEATURES	25RC	27RT	31RQ	33RQ	36RQ
Radial Tires	OPT	STD	STD	STD	STD
Fog Lamps	NA	NA	OPT	OPT	OPT
Electronic Ignition					
Furnace (BTUs) STD	24,000	24,000	34,000	34,000	34,000
OPT	34,000	34,000	NA	NA	NA
Front Stabilizer Shocks (Chev. only)	OPT	OPT	OPT	OPT	STD
Central Vacuum Cleaner	NA	NA	OPT	OPT	OPT
Double Door Refrigerator (Reg./Large)	STD/OPT	STD/OPT	NA/STD	NA/STD	NA/STD
Large Refrigerator w/Icemaker	NA	NA	OPT	OPT	OPT
TV Antenna w/2 Jacks, Cable Connection	OPT	OPT	STD	STD	STD
Rear Bedroom Stereo	NA	NA	OPT	OPT	OPT
Overhead Storage Cabinet w/Queen Bed	NA	NA	OPT	OPT	OPT
Generator (Onan) 4,000/6,500-Watt	OPT/NA	OPT/NA	OPT/OPT	OPT/OPT	OPT/OPT
Generator (Kohler) 4,500/7,000-Watt	OPT/NA	OPT/NA	OPT/OPT	OPT/OPT	OPT/OPT
Auxiliary Generator Start Switch (w/generator option only)	NA	NA	OPT	OPT	OPT

## STANDARD EQUIPMENT\*\*

## AUTOMOTIVE FEATURES:

Chevrolet Chassis:  
454 V-8 Gasoline Engine

Chevrolet Chassis continued:  
Coil Spring Front Suspension with  
Auxiliary Air Springs and Leaf  
Spring Rear Suspension [Front  
Stabilizer Shocks and Self Propor-



tioning Air Suspension Drive Axle  
Torsional Rubber Rear Suspension—  
Standard on 36RQ Only],  
Rear Air Springs (Except on 36RQ)  
105-Amp. Alternator  
630-CCA Battery  
3-Speed Automatic Transmission  
w/Cooler-Integral with Radiator  
Emergency Start Solenoid (Dual  
Battery Switch)  
Automotive Air Conditioning  
Auxiliary Battery Disconnect Switch  
Power Steering  
Tilt Steering Wheel  
Multi-Functional Signal Lever  
(Including: Intermittent Windshield  
Wipers & Washers, High/Low Beam  
and Cruise Control)  
Map Light  
Electronic Tune/Signal Seeking  
AM/FM/Cassette Stereo With  
Four Speakers  
Radio Power Switch (Main/Aux.  
Batteries)  
Vacuum and Battery Gauges  
Remote Control Hood Release  
Foot Operated Park Brake\*  
Oak Beverage Tray  
Cigarette Lighter  
Cab Blackout Curtain  
Front Wraparound Curtain  
Reclining Bucket Seats w/Swivel/  
Slide Pedestal and 3-Point Retracting  
Seat Belts  
Side Trim Panels w/Map Pocket and  
Ashtray  
Multi-Adjustable Sunvisors

#### **APPLIANCES/SAFETY FEATURES:**

4-Burner Range w/Bi-Fold Range Cover and  
Large Oven  
Powered Range Hood w/Monitor  
Panel  
Double Stainless Steel Sink  
w/Butcher Block Sink Cover\* and  
Single Control Faucet  
Direct Drive Water Pump with Two  
Water Pump Switches  
6-Gallon Electronic Ignition Water  
Heater  
10-B.C. Recessed Fire Extinguisher  
Ground Fault Interrupter  
LP Leak Tester  
Smoke Detector

#### **INTERIOR FEATURES\*\*:**

Entry Assist Handle\*\*  
Cabinet Above Cab Area  
Vents (Coach, Galley, Bedroom)  
Fluorescent Galley Lighting  
Aisle Courtesy Light by Entrance Step  
Carpeting w/Pad  
In-Floor Lockbox  
Pleated Blinds (Bedroom)  
Mini-Blinds (Galley, Bath, Lounge/  
Dinette)  
Flip-Up Galley Extension\*\*  
Knife Rack  
Wire Towel Rack  
Magazine Rack\*\*  
Shower/Tub w/Flexible Shower Head  
and Solid Door (Shower w/Curtain  
in 25RC and 27RT)  
Shower Skylight\*  
Brass-Tone Soap Dish  
Tissue Holder  
Towel Bar and Towel Ring  
Removable Clothes Rod in Shower  
Marine Toilet  
Dual Handle Brass-Tone Bathroom  
Faucet  
Wood Framed Mirrored Medicine  
Cabinet\*\*  
Framed Bathroom Wall Mirror\*  
Make-Up Lights\*\*  
Power Lavatory Vent  
Wall Switch for Bath Light  
Innerspring Mattress(es)  
Air Cylinders to Lift Beds  
Bedroom Decorator Lamp\*  
Lighted Wardrobe w/Carpeted Shelf  
and Mirrored Doors  
Wardrobe Drawers  
Radiused Corner Cabinets w/Solid  
Oak Overhead Doors and Spring-  
Loaded Props  
Wastebasket\*

#### **EXTERIOR FEATURES:**

Single-Piece Fiberglass Exterior Sidewall Skin  
Tinted Windows  
Light w/Switch in Electrical Center  
Under Hood  
Manual Rearview Mirrors w/separate  
Convex Mirror  
Entry Assist Handle  
Electric Entrance Step  
Locking Storage Doors w/Hold-Ups

Lockable Fuel Fill Door  
Lockable Water Fill Compartment  
w/Drain/Faucet  
Secondary Dead-Bolt Entrance  
Door Lock  
Screen Door  
Porch Light w/Interior Switch  
40-Amp. Converter/Battery Charger  
110-Volt and TV Outlets  
30-Amp. Power Cord w/Light in  
Storage Compartment  
2 Deep Cycle Marine/RV Batteries  
Generator Prep Kit  
Sewer Hose and Storage  
Spare Tire  
Tire Tools  
Service Light w/Trunk Switch  
Rear Mud Flaps\*\*  
Pre-wire for Roof Air Conditioner(s)  
Wheel Covers  
Extensive Warranty (See your Winnebago dealer  
for complete terms and conditions of  
Winnebago Industries' warranty coverage)

#### **OPTIONAL EQUIPMENT\*\***

Ford Chassis:  
7.5 L EFI 460 V-8 Ford Gasoline  
Engine  
Mono-Beam Axle w/Leaf Spring  
Front Suspension and Multi-  
Leaf Spring Rear Suspension\*\*  
(Self Proportioning Air Suspend-  
ion Drive Axle, Torsional Rubber  
Rear Suspension on 36RQ)  
4-Speed Overdrive Automatic  
Transmission  
100-Amp. Alternator  
650-CCA Battery  
Foot Operated Park Brake  
Air Sensoride\* (NA on 36RQ, 25RC)  
Hydraulic Leveling Jacks (36RQ Only)  
Front Pull-Down Bunk with Overhead  
Tip-Out Window On Driver's Side  
Chrome Air Horns\*\*  
6-Way Power Driver's Seat\*  
Power Driver's Window and Electron-  
ically Heated Power Mirrors  
Auxiliary Defrost Fans  
Rear Monitor System\*  
Custom Steering Wheel (Chevrolet  
Only)  
Electronic Instrument Panel Cluster  
(Chevrolet Only)

TV and VCR w/Switching System  
AM/FM/Cassette Stereo Radio  
w/Electronic Seek Tuner and  
Digital Clock  
Floor Mats (Driver, Pass., Entry)  
Water Purification System\*  
Decorator Clock\*\*  
Fluorescent Lighting Package\*  
Microwave/Browning Oven  
w/4-Burner Range Top and Either  
Utility Drawer or Regular Oven  
Vinyl Galley Floor Covering  
Power Galley Ventilator Fan  
Galley Trim Package (Paper Towel  
Holder, Spice Rack, Silverware  
Tray)  
Porcelain Marine Toilet w/Sprayer\*  
13,500-BTU Roof Air  
Second Roof Air Unit\*\*  
6-Gallon Electronic Ignition Water  
Heater w/Motoraid and Auxiliary  
Rear Auto Heater  
Stainless Steel Wheel Liners  
Rear Window Wiper/Washer\*  
Spotlight\*\*  
Luggage Rack and Ladder  
Exterior Accessory Package (Tool  
Box, Squeegee, Garden Hose and  
Reel, and Exterior Storage  
Compartment Slide Out Drawers)  
Undercoating  
Trailer Towing Package\*\*  
Color Options: Blue, Fawn or  
Mauve/Beige  
\* Not available on 25RC.  
\*\* Not all standard features or options  
are available on all models. See  
your dealer for availability of  
specific options.

If you are in the Forest City area, be sure to take the  
free Winnebago Industries factory tour. For more  
information call 1-515-582-6936.

Every Winnebago owner is invited to join the  
Winnebago-Itasca Travelers (W.I.T.) Club. Members  
enjoy rallies and caravans, receive special discounts  
and services, make new friends and renew old  
acquaintances, and, of course, have the time of their  
lives. For more information, call W.I.T. at  
(515) 582-6874.



# THE WINNEBAGO AIR SENSORIDE™ SUSPENSION SYSTEM.

With the optional Air Sensoride rear suspension system, you can enjoy the smoothest ride in motor homing.

Because your motor home is suspended on cushions of air, rather than metal springs or solid rubber blocks, you'll immediately notice that your motor home rides smoother and quieter with Air Sensoride.

Unlike leaf spring or solid rubber block suspensions, the continuous height control of the Air

Sensoride system constantly keeps the entire motor home level (front to back and side to side). Air Sensoride also minimizes vibrations to give your motor home a longer life and higher resale value.

The Air Sensoride Suspension System is backed by Winnebago Industries' limited warranty. Details are available through the nationwide service network of Winnebago Industries' motor home dealers.



The Air Sensoride park and level option allows you to raise or lower your motor home to compensate for load, wind and terrain variation.



An added Air Sensoride option is the Park and Level feature. The cockpit-mounted controls allow automatic or manual levelling while parked or underway.

Winnebago's continuing program of product improvement makes specifications, equipment, model availability and prices subject to change without notice. Some items shown may be extra cost options.

©1989 Winnebago Industries, Inc. Forest City, Iowa 50436

Part #1390

Printed in the U.S.A.

For Winnebago Sales and Service, contact:

**THE UNBEATABLE CHIEFTAIN**  
**WINNEBAGO**

