



**Minnie Winnie®...
Winnebago comforts
at our most
comfortable prices.**



WINNEBAGO

Minnie Winnie® Specifications

MODELS
MW20RG MW23RB

Length	20'6"	23'2"
Wheelbase	127"	145"
Width	7'9"	7'9"
Height, exterior w/air cond.	9'3" 9'9"	9'3" 9'9"
Height, interior		
Rear	6'8"	6'8"
Front	6'11"	6'11"
GVW (lbs.)	9,000	10,500
Curbside wet weight (lbs.)	7,200	7,700
V8 engine (cu. in.)	360	360
Batteries (amp.)		
Main	70	70
Auxiliary	105	105
Fuel (gal.)	35	35
LPG tanks (lbs.)	40	40
Fresh water tanks (gal.)	25	25
Holding tanks (gal.)	41	38
Sleeping capacity	5	6
Refrigerator (cu. ft.)	6	6
Water heater (gal.)	6	6
Furnace (BTU)	22,000	22,000

Decor choices: Cactus, Inca, Sage

Standard Features

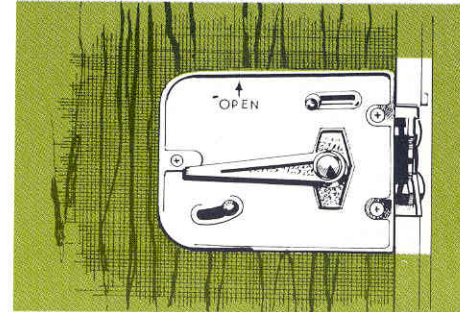

Construction and Safety: Cab roof cut-out provides stand-up, walk-through passage between cab and living area Automotive-type door lock with bolt safety latch Fire extinguisher (2 B.C.) Inside and outside rearview mirrors Front and rear bumpers for protection of coach Automotive style wheelwell trim with radius corners and clean fitting joints Prefinished aluminum exterior and underside of floor with contoured trim, radius corners, rivets and smooth joints on doors, access doors, vents and fittings Seals at openings for steering column, accelerator, and brake to keep water and dust out and cockpit quiet Outside assist handle LPG leak detection system Quick release rear window.

Chassis and Automotive: Dodge MBH chassis 360 cubic-inch V8 engine Jack and tools Dual rear wheels RV thumpless tires Aluminized exhaust system Cab undercoating Spare wheel and carrier.

Driver Comfort and Convenience: Power assist driving aids including 3-speed automatic transmission, power

brakes (power front disc), power steering and electronic ignition for easier starts and efficient fuel consumption Map pocket behind driver and co-pilot seats Easy-adjust sunvisors with positive hold catches Cigarette lighter and ashtray Bunk curtain to shut out light and distraction from living area Glove compartment Map light Complete instrument panel Automotive heater Armrests and headrests.

Kitchen and Dinette: 4-burner range with oven Range hood (20RG) Power range vent (23RB) Gas/electric refrigerator recessed against wall for more walk-way space Double stainless steel sink with breadboard cover Roll-out pantry for convenient storage of provisions and easier spotting of items on shelves (23RB) Kitchen features angled sinks and counters for more working space Numerous cabinets and drawers with finished interiors Self-edged countertops with radius corners Comfortable foam dinette seating Galley table extension (20RG).

Sleeping: Dinette converts to bed



Sliding front overhead bunk furnishes a big 76" by 54" bed with thick foam mattress.

Bathroom: Attractive 3-piece modular ABS plastic shower eliminates water leaks and is easy to clean (23RB) Marine toilet Bath mirror Power bath vent (23RB) Bath vent (20RG) Shower door (23RB) Lavatory Water saver flexible phone head shower.

Utility: Roof air wiring tube Demand water system 6-gallon water heater Holding tanks Sewer hose with outside storage compartment and convenient single dump outlet Rust-free ABS plastic water lines routed inside motor home provide clean water and also reduce chance of lines freezing 12-volt changeover lighting system operates from battery or external 110-volt supply Electrical 12-volt converter and battery charger with 110-volt circuit breakers and 12-volt fuses centrally located for convenience Looms for all AC/DC wiring eliminates wiring confusion 25' 110-volt power cord City water hookup 70 Amp

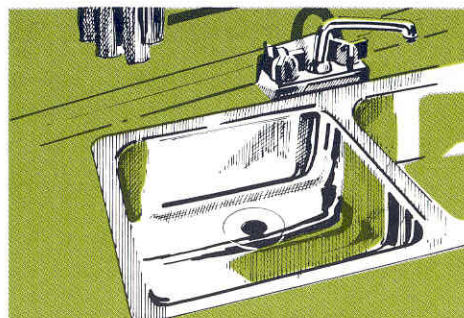

battery 105 Amp deep cycle auxiliary battery Two 20 lb. LPG tanks.

Interior Comfort and Convenience:

Silverware drawer under shirt closet in 20RG Forced air (ducted) furnace Gauchos are on rail guides for ease in pulling out bed and have steel support legs for sturdy seating Shirt closet has counter for additional working space Carpeting Numerous cabinets and drawers with color coordinated hardware. Cabinets have positive latches for one-hand operation Convenient 110-volt duplex outlets wherever appropriate on separate 110-volt wiring system Prefinished washable vinyl paneling in attractive woodgrain design Rear overhead cabinet (20RG).

Exterior: Weatherproof outside storage and luggage compartments Radius cornered tinted slide windows with screens Entrance step positioned near ground for ease of entry and exit Recessed gas tank fills Front outside access to water, oil, and windshield washer fills Screen door with decorator kick panel to protect screen.

Options, accessories to match your family's fun.

	MODELS	
	MW20RG	MW23RB
Automotive air conditioning	O	O
Cruise control	O	O
Battery gauge	O	O
11,000 BTU roof air conditioner	O	O
22,000 BTU forced air (ducted) furnace	S	S
28,000 BTU forced air (ducted) furnace	O	O
8 cubic-foot refrigerator	N	O
Ground fault interrupter	N	O
AM radio	O	O
AM/FM radio and tape player	O	O
AM/FM radio, tape player, and CB radio combination	O	O
Bath and galley package: medicine cabinet, power vent, power stove vent	O	S
Stove hood	S	N
Galley table extension	S	N
Bath vent	S	N
Front wrap-around curtain	O	O
Shower door	N	S
Beverage tray	O	O
Bath floor carpeting	N	S
Gauges for holding tank and water tank levels	O	O
440 cubic-inch V8 engine	N	O
Spare tire and cover	O	O
Trailer hitch	O	O
Generator prep kit	O	O
2700-watt generator and hourmeter	O	O
Luggage rack and ladder	O	O
Television antenna	O	O
Two 30 lb. LPG tanks and automatic regulator	O	O

S-Standard O-Optional N-Not Available

Minnie Winnie fits a joyful lifestyle.

Versatile, maneuverable, easy to drive—it's also one of the easiest Winnebago's to afford.

Yet the nimble-footed Minnie Winnie offers you the kind of space and self-contained traveling, living, eating, and sleeping comfort and convenience you might expect from a larger and more expensive motor home.

There are two sensible floor plans in our Dodge chassis line Minnie Winnies this year. In 20 and 23 feet lengths. Each is tailored to provide the utmost in motor home fun.

Feature for feature, dollar for dollar, we believe Minnie Winnie is the biggest value of any mini motor home on the road. Check the facts, the Minnie Winnie features, then see how easily you and Minnie Winnie can take to the road.

A common sense book to help you buy a motor home wisely... Noted RV writer Ginny Ade has prepared a comprehensive guide to sensible and rewarding motor home buying. What to look for. What to avoid. How to evaluate and compare all that the manufacturer offers. It's available from Winnebago for \$1.95 to defray postage and handling. Send your check or money order to Winnebago Industries, Inc., Consumer Information Services, 1909 East Cornell, Peoria, Illinois 61614.

It could be the best initial investment you make to insure years of uninterrupted motor home pleasure.

Winnebago's continuing program of product improvement makes specifications, equipment, model availability and prices subject to change without notice. Some items shown may be extra cost options.

WINNEBAGO®

Winnebago Industries, Inc.
P.O. Box 152, Forest City, Iowa 50436

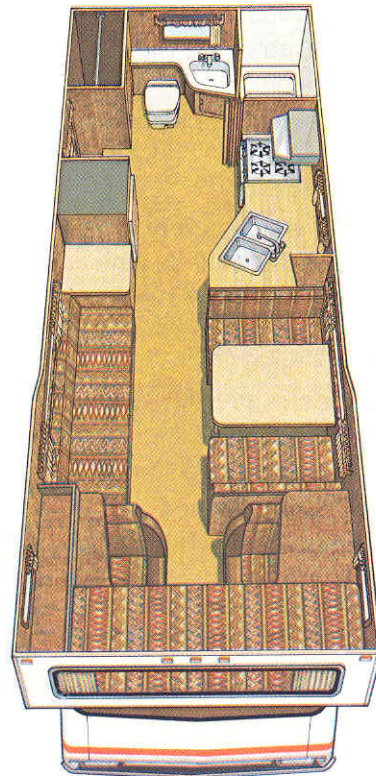

Minnie Winnie 23RB,
Inca interior shown

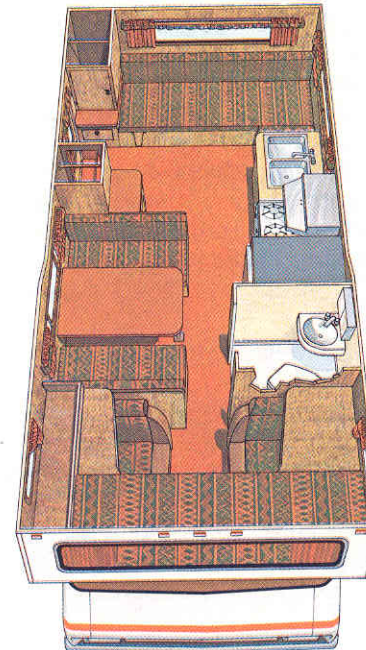

Minnie Winnie 20RG,
Cactus interior shown