

The 1975 Chieftains

FILE COPY
DO NOT REMOVE



WINNEBAGO

The name that means
the most in motorhomes.

The Chieftains By Winnebago

*The Chieftain look for '75 . . .
by the name that means the most in motorhomes*

"There's a Winnebago." You will hear it wherever there is fun to be found or adventure to be sought.

And when "It's a Chieftain" completes the expression, it takes on an extra note of admiration. Because the Chieftain has style. Season after season. Year after year. Winnebago style unique in motorhomes.

One look at the classic, symmetrically balanced lines of the 1975 Chieftain and you know that inside comfort abounds. With utilization of space that is uniquely Winnebago.

Roomy on the inside, practical and handsome throughout. The Chieftain look for 1975. A look that invites lots of looks. Whether you are wheeling through the lush, fruited valleys of California, up the snow-capped Tetons, or by the sparkling

sands of Destin and Fort Walton Beach.

Beautifully crafted coachwork with a broad, graceful windshield and spacious, rounded corner windows and complimentary trim denote the Chieftain as classic in motorhome styling.

For 1975, the Chieftain look is available in four unique floor plans to provide a choice best suited to your life style. Choose from two 25-foot plans or two 27-foot plans to match your Chieftain to your ideas. And array the Chieftain of your choice in beautiful color coordinated interior themes of clover, honey or coffee.

The Chieftain look for 1975. As enduring as tomorrow. A classic, luxurious home away from home for years to come. Because it's built by the name that means the most.



D-27C and D-27CL Chieftain

A tough choice, but a nice one awaits your decision between these two rear lounge themes. The D-27C has a twin bed arrangement with center nightstand and a separate reading light for each bed. The D-27CL has a lounge across the rear for a wrap-around seating arrangement—ideal for a party or just visiting with friends.

Splendid lounge-bedrooms are complemented by elegant kitchen and bath facilities. The hostess has ample work and cupboard space in the kitchen, together with luxuries like a big 8 cubic-foot gas/electric refrigerator and a 4-burner stove with eye-level oven and power vent. The D-27 Chieftains. Splendid luxury hide-aways for the good life. With sleeping accommodations for five or seven persons, air conditioning and a big furnace for all-year comfort.

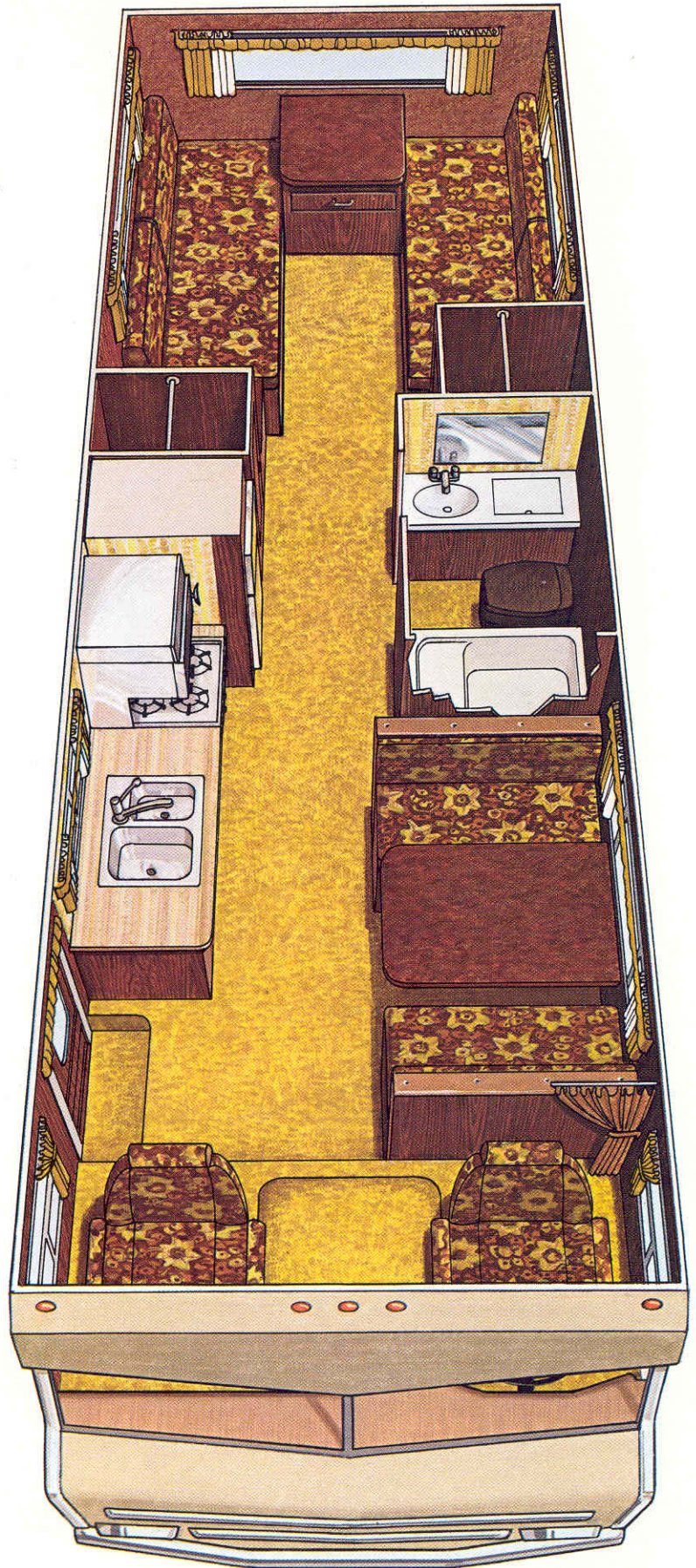

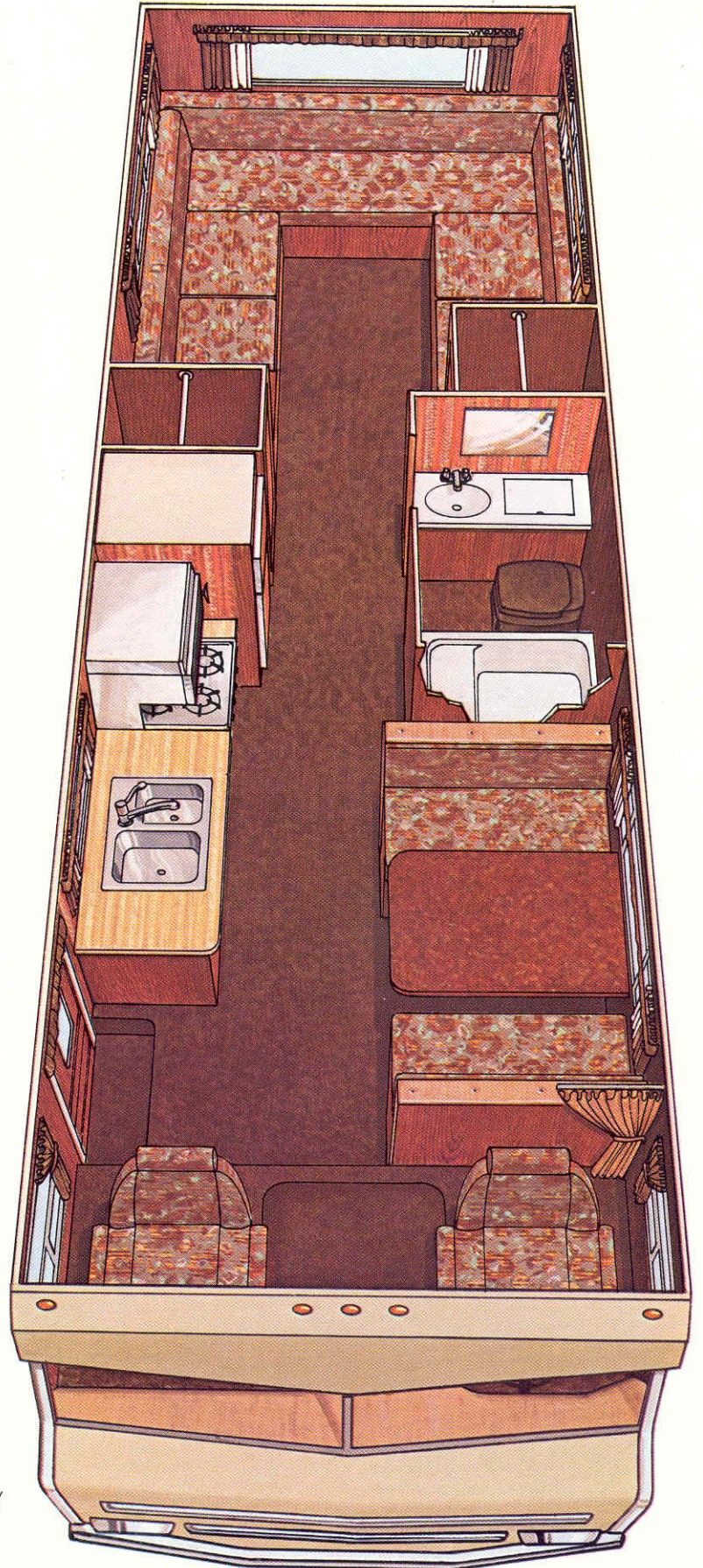

SPECIFICATIONS: Length 27'2" / Width: 7'9" / Exterior height: 10'6" / Interior height: 6'6" / Estimated curbside wet weight: 12,100 lbs. / Dodge RM-400 chassis / Wheel base: 178" / 440 cubic-inch Dodge V-8 engine / 3-speed automatic transmission / Power steering with tilt column / Power brakes with power front disc / Electronic ignition system / Tires: 8.19x5-D, 8-ply front and rear duals / 60 Amp alternator / 70 and 200 Amp-hour batteries / 4,000-watt generator standard, optional 5,000 or 6,500-watt generator / 10,000 BTU roof air conditioner / Sleeping capacity: 5 standard, 7 optional.

D-25C and D-25CL Chieftain

Our smallest Chieftains are by no means little. They're just as long on luxury as most of the bigger chieftains and they're a great entrance into Winnebago's new world of top of the line excellence.

Match your D-25 to your ideas by choosing either the D-25C for facing lounges providing a lot of daytime seating and twin beds for sleeping . . . or the D-25CL for a single convertible lounge that makes into one big double bed and includes a built-in dresser and upholstered swivel chair opposite.

In both plans you get a spacious rear bath that is sheer luxury. A big tub and shower is backed by a big 66-gallon pressurized water system, with a water heater operating on LP gas or from your engine coolant system as you drive. Plus there's a vanity with deluxe medicine cabinet and power roof vent. And with the privacy door closed, a dressing room complete with wardrobe.

And this Chieftain, too, keeps you comfortable in sunshine or snow with standard roof air conditioning and forced air furnace.

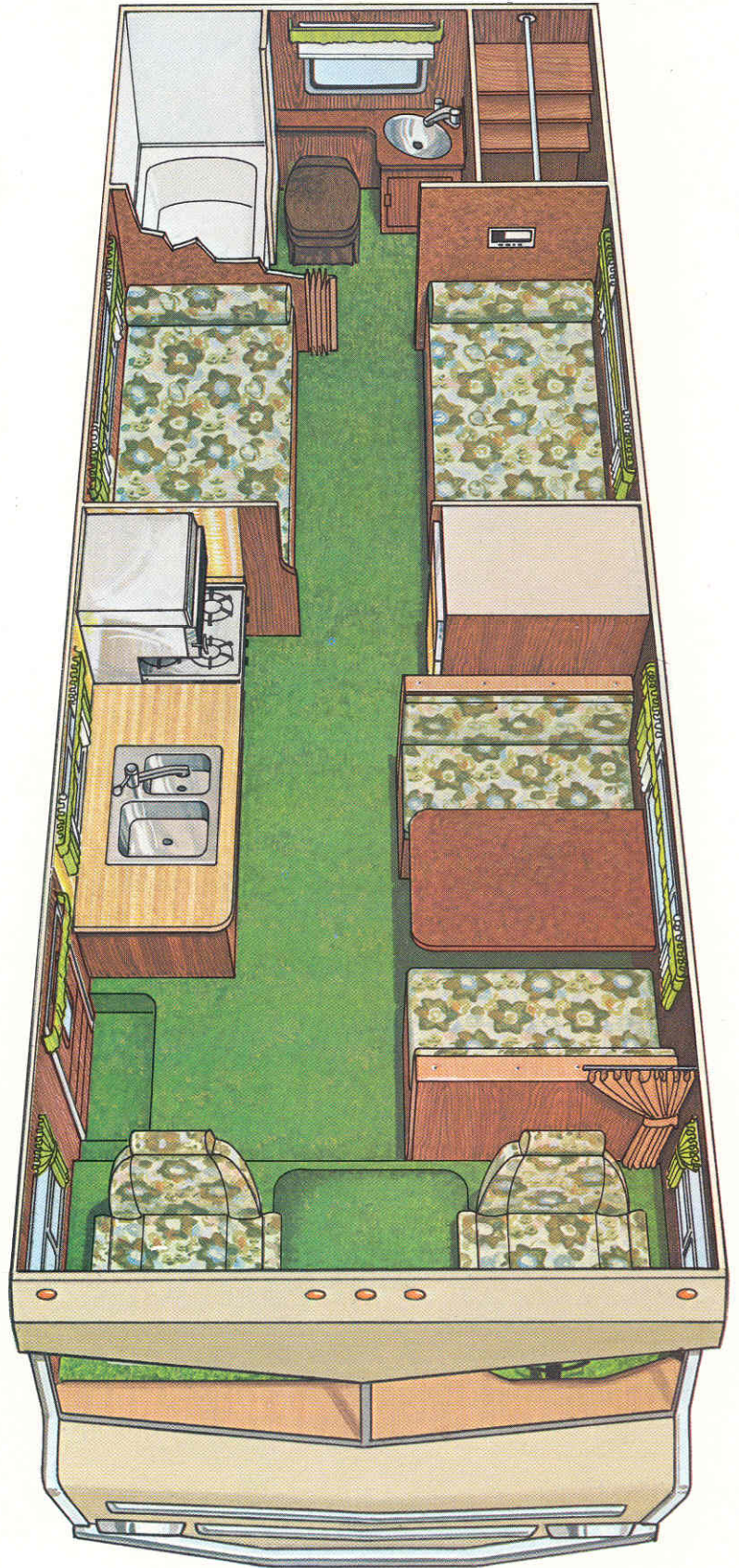

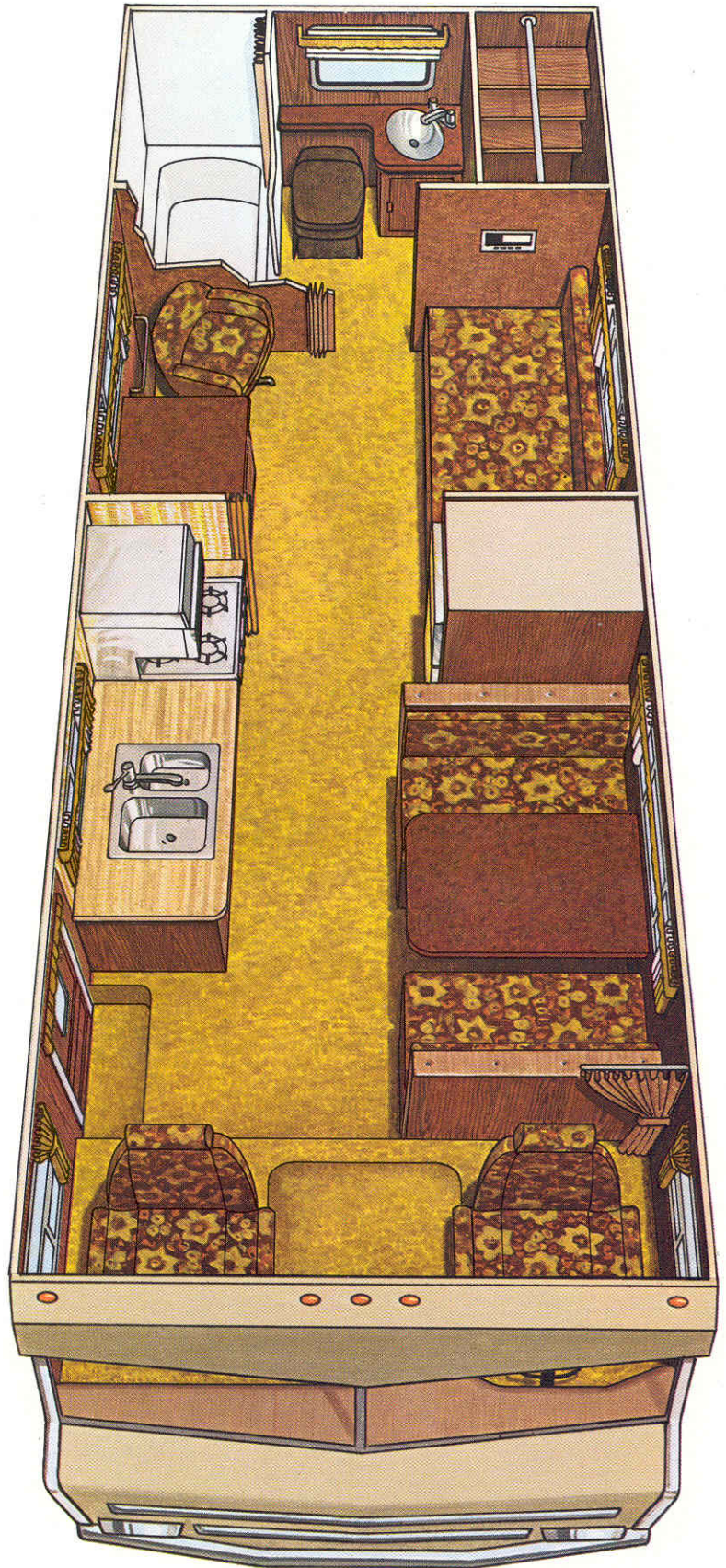

SPECIFICATIONS: Length: 25'4" / Width: 7'9" / Exterior height: 10'6" / Interior height: 6'6" / Estimated curbside wet weight: 11,700 lbs. / Dodge RM-400 chassis / Wheel base: 159" / 440 cubic-inch V-8 engine / 3-speed automatic transmission / Power steering with tilt column / Power brakes with power front disc / Electronic ignition system / Tires 8.19x5-D, 8-ply front and rear duals / 60 Amp alternator / 70 and 200 Amp-hour batteries / 4,000-watt generator standard, optional 5,000 or 6,500-watt generator / 10,000 BTU roof air conditioner / Sleeping capacity: (D-25) 5 standard, 7 optional; (D-25CL) 5 standard, 6 optional.



A woman in equestrian attire stands in a horse trailer, adjusting her black riding helmet. She is wearing a brown tweed jacket, white breeches with tan knee patches, and black riding boots.

1973 Horse Show
1st Place

1973 Horse Show
2nd Place

1973 Horse Show
3rd Place

1973 Horse Show
4th Place

1973 Horse Show
5th Place

1973 Horse Show
6th Place

1973 Horse Show
7th Place

WINNEBAGO The name that means the most in motorhomes.

When you buy a Chieftain . . . or any Winnebago . . . tradition is part of the deal. A tradition of more motorhomes built than any other manufacturer. A tradition of well over a billion miles logged by Winnebago owners.

A tradition based on a solid philosophy to build the best recreational vehicle we can and to sell it for an honest price.

And that philosophy follows every Chieftain, every Winnebago, from the drawing board to the dealership. The dealership lot to your driveway.

Since we make almost everything that goes into a Winnebago, we know our products well. We can constantly hone and refine our models to accommodate the best use of equipment and space for your satisfaction.

And we can constantly adjust our construction techniques to furnish you the toughest motorhome possible to make. Built for the road and for strength and durability that lasts.

Thermo-Steel™ construction merges the strength of steel with the superior insulating qualities of our exclusive "Thermo-Panel®." Proven in our over a billion owner miles, Thermo-Panel® is an outer layer of rust-proof aluminum and an inner wall of tough paneling bonded to either side of thick core of insulating material.

Winnebago has used the U.S. Department of Transportation's crash worthiness safety specifications proposed for urban transit buses as a guideline in

the structural design of type A motorhomes in the '75 product line.

Computer-stressed testing of frame structure is just one of the guidelines Winnebago is using to meet the crash worthiness safety specifications.

Floor, walls, ceiling, and motorhome components are anchored to the framework, with extra strength provided by steel members front to rear.

Up front, steel surrounds the driver's compartment. A tough aluminum underbelly protects the flooring from weather and road knocks. And, underneath, we add additional steel supports to heavy-duty Dodge chassis.

The result is a motorhome of solid dependable strength. In safety as in many other areas, Winnebago is a name that means the most in motorhomes.

And because it's a Winnebago, you know that even the smallest unseen detail has received its share of attention and planning.

Details like installing plastic vents in the window weep holes to prevent leakage. Using double-flared fittings on all plumbing and LP gas lines to provide tighter, longer lasting connections. Incorporating hollow core interior cabinet doors, which are lighter and resist warping. And installing a small plastic deflector on all our air-cooled power plants to prevent damage-causing sand or other ground particles from entering the air-exhaust.

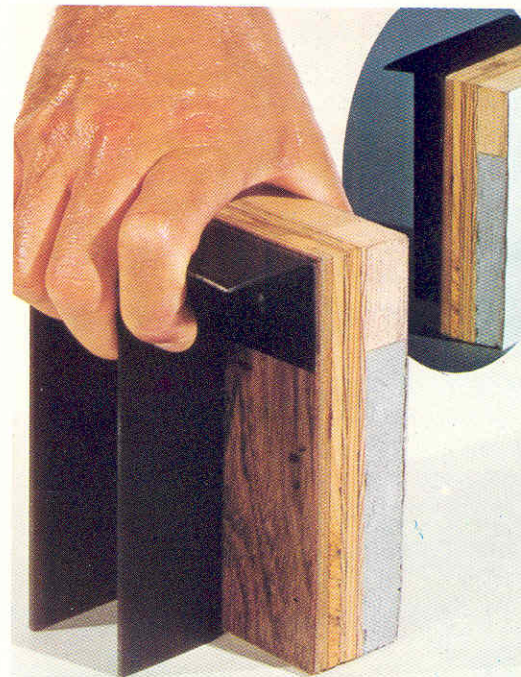

Chieftain Standard Equipment

You don't expect to purchase a luxury motorhome then have to pay extra for conveniences that are necessities for comfortable living. We don't expect you to, either. That's why when we call a motorhome a "luxury motorhome," we make it fully self-contained with every feature you need as standard equipment.

We've already mentioned some of these features, and there are dozens more. Because when you buy a Chieftain—or any Winnebago—you're getting a lot more motorhome for your money. That's another reason why we're the name that means the most.

Safety Features

- Thermo-Steel™ construction
- Quick release rear escape window
- Clearance lights comply with Federal and SAE regulations
- Backup lights, parking lights, turn signals, safety flashers
- Extra side-mounted turn signals
- Seat belts comply with Federal regulations
- Door Lock complies with National Highway Safety Bureau standard 206
- Fire extinguisher
- Tinted windows and windshield
- Sun Visors
- Safety glass windshield and windows

Chassis and Automotive Features

- Heavy-duty Dodge RM-400 chassis
- New front and rear suspension system has longer and wider springs with rolled ends and non-lube rubber bushings
- 440 cubic-inch Dodge V-8 engine with fuel filtration system
- 3-speed Load Flite automatic transmission
- Power brakes with power front disc brakes
- New rear wheel parking brake system
- Power steering with tilt column
- Electronic ignition system
- Aluminized emission control exhaust system
- Front and dual rear wheels with non-flat spotting recreational tires
- Heavy-duty 70 Amp-hour battery with auxiliary 200 Amp-hour battery
- 60 Amp alternator
- Adjustable defroster vents with separate blower
- Dual gas tanks
- Fuel capacities:
 - D-27's: 45-gal. and 26-gal. aux.
 - D-25's: 36-gal. and 20-gal. aux.
- Fresh air automotive heater, separate blower
- Hydraulic jack
- Spare wheel
- Spare tire cover and carrier
- Voltage and Vacuum gauge
- Mud flaps
- Cruise control

Driver's Compartment

- Reset trip odometer
- Removable instrument cluster
- New contour padded dash with clustered instruments
- Armrests

- Headrests
- Cigar lighter
- Ash trays
- Inside rearview mirror
- Twin outside rearview mirrors
- Vinyl blackout curtain
- Wrap-around windshield curtain
- Deluxe contoured swivel bucket seats for driver and co-pilot, upholstered in fabric
- Glove compartment
- Map light

Kitchen Features

- 8 cubic-foot gas/electric refrigerator
- 4-burner stove with eye level oven and power stove vent
- Double stainless steel sink
- Easy-to-clean back splash and countertop in galley area
- Sink cover that doubles as bread board

Dinette Features

- Plush quilted fabric seat cushions
- Reversible fabric and vinyl dinette seats
- Decorator wall panel behind dinette table
- Overhead cabinets

Sleeping Features

- Dinette converts to bed
- Full-length wardrobe
- Front overhead cabinets (in front of bunk)
- Glide-away front bunk bed with foam mattress and twin reading lights over driver's compartment
- Lounge converts into double bed (D-25L and D-27L)
- Twin beds (D-25 and D-27)
- Divider curtain for bedroom privacy
- Full length mirror

Bathroom Features

- Tub and shower combination
- Water saver phone head shower
- Deluxe medicine cabinet
- Carpeted bathroom floor
- Shower curtain
- Power roof vent in bath
- Marine toilet
- Water heater operates from either LP gas or engine coolant system to automatically heat water as you drive
- 60-gallon pressurized fresh water system with 12-volt pressure pump and wall mounted switch
- Dual holding tanks:
 - D-27's—36 gal. sewage, 22 gal. waste water; D-25's—36 gal. sewage, 15 gal. waste water

- Fresh water and holding tank "read out" gauges
- Sewer hose
- Lavatory

Utility Features

- 10,000 BTU roof air conditioner
- 4,000-watt auxiliary power plant
- Double 40 lb. LP gas bottles
- Automatic LP changeover
- 6-gal. hot water heater
- Slide-out battery tray
- Hour meter for power plant
- City water hook-up
- Forced air (ducted) heating system
- Electrical 12-volt converter
- Battery charger
- 12-volt changeover lighting system operates from battery or external 110-volt supply
- 12-volt interior lights
- 25' 110-volt power cord

Interior Features

- Deluxe wall-to-wall carpeting
- Pre-finished washable paneling
- Single swivel lounge chair (D-25CL)
- Waste basket
- Bolsters (D-25C and D-27C)
- Roomy drawers for storage

- Convenient 110-volt duplex outlets on separate 110-volt wiring system
- Attractive color-coordinated curtains with positive position tracks
- Attractive hollow core cabinet doors with positive door locks
- 28,000 BTU furnace

Exterior Features

- Chrome bumpers front and rear
- Front bumper guards
- Radius-cornered tinted slider windows with screen
- Glide-away step with self-cleaning mesh tread
- Pre-finished aluminum exterior and under-side of floor
- Rear storage trunk with 12-volt light and door lock
- Flush-mounted gas tank fills
- Chrome windshield insert
- Screen door
- Windshield washers and electric wipers
- Front outside access to water fill, oil fill and windshield washer fluid
- Skylight roof vents
- Outside luggage compartment
- Chrome wheel covers

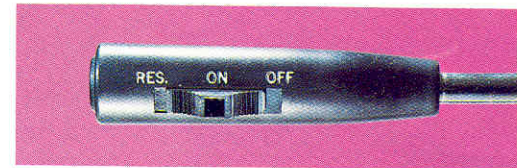
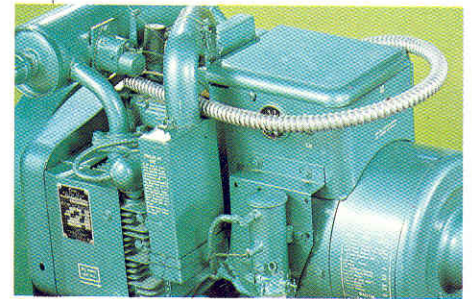
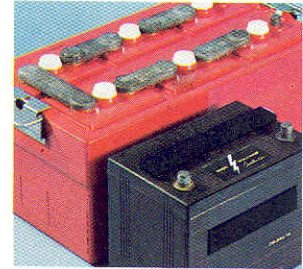

Chieftain Optional Equipment

Interior Options

- Rear bunk (D-27)
- Twin bunk, left side (D-25 and D-25L)
- Twin bunk, both sides (D-25)
- Twin bunk, right side (D-25)
- Bunk ladder
- Galley extension
- 13,500 BTU roof air unit
- Double co-pilot seat
- Chemical toilet
- Chemical toilet with automatic refill
- Thermo-waste disposal system
- AM radio and clock
- AM/FM multiplex radio and clock

- AM/FM multiplex radio/tape deck and clock
- Automotive air conditioning

Exterior Options

- 6,500-watt generator with hour meter
- 5,000-watt generator with hour meter
- Spare tire
- Limited-slip rear axle
- Leveler system
- Luggage rack and ladder
- Trailer hitch
- Undercoating
- Storm windows
- Rear window washer and wiper

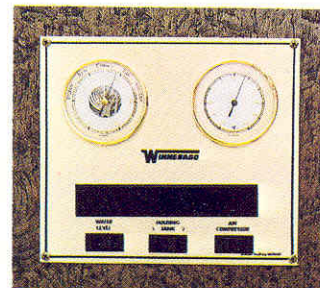



We didn't get our name by selling you a motorhome and then forgetting you.

It's easy to come by service, parts and helpful advice when you choose Winnebago. Because in addition to being the largest RV manufacturer we also offer you the largest motorhome service organization in the nation. An established service network of over 300 authorized dealers from coast to coast and in Canada and Alaska is ready to serve you.

To these Winnebago dealers, motorhoming isn't a sideline. It's a full-time job and their attitudes reflect it. That's why you can count on trained experts looking after your Winnebago, whether it's tackling a problem or routine maintenance. We're proud of these sales and service dealers. And we're proud of our name.

See the complete family of America's finest motorhomes now at your Winnebago dealer's showroom. From the most luxurious Custom to the Chieftain, Indian, Minnie Winnie, or most economical Brave, he has many different models of all RV types:

Camper coaches, trailers, 5th wheels, motorhomes, mini motorhomes and van conversions. From 14 feet to 31 feet. One visit will show you why we're the name that means the most in motorhomes.

WINNEBAGO The name that means
the most in motorhomes.

Winnebago Industries, Inc.
P.O. Box 152, Forest City, Iowa 50436

Due to continued product improvement and changes in suppliers, design and production, accuracy cannot be guaranteed in descriptive and pictorial representation of the products in this brochure. While they are believed to be current at the time of publication, equipment, colors, material specifications, and model availability are subject to change without notice. Please contact your authorized Winnebago dealer for current model specifications.

Winnebago Warranty

Winnebago Industries, Inc., warrants each new Winnebago Motor Home (excluding chassis, 110 volt power plant, and tires), Travel Trailer (excluding tires) or Camper Coach to the original purchaser as follows:

- For the life time of the unit—Winnebago Industries' exclusive "Thermo-Panel" Construction is warranted against defects in lamination for the lifetime of the Winnebago Motor Home Body, Travel Trailer, or Camper Coach.
- For the period of one year from the date of purchase—air compressor, air conditioner (auto), air conditioner (roof), antenna, axles (TT), auxiliary battery (MH), battery (TT), brake assembly (TT), converter, speed control, demand pump, furnace, hitch (TT), LP gas bottle(s), power range hood, pre-finished panelling, range, radio, refrigerator, sink, stereo, vacuum cleaner, gauges, water conditioner, toilet, and water heater.
- For the period of 90 days from the date of purchase—carpet, cushion foam, compartment doors, drainage hose, driver and passenger seats, electrical systems, cushion fabric, fire extinguisher, plastic refrigerator interior door, faucets, light fixtures, plumbing system, switches, shower door, shower head, vinyl, jack (MH), sealants, LP gas valves, and windows.

Any part of the Winnebago Motor Home, Travel Trailer or Camper Coach subject to this warranty which is found to be defective in material or workmanship, will be repaired or replaced, at Winnebago Industries' option, by the selling dealer without charge for parts or labor. If the selling dealer has ceased to do business as an authorized Winnebago dealer or the owner is traveling or has moved to a different locality and cannot return to the selling dealer, the owner may obtain warranty repairs or replacement at any authorized Winnebago Dealership.

Winnebago Industries, Inc., cannot, however, and does not accept any responsibility in connection with any of its Motor Homes, Travel Trailers, or Camper Coaches when they have been altered outside of its own factory. If the purchaser shall use or allow to be used in the Motor Home, Travel Trailer or Camper Coach, equipment and/or parts not made or supplied by Winnebago Industries, Inc., then this warranty shall become void, if failure is a result of improper installation or adaption.

Winnebago Industries, Inc., does not undertake responsibility to any purchaser of its products for any undertaking, representation or warranty made by dealers selling its products beyond those herein expressed.

This express warranty is the only warranty applicable to the Winnebago Motor Home, Travel Trailer, or Camper Coach and is expressly in lieu of any warranties otherwise implied by law (including but not limited to implied warranties of merchantability or fitness for any particular purpose). The remedies available under this express warranty shall be the only remedies available to the purchaser-user with respect to defects in material or workmanship.

Without regard to the alleged defect, Winnebago Industries, Inc., under any circumstances, does not assume any responsibility for loss of time, inconvenience or other consequential damage including, but not limited to, expense for gasoline, telephone, travel, lodging, loss or damage to personal property or loss of revenue.

Winnebago Industries, Inc., reserves the right to make changes in design and changes or improvements upon its products without imposing any obligation upon itself to install the same upon its products theretofore manufactured.

It is the obligation of each Winnebago dealer to provide full service for owners of Winnebago Motor Homes, including Winnebago installed and/or approved components as to all aspects of said products. If the dealer is unable to provide said service at his place of business, the dealer will, at his own expense, secure said service for you from other firms authorized to service the various components in your Winnebago Motor Home.