

1988 W/IF426RT

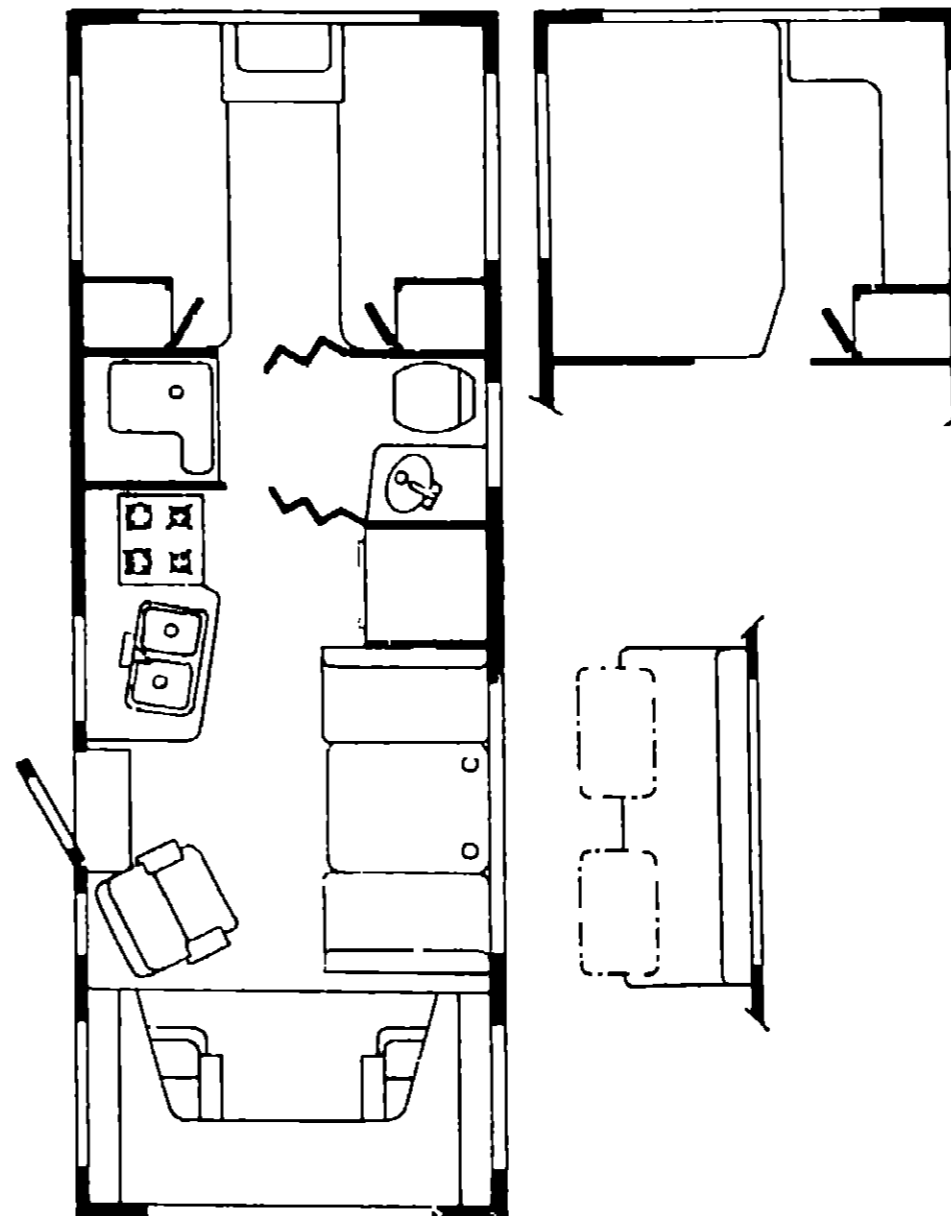

1988 WINNEBAGO-ITASCA TABLE OF CONTENTS

W/IT319RK	A-01 - B-04
W/IT319RB	B-05 - C-08
W/IC420EG	C-09 - D-06
W/IF420RG	D-07 - E-10
W/IC420RG	D-07 - E-10
W/IF421RB	E-11 - F-04
W/IC421RB	E-11 - F-04
W/IF424RB	F-05 - G-02
W/IC424RB	F-05 - G-02
W/IF424RC	G-03 - H-02
W/IC424RC	G-03 - H-02
W/IF426RT	H-03 - I-02

1988 W/IF426RT INDEX

Floor Plan	H-03 - H-04
Bath Group	H-05
Curtain, Cushion & Pad Group	H-06 - H-14
Dinette Group	H-15 - H-16
Exterior Body Group	H-17 - H-20
Galley Group	H-21
Lounge Group	H-22 - H-23
Window, Vent & Exterior Door Group	H-24 - I-02

BATH GROUP

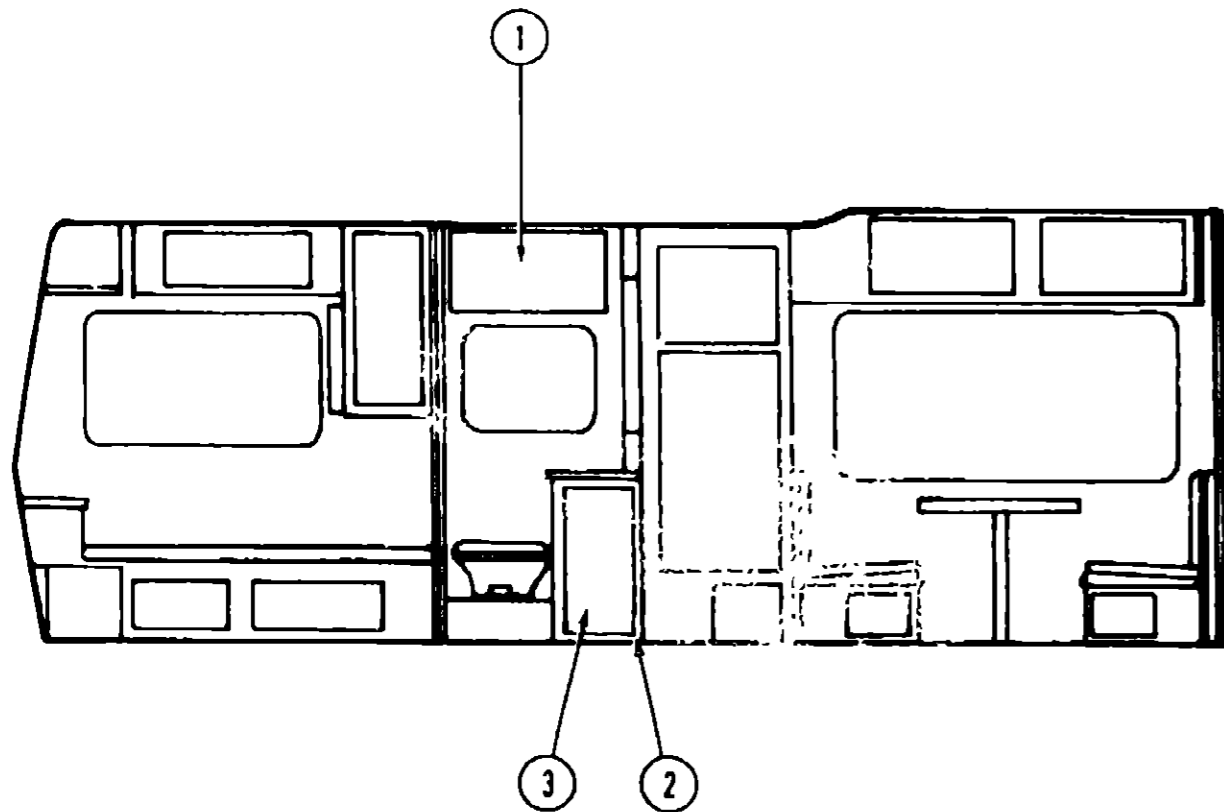

BATH CABINETS & HARDWARE

Key	Part Number	U/M	Description
1	088303-52-X08	EA	Door Asm - Medicine Cabinet - 29 5" x 15 5" - Mirror
•	076073-01-000	EA	Cabinet Asm - Medicine - Almond
•	076387-01-000	EA	Bracket - Medicine Cabinet
2	M83934-01-X08	EA	Cabinet Asm - Lavatory - w/o Door, Drawer, Hardware or Countertop
•	M02666-01-X08	EA	Countertop Asm - Lavatory Cabinet
•	077251-01-000	EA	Drawer Asm - Plastic - Tipout
3	M88304-97-X08	EA	Door Asm - Lavatory Cabinet - 10" x 25 1" - w/o Hardware
•	080224-18-000	EA	Door Asm - Folding - 35" x 75
•	080224-14-000	EA	Track - Folding Door - "S" Curve - Front
•	080224-16-000	EA	Track - Folding Door - Rear
•	082169-01-000	EA	Light - Make-up - 3 Bulb
•	089318-01-000	EA	Door Asm - Shower
•	058331-05-000	EA	Mirror - Tempered Glass - 12" x 26
•	058331-14-000	EA	Mirror - Tempered Glass - 14" x 12 7"
•	080508-01-000	EA	Panel - Skylight - Inner
•	080507-01-000	EA	Panel - Skylight - Outer
•	M02673 02-X11	EA	Shower Pan Asm - Off White
•			Not illustrated

CURTAIN, CUSHION & PAD GROUP NOTICE

In order to assist our Parts Sales Dept in providing interior software items, please include the serial number and the color code number from the vehicle certification label when ordering. This label is located on the left sidewall at the end of the dash (A-Body), or on the driver's door latch plate (C-Body).

An example of a color code number is P31, which designates an overall color scheme of a particular unit. The color listed after the item description on the microfiche, indicates the overall unit color. Order the item you desire according to unit color code.

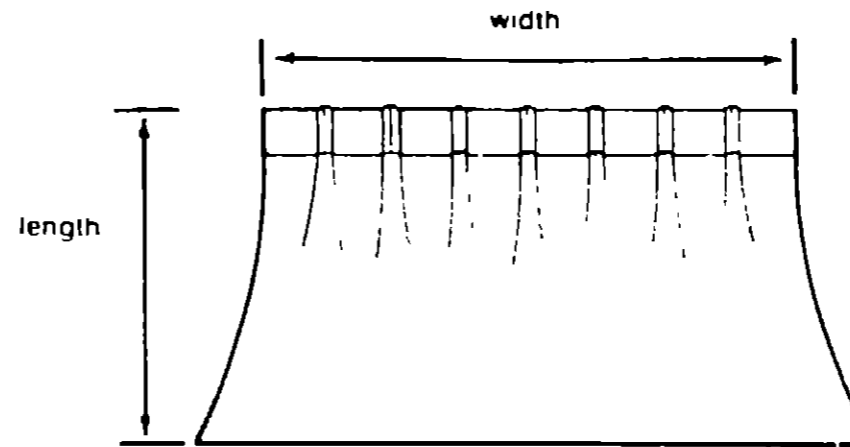

NOTE

Use this illustration when determining length and width measurements for curtains. You will note the width measurement is taken on the top of the curtain with the curtain fully extended. The length measurement is taken from top to bottom.

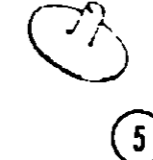

Key	Part Number	U/M	Description
1	029130-01-000	EA	Socket - Snap Fastener
2	029155 01-000	EA	Cap - Snap - 156" Dia x 17" Barrel
3	029156-01-000	EA	Socket - Snap Fastener
4	029092 01-000	EA	Stud - Nickel Finish
5	029093-01-000	EA	Eyelet - Nickel Finish

1988 WINNEBAGO-ITASCA TABLE OF CONTENTS

W/IT319RK	A-01 - B-04
W/IT319RB	B-05 - C-08
W/IC420EG	C-09 - D-06
W/IF420RG	D-07 - E-10
W/IC420RG	D-07 - E-10
W/IF421RB	E-11 - F-04
W/IC421RB	E-11 - F-04
W/IF424RB	F-05 - G-02
W/IC424RB	F-05 - G-02
W/IF424RC	G-03 - H-02
W/IC424RC	G-03 - H-02
W/IF426RT	H-03 - I-02

1988 W/IF426RT INDEX

Floor Plan	H-03 - H-04
Bath Group	H-05
Curtain, Cushion & Pad Group	H-06 - H-14
Dinette Group	H-15 - H-16
Exterior Body Group	H-17 - H-20
Galley Group	H-21
Lounge Group	H-22 - H-23
Window, Vent & Exterior Door Group	H-24 - I-02

CURTAIN, CUSHION & PAD GROUP (CONTINUED)

CURTAIN, CUSHION & PAD GROUP (CONTINUED)

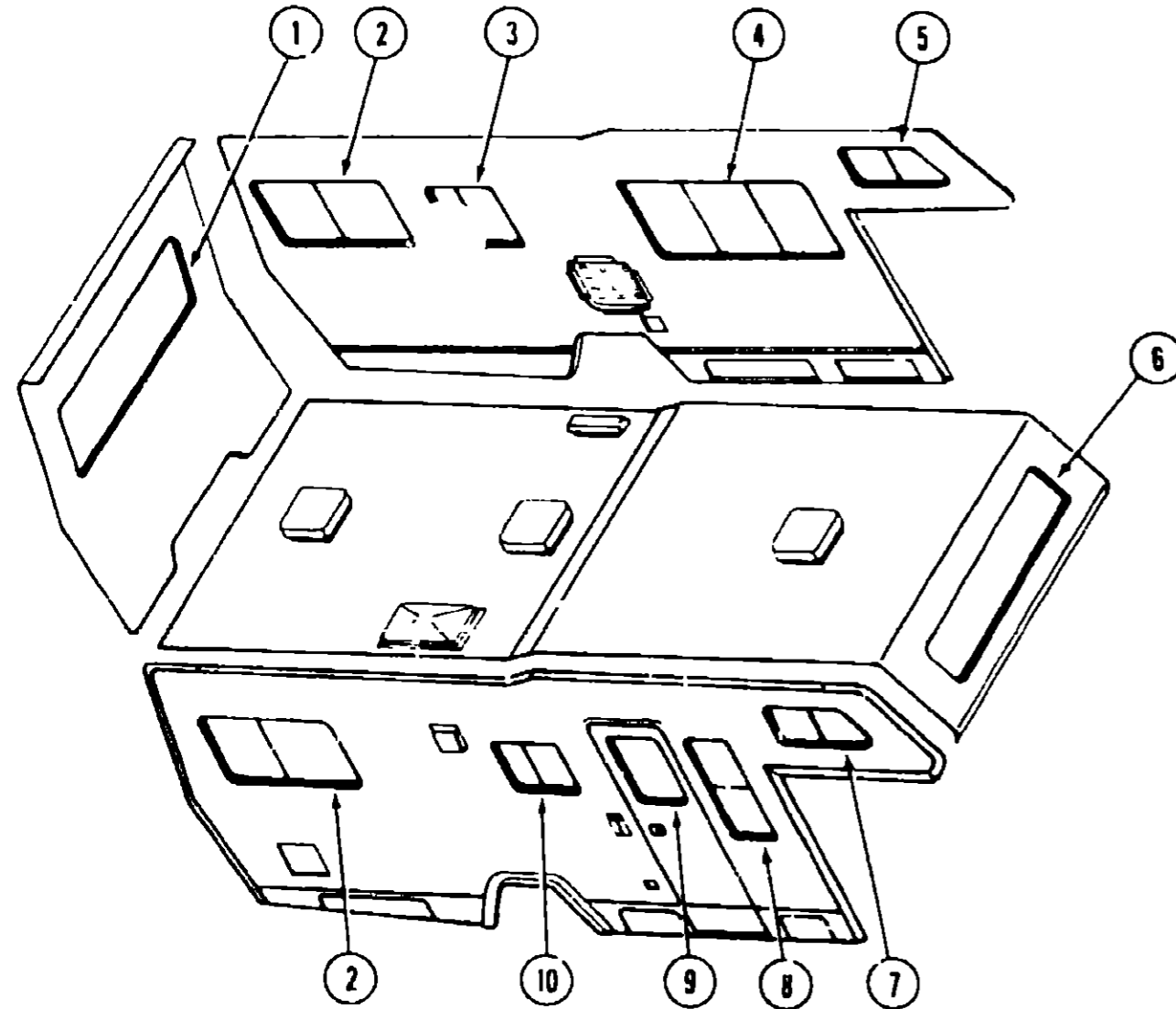

WINNEBAGO

CURTAINS, SHADES, VALANCES & TIEBACKS

Key	Part Number	U/M	Description
1	085190-25-X08	EA	Curtain Asm w/Snap Top - 26" x 15" (X08)
**1	085190-25-XA0	EA	Curtain Asm w/Snap Top - 26" x 15" (X08)
1	085190-25-X09	EA	Curtain Asm w/Snap Top - 26" x 15" (X09)
**1	085190-25-XA1	EA	Curtain Asm w/Snap Top - 26" x 15" (X09)
1	085190-25-X10	EA	Curtain Asm w/Snap Top - 26" x 15" (X10)
**1	085190-25-XA2	EA	Curtain Asm w/Snap Top - 26" x 15" (X10)
1	066226-50-X08	EA	Curtain Asm w/Rod Top - Sheer - 25" x 78"
1	088926-01-X11	EA	Valance Asm - Quilted - 76" (X08)
**1	088926-01-XA0	EA	Valance Asm - Quilted - 76" (X08)
1	088926-01-X12	EA	Valance Asm - Quilted - 76" (X09)
**1	088926-01-XA1	EA	Valance Asm - Quilted - 76" (X09)
1	088926-01-X13	EA	Valance Asm - Quilted - 76" (X10)
**1	088926-01-XA2	EA	Valance Asm - Quilted - 76" (X10)
1	084755-29-X11	EA	Shade Asm - Linen - 72 25"
**	Parts used after 2/22/88		

WINNEBAGO

CURTAINS, SHADES, VALANCES & TIEBACKS (CONT.)

Key	Part Number	U/M	Description
2	085190-07-X08	EA	Curtain Asm w/Snap Top - 29 5" x 15" (X08)
**2	085190-07-XA0	EA	Curtain Asm w/Snap Top - 29 5" x 15" (X08)
2	085190-07-X09	EA	Curtain Asm w/Snap Top - 29 5" x 15" (X09)
**2	085190-07-XA1	EA	Curtain Asm w/Snap Top - 29 5" x 15" (X09)
2	085190-07-X10	EA	Curtain Asm w/Snap Top - 29 5" x 15" (X10)
**2	085190-07-XA2	EA	Curtain Asm w/Snap Top - 29 5" x 15" (X10)
2	066226-42-X11	EA	Curtain Asm w/Rod Top - Sheer - 28" x 78"
2	088926-02-X11	EA	Valance Asm - Quilted - 50" (X08)
**2	088926-02-XA0	EA	Valance Asm - Quilted - 50" (X08)
2	088926-02-X12	EA	Valance Asm - Quilted - 50" (X09)
**2	088926-02-XA1	EA	Valance Asm - Quilted - 50" (X09)
2	088926-02-X13	EA	Valance Asm - Quilted - 50" (X10)
**2	088926-02-XA2	EA	Valance Asm - Quilted - 50" (X10)
2	084755-28-X11	EA	Shade Asm - Linen - 47 25"
3	073304-43-X08	EA	Curtain Asm - w/Snap Top - 25 5" x 10'
3	M81977-21-X08	EA	Valance Asm - 31 7"
3	082118-B4-000	EA	Blind - 28" x 24" Drop (X08)
3	088729-10-000	EA	Blind - 28" x 24" Drop (X09)
3	082118-B5-000	EA	Blind - 28" x 24" Drop (X10)
4	087318-07-X11	EA	Curtain Asm w/Snap Top - 33 5" x 15'
4	M81977-23-X08	EA	Valance Asm - 68 5"
4	M81977-23-X09	EA	Valance Asm - 68 5"
4	M81977-23-X10	EA	Valance Asm - 68 5"
4	082118-C6-000	EA	Blind - 65" x 33" Drop (X08)
4	088729-01-000	EA	Blind - 65" x 33" Drop (X09)
4	082118-C7-000	EA	Blind - 65" x 33" Drop (X10)
5	073323-33-X08	EA	Curtain Asm w/Rod Top & Bottom - 17 5" x 24'
6	073323-37-X08	EA	Curtain Asm w/Rod Top & Bottom - 21" x 30"
7	085190-15-X08	EA	Curtain Asm w/Darts - 45" x 10
7	082118-A5-000	EA	Blind - 19" x 42 5" Drop (X08)
7	088729-09-000	EA	Blind - 19" x 42 5" Drop (X09)
7	082118-A6-000	EA	Blind - 19" x 42 5" Drop (X10)
8	084755-04-X11	EA	Shade Asm - Linen - 24 25"
8	080824-06-X08	EA	Valance Asm - Entrance Door
9	M81977-22-X08	EA	Valance Asm - 29 5"
9	082118-A8-000	EA	Blind - 27" x 22" Drop (X08)
9	088729-03-000	EA	Blind - 27" x 22" Drop (X09)
9	082118-A9-000	EA	Blind - 27" x 22" Drop (X10)
.	077591-01-X08	EA	Curtain Asm w/Velcro - 52" x 40" - Right
.	077591-02-X08	EA	Curtain Asm w/Velcro - 52" x 42" - Left
.	073295-04-X08	EA	Curtain Asm w/Lining - Front Wraparound - 23" x 64"
.	073295-06-X08	EA	Curtain Asm w/Lining - Front Wraparound - 23" x 64"
.	073295-23-X08	EA	Tieback Asm - 3' x 18" - Drapery
.	073295-24-X08	EA	Tieback Asm - 2" x 14" - Drapery
.	Not illustrated		
**	Parts used after 2/22/88		

**1988 WINNEBAGO-ITASCA
TABLE OF CONTENTS**

W/IT319PK	A-01 - B-04
W/IT315RB	B-05 - C-08
W/IC420EG	C-09 - D-06
W/IF420RG	D-07 - E-10
W/IC420RG	D-07 - E-10
W/IF421RB	E-11 - F-04
W/IC421RB	E-11 - F-04
W/IF424RB	F-05 - G-02
W/IC424RB	F-05 - G-02
W/IF424RC	G-03 - H-02
W/IC424RC	G-03 - H-02
W/IF426RT	H-03 - I-02

1988 W/IF426RT INDEX

Floor Plan	H-03 - H-04
Bath Group	H-05
Curtain, Cushion & Pad Group	H-06 - H-14
Director Group	H-15 - H-16
Exterior Body Group	H-17 - H-20
Galley Group	H-21
Lounge Group	H-22 - H-23
Window, Vent & Exterior Door Group	H-24 - I-02

CURTAIN, CUSHION & PAD GROUP (CONTINUED)

CURTAIN, CUSHION & PAD GROUP (CONTINUED)

ITASCA X33

CURTAINS, SHADES, VALANCES & TIEBACKS

**1988 WINNEBAGO-ITASCA
TABLE OF CONTENTS**

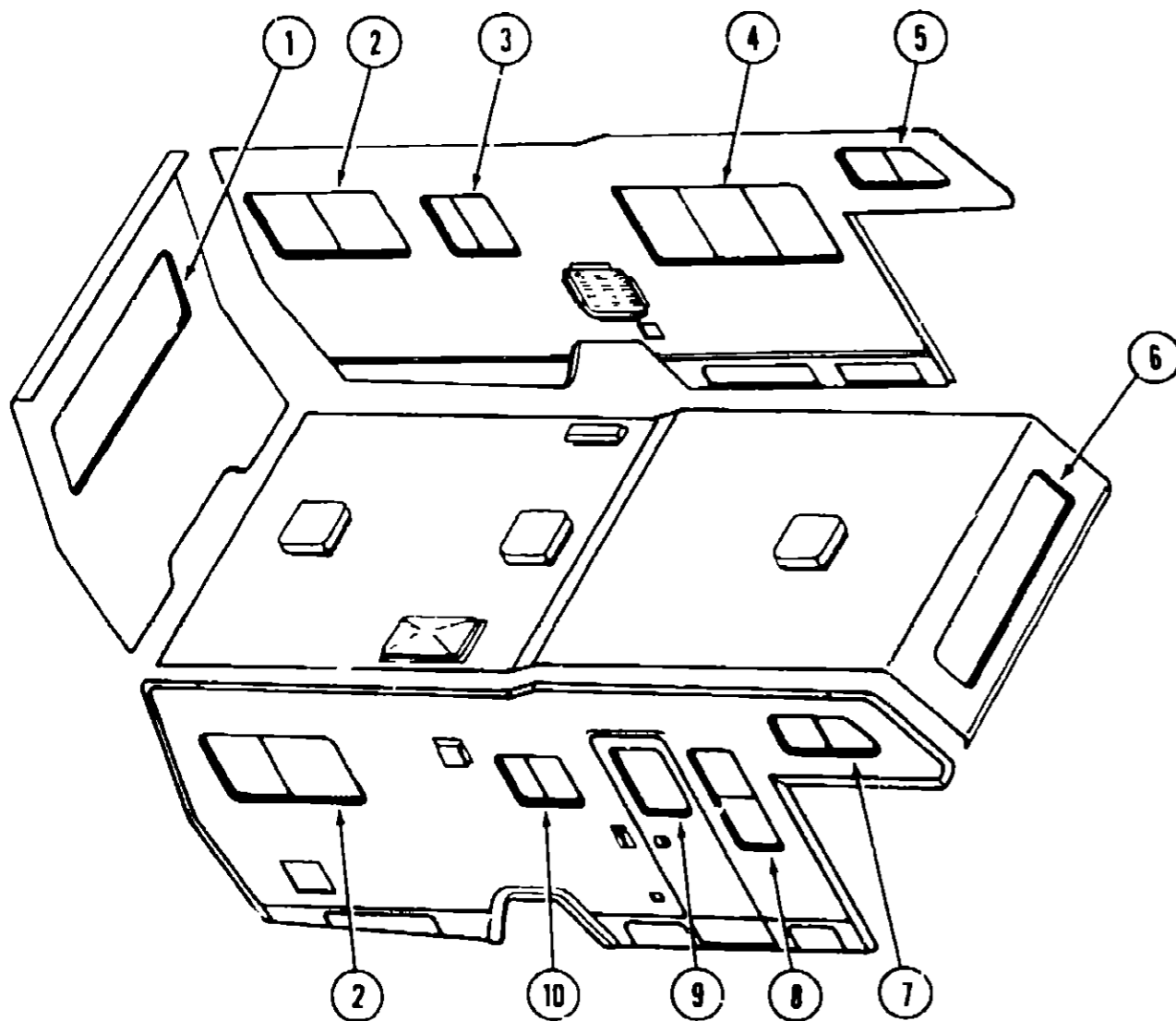

Key	Part Number	U/M	Description
1	079558-20-X36	EA	Valance Asm w/Gathers - 5" x 140"
1	079559-11-X33	EA	Curtain Asm w/Gathers - 32" x 41"
1	084755-03-X36	EA	Shade Asm - Linen - 72 25"
††1	084755-03-XA3	EA	Shade Asm - Linen - 72 25"
**1	084755-03-XA6	EA	Shade Asm - Linen - 72 25"
2	079558-22-X33	EA	Valance Asm w/Gathers - 5" x 95"
2	079559-11-X33	EA	Curtain Asm w/Gathers - 32" x 41"
2	084755-13-X33	EA	Shade Asm - Linen - 47 25"
††2	084755-13-XA3	EA	Shade Asm - Linen - 47 25"
**2	084755-13-XA6	EA	Shade Asm - Linen - 47 25"
3	079558-15-X33	EA	Valance Asm w/Gathers - 5" x 40"
3	079559-14-X33	EA	Curtain Asm w/Gathers - 26" x 20"
3	084755-01-X33	EA	Shade Asm - Linen - 28 25"
††3	084755-01-XA3	EA	Shade Asm - Linen - 28 25"
**3	084755-01-XA6	EA	Shade Asm - Linen - 28 25"
4	079558-13-WB6	EA	Valance Asm w/Gathers - 5" x 140"
4	079559-15-X33	EA	Curtain Asm w/Gathers - 36" x 44"
4	084755-02-X33	EA	Shade Asm - Linen - 67 25"
††4	084755-02-XA3	EA	Shade Asm - Linen - 67 25"
**4	084755-02-XA6	EA	Shade Asm - Linen - 67 25"
5	073323-33-X33	EA	Curtain Asm w/Rod Top & Bottom - 17 5" x 24"
5	073323-37-X33	EA	Curtain Asm w/Rod Top & Bottom - 21" x 30"
7	080824-06-X33	EA	Valance Asm - Entrance Door
7	085190-15-X33	EA	Curtain Asm w/Darts - 45" x 10"
7	084755-12-X33	EA	Shade Asm - Linen - 19 25"
††7	084755-12-XA3	EA	Shade Asm - Linen - 19 25"
**7	084755-12-XA6	EA	Shade Asm - Linen - 19 25"
8	084755-04-X33	EA	Shade Asm - Linen - 24 25"
††8	084755-04-XA3	EA	Shade Asm - Linen - 24 25"
**8	084755-04-XA6	EA	Shade Asm - Linen - 24 25"
9	079558-14-WB6	EA	Valance Asm w/Gathers - 5" x 75"
9	084755-01-X33	EA	Shade Asm - Linen - 28 25"
††9	084755-01-XA3	EA	Shade Asm - Linen - 28 25"
**9	084755-01-XA6	EA	Shade Asm - Linen - 28 25"
.	077591-01-X33	EA	Curtain Asm w/Velcro Top - Blackout - 52" x 40"
.	077591-02-X33	EA	Curtain Asm w/Velcro Top - Blackout - 52" x 42"
.	073295-04-X33	EA	Curtain Asm w/Lining - Front Wraparound - 23" x 64"
.	073295-06-X33	EA	Curtain Asm w/Lining - Front Wraparound - 23" x 64"
.	073260-24-X33	EA	Tieback Asm - 2" x 14" - Drapery
.	073260-27-X78	EA	Tieback Asm - 3" x 23" - Bedspread
.	073260-34-X33	EA	Tieback Asm - 4" x 20" - Drapery
††	073260-34-XB3	EA	Tieback Asm - 4" x 20" Drapery
.			Not Illustrated
††			Parts used after 12/1/87
**			Parts used after 3/1/88

W/IT319RK	A-01 - B-04
W/IT319RB	B-05 - C-08
W/IC420EG	C-09 - D-06
W/IF420RG	D-07 - E-10
W/IC420RG	D-07 - E-10
W/IF421RB	E-11 - F-04
W/IC421RB	E-11 - F-04
W/IF424RB	F-05 - G-02
W/IC424RB	F-05 - G-02
W/IF424RC	G-03 - H-02
W/IC424RC	G-03 - H-02
W/IF426RT	H-03 - I-02

1988 W/IF426RT INDEX

Floor Plan	H-03 - H-04
Bath Group	H-05
Curtain, Cushion & Pad Group	H-06 - H-14
Dinette Group	H-15 - H-16
Exterior Body Group	H-17 - H-20
Galley Group	H-21
Lounge Group	H-22 - H-23
Window, Vent & Exterior Door Group	H-24 - I-02

ITASCA X34

CURTAINS, SHADES, VALANCES & TIEBACKS

1988 WINNEBAGO-ITASCA
TABLE OF CONTENTS

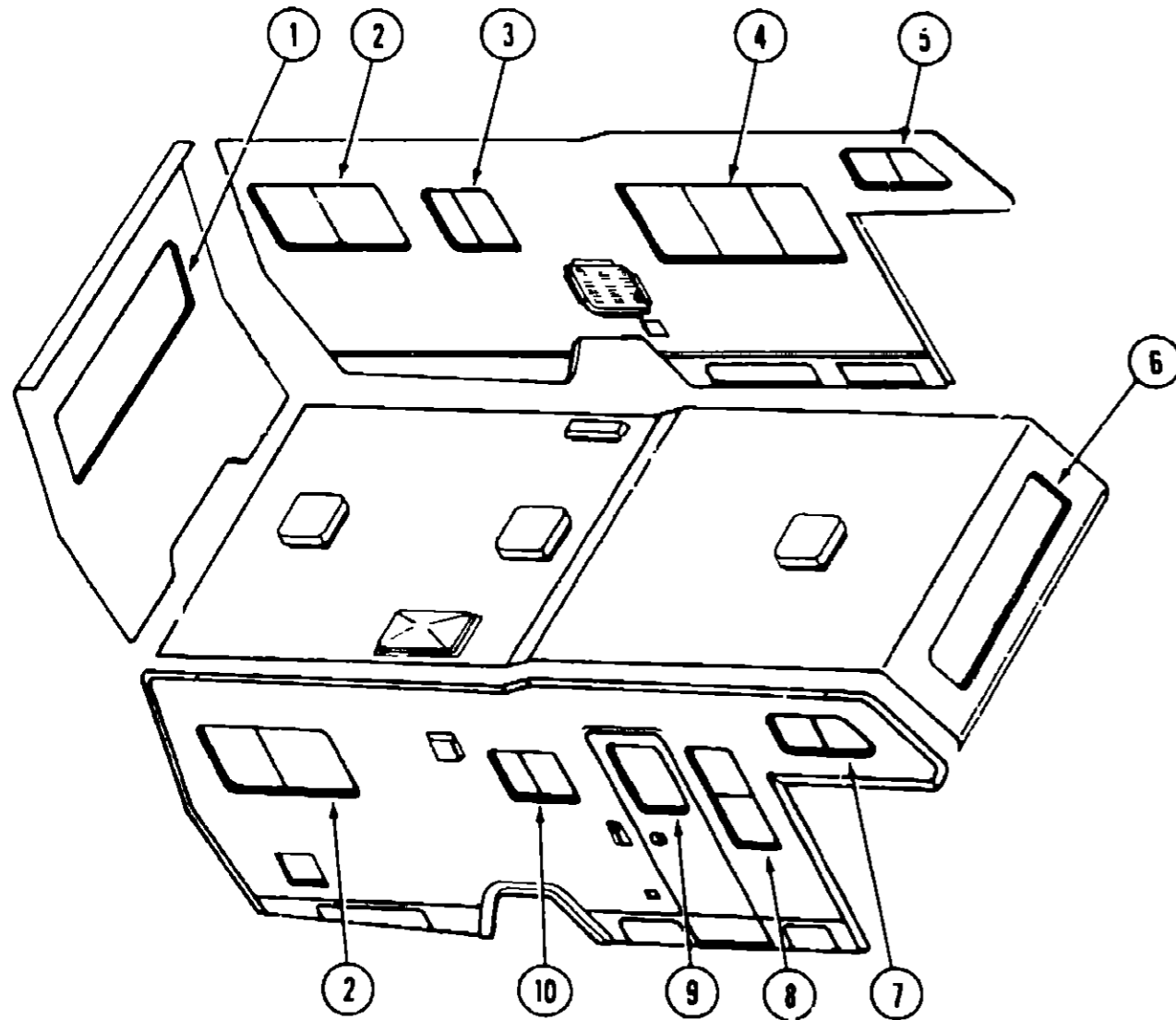

Key	Part Number	U/M	Description
1	079558-20-X37	EA	Valance Asm w/Gathers - 5" x 140"
1	079559-11-X34	EA	Curtain Asm w/Gathers - 32" x 41"
1	084755-03-X37	EA	Shade Asm - Linen - 72 25"
††1	084755-03-XA3	EA	Shade Asm - Linen - 72 25"
**1	084755-03-XA6	EA	Shade Asm - Linen - 72 25"
2	079558-22-X34	EA	Valance Asm w/Gathers - 5" x 95"
2	079559-11-X34	EA	Curtain Asm w/Gathers - 32" x 41"
2	084755-13-X34	EA	Shade Asm - Linen - 47 25"
††2	084755-13-XA3	EA	Shade Asm - Linen - 47 25"
**2	084755-13-XA6	EA	Shade Asm - Linen - 47 25"
3	079558-15-X34	EA	Valance Asm w/Gathers - 5" x 40"
†3	079558-15-XA4	EA	Valance Asm w/Gathers - 5" x 40"
3	079559-14-X34	EA	Curtain Asm w/Gathers - 26" x 20"
†3	079558-14-XA4	EA	Curtain Asm w/Gathers - 26" x 20"
3	084755-01-X34	EA	Shade Asm - Linen - 28 25"
††3	084755-01-XA3	EA	Shade Asm - Linen - 28 25"
**3	084755-01-XA6	EA	Shade Asm - Linen - 28 25"
4	079558-13-W34	EA	Valance Asm w/Gathers - 5" x 140"
†4	079558-13-XA4	EA	Valance Asm w/Gathers - 5" x 140"
4	079559-15-X34	EA	Curtain Asm w/Gathers - 36" x 44"
†4	079559-15-XA4	EA	Curtain Asm w/Gathers - 36" x 44"
4	084755-02-X34	EA	Shade Asm - Linen - 67 25"
††4	084755-02-XA3	EA	Shade Asm - Linen - 67 25"
**4	084755-02-XA6	EA	Shade Asm - Linen - 67 25"
5	073323-33-X34	EA	Curtain Asm w/Rod Top & Bottom - 17 5" x 24"
†5	073323-33-XA4	EA	Curtain Asm w/Rod Top & Bottom - 17 5" x 24"
6	073323-37-X34	EA	Curtain Asm w/Rod Top & Bottom - 21" x 30"
†6	073323-37-XA4	EA	Curtain Asm w/Rod Top & Bottom - 21" x 30"
7	080824-06-X34	EA	Valance Asm - Entrance Door
†7	080824-06-XA4	EA	Valance Asm - Entrance Door
7	085190-15-X34	EA	Curtain Asm w/Darts - 45" x 10"
†7	085190-15-XA4	EA	Curtain Asm w/Darts - 45" x 10"
7	084755-12-X34	EA	Shade Asm - Linen - 19 25"
††7	084755-12-XA3	EA	Shade Asm - Linen - 19 25"
**7	084755-12-XA6	EA	Shade Asm - Linen - 19 25"
8	084755-04-X34	EA	Shade Asm - Linen - 24 25"
††8	084755-04-XA3	EA	Shade Asm - Linen - 24 25"
**8	084755-04-XA6	EA	Shade Asm - Linen - 24 25"
9	079558-14-W34	EA	Valance Asm w/Gathers - 5" x 75"
†9	079558-14-XA4	EA	Valance Asm w/Gathers - 5" x 75"
9	084755-01-X34	EA	Shade Asm - Linen - 28 25"
††9	084755-01-XA3	EA	Shade Asm - Linen - 28 25"
**9	084755-01-XA6	EA	Shade Asm - Linen - 28 25"
.	077591-01-X34	EA	Curtain Asm w/Velcro Top - Blackout - 52" x 40"
†	077591-01-XA4	EA	Curtain Asm w/Velcro Top - Blackout - 52" x 40"
.	077591-02-X34	EA	Curtain Asm w/Velcro Top - Blackout - 52" x 42"
†	077591-02-XA4	EA	Curtain Asm w/Velcro Top - Blackout - 52" x 42"
.	073295-04-X34	EA	Curtain Asm w/Lining - Front Wraparound - 23" x 64"
†	073295-04-XA4	EA	Curtain Asm w/Lining - Front Wraparound - 23" x 64"
.	073295-06-X33	EA	Curtain Asm w/Lining - Front Wraparound - 23" x 64"
†	073295-06-XA4	EA	Curtain Asm w/Lining - Front Wraparound - 23" x 64"
.	073260-24-X79	EA	Tieback Asm - 2" x 14" - Drapery
†	073260-24-XA4	EA	Tieback Asm - 2" x 14" - Drapery
.	073260-27-WB6	EA	Tieback Asm - 3" x 23" - Bedspread
.	073260-34-X34	EA	Tieback Asm - 4" x 20" - Drapery
†	073260-34-XB4	EA	Tieback Asm - 4" x 20" - Drapery
††	073260-34-XA4	EA	Tieback Asm - 4" x 20" - Drapery
.	Not Illustrated		
†	Parts used after 10/1/87		
††	Parts used after 12/1/87.		
**	Parts used after 3/1/84		

W/IT319RK	A-01 - B-04
W/IT319RB	B-05 - C-08
W/IC420EG	C-09 - D-06
W/IF420RG	D-07 - E-10
W/IC420RG	D-07 - E-10
W/IF421RB	E-11 - F-04
W/IC421RB	E-11 - F-04
W/IF424RB	F-05 - G-02
W/IC424RB	F-05 - G-02
W/IF424RC	G-03 - H-02
W/IC424RC	G-03 - H-02
W/IF126RT	H-03 - I-02

1988 W/IF426RT INDEX

Floor Plan	H-03 - H-04
Bath Group	H-05
Curtain, Cushion & Pad Group	H-06 - H-14
Dinette Group	H-15 - H-16
Exterior Body Group	H-17 - H-20
Galley Group	H-21
Lounge Group	H-22 - H-23
Window, Vent & Exterior Door Group	H-24 - I-02

CURTAIN, CUSHION & PAD GROUP (CONTINUED)

CURTAIN, CUSHION & PAD GROUP (CONTINUED)

ITASCA X35

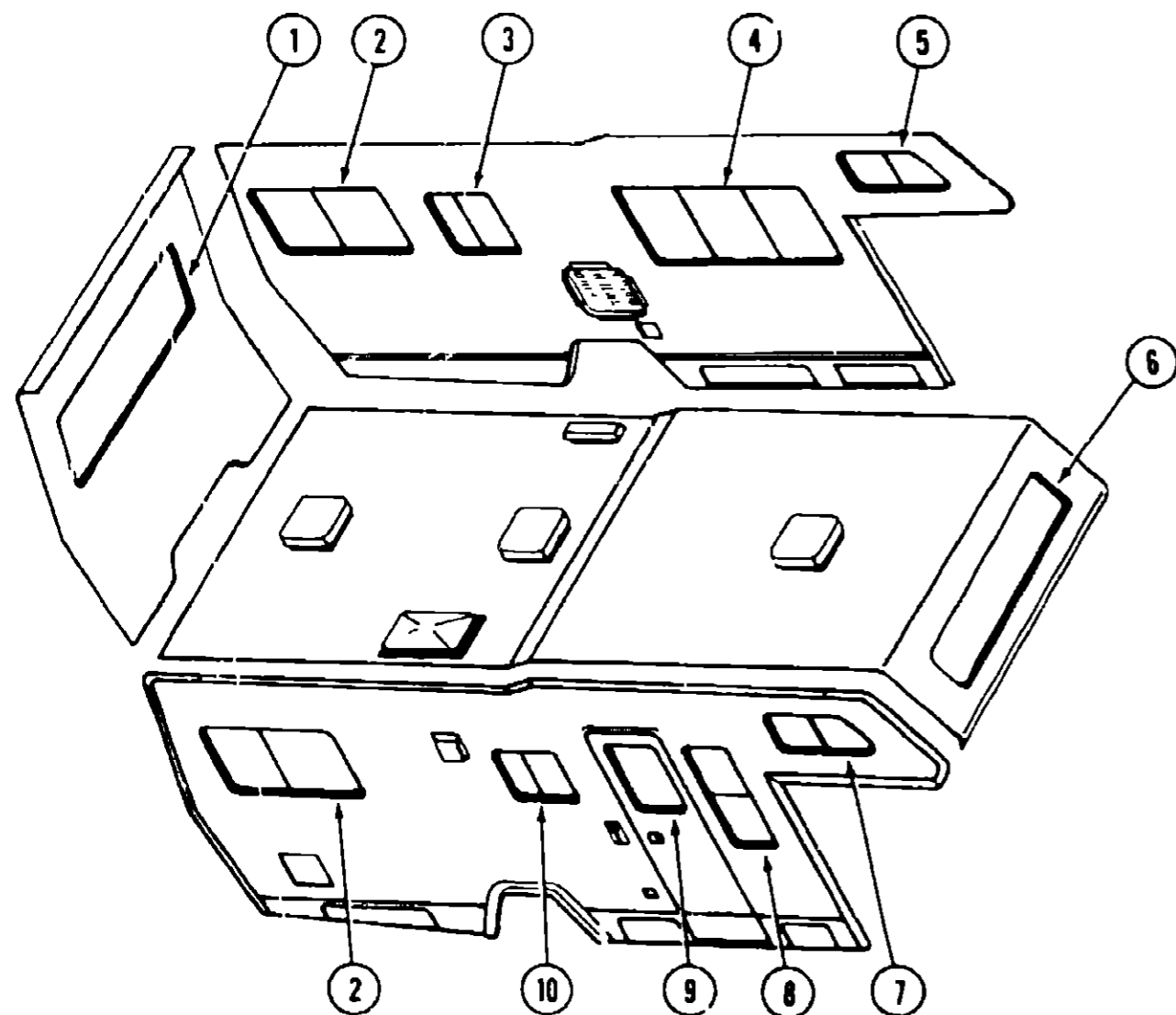

CURTAINS, SHADES, VALANCES & TIEBACKS

Key	Part Number	U/M	Description
1	079558-20-X38	EA	Valance Asm w/Gathers - 5" x 140"
1	079559-11-X35	EA	Curtain Asm w/Gathers - 32" x 41"
1	084755-03-X38	EA	Shade Asm - Linen - 72 25"
**1	084755-03-XA8	EA	Shade Asm - Linen - 72 25"
2	079558-22-X35	EA	Valance Asm w/Gathers - 5" x 95"
2	079559-11-X35	EA	Curtain Asm w/Gathers 32" x 41"
2	084755-13-X35	EA	Shade Asm - Linen - 47 25"
**2	084755-13-XA8	EA	Shade Asm - Linen - 47 25"
3	079558-15-X35	EA	Valance Asm w/Gathers - 5" x 40"
3	079559-14-X35	EA	Curtain Asm w/Gathers - 26" x 20"
3	084755-01-X35	EA	Shade Asm - Linen - 28 25"
**3	084755-01-XA8	EA	Shade Asm - Linen - 28 25"
4	079558-13-X35	EA	Valance Asm w/Gathers - 5" x 140"
4	079559-15-X35	EA	Curtain Asm w/Gathers - 36" x 44"
4	084755-02-X35	EA	Shade Asm - Linen - 67 25"
**4	084755-02-XA8	EA	Shade Asm - Linen - 67 25"
5	073323-33-X35	EA	Curtain Asm w/Rod Top & Bottom - 17 5" x 24"
6	073323-37-X35	EA	Curtain Asm w/Rod Top & Bottom - 21" x 30"
7	080824-06-X35	EA	Valance Asm - Entrance Door
7	085190-15-X35	EA	Curtain Asm w/Darts - 45" x 10"
7	084755-12-X35	EA	Shade Asm - Linen - 19 25"
**7	084755-12-XA8	EA	Shade Asm - Linen - 19 25"
8	084755-04-X35	EA	Shade Asm - Linen - 24 25"
**8	084755-04-XA8	EA	Shade Asm - Linen - 24 25"
9	079558-14-W35	EA	Valance Asm w/Gathers - 5" x 75"
9	084755-01-X35	EA	Shade Asm - Linen - 28 25"
**9	084755-01-XA8	EA	Shade Asm - Linen - 28 25"
.	077591-01-X35	EA	Curtain Asm w/Velcro Top - Blackout - 52" x 40"
.	077591-02-X35	EA	Curtain Asm w/Velcro Top - Blackout - 52" x 42"
.	073295-04-X35	EA	Curtain Asm w/Lining - Front Wraparound - 23" x 64"
.	073295-06-X35	EA	Curtain Asm w/Lining - Front Wraparound - 23" x 64"
.	073280-24-X35	EA	Tieback Asm - 2" x 14" - Drapery
.	073260-27-X80	EA	Tieback Asm - 3" x 23" - Bedspread
.	073260-34-X35	EA	Tieback Asm - 4" x 20" - Drapery
.			Not Illustrated
†			Parts used after 10/1/87
**			Parts used after 3/1/88

**1988 WINNEBAGO-ITASCA
TABLE OF CONTENTS**

W/IT319RK	A-01 - B-04
W/IT319RB	B-05 - C-08
W/IC420EG	C-09 - D-06
W/IF420RG	D-07 - E-10
W/IC420RG	D-07 - E-10
W/IF421RB	E-11 - F-04
W/IC421RB	E-11 - F-04
W/IF424RB	F-05 - G-02
W/IC424RB	F-05 - G-02
W/IF424RC	G-03 - H-02
W/IC424RC	G-03 - H-02
W/IF426RT	H-03 - I-02

1988 W/IF426RT INDEX

Floor Plan	H-03 - H-04
Bath Group	H-05
Curtain, Cushion & Pad Group	H-06 - H-14
Dinette Group	H-15 - H-16
Exterior Body Group	H-17 - H-20
Galley Group	H-21
Lounge Group	H-22 - I-23
Window, Vent & Exterior Door Group	H-24 - I-02

DINETTE GROUP

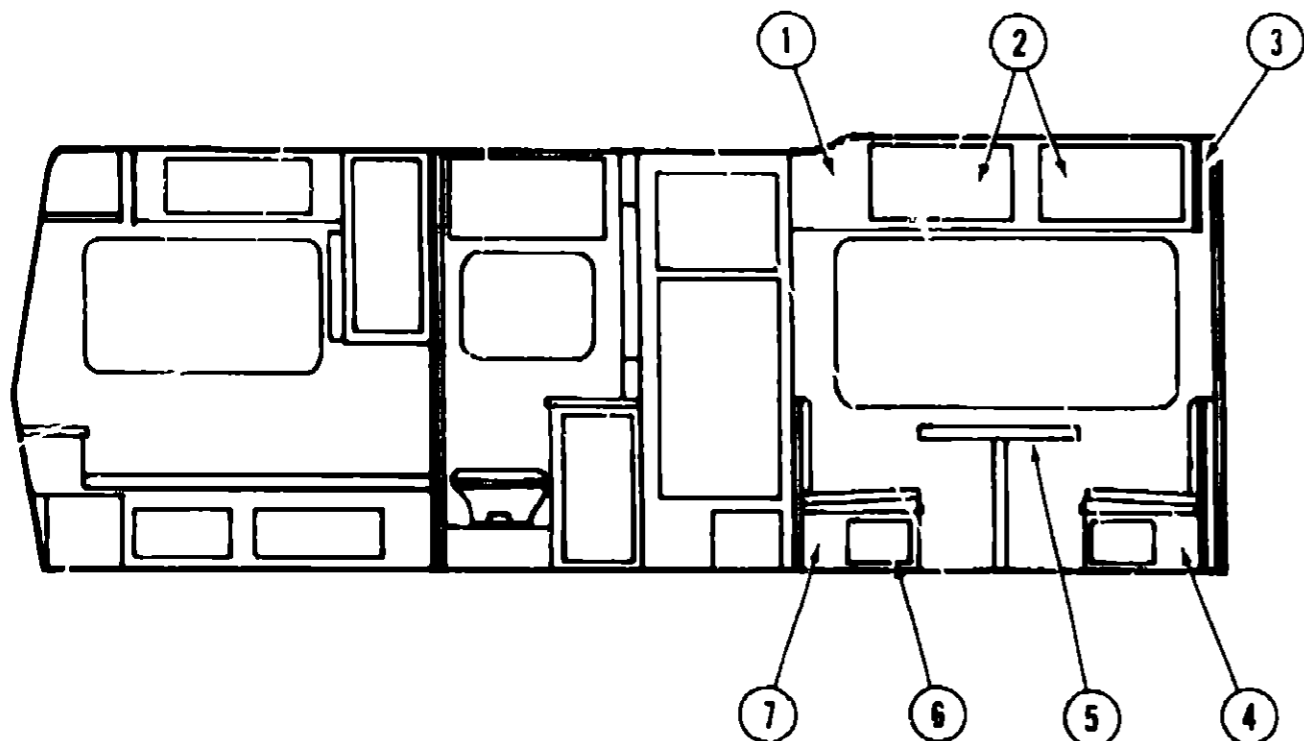

DINETTE CABINETRY & HARDWARE

Key	Part Number	U/M	Description
1	M83929-03-X33	EA	Cabinet Asm - Dinette Overhead - w/o Doors or Hardware
2	M88304-84-X08	EA	Door Asm - Dinette Overhead - 14 3" x 26 7" - w/o Hardware
3	081280-21-W24	EA	Pad Asm - End Cap - Dinette Overhead - Vinyl
4	M02175-02-W30	EA	Cabinet Asm - Dinette Seat - w/o Door or Hardware
•	M02174-01-W30	EA	Cabinet Asm - Dinette Back - w/o Hardware
5	M02115-09-U17	EA	Table Asm - Dinette - w/o Hardware
6	M88304-21-X08	EA	Door Asm - Dinette Seat - w/o Door or Hardware
7	M02175-04-W30	EA	Cabinet Asm - Dinette Seat - w/o Door or Hardware
•	M02174-03-W30	EA	Cabinet Asm - Dinette Back - w/o Hardware
•	053200-05-000	EA	Bracket - Upper Wall Mount - 23 5" - Beige
**	053201-06-000	EA	Bracket - Table Mount - 23" - Beige
•	024275-05-000	EA	Rod - Table Lift - 8" x 23 5" - Beige
•	088410-01-000	EA	Hangar - Table - Beige
•	024281-07-000	EA	Bracket - Lower Wall Mount - Table Lift - Tan
•	024276-17-000	EA	Leg Asm - Table - 26 75" - Brown
**	064050-02-000	EA	Hinge - Table Leg
**	024282-01-000	EA	Brace - Table Leg
**	024283-01-000	EA	Clip - 1" O D Tube
•	049493-05-000	EA	Catch - Table Leg - Mounts on Floor - Tan
•	Not illustrated		
**	The illustrated parts breakdown for this item is provided on the Common Items Fiche		

DINETTE GROUP (CONTINUED)

COUCH/BED CUSHIONS W/TABLE OPTION

Key	Part Number	U/M	Description
**	NOTE		Couch/Bed Cushions
	081298-01-X11	EA	Table Asm - Pedestal
	009040-06-000	EA	Leg - Pedestal Table - 27 50"
	009040-03-000	EA	Base - Table - Raised
	041194-01-000	EA	Base - Table - Flush Mount
	062046-01-000	EA	Clip - Pedestal Table
**	See the Common Series Fiche #3		

1988 WINNEBAGO-ITASCA TABLE OF CONTENTS

W/IT319RK	A-01 - B-04
W/IT319RB	B-05 - C-08
W/IC420EG	C-09 - D-06
W/IF420RG	D-07 - E-10
W/IC420RG	D-07 - E-10
W/IF421RB	E-11 - F-04
W/IC421RB	E-11 - F-04
W/IF424RB	F-05 - G-02
W/IC424RB	F-05 - G-02
W/IF424RC	G-03 - H-02
W/IC424RC	G-03 - H-02
W/IF426RT	H-03 - I-02

1988 W/IF426RT INDEX

Floor Plan	H-03 - H-04
Bath Group	H-05
Curtain, Cushion & Pad Group	H-06 - H-14
Dinette Group	H-15 - H-16
Exterior Body Group	H-17 - H-20
Galley Group	H-21
Lounge Group	H-22 - H-23
Window, Vent & Exterior Door Group	H-24 - I-02

EXTERIOR BODY GROUP

WINNEBAGO

EXTERIOR BODY PANELS

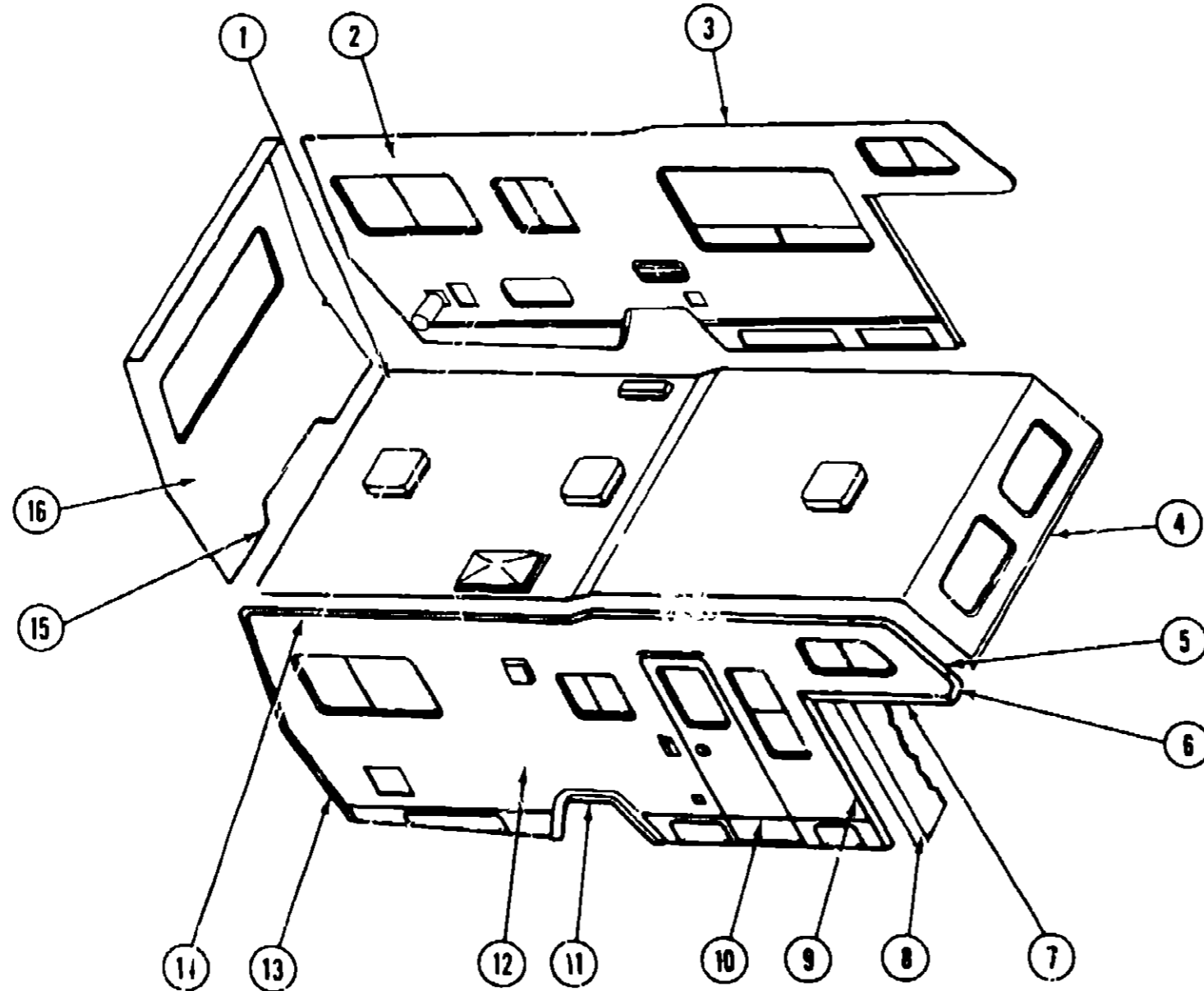

1988 WINNEBAGO-ITASCA TABLE OF CONTENTS

W/IT319RK	A-01 - B-04
W/IT319RB	B-05 - C-08
W/IC420EG	C-09 - D-06
W/IF420RG	D-07 - E-10
W/IC420RG	D-07 - E-10
W/IF421RB	E-11 - F-04
W/IC421RB	E-11 - F-04
W/IF424RB	F-05 - G-02
W/IC424RB	F-05 - G-02
W/IF424RC	G-03 - H-02
W/IC424RC	G-03 - H-02
W/IF426RT	H-03 - I-02

1988 W/IF426RT INDEX

Floor Plan	H-03 - H-04
Bath Group	H-05
Curtain, Cushion & Pad Group	H-06 - H-14
Dinette Group	H-15 - H-18
Exterior Body Group	H-17 - H-20
Galley Group	H-21
Lounge Group	H-22 - H-23
Window, Vent & Exterior Door Group	H-24 - I-02

Key	Part Number	U/M	Description
1	M88628-01-X08	EA	Roof Asm
•	M76177-01-700	EA	Roof Section - Cab Over To First Seam
2	M88984-01-X08	EA	Sidewall Asm - Driver
2	M88984-01-X09	EA	Sidewall Asm - Driver
2	M88984-01-X10	EA	Sidewall Asm - Driver
3	076502-08-000	EA	Trim - Contour - Upper Front - Driver - Off White
•	076802-07-000	EA	Trim - Contour - Upper Front - Passenger - Off White
4	039644-08-000	EA	Trim - Sleeper Board - Front - Off White
5	085490-01-000	EA	Trim - Contour - Front - Passenger - Off White
•	085490-02-000	EA	Trim - Contour - Front - Driver - Off White
6	086899-03-000	EA	Trim - Front Radius - Passenger - Off White
•	086899-04-000	EA	Trim - Front Radius - Driver - Off White
7	076975-05-000	EA	Trim - Wingwall - Passenger - Off White
•	076975-06-000	EA	Trim - Wingwall - Driver - Off White
8	M81653-03-W04	EA	Wingwall Asm - Passenger
•	M81653-04-W04	EA	Windwall Asm - Drive
9	076975-03-000	EA	Trim - Wingwall Transition - Passenger - Off White
•	076975-04-000	EA	Trim - Wingwall Transition - Driver - Off White

Key	Part Number	U/M	Description
10	059576-05-000	EA	Feature Strip - w/o Insert - Extr - 14' - Brown
•	001030-02-100	EA	Insert - Feature Strip - 17' - Off White
•	009731-01-000	EA	End Cap - Feature Strip
11	075189-01-000	EA	Trim - Wheelwell - Rear - Passenger - Off White
•	075189-02-000	EA	Trim - Wheelwell - Rear - Driver - Off White
•	087953-01-000	EA	Trim - Wheelwell - Rear - Extrusion
12	M88985-01-X08	EA	Sidewall Asm - Passenger
12	M88985-01-X09	EA	Sidewall Asm - Passenger
12	M88985-01-X10	EA	Sidewall Asm - Passenger
13	076805-01-000	EA	Trim - Contour - Rear - Passenger - Off White
•	076805-02-000	EA	Trim - Contour - Rear - Driver - Off White
14	077339-05-000	EA	Trim - Contour - Upper Rear - Passenger - Off White
•	077339-06-000	EA	Trim - Contour - Upper Rear - Driver - Off White
15	074984-02-000	EA	Trim - Backwall - Lower - Passenger or Driver
16	081651-01-W04	EA	Backwall Asm
•	M01898-08-U10	EA	Rear Cap Asm - Fiberglass
•	078578-05-000	EA	Bumper End Cap - Rear - Passenger - Off White
•	078578-06-000	EA	Bumper End Cap - Rear - Driver - Off White
•			Not keyed

EXTERIOR BODY GROUP (CONTINUED)

ITASCA

EXTERIOR BODY PANELS

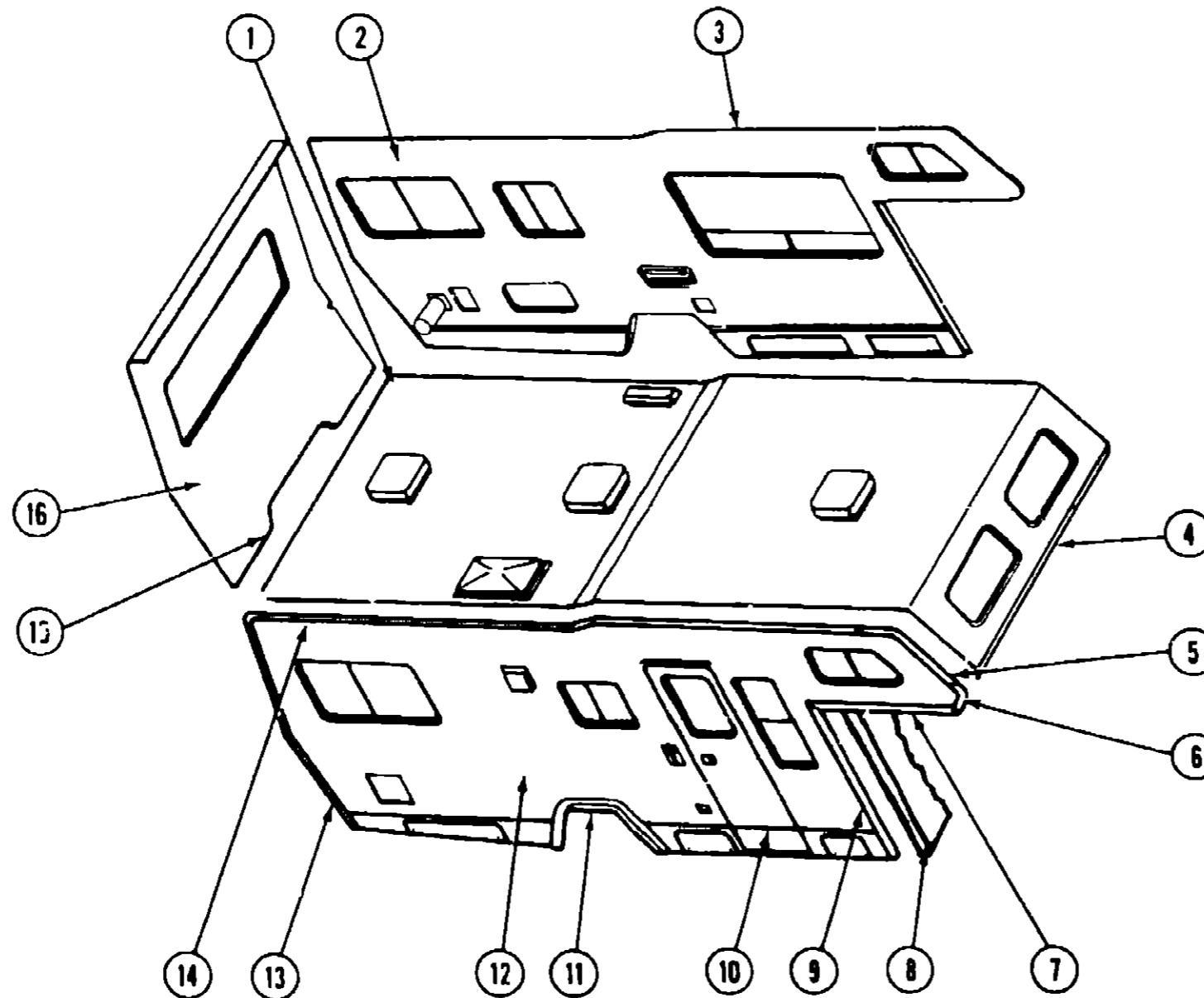

1988 WINNEBAGO-ITASCA TABLE OF CONTENTS

W/IT319RK	A-01 - B-04
W/IT319RB	B-05 - C-08
W/IC420EG	C-09 - D-06
W/IF420RG	D-07 - E-10
W/IC420RG	D-07 - E-10
W/IF421RB	E-11 - F-04
W/IC421RB	E-11 - F-04
W/IF424RB	F-05 - G-02
W/IC424RB	F-05 - G-02
W/IF424RC	G-03 - H-02
W/IC424RC	G-03 - H-02
W/IF426RT	H-03 - I-02

1988 W/IF426RT INDEX

Floor Plan	H-03 - H-04
Bath Group	H-05
Curtain, Cushion & Pad Group	H-06 - H-14
Dinette Group	H-15 - H-16
Exterior Body Group	H-17 - H-20
Galley Group	H-21
Lounge Group	H-22 - H-23
Window, Vent & Exterior Door Group	H-24 - I-02

Key	Part Number	U/M	Description
1	M88628-01-X08	EA	Roof Asm
•	M76177-01-700	EA	Roof Section - Cab Over To First Seam
2	M03144-01-X33	EA	Sidewall Asm - Driver
2	M03144-01-X34	EA	Sidewall Asm - Driver
2	M03144-01-X35	EA	Sidewall Asm - Driver
3	076802-08-000	EA	Trim - Contour - Upper Front - Driver - Off White
•	076802-07-000	EA	Trim - Contour - Upper Front - Passenger - Off White
4	039644-08-000	EA	Trim - Sleeper Board - Front - Off White
5	085490-01-000	EA	Trim - Contour - Front - Passenger - Off White
•	085490-02-000	EA	Trim - Contour - Front - Driver - Off White
6	086899-03-000	EA	Trim - Front Radius - Passenger - Off White
•	086899-04-000	EA	Trim - Front Radius - Driver - Off White
7	076975-05-000	EA	Trim - Wingwall - Passenger - Off White
•	076975-06-000	EA	Trim - Wingwall - Driver - Off White
8	M81653-03-W04	EA	Wingwall Asm - Passenger
•	M81653-04-W04	EA	Windwall Asm - Driver
9	076975-03-000	EA	Trim - Wingwall Transition - Passenger - Off White
•	076975-04-000	EA	Trim - Wingwall Transition - Driver - Off White

Key	Part Number	U/M	Description
10	059576-05-000	EA	Feature Strip - w/o Insert - Extr - 14' - Brown
•	001030-02-100	EA	Insert - Feature Strip - 17' - Off White
•	009731-01-000	EA	End Cap - Feature Strip
11	075189-01-000	EA	Trim - Wheelwell - Rear - Passenger - Off White
•	075189-02-000	EA	Trim - Wheelwell - Rear - Driver - Off White
•	087953-01-000	EA	Trim - Wheelwell - Rear - Extrusion
12	M88927-01-X33	EA	Sidewall Asm - Passenger
12	M88927-01-X34	EA	Sidewall Asm - Passenger
12	M88927-01-X35	EA	Sidewall Asm - Passenger
13	076805-01-000	EA	Trim - Contour - Rear - Passenger - Off White
•	076805-02-000	EA	Trim - Contour - Rear - Driver - Off White
14	077339-05-000	EA	Trim - Contour - Upper Rear - Passenger - Off White
•	077339-06-000	EA	Trim - Contour - Upper Rear - Driver - Off White
15	074986-02-000	EA	Trim - Backwall - Lower - Passenger or Driver
16	M81600-01-X33	EA	Backwall Asm
•	078578-05-000	EA	Bumper End Cap - Rear - Passenger - Off White
•	078578-06-000	EA	Bumper End Cap - Rear - Driver - Off White
•			Not keyed

GALLEY GROUP

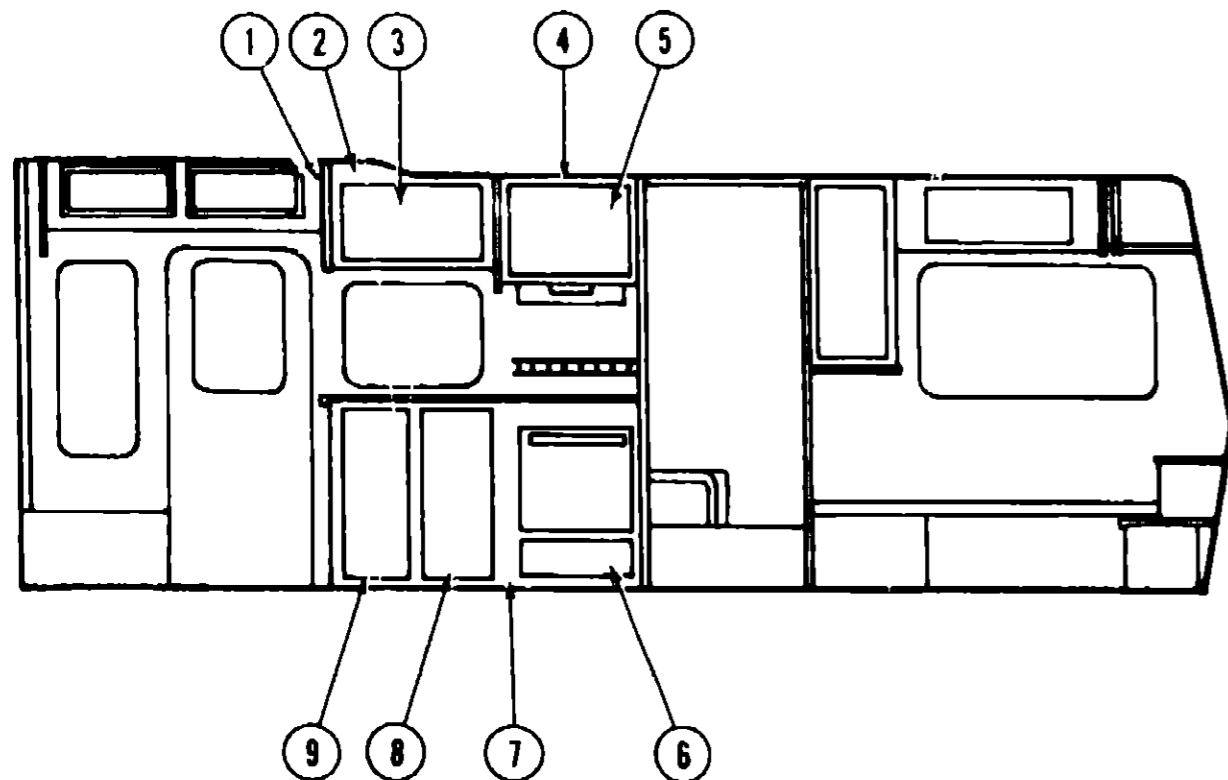

GALLEY CABINETRY

Key	Part Number	U/M	Description
1	081280-06-W24	EA	Pad Asm - End Cap - Galley Overhead - Vinyl
2	M83916-01-X08	EA	Cabinet Asm - Galley Overhead - w/o Doors or Hardware
3	M88304-84-X08	EA	Door Asm - Galley Overhead - 14 3" x 26 7" - w/o Hardware
4	M88307-03-X11	EA	Cabinet Asm - Galley Overhead - w/o Doors or Hardware
*	081280-10-W24	EA	Pad Asm - End Cap - Microwave Overhead - Vinyl
5	M88304-01-X08	EA	Door Asm - Galley Overhead - 17 7" x 22 8" - w/o Hardware
6	M88304-67-X11	EA	Door Asm - Galley Overhead - 21 8" x 15 9" - w/o Hardware
†6	M92073-04-X11	EA	Door Asm - Galley Overhead - 13 3" x 21 8" - w/o Hardware
7	M88611-01-X08	EA	Cabinet Asm - Galley - w/o Countertop, Doors Drawers or Hardware
*	088611-12-X08	EA	Countertop - Galley Cabinet
**	M82184-11-X36	EA	Drawer Asm - Galley Cabinet - w/o Hardware
8	M88304-14-X08	EA	Door Asm - Galley Cabinet - 14 3" x 33 4" - w/o Hardware
9	M88304-13-X08	EA	Door Asm - Galley Cabinet - 14 3" x 33 4" - w/o Hardware
*	077404-01-000	EA	Drawer - Plastic - 20" x 12 7"
*	074490-01-000	EA	Spice Rack Asm
*	080812-03-W24	EA	Extension Asm. - Galley Cabinet
			Not illustrated
**			Parts used in the Microwave Option
†			Part used after 12/13/87

LOUNGE GROUP

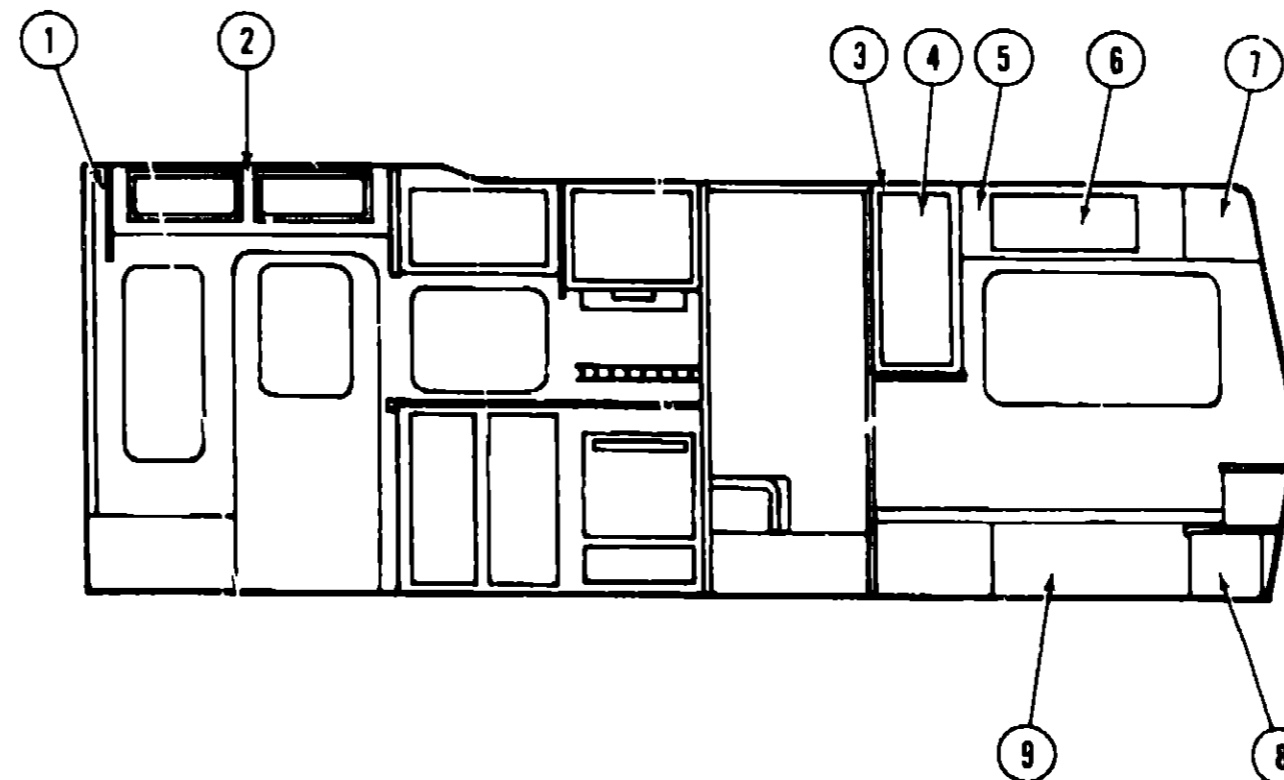

LOUNGE CABINETRY W/TWIN BED

Key	Part Number	U/M	Description
1	081280-22-W24	EA	Pad Asm - End Cap - Entrance Overhead - Vinyl
2	088603-02-X33	EA	Cabinet Asm - Entrance
3	083948-01-W24	EA	Cabinet Asm - Right Shirt Closet - w/o Door or Hardware
*	083949-01-W24	EA	Cabinet Asm - Left Shirt Closet - w/o Door or Hardware
4	M88304-82-X08	EA	Door Asm - Shirt Closet - 14 3" x 33 4" - w/o Hardware
*	081280-13-W24	EA	Pad Asm - End Cap - Right Shirt Closet - Vinyl
*	081280-16-W24	EA	Pad Asm - End Cap - Left Shirt Closet - Vinyl
5	M83931-01-X08	EA	Cabinet Asm - Right Rear Overhead - w/o Door or Hardware
*	M83930-01-X08	EA	Cabinet Asm - Left Rear Overhead - w/o Door or Hardware
6	M88304-66-X08	EA	Door Asm. - Rear Overheads - 11 4" x 28 1" - w/o Hardware
7	M83932-01-X08	EA	Cabinet Asm - Rear Overhead - w/o Doors or Hardware
8	M83903-01-X08	EA	Cabinet Asm - Nightstand - w/o Doors, Countertop or Hardware
*	M88304-02-X23	EA	Door Asm - Nightstand - 11" x 21 8" - w/o Hardware
*	M02670-01-X08	EA	Countertop Asm - Nightstand - Top
*	M02671-01-X08	EA	Countertop Asm. - Nightstand - Bottom
*	082686-01-000	EA	Table Lamp - Brass w/Wood
*	082686-02-000	EA	Shade - Table Lamp
**	089774-11-X08	EA	Countertop Asm - Wardrobe - w/o Hardware
**	M88304-82-X08	EA	Door Asm - Wardrobe - 16 7" x 48" - w/o Hardware
9	M88609-01-X08	EA	Cabinet Asm - Twin Bed - Right
*	090125-01-X08	EA	Cabinet Asm - Twin Bed - Left
*	M88304-21-X08	EA	Door Asm - Twin Bed - Left - 10" x 19" - w/o Hardware
*	084357-02-W24	EA	TV Stand Asm
*	084451-01-000	EA	Catch - TV Stand
**			Parts used for the Center Wardrobe Option

1988 WINNEBAGO-ITASCA TABLE OF CONTENTS

W/IT319RK	A-01 - B-04
W/IT319RB	B-05 - C-08
W/IC420EG	C-09 - D-06
W/IF420RG	D-07 - E-10
W/IC420RG	D-07 - E-10
W/IF421RB	E-11 - F-04
W/IC421RB	E-11 - F-04
W/IF424RB	F-05 - G-02
W/IC424RB	F-05 - G-02
W/IF424RC	G-03 - H-02
W/IC424RC	G-03 - H-02
W/IF426RT	H-03 - I-02

1988 W/IF426RT INDEX

Floor Plan	H-03 - H-04
Bath Group	H-05
Curtain, Cushion & Pad Group	H-06 - H-14
Dinette Group	H-15 - H-16
Exterior Body Group	H-17 - H-20
Galley Group	H-21
Lounge Group	H-22 - H-23
Window, Vent & Exterior Door Group	H-24 - I-02

LOUNGE GROUP (CONTINUED)

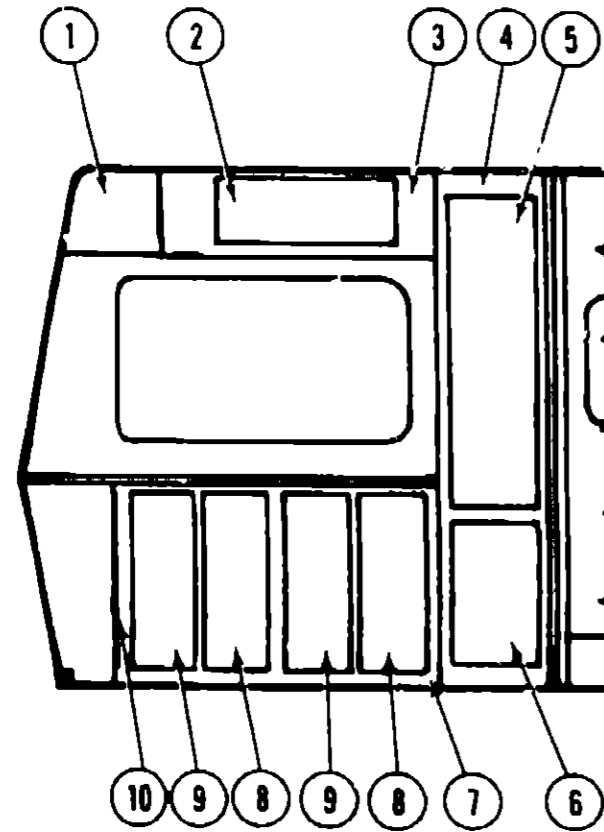

DOUBLE BED OPTION

Key	Part Number	U/M	Description
1	M83932-01-X08	EA	Cabinet Asm - Rear Overhead - w/o Doors or Hardware
2	M88304-66-X08	EA	Door Asm - Rear Overheads - 11 4" x 28 1" - w/o Hardware
3	M83930-01-X08	EA	Cabinet Asm - Left Rear Overhead - w/o Doors or Hardware
4	M83977-01-X08	EA	Cabinet Asm - Wardrobe - w/o Doors or Hardware
5	M88304-09-X08	EA	Door Asm - Wardrobe Cabinet - 12 1" x 48" - w/o Hardware
6	M88304-52-X23	EA	Door Asm - Wardrobe Cabinet - 14 3" x 21 8" - w/o Hardware
7	M83946-01-X08	EA	Cabinet Asm - Vanity - w/o Doors or Hardware
*	M02667-01-X08	EA	Countertop Asm - Vanity
8	M88304-72-X08	EA	Door Asm - Vanity Cabinet - 10 8" x 27 9" - w/o Hardware
9	M88304-71-X08	EA	Door Asm - Vanity Cabinet - 10 8" x 27 9" - w/o Hardware
10	M88304-98-X08	EA	Door Asm - Vanity Cabinet - 15 7" x 27 9" - w/o Hardware
*	M88304-73-X11	EA	Door Asm - Double Bed Cabinet - 10" x 25 1" - w/o Hardware
*			Not illustrated

WINDOWS, VENTS & EXTERIOR DOORS GROUP

ACCESS DOOR HARDWARE

Key	Part Number	U/M	Description
	052424-01-000	EA	Jamb - Power Cord/Fuel Fill Door - Off White
	088794-1J-000	EA	Hatch - Power Cord Door
	079246-01-000	EA	Jamb Asm - Generator Door - Off White
	064075-04-000	FT	Seal - Bulb - Door - 25'
	041312-01-000	FT	Seal - Bulb - "E" Section
	042442-01-000	EA	Lock Asm - Twist Type (Power Cord)
	079366-03-000	EA	Lock Asm - Key Type - w/o Keys - 1 3" Latch - 2 10" Depth
	079366-04-000	EA	Lock Asm - Key Type - w/o Keys - 1 3" Latch - 1 90" Depth
	083223-03-000	EA	Lock Asm - Key Type
	079927-03-000	EA	Lock Asm - Twist Type - Double Cam

1988 WINNEBAGO-ITASCA TABLE OF CONTENTS

W/IT319RK	A-01 - B-04
W/IT319RB	B-05 - C-08
W/IC42UEG	C-09 - D-06
W/IF420RG	D-07 - E-10
W/IC420RG	D-07 - E-10
W/IF421RB	E-11 - F-04
W/IC421RB	E-11 - F-04
W/IF424RB	F-05 - G-02
W/IC424RB	F-05 - G-02
W/IF424RC	G-03 - H-02
W/IC424RC	G-03 - H-02
W/IF426RT	H-03 - I-02

1988 W/IF426RT INDEX

Floor Plan	H-03 - H-04
Bath Group	H-05
Curtain, Cushion & Pad Group	H-06 - H-14
Dinette Group	H-15 - H-16
Exterior Body Group	H-17 - H-20
Galley Group	H-21
Lounge Group	H-22 - H-23
Window, Vent & Exterior Door Group	H-24 - I-02

WINDOW, VENT & EXTERIOR DOOR GROUP (CONTINUED)

WINDOWS & ACCESS DOORS

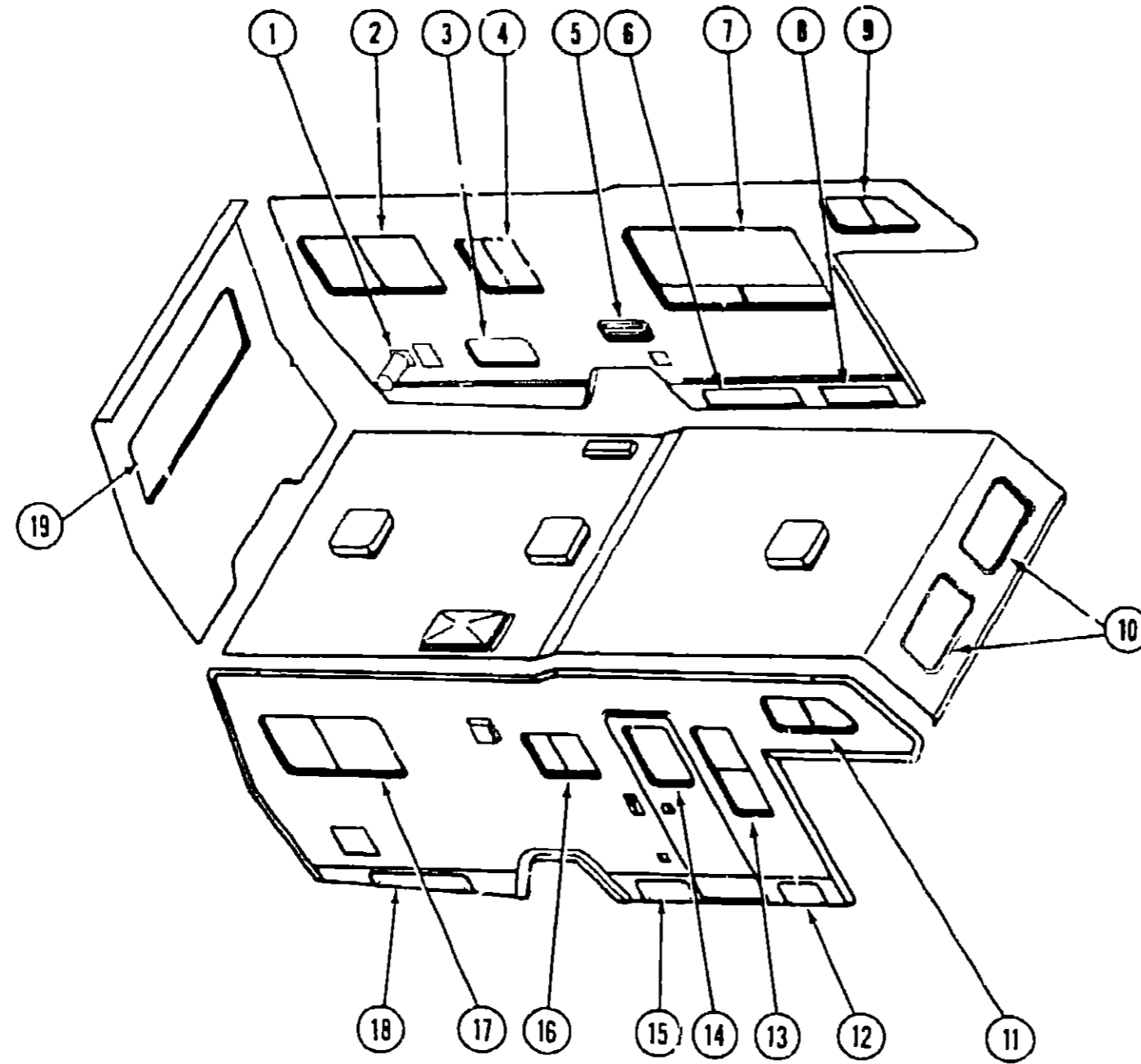

1988 WINNEBAGO-ITASCA TABLE OF CONTENTS

W/IT319RK	A-01 - B-04
W/IT319RB	B-05 - C-08
W/IC420EG	C-09 - D-06
W/IF420RG	D-07 - E-10
W/IC420RG	D-07 - E-10
W/IF421RB	E-11 - F-04
W/IC421RB	E-11 - F-04
W/IF424RB	F-05 - G-02
W/IC424RB	F-05 - G-02
W/IF424RC	G-03 - H-02
W/IC424RC	G-03 - H-02
W/IF426RT	H-03 - I-02

1988 W/IF426RT INDEX

Floor Plan	H-03 - H-04
Bath Group	H-05
Curtain, Cushion & Pad Group	H-06 - H-14
Dinette Group	H-15 - H-16
Exterior Body Group	H-17 - H-20
Galley Group	H-21
Lounge Group	H-22 - H-23
Window, Vent & Exterior Door Group	H-24 - I-02

Key	Part Number	U/M	Description
1	052423-01-000	EA	Door Asm - Sewer Hose
2	078266-06-T03	EA	Window Asm - Single Slider
3	079578 07-X08	EA	Door Asm - Storage
4	078266-03-T03	EA	Window Asm - Single Slider
5	084103-03-000	EA	Door Asm - Refrigerator Access
*	084104-03-000	EA	Jamb - Refrigerator Vent Door
*	088794-01-000	EA	Door Asm - Power Cord
6	079455-07-U01	EA	Door Asm - Storage
7	085354-02-W07	EA	Window Asm - Double (Winnebago)
7	078269-02-W24	EA	Window Asm - Double Slider (Itasca)
8	079149-01-T03	EA	Door Asm - Luggage
8	M79321-01-T03	EA	Door Asm - Generator
9	086227-02-000	EA	Window Asm - Bunk - Slant Slider - Left

Key	Part Number	U/M	Description
10	078533-04-X08	EA	Window Asm - Radius Picture
11	086227-01-000	EA	Window Asm - Bunk - Slant Slider - Right
12	079455-01-T95	EA	Door Asm - Storage
13	078453-01-T03	EA	Window Asm - Vertical Slider
14	079733-04-T03	EA	Window Asm - Picture
15	079455-03-T95	EA	Door Asm - LP
16	078266-02-T03	EA	Window Asm - Single Slider
17	078266-05-T03	EA	Window Asm - Single Slider
18	083264-05-X08	EA	Door Asm - Storage
19	07853C-01-T03	EA	Window Asm - Rear Escape
*	052009-01-000	EA	Door Asm - Water Heater
*	078010-03-000	EA	Door Asm - Fuel Fill
*	Not illustrated		