

1988 W/ICN31RT W/IJN31RT

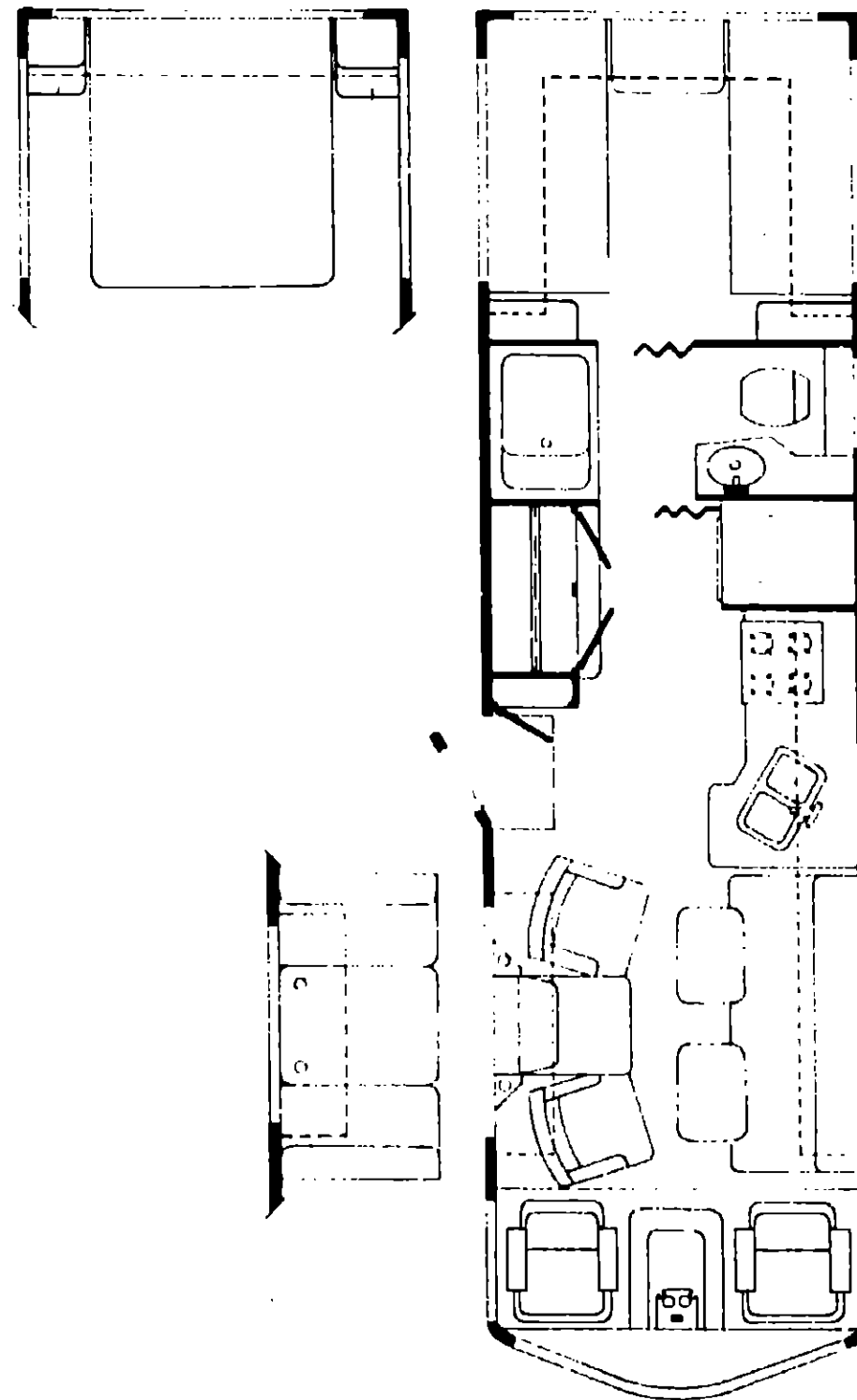

1988 N-SERIES TABLE OF CONTENTS

W/ICN22EC	A-01 - A-22
WCN22RC	A-23 - B-14
W/ICN27RT	B-15 - C-18
W/ICN27RU	C-19 - D-20
W/ICN31RT & W/IJN31RT	D-21 - E-18
W/ICN33RU	E-19 - F-18

1988 W/ICN31RT & W/IJN31RT INDEX

Floor Plan	D-21 - D-22
Bath Group	D-23
Curtain, Cushion & Pad Group	D-24 - E-06
Dinette Group	E-07 - E-08
Exterior Body Group	E-09 - E-13
Galley Group	E-14
Lounge Group	E-15 - E-16
Window, Vent & Exterior Door Group	E-17 - E-18

BATH GROUP

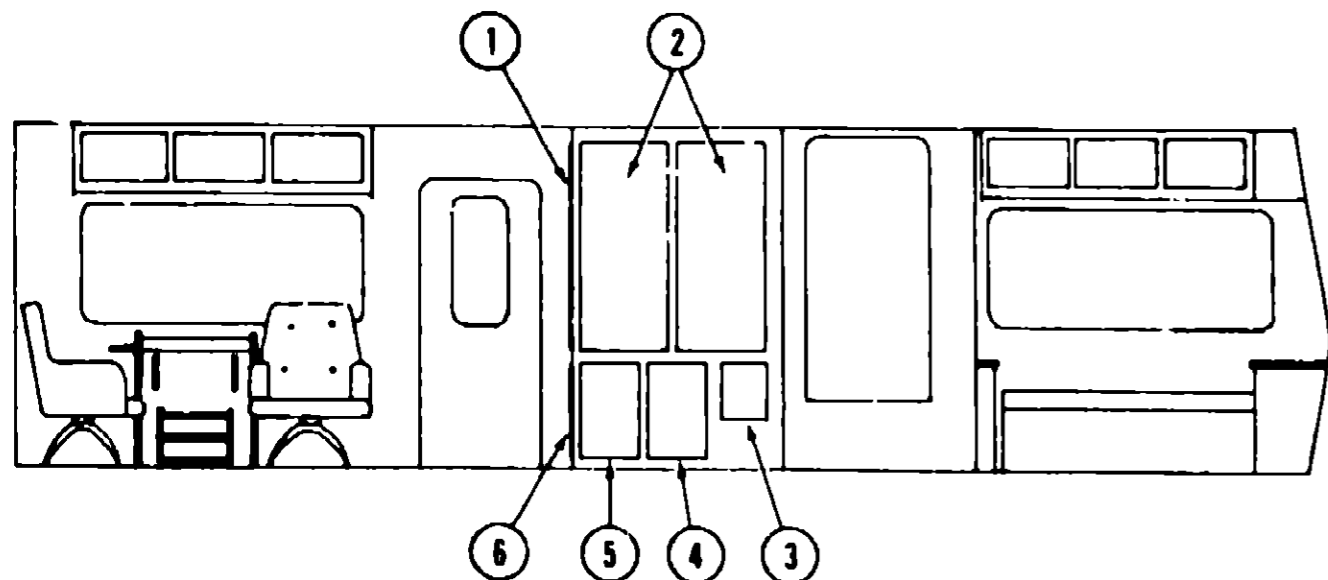

WARDROBE CABINETY

Key	Part Number	U/M	Description
1	M88304-70-X11	EA	Door Asm - Wardrobe Cabinet - 15 4" x 49 2" - w/o Hardware
	083224-03-000	EA	Glass - Wardrobe Door
2	M88304-64-X11	EA	Door Asm - Wardrobe Cabinet - 20 7" x 48" - w/o Hardware
3	M88304-52-X23	EA	Door Asm - Wardrobe Cabinet - 14 3" x 21 9" - w/o Hardware
4	M88304-65-X11	EA	Door Asm - Wardrobe Cabinet - 14 3" x 21 9" - w/o Hardware
5	M88304-68-X11	EA	Door Asm - Wardrobe Cabinet - 14 9" x 21 9" - w/o Hardware
	M02124-01-X11	EA	Countertop Asm - Wardrobe Cabinet
	077404-01-000	EA	Drawer - 20" x 12 7" - Plastic
	077409-02-000	EA	Slide - Plastic Drawer
	081646-01-000	EA	Storage Rack - White Wire
	075451-02-000	EA	Clip - Storage Rack
	083204-02-000	EA	Button - Glass Retaining
			Not illustrated

BATH CABINETY

Key	Part Number	U/M	Description
	M82195-01-X11	EA	Cabinet Asm - Lavatory - w/o Countertop, Doors or Drawers
	M02194-01-X11	EA	Countertop Asm - Lavatory Cabinet
	M88304-69-X11	EA	Door Asm - Lavatory - Hamper - 11 2" x 19 6" - w/o Hardware
	M88304-28-X11	EA	Door Asm - Lavatory - 16 1" x 11 4" - w/o Hardware
	081894-02-X11	EA	Drawer Asm - Lavatory - w/o Hardware
	077251-01-000	EA	Tipout Drawer - Plastic
	076073-01-000	EA	Cabinet Asm - Medicine - 15 4" x 20 4"
	088303-52-X08	EA	Door Asm - Medicine Cabinet - 29 4" x 15 5" - w/o Hardware
	M82094-01-X11	EA	Cabinet Asm - Pipe Cover
	M02195-01-X11	EA	Countertop Asm - Pipe Cover
	080224-29-000	EA	Door Asm - Folding - Front - w/o Hardware
	080224-30-000	EA	Door Asm - Folding - Rear - w/o Hardware
	075603-01-000	EA	Threshold - Door - Bath
	M87868-01-W33	EA	Door Asm - Bath - w/o Lock
	M88304-91-X11	EA	Mirror Asm - Bath Wall - 22 4" x 29 5" - w/o Hardware

CURTAIN, CUSHION & PAD GROUP

NOTICE

In order to assist our Parts Sales Dept. in providing interior software items, please include the serial number and the color code number from the vehicle certification label when ordering. This label is located on the left sidewall at the end of the dash (A-Body), or on the driver's door latch plate (C-Body).

An example of a color code number is P31, which designates an overall color scheme of a particular unit. The color listed after the item description on the microfiche, indicates the overall unit color. Order the item you desire according to unit color code.

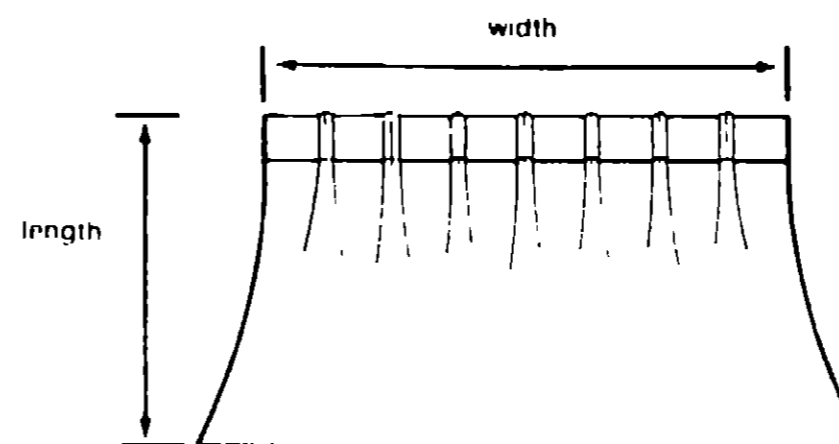

NOTE

Use this illustration when determining length and width measurements for curtains. You will note the width measurement is taken on the top of the curtain with the curtain fully extended. The length measurement is taken from top to bottom.



Key	Part Number	U/M	Description
1	029130-01-000	EA	Socket - Snap Fastener
2	029155-01-000	EA	Cap - Snap - 156" Dia x 17" Barrel
3	029156-01-000	EA	Socket - Snap Fastener
4	029092-01-000	EA	Stud - Nickel Finish
5	029093-01-000	EA	Eyelet - Nickel Finish

1988 N-SERIES TABLE OF CONTENTS

W/ICN22EC	A-01 - A-22
WCN22RC	A-23 - B-14
W/ICN27RT	B-15 - C-18
W/ICN27RU	C-19 - D-20
W/ICN31RT & W/IJN31RT	D-21 - E-18
W/ICN33RU	E-19 - F-16

1988 W/ICN31RT & W/IJN31RT INDEX

Floor Plan	D-21 - D-22
Bath Group	D-23
Curtain, Cushion & Pad Group	D-24 - E-08
Dinette Group	E-07 - E-08
Exterior Body Group	E-09 - E-13
Galley Group	E-14
Lounge Group	E-15 - E-16
Window, Vent & Exterior Door Group	E-17 - E-18

CURTAIN, CUSHION & PAD GROUP (CONTINUED)

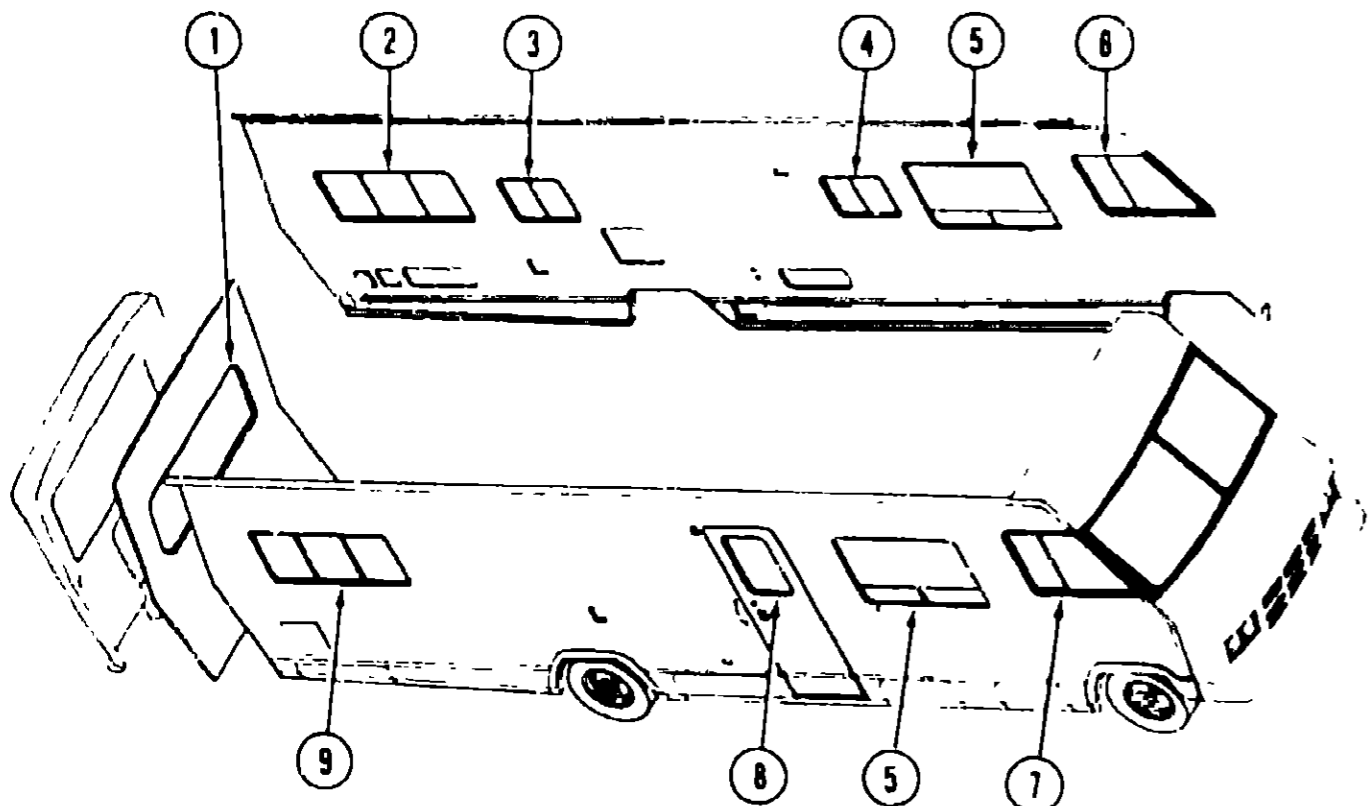

WINNEBAGO

CURTAINS, SHADES VALANCES & TIEBACKS

Key	Part Number	U/M	Description
1	084755-27-X11	EA	Shade Asm - Linen - 53 25
1	088926-07-X11	EA	Valance Asm - Quilted - 58"
1	088926-07-X12	EA	Valance Asm - Quilted - 58"
1	088926-07-X13	EA	Valance Asm - Quilted - 58"
**1	088926-07-XA0	EA	Valance Asm - Quilted - 58" (X11)
†1	088926-07-XA1	EA	Valance Asm - Quilted - 58" (X12)
††1	088926-07-XA2	EA	Valance Asm - Quilted - 58" (X13)
1	085190-07-X08	EA	Curtain Asm w/Snap Top - 29 5" x 15" (X11)
1	085190-07-X09	EA	Curtain Asm w/Snap Top - 29 5" x 15" (X12)
1	085190-07-X10	EA	Curtain Asm w/Snap Top - 29 5" x 15" (X13)
**1	085190-07-XA0	EA	Curtain Asm w/Snap Top - 29 5" x 15" (X11)
†1	085190-07-XA1	EA	Curtain Asm w/Snap Top - 29 5" x 15" (X12)
††1	085190-07-XA2	EA	Curtain Asm w/Snap Top - 29 5" x 15" (X13)
1	066226-42-X11	EA	Curtain Asm - Sheer - 28" x 78"
2	084755-31-X11	EA	Shade Asm - Linen - 69 2"
2	088926-08-X11	EA	Valance Asm - Quilted - 72"
2	088926-08-X12	EA	Valance Asm - Quilted - 72"
2	088926-08-X13	EA	Valance Asm - Quilted - 72"
**2	088926-08-XA0	EA	Valance Asm - Quilted - 72" (X11)
†2	088926-08-XA1	EA	Valance Asm - Quilted - 72" (X12)
††2	088926-08-XA2	EA	Valance Asm - Quilted - 72" (X13)
2	085190-07-X08	EA	Curtain Asm w/Snap Top - 29 5" x 15" (X11)
2	085190-07-X09	EA	Curtain Asm w/Snap Top - 29 5" x 15" (X12)
2	085190-07-X10	EA	Curtain Asm w/Snap Top - 29 5" x 15" (X13)
2	085190-07-XA0	EA	Curtain Asm w/Snap Top - 29 5" x 15" (X11)
†2	085190-07-XA1	EA	Curtain Asm w/Snap Top - 29 5" x 15" (X12)
††2	085190-07-XA2	EA	Curtain Asm w/Snap Top - 29 5" x 15" (X13)
2	066226-42-X11	EA	Curtain Asm - Sheer - 28" x 78"
3	085304-77-000	EA	Blind - Pleated - 32" x 26" Drop (X11)
3	085304-76-000	EA	Blind - Pleated - 32" x 26" Drop (X12)
3	085304-78-000	EA	Blind - Pleated - 32" x 26" Drop (X13)
3	085191-02-X11	EA	Valance Asm - w/Insert - 35 5"
3	073304-39-X08	EA	Curtain Asm - w/Snap Top - 27 5" x 10
**	Parts used after 2/22/88		
†	Parts used after 1/18/88		
††	Parts used after 1/25/88		

CURTAIN, CUSHION & PAD GROUP (CONTINUED)

WINNEBAGO

CURTAINS, SHADES VALANCES & TIEBACKS (CONT.)

Key	Part Number	U/M	Description
4	085304-71-000	EA	Blind - Pleated - 27" x 22" Drop (X11)
4	085304-70-000	EA	Blind - Pleated - 27" x 22" Drop (X12)
4	085304-72-000	EA	Blind - Pleated - 27" x 22" Drop (X13)
4	085191-03-X11	EA	Valance Asm w/Insert - 29 5"
5	085304-20-000	EA	Blinds - Pleated - 65" x 33" Drop (X11)
5	085304-19-000	EA	Blinds - Pleated - 65" x 33" Drop (X12)
5	085304-17-000	EA	Blinds - Pleated - 65" x 33" Drop (X13)
5	085191-01-X11	EA	Valance Asm - w/Insert - 68 5"
5	085190-16-X11	EA	Curtain Asm w/Snap Top - 33 5" x 44" - Right
5	085190-19-X11	EA	Curtain Asm w/Snap Top - 33 5" x 44" - Left
***	082127-77-000	EA	Shade Asm - Woven Wood - 65" x 33" Drop
***	087318-07-X11	EA	Curtain Asm w/Snap Top - 33 5" x 15
6	073304-41-X23	EA	Curtain Asm - Front Wraparound - 32 5" x 86"
†6	073304-49-X11	EA	Curtain Asm - Front Wraparound - 34" x 86"
6	077591-06-X11	EA	Curtain Asm - Front Bunk - 60" x 50"
†6	077591-10-X11	EA	Curtain Asm - Front Bunk - 60" x 47 5"
7	073304-40-X23	EA	Curtain Asm - Front Wraparound - 32 5" x 86"
†7	073304-49-X11	EA	Curtain Asm - Front Wraparound - 34" x 86"
7	077591-05-X11	EA	Curtain Asm - Front Bunk - 60" x 50"
†7	077591-09-X11	EA	Curtain Asm - Front Bunk - 60" x 47 5"
8	084755-04-X11	EA	Shade Asm w/Braid Trim - 24 25"
8	085191-04-X11	EA	Valance Asm w/Insert - 27 4"
.	073260-23-X08	EA	Tieback Asm - 3" x 18" - Drapery
.	Not illustrated		
***	Parts used on the Woven Woods Option		
†	Parts used after 8/18/87		
††	Parts used after 7/22/87		

WINNEBAGO

PAD & WALL TRIMS

Key	Part Number	U/M	Description
	081519-03-X23	EA	Pad Asm - Dinette - Front (X11)
	081519-03-X24	EA	Pad Asm - Dinette - Front (X12)
	081519-03-X25	EA	Pad Asm - Dinette - Front (X13)
	081519-04-X23	EA	Pad Asm - Dinette - Rear (X11)
	081519-04-X24	EA	Pad Asm - Dinette - Rear (X12)
	081519-04-X25	EA	Pad Asm - Dinette - Rear (X13)
	059414-06-000	EA	Pad Asm - Trim - Sidewall - Right - Vinyl
	059467-04-T03	EA	Pad Asm - Map Pocket - Right Vinyl
	086109-02-X11	EA	Headboard Asm - 26" - Gathered (Twin) (X11)
	086109-02-X12	EA	Headboard Asm - 26" - Gathered (Twin) (X12)
	086109-02-X13	EA	Headboard Asm - 26" - Gathered (Twin) (X13)
†	086109-02-XA0	EA	Headboard Asm - 26" - Gathered (Twin) (X11)
.	086109-02-XA1	EA	Headboard Asm - 26" - Gathered (Twin) (X12)
**	086109-02-XA2	EA	Headboard Asm - 26" - Gathered (Twin) (X13)
	086109-03-X08	EA	Headboard Asm - 44" - Gathered (Double/Queen) (X11)
	086109-03-X09	EA	Headboard Asm - 44" - Gathered (Double/Queen) (X12)
	086109-03-X10	EA	Headboard Asm - 44" - Gathered (Double/Queen) (X13)
†	086109-03-XA0	EA	Headboard Asm - 44" - Gathered (Double/Queen) (X11)
.	086109-03-XA1	EA	Headboard Asm - 44" - Gathered (Double/Queen) (X12)
**	086109-03-XA2	EA	Headboard Asm - 44" - Gathered (Double/Queen) (X13)
†	Parts used after 2/22/88		
.	Parts used after 1/18/88		
**	Parts used after 1/25/88		

**1988 N-SERIES
TABLE OF CONTENTS**

W/ICN22EC	A-01 - A-22
WCN22RC	A-23 - B-14
W/ICN27RT	B-15 - C-18
W/ICN27RU	C-19 - D-20
W/ICN31RT & W/IJN31RT	D-21 - E-18
W/ICN33RU	E-19 - F-16

**1988 W/ICN31RT & W/IJN31RT
INDEX**

Floor Plan	D-21 - D-22
Bath Group	D-23
Curtain, Cushion & Pad Group	D-24 - E-06
Dinette Group	E-07 - E-08
Exterior Body Group	E-09 - E-13
Galley Group	E-14
Lounge Group	E-15 - E-16
Window Vent & Exterior Door Group	E-17 - E-18

CURTAIN, CUSHION & PAD GROUP (CONTINUED)

ITASCA

PADS & WALL TRIMS

Key	Part Number	U/M	Description
	081519-01-X08	EA	Pad Asm - Dinette - Front (X36)
	081519-01-X09	EA	Pad Asm - Dinette - Front (X37)
	081519-01-W05	EA	Pad Asm - Dinette - Front (X38)
	081519-02-X08	EA	Pad Asm - Dinette - Front (X36)
	081519-02-X09	EA	Pad Asm - Dinette - Front (X37)
	081519-02-W05	EA	Pad Asm - Dinette - Front (X38)
	059414-06-000	EA	Pad Asm - Trim - Sidewall - Right - Vinyl
	059467-04-T03	EA	Pad Asm - Map Pocket - Right Vinyl
	077463-08-X36	EA	Headboard Asm - Twin
	077463-08-X37	EA	Headboard Asm - Twin
	077463-08-X38	EA	Headboard Asm - Twin
	077463-16-X33	EA	Headboard Asm - Queen (X36)
	077463-16-X34	EA	Headboard Asm - Queen (X37)
	077463-16-X35	EA	Headboard Asm - Queen (X38)

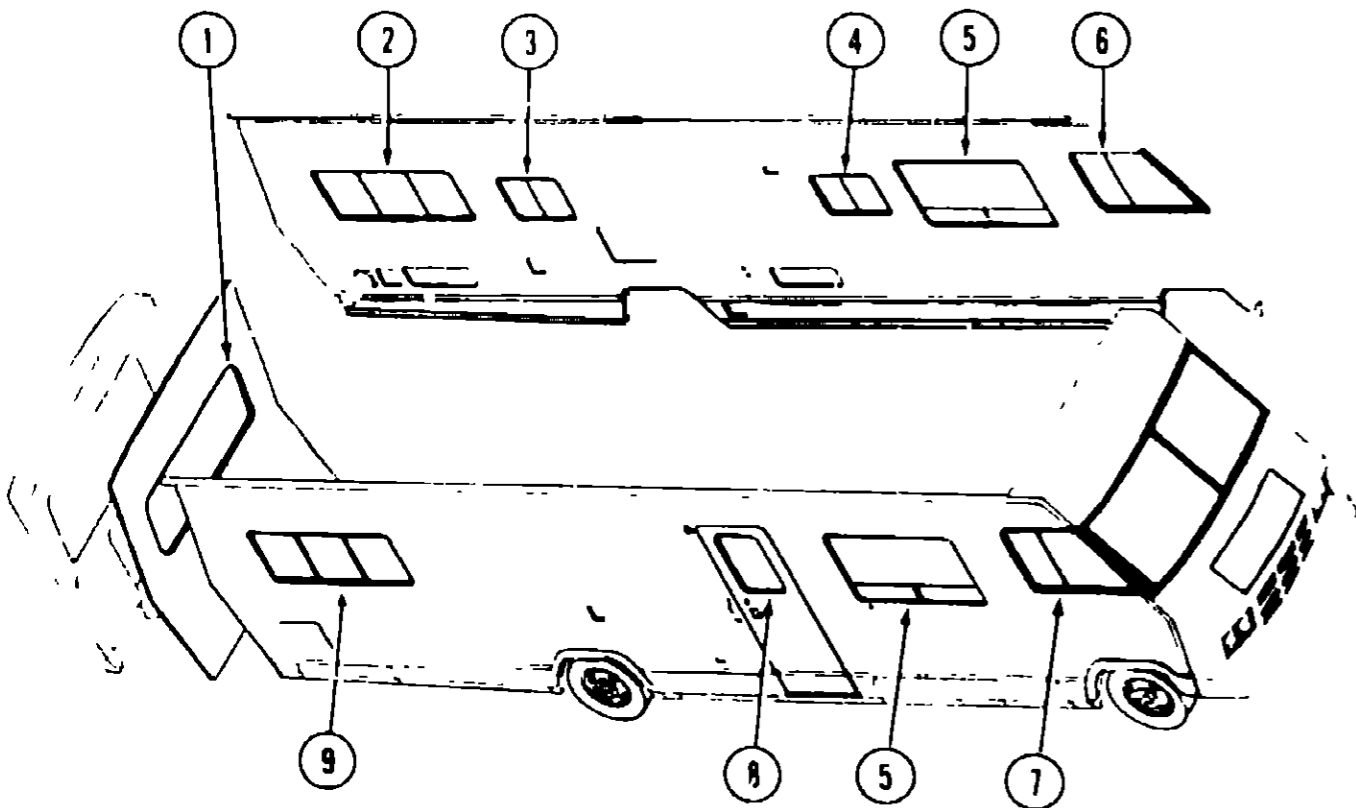

CURTAIN, CUSHION & PAD GROUP (CONTINUED)

ITASCA X36

CURTAINS, SHADES, VALANCES & TIEBACKS

Key	Part Number	U/M	Description
1	084755-15-X36	EA	Shade Asm - Linen - 53 25"
**1	084755-15-XA3	EA	Shade Asm - Linen - 53 25"
**1	084755-15-XA6	EA	Shade Asm - Linen - 53 25"
1	079558-20-X36	EA	Valance Asm - Gathered - 5' x 140
1	079559-11-X33	EA	Curtain Asm - Gathered - 32' x 41'
2	084755-16-X36	EA	Shade Asm - Linen - 69 25'
**2	084755-16-XA3	EA	Shade Asm - Linen - 69 25'
**2	084755-16-XA6	EA	Shade Asm - Linen - 69 25'
2	079558-21-X36	EA	Valance Asm - Gathered - 5' x 120
2	079559-11-X33	EA	Curtain Asm - Gathered - 32' x 41'
3	082118-B9-000	EA	Blind - 32' x 26' Drop
3	M81977-24-X36	EA	Valance Asm - Padded - 35 5'
3	073304-39-X36	EA	Curtain Asm w/Snap Top - 27 5" x 10'
4	082118-B0-000	EA	Blind - 27" x 22" Drop
4	M81977-22-X36	EA	Valance Asm - Padded - 29 5'
5	082118-C8-000	EA	Blind - 65' x 33" Drop
5	M81977-23-X36	EA	Valance Asm - Padded - 68 5"
5	087318-07-X36	EA	Curtain Asm w/Snap Top - 33 5" x 15"
6	073304-41-X20	EA	Curtain Asm - Front Wraparound - 32 5" x 86"
†6	073304-49-X33	EA	Curtain Asm - Front Wraparound - 34" x 86'
6	077591-06-X36	EA	Curtain Asm - Front Bunk - 60" x 50'
†6	077591-10-X36	EA	Curtain Asm - Front Bunk - 60' x 47 5'
7	073304-40-X20	EA	Curtain Asm - Front Wraparound - 32 5' x 86"
†7	073304-49-X33	EA	Curtain Asm - Front Wraparound - 34' x 86'
7	077591-05-X36	EA	Curtain Asm - Front Bunk - 60' x 50'
†7	077591-09-X36	EA	Curtain Asm - Front Bunk - 60' x 47 5'
8	084755-04-X33	EA	Shade Asm - Linen - 24 25'
**8	084755-04-XA3	EA	Shade Asm - Linen - 24 25'
**8	084755-04-XA6	EA	Shade Asm - Linen - 24 25'
8	M81977-26-X36	EA	Valance Asm - Padded - 27 4'
.	073260-23-WB6	EA	Tieback Asm - 3" x 18 - Drapery
.	073260-27-X78	EA	Tieback Asm - 3" x 23 - Bedspread
.	073260-34-X33	EA	Tieback Asm - 3' x 20' - Drapery
.	073260-34-XB3	EA	Tieback Asm - 4' x 20' - Drapery
.			Not illustrated
†			Parts used after 7/22/87
††			Parts used after 8/19/87
**			Parts used after 12/1/87
*†			Parts used after 3/1/88

**1988 N-SERIES
TABLE OF CONTENTS**

W/ICN22EC	A-01 - A-22
WCN22RC	A-23 - B-14
W/ICN27RT	B-15 - C-18
W/ICN27RU	C-19 - D-20
W/ICN31RT & W/IJN31RT	D-21 - E-18
W/ICN33RU	E-19 - F-18

**1988 W/ICN31RT & W/IJN31RT
INDEX**

Floor Plan	D-21 - D-22
Bath Group	D-23
Curtain, Cushion & Pad Group	D-24 - E-08
Dinette Group	E-07 - E-08
Exterior Body Group	E-09 - E-13
Galley Group	E-14
Lounge Group	E-15 - E-18
Window, Vent & Exterior Door Group	E-17 - E-18

CURTAIN, CUSHION & PAD GROUP (CONTINUED)

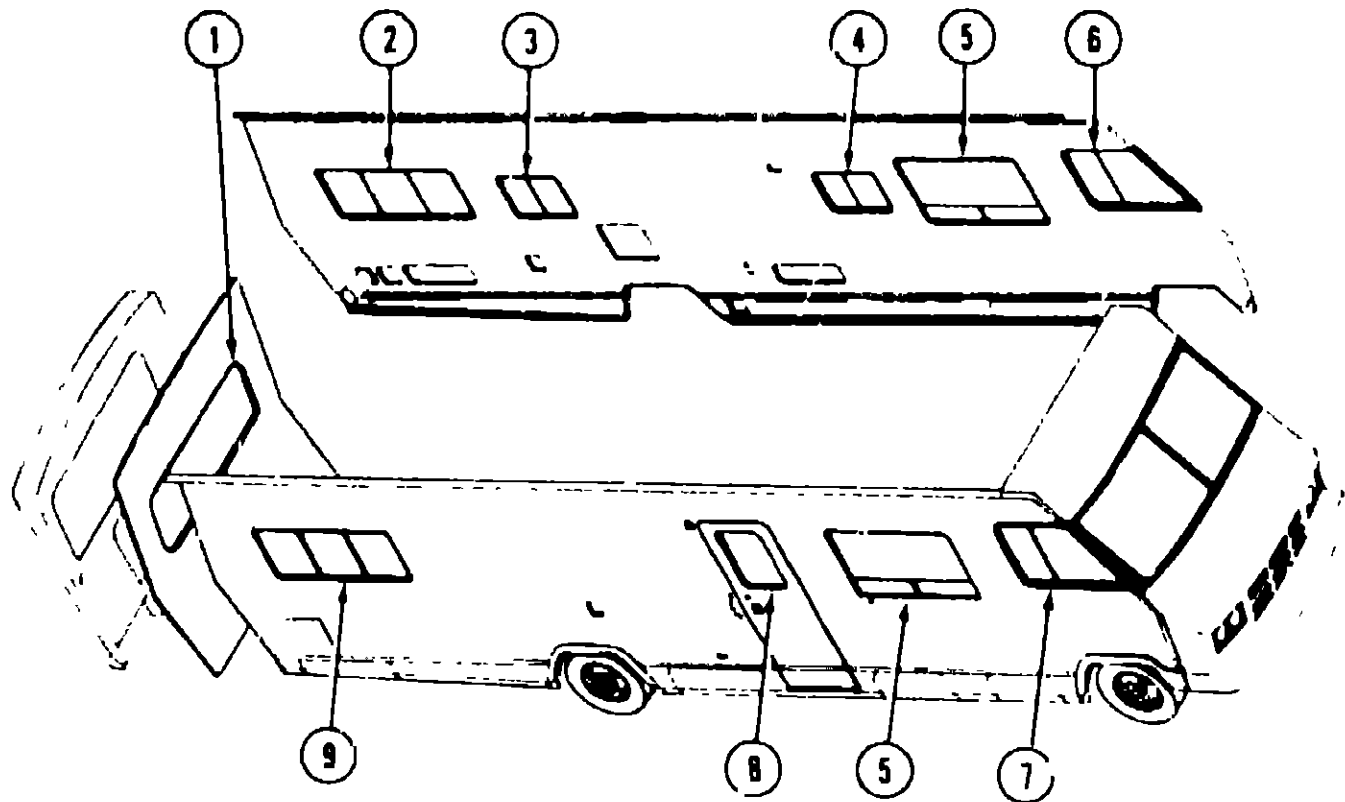

ITASCA XJ7

CURTAINS, SHADES, VALANCES & TIEBACKS

Key	Part Number	U/M	Description
1	084755-15-X37	EA	Shade Asm - Linen - 53 25"
**1	084755-15-XA3	EA	Shade Asm - Linen - 53 25"
†1	084755-15-XA6	EA	Shade Asm - Linen - 53 25"
1	079558-20-X37	EA	Valance Asm - Gathered - 5' x 140"
1	079559-11-X34	EA	Curtain Asm - Gathered - 32" x 41"
2	084755-16-X37	EA	Shade Asm - Linen - 69 25"
**2	084755-16-XA3	EA	Shade Asm - Linen - 69 25"
†2	084755-16-XA6	EA	Shade Asm - Linen - 69 25"
2	079558-21-X37	EA	Valance Asm - Gathered - 5' x 120"
2	079559-11-X34	EA	Curtain Asm - Gathered - 32" x 41"
3	088729-02-000	EA	Blind - 32" x 26" Drop
3	M81977-24-X37	EA	Valance Asm - Padded - 35 5'
†3	M81977-24-XA4	EA	Valance Asm - Padded - 35 5'
3	073304-39-X37	EA	Curtain Asm w/Snap Top - 27 5" x 10'
†	073304-39-XA4	EA	Curtain Asm w/Snap Top - 27 5" x 10'
4	088729-03-000	EA	Blind - 27" x 22" Drop
4	M81977-22-X37	EA	Valance Asm - Padded - 29 5"
†4	M81977-22-XA4	EA	Valance Asm - Padded - 29 5"
5	088729-01-000	EA	Blind - 65" x 33" Drop
5	M81977-23-X37	EA	Valance Asm - Padded - 68 5"
†5	M81977-23-XA4	EA	Valance Asm - Padded - 68 5"
5	087318-07-X37	EA	Curtain Asm w/Snap Top - 33 5" x 15"
†5	087318-07-XA4	EA	Curtain Asm w/Snap Top - 33 5" x 15"
6	073304-41-X37	EA	Curtain Asm - Front Wraparound - 32 5" x 86"
†6	073304-49-X34	EA	Curtain Asm - Front Wraparound - 34" x 86"
†6	073304-49-XA4	EA	Curtain Asm - Front Wraparound - 34" x 86"
6	077591-06-X37	EA	Curtain Asm - Front Bunk - 60" x 50"
†6	077591-10-X37	EA	Curtain Asm - Front Bunk - 60" x 47 5"
†6	077591-10-XA4	EA	Curtain Asm - Front Bunk - 60" x 47 5"
7	073304-40-X37	EA	Curtain Asm - Front Wraparound - 32 5" x 86"
†7	073304-49-X34	EA	Curtain Asm - Front Wraparound - 34" x 86"
†7	073304-49-XA4	EA	Curtain Asm - Front Wraparound - 34" x 86"
7	077591-05-X37	EA	Curtain Asm - Front Bunk - 60" x 50"
†7	077591-09-X37	EA	Curtain Asm - Front Bunk - 60" x 47 5"
†7	077591-09-XA4	EA	Curtain Asm - Front Bunk - 60" x 47 5"

CURTAIN, CUSHION & PAD GROUP (CONTINUED)

ITASCA X37

CURTAINS, SHADES, VALANCES & TIEBACKS (CONT.)

Key	Part Number	U/M	Description
8	084755-04-X34	EA	Shade Asm - Linen - 24 25"
**8	084755-04-XA3	EA	Shade Asm - Linen - 24 25"
†8	084755-04-XA6	EA	Shade Asm - Linen - 24 25"
8	M81977-26-X37	EA	Valance Asm - Padded - 27 4"
†8	M81977-26-XA4	EA	Valance Asm - Padded - 27 4"
.	073260-23-X34	EA	Tieback Asm - 3' x 18" - Drapery
†	073260-23-XA4	EA	Tieback Asm - 3' x 18" - Drapery
.	073260-27 X79	EA	Tieback Asm - 3" x 23 - Bedspread
.	073260-34-X34	EA	Tieback Asm - 3" x 23' - Bedspread
†	073260-34-XB4	EA	Tieback Asm - 3" x 20' - Drapery
**	073260-34-XA4	EA	Tieback Asm - 4" x 20" - Drapery
.	Not illustrated		
†	Parts used after 7/22/87		
††	Parts used after 8/19/87		
††	Parts used after 10/1/87		
**	Parts used after 12/1/87		
†	Parts used after 3/1/88		

ITASCA X38

CURTAINS, SHADES, VALANCES & TIEBACKS

Key	Part Number	U/M	Description
1	084755-15-X38	EA	Shade Asm - Linen - 53 25"
†1	084755-15-XA8	EA	Shade Asm - Linen - 53 25"
1	079558-20-X38	EA	Valance Asm - Gathered - 5" x 140"
1	079559-11-X35	EA	Curtain Asm - Gathered - 32" x 41"
2	084755-16-X38	EA	Shade Asm - Linen - 69 25"
†2	084755-16-XA8	EA	Shade Asm - Linen - 69 25"
2	079558-21-X38	EA	Valance Asm - Gathered - 5' x 120"
2	079559-11-X35	EA	Curtain Asm - Gathered - 32" x 41"
3	082118-B8-000	EA	Blind - 32" x 26" Drop
3	M81977-24-X38	EA	Valance Asm - Padded - 35 5"
3	073304-39-X38	EA	Curtain Asm - w/Snap Top - 27 5" x 10'
4	082118 A9-000	EA	Blind - 27" x 22" Drop
4	M81977-22-X38	EA	Valance Asm - Padded - 29 5"
5	082118-C7-000	EA	Blind - 65" x 33" Drop
5	M81977-23-X38	EA	Valance Asm - Padded - 68 5"
5	087318-07-X38	EA	Curtain Asm w/Snap Top - 33 5" x 15"
6	073304-41-X19	EA	Curtain Asm - Front Wraparound - 32 5" x 86"
†6	073304-49-X35	EA	Curtain Asm - Front Wraparound - 34" x 86"
6	077591-06-X38	EA	Curtain Asm - Front Bunk - 60" x 50"
†6	077591-10-X38	EA	Curtain Asm - Front Bunk - 60" x 47 5"
7	073304-40-X19	EA	Curtain Asm - Front Wraparound - 32 5" x 86"
†7	073304-49-X35	EA	Curtain Asm - Front Wraparound - 34" x 86"
7	077591-05-X38	EA	Curtain Asm - Front Bunk - 60" x 50"
†7	077591-09-X38	EA	Curtain Asm - Front Bunk - 60" x 47 5"
8	084755-04-X35	EA	Shade Asm - Linen - 24 25"
†8	084755-04-XA8	EA	Shade Asm - Linen - 24 25"
8	M81977-26-X38	EA	Valance Asm - Padded - 27 4"
.	073260-23-X19	EA	Tieback Asm - 3" x 18 - Drapery
.	073260-27-X80	EA	Tieback Asm - 3' x 23' - Bedspread
.	073260-34-X35	EA	Tieback Asm - 3' x 20' - Drapery
.	Not illustrated		
†	Parts used after 7/22/87		
††	Parts used after 8/19/87		
**	Parts used after 12/1/87		
†	Parts used after 3/1/88		

**1988 N-SERIES
TABLE OF CONTENTS**

W/ICN22EC	A-01 - A-22
WCN22RC	A-23 - B-14
W/ICN27RT	B-15 - C-18
W/ICN27RU	C-19 - D-20
W/ICN31RT & W/IJN31RT	D-21 - E-18
W/ICN33RU	E-19 - F-16

**1988 W/ICN31RT & W/IJN31RT
INDEX**

Floor Plan	D-21 - D-22
Bath Group	D-23
Curtain, Cushion & Pad Group	D-24 - E-06
Dinette Group	E-07 - E-08
Exterior Body Group	E-09 - E-13
Galley Group	E-14
Lounge Group	E-15 - E-16
Window Vent & Exterior Door Group	E-17 - E-18

DINETTE GROUP

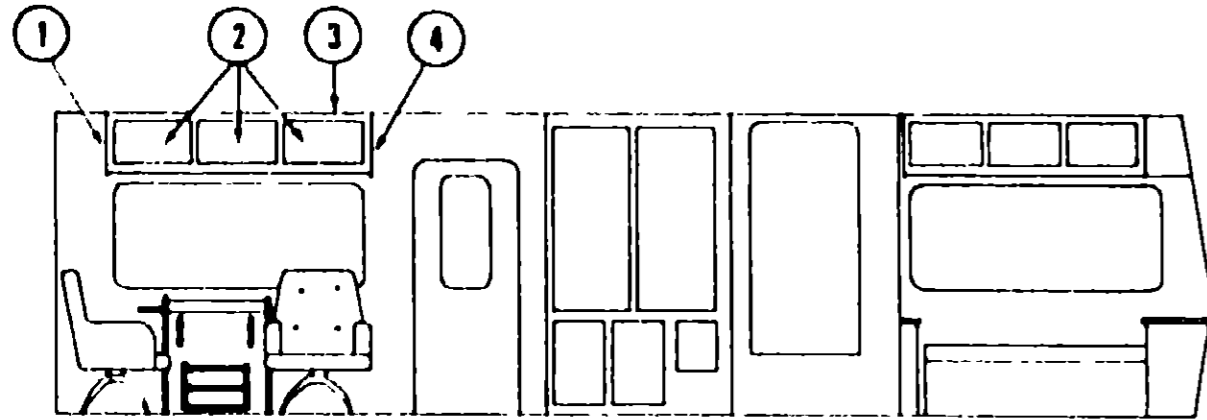

SWIVEL CHAIR DINETTE & OVERHEAD CABINETS

Key	Part Number	U/M	Description
1	081325-02-W30	EA	Pad Asm - End Cap - Front Overhead - Left - Vinyl
2	M88304-16-X23	EA	Door Asm - Overhead Cabinet - w/o Hardware
3	M81550-04-X11	EA	Cabinet Asm - Front Overhead - Passenger - w/o Doors or Hardware
*	M81550-06-X11	EA	Cabinet Asm - Front Overhead - Driver - w/o Doors or Hardware
4	081325-01-W30	EA	Pad Asm - End Cap - Front Overhead - Right - Vinyl
*	M81727-02-X19	EA	Cabinet Asm - Pullout Table
*	M02415-01-X19	EA	Table Asm - Pullout
*	M02416-01-X19	EA	Countertop Asm - Pullout Table
*	M02414-01-X19	EA	Top - Cupholder - Pullout Table
*	M02417-01-X19	EA	Hinged Top - Pullout Table - w/o Hardware
*	079606-03-W30	EA	Magazine Rack
*	080728-01-000	EA	Handle - Pullout Table
*	035036-01-000	EA	Plate - Tilt & Swivel
*	035036-04-000	EA	Base w/Leg - Swivel Chair
*	035036-06-000	EA	Extension - 7' - Swivel Chair
*	081298-01-X11	EA	Table Asm - Pedestal
*	009040-03-000	EA	Base - Table - Mount on Table
*	009040-04-000	EA	Leg - Pedestal Table
*	062046-01-000	EA	Clip - Pedestal Leg
*	041194-01-000	EA	Base - Table - Flush Mount in Floor
*	Not illustrated		

DINETTE GROUP (CONTINUED)

DINETTE CABINETS & HARDWARE (OPTION)

Key	Part Number	U/M	Description
	M02174-02-W84	EA	Cabinet Asm - Dinette Back - Right
	M02174-03-W84	EA	Cabinet Asm - Dinette Back - Left
	M02175-01-W30	EA	Cabinet Asm - Dinette Seat - Right w/o Door
	M02175-04-W24	EA	Cabinet Asm - Dinette Seat - Left - w/o Door
	M81299-01-W24	EA	Table - Dinette - w/o Hardware
	M88304-21-X08	EA	Door Asm - Left - Dinette Seat - 10' x 19' - w/o Hardware
	M88304-73-X11	EA	Door Asm - Right - Dinette Seat - 10' x 25' - w/o Hardware
	088410-01-000	EA	Hanger - Table - 23' - Beige
	074493-02-000	EA	Support - Sprung Door Asm - Overhead Cabinet
	053200-05-000	EA	Bracket - Upper Wall Mount - 23.5' - Beige
	053201-06-000	EA	Bracket - Table Mount - 23
	024275-05-000	EA	Rod - Table Lift - 8' x 23.5' - Beige
	024281-07-000	EA	Bracket - Lower Wall Mount - 22.12' - Beige
	024276-17-000	EA	Leg Asm - Table - 26.75' - Tan
	064050-02-000	EA	Hinge - Table Leg
**	024282-01-000	EA	Brace - Table Leg
**	024283-01-000	EA	Clip - 1" O D Tube
	049493-05-000	EA	Catch - Table Leg - Mounts on Floor - Tan
	064781-01-000	EA	Cup Holder - 3.47" O D x 2.75" I D x 1.5"
**	The illustrated parts breakdown for this item is provided on the Common Items Fiche		

1988 N-SERIES TABLE OF CONTENTS

W/ICN22EC	A-01 - A-22
WCN22RC	A-23 - B-14
W/ICN27RT	B-15 - C-18
W/ICN27RU	C-19 - D-20
W/ICN31RT & W/IJN31RT	D-21 - E-18
W/ICN33RU	E-19 - F-18

1988 W/ICN31RT & W/IJN31RT INDEX

Floor Plan	D-21 - D-22
Bath Group	D-23
Curtain Cushion & Pad Group	D-24 - E-06
Dinette Group	E-07 - E-08
Exterior Body Group	E-09 - E-13
Galley Group	E-14
Lounge Group	E-15 - E-16
Window Vent & Exterior Door Group	E-17 - E-18

EXTERIOR BODY GROUP

WINNEBAGO

EXTERIOR BODY PANELS

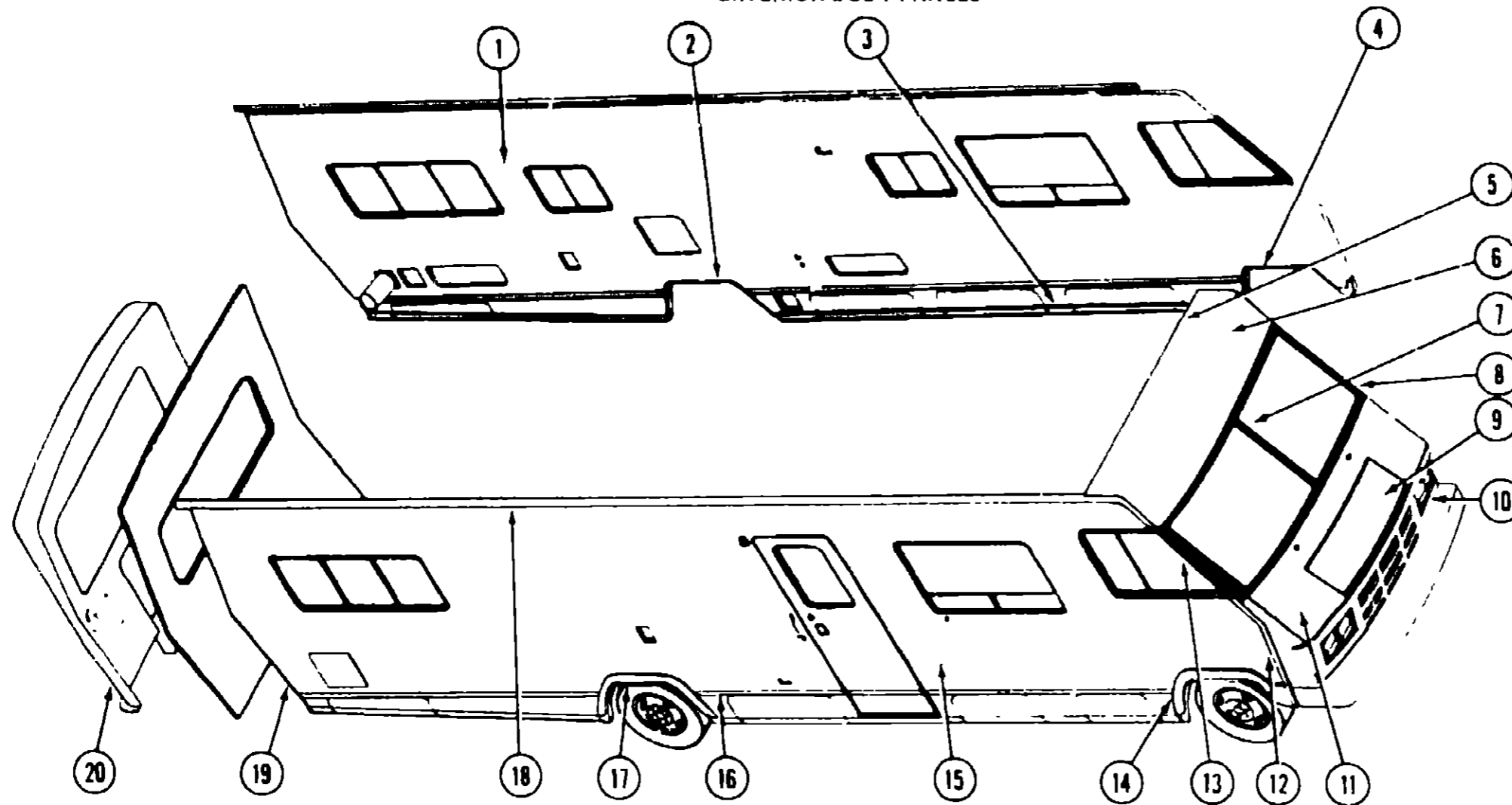

Key	Part Number	U/M	Description
1	M88714-01-X11	EA	Sidewall Asm - Left
1	M88714-01-X12	EA	Sidewall Asm - Left
1	M88714-01-X13	EA	Sidewall Asm - Left
2	058487-07-000	EA	Trim - Wheel Well - Rear - U Channel - Driver or Passenger
•	075070-03-000	EA	Trim - Wheel Well - Rear - Plastic - Driver
3	072639-05-001	EA	Extr - Rocker Panel - 216
4	073647-02-000	EA	Trim - Wheel Well - Front - U Channel - Driver or Passenger
•	078556-08-000	EA	Trim - Wheel Well - Front - Plastic - Driver
5	078580-01-000	EA	Trim - Roof/Front Cap
6	M02959-01-W07	EA	Cap - Over Windshield - Gray
7	083178-01-000	EA	Trim - Molding - Windshield - Center
8	087601-02-000	EA	Trim - Contour - Windshield - Driver
•	084903-01-000	EA	Trim - Molding - Windshield - Upper
•	084897-02-000	EA	Cap - Reveal Molding
•	086425-06-000	EA	Headlamp Bezel - Driver
9	M86045-01-W07	EA	Access Panel - w/Hardware
10	086425-05-000	EA	Headlamp Bezel - Passenger
•	049359-01-000	EA	Spring - Headlamp Retainer
•	062207-01-000	EA	Headlamp Guard
11	M01115-12-W07	EA	Panel Asm - Front Shroud (includes access panel)
12	086414-01-000	EA	Trim - Fiberglass Panel - Passenger - Beige
12	086414-03-000	EA	Trim - Fiberglass Panel - Driver - Beige

Key	Part Number	U/M	Description
13	087601-01-000	EA	Trim - Contour - Windshield - Passenger
14	078556-07-000	EA	Trim - Wheelwell - Front - Passenger - Beige
15	M88713-01-X11	EA	Sidewall Asm - Right
15	M88713-01-X12	EA	Sidewall Asm - Right
15	M88713-01-X13	EA	Sidewall Asm - Right
16	059576-08-000	EA	Feature Strip - Extr - 14' - w/o Insert
•	009731-01-000	EA	End Cap - Feature Strip Insert
•	001030-12-001	EA	Insert - Feature Strip - 17
17	075070 01-000	EA	Trim - Wheelwell - Rear - Passenger - Beige
18	078600-13-000	EA	Trim - Sidewall - Upper - Driver or Passenger - Beige
19	073502-23 000	EA	Trim - Passenger - Rear - Beige
•	073502-24-000	EA	Trim - Driver Rear - Beige
•	089502-01-X11	EA	Roof Asm
20	M01893-05-W07	EA	Backwall Cap Asm - Beige
20	081687-01-W07	EA	Backwall Asm
•	050406-13-000	EA	Trim - Backwall - Lower - Mill Finish
•	086415-01-000	EA	Bumper End Cap - Front Passenger Hand - Beige
•	086415-03-000	EA	Bumper End Cap - Front Driver Hand - Beige
•	078578-01-000	EA	Bumper End Cap - Rear Passenger - Beige
•	078578-02-000	EA	Bumper End Cap - Rear Driver - Beige
•	Not illustrated		

1988 N-SERIES TABLE OF CONTENTS

W/ICN22EC	A-01 - A-22
WCN22RC	A-23 - B-14
W/ICN27RT	B-15 - C-18
W/ICN27RU	C-19 - D-20
W/ICN31RT & W/IJN31RT	D-21 - E-18
W/ICN33RU	E-19 - F-16

1988 W/ICN31RT & W/IJN31RT INDEX

Floor Plan	D-21 - D-22
Bath Group	D-23
Curtain, Cushion & Pad Group	D-24 - E-08
Dinette Group	E-07 - E-08
Exterior Body Group	E-09 - E-13
Galley Group	E-14
Lounge Group	E-15 - E-16
Window Vent & Exterior Door Group	E-17 - E-18

EXTERIOR BODY GROUP (CONTINUED)

ITASCA

EXTERIOR BODY PANELS

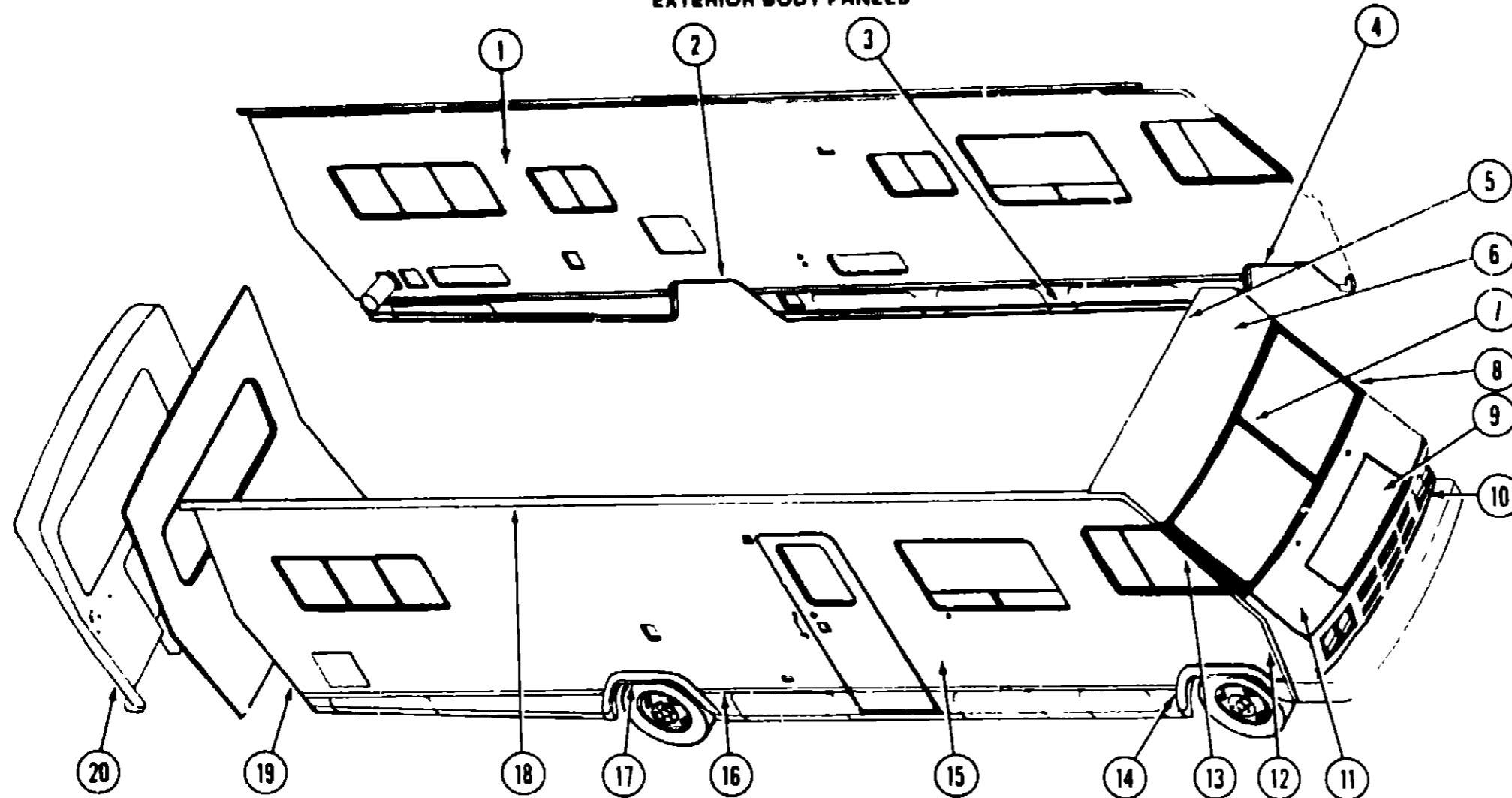

Key	Part Number	U/M	Description
1	M88716-01-X36	EA	Sidewall Asm - Left
1	M88716-01-X37	EA	Sidewall Asm - Left
1	M88716-01-X38	EA	Sidewall Asm - Left
2	058487-07-000	EA	Trim - Wheel Well - Rear - U Channel - Driver or Passenger
	075070-04-000	EA	Trim - Wheel Well - Rear - Plastic - Driver
3	072639-01-001	EA	Extr - Rocker Panel - 216'
4	073647-02-000	EA	Trim - Wheel Well - Front - U Channel - Driver or Passenger
	078556-06-000	EA	Trim - Wheel Well - Front - Plastic - Driver
5	078580-01-000	EA	Trim - Roof/Front Cap
6	M01899-01-T09	EA	Cap - Over Windshield - Gray
7	076676-02-000	EA	Trim - Molding - Windshield - Center
	077952-02-000	EA	Cap - Reveal Molding
8	079225-02-000	EA	Trim - Contour - Windshield - Driver
	077944-02-000	EA	Reveal Molding - Windshield - Upper - Driver
	077945-02-000	EA	Reveal Molding - Windshield - Lower - Driver
	076910-02-000	EA	Headlamp Bezel - Driver
9	078281-01-T09	EA	Access Panel - w/Hardware
10	076910-01-000	EA	Headlamp Bezel - Passenger
	049359-01-000	EA	Spring - Headlamp Retainer
	062207-01-000	EA	Headlamp Guard
11	M01115-11-T09	EA	Panel Asm - Front Shroud (includes access panel)
12	086414-02-000	EA	Trim - Fiberglass Panel - Passenger - Gray
12	086414-04-000	EA	Trim - Fiberglass Panel - Driver - Gray
13	075225-01-000	EA	Trim - Contour - Windshield - Passenger
	077944-01-000	EA	Reveal Molding - Windshield - Upper - Passenger
	077945-01-000	EA	Reveal Molding - Windshield - Lower - Passenger
14	078556-05-000	EA	Trim - Wheelwell - Front - Passenger - Gray

Key	Part Number	U/M	Description
15	M88715-01-X36	EA	Sidewall Asm - Right
15	M88715-01-X37	EA	Sidewall Asm - Right
15	M88715-01-X38	EA	Sidewall Asm - Right
16	059576-11-000	EA	Feature Strip - Extr - Gray - 14 - w/o Insert
	009731-01-000	EA	End Cap - Feature Strip Insert
	001030-11-001	EA	Insert - Feature Strip - Gray - 17
17	075070-02-000	EA	Trim - Wheelwell - Rear - Passenger - Gray
18	078600-14-000	EA	Trim - Sidewall - Upper - Driver or Passenger - Gray
19	073502-11-000	EA	Trim - Passenger - Rear - Gray
	073502-12-000	EA	Trim - Driver Rear - Gray
	089502-02-X36	EA	Roof Asm
20	M01898-05-T09	EA	Backwall Cap Asm - Gray
20	081687-01-X36	EA	Backwall Asm
	078577-05-000	EA	Bumper End Cap - Front Passenger Hand - Gray
	078577-06-000	EA	Bumper End Cap - Front Driver Hand - Gray
	078578-07-000	EA	Bumper End Cap - Rear Passenger - Gray
	078578-08-000	EA	Bumper End Cap - Rear Driver - Gray
			Not illustrated

1988 N-SERIES TABLE OF CONTENTS

W/ICN22EC	A-01 - A-22
WCN22RC	A-23 - B-14
W/ICN27RT	B-15 - C-18
W/ILN27RU	C-19 - D-20
W/ICN31RT & W/IJN31RT	D-21 - E-18
W/ICN33RU	E-19 - F-16

1988 W/ICN31RT & W/IJN31RT INDEX

Floor Plan	D-21 - D-22
Bath Group	D-23
Curtain Cushion & Pad Group	D-24 - E-06
Dinette Group	E-07 - E-08
Exterior Body Group	E-09 - E-13
Galley Group	E-14
Lounge Group	E-15 - E-16
Window Vent & Exterior Door Group	E-17 - E-18

EXTERIOR BODY GROUP (CONTINUED)

WINNEBAGO

ACCESS PANEL HARDWARE

Key	Part Number	U/M	Description
	076837-01-000	EA	Rod - Hood Prop
	062628-01-000	EA	Clip - Prop Rod
	085934-01-000	EA	Hinge - Access Panel - Passenger
	085934-02-000	EA	Hinge - Access Panel - Drivers
	085360-02-000	EA	Bracket - Hinge Asm - Hood - Drivers
	085360-01-000	EA	Bracket - Hinge Asm - Hood - Passenger
	077064-01-000	EA	Cable Asm - Hood Release (Access Panel)
	074178-01-000	EA	Bracket - Cable Release - Inside
	R77007-01-950	EA	Striker - Hood Latch
	079286-01-000	EA	Latch - Hood
	R77006 38-499	EA	Spring
	R77006 19-765	EA	Cable Sheath
	073341-01-000	EA	Bracket - Hood Latch

ITASCA

ACCESS PANEL HARDWARE

Key	Part Number	U/M	Description
	072917-01-000	EA	Rod - Hood Prop
	062628-01-000	EA	Clip - Prop Rod
	058833-01-000	EA	Bracket - Prop Rod
	073340-01-000	EA	Hinge - Access Panel - Passenger
	073340-02-000	EA	Hinge - Access Panel - Drivers
	058960-01-000	EA	Bracket - Hinge Asm - Hood - Drivers
	058960-02-000	EA	Bracket - Hinge Asm - Hood - Passenger
	R77006-68-721	EA	Cable Asm - Hood Release (Access Panel)
	074178-01-000	EA	Bracket - Cable Release - Inside
	R77007-01-950	EA	Striker - Hood Latch
	R77006-59-931	EA	Latch - Hood
	R77006-38-499	EA	Spring
	R77006-19-765	EA	Cable Sheath
	073341-01-000	EA	Bracket - Hood Latch

GALLEY GROUP

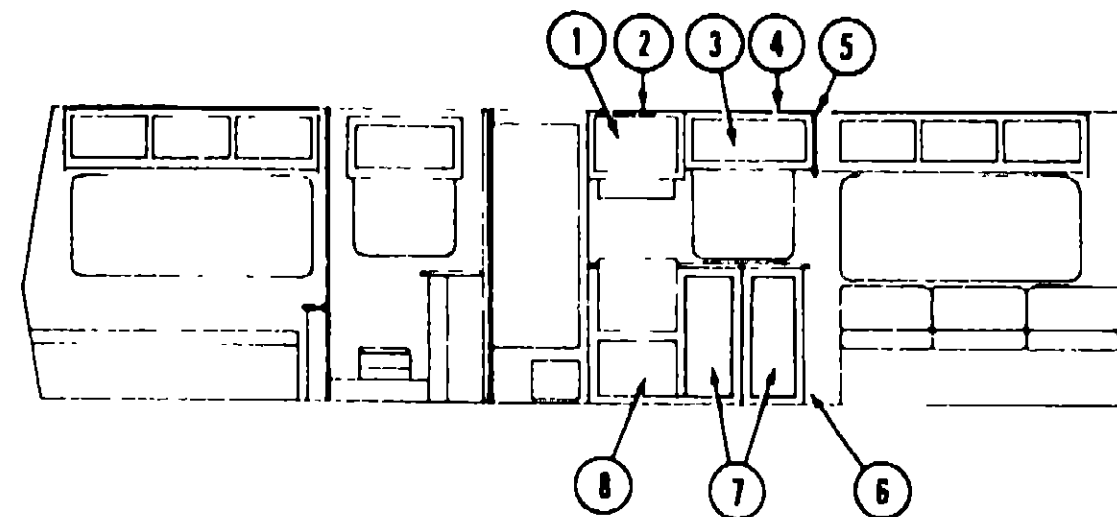

GALLEY CABINETRY

Key	Part Number	U/M	Description
1	M88304-12-X08	EA	Door Asm - Galley Overhead - 18 1' x 27 9" - w/o Hardware
2	088307-02-X14	EA	Cabinet Asm - Galley Overhead - w/o Doors or Hardware (Microwave)
3	M88304-11-X11	EA	Door Asm Galley Overhead - 15 7' x 27 9 - w/o Hardware
4	M81656-03-X11	EA	Cabinet Asm - Galley Overhead - w/o Doors or Hardware
5	081320-03-W30	EA	Pad Asm - End Cap - Galley Overhead - Vinyl
6	M81999-01-X11	EA	Cabinet Asm - Galley - w/o Doors Countertop or Hardware
*	M02193-01-W30	EA	Countertop Asm - Galley Cabinet
*	M81999-03-X11	EA	Cabinet Asm - Galley - w/o Doors Countertop Drawers or Hardware
*	M02193-01-W30	EA	Countertop Asm - Galley Cabinet
**	M82184-10-X11	EA	Drawer Asm - Galley Cabinet
7	M88304-14-X08	EA	Door Asm - Galley - 14 3' x 33 5 - w/o Hardware
8	M92073-04-X11	EA	Door Asm - Furnace - w/o Hardware
*	072369-14-000	EA	Mesh Insert - Furnace Door - 22' x 12 5 - Gold
*	077925-01-000	EA	Rail Asm - Galley - 72
			Not illustrated
**			Used with microwave option

**1988 N-SERIES
TABLE OF CONTENTS**

W/ICN22EC	A-01 - A-22
WCN22RC	A-23 - B-14
W/ICN27RT	B-15 - C-18
W/ICN27RU	C-19 - D-20
W/ICN31RT & W/IJN31RT	D-21 - E-18
W/ICN33RU	E-19 - F-16

**1988 W/ICN31RT & W/IJN31RT
INDEX**

Floor Plan	D-21 - D-22
Bath Group	D-23
Curtain Cushion & Pad Group	D-24 - E-06
Dinette Group	E-07 - E-08
Exterior Body Group	E-09 - E-13
Galley Group	E-14
Lounge Group	E-15 - E-16
Window Vent & Exterior Door Group	E-17 - E-18

LOUNGE GROUP

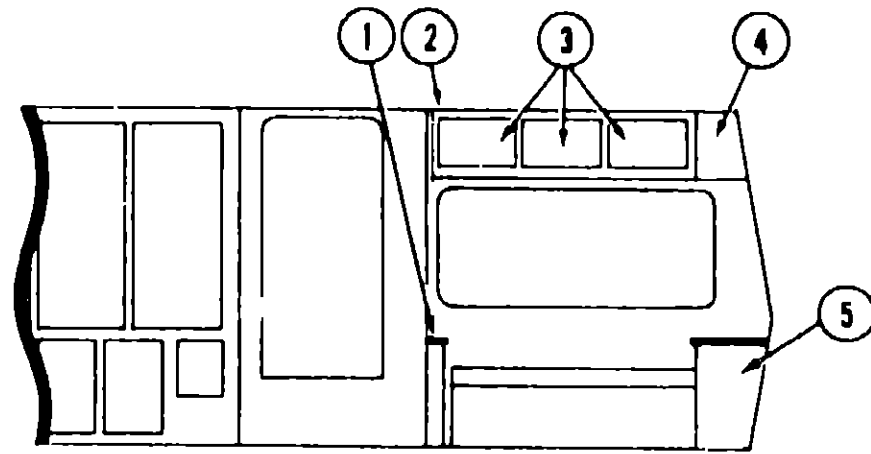

TWIN BED CABINERY

Key	Part Number	U/M	Description
1	081794-01-X11	EA	Cabinet Asm - Nightstand - w/o Countertop or Hardware
1	M02158-01-X11	EA	Countertop Asm - Nightstand - w/o Hardware
•	087882-01-X11	EA	Cabinet Asm - Nightstand - w/o Countertop or Hardware
•	M03000-13-X11	EA	Countertop Asm - Nightstand - w/o Hardware
2	081970-03-X11	EA	Cabinet Asm - Lounge Overhead - Passenger - w/o Doors or Hardware
•	081970-01-X11	EA	Cabinet Asm - Lounge Overhead - Driver - w/o Doors or Hardware
3	M88304-16-X23	EA	Door Asm - Overhead Cabinets - 12' x 21 9' - w/o Hardware
4	M81308-09-X11	EA	Cabinet Asm - Rear Overhead - w/o Doors or Hardware
•	M88304-08-X11	EA	Door Asm - Rear Overhead - 12" x 18 7' - w/o Hardware
5	M83441-01-W30	EA	Cabinet Asm - Nightstand - w/o Countertop Door or Hardware
•	M02608-01-W30	EA	Countertop Asm - Nightstand - Lower
•	M02609-01-W30	EA	Countertop Asm - Nightstand - Upper
•	084357-01-W07	EA	T V Stand Asm
•	M88304-02-X23	EA	Door Asm - Twin Bed/Nightstand - 11' x 21 9' - w/o Hardware
•			Not illustrated

LOUNGE GROUP (CONTINUED)

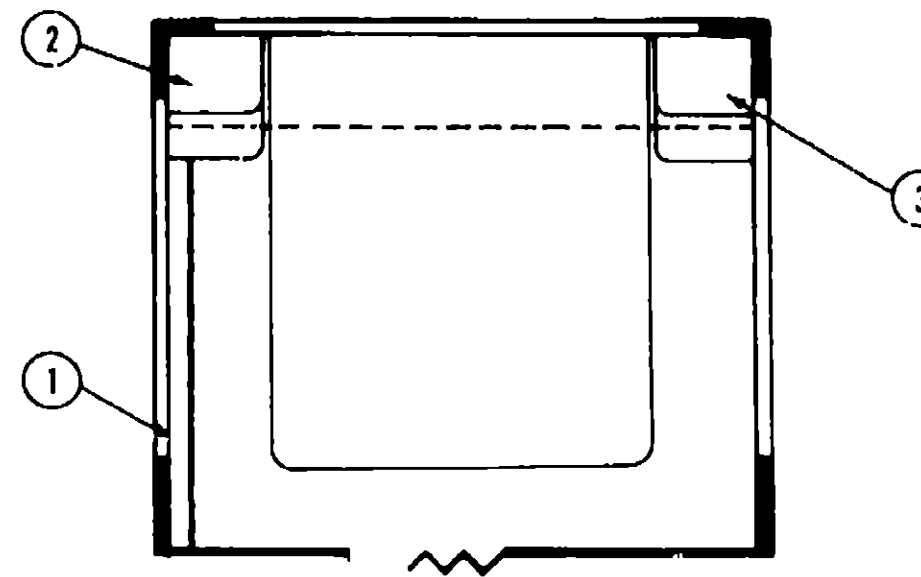

QUEEN BED OPTION

Key	Part Number	U/M	Description
1	081975-01-X11	EA	Cabinet Asm - Pipe Cover - w/o Hardware
2	M81759-01-X11	EA	Cabinet Asm - Nightstand - w/o Countertop Drawer or Hardware
•	M02159-01-X11	EA	Countertop Asm - Nightstand - Lower
•	M02159-02-X11	EA	Countertop Asm - Nightstand - Upper
•	M78921-04-W13	EA	Drawer Asm - Nightstand Cabinets - w/o Hardware
•	M81707-05-X11	EA	Cabinet Asm - Rear Overhead - w/o Doors or Hardware
•	M88304-66-X08	EA	Door Asm - Overhead Cabinet - 11 4" x 28 1" - w/o Hardware
3	M81760-01-X11	EA	Cabinet Asm - Nightstand - w/o Countertop Drawer or Hardware
•	M02160-01-X11	EA	Countertop Asm - Nightstand - Lower
•	M02160-02-X11	EA	Countertop Asm - Nightstand - Upper
•			Not illustrated

**1988 N-SERIES
TABLE OF CONTENTS**

W/ICN22EC	A-01 - A-22
WCN22RC	A-23 - B-14
W/ICN27RT	B-15 - C-18
W/ICN27RU	C-19 - D-20
W/ICN31RT & W/IJN31RT	D-21 - E-18
W/ICN33RU	E-19 - F-16

**1988 W/ICN31RT & W/IJN31RT
INDEX**

Floor Plan	D-21 - D-22
Bath Group	D-23
Curtain, Cushion & Pad Group	D-24 - E-06
Dinette Group	E-07 - E-08
Exterior Body Group	E-09 - E-13
Galley Group	E-14
Lounge Group	E-15 - E-16
Window Vent & Exterior Door Group	E-17 - E-18

WINDOW, VENT & EXTERIOR DOOR GROUP

WINDOWS & ACCESS DOORS

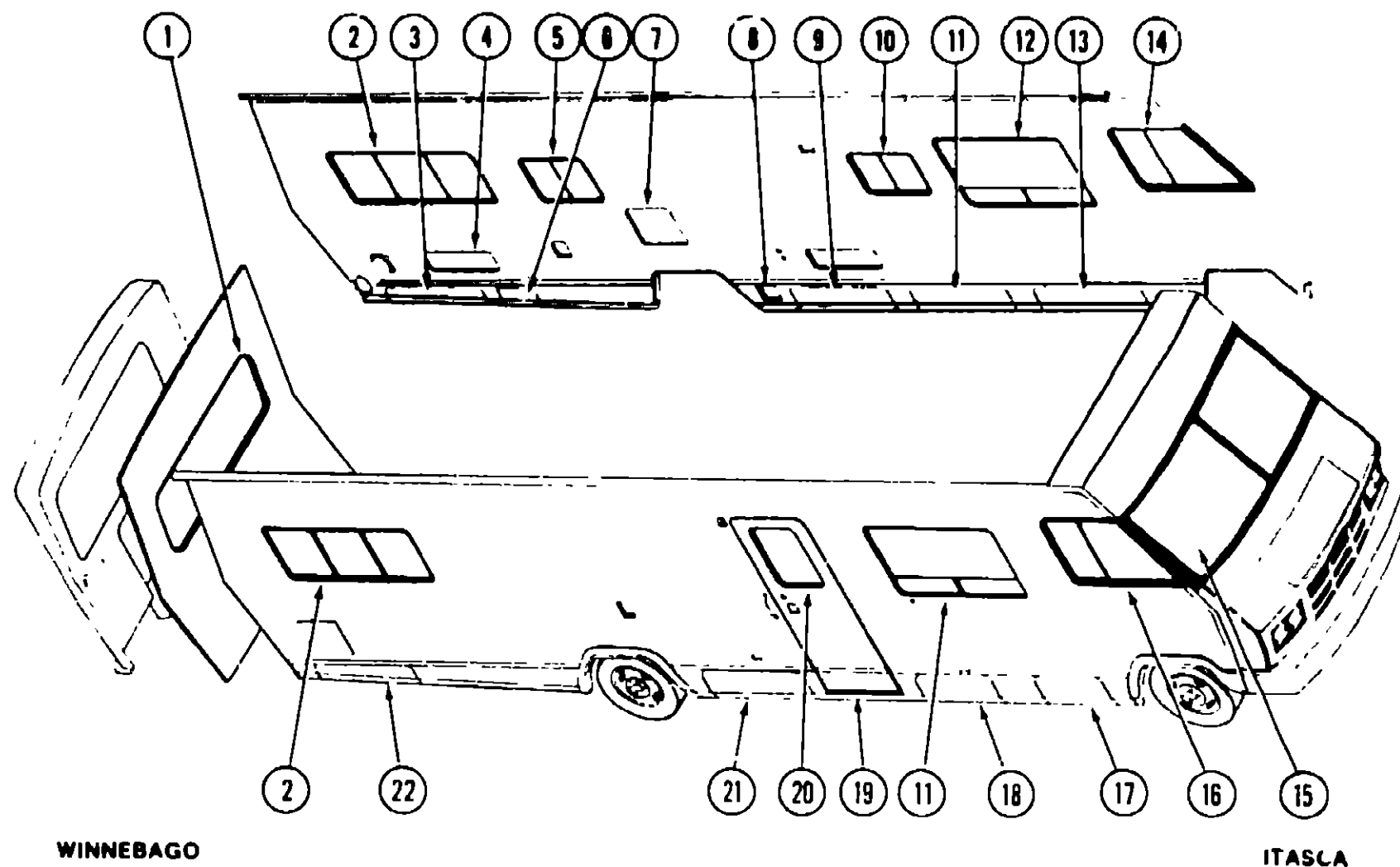

WINNEBAGO

ITASCA

Key	Part Number	U/M	Description
1	078528-01-T03	EA	Window Asm - Escape
2	078269-01-T03	EA	Window Asm - Double Slider
3	086552-08-X11	EA	Door Asm - Storage
4	079578-01-T03	EA	Door Asm - Storage
5	078266-04-T03	EA	Window Asm - Slider
6	088723-02-X11	EA	Door Asm - Storage
7	084103-01-000	EA	Door Asm - Refrigerator Access
8	063742-02-000	EA	Door Asm - Power Cord
9	086553-02-X11	EA	Door Asm - Luggage/Generator
10	078266-03-T03	EA	Window Asm - Slider
11	086531-05-X11	EA	Door Asm - Storage
12	085354-02-W07	EA	Window Asm - Awning
13	086531-04-X11	EA	Door Asm - Storage
14	085025-04-000	EA	Window Asm - Slant - Left
15	084464-01-000	EA	Glass - Windshield - Passenger
16	084464-02-000	EA	Glass - Windshield - Driver
17	084978-03-W30	EA	Window Asm - Slant Slider
18	085025-03-000	EA	Window Asm - Slant - Right
19	086531-04-X11	EA	Door Asm - Storage
20	086517-05-X11	EA	Door Asm - Storage
21	M01870-15-X11	EA	Door Asm - Entrance
22	079733-04-T03	EA	Window Asm - Picture
23	086517-08-X11	EA	Door Asm - Storage
24	086552-07-X11	EA	Door Asm - Storage
25	Not illustrated		

Key	Part Number	U/M	Description
1	078528-01-T03	EA	Window Asm - Escape
2	078269-01-T03	EA	Window Asm - Double Slider
3	086552-02-W30	EA	Door Asm - Storage
4	079578-01-T09	EA	Door Asm - Storage
5	078266-04-T03	EA	Window Asm - Slider
6	088723-01-X36	EA	Door Asm - Storage
7	084103-02-000	EA	Door Asm - Refrigerator Access
8	063742-03-000	EA	Door Asm - Power Cord
9	086553-01-W30	EA	Door Asm - Luggage/Generator
10	078266-03-T03	EA	Window Asm - Slider
11	086531-02-W30	EA	Door Asm - Storage
12	085354-02-W07	EA	Window Asm - Awning
13	086531-01-W30	EA	Door Asm - Storage
14	079421-02-T03	EA	Window Asm - Slant - Left
15	077675-01-000	EA	Glass - Windshield - Passenger
16	077675-02-000	EA	Glass - Windshield - Driver
17	082057-01-U04	EA	Window Asm - Slant Slider
18	079421-01-T03	EA	Window Asm - Slant - Right
19	086531-01-W30	EA	Door Asm - Storage
20	086517-01-W30	EA	Door Asm - Storage
21	M01870-12-X36	EA	Door Asm - Entrance
22	079733-04-T03	EA	Window Asm - Picture
23	086517-04-W30	EA	Door Asm - Storage
24	086552-01-W30	EA	Door Asm - Storage
25	Not illustrated		

1988 N-SERIES TABLE OF CONTENTS

W/ICN22EC	A-01 - A-22
WCN22RC	A-23 - B-14
W/ICN27RT	B-15 - C-18
W/ICN27RU	C-19 - D-20
W/ICN31RT & W/IJN31RT	D-21 - E-18
W/ICN33RU	E-19 - F-16

1988 W/ICN31RT & W/IJN31RT INDEX

Floor Plan	D-21 - D-22
Bath Group	D-23
Curtain, Cushion & Pad Group	D-24 - E-06
Dinette Group	E-07 - E-08
Exterior Body Group	E-09 - E-13
Galley Group	E-14
Lounge Group	E-15 - E-16
Window, Vent & Exterior Door Group	E-17 - E-18