

1985 WCP31RC

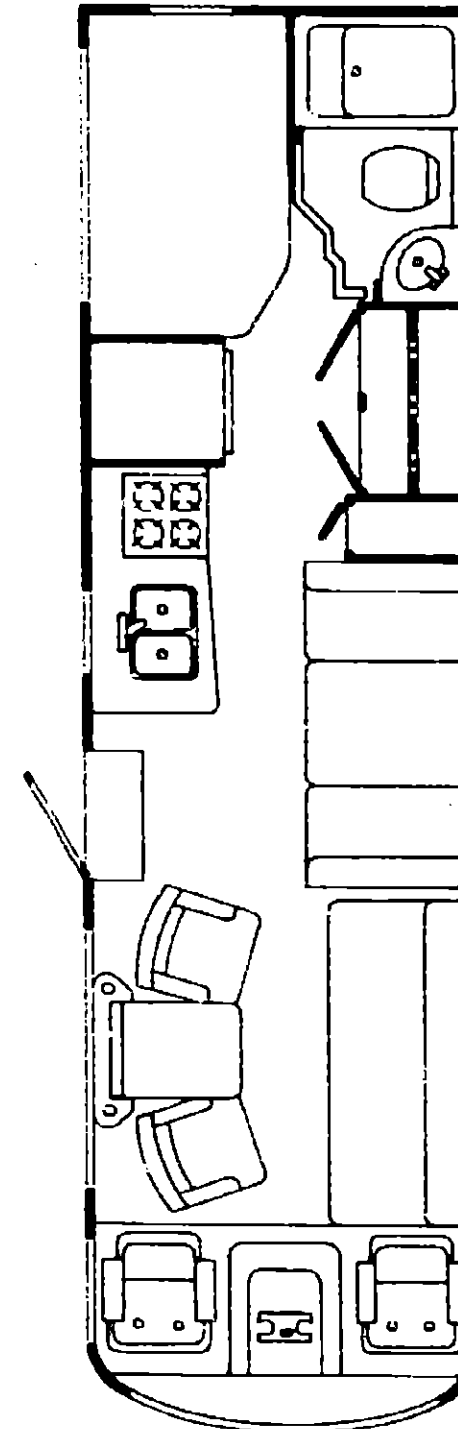
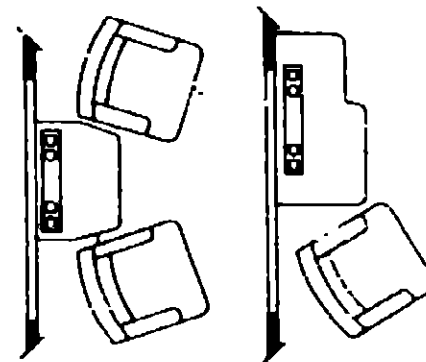

1985 WINNEBAGO TABLE OF CONTENTS

WC420RG	A-01 - C-02
WCN23RG	C-03 - E-10
WCP31RT	E-11 - G-14
WCN31RT	G-15 - I-24

1985 WCP31RC INDEX

Floor Plan	E-11 - E-12
Accessories Group	E-13 - E-15
Bath Group	E-16
Chassis Group	E-17 - E-22
Curtain, Cushion & Pad Group	E-23 - F-05
Dinette Group	F-06
Driver's Compartment Group	F-07 - F-10
Electrical Group	F-11 - F-13
Exterior Body Group	F-14 - F-23
Galley Group	F-24 - G-02
Heating & Air Conditioning Group	G-03
Interior Finish Group	G-04 - G-05
L ^o Group	G-06
Lounge Group	G-07
Water & Sewage Group	G-08
Window, Vent & Exterior Door Group	G-09 - G-14

ACCESSORIES GROUP

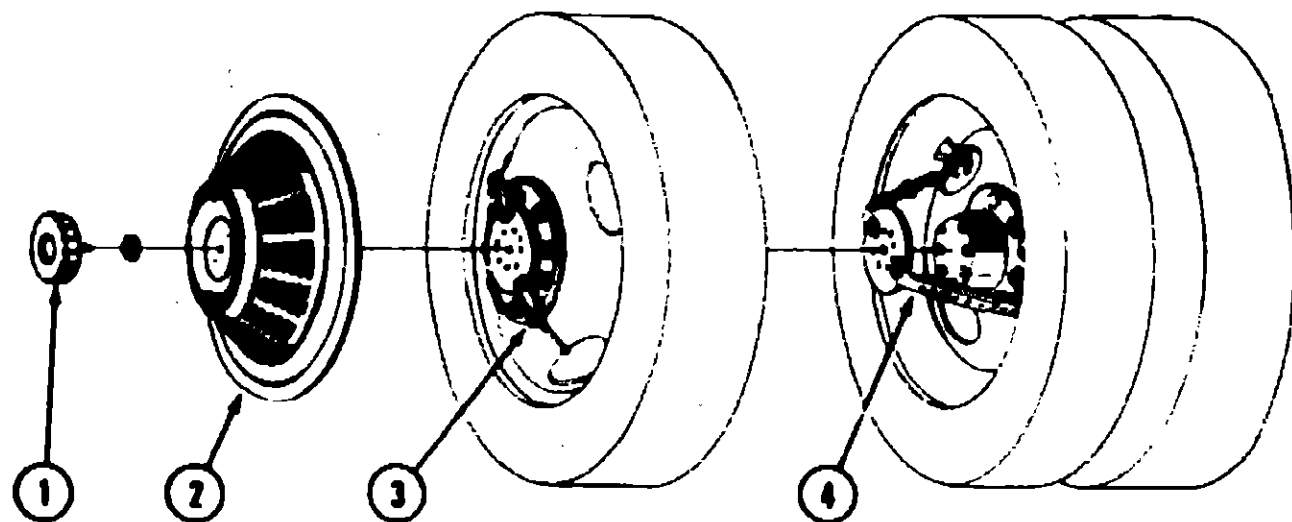

WHEEL COVER & MOUNTING HARDWARE

Key	Part Number	U/M	Description
1	084082-02-000	EA	Retaining Nut - Delmat - Wheel Cover
2	073428-02-700	EA	Wheel Cover - Bolt On - 18.5" - Delmat (1)
3	073428-05-700	EA	Retention Bracket Asm. - Wheel Cover Support - Heavy Duty - Front (1)
4	073428-05-701	EA	Retention Bracket Asm. - Wheel Cover Support - Heavy Duty - Rear (1)
.	073428-05-000	EA	Retention Bracket Asm. - Wheel Cover Support - Heavy Duty (Set/4)
.	Not illustrated		

GENERATORS & COMPONENTS

Key	Part Number	U/M	Description
..	054428-01-000	EA	Generator - Onan - 4.0 kw
..	088228-01-000	EA	Generator - Kohler - 4.5 kw
..	054433-01-000	EA	Generator - Onan - 8.5 kw
..	051911-01-000	EA	Generator - Kohler - 7.000 kw - US
..	053756-01-000	EA	Generator - Kohler - 7.000 kw - CSA
..	701629-01-000	EA	Kohler Installation Package
..	701629-02-000	EA	Onan Installation Package
..	024732-01-016	EA	Tailpipe - 1.5" O.D. x 43.5"
..	067753-01-000	EA	Muffler - Generator - w/Spark Arrestor - Nelson
..	088046-01-000	EA	Conversion Kit - LP - Onan Generator
..	The illustrated parts breakdown for this item is provided on the Common Items Fiche.		

RADIO & RELATED COMPONENTS

Key	Part Number	U/M	Description
..	077088-01-000	EA	Antenna - Radio
..	031105-01-700	EA	Holder - Antenna - Radio - Upper
..	064791-01-000	EA	Speaker - Recessed - 5.25"
..	064792-01-000	EA	Grille - Speaker - 5.25" - w/Mesh - Brown
..	073741-01-000	EA	Speaker - 4" x 6" - Oval
..	073431-01-000	EA	Speaker - 5.25" - 3 Way (Pair)
..	074879-01-000	EA	Speaker Cover Protector - Plastic
..	075803-01-000	EA	Radio - AM/FM MPX - w/Cassette
..	075804-01-000	EA	Radio - AM/FM Stereo Cassette - Electric Tuning

EXTERIOR MIRRORS

Key	Part Number	U/M	Description
..	077051-03-000	EA	Mirror Asm. - Exterior - Right - w/Convex Mirror
..	077051-02-000	EA	Mirror Asm. - Exterior - Left (Drivers)
..	008043-01-000	EA	Mirror - Convex - Adhesive Back

ACCESSORIES GROUP (CONTINUED)

MISCELLANEOUS ACCESSORIES

Key	Part Number	U/M	Description
..	054185-22-000	EA	Owners Manual - 1985 - Itasca & Winnebago
..	076319-01-000	EA	Antenna - TV - (Wineguard Antenna)
..	076319-03-000	FT	Coaxial Cable - 75 Ohm (Wineguard Antenna)
..	076319-04-000	EA	Connector & Ferrule (Wineguard Antenna)
..	076319-07-000	EA	Wall Plate - Power Supply - Brown (Wineguard Antenna)
..	076319-09-000	EA	Wall Plate/Receptacle - Brown (Wineguard Antenna)
..	064083-01-000	EA	Luggage Box - 14" x 30" x 60" - Roof Mount
..	078840-01-000	EA	Shock Cord Asm.
..	078408-01-000	EA	Ladder Asm. (Luggage Rack)
..	078408-02-000	EA	Luggage Rack Asm.
..	078516-02-000	EA	Mudflap - Black - 14" x 12" - Front
..	017516-01-000	EA	Mud Flap - Black - 14" x 18" w/Holes - Rear
..	041944-02-000	EA	Fire Extinguisher Bracket
..	041944-03-000	EA	Fire Extinguisher - 5 BC
..	075822-01-000	EA	Oven - Microwave - Litton
..	078883-01-000	EA	Bracket Asm. - Microwave - Right
..	078883-02-000	EA	Bracket Asm. - Microwave - Left
..	075822-03-000	EA	Trim Ring - Microwave
..	075822-04-000	EA	Air Duct - Exhaust - Microwave
..	078253-02-000	EA	Bracket Asm. - Microwave (2 required)
..	075807-01-000	EA	Decor Pictures - Assorted Grasses & Fields
..	055285-01-000	EA	Vacuum Cleaner - Built In - Tevis Cambell
..	055285-01-700	EA	Accessories Kit - Standard - Tevis Cambell
..	055285-01-701	EA	Filter - 10 per Consumer Package - Tevis Cambell
..	068629-01-000	EA	Speed Control Package - Electric - Dana
..	072852-01-000	EA	Smoke Detector w/9 Volt Battery
..	008068-01-000	EA	Key Case - Leather
..	007038-01-000	EA	Door Mat - 10.5" x 26" - Black Rubber
..	088580-01-000	EA	Lug Wrench - 1" x 1.25" x 18.3"
..	088580-02-000	EA	Leverage Bar - 22" - Lug Wrench
..	083708-01-000	EA	Cover - Air Conditioning - Vinyl
..	008113-01-000	EA	Jack - Hydraulic - 6 Ton - w/Handle
..	038420-02-000	EA	Defroster Fan - 6" - 2 Speed
..	077487-01-000	EA	Air Horns - Roof Mount - Chrome
..	077487-01-700	EA	Solenoid - Air Tank
..	077487-01-701	EA	Switch - Compressor
..	077487-01-702	EA	Toggle Switch
..	077487-01-703	EA	Air Tank
..	077487-01-704	EA	Compressor - w/Switch
..	078841-01-000	EA	Fog Lamps - w/Cover
..	078841-01-700	EA	Fog Lamps - w/Cover (Set)
..	078841-01-701	EA	Lens - Fog Light
..	078841-01-702	EA	Switch - Fog Light
..	078841-01-703	EA	Solenoid - Fog Light
..	051057-01-000	EA	Searchlight - Power Driven
..	051057-01-700	EA	Switch - Auxiliary Toggle - Searchlight
..	051057-01-701	EA	Switch - Replacement Toggle - Searchlight
..	051057-01-702	EA	Joy Switch & Housing - Searchlight
..	051057-01-703	EA	Switch - Toggle - On/Off - Searchlight
..	051057-01-704	EA	Switch - Micro - Searchlight
..	078885-01-000	EA	Clock - 9" x 9" - Round Face
..	078885-02-000	EA	Weather Center

1985 WINNEBAGO TABLE OF CONTENTS

WC420RG	A-01 - C-02
WCN23RG	C-03 - E-10
WCP31RT	E-11 - G-14
WCN31RT	G-15 - I-24

1985 WCP31RC INDEX

Floor Plan	E-11 - E-12
Accessories Group	E-13 - E-15
Bath Group	E-16
Chassis Group	E-17 - E-22
Curtain, Cushion & Pad Group	E-23 - F-05
Dinette Group	F-06
Driver's Compartment Group	F-07 - F-10
Electrical Group	F-11 - F-13
Exterior Body Group	F-14 - F-23
Galley Group	F-24 - G-02
Heating & Air Conditioning Group	G-03
Interior Finish Group	G-04 - G-05
LP Group	G-06
Lounge Group	G-07
Water & Sewage Group	G-08
Window, Vent & Exterior Door Group	G-09 - G-14

ACCESSORIES GROUP (CONTINUED)

ELECTRIC STEP

Key	Part Number	U/M	Description
	075481-01-000	EA	Step Asm. - Electric (Kwikkee)
	075481-01-700	EA	Motor
	041250-01-000	EA	Door Switch
	075481-01-704	EA	Under Step Control Unit
	075481-01-705	EA	4-Way Plug (Dash End)
	075481-01-706	EA	Kill Switch
	075481-01-707	EA	Step Light
	075481-01-708	EA	4-Way Plug (Control Bc x End)
	075481-01-709	EA	90° Plug
	075481-01-710	EA	Gear
	075481-01-711	EA	Drive Link

BATH GROUP

BATH & WARDROBE CABINETRY

Key	Part Number	U/M	Description
	M80852-01-T08	EA	Cabinet Asm. - Lavatory w/o Countertop, Doors or Hardware
	M02083-01-T08	EA	Countertop Asm. - Lavatory
	M78803-11-T08	EA	Door Asm. - Vanity Cabinet - w/o Hardware
	08C744-01-000	EA	Cabinet Asm. - Medicine - Metal - Almond - w/Door & Mirror
	080224-09-000	EA	Door Asm. - Folding 50" x 75" - Right
	M78803-07-T08	EA	Door Asm. - Wardrobe Cabinet - Upper - w/o Hardware
	M78803-18-T08	EA	Door Asm. - Wardrobe Cabinet - Lower - w/o Hardware
	078917-01-T08	EA	Drawer Asm. - Lavatory - Tiltout

BATH & WARDROBE HARDWARE

Key	Part Number	U/M	Description
	075240-02-000	EA	Faucet - Lavatory
	075242-02-000	EA	Faucet - Tub & Shower
	058713-01-000	EA	Sink Oval - Ivory Plastic
	M01817-01-T03	EA	Bathtub Asm. - w/Strainer
	075541-03-000	EA	Bathtub Shroud Asm.
	008059-01-000	EA	Hinge - 2" Gold
	059777-01-000	EA	Hinge - Antique Brass
	077523-01-000	EA	Latch Asm. - Cabinet Door
	039873-01-700	EA	Nylon Catch & Spring Steel Strike
	058034-02-000	EA	Latch - Sliding Door
	075808-01-000	EA	Panel - Shower Faucet
	011083-01-000	EA	Tail Piece 1.25" x 5" - Plastic - w/Stopper
	011048-02-000	EA	Shower Head - w/60" Hose
	086729-01-000	EA	Strainer - Shower Pan & Tub
	086436-01-000	EA	Slip Nut - 1.5" Tail Piece - Bathtub
	086435-01-000	EA	Nut - Strainer - Plastic
	075452-01-000	EA	Holder - Tissue
	075680-01-000	EA	Clothes Rod - Adjustable
	075454-01-000	EA	Towel Ring - Antique Brass
	080224-10-000	EA	Folding Door Track
	062906-02-000	EA	Shower Door Asm.
	009112-01-000	EA	Flange - 1" Closet Rod
	057871-01-000	EA	Screw Cover (No. 8)
	058331-08-000	EA	Mirror - Tempered Glass - 24" x 30"
	058331-04-000	EA	Mirror - Tempered Glass - 12" x 42"
	009089-01-000	EA	Mirror Clip
	039341-02-000	EA	Toilet - Thetford - Aqua Magic - Ivory - 8420 SH

1985 WINNEBAGO
TABLE OF CONTENTS

WC420RG	A-01 - C-02
WCN23RG	C-03 - E-10
WCP31RT	E-11 - G-14
WCN31RT	G-15 - I-24

1985 WCP31RC INDEX

Floor Plan	E-11 - E-12
Accessories Group	E-13 - E-15
Bath Group	E-16
Chassis Group	E-17 - E-22
Curtain, Cushion & Pad Group	E-23 - F-05
Dinette Group	F-06
Driver's Compartment Group	F-07 - F-10
Electrical Group	F-11 - F-13
Exterior Body Group	F-14 - F-23
Galley Group	F-24 - G-02
Heating & Air Conditioning Group	G-03
Interior Finish Group	G-04 - G-05
LP Group	G-06
Lounge Group	G-07
Water & Sewage Group	G-08
Window, Vent & Exterior Door Group	G-09 - G-14

CHASSIS GROUP

WHEELS & TIRES

Key	Part Number	U/M	Description
	077043-01-000	EA	Lug Nut - 2 Pc. - Cone Seat & Flange
	077044-01-000	EA	Lug Nut Cover - Chrome w/Skirt
	077045-01-000	EA	Front Hub Cover - Chrome
	077045-02-000	EA	Rear Hub Cover - Chrome
	007324-04-000	EA	Tire - 8R19.5XZA - Michelin
	007321-02-000	EA	Tire - 8.00 x 19.5 - 8 Ply - Tubeless
	051377-01-000	EA	Valve Stem Asm. - TR500
	077042-01-000	EA	Wheel - 19.5 x 8 - Aluminum - Front - Outside Polish
	077042-02-000	EA	Wheel - 19.5 x 8 - Aluminum - Rear - Inside Polish
	084883-01-000	EA	Wheel - 19.5 x 8.75
	077030-02-000	EA	Extension - Valve Stem - 1.25"
	081808-01-000	EA	Cover - Rear Axle - Chrome
	081808-02-000	EA	Cover - Front Axle - Chrome
	081808-03-000	EA	Liner Front Wheel - Chrome
	081808-04-000	EA	Liner Rear Wheel - Chrome
	081808-05-000	EA	Cover - Lug Nut - Chrome
	081808-06-000	EA	Ring Spring - Chrome

MISCELLANEOUS

Key	Part Number	U/M	Description
	081057-01-000	EA	Alternator Kit - 105 Amp w/Regulator
	081057-01-700	EA	Brush Asm.
	081057-01-701	EA	Diode Bridge
	081057-01-702	EA	Condenser
	081057-01-703	EA	Inside Bearing Spacer
	081057-01-704	EA	Front Bearing
	081057-01-705	EA	Outside Bearing Spacer
	081057-01-706	EA	Pulley
	081057-01-707	EA	Diode (-)
	081057-01-708	EA	Stator - 105 Amp.
	081057-01-710	EA	Rotor
	081057-01-711	EA	Ground Terminal Kit
	081057-01-712	EA	Battery Terminal Kit
	081057-01-713	EA	Rear Bearing
	022855-05-000	EA	Tailpipe - 2.5" x 32"
	007131-01-000	EA	Tailpipe Hanger
	007125-07-000	EA	Clamp Asm. - Muffler - 2.5"
	075758-01-000	EA	Wheel Well - Plastic - Rear - Left/Right
	085450-01-000	EA	Battery Tie Down
	080448-01-000	EA	Step Asm. - Entry
	080448-02-000	EA	Bracket - Entry Step - Right
	080448-03-000	EA	Bracket - Entry Step - Left
	047441-01-000	EA	Battery Terminal - Horizontal Lug
	077479-02-000	EA	Battery Terminal Boot
	080208-01-000	EA	Lug Wrench - 1" x 1.25"
	080208-02-000	EA	Leverage Bar - Lug Wrench
	008113-01-000	EA	Jack - Hydraulic - 6 Ton - w/Handle
	020167-03-000	EA	Dirt Guard - Wheel Well
	008188-01-000	EA	Solenoid Relay - 3 Terminal
	079942-01-000	EA	Shock Absorber Stabilizer - Front
	079942-02-000	EA	Shock Absorber Stabilizer - Rear
	079942-07-000	EA	Bracket - Stabilizer Mount

CHASSIS GROUP (CONTINUED)

SPARE TIRE & COMPARTMENT

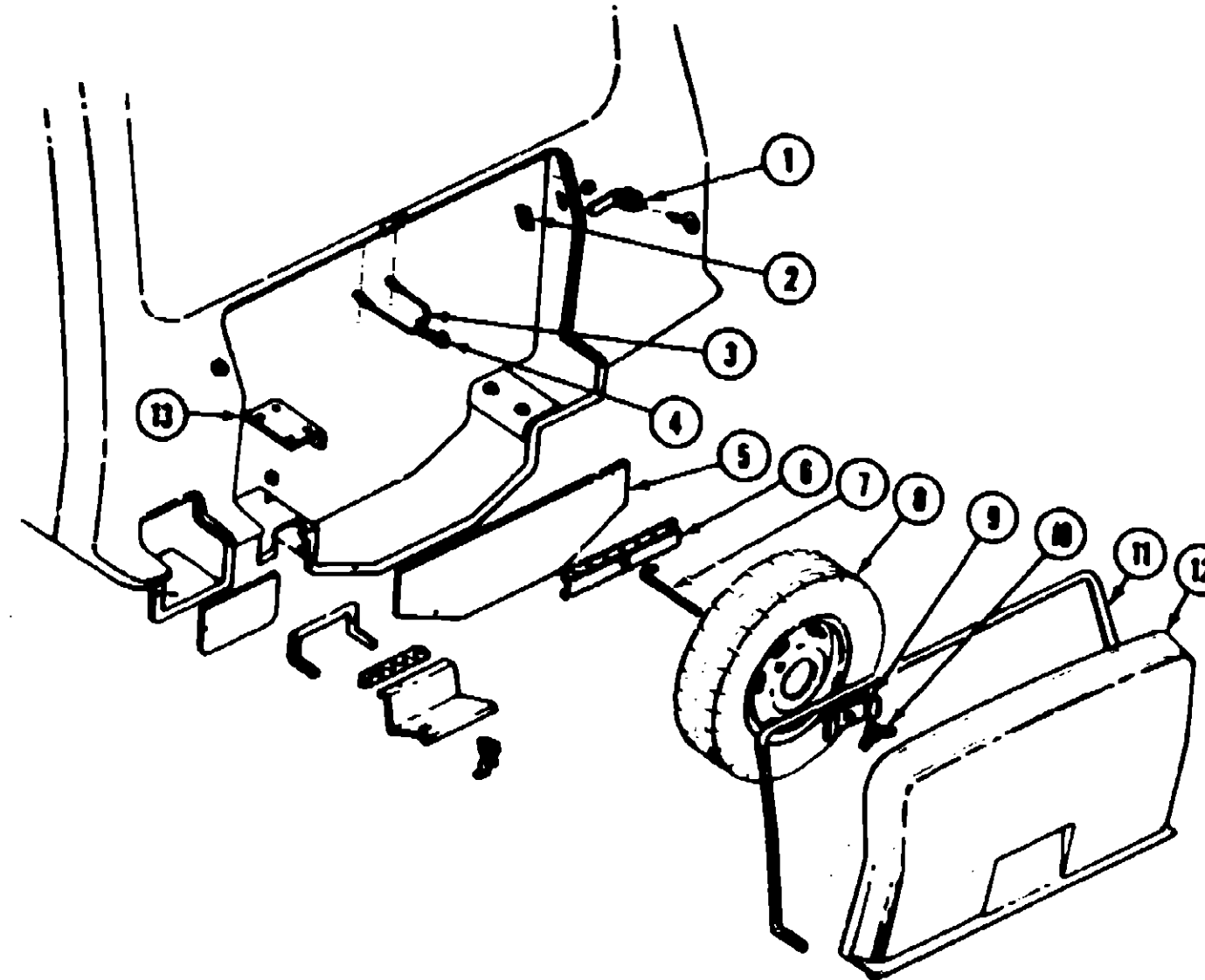

Key	Part Number	U/M	Description
1	077408-01-000	EA	Lock Asm. - Key Type
2	077941-01-000	EA	Rubber Seal - Flat w/Slit
3	076767-02-000	EA	Cable Asm.
4	072463-01-000	EA	Spring Hook - 1/2"
5	077385-01-000	EA	Shield - Spare Tire
6	077403-01-000	EA	Support Bracket - Spare Tire
7	077411-01-000	EA	Retaining Rod - Spare Tire
8	007324-04-000	EA	Tire - 8.00 x 19.5 - 8 Ply - Tubeless - XZA - Michelin
9	077389-01-000	EA	Retainer - Spare Tire
10	084081-01-000	EA	Wing Nut - 3/8" - Spare Tire
11	073080-01-000	FT	Weather Seal
12	M01980-01-000	EA	Cover - Spare Tire - Beige
13	077400-01-000	EA	Support - Spare Tire

1985 WINNEBAGO TABLE OF CONTENTS

WC420RG	A-01 - C-02
WCN23RG	C-03 - E-10
WCP31RT	E-11 - G-14
WCN31RT	G-15 - I-24

1985 WCP31RC INDEX

Floor Plan	E-11 - E-12
Accessories Group	E-13 - E-15
Bath Group	E-16
Chassis Group	E-17 - E-22
Curtain, Cushion & Pad Group	E-23 - F-06
Dinette Group	F-08
Driver's Compartment Group	F-07 - F-10
Electrical Group	F-11 - F-13
Exterior Body Group	F-14 - F-23
Galley Group	F-24 - G-02
Heating & Air Conditioning Group	G-03
Interior Finish Group	G-04 - G-06
LP Group	G-08
Lounge Group	G-07
Water & Sewage Group	G-09
Window, Vent & Exterior Door Group	G-08 - G-14

CHASSIS GROUP (CONTINUED)

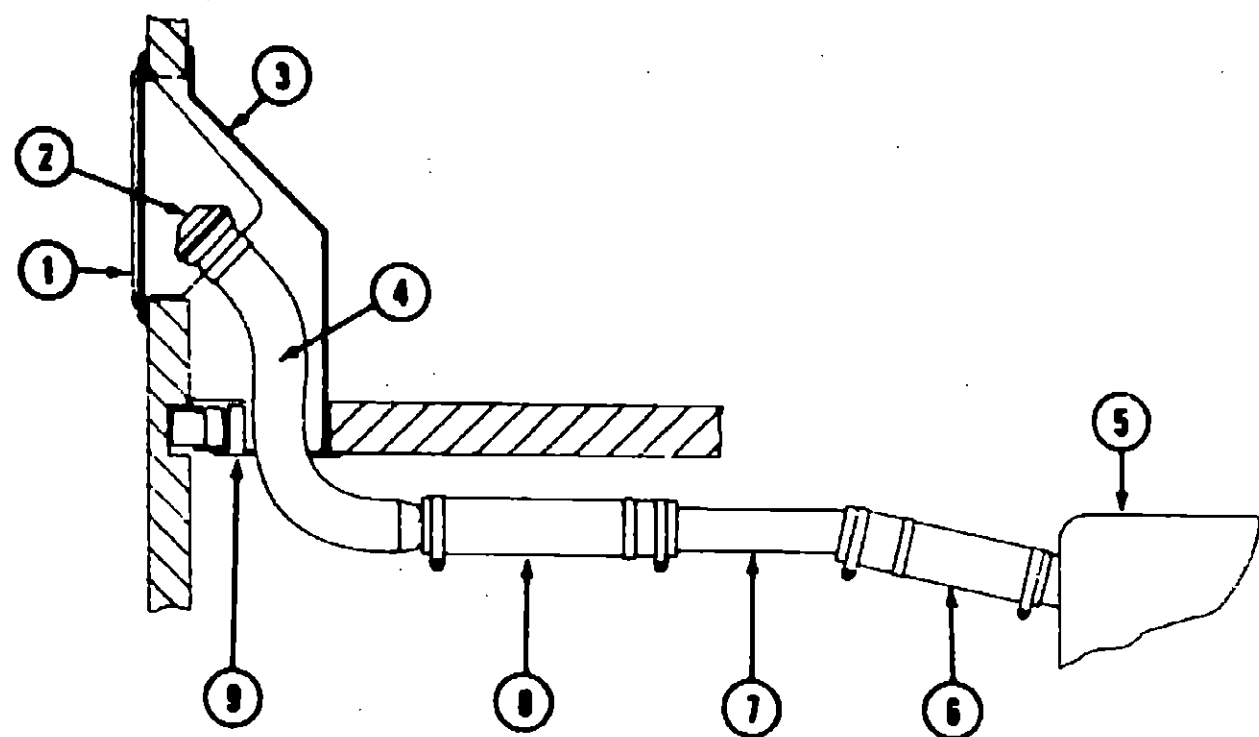

MAIN FUEL FILL

Key	Part Number	U/M	Description
1	078010-01-000	EA	Door Asm. & Upper Shroud - Fuel Fill
2	073220-02-000	EA	Cap - Fuel Fill
3	078032-01-000	EA	Shroud - Fuel Fill - Inside
4	075227-01-000	EA	Neck Asm. - Upper Fuel Fill
5	075230-01-000	EA	Tank - Fuel - 80 Gallon
6	007111-03-005	EA	Hose - Fuel - 1.75" x 4.70"
7	075228-01-000	EA	Neck Asm. - Lower Fuel Fill
8	007111-03-006	EA	Hose - Fuel - 1.75" x 11"
9	063303-04-000	EA	Shroud - Fuel Fill - Lower
.	057038-08-000	EA	Sending Unit - Fuel - 90 Ohm
.	075232-01-000	EA	Strap - Fuel Tank Mounting
.	075231-01-000	EA	Hanger - Fuel Tank Mounting
.	Not illustrated		

CHASSIS GROUP (CONTINUED)

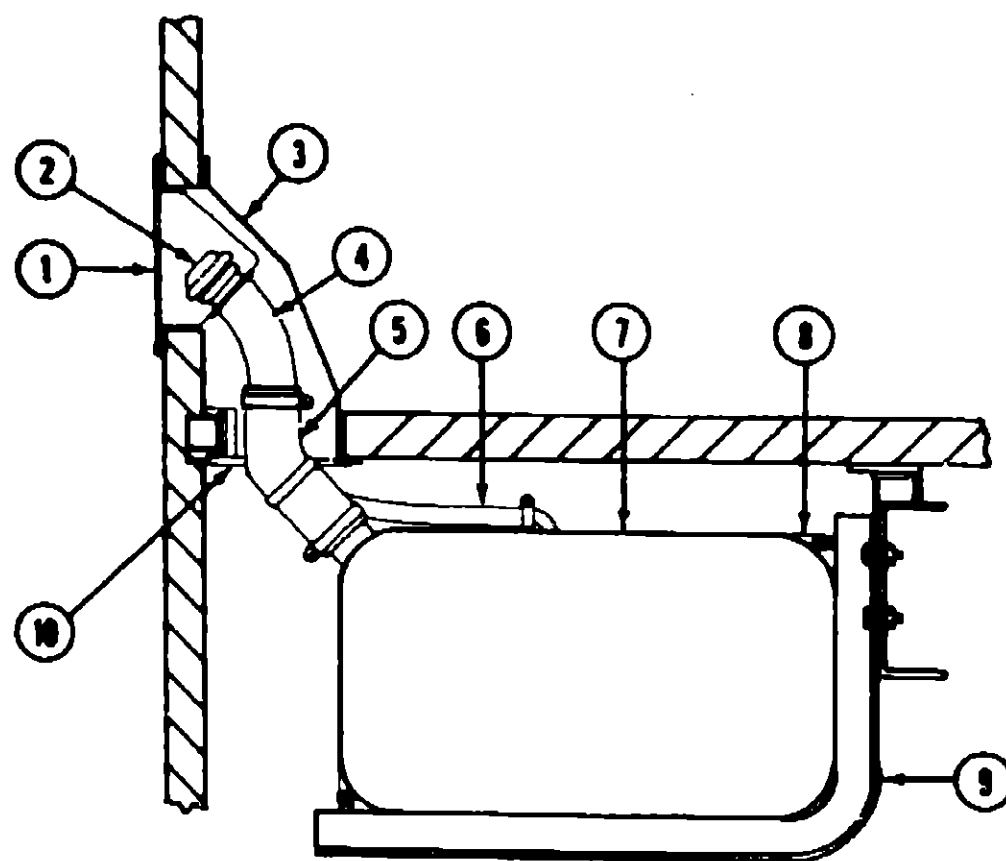

AUXILIARY FUEL FILL

Key	Part Number	U/M	Description
1	078010-01-000	EA	Door Asm. & Upper Shroud - Fuel Fill
2	073220-02-000	EA	Cap - Fuel Fill
3	078032-01-000	EA	Shroud - Fuel Fill - Inside
4	075014-02-000	EA	Neck Asm. - Upper Fuel Fill
5	077388-01-000	EA	Hose - Fuel - Formed 2" I.D.
6	086732-01-000	FT	Hose - Fuel - .62" I.D. - Vent
7	075686-01-000	EA	Tank - Fuel - 30 Gallon
8	075232-02-000	EA	Strap Asm. - Fuel Tank - T-Bolt Ends
9	075685-01-000	EA	Bracket - Fuel Tank Mounting
10	063303-04-000	EA	Shroud - Fuel Fill - Lower
.	057038-08-000	EA	Sending Unit - Fuel - 90 Ohm
.	080212-01-000	EA	Valve Asm. - Fuel Select - 6 Port
.	Not illustrated		

1985 WINNEBAGO TABLE OF CONTENTS

WC420RG
WCN23RG
WCP31RT
WCN31RT

A-01 - C-02
C-03 - E-10
E-11 - G-14
G-15 - I-24

1985 WCP31RC INDEX

Floor Plan	E-11 - E-12
Accessories Group	E-13 - E-15
Bath Group	E-16
Chassis Group	E-17 - E-22
Curtain, Cushion & Pad Group	E-23 - F-05
Dinette Group	F-06
Driver's Compartment Group	F-07 - F-10
Electrical Group	F-11 - F-13
Exterior Body Group	F-14 - F-23
Galley Group	F-24 - G-02
Heating & Air Conditioning Group	G-03
Interior Finish Group	G-04 - G-05
LP Group	G-06
Lounge Group	G-07
Water & Sewage Group	G-08
Window, Vent & Exterior Door Group	G-09 - G-14

CHASSIS GROUP (CONTINUED)

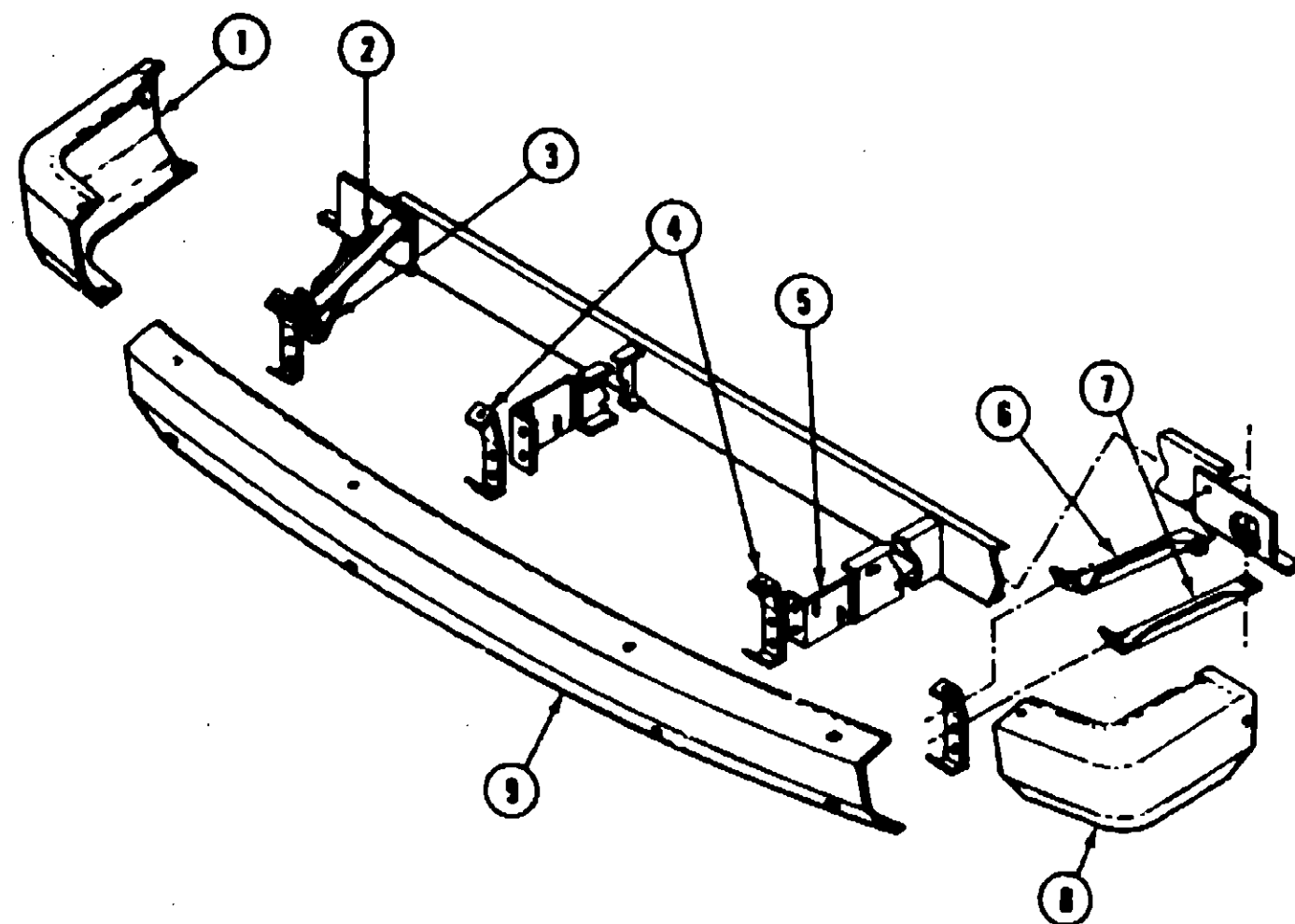

FRONT BUMPER

Key	Part Number	U/M	Description
1	075767-01-000	EA	Bumper End - Beige - Right Front
2	077852-01-000	EA	Brace - Upper Right - Front Bumper
3	077854-01-000	EA	Brace - Lower Right - Front Bumper
4	077852-01-000	EA	Bracket to Bumper - Front
5	076527-01-000	EA	Bracket to Frame - Front Bumper
6	077853-02-000	EA	Brace - Upper Left - Front Bumper
7	077854-02-000	EA	Brace - Lower Left - Front Bumper
8	075767-03-000	EA	Bumper End - Beige - Left Front
9	077850-08-000	EA	Bumper - Front - Gray
9	077850-07-000	EA	Bumper - Front - Chrome
.	005200-01-000	EA	Carriage Bolt - Chrome - 7/16" x 14 x 1 1/4"
.	Not illustrated		

CHASSIS GROUP (CONTINUED)

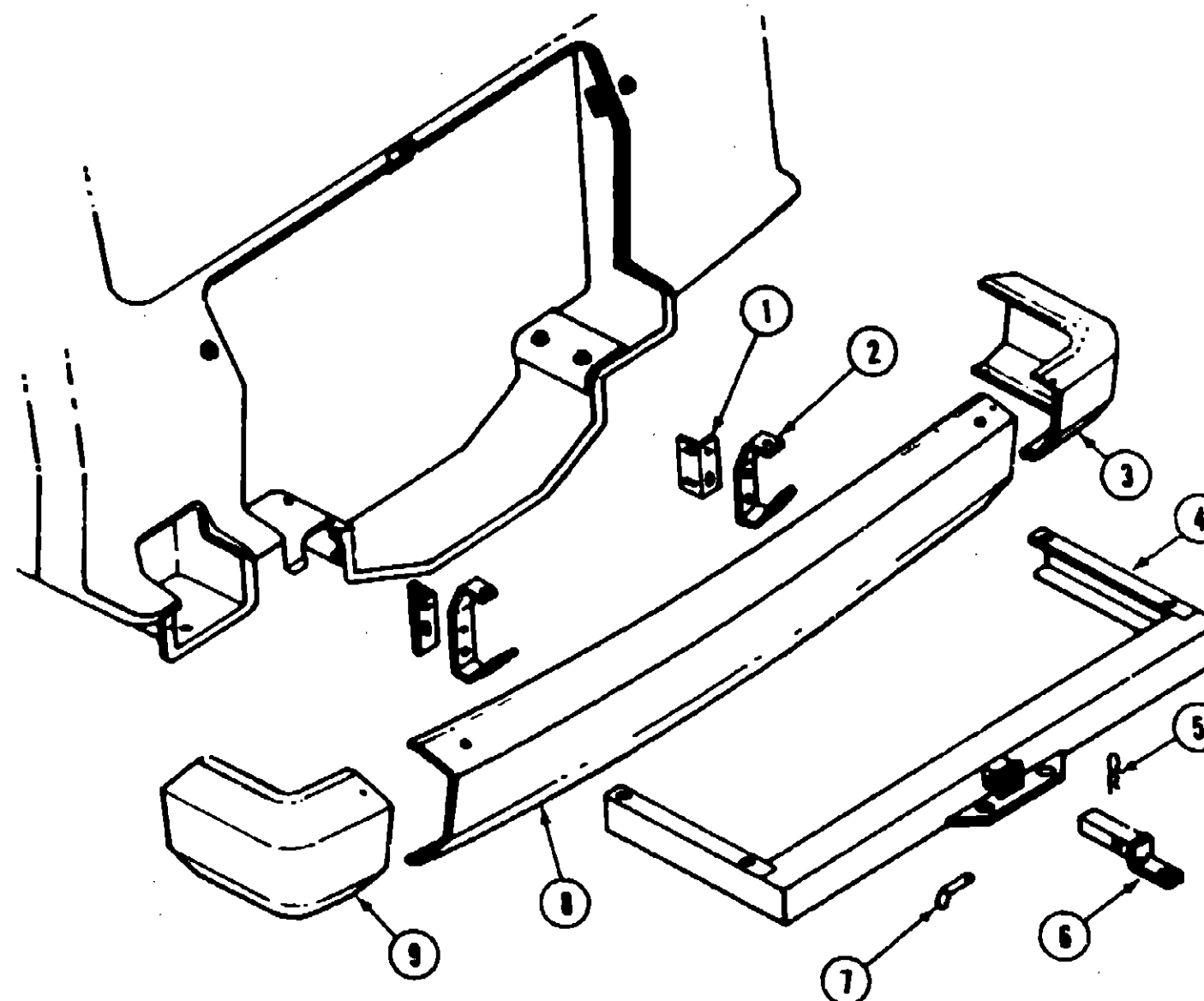

REAR BUMPER & HITCH

Key	Part Number	U/M	Description
1	076558-01-000	EA	Bracket to Frame - Rear Bumper
2	077855-01-000	EA	Bracket to Bumper - Rear
3	077330-02-000	EA	Bumper End - Gray - Right Rear
4	077817-01-000	EA	Hitch Asm. - w/o Drawbar
5	034513-01-000	EA	Spring Pin - Hitch - 3/16" Wire
6	077613-01-000	EA	Drawbar Asm.
7	034512-01-000	EA	Locking Pin - Drawbar
8	077851-01-000	EA	Bumper - Rear - Plain
8	077851-04-000	EA	Bumper - Rear - Chrome
9	077330-04-000	EA	Bumper - End - Gray - Left Rear
.	005200-01-000	EA	Carriage Bolt - Chrome - 7/16" - 14 x 1 1/4"
.	Not illustrated		

1985 WINNEBAGO TABLE OF CONTENTS

WC420RG
WCN23RG
WCP31RT
WCN31RT

A-01 - C-02
C-03 - E-10
E-11 - G-14
G-15 - I-24

1985 WCP31RC INDEX

Floor Plan	E-11 - E-12
Accessories Group	E-13 - E-15
Bath Group	E-16
Chassis Group	E-17 - E-22
Curtain, Cushion & Pad Group	E-23 - F-05
Dinette Group	F-06
Driver's Compartment Group	F-07 - F-10
Electrical Group	F-11 - F-13
Exterior Body Group	F-14 - F-23
Galley Group	F-24 - G-02
Heating & Air Conditioning Group	G-03
Interior Finish Group	G-04 - G-05
LP Group	G-06
Lounge Group	G-07
Water & Sewage Group	G-08
Window, Vent & Exterior Door Group	G-09 - G-14

CURTAIN, CUSHION & PAD GROUP

NOTICE

In order to assist our Parts Sales Dept. in providing interior software items, please include the serial number and the color code number from the vehicle certification label when ordering. This label is located on the left sidewall at the end of the dash (A-Body), or on the driver's door latch plate (C-Body).

An example of a color code number is P31, which designates an overall color scheme of a particular unit. The color listed after the item description on the microfiche, indicates the overall unit color. Order the item you desire according to unit color code.

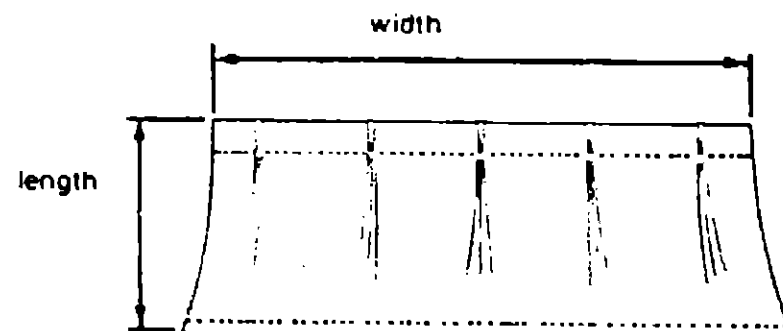

NOTE:

Use this illustration when determining length and width measurements for curtains. You will note the width measurement is taken on the top of the curtain with the curtain fully extended. The length measurement is taken from top to bottom.



Key	Part Number	U/M	Description
1	029130-01-000	EA	Socket - Snap Fastener
2	029155-01-000	EA	Cap - Snap - .156" Dia. x .17" Barrel
3	029156-01-000	EA	Socket - Snap Fastener
4	029092-01-000	EA	Stud - Nickel Finish
5	029093-01-000	EA	Eyelet - Nickel Finish

FABRIC & TRIMS

Key	Part Number	U/M	Description
	077498-10-000	YD	Fabric - Upholstery - Blue (T06)
	077498-11-000	YD	Fabric - Upholstery - Peach (T07)
	077498-12-000	YD	Fabric - Upholstery - Rust (T08)
	077498-22-000	YD	Fabric - Upholstery/Accent (Drapery & Seat Covers) Blue (T06)
	077498-23-000	YD	Fabric - Upholstery/Accent (Drapery & Seat Covers) Peach (T07)
	077498-24-000	YD	Fabric - Upholstery/Accent (Drapery & Seat Covers) Rust (T08)
	088729-16-000	YD	Fabric - Bedspread - Blue (T08)
	088729-17-000	YD	Fabric - Bedspread - Peach, Rust (T07, T08)
	072333-12-000	YD	Fabric - Drapery - Sand
	079880-04-000	YD	Vinyl - Expanded (End Caps) Teak
	072880-33-000	SY	Carpet - Blue (T06)
	072880-24-000	SY	Carpet - Peach (T07)
	072880-34-000	SY	Carpet - Rust (T08)
	075233-01-000	SY	Carpet - Pad - 3/8" Foam
	038421-01-000	YD	Fabric - Mattress Ticking
	071127-06-T06	EA	Button Asm. - #36 Round - Blue
	071127-06-T07	EA	Button Asm. - #36 Round - Peach
	071127-06-T08	EA	Button Asm. - #36 Round - Rust

CURTAIN, CUSHION & PAD GROUP (CONTINUED)

CURTAIN HARDWARE

Key	Part Number	U/M	Description
	056116-01-000	EA	Track - Curtain - Brown - Plastic
	077046-01-000	EA	Track - Curtain - Front Wraparound - Passenger
	077046-02-000	EA	Track - Curtain - Front Wraparound - Drivers
	056001-01-000	EA	Bracket - Shade - Left
	056002-01-000	EA	Bracket - Shade - Right
	056003-01-000	EA	Bracket - Drapery Retainer - Right
	056003-02-000	EA	Bracket - Drapery Retainer - Left
	056003-03-000	EA	Bracket - Drapery Retainer - Universal
	056784-01-000	EA	Pull - Window Shade - Antique Brass
	039175-01-000	EA	Curtain Rod - Ext. 48" - 84"
	039175-03-000	EA	Curtain Rod - Ext. 36" - 48"
	039175-04-000	EA	Curtain Rod - Ext. 16" - 28"
	039175-02-000	EA	Bracket - Curtain Rod
	056115-02-000	YD	Tape - Clear Plastic - w/Guides
	048394-01-000	YD	Tape Hook - 1" x 25 YD - Beige (Velcro)
	048395-01-000	YD	Tape Loop - 1" x 25 YD - Beige (Velcro)
	075477-01-000	EA	Bracket Installation - Blinds
	075477-03-000	EA	Bracket Hold Down - Blinds

BUCKET SEATS

Key	Part Number	U/M	Description
	078004-07-T06	EA	Seat Asm. - Single Bucket - w/Armrests & Headrest - Blue
	078004-07-T07	EA	Seat Asm. - Single Bucket - w/Armrests & Headrest - Peach
	078004-07-T08	EA	Seat Asm. - Single Bucket - w/Armrests & Headrest - Rust
	M01863-02-T06	EA	Cover - Back - Single Bucket - Blue
	M01863-02-T07	EA	Cover - Back - Single Bucket - Peach
	M01863-02-T08	EA	Cover - Back - Single Bucket - Rust
	M01863-01-T06	EA	Cover - Bottom - Single Bucket - Blue
	M01863-01-T07	EA	Cover - Bottom - Single Bucket - Peach
	M01863-01-T08	EA	Cover - Bottom - Single Bucket - Rust
	071126-09-T06	EA	Skirt - Single Bucket - Blue
	071126-09-T07	EA	Skirt - Single Bucket - Peach
	071126-09-T08	EA	Skirt - Single Bucket - Rust
	079281-02-T06	EA	Seat Asm. - Double Bucket w/Armrests & Headrest - Blue
	079281-02-T07	EA	Seat Asm. - Double Bucket w/Armrests & Headrest - Peach
	079281-02-T08	EA	Seat Asm. - Double Bucket w/Armrests & Headrest - Rust
	M01874-04-T06	EA	Cover - Back - Double Bucket - Blue
	M01874-04-T07	EA	Cover - Back - Double Bucket - Peach
	M01874-04-T08	EA	Cover - Back - Double Bucket - Rust
	M01874-03-T06	EA	Cover - Bottom - Double Bucket - Blue
	M01874-03-T07	EA	Cover - Bottom - Double Bucket - Peach
	M01874-03-T08	EA	Cover - Bottom - Double Bucket - Rust
	071680-02-T06	EA	Skirt - Double Bucket - Blue
	071680-02-T07	EA	Skirt - Double Bucket - Peach
	071680-02-T08	EA	Skirt - Double Bucket - Rust
	080243-01-T06	EA	Armrest Asm. - Right - Blue
	080243-01-T07	EA	Armrest Asm. - Right - Peach
	080243-01-T08	EA	Armrest Asm. - Right - Rust
	080243-02-T06	EA	Armrest Asm. - Left - Blue
	080243-02-T07	EA	Armrest Asm. - Left - Peach
	080243-02-T08	EA	Armrest Asm. - Left - Rust
	M80243-01-T06	EA	Cover - Armrest - Blue
	M80243-01-T07	EA	Cover - Armrest - Peach
	M80243-01-T08	EA	Cover - Armrest - Rust
	080242-01-T06	EA	Headrest Asm. - Blue
	080242-01-T07	EA	Headrest Asm. - Peach
	080242-01-T08	EA	Headrest Asm. - Rust
	M80242-01-T06	EA	Headrest Cover - Blue
	M80242-01-T07	EA	Headrest Cover - Peach
	M80242-01-T08	EA	Headrest Cover - Rust

1985 WINNEBAGO TABLE OF CONTENTS

WC420RG	A-01 - C-02
WCN23RG	C-03 - E-10
WCP31RT	E-11 - G-14
WCN31RT	G-15 - I-24

1985 WCP31RC INDEX

Floor Plan	E-11 - E-12
Accessories Group	E-13 - E-15
Bath Group	E-16
Chassis Group	E-17 - E-22
Curtain, Cushion & Pad Group	E-23 - F-05
Dinette Group	F-06
Driver's Compartment Group	F-07 - F-10
Electrical Group	F-11 - F-13
Exterior Body Group	F-14 - F-23
Galley Group	F-24 - G-02
Heating & Air Conditioning Group	G-03
Interior Finish Group	G-04 - G-05
LP Group	G-06
Lounge Group	G-07
Water & Sewage Group	G-08
Window, Vent & Exterior Door Group	G-09 - G-14

CURTAIN, CUSHION & PAD GROUP (CONTINUED)

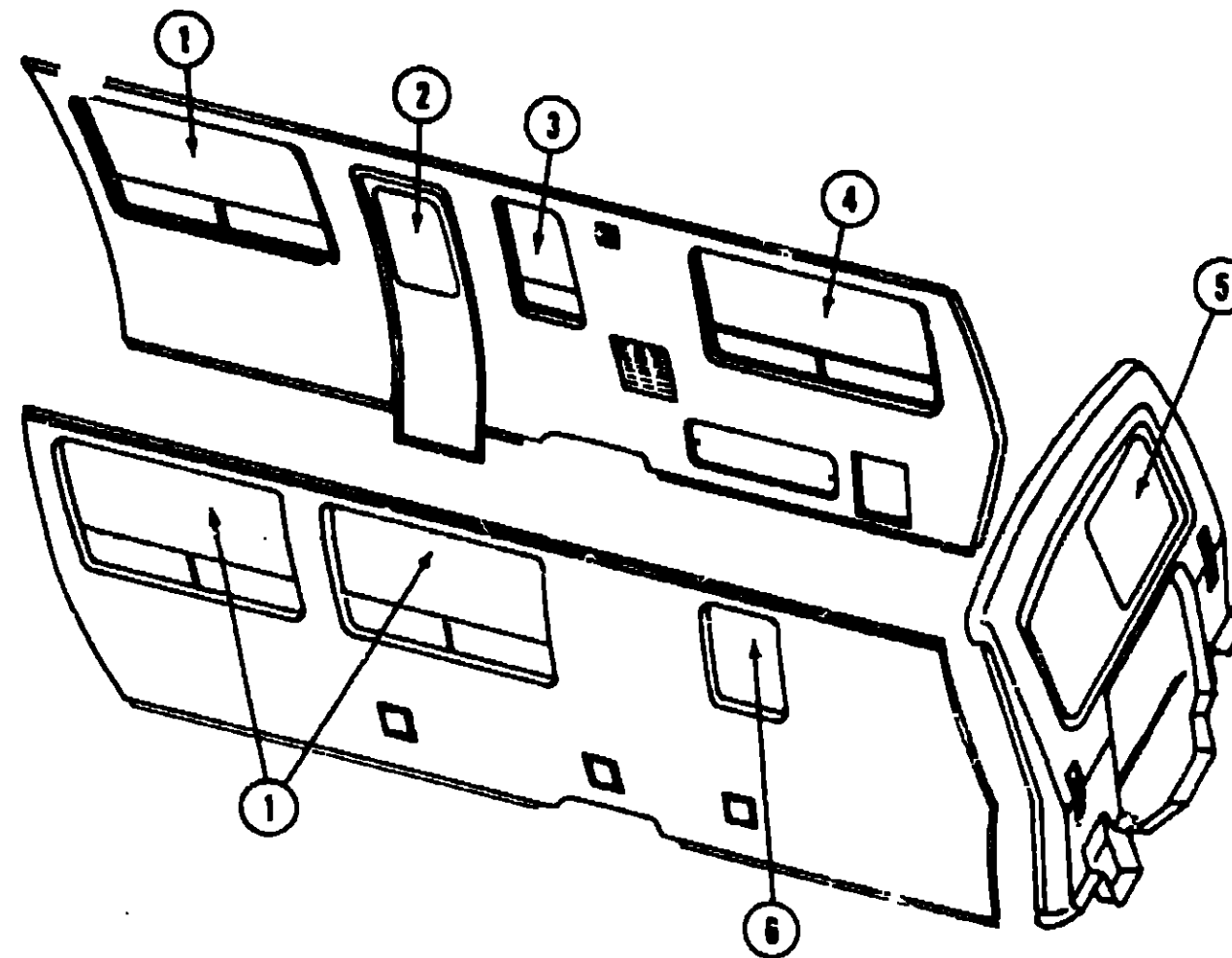

1985 WINNEBAGO TABLE OF CONTENTS

WC420RG
WCN23RG
WCP31RT
WCN31RT

A-01 - C-02
C-03 - E-10
E-11 - G-14
G-15 - I-24

CURTAINS, VALANCES, SHADES & TIEBACKS

Key	Part Number	U/M	Description
1	077444-03-T06	EA	Curtain w/Tape Top & Bottom - 37.5" x 18" - Blue
1	077444-03-T07	EA	Curtain w/Tape Top & Bottom - 37.5" x 18" - Peach
1	077444-03-T08	EA	Curtain w/Tape Top & Bottom - 37.5" x 18" - Rust
1	077502-13-000	EA	Woven Wood Shade - 64.5" Wide x 35" (T06)
1	077502-14-000	EA	Woven Wood Shade - 64.5" Wide x 36" (T07)
1	077502-15-000	EA	Woven Wood Shade - 64.5" Wide x 36" (T08)
2	M77188-02-T06	EA	Valance Asm. - 4.3" x 31.6" - Blue
2	M77188-02-T07	EA	Valance Asm. - 4.3" x 31.6" - Peach
2	M77188-02-T08	EA	Valance Asm. - 4.3" x 31.6" - Rust
2	079091-07-000	EA	Shade Asm. - Fabric - 22.25" x 40" (T06)
2	079091-14-000	EA	Shade Asm. - Fabric - 22.25" x 40" (T07, T08)
3	075477-01-000	EA	Blinds - Galley
4	077444-05-T06	EA	Curtain w/Darts - 37.5" x 18" - Bedspread - Blue
4	077444-05-T07	EA	Curtain w/Darts - 37.5" x 18" - Bedspread - Peach
4	077444-05-T08	EA	Curtain w/Darts - 37.5" x 18" - Bedspread - Rust
4	079082-01-000	EA	Shade Asm. - Fabric - 64.25" x 48" (T06)
4	079082-03-000	EA	Shade Asm. - Fabric - 64.25" x 48" (T07, T08)

CURTAINS, VALANCES SHADES & TIEBACKS (CONT.)

Key	Part Number	U/M	Description
5	077444-06-T06	EA	Curtain w/Darts - 35.5" x 18" - Bedspread - Blue
5	077444-06-T07	EA	Curtain w/Darts - 35.5" x 18" - Bedspread - Peach
5	077444-06-T08	EA	Curtain w/Darts - 35.5" x 18" - Bedspread - Rust
5	M81014-01-T06	EA	Valance Asm. - Bedspread (Bedroom) - Blue
5	M81014-01-T07	EA	Valance Asm. - Bedspread (Bedroom) - Peach
5	M81014-01-T08	EA	Valance Asm. - Bedspread (Bedroom) - Rust
5	079082-02-000	EA	Shade Asm. - Fabric - 30" x 46" (T06)
5	079082-04-000	EA	Shade Asm. - Fabric - 30" x 48" (T07, T08)
6	075477-01-000	EA	Blinds - Bath (T06)
.	073304-31-T06	EA	Curtain w/Snaps - Front Wraparound - Passenger Side
.	073304-32-T06	EA	Curtain w/Snaps - Front Wraparound - Driver Side
.	077591-01-T06	EA	Curtain w/Velcro Top - 52" x 40" - Blackout
.	077591-02-T06	EA	Curtain w/Velcro Top - 52" x 42" - Blackout
.	073260-16-T06	EA	Tie Back Asm. - 3" x 20" - Blue
.	073260-16-T07	EA	Tie Back Asm. - 3" x 20" - Peach
.	073260-16-T08	EA	Tie Back Asm. - 3" x 20" - Rust
.	057534-05-000	EA	Tie Back Asm. - Vinyl - 6" - Brown
.	057534-01-000	EA	Tie Back - Clear Plastic - 6"
.	057534-03-000	EA	Tie Back - Clear Plastic - 7.5"
.	057534-04-000	EA	Tie Back - Clear Plastic - 20"
.			Not illustrated

1985 WCP31RC INDEX

Floor Plan	E-11 - E-12
Accessories Group	E-13 - E-15
Bath Group	E-16
Chassis Group	E-17 - E-22
Curtain, Cushion & Pad Group	E-23 - F-05
Dinette Group	F-06
Driver's Compartment Group	F-07 - F-10
Electrical Group	F-11 - F-13
Exterior Body Group	F-14 - F-23
Galley Group	F-24 - G-02
Heating & Air Conditioning Group	G-03
Interior Finish Group	G-04 - G-05
LP Group	G-06
Lounge Group	G-07
Water & Sewage Group	G-08
Window, Vent & Exterior Door Group	G-09 - G-14

CURTAIN, CUSHION & PAD GROUP (CONTINUED)

CURTAIN, CUSHION & PAD GROUP (CONTINUED)

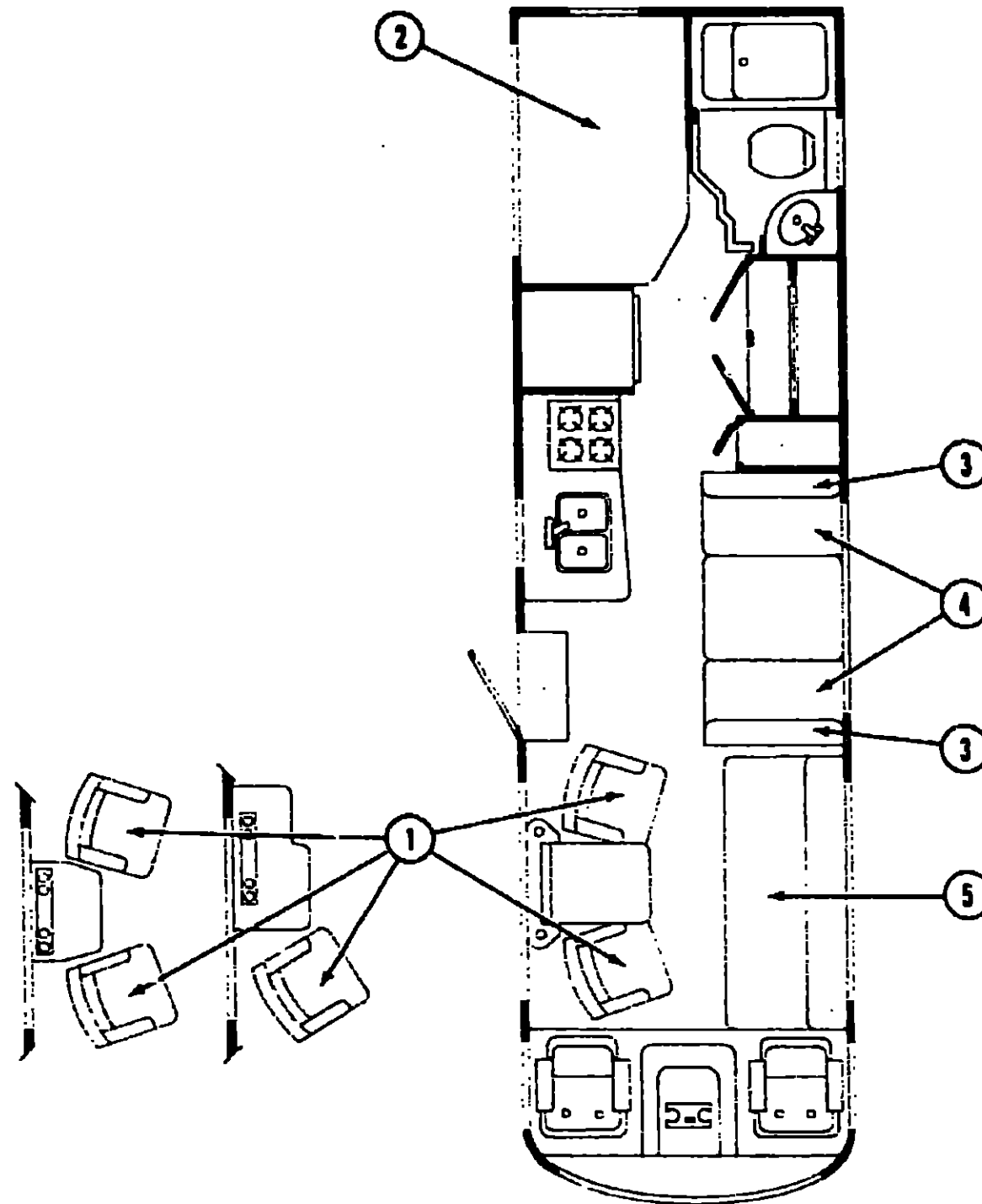

SWIVEL CHAIRS

Key	Part Number	U/M	Description
1	073518-07-T06	EA	Chair Asm. w/Pillow Back - Swivel - Blue
1	073518-07-T07	EA	Chair Asm. w/Pillow Back - Swivel - Peach
1	073518-07-T08	EA	Chair Asm. w/Pillow Back - Swivel - Rust
	075174-02-T06	EA	Skirt Asm. - Swivel Chair - Blue
	075174-02-T07	EA	Skirt Asm. - Swivel Chair - Peach
	075174-02-T08	EA	Skirt Asm. - Swivel Chair - Rust
	035036-01-000	EA	Plate - Tilt & Swivel - Swivel Chair
	035036-05-000	EA	Extension - 7" - Swivel Chair
	035036-04-000	EA	Base w/Legs - Swivel Chair

SINGLE & DOUBLE BED

Key	Part Number	U/M	Description
2	079389-01-000	EA	Mattress - Inner Spring - 48" x 75"
	079371-26-000	EA	Bedspreed - Double Fitted - Blue (T06)
	079371-27-000	EA	Bedspreed - Double Fitted - Peach - Rust (T07, T08)
	077463-02-T06	EA	Headboard Asm. - Double - Blue
	077463-02-T07	EA	Headboard Asm. - Double - Peach
	079390-08-000	EA	Pillow Sham - 20" x 26" - Blue (T06)
	079390-09-000	EA	Pillow Sham - 20" x 26" - Peach - Rust (T07, T08)

DINETTE CUSHIONS

Key	Part Number	U/M	Description
3	072430-53-T06	EA	Cushion - Dinette Back - 19.25" x 38" x 5" - Blue
3	072430-53-T07	EA	Cushion - Dinette Back - 19.25" x 38" x 5" - Peach
3	072430-53-T08	EA	Cushion - Dinette Back - 19.25" x 38" x 5" - Rust
	M72430-53-T06	EA	Cushion - Dinette Back Cushion - 19.25" x 38" x 5" - Blue
	M72430-53-T07	EA	Cushion - Dinette Back Cushion - 19.25" x 38" x 5" - Peach
	M72430-53-T08	EA	Cushion - Dinette Back Cushion - 19.25" x 38" x 5" - Rust
4	072430-54-T06	EA	Cushion - Dinette Bottom - 17.5" x 38" x 5" - Blue
4	072430-54-T07	EA	Cushion - Dinette Bottom - 17.5" x 38" x 5" - Peach
4	072430-54-T08	EA	Cushion - Dinette Bottom - 17.5" x 38" x 5" - Rust
	M72430-54-T06	EA	Cover - Dinette Bottom Cushion - 17.5" x 38" x 5" - Blue
	M72430-54-T07	EA	Cover - Dinette Bottom Cushion - 17.5" x 38" x 5" - Peach
	M72430-54-T08	EA	Cover - Dinette Bottom Cushion - 17.5" x 38" x 5" - Rust

MAGIC BED

Key	Part Number	U/M	Description
5	079054-07-000	EA	Magic Bed - 3 Pillow - Blue (T06)
5	079054-08-000	EA	Magic Bed - 3 Pillow - Peach (T07)
5	079054-09-000	EA	Magic Bed - 3 Pillow - Rust (T08)

FRONT OVERHEAD BUNK CUSHIONS

Key	Part Number	U/M	Description
	079145-02-000	EA	Cushion Asm. - Front Bunk - 30" x 72" x 4"
	M79145-02-000	EA	Cover - Front Bunk Cushion - 30" x 72" x 4"

TRIM PADS

Key	Part Number	U/M	Description
	077123-13-000	EA	Insert - Upper Passenger Door - 2.5" x 6.25" - Blue (T06)
	077123-15-000	EA	Insert - Upper Passenger Door - 2.5" x 6.25" - Peach (T07)
	077123-17-000	EA	Insert - Upper Passenger Door - 2.5" x 6.25" - Rust (T08)
	077123-14-000	EA	Insert - Upper Drivers Door - 2.5" x 6.25" - Blue (T06)
	077123-16-000	EA	Insert - Upper Drivers Door - 2.5" x 6.25" - Peach (T07)
	077123-18-000	EA	Insert - Upper Drivers Door - 2.5" x 6.25" - Rust (T08)
	077124-13-000	EA	Insert - Lower Passenger Door - 14.2" x 28.25" - Blue (T06)
	077124-15-000	EA	Insert - Lower Passenger Door - 14.2" x 28.25" - Peach (T07)
	077124-17-000	EA	Insert - Lower Passenger Door - 14.2" x 28.25" - Rust (T08)
	077124-14-000	EA	Insert - Lower Drivers Door - 14.2" x 28.25" - Blue (T06)
	077124-16-000	EA	Insert - Lower Drivers Door - 14.2" x 28.25" - Peach (T07)
	077124-18-000	EA	Insert - Lower Drivers Door - 14.2" x 28.25" - Rust (T08)

1985 WINNEBAGO TABLE OF CONTENTS

WC420RG	A-01 - C-02
WCN23RG	C-03 - E-10
WCP31RT	E-11 - G-14
WCN31RT	G-15 - I-24

1985 WCP31RC INDEX

Floor Plan	E-11 - E-12
Accessories Group	E-13 - E-15
Bath Group	E-16
Chassis Group	E-17 - E-22
Curtain, Cushion & Pad Group	E-23 - F-05
Dinette Group	F-06
Driver's Compartment Group	F-07 - F-10
Electrical Group	F-11 - F-13
Exterior Body Group	F-14 - F-23
Galley Group	F-24 - G-02
Heating & Air Conditioning Group	G-03
Interior Finish Group	G-04 - G-05
LP Group	G-06
Lounge Group	G-07
Water & Sewage Group	G-08
Window, Vent & Exterior Door Group	G-09 - G-14

CURTAIN, CUSHION & PAD GROUP (CONTINUED)

TRIM PADS (CONT.)

Key	Part Number	U/M	Description
	077125-13-000	EA	Insert - Map Pocket - Passenger Door - 5.75" x 7.6" - Blue (T06)
	077125-15-000	EA	Insert - Map Pocket - Passenger Door - 5.75" x 7.6" - Peach (T07)
	077125-17-000	EA	Insert - Map Pocket - Passenger Door - 5.75" x 7.6" - Rust (T08)
	077125-14-000	EA	Insert - Map Pocket - Drivers Door - 5.75" x 7.6" - Blue (T06)
	077125-16-000	EA	Insert - Map Pocket - Drivers Door - 5.75" x 7.6" - Peach (T07)
	077125-18-000	EA	Insert - Map Pocket - Drivers Door - 5.75" x 7.6" - Rust (T08)
	077614-33-000	EA	Insert - Double Bed - Roof Cove - 9.25" x 89.75" - Blue (T06)
	077614-38-000	EA	Insert - Double Bed - Roof Cove - 9.25" x 89.75" - Peach (T07)
	077614-43-000	EA	Insert - Double Bed - Roof Cove - 9.25" x 89.75" - Rust (T08)
	077614-31-000	EA	Insert - Bath - Roof Cove - 9.25" x 35" - Blue (T06)
	077614-36-000	EA	Insert - Bath - Roof Cove - 9.25" x 35" - Peach (T07)
	077614-41-000	EA	Insert - Bath - Roof Cove - 9.25" x 35" - Rust (T08)
	077614-31-000	EA	Insert - Entrance Door - Roof Cove - 9.25" x 41.25" - Blue (T06)
	077614-36-000	EA	Insert - Entrance Door - Roof Cove - 9.25" x 41.25" - Peach (T07)
	077614-41-000	EA	Insert - Entrance Door - Roof Cove - 9.25" x 41.25" - Rust (T08)
	077641-29-000	EA	Insert - TT Chair Lounge - 12" x 16" - Blue (T06)
	077641-31-000	EA	Insert - TT Chair Lounge - 12" x 16" - Peach (T07)
	077641-33-000	EA	Insert - TT Chair Lounge - 12" x 16" - Rust (T08)
	077641-28-000	EA	Insert - Dinette Lounge - 12" x 12" - Blue (T06)
	077641-30-000	EA	Insert - Dinette Lounge - 12" x 12" - Peach (T07)
	077641-32-000	EA	Insert - Dinette Lounge - 12" x 12" - Rust (T08)
	077130-07-000	EA	Insert - Front Center Overhead - 19.5" x 4" - Blue (T06)
	077130-08-000	EA	Insert - Front Center Overhead - 19.5" x 4" - Peach (T07)
	077130-09-000	EA	Insert - Front Center Overhead - 19.5" x 4" - Rust (T08)
	077131-13-000	EA	Insert - Front Overhead (Sunvisor) Right - 2.8" x 23.2" - Blue (T06)
	077131-15-000	EA	Insert - Front Overhead (Sunvisor) Right - 2.8" x 23.2" - Peach (T07)
	077131-17-000	EA	Insert - Front Overhead (Sunvisor) Right - 2.8" x 23.2" - Rust (T08)
	077131-14-000	EA	Insert - Front Overhead (Sunvisor) Left - 2.8" x 23.2" - Blue (T06)
	077131-16-000	EA	Insert - Front Overhead (Sunvisor) Left - 2.8" x 23.2" - Peach (T07)
	077131-18-000	EA	Insert - Front Overhead (Sunvisor) Left - 2.8" x 23.2" - Rust (T08)
	077126-07-000	EA	Insert - Side Upper - Drivers - 2.6" x 3.14" - Blue (T06)
	077126-08-000	EA	Insert - Side Upper - Drivers - 2.6" x 3.14" - Peach (T07)
	077126-09-000	EA	Insert - Side Upper - Drivers - 2.6" x 3.14" - Rust (T08)
	077126-07-000	EA	Insert - Side Upper - Passenger - 2.6" x 17.1" - Blue (T06)
	077126-08-000	EA	Insert - Side Upper - Passenger - 2.6" x 17.1" - Peach (T07)
	077126-09-000	EA	Insert - Side Upper - Passenger - 2.6" x 17.1" - Rust (T08)
	077127-07-000	EA	Insert - Side Lower - Drivers - 9.3" x 21.3" - Blue (T06)
	077127-08-000	EA	Insert - Side Lower - Drivers - 9.3" x 21.3" - Peach (T07)
	077127-09-000	EA	Insert - Side Lower - Drivers - 9.3" x 21.3" - Rust (T08)
	077129-07-000	EA	Insert - Side Lower - Passenger - 9.2" x 28" - Blue (T06)
	077129-08-000	EA	Insert - Side Lower - Passenger - 9.2" x 28" - Peach (T07)
	077129-09-000	EA	Insert - Side Lower - Passenger - 9.2" x 28" - Rust (T08)
	077133-07-000	EA	Insert - Lower Bunk - 22.5" x 67.1" - Blue (T06)
	077133-08-000	EA	Insert - Lower Bunk - 22.5" x 67.1" - Peach (T07)
	077133-09-000	EA	Insert - Lower Bunk - 22.5" x 67.1" - Rust (T08)
	077132-07-000	EA	Insert - Bunk - Rear - 8.75" x 74.5" - Blue (T06)
	077132-08-000	EA	Insert - Bunk - Rear - 8.75" x 74.5" - Peach (T07)
	077132-09-000	EA	Insert - Bunk - Rear - 8.75" x 74.5" - Rust (T08)
	077513-07-000	EA	Insert - Bunk - Rear Upper - 5" x 56" - Blue (T06)
	077513-08-000	EA	Insert - Bunk - Rear Upper - 5" x 56" - Peach (T07)
	077513-09-000	EA	Insert - Bunk - Rear Upper - 5" x 56" - Rust (T08)
	079144-01-T06	EA	Bunk Pull Strap - Blue
	079144-01-T07	EA	Bunk Pull Strap - Peach
	079144-01-T08	EA	Bunk Pull Strap - Rust
	077968-01-000	EA	Pad Retainers - Plastic
	074549-10-T06	EA	Pad Asm. - Dinette Seat - Front - Blue
	074549-10-T07	EA	Pad Asm. - Dinette Seat - Front - Peach
	074549-10-T08	EA	Pad Asm. - Dinette Seat - Front - Rust
	074549-11-T06	EA	Pad Asm. - Dinette Seat - Rear - Blue
	074549-11-T07	EA	Pad Asm. - Dinette Seat - Rear - Peach
	074549-11-T08	EA	Pad Asm. - Dinette Seat - Rear - Rust

DINETTE GROUP

SWIVEL CHAIRS W/PULLOUT TABLE

Key	Part Number	U/M	Description
	M78802-02-T06	EA	Table Asm. - Foldout - Empire Walnut
	M01837-01-T06	EA	Countertop Asm. - Table - Pullout
	M01838-01-T06	EA	Countertop Asm. - Foldout Table Cabinet - TV - Shelf
	M01839-01-T06	EA	Hinged Lid - Pullout Tables - w/o Hardware
	M01836-01-T06	EA	Countertop Asm. - Pullout Table Cup Holder
	078832-03-T06	EA	Cabinet Asm. - Overhead - w/o Doors or Hardware
	M78802-01-T06	EA	Door Asm. - Overhead Cabinet - w/o Hardware
	035036-04-000	EA	Base w/Leg - Swivel Chair
	035036-05-000	EA	Extension - 7" - Swivel Chair
..	NOTE	EA	Swivel Chairs
	079806-01-T06	EA	Magazine Rack
	074549-10-T06	EA	Pad Asm. - Dinette - Right Hand - Blue
	074549-10-T07	EA	Pad Asm. - Dinette - Right Hand - Peach
	074549-10-T08	EA	Pad Asm. - Dinette - Right Hand - Rust
	074549-11-T06	EA	Pad Asm. - Dinette - Left Hand - Blue
	074549-11-T07	EA	Pad Asm. - Dinette - Left Hand - Peach
	074549-11-T08	EA	Pad Asm. - Dinette - Left Hand - Rust
..	See Curtain, Cushion & Pad Group		

SWIVEL CHAIR & ENTERTAINMENT CENTER

Key	Part Number	U/M	Description
	M78977-03-T06	EA	Cabinet Asm. - Entertainment Center
	M01619-01-T06	EA	Countertop - Entertainment Center - Empire Walnut
	077582-01-T06	EA	Bottle Holder - Lower
	077583-01-T06	EA	Bottle Holder - Upper
	077663-02-T06	EA	Glass Holder
	077773-01-T06	EA	Wineglass Guide
	M78905-05-T06	EA	Door Asm. - 9.75" x 26.25" - Right Hand
	M78905-06-T06	EA	Door Asm. - 9.75" x 26.25" - Left Hand
	076799-01-000	EA	Ice Maker - Black Glass
	074489-02-T06	EA	Beverage Holder - w/Tray
..	NOTE	EA	Swivel Chair
..	See Curtain, Cushion & Pad Group		

SWIVEL CHAIRS & ICE MAKER

Key	Part Number	U/M	Description
	M77600-01-T06	EA	Cabinet Asm. - Ice Maker
	M01636-01-T06	EA	Countertop Asm. - Ice Maker - Empire Walnut
	M01637-01-T06	EA	Slideout Table
	076799-01-000	EA	Ice Maker - Black Glass
	078238-02-T06	EA	Access Panel
	074489-02-T06	EA	Beverage Holder - w/Tray
..	NOTE	EA	Swivel Chairs
..	See Curtain, Cushion & Pad Group		

DINETTE

Key	Part Number	U/M	Description
	M78903-03-T06	EA	Door Asm. - Dinette Seat Cabinet - Right - w/o Hardware
	M01858-03-T06	EA	Cabinet Asm. - Dinette Seat - Right - w/o Door or Hardware
	M01858-04-T06	EA	Cabinet Asm. - Dinette Seat - Left
	M01859-03-T06	EA	Cabinet Asm. - Dinette Seat Back - Left
	M01859-04-T06	EA	Cabinet Asm. - Dinette Seat Back - Right
	M75501-01-T06	EA	Table Asm. - Dinette - w/o Hardware - Empire Walnut
	053200-05-000	EA	Bracket - Upper Wall Mount - 23.5" - Beige
	053201-03-000	EA	Bracket - Table Mount - 23"
	024275-05-000	EA	Rod - Table Lift - 8" x 23.5" - Beige
	024276-14-000	EA	Leg Asm. - Table - 29.5" - Brown
	024281-07-000	EA	Bracket - Lower Wall Mount - 22.12" - Beige
	024282-01-000	EA	Brace - Table Leg
	024283-01-000	EA	Clip - 1" O.D. Tube
	049493-02-000	EA	Catch - Table Leg - Mount on Floor - Brown
	064050-01-000	EA	Hinge - Table Leg
	064781-03-000	EA	Cup Holder - 3.5" x 1.5"

1985 WINNEBAGO
TABLE OF CONTENTS

WC420RG	A-01 - C-02
WCN23RG	C-03 - E-10
WCP31RT	E-11 - G-14
WCN31RT	G-15 - I-24

1985 WCP31RC INDEX

Floor Plan	E-11 - E-12
Accessories Group	E-13 - E-15
Bath Group	E-16
Chassis Group	E-17 - E-22
Curtain, Cushion & Pad Group	E-23 - F-05
Dinette Group	F-06
Driver's Compartment Group	F-07 - F-10
Electrical Group	F-11 - F-13
Exterior Body Group	F-14 - F-23
Galley Group	F-24 - G-02
Heating & Air Conditioning Group	G-03
Interior Finish Group	G-04 - G-05
LP Group	G-06
Lounge Group	G-07
Water & Sewage Group	G-08
Window, Vent & Exterior Door Group	G-09 - G-14

DRIVERS COMPARTMENT GROUP

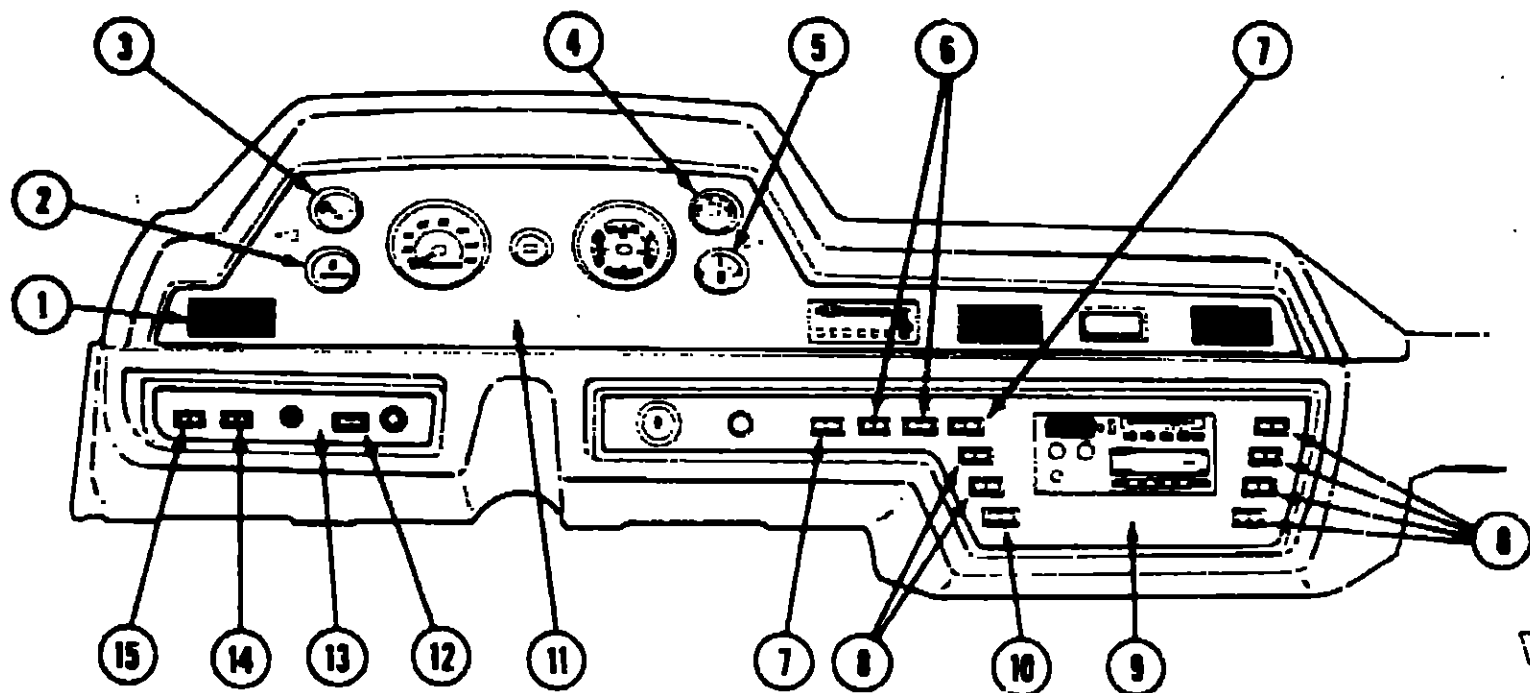

DASH SWITCHES AND GAUGES

Key	Part Number	U/M	Description
1	076783-02-000	EA	Louver Asm. - A/C Adjustable
2	031035-02-000	EA	Gauge - Hour meter - Generator
3	024480-04-000	EA	Gauge - Vacuum
4	024459-04-000	EA	Gauge - Voltmeter
5	076781-01-000	EA	Gauge - Auxiliary Fuel
6	076759-05-000	EA	Switch - 3 Position
7	076759-04-000	EA	Switch - 3 Position
8	076759-01-000	EA	Switch - 2 Position
9	076217-01-000	FA	Instrument Panel - Lower
10	076800-01-000	EA	Switch w/Thermometer
11	076216-01-000	EA	Instrument Panel - Upper
12	076759-07-000	EA	Switch - 2 Position
13	076218-01-000	EA	Instrument Panel - Lower Left
14	076759-02-000	EA	Switch - 2 Position
15	076759-03-000	EA	Switch - 3 Position
.	077470-01-000	EA	Dash Panel - Right Upper
.	076797-01-000	EA	Bezel - Upper Right
.	076734-01-000	EA	Beverage Tray - Lower Right
.			Not illustrated

DRIVER'S COMPARTMENT GROUP (CONTINUED)

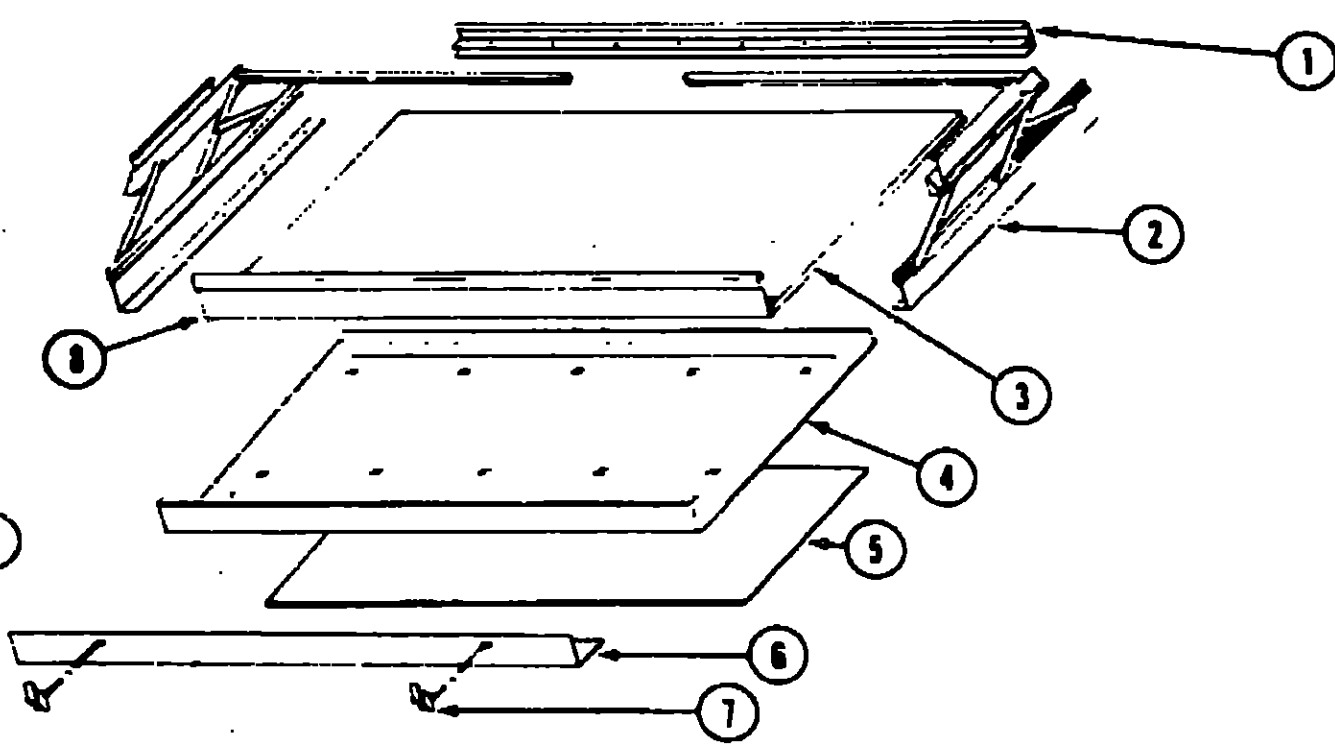

FRONT BUNK & HARDWARE

Key	Part Number	U/M	Description
1	077246-01-000	EA	Bunk Rail - Front - Beige
1	077246-03-000	EA	Bunk Rail - Front - Brown
2	076760-01-000	EA	Bunk Supports - Overhead - Complete
.	077110-01-000	EA	Cover - Bunk Support - Right
.	077110-02-000	EA	Cover - Bunk Support - Left
3	077243-01-T06	EA	Bunkboard Asm. - w/Rails - Beige
3	077243-03-T06	EA	Bunkboard Asm. - w/Rails - Brown
4	077121-01-000	EA	Trim Panel - Front Bunk
5	077133-09-T06	EA	Bunk Insert - Lower - Blue
5	077133-09-T07	EA	Bunk Insert - Lower - Peach
5	077133-09-T08	EA	Bunk Insert - Lower - Rust
6	077132-09-T06	EA	Bunk Insert - Rear - Blue
6	077132-09-T07	EA	Bunk Insert - Rear - Peach
6	077132-09-T08	EA	Bunk Insert - Rear - Rust
.	077513-07-000	EA	Bunk Insert - Rear Upper (Mounts to Roof) Blue (R06)
.	077513-08-000	EA	Bunk Insert - Rear Upper (Mounts to Roof) Peach (R07)
.	077513-09-000	EA	Bunk Insert - Rear Upper (Mounts to Roof) Rust (R08)
7	042541-01-000	EA	Latch Asm. - w/Strike - Chrome
8	077244-01-000	EA	Bunk Rail - Rear - Beige
8	077244-03-000	EA	Bunk Rail - Rear - Brown
.	079144-01-T06	EA	Bunk Strap - Blue
.	079144-01-T07	EA	Bunk Strap - Peach
.	079144-01-T08	EA	Bunk Strap - Rust
.			Not illustrated

1985 WINNEBAGO
TABLE OF CONTENTS

WC420RG
WCN23RG
WCP31RT
WCN31RT

A-01 - C-02
C-03 - E-10
E-11 - G-14
G-15 - I-24

1985 WCP31RC INDEX

Floor Plan	E-11 - E-12
Accessories Group	E-13 - E-15
Bath Group	E-16
Chassis Group	E-17 - E-22
Curtain, Cushion & Pad Group	E-23 - F-05
Dinette Group	F-06
Driver's Compartment Group	F-07 - F-10
Electrical Group	F-11 - F-13
Exterior Body Group	F-14 - F-23
Galley Group	F-24 - G-02
Heating & Air Conditioning Group	G-03
Interior Finish Group	G-04 - G-05
LP Group	G-06
Lounge Group	G-07
Water & Sewage Group	G-08
Window, Vent & Exterior Door Group	G-09 - G-14

DRIVER'S COMPARTMENT GROUP (CONTINUED)

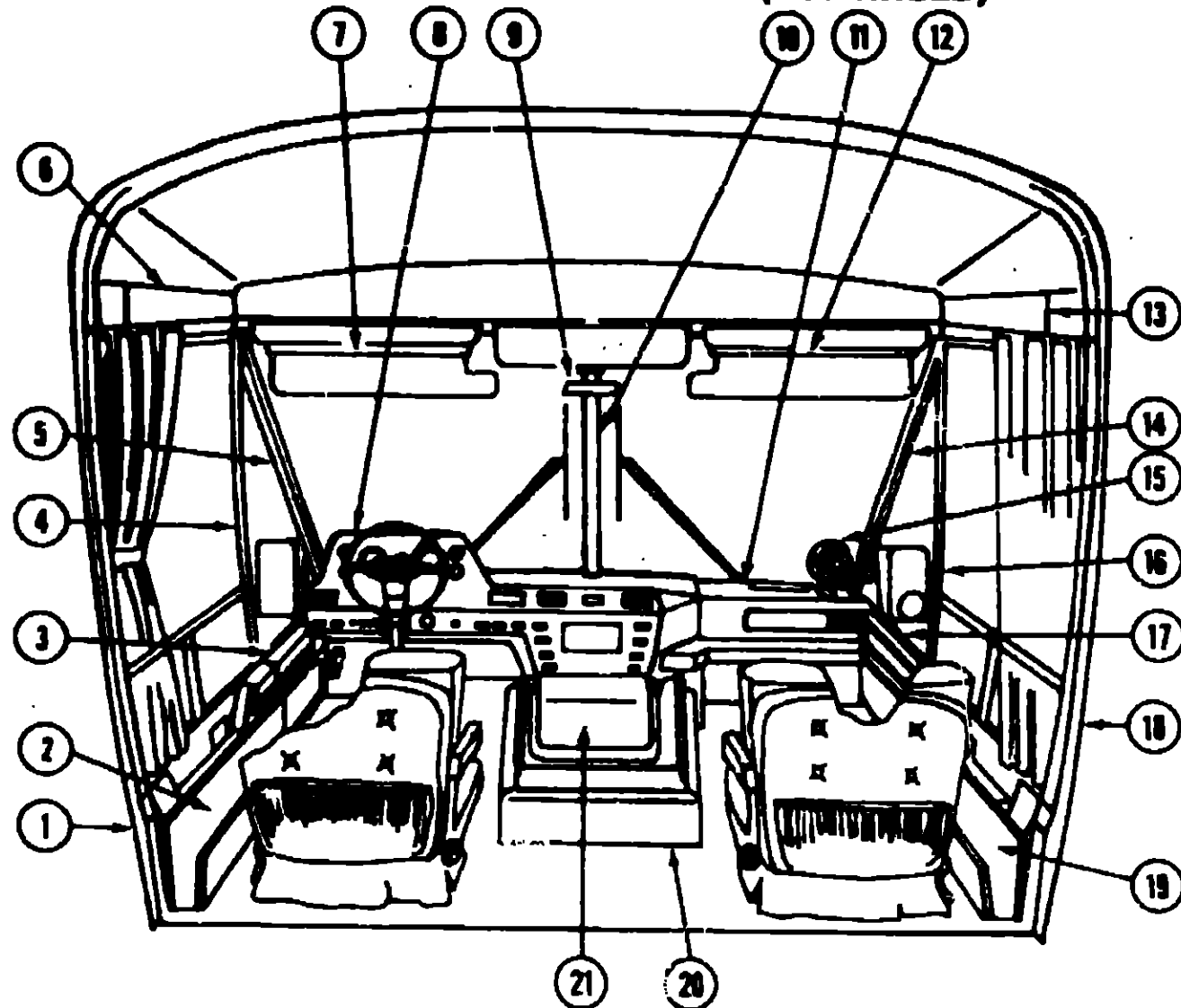

MISCELLANEOUS DRIVER'S COMPARTMENT COMPONENTS

Key	Part Number	U/M	Description
1	077111-02-000	EA	Trim Panel - Drivers Side - Beige
2	077117-02-000	EA	Trim - Side Panel - Door - Beige
3	077115-01-000	EA	Trim - Side Panel - Front - Beige
4	077113-02-000	EA	Trim Panel - Hinge Pillar - Beige
5	077112-02-000	EA	Trim - Windshield - Interior - "A" Post - Left - Beige
6	077110-02-000	EA	Trim Cover - w/Bunk - Left - Beige
7	076765-01-000	EA	Sunvisor Asm. - Drivers - Vinyl - Beige
8	077469-01-000	EA	Dash Panel - Left Upper
9	040714-01-000	EA	Mirror - Inside - Rearview - Glare Proof
	067490-01-000	EA	Button - Mirror - Rearview - Support
10	077114-01-000	EA	Trim Panel - Pillar - Center - Beige
	024990-02-000	EA	Outlet - Defroster w/Swivel - 2" Dark Brown
	076783-01-000	EA	Louver Asm. - A/C Adjustable
11	077470-01-000	EA	Dash Panel - Right Hand
12	076765-01-000	EA	Sunvisor Asm. - Vinyl - Beige
13	077110-01-000	EA	Trim Cover - w/Bunk - Right - Beige
14	077112-01-000	EA	Trim - Windshield - Interior - "A" Post - Right - Beige
15	036420-02-000	EA	Defroster Fan
16	077113-01-000	EA	Trim Panel - Hinge Pillar - Beige
17	077115-01-000	EA	Trim - Side Panel - Front - Beige
18	077111-01-000	EA	Trim Panel - Passenger Side - Beige
19	077117-01-000	EA	Trim - Side Panel - Door - Beige
20	077660-01-000	EA	Motor Cover
21	076729-01-000	EA	Beverage Tray (Support) - Beige
	077431-01-000	EA	Beverage Tray - Oak
	052367-01-000	EA	Cigarette Lighter
	Not illustrated		

DRIVER'S COMPARTMENT GROUP (CONTINUED)

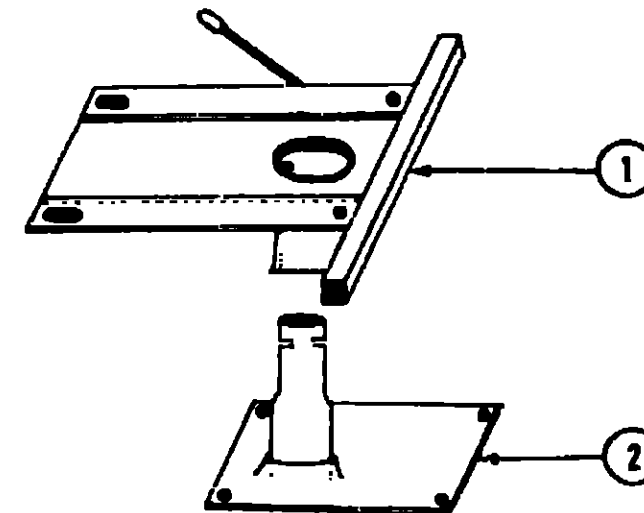

BUCKET SEAT PEDESTAL & SEAT BELTS

Key	Part Number	U/M	Description
1	079585-04-000	EA	Plate - Top - Pedestal Asm. - Single Bucket Seat
1	035585-10-000	EA	Plate - Top - Pedestal Asm. - Double Bucket Seat
2	069585-06-000	EA	Plate - Sub - Pedestal Asm. - Bucket Seat
	007019-01-000	EA	Belt Asm. - Seat - 2" x 84" - Black
	007021-01-000	EA	Belt Asm. - Seat - 2" x 90" - Black
	056271-02-000	EA	Belt Asm. - Seat - 2" x 72" - Black
	041322-01-000	EA	Washer - Flat 15/32" I.D. x 2 3/8" O.D. - Seat Belt
	058375-01-000	EA	Bracket - Seat Belt - Washer
	069246-01-000	EA	Adjuster Asm. - Seat - w/Lock
	069246-02-000	EA	Adjuster Asm. - Seat - w/o Lock
	Not illustrated		

1985 WINNEBAGO TABLE OF CONTENTS

WC420RG
WCN23RG
WCP31RT
WCN31RT

A-01 - C-02
C-03 - E-10
E-11 - G-14
G-15 - I-24

1985 WCP31RC INDEX

Floor Plan	E-11 - E-12
Accessories Group	E-13 - E-15
Bath Group	E-16
Chassis Group	E-17 - E-22
Curtain, Cushion & Pad Group	E-23 - F-05
Dinette Group	F-06
Driver's Compartment Group	F-07 - F-10
Electrical Group	F-11 - F-13
Exterior Body Group	F-14 - F-23
Galley Group	F-24 - G-02
Heating & Air Conditioning Group	G-03
Interior Finish Group	G-04 - G-05
LP Group	G-06
Lounge Group	G-07
Water & Sewage Group	G-08
Window, Vent & Exterior Door Group	G-09 - G-14

ELECTRICAL GROUP

BULBS

Key	Part Number	U/M	Description
	037935-01-000	EA	Bulb - 1157
	063914-01-000	EA	Bulb - 1139
	008103-01-000	EA	Bulb - 53
	008213-01-000	EA	Bulb - 57
	008214-01-000	EA	Bulb - 67
	008215-01-000	EA	Bulb - 1003
	008216-01-000	EA	Bulb - 1034
	008217-01-000	EA	Bulb - 1073
	008218-01-000	EA	Bulb - 1141
	008220-01-000	EA	Bulb - 12V - 25W
	036198-01-000	EA	Bulb - 194
	067479-01-000	EA	Bulb - 1076 - 12V - 1.80 Amp.

FUSES AND CIRCUIT BREAKERS

Key	Part Number	U/M	Description
	056473-02-000	EA	Fuse - Slow Blow - 5 Amp. - 32 Volt Capacity
	056473-01-000	EA	Fuse - Slow Blow - 6 1/4 Amp.
	008233-01-000	EA	Fuse - 12 Volt - 6 Amp.
	008234-01-000	EA	Fuse - 12 Volt - 10 Amp.
	046883-01-000	EA	Fuse - 12 Volt - 13 Amp.
	008235-01-000	EA	Fuse - 12 Volt - 15 Amp.
	008236-01-000	EA	Fuse - 12 Volt - 20 Amp.
	008246-01-000	EA	Fuse - 110 Volt - 30 Amp. - AGU
	008252-01-000	EA	Fuse - 110 Volt - 50 Amp.
	062901-02-000	EA	Fuse - Automotive - 5 Amp.
	062901-05-000	EA	Fuse - Automotive - 15 Amp.
	044486-03-000	EA	Circuit Breaker - 12 Volt - 25 Amp. - DC
	008208-01-000	EA	Circuit Breaker - 12 Volt - 40 Amp.
	008211-01-000	EA	Circuit Breaker - 12 Volt - 6 Amp.
	008268-01-000	EA	Circuit Breaker - 12 Volt - 30 Amp. w/Mount
	033573-02-000	EA	Circuit Breaker - 12 Volt - 15 Amp. w/Mount
	033573-01-000	EA	Circuit Breaker - 12 Volt - 20 Amp. w/Mount
	040051-01-000	EA	Circuit Breaker - 110 Volt - 20 Amp. TQL
	071279-01-000	EA	Circuit Breaker - 120 Volt - 15 Amp.
	008273-03-000	EA	Circuit Breaker - 15/20 Amp. TQL
	008299-01-000	EA	Circuit Breaker - 115 Amp. TQL
	008297-01-000	EA	Circuit Breaker - 120 Amp. TQL
	008293-01-000	EA	Circuit Breaker - 130 Amp. TQL
	071279-02-000	EA	Circuit Breaker - 15/15 Amp. - 120 Volt
	071279-03-000	EA	Circuit Breaker - 15/20 Amp. - 120 Volt
	071279-04-000	EA	Circuit Breaker - 30 Amp. - 120 Volt
	075735-02-000	EA	Circuit Breaker - GF 115 Amp. - 120 Volt
	071279-05-000	EA	Circuit Breaker - 20 Amp. - 120 Volt
	071279-06-000	EA	Circuit Breaker - 30/15 Amp. - 120 Volt
	071279-07-000	EA	Circuit Breaker - 20/20 Amp. - 120 Volt
	071280-01-000	EA	Circuit Breaker Blank

MISCELLANEOUS ELECTRICAL COMPONENTS

Key	Part Number	U/M	Description
	063739-01-000	EA	Battery - 12 Volt - 80 Amp. Gould
	008188-01-000	EA	Solenoid - Dual Battery - Relay
	024459-04-000	EA	Gauge - Voltmeter - w/o Bracket
	031035-02-000	EA	Gauge - Hourmeter - Generator
	024460-04-000	EA	Gauge - Vacuum - w/o Bracket
	008343-01-000	EA	Wire Tie - Plastic - 6"
	052367-01-000	EA	Lighter Asm. - Cigarette
	071278-02-000	EA	Control Center - 45 Amp.
	071278-01-700	EA	Door - w/Catch - Brown
	071278-01-701	EA	Converter Module
	071278-01-702	EA	Label - 45 Amp.
	071278-01-703	EA	Door Catch
	036420-02-000	EA	Fan - 6" Defroster - 2 Speed

ELECTRICAL GROUP (CONTINUED)

WINDSHIELD WIPER & WASHER

Key	Part Number	U/M	Description
	056000-02-000	EA	Washer Asm. - Windshield - w/o Nozzles
	072472-04-000	EA	Arm - Windshield Wiper - 29" - Black
	048484-03-000	EA	Blade - Windshield Wiper - 20" Black
	067188-01-000	EA	Crank Stud - Wiper
	067190-01-000	EA	Shaft & Pivot Asm. - Wiper
	067192-01-000	EA	Connecting Link Asm. - Drivers Side
	067193-01-000	EA	Connecting Link Asm. - Passenger Side
	067191-01-700	EA	Wiper Motor Asm.
.. The illustrated parts breakdown for this item is provided on the Common Items Fiche.			

WIRE, SWITCHES & RECEPTACLES

Key	Part Number	U/M	Description
	008024-01-000	FT	Wire - 18.5 Bonded - Orange/White/Yellow/Blue/Brown
	008025-01-000	FT	Wire - 18.5 Bonded - Orange/White/Yellow/Blue/Green
	008026-01-000	FT	Wire - 18.5 Bonded - Blue/Red/Yellow/Orange/White
	008277-01-000	EA	Holder - Fuse - Black - Panel Mount
	008054-01-000	EA	Cord - Power - 10-3 30 Amp. - 25' - UL
	008052-01-000	EA	Cord - Power - 10-3 30 Amp. - 25' - CSA
	024571-03-000	EA	Cover Plate - Receptacle - Jumbo Plastic - Brown
	024571-04-000	EA	Cover Plate - Receptacle - Jumbo Plastic - Ivory
	008160-01-000	EA	Cover Plate - Receptacle - Plastic - Ivory
	008164-01-000	EA	Cover Plate - Switch - Brown
	076319-09-000	EA	TV Wall Plate/Receptacle - Brown (Winegard Antenna)
	076319-07-000	EA	TV Wall Plate - Power Supply - Brown (Winegard Antenna)
	074151-01-000	EA	Switch Plate - On/Off - Jensen
	058028-01-000	EA	Connector - Pigtail - Clear - Nylon
	008162-02-000	EA	Switch - Double Toggle - Ivory
	008162-01-000	EA	Switch - Double Toggle - Brown
	008163-01-000	EA	Switch - Toggle Brown
	056264-01-000	EA	Switch - Leaf Actuator
	074007-01-000	EA	Switch - Intermitent - Windshield Wiper
	063912-01-000	EA	Relay - Canister Spot w/Ground
	069238-01-000	EA	Cover - Electrical - 4 x 4 Box
	008058-01-000	EA	Adaptor - Power Cord
	024924-02-000	EA	Receptacle - Power Cord
	058707-01-000	EA	Receptacle - Single - Brown
	058708-01-000	EA	Receptacle - Duplex - Brown
	058708-02-000	EA	Receptacle - Duplex - Ivory
	075736-01-000	EA	Receptacle/Cover - Exterior
	008294-01-000	EA	Cover - Steel - Flat Blank - 4" x 4"
	008288-01-000	EA	Box - Electrical - Plastic - 3" x 3.5"
	008289-01-000	EA	Box - Electrical - Steel - 4 x 4 - 1/2 & 3/4 UL
	058049-01-000	EA	Box - Electrical - 2" 3" x 2.25" - Steel
	064398-01-000	EA	Housing Asm. - Trailer Receptacle
	064399-01-000	EA	Housing Asm. - Trailer Pin
	064450-01-000	EA	Housing Asm. - Trailer Plug
	035417-01-000	EA	Terminal - Pin Receptacle - .125 Dia.
	054532-01-000	EA	Housing Pin - 6 Position
	054532-02-000	EA	Housing Pin - 4 Position
	031968-01-000	EA	Contact - Plug - Brass - Tin Plated
	073937-01-000	EA	Switch - Roof Air - A/C Selector - 3 Deck Rotary
	074151-01-000	EA	Switch - Rocker

1985 WINNEBAGO
TABLE OF CONTENTS

WC420RG
WCN23RG
WCP31RT
WCN31RT

A-01 - C-02
C-03 - E-10
E-11 - G-14
G-15 - I-24

1985 WCP31RC INDEX

Floor Plan	E-11 - E-12
Accessories Group	E-13 - E-15
Bath Group	E-16
Chassis Group	E-17 - E-22
Curtain, Cushion & Pad Group	E-23 - F-05
Dinette Group	F-06
Driver's Compartment Group	F-07 - F-10
Electrical Group	F-11 - F-13
Exterior Body Group	F-14 - F-23
Galley Group	F-24 - G-02
Heating & Air Conditioning Group	G-03
Interior Finish Group	G-04 - G-05
LP Group	G-06
Lounge Group	G-07
Water & Sewage Group	G-08
Window, Vent & Exterior Door Group	G-09 - G-14

ELECTRICAL GROUP (CONTINUED)

EXTERIOR LIGHTS

Key	Part Number	U/M	Description
	075680-02-000	EA	Light Asm. - Rear Side Marker - Red
	075680-01-000	EA	Light Asm. - Side Marker - Amber
	075458-03-000	EA	Socket Asm. - Side Marker
	075458-04-000	EA	Lamp Asm. - Taillight - Red
	075458-05-000	EA	Lamp Asm. - Taillight - Amber
	075458-06-000	EA	Lamp Asm. - Taillight - Back up w/Reflex
	008089-01-000	EA	Light - Porch - Recessed
	079941-01-000	EA	Fog Lamps - w/Cover
	051057-01-000	EA	Searchlight - Power Driven
	076345-01-000	EA	Lens - Park/Turn Light - Amber
	081237-01-000	EA	Light Asm. - Cab Marker - Amber
	081237-02-000	EA	Light Asm. - Cab Marker - Red

INTERIOR LIGHTS

Key	Part Number	U/M	Description
	033508-02-000	EA	Light - Dome - Ivory - 1 Bulb - US
	033508-03-000	EA	Light - Dome - Ivory - 1 Bulb - CSA
	033509-02-000	EA	Light - Dome - Ivory - 2 Bulb - US
	033509-03-000	EA	Light - Dome - Ivory - 2 Bulb - CSA
	061424-01-000	EA	Light - 12 V Receptacle - Aisle - IP
	065202-03-000	EA	Wall Lamp - Decor - 2 Bulb - Brass - (Stationary)
	065202-05-000	EA	Wall Lamp - Decor - 2 Bulb - Brass - 6°
	065202-06-000	EA	Wall Lamp - Decor - 2 Bulb - Brass - 10°
	065201-02-000	EA	Lamp Shade - Fabric - Parchment - Wall Lamp
	077026-01-000	EA	Lens - Courtesy Light - Clear - Front Door Panels
	078424-01-000	EA	Light - Fluorescent 12V - 18"
	079926-01-000	EA	Lamp - Flexible Arm

EXTERIOR BODY GROUP

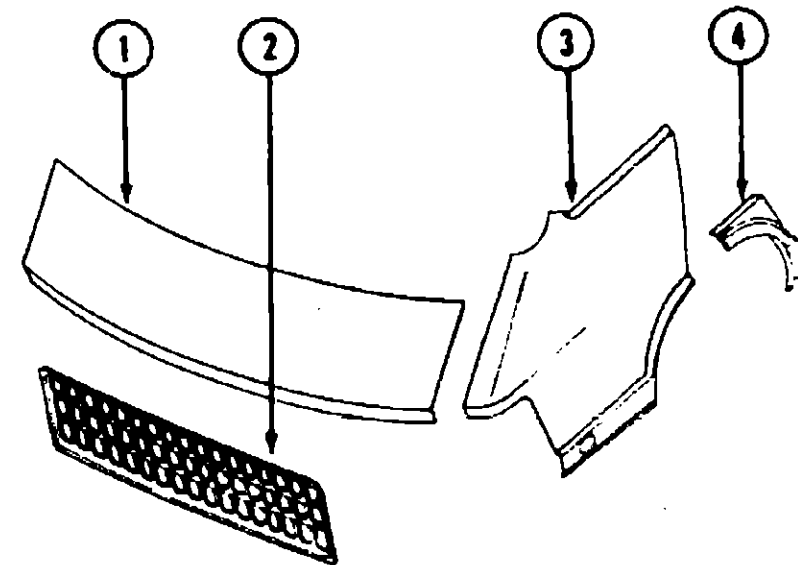

EXTERIOR BODY PANELS (CAB)

Key	Part Number	U/M	Description
1	077229-01-000	EA	Hood Panel
2	076777-02-000	EA	Grill Panel - Gray
2	076777-01-000	EA	Grill - Panel - Chrome
3	075757-03-000	EA	Fender Panel - Front Left
	075757-01-000	EA	Fender Panel - Front Right
4	075759-03-000	EA	Fender Panel - Rear Left
	075759-01-000	EA	Fender Panel - Rear Right
	058786-02-000	EA	Hood Bolt - Adjusting
	R77006-38-499	EA	Spring - Hood Latch Cable
	077257-01-000	EA	Hinge Asm. - Hood - Right
	077257-02-000	EA	Hinge Asm. - Hood - Left
	077252-01-000	EA	Hinge Pin - Stainless Steel
	077407-01-000	EA	Bracket - Hood Release Cable
	070307-01-000	EA	Headlamp Capsule Asm. - High/Low Beam - Left or Right
	076911-01-000	EA	Headlamp Bezel - Chrome - Right Hand
	076911-02-000	EA	Headlamp Bezel - Chrome - Left Hand
	076911-03-000	EA	Headlamp Bezel - Gray - Right Hand
	076911-04-000	EA	Headlamp Bezel - Gray - Left Hand
	075767-01-000	EA	Bumper End - Plastic - Passenger Side - Beige
	075767-03-000	EA	Bumper End - Plastic - Drivers Side - Beige
	076345-01-000	EA	Lamp Asm. - Park/Turn - Amber - Left or Right
	M01615-01-000	EA	Roof Cap - Front Cab
			Not illustrated

MISCELLANEOUS EXTERNALLY MOUNTED PARTS

Key	Part Number	U/M	Description
	011129-01-000	EA	Plumbing Seal - Roof Vent - 1 1/2"
	010230-03-000	EA	Fill - City Water - Recessed - Beige
	058808-02-000	EA	Water Fill - Lockable - Beige

1985 WINNEBAGO TABLE OF CONTENTS

WC420RG	A-01 - C-02
WCN23RG	C-03 - E-10
WCP31RT	E-11 - G-14
WCN31RT	G-15 - I-24

1985 WCP31RC INDEX

Floor Plan	E-11 - E-12
Accessories Group	E-13 - E-15
Bath Group	E-16
Chassis Group	E-17 - E-22
Curtain, Cushion & Pad Group	E-23 - F-05
Dinette Group	F-06
Driver's Compartment Group	F-07 - F-10
Electrical Group	F-11 - F-13
Exterior Body Group	F-14 - F-23
Galley Group	F-24 - G-02
Heating & Air Conditioning Group	G-03
Interior Finish Group	G-04 - G-05
LP Group	G-06
Lounge Group	G-07
Water & Sewage Group	G-08
Window, Vent & Exterior Door Group	G-09 - G-14

EXTERIOR BODY GROUP (CONTINUED)

EXTERIOR BODY PANELS

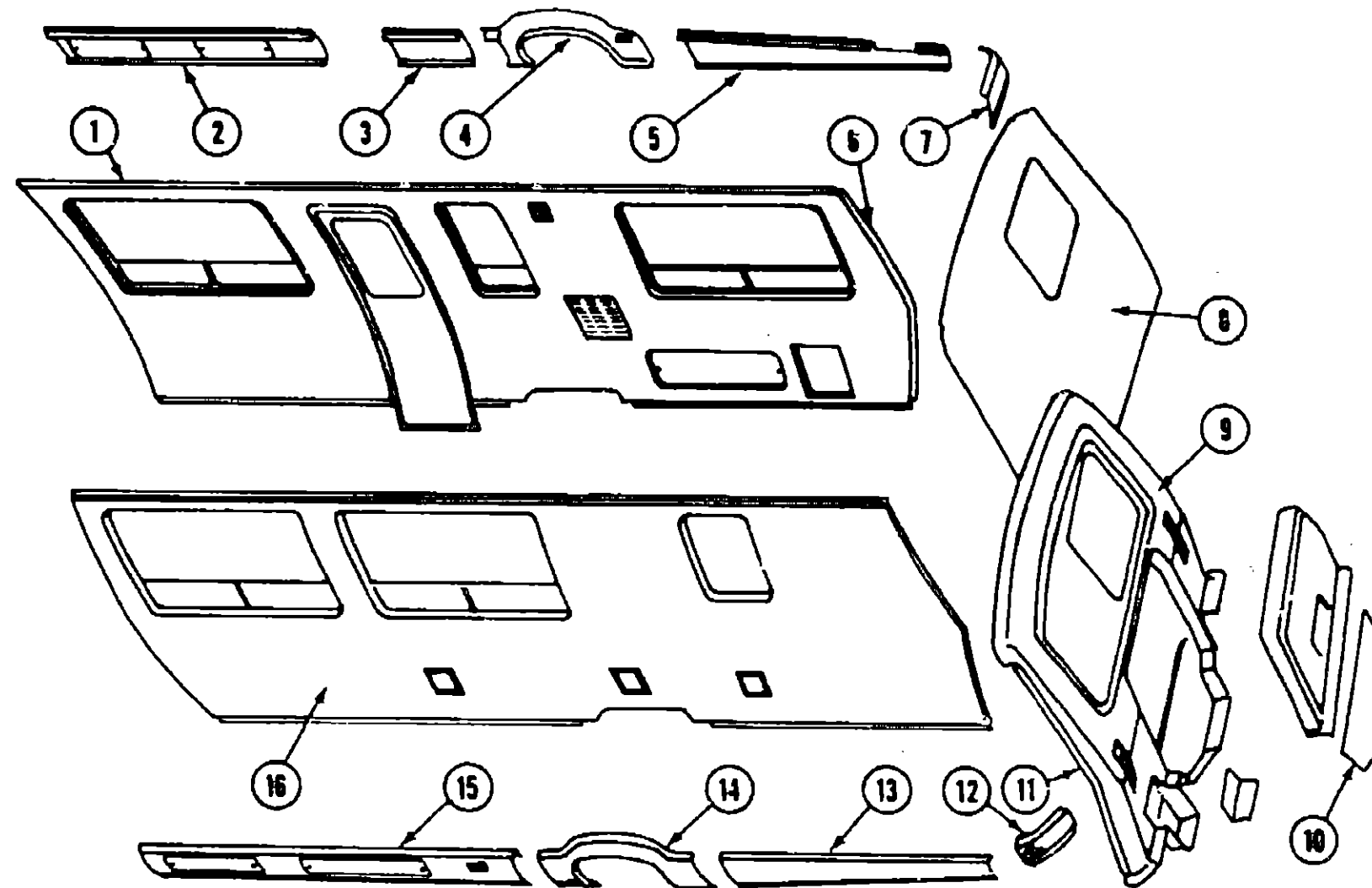

Key	Part Number	U/M	Description
1	M80571-01-T06	EA	Sidewall Asm. - Right
1	M80571-01-T07	EA	Sidewall Asm. - Right
1	M80571-01-T08	EA	Sidewall Asm. - Right
2	076236-03-000	EA	Valance Panel - Right Front
3	076235-03-000	EA	Valance Panel - (Right)
4	076948-03-000	EA	Valance Panel - Entrance Door
5	076234-05-000	EA	Wheelwell Trim - Rear Right - Beige
6	076238-10-000	EA	Valance Panel - Right Rear
7	073502-07-000	EA	Fiberglass Trim - Right Rear - Beige
8	080574-01-T06	EA	Bumper End - Rear Right
9	080794-01-000	EA	Backwall Asm.
10	076232-01-000	EA	Rear Cap Panel - Beige
		EA	Spare Tire Shield

Key	Part Number	U/M	Description
11	073502-08-000	EA	Fiberglass Trim - Rear Left - Beige
12	077330-06-000	EA	Bumper End - Rear Left
13	077792-14-000	EA	Valance Panel - Left Rear
14	076234-07-000	EA	Wheelwell Trim - Rear Left - Beige
15	076237-03-000	EA	Valance Panel - Left Front
16	M80572-01-T06	EA	Sidewall Asm. - Left
16	M80572-01-T07	EA	Sidewall Asm. - Left
16	M80572-01-T08	EA	Sidewall Asm. - Left
	M80585-01-T06	EA	Roof Asm. - Beige
	073505-06-000	EA	Roof Trim - 180" - Beige
	076515-01-000	EA	Inside Trim - Wheelwell - Rear - Left/Right - Steel
	077412-01-000	EA	Trim Cap - Rear Upper Right Corner - Sidewall
	077412-02-000	EA	Trim Cap - Rear Upper Left Corner - Sidewall
			Not illustrated

1985 WINNEBAGO TABLE OF CONTENTS

WC420RG
WCN23RG
WCP31RT
WCN31RT

A-01 - C-02
C-03 - E-10
E-11 - G-14
G-15 - I-24

1985 WCP31RC INDEX

Floor Plan	E-11 - E-12
Accessories Group	E-13 - E-15
Bath Group	E-16
Chassis Group	E-17 - E-22
Curtain, Cushion & Pad Group	E-23 - F-05
Dinette Group	F-06
Driver's Compartment Group	F-07 - F-10
Electrical Group	F-11 - F-13
Exterior Body Group	F-14 - F-23
Galley Group	F-24 - G-02
Heating & Air Conditioning Group	G-03
Interior Finish Group	G-04 - G-05
LP Group	G-06
Lounge Group	G-07
Water & Sewage Group	G-08
Window, Vent & Exterior Door Group	G-09 - G-14

EXTERIOR BODY GROUP (CONTINUED)

DECALS & FILM STRIPE

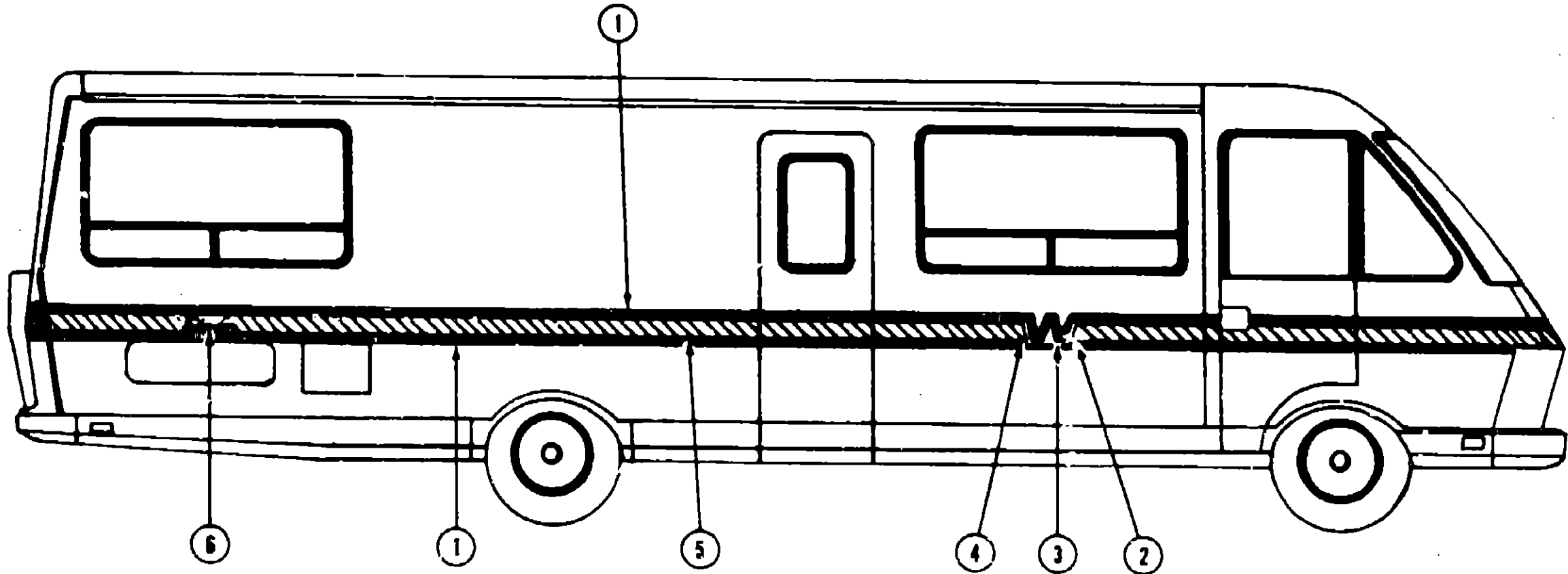

Key	Part Number	U/M	Description
1	069245-35-000	FT	Film Stripe - Medium Blue Metallic (T06)
1	069245-34-000	FT	Film Stripe - Red/Copper Metallic (T07)
1	069245-33-000	FT	Film Stripe - Dark Copper Metallic (T08)
2	073719-18-000	EA	Decal - Dark Gold Metallic (T06)
2	073719-16-000	EA	Decal - Copper Metallic (T07, T08)
3	073725-07-000	EA	Decal - Medium Blue Metallic (T06)
3	073725-06-000	EA	Decal - Red/Copper Metallic (T07)
3	073725-05-000	EA	Decal - Dark Copper Metallic (T08)
4	073719-17-000	EA	Decal - Dark Gold Metallic (T06)
4	073719-15-000	EA	Decal - Copper Metallic (T07, T08)
5	069245-37-000	FT	Film Stripe - Dark Gold Metallic (T06)
5	069245-36-000	FT	Film Stripe - Copper Metallic (T07, T08)
6	076754-01-000	EA	Decal - "Elandan" - Chrome

1985 WINNEBAGO
TABLE OF CONTENTS

WC420RG	A-01 - C-02
WCN23RG	C-03 - E-10
WCP31RT	E-11 - G-14
WCN31RT	G-15 - I-24

1985 WCP31RC INDEX

Floor Plan	E-11 - E-12
Accessories Group	E-13 - E-15
Bath Group	E-16
Chassis Group	E-17 - E-22
Curtain, Cushion & Pad Group	E-23 - F-05
Dinette Group	F-06
Driver's Compartment Group	F-07 - F-10
Electrical Group	F-11 - F-13
Exterior Body Group	F-14 - F-23
Galley Group	F-24 - G-02
Heating & Air Conditioning Group	G-03
Interior Finish Group	G-04 - G-05
LP Group	G-06
Lounge Group	G-07
Water & Sewage Group	G-08
Window, Vent & Exterior Door Group	G-09 - G-14

EXTERIOR BODY GROUP (CONTINUED)

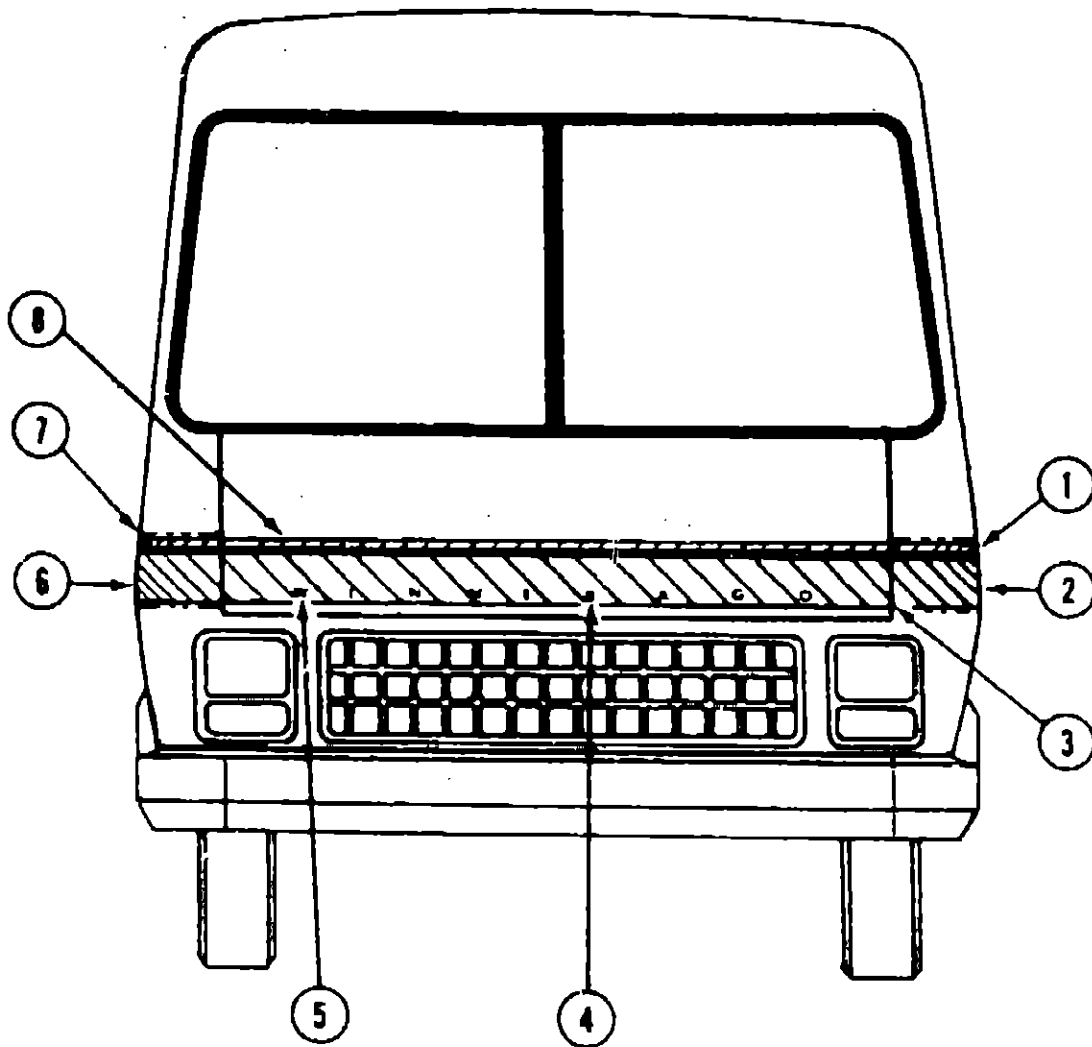

DECALS & FILM STRIPE (CONT.)

Key	Part Number	U/M	Description
1	076350-11-000	EA	Decal - Medium Blue Metallic (T06) Left Hand
1	076350-09-000	EA	Decal - Red/Copper Metallic (T07) Left Hand
1	076350-07-000	EA	Decal - Dark Copper Metallic (T08) Left Hand
2	076348-09-000	EA	Decal - Dark Gold Metallic (T06) Left Hand
2	076348-07-000	EA	Decal - Copper Metallic (T07, T08) Left Hand
3	076349-05-000	EA	Decal - Dark Gold Metallic (T06) Hood
3	076349-04-000	EA	Decal - Copper Metallic (T07, T08) Hood
4	069745-03-000	EA	Decal - "Bago"
5	069745-04-000	EA	Decal - "Winnie"
6	076346-10-000	EA	Decal - Dark Gold Metallic (T06) Right Hand
6	076348-08-000	EA	Decal - Copper Metallic (T07, T08) Right Hand
7	076350-12-000	EA	Decal - Medium Blue Metallic (T06) Right Hand
7	076350-10-000	EA	Decal - Red/Copper Metallic (T07) Right Hand
7	076350-08-000	EA	Decal - Copper Metallic (T08) Right Hand
8	069245-40-000	FT	Film Stripe - Medium Blue Metallic (T06)
8	069245-39-000	FT	Film Stripe - Red/Copper Metallic (T07)
8	069245-38-000	FT	Film Stripe - Dark Copper Metallic (T08)

EXTERIOR BODY GROUP (CONTINUED)

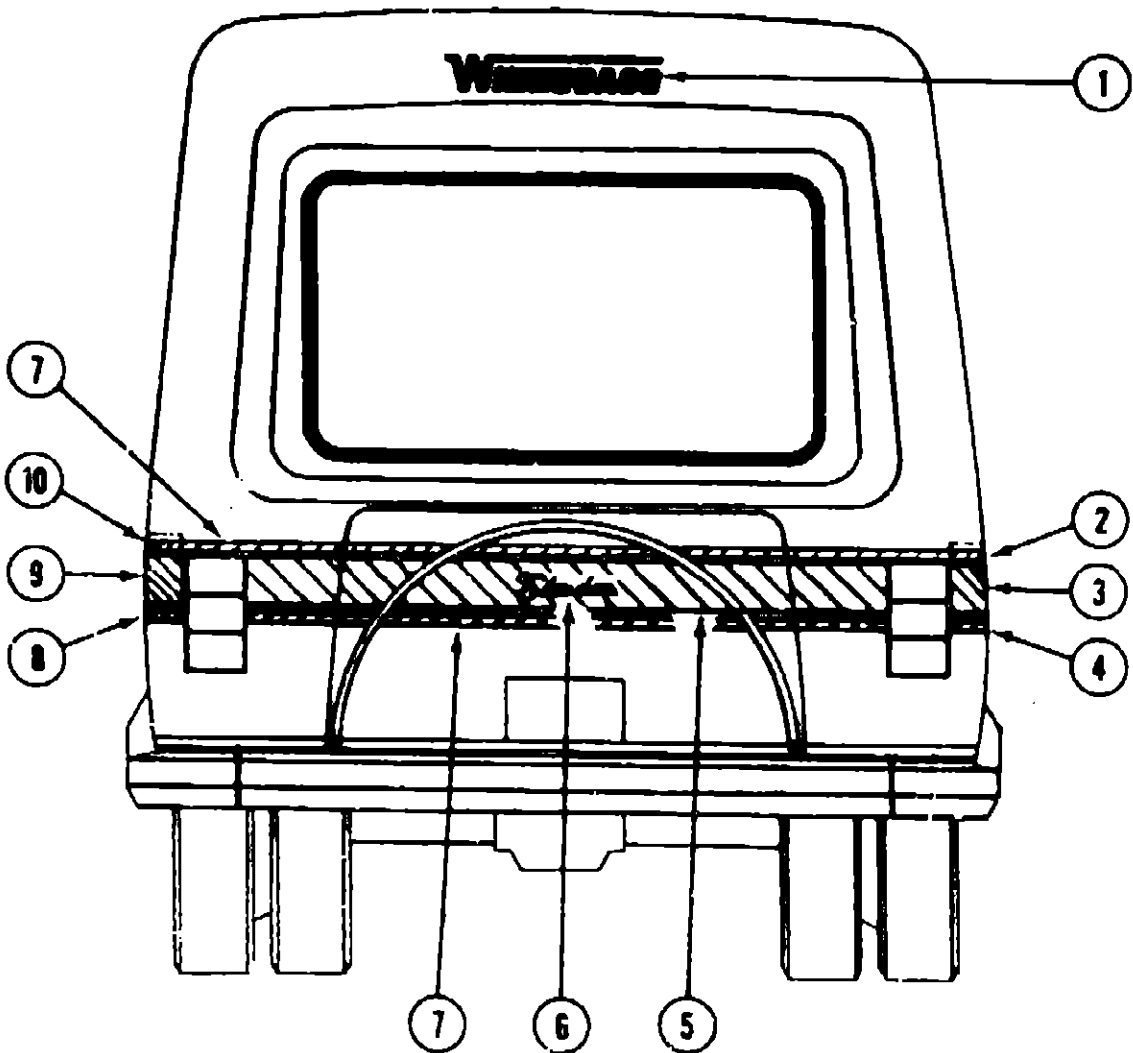

DECALS & FILM STRIPE (CONT.)

Key	Part Number	U/M	Description
1	050313-22-000	EA	Decal - "Winnebago" - 2.8" Chrome
2	076753-12-000	EA	Decal - Medium Blue Metallic (T06) Right Hand
2	076753-10-000	EA	Decal - Red/Copper Metallic (T06) Right Hand
2	076753-08-000	EA	Decal - Dark Copper Metallic (T08) Right Hand
3	076751-10-000	EA	Decal - Dark Gold Metallic (T06) Right Hand
3	076751-08-000	EA	Decal - Copper Metallic (T07, T08) Right Hand
4	076752-12-000	EA	Decal - Medium Blue Metallic (T06) Right Hand
4	076752-10-000	EA	Decal - Red/Copper Metallic (T07) Right Hand
4	076752-08-000	EA	Decal - Dark Copper Metallic (T08) Right Hand
5	069245-37-000	FT	Film Stripe - Dark Gold Metallic (T06)
5	069245-36-000	FT	Film Stripe - Copper Metallic (T07, T08)
6	076754-01-000	EA	Decal - "Elandan" - Chrome
7	069245-35-000	FT	Film Stripe - Medium Blue Metallic (T06)
7	069245-34-000	FT	Film Stripe - Red/Copper Metallic (T07)
7	069245-33-000	FT	Film Stripe - Dark Copper Metallic (T08)
8	076752-11-000	EA	Decal - Medium Blue Metallic (T06) Left Hand
8	076752-09-000	EA	Decal - Red/Copper Metallic (T07) Left Hand
8	076752-07-000	EA	Decal - Dark Copper Metallic (T08) Left Hand
9	076751-09-000	EA	Decal - Dark Gold Metallic (T06) Left Hand
9	076751-07-000	EA	Decal - Copper Metallic (T07, T08) Left Hand
10	076753-11-000	EA	Decal - Medium Blue Metallic (T06) Left Hand
10	076753-09-000	EA	Decal - Red/Copper Metallic (T07) Left Hand
10	076753-07-000	EA	Decal - Dark Copper Metallic (T08) Left Hand

1985 WINNEBAGO
TABLE OF CONTENTS

WC420RG	A-01 - C-02
WCN23RG	C-03 - E-10
WCP31RT	E-11 - G-14
WCN31RT	G-15 - I-24

1985 WCP31RC INDEX

Floor Plan	E-11 - E-12
Accessories Group	E-13 - E-15
Bath Group	E-16
Chassis Group	E-17 - E-22
Curtain, Cushion & Pad Group	E-23 - F-05
Dinette Group	F-06
Driver's Compartment Group	F-07 - F-10
Electrical Group	F-11 - F-13
Exterior Body Group	F-14 - F-23
Galley Group	F-24 - G-02
Heating & Air Conditioning Group	G-03
Interior Finish Group	G-04 - G-05
LP Group	G-06
Lounge Group	G-07
Water & Sewage Group	G-08
Window, Vent & Exterior Door Group	G-09 - G-14

EXTERIOR BODY GROUP (CONTINUED)

SEALANTS & ADHESIVES

Key	Part Number	U/M	Description
	004020-01-000	QT	Adhesive - ABS Cement (Plastic Fittings)
	002337-01-000	EA	Adhesive - 1300 Tube - 3M (Windows)
	004005-02-000	GL	Adhesive - Swifts - Glue (Sidewalls)
	053766-07-000	EA	Bedding Compound - Tube - Beige (Exterior)
	053766-06-000	EA	Bedding Compound - Tube - Clear (Window)
	053766-08-000	EA	Bedding Compound - Tube - Gray (Exterior)
	053766-05-000	EA	Bedding Compound - Tube - Gray (Sidewalls to Floor)
	053766-02-000	EA	Bedding Compound - Tube - Off White (Exterior)
	002328-02-000	EA	Block - Rubber Spacer (Windshield)
	004336-01-000	EA	Caulk - Latex - Golden Walnut (Sidewalls)
	072891-02-000	QT	Primer - Glass - Black
	072891-01-000	QT	Primer - Glass - Clear
	035024-01-000	EA	Primer - Glass - Clear - Windshield
	072890-01-000	QT	Primer - Metal - Black
	035023-01-000	GL	Primer - Metal - Windshield
	077967-01-000	EA	Sealant - Acrylic Latex - Tube - Off White (Interior Sealant)
	034552-04-000	EA	Sealant - Silicone - Beige
	034552-02-000	EA	Sealant - Silicone - Clear
	034552-07-000	EA	Sealant - Silicone - Dark Gray
	034552-06-000	EA	Sealant - Silicone - Off White
	069637-01-000	EA	Sealant - Weatherban 404 - Tube - White (Door Caulk)
	072889-01-000	EA	Sealant - Urethane - Black (Windshield)
	069640-01-000	FT	Sealer Ribbon - .25" Bead x 20'
	069640-02-000	FT	Sealer Ribbon - .5" x .125" x 30'
	069640-03-000	FT	Sealer Ribbon - .75" x .125" x 30'
	069640-04-000	FT	Sealer Ribbon - 2" x .09" x 45' (P Series)
	069640-05-000	FT	Sealer Ribbon - 2.5" x .09" x 50'
	069640-06-000	FT	Sealer Ribbon - 5/16" Bead x 15'
	069640-07-000	FT	Sealer Ribbon - 2" x 3/32" x 30'
	002316-01-000	FT	Sealer Tape - 3/32" x 3/8" - White (Window)
	002707-01-000	FT	Sealer Tape - 5/16" x 3/4"
	002707-02-000	FT	Sealer Tape - 5/16" x 1/2"
	040545-01-000	GL	Sealer - Seam Weld
	053752-04-000	EA	Seam Sealer - Tube - Aluminum (Roof)
	063642-01-000	FT	Tape - Adhesive - .10 mm. x 1.5" Wide
	038886-01-000	EA	Tape - Butyl - .31" x .31" x 148" (Windshield)
	076322-01-000	FT	Tape - Foam - Double Coated - .025 x 1" (Fiberglass Sidewall Seams)
	076322-02-000	FT	Tape - Foam - Double Coated - .045 x 1" (Fiberglass Sidewall Seams)
	009200-01-000	EA	Tape - Furnace - 1.5"
	002825-01-000	FT	Weather Striping (Roof Vent)

SHEET FIBERGLASS, ALUMINUM & STYROFOAM

Key	Part Number	U/M	Description
	076054-20-001	EA	Fiberglass Sheet - 44" x 290" - Beige
	076054-29-001	EA	Fiberglass Sheet - 25.6" x 74.25" - Beige
	076054-18-001	EA	Fiberglass Sheet - 27.4" x 290" - Beige
	044487-01-001	EA	Alum. - Mill Finish - No Design (Roof) - 96" x 360"
	000866-01-000	SF	Styrofoam - 3/4" x 24" x 96"
	000870-01-000	SF	Styrofoam - 1 1/2" x 24" x 96"
	000870-02-000	SF	Styrofoam - 1 1/2" x 48" x 96"

EXTERIOR BODY GROUP (CONTINUED)

INTERIOR/EXTERIOR SCREWS & FASTENERS

Key	Part Number	U/M	Description
	005200-01-000	EA	Bolt - Round Head - Square Neck w/SST Cap - 7/16" - 14 x 1 1/4"
	058279-01-000	EA	Clip - Mounting - Front Panel
	035628-01-000	EA	Fastener - Blind Well Nut - 1.05" x .38"
	000D15-06-008	EA	Nut - Hex - 3/8" x 24 - Zinc
	005081-01-000	EA	Nut - Speed - C Type - #8 Screw
	000G54-04-20B	EA	Screw 1/4 - 20 x 1 1/4" PTH - Zinc
	000G54-04-22B	EA	Screw 1/4 - 20 x 1 3/8" PTH - Zinc
	000G53-04-06B	EA	Screw 1/4 - Machine - 20 x 3/8" PTH - Zinc
	000G13-03-12P	EA	Screw #6 - 20 x 3/4" PFH - Dark Brown
	000G13-06-28X	EA	Screw #6 - 20 x 3/4" PFH - Gray
	000G13-06-16R	EA	Screw #6 - 20 x 1" PFH - Beige
	000G11-07-08B	EA	Screw #7 - 19 x 1/2" PPH - Zinc
	000G12-06-12M	EA	Screw #8 - 18 x 3/4" POH - Gray
	000G11-03-12R	EA	Screw #8 - 18 x 3/4" PPH - Beige
	000G11-03-12X	EA	Screw #8 - 18 x 3/4" PPH - Gray
	000G11-03-12B	EA	Screw #8 - 18 x 3/4" PPH - Zinc
	000G39-03-12R	EA	Screw #8 - 18 x 3/4" SDPH - Beige
	000G66-03-12M	EA	Screw #8 - 18 x 3/4" SDPH - Gray
	000G11-03-16R	EA	Screw #8 - 18 x 1" PFH - Gray
	000G66-03-16R	EA	Screw #8 - 18 x 1" SDPH - Beige
	000G12-03-28R	EA	Screw #8 - 18 x 1 3/4" POH - Beige
	000G36-08-08E	EA	Screw #8 - 32 x 1/2" PFH - Chrome
	000G39-08-08B	EA	Screw #8 - Self Drilling - 18 x 1/2" PPH - Zinc
	000G39-08-12B	EA	Screw #8 - Self Drilling - 18 x 3/4" PPH - Zinc
	000G39-08-12R	EA	Screw #8 - Self Drilling - 18 x 3/4" PPH - Beige
	000G39-08-16R	EA	Screw #8 - Self Drilling - 18 x 1" PPH - Beige
	000G39-08-16T	EA	Screw #8 - Self Drilling - 18 x 1" PPH - Black
	000G39-08-16P	EA	Screw #8 - Self Drilling - 18 x 1" PPH - Dark Brown
	000G39-08-16X	EA	Screw #8 - Self Drilling - 18 x 1" PPH - Gray
	000G39-08-16E	EA	Screw #8 - Self Drilling - 18 x 1" PPH - Chrome
	000G64-08-16M	EA	Screw #8 - Self Drilling - 18 x 1" SDPH - Gray
	000G67-10-08B	EA	Screw #10 - 12 x 1/2" PPH - Zinc
	000G67-10-10R	EA	Screw #10 - 12 x 5/8" PPH - Beige
	000G67-10-16P	EA	Screw #10 - 12 x 1" PPH - Dark Brown
	000G57-10-16B	EA	Screw #10 - 12 x 1" PPH - Zinc
	000G67-10-20B	EA	Screw #10 - 12 x 1 1/4" PPH - Zinc
	000G57-10-24B	EA	Screw #10 - 12 x 1 1/2" PPH - Zinc
	049465-04-000	EA	Screw #10 - 16 x 1" POH - w/Washer - Beige
	049465-05-000	EA	Screw #10 - 16 x 1" POH - w/Washer - Gray
	000G12-10-24E	EA	Screw #10 - 16 x 1 1/2" POH - Chrome
	000G11-10-08D	EA	Screw #10 - 16 x 1/2" PPH - Dark Brown
	000G11-10-12R	EA	Screw #10 - 16 x 3/4" PPH - Beige
	000G11-10-12S	EA	Screw #10 - 16 x 3/4" PPH - Off White
	000G11-10-12B	EA	Screw #10 - 16 x 3/4" PPH - Zinc
	000G11-10-16B	EA	Screw #10 - 16 x 1" PPH - Zinc
	000G11-10-40B	EA	Screw #10 - 16 x 2 1/2" PPH - CAD
	000G19-10-12B	EA	Screw #10 - Machine - 32 TPI x 3/4"
	075908-01-000	EA	Screw #10 - Machine - 32 x .55" PTH - Zinc
	000G19-10-20B	EA	Screw #10 - Machine - 32 x 1 1/4" PPH - Zinc
	000G39-12-12E	EA	Screw #10 - Self Drilling - 14 x 3/4" PPH - Chrome
	000G39-10-10R	EA	Screw #10 - Self Drilling - 16 x .62" PPH - Beige
	000G39-10-12R	EA	Screw #10 - Self Drilling - 16 x 3/4" PPH - Beige
	000G39-10-12P	EA	Screw #10 - Self Drilling - 16 x 3/4" PPH - Dark Brown
	000G56-12-48C	EA	Screw #12 - Wood - 11 x 3" POH - CAD

1985 WINNEBAGO TABLE OF CONTENTS

WC420RG	A-01 - C-02
WCN23RG	C-03 - E-10
WCP31RT	E-11 - G-14
WCN31RT	G-15 - I-24

1985 WCP31RC INDEX

Floor Plan	E-11 - E-12
Accessories Group	E-13 - E-15
Bath Group	E-16
Chassis Group	E-17 - E-22
Curtain, Cushion & Pad Group	E-23 - F-05
Dinette Group	F-06
Driver's Compartment Group	F-07 - F-10
Electrical Group	F-11 - F-13
Exterior Body Group	F-14 - F-23
Galley Group	F-24 - G-02
Heating & Air Conditioning Group	G-03
Interior Finish Group	G-04 - G-05
LP Group	G-06
Lounge Group	G-07
Water & Sewage Group	G-08
Window, Vent & Exterior Door Group	G-09 - G-14

EXTERIOR BODY GROUP (CONTINUED)

LABELS & EXTERIOR PAINT

Key	Part Number	U/M	Description
	068383-01-000	EA	Label - Diesel Fuel
	006195-01-000	EA	Label - Electrical Test
	047731-01-000	EA	Label - Emergency Exit
	006199-01-000	EA	Label - Exit - Escape Window
	057467-04-000	EA	Label - Exterior Loading Limit
	064378-01-000	EA	Label - Flying "W" w/Thermo Panel
	061417-01-000	EA	Label - Fuel
	006196-01-000	EA	Label - Gas Test
	054531-01-000	EA	Label - LP Gas Only
	040944-01-000	EA	Label - Open - Entrance Door
	006015-01-000	EA	Label - Patent Motor Home
	056259-01-000	EA	Label - Safety Check List
	006064-01-000	EA	Label - Seat - w/o Seat Belts
	006187-01-000	EA	Label - Sewage
	006006-01-000	EA	Label - Thermo Panel - 2 1/4" x 2 1/4"
	075221-01-000	EA	Label - Trailer Hitch Capacity
	075220-01-000	EA	Label - Warning - Exterior Load Limit
	050225-01-000	EA	Label - Warning - Stove Vent - US
	006189-01-000	EA	Label - Waste Water
	006197-01-000	EA	Label - Water Test
	072863-01-000	EA	Nameplate - Diesel - 6.2L
	006062-01-000	EA	Tag - Electrical - 110 Volt Connection
	006040-01-000	EA	Tag - Gas - Refueling Warning
	044486-03-000	EA	Paint - Beige Acrylic Enamel - 16 oz. Aerosol (7633A Dupont)
	045681-03-000	EA	Paint - Gloss Black - Acrylic Enamel - 16 oz. Aerosol (99 Dupont)
	058637-05-000	EA	Paint - Gray Acrylic Enamel - 16 oz. Aerosol (71537 Dupont)
	041561-03-000	EA	Paint - Off White Acrylic Enamel - 16 oz. Aerosol (45396A Dupont)
	074559-01-000	EA	Label "LPG" - 3.3" x 1.75" - (Calif. Code)

GALLEY GROUP

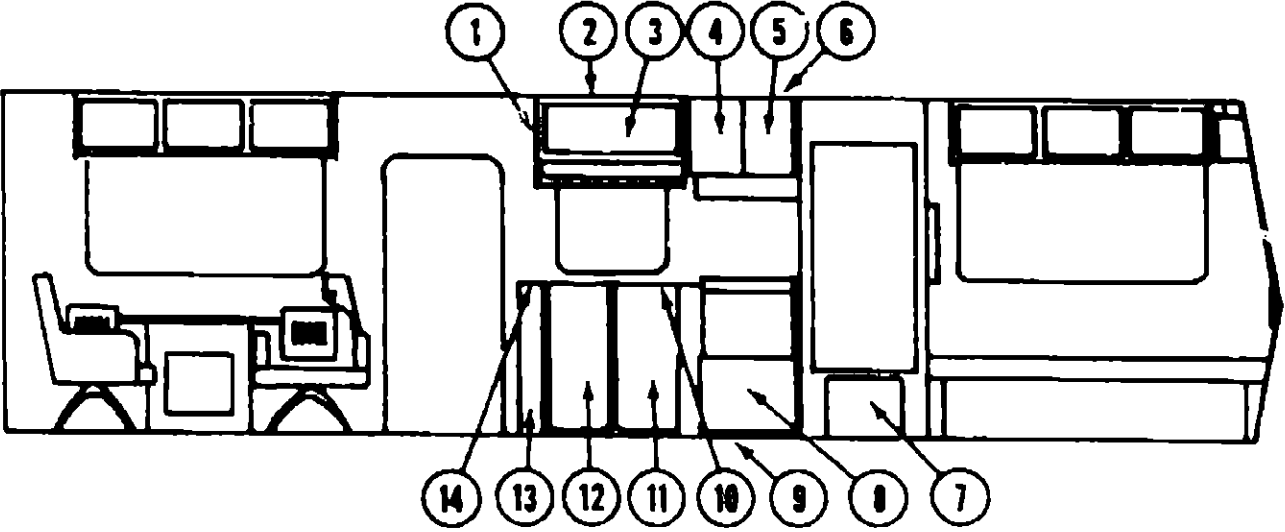

GALLEY CABINETRY

Key	Part Number	U/M	Description
1	076548-02-T06	EA	End Cap - Galley Overhead
2	078898-02-T06	EA	Cabinet Asm. - Galley Overhead - w/o Doors or Hardware
3	M78902-02-T06	EA	Door Asm. - Galley Overhead - w/o Hardware
4	M78905-02-T06	EA	Door Asm. - Range Overhead - w/o Hardware - Front
5	M78905-01-T06	EA	Door Asm. - Range Overhead - w/o Hardware - Rear
6	M76714-03-T06	EA	Cabinet Asm. - Range Overhead - w/o Doors or Hardware
7	M78904-02-T06	EA	Door Asm. - Furnace
8	M78903-13-T06	EA	Door Asm. - w/o Hardware
9	M80659-01-T06	EA	Cabinet Asm. - Galley - w/o Doors, Drawers, Countertop or Hardware
10	M02089-01-T06	EA	Countertop Asm. - Galley Cabinet
11	M76903-01-T06	EA	Door Asm. - Galley Cabinet - w/o Hardware - Rear
12	M78903-02-T06	EA	Door Asm. - Galley Cabinet - w/o Hardware - Front
13	080658-01-T06	EA	Cabinetry Asm. - Entrance Shell
14	M02090-01-T06	EA	Countertop Asm. - Entrance Shell

GALLEY HARDWARE

Key	Part Number	U/M	Description
	053424-04-T06	EA	Sink Cover - Large - Almond Woodgrain
	068615-01-000	EA	Sink - Stainless Steel - Double w/Bolts
**	011053-01-000	EA	Faucet - Swing Spout - 8" - US
**	011053-02-000	EA	Faucet - Swing Spout - 8" - CSA
	066437-01-000	EA	Strainer w/Basket - Sink
**	011053-01-700	EA	Aerator - Swing Spout Faucet
	058314-01-000	EA	Wastebasket - 9 3/4" x 7" x 10" - White Rubbermaid
	033118-01-000	EA	Support - Wastebasket
	077409-01-000	EA	Drawer Slide - Plastic - 20.75"
	077404-01-000	EA	Drawer - Plastic - 20" x 12.7"
	061604-01-000	EA	Slide Bolt - Antique Brass
	076097-01-000	EA	Striker Plate
	074316-01-000	EA	Slide - Pantry - Top & Bottom
	076098-01-000	EA	Slide Bracket - Pantry - Top & Bottom
	075451-01-000	EA	Storage Rack - Canned Goods
	075451-02-000	EA	Storage Rack Clip - White
	037688-01-000	EA	Drawer Rail - V Guide
	039873-01-700	EA	Door Catch & Strike - Nylon & Spring Steel
**	052932-01-K16	EA	Hinge Kit - Cabinet Door - Antique Brass
	074981-01-000	EA	Cutting Board - Maple
	054450-01-000	EA	Level - Refrigerator
	074493-01-000	EA	Door Support - Sprung

**The illustrated parts breakdown for this item is provided on the Common Items Fiche.

1985 WINNEBAGO
TABLE OF CONTENTS

WC420RG	A-01 - D-02
WCN23RG	C-03 - E-10
WCP31RT	E-11 - G-14
WCN31RT	G-15 - I-24

1985 WCP31RC INDEX

Floor Plan	E-11 - E-12
Accessories Group	E-13 - E-15
Bath Group	E-16
Chassis Group	E-17 - E-22
Curtain, Cushion & Pad Group	E-23 - F-05
Dinette Group	F-06
Driver's Compartment Group	F-07 - F-10
Electrical Group	F-11 - F-13
Exterior Body Group	F-14 - F-23
Galley Group	F-24 - G-02
Heating & Air Conditioning Group	G-03
Interior Finish Group	G-04 - G-05
LP Group	G-06
Lounge Group	G-07
Water & Sewage Group	G-08
Window, Vent & Exterior Door Group	G-09 - G-14

GALLEY GROUP (CONTINUED)

GALLEY APPLIANCES

Key	Part Number	U/M	Description
	023111-01-000	EA	Blender - Built In
	079353-02-000	EA	Hood - Stove - w/Monitor - Almond - CSA
	079353-01-000	EA	Hood - Stove - w/Monitor - Almond - US
	079354-01-000	EA	Spacer - Stove Hood
	079355-02-000	EA	Duct Extension - Stove Hood
	075470-01-700	EA	Monitor Panel
	075470-01-701	EA	Clock - Digital - Jensen
	072351-02-700	EA	Clock - Digital - LVS
	075470-01-702	EA	Switch - On/Off
	075470-01-703	EA	Switch - On - Momentary
	075470-01-704	EA	Switch - On/Off/On - Fan Motor
	075470-01-705	EA	Switch - On/Off/On - Momentary
	075470-01-706	EA	Nuts - Plastic
	075470-01-707	EA	Bulb - #912
	075470-01-705	EA	Panel Asm. - Complete
	075470-01-709	EA	Fan Blade - Stove Hood - LVS
	075470-01-710	EA	Filter & Lens - Stove Hood - LVS
	075470-01-711	EA	Motor - Stove Hood - LVS
	049549-01-000	EA	Fan Blade - Stove Hood - Jensen
	049260-01-700	EA	Filter - Stove Hood - Jensen
	048548-01-000	EA	Motor - Stove Hood - Jensen
	049935-01-701	EA	Lens - Stove Hood - Jensen
	075217-01-000	EA	Refrigerator - AC/DC Gas - Norcold 6' - 838-EG3
	075217-01-700	EA	Shell Asm. - Door - w Trim
	075217-01-701	EA	Gasket - Door - Freezer
	075217-01-702	EA	Frame Asm. - Door
	075217-01-703	EA	Decor Trim - Top & Bottom
	075217-01-704	EA	Gasket - Door - Refrigerator
	075217-01-705	EA	Cabinet Asm. - Urethane
	075217-01-707	EA	Bulb - Light - DC
	075217-01-708	EA	Lamp Socket
	075217-01-710	EA	Eye brow Asm.
	075217-01-711	EA	Breaker Strip - Top
	075217-01-713	EA	Crisper Drawer
	075217-01-714	EA	Thermostat Asm
	075217-01-715	EA	Knob - Thermostat
	075217-01-716	EA	Front Divider Asm
	075217-01-717	EA	Humidity Switch
	075217-01-718	EA	Light Switch
	075217-01-719	EA	Eye brow Board
	075217-01-720	EA	Eye brow
	075217-01-721	EA	Lamp - Indicator - Amber
	075217-01-722	EA	Lamp - Indicator - Green
	075217-01-723	EA	Lamp - Indicator - Red
	075217-01-724	EA	Lamp - Indicator - Blue
	075217-01-725	EA	Rocker Switch - #615258
	075217-01-726	EA	Interface Board
	075217-01-726	EA	Cover - Interface Board
	075217-01-729	EA	Fitting - Outlet
	075217-01-730	EA	Gas Valve
	075217-01-731	EA	Nipple
	075217-01-732	EA	Fitting - Inlet
	075217-01-733	EA	Shut-Off Cock
	075217-01-734	EA	Fuse - 3 Amp.
	075217-01-735	EA	Ignition Electrode
	075217-01-735	EA	Sensing Electrode
	075217-01-737	EA	Control Module
	075217-01-738	EA	Rocker Switch - #515259
	075217-01-739	EA	Heater
	075217-01-740	EA	Screw #6 - 32" x 2 3/8"
	075217-01-741	EA	Wing - Nut #6 - 32

GALLEY GROUP (CONTINUED)

GALLEY HARDWARE & APPLIANCES (CONT.)

Key	Part Number	U/M	Description
	075217-C1-742	EA	Hex Nut
	075217-01-743	EA	Elbow - 90°
	075217-01-744	EA	Cable - Wiring
	075217-01-745	EA	Liner Asm. - Foamed - Door
	075217-01-746	EA	Baffle Asm.
	075217-01-747	EA	Liner Asm. - Foamed - Lower - Door
	075218-01-000	EA	Refrigerator - 3-Way - 10' Norcold
	075218-01-700	EA	Gasket - Freezer Door
	075218-01-701	EA	Gasket - Refrigerator Door
	075218-01-702	EA	Connector Rod
	075218-01-703	EA	Frame Asm.
	075218-01-704	EA	Cabinet - Urethane
	075218-01-705	EA	Breaker Strip - Bottom
	075218-01-707	EA	Divider - Front
	075218-01-703	EA	Cable - Wiring
	075218-01-709	EA	Door Liner Asm. - Foamed
	075218-01-710	EA	Door Liner Asm. - Foamed - Lower
	064782-02-000	EA	Range - 4 Burner - Almond Top
	054782-01-700	EA	Frame - Upper Glass
	064782-01-701	EA	Glass - Outside
	064782-01-702	EA	Panel - Door - Black
	064782-01-703	EA	Trim - Cabinet - Right
	064782-01-704	EA	Trim - Cabinet - Left
	054782-01-705	EA	Washer - Door Handle
	054782-02-700	EA	Top - 4 Burner - Almond
	054782-02-701	EA	Deflector - Plate - Black
	054782-02-702	EA	Trim - Cabinet - Right - Black
	054782-02-703	EA	Trim - Cabinet - Left - Black
	064782-02-704	EA	Trim - Glass - Lower Outside - Black
	064782-02-705	EA	Handle - Oven Door - Black
	064782-02-705	EA	Trim - Vertical - Black
	064782-02-707	EA	Panel - Manifold
	064782-02-708	EA	Mercury Valve
	749045-01-740	EA	Cover - Stovetop Bifold - Magic Chef
	075922-01-000	EA	Microwave
	075922-03-000	EA	Trim Ring - Microwave
	075922-04-000	EA	Exhaust Duct - Microwave
	075930-02-000	EA	Bracket - Microwave - Left
	075930-01-000	EA	Bracket - Microwave - Right
	076253-02-000	EA	Bracket - 6" - Microwave

**1985 WINNEBAGO
TABLE OF CONTENTS**

WC420RG	A-01 - C-02
WCN23RG	C-03 - E-10
WCP31RT	E-11 - G-14
WCN31RT	G-15 - I-24

1985 WCP31RC INDEX

Floor Plan	E-11 - E-12
Accessories Group	E-13 - E-15
Bath Group	E-16
Chassis Group	E-17 - E-22
Curtain, Cushion & Pad Group	E-23 - F-05
Dinette Group	F-06
Driver's Compartment Group	F-07 - F-10
Electrical Group	F-11 - F-13
Exterior Body Group	F-14 - F-23
Galley Group	F-24 - G-02
Heating & Air Conditioning Group	G-03
Interior Finish Group	G-04 - G-05
LP Group	G-06
Lounge Group	G-07
Water & Sewage Group	G-08
Window, Vent & Exterior Door Group	G-09 - G-14

HEATING & AIR CONDITIONING GROUP

AUTOMOTIVE HEATER & AIR CONDITIONER

Key	Part Number	U/M	Description
	077052-01-000	EA	Heater/Evaporator Asm. - A.R.A.
	072342-01-000	EA	Condensor Asm. - A.R.A.
	072343-01-000	EA	Compressor/Clutch - A.R.A.
	072344-01-000	EA	Package - Compressor Mount
	049401-01-000	EA	Heater Asm. - Rear - Auxiliary
	049401-01-700	EA	Valve - Water Control (Aux. Heater)
	049401-01-701	EA	Control Cable (Aux. Heater)
	049401-01-702	EA	Motor Asm. (Aux. Heater)
	049401-01-703	EA	Heater Core (Aux. Heater)
	049401-01-704	EA	Switch (Aux. Heater)
	058906-01-000	EA	Control Panel - Brown (Aux. Rear Heater)

FURNACES & ROOF AIR CONDITIONER

Key	Part Number	U/M	Description
	075696-01-000	EA	Furnace - 34,000 BTU - w/Direct Ignition
	010326-01-000	EA	Adapter Flare - w/Cone & Gasket
	009198-01-000	FT	Duct - Flexible - 4" I.D. x 25'
	056464-01-000	EA	Register - 4" Dia. - Plastic - w/Damper
	056464-02-000	EA	Register - 4" Dia. - Plastic - w/o Damper
	009200-01-000	EA	Tape - Furnace - 1 1/2"
	023146-01-000	EA	Clamp Screw Type - 4"
**	073743-01-000	EA	Shroud Asm. - Ceiling - Inside - Roof Air Cool Only - 13,500 BTU - Coleman
**	073744-01-000	EA	Shroud Asm. - Ceiling - Inside - Roof Air Heat and Cool - 13,500 BTU - Coleman
	073742-02-000	EA	Air Conditioner - 110 Volt - Roof Mount - 13,500 BTU Rotary
	073742-01-700	EA	Decal Package - Mack 3 - Left & Right
	073742-01-701	EA	Switch - Selector - 5 Terminal
	073742-01-702	EA	Decal - Cool Only
	073742-01-703	EA	Decal - Heat & Cool
	073742-01-704	EA	Decal - Thermostat
	073742-02-700	EA	Shroud - Gray w/o Decals
	073742-02-701	EA	Motor - 115 V - 2.7A - .06H2
	073742-02-702	EA	Start Capacitor
	073742-02-703	EA	Start Relay
	073742-02-704	EA	Run Capacitor - Compressor

** The illustrated parts breakdown for this item is provided on the Common Items Fiche.

INTERIOR FINISH GROUP

PANELING & COUNTERTOP MATERIALS

Key	Part Number	U/M	Description
	074496-01-000	SF	Paneling - Chevron Almond - 48" x 84" (Wall)
	074497-01-000	SF	Paneling - Empire Walnut - 43" x 84" (Bedroom Wall)
	074497-02-000	SF	Paneling - Kenora Woodgrain - 48" x 96" (Ceiling)
	074496-21-000	SF	Paneling - Decor - Stauffer Blossom - Galley & Bath - 48" x 84" (T06)
	077496-22-000	SF	Paneling - Decor - Stauffer Blossom - Galley & Bath - 48" x 84" (T07)
	077496-23-000	SF	Paneling - Decor - Stauffer Blossom - Galley & Bath - 48" x 84" (T08)
	074498-06-000	SF	Plastic Laminate - Beige Crescent
	076325-02-000	FT	Edge Molding - Empire Walnut - Galley & Tabletops
	074498-04-000	SF	Plastic Laminate - Victorian Onyx
	074498-04-019	EA	Plastic Laminate - Victorian Onyx - 1.19" x 96"
	074498-03-000	SF	Plastic Laminate - Empire Walnut

INTERIOR MOLDINGS & TRIM

Key	Part Number	U/M	Description
	074045-01-000	EA	Oak Plug - .50" Dia.
	075400-09-T06	EA	Oak Railing - 52"
	075400-10-T06	EA	Oak Railing - 62.4"
	075400-11-T06	EA	Oak Railing - 68.6"
	009812-14-000	FT	Molding - Outside Corner - .50" - Empire Walnut
	009809-14-000	FT	Molding - Outside Corner - 1" - Empire Walnut
	042357-08-000	FT	Molding - Outside Corner - Walnut
	009767-06-000	FT	Welting - Beige
	009767-08-000	FT	Welting - Walnut
	009815-05-000	FT	T-Molding - .75" - Walnut
	022992-08-000	FT	Molding - Reverse Cove - Champagne White
	070504-04-000	FT	U-Channel - .815" - Walnut
	070504-01-000	FT	U-Channel - .65" - Light Brown
	009778-05-000	FT	U-Channel - 1" - Walnut
	069733-25-000	EA	Batt Strip - Chevron Almond (Wall) 8'
	069733-41-000	EA	Batt Strip - Kenora Woodgrain (Ceiling) 8'
	069733-24-000	EA	Batt Strip - Empire Walnut (Wall) 8'
	069733-49-000	EA	Batt Strip - Stauffer Blossoms - 8' (T06)
	069733-50-000	EA	Batt Strip - Stauffer Blossoms - 8' (T07)
	069733-51-000	EA	Batt Strip - Stauffer Blossoms - 8' (T08)
	045375-52-000	EA	Molding Retainer - Aluminum - 16'
	076325-02-000	EA	Molding - Table Edgeband - Empire Walnut
	073321-01-000	EA	Wall Trim - Carpet
	077501-01-000	EA	Cap - Corner Radius

FABRICS & CARPET

Key	Part Number	U/M	Description
	077498-10-000	YD	Fabric - Upholstery - Blue (T06)
	077498-11-000	YD	Fabric - Upholstery - Peach (T07)
	077498-12-000	YD	Fabric - Upholstery - Rust (T08)
	077498-22-000	YD	Fabric - Upholstery/Accent (Drapery & Seat Covers) Blue (T06)
	077498-23-000	YD	Fabric - Upholstery/Accent (Drapery & Seat Covers) Peach (T07)
	077498-24-000	YD	Fabric - Upholstery/Accent (Drapery & Seat Covers) Rust (T08)
	069729-18-000	YD	Fabric - Bedspread - Blue (T06)
	069729-17-000	YD	Fabric - Bedspread - Peach, Rust (T07, T08)
	072343-12-000	YD	Fabric - Drapery - Sand
	079680-04-000	YD	Vinyl - Expanded (End Caps) Teak
	072860-33-000	SY	Carpet - Blue (T06)
	072860-24-000	SY	Carpet - Peach (T07)
	072860-34-000	SY	Carpet - Rust (T08)
	075233-01-000	SY	Carpet - Pad 3/8" Foam
	078421-01-000	YD	Fabric - Mattress Ticking

1985 WINNEBAGO TABLE OF CONTENTS

WC420RG	A-01 - C-02
WCN23RG	C-03 - E-10
WCP31RT	E-11 - G-14
WCN31RT	G-15 - I-24

1985 WCP31RC INDEX

Floor Plan	E-11 - E-12
Accessories Group	E-13 - E-15
Bath Group	E-16
Chassis Group	E-17 - E-22
Curtain, Cushion & Pad Group	E-23 - F-05
Dinette Group	F-06
Driver's Compartment Group	F-07 - F-10
Electrical Group	F-11 - F-13
Exterior Body Group	F-14 - F-23
Galley Group	F-24 - G-02
Heating & Air Conditioning Group	G-03
Interior Finish Group	G-04 - G-05
LP Group	G-06
Lounge Group	G-07
Water & Sewage Group	G-08
Window, Vent & Exterior Door Group	G-09 - G-14

INTERIOR FINISH GROUP (CONTINUED)

MISCELLANEOUS PARTS

Key	Part Number	U/M	Description
	053552-02-T12	EA	Handle Asm. - Interior Assist - Medium Almond Vinyl
	041944-03-000	EA	Fire Extinguisher - 5 BC
	054185-22-000	EA	Owner's Manual - Itasca - Winnebago
	007038-01-000	EA	Door Mat - Black Rubber - 10 1/2" x 26"
	081072-01-000	EA	Door Mat - Front Right - Brown
	081074-01-000	EA	Door Mat - Front Left - Brown
	081075-01-000	EA	Door Mat - Entrance - Brown
	065201-02-000	EA	Lamp Shade - Fabric - Parchment

CABINETRY & TABLE HARDWARE

Key	Part Number	U/M	Description
	053200-05-000	EA	Bracket - Upper Wall Mount - Beige - 23.5"
..	053201-03-000	EA	Bracket - Table Mount - 23"
	024275-05-000	EA	Rod - Table Lift - 8" x 23.5" - Beige
	024281-07-000	EA	Bracket - Lower Wall Mount - Beige - 22.12"
	024276-14-000	EA	Leg Asm. - Table - 29.5" - Brown
	054050-01-000	EA	Hinge - Table Leg
..	024282-01-000	EA	Brace - Table Leg
..	024283-01-000	EA	Clip - 1" O.D. Tube
	049493-02-000	EA	Catch - Table Leg - Mounts on Floor - Brown
	077523-01-000	EA	Latch Asm. - Cabinet Door
	009112-01-000	EA	Flange - 1" Chrome - Closet Rod
	077409-01-000	EA	Slide - Drawer - Plastic
..	037688-01-000	FT	Rail - Drawer
	076312-01-000	EA	Mesh - Grille - Brass - 7.3" x 5.8" (Rear Lounge)
	009040-02-000	EA	Leg - Pedestal Table - 27.5" x 2.25" O.D. - Chrome
	009040-04-000	EA	Leg - Pedestal Table - 27.5" x 2.25" O.D. - Brown
	039873-01-700	EA	Nylon Catch & Spring Steel Strike
	009040-03-000	EA	Base - Table Leg - Mounts on Table
	041194-01-000	EA	Base - Table Leg - Mounts in Floor
	062046-01-000	EA	Clip - Leg Pedestal - 2.25" O.D. Tube
	075687-01-000	EA	Lock Set - Bath Door - Bronze Stone
	009050-01-000	EA	Warp Guard - 64"
	009051-01-000	EA	Warp Guard - 48"
..	052932-01-K16	EA	Hinge Kit - Cabinet Door - Antique Brass
	074493-01-000	EA	Overhead Door Support - Sprung
	078212-01-000	EA	Door Pull - Polished Brass & Oak Inlay
..	The illustrated parts breakdown for this item is provided on the Common Items Fiche.		

CURTAIN HARDWARE

Key	Part Number	U/M	Description
	056116-01-000	EA	Track - Curtain - Brown - Plastic
	077046-01-000	EA	Track - Curtain - Front Wraparound - Passenger
	077046-02-000	EA	Track - Curtain - Front Wraparound - Drivers
	056001-01-000	EA	Bracket - Shade - Left
	056002-01-000	EA	Bracket - Shade - Right
	056003-01-000	EA	Bracket - Drapery Retainer - Right
	056003-02-000	EA	Bracket - Drapery Retainer - Left
	056003-03-000	EA	Bracket - Drapery Retainer - Universal
	056784-01-000	EA	Pull - Window Shade - Antique Brass
	039175-02-000	EA	Bracket - Curtain Rod
	056115-01-000	YD	Tape - Clear Plastic - w/Guides
	048394-01-000	YD	Tape Hood - 1" x 25 YD - Beige (Velcro)
	049385-01-000	YD	Tape Loop - 1" x 25 YD - Beige (Velcro)

LP GROUP

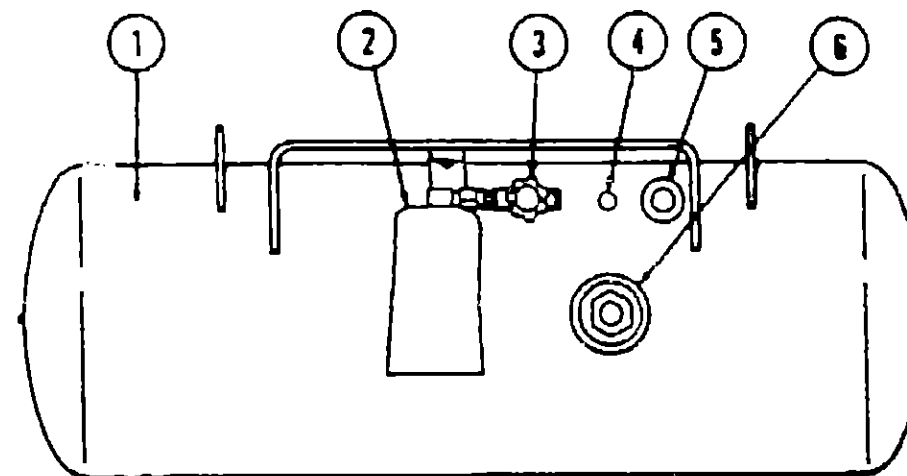

Key	Part Number	U/M	Description
1	074142-01-000	EA	Tank Asm. - LP - Frame Mount - 80 Pound - 13" x 44"
2	077277-01-000	EA	Compartment - LP Regulator - Front
2	076278-01-000	EA	Compartment - LP Regulator - Back
*	076301-01-000	EA	Regulator - Two Stage - LP Gas
3	040421-01-703	EA	Valve - Vapor Relief
4	040421-01-700	EA	Gauge - Liquid Level - 20% LP
5	040421-01-701	EA	Valve - Filler - LP
*	040421-01-702	EA	Cap - Plastic Fill Valve
6	040421-01-707	EA	Gauge - Float - w/Visible Dial - 80 Pound Tank
*	040421-01-706	EA	Dial - Visible Face - Float Gauge (Tank w/o Electric Transmitter)
*	040440-01-000	EA	Dial - Transmitter - 0-90 Ohm (Float Gauge)
*	045703-01-000	EA	Hose Asm. - LP - 3/8" I.D. x 24" - US
*	045703-02-000	EA	Hose Asm. - LP - 3/8" I.D. x 24" - CSA
*	045703-03-000	EA	Hose Asm. - LP - 3/8" I.D. x 18" - US
*	045703-04-000	EA	Hose Asm. - LP - 3/8" I.D. x 14" - CSA
*	065741-01-000	EA	Gauge - Diaphragm Pressure - Test Leak
*	Not illustrated		

1985 WINNEBAGO TABLE OF CONTENTS

WC420RG
WCN23RG
WCP31RT
WCN31RT

A-01 - C-02
C-03 - E-10
E-11 - G-14
G-15 - I-24

1985 WCP31RC INDEX

Floor Plan	E-11 - E-12
Accessories Group	E-13 - E-15
Bath Group	E-16
Chassis Group	E-17 - E-22
Curtain, Cushion & Pad Group	E-23 - F-05
Dinette Group	F-06
Driver's Compartment Group	F-07 - F-10
Electrical Group	F-11 - F-13
Exterior Body Group	F-14 - F-23
Galley Group	F-24 - G-02
Heating & Air Conditioning Group	G-03
Interior Finish Group	G-04 - G-05
LP Group	G-06
Lounge Group	G-07
Water & Sewage Group	G-08
Window, Vent & Exterior Door Group	G-09 - G-14

LOUNGE GROUP

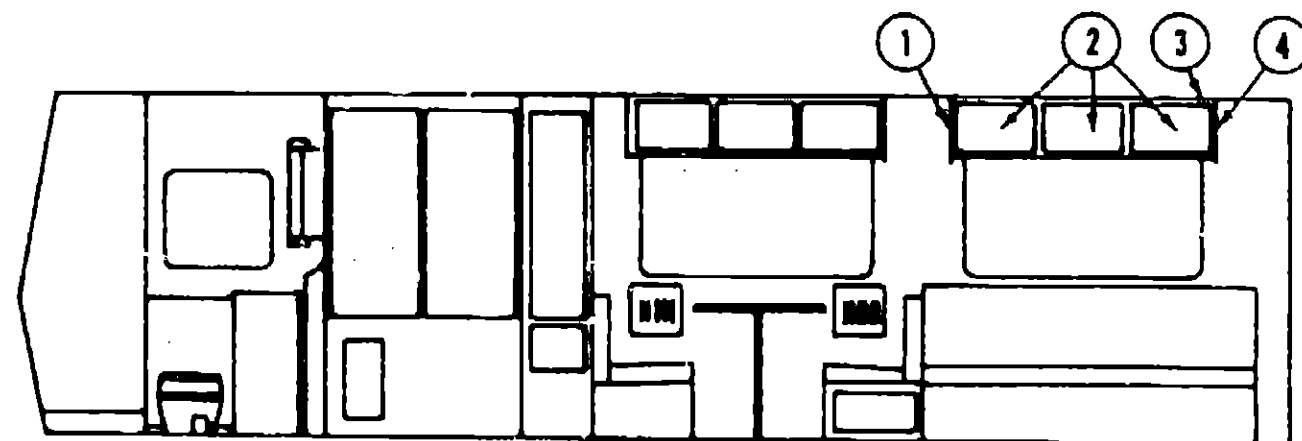

FRONT LOUNGE OVERHEAD CABINETRY

Key	Part Number	U/M	Description
1	076548-02-T06	EA	Pad Asm. - End Cap - Front Lounge Overhead - Teak Vinyl - Rear
2	M78902-01-T06	EA	Door Asm. - Overhead Cabinet - 11.3" x 28" - w/o Hardware
3	078932-03-T06	EA	Cabinet Asm. - Front Lounge Overhead - w/o Doors or Hardware
4	076548-01-T06	EA	Pad Asm. - End Cap - Front Lounge Overhead - Teak Vinyl - Front

DOUBLE BED W/NIGHT STAND

Key	Part Number	U/M	Description
	078932-14-T06	EA	Cabinet Asm. - Overhead - Rear - Right Side
	M78902-01-T06	EA	Door Asm. - Right Rear Overhead - w/o Hardware
	M80656-01-T06	EA	Cabinet Asm. - Double Bed Base

WATER & SEWAGE GROUP

PLUMBING AND REPAIR PARTS

Key	Part Number	U/M	Description
	045729-01-000	EA	Pump - Water - 2.8 G.P.M. - Direct Drive - Shurflo - US
	045729-02-000	EA	Pump - Water - 2.8 G.P.M. - Direct Drive - Shurflo - CSA
	039647-02-000	EA	Filter - Water Pump - 1/2" MPT
	039647-03-000	EA	Filter - Water Pump - 1/2" Flare
	032959-03-000	EA	Connector - 1/2 F x 3/8 MPT - Plastic
	J52960-01-000	EA	Drain Valve - 1/2 F x 1/2 F - Plastic
..	046524-02-000	EA	Kit - Water Tank Fittings - Blank Tank
..	010079-01-000	EA	Tee - Plastic - 1 1/2 H x 1 1/2 H x 1 1/4 H
..	010121-01-000	EA	Bushing - Plastic - 1 1/2 S x 1 1/4 H
..	010133-01-000	EA	Trap Adapter - Plastic - 1 1/2 H x MPT
..	052954-01-000	EA	Adapter - Nose Cone - 5/8 or 1/2 - Plastic
..	010201-01-000	EA	Sewer Hose - 3" x 8' w/Clamp
..	050780-01-000	EA	Coupler Rubber - 3" x 3"
	062415-01-000	EA	Cap - Sewer - 3"
	062416-01-000	EA	Hose Adapter - 3"
	062417-01-000	EA	Adapter - Termination - 3"
	062418-01-000	EA	Valve - 3" - w/Handle
	062421-01-000	EA	Valve - 1 1/2" - w/Handle
..	011066-01-000	EA	P-Trap - 1 1/4" - Plastic
	010071-01-000	EA	Tee - Plastic - 1 1/2" x H x H x H
	010072-01-000	EA	Tee - Plastic - 1 1/2" H x 1 1/4 H x 1 1/2 H
	052956-01-000	EA	Tee - Plastic - 1/2 F x 1/2 MPT x 1/2 F
	052958-01-000	EA	Tee - Plastic - 1/2 F x 1/2 F x 1/2 F
..	053335-01-000	EA	P-Trap - Plastic - 1 1/4 H x H - w/Union
..	011091-01-000	EA	Waste - Continuous - Double Sink - 11 7/8"
	061607-01-000	EA	Grommet - Holding Tank Coupler - 1 1/2"
	061607-02-000	EA	Grommet - Holding Tank Coupler - 3"
	010000-01-000	EA	Elbow - Plastic - 1/8 BD x 1 1/4" x 45° H x H
	010006-01-000	EA	Elbow - Plastic - 1/8 BD x 1 1/2 x 45° H x H
	010051-01-000	EA	Elbow - ST - Plastic - 1/8 BD x 1 1/2 x 45°
	010219-01-000	EA	Elbow - 1 1/4 Barb x 1 1/4 MPT x 90°
	034250-01-000	EA	Elbow - Plastic - 1/4 BD x 1 1/2 x 90° H x H
	052957-01-000	EA	Elbow - Plastic - 1/2 F x 3/8 MPT
	052957-02-000	EA	Elbow - Plastic - 1/2 F x 1/2 MPT
	065120-01-000	EA	Elbow - Plastic - Swivel - .50"
	070924-01-000	EA	Elbow - Plastic - Swivel - 1/2 MPT x 1/2 FP
	010123-01-000	EA	Bushing - Plastic - 2S x 1 1/2 H
	033302-02-000	EA	Adapter Asm. - SWVC Strain - 1 1/2"
	072346-01-000	EA	Valve Asm. - 3" Ell - w/2" Socket
	039800-01-000	FT	Tubing - Polybutyl - 1/2 O.D. (Water Line)
	044928-01-000	FT	Flexible Tubing - 1 1/4 I.D.
	004020-01-000	QT	Adhesive - ABS Cement
	077954-01-000	EA	Filter/Screen - Plastic Water Tank
	042989-02-000	EA	Plastic Fitting - Spinweld (Filter/Screen)
	062422-01-000	EA	Adapter - Hose Offset - Reducer - 3" x 1 1/2"
	052962-01-000	EA	Valve - Stool - 90° x 1/2 F x 3/8 MPT
	010147-01-000	EA	Flange - Closet - 4" F x 3" FPT
	010224-01-000	EA	Adapter - Plastic - 3/8 MPT x 3/8 Barb
	007108-01-000	EA	Hose - Heater - 5/8"
..	The illustrated parts breakdown for this item is provided on the Common Items Fiche.		

HOLDING TANKS & WATER HEATERS

Key	Part Number	U/M	Description
	M01275-89-000	EA	Tank Asm. - Water - 58 Gallon - w/Fittings (Double Bed)
	075550-03-000	EA	Tank - Water - 58 Gallon - w/o Fittings
	M01275-88-000	EA	Tank - Waste Water - 42 Gallon - w/o Fittings
	M01275-87-000	EA	Tank - Sewage - 45 Gallon - w/o Fittings
..	051393-01-000	EA	Water Heater - w/Motor Aid - GH6-3E
..	051391-03-000	EA	Water Heater - w/Electronic Ignition
..	The illustrated parts breakdown for this item is provided on the Common Items Fiche.		

1985 WINNEBAGO TABLE OF CONTENTS

WC420RG	A-01 - C-02
WCN23RG	C-03 - E-10
WCP31RT	E-11 - G-14
WCN31RT	G-15 - I-24

1985 WCP31RC INDEX

Floor Plan	E-11 - E-12
Accessories Group	E-13 - E-15
Bath Group	E-16
Chassis Group	E-17 - E-22
Curtain, Cushion & Pad Group	E-23 - F-05
Dinette Group	F-06
Driver's Compartment Group	F-07 - F-10
Electrical Group	F-11 - F-13
Exterior Body Group	F-14 - F-23
Galley Group	F-24 - G-02
Heating & Air Conditioning Group	G-03
Interior Finish Group	G-04 - G-05
LP Group	G-06
Lounge Group	G-07
Water & Sewage Group	G-08
Window, Vent & Exterior Door Group	G-09 - G-14

WINDOW, VENT & EXTERIOR DOOR GROUP

WINDOWS & ACCESS DOORS

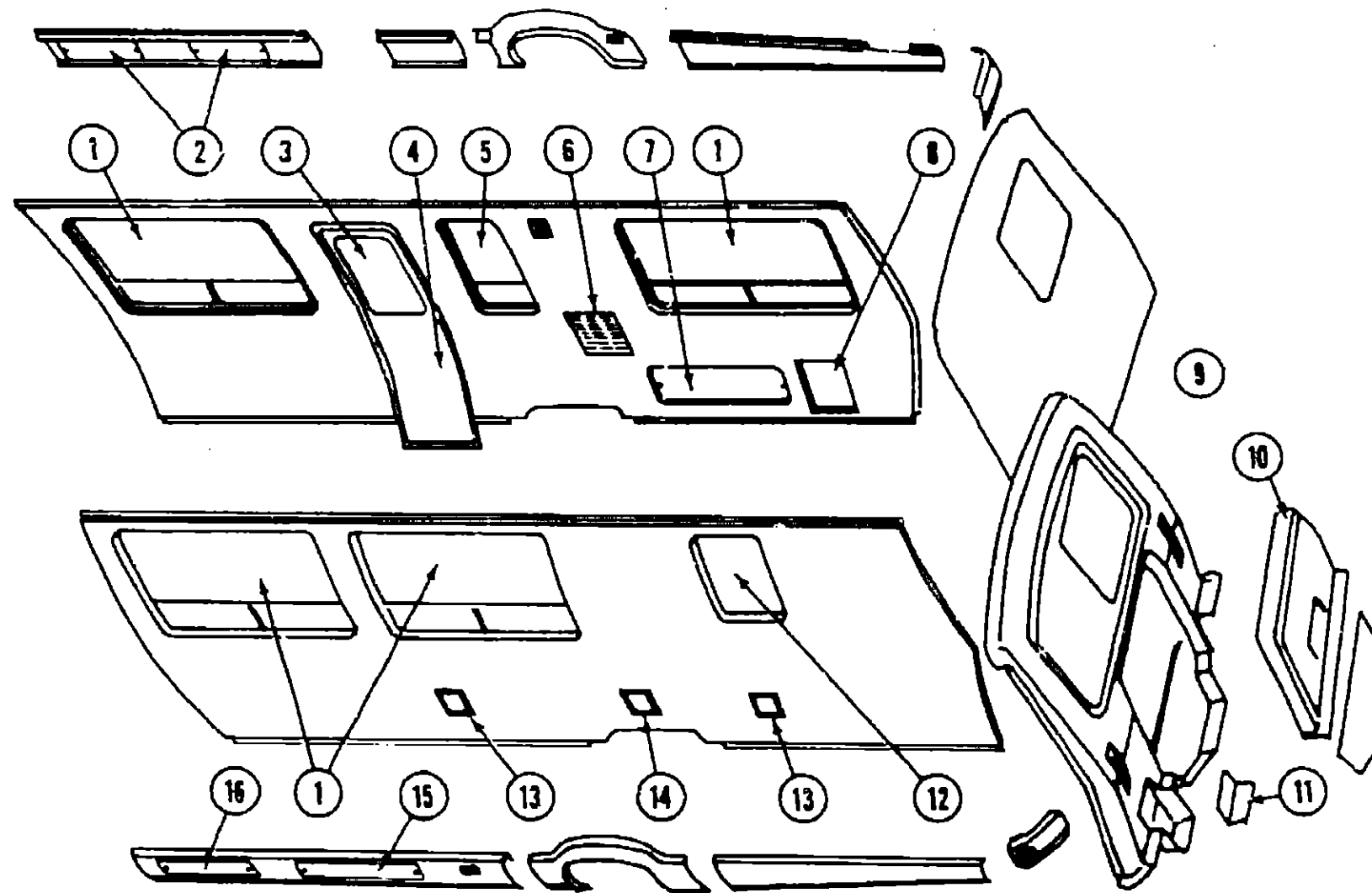

Key	Part Number	U/M	Description
1	075901-02-000	EA	Window Asm. - Crankout (w/o inside frame)
1	075901-06-000	EA	Inside Frame - Black
2	076510-01-000	EA	Door Asm. - Small Storage - w/Twist & Key Lock - Beige
3	079733-04-T03	EA	Window Asm. - Picture (w/o inside frame)
3	067609-03-000	EA	Inside Frame - Beige
4	M76900-01-T06	EA	Door Asm. - Entrance - Beige
5	075901-01-000	EA	Window Asm. - Crankout (w/o inside frame)
5	075901-05-000	EA	Inside Frame - Black
6	059247-05-000	EA	Door Asm. - Refrigerator Access - Beige
7	077343-03-000	EA	Door Asm. - Luggage - Beige
7	M77343-01-000	EA	Door Asm. - Generator - Beige
8	052009-02-000	EA	Door Asm. - Water Heater
9	076548-02-000	EA	Window Asm. - Rear Escape (w/o inside frame)
9	076650-02-000	EA	Inside Frame - Escape - Black

Key	Part Number	U/M	Description
10	076232-01-000	EA	Spare Tire Door Cover - Beige
11	077137-01-000	EA	Door - Sewer Hose Compartment - Beige
12	076648-02-000	EA	Window Asm. - Escape
12	079771-03-000	EA	Inside Frame - Escape - Beige
13	NOTE	EA	Door Asm. - Fuel Fill (See Access Doors)
14	NOTE	EA	Door Asm. - Power Cord (See Access Doors)
15	076510-03-000	EA	Door Asm. - Large Storage Compartment w/Locks
16	076510-01-000	EA	Door Asm. - Small Storage Compartment w/Locks
	M78469-02-000	EA	Window Asm. - Driver Door (w/o inside frame)
	077209-02-000	EA	Inside Frame - Driver Door Window - Black
	M78469-01-000	EA	Window Asm. - Passenger Door (w/o inside frame)
	077209-01-000	EA	Inside Frame - Passenger Door Window - Black
	Not illustrated		

1985 WINNEBAGO TABLE OF CONTENTS

WC420RG
WCN23RG
WCP31RT
WCN31RT

A-01 - C-02
C-03 - E-10
E-11 - G-14
G-15 - I-24

1985 WCP31RC INDEX

Floor Plan	E-11 - E-12
Accessories Group	E-13 - E-15
Bath Group	E-16
Chassis Group	E-17 - E-22
Curtain, Cushion & Pad Group	E-23 - F-05
Dinette Group	F-06
Driver's Compartment Group	F-07 - F-10
Electrical Group	F-11 - F-13
Exterior Body Group	F-14 - F-23
Galley Group	F-24 - G-02
Heating & Air Conditioning Group	G-03
Interior Finish Group	G-04 - G-05
LP Group	G-06
Lounge Group	G-07
Water & Sewage Group	G-08
Window, Vent & Exterior Door Group	G-09 - G-14

WINDOW, VENT & EXTERIOR DOOR GROUP (CONTINUED)

DRIVER & PASSENGER CAB DOORS

Key	Part Number	U/M	Description
	M01595-01-T06	EA	Door Complete - Passenger
	M01595-01-T07	EA	Door Complete - Passenger
	M01595-01-T08	EA	Door Complete - Passenger
	M01596-01-T06	EA	Door Complete - Drivers
	M01596-01-T07	EA	Door Complete - Drivers
	M01596-01-T08	EA	Door Complete - Drivers
	M78469-01-000	EA	Window Asm. - Passenger Door - w/Support
	M78469-02-000	EA	Window Asm. - Drivers Door - w/Support
	047369-01-000	EA	Latch
	M02389-53-001	EA	Outside Mullion - w/Finish Seal
	002324-02-000	EA	Channel - Weatherstrip - Glass
	041928-02-000	EA	Seal - Window Channel
	050216-02-000	EA	Spline - Vinyl Glass - .19 Black
	077036-01-000	EA	Glass - .19" x 28.9" x 22"
	077378-01-000	EA	Glass - .19" x 15" x 9.3"
	077379-01-000	EA	Glass - .19" x 15" x 9.3" - w/Hole
	077224-03-000	EA	Window Mullion - Horizontal - Passenger
	077224-04-000	EA	Window Mullion - Horizontal - Driver
	077226-01-000	EA	Window Mullion - Vertical - Passenger
	077226-02-000	EA	Window Mullion - Vertical - Driver
	051400-05-000	EA	Assist Strap - 12" - w/Woodgrain
	075671-01-000	FT	Sponge Seal - Lazy T Shape
	076542-01-000	EA	Control Rod - Right Hand Latch
	076543-01-000	EA	Control Rod - Right Hand Lock
	076542-02-000	EA	Control Rod - Left Hand Latch
	076543-02-000	EA	Control Rod - Left Hand Lock
	077167-01-000	EA	Door Prop Rod - Passenger
	077167-02-000	EA	Door Prop Rod - Drivers
	076783-01-000	EA	Louver/Bezel Asm. - Black - 2"
	076813-01-000	FT	Seal - Entrance Door
	077179-01-000	EA	Hose Adapter - 2" - Snap In
	077000-01-000	EA	Socket Asm. - w/8" Pigtail Leads
	077117-03-000	EA	Door Panel - Front Inner - Passenger
	077117-04-000	EA	Door Panel - Front Inner - Driver
	077209-01-000	EA	Inside Frame Asm. - Window - Passenger
	077209-02-000	EA	Inside Frame Asm. - Window - Driver
	063886-03-000	EA	Assist Handle - Beige Steel Tube
	R77007-56-702	EA	Bolt Lock - Left
	R77040-01-538	EA	Door Handle - Exterior
	R77007-05-374	EA	Gasket - Door Handle - Exterior
	R77006-50-326	EA	Door Handle - Interior - Left
	R77007-04-136	EA	Lock Bracket
	R77006-89-269	EA	Control Arm Lock
	R77030-67-257	EA	Spline Pin
	R77007-18-263	EA	Latch Asm. - Inner - Left
	R77007-51-201	EA	Cylinder & Key
	R77006-64-355	EA	Control Link

WINDOW, VENT & EXTERIOR DOOR GROUP (CONTINUED)

CRANKOUT WINDOW HARDWARE

Key	Part Number	U/M	Description
	075901-01-000	EA	Window Asm. - 10" Awning Type - 26 3/8" x 27 3/8" - Left Mech. - Hehr
	075901-01-700	EA	Operating Mech. - Left Hand
	075901-01-701	EA	Operating Mech. - Right Hand
	075901-01-702	EA	Knob - Black
	075901-01-703	EA	Screen Clip
	075901-02-000	EA	Window Asm. - 10" Awning Type - Double - 62 3/8" x 33 3/8" - Hehr
	075901-03-000	EA	Window Asm. - 10" Awning Type - 42 3/8" x 33 3/8" - Left Mech. - Hehr
	075901-04-000	EA	Window Asm. - 10" Awning Type - 15 3/8" x 33 3/8" - Left Mech. - Hehr
	075901-05-000	EA	Window Frame - Inside - 26 3/8" x 27 3/8" - Black
	075901-06-000	EA	Window Frame - Inside - 62 3/8" x 33 3/8" - Black
	075901-07-000	EA	Window Frame - Inside - 42 3/8" x 33 3/8" - Black
	075901-08-000	EA	Window Frame - Inside - 15 3/8" x 33 3/8" - Black
	075901-09-000	EA	Window Asm. - 10" Awning Type - 24 7/8" x 25" - Right Mech. - Hehr
	075901-10-000	EA	Window Asm. - 10" Awning Type - 24 7/8" x 25" - Left Mech. - Hehr
	075901-11-000	EA	Window Frame - Inside - 24 7/8" x 25" - Black
	075901-11-700	EA	Window Frame - Inside - 24 5/8" x 24 3/4" - Black

VENTS & DOMES

Key	Part Number	U/M	Description
	071290-02-000	EA	Cover - Refrigerator Vent - 11 5/8" x 24 3/4" - Galv. Steel
	071290-01-000	EA	Roof Base - Refrigerator Vent - 7.5" x 25.5" - Galv. Steel
	049352-02-000	EA	Vent - Stovehood - Outside - Beige
	077487-01-000	EA	Skylight - Fixed Dome (Bath)
	077902-01-000	EA	Collar - Skylight
	075056-01-000	EA	Vent Asm. - Roof - Non-Powered - w/o Screen
	016335-07-000	EA	Screen Asm. - Roof - Non-Powered - Beige/Black Screen
	064469-01-000	EA	Vent - Power Roof - 14 x 14 - 12 Volt - Off White - Jensen (Bath) - US
	064469-02-000	EA	Vent - Power Roof - 14 x 14 - 12 Volt - Off White - Jensen (Bath) - CSA
	064469-03-000	EA	Vent - Power Roof - 12 Volt - UL
	064469-03-700	EA	Switch - On/Off/On
	064469-03-701	EA	Switch - Rocker - On/Off
	064469-03-702	EA	Lid - Vent - White
	064469-03-703	EA	Screen Frame/Light Assembly
	064469-03-704	EA	Screw - 10-24
	064469-03-705	EA	Garnish - Vent - 2.5" Wide
	064469-03-706	EA	Lift Mechanism
	064469-03-707	EA	Motor Lift
	064469-03-708	EA	Gear Drive
	064469-03-709	EA	Gear - Motor Pinion
	064469-03-710	EA	Lens - Light w/o Switch Holes
	064469-04-000	EA	Vent - Non-Power Roof - 12 Volt - Jensen (Bath) - UL
	064469-05-000	EA	Vent - Non-Power Roof - 12 Volt - Jensen (Bath) - CSA

1985 WINNEBAGO
TABLE OF CONTENTS

WC420RG	A-01 - C-02
WCN23RG	C-03 - E-10
WCP31RT	E-11 - G-14
WCN31RT	G-15 - I-24

1985 WCP31RC INDEX

Floor Plan	E-11 - E-12
Accessories Group	E-13 - E-15
Bath Group	E-16
Chassis Group	E-17 - E-22
Curtain, Cushion & Pad Group	E-23 - F-05
Dinette Group	F-06
Driver's Compartment Group	F-07 - F-10
Electrical Group	F-11 - F-13
Exterior Body Group	F-14 - F-23
Galley Group	F-24 - G-02
Heating & Air Conditioning Group	G-03
Interior Finish Group	G-04 - G-05
LP Group	G-06
Lounge Group	G-07
Water & Sewage Group	G-08
Window, Vent & Exterior Door Group	G-09 - G-14

WINDOW, VENT & EXTERIOR DOOR GROUP (CONTINUED)

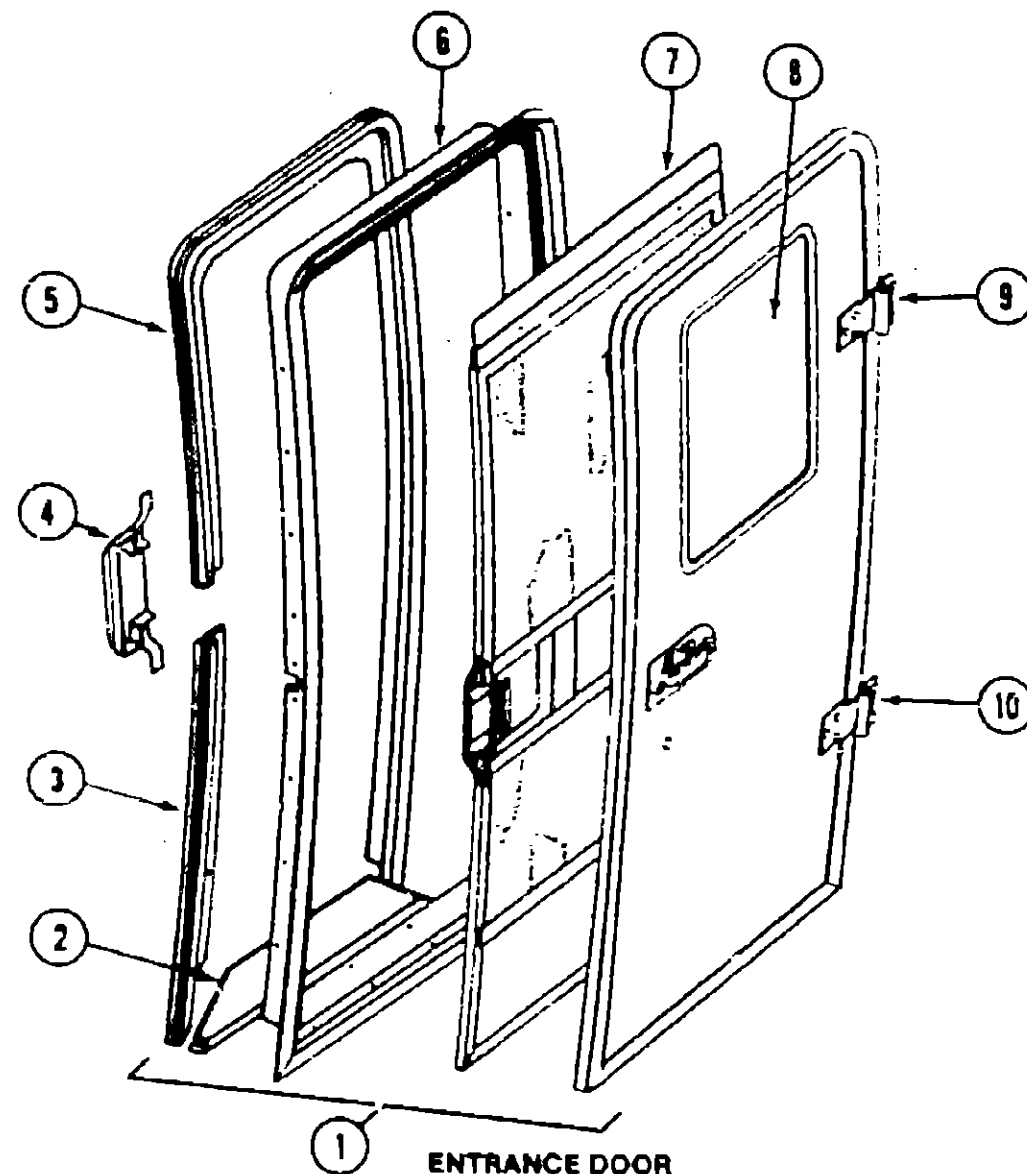

Key	Part Number	U/M	Description
1	M76900-01-T06	EA	Door Asm. - Radius Entry w/Screen Door - Fiberglass - Beige
2	076929-01-000	EA	Trim - Entrance Door - Lower
3	076936-01-000	EA	Trim - Entrance Door - Side
4	076726-01-000	EA	Strike Cover
5	076928-01-000	EA	Trim - Entrance Door Upper
6	076947-01-000	EA	Jamb Asm. (w/o Bottom Portion)
	076942-01-000	EA	Jamb Asm. (Bottom Portion Only)
7	076981-01-000	EA	Screen Door - Complete
	076727-01-000	EA	Slider - Screen Door - Light Oak Plastic
8	079733-04-T03	EA	Window Asm. - Picture (w/o inside frame)
	002181-06-000	EA	Glass - .115" x 16.25" x 24"
	067609-03-000	EA	Inside Window Frame - Beige
	076948-03-000	EA	Valance Panel - Lower Outside - Entrance Door
9	076720-02-000	EA	Hinge Asm. - Upper - Beige
10	076719-02-000	EA	Hinge Asm. - Lower - Beige
	076838-01-000	EA	Hinge Shim
	076810-01-000	EA	Gasket - Hinge Shim
	041875-09-000	EA	Assist Handle - Black
	R77040-01-538	EA	Door Handle - Exterior
	R77006-50-261	EA	Door Handle - Interior
	073303-01-000	EA	Latch Asm. - Inner
	076728-02-000	EA	Panel Trim - Light Oak - Plastic
	R77007-56-701	EA	Lock Bolt
	R77007-51-201	EA	Cylinder & Key Set
	075671-02-000	FT	Sponge Seal - Lazy T Shape
	Not illustrated		

WINDOW, VENT & EXTERIOR DOOR GROUP (CONTINUED)

WINDSHIELD & SIDE VENT WINDOWS

Key	Part Number	U/M	Description
	074887-01-000	EA	Glass - Windshield - Passenger
	074887-02-000	EA	Glass - Windshield - Drivers
	076671-01-000	EA	Glass - Front Corner Vent - Drivers
	076671-03-000	EA	Glass - Front Corner Vent - w/Shade Band - Drivers
	076671-02-000	EA	Glass - Front Corner Vent - Passenger
	076671-04-000	EA	Glass - Front Corner Vent - w/Shade Band - Passenger
	002328-02-000	EA	Cushion Block - Windshield
	076672-01-000	EA	Molding Seal - Passenger Windshield - Rubber
	076672-02-000	EA	Molding Seal - Drivers Windshield - Rubber
	076676-01-000	EA	Molding Seal - Windshield Center

ACCESS DOORS

Key	Part Number	U/M	Description
	077343-03-000	EA	Door Asm. - Luggage - Beige - w/Locks
	076510-01-000	EA	Door Asm. - Small Storage - Beige - w/Locks
	076510-03-000	EA	Door Asm. - Large Storage - Beige - w/Locks
	059247-05-000	EA	Door Asm. - Refrigerator Access - Beige - w/Twist Lock
	076232-01-000	EA	Door Asm. - Spare Tire Compartment - Beige
	M77343-01-000	EA	Door Asm. - Generator - w/Twist Locks - Beige
	052009-02-000	EA	Door Asm. - Water Heater - Beige
	076859-01-000	EA	Water Heater Shroud - Beige
	052181-01-000	EA	Baffle - Generator Door
	063742-02-000	EA	Door - Power Cord - Beige
	054543-02-000	EA	Hatch - Power Cord Door - Beige
	054530-01-000	EA	Door Holder
	042441-01-000	EA	Lock Asm. - Key Type - Gas Fill
	077486-01-000	EA	Lock Asm. - Key Type w/Clip (Storage)
	042442-02-000	EA	Lock Asm. - Twist Type - w/Clip (Storage)
	009003-01-000	EA	Lock Asm. - Twist Type - w/Clip (Generator)
	047305-01-000	EA	Lock Asm. - Key Type - w/Clip (Luggage)
	077408-01-000	EA	Lock Asm. - Key Type - w/Clip (Tire Cover)
	077392-01-000	EA	Strike Asm. (Tire Cover)
	041312-01-000	FT	Door Seal e-Section - Rubber
	058027-02-000	FT	Door Seal - D Section - Sponge Rubber
	078010-01-000	EA	Door - Fuel Fill - Beige

1985 WINNEBAGO TABLE OF CONTENTS

WC420RG	A-01 - C-02
WCN23RG	C-03 - E-10
WCP31RT	E-11 - G-14
WCN31RT	G-15 - I-24

1985 WCP31RC INDEX

Floor Plan	E-11 - E-12
Accessories Group	E-13 - E-15
Bath Group	E-16
Chassis Group	E-17 - E-22
Curtain, Cushion & Pad Group	E-23 - F-05
Dinette Group	F-06
Driver's Compartment Group	F-07 - F-10
Electrical Group	F-11 - F-13
Exterior Body Group	F-14 - F-23
Galley Group	F-24 - G-02
Heating & Air Conditioning Group	G-03
Interior Finish Group	G-04 - G-05
LP Group	G-06
Lounge Group	G-07
Water & Sewage Group	G-08
Window, Vent & Exterior Door Group	G-09 - G-14