

1985 WCN26RB

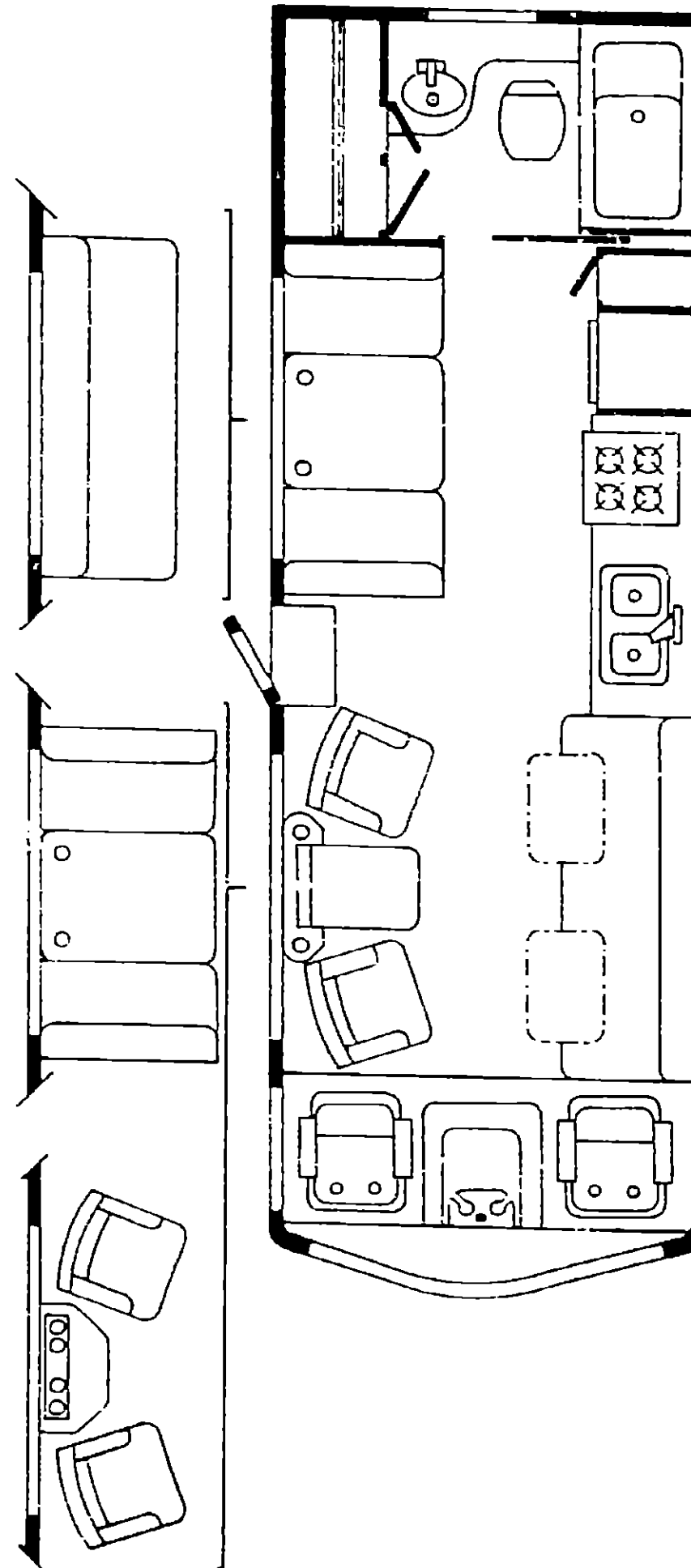
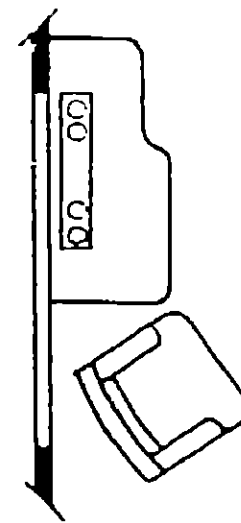

1985 WINNEBAGO TABLE OF CONTENTS

WC/WF421RB	A-01 - C-06
WC424RC	C-07 - E-16
WCN26RH	E-17 - G-22
WCN26RB	G-23 - J-04

1985 WCN26RB INDEX

Floor Plan	G-23 - G-24
Accessories Group	H-01 - H-03
Bath Group	H-04
Chassis Group	H-05
Curtain, Cushion & Pad Group	H-06 - H-12
Dinette Group	H-13 - H-16
Driver's Compartment Group	H-17 - H-19
Electrical Group	H-20 - H-22
Exterior Body Group	H-23 - I-05
Galley Group	I-06 - I-08
Heating & Air Conditioning Group	I-09 - I-10
Interior Finish Group	I-11 - I-12
LP Group	I-13
Lounge Group	I-14
Water & Sewage Group	I-15 - I-16
Window, Vent & Exterior Door Group	I-17 - J-04

ACCESSORIES GROUP

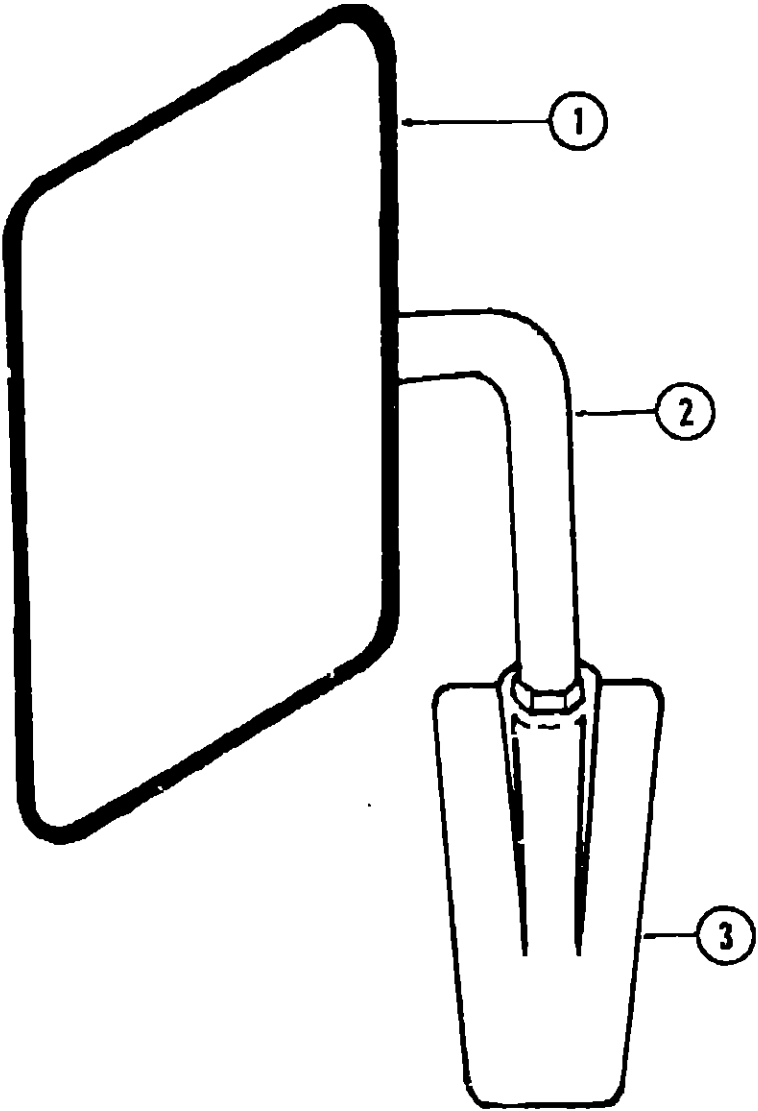

EXTERIOR MIRRORS

Key	Part Number	U/M	Description
1	049347-01-000	EA	Mirror Head - 7 1/2" x 10 1/2"
2	049348-03-000	EA	Arm - Low Mount Mirror - Black
3	049944-04-000	EA	Bracket - Mirror - Outside - Black
.	065116-01-000	EA	Mirror - West Coast - Double - Messenger
.	065116-02-000	EA	Mirror - West Coast - Double - Driver
.	006043-01-000	EA	Mirror - Convex - Adhesive Back
.	Not illustrated		

ACCESSORIES GROUP (CONTINUED)

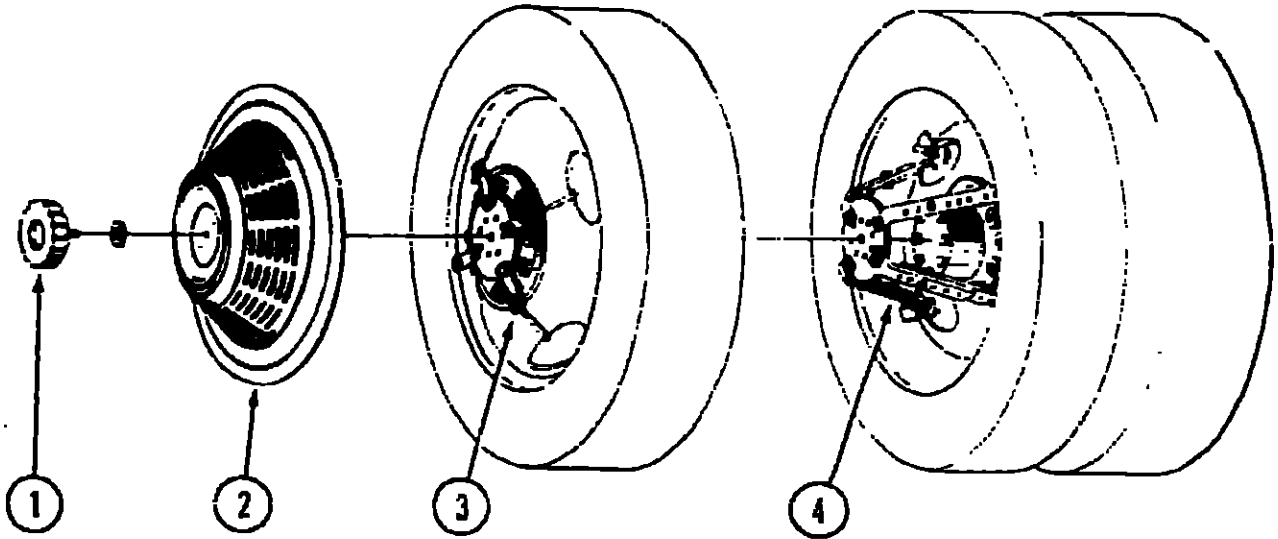

WHEEL COVER & MOUNTING HARDWARE

Key	Part Number	U/M	Description
1	064082-02-000	EA	Retaining Nut - Delmet - Wheel Cover
2	073426-01-700	EA	Wheel Cover - Bolt On - 16" or 16.5" - Delmet (1)
3	073426-04-700	EA	Retention Bracket Asm. - Wheel Cover Support - Heavy Duty - Front (1)
4	073426-04-701	EA	Retention Bracket Asm. - Wheel Cover Support - Heavy Duty - Rear (1)
.	073426-04-000	EA	Retention Bracket Asm. - Wheel Cover Support - Heavy Duty (Set/4)
**	031296-04-000	EA	Wheel Cover - 16" - Clip On
.	Not illustrated		
**	The illustrated parts breakdown for this item is provided on the Common Items Fiche.		

GENERATORS & COMPONENTS

Key	Part Number	U/M	Description
**	054429-01-000	EA	Generator - Onan - 4.0 kw
.	052168-01-000	EA	Generator - Onan - 4.25 kw
.	068046-01-000	EA	Conversion Kit - LP - Onan Generator
.	024732-01-016	EA	Tailpipe - 1.5" O.D. x 43.5"
.	067753-01-000	EA	Muffler - Generator - w/Spark Arrestor - Nelson
.	007067-01-000	SF	Insulation - 1" - Fiberglass
.	701629-02-000	EA	Installation Package
**	The illustrated parts breakdown for this item is provided on the Common Items Fiche		

RADIO & RELATED COMPONENTS

Key	Part Number	U/M	Description
.	031105-01-000	EA	Antenna - Radio - Side Mount
.	031105-01-700	EA	Holder - Antenna - Radio - Upper
.	064791-01-000	EA	Speaker - Recessed - 5.25"
.	073431-01-000	EA	Speaker - 5.25" - 3-Way (Pair)
.	074979-01-000	EA	Speaker Cover Protector - Plastic
.	064792-01-000	EA	Grille - Speaker - 5.25" - w/Mesh - Brown
.	075903-01-000	EA	Radio - AM/FM Stereo - w/Cassette - Audiovox - GMJSPG
.	075904-01-000	EA	Radio - AM/FM Stereo - w/Cassette - Electronic Tune - Audiovox - GMJDGO

1985 WINNEBAGO
TABLE OF CONTENTS

WC/VF421RB	A-01 - C-06
WC424RC	C-07 - E-16
WCN26RH	E-17 - G-22
WCN26RB	G-23 - J-04

1985 WCN26RB INDEX

Floor Plan	G-23 - G-24
Accessories Group	H-01 - H-03
Bath Group	H-04
Chassis Group	H-05
Curtain, Cushion & Pad Group	H-06 - H-12
Dinette Group	H-13 - H-16
Driver's Compartment Group	H-17 - H-19
Electrical Group	H-20 - H-22
Exterior Body Group	H-23 - I-05
Galley Group	I-06 - I-09
Heating & Air Conditioning Group	I-09 - I-10
Interior Finish Group	I-11 - I-12
LP Group	I-13
Lounge Group	I-14
Water & Sewage Group	I-15 - I-16
Window, Vent & Exterior Door Group	I-17 - J-04

ACCESSORIES GROUP (CONTINUED)

MISCELLANEOUS ACCESSORIES

Key	Part Number	U/M	Description
	054185-22-000	EA	Owners Manual - 1985 - Itasca & Winnebago
	076319-01-000	EA	Antenna - TV - (Wineguard Antenna)
	076319-03-000	EA	Coaxial Cable - 75 Ohm (Wineguard Antenna)
	076319-04-000	EA	Connector & Ferrule (Wineguard Antenna)
	076319-09-000	EA	Wall Plate/Receptacle - Brown (Wineguard Antenna)
	076319-05-000	EA	Wallplate - Power Supply - Ivory
	076319-06-000	EA	Adapter - Cable Roof Plate
	076319-07-000	EA	Wallplate - Power Supply - Brown
	076319-08-000	EA	Wallplate - Receptacle - Ivory
	076319-09-000	EA	Wallplate - Receptacle - Brown
	017516-01-000	EA	Mud Flap w/Holes - 14" x 18" - Black
	041944-03-000	EA	Fire Extinguisher - 5BC
	041944-02-000	EA	Bracket - Fire Extinguisher
	075922-01-000	EA	Microwave Oven - Litten - 1450
	078977-01-000	EA	Bracket Asm. - Microwave - Right
	078977-02-000	EA	Bracket Asm. - Microwave - Left
	076253-02-000	EA	Bracket Asm. - Microwave - Bottom (2 required)
	075922-03-000	EA	Trim Ring - Microwave Oven
	075922-04-000	EA	Air Exhaust Duct - Microwave Oven
	079110-01-000	EA	Ladder Asm.
	079110-01-701	EA	Luggage Rack Asm.
	080752-05-000	EA	Steering Wheel - Custom
	080752-06-000	EA	Adapter Hub - Steering Wheel
	080752-07-000	EA	Horn Button - Steering Wheel
	080752-08-000	EA	Screw - Steering Wheel - Custom
	067130-01-000	EA	Ladder Step
	076990-01-000	EA	End Cap - Ladder Step
	067125-01-000	EA	Stand Off - Rack & Ladder Asm.
	084093-01-000	EA	Luggage Carrier Assembly - 14" x 30" x 60" - Plastic
	039881-01-000	EA	Catch & Strike - Luggage Carrier
	072366-01-000	EA	Speed Control Package - Electric - Diesel - Dana
	072366-01-700	EA	Flex Fittings
	072366-01-701	EA	Cable Only
	072366-01-702	EA	Vacuum Regulator
	072366-01-703	EA	Control Switch & Lever Asm.
	069629-01-000	EA	Speed Control Package - Electric Dana
	069629-01-700	EA	Regulator Asm. - Electric
	069629-01-701	EA	Vacuum Valve & Electric Switch
	069629-01-702	EA	Control Switch & Lever Asm.
	069629-01-703	EA	Harness Asm. (Main Wiring)
	069629-01-704	EA	Generator Switch
	069629-01-705	EA	Adapter Key
	074481-01-000	EA	Valve Asm. - Switch - Speed Control
	074483-01-000	EA	Retainer Nut - Snap On - Speed Control
	072852-01-000	EA	Smoke Detector w/9 Volt Battery
	079664-02-000	EA	Weather Center - 8.5" x 8.5"
	079664-01-000	EA	Clock - 8.5" x 8.5"
	006069-01-000	EA	Key Case - Leather
	007038-01-000	EA	Door Mat - 10.5" x 26" - Black Rubber
	080208-01-000	EA	Lug Wrench - 1.06" x 1.0"
	080208-02-000	EA	Leverage Bar - 21" - Lug Wrench
	006113-01-000	EA	Jack - Hydraulic - 5 Ton - w/Handle
	079941-01-000	EA	Lamp Asm. - Fog w/Cover - Amber

BATH GROUP

BATH CABINETRY

Key	Part Number	U/M	Description
	M80590-01-T03	EA	Cabinet Asm. - Vanity - w/o Countertop & Doors
	076633-34-T03	EA	Door Asm. - Lavatory - w/o Hardware
	M02081-01-T03	EA	Countertop Asm. - Vanity Cabinet
	076073-01-000	EA	Cabinet Asm. - Medicine - w/o Door or Hardware
	076353-01-T03	EA	Door Asm. - Medicine Cabinet w/Mirror - 15.1" x 30.1" - w/o Hardware
	079547-01-T03	EA	Door Asm. - Sliding - 74.1" x 28" - w/o Hardware
	076633-31-T03	EA	Door Asm. - Wardrobe Cabinet - 39.6" x 12.9" - w/o Hardware
	076633-30-T03	EA	Door Asm. - Wardrobe Cabinet - 59" x 16" - w/o Hardware
	077358-01-T03	EA	Drawer Asm. - Lavatory

BATH HARDWARE

Key	Part Number	U/M	Description
	075356-01-000	EA	Bathtub Asm.
	075242-02-000	EA	Faucet - Tub & Shower - Antique Brass
	031558-01-000	EA	Faucet - Tub & Shower - CSA
	031558-01-700	EA	Adapter - Shower Hose/Faucet
..	011048-02-000	EA	Shower Head - w/60" Hose
	011048-04-000	EA	Vacuum Breaker - 1/8 MPT - Nylon - Shower Head
	072650-01-000	EA	Shower Panel w/Soap Dish - Plastic
	075606-01-000	EA	Shower Panel - Faucet - Plastic
	076137-01-000	EA	Trim - Jamb - Bathtub Asm.
..	066729-01-000	EA	Strainer - Bathtub Asm.
	066435-01-000	EA	Nut - Strainer - Plastic - Bathtub Asm.
	066436-01-000	EA	Slip Nut - 1.5" Tail Piece - Bathtub Asm.
	069735-01-000	EA	Washer - Tail Piece - 1.5" - Plastic - Bathtub Asm.
	011069-02-000	EA	Tail Piece - 1.5" x 1.25" x 4" - Brass - Bathtub Asm.
	058713-01-000	EA	Sink - Oval - Ivory Plastic
	075240-02-000	EA	Faucet - Lavatory - Antique Brass
	011056-02-000	EA	Faucet - Lavatory - CSA
	011083-01-000	EA	Tail Piece w/Stopper - 1.25" x 5" - Plastic - Sink
	039341-02-000	EA	Toilet - Thetford - Aqua Magic - Ivory - 8420 SH
	075452-01-000	EA	Tissue Holder - Antique Brass
	075453-01-000	EA	Towel Bar - 18" - Antique Brass
	075454-01-000	EA	Towel Ring - Antique Brass
	052563-03-T03	EA	Towel Rack Asm. - Wood
	062467-01-000	EA	Guide - Sliding Door - Mounts on Wall
	009156-01-000	EA	Hanger - Sliding Door
	075145-06-000	EA	Cover - Sliding Door Track - 54 2"
	075153-01-000	EA	Cover - End Cap - Sliding Door Track - Beige
	075149-04-000	EA	Track - Sliding Door - 54 2"
	058034-02-000	EA	Latch - Sliding Door - w/o Lock
	075687-01-000	EA	Latch Asm. - Bathroom Door - Privacy
	009112-01-000	EA	Flange - 1" Closet Rod
	075680-01-000	EA	Closet Rod - Adjustable
	009150-01-000	EA	Warp Guard - 64"
	058331-05-000	EA	Mirror - Tempered Glass - 12" x 26"
	057671-01-000	EA	Screw Cover - #8 - Antique White
	066433-01-000	EA	Cup Hook - Bright
	071632-01-000	EA	Hamper Bag - 49" - w/Elastic
..	The illustrated parts breakdown for this item is provided on the Common Items Fiche.		

1985 WINNEBAGO
TABLE OF CONTENTS

WC/WF421RB	A-01 - C-06
WC424RC	C-07 - E-16
WCN26RH	E-17 - G-22
WCN26RB	G-23 - J-04

1985 WCN26RB INDEX

Floor Plan	G-23 - G-24
Accessories Group	H-01 - H-03
Bath Group	H-04
Chassis Group	H-05
Curtain, Cushion & Pad Group	H-06 - H-12
Dinette Group	H-13 - H-16
Driver's Compartment Group	H-17 - H-19
Electrical Group	H-20 - H-22
Exterior Body Group	H-23 - I-05
Galley Group	I-06 - I-08
Heating & Air Conditioning Group	I-09 - I-10
Interior Finish Group	I-11 - I-12
LP Group	I-13
Lounge Group	I-14
Water & Sewage Group	I-15 - I-16
Window, Vent & Exterior Door Group	I-17 - J-04

CHASSIS GROUP

MISCELLANEOUS

Key	Part Number	U/M	Description
	071795-02-000	EA	Pipe - Fuel Fill - 55.2" - Lower
	075227-02-000	EA	Fuel Fill - w/Vent - Upper (Diesel)
	075227-01-000	EA	Fuel Fill - w/Vent - Upper (Gas)
	073220-02-000	EA	Cap - Fuel Fill - Non Lock (Gas)
	073220-03-000	EA	Cap - Fuel Fill - Non Lock (Diesel)
	024141-01-000	FT	Hose - Rubber - 1/2" I.D.
	007134-01-000	EA	Clamp - Hose - Spring Type 9/16"
	061411-03-000	EA	Extension - Exhaust - 2.25" O.D. x 10.5" (454 Engine)
	022655-02-000	EA	Extension - Exhaust - 2.25" O.D. x 8" (Diesel Engine)
	007111-02-000	FT	Hose - Fuel - 2" I.D. SAE 30RI (3')
	055080-01-000	EA	Wheel Well - Plastic
	052431-02-000	EA	Tray - Luggage
	007125-05-000	EA	Clamp Asm. - Muffler - 2"
	017516-01-000	EA	Mud Flap - Black - 14" x 18"
	051697-04-000	EA	Bracket - Battery Tie Down - 9"
	048594-01-000	EA	Battery Tray Asm.
	078465-01-000	EA	Hood Board - Upper - Right - Steel
	078464-01-000	EA	Hood Board - Upper - Left - Steel
	071656-01-000	EA	Cover - Radiator - Rear
	071657-01-000	EA	Cover - Radiator - Rear Back (Fan Shroud)
	077850-09-000	EA	Bumper - Front - Chrome
	077850-06-000	EA	Bumper - Front - Beige
	078584-08-000	EA	Bumper - Rear - Chrome
	078584-04-000	EA	Bumper - Rear - Beige
	079129-01-000	EA	Bracket - Bumper Mount - Rear Bumper
	063977-03-000	EA	Step Asm. - Driver Door
	024652-01-700	EA	Step Asm. - Entry
	047441-01-000	EA	Battery Terminal - Horizontal Lug
	071479-02-000	EA	Battery Terminal Boot
	040546-03-000	EA	Tire - 7.50 x 16 - 8 Ply - Tube Type
	064962-02-000	EA	Rim - Wheel - 16 x 6.00
	050273-02-000	EA	Tire - 7.50 x R16 x CA T8 - Tubeless
	064225-02-000	EA	Hold Down - Spare Tire Carrier
	064179-01-000	EA	Tire Carrier - Side Compartment
	072363-01-000	EA	Water Detector Probe - Fuel Line
	072364-01-000	EA	Water Detector Module - Fuel Line
	073352-01-000	EA	Bracket - License Plate - Front
	080208-01-000	EA	Lug Wrench - 1.06" x 1.0"
	080208-02-000	EA	Leverage Bar - 21" - Lug Wrench
	006113-01-000	EA	Jack - Hydraulic - 6 Ton - w. Handle
	072850-01-700	EA	Bumper Kit - Rubber - Front
	020167-03-000	EA	Dirt Guard - Wheel Well
	034512-01-000	EA	Drawbar Pin - Locking
	034513-01-000	EA	Hitch Pin - 3/16 Wire
	077613-01-000	EA	Drawbar Asm
	077617-01-000	EA	Drawbar Hitch - w/o Draw Bar Asm

CURTAIN, CUSHION & PAD GROUP

NOTICE

In order to assist our Parts Sales Dept. in providing interior software items, please include the serial number and the color code number from the vehicle certification label when ordering. This label is located on the left sidewall at the end of the dash (A-Body), or on the driver's door latch plate (C-Body).

An example of a color code number is P31, which designates an overall color scheme of a particular unit. The color listed after the item description on the microfiche, indicates the overall unit color. Order the item you desire according to unit color code.

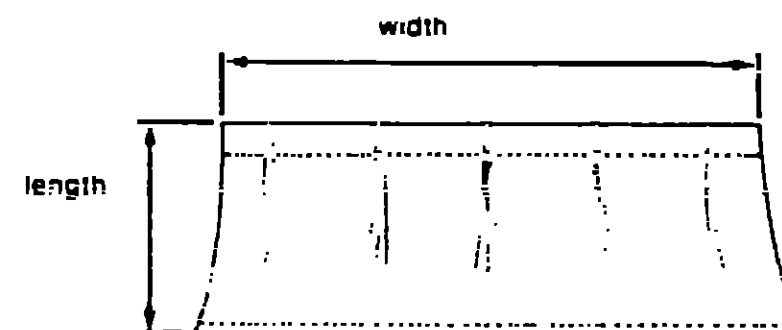

NOTE:

Use this illustration when determining length and width measurements for curtains. You will note the width measurement is taken on the top of the curtain with the curtain fully extended. The length measurement is taken from top to bottom.

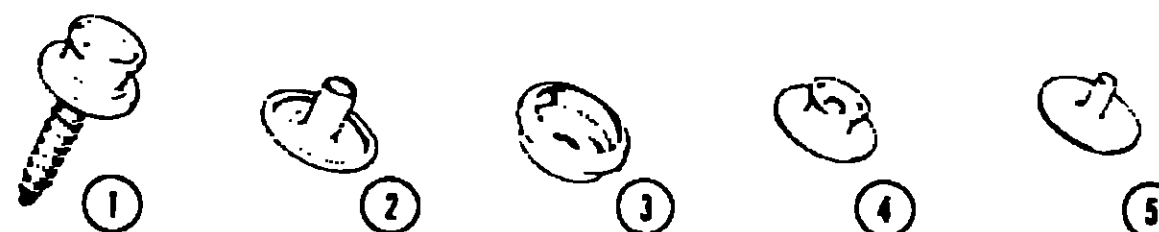

Key	Part Number	U/M	Description
1	029130-01-000	EA	Socket - Snap Fastener
2	029155-01-000	EA	Cap - Snap - .156" Dia x .17" Barrel
3	029156-01-000	EA	Socket - Snap Fastener
4	029092-01-000	EA	Stud - Nickel Finish
5	029093-01-000	EA	Eyelet - Nickel Finish

CURTAIN HARDWARE

Key	Part Number	U/M	Description
	079946-01-000	EA	Track - Curtain - Front Wraparound - Right
	078846-02-000	EA	Track - Curtain - Front Wraparound - Left
	056001-01-000	EA	Bracket - Shade - Left
	056002-01-000	EA	Bracket - Shade - Right
	056003-01-000	EA	Bracket - Drapery Retainer - Right
	056003-02-000	EA	Bracket - Drapery Retainer - Left
	056003-03-000	EA	Bracket - Drapery Retainer - Universal
	056784-01-000	EA	Pull - Window Shade - Antique Brass
	056115-01-000	YD	Tape - Clear Plastic - w. Guides
	048394-01-000	YD	Tape Hook - 1" x 25 YD - Beige (Velcro)
	048395-01-000	YD	Tape Loop - 1" x 25 YD - Beige (Velcro)

1985 WINNEBAGO TABLE OF CONTENTS

WC/WF421RB
WC424RC
WCN26RH
WCN26RB

A-01 - C-06
C-07 - E-16
E-17 - G-22
G-23 - J-04

1985 WCN26RS INDEX

Floor Plan	G-23 - G-24
Accessories Group	H-01 - H-03
Bath Group	H-04
Chassis Group	H-05
Curtain, Cushion & Pad Group	H-06 - H-12
Dinette Group	H-13 - H-16
Driver's Compartment Group	H-17 - H-19
Electrical Group	H-20 - H-22
Exterior Body Group	H-23 - I-05
Galley Group	I-06 - I-08
Heating & Air Conditioning Group	I-09 - I-10
Interior Finish Group	I-11 - I-12
LP Group	I-13
Lounge Group	I-14
Water & Sewage Group	I-15 - I-16
Window, Vent & Exterior Door Group	I-17 - J-04

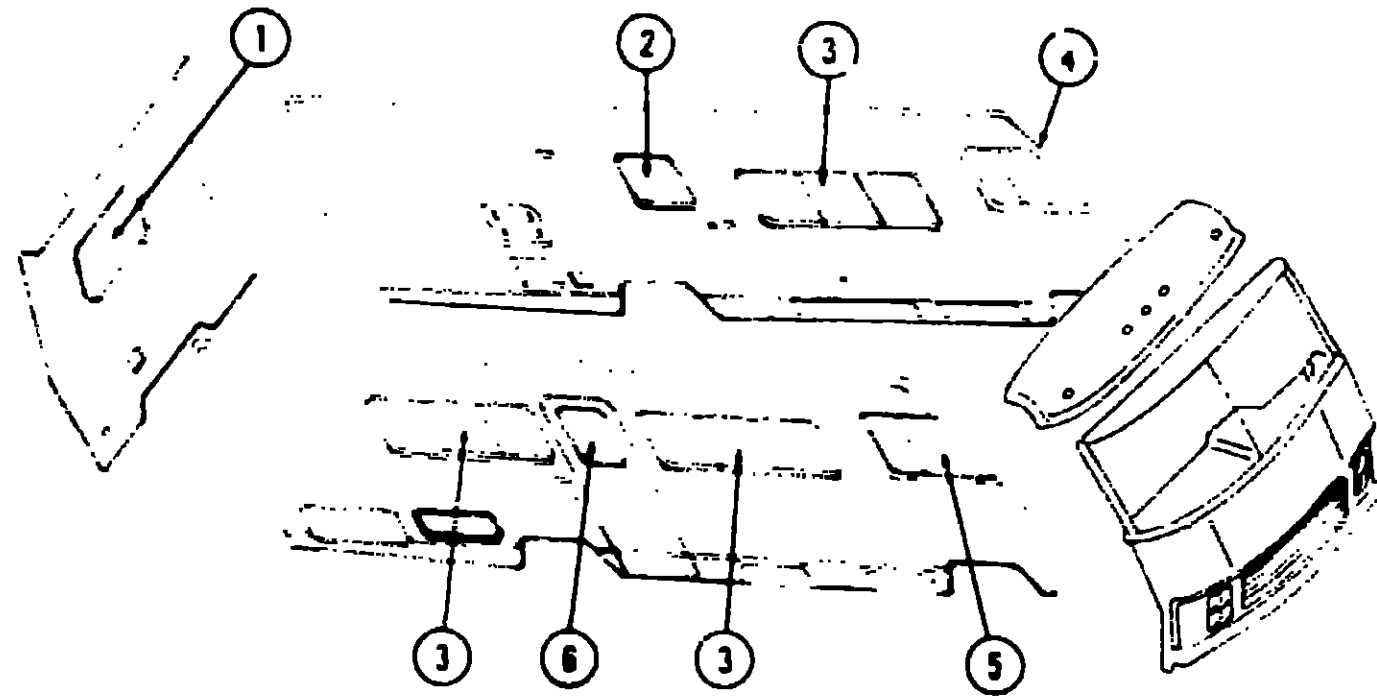

CURTAINS, VALANCES, SHADES & TIEBACKS

Key	Part Number	U/M	Description
1	079544-05-T03	EA	Curtain Asm. - 26" x 16" - w/Tape Top - Right - Blue
1	079544-05-T04	EA	Curtain Asm. - 26" x 16" - w/Tape Top - Right - Brown
1	079544-05-T05	EA	Curtain Asm. - 26" x 16" - w/Tape Top - Right - Burgundy
1	079544-06-T03	EA	Curtain Asm. - 26" x 16" - w/Tape Top - Left - Blue
1	079544-06-T04	EA	Curtain Asm. - 26" x 16" - w/Tape Top - Left - Brown
1	079544-06-T05	EA	Curtain Asm. - 26" x 16" - w/Tape Top - Left - Burgundy
1	M79625-02-T03	EA	Valance Asm. - Padded - w/o Trim - Blue
1	M79625-02-T04	EA	Valance Asm. - Padded - w/o Trim - Brown
1	M79625-02-T05	EA	Valance Asm. - Padded - w/o Trim - Burgundy
1	078377-64-000	EA	Woven Wood Shade - 32" Wide x 26" - Blue
1	078377-65-000	EA	Woven Wood Shade - 32" Wide x 26" - Brown
1	078377-66-000	EA	Woven Wood Shade - 32" Wide x 26" - Burgundy
1	079091-10-000	EA	Pull Shade - Vinyl - 33 25" x 38" - Blue
1	079091-17-000	EA	Pull Shade - Vinyl - 33 25" x 38" - Brown
1	079091-24-000	EA	Pull Shade - Vinyl - 33 25" x 38" - Burgundy

CURTAIN, VALANCES, SHADE & TIEBACKS (CONT.)

Key	Part Number	U/M	Description
2	079544-03-T03	EA	Curtain Asm. - 21 5" x 14" - w/Tape Top - Right - Blue
2	079544-03-T04	EA	Curtain Asm. - 21 5" x 14" - w/Tape Top - Right - Brown
2	079544-03-T05	EA	Curtain Asm. - 21 5" x 14" - w/Tape Top - Right - Burgundy
2	079544-04-T03	EA	Curtain Asm. - 21 5" x 14" - w/Tape Top - Left - Blue
2	079544-04-T04	EA	Curtain Asm. - 21 5" x 14" - w/Tape Top - Left - Brown
2	079544-04-T05	EA	Curtain Asm. - 21 5" x 14" - w/Tape Top - Left - Burgundy
2	M79625-07-T03	EA	Valance Asm. - 4 5" x 31.7" - Padded - Blue
2	M79625-07-T04	EA	Valance Asm. - 4 5" x 31.7" - Padded - Brown
2	M79625-07-T05	EA	Valance Asm. - 4 5" x 31.7" - Padded - Burgundy
2	078377-40-000	EA	Woven Wood Shade - 28" Wide x 23" - Blue
2	078377-41-000	EA	Woven Wood Shade - 28" Wide x 23" - Brown
2	078377-42-000	EA	Woven Wood Shade - 28" Wide x 23" - Burgundy
2	079091-08-000	EA	Pull Shade Asm. - 28 25" x 38" - Blue
2	079091-15-000	EA	Pull Shade Asm. - 28 25" x 38" - Brown
2	079091-22-000	EA	Pull Shade Asm. - 28 25" x 38" - Burgundy
3	079542-01-T03	EA	Curtain Asm. - 30 5" x 20" - Left or Right - Blue
3	079542-01-T04	EA	Curtain Asm. - 30 5" x 20" - Left or Right - Brown
3	079542-01-T05	EA	Curtain Asm. - 30 5" x 20" - Left or Right - Burgundy
3	079543-05-T03	EA	Curtain Asm. - 30 5" x 16" (Woven Wood Shades) Blue
3	079543-05-T04	EA	Curtain Asm. - 30 5" x 16" (Woven Wood Shades) Brown
3	079543-05-T05	EA	Curtain Asm. - 30 5" x 16" (Woven Wood Shades) Burgundy
3	M79625-04-T03	EA	Valance Asm. - Padded - w/o Trim - Blue
3	M79625-04-T04	EA	Valance Asm. - Padded - w/o Trim - Brown
3	M79625-04-T05	EA	Valance Asm. - Padded - w/o Trim - Burgundy
3	075477-45-000	EA	Blinds - 68" Wide x 28" - Indigo (T03)
3	075477-59-000	EA	Blinds - 68" Wide x 28" - Bright Gold (T04)
3	075477-52-000	EA	Blinds - 68" Wide x 28" - Garnet Red (T05)
3	078377-52-000	EA	Woven Wood Shade - 68" Wide x 29" - Blue
3	078377-53-000	EA	Woven Wood Shade - 68" Wide x 29" - Brown
3	078377-54-000	EA	Woven Wood Shade - 68" Wide x 29" - Burgundy
4	073304-32-T06	EA	Front Wraparound Curtain - 32 5" x 86" - Snap Top - Sand - Left
5	073304-31-T06	EA	Front Wraparound Curtain - 32 5" x 86" - Snap Top - Sand - Right
•	077591-06-T03	EA	Blackout Curtain - 60" x 50" - Velcro Top - Sand - Left
•	077591-05-T03	EA	Blackout Curtain - 60" x 50" - Velcro Top - Sand - Right
6	M01681-15-T03	EA	Valance Asm. - 4 2" x 27 4" - Padded - Blue
6	M01681-15-T04	EA	Valance Asm. - 4 2" x 27 4" - Padded - Brown
6	M01681-15-T05	EA	Valance Asm. - 4 2" x 27 4" - Padded - Burgundy
6	079091-29-000	EA	Pull Shade Asm. - 24" x 40" - Blue
6	079091-30-000	EA	Pull Shade Asm. - 24" x 40" - Brown
6	079091-31-000	EA	Pull Shade Asm. - 24" x 40" - Burgundy
•	073260-16-T03	EA	Tieback Asm. - 3" x 20" - Blue
•	073260-16-T04	EA	Tieback Asm. - 3" x 20" - Brown
•	073260-16-T05	EA	Tieback Asm. - 3" x 20" - Burgundy
•	057534-04-000	EA	Tieback Asm. - Clear - 20"
•	057534-01-000	EA	Tieback Asm. - Clear - 6"
•	Not illustrated		

1985 WINNEBAGO
TABLE OF CONTENTS

WC/WF421RB	A-01 - C-06
WC424RC	C-07 - E-16
WCN26RH	E-17 - G-22
WCN26RB	G-23 - J-04

1985 WCN26RB INDEX

Floor Plan	G-23 - G-24
Accessories Group	H-01 - H-03
Bath Group	H-04
Chassis Group	H-05
Curtain, Cushion & Pad Group	H-06 - H-12
Dinette Group	H-13 - H-16
Driver's Compartment Group	H-17 - H-19
Electrical Group	H-20 - H-22
Exterior Body Group	H-23 - I-05
Galley Group	I-06 - I-08
Heating & Air Conditioning Group	I-09 - I-10
Interior Finish Group	I-11 - I-12
LP Group	I-13
Lounge Group	I-14
Water & Sewage Group	I-15 - I-16
Window, Vent & Exterior Door Group	I-17 - J-04

SPRUNG COUCH CUSHIONS

Key	Part Number	U/M	Description
1	058860-02-T03	EA	Pad Asm. - Armrest Cabinet - 32" x 62" x 3" - Blue
1	058860-02-T04	EA	Pad Asm. - Armrest Cabinet - 32" x 62" x 3" - Brown
1	058860-02-T05	EA	Pad Asm. - Armrest Cabinet - 32" x 62" x 3" - Burgundy
2	073630-01-T03	EA	Cushion Asm. - 3 Pillow Back - 15" x 76" x 5" - Blue
2	073630-01-T04	EA	Cushion Asm. - 3 Pillow Back - 15" x 76" x 5" - Brown
2	073630-01-T05	EA	Cushion Asm. - 3 Pillow Back - 15" x 76" x 5" - Burgundy
	M73630-01-T03	EA	Cover Asm. - 3 Pillow Back - 15" x 76" x 5" - Blue
	M73630-01-T04	EA	Cover Asm. - 3 Pillow Back - 15" x 76" x 5" - Brown
	M73630-01-T05	EA	Cover Asm. - 3 Pillow Back - 15" x 76" x 5" - Burgundy
3	073631-02-T03	EA	Cushion Asm. - 3 Pillow Seat - 23.5" x 76" x 5" - Blue
3	073631-02-T04	EA	Cushion Asm. - 3 Pillow Seat - 23.5" x 76" x 5" - Brown
3	073631-02-T05	EA	Cushion Asm. - 3 Pillow Seat - 23.5" x 76" x 5" - Burgundy
	M73631-02-T03	EA	Cover Asm. - 3 Pillow Seat - 23.5" x 76" x 5" - Blue
	M73631-02-T04	EA	Cover Asm. - 3 Pillow Seat - 23.5" x 76" x 5" - Brown
	M73631-02-T05	EA	Cover Asm. - 3 Pillow Seat - 23.5" x 76" x 5" - Burgundy
	M01846-01-T03	EA	Front Panel - Left Hand - Blue
	M01846-01-T04	EA	Front Panel - Left Hand - Brown
	M01846-01-T05	EA	Front Panel - Left Hand - Burgundy
	M01846-02-T03	EA	Front Panel - Center - Blue
	M01846-02-T04	EA	Front Panel - Center - Brown
	M01846-02-T05	EA	Front Panel - Center - Burgundy
	M01846-03-T03	EA	Front Panel - Right Hand - Blue
	M01846-03-T04	EA	Front Panel - Right Hand - Brown
	M01846-03-T05	EA	Front Panel - Right Hand - Burgundy
	Part used on front couch only		

DINETTE CUSHIONS

Key	Part Number	U/M	Description
4	072430-03-T03	EA	Cushion Asm. - Dinette Back - 19.25" x 38" x 5" - Blue
4	072430-03-T04	EA	Cushion Asm. - Dinette Back - 19.25" x 38" x 5" - Brown
4	072430-03-T05	EA	Cushion Asm. - Dinette Back - 19.25" x 38" x 5" - Burgundy
	M72430-03-T03	EA	Cover Asm. - Dinette Back - 19.25" x 38" x 5" - Blue
	M72430-03-T04	EA	Cover Asm. - Dinette Back - 19.25" x 38" x 5" - Brown
	M72430-03-T05	EA	Cover Asm. - Dinette Back - 19.25" x 38" x 5" - Burgundy
5	072430-04-T03	EA	Cushion Asm. - Dinette Bottom - 17.5" x 38" x 5" - Blue
5	072430-04-T04	EA	Cushion Asm. - Dinette Bottom - 17.5" x 38" x 5" - Brown
5	072430-04-T05	EA	Cushion Asm. - Dinette Bottom - 17.5" x 38" x 5" - Burgundy
	M72430-04-T03	EA	Cover Asm. - Dinette Bottom - 17.5" x 38" x 5" - Blue
	M72430-04-T04	EA	Cover Asm. - Dinette Bottom - 17.5" x 38" x 5" - Brown
	M72430-04-T05	EA	Cover Asm. - Dinette Bottom - 17.5" x 38" x 5" - Burgundy

SWIVEL CHAIRS

Key	Part Number	U/M	Description
6	073518-09-T03	EA	Chair Asm. w/ Pillow Back - Swivel/Recline - Blue
6	073518-09-T04	EA	Chair Asm. w/ Pillow Back - Swivel/Recline - Brown
6	073518-09-T05	EA	Chair Asm. w/ Pillow Back - Swivel/Recline - Burgundy
	075174-02-T03	EA	Skirt Asm. - Swivel Chair - Blue
	075174-02-T04	EA	Skirt Asm. - Swivel Chair - Brown
	075174-02-T05	EA	Skirt Asm. - Swivel Chair - Burgundy
	035036-01-000	EA	Plate - Tilt & Swivel - Swivel Chair - High Base
	035036-05-000	EA	Extension - 7" - Swivel Chair
	035036-04-000	EA	Base w/ Legs - Swivel Chair
	Not illustrated		

1985 WINNEBAGO
TABLE OF CONTENTS

WC/WF421RB	A-01 - C-06
WC424RC	C-07 - E-16
WCN26RH	E-17 - G-22
WCN26RB	G-23 - J-04

1985 WCN26RB INDEX

Floor Plan	G-23 - G-24
Accessories Group	H-01 - H-03
Bath Group	H-04
Chassis Group	H-05
Curtain, Cushion & Pad Group	H-06 - H-12
Dinette Group	H-13 - H-16
Driver's Compartment Group	H-17 - H-19
Electrical Group	H-20 - H-22
Exterior Body Group	H-23 - I-05
Galley Group	I-06 - I-08
Heating & Air Conditioning Group	I-09 - I-10
Interior Finish Group	I-11 - I-12
LP Group	I-13
Lounge Group	I-14
Water & Sewage Group	I-15 - I-16
Window, Vent & Exterior Door Group	I-17 - J-04

CURTAIN, CUSHION & PAD GROUP (CONTINUED)

FRONT OVERHEAD BUNK CUSHIONS

Key	Part Number	U/M	Description
	079145-04-000	EA	Cushion Asm. - Front Bunk - 34" x 78" x 4"
	M79145-04-000	EA	Cover - Front Bunk Cushion - 34" x 78" x 4"

FABRICS, TRIMS & PADS

Key	Part Number	U/M	Description
	072333-12-000	YD	Fabric - Drapery - Sand (Wraparound)
	077498-16-000	YD	Fabric - Upholstery/Accent (T03)
	077498-20-000	YD	Fabric - Upholstery/Accent (T04)
	077498-21-000	YD	Fabric - Upholstery/Accent (T05)
	077498-18-000	YD	Fabric w/Pattern - Upholstery (T03)
	077498-17-000	YD	Fabric w/Pattern - Upholstery (T04)
	077498-19-000	YD	Fabric w/Pattern - Upholstery (T05)
	038421-02-000	YD	Fabric - Mattress Ticking
	079680-01-000	YD	Vinyl - Expanded - 26 oz. Buckskin
	057550-05-T03	EA	Button Asm. - Nail - #36 - 3/8" Shank - Vinyl
	057093-01-T03	EA	Button Asm. - Covered #60 - Nail - Vinyl
	071127-03-T03	EA	Button Asm. - Square #65 - Blue
	071127-03-T04	EA	Button Asm. - Square #65 - Brown
	071127-03-T05	EA	Button Asm. - Square #65 - Burgundy
	059414-05-000	EA	Pad - Sidewall Trim - Drivers - Vinyl
	059414-06-000	EA	Pad - Sidewall Trim - Passenger - Vinyl
	059467-03-T03	EA	Pad - Map Pocket - Drivers - Vinyl
	059467-04-T03	EA	Pad - Map Pocket - Passenger - Vinyl
	074549-01-T03	EA	Pad Asm. - Dinette Seat Back - Right - Blue
	074549-01-T04	EA	Pad Asm. - Dinette Seat Back - Right - Brown
	074549-01-T05	EA	Pad Asm. - Dinette Seat Back - Right - Burgundy
	074549-02-T03	EA	Pad Asm. - Dinette Seat Back - Right - Blue
	074549-02-T04	EA	Pad Asm. - Dinette Seat Back - Right - Brown
	074549-02-T05	EA	Pad Asm. - Dinette Seat Back - Right - Burgundy
	077461-40-000	EA	Pad Asm. - Dinette Wall - 12" x 12" - Blue
	077461-42-000	EA	Pad Asm. - Dinette Wall - 12" x 12" - Brown
	077461-44-000	EA	Pad Asm. - Dinette Wall - 12" x 12" - Burgundy
	077642-11-000	EA	Pad Asm. - Dinette Wall - 3 5" x 30" - Blue
	077642-13-000	EA	Pad Asm. - Dinette Wall - 3 5" x 30" - Brown
	077642-15-000	EA	Pad Asm. - Dinette Wall - 3 5" x 30" - Burgundy
	077641-41-000	EA	Pad Asm. - TT Chair Wall - 12" x 16" - Blue
	077641-43-000	EA	Pad Asm. - TT Chair Wall - 12" x 16" - Brown
	077641-45-000	EA	Pad Asm. - TT Chair Wall - 12" x 16" - Burgundy
	077642-12-000	EA	Pad Asm. - TT Chair Wall - 3 5" x 36" - Blue
	077642-14-000	EA	Pad Asm. - TT Chair Wall - 3 5" x 36" - Brown
	077642-16-000	EA	Pad Asm. - TT Chair Wall - 3 5" x 36" - Burgundy

CURTAIN, CUSHION & PAD GROUP (CONTINUED)

BUCKET SEATS

Key	Part Number	U/M	Description
	079300-01-T03	EA	Seat Asm. - Single Bucket - Vinyl - Blue
	079300-01-T04	EA	Seat Asm. - Single Bucket - Vinyl - Brown
	079300-01-T05	EA	Seat Asm. - Single Bucket - Vinyl - Burgundy
	M01862-02-T03	EA	Cover Asm. - Back - Single Bucket - Vinyl - Blue
	M01862-02-T04	EA	Cover Asm. - Back - Single Bucket - Vinyl - Brown
	M01862-02-T05	EA	Cover Asm. - Back - Single Bucket - Vinyl - Burgundy
	M01862-01-T03	EA	Cover Asm. - Bottom - Single Bucket - Vinyl - Blue
	M01862-01-T04	EA	Cover Asm. - Bottom - Single Bucket - Vinyl - Brown
	M01862-01-T05	EA	Cover Asm. - Bottom - Single Bucket - Vinyl - Burgundy
	078804-07-T03	EA	Seat Asm. - Single Bucket - w/Armrests & Headrest - Blue
	078804-07-T04	EA	Seat Asm. - Single Bucket - w/Armrests & Headrest - Brown
	078804-07-T05	EA	Seat Asm. - Single Bucket - w/Armrests & Headrest - Burgundy
	M01863-02-T03	EA	Cover - Back - Single Bucket - Blue
	M01863-02-T04	EA	Cover - Back - Single Bucket - Brown
	M01863-02-T05	EA	Cover - Back - Single Bucket - Burgundy
	M01863-01-T03	EA	Cover - Bottom - Single Bucket - Blue
	M01863-01-T04	EA	Cover - Bottom - Single Bucket - Brown
	M01863-01-T05	EA	Cover - Bottom - Single Bucket - Burgundy
	071126-09-T03	EA	Skirt - Single Bucket - Blue
	071126-09-T04	EA	Skirt - Single Bucket - Brown
	071126-09-T05	EA	Skirt - Single Bucket - Burgundy
	079281-02-T03	EA	Seat Asm. - Double Bucket w/Armrests - Blue
	079281-02-T04	EA	Seat Asm. - Double Bucket w/Armrests - Brown
	079281-02-T05	EA	Seat Asm. - Double Bucket w/Armrests - Burgundy
	M01874-04-T03	EA	Cover - Back - Double Bucket - Blue
	M01874-04-T04	EA	Cover - Back - Double Bucket - Brown
	M01874-04-T05	EA	Cover - Back - Double Bucket - Burgundy
	M01874-03-T03	EA	Cover - Bottom - Double Bucket - Blue
	M01874-03-T04	EA	Cover - Bottom - Double Bucket - Brown
	M01874-03-T05	EA	Cover - Bottom - Double Bucket - Burgundy
	071690-04-T03	EA	Skirt - Double Bucket - Blue
	071690-04-T04	EA	Skirt - Double Bucket - Brown
	071690-04-T05	EA	Skirt - Double Bucket - Burgundy
	080243-01-T03	EA	Armrest Asm. - Right - Blue
	080243-01-T04	EA	Armrest Asm. - Right - Brown
	080243-01-T05	EA	Armrest Asm. - Right - Burgundy
	080243-02-T03	EA	Armrest Asm. - Left - Blue
	080243-02-T04	EA	Armrest Asm. - Left - Brown
	080243-02-T05	EA	Armrest Asm. - Left - Burgundy
	M80243-01-T03	EA	Cover - Armrest - Right - Blue
	M80243-01-T04	EA	Cover - Armrest - Right - Brown
	M80243-01-T05	EA	Cover - Armrest - Right - Burgundy
	M80243-02-T03	EA	Cover - Armrest - Left - Blue
	M80243-02-T04	EA	Cover - Armrest - Left - Brown
	M80243-02-T05	EA	Cover - Armrest - Left - Burgundy
	080242-01-T03	EA	Headrest Asm. - w/Cover - Blue
	080242-01-T04	EA	Headrest Asm. - w/Cover - Brown
	080242-01-T05	EA	Headrest Asm. - w/Cover - Burgundy
	M80242-01-T03	EA	Cover - Headrest - Blue
	M80242-01-T04	EA	Cover - Headrest - Brown
	M80242-01-T05	EA	Cover - Headrest - Burgundy

1985 WINNEBAGO
TABLE OF CONTENTS

WC/WF421RB	A-01 - C-06
WC424RC	C-07 - E-16
WCN26RH	E-17 - G-22
WCN26RB	G-23 - J-04

1985 WCN26RB INDEX

Floor Plan	G-23 - G-24
Accessories Group	H-01 - H-03
Bath Group	H-04
Chassis Group	H-05
Curtain, Cushion & Pad Group	H-06 - H-12
Dinette Group	H-13 - H-16
Driver's Compartment Group	H-17 - H-19
Electrical Group	H-20 - H-22
Exterior Body Group	H-23 - I-05
Galley Group	I-06 - I-08
Heating & Air Conditioning Group	I-09 - I-10
Interior Finish Group	I-11 - I-12
LP Group	I-13
Lounge Group	I-14
Water & Sewage Group	I-15 - I-16
Window, Vent & Exterior Door Group	I-17 - J-04

DINETTE GROUP

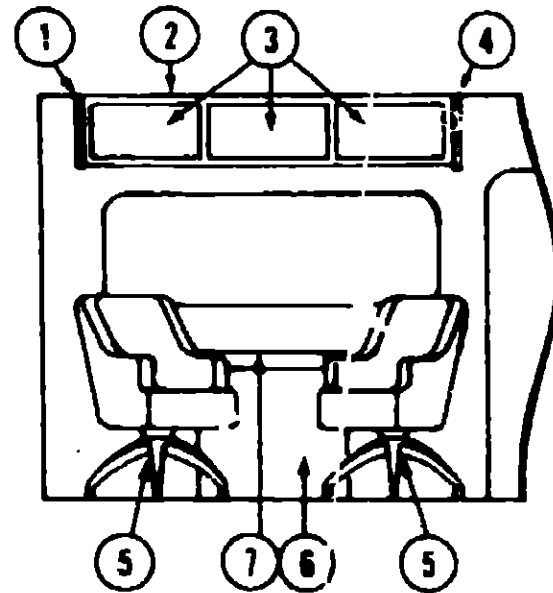

SWIVEL CHAIRS W/FOLD OUT TABLE AND OVERHEAD CABINETRY

Key	Part Number	U/M	Description
1	078510-02-T03	EA	Pad - End - Dinette Overhead Cabinet - Left - Beige Vinyl
2	078508-22-T03	EA	Cabinet Asm. - Dinette Overhead - w/o Doors or Hardware
3	078526-05-T03	EA	Door Asm. - Dinette Overhead Cabinet - w/o Hardware
4	078510-01-T03	EA	Pad - End - Dinette Overhead Cabinet - Right - Beige Vinyl
5	035036-04-000	EA	Base - w/Leg - Swivel Chair
-	035036-01-000	EA	Plate - Tilt and Swivel - Swivel Chair
-	035036-05-000	EA	Extension - 7" TT Chair
6	M79602-01-T03	EA	Cabinet Asm. - Foldout
7	M01937-01-T03	EA	Fold Out Table - Sunset
-			Not Illustrated

ENTERTAINMENT CENTER & ICEMAKER

Key	Part Number	U/M	Description
	M77808-01-T03	EA	Cabinet Asm. - Ice Maker - w/o Countertop
	M01646-01-T09	EA	Countertop Asm. - Ice Maker - Sunset Oak
	M01647-01-T09	EA	Countertop Asm. - Ice Maker Pullout - Sunset Oak
	071489-01-000	EA	Beverage Holder - w/Tray - Oak
	076799-01-000	EA	Ice Maker - Black Glass
	M77807-02-T03	EA	Cabinet Asm. - Entertainment Center - w/o Countertop & Hardware
	M01649-01-T03	EA	Countertop Asm. - Entertainment Center - Sunset Oak
	077867-11-T03	EA	TV Stand - Entertainment Center
	077773-01-T03	EA	Guide - Wine Glass - Entertainment Center
	M78460-12-T03	EA	Door Asm. - Entertainment Center - Right
	M78460-11-T03	EA	Door Asm. - Entertainment Center - Left
	053248-02-T03	EA	Table Asm. - Dinette (Pedestal)
	009040-03-000	EA	Table Base - Flaired
	041194-01-000	EA	Table Base - Flush Mount

DINETTE GROUP (CONTINUED)

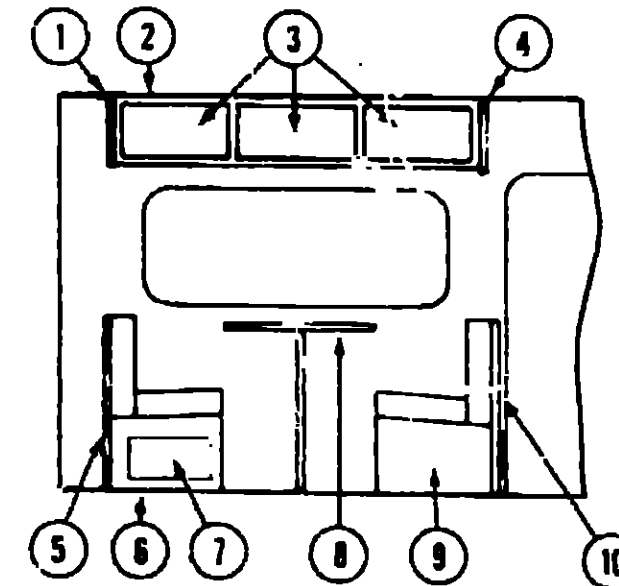

DINETTE CABINETRY (FRONT OPTION)

Key	Part Number	U/M	Description
1	078510-02-T03	EA	Pad - End - Dinette Overhead Cabinet - Left - Brown Vinyl
2	078508-22-T03	EA	Cabinet Asm. - Dinette Overhead - w/o Doors or Hardware
3	078526-05-T03	EA	Door Asm. - Dinette Overhead Cabinet - w/o Hardware
4	078510-01-T03	EA	Pad - End - Dinette Overhead Cabinet - Right - Brown Vinyl
5	M01853-03-T03	EA	Cabinet Asm. - Dinette Back - Left
6	M01844-04-T03	EA	Cabinet Asm. - Dinette Seat - Left
7	076633-27-T03	EA	Door Asm. - Dinette Cabinet - w/o Hardware - Left
8	M01291-50-T03	EA	Table Asm. - Dinette - w/o Hardware - Sunset Oak
9	M01854-01-T03	EA	Cabinet Asm. - Dinette Seat - Right - w/o Door or Hardware
-	076633-26-T03	EA	Door Asm. - Dinette Seat - w/o Hardware - Right
10	M01853-02-T03	EA	Cabinet Asm. - Dinette Back - Right - w/o Door or Hardware
-	053200-05-000	EA	Bracket - Upper Wall Mount - 23.5" - Beige
-	053201-03-000	EA	Bracket - Table Mount - 23" - Anod.
-	024275-05-000	EA	Rod - Table Lift - 8" x 23.5" - Beige
-	024281-07-000	EA	Bracket - Lower Wall Mount - Beige - 22.12"
-	024276-14-000	EA	Leg Asm. - Table - Beige - 29.5"
-	064050-01-000	EA	Hinge - Table Leg
-	024282-01-000	EA	Brace - Table Leg
-	024283-01-000	EA	Clip - 1" O.D. Tube
-	049493-02-000	EA	Catch - Table Leg - Mounts on Floor - Brown
-	064781-03-000	EA	Cup Holder - 3.47" O.D. x 2.75" I.D. x 1.5"
-			Not Illustrated
-			The illustrated parts breakdown for this item is provided on the Common Items Fiche.

1985 WINNEBAGO TABLE OF CONTENTS

WC/WF421RB
WC424RC
WCN26RH
WCN26RB

A-01 - C-06
C-07 - E-16
E-17 - G-22
G-23 - J-04

1985 WCN26RB INDEX

Floor Plan	G-23 - G-24
Accessories Group	H-01 - H-03
Bath Group	H-04
Chassis Group	H-05
Curtain, Cushion & Pad Group	H-06 - H-12
Dinette Group	H-13 - H-16
Driver's Compartment Group	H-17 - H-19
Electrical Group	H-20 - H-22
Exterior Body Group	H-23 - I-05
Galley Group	I-06 - I-08
Heating & Air Conditioning Group	I-09 - I-10
Interior Finish Group	I-11 - I-12
LP Group	I-13
Lounge Group	I-14
Water & Sewage Group	I-15 - I-16
Window, Vent & Exterior Door Group	I-17 - J-04

DINETTE GROUP (CONTINUED)

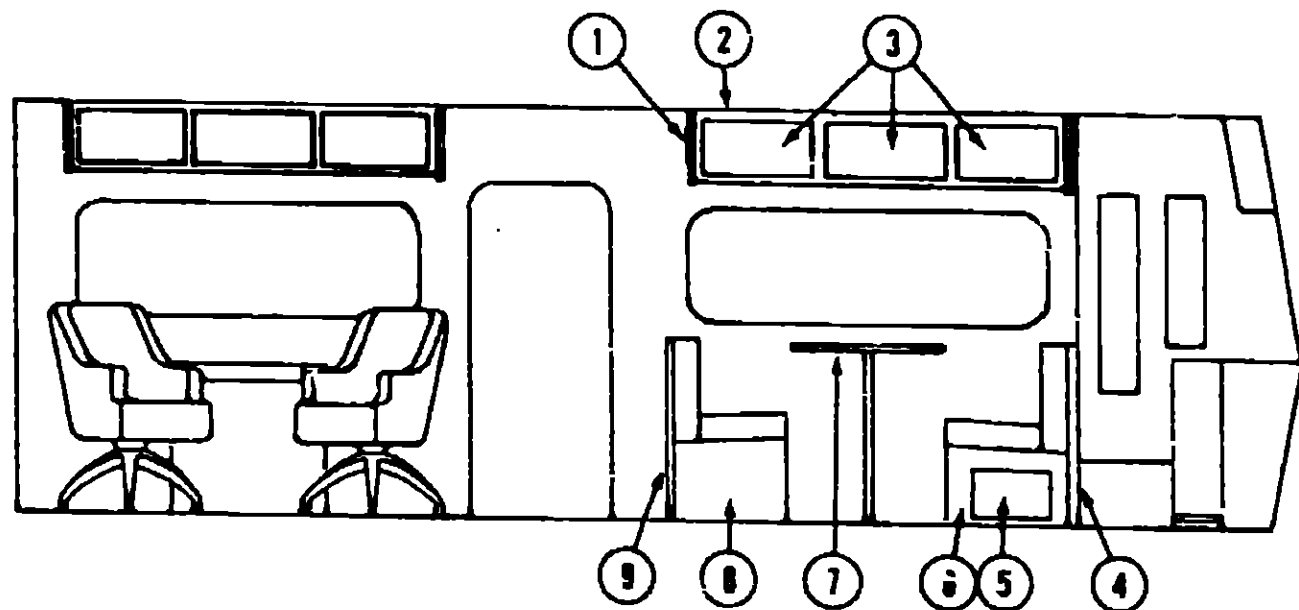

CONVENTIONAL DINETTE AND OVERHEAD CABINETRY

Key	Part Number	U/M	Description
1	078510-02-T03	EA	Pad - End - Dinette Overhead Cabinet - Left - Brown Vinyl
2	078508-24-T03	EA	Cabinet Asm. - Dinette Overhead - w/o Doors or Hardware
3	078526-05-T03	EA	Door Asm. - Dinette Overhead Cabinet - w/o Hardware
4	M01528-03-T03	EA	Cabinet Asm. - Dinette Back - Right
5	076633-26-T03	EA	Door Asm. - Dinette Cabinet
6	M01527-03-T03	EA	Cabinet Asm. - Dinette Seat - Right
7	M01291-50-T03	EA	Table Asm. - Dinette - w/o Hardware - Sunset Oak
8	M01527-02-T03	EA	Cabinet Asm. - Dinette Seat - Left
9	M01528-02-T03	EA	Cabinet Asm. - Dinette Back - Left
.	053200-05-000	EA	Bracket - Upper Wall Mount - 23.5" - Beige
.	074491-02-R10	EA	Magazine Rack - Oak
..	053201-03-000	EA	Bracket - Table Mount - 23" - Anod.
.	024275-05-000	EA	Rod - Table Lift - 8" x 23.5" - Beige
.	024281-07-000	EA	Bracket - Lower Wall Mount - Beige - 22.12"
..	024276-14-000	EA	Leg Asm. - Table - 29.5" - Brown
..	064050-01-000	EA	Hinge - Table Leg
..	024282-01-000	EA	Brace - Table Leg
..	024283-01-000	EA	Clip - 1" O.D. Tube
.	049493-02-000	EA	Catch - Table Leg - Mounts on Floor - Brown
.	064781-03-000	EA	Cup Holder - 3.47" O.D. x 2.75" I.D. x 1.5"
..	Not illustrated		
..	The illustrated parts breakdown for this item is provided on the Common Items Fiche		

DINETTE GROUP (CONTINUED)

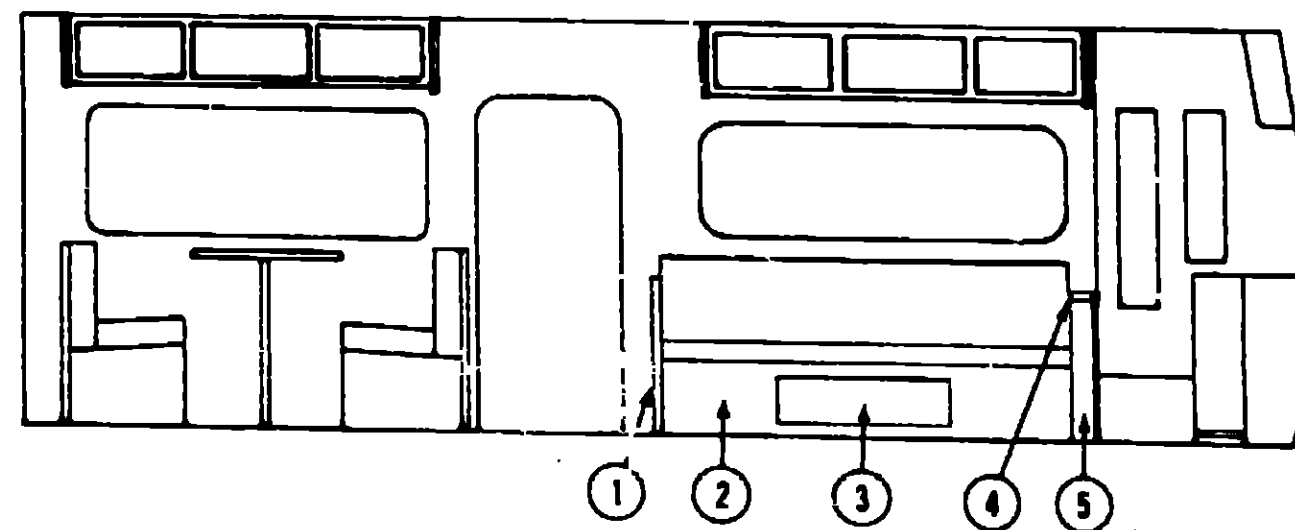

SPRUNG COUCH (REAR OPTION)

Key	Part Number	U/M	Description
1	057618-04-T03	EA	End Panel - Sprung Couch - Left
2	M70635-04-T03	EA	Front Panel Asm. - Sprung Couch - w/o Door or Hardware
3	076633-59-T03	EA	Door Asm. - Couch Cabinet - w/o Hardware
4	058860-02-T03	EA	Pad Asm. - Armrest Cabinet - 31.4" x 6.2" x 3"
4	058860-02-T04	EA	Pad Asm. - Armrest Cabinet - 31.4" x 6.2" x 3"
4	058860-02-T05	EA	Pad Asm. - Armrest Cabinet - 31.4" x 6.2" x 3"
5	076283-01-T03	EA	Cabinet Asm. - Armrest - w/o Pad
.	057468-02-000	EA	Base Asm. - Sprung Couch - Right
.	057468-03-000	EA	Base Asm. - Sprung Couch - Left
.	057468-04-000	EA	Base Asm. - Spacers - Sprung Couch - 2 per Couch
.	057459-01-000	EA	Leg Asm. - Sprung Couch - 2 per Couch
..	Not illustrated		

1985 WINNEBAGO TABLE OF CONTENTS

WC/WF421RB
WC424RC
WCN26RH
WCN26RB

A-01 - C-06
C-07 - E-16
E-17 - G-22
G-23 - J-04

1985 WCN26RB INDEX

Floor Plan	G-23 - G-24
Accessories Group	H-01 - H-03
Bath Group	H-04
Chassis Group	H-05
Curtain, Cushion & Pad Group	H-06 - H-12
Dinette Group	H-13 - H-16
Driver's Compartment Group	H-17 - H-19
Electrical Group	H-20 - H-22
Exterior Body Group	H-23 - I-05
Galley Group	I-06 - I-08
Heating & Air Conditioning Group	I-09 - I-10
Interior Finish Group	I-11 - I-12
LP Group	I-13
Lounge Group	I-14
Water & Sewage Group	I-15 - I-16
Window, Vent & Exterior Door Group	I-17 - J-04

DRIVER'S COMPARTMENT GROUP

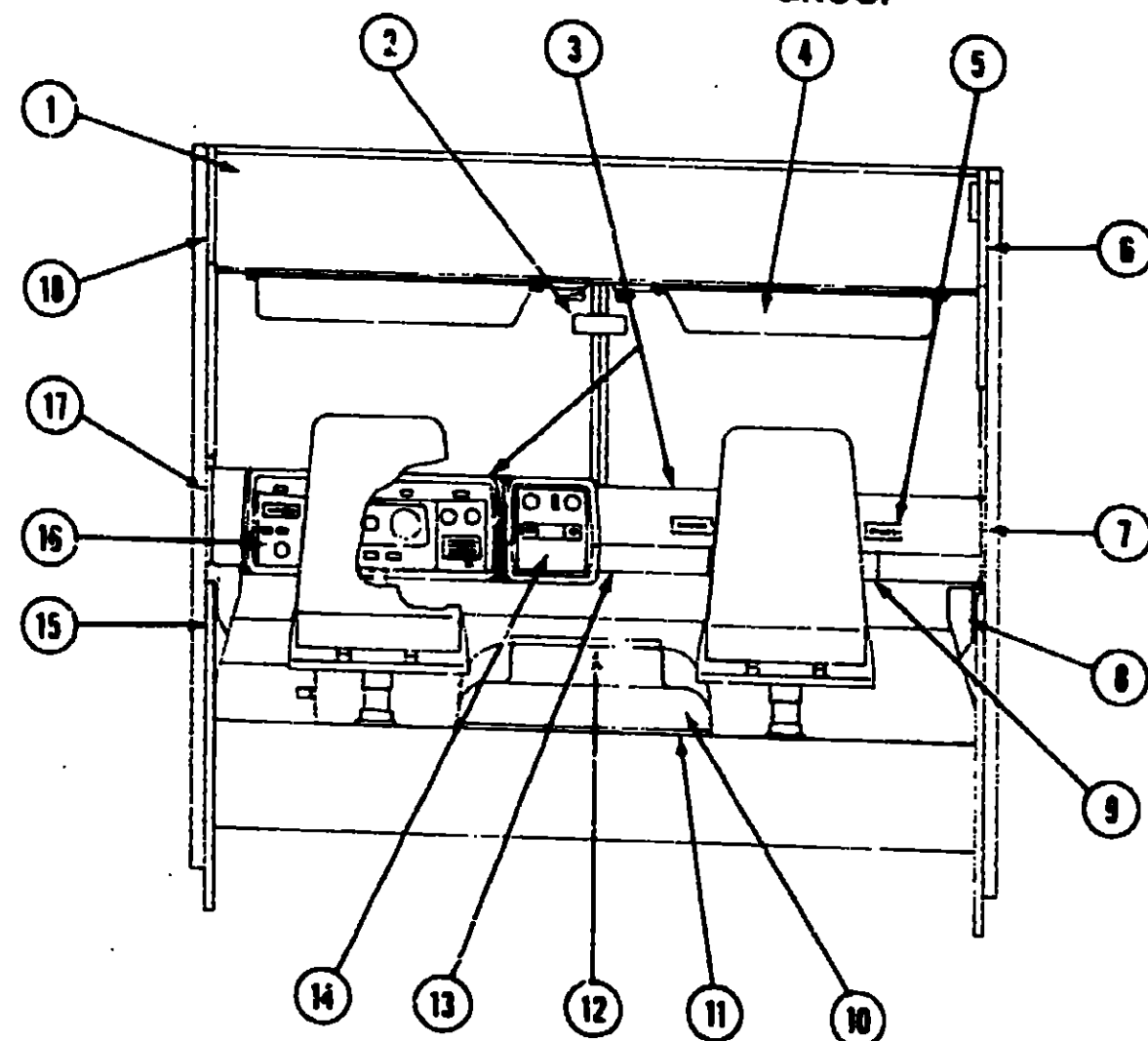

MISCELLANEOUS DRIVER'S COMPARTMENT COMPONENTS

Key	Part Number	U/M	Description
1	080085-02-T03	EA	Header Trim Asm. - Upper
2	040714-01-700	EA	Mirror - Inside Rear View - w/Button Support
3	MD1113-12-T03	EA	Dash Asm. - Complete - w/Gauges & Switches (w/o Clock)
4	MD1113-13-T03	EA	Dash Asm. - Complete - w/Gauges & Switches (w/o Clock) - Diesel
5	038846-01-000	EA	Retainer - Dash - 1" x .25" - w/.188" Dia. Hole
6	038846-02-000	EA	Retainer - Dash - 3" x .17" - w/.140" Dia. Hole
7	079089-01-000	EA	Dash Pad - Passenger - Brown
8	079088-01-000	EA	Dash Pad - Drivers - Brown
9	024990-02-000	EA	Outlet - Defroster w/Swivel - 2" - Dark Brown
10	076765-05-000	EA	Sunvisor Asm. - w/Mirror
11	076765-05-000	EA	Sunvisor Asm. - w/o Mirror
12	040695-02-000	EA	Clip - Sunvisor
13	074012-01-000	EA	Clip - Sunvisor - Square - Pinch On
14	039044-01-000	EA	Lower Asm. - Air Conditioning Adjustable
15	080855-03-000	EA	Side Trim - Front - Upper (w/o Bunk)
16	080856-03-000	EA	Side Trim - Front - Lower (w/o Bunk)
17	059414-06-000	EA	Pad - Sidewall Trim - Passenger - Vinyl
18	072811-01-000	EA	Side Panel - Passenger - Plastic
19	059467-04-T03	EA	Pad - Map Pocket - Passenger - Vinyl
20	022219-01-000	EA	Glove Compartment Door
21	023892-01-000	EA	Glove Compartment Box - Black Fiberboard
22	009118-01-000	EA	Glove Compartment Twist Lock
23	024598-01-000	EA	Glove Compartment Hinge
24	034309-01-000	EA	Glove Compartment Chain - Door
25	079645-01-000	EA	Motor Cover - Fiberglass
26	075564-01-000	EA	Mounting Bracket - Motor Cover
27	039623-01-000	FT	Seal - Engine Cover - Neoprene
28	Not illustrated		

NOTE: To be special ordered only.

DRIVER'S COMPARTMENT GROUP (CONTINUED)

MISCELLANEOUS DRIVER'S COMPARTMENT COMPONENTS (CONT.)

Key	Part Number	U/M	Description
12	080216-01-000	EA	Beverage Tray
13	023834-01-000	EA	Panel - Knee Kick - Bottom of Dash
14	076006-03-000	EA	Bezel - Entertainment Center - w/Radio & Generator Switch
15	076006-02-000	EA	Bezel - Entertainment Center - w/Radio
16	059198-05-000	EA	Side Panel - Drivers - Plastic
17	064499-02-000	EA	Panel - Drivers Door - Inner - Plastic
18	059467-03-T03	EA	Pad - Map Pocket - Driver's - Vinyl
19	050796-01-000	EA	Pocket - Ash Tray - Plastic
20	046886-03-000	EA	Ash Tray - Chrome
21	071662-01-000	EA	Bezel - Control Panel
22	078581-01-000	EA	Trim - Instrument Panel - Front - Passenger
23	078582-01-000	EA	Trim - Instrument Panel - Front - Driver
24	052367-01-000	EA	Cigarette Lighter Asm. - 12 Volt
25	007041-01-000	EA	Bezel - Cigarette Lighter
26	061424-01-000	CA	Lamp Asm. - Map/Gauge
27	061400-06-000	EA	Assist Strap - 12" - Medium Almond
28	059414-05-000	EA	Pad - Sidewall Trim - Driver - Vinyl
29	080855-04-000	EA	Side Trim - Front - Upper (w/o Bunk)
30	080856-04-000	EA	Side Trim - Front - Lower (w/o Bunk)
31	054250-01-000	EA	Support - Dimmer Switch - w/o Holes
32	078579-01-000	EA	Windshield Trim - Interior - Upper - Passenger
33	078579-02-000	EA	Windshield Trim - Interior - Upper - Driver
34	079765-01-000	EA	Windshield Trim - Center
35	079206-01-000	EA	Windshield Trim - Interior - Front - Passenger
36	079206-02-000	EA	Windshield Trim - Interior - Post - Driver
37	Not illustrated		

DASH SWITCHES & GAUGES

Key	Part Number	U/M	Description
1	024461-01-000	EA	Switch - Battery
2	024462-01-000	EA	Switch - Battery Condition
3	024464-02-000	EA	Switch - Battery - Dual Boost
4	024464-01-000	EA	Switch - Washer
5	024465-01-000	EA	Switch - Fuel
6	024467-01-000	EA	Switch - Wiper
7	024976-01-000	EA	Switch - Generator w/o Circuit Board
8	074007-01-000	EA	Switch - Intermittent - Windshield Wiper
9	024459-04-000	EA	Gauge - Voltmeter
10	024460-04-000	EA	Gauge - Vacuum
11	024460-02-000	EA	Mounting Bracket - Vacuum Gauge
12	031035-02-000	EA	Gauge - Generator Hourmeter
13	072363-01-000	EA	Water Detector Probe - Fuel Line
14	072364-01-000	EA	Water Detector Module - Fuel Line

1985 WINNEBAGO TABLE OF CONTENTS

WC/WF421RB	A-01 - C-06
WC424RC	C-07 - E-16
WCN26RH	E-17 - G-22
WCN26RB	G-23 - J-04

1985 WCN26RB INDEX

Floor Plan	G-23 - G-24
Accessories Group	H-01 - H-03
Bath Group	H-04
Chassis Group	H-05
Curtain, Cushion & Pad Group	H-06 - H-12
Dinette Group	H-13 - H-16
Driver's Compartment Group	H-17 - H-19
Electrical Group	H-20 - H-22
Exterior Body Group	H-23 - I-05
Galley Group	I-06 - I-08
Heating & Air Conditioning Group	I-09 - I-10
Interior Finish Group	I-11 - I-12
LP Group	I-13
Lounge Group	I-14
Water & Sewage Group	I-15 - I-16
Window, Vent & Exterior Door Group	I-17 - J-04

DRIVER'S COMPARTMENT GROUP (CONTINUED)

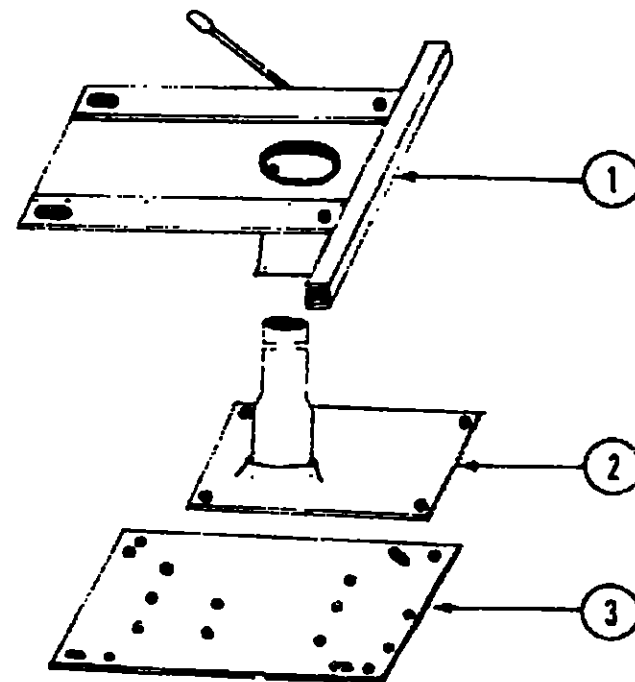

BUCKET SEAT PEDESTAL & SEAT BELTS

Key	Part Number	U/M	Description
1	069585-04-000	EA	Plate - Top - Pedestal Asm. - Single Bucket Seat
1	069585-10-000	EA	Plate - Top - Pedestal Asm. - Double Bucket Seat
2	069585-08-000	EA	Plate - Sub - Pedestal Asm. - Bucket Seat
.	069585-05-000	EA	Hardware Kit - Bolt/Acorn Nut - 4 ea. - Pedestal Asm
.	007019-01-000	EA	Belt Asm. - Seat - 2" x 84" - Black
.	007021-01-000	EA	Belt Asm. - Seat - 2" x 90" - Black
.	056271-01-000	EA	Belt Asm. - Seat - 2" x 72" - Black
.	057759-01-000	EA	Bracket - Seat Belt Washer
.	069246-01-000	EA	Adjuster Asm. - Seat - w/Lock
.	069246-02-000	EA	Adjuster Asm. - Seat - w/o Lock
.	Not illustrated		

FRONT BUNK & PULL DOWN STORAGE

Key	Part Number	U/M	Description
	076760-02-000	EA	Overhead Bunk Hardware (Complete)
	079131-01-T03	EA	Bunk Board Asm
	079144-02-T03	EA	Bunk Strap
	042541-04-000	EA	Latch Asm. - w/o Strike - Brass
	042541-05-000	EA	Latch Strike - Brass
	080855-01-000	EA	Bunk Trim - Upper Side - Right
	080855-02-000	EA	Bunk Trim - Upper Side - Left
	080856-01-000	EA	Bunk Trim - Lower Side - Right
	080856-02-000	EA	Bunk Trim - Lower Side - Left
	079098-01-C00	EA	Pivot Asm. - Spring Loaded - Right (Storage Area)
	079098-02-000	EA	Pivot Asm. - Spring Loaded - Left (Storage Area)
	078635-01-T03	EA	Panel Asm. - Front Bunk

ELECTRICAL GROUP

MISCELLANEOUS ELECTRICAL COMPONENTS

Key	Part Number	U/M	Description
	047338-03-000	EA	Isolator - Dual Battery - 70 Amp.
	063739-01-000	EA	Battery - 12 Volt - 80 Amp. Gould
	008188-01-000	EA	Solenoid - Dual Battery - Relay
	024459-03-000	EA	Gauge - Voltmeter - w/o Bracket
	031035-01-000	EA	Gauge - Hourmeter - Generator
	024460-03-000	EA	Gauge - Vacuum - w/o Bracket
	008343-01-000	EA	Wire Tie - Plastic - 6"
	052367-01-000	EA	Lighter Asm. - Cigarette
	024461-01-000	EA	Switch - Dual Battery
	071278-01-000	EA	Control Center - 32 Amp
	071278-01-700	EA	Door - w/Catch - Brown
	071278-01-701	EA	Converter Module
	071278-01-702	EA	Label - 45 Amp.
	071278-01-703	EA	Door Catch

WINDSHIELD WIPER & WASHER

Key	Part Number	U/M	Description
..	056000-02-000	EA	Washer Asm. - Windshield - w/o Nozzles
..	057653-01-000	EA	Arm - Windshield Wiper - 18" - Black
	067191-02-000	EA	Motor Asm. - Windshield Wiper - 2 Speed
	067192-01-000	EA	Link Asm. - Connecting - Left
	067193-01-000	EA	Link Asm. - Connecting - Right
	049464-03-000	EA	Blade - Windshield wiper - 20" Black
	067190-01-000	EA	Shaft & Pivot Asm.

The illustrated parts breakdown for this item is provided on the Common Items Fiche

EXTERIOR LIGHTS

Key	Part Number	U/M	Description
	058030-01-000	EA	Tail Lamp Asm. - 3 Bulb - Chrome - Right Hand
	058030-02-000	EA	Tail Lamp Asm. - 3 Bulb - Chrome - Left Hand
	059540-01-000	EA	Bracket - License Plate
	042405-03-000	EA	Base - Rectangular - Clearance Light (Sidewall)
	042405-01-000	EA	Lens - Clearance Light - Red w/Reflex (Sidewall)
	042405-04-000	EA	Lens - Clearance Light - Red w/o Reflex (Sidewall)
	042405-02-000	EA	Lens - Clearance Light - Amber w/Reflex (Sidewall)
	042405-05-000	EA	Lens - Clearance Light - Amber w/o Reflex (Sidewall)
	079377-02-000	EA	Clearance Light - Upper Rear - Red
	079377-01-000	EA	Clearance Light - Upper Front - Amber
	049185-01-000	EA	Headlight Capsule Asm. - High/Low Beam - Driver
	049186-01-000	EA	Headlight Capsule Asm. - High/Low Beam - Passenger
	049187-01-000	EA	Headlight Capsule Asm. - High Beam - Driver
	049188-01-000	EA	Headlight Capsule Asm. - High Beam - Passenger

INTERIOR LIGHTS

Key	Part Number	U/M	Description
	033508-02-000	EA	Light - Dome - Ivory - 1 Bulb - US
	033508-03-000	EA	Light - Dome - Ivory - 1 Bulb - CSA
	033509-02-000	EA	Light - Dome - Ivory - 2 Bulb - US
	033509-03-000	EA	Light - Dome - Ivory - 2 Bulb - CSA
	061424-01-000	EA	Light - 12 V Receptacle - Aisle - IP
	007309-01-000	EA	Light - Step Wall
	065202-01-000	EA	Wall Lamp - Decor - 2 Bulb - Brass
	065201-01-000	EA	Lamp Shade - Fabric - White Flax - Wall Lamp
	072353-03-000	EA	Light - Reading - Single - 360° Swivel - Almond
	072353-04-000	EA	Light - Reading - Double - 360° Swivel - Silver
	008089-01-000	EA	Porch Light - Recessed
	078424-01-000	EA	Fluorescent Light - 12VDC - 18"

1985 WINNEBAGO TABLE OF CONTENTS

WC/WF421RB	A-01 - C-06
WC424RC	C-07 - E-16
WCN26RH	E-17 - G-22
WCN26RB	G-23 - J-04

1985 WCN26RB INDEX

Floor Plan	G-23 - G-24
Accessories Group	H-01 - H-03
Bath Group	H-04
Chassis Group	H-05
Curtain, Cushion & Pad Group	H-06 - H-12
Dinette Group	H-13 - H-16
Driver's Compartment Group	H-17 - H-19
Electrical Group	H-20 - H-22
Exterior Body Group	H-23 - I-05
Galley Group	I-06 - I-08
Heating & Air Conditioning Group	I-09 - I-10
Interior Finish Group	I-11 - I-12
LP Group	I-13
Lounge Group	I-14
Water & Sewage Group	I-15 - I-16
Window, Vent & Exterior Door Group	I-17 - J-04

ELECTRICAL GROUP (CONTINUED)

WIRE, SWITCHES & RECEPTACLES

Key	Part Number	U/M	Description
	008024-01-000	FT	Wire - 18.5 Bonded - Orange/White/Yellow/Blue/Brown
	008025-01-000	FT	Wire - 18.5 Bonded - Orange/White/Yellow/Blue/Green
	008028-01-000	FT	Wire - 18.5 Bonded - Blue/Red/Yellow/Orange/White
	008030-01-000	FT	Wire - 18.5 Bonded - Red/Blue/Orange/Green
	008277-01-000	EA	Holder - Fuse - Black - Panel Mount
	006077-01-000	EA	Plaque - Compressor Switch
	008054-01-000	EA	Cord - Power - 10-3 30 Amp. - 25' - UL
	008052-01-000	EA	Cord - Power - 10-3 30 Amp. - 25' - CSA
	024571-03-000	EA	Cover Plate - Receptacle - Jumbo Plastic - Brown
	024571-04-000	EA	Cover Plate - Receptacle - Jumbo Plastic - Ivory
	008160-01-000	EA	Cover Plate - Receptacle - Plastic - Ivory
	008164-01-000	EA	Cover Plate - Switch - Brown
	076319-09-000	EA	TV Wall Plate/Receptacle - Brown (Winegard Antenna)
	058028-01-000	EA	Connector - Pigtail - Clear - Nylon
	008162-02-000	EA	Switch - Double Toggle - Ivory
	008162-01-000	EA	Switch - Double Toggle - Brown
	008163-01-000	EA	Switch - Toggle - Brown
	008173-01-000	EA	Switch - Toggle - Ivory
	008195-01-000	EA	Switch - Push Button - 12 Volt
	056264-01-000	EA	Switch - Leaf Actuator
	024462-01-000	EA	Switch - Battery Condition
	024464-01-000	EA	Switch - Washer
	024467-01-000	EA	Switch - Wiper
	024976-01-000	EA	Switch - Generator w/o Circuit Board
	074007-01-000	EA	Switch - Intermittent - Windshield Wiper
	063912-01-000	EA	Relay - Canister Spot w/Ground
	069238-01-000	EA	Cover - Electrical - 4 x 4 Box
	008058-01-000	EA	Adaptor - Power Cord
	024924-02-000	EA	Receptacle - Power Cord
	053126-01-000	EA	Receptacle - Ground Fault Interrupter - 125 Volt - Ivory
	053126-02-000	EA	Receptacle - Ground Fault Interrupter - 125 Volt - Brown
	058707-01-000	EA	Receptacle - Single - Brown
	058708-01-000	EA	Receptacle - Duplex - Brown
	008157-01-000	EA	Receptacle - Duplex - Brown (Exterior Backwall)
	058048-01-000	EA	Cover - Electrical Box - 4.5" x 2.75" - Rain Tight (Exterior)
	008294-01-000	EA	Cover - Steel - Flat Blank - 4" x 4"
	008288-01-000	EA	Box - Electrical - Plastic - 3" x 3.5"
	008289-01-000	EA	Box - Electrical - Steel - 4 x 4 - 1/2 & 3/4 UL
	058049-01-000	EA	Box - Electrical - 2" 3" x 2.25" - Steel
	064398-01-000	EA	Housing Asm. - Trailer Receptacle
	064399-01-000	EA	Housing Asm. - Trailer Pin
	064450-01-000	EA	Housing Asm. - Trailer Plug
	035417-01-000	EA	Terminal - Pin Receptacle - .125 Dia.
	054532-01-000	EA	Housing Pin - 6 Position
	031968-01-000	EA	Contact - Plug - Brass - Tin Plated
	035290-17-000	EA	Cable Asm. - Battery - 1 AWG Strand - 282"
	054865-01-000	EA	Wire Asm. - Generator Switch

ELECTRICAL GROUP (CONTINUED)

BULBS

Key	Part Number	U/M	Description
	037935-01-000	EA	Bulb - 1157
	063914-01-000	EA	Bulb - 1139
	008103-01-000	EA	Bulb - 53
	008213-01-000	EA	Bulb - 57
	008214-01-000	EA	Bulb - 67
	008215-01-000	EA	Bulb - 1003
	008216-01-000	EA	Bulb - 1034
	008217-01-000	EA	Bulb - 1073
	008218-01-000	EA	Bulb - 1141
	008220-01-000	EA	Bulb - 12V - 25W
	036196-01-000	EA	Bulb - 194
	067479-01-000	EA	Bulb - 1076 - 12V - 1.80 Amp.

FUSES AND CIRCUIT BREAKERS

Key	Part Number	U/M	Description
	056473-02-000	EA	Fuse - Slow Blow - 5 Amp. - 32 Volt Capacity
	056473-01-000	EA	Fuse - Slow Blow - 6 1/4 Amp.
	008233-01-000	EA	Fuse - 12 Volt - 6 Amp.
	008234-01-000	EA	Fuse - 12 Volt - 10 Amp.
	046893-01-000	EA	Fuse - 12 Volt - 13 Amp.
	008235-01-000	EA	Fuse - 12 Volt - 15 Amp.
	008236-01-000	EA	Fuse - 12 Volt - 20 Amp.
	008248-01-000	EA	Fuse - 110 Volt - 30 Amp. - AGU
	008252-01-000	EA	Fuse - 110 Volt - 50 Amp.
	062901-02-000	EA	Fuse - Automotive - 5 Amp.
	062901-05-000	EA	Fuse - Automotive - 15 Amp.
	008208-01-000	EA	Circuit Breaker - 12 Volt - 40 Amp.
	008211-01-000	EA	Circuit Breaker - 12 Volt - 6 Amp.
	008268-01-000	EA	Circuit Breaker - 12 Volt - 30 Amp. w/Mount
	033573-02-000	EA	Circuit Breaker - 12 Volt - 15 Amp. w/Mount
	033573-01-000	EA	Circuit Breaker - 12 Volt - 20 Amp. w/Mount
	040051-01-000	EA	Circuit Breaker - 110 Volt - 20 Amp. TQL
	071279-01-000	EA	Circuit Breaker - 120 Volt - 15 Amp.
	008273-03-000	EA	Circuit Breaker - 15/20 Amp. TQL
	008299-01-000	EA	Circuit Breaker - 115 Amp. TQL
	008297-01-000	EA	Circuit Breaker - 120 Amp. TQL
	008293-01-000	EA	Circuit Breaker - 130 Amp. TQL
	071279-02-000	EA	Circuit Breaker - 15/15 Amp. - 120 Volt
	071279-03-000	EA	Circuit Breaker - 15/20 Amp. - 120 Volt
	071279-04-000	EA	Circuit Breaker - 30 Amp. - 120 Volt
	071279-05-000	EA	Circuit Breaker - 20 Amp. - 120 Volt
	071279-06-000	EA	Circuit Breaker - 30/15 Amp. - 120 Volt
	071279-07-000	EA	Circuit Breaker - 20/20 Amp. - 120 Volt
	071280-01-000	EA	Circuit Breaker Blank

1985 WINNEBAGO TABLE OF CONTENTS

WC/WF421RB	A-01 - C-06
WC424RC	C-07 - E-16
WCN26RH	E-17 - G-22
WCN26FB	G-23 - J-04

1985 WCN26RB INDEX

Floor Plan	G-23 - G-24
Accessories Group	H-01 - H-03
Bath Group	H-04
Chassis Group	H-05
Curtain, Cushion & Pad Group	H-06 - H-12
Dinette Group	H-13 - H-16
Driver's Compartment Group	H-17 - H-19
Electrical Group	H-20 - H-22
Exterior Body Group	H-23 - I-05
Galley Group	I-06 - I-08
Heating & Air Conditioning Group	I-09 - I-10
Interior Finish Group	I-11 - I-12
LP Group	I-13
Lounge Group	I-14
Water & Sewage Group	I-15 - I-16
Window, Vent & Exterior Door Group	I-17 - J-04

EXTERIOR BODY GROUP

EXTERIOR BODY PANELS & TRIMS

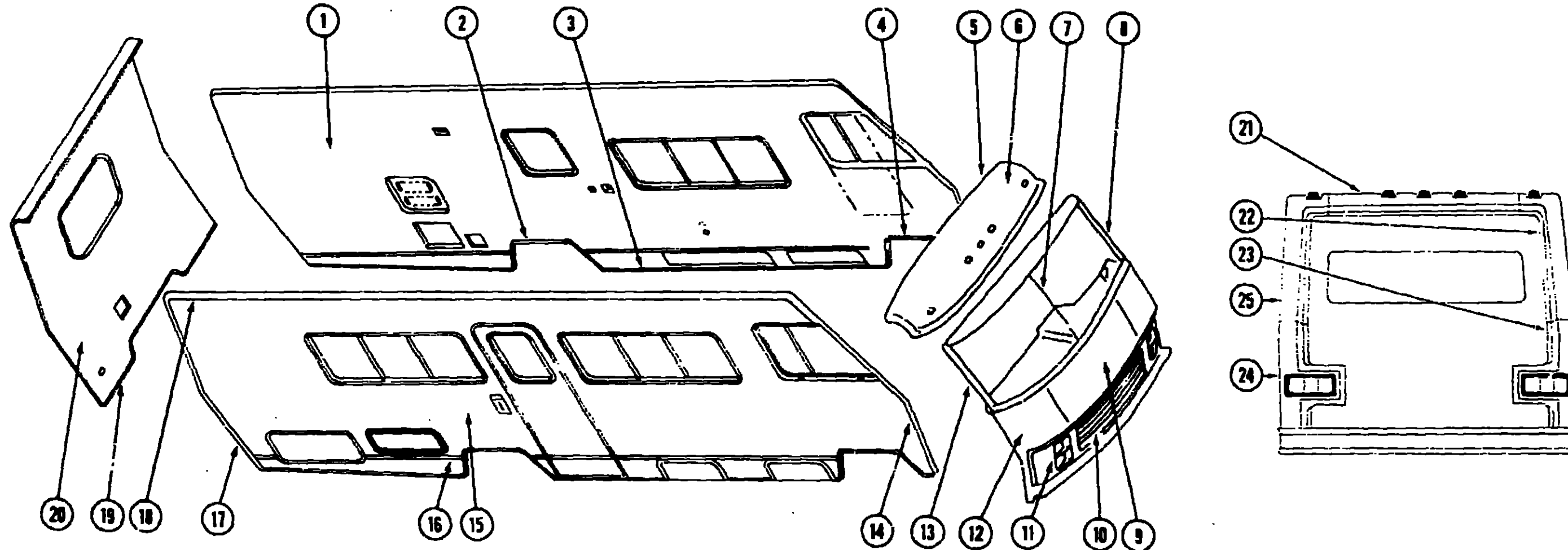

Key	Part Number	U/M	Description
1	M78293-01-T03	EA	Sidewall Asm. - Left
1	M78293-01-T04	EA	Sidewall Asm. - Left
1	M78293-01-T05	EA	Sidewall Asm. - Left
2	058487-07-000	EA	Trim - Wheel Well - Rear - U Channel - Left or Right
	075070-01-000	EA	Trim - Wheel Well - Rear - Plastic - Passenger Side
	075070-03-000	EA	Trim - Wheel Well - Rear - Plastic - Driver Side
3	079778-01-000	EA	Extr. - Rocker Panel
4	073647-02-000	EA	Trim - Wheel Well - Front - U Channel - Left or Right
	078556-01-000	EA	Trim - Wheel Well - Front - Plastic - Passenger Side
	078556-03-000	EA	Trim - Wheel Well - Front - Plastic - Drivers Side
5	062396-01-000	EA	Trim - Roof/Front Cap
6	078572-01-000	EA	Cap - Over Windshield - Beige
7	053288-01-000	EA	Trim - Molding - Windshield - Center
8	079225-02-000	EA	Trim - Contour - Windshield - Left
	058287-01-000	EA	Trim - Molding - Windshield - Upper/Lower
	079760-02-000	EA	Headlamp Bezel - Left
9	078281-01-T03	EA	Access Panel - w/Hardware
10	078891-01-T03	EA	Grille Asm.
	074588-01-000	EA	Mesh Asm. - Grille
11	079760-01-000	EA	Headlamp Bezel - Right
12	M01115-08-T03	EA	Panel Asm. - Front Shroud (includes access panel)
13	079225-01-000	EA	Trim - Contour - Windshield - Right
	042743-01-000	EA	Corner Support - Windshield - Lower - Steel
	042743-02-000	EA	Corner Support - Windshield - Upper - Steel
14	079224-01-000	EA	Trim - Fiberglass Panel - Right - Beige
	079224-02-000	EA	Trim - Fiberglass Panel - Left - Beige

1985 WINNEBAGO TABLE OF CONTENTS

WC/WF421RB
WC424RC
WCN26RH
WCN26RB

A-01 - C-06
C-07 - E-16
E-17 - G-22
G-23 - J-04

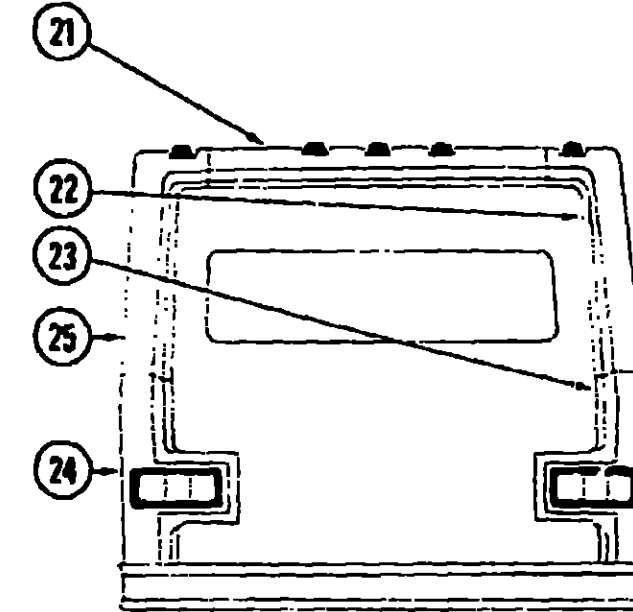

Key	Part Number	U/M	Description
15	M78292-01-T03	EA	Sidewall Asm. - Right
15	M78292-01-T04	EA	Sidewall Asm. - Right
15	M78292-01-T05	EA	Sidewall Asm. - Right
16	059576-02-000	EA	Feature Strip - Extr. Beige - 14' - w/o Insert
	009731-01-000	EA	End Cap - Feature Strip Insert
	G31030-02-004	EA	Insert - Feature Strip - Off White - 17'
17	073502-17-000	EA	Trim - Right Rear - Beige
	073502-18-000	EA	Trim - Left Rear - Beige
18	078600-01-000	EA	Trim - Sidewall - Upper - Left or Right - Beige
19	050406-06-000	EA	Trim - Backwall - Lower - Left or Right
	075176-01-T03	EA	Roof Asm.
20	078913-01-T03	EA	Backwall Asm.
20	078913-01-T04	EA	Backwall Asm.
20	078913-01-T05	EA	Backwall Asm.
21	M01893-01-000	EA	Trim - Rear - Center Upper - Plastic - Beige
22	078559-01-000	EA	Trim - Rear - Upper Right - Plastic - Beige
23	078557-01-000	EA	Trim - Rear - Lower Right - Plastic - Beige
24	078557-02-000	EA	Trim - Rear - Lower Left - Plastic - Beige
25	078559-03-000	EA	Trim - Rear - Upper Left - Plastic - Beige
	078577-01-000	EA	Bumper End Cap - Front Right Hand - Beige
	078577-02-000	EA	Bumper End Cap - Front Left Hand - Beige
	078578-01-000	EA	Bumper End Cap - Rear Right - Beige
	078578-02-000	EA	Bumper End Cap - Rear Left - Beige
	Not illustrated		

1985 WCN26RB INDEX

Floor Plan	G-23 - G-24
Accessories Group	H-01 - H-03
Bath Group	H-04
Chassis Group	H-05
Curtain, Cushion & Pad Group	H-06 - H-12
Dinette Group	H-13 - H-16
Driver's Compartment Group	H-17 - H-19
Electrical Group	H-20 - H-22
Exterior Body Group	H-23 - I-05
Galley Group	I-06 - I-08
Heating & Air Conditioning Group	I-09 - I-10
Interior Finish Group	I-11 - I-12
LP Group	I-13
Lounge Group	I-14
Water & Sewage Group	I-15 - I-16
Window, Vent & Exterior Door Group	I-17 - J-04

EXTERIOR BODY GROUP (CONTINUED)

DECALS & STRIPING

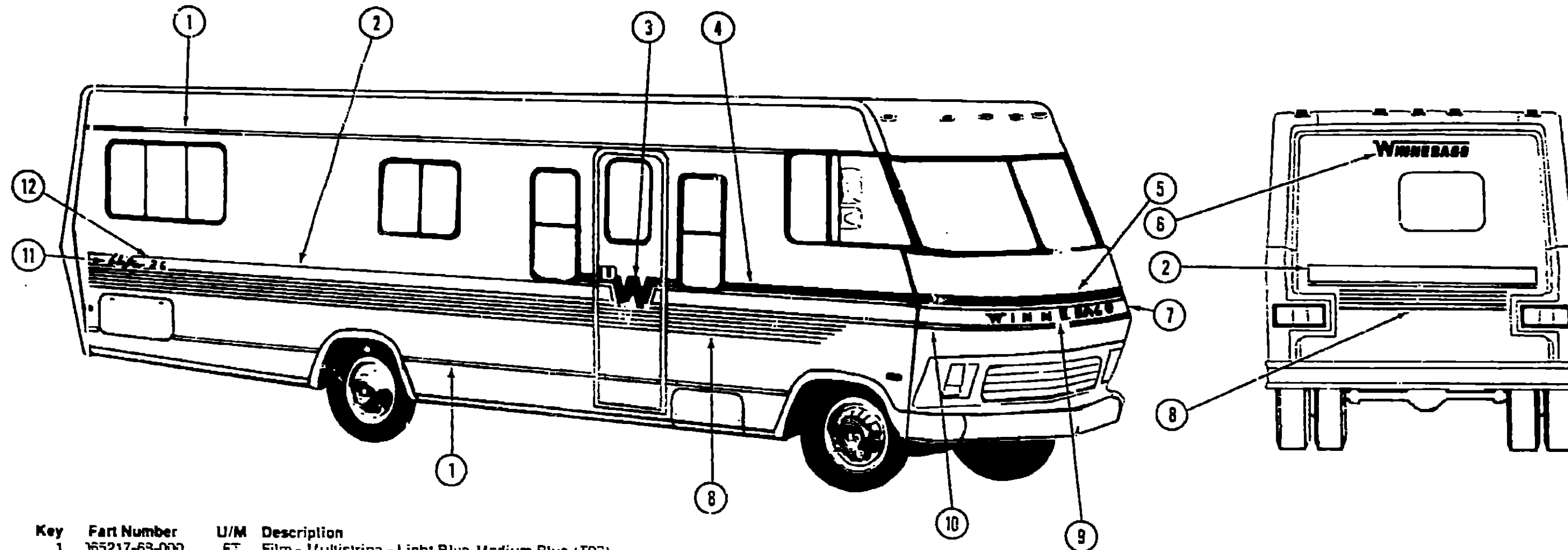

Key	Part Number	U/M	Description
1	365217-69-000	FT	Film - Multistripe - Light Blue/Medium Blue (T03)
1	365217-69-000	FT	Film - Multistripe - Dark Gold/Brown (T04)
1	365217-70-000	FT	Film - Multistripe - Rose/Burgundy (T05)
2	365217-71-000	FT	Film - Multistripe - Light Blue/Medium Blue (T03)
2	365217-72-000	FT	Film - Multistripe - Dark Gold/Brown (T04)
2	365217-73-000	FT	Film - Multistripe - Rose/Burgundy (T05)
3	79351-01-000	EA	Decal - Flying W - Light Blue (T03)
3	79351-02-000	EA	Decal - Flying W - Dark Gold (T04)
3	79351-03-000	EA	Decal - Flying W - Rose (T05)
4	78831-03-000	FT	Decal Striping - Light Blue (T03)
4	78831-09-000	FT	Decal Striping - Dark Gold (T04)
4	78831-10-000	FT	Decal Striping - Rose (T05)
5	079100-01-000	EA	Decal - Hood - Light Blue (T03)
5	079100-02-000	EA	Decal - Hood - Dark Gold (T04)
5	079100-03-000	EA	Decal - Hood - Rose (T05)
6	078831-04-000	EA	Decal - Under Hood - Medium Blue (T03)
6	078831-05-000	EA	Decal - Under Hood - Brown (T04)
6	078831-05-000	EA	Decal - Under Hood - Burgundy (T05)
7	050313-22-000	EA	Decal Logo - "Winnebago"
7	079099-02-000	EA	Decal - Corner - Light Blue (T03)
7	079099-04-000	EA	Decal - Corner - Dark Gold (T04)
7	079099-05-000	EA	Decal - Corner - Rose (T05)
8	076791-05-000	FT	Film - Multistripe - Medium Blue (T03)
8	076791-06-000	FT	Film - Multistripe - Brown (T04)
8	076791-07-000	FT	Film - Multistripe - Burgundy (T05)
9	059745-03-000	EA	Decal - "Winne"
9	059745-04-000	EA	Decal - "Bago"
10	079099-01-000	EA	Decal - Corner - Light Blue (T03)
10	079099-03-000	EA	Decal - Corner - Dark Gold (T04)
10	079099-05-000	EA	Decal - Corner - Rose (T05)
11	050712-02-000	EA	Decal Logo - "Chieftain"
12	070724-06-000	EA	Decal Logo - "26"

1985 WINNEBAGO TABLE OF CONTENTS

WC/VF421RB
WC424RC
WCN26RH
WCN26RB

A-01 - C-06
C-07 - E-16
E-17 - G-22
G-23 - J-04

1985 WCN26RB INDEX

Floor Plan	G-23 - G-24
Accessories Group	H-01 - H-03
Bath Group	H-04
Chassis Group	H-05
Curtain, Cushion & Pad Group	H-06 - H-12
Dinette Group	H-13 - H-16
Driver's Compartment Group	H-17 - H-19
Electrical Group	H-20 - H-22
Exterior Body Group	H-23 - I-05
Galley Group	I-06 - I-08
Heating & Air Conditioning Group	I-09 - I-10
Interior Finish Group	I-11 - I-12
LP Group	I-13
Lounge Group	I-14
Water & Sewage Group	I-15 - I-16
Window, Vent & Exterior Door Group	I-17 - J-04

EXTERIOR BODY GROUP (CONTINUED)

MISCELLANEOUS EXTERNALLY MOUNTED PARTS

Key	Part Number	U/M	Description
..	011129-01-000	EA	Plumbing Seal - Roof Vent - 1.5"
	048817-01-000	EA	Assist Handle - Chrome
	010230-03-000	EA	Fill - City Water - Recessed - Beige
	058808-02-000	EA	Water Fill - Lockable - Beige
	078037-01-000	EA	Shroud - Fuel Fill - Upper
	072309-02-000	EA	Shroud - Fill Neck
	054530-01-000	EA	Exterior Door Holder
..	The illustrated parts breakdown for this item is provided on the Common Items Fiche.		

SHEET FIBERGLASS, ALUMINUM & STYROFOAM

Key	Part Number	U/M	Description
	077517-10-001	EA	Fiberglass Sidewall Skin - 46.12" x 378" - Mesa
	077517-10-002	EA	Fiberglass Sidewall Skin - 46.12" x 68" - Mesa
	001018-01-024	EA	Alum. - Beige - No Design - 43" x 96"
	044487-01-001	EA	Alum. - Mill Finish - No Design (Roof) - 96" x 360"
	000858-01-000	SF	Styrofoam - .75" x 24" x 96"
	000870-01-000	SF	Styrofoam - 1.50" x 24" x 96"
	000870-03-000	SF	Styrofoam - 1.34" x 43" x 96"

LABELS & EXTERIOR PAINT

Key	Part Number	U/M	Description
	068383-01-000	EA	Label - Diesel Fuel
	006195-01-000	EA	Label - Electrical Test
	047731-01-000	EA	Label - Emergency Exit
	006199-01-000	EA	Label - Exit - Escape Window
	057467-04-000	EA	Label - Exterior Loading Limit
	064378-01-000	EA	Label - Flying "W" w/Thermo Panel
	061417-01-000	EA	Label - Fuel
	006196-01-000	EA	Label - Gas Test
	054531-01-000	EA	Label - LP Gas Only
	040944-01-000	EA	Label - Open - Entrance Door
	006015-01-000	EA	Label - Patent Motor Home
	056259-01-000	EA	Label - Safety Check List
	006064-01-000	EA	Label - Seat - w/o Seat Belts
	006187-01-000	EA	Label - Sewage
	006006-01-000	EA	Label - Thermo Panel - 2 1/4" x 2 1/4"
	075221-01-000	EA	Label - Trailer Hitch Capacity
	075220-01-000	EA	Label - Warning - Exterior Load Limit
	050225-01-000	EA	Label - Warning - Stove Vent - US
	005188-01-000	EA	Label - Waste Water
	005197-01-000	EA	Label - Water Test
	072863-01-000	EA	Nameplate - Diesel - 6.2L
	005062-01-000	EA	Tag - Electrical - 110 Volt Connection
	006040-01-000	EA	Tag - Gas - Refueling Warning
	044486-03-000	EA	Paint - Beige Acrylic Enamel - 16 oz. Aerosol (7633A Dupont)
	045681-03-000	EA	Paint - Gloss Black - Acrylic Enamel - 16 oz. Aerosol (99 Dupont)
	058637-05-000	EA	Paint - Gray Acrylic Enamel - 16 oz. Aerosol (71537 Dupont)
	041561-03-000	EA	Paint - Off White Acrylic Enamel - 16 oz. Aerosol (45396A Dupont)
	074559-01-000	EA	Label "LPG" - 3 3" x 1.75" - (Calif. Code)

EXTERIOR BODY GROUP (CONTINUED)

INTERIOR/EXTERIOR SCREWS & FASTENERS

Key	Part Number	U/M	Description
	005200-01-000	EA	Bolt - Round Head - Square Neck w/SST Cap - 7/16" - 14 x 1 1/4"
	058279-01-000	EA	Clip - Mounting - Front Panel
	035628-01-000	EA	Fastener - Blind Well Nut - 1.05" x .38"
	000015-06-008	EA	Nut - Hex - 3/8" x 24 - Zinc
	005081-01-000	EA	Nut - Speed - C Type - #8 Screw
	000G54-04-20B	EA	Screw 1/4 - 20 x 1 1/4" PTH - Zinc
	000G54-04-22B	EA	Screw 1/4 - 20 x 1 3/8" PTH - Zinc
	000G53-04-06B	EA	Screw 1/4 - Machine - 20 x 3/8" PTH - Zinc
	000G13-06-12P	EA	Screw #6 - 20 x 3/4" PFH - Dark Brown
	000G13-06-28X	EA	Screw #6 - 20 x 3/4" PFH - Gray
	000G13-06-16R	EA	Screw #6 - 20 x 1" PFH - Beige
	000G11-07-08B	EA	Screw #7 - 19 x 1/2" PPH - Zinc
	000G12-08-12M	EA	Screw #8 - 18 x 3/4" POH - Gray
	000G11-08-12R	EA	Screw #8 - 18 x 3/4" PPH - Beige
	000G11-08-12X	EA	Screw #8 - 18 x 3/4" PPH - Gray
	000G11-08-12B	EA	Screw #8 - 18 x 3/4" PPH - Zinc
	000G39-08-12R	EA	Screw #8 - 18 x 3/4" SDPH - Beige
	000G66-08-12J1	EA	Screw #8 - 18 x 3/4" SDPH - Gray
	000G11-08-16R	EA	Screw #8 - 18 x 1" PFH - Gray
	000G66-08-16R	EA	Screw #8 - 18 x 1" SDPH - Beige
	000G12-08-28R	EA	Screw #8 - 18 x 1 3/4" POH - Beige
	000G36-08-08E	EA	Screw #8 - 32 x 1/2" PFH - Chrome
	000G39-08-02B	EA	Screw #8 - Self Drilling - 18 x 1/2" PPH - Zinc
	000G39-08-12B	EA	Screw #8 - Self Drilling - 18 x 3/4" PPH - Zinc
	000G39-08-12R	EA	Screw #8 - Self Drilling - 18 x 3/4" PPH - Beige
	000G39-08-16R	EA	Screw #8 - Self Drilling - 18 x 1" PPH - Beige
	000G39-08-16T	EA	Screw #8 - Self Drilling - 18 x 1" PPH - Black
	000G39-08-16P	EA	Screw #8 - Self Drilling - 18 x 1" PPH - Dark Brown
	000G39-08-16X	EA	Screw #8 - Self Drilling - 18 x 1" PPH - Gray
	000G39-08-16E	EA	Screw #8 - Self Drilling - 18 x 1" PPH - Chrome
	000G64-08-16M	EA	Screw #8 - Self Drilling - 18 x 1" SDPH - Gray
	000G67-10-08B	EA	Screw #10 - 12 x 1/2" PPH - Zinc
	000G67-10-10R	EA	Screw #10 - 12 x 5/8" PPH - Beige
	000G67-10-16P	EA	Screw #10 - 12 x 1" PPH - Dark Brown
	000G67-10-16B	EA	Screw #10 - 12 x 1" PPH - Zinc
	000G67-10-20B	EA	Screw #10 - 12 x 1 1/4" PPH - Zinc
	000G67-10-24B	EA	Screw #10 - 12 x 1 1/2" PPH - Zinc
	049465-04-000	EA	Screw #10 - 16 x 1" POH - w/Washer - Beige
	049465-05-000	EA	Screw #10 - 16 x 1" POH - w/Washer - Gray
	000G12-10-24E	EA	Screw #10 - 16 x 1 1/2" POH - Chrome
	000G11-10-03D	EA	Screw #10 - 16 x 1/2" PPH - Dark Brown
	000G11-10-12R	EA	Screw #10 - 16 x 3/4" PPH - Beige
	000G11-10-12S	EA	Screw #10 - 16 x 3/4" PPH - Off White
	000G11-10-12B	EA	Screw #10 - 16 x 3/4" PPH - Zinc
	000G11-10-16B	EA	Screw #10 - 16 x 1" PPH - Zinc
	000G11-10-403	EA	Screw #10 - 16 x 2 1/2" PPH - CAD
	000G19-10-12B	EA	Screw #10 - Machine - 32 TPI x 3/4"
	075908-G1-000	EA	Screw #10 - Machine - 32 x 56" PTH - Zinc
	000G19-10-20B	EA	Screw #10 - Machine - 32 x 1 1/4" PPH - Zinc
	000G39-12-12E	EA	Screw #10 - Self Drilling - 14 x 3/4" PPH - Chrome
	000G39-10-10R	EA	Screw #10 - Self Drilling - 16 x .62" PPH - Beige
	000G39-10-12R	EA	Screw #10 - Self Drilling - 16 x 3/4" PPH - Beige
	000G39-10-12P	EA	Screw #10 - Self Drilling - 16 x 3/4" PPH - Dark Brown
	000G56-12-45C	EA	Screw #12 - Wood - 11 x 3" POH - CAD

1985 WINNEBAGO TABLE OF CONTENTS

WC:WF421RB	A-01 - C-06
WC42/RC	C-07 - E-16
WCN26RH	E-17 - G-22
WCN26RB	G-23 - J-04

1985 WCN26RB INDEX

Floor Plan	G-23 - G-24
Accessories Group	H-01 - H-03
Bath Group	H-04
Chassis Group	H-05
Curtain, Cushion & Pad Group	H-06 - H-12
Dinette Group	H-13 - H-16
Driver's Compartment Group	H-17 - H-19
Electrical Group	H-20 - H-22
Exterior Body Group	H-23 - I-05
Galley Group	I-06 - I-08
Heating & Air Conditioning Group	I-09 - I-10
Interior Finish Group	I-11 - I-12
LP Group	I-13
Lounge Group	I-14
Water & Sewage Group	I-15 - I-16
Window, Vent & Exterior Door Group	I-17 - J-04

EXTERIOR BODY GROUP (CONTINUED)

ACCESS PANEL HARDWARE

Key	Part Number	U/M	Description
	072917-02-000	EA	Rod - Hood Prop
	062628-01-000	EA	Clip - Prop Rod
	058833-01-000	EA	Bracket - Prop Rod
	073340-01-000	EA	Hinge - Access Panel - Passenger
	073340-02-000	EA	Hinge - Access Panel - Drivers
	058960-01-000	EA	Bracket - Hinge Asm - Hood - Drivers
	058960-02-000	EA	Bracket - Hinge Asm - Hood - Passenger
	R77006-68-721	EA	Cable - Release (Access Panel)
	074178-01-000	EA	Bracket - Cable Release - Inside
	R77007-01-950	EA	Striker - Hood Latch
	R77006-59-931	EA	Latch - Hood
	R77006-38-499	EA	Spring
	R77006-19-765	EA	Cable Sheath
	073333-01-000	EA	Bracket - Latch Support
	073337-01-000	EA	Strake Latch - Hood
	073341-01-000	EA	Bracket - Hood Latch
	058786-02-000	EA	Bolt - Hood Adjusting - 5/16" x 18 x 1 1/4"

SEALANTS & ADHESIVES

Key	Part Number	U/M	Description
	004020-01-000	QT	Adhesive - ABS Cement (Plastic Fittings)
	002337-01-000	EA	Adhesive - 1500 Tube - 3M (Windows)
	004005-02-000	GL	Adhesive - Swifts - Glue (Sidewalls)
	053766-07-000	EA	Bedding Compound - Tube - Beige (Exterior)
	053766-06-000	EA	Bedding Compound - Tube - Clear (Window)
	053766-08-000	EA	Bedding Compound - Tube - Gray (Exterior)
	053766-05-000	EA	Bedding Compound - Tube - Gray (Sidewalls to Floor)
	053766-02-000	EA	Bedding Compound - Tube - Off White (Exterior)
	002328-02-000	EA	Block - Rubber Spacer (Windshield)
	004336-01-000	EA	Caulk - Latex - Golden Walnut (Sidewalls)
	072891-02-000	QT	Primer - Glass - Black
	072891-01-000	QT	Primer - Glass - Clear
	035024-01-000	EA	Primer - Glass - Clear - Windshield
	072890-01-000	QT	Primer - Metal - Black
	035023-01-000	GL	Primer - Metal - Windshield
	077967-01-000	EA	Sealant - Acrylic Latex - Tube - Off White (Interior Sealant)
	034552-04-000	EA	Sealant - Silicone - Beige
	034552-02-000	EA	Sealant - Silicone - Clear
	034552-07-000	EA	Sealant - Silicone - Dark Gray
	034552-06-000	EA	Sealant - Silicone - Off White
	069637-01-000	EA	Sealant - Weatherban 404 - Tube - White (Door Caulk)
	072889-01-000	EA	Sealant - Urethane - Black (Windshield)
	069640-01-000	FT	Sealer Ribbon - .25" Bead x 20'
	069640-02-000	FT	Sealer Ribbon - 5" x 125" x 30'
	069640-03-000	FT	Sealer Ribbon - 75" x 125" x 30'
	069640-04-000	FT	Sealer Ribbon - 2" x .09" x 45' (P Series)
	069640-05-000	FT	Sealer Ribbon - 2 5/8" x .09" x 50'
	069640-06-000	FT	Sealer Ribbon - 5/16" Bead x 15'
	069640-07-000	FT	Sealer Ribbon - 2" x 3 3/32" x 30'
	002316-01-000	FT	Sealer Tape - 3/32" x 3 6" - White (Window)
	002707-01-000	FT	Sealer Tape - 5/16" x 3 4"
	002707-02-000	FT	Sealer Tape - 5/16" x 1 2"
	040545-01-000	GL	Sealer - Seam Weld
	053752-04-000	EA	Seam Sealer - Tube - Aluminum (Roof)
	063642-01-000	FT	Tape - Adhesive - 10 mm. x 1 5" Wide
	038586-01-000	EA	Tape - Butyl - .31" x 31" x 143" (Windshield)
	076322-01-000	FT	Tape - Foam - Double Coated - .025 x 1" (Fiberglass Sidewall Seams)
	076322-02-000	FT	Tape - Foam - Double Coated - .045 x 1" (Fiberglass Sidewall Seams)
	009200-01-000	EA	Tape - Furnace - 1.5"
	002825-01-000	FT	Weather Striping (Roof Vent)

GALLEY GROUP

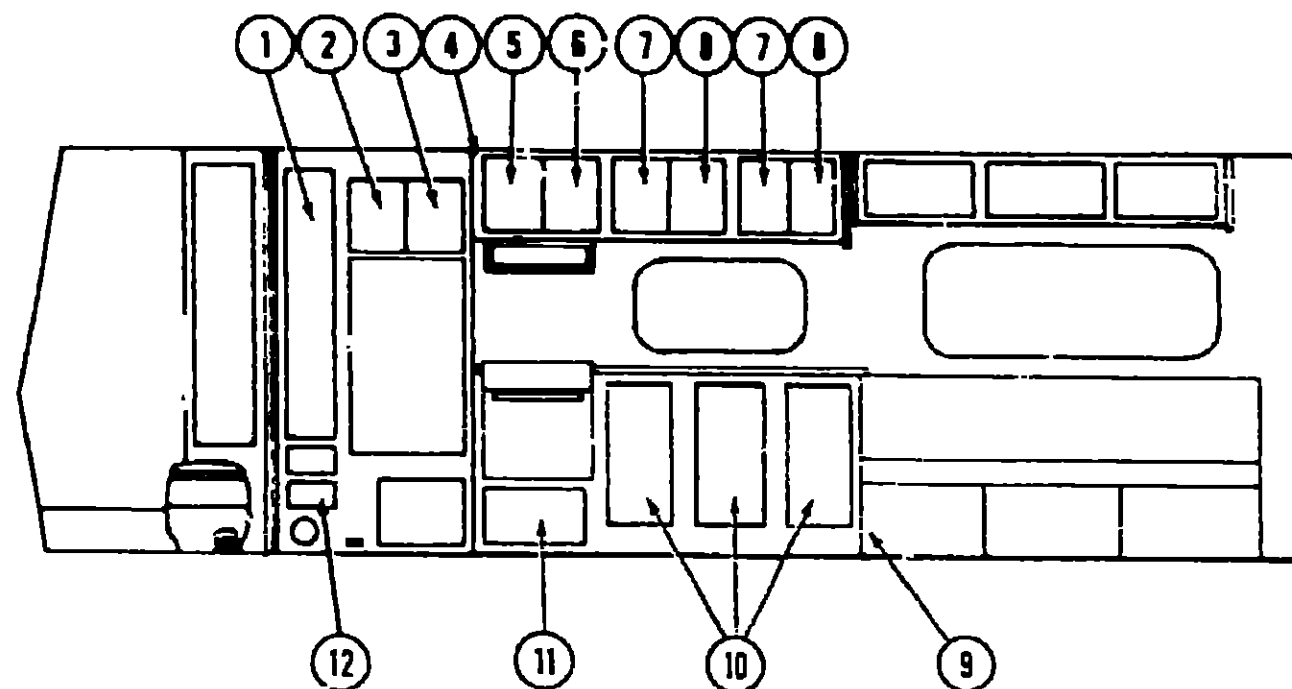

GALLEY CABINETRY

Key	Part Number	U/M	Description
1	069352-69-T03	EA	Door Asm. - Refrigerator Cabinet - Storage Rack - w/o Hardware
2	076740-06-T03	EA	Door Asm. - Refrigerator Cabinet - Storage Rack - w/o Hardware - Left
3	076740-05-T03	EA	Door Asm. - Refrigerator Cabinet - Storage Rack - w/o Hardware - Right
4	M76953-01-T03	EA	Cabinet Asm. - Galley Overhead - w/o Doors or Hardware
5	076740-02-T03	EA	Door Asm. - Galley Overhead - w/o Hardware - Left
6	076740-01-T01	EA	Door Asm. - Galley Overhead - w/o Hardware - Right
7	076740-04-T03	EA	Door Asm. - Galley Overhead - w/o Hardware - Left
8	076740-03-T03	EA	Door Asm. - Galley Overhead - w/o Hardware - Right
9	M78246-01-T03	EA	Cabinet Asm. - Galley - w/o Countertop, Doors, Drawers or Hardware
*	M01838-01-T03	EA	Countertop Asm. - Galley - Sunset Oak
10	076633-03-T03	EA	Door Asm. - Galley Cabinet - w/o Hardware
11	076533-20-T03	EA	Door Asm. - Galley Cabinet - w/o Hardware
*	067195-01-000	EA	Drawer - Plastic - 10.5" x 17.5" x 5"
12	M59913-13-R07	EA	Drawer Asm. - Refrigerator Cabinet - 5" x 8 7/8" x 17 2" Deep - w/o Hardware
*	Not illustrated		

GALLEY HARDWARE

Key	Part Number	U/M	Description
	053424-04-T03	EA	Sink Cover - Large - Sunset Oak
	068615-01-000	EA	Sink - Stainless Steel - Double w. Bolts
**	011053-01-000	EA	Faucet - Swing Spout - 8" - US
**	011053-02-000	EA	Faucet - Swing Spout - 8" - CSA
	066437-01-000	EA	Strainer - Sink
**	011053-01-700	EA	Aerator - Swing Spout Faucet
	058334-01-000	EA	Wastebasket - 9 3/4" x 7" x 10" - White Rubbermaid
	059377-01-000	EA	Support - Wastebasket - Plastic - Galley Mount
	058476-01-000	EA	Support - Wastebasket - Metal - Door Mount
	058641-01-T03	EA	Cover - Wastebasket - Sunset Oak
	052932-01-M10	EA	Hinge Kit - Cabinet Door - Antique Brass
**	041939-01-000	EA	Hinge Kit - Double Acting - Overhead Door
**	057698-01-000	EA	Latch - Hidden - Cabinet Door
**	057898-02-000	EA	Strike - Hidden Latch - Cabinet Door
	037688-01-000	FT	Rail - Drawer Guide - Steel
	047744-01-000	EA	Kit - Drawer Guide - Plastic
	054450-01-000	EA	Level - Refrigerator
	075451-01-000	EA	Storage Rack - Canned Goods
	074490-02-T03	EA	Spice Rack - Oak
	074981-01-000	EA	Cutting Board - Maple
**	The illustrated parts breakdown for this item is provided on the Common Items Fiche		

1985 WINNEBAGO TABLE OF CONTENTS

WC-WF421RB	A-01 - C-06
WC424RC	C-07 - E-16
WCN26RH	E-17 - G-22
WCN26RB	G-23 - J-04

1985 WCN26RB INDEX

Floor Plan	G-23 - G-24
Accessories Group	H-01 - H-03
Bath Group	H-04
Chassis Group	H-05
Curtain, Cushion & Pad Group	H-06 - H-12
Dinette Group	H-13 - H-16
Driver's Compartment Group	H-17 - H-19
Electrical Group	H-20 - H-22
Exterior Body Group	H-23 - I-05
Galley Group	I-06 - I-08
Heating & Air Conditioning Group	I-09 - I-12
Interior Finish Group	I-11 - I-12
LP Group	I-13
Lounge Group	I-14
Water & Sewage Group	I-15 - I-16
Window, Vent & Exterior Door Group	I-17 - J-04

GALLEY GROUP (CONTINUED)

GALLEY APPLIANCES

Key	Part Number	U/M	Description
	079353-02-000	EA	Hood - Stove - w Monitor - Almond - CSA
	079353-01-000	EA	Hood - Stove - w Monitor - Almond -US
	079352-01-000	EA	Hood - Stove - Non Power w Light - US
	079353-01-705	EA	Monitor Panel
	079353-01-701	EA	Fan Blade - Stove Hood - LVS
	079353-01-702	EA	Filter & Lens - Stove Hood - LVS
	079353-01-703	EA	Motor - Stove Hood - LVS
	045649-01-000	EA	Fan Blade - Stove Hood - Jensen
	049930-01-700	EA	Filter - Stove Hood - Jensen
	048643-01-000	EA	Motor - Stove Hood - Jensen
	049930-01-701	EA	Lens - Stove Hood - Jensen
	075217-01-000	EA	Refrigerator - AC DC Gas - Norcold 5 - 835-EG3
	075217-01-700	EA	Shell Asm - Door - w Trim
	075217-01-701	EA	Gasket - Door - Freezer
	075217-01-702	EA	Frame Asm. - Door
	075217-01-703	EA	Decor Trim - Top & Bottom
	075217-01-704	EA	Gasket - Door - Refrigerator
	075217-01-705	EA	Cabinet Asm. - Urethane
	075217-01-707	EA	Bulb - Light - DC
	075217-01-708	EA	Lamp Socket
	075217-01-710	EA	Eyebrow Asm
	075217-01-711	EA	Breaker Strip - Top
	075217-01-713	EA	Crisper Drawer
	075217-01-714	EA	Thermostat Asm.
	075217-01-715	EA	Knob - Thermostat
	075217-01-716	EA	Front Divider Asm.
	075217-01-717	EA	Humidity Switch
	075217-01-718	EA	Light Switch
	075217-01-719	EA	Eyebrow Board
	075217-01-720	EA	Eyebrow
	075217-01-721	EA	Lamp - Indicator - Amber
	075217-01-722	EA	Lamp - Indicator - Green
	075217-01-723	EA	Lamp - Indicator - Red
	075217-01-724	EA	Lamp - Indicator - Blue
	075217-01-725	EA	Rocker Switch - #615258
	075217-01-726	EA	Interface Board
	075217-01-728	EA	Cover - Interface Board
	075217-01-729	EA	Fitting - Outlet
	075217-01-730	EA	Gas Valve
	075217-01-731	EA	Nipple
	075217-01-732	EA	Fitting - Inlet
	075217-01-733	EA	Shut-Off Cock
	075217-01-734	EA	Fuse - 3 Amp
	075217-01-735	EA	Ignition Electrode
	075217-01-736	EA	Sensing Electrode
	075217-01-737	EA	Control Module
	075217-01-738	EA	Rocker Switch - #615259
	075217-01-739	EA	Heater
	075217-01-740	EA	Screw #6 - 32" x 2 3/8"
	075217-01-741	EA	Wing - Nut #6 - 32
	075217-01-742	EA	Hex Nut
	075217-01-743	EA	Elbow - 90

GALLEY GROUP (CONTINUED)

GALLEY APPLIANCES (CONT.)

Key	Part Number	U/M	Description
	075217-01-744	EA	Cable - Wiring
	075217-01-745	EA	Liner Asm - Foamed - Door
	075217-01-746	EA	Baffle Asm.
	075217-01-747	EA	Liner Asm - Foamed - Lower - Door
	075217-01-000	EA	Refrigerator - 3-Way - 10' Norcold
	075218-01-700	EA	Gasket - Freezer Door
	075218-01-701	EA	Gasket - Refrigerator Door
	075218-01-702	EA	Connector Rod
	075218-01-703	EA	Frame Asm.
	075218-01-704	EA	Cabinet - Urethane
	075218-01-705	EA	Breaker Strip - Bottom
	075218-01-707	EA	Divider - Front
	075218-01-708	EA	Cable - Wiring
	075218-01-709	EA	Door Liner Asm - Foamed
	075218-01-710	EA	Door Liner Asm - Foamed - Lower
	064782-02-000	EA	Range - 4 Burner - Almond Top
	065782-01-700	EA	Frame - Upper Glass
	064782-01-701	EA	Glass - Outside
	064782-01-702	EA	Panel - Door - Black
	064782-01-703	EA	Trim - Cabinet - Right
	065782-01-704	EA	Trim - Cabinet - Left
	064782-01-705	EA	Washer - Door Handle
	065782-02-700	EA	Top - 4 Burner - Almond
	064782-02-701	EA	Deflector - Plate - Black
	064782-02-702	EA	Trim - Cabinet - Right - Black
	064782-02-703	EA	Trim - Cabinet - Left - Black
	064782-02-704	EA	Trim - Glass - Lower Outside - Black
	064782-02-705	EA	Handle - Oven Door - Black
	064782-02-706	EA	Trim - Vertical - Black
	064782-02-707	EA	Panel - Manifold
	064782-02-708	EA	Mercury Valve
	745045-01-740	EA	Cover - Stove Top Bifold - Magic Chef
	075922-01-000	EA	Microwave
	075922-03-000	EA	Trim Ring - Microwave
	075922-04-000	EA	Exhaust Duct - Microwave
	075930-02-000	EA	Bracket - Microwave - Left
	075930-01-000	EA	Bracket - Microwave - Right
	076253-02-000	EA	Bracket - 6" - Microwave

1985 WINNEBAGO TABLE OF CONTENTS

WC/WF421RB	A-C1 - C-06
WC424RC	C-17 - E-16
WCN26RH	E-17 - G-22
WCN26RB	G-23 - J-04

1985 WCN26RB INDEX

Floor Plan	G-23 - G-24
Accessories Group	H-01 - H-03
Bath Group	H-04
Chassis Group	H-05
Curtain, Cushion & Pad Group	H-06 - H-12
Dinette Group	H-13 - H-16
Driver's Compartment Group	H-17 - H-19
Electrical Group	H-20 - H-22
Exterior Body Group	H-23 - I-05
Galley Group	I-06 - I-08
Heating & Air Conditioning Group	I-09 - I-10
Interior Finish Group	I-11 - I-12
LP Group	I-13
Lounge Group	I-14
Water & Sewage Group	I-15 - I-16
Window, Vent & Exterior Door Group	I-17 - J-04

HEATING & AIR CONDITIONING GROUP

FURNACES & ROOF AIR CONDITIONER

Key	Part Number	U/M	Description
	078182-03-070	EA	Furnace - 30,000 BTU - w/ Electric Ignition
	078182-01-000	EA	Furnace - 20,000 BTU - w/ Electric Ignition
	078182-01-740	EA	Thermostat - Furnace
	078182-01-710	EA	Igniter Asm - Furnace
	078182-01-708	EA	Manifold Asm - Furnace
	078182-01-723	EA	Burner Asm - Furnace
	078182-01-717	EA	Motor Furnace - 30,000 BTU
	069636-01-000	EA	Connector - 4" Duct
	009198-01-000	FT	Duct - Flexible - 4" I.D. x 25'
	056464-01-000	EA	Register - 4" Dia. - Plastic - w/ Damper
	056464-02-000	EA	Register - 4" Dia. - Plastic - w/o Damper
	009200-01-000	EA	Tape - Furnace - 1 1/2"
	023146-01-000	EA	Clamp - Screw Type - 4"
	073743-01-000	EA	Shroud Asm - Ceiling - Inside - Roof Air - 13,500 BTU - Cool Only
	073744-01-000	EA	Shroud Asm - Ceiling - Inside - Roof Air - 13,500 BTU - Heat & Cool
	073742-01-000	EA	Air Conditioner - 110 Volt - Roof Mount - 13,500 BTU Rotary
	073742-01-700	EA	Decal Package - Left & Right (Exterior)
	073742-01-701	EA	Selector Switch (5 Terminal)
	073742-01-702	EA	Decal - Cool Only
	073742-01-703	EA	Decal - Heat & Cool
	073742-01-704	EA	Decal - Thermostat - TSR

AUTOMOTIVE HEATER & AIR CONDITIONER

Key	Part Number	U/M	Description
	072341-04-000	EA	Heater-Evaporator Asm - A.R.A.
	072341-01-700	EA	Wheel - w/ Retainer & Index Clip
	072341-01-701	EA	Core - Heater - A.R.A.
	072341-01-702	EA	Coil - Evaporator - A.R.A.
	072341-01-703	EA	Valve - Expansion - A.R.A.
	072341-01-704	EA	Valve - Suction - A.R.A.
	072341-01-705	EA	Switch - Pressure - Low Cut Out
	072341-01-706	EA	Resistor - A.R.A.
	072341-01-707	EA	Thermostat - A.R.A.
	072341-01-708	EA	Motor - Vacuum - A.R.A.
	056455-01-702	EA	Blower - Evaporator Motor
	R77005-81-129	EA	Relay - Glow Plug
	072341-01-710	EA	Control Asm - Heater A.C. - A.R.A.
	072341-01-711	EA	Cable - Bowden - 72" - A.R.A.
	072341-01-712	EA	Switch - Vacuum - A.R.A.
	072341-01-713	EA	Switch - Jumper Control - A.R.A.
	072341-01-714	EA	Valve - Heater - Water Flow Control - A.R.A.
	072341-01-715	EA	Escape & Louver Adapter Asm
	072341-01-716	EA	Discharge Valve - 1 1/2"
	072341-06-000	EA	Duct & Control Kit
	072342-01-000	EA	Condenser Asm - A.R.A.
	072342-02-700	EA	Receiver Drier - Condenser Asm
	072343-01-000	EA	Compressor Clutch - A.R.A.
	072344-01-000	EA	Package - Compressor Mount
	074026-01-000	EA	Package - Compressor Mount - 6 1/2 L Diesel
	039044-01-000	EA	Louver Asm - A.C. Adjustable
	007076-01-700	FT	Hose - Flexible PVC - 2" I.D.
	007231-01-700	FT	Hose - Flexible PVC - 2 1/2" I.D.
	007103-01-000	FT	Hose - Heater - 5 8" I.D. SAE 20R3
	062401-04-000	EA	Clamp - Worm Drive - 69" - 1 25" I.D.
	010227-01-000	EA	Tee - Plastic - Bath 5/8" or 3/4" Hose

HEATING & AIR CONDITIONING GROUP (CONTINUED)

AUXILIARY HEATER ASSEMBLY

Key	Part Number	U/M	Description
	049401-01-000	EA	Heater Asm - Rear - Auxiliary
	049401-01-700	EA	Valve - Water Control
	049401-01-701	EA	Control Cable
	049401-01-702	EA	Motor Asm
	049401-01-703	EA	Heater Core
	049401-01-704	EA	Switch
	058906-02-000	EA	Control Panel - Beige
	058893-01-000	EA	Bracket - Side Mount - Motor Aid
	076312-01-000	EA	Mesh - Grille - 7 3/8" x 6 7/8" - Gold Aluminum

1985 WINNEBAGO TABLE OF CONTENTS

WCWF21RB	A-01 - C-06
WC424r/C	C-07 - E-16
WCN26RH	E-17 - G-22
WCN26RB	G-23 - J-04

1985 WCN26RB INDEX

Floor Plan	G-23 - G-24
Accessories Group	H-01 - H-03
Bath Group	H-04
Chassis Group	H-05
Curtain, Cushion & Pad Group	H-06 - H-12
Dinette Group	H-13 - H-16
Driver's Compartment Group	H-17 - H-19
Electrical Group	H-20 - H-22
Exterior Body Group	H-23 - I-05
Galley Group	I-06 - I-08
Heating & Air Conditioning Group	I-09 - I-10
Interior Finish Group	I-11 - I-12
LP Group	I-13
Lounge Group	I-14
Water & Sewage Group	I-15 - I-16
Window, Vent & Exterior Door Group	I-17 - J-04

INTERIOR FINISH GROUP

CURTAIN HARDWARE

Key	Part Number	U/M	Description
	079946-01-000	EA	Track - Curtain - Front Wraparound - Right
	079946-02-000	EA	Track - Curtain - Front Wraparound - Left
	056001-01-000	EA	Bracket - Shade - Left
	056002-01-000	EA	Bracket - Shade - Right
	056003-01-000	EA	Bracket - Drapery Retainer - Right
	056003-02-000	EA	Bracket - Drapery Retainer - Left
	056003-03-000	EA	Bracket - Drapery Retainer - Universal
	056784-01-000	EA	Pull - Window Shade - Antique Brass
	039175-02-000	EA	Bracket - Curtain Rod
	056115-01-000	YD	Tape - Clear Plastic - w/ Guides
	048394-01-000	YD	Tape Hook - 1" x 25 YD - Beige (Velcro)
	049385-01-000	YD	Tape Loop - 1" x 25 YD - Beige (Velcro)

CABINETRY & TABLE HARDWARE

Key	Part Number	U/M	Description
	053200-05-000	EA	Bracket - Upper Wall Mount - Beige - 23.5"
**	053201-03-000	EA	Bracket - Table Mount - 23"
	024275-05-000	EA	Rod - Table Lift - 8" x 23.5" - Beige
	024281-07-000	EA	Bracket - Lower Wall Mount - Beige - 22.12"
	024276-14-000	EA	Leg Asm. - Table - 29.5" - Brown
	064050-01-000	EA	Hinge - Table Leg
**	024282-01-000	EA	Brace - Table Leg
**	024283-01-000	EA	Clip - 1" O.D. Tube
	049493-02-000	EA	Catch - Table Leg - Mount's on Floor - Brown
	057898-01-000	EA	Latch - Hidden - Cabinet Door
	057898-02-000	EA	Strike - Hidden Latch - Cabinet Door
	009112-01-000	EA	Flange - 1" Chrome - Closet Rod
	059753-01-000	EA	Slide - Drawer - Left
	059753-02-000	EA	Slide - Drawer - Right
**	037588-01-000	FT	Rail - Drawer
**	047744-01-000	EA	Kit - Drawer Glide
	057671-01-000	EA	Screw Cover - #8 - Off White
	072369-01-000	EA	Mesh - Grille - Brass - 14.3" x 10.1"
	009040-02-000	EA	Leg - Pedestal Table - 27.5" x 2.25" O.D. - Chrome
	009040-03-000	EA	Base - Table Leg - Mounts on Table
	041194-01-000	EA	Base - Table Leg - Mounts in Floor
	062046-01-000	EA	Clip - Leg Pedestal
	009050-01-000	EA	Warp Guard - 64"
	009051-01-000	EA	Warp Guard - 48"
	039873-01-700	EA	Door Catch & Strike - Nylon & Spring Steel
**	052932-01-J30	EA	Hinge Kit - Cabinet Door - Antique Brass
	074493-01-000	EA	Overhead Door Support - Sprung
** The illustrated parts breakdown for this item is provided on the Common Items Fiche.			

INTERIOR FINISH GROUP (CONTINUED)

PANELING & COUNTERTOP MATERIALS

Key	Part Number	U/M	Description
	074497-04-000	SF	Paneling - Scrimshaw Sand - 48" x 84" (Wall)
	074497-03-000	SF	Paneling - Accent - Sunset Oak - 48" x 84" (Wall)
	074497-02-000	SF	Paneling - Woodgrain - 48" x 96" (Ceiling)
	074496-12-000	SF	Paneling - Decor - Autumn Tangerine - 48" x 84" (Galley & Bath) (T03)
	074496-13-000	SF	Paneling - Decor - Autumn Wheat - 48" x 84" (Galley & Bath) (T04)
	074496-14-000	SF	Paneling - Decor - Autumn Burgundy - 48" x 84" (Galley & Bath) (T05)
	074498-05-000	SF	Plastic Laminate - Sunset Oak (Galley)
	074498-04-000	SF	Plastic Laminate - Victorian Onyx (Bath)

INTERIOR MOLDINGS & TRIMS

Key	Part Number	U/M	Description
	024700-18-000	EA	Cover - Sidewall Roll Bar - 65" - Beige
	024700-19-000	EA	Cover - Sidewall Roll Bar - 53" - Beige
	009809-08-000	FT	Molding - Outside Corner - 1" 159 Elm
	009812-08-000	FT	Molding - Outside Corner - .50" - Teak
	042357-09-000	FT	Molding - Outside - .75" - 159 Elm
	009767-07-000	FT	Welling - Brown
	009815-03-000	FT	T-Molding - .75" - Light Brown
	022992-09-000	FT	Molding - Reverse Cove - Champagne White
	070504-02-000	FT	U-Channel - .815" - Light Brown
	009778-03-000	FT	U-Channel - 1" - Light Brown
	009779-03-000	FT	U-Channel - 1 1/2" - Light Brown
	052859-01-P01	FT	Accent Trim - Medium Almond Vinyl (Beige)
	059352-01-000	FT	Insert - Vinyl - Style & Rail Door
	069733-37-000	EA	Batt Strip - Sunset Oak - 8" (Wall)
	069733-42-000	EA	Batt Strip - Scrimshaw Sand - 8" (Wall)
	069733-11-000	EA	Batt Strip - Kenora - 8" (Ceiling)
	069733-38-000	EA	Batt Strip - Autumn Tangerine - 8" (T03)
	069733-39-000	EA	Batt Strip - Autumn Wheat - 8" (T04)
	069733-40-000	EA	Batt Strip - Autumn Burgundy - 8" (T05)
	064382-01-000	FT	Extrusion - Plastic Trim - Rolled Door
	042356-01-000	EA	Plug - Button - Mahogany - 3/8" Diameter
	045375-52-000	EA	Molding Retainer - Aluminum - 16"

FABRICS & CARPET

Key	Part Number	U/M	Description
	077498-16-000	YD	Fabric - Upholstery/Accent (T03)
	072333-12-000	YD	Fabric - Drapery - Sand (Wraparound)
	077498-20-000	YD	Fabric - Upholstery/Accent (T04)
	077498-21-000	YD	Fabric - Upholstery/Accent (T05)
	077498-18-000	YD	Fabric w. Pattern - Upholstery (T03)
	077498-17-000	YD	Fabric w. Pattern - Upholstery (T04)
	077498-19-000	YD	Fabric w. Pattern - Upholstery (T05)
	038421-02-000	YD	Fabric - Mattress Ticking
	079680-01-000	YD	Vinyl - Non-Expanded - 12 Gauge Film - Medium Almond (Beige)
	072860-30-000	SY	Carpet - Blue (T03)
	072860-31-000	SY	Carpet - Brown (T04)
	063340-32-000	SY	Carpet - Burgundy (T05)

MISCELLANEOUS PARTS

Key	Part Number	U/M	Description
	053552-01-T03	EA	Handle Asm. - Interior Assist - Medium Almond Vinyl
	041944-03-000	EA	Fire Extinguisher
	054185-22-000	EA	Owner's Manual - Itasca - Winnebago
	007038-01-000	EA	Door Mat - Black Rubber - 10 1/2" x 26"
	065201-01-000	EA	Lamp Shade - Fabric - White Flax
	041944-02-000	EA	Bracket - Fire Extinguisher

1985 WINNEBAGO TABLE OF CONTENTS

WC/WF421RB	A-01 - C-06
WC424RC	C-07 - E-16
WCN26RB	E-17 - G-22
WCN26RB	G-23 - J-04

1985 WCN26RB INDEX

Floor Plan	G-23 - G-24
Accessories Group	H-01 - H-03
Bath Group	H-04
Chassis Group	H-05
Curtain, Cushion & Pad Group	H-06 - H-12
Dinette Group	H-13 - H-16
Driver's Compartment Group	H-17 - H-19
Electrical Group	H-20 - H-22
Exterior Body Group	H-23 - I-05
Galley Group	I-06 - I-08
Heating & Air Conditioning Group	I-09 - I-10
Interior Finish Group	I-11 - I-12
LP Group	I-13
Lounge Group	I-14
Water & Sewage Group	I-15 - I-16
Window, Vent & Exterior Door Group	I-17 - J-04

LP GROUP

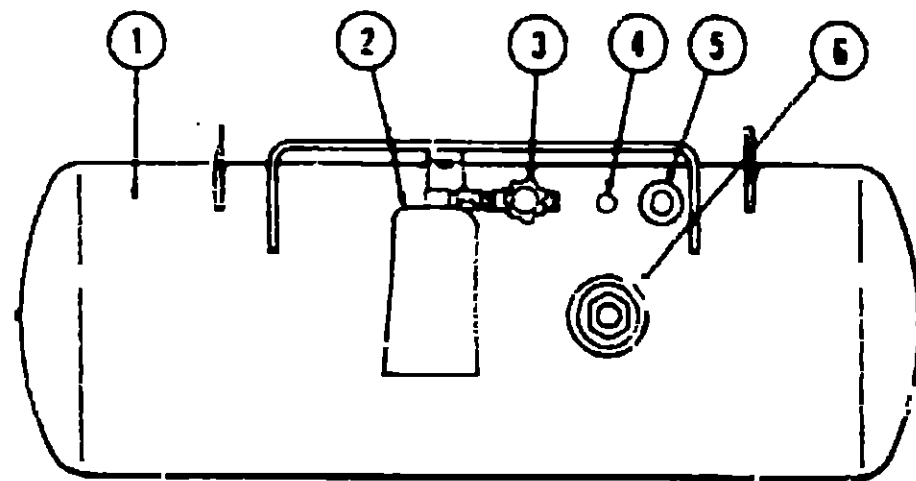

Key	Part Number	U/M	Description
1	074142-01-000	EA	Tank Asm - LP - Frame Mount - 80 Pound - 13" x 44"
1	074141-01-000	EA	Tank Asm - LP - Frame Mount - 42 Pound - 12" x 26"
•	065741-01-000	EA	Detector - LP Gas Leak - Marshalltown Instruments
2	076277-01-000	EA	Cover - Regulator - Two Stage - Front
2	076278-01-000	EA	Cover - Regulator - Two Stage - Back
•	076301-01-000	EA	Regulator - Two Stage - US
•	076301-02-000	EA	Regulator - Two Stage - CSA
3	040421-01-703	EA	Valve - Vapor Relief
4	040421-01-700	EA	Gauge - Liquid Level - 20" LP
5	040421-01-701	EA	Valve - Filler - LP
•	040421-01-702	EA	Cap - Plastic Fill Valve
6	040421-01-707	EA	Gauge - Float - w Visible Dial
•	040421-01-716	EA	Dial - Visible Face - Float Gauge (Tank w/o Electric Transmitter)
•	040440-01-000	EA	Dial - Transmitter - 0 - 90 Ohm (Float Gauge)
•	045703-01-000	EA	Hose Asm - LP - 3/8" I.D. x 24" - US
•	045703-02-000	EA	Hose Asm - LP - 3/8" I.D. x 24" - CSA
•	045703-03-000	EA	Hose Asm - LP - 3/8" I.D. x 18" - US
•	045703-04-000	EA	Hose Asm - LP - 3/8" I.D. x 14" - CSA
•	066046-01-000	EA	Conversion Kit - LP - Onan Generator
•	Not illustrated		

LOUNGE GROUP

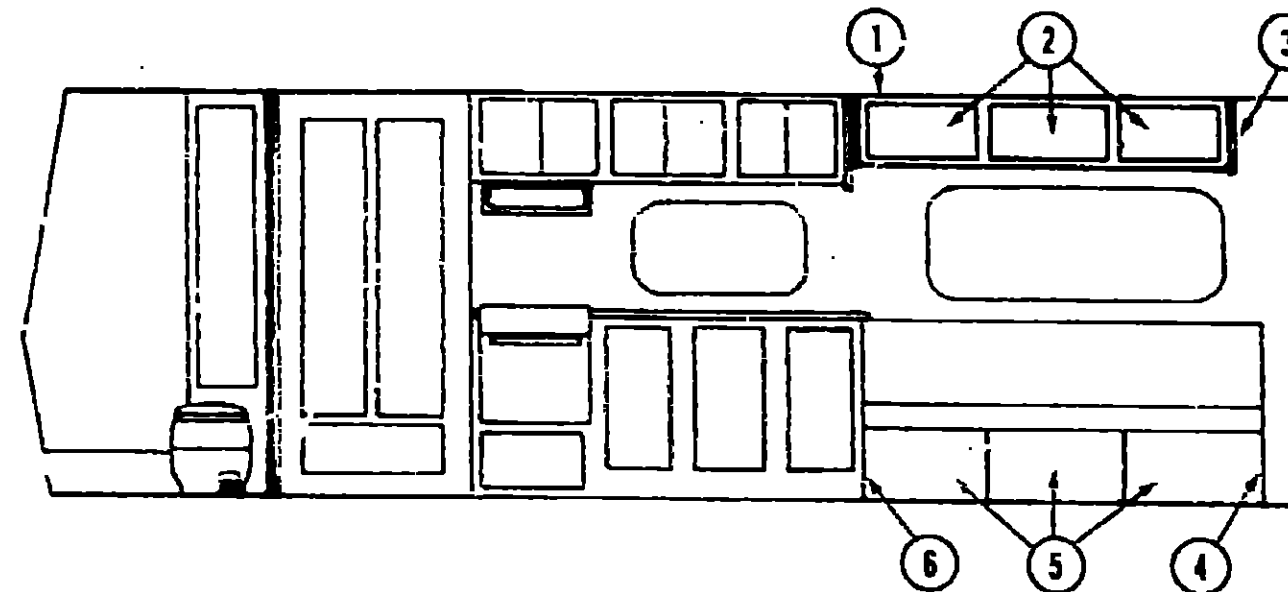

SPRUNG COUCH

Key	Part Number	U/M	Description
1	073503-01-T03	EA	Cabinet Asm - Overhead - Lounge - w/o Doors or Hardware
2	078525-05-T03	EA	Door Asm - Overhead Cabinet - w/o Hardware
3	076515-01-T03	EA	Pad - End - Lounge Overhead Cabinet - Right - Beige Vinyl
4	078921-01-T03	EA	End Panel - Sprung Couch - Right
5	NOTE	EA	Front Panel Asm. - Sprung Couch - (See Curtain, Cushion & Pad Group)
6	059750-01-T03	EA	End Panel - Sprung Couch - Left
•	057468-02-000	EA	Base Asm - Sprung Couch - Right
•	057468-03-000	EA	Base Asm - Sprung Couch - Left
•	057468-04-000	EA	Base Asm - Spacers - Sprung Couch - 2 per Couch
•	057469-04-000	EA	Leg Asm - Sprung Couch - 2 per Couch
•	053243-02-T03	EA	Table Asm - Pedestal - w/o Hardware
•	009040-02-000	EA	Leg - Pedestal Table - 27 5" x 2 25" O.D. - Chrome
•	009040-03-000	EA	Base - Table - Mounts on Table
•	041194-01-000	EA	Base - Table - Mounts in Floor
•	062045-01-000	EA	Clip - Pedestal Leg
•	Not illustrated		

1985 WINNEBAGO TABLE OF CONTENTS

WC WF421RB
WC424RC
WCN26RH
WCN26RB

A-01 - G-06
C-07 - E-16
E-17 - G-22
G-23 - J-04

1985 WCN26RB INDEX

Floor Plan	G-23 - G-24
Accessories Group	H-01 - H-03
Bath Group	H-04
Chassis Group	H-05
Curtain, Cushion & Pad Group	H-06 - H-12
Dinette Group	H-13 - H-16
Driver's Compartment Group	H-17 - H-19
Electrical Group	H-20 - H-22
Exterior Body Group	H-23 - I-05
Galley Group	I-06 - I-08
Heating & Air Conditioning Group	I-09 - I-10
Interior Finish Group	I-11 - I-12
LP Group	I-13
Lounge Group	I-14
Water & Sewage Group	I-15 - I-16
Window, Vent & Exterior Door Group	I-17 - J-04

WATER & SEWAGE GROUP

PLUMBING & REPAIR PARTS

Key	Part Number	U/M	Description
	033302-02-000	EA	Adapter Asm - SWVC Strain - 1 1/2
	062422-01-000	EA	Adapter - Hose Offset - Reducer - 3" x 1 1/2"
	062416-01-000	EA	Adapter - Hose - 3"
	052954-01-000	EA	Adapter - Nose Cone - 3/8 or 1/2 - Plastic
	010224-01-000	EA	Adapter - Plastic - 3/8 MPT x 3/8 Barb
	031602-02-000	EA	Adaptic - Plastic - 1 1/2 H x FPT
	010134-01-000	EA	Adapter - Plastic - 1 1/2 Male x MPT
	004020-01-000	QT	Adhesive - ABS Cement
**	010121-01-000	EA	Bushing - Plastic - 1 1/2 S x 1 1/4 H
	010123-01-000	EA	Bushing - Plastic - 2S x 1 1/2 H
	036522-02-000	EA	Cap - 1/2 Flare - Brass
	075730-01-000	EA	Cap - End - Sewer Hose
	052415-01-000	EA	Cap - Sewer - 3"
	052959-02-000	EA	Connector - 1/2 F x 1/2 MPT - Plastic (In Tank Filter)
	052959-03-000	EA	Connector - 1/2 F x 3/8 MPT - Plastic
**	011091-01-000	EA	Continuous Waste - Double Sink - 11 7/8" - US
	053874-01-000	EA	Continuous Waste Asm. - Double Sink - CSA
**	050780-01-000	EA	Coupler Rubber - 3" x 3"
	052960-01-000	EA	Drain Valve - 1/2 F x 1/2 F - Plastic
	010005-01-000	EA	Elbow - Plastic - 1/15 BD x 1 1/2
	010006-01-000	EA	Elbow - Plastic - 1.8 BD x 1 1/2 x 45° H x H
	010008-01-000	EA	Elbow - Plastic - 1/4 BD x 1 1/2 x 90° Left
	010051-01-000	EA	Elbow - ST - Plastic - 1.8 BD x 1 1/2 x 45°
	010219-01-000	EA	Elbow - 1 1/4 Barb x 1 1/4 MPT x 90°
	034250-01-000	EA	Elbow - Plastic - 1/4 BD x 1 1/2 x 90° x H x H
	035539-01-000	EA	Elbow - Plastic - 3/8 MPT x 3/8 Barb
	052957-01-000	EA	Elbow - Plastic - 1/2 F x 3/8 MPT
	052957-02-000	EA	Elbow - Plastic - 1/2 F x 1/2 MPT
	065120-01-000	EA	Elbow - Plastic - Swivel - .50"
	070924-01-000	EA	Elbow - Plastic - Swivel - 1/2 MPT x 1/2 FP
	075726-01-000	EA	Extension - Outlet - Sewer Hose
	010147-01-000	EA	Flange - Closet - 4" F x 3" FPT - US
	010147-02-000	EA	Flange - Closet - 4" F x 3" FPT - CSA
	077954-01-000	EA	Filter/Screen (In Water Tank)
	044928-01-000	FT	Flexible Tubing - 1 1/4 I.D. x 10'
	061607-01-000	EA	Grommet - Holding Tank Coupler - 1 1/2"
	061607-02-000	EA	Grommet - Holding Tank Coupler - 3"
**	052961-01-000	EA	Header - 1/2 F x 1/2 F x 1/2 F x 1/2 F
**	046524-01-000	EA	Kit - Holding Tank Fittings - Blank Tank
**	046524-02-000	EA	Kit - Water Tank Fittings - Blank Tank
	052953-01-000	EA	Nut - Faucet - 1/2 Tube x 1.2 FPT
	052952-01-000	EA	Nut - 1/2 F - Plastic
**	011066-01-000	EA	P-Trap - 1 1/4" - Plastic - US
**	011066-02-000	EA	P-Trap - 1 1/4" - Plastic - CSA
	053335-01-000	EA	P-Trap - Plastic - 1 1/4 H x H - w/Union - CSA
	075666-01-000	EA	Pipe - PVC - DWV - 4" I.D. x 10'
	045729-01-000	EA	Pump - Water - 2.8 G.P.M. - Direct Drive - Shurflo - US
	045729-02-000	EA	Pump - Water - 2.8 G.P.M. - Direct Drive - Shurflo - CSA
**	010201-01-000	EA	Sewer Hose - 3" x 8' w/Clamp
	042959-04-000	EA	Spinweld Fittings - Plastic - 3/8 FPT
	042959-02-000	EA	Spinweld Fittings - Plastic - 1/2 FPT (In Tank Filter)
	042959-03-000	EA	Spinweld Fittings - Plastic - 1 1/4" NPT
	010071-01-000	EA	Tee - Plastic - 1 1/2 x H x H x H
	010072-01-000	EA	Tee - Plastic - 1 1/2 H x 1 1/4 H x 1 1/2 H
**	010079-01-000	EA	Tee - Plastic - 1 1/2 H x 1 1/2 H x 1 1/4 H
	046172-01-000	EA	Tee - Plastic - 3/8 B x 3/8 B x 3/8 MPT
	052955-01-000	EA	Tee - Plastic - 1/2 F x 1/2 F x 1/2 MPT
	052956-01-000	EA	Tee - Plastic - 1/2 F x 1/2 MPT x 1/2 F
	039800-01-000	FT	Tubing - Polybutyl - 1/2 O.D. (Water Line)
	074462-02-000	FT	Tubing - Vinyl - 3/8" I.D.

WATER & SEWAGE GROUP (CONTINUED)

HOLDING TANKS & WATER HEATERS

Key	Part Number	U/M	Description
	M01275-55-000	EA	Tank Asm - Water - 40 Gallon - w/Fittings
	078252-01-000	EA	Tank Asm - Water - 40 Gallon - w/o Fittings
	075589-01-000	EA	Tank Asm - Holding - 33 Gallon - w/o Fittings - Waste Water
	075298-01-000	EA	Tank Asm - Holding - 37 Gallon - w/o Fittings - Sewage
**	051391-01-000	EA	Water Heater - w/o Motor Aid - G6A3
**	051393-01-000	EA	Water Heater - w/Motor Aid - GH6-3E

The illustrated parts breakdown for this item is provided on the Common Items Fiche

1985 WINNEBAGO TABLE OF CONTENTS

WC/WF-21RB	A-01 - C-05
WC424RC	C-07 - E-16
WCN26R:1	E-17 - G-22
WCN26RB	G-23 - J-04

1985 WCN26RB INDEX

Floor Plan	G-23 - G-24
Accessories Group	H-01 - H-03
Bath Group	H-04
Chassis Group	H-05
Curtain, Cushion & Pad Group	H-06 - H-12
Dinette Group	H-13 - H-16
Driver's Compartment Group	H-17 - H-19
Electrical Group	H-20 - H-22
Exterior Body Group	H-23 - I-05
Galley Group	I-06 - I-08
Heating & Air Conditioning Group	I-09 - I-10
Interior Finish Group	I-11 - I-12
LP Group	I-13
Lounge Group	I-14
Water & Sewage Group	I-15 - I-16
Window, Vent & Exterior Door Group	I-17 - J-04

** The illustrated parts breakdown for this item is provided on the Common Items Fiche

WINDOW, VENT & EXTERIOR DOOR GROUP

WINDOWS & ACCESS DOORS

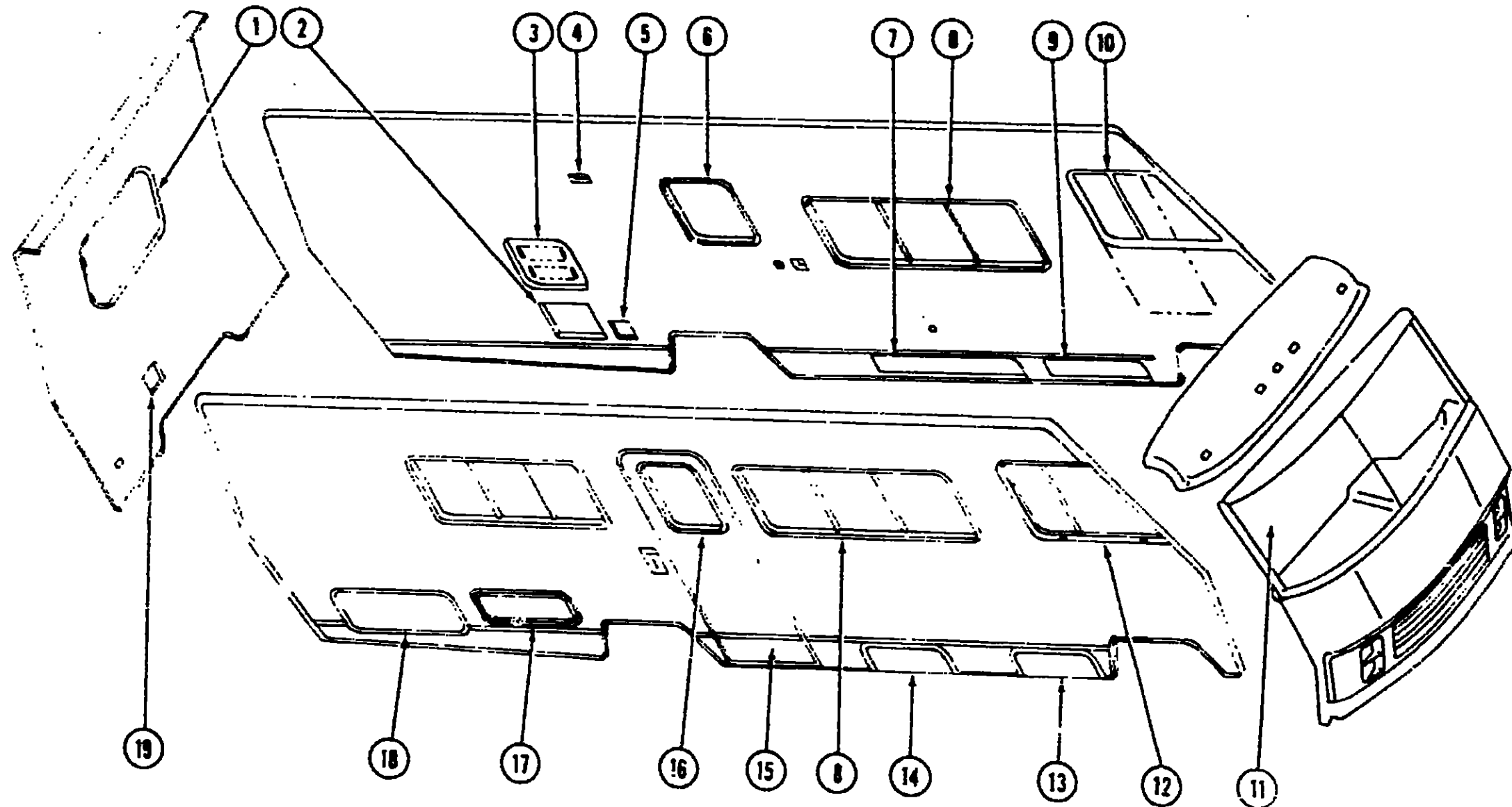

Key	Part Number	U/M	Description
1	079415-01-T03	EA	Window Asm - Rear Escape - 23" x 29"
2	052009-02-000	EA	Door Asm - Water Heater
3	069762-03-000	EA	Door Asm - Refrigerator Access - w/Twist Lock
4	079355-05-000	EA	Vent - Stovehood - Outside
5	NOTE	EA	Door Asm - Power Cord (See Access Door)
6	046631-34-000	EA	Window Asm w Charcoal Screen - Left - Single Slider
7	079435-03-000	EA	Door Asm - Luggage
8	075738-02-000	EA	Window Asm - w Charcoal Screen
9	079436-02-000	EA	Door Asm - Spare Tire Compartment
10	079429-02-T03	EA	Window Asm - Left Front Slant Slider - 23" x 39"

Key	Part Number	U/M	Description
11	077675-01-000	EA	Glass - Windshield - Right
12	077675-02-000	EA	Glass Windshield - Left
13	079429-01-T03	EA	Window Asm. - Right Front Slant Slider - 23" x 39"
14	079436-01-000	EA	Door Asm. - Access - 25 3" x 9" w/Key Lock
15	079436-03-000	EA	Door Asm. - Access - 25 3" x 9" w/Twist Lock
16	1401870-01-T03	EA	Door Asm - Radius Entry w/Screen Door
17	079733-04-T03	EA	Window Asm - Picture - 17" x 25"
18	078966-01-T03	EA	Door Asm. - Insulated Storage
19	1401883-01-T03	EA	Door Asm - Generator - w/o Baffle
20	078964-01-T03	EA	Door Asm - Luggage - Beige
21	078010-06-000	EA	Door Asm - Fuel Fill
22	-	-	Not illustrated

1985 WINNEBAGO TABLE OF CONTENTS

WC/WF421RB
WC424RC
WCN26RH
WCN26RB

A-01 - C-06
C-07 - E-16
E-17 - G-22
G-23 - J-04

1985 WCN26RB INDEX

Floor Plan	G-23 - G-24
Accessories Group	H-01 - H-03
Bath Group	H-04
Chassis Group	H-05
Curtain, Cushion & Pad Group	H-06 - H-12
Dinette Group	H-13 - H-16
Driver's Compartment Group	H-17 - H-19
Electrical Group	H-20 - H-22
Exterior Body Group	H-23 - I-05
Galley Group	I-06 - I-08
Heating & Air Conditioning Group	I-09 - I-10
Interior Finish Group	I-11 - I-12
LP Group	I-13
Lounge Group	I-14
Water & Sewage Group	I-15 - I-16
Window, Vent & Exterior Door Group	I-17 - J-04

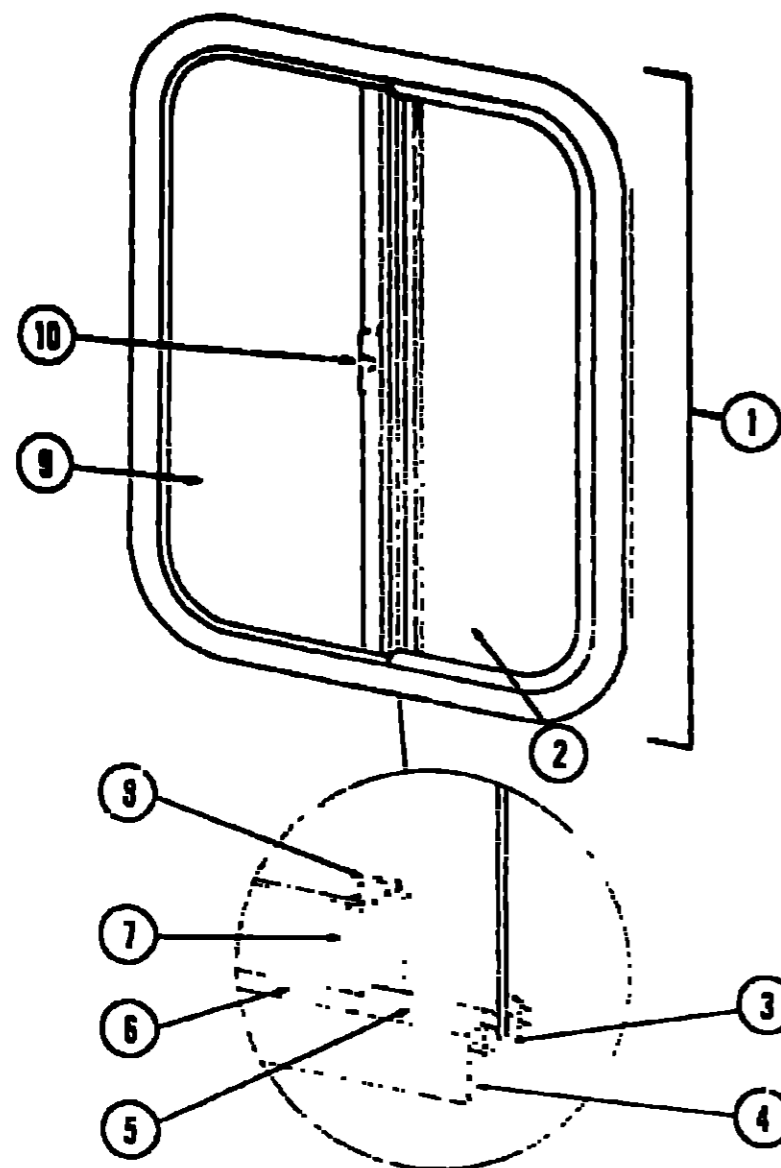

Key	Part Number	U/M	Description
1	03631-34-000	EA	Window Asm. w/Charcoal Screen - Left Single Slider (w/o inside frame)
2	04247-12-000	EA	Inside Frame - Beige (not included in assembly)
3	00241-02-000	EA	Glass - Stationary - 1/8" x 12.3" x 19"
4	00224-02-000	FT	Channel - Weatherstrip - Glass
5	06950-01-000	FT	Tape - 1/4" Bead x 20' - Gray - 3M
6	05731-02-000	FT	Extr. Vinyl - Window Seal - Black
7	00230-02-000	FT	Spline - Glass - 1/8" Material - Black
8	M69836-03-011	EA	Extr. Holder - Glass Seal - 18.19" - Black
9	041794-10-000	EA	Mullion - Slider Window - 20" - Black
10	047320-01-000	EA	Glass - Sliding - w/Hole - 1/8" x 13.68" x 19"
	047369-01-000	EA	Latch - Window - Plastic - w/Fastener
	002193-01-000	SF	Screen - Window - 26" - Gray
	002218-01-000	FT	Spline - .130" Dia. - Gray (Screen)
	073740-01-000	FT	Seal - Fin - Pile - .460"
			Not illustrated

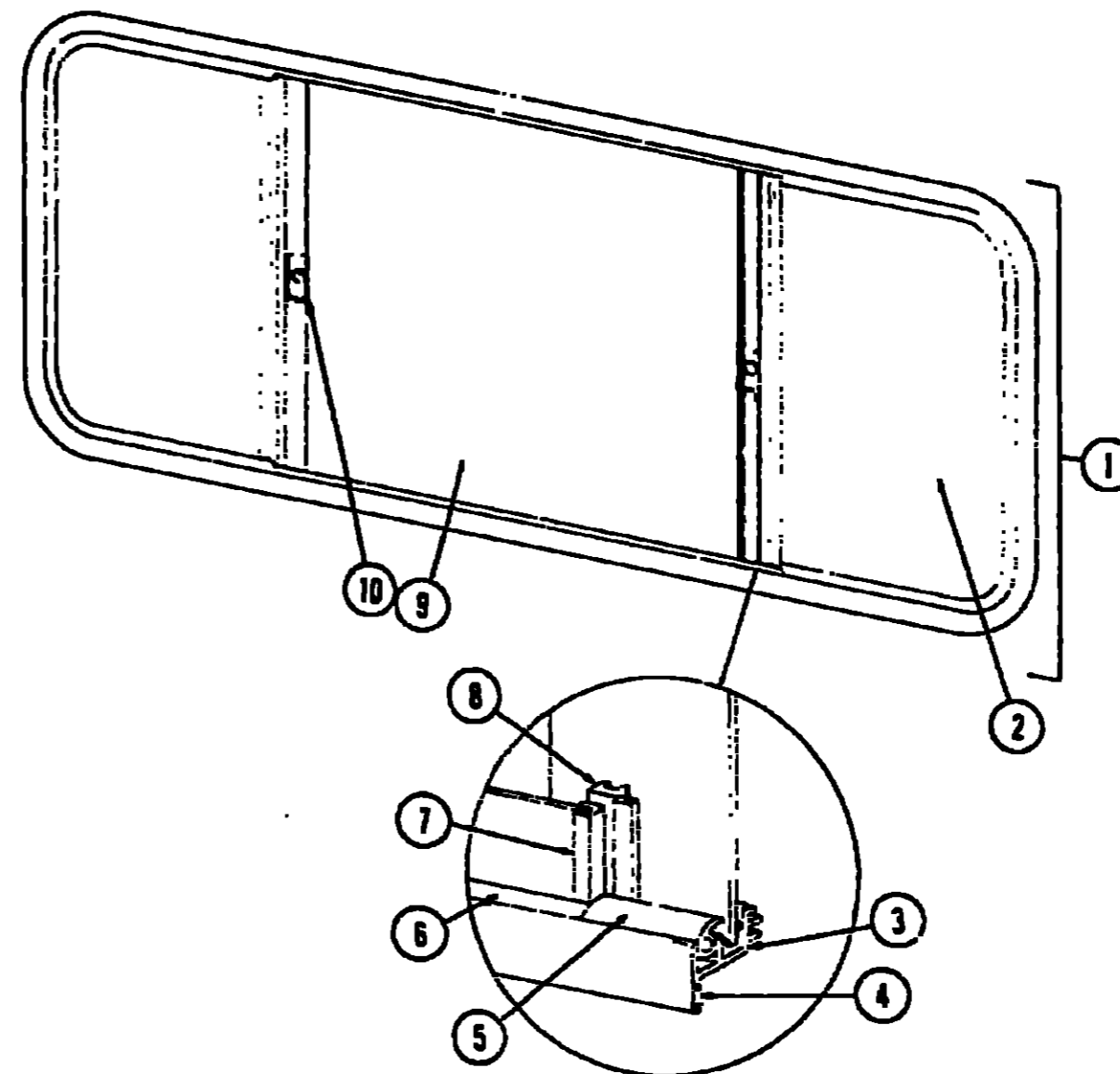

Key	Part Number	U/M	Description
1	075739-02-000	EA	Window Asm. w/Charcoal Screen - Double Slider (w/o inside frame)
2	067609-06-000	EA	Inside Frame - Beige (not included in assembly)
3	047822-04-000	EA	Glass - Sliding - 1/8" x 24" x 21.03"
4	002324-02-000	FT	Channel - Weatherstrip - Glass
5	06950-06-000	FT	Ribbon Sealer - 5/16" Bead x 15'
6	057374-02-000	FT	Extr. Vinyl - Window Seal - Black
7	002309-02-000	FT	Spline - Glass - 1/8" Material - Black
8	M69886-03-003	EA	Seal Holder - w/Fin Seal - 23.19" - Black
9	059836-02-000	EA	Mullion - Slider Window - Black
10	002188-05-000	EA	Glass - Stationary - .125" x 24" x 25.5"
	047369-01-700	EA	Latch Kit - Window - Plastic w/Fastener
	002293-02-000	SF	Screen - Window - 26" - Charcoal
	002293-01-000	SF	Screen - Window - 26" - Gray
	002298-02-000	FT	Spline - Screen - .13" Dia. - Charcoal
	002298-01-000	FT	Spline - Screen - .13" Dia. - Gray
	073740-01-000	FT	Seal - Fin - Pile - .46"
			Not illustrated

1985 WINNEBAGO TABLE OF CONTENTS

WC/WF421RB
WC424RC
WCN26RH
WCN26RB

A-01 - C-08
C-07 - E-16
E-17 - G-22
G-23 - J-04

1985 WCN26RB INDEX

Floor Plan	G-23 - G-24
Accessories Group	H-01 - H-03
Bath Group	H-04
Chassis Group	H-05
Curtain, Cushion & Pad Group	H-06 - H-12
Dinette Group	H-13 - H-16
Driver's Compartment Group	H-17 - H-19
Electrical Group	H-20 - H-22
Exterior Body Group	H-23 - I-05
Galley Group	I-06 - I-08
Heating & Air Conditioning Group	I-09 - I-10
Interior Finish Group	I-11 - I-12
LP Group	I-13
Lounge Group	I-14
Water & Sewage Group	I-15 - I-16
Window, Vent & Exterior Door Group	I-17 - J-04

WINDOW, VENT & EXTERIOR DOOR GROUP (CONTINUED)

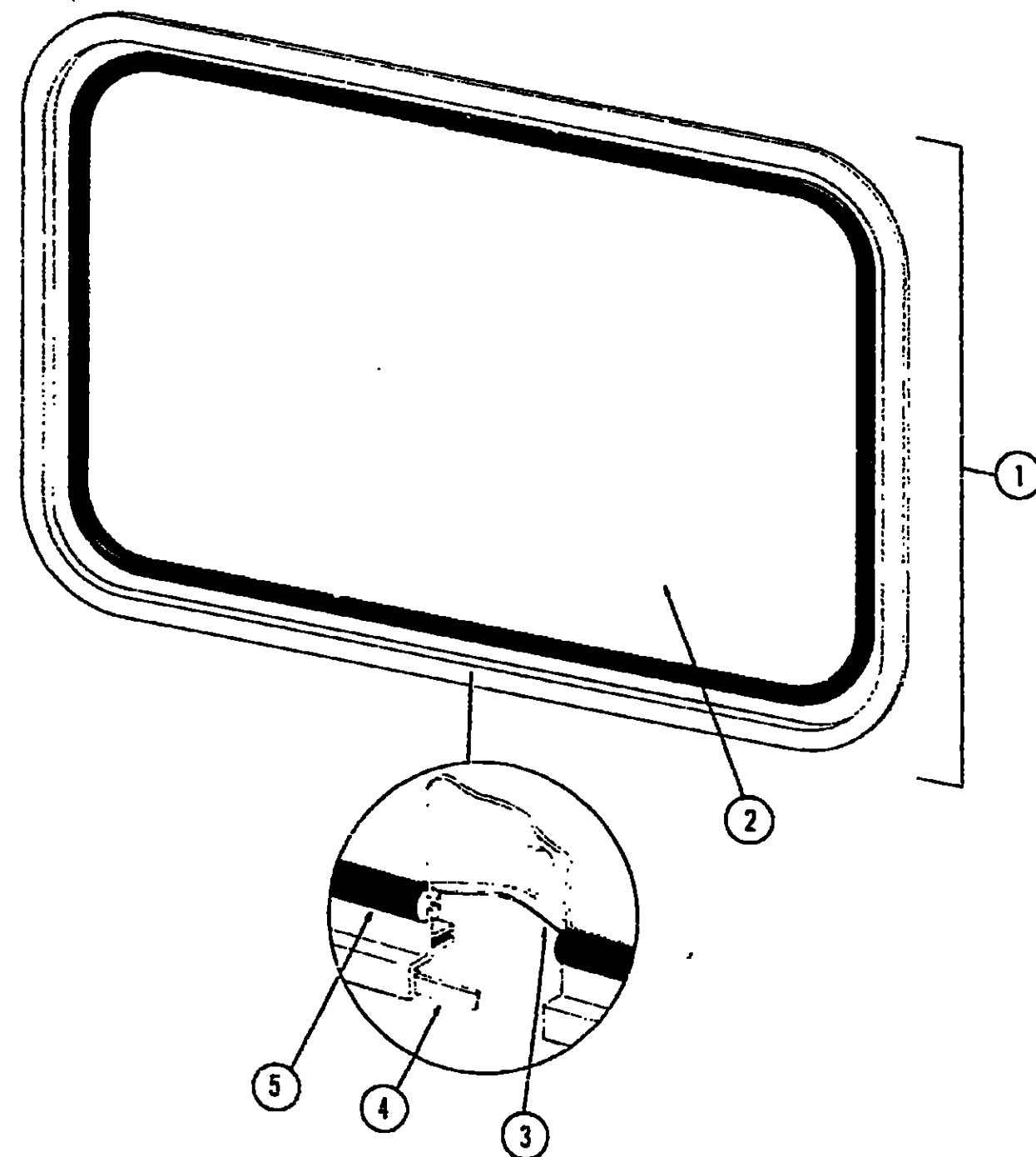

Key	Part Number	U/M	Description
1	079415-01-T03	EA	Window Asm - Rear Escape - 23" x 29" - Black (w/o inside frame)
2	002174-01-000	EA	Glass - 1/8" x 19.6" x 25.92"
3	002285-01-000	FT	Filler - Weatherstrip - Black
4	020395-01-000	EA	Pull Ring - Escape Window
5	053767-02-000	FT	Tape - 3/16" Bead x 25' - Gray
6	002282-01-000	FT	Weatherstrip - .125" - Window
.	020749-05-000	EA	Inside Frame - Escape Window - Beige (not included in assembly)
.	006199-01-000	EA	Label - Exit - Escape Window
.	Not illustrated		

WINDOW, VENT & EXTERIOR DOOR GROUP (CONTINUED)

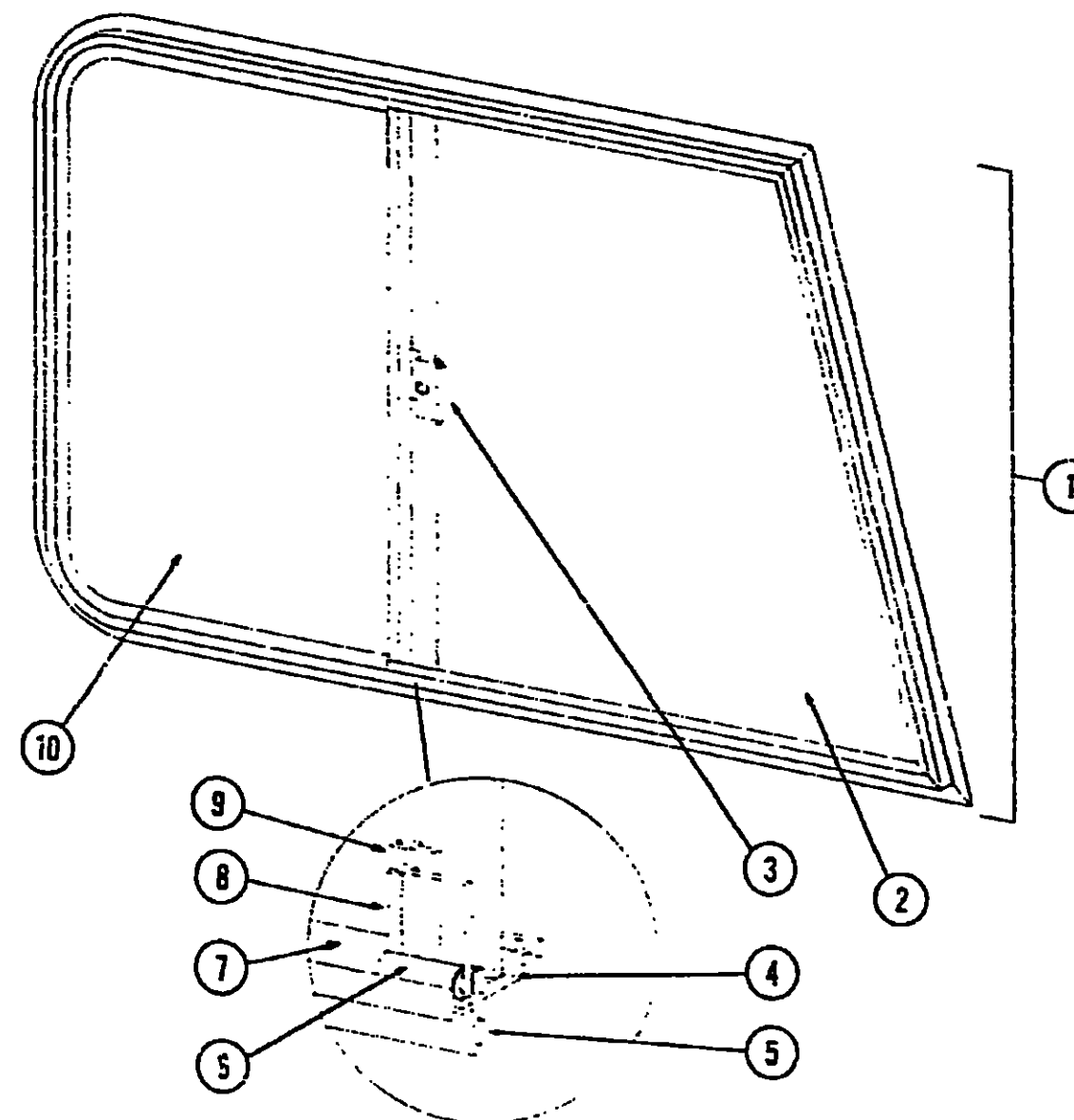

Key	Part Number	U/M	Description
1	079429-01-T03	EA	Window Asm. - Right Front Slant Slider (w/o inside frame)
1	079429-02-T03	EA	Window Asm. - Left Front Slant Slider (w/o inside frame)
2	057656-03-000	EA	Glass - .19" x 28.11" x 26.5" - Stationary
3	047369-01-700	EA	Latch - Window - Plastic w/ Fastener
.	023320-01-000	EA	Foam Pad - 3.8" Dia. (used w/ plastic latch)
4	002324-02-000	FT	Channel - Weatherstrip - Glass Run - 3/16" Glass
5	069640-06-000	FT	Ribbon Sealer - 5/16" Bead x 15'
6	002309-02-000	FT	Spline - 3/16" Glass
7	057374-02-000	FT	Extr. Vinyl - Window Seal - Black
8	078562-01-000	EA	Mullion - Outside - Black - 24.13"
9	079796-01-000	EA	Mullion - Window - Slant Slider
10	057657-03-000	EA	Glass - .19" x 28.11" x 14.68" - Sliding
.	079755-01-000	EA	Inside Frame - Right Front Slant Slider - Beige (not included in assembly)
.	079755-02-000	EA	Inside Frame - Left Front Slant Slider - Beige (not included in assembly)
.	055164-05-000	EA	Slider Screen Asm. - Right or Left - Black
.	016310-03-000	EA	Handle - Slider Screen - Black
.	002292-02-000	SF	Screen - Window - 20"
.	073740-01-000	FT	Seal - Fin - Pile - .460"
.	Not illustrated		

1985 WINNEBAGO TABLE OF CONTENTS

WC/WF421RB
WC424RC
WCN26RH
WCN26RB

A-01 - C-06
C-07 - E-16
E-17 - G-22
G-23 - J-04

1985 WCN26RB INDEX

Floor Plan	G-23 - G-24
Accessories Group	H-01 - H-03
Bath Group	H-04
Chassis Group	H-05
Curtain, Cushion & Pad Group	H-06 - H-12
Dinette Group	H-13 - H-16
Driver's Compartment Group	H-17 - H-19
Electrical Group	H-20 - H-22
Exterior Body Group	H-23 - I-05
Galley Group	I-06 - I-08
Heating & Air Conditioning Group	I-09 - I-10
Interior Finish Group	I-11 - I-12
LP Group	I-13
Lounge Group	I-14
Water & Sewage Group	I-15 - I-16
Window, Vent & Exterior Door Group	I-17 - J-04

WINDOW, VENT & EXTERIOR DOOR GROUP (CONTINUED)

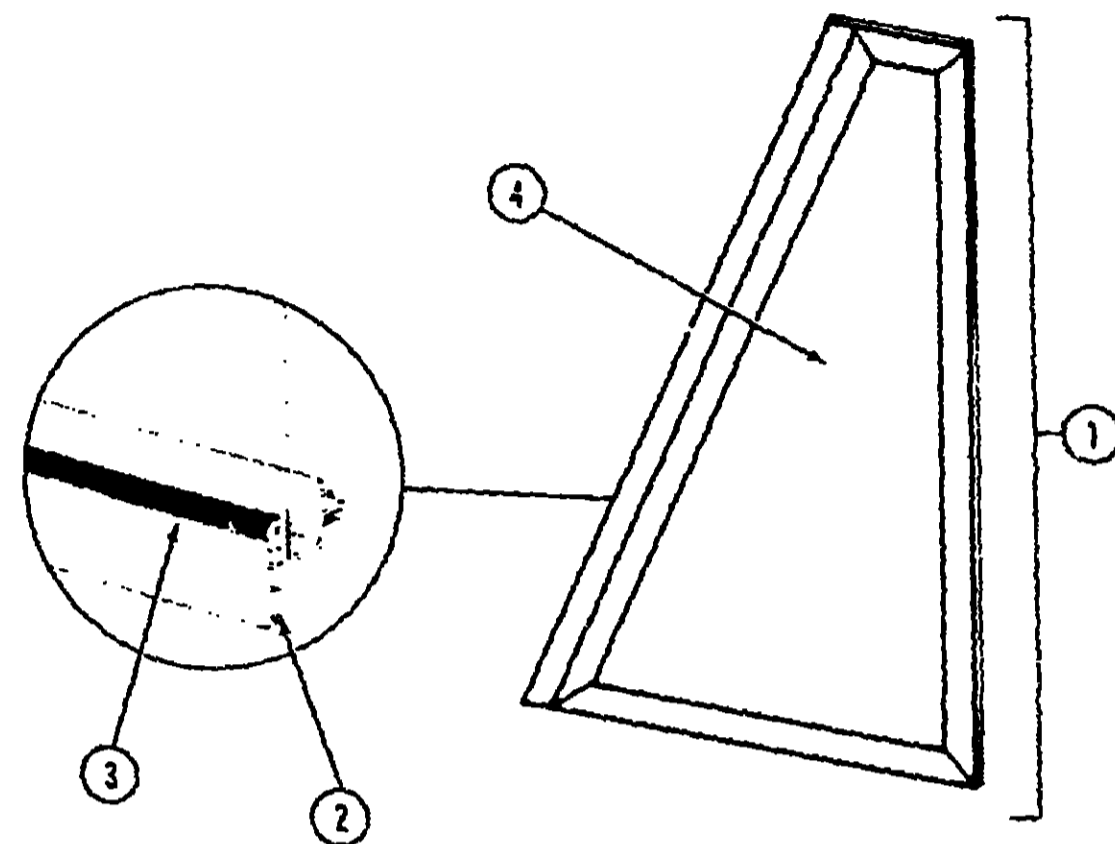

Key	Part Number	U/M	Description
1	079421-02-T03	EA	Window Asm. - Stationary - Drivers Side - Black (w/o inside frame)
1	079421-01-T03	EA	Window Asm. - Stationary - Passenger Side - Black (w/o inside frame)
2	060540-01-000	FT	Ribbon Sealer - 5/16 Bead
3	002309-02-000	FT	Spline - Glass - 1/8" - Black
4	057656-02-000	EA	Glass - 19" x 24.65" x 13.65"
.	079215-01-000	EA	Inside Frame - Passenger - Beige
.	079215-02-000	EA	Inside Frame - Drivers - Beige
.	Not illustrated		

WINDOW, VENT & EXTERIOR DOOR GROUP (CONTINUED)

ACCESS DOOR

Key	Part Number	U/M	Description
	078966-01-T03	EA	Door Asm. - Storage - Insulated - Beige - w/Key Lock
	078964-01-T03	EA	Door Asm. - Storage - Beige - w/Key Lock (Gen)
	079436-03-T03	EA	Door Asm. - Luggage - Beige - w/Key Lock
	074969-03-T03	EA	Door Asm. - Refrigerator Access - Beige - w/Twist Lock
	079436-02-T03	EA	Door Asm. - Spare Tire Compartment - Beige - w/Key Lock
	079436-01-T03	EA	Door Asm. - Access - Beige - w/Key Lock (Battery)
	M01883-01-T03	EA	Door Asm. - Generator - Beige - w/Twist Lock
	078010-06-000	EA	Door Asm. - Fuel Fill - Beige
	052009-02-000	EA	Door Asm. - Water Heater - Beige
	052181-01-000	EA	Baffle - Generator Door
	052423-02-000	EA	Door - Sewer Hose - Beige
	052424-02-000	EA	Jamb - Power Cord/Fuel Fill Door - Beige
	063742-02-000	EA	Door - Power Cord - Beige
	054543-02-000	EA	Hatch - Power Cord Door - Beige
	054530-01-000	EA	Door Holder
	042441-01-000	EA	Lock Asm. - Key Type - Gas Fill
	047305-01-000	EA	Lock Asm. - Key Type - w/Clip - (Luggage)
	052950-01-700	EA	Lock Kit - Twist Type - w/Clip - (Power Cord)
	079356-01-000	EA	Lock Asm. - Key Type (Storage)
	079927-01-000	EA	Lock Asm. - Twist Type (Storage)

WINDSHIELD

Key	Part Number	U/M	Description
	077675-01-000	EA	Glass - Windshield - Right
	077675-02-000	EA	Glass - Windshield - Left

VENTS

Key	Part Number	U/M	Description
	071290-02-000	EA	Cover - Refrigerator Vent - 11 5/8" x 24 3/4" - Galv. Steel
	071290-01-000	EA	Roof Base - Refrigerator Vent - 7 5/8" x 25 5/8" - Galv. Steel
	079355-01-000	EA	Vent - Stovehood - Outside - Beige
	079537-01-000	EA	Vent Asm. - Roof - Powered - w/o Screen - Alum.
	075055-01-000	EA	Vent Asm. - Roof - Non Powered - w/o Screen - Alum.
	076765-01-T03	EA	Screen Asm. - Roof Vent - Non Powered - Off White
	076765-01-T03	EA	Screen Asm. - Roof Vent - Powered - Off White

1985 WINNEBAGO TABLE OF CONTENTS

WC/WF421RB	A-01 - C-06
WC424RC	C-07 - E-16
WCN26RH	E-17 - G-22
WCN26RB	G-23 - J-04

1935 WCN26RB INDEX

Floor Plan	G-23 - G-24
Accessories Group	H-01 - H-03
Bath Group	H-04
Chassis Group	H-05
Curtain, Cushion & Pad Group	H-06 - H-12
Dinette Group	H-13 - H-16
Driver's Compartment Group	H-17 - H-19
Electrical Group	H-20 - H-22
Exterior Body Group	H-23 - I-05
Galley Group	I-06 - I-08
Heating & Air Conditioning Group	I-09 - I-10
Interior Finish Group	I-11 - I-12
LP Group	I-13
Lounge Group	I-14
Water & Sewage Group	I-15 - I-16
Window, Vent & Exterior Door Group	I-17 - J-04

DRIVER & PASSENGER CAB DOORS

Key	Part Number	U/M	Description
1	079624-01-T03	EA	Door Asm. - Driver - Beige
1	079624-02-T03	EA	Door Asm. - Passenger - Beige
2	064088-03-000	EA	Pad Asm. - Trim - Beige Vinyl - Drivers Door
2	064088-04-000	EA	Pad Asm. - Trim - Beige - Vinyl - Passenger
	061400-06-000	EA	Assist Strap - 12" - Beige Vinyl
3	046886-01-000	EA	Ash Tray Asm. - Flush Mount - Chrome
4	064499-02-000	EA	Panel - Driver Door - Inner - Light Oak Plastic
4	064499-03-000	EA	Panel - Passenger Door - Inner - Light Oak Plastic
5	079214-01-000	EA	Trim - Door Frame - Front - Beige - Drivers Door
5	079214-02-000	EA	Trim - Door Frame - Front - Beige - Passenger Door
6	079250-01-000	EA	Trim - Door Frame - Rear - Beige - Drivers Door
6	079250-02-000	EA	Trim - Door Frame - Rear - Beige - Passenger Door
7	045017-06-000	EA	Paddle Asm. - Door Lock - Drivers
7	045017-08-000	EA	Paddle Asm. - Door Lock - Exterior - Passenger
	045017-05-700	EA	Lock Cylinder w/Keys - Lynor
	041250-01-000	EA	Switch - Push Button - Door On/Off
	063731-01-000	EA	Cap
	039979-02-000	EA	Inside Plate - Door Lock - w/Inside Handle
	039540-02-000	EA	Latch Claw - Entry Door Lock
	039738-01-000	EA	Deadbolt - Entrance Door Lock
	039539-01-000	EA	Strike Bolt - Entrance Door (Jamb Mount)
	063124-02-000	EA	Plate - Striker - 8 1/4" x 1" - Black
	078135-04-000	EA	Jamb - Driver Door - Front - Beige
	079249-01-000	EA	Jamb - Driver Door - Rear - Beige
	078135-03-000	EA	Jamb - Passenger Door - Front - Beige
	079249-02-000	EA	Jamb - Passenger Door - Rear - Beige
	064199-04-000	EA	Trim - Door Jamb - Rear - w/Drip Cap - Beige
	064184-01-000	EA	Drip Cap - Driver Door
	063768-01-000	EA	Sill Plate
8	063993-01-000	EA	Hinge Asm. - Driver Door - Beige
	064580-01-000	EA	Check Strap - Driver Door - Seat Belt Wearing
	064219-01-000	EA	Retainer - Driver Door Check Strap
	063886-03-000	EA	Assist Handle - Beige Steel Tube (2 required per door)
	064075-01-000	EA	Bulb Seal - 145"
9	079101-02-T03	EA	Window Asm. - Driver Door - Single Slider
			Black (w/o inside frame)
9	079101-01-T03	EA	Window Asm. - Passenger Door - Single Slider - Black
			(w/o inside frame)
10	057657-04-000	EA	Glass - .19" x 28.11" x 12.25"
11	047369-01-700	EA	Latch - Window - Plastic w/Fastener
12	002188-06-000	EA	Glass - .19" x 28.11" x 12" - Stationary
13	042077-01-000	FT	Channel - Weatherstrip - Glass Run - .19" Glass
14	069640-01-000	FT	Ribbon Sealer - 5/16 Bead
15	041928-02-000	FT	Seal - Window Channel - Black
16	050216-02-000	FT	Spline - Glass - Black
17	M69886-03-003	EA	Outside Mullion - 23.19 - Black
	002288-01-000	FT	Weatherstrip - Glass Seal
18	058652-07-000	EA	Inside Mullion - Slider Window - Black
	079214-01-000	EA	Inside Frame - Window - Beige
	055164-05-000	EA	Screen Asm. - Slider
	002292-02-000	SF	Screen - Window - 16" - Charcoal
	002298-02-000	FT	Spline - Charcoal - Screen - .130" Dia.
	016310-03-000	EA	Screen Handle - Black
	043485-02-000	FT	Screen Seal - Extr. Vinyl
	063977-03-000	EA	Step Asm. - Single - Door
			Not illustrated

1985 WINNEBAGO
TABLE OF CONTENTS

WC/WF421RB	A-01 - C-06
WC424RC	C-07 - E-16
WCN26RH	E-17 - G-22
WCN26RB	G-23 - J-04

1985 WCN26RB INDEX

Floor Plan	G-23 - G-24
Accessories Group	H-01 - H-03
Bath Group	H-04
Chassis Group	H-05
Curtain, Cushion & Pad Group	H-06 - H-12
Dinette Group	H-13 - H-16
Driver's Compartment Group	H-17 - H-19
Electrical Group	H-20 - H-22
Exterior Body Group	H-23 - I-05
Galley Group	I-06 - I-08
Heating & Air Conditioning Group	I-09 - I-10
Interior Finish Group	I-11 - I-12
LP Group	I-13
Lounge Group	I-14
Water & Sewage Group	I-15 - I-16
Window, Vent & Exterior Door Group	I-17 - J-04

ENTRANCE & SCREEN DOOR

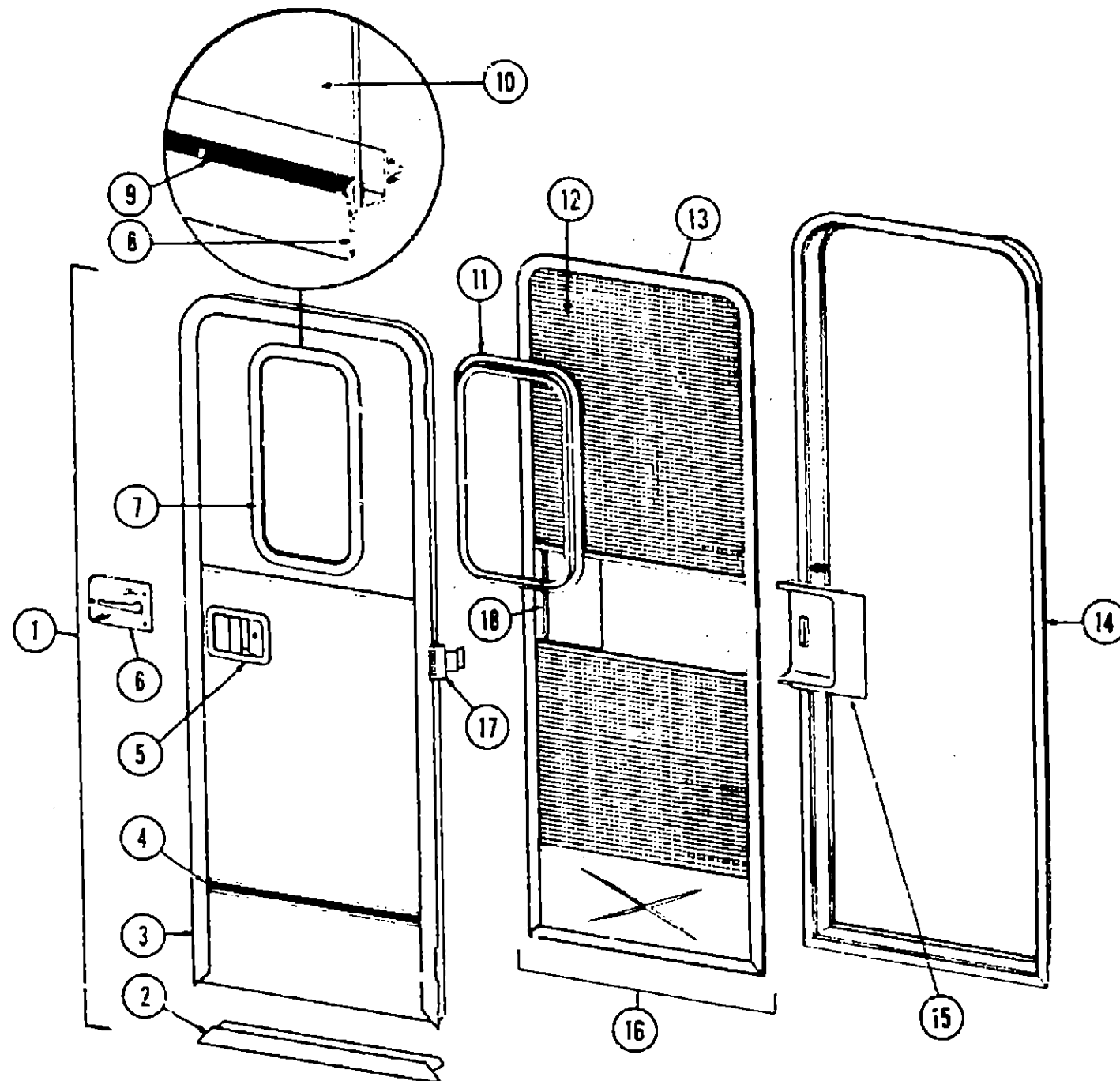

Key	Part Number	U/M	Description
1	M01870-01-T03	EA	Door Asm. - Radius Entry w/Screen Door
2	077998-02-000	EA	Frame - Entry Door (Bottom Portion Only)
3	076863-02-000	EA	Frame - Entry Door (Except Bottom Portion) Fiberglass
4	059576-02-000	EA	Feature Strip - Beige - 14"
5	001030-02-004	EA	Insert - Feature Strip - Off White - 17"
6	009731-01-000	EA	End Cap - Feature Strip
7	045017-05-000	EA	Paddle Asm. - Door Lock - Exterior
8	045017-05-700	EA	Lock Cylinder w/Keys - Lynor
9	039539-01-000	EA	Striker Bolt - Entry Door
10	039540-01-000	EA	Latch Claw - Entry Door
11	078448-01-000	EA	Dead Bolt - Entry Door
12	039979-01-000	EA	Plate - Lock - Inside - Including Inside Handle
13	052186-01-000	EA	Lock Asm. - Complete - Lynor
14	079733-04-T03	EA	Window Asm. - Picture - 17" x 25" - Black (w/o inside frame)
15	069640-01-000	FT	Ribbon Sealer - 5/16 Bead
16	002309-02-000	FT	Spline - Glass - 1/8" Black
17	002181-06-000	EA	Glass - Picture Window - .125" x 16.25" x 24" - Gray
18	067609-03-000	EA	Inside Frame - Window - 17" x 25" - Beige (not included in assembly)
12	002293-02-000	SF	Screen - Window - 26" - Charcoal
13	056795-01-000	FT	Seal Tape - 1/8" x 3/8" - Press On
14	078591-01-000	EA	Jamb Asm. - Entrance Door
15	051049-01-000	EA	Jamb - Entrance Door - Bottom
16	015550-02-000	EA	Slider - Screen Door - Light Oak Plastic
17	079012-01-T03	EA	Door Asm. - Screen
18	079361-02-000	EA	Hinge - Entry Door (3 used per door)
19	015581-02-000	EA	Cap - Screen Door - Light Oak Plastic
20	009016-01-000	EA	Catch - Elbow - Spring Loaded - Screen Door
21	039863-01-000	EA	Catch Asm. - Single Roller w/Strike - Screen Door
22	076231-01-000	EA	Spacer - Latch - Screen Door
23	077437-01-000	EA	Strike - Roller Catch
24	044582-02-000	EA	Drip Cap - Beige
25	079278-01-000	EA	Seal - Mocket - Entrance Door
26	073090-01-000	EA	Seal - Entrance Door
27	075739-02-000	EA	Stiffener - Entrance Door - Beige
28	075673-01-000	FT	Seal - Pile - Adhesive Back
29	075671-01-000	FT	Seal - Sponge - Lazy "T" Shaped
30	002294-01-000	FT	Spline - Black - .135" x .138 (Screen Door)
31	063538-01-000	EA	Strike - Screen Door
32	063729-04-000	EA	Rivnut - 10 - 32 UNF - .010 x .080
33	075639-01-000	EA	Garnish - Radius - Entrance Door
34			Not illustrated

1985 WINNEBAGO
TABLE OF CONTENTS

WC/WF421RB	A-01 - C-06
WC424RC	C-07 - E-16
WCN26RH	E-17 - G-22
WCN26RB	G-23 - J-04

1985 WCN26RB INDEX

Floor Plan	G-23 - G-24
Accessories Group	H-01 - H-03
Bath Group	H-04
Chassis Group	H-05
Curtain, Cushion & Pad Group	H-06 - H-12
Dinette Group	H-13 - H-16
Driver's Compartment Group	H-17 - H-19
Electrical Group	H-20 - H-22
Exterior Body Group	H-23 - I-05
Galley Group	I-06 - I-08
Heating & Air Conditioning Group	I-09 - I-10
Interior Finish Group	I-11 - I-12
! P Group	I-13
Lounge Group	I-14
Water & Sewage Group	I-15 - I-16
Window, Vent & Exterior Door Group	I-17 - J-04