

# 1983 WCF26RB

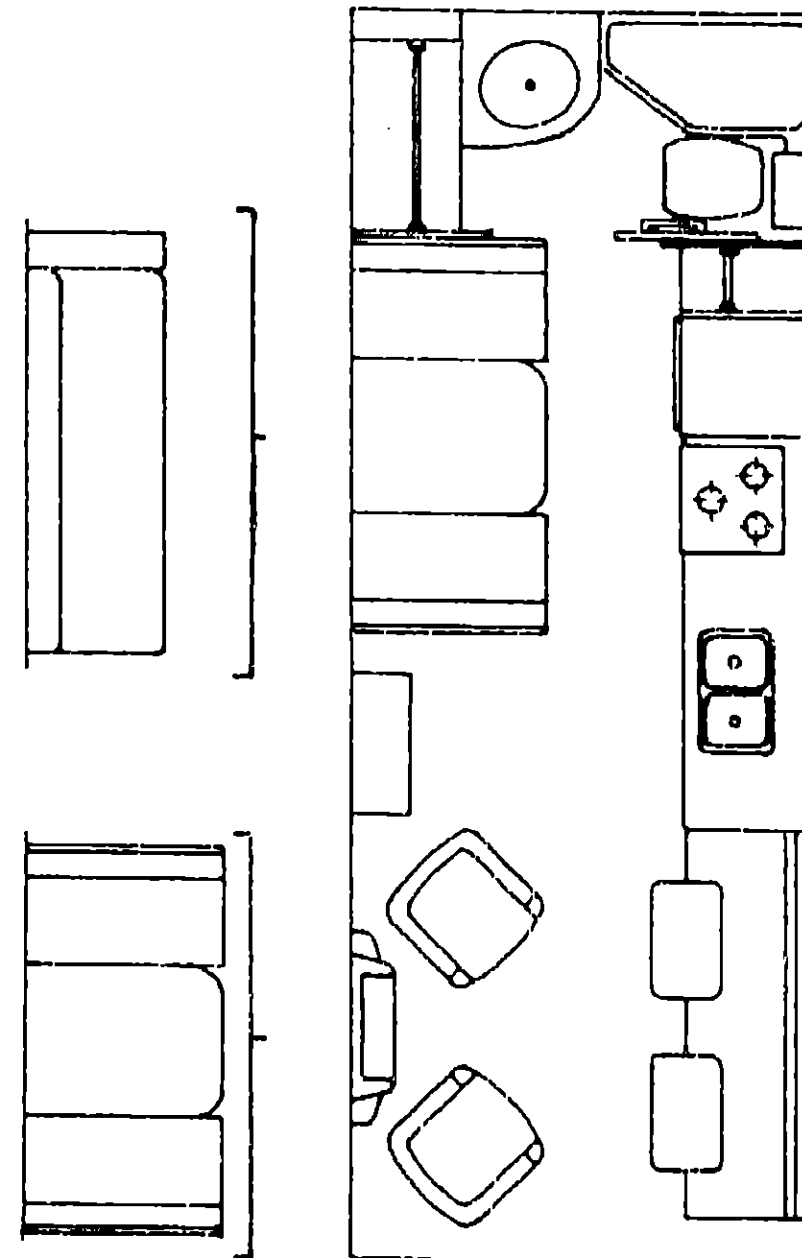

## 1983 WINNEBAGO TABLE OF CONTENTS

WC420RG	A-1 - B-22
WC424RB	B-23 - E-4
WCF26RH	E-5 - G-8
WCF26RB	G-9 - I-14

## 1983 WCF26RB INDEX

Floor Plan	G-9 - G-10
Accessories Group	G-11 - G-13
Bath Group	G-14 - G-15
Chassis Group	G-16 - G-17
Curtain, Cushion & Pad Group	G-18 - G-24
Dinette Group	H-1 - H-4
Driver's Compartment Group	H-5 - H-7
Electrical Group	H-8 - H-10
Exterior Body Group	H-11 - H-15
Galley Group	H-16 - H-17
Heating & Air Conditioning Group	H-18 - H-19
Interior Finish Group	H-20 - H-22
LP Group	H-23
Lounge Group	H-24
Water & Sewage Group	I-1 - I-2
Window, Vent & Exterior Door Group	I-3 - I-14

## ACCESSORIES GROUP

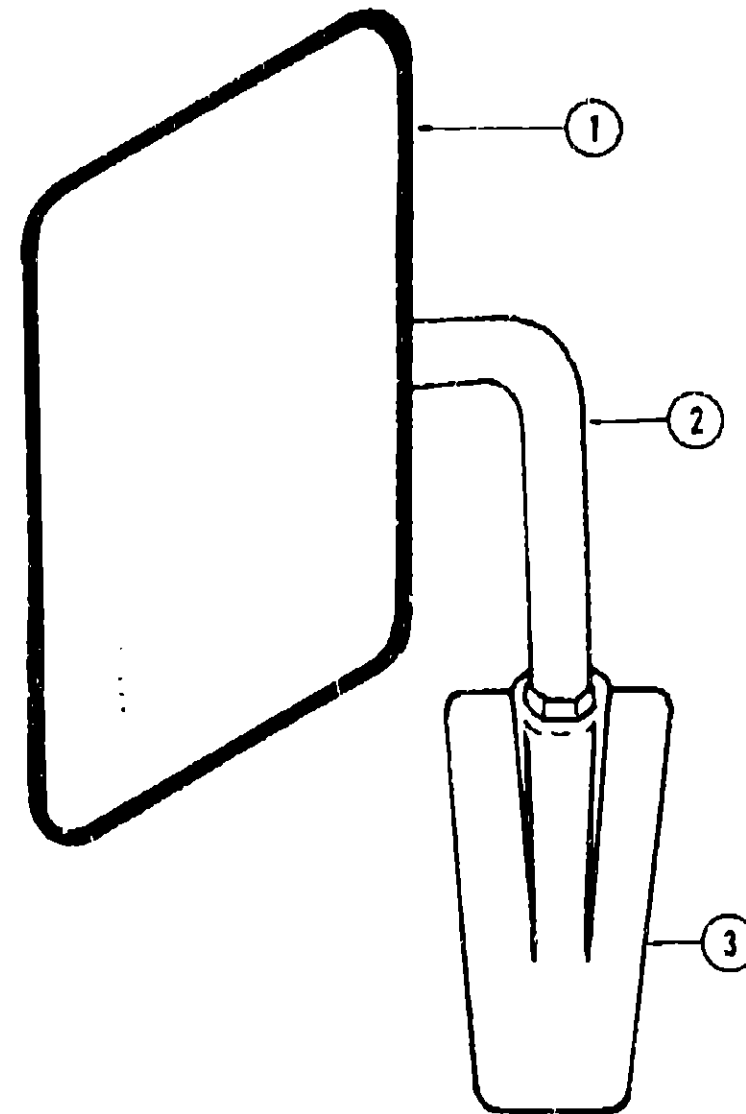

EXTERIOR MIRRORS

Key	Part Number	U/M	Description
1	049347-02-000	EA	Mirror Head - 7 1/2" x 10 1/2" - Off White
2	049348-03-000	EA	Arm - Low Mount Mirror - Black
3	049944-04-000	EA	Bracket - Mirror - Outside - Black
.	065116-01-000	EA	Mirror - West Coast - Double Mirror - Right
.	065116-02-000	EA	Mirror - West Coast - Double Mirror - Left
.	006043-01-000	EA	Mirror - Convex - Adhesive Back
.	Not illustrated		

## ACCESSORIES GROUP (CONTINUED)

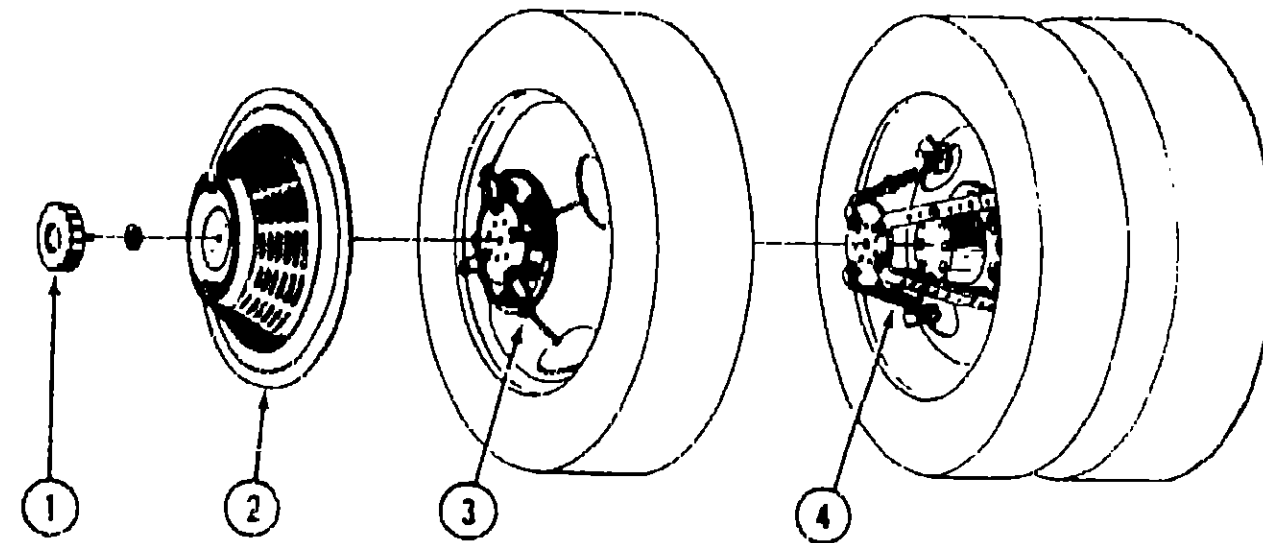

WHEEL COVER AND MOUNTING HARDWARE

Key	Part Number	U/M	Description
1	064082-02-000	EA	Retaining Nut - Delmet - Wheel Cover
2	073426-01-700	EA	Wheel Cover - Bolt On - 16" or 16.5" - Delmet (1)
3	073426-04-700	EA	Retention Bracket Asm. - Wheel Cover Support - Heavy Duty - Front (1)
4	073426-04-701	EA	Retention Bracket Asm. - Wheel Cover Support - Heavy Duty - Rear (1)
.	073426-04-000	EA	Retention Bracket Asm. - Wheel Cover Support - Heavy Duty (Set/4)
..	031396-04-000	EA	Wheel Cover - 16" - Clip On
.	Not illustrated		
..	The illustrated parts breakdown for this item is provided on the Common Items Fiche.		

RADIO AND RELATED COMPONENTS

Key	Part Number	U/M	Description
	031105-01-000	EA	Antenna - Radio - Side Mount
	031105-01-700	EA	Holder - Antenna - Radio - Upper
	064791-01-000	EA	Speaker - Recessed - 5 1/4"
	064792-01-000	EA	Grille - Speaker - 5 1/4" - w/Mesh - Brown
	074979-01-000	EA	Speaker Cover Protector - Plastic
	064787-01-000	EA	Radio - AM/FM MPX - w/Cassette
	064794-01-000	EA	Trim Plate - Radio
	068002-01-000	EA	Mounting Plate - Radio
	073432-01-000	EA	Amplifier - Radio - 4 x 15 Watts
	073433-01-000	EA	Adaptor - Radio to Amplifier

GENERATORS AND COMPONENTS

Key	Part Number	U/M	Description
..	054429-01-000	EA	Generator - Onan - 4.0 kw
	701629-02-000	EA	Onan Installation Package
	024732-01-000	EA	Tailpipe - 1.5" O.D. x 23"
	067753-01-000	EA	Muffler - Generator - w/Spark Arrestor - Nelson
	740313-56-000	EA	Tray - Generator - 4.0 kw - Onan
..	068046-01-000	EA	Conversion Kit - LP - Onan Generator
..	The illustrated parts breakdown for this item is provided on the Common Items Fiche.		

## 1983 WINNEBAGO TABLE OF CONTENTS

WC420RG  
WC424RB  
WCF26RH  
WCF26RB

A-1 - B-22  
B-23 - E-4  
E-5 - G-8  
G-9 - I-14

## 1983 WCF26RB INDEX

Floor Plan	G-9 - G-10
Accessories Group	G-11 - G-13
Bath Group	G-14 - G-15
Chassis Group	G-16 - G-17
Curtain, Cushion & Pad Group	G-18 - G-24
Dinette Group	H-1 - H-4
Driver's Compartment Group	H-5 - H-7
Electrical Group	H-8 - H-10
Exterior Body Group	H-11 - H-15
Galley Group	H-16 - H-17
Heating & Air Conditioning Group	H-18 - H-19
Interior Finish Group	H-20 - H-22
LP Group	H-23
Lounge Group	H-24
Water & Sewage Group	I-1 - I-2
Window, Vent & Exterior Door Group	I-3 - I-14

ACCESSORIES GROUP (CONTINUED)

MISCELLANEOUS ACCESSORIES

Key	Part Number	U/M	Description
	054185-19-000	EA	Owners Manual - 1983 - Itasca & Winnebago
	006053-01-000	EA	Antenna - TV Braund Delux
	006050-01-000	EA	Jack - TV - Ivory (Antenna)
	017516-01-000	EA	Mud Flap - Black - 14" x 18" w/Holes
	041944-03-000	EA	Fire Extingulsher - w/Bracket - 5 BC
	052771-02-000	EA	Oven - Microwave - Magic Chef MW207
	053287-07-000	EA	Bracket Asm. - Microwave - Right
	053287-08-000	EA	Bracket Asm. - Microwave - Left
	067203-01-000	EA	Ladder Asm.
	067130-01-000	EA	Ladder Step
	076980-01-000	EA	End Cap - Ladder Step
	067125-01-000	EA	Stand Off - Rack & Ladder Asm.
	067203-02-000	EA	Luggage Rack Asm.
	064093-01-000	EA	Luggage Carrier Assembly - 14" x 30" x 60"
	039881-01-000	EA	Catch and Strike - Luggage Carrier
	072366-01-000	EA	Speed Control Package - Electric - Diesel - Dana
**	068629-01-000	EA	Speed Control Package - Electric - Dana
	072852-01-000	EA	Smoke Detector w/9 Volt BATTERY
	072373-01-000	EA	Weather Center - 7" x 7" x 2"
	006069-01-000	EA	Key Case - Leather
	007038-01-000	EA	Door Mat - 10.5" x 26" - Black Rubber
	069580-01-000	EA	Lug Wrench - 1" x 1.25" x 16.3"
	069580-02-000	EA	Leverage Bar - 22" - Lug Wrench
	063708-01-000	EA	Cover - Air Conditioning - Vinyl
	006113-01-000	EA	Jack - Hydraulic - 6 Ton - w/Handle
	072374-01-000	EA	Clock - 7" x 7" x 2"
	073322-04-000	EA	Tire Cover - Vinyl - 32"

\*\* The illustrated parts breakdown for this item is provided on the Common Items Fiche.

Key	Part Number	U/M	Description
	074637-01-P01	EA	Cabinet Asm. - Front Overhead
	058844-03-P01	EA	Bunk Board Asm. - Front Overhead - w/Off White Rails
	053773-01-000	EA	Support - Overhead Bunk - Brown - Right
	053773-02-000	EA	Support - Overhead Bunk - Brown - Left
	040071-02-000	EA	Support - Bunk - Seat Belt
	039516-03-000	EA	Catch - Bunk - Off White
	023812-29-000	EA	Rail - Bunk - 77.1" - Off White
	053774-04-000	EA	Torsion Rod - Overhead Bunk - Brown
	041322-01-000	EA	Washer - Flat - 15/32" I.D. x 2 3/8" O.D. - Seat Belt
	074212-01-P01	EA	Pad Asm. - Front Side Overhead - Right - Beige Vinyl
	074212-02-P01	EA	Pad Asm. - Front Side Overhead - Left - Beige Vinyl
	074212-01-P01	EA	Pad Asm. - Front Side Overhead - Driver Door - Beige Vinyl
	048394-01-000	YD	Tape Hook - 1" x 25 YD - Beige
	048395-01-000	YD	Tape Loop - 1" x 25 YD - Beige
	007021-01-000	EA	Seat Belt Asm. - 2" x 90" - Black

BATH GROUP

BATH CABINETRY

Key	Part Number	U/M	Description
	M65894-01-P01	EA	Cabinet Asm. - Vanity - w/o Countertop & Doors
	063224-11-P01	EA	Door Asm. - Rolled - 12.4" x 24" - Lower
	063224-12-P01	EA	Door Asm. - Rolled - 18.1" x 24" - Upper
	065897-01-P01	EA	Countertop Asm. - Vanity Cabinet - Almond
	M69933-03-P01	EA	Cabinet Asm. - Medicine - w/o Door or Hardware
	069859-02-P07	EA	Door Asm. - Medicine Cabinet w/Mirror - 16.1" x 30.1" - w/o Hardware
	072232-01-P01	EA	Pad Asm. - End - Medicine Cabinet - Beige Vinyl
	M70626-03-P01	EA	Cabinet Asm. - Linen/Hamper - w/o Door or Hardware
	069852-09-P01	EA	Door Asm. - Linen Cabinet - 52.8" x 12.7" - w/o Hardware
	M65889-01-P01	EA	Door Asm. - Sliding - 74.1" x 26" - w/o Hardware
	069852-04-P01	EA	Door Asm. - Wardrobe Cabinet - 39.6" x 12.9" - w/o Hardware
	069859-01-P01	EA	Door Asm. - Wardrobe Cabinet - 59.1" x 16.2" - w/o Hardware

BATH HARDWARE

Key	Part Number	U/M	Description
**	011056-01-000	EA	Faucet - Lavatory - US
**	011056-02-000	EA	Faucet - Lavatory - CSA
**	011057-03-000	EA	Faucet - Tub and Shower
	058640-01-000	EA	Sink - Oval - Ivory Plastic
	011083-01-000	EA	Tail Piece - 1 1/4" x 5" - Plastic w/Stopper
**	011048-02-000	EA	Shower Head - w/60" Hose
	010495-01-000	EA	Hose Clamp - 9/16"
**	066729-01-000	EA	Strainer - Shower Pan & Tub
	009134-01-000	EA	Holder - Tissue
	009133-01-000	EA	Bar - Towel Rack - 12" - Plastic
	009133-02-000	EA	Bar - Towel Rack - 18" - Plastic
	023449-01-000	EA	Support - Chrome - Towel Rack
	009151-01-000	EA	Warp Guard - 48"
	033580-01-000	EA	Towel Ring - Chrome w/Plastic Ring
	058034-02-000	EA	Latch - Bathroom Door - w/o Lock
	009156-01-000	EA	Hanger - Sliding Door
	071817-01-000	EA	Track - Sliding Door - 48"
	064467-01-000	EA	Guide - Sliding Door - Mounts on Floor
	066435-01-000	EA	Nut - Strainer - Plastic
	009112-01-000	EA	Flange - 1" Closet Rod
	057671-01-000	EA	Screw Cover (No. 8)
	058331-05-000	EA	Mirror - Tempered Glass - 12" x 26"
	057534-01-000	EA	Tie Back - 6" - Clear Plastic
	071632-01-000	EA	Hamper Bag - Fabric
	066433-01-000	EA	Hook - Screw Back - Bright Finish
	039341-02-000	EA	Toilet - Thetford - Aqua Magic - Ivory - 8420 SH
	063740-01-000	EA	Toilet - Thetford - Aqua Magic IV - Ivory

\*\* The illustrated parts breakdown for this item is provided on the Common Items Fiche.

1983 WINNEBAGO  
TABLE OF CONTENTS

WC420RG	A-1 - B-22
WC424RB	B-23 - E-4
WCF26HH	E-5 - G-8
WCF26RB	G-9 - I-14

1983 WCF26RB INDEX

Floor Plan	G-9 - G-10
Accessories Group	G-11 - G-13
Bath Group	G-14 - G-15
Chassis Group	G-16 - G-17
Curtain, Cushion & Pad Group	G-18 - G-24
Dinette Group	H-1 - H-4
Driver's Compartment Group	H-5 - H-7
Electrical Group	H-8 - H-10
Exterior Body Group	H-11 - H-15
Galley Group	H-16 - H-17
Heating & Air Conditioning Group	H-18 - H-19
Interior Finish Group	H-20 - H-22
LP Group	H-23
Lounge Group	H-24
Water & Sewage Group	I-1 - I-2
Window, Vent & Exterior Door Group	I-3 - I-14

## BATH GROUP (CONTINUED)

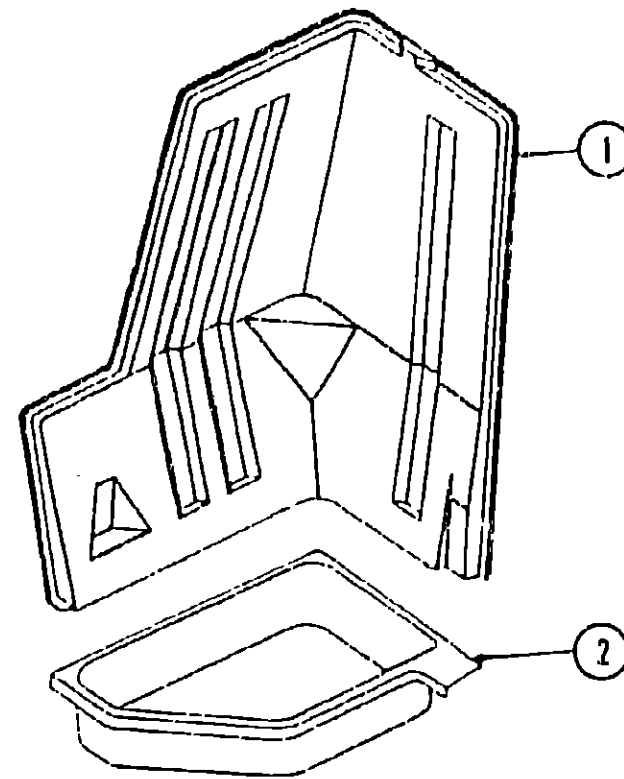

Key	Part Number	U/M	Description
1	069711-01-000	EA	Shower Stall
2	064552-02-000	EA	Shower Pan

## CHASSIS GROUP

### MISCELLANEOUS

Key	Part Number	U/M	Description
	068624-01-000	EA	Gas Fill - w/Vent
	064456-02-000	EA	Tube - Fuel Vent - .5" O.D. x 46"
	024611-04-000	EA	Cap - Gas - Pressure - 1.50" - Chrome
	024138-01-000	FT	Hose - Fuel - 5/16" I.D. SAE 30R1
	024141-01-000	FT	Hose - Rubber - 1/2" I.D.
	007134-01-000	EA	Clamp - Hose - Spring Type 9/16"
	067058-03-000	EA	Tank - 69.7 Gallon
	057039-02-000	EA	Sending Unit - Fuel - 90 Ohm (454 Engine)
	057036-05-000	EA	Sending Unit - Fuel - 90 Ohm (Diesel Engine)
	063386-01-000	EA	Strap - Fuel Tank Mounting
	063386-02-000	EA	Hanger - Fuel Tank Mounting
	064001-01-000	EA	Hose - Fuel - 2" I.D. x 90" Bend
	061411-03-000	EA	Extension - Exhaust - 2.25" O.D. x 10.5" (454 Engine)
	022655-02-000	EA	Extension - Exhaust - 2.25" O.D. x 8" (Diesel Engine)
	007111-02-000	FT	Hose - Fuel - 2" I.D. SAE 30R1 (3')
	024490-01-000	EA	Power Cord Box - Plastic
	055080-01-000	EA	Wheel Well - Plastic
	052431-01-000	EA	Tray - Luggage
	007125-05-000	EA	Clamp Asm. - Muffler - 2"
	017516-01-000	EA	Mud Flap - Black - 14" x 18" w/Holes
	051697-02-000	EA	Bracket - Battery Tie Down - 12"
	072644-01-000	EA	Battery Tray Asm.
	063739-01-000	EA	Battery - 12 Volt - Gould
	058401-01-000	EA	Hood Board - Upper - Right - Steel
	058404-01-000	EA	Hood Board - Upper - Left - Steel
	072613-01-000	EA	Filter - Radiator Cover
	071656-01-000	EA	Cover - Radiator - Rear
	071657-01-000	EA	Cover - Radiator - Rear Back (Fan Shroud)
	072850-01-000	EA	Bumper - Front - Chrome
	072850-07-000	EA	Bumper - Front - Primed
	058425-01-000	EA	Bracket - Front Bumper - Left
	058425-02-000	EA	Bracket - Front Bumper - Right
	064053-01-000	EA	Bracket - Front Bumper - Reinforcement
	058439-01-000	EA	Bracket - Front Bumper - Mounts Bumper to Frame
	064602-05-000	EA	Bumper Asm. - Rear Square - 92" - Primed
	064601-02-000	EA	Bracket - Bumper Mount
	039779-01-000	EA	Cap - Rubber - 4" x 4" - Square Bumper
	063977-03-000	EA	Step Asm. - Driver Door
	024652-01-700	EA	Step Asm. - Entry
	047441-01-000	EA	Battery Terminal - Horizontal Lug
	040546-01-000	EA	Tire - 750 x 16 - 8 Ply Poly
	064962-02-000	EA	Rim - Wheel - 16 x 6.00
	050273-02-000	EA	Tire - 750 x 16 x CA T8 - Tubeless
	072363-01-000	EA	Water Detector Probe - Fuel Line
	072364-01-000	EA	Water Detector Module - Fuel Line
	073352-01-000	EA	Bracket - License Plate - Front
	069580-01-000	EA	Lug Wrench - 1" x 1.25" x 16.3"
	069580-02-000	EA	Leverage Bar - 22" - Lug Wrench
	006113-01-000	EA	Jack - Hydraulic - 6 Ton - w/Handle
	052165-03-000	EA	Shock Cord - Rubber - 24" (Spare Tire)
	072359-01-000	EA	Bolts - Coolant Expansion
	072850-01-700	EA	Bumper Kit - Rubber - (Front)

## 1983 WINNEBAGO TABLE OF CONTENTS

WC420RG	A-1 - B-22
WC424RB	B-23 - E-4
WCF26RB	E-5 - G-8
WCF26RS	G-9 - I-14

## 1983 WCF26RB INDEX

Floor Plan	G-9 - G-10
Accessories Group	G-11 - G-13
Bath Group	G-14 - G-15
Chassis Group	G-16 - G-17
Curtain, Cushion & Pad Group	G-18 - G-24
Dinette Group	H-1 - H-4
Driver's Compartment Group	H-5 - H-7
Electrical Group	H-8 - H-10
Exterior Body Group	H-11 - H-15
Galley Group	H-16 - H-17
Heating & Air Conditioning Group	H-18 - H-19
Interior Finish Group	H-20 - H-22
LP Group	H-23
Lounge Group	H-24
Water & Sewage Group	I-1 - I-2
Window, Vent & Exterior Door Group	I-3 - I-14

## CHASSIS GROUP (CONTINUED)

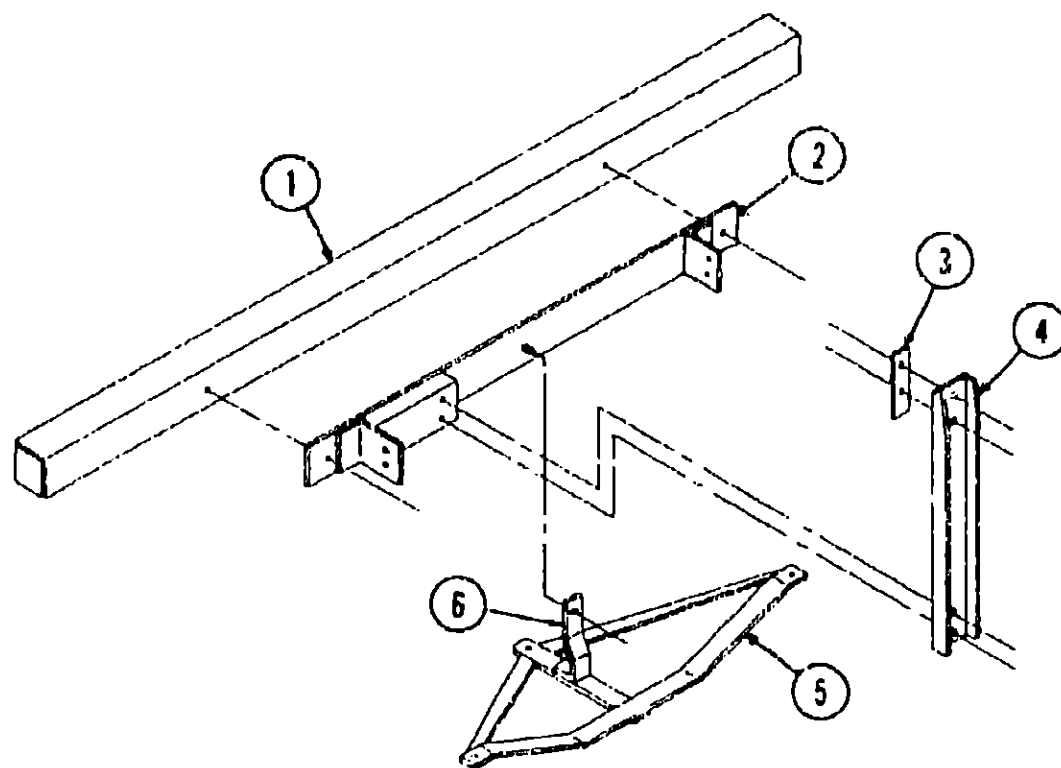

Key	Part Number	U/M	Description
1	064602-05-000	EA	Bumper Asm. - Square - 92" - Primed
2	039779-01-000	EA	Cap - Rubber - 4" x 4" - Square Bumper
3	064601-02-000	EA	Bracket - Bumper Mount
4	040974-01-000	EA	Bracket - Square Tire Retainer - 2" x 6 75"
5	064598-03-000	EA	Bracket Asm. - Spare Tire Carrier
6	064833-01-000	EA	Trailer Hitch Asm.
7	064824-02-000	EA	Support - Trailer Hitch
8	041332-02-000	EA	Reflector - 6 1/2" x 3/4" - Bumper Cover
9	041332-03-000	EA	Bumper Cover - Aluminum Fits 4" Square Bumper
10	Not illustrated		

## CURTAIN, CUSHION & PAD GROUP

### CURTAIN HARDWARE

Key	Part Number	U/M	Description
	056116-01-000	EA	Track - Curtain - Brown Plastic
	053272-04-200	EA	Track - Curtain - 89" - Off White
	059430-05-000	EA	Track - Front Wraparound (2 per unit) - 43.75" x 36" - Beige
	059430-07-000	EA	Track - Front Wraparound (Drivers Door) - 86.2" x 36" - Beige
	018031-48-000	EA	Track - Curtain - "L" Rod - Alum. Extr. - 192"
	056001-01-000	EA	Bracket - Shade - Left
	056002-01-000	EA	Bracket - Shade - Right
	056003-01-000	EA	Bracket - Drapery Retainer - Right
	056003-02-000	EA	Bracket - Drapery Retainer - Left
	056002-03-000	EA	Bracket - Drapery Retainer - Universal
	009107-01-000	EA	Guide - Nylon Snap - Curtain
	056784-01-000	EA	Pull - Window Shade - Antique Brass
	039175-01-000	EA	Curtain Rod - Extension 4" - 84"
	039175-03-000	EA	Curtain Rod - Extension 28" - 48"
	039175-04-000	EA	Curtain Rod - Extension 16" - 28"
	039175-02-000	EA	Bracket - Curtain Rod
	056115-01-000	YD	Tape - Clear Plastic - w/Guides
	048394-01-000	YD	Tape Hook - 1" x 25 YD - Beige
	048395-01-000	YD	Tape Loop - 1" x 25 YD - Beige
	009701-01-000	EA	Carrier - Curtain - "L" Rod
	009702-01-000	EA	End - Stop - Curtain - "L" Rod

## 1983 WINNEBAGO TABLE OF CONTENTS

WC420RG	A-1 - B-22
WC424RB	B-23 - E-4
WCF26RH	E-5 - G-8
WCF26RB	G-9 - I-14

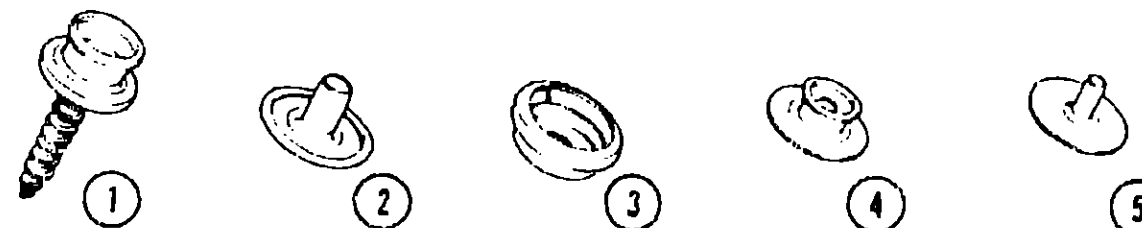

Key	Part Number	U/M	Description
1	029130-01-000	EA	Socket - Snap Fastener
2	029155-01-000	EA	Cap - Snap - .156" Dia. x .17" Barrel
3	029156-01-000	EA	Socket - Snap Fastener
4	029092-01-000	EA	Stud - Nickel Finish
5	029093-01-000	EA	Eyelet - Nickel Finish

## 1983 WCF26RB INDEX

Floor Plan	G-9 - G-10
Accessories Group	G-11 - G-13
Bath Group	G-14 - G-15
Chassis Group	G-16 - G-17
Curtain, Cushion & Pad Group	G-18 - G-24
Dinette Group	H-1 - H-4
Driver's Compartment Group	H-5 - H-7
Electrical Group	H-8 - H-10
Exterior Body Group	H-11 - H-15
Galley Group	H-16 - H-17
Heating & Air Conditioning Group	H-18 - H-19
Interior Finish Group	H-20 - H-22
LP Group	H-23
Lounge Group	H-24
Water & Sewage Group	I-1 - I-2
Window, Vent & Exterior Door Group	I-3 - I-14

## NOTICE

In order to assist our Parts Sales Dept. in providing interior software items, please include the serial number and the color code number from the vehicle certification label when ordering. This label is located on the left sidewall at the end of the dash (A-Body), or on the driver's door latch plate (C-Body).

An example of a color code number is P31, which designates an overall color scheme of a particular unit. The color listed after the item description on the microfiche, indicates the overall unit color. Order the item you desire according to unit color code.

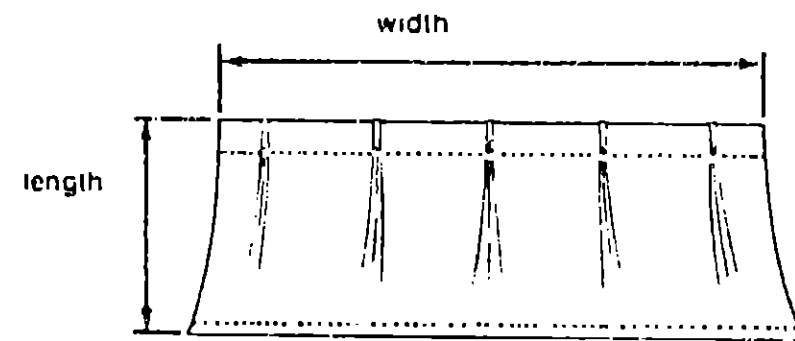

## NOTE:

Use this illustration when determining length and width measurements for curtains. You will note the width measurement is taken on the top of the curtain with the curtain fully extended. The length measurement is taken from top to bottom.

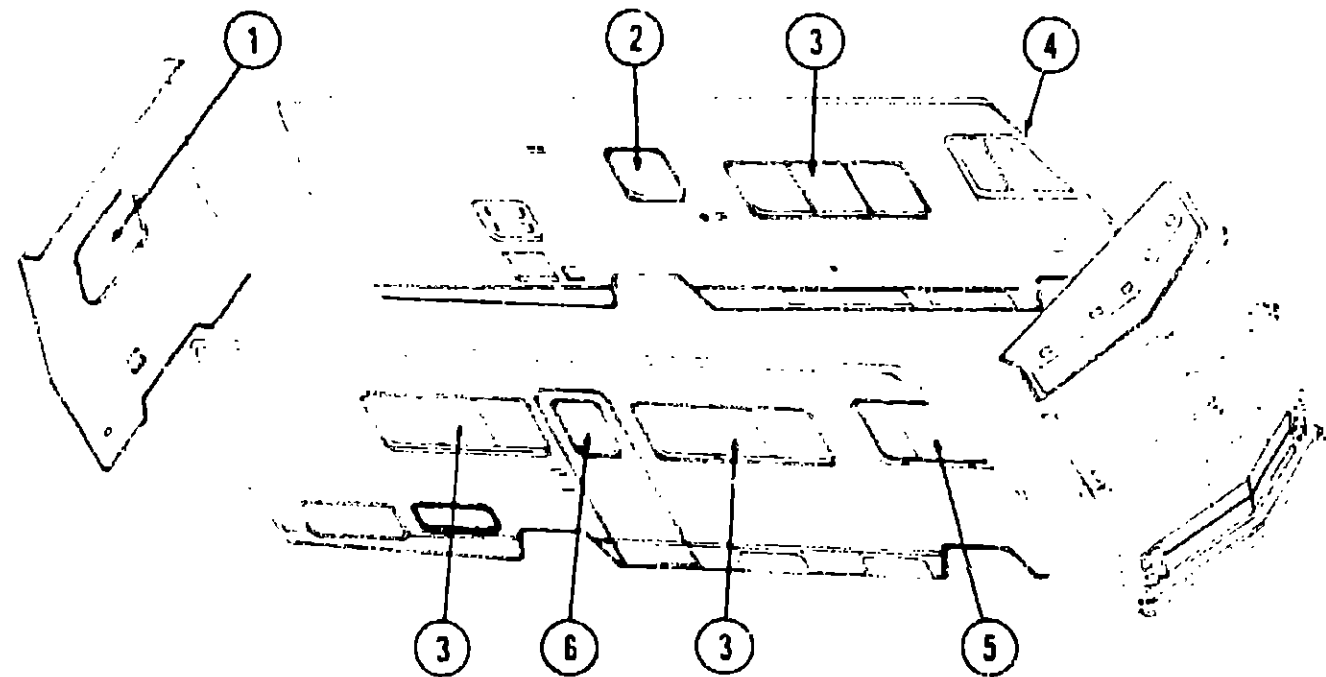

## CURTAINS, VALANCES, SHADES AND TIEBACKS

Key	Part Number	U/M	Description
1	073251-04-P01	EA	Curtain w/Tape Top - 25" x 12"
1	073227-07-P01	EA	Valance Asm. - 5" x 42" - Stapled (P31)
1	073227-07-P02	EA	Valance Asm. - 5" x 42" - Stapled (P32)
1	073227-07-P03	EA	Valance Asm. - 5" x 42" - Stapled (P33)
1	065522-06-000	EA	Shade Asm. - Vinyl - 33.25" x 38"
2	073251-05-P01	EA	Curtain w/Tape Top - 21.5" x 9"
2	073227-11-P01	EA	Valance Asm. - 5" x 38.5" - Stapled (P31)
2	073227-11-P02	EA	Valance Asm. - 5" x 38.5" - Stapled (P32)
2	073227-11-P03	EA	Valance Asm. - 5" x 38.5" - Stapled (P33)
2	065522-16-000	EA	Shade Asm. - Vinyl - 28.50" x 30"
3	073251-03-P01	EA	Curtain w/Tape Top - 28" x 24"
3	073323-02-P01	EA	Curtain w/Rod Top - Sheer - 27.5" x 66"
3	073227-01-P01	EA	Valance Asm. - 5" x 80" - Stapled (P31)
3	073227-01-P02	EA	Valance Asm. - 5" x 80" - Stapled (P32)
3	073227-01-P03	EA	Valance Asm. - 5" x 80" - Stapled (P33)
3	065522-12-000	EA	Shade Asm. - Vinyl - 69.25" x 38"
4	059900-05-P01	EA	Curtain w/Snaps - Drivers Door - 29" x 35"
5	073304-03-P01	EA	Curtain w/Snaps - Front Wraparound - w/Drivers Door - 27.5" x 125"
•	073304-07-P01	EA	Curtain w/Snaps - Front Wraparound - 27.5" x 81" (2 required)
•	073304-02-P01	EA	Curtain Asm. - w/Snap Top - Bunk Privacy - 22" x 96"
6	073304-05-P01	EA	Curtain w/Snaps - 29" x 37"
•	073304-14-P01	EA	Curtain Asm. - w/Snap Top - Privacy - 58" x 96"
•	073260-04-P01	EA	Tie Back Asm. - 3" x 14" (P31)
•	073260-04-P02	EA	Tie Back Asm. - 3" x 14" (P32)
•	073260-04-P03	EA	Tie Back Asm. - 3" x 14" (P33)
•	057534-01-000	EA	Tie Back Asm. - 6" - Clear Plastic
•	057534-03-000	EA	Tie Back Asm. - 7.5" - Clear Plastic
•	Not illustrated		

## OVERHEAD BUNK CUSHIONS

Key	Part Number	U/M	Description
	073467-03-P01	EA	Cushion - Front Overhead Bunk - 47" x 76" x 4" (P31)
	073467-03-P02	EA	Cushion - Front Overhead Bunk - 47" x 76" x 4" (P32)
	073467-03-P03	EA	Cushion - Front Overhead Bunk - 47" x 76" x 4" (P33)
	M73467-03-P01	EA	Cover - Front Bunk Cushion - 47" x 76" x 4" (P31)
	M73467-03-P02	EA	Cover - Front Bunk Cushion - 47" x 76" x 4" (P32)
	M73467-03-P03	EA	Cover - Front Bunk Cushion - 47" x 76" x 4" (P33)

1983 WINNEBAGO  
TABLE OF CONTENTS

WC420RG	A-1 - B-22
WC424RB	B-23 - E-4
WCF26RH	E-5 - G-8
WCF26RB	G-9 - I-14

## 1983 WCF26RB INDEX

Floor Plan	G-9 - G-10
Accessories Group	G-11 - G-13
Bath Group	G-14 - G-15
Chassis Group	G-16 - G-17
Curtain, Cushion & Pad Group	G-18 - G-24
Dinette Group	H-1 - H-4
Driver's Compartment Group	H-5 - H-7
Electrical Group	H-8 - H-10
Exterior Body Group	H-11 - H-15
Galley Group	H-16 - H-17
Heating & Air Conditioning Group	H-18 - H-19
Interior Finish Group	H-20 - H-22
LP Group	H-23
Lounge Group	H-24
Water & Sewage Group	I-1 - I-2
Window, Vent & Exterior Door Group	I-3 - I-14

## SPRUNG COUCH CUSHIONS

Key	Part Number	U/M	Description
1	058860-01-P01	EA	Pad Asm. - Armrest Cabinet - 31.4" x 6.2" x 3" (P31)
1	058860-01-P02	EA	Pad Asm. - Armrest Cabinet - 31.4" x 6.2" x 3" (P32)
1	058860-01-P03	EA	Pad Asm. - Armrest Cabinet - 31.4" x 6.2" x 3" (P33)
2	073630-01-P01	EA	Cushion Asm. - Sprung Couch Back - 3 Pillow (P31)
2	073630-01-P02	EA	Cushion Asm. - Sprung Couch Back - 3 Pillow (P32)
2	073630-01-P03	EA	Cushion Asm. - Sprung Couch Back - 3 Pillow (P33)
	M73630-01-P01	EA	Cover - Sprung Couch Back - 3 Pillow (P31)
	M73630-01-P02	EA	Cover - Sprung Couch Back - 3 Pillow (P32)
	M73630-01-P03	EA	Cover - Sprung Couch Back - 3 Pillow (P33)
3	073631-02-P01	EA	Cushion Asm. - Sprung Couch Bottom - 3 Pillow (P31)
3	073631-02-P02	EA	Cushion Asm. - Sprung Couch Bottom - 3 Pillow (P32)
3	073631-02-P03	EA	Cushion Asm. - Sprung Couch Bottom - 3 Pillow (P33)
	M73631-02-P01	EA	Cover - Sprung Couch Bottom - 3 Pillow (P31)
	M73631-02-P02	EA	Cover - Sprung Couch Bottom - 3 Pillow (P32)
	M73631-02-P03	EA	Cover - Sprung Couch Bottom - 3 Pillow (P33)

## DINETTE CUSHIONS

Key	Part Number	U/M	Description
4	072430-05-P01	EA	Cushion - Dinette Back - 19.2" x 38" x 5" (P31)
4	072430-05-P02	EA	Cushion - Dinette Back - 19.2" x 38" x 5" (P32)
4	072430-05-P03	EA	Cushion - Dinette Back - 19.2" x 38" x 5" (P33)
	M72430-05-P01	EA	Cover - Dinette Back Cushion - 19.2" x 38" x 5" (P31)
	M72430-05-P02	EA	Cover - Dinette Back Cushion - 19.2" x 38" x 5" (P32)
	M72430-05-P03	EA	Cover - Dinette Back Cushion - 19.2" x 38" x 5" (P33)
5	072430-06-P01	EA	Cushion - Dinette Bottom - 17.5" x 38" x 5" (P31)
5	072430-06-P02	EA	Cushion - Dinette Bottom - 17.5" x 38" x 5" (P32)
5	072430-06-P03	EA	Cushion - Dinette Bottom - 17.5" x 38" x 5" (P33)
	M72430-06-P01	EA	Cover - Dinette Bottom Cushion - 17.5" x 38" x 5" (P31)
	M72430-06-P02	EA	Cover - Dinette Bottom Cushion - 17.5" x 38" x 5" (P32)
	M72430-06-P03	EA	Cover - Dinette Bottom Cushion - 17.5" x 38" x 5" (P33)

## SWIVEL CHAIRS

Key	Part Number	U/M	Description
6	073518-01-P01	EA	Chair Asm. w/Pillow Back - Swivel (P31)
6	073518-01-P02	EA	Chair Asm. w/Pillow Back - Swivel (P32)
6	073518-01-P03	EA	Chair Asm. w/Pillow Back - Swivel (P33)
	075174-01-P01	EA	Skirt Asm. - Swivel Chair (P31)
	075174-01-P02	EA	Skirt Asm. - Swivel Chair (P32)
	075174-01-P03	EA	Skirt Asm. - Swivel Chair (P33)
	035036-01-000	EA	Plate - Tilt and Swivel - Swivel Chair
	035036-02-000	EA	Base w/Legs - Swivel Chair
	Not illustrated		

1983 WINNEBAGO  
TABLE OF CONTENTS

WC420RG	A-1 - B-22
WC424RB	B-23 - E-4
WCF26RH	E-5 - G-8
WCF26RB	G-9 - I-14

## 1983 WCF26RB INDEX

Floor Plan	G-9 - G-10
Accessories Group	G-11 - G-13
Bath Group	G-14 - G-15
Chassis Group	G-16 - G-17
Curtain, Cushion & Pad Group	G-18 - G-24
Dinette Group	H-1 - H-4
Driver's Compartment Group	H-5 - H-7
Electrical Group	H-8 - H-10
Exterior Body Group	H-11 - H-15
Galley Group	H-16 - H-17
Heating & Air Conditioning Group	H-18 - H-19
Interior Finish Group	H-20 - H-22
LP Group	H-23
Lounge Group	H-24
Water & Sewage Group	I-1 - I-2
Window, Vent & Exterior Door Group	I-3 - I-14

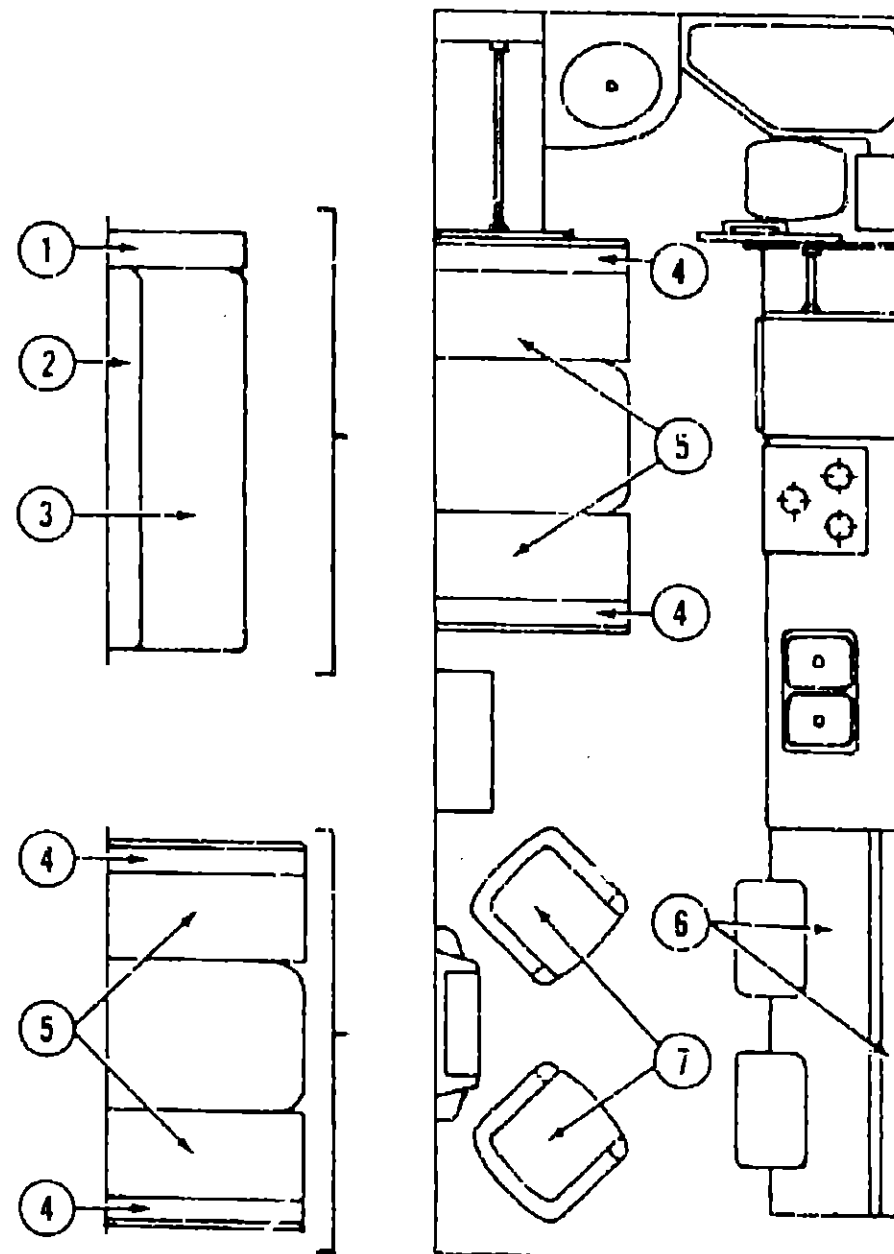

## CURTAIN, CUSHION &amp; PAD GROUP (CONTINUED)

## FABRICS, TRIMS AND PADS

Key	Part Number	U/M	Description
	072333-05-000	YD	Fabric - Drapery (Front Wraparound Ect.)
	072333-02-000	YD	Fabric - Drapery - Sheers
	072334-31-000	YD	Fabric - Drapery/Accent (P01, P31)
	072334-24-000	YD	Fabric - Drapery/Accent (P02, P32)
	072334-26-000	YD	Fabric - Drapery/Accent (P03, P33)
	072334-25-000	YD	Fabric - Upholstery/Accent (P01)
	072334-28-000	YD	Fabric w/Pattern - Upholstery (P01, P31)
	072334-27-000	YD	Fabric w/Pattern - Upholstery (P02, P32)
	072334-29-000	YD	Fabric w/Pattern - Upholstery (P03, P33)
	038421-01-000	YD	Fabric - Mattress Ticking
	072872-01-000	YD	Trim - Drapery
	052859-01-N01	FT	Trim Asm. - Accent
	070502-01-000	YD	Vinyl - Non-Expanded - 12 Gauge Film
	057093-01-N07	EA	Button Asm. - Covered #60 - Nail - Vinyl
	071127-03-P01	EA	Button Asm. - Square #65 (P31)
	071127-03-P02	EA	Button Asm. - Square #65 (P32)
	071127-03-P03	EA	Button Asm. - Square #65 (P33)
	075269-01-P01	EA	Button Asm. - Square #65 - w/3/4" Stud (P31)
	075269-01-P02	EA	Button Asm. - Square #65 - w/3/4" Stud (P32)
	075269-01-P03	EA	Button Asm. - Square #65 - w/3/4" Stud (P33)
	071846-01-P01	EA	Pad Asm. - End Cap - Dinette Overhead - Right - Vinyl
	071846-02-P01	EA	Pad Asm. - End Cap - Dinette Overhead - Left - Vinyl
	059414-03-000	EA	Pad - Sidewall Trim - Drivers - Vinyl
	059414-04-000	EA	Pad - Sidewall Trim - Passenger - Vinyl
	059467-03-N07	EA	Pad - Map Pocket - Drivers - Vinyl
	059467-04-N07	EA	Pad - Map Pocket - Passenger - Vinyl
	074212-01-P01	EA	Pad Asm. - Front Side Overhead - Right - Vinyl
	074212-02-P01	EA	Pad Asm. - Front Side Overhead - Left - Vinyl
	074212-03-P01	EA	Pad Asm. - Front Side Overhead - Left - w/Drivers Door - Vinyl
	074549-01-P31	EA	Pad Asm. - Dinette - Right
	074549-01-P32	EA	Pad Asm. - Dinette - Right
	074549-01-P33	EA	Pad Asm. - Dinette - Right
	074549-02-P31	EA	Pad Asm. - Dinette - Left
	074549-02-P32	EA	Pad Asm. - Dinette - Left
	074549-02-P33	EA	Pad Asm. - Dinette - Left

## CURTAIN, CUSHION &amp; PAD GROUP (CONTINUED)

## BUCKET SEATS

Key	Part Number	U/M	Description
	072460-04-P01	EA	Seat Asm. - Single Bucket - Mid Range - w/Armrests (P31)
	072460-04-P02	EA	Seat Asm. - Single Bucket - Mid Range - w/Armrests (P32)
	072460-04-P03	EA	Seat Asm. - Single Bucket - Mid Range - w/Armrests (P33)
	M00784-10-P01	EA	Cover - Back - Single Bucket - Mid Range (P31)
	M00784-10-P02	EA	Cover - Back - Single Bucket - Mid Range (P32)
	M00784-10-P03	EA	Cover - Back - Single Bucket - Mid Range (P33)
	M00784-09-P01	EA	Cover - Bottom - Single Bucket - Mid Range (P31)
	M00784-09-P02	EA	Cover - Bottom - Single Bucket - Mid Range (P32)
	M00784-09-P03	EA	Cover - Bottom - Single Bucket - Mid Range (P33)
	071126-04-P01	EA	Skirt - Single Bucket (P31)
	071126-04-P02	EA	Skirt - Single Bucket (P32)
	071126-04-P03	EA	Skirt - Single Bucket (P33)
	073486-01-P01	EA	Seat Asm. - Double Bucket - Mid Range - w/Armrests (P31)
	073486-01-P02	EA	Seat Asm. - Double Bucket - Mid Range - w/Armrests (P32)
	073486-01-P03	EA	Seat Asm. - Double Bucket - Mid Range - w/Armrests (P33)
	M00784-12-P01	EA	Cover - Back - Double Bucket - Mid Range (P31)
	M00784-12-P02	EA	Cover - Back - Double Bucket - Mid Range (P32)
	M00784-12-P03	EA	Cover - Back - Double Bucket - Mid Range (P33)
	M00784-11-P01	EA	Cover - Bottom - Double Bucket - Mid Range (P31)
	M00784-11-P02	EA	Cover - Bottom - Double Bucket - Mid Range (P32)
	M00784-11-P03	EA	Cover - Bottom - Double Bucket - Mid Range (P33)
	071690-02-P01	EA	Skirt - Double Bucket (P31)
	071690-02-P02	EA	Skirt - Double Bucket (P32)
	071690-02-P03	EA	Skirt - Double Bucket (P33)
	071122-11-P01	EA	Armrest Asm. - Right (P31)
	071122-11-P02	EA	Armrest Asm. - Right (P32)
	071122-11-P03	EA	Armrest Asm. - Right (P33)
	071122-12-P01	EA	Armrest Asm. - Left (P31)
	071122-12-P02	EA	Armrest Asm. - Left (P32)
	071122-12-P03	EA	Armrest Asm. - Left (P33)
	071123-06-P01	EA	Cover - Armrest - Right or Left (P31)
	071123-06-P02	EA	Cover - Armrest - Right or Left (P32)
	071123-06-P03	EA	Cover - Armrest - Right or Left (P33)
	073619-06-P01	EA	Seat Asm. - Single Bucket - Low Back (P31)
	073619-06-P02	EA	Seat Asm. - Single Bucket - Low Back (P32)
	073619-06-P03	EA	Seat Asm. - Single Bucket - Low Back (P33)
	M00435-03-P01	EA	Cover - Back - Single Bucket - Low Back (P31)
	M00435-03-P02	EA	Cover - Back - Single Bucket - Low Back (P32)
	M00435-03-P03	EA	Cover - Back - Single Bucket - Low Back (P33)
	M00435-04-P01	EA	Cover - Bottom - Single Bucket - Low Back (P31)
	M00435-04-P02	EA	Cover - Bottom - Single Bucket - Low Back (P32)
	M00435-04-P03	EA	Cover - Bottom - Single Bucket - Low Back (P33)

1983 WINNEBAGO  
TABLE OF CONTENTS

WC420RG	A-1 - B-22
WC424RB	B-23 - E-4
WCF26RH	E-5 - G-8
WCF26RB	G-9 - I-14

## 1983 WCF26RB INDEX

Floor Plan	G-9 - G-10
Accessories Group	G-11 - G-13
Bath Group	G-14 - G-15
Chassis Group	G-16 - G-17
Curtain, Cushion & Pad Group	G-18 - G-24
Dinette Group	H-1 - H-4
Driver's Compartment Group	H-5 - H-7
Electrical Group	H-8 - H-10
Exterior Body Group	H-11 - H-15
Galley Group	H-16 - H-17
Heating & Air Conditioning Group	H-18 - H-19
Interior Finish Group	H-20 - H-22
LP Group	H-23
Lounge Group	H-24
Water & Sewage Group	I-1 - I-2
Window, Vent & Exterior Door Group	I-3 - I-14



## DINETTE GROUP

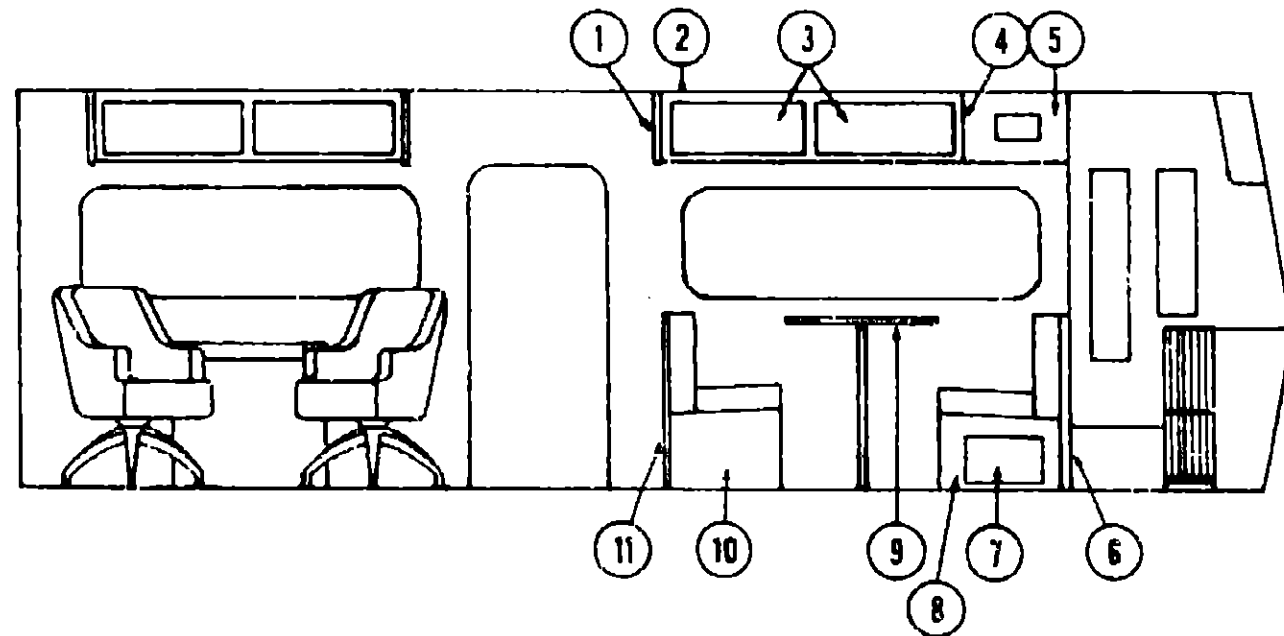

### CONVENTIONAL DINETTE AND OVERHEAD CABINETRY

Key	Part Number	U/M	Description
1	071846-02-P01	EA	Pad - End - Dinette Overhead Cabinet - Left - Beige Vinyl
2	074977-02-P01	EA	Cabinet Asm. - Dinette Overhead - w/o Doors or Hardware
3	069852-05-P01	EA	Door Asm. - Dinette Overhead Cabinet - 11.5" x 28.2" - w/o Hardware
4	071846-01-P01	EA	Pad - End - Dinette Overhead Cabinet - Right - Beige Vinyl
5	071846-08-P01	EA	Panel - End - Dinette Overhead Cabinet - Right
6	069863-01-P01	EA	Pad Asm. - Wemac Overhead - Beige Vinyl
7	M01108-01-P01	EA	Cabinet Asm. - Dinette Back - Right
8	069652-62-P01	EA	Door Asm. - Dinette Cabinet
9	M01107-01-P01	EA	Cabinet Asm. - Dinette Seat - Right
10	053191-07-P01	EA	Table Asm. - Dinette - w/o Hardware - Almond
11	M01107-02-P01	EA	Cabinet Asm. - Dinette Seat - Left
..	053200-05-000	EA	Bracket - Upper Wall Mount - 23.5" - Beige
..	074491-02-R10	EA	Magazine Rack - Oak
..	053201-03-000	EA	Bracket - Table Mount - 23" - Anod.
..	024275-05-000	EA	Rod - Table Lift - 8" x 23.5" - Beige
..	024281-07-000	EA	Bracket - Lower Wall Mount - Beige - 22.12"
..	024276-08-000	EA	Leg Asm. - Table - Beige - 29.5"
..	064050-01-000	EA	Hinge - Table Leg
..	024282-01-000	EA	Brace - Table Leg
..	024283-01-000	EA	Clip - 1" O.D. Tube
..	049493-03-000	EA	Catch - Table Leg - Mounts on Floor - Beige
..	Not illustrated		
..	The illustrated parts breakdown for this item is provided on the Common Items Fiche.		

## DINETTE GROUP (CONTINUED)

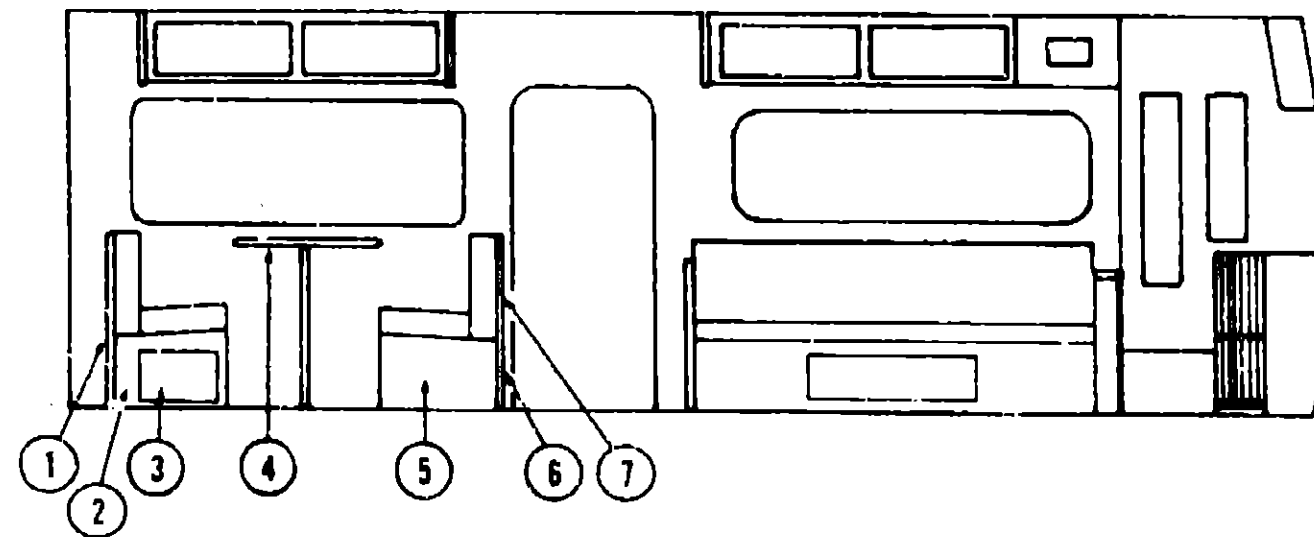

### DINETTE CABINETRY (FRONT OPTION)

Key	Part Number	U/M	Description
1	M01106-02-P01	EA	Cabinet Asm. - Dinette Back - Left
2	M01105-02-P01	EA	Cabinet Asm. - Dinette Seat - Left
3	069852-62-P01	EA	Door Asm. - Dinette Cabinet
4	M75195-01-P01	EA	Table Asm. - Dinette - w/o Hardware - Almond
5	M01105-01-P01	EA	Cabinet Asm. - Dinette Seat - Right - w/o Door or Hardware
6	069852-22-P01	EA	Door Asm. - Dinette Seat - 25.2" x 10.5" - w/o Hardware
7	M01106-01-P01	EA	Cabinet Asm. - Dinette Back - Right - w/o Door or Hardware
..	053200-05-000	EA	Bracket - Upper Wall Mount - 23.5" - Beige
..	053201-03-000	EA	Bracket - Table Mount - 23" - Anod.
..	024275-05-000	EA	Rod - Table Lift - 8" x 23.5" - Beige
..	024281-07-000	EA	Bracket - Lower Wall Mount - Beige - 22.12"
..	024276-08-000	EA	Leg Asm. - Table - Beige - 29.5"
..	064050-01-000	EA	Hinge - Table Leg
..	024282-01-000	EA	Brace - Table Leg
..	024283-01-000	EA	Clip - 1" O.D. Tube
..	049493-03-000	EA	Catch - Table Leg - Mounts on Floor - Beige
..	Not illustrated		
..	The illustrated parts breakdown for this item is provided on the Common Items Fiche.		

## 1983 WINNEBAGO TABLE OF CONTENTS

WC420RG  
WC424RB  
WCF26RH  
WCF26RB

A-1 - B-22  
B-23 - E-4  
E-5 - G-8  
G-9 - I-14

## 1983 WCF26RB INDEX

Floor Plan	G-9 - G-10
Accessories Group	G-11 - G-13
Bath Group	G-14 - G-15
Chassis Group	G-16 - G-17
Curtain, Cushion & Pad Group	G-18 - G-24
Dinette Group	H-1 - H-4
Driver's Compartment Group	H-5 - H-7
Electrical Group	H-8 - H-10
Exterior Body Group	H-11 - H-15
Galley Group	H-16 - H-17
Heating & Air Conditioning Group	H-18 - H-19
Interior Finish Group	H-20 - H-22
LP Group	H-23
Lounge Group	H-24
Water & Sewage Group	I-1 - I-2
Window, Vent & Exterior Door Group	I-3 - I-14

DINETTE GROUP (CONTINUED)

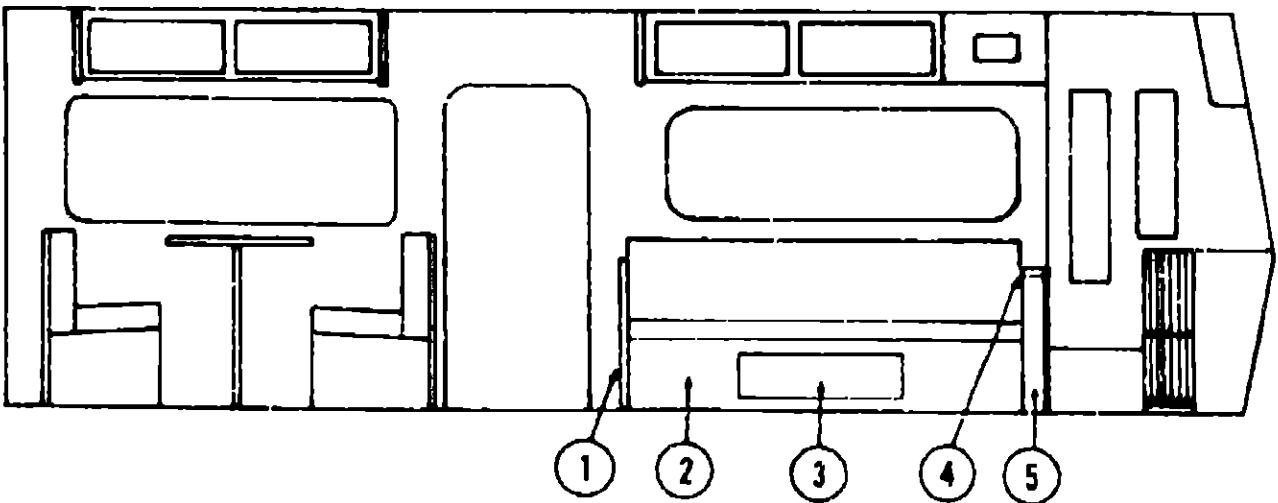

SPRUNG COUCH (REAR OPTION)

Key	Part Number	U/M	Description
1	057618-04-P01	EA	End Panel - Sprung Couch - Left
2	M70633-03-P01	EA	Front Panel Asm. - Sprung Couch - w/o Door or Hardware
3	069852-53-P01	EA	Door Asm. - Couch Cabinet - 37.2" x 12" - w/o Hardware
4	058860-01-P01	EA	Pad Asm. - Armrest Cabinet - 31.4" x 6.2" x 3" (P31)
4	058860-01-P02	EA	Pad Asm. - Armrest Cabinet - 31.4" x 6.2" x 3" (P32)
4	058860-01-P03	EA	Pad Asm. - Armrest Cabinet - 31.4" x 6.2" x 3" (P33)
5	070625-01-P01	EA	Cabinet Asm. - Armrest - w/o Pad
•	057468-02-000	EA	Base Asm. - Sprung Couch - Right
•	057468-03-000	EA	Base Asm. - Sprung Couch - Left
•	057468-04-000	EA	Base Asm. - Spacers - Sprung Couch - 2 per Couch
•	057469-01-000	EA	Leg Asm. - Sprung Couch - 2 per Couch
•	Not illustrated		

DINETTE GROUP (CONTINUED)

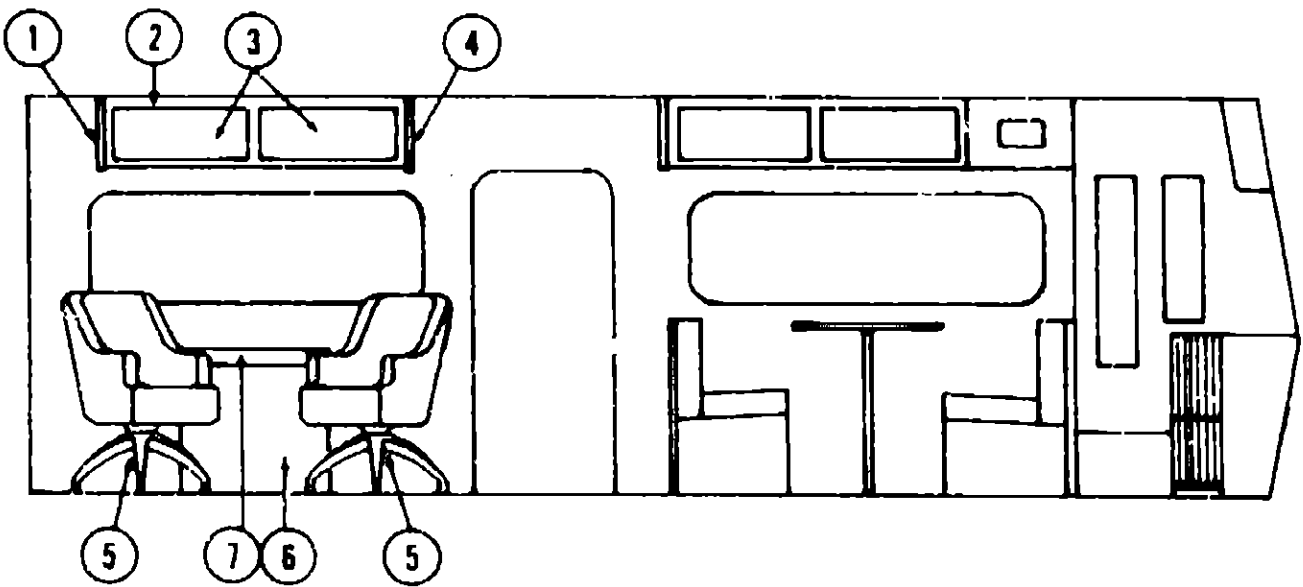

SWIVEL CHAIRS W/FOLD OUT TABLE AND OVERHEAD CABINERY

Key	Part Number	U/M	Description
1	071846-02-P01	EA	Pad - End - Dinette Overhead Cabinet - Left - Beige Vinyl
2	074977-01-P01	EA	Cabinet Asm. - Dinette Overhead - w/o Doors or Hardware
3	069852-05-P01	EA	Door Asm. - Dinette Overhead Cabinet - 11.5" x 28.2" - w/o Hardware
4	071846-01-P01	EA	Pad - End - Dinette Overhead Cabinet - Right - Beige Vinyl
5	035036-02-000	EA	Base - w/Leg - Swivel Chair
•	035036-01-000	EA	Plate - Till and Swivel - Swivel Chair
6	M00675-35-P01	EA	Table Asm. - Foldout - Almond
7	M01133-46-P01	EA	Countertop Asm. - Fold Out Table - Almond
•	024276-11-000	EA	Leg Asm. - Table - Beige - 25.18"
••	064050-01-000	EA	Hinge - Table Leg
••	024282-01-000	EA	Brace - Table Leg
••	024283-01-000	EA	Clip - 1" O.D. Tube
•	049493-03-000	EA	Catch - Table Leg - Mounts on Floor - Beige
•	048394-01-000	YD	Tape Hook - 1" x 25 YD - Beige
•	048395-01-000	YD	Tape Loop - 1" x 25 YD - Beige
•	035036-01-000	EA	Plate - Swivel Chair
•	035036-02-000	EA	Base - w/Leg - Swivel Chair
•	063224-26-P01	EA	Door Asm. - Rolled - 26.10" x 9.50"
•	074489-02-R10	EA	Beverage Tray Holder - Oak
•	Not illustrated		
••	The illustrated parts breakdown for this item is provided on the Common Items Fiche.		

1983 WINNEBAGO  
TABLE OF CONTENTS

WC420RG  
WC424RB  
WCF26RH  
WCF26RB

A-1 - B-22  
B-23 - E-4  
E-5 - G-8  
G-9 - I-14

1983 WCF26RB INDEX

Floor Plan	G-9 - G-10
Accessories Group	G-11 - G-13
Bath Group	G-14 - G-15
Chassis Group	G-16 - G-17
Curtain, Cushion & Pad Group	G-18 - G-24
Dinette Group	H-1 - H-4
Driver's Compartment Group	H-5 - H-7
Electrical Group	H-8 - H-10
Exterior Body Group	H-11 - H-15
Galley Group	H-16 - H-17
Heating & Air Conditioning Group	H-18 - H-19
Interior Finish Group	H-20 - H-22
LP Group	H-23
Lounge Group	H-24
Water & Sewage Group	I-1 - I-2
Window, Vent & Exterior Door Group	I-3 - I-14

## DRIVER'S COMPARTMENT GROUP

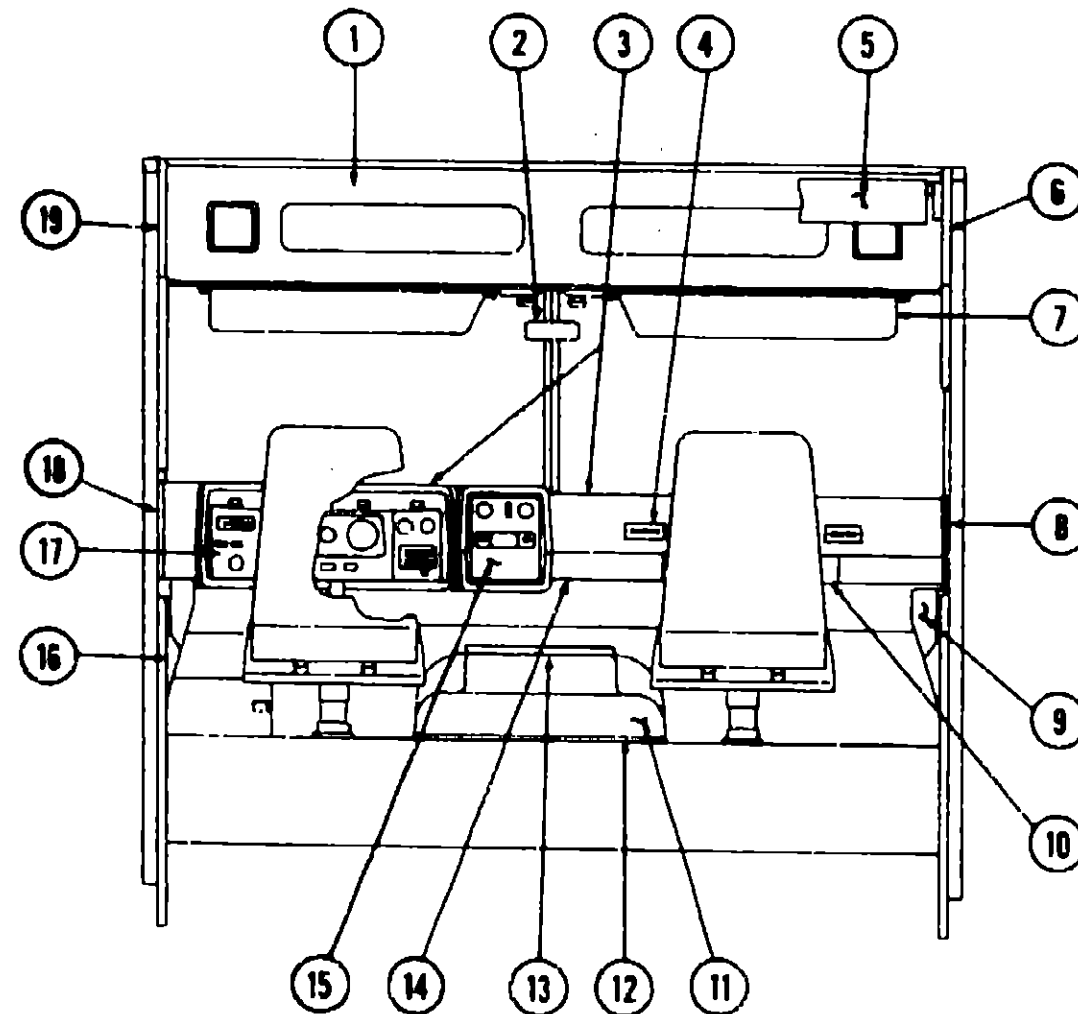

### MISCELLANEOUS DRIVER'S COMPARTMENT COMPONENTS

Key	Part Number	U/M	Description
1	074637-01-P01	EA	Cabinet Asm. - Front Overhead
2	040714-01-000	EA	Mirror - Inside - Rear View - Glare Proof
3	067490-01-000	EA	Button - Mirror - Rear View - Support
4	022548-04-000	EA	Dash Asm. - Complete - w/Gauges and Switches (w/o Clock)
5	023242-06-000	EA	Pad - Dash - Right - Dark Brown
6	024990-02-000	EA	Pad - Dash - Left - Dark Brown
7	039044-01-000	EA	Outlet - Defroster w/Swivel - 2" Dark Brown
8	053320-07-P01	EA	Louver Asm. - A/C Adjustable
9	074211-12-P01	EA	Bunk Board Asm. - Front Overhead - w/Off White Rails
10	075580-01-P01	EA	Pad Asm. - Front Side Overhead - Right - Beige Vinyl
11	040695-02-000	EA	Sunvisor Asm. - Right & Left - Almond Vinyl - w/o Mirror
12	074012-01-000	EA	Clip - Sunvisor
13	061350-03-000	EA	Clip - Sunvisor - Square - Pinch On
14	061350-04-000	EA	Windshield Trim - Interior - "A" Post - Light Oak Plastic - Right
15	059414-04-000	EA	Windshield Trim - Interior - "A" Post - Light Oak Plastic - Left
16	072811-01-000	EA	Pad - Sidewall Trim - Passenger - Beige Vinyl
17	059467-04-N07	EA	Panel - Side - Passenger - Light Oak Plastic
18	022219-01-000	EA	Pad - Map Pocket - Passenger - Beige Vinyl
19	023892-01-000	EA	Glove Compartment Door
20	009118-01-000	EA	Glove Compartment Box - Black Fiberboard
21	024598-01-000	EA	Glove Compartment Twist Lock
22	034309-01-000	EA	Glove Compartment Hinge - 1 1/16" x 19"
23	067213-03-000	EA	Glove Compartment Chain - Door
24		EA	Motor Cover - Fiberglass

## DRIVER'S COMPARTMENT GROUP (CONTINUED)

### MISCELLANEOUS DRIVER'S COMPARTMENT COMPONENTS (CONT)

Key	Part Number	U/M	Description
12	035368-05-000	EA	Seal - Motor Cover - Alum. - Beige
13	039823-01-000	FT	Seal - Cover - Engine - Neoprene
14	052783-04-000	EA	Seal - Cover - Motor - Upper - Beige
15	039857-01-000	EA	Latch - Rubber - Draw Handle - 5 3/4" w/Strike
16	039856-01-000	EA	Latch - Rubber - Draw Handle - 3" w/Strike
17	042541-01-000	EA	Latch Asm. - w/Strike - Chrome
18	071714-04-000	EA	Beverage Tray Asm.
19	023834-01-000	EA	Panel - Knee Kick - Bottom of Dash
20	050345-04-000	EA	Bezel - Entertainment Center No. 3 - w/Cut Out for Clock, Hourmeter & Radio
21	067337-02-000	EA	Bezel - Entertainment Center No. 6 - w/Cut Out for Radio
22	067338-02-000	EA	Bezel - Entertainment Center No. 7 - w/Cut Out for Radio, Hourmeter and Generator Start Stop Switch
23	050345-04-000	EA	Bezel - Entertainment Center No. 3 - w/Cut Out for Radio, Clock, Hourmeter and Generator Start Stop Switch
24	007308-01-000	EA	Dash Clock
25	059198-05-000	EA	Panel - Side - Drivers - Light Oak Plastic
26	064499-02-000	EA	Panel - Drivers Door - Inner - Light Oak Plastic
27	059467-03-N07	EA	Pad - Map Pocket - Drivers - Beige Vinyl
28	050796-01-000	EA	Pocket - Ash Tray - Plastic
29	050797-01-000	EA	Ash Tray - Plastic
30	046886-01-000	EA	Ashtray Asm. - Flush Mount - Chrome
31	039847-08-000	EA	Bezel - Control Panel
32	052367-01-000	EA	Cigarette Lighter Asm. - 12 Volt
33	007041-01-000	EA	Bezel - Cigarette Lighter
34	061424-01-000	EA	Lamp Asm. - Map/Gauge
35	061400-03-000	EA	Assist Strap - 12" - Medium Almond
36	059414-03-000	EA	Pad - Sidewall Trim - Drivers - Beige Vinyl
37	074212-02-P01	EA	Pad Asm. - Front Overhead Cabinet - Left - Beige Vinyl
38	074212-03-P01	EA	Pad Asm. - Front Overhead Cabinet - Driver Door - Beige Vinyl
39	040519-01-000	EA	Boot - Rubber Steering Column
40	040520-01-000	EA	Boot Retainer - Steering Column
41	054250-01-000	EA	Support - Dimmer Switch - w/o Holes
42	024849-01-000	EA	Damper Asm. - Fresh Air
43			Not illustrated
44	Note: To be special ordered only.		

### FRONT BUNK AND HARDWARE

Key	Part Number	U/M	Description
1	074637-01-P01	EA	Cabinet Asm. - Front Overhead
2	053320-07-P01	EA	Bunk Board Asm. - Front Overhead - w/Off White Rails
3	053773-01-000	EA	Support - Overhead Bunk - Brown - Right
4	053773-02-000	EA	Support - Overhead Bunk - Brown - Left
5	040071-02-000	EA	Support - Bunk - Seat Belt
6	039516-03-000	EA	Catch - Bunk - Off White
7	023812-29-000	EA	Rail - Bunk - 77 1" - Off White
8	053774-04-000	EA	Torsion Rod - Overhead Bunk - Brown
9	041322-01-000	EA	Washer - Flat - 15/32" I.D. x 2 3/8" O.D. - Seat Belt
10	074212-01-P01	EA	Pad Asm. - Front Side Overhead - Right - Beige Vinyl
11	074212-02-P01	EA	Pad Asm. - Front Side Overhead - Left - Beige Vinyl
12	074212-03-P01	EA	Pad Asm. - Front Side Overhead - Driver Door - Beige Vinyl
13	048394-01-000	YD	Tape Hook - 1" x 25 YD - Beige
14	048395-01-000	YD	Tape Loop - 1" x 25 YD - Beige
15	007021-01-000	EA	Belt Asm. - Seat - 2" x 90" - Black

## 1983 WINNEBAGO TABLE OF CONTENTS

WC420RG	A-1 - B-22
WC424RB	B-23 - E-4
WCF26RH	E-5 - G-8
WCF26RB	G-9 - I-14

## 1983 WCF26RB INDEX

Floor Plan	G-9 - G-10
Accessories Group	G-11 - G-13
Bath Group	G-14 - G-15
Chassis Group	G-16 - G-17
Curtain, Cushion & Pad Group	G-18 - G-24
Dinette Group	H-1 - H-4
Driver's Compartment Group	H-5 - H-7
Electrical Group	H-8 - H-10
Exterior Body Group	H-11 - H-15
Galley Group	H-16 - H-17
Heating & Air Conditioning Group	H-18 - H-19
Interior Finish Group	H-20 - H-22
LP Group	H-23
Lounge Group	H-24
Water & Sewage Group	I-1 - I-2
Window, Vent & Exterior Door Group	I-3 - I-14

# DRIVER'S COMPARTMENT GROUP (CONTINUED)

## DASH SWITCHES AND GAUGES

Key	Part Number	U/M	Description
	024461-01-000	EA	Switch - Battery
	024462-01-000	EA	Switch - Battery Condition
	024464-02-000	EA	Switch - Battery - Dual Boost
	024463-01-000	EA	Switch - Blinker
	024464-01-000	EA	Switch - Washer
	024465-01-000	EA	Switch - Fuel
	024467-01-000	EA	Switch - Wiper
	324976-01-000	EA	Switch - Generator w/o Circuit Board
	037387-01-000	EA	Switch - Generator w/Circuit Board
	024459-03-000	EA	Gauge - Voltmeter
	024460-03-000	EA	Gauge - Vacuum
	031035-01-000	EA	Gauge - Generator Hourmeter
	031376-01-000	EA	Control Asm. - Heater - 3 Speed
	055279-01-000	EA	Control Asm. - Heater A/C - 3 Speed
	072341-01-710	EA	Control Asm. - Heater A/C - A.R.A.
	074007-01-000	EA	Switch - Intermittent - Windshield Wiper
	072363-01-000	EA	Water Detector Probe - Fuel Line (Diesel)
	072364-01-000	EA	Water Detector Module - Fuel Line (Diesel)

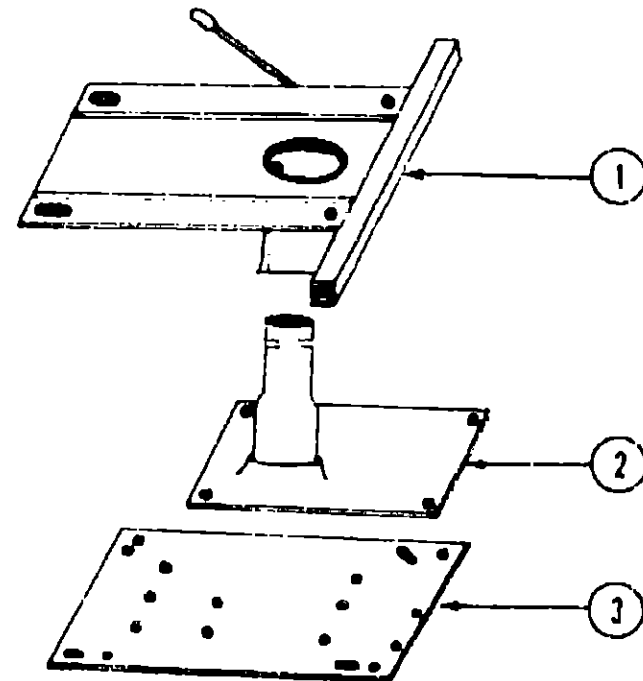

BUCKET SEAT PEDESTAL AND SEAT BELTS

Key	Part Number	U/M	Description
1	069585-04-000	EA	Plate - Top - Pedestal Asm. - Single - Bucket Seat
1	069585-10-000	EA	Plate - Top - Pedestal Asm. - Double Bucket Seat
2	069585-08-000	EA	Plate - Sub - Pedestal Asm. - Bucket Seat
3	069585-07-000	EA	Plate - Base - Pedestal Asm. - Bucket Seat
•	069585-05-000	EA	Hardware Kit - Bolt/Acorn Nut - 4 ea. - Pedestal Asm.
•	007019-01-000	EA	Belt Asm. - Seat - 2" x 84" - Black
•	041322-01-000	EA	Washer - Flat 15/32" I.D. x 2 3/8" O.D. - Seat Belt
•	007021-01-000	EA	Belt Asm. - Seat - 2" x 90" - Black
•	007222-01-000	EA	Belt Asm. - Seat - 2" x 60" - Black
•	043910-01-000	EA	Bracket Asm. - Seat Belt
•	058375-01-000	EA	Bracket - Seat Belt - Washer
•	069246-01-000	EA	Adjuster Asm. - Seat - w/Lock
•	069246-02-000	EA	Adjuster Asm. - Seat - w/o Lock
•	056271-02-000	EA	Belt Asm. - Seat - 2" x 72" - Black
•	068601-01-000	EA	Recliner Drive - Single Bucket - Driver
•	068601-02-000	EA	Recliner Drive - Single Bucket - Passenger
•	068601-06-000	EA	Recliner Drive - Double Bucket - Driver
•	068601-07-000	EA	Recliner Drive - Double Bucket - Passenger
•	Not illustrated		

# ELECTRICAL GROUP

## BULBS

Key	Part Number	U/M	Description
	037935-01-000	EA	Bulb - 1157
	063914-01-000	EA	Bulb - 1139
	008103-01-000	EA	Bulb - 53
	008213-01-000	EA	Bulb - 57
	008214-01-000	EA	Bulb - 67
	008215-01-000	EA	Bulb - 1003
	008216-01-000	EA	Bulb - 1034
	008217-01-000	EA	Bulb - 1073
	008218-01-000	EA	Bulb - 1141
	008220-01-000	EA	Bulb - 12V - 25W
	036196-01-000	EA	Bulb - 194
	067479-01-000	EA	Bulb - 1076 - 12V - 1.80 Amp.

## FUSES AND CIRCUIT BREAKER

Key	Part Number	U/M	Description
	056473-02-000	EA	Fuse - Slow Blow - 5 Amp. - 32 Volt Capacity
	056473-01-000	EA	Fuse - Slow Blow - 6 1/4 Amp.
	008233-01-000	EA	Fuse - 12 Volt - 6 Amp.
	008234-01-000	EA	Fuse - 12 Volt - 10 Amp.
	046893-01-000	EA	Fuse - 12 Volt - 13 Amp.
	008235-01-000	EA	Fuse - 12 Volt - 15 Amp.
	008236-01-000	EA	Fuse - 12 Volt - 20 Amp.
	008248-01-000	EA	Fuse - 110 Volt - 30 Amp. - AGU
	008252-01-000	EA	Fuse - 110 Volt - 50 Amp.
	062901-02-000	EA	Fuse - Automotive - 5 Amp.
	062901-05-000	EA	Fuse - Automotive - 15 Amp.
	008208-01-000	EA	Circuit Breaker - 12 Volt - 40 Amp.
	008211-01-000	EA	Circuit Breaker - 12 Volt - 6 Amp.
	008268-01-000	EA	Circuit Breaker - 12 Volt - 30 Amp. w/Mount
	033573-02-000	EA	Circuit Breaker - 12 Volt - 15 Amp. w/Mount
	033573-01-000	EA	Circuit Breaker - 12 Volt - 20 Amp. w/Mount
	040051-01-000	EA	Circuit Breaker - 110 Volt - 20 Amp. TQL
	071279-01-000	EA	Circuit Breaker - 120 Volt - 15 Amp.
	008273-03-000	EA	Circuit Breaker - 15/20 Amp. TQL
	008299-01-000	EA	Circuit Breaker - 115 Amp. TQL
	008297-01-000	EA	Circuit Breaker - 120 Amp. TQL
	008293-01-000	EA	Circuit Breaker - 130 Amp. TQL
	071279-02-000	EA	Circuit Breaker - 15/15 Amp. - 120 Volt
	071279-03-000	EA	Circuit Breaker - 15/20 Amp. - 120 Volt
	071279-04-000	EA	Circuit Breaker - 30 Amp. - 120 Volt
	071279-05-000	EA	Circuit Breaker - 20 Amp. - 120 Volt
	071280-01-000	EA	Circuit Breaker Blank

## WINDSHIELD WIPER AND WASHER

Key	Part Number	U/M	Description
•	056000-02-000	EA	Washer Asm. - Windshield - w/o Nozzels
•	057053-01-000	EA	Arm - Windshield Wiper - 18" - Black
•	067191-02-000	EA	Motor Asm. - Windshield Wiper - 2 Speed
•	067192-01-000	EA	Link Asm. - Connecting - Left
•	067193-01-000	EA	Link Asm. - Connecting - Right
•	049464-03-000	EA	Blade - Windshield Wiper - 20" Black
•	067190-01-000	EA	Shaft and Pivot Asm.
•	The illustrated parts breakdown for this item is provided on the Common Items Fiche.		

# 1983 WINNEBAGO TABLE OF CONTENTS

WC420RG	A-1 - B-22
WC424RB	B-23 - E-4
WCF26RH	E-5 - G-8
WCF26RB	G-9 - I-14

# 1983 WCF26RB INDEX

Floor Plan	G-9 - G-10
Accessories Group	G-11 - G-13
Bath Group	G-14 - G-15
Chassis Group	G-16 - G-17
Curtain, Cushion & Pad Group	G-18 - G-24
Dinette Group	H-1 - H-4
Driver's Compartment Group	H-5 - H-7
Electrical Group	H-8 - H-10
Exterior Body Group	H-11 - H-15
Galley Group	H-16 - H-17
Heating & Air Conditioning Group	H-18 - H-19
Interior Finish Group	H-20 - H-22
LP Group	H-23
Lounge Group	H-24
Water & Sewage Group	I-1 - I-2
Window, Vent & Exterior Door Group	I-3 - I-14

## ELECTRICAL GROUP (CONTINUED)

## WIRE, SWITCHES AND RECEPTACLES

Key	Part Number	U/M	Description
	006024-01-000	FT	Wire - 18.5 Bonded - Orange/White/Yellow/Blue/Brown
	006025-01-000	FT	Wire - 18.5 Bonded - Orange/White/Yellow/Blue/Green
	006028-01-000	FT	Wire - 18.5 Bonded - Blue/Red/Yellow/Orange/White
	006030-01-000	FT	Wire - 18.4 Bonded - Red/Blue/Orange/Green
	006277-01-000	EA	Holder - Fuse - Black - Panel Mount
	006077-01-000	EA	Plaque - Compressor Switch
	006054-01-000	EA	Cord - Power - 10-3 30 Amp. - 25' - UL
	006052-01-000	EA	Cord - Power - 10-3 30 Amp. - 25' - CSA
	024571-03-000	EA	Cover Plate - Receptacle - Jumbo Plastic - Brown
	024571-04-000	EA	Cover Plate - Receptacle - Jumbo Plastic - Ivory
	006158-01-000	EA	Cover Plate - Receptacle - Single - Plastic - Brown
	006164-01-000	EA	Cover Plate - Switch - Brown
	006050-01-000	EA	TV Jack - Ivory
	058028-01-000	EA	Connector - Pigtail - Clear - Nylon
	006162-01-000	EA	Switch - Double Toggle - Spade Brown
	006163-01-000	EA	Switch - Toggle Brown
	006195-01-000	EA	Switch - Push Button - 12 Volt
	056264-01-000	EA	Switch - Leaf Actuator
	024462-01-000	EA	Switch - Battery Condition
	024464-01-000	EA	Switch - Washer
	024467-01-000	EA	Switch - Wiper
	024976-01-000	EA	Switch - Generator w/o Circuit Board
	074007-01-000	EA	Switch - Intermittent - Windshield Wiper
	063912-01-000	EA	Relay - Canister Spot w/Ground
	069238-01-000	EA	Cover - Electrical - 4 x 4 Box
	006058-01-000	EA	Adaptor - Power Cord
	024024-02-000	EA	Receptacle - Power Cord
	053126-01-000	EA	Receptacle - Ground Fault Interrupter - 125 Volt - Ivory
	053126-02-000	EA	Receptacle - Ground Fault Interrupter - 125 Volt - Brown
	058707-01-000	EA	Receptacle - Single - Brown
	058700-01-000	EA	Receptacle - Duplex - Brown
	006157-01-000	EA	Receptacle - Duplex - Brown (Exterior Backwall)
	058046-01-000	EA	Cover - Electrical Box - 4.5" x 2.75" - Rain Tight (Exterior)
	006294-01-000	EA	Cover - Steel - Flat Blank 4" x 4"
	006288-01-000	EA	Box - Electrical - Plastic - 3" x 3.5"
	006289-01-000	EA	Box - Electrical - Steel - 4 x 4 - 1/2 & 3/4 UL
	058049-01-000	EA	Box - Electrical - 2" x 3" x 2.25" - Steel
	064398-01-000	EA	Housing Asm. - Trailer Receptacle
	064399-01-000	EA	Housing Asm. - Trailer Pin
	064450-01-000	EA	Housing Asm. - Trailer Plug
	035417-01-000	EA	Terminal - Pin Receptacle - .125 Dia.
	054532-01-000	EA	Housing Pin - 6 Position
	031968-01-000	EA	Contact - Plug - Brass - Tin Plated
	035290-17-000	EA	Cable Asm. - Battery - 1 AWG Strand - 282"
	054865-01-000	EA	Wire Asm. - Generator Switch

## ELECTRICAL GROUP (CONTINUED)

## MISCELLANEOUS ELECTRICAL COMPONENTS

Key	Part Number	U/M	Description
	047338-03-000	EA	Insulator - Dual Battery - 70 Amp.
	063739-01-000	EA	Battery - 12 Volt - 80 Amp. Gould
	006188-01-000	EA	Solenoid - Dual Battery - Relay
	039950-01-702	EA	Circuit Board - Control Center
	024458-03-000	EA	Gauge - Voltmeter - w/o Bracket
	031035-01-000	EA	Gauge - Hourmeter - Generator
	024460-03-000	EA	Gauge - Vacuum - w/o Bracket
	039861-01-000	EA	Sending Unit Kit - Wemac
	048812-12-000	EA	Refrigerator Sensor - Refrigerator Alarm
	048812-04-000	EA	Control Panel - Basic
	048812-09-000	EA	Control Panel - Insert - w/LP Alarm - Refrigerator
	072351-03-000	EA	Control Panel Complete - Digital Alarm - LP
	072351-01-000	EA	Control Panel Complete - Digital Alarm - LP - Refrigerator
	067762-01-000	EA	Converter - 40 Amp. w/Charger
	024461-01-000	EA	Switch - Dual Battery
	071278-02-000	EA	Control Center - 45 Amp.
	052387-01-000	EA	Lighter Asm. - Cigarette

## EXTERIOR LIGHTS

Key	Part Number	U/M	Description
	007309-01-000	EA	Light - Step Well
	058032-01-000	EA	Tail Lamp Asm. - 2 Bulb - Chrome - Right/Left
	059036-01-000	EA	Bracket - Tail Lamp
	059540-01-000	EA	Bracket - License Plate
	062742-04-000	EA	Wedge - Tail Lamp w/License Plate - Off White - Left
	062740-04-000	EA	Wedge - Tail Lamp - Off White - Right
	042405-03-000	EA	Base - Rectangular Clearance Light
	042405-01-000	EA	Lens - Clearance Light - Red w/Reflex
	042405-04-000	EA	Lens - Clearance Light - Red w/o Reflex
	042405-02-000	EA	Lens - Clearance Light - Amber w/Reflex
	042405-05-000	EA	Lens - Clearance Light - Amber w/o Reflex
	006089-01-000	EA	Light - Porch - Recessed
	058330-01-000	EA	Lamp Asm. - Parking
	058330-02-000	EA	Socket Asm. - Parking Lamp w/Wire

## INTERIOR LIGHTS

Key	Part Number	U/M	Description
	033508-02-000	EA	Light - Dome - Ivory - 1 Bulb - US - Progressive Dynamics, Inc.
	033508-03-000	EA	Light - Dome - Ivory - 1 Bulb - CSA - Progressive Dynamics, Inc.
	033509-02-000	EA	Light - Dome - Ivory - 2 Bulb - US - Progressive Dynamics, Inc.
	033509-03-000	EA	Light - Dome - Ivory - 2 Bulb - CSA - Progressive Dynamics, Inc.
	061424-01-000	EA	Light - 12 V Receptacle - Aisle - IP
	053346-01-000	EA	Light - High Intensity - Brown
	007309-01-000	EA	Light - Step Well
	072353-01-000	EA	Light - Reading - Single - 360° Swivel - Silver
	072353-02-000	EA	Light - Reading - Double - 360° Swivel - Silver

1983 WINNEBAGO  
TABLE OF CONTENTS

WC420RG	A-1 - B-22
WC424RB	B-23 - E-4
WCF26RH	E-5 - G-8
WCF26RB	G-9 - I-14

## 1983 WCF26RB INDEX

Floor Plan	G-9 - G-10
Accessories Group	G-11 - G-13
Bath Group	G-14 - G-15
Chassis Group	G-16 - G-17
Curtain, Cushion & Pad Group	G-18 - G-24
Dinette Group	H-1 - H-4
Driver's Compartment Group	H-5 - H-7
Electrical Group	H-8 - H-10
Exterior Body Group	H-11 - H-15
Galley Group	H-16 - H-17
Heating & Air Conditioning Group	H-18 - H-19
Interior Finish Group	H-20 - H-22
LP Group	H-23
Lounge Group	H-24
Water & Sewage Group	I-1 - I-2
Window, Vent & Exterior Door Group	I-3 - I-14

# EXTERIOR BODY GROUP (CONTINUED)

EXTERIOR BODY PANELS AND TRIM

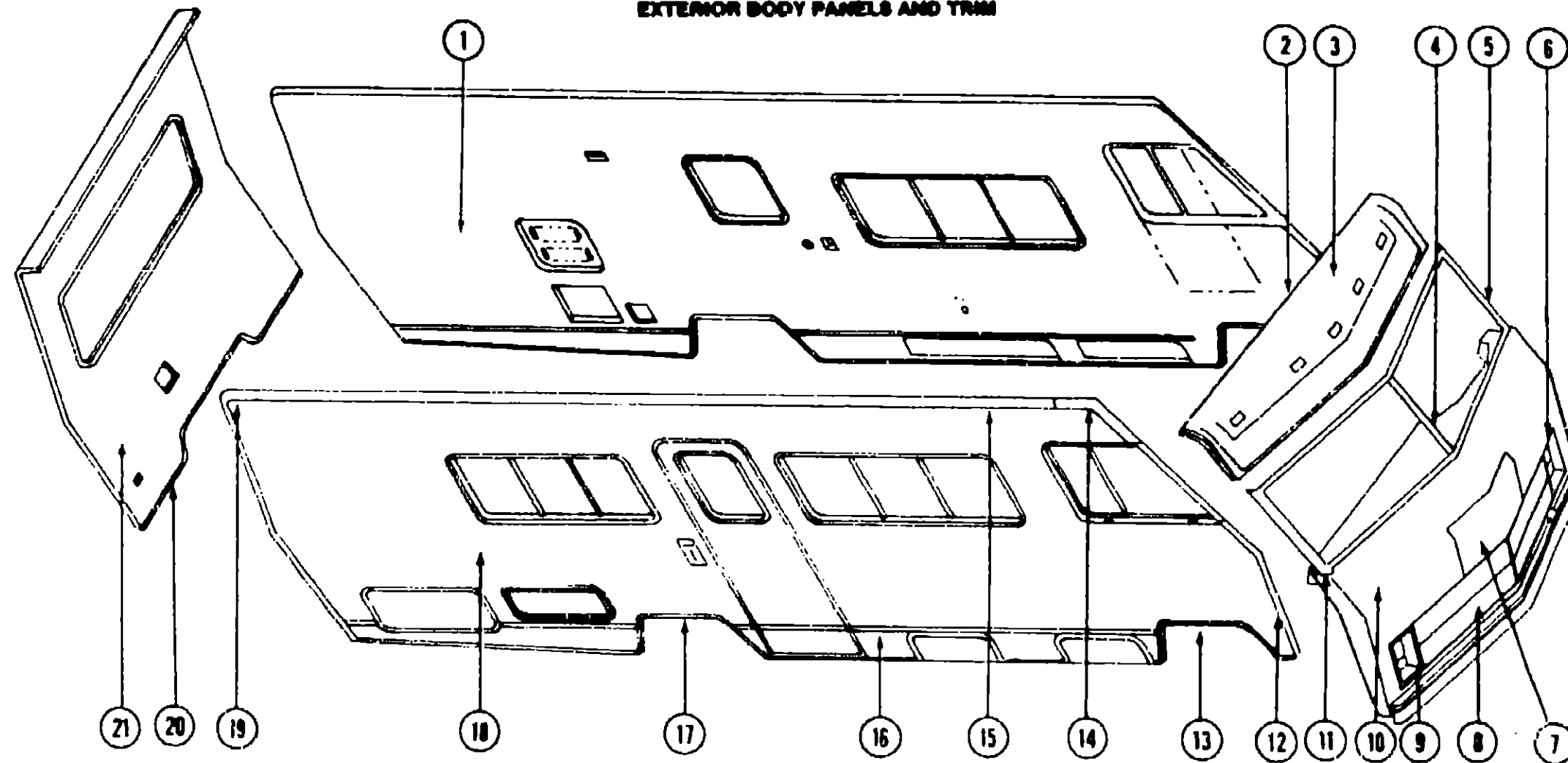

Key	Part Number	U/M	Description
1	M01109-01-P01	EA	Sidewall Asm. - Left (P31)
1	M01109-01-P02	EA	Sidewall Asm. - Left (P32)
1	M01109-01-P03	EA	Sidewall Asm. - Left (P33)
2	062386-01-000	EA	Trim - Roof/Front Cap - 91"
3	055401-01-000	EA	Cap Asm. - Over Windshield - Off White
4	058287-01-000	EA	Trim - Molding - Windshield - Upper & Lower
4	058288-01-000	EA	Trim - Molding - Windshield - Center
4	042743-02-000	EA	Corner Support - Windshield - Upper - Steel
4	042743-01-000	EA	Corner Support - Windshield - Lower - Steel
5	058289-01-000	EA	Trim - Contour - Windshield - Left
6	070617-03-000	EA	Bezel - Headlamp - Left
7	073064-01-000	EA	Access Panel
7	072917-02-000	EA	Hood Prop Rod
7	062626-01-000	EA	Clip - Prop Rod
7	072013-01-000	EA	Spring - Access Door Release
7	073611-01-000	EA	Striker - Hood Latch
7	073340-01-000	EA	Hinge - Access Panel - Right
7	073340-02-000	EA	Hinge - Access Panel - Left
7	074178-01-000	EA	Bracket - Cable - Hood Release
7	074202-01-000	EA	Latch Asm. - Hood
7	072010-01-000	EA	Cable Asm. - Access Panel
7	072011-01-000	EA	Sheath - Cable - End - Hood
8	074780-01-000	EA	Grille Asm.
9	070617-04-000	EA	Bezel - Headlamp - Right
10	M00677-01-000	EA	Panel Asm. - Front Shroud - Includes Access Panel - Off White
11	058289-02-000	EA	Trim - Contour - Windshield - Right
12	073861-03-000	EA	Trim - Fiberglass Panel - Right
12	073861-04-000	EA	Trim - Fiberglass Panel - Left

Key	Part Number	U/M	Description
13	073389-01-000	EA	Trim - Wheel Well - Front - Left or Right
14	058284-02-000	EA	Trim - Contour - Right Front Upper - Off White
14	058284-01-000	EA	Trim - Contour - Left Front Upper - Off White
15	034822-03-000	EA	Trim - Sidewall - Upper - Left or Right - Off White
16	002444-01-001	EA	Feature Strip - Extr. - 14' - w/o Insert
16	001030-02-003	EA	Insert - Feature Strip - Off White - Stucco - 17'
16	009731-01-000	EA	End Cap - Feature Strip
17	052842-01-000	EA	Trim - Wheel Well - Rear - Right or Left
18	M01110-01-P01	EA	Sidewall Asm. - Right
18	044381-01-004	EA	Extrusion - Awning Rail - 192"
18	002776-02-001	EA	U-Channel - Extrusion 1.75" x 18'
19	039964-01-000	EA	Trim - Contour - Right Rear - Off White
19	039964-02-000	EA	Trim - Contour - Left Rear - Off White
20	050406-02-000	EA	Trim - Backwall - Lower - Left or Right
20	002365-02-001	EA	U-Channel - Extrusion - 1" x 18'
21	M01131-01-P01	EA	Backwall Asm.
21	073864-01-P01	EA	Roof Asm.
21	073648-01-000	EA	Trim - Sidewall - Front Wheelwell - Right
21	073648-02-000	EA	Trim - Sidewall - Front Wheelwell - Left
21	Not illustrated		

## 1983 WINNEBAGO TABLE OF CONTENTS

WC420RG  
WC424RB  
WCF26RH  
WCF26RB

A-1 - B-22  
B-23 - E-4  
E-5 - G-8  
G-9 - I-14

## 1983 WCF26RB INDEX

Floor Plan	G-9 - G-10
Accessories Group	G-11 - G-13
Bath Group	G-14 - G-15
Chassis Group	G-16 - G-17
Curtain, Cushion & Pad Group	G-18 - G-24
Dinette Group	H-1 - H-4
Driver's Compartment Group	H-5 - H-7
Electrical Group	H-8 - H-10
Exterior Body Group	H-11 - H-15
Galley Group	H-16 - H-17
Heating & Air Conditioning Group	H-18 - H-19
Interior Finish Group	H-20 - H-22
LP Group	H-23
Lounge Group	H-24
Water & Sewage Group	I-1 - I-2
Window, Vent & Exterior Door Group	I-3 - I-14

EXTERIOR BODY GROUP (CONTINUED)

LABELS, DECALS AND EXTERIOR PAINT

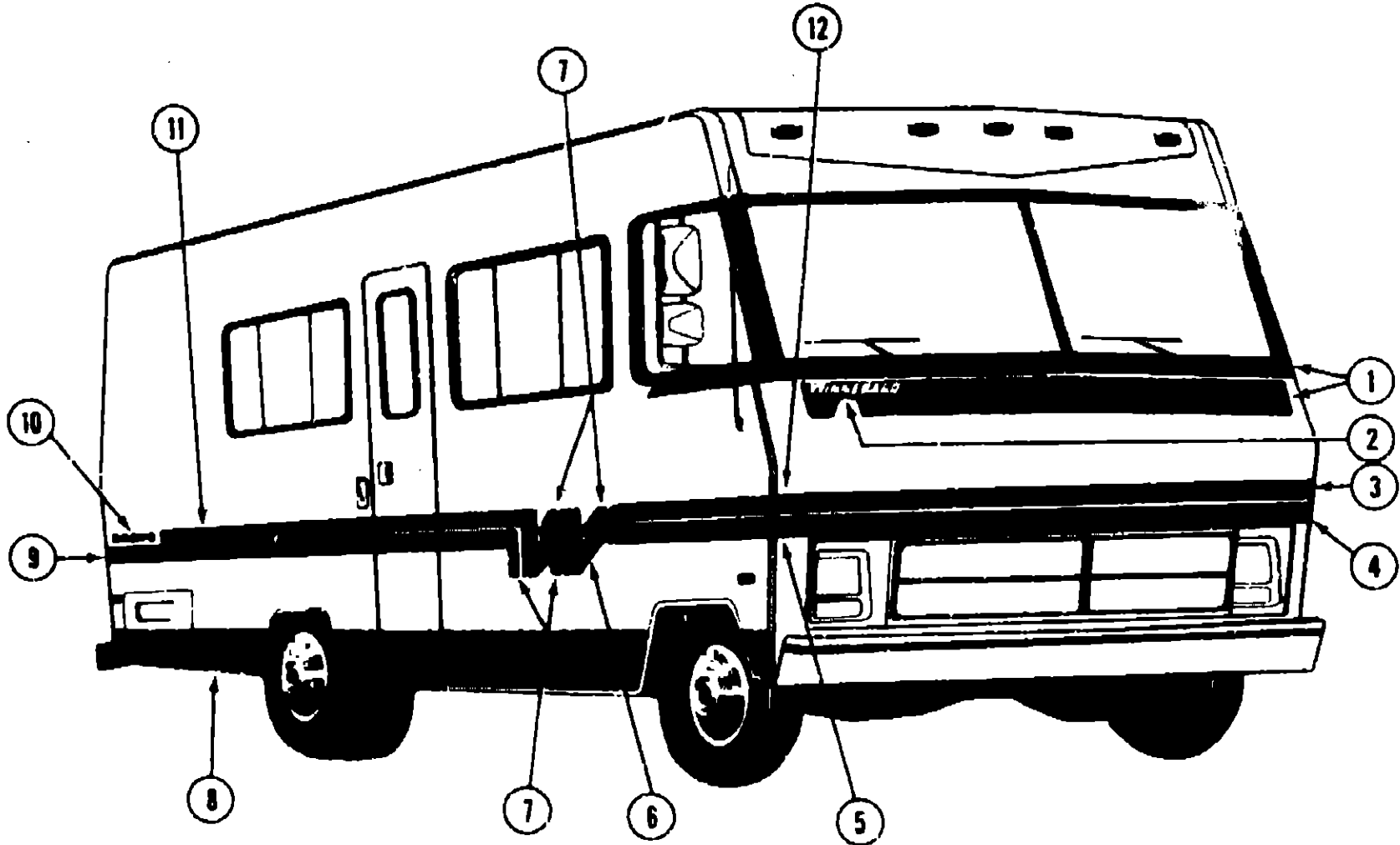

1983 WINNEBAGO  
TABLE OF CONTENTS

WC420RG	A-1 - B-22
WC424RB	B-23 - E-4
WCF26RH	E-5 - G-8
WCF26RB	G-9 - I-14

Key	Part Number	U/M	Description
1	073425-03-000	EA	Paint - Dark Brown Metallic - 16 oz. Aerosol (Dupont 43472AM)
2	082034-02-000	EA	Stencil - Winnebago - 2.8" x 22"
3	041273-42-000	FT	Decal - Striping - 3.27" - Dark Brown Metallic
4	041273-47-000	FT	Decal - Striping - 4.16" (Front & Rear) - Light Blue Metallic (P01, P31)
4	041273-48-000	FT	Decal - Striping - 4.16" (Front & Rear) - Copper (P02, P32)
4	041273-49-000	FT	Decal - Striping - 4.16" (Front & Rear) - Red/Brown (P03, P33)
5	073422-01-000	EA	Decal - Corner - Bottom Stripe - Right - Light Blue Metallic (P01, P31)
5	073422-02-000	EA	Decal - Corner - Bottom Stripe - Left - Light Blue Metallic (P01, P31)
5	073422-03-000	EA	Decal - Corner - Bottom Stripe - Right - Copper (P02, P32)
5	073422-04-000	EA	Decal - Corner - Bottom Stripe - Left - Copper (P02, P32)
5	073422-05-000	EA	Decal - Corner - Bottom Stripe - Right - Red/Brown (P03, P33)
5	073422-06-000	EA	Decal - Corner - Bottom Stripe - Left - Red/Brown (P03, P33)
6	073423-01-000	EA	Decal - Leaning W - 36.5" x 15" - Dark Brown Metallic
7	041273-50-000	FT	Decal - Striping - 2.25" - Light Blue Metallic (P01, P31)
7	041273-51-000	FT	Decal - Striping - 2.25" - Copper (P02, P32)
7	041273-52-000	FT	Decal - Striping - 2.25" - Red/Brown (P03, P33)
8	041273-43-000	FT	Decal - Striping - 11" - Dark Brown Metallic
9	041273-44-000	FT	Decal - Striping - 4" (Front & Rear) - Light Blue Metallic (P02, P32)
9	041273-45-000	FT	Decal - Striping - 4" (Front & Rear) - Copper (P01, P31)
9	041273-46-000	FT	Decal - Striping - 4" (Front & Rear) - Red/Brown (P03, P33)
10	073424-01-000	EA	Decal - Logo - Brave - 19.5" x 3" - Dark Brown Metallic
11	041273-41-000	FT	Decal - Striping - 3" - Dark Brown Metallic
12	073421-01-000	EA	Decal - Corner - Top Stripe - Right - Dark Brown Metallic
12	073421-02-000	EA	Decal - Corner - Top Stripe - Left - Dark Brown Metallic
12	041273-53-000	FT	Decal - Striping - .19" - Chrome
12	050313-20-000	EA	Decal - "Winnebago" - 2.8"

Key	Part Number	U/M	Description
1	006031-01-000	EA	Label - Potable Water Only
1	008187-01-000	EA	Label - Sewage
1	008188-01-000	EA	Label - Waste Water
1	006198-01-000	EA	Label - Exit - Escape Window
1	006028-01-000	EA	Label - Drain Cap - 2" x 3"
1	040944-01-000	EA	Label - Open - Entrance Door
1	047731-01-000	EA	Label - Emergency Exit
1	054531-01-000	EA	Label - LP Gas Only
1	061417-01-000	EA	Label - Fuel
1	050225-01-000	EA	Label - Warning - Stove Vent - US
1	006015-01-000	EA	Label - Patent Motor Home
1	006004-01-000	EA	Label - Seat - w/o Seat Belt
1	084378-01-000	EA	Label - Flying "W" w/ Thermo Panel
1	006195-01-000	EA	Label - Electrical Test
1	006196-01-000	EA	Label - Gas Test
1	006197-01-000	EA	Label - Water Test
1	023769-01-000	EA	Label - Warning - LPG - Canada
1	057467-04-000	EA	Label - Exterior Loading Limit
1	006040-01-000	EA	Tag - Gas - Refueling Warning
1	006062-01-000	EA	Tag - Electrical - 110 V Connection
1	072863-01-000	EA	Nameplate - Diesel - 6.2L
1	056259-01-000	EA	Label - Safety Check List
1	045681-03-000	EA	Paint - Gloss Black - Acrylic Enamel - 16 oz. Aerosol (99A Dupont)
1	041561-03-000	EA	Paint - Off White - Acrylic Enamel - 16 oz. Aerosol
1	Not illustrated		

1983 WCF26RB INDEX

Floor Plan	G-9 - G-10
Accessories Group	G-11 - G-13
Bath Group	G-14 - G-15
Chassis Group	G-16 - G-17
Curtain, Cushion & Pad Group	G-18 - G-24
Dinette Group	H-1 - H-4
Driver's Compartment Group	H-5 - H-7
Electrical Group	H-8 - H-10
Exterior Body Group	H-11 - H-15
Galley Group	H-16 - H-17
Heating & Air Conditioning Group	H-18 - H-19
Interior Finish Group	H-20 - H-22
LP Group	H-23
Lounge Group	H-24
Water & Sewage Group	I-1 - I-2
Window, Vent & Exterior Door Group	I-3 - I-14

## EXTERIOR BODY GROUP (CONTINUED)

### SEALANTS, ADHESIVES AND FASTENERS

Key	Part Number	U/M	Description
	034552-1-100	EA	Sealant - Off White Silicone
	034552-1-100	EA	Sealant - Beige Silicone
	034552-02-000	EA	Sealant - Clear Silicone
	060637-01-000	EA	Sealant - Weatherban 404 Tube - 3M
	004346-02-000	EA	Sealant - White Silicone
	009200-01-000	EA	Tape - Furnace - 1.5"
	004353-01-000	FT	Tape - Gasket - .125" x .75" - White
	002825-01-000	FT	Weather Stripping - Roof Vent
	002337-01-000	EA	Adhesive - 3M - 1300 Tube
	004005-01-000	GL	Adhesive - Swifts - Glue (Sidewalls)
	004020-01-000	QT	Adhesive - ABS Cement (Plastic Fittings)
	000G66-06-12R	EA	Screw #8 - 18 x .75" SDPH - Beige
	000G66-06-16S	EA	Screw #8 - 18 x .75" SDPH - Off White
	000G64-06-16R	EA	Screw #8 - 18 x 1" SDPH - Beige
	000G64-06-16S	EA	Screw #8 - 18 x 1" SDPH - Off White
	000G64-06-16M	EA	Screw #8 - 18 x 1" SDPH - Gray
	053786-01-000	EA	Bedding Compound - Tube Black - Schnee Morehead
	053786-02-000	EA	Bedding Compound - Tube White - Schnee Morehead
	035628-01-000	EA	Fastener - Blind Well Nut
	069640-01-000	FT	Tape - .25" Bead x 20' - Gray - 3M
	069640-02-000	FT	Tape - .5" x .125" x 30' - Gray - 3M
	069640-03-000	FT	Tape - .75" x .125" x 30' - Gray - 3M
	069640-04-000	FT	Tape - 2" x .09" x 45' - Gray - 3M
	069640-05-000	FT	Tape - 2.5" x .09" x 50' - Gray - 3M
	038886-01-000	EA	Tape - Butyl - .31" x .31" x 148" - Windshield

### MISCELLANEOUS EXTERNALLY MOUNTED PARTS

Key	Part Number	U/M	Description
	010230-02-000	EA	Fill - City Water - Recessed - Off White
	058808-01-000	EA	Fill - Water - Lockable
**	011129-01-000	EA	Plumbing Seal - Roof Vent - 1 1/2" White
	048817-01-000	EA	Assist Handle - w/Light
	048817-01-700	EA	Lens - Assist Handle
	064576-01-000	EA	Shroud - Fuel Fill - Rear
	063304-01-000	EA	Shroud - Fuel Fill - Upper - Angled
**	The illustrated parts breakdown for this item is provided on the Common Items Fiche.		

### SHEET ALUMINUM AND STYROFOAM

Key	Part Number	U/M	Description
	039155-28-006	EA	Alum. - Off White - Mesa II - .024" x 48" x 360"
	039155-28-003	EA	Alum. - Off White - Mesa II - .024" x 36" x 360"
	039155-28-007	EA	Alum. - Off White - Mesa II - .024" x 12" x 360"
	039155-08-001	EA	Alum. - Off White - Grayhound Design - 48" x 96"
	001018-01-024	EA	Alum. - Off White - No Design - 48" x 96"
	044487-01-001	EA	Alum. - Mill Finish - No Design (Roof) - 96" x 360"
	000868-01-000	SF	Styrofoam - .75" x 24" x 96"
	000870-01-000	SF	Styrofoam - 1.5" x 24" x 96"

## GALLEY GROUP

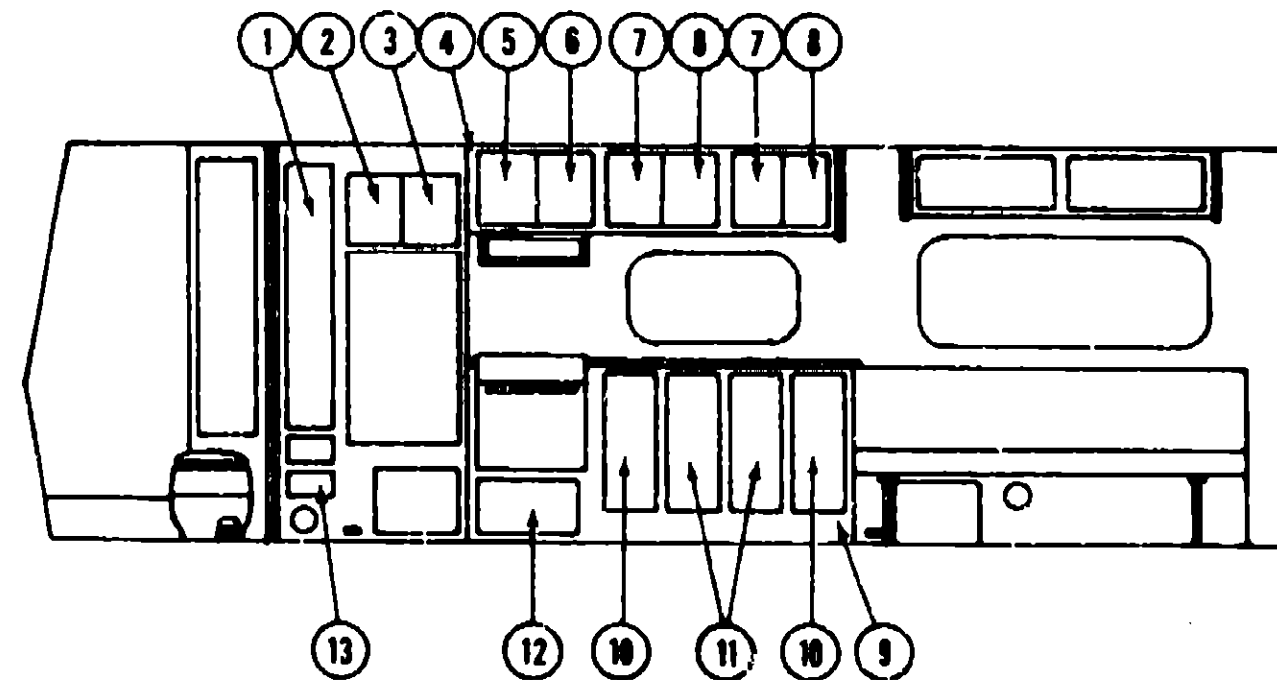

### GALLEY CABINETRY

Key	Part Number	U/M	Description
	069852-33-P01	EA	Door Asm. - Refrigerator Cabinet - 52.6" x 8.9" - w/o Hardware
	073521-01-P01	EA	Door Asm. - Refrigerator Cabinet - 13.8" x 12.5" - w/o Hardware - Left
	073521-02-P01	EA	Door Asm. - Refrigerator Cabinet - 13.8" x 12.5" - w/o Hardware - Right
	M73525-01-P01	EA	Cabinet Asm. - Galley Overhead - w/o Doors or Hardware
	073521-05-P01	EA	Door Asm. - Galley Overhead - 15.8" x 11.6" - w/o Hardware - Left
	073521-06-P01	EA	Door Asm. - Galley Overhead - 15.8" x 11.6" - w/o hardware - Right
	073521-04-P01	EA	Door Asm. - Galley Overhead - 16" x 10.6" - w/o Hardware - Left
	073521-03-P01	EA	Door Asm. - Galley Overhead - 16" x 10.6" - w/o Hardware - Right
	M73529-01-P01	EA	Cabinet Asm. - Galley - w/o Countertop, Doors, Drawers or Hardware
	M01119-01-P01	EA	Countertop Asm. - Galley - Almond
	069852-02-P01	EA	Door Asm. - Galley Cabinet - 28" x 11.8" - w/o Hardware
	069852-03-P01	EA	Door Asm. - Galley Cabinet - 28" x 10.9" - w/o Hardware
	069852-39-P01	EA	Door Asm. - Galley Cabinet - 16.7" x 21.3" - w/o Hardware
	M70621-06-P01	EA	Drawer Asm. - Refrigerator Cabinet - 5" x 9" x 16.4" Deep - w/o Hardware
	067195-01-000	EA	Drawer - Plastic - 10.5" x 17.5" x 5"
	Not illustrated		

## 1983 WINNEBAGO TABLE OF CONTENTS

WC420RG  
WC424RB  
WCF26RH  
WCF26RB

A-1 - B-22  
B-23 - E-4  
E-5 - G-8  
G-9 - I-14

## 1983 WCF26RB INDEX

Floor Plan	G-9 - G-10
Accessories Group	G-11 - G-13
Bath Group	G-14 - G-15
Chassis Group	G-16 - G-17
Curtain, Cushion & Pad Group	G-18 - G-24
Dinette Group	H-1 - H-4
Driver's Compartment Group	H-5 - H-7
Electrical Group	H-8 - H-10
Exterior Body Group	H-11 - H-15
Galley Group	H-16 - H-17
Heating & Air Conditioning Group	H-18 - H-19
Interior Finish Group	H-20 - H-22
LP Group	H-23
Lounge Group	H-24
Water & Sewage Group	I-1 - I-2
Window, Vent & Exterior Door Group	I-3 - I-14



**GALLEY GROUP (CONTINUED)**

**GALLEY HARDWARE AND APPLIANCES**

Key	Part Number	U/M	Description
	053424-04-P01	EA	Sink Cover - Large - Almond
	068515-01-000	EA	Sink - Stainless Steel - Double w/Bolts
..	011053-01-000	EA	Faucet - Swing Spout - 8" - US
..	011053-02-000	EA	Faucet - Swing Spout - 8" - CSA
	066437-01-000	EA	Strainer - Sink
..	011053-01-700	EA	Aerator - Swing Spout Faucet
	058334-01-000	EA	Wastebasket - 9 3/4" x 7" x 10" - White Rubbermaid
	059877-01-000	EA	Support - Wastebasket - Plastic - Galley Mount
	058478-01-000	EA	Support - Wastebasket - Metal - Door Mount
	058841-01-N16	EA	Cover - Wastebasket - Almond
	053333-01-000	EA	Range Hood - Non Power - Black - US
	053333-02-000	EA	Range Hood - Non Power - Black - CSA
..	049930-03-000	EA	Range Hood - Powered - Black - Jensen - US
..	049930-04-000	EA	Range Hood - Powered - Black - Jensen - CSA
	052771-02-000	EA	Microwave Oven - Magic Chef - MW207
	053287-07-000	EA	Bracket Asm. - Microwave - Right
	053287-08-000	EA	Bracket Asm. - Microwave - Left
	067754-01-000	EA	Range - 3 Burner - Small Oven - Magic Chef
	749045-01-740	EA	Cover - Stove Top - Bifold - Chrome - Magic Chef
	064473-02-000	EA	Refrigerator - AC/DC/Gas - Norcold - 6'
	064472-02-000	EA	Refrigerator - AC/DC/Gas - Norcold - 8'
..	052932-01-M10	EA	Hinge Kit - Cabinet Door - Antique Brass
..	041939-01-300	EA	Hinge Kit - Double Acting - Overhead Door
..	057898-01-000	EA	Latch - Hidden - Cabinet Door
..	057898-02-000	EA	Strike - Hidden Latch - Cabinet Door
	037688-01-000	FT	Rail - Drawer Guide - Steel
	047744-01-000	EA	Kit - Drawer Guide - Plastic
	054450-01-000	EA	Level - Refrigerator
	074490-02-R10	EA	Spice Rack - Oak
..	074981-01-000	EA	Cutting Board - Maple
.. The illustrated parts breakdown for this item is provided on the Common Items Fiche.			

**HEATING & AIR CONDITIONING GROUP**

**AUTOMOTIVE HEATER AND AIR CONDITIONER**

Key	Part Number	U/M	Description
	072341-01-700	EA	Wheel - w/Retainer & Index Clip - A.R.A.
	072341-01-701	EA	Core - Heater - A.R.A.
	072341-01-702	EA	Coil - Evaporator - A.R.A.
	072341-01-703	EA	Valve - Expansion - A.R.A.
	072341-01-704	EA	Valve - Suction - A.R.A.
	072341-01-705	EA	Switch - Pressure - Low Cut Out - A.R.A.
	072341-01-706	EA	Resistor - A.R.A.
	072341-01-707	EA	Thermostat - A.R.A.
	072341-01-708	EA	Motor - Vacuum - A.R.A.
	072341-01-709	EA	Relay - w/Tab - Bosh - A.R.A.
	072341-01-710	EA	Control Asm. - Heater A/C - A.R.A.
	072341-01-711	EA	Cable - Bowden - 72" - A.R.A.
	072341-01-712	EA	Switch - Vacuum - A.R.A.
	072341-01-713	EA	Switch - Jumper Control - A.R.A.
	072341-01-714	EA	Valve - Heater - Water Flow Control - A.R.A.
	072341-04-000	EA	Heater/Evaporator Asm. - A.R.A.
	072342-01-000	EA	Condensor Asm. - A.R.A.
	072343-01-000	EA	Compressor/Clutch - A.R.A.
	072344-01-000	EA	Package - Compressor Mount
	074028-01-000	EA	Package - Compressor Mount - 6.2 L Diesel
	039044-01-000	EA	Louver Asm. - A/C Adjustable
	047046-01-000	EA	Motor 12 Volt - 3 Speed - Heater - Air Conditioner
	031043-01-000	EA	Valve - Heater - Water Flow Control
	033880-02-000	EA	Cable - Control - Flexible - 46"
	031170-01-000	EA	Clamp - Cable - 3/16" Dia.
	024996-01-000	EA	Clutch - Magnetic - Compressor
	024999-01-000	EA	Compressor - Auto Air - 10.3 Cubic Inch
	071291-01-000	EA	Package - Compressor Mount 454 C.I.D.
	048801-01-000	EA	Condensor - Radiator Mount
	072341-05-000	EA	Heater w/o Air Conditioning
	058893-01-000	EA	Bracket - Side Mount - Motor Aid
	031376-01-000	EA	Control Asm. - Heater - 3 Speed
	055279-01-000	EA	Control Asm. - Heater A/C - 3 Speed
	055280-01-000	EA	Switch - Fan - 3 Speed - Control Asm. - Heater & A/C
	007076-01-700	FT	Hose - Flexible PVC - 2" I.D.
	007108-01-000	FT	Hose - Heater - 5/8" I.D. SAE 20R3
	007281-01-700	FT	Hose - Flexible PVC - 2 1/2" I.D.
	062401-04-000	EA	Clamp - Worm Drive - .69" - 1.25" I.D.
	033258-01-000	EA	Hose - Refrigerant - .50" I.D. x 34.50"
	031960-01-000	EA	Hose - Refrigerant - .34" I.D. x 30"
	031961-02-000	EA	Hose - Refrigerant - .31" I.D. x 19"
	049401-01-000	EA	Heater Asm. - Rear - Auxillary
	049401-01-700	EA	Valve - Water Control (Aux. Heater)
	049401-01-701	EA	Control Cable (Aux. Heater)
	040401-01-702	EA	Motor Asm. (Aux. Heater)
	049401-01-703	EA	Heater Core (Aux. Heater)
	049401-01-704	EA	Switch (Aux. Heater)
	058906-02-000	EA	Control Panel - Beige - (Auxillary Rear Heater)
	058906-01-000	EA	Control Panel - Brown (Auxiliary Rear Heater)
	024868-01-000	EA	Receiver - Dehydrator
	031044-01-000	EA	Clamp - Receiver Dehydrator
	031962-01-000	EA	Bracket - Receiver Dehydrator
	048232-02-000	EA	Kit - Auto Air - 454 C.I.D. - A-Body - Chevy
	024851-01-000	EA	Door Asm. - Defroster - A/C
	010227-01-000	EA	Tee - Plastic - Barb 5/8" or 3/4" Hose
	024855-01-000	EA	Duct Asm. - Fresh Air
	024849-01-000	EA	Damper Asm. - Fresh Air
	072341-06-000	EA	Duct & Control Kit

**1983 WINNEBAGO  
TABLE OF CONTENTS**

WC420RG	A-1 - B-22
WC424RB	B-23 - E-4
WCF26RH	E-5 - G-8
WCF26RB	G-9 - I-14

**1983 WCF26RB INDEX**

Floor Plan	G-9 - G-10
Accessories Group	G-11 - G-13
Bath Group	G-14 - G-15
Chassis Group	G-16 - G-17
Curtain, Cushion & Pad Group	G-18 - G-24
Dinette Group	H-1 - H-4
Driver's Compartment Group	H-5 - H-7
Electrical Group	H-8 - H-10
Exterior Body Group	H-11 - H-15
Galley Group	H-16 - H-17
Heating & Air Conditioning Group	H-18 - H-19
Interior Finish Group	H-20 - H-22
LP Group	H-23
Lounge Group	H-24
Water & Sewage Group	I-1 - I-2
Window, Vent & Exterior Door Group	I-3 - I-14

## HEATING & AIR CONDITIONING GROUP (CONTINUED)

### FURNACES AND ROOF AIR CONDITIONER

Key	Part Number	U/M	Description
**	075696-01-000	EA	Furnace - 34,000 BTU - w/Direct Ignition - NT-34S
**	075695-01-000	EA	Furnace - 24,000 BTU - w/Direct Ignition - NT-24S
	009196-01-000	FT	Duct - Flexible - 4" I.D. x 25'
	056464-01-000	EA	Register - 4" Dia. - Plastic - w/Damper
	056464-02-000	EA	Register - 4" Dia. - Plastic - w/o Damper
	009200-01-000	EA	Tape - Furnace - 1 1/2"
	023146-01-000	EA	Clamp - Screw Type - 4"
	069633-01-705	EA	Vent Package - Furnace - Suburban
	069634-01-723	EA	Thermostat - Wall Mount - Suburban
**	073743-01-000	EA	Shroud Asm. - Ceiling - Inside - Roof Air Cool Only - 13,500 BTU - Coleman
**	073744-01-000	EA	Shroud Asm. - Ceiling - Inside - Roof Air Heat and Cool - 13,500 BTU - Coleman
	073742-01-000	EA	Air Conditioner - 110 Volt - Roof Mount - 13,500 BTU Rotary
**	The illustrated parts breakdown for this item is provided on the Common Items Fiche.		

## INTERIOR FINISH GROUP

### PANELING AND COUNTERTOP MATERIALS

Key	Part Number	U/M	Description
	068344-04-000	SF	Paneling - Wall - Birch - 48" x 84" (26 SF)
	045963-01-000	SF	Paneling - 825 Buff - Ceiling - 48" x 96" (32 SF)
	072336-14-000	SF	Paneling - Decor - Silk Flowers - 48" x 84" (26 SF) - Blue (P01, P31)
	072336-13-000	SF	Paneling - Decor - Silk Flowers - 48" x 84" (26 SF) - Rose (P02, P32)
	072336-15-000	SF	Paneling - Decor - Silk Flowers - 48" x 84" (26 SF) - Carmel (P03, P33)
	072336-06-000	SF	Paneling - Decor - Willows - 48" x 84" (26 SF) (Bath)
	057680-04-000	SF	Pluswood Board - Birch (Door Asm.)
	069731-02-000	SF	Plastic Laminate - Almond - 48" x 96" (32 SF) (Galley)
	069731-02-019	EA	Plastic Laminate - Almond - 1.19" x 96"
	072337-02-000	SF	Plastic Laminate - Travertine - 48" x 96" (32 SF) (Bath)
	072337-02-019	EA	Plastic Laminate - Travertine - 1.19" x 96"

### INTERIOR MOLDINGS AND TRIMS

Key	Part Number	U/M	Description
	024700-17-000	EA	Cover - Sidewall Roll Bar - Beige
	042430-01-000	EA	Molding - Shelf - Wood
	009812-10-000	FT	Molding - Outside Corner - .50" - Birch
	009812-08-000	FT	Molding - Outside Corner - .50" - Teak
	009809-10-000	FT	Molding - Outside - 1" - Birch
	009767-06-000	FT	Welling - Beige
	009815-03-000	FT	T-Molding - .75" - Light Brown
	022992-08-000	FT	Molding - Reverse Cove - Champagne White
	070504-02-000	FT	U-Channel - .815" - Light Brown
	009778-03-000	FT	U-Channel - 1" - Light Brown
	009779-03-000	FT	U-Channel - 1.125" - Light Brown
	052859-01-P01	FT	Accent Trim - Medium Almond Vinyl (Beige)
	059352-01-000	FT	Insert - Vinyl - Style and Rail Door
	047354-01-000	EA	Batt Strip - Ceiling - 825 Buff - 8'
	064386-01-000	EA	Batt Strip - Birch - 8'
	069733-15-000	EA	Batt Strip - Silk Flowers - 8' - Blue (P01, P31)
	069733-14-000	EA	Batt Strip - Silk Flowers - 8' - Rose (P02, P32)
	069733-16-000	EA	Batt Strip - Silk Flowers - 8' - Carmel (P03, P33)
	069733-18-000	EA	Batt Strip - Willow - 8' (Bath)
	064382-01-000	FT	Extrusion - Plastic Trim - Rolled Door
	042356-01-000	EA	Plug - Button - Mahogany - 3/8" Diameter

### FABRICS AND CARPET

Key	Part Number	U/M	Description
	072333-02-000	YD	Fabric - Drapery - Ivory (Sheers)
	072333-05-000	YD	Fabric - Drapery - Off White
	072334-31-000	YD	Fabric - Drapery/Accent - Blue Smoke (P01, P31)
	072334-24-000	YD	Fabric - Upholstery/Accent - Mocha (P02, P32)
	072334-26-000	YD	Fabric - Upholstery/Accent - Burnt Sienna (P03, P33)
	072334-25-000	YD	Fabric - Upholstery - Beige (P01, P31)
	072334-28-000	YD	Fabric w/Pattern - Upholstery - Horizon (P01, P31)
	072334-27-000	YD	Fabric w/Pattern - Upholstery - Plum (P02, P32)
	072334-29-000	YD	Fabric w/Pattern - Upholstery - Sienna (P03, P33)
	038421-01-000	YD	Fabric - Mattress Ticking
	072872-01-000	YD	Trim - Drapery - Jute/Beige
	052859-01-N01	FT	Trim Asm. - Accent - Almond Vinyl (Beige)
	070502-01-000	YD	Vinyl - Non-Expanded - 12 Gauge Film - Medium Almond (Beige)
	072860-04-000	SY	Carpet - Steel Blue (P01, P31)
	072860-02-000	SY	Carpet - Shadowesque (Light Brown) (P02, P32)
	068340-03-000	SY	Carpet - Cinnamon (Rust) (P03, P33)

## 1983 WINNEBAGO TABLE OF CONTENTS

WC420RG	A-1 - B-22
WC424RB	B-23 - E-4
WCF26RH	E-5 - G-8
WCF26RB	G-9 - I-14

## 1983 WCF26RB INDEX

Floor Plan	G-9 - G-10
Accessories Group	G-11 - G-13
Bath Group	G-14 - G-15
Chassis Group	G-16 - G-17
Curtain, Cushion & Pad Group	G-18 - G-24
Dinette Group	H-1 - H-4
Driver's Compartment Group	H-5 - H-7
Electrical Group	H-8 - H-10
Exterior Body Group	H-11 - H-15
Galley Group	H-16 - H-17
Heating & Air Conditioning Group	H-18 - H-19
Interior Finish Group	H-20 - H-22
LP Group	H-23
Lounge Group	H-24
Water & Sewage Group	I-1 - I-2
Window, Vent & Exterior Door Group	I-3 - I-14

# INTERIOR FINISH GROUP (CONTINUED)

## MISCELLANEOUS PARTS

Key	Part Number	U/M	Description
	053552-01-N07	EA	Handle Asm. - Interior Assist - Medium Almond Vinyl
	041944-03-000	EA	Fire Extinguisher - w/Bracket - 5BC - (Calif.)
	054185-19-000	EA	Owner's Manual - Itasca - Winnebago
	007038-01-000	EA	Door Mat - Black Rubber - 10 1/2" x 26"
	085201-01-000	EA	Lamp Shade - Fabric - White Flax
	045588-02-000	EA	Wood Spindle - Galley - 1.75" x 24"
	063951-01-000	EA	Door Asm. - Battery - w/o Carpet
	042541-01-000	EA	Latch Asm. - w/Strike Chrome (Battery Door)

## CURTAIN HARDWARE

Key	Part Number	U/M	Description
	052327-05-009	EA	Track - Curtain Beige Alum. - 76" w/Holes
	056116-01-000	EA	Track - Curtain - Brown Plastic
	059430-05-000	EA	Track - Curtain - Front Wraparound (2 per unit) - 43.75" x 36" - Beige
	059430-07-000	EA	Track - Curtain - Front Wraparound - 32.8" x 89.1" (Drivers Door) Beige
	056001-01-000	EA	Bracket - Shade - Left
	056002-01-000	EA	Bracket - Shade - Right
	056003-01-000	EA	Bracket - Drapery Retainer - Right
	056003-02-000	EA	Bracket - Drapery Retainer - Left
	056003-03-000	EA	Bracket - Drapery Retainer - Universal
	009107-01-000	EA	Guide - Nylon Snap - Curtain
	056784-01-000	EA	Pull - Window Shade - Antique Brass
	039175-01-000	EA	Curtain Rod - Ext. 48" - 84"
	039175-03-000	EA	Curtain Rod - Ext. 28" - 48"
	039175-04-000	EA	Curtain Rod - Ext. 16" - 28"
	039175-02-000	EA	Bracket - Curtain Rod
	056115-01-000	YD	Tape - Clear Plastic - w/Guides
	048394-01-000	YD	Tape - Hook - 1" x 25 YD - Beige
	048395-01-000	YD	Tape - Loop - 1" x 25 YD - Beige

# INTERIOR FINISH GROUP (CONTINUED)

## CABINETRY AND TABLE HARDWARE

Key	Part Number	U/M	Description
	053200-05-000	EA	Bracket - Upper Wall Mount - Beige - 23.5"
..	053201-03-000	EA	Bracket - Table Mount - 23"
	024275-05-000	EA	Rod - Table Lift - 8" x 23.5" - Beige
	024281-07-000	EA	Bracket - Lower Wall Mount - Beige - 22.12"
	024276-08-000	EA	Leg Asm. - Table - Beige - 29.5"
	064050-01-000	EA	Hinge - Table Leg
..	024282-01-000	EA	Brace - Table Leg
..	024283-01-000	EA	Clip - 1" O.D. Tube
	049493-03-000	EA	Catch - Table Leg - Mounts on Floor - Beige
..	057898-01-000	EA	Latch - Hidden - Cabinet Door
..	057898-02-000	EA	Strike - Hidden Latch - Cabinet Door
	009112-01-000	EA	Flange - 1" - Chrome - Closet Rod
	059753-01-000	EA	Slide - Drawer - Left
	059753-02-000	EA	Slide - Drawer - Right
	009049-01-000	EA	Table Support - Drop Leaf
	009059-01-000	EA	Hinge - 2" - Gold
..	037688-01-000	FT	Rail - Drawer
..	047744-01-000	EA	Kit - Drawer Glide
	057671-01-000	EA	Screw Cover - #8 - Off White
	072369-02-000	EA	Mesh - Grille - Brass - 13.8" x 8.8" - Furnace Grill
	009040-02-000	EA	Leg - Pedestal Table - 27.5" x 2.25" O.D. - Chrome
	009040-03-000	EA	Base - Table Leg - Mounts on Table
	041194-01-000	EA	Base - Table Leg - Mounts in Floor
	062046-01-000	EA	Clip - Leg Pedestal
	058335-02-000	EA	Latch - Bathroom Door w/o Lock
	009050-01-000	EA	Warp Guard - 64"
	009051-01-000	EA	Warp Guard - 48"
	009021-01-000	EA	Catch - Nylon - Furnace Door
	009021-02-000	EA	Strike - Nylon Catch - Furnace Door
..	052932-01-J30	EA	Hinge Kit - Cabinet Door - Antique Brass
..	041939-01-000	EA	Hinge Kit - Double Acting - Overhead Door
..	The illustrated parts breakdown for this item is provided on the Common Items Fiche.		

## 1983 WINNEBAGO TABLE OF CONTENTS

WC420RG	A-1 - B-22
WC424RB	B-23 - E-4
WCF26RH	E-5 - G-8
WCF26RB	G-9 - I-14

## 1983 WCF26RB INDEX

Floor Plan	G-9 - G-10
Accessories Group	G-11 - G-13
Bath Group	G-14 - G-15
Chassis Group	G-16 - G-17
Curtain, Cushion & Pad Group	G-18 - G-24
Dinette Group	H-1 - H-4
Driver's Compartment Group	H-5 - H-7
Electrical Group	H-8 - H-10
Exterior Body Group	H-11 - H-15
Galley Group	H-16 - H-17
Heating & Air Conditioning Group	H-18 - H-19
Interior Finish Group	H-20 - H-22
LP Group	H-23
Lounge Group	H-24
Water & Sewage Group	I-1 - I-2
Window, Vent & Exterior Door Group	I-3 - I-14

## LP GROUP

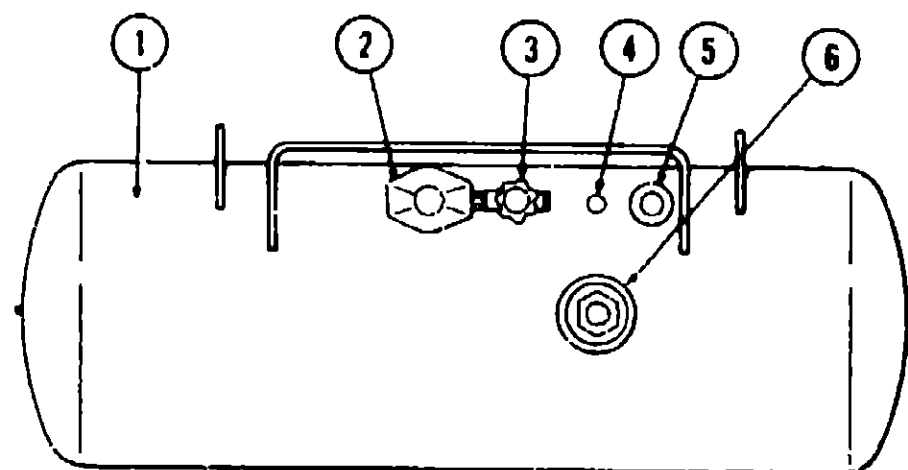

Key	Part Number	U/M	Description
1	052769-01-000	EA	Tank Asm. - LP - Frame Mount - 42 Pound - 12" x 28"
1	074142-01-000	EA	Tank Asm. - LP - Frame Mount - 80 Pound - 13" x 44"
1	065741-01-000	EA	Detector - LP Gas Leak - Marshalltown Instruments
2	058706-01-000	EA	Cover - Regulator - Two Stage
1	058705-01-000	EA	Regulator - Two Stage - LP Gas
3	040421-01-703	EA	Valve - Vapor Relief
4	040421-01-700	EA	Gauge - Liquid Level - 20% LP
5	040421-01-701	EA	Valve - Filler - LP
1	040421-01-702	EA	Cap - Plastic Fill Valve
6	040421-01-707	EA	Gauge - Float - w/Visible Dial - 80 Pound Tank
1	040421-01-706	EA	Dial - Visible Face - Float Gauge (Tank w/o Electric Transmitter)
1	040440-01-000	EA	Dial - Transmitter - 0 - 90 Ohm (Float Gauge)
1	045703-01-000	EA	Hose Asm. - LP - 3/8" I.D. x 24" - US
1	045703-02-000	EA	Hose Asm. - LP - 3/8" I.D. x 24" - CSA
1	045703-03-000	EA	Hose Asm. - LP - 3/8" I.D. x 14" - US
1	045703-04-000	EA	Hose Asm. - LP - 3/8" I.D. x 14" - CSA
1	047737-02-000	EA	Support - LP Tank - 89.25"
1	047737-03-000	EA	Support - LP Tank - 30.50"
1	053112-02-000	EA	Bracket - LP Support
1	068046-01-000	EA	Conversion Kit - LP - Onan Generator
1	Not illustrated		

## WINN AIR WITH LANDI-HARTOG (A-BODY)

Key	Part Number	U/M	Description
	065279-01-000	EA	Relief Valve - Hydrostatic
	065287-02-000	EA	Valve - Gasoline Shut-Off
	065820-02-000	EA	Hose Asm. - High Pressure - 36"
	065820-03-000	EA	Hose Asm. - High Pressure - 71"
	065820-04-000	EA	Hose Asm. - High Pressure - 25"
	067290-01-000	EA	Hose - Vapor 5/8" x 51"
	068050-07-000	EA	LP Mixer (350 Engine)
	068050-12-000	EA	LP Mixer (454 Engine)
	068197-01-000	EA	Instrument Asm. - LP
	068144-01-000	EA	Bracket - Angle - Converter
	068142-01-000	EA	Tube Asm. - Converter - Copper w/Flare Nuts - 5/16" x 270° Bend
	065802-01-000	EA	Gauge - LP Level w/Hardware
	068050-05-000	EA	Switch - LP/Gas Changeover
	068050-01-000	EA	Converter - LP
	068050-02-000	EA	LP Lock Off
	068050-03-000	EA	Switch - LP - Vacuum Safety

## LOUNGE GROUP

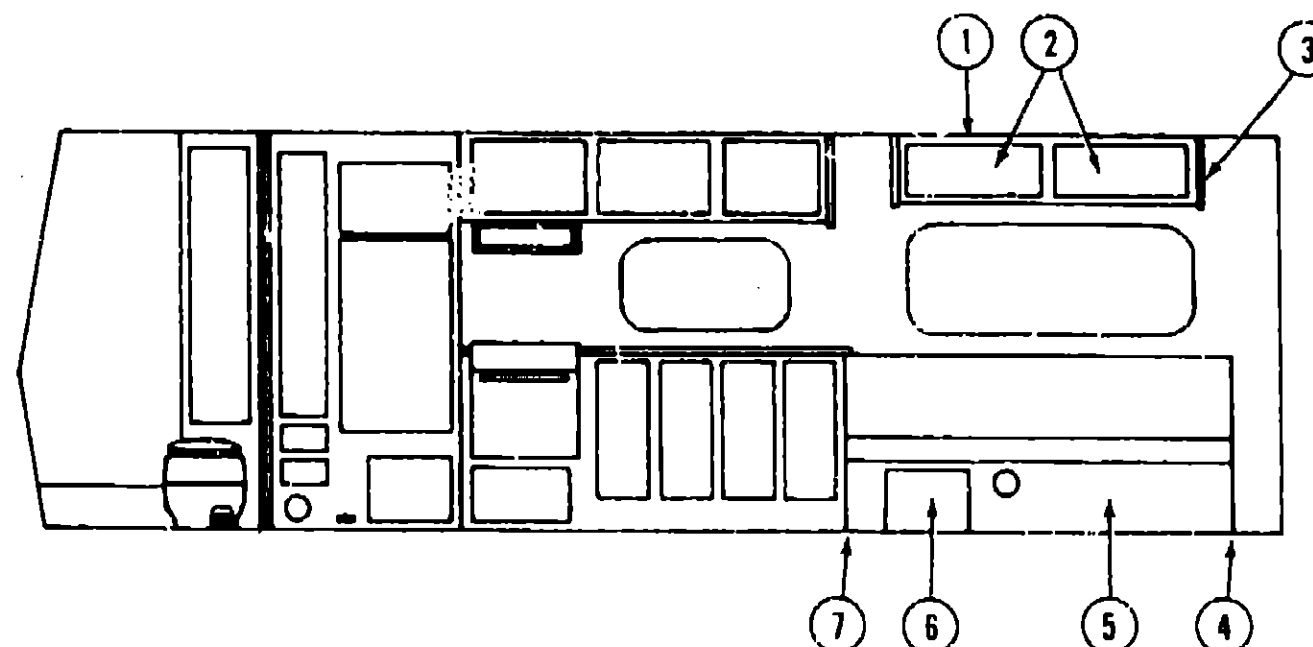

## SPRING COUCH

Key	Part Number	U/M	Description
1	074977-03-P01	EA	Cabinet Asm. - Overhead - Lounge - w/o Doors or Hardware
2	069852-05-P01	EA	Door Asm. - Overhead Cabinet - 11.5" x 28.2" - w/o Hardware
3	071846-01-P01	EA	Pad - End - Lounge Overhead Cabinet - Right - Belge Vinyl
4	057618-01-P01	EA	End Panel - Sprung Couch - Right
5	070633-01-P01	EA	Front Panel Asm. - Sprung Couch - w/o Door or Hardware
6	M69856-01-P01	EA	Door Asm. - Furnace - w/Mesh Insert - 13" x 18" - w/o Hardware
7	059750-01-P01	EA	End Panel - Sprung Couch - Left
1	072369-02-000	EA	Gold Mesh - 13.8" x 8.8" - Furnace Grill
1	057468-02-000	EA	Base Asm. - Sprung Couch - Right
1	057468-03-000	EA	Base Asm. - Sprung Couch - Left
1	057468-04-000	EA	Base Asm. - Spacers - Sprung Couch - 2 per Couch
1	057469-01-000	EA	Leg Asm. - Sprung Couch - 2 per Couch
1	053248-02-P01	EA	Table Asm. - Pedestal - w/o Hardware - Almond
1	009040-02-000	EA	Leg - Pedestal Table - 27.5" x 2.25" O.D. - Chrome
1	009040-03-000	EA	Base - Table - Mounts on Table
1	041194-01-000	EA	Base - Table - Mounts in Floor
1	062046-01-000	EA	Clip - Pedestal Leg
1	056093-01-P01	EA	Plug Asm. - Pedestal Table (P31)
1	056093-01-P02	EA	Plug Asm. - Pedestal Table (P32)
1	057793-01-P03	EA	Plug Asm. - Pedestal Table (P33)
1	Not illustrated		

## 1983 WINNEBAGO TABLE OF CONTENTS

WC420RG  
WC424RB  
WCF26RH  
WCF26RB

A-1 - B-22  
B-23 - E-4  
E-5 - G-8  
G-9 - I-14

## 1983 WCF26RB INDEX

Floor Plan	G-9 - G-10
Accessories Group	G-11 - G-13
Bath Group	G-14 - G-15
Chassis Group	G-16 - G-17
Curtain, Cushion & Pad Group	G-18 - G-24
Dinette Group	H-1 - H-4
Driver's Compartment Group	H-5 - H-7
Electrical Group	H-8 - H-10
Exterior Body Group	H-11 - H-15
Galley Group	H-16 - H-17
Heating & Air Conditioning Group	H-18 - H-19
Interior Finish Group	H-20 - H-22
LP Group	H-23
Lounge Group	H-24
Water & Sewage Group	I-1 - I-2
Window, Vent & Exterior Door Group	I-3 - I-14

## WATER & SEWAGE GROUP

### PLUMBING AND REPAIR PARTS

Key	Part Number	U/M	Description
	045729-01-000	EA	Pump - Water - 2.8 G.P.M. - Direct Drive - Shurflo - US
	045729-02-000	EA	Pump - Water - 2.8 G.P.M. - Direct Drive - Shurflo - CSA
	039647-02-000	EA	Filter - Water Pump - 1/2" MPT
	039647-03-000	EA	Filter - Water Pump - 1/2" Flare
	052959-03-000	EA	Connector - 1/2 F x 3/8 MPT - Plastic
	052960-01-000	EA	Drain Valve - 1/2 F x 1/2 F - Plastic
	052961-01-000	EA	Header - 1/2 F x 1/2 F x 1/2 F x 1/2 F
**	046524-02-000	EA	Kit - Water Tank Fittings - Blank Tank
**	046524-01-000	EA	Kit - Holding Tank Fittings - Blank Tank
**	010079-01-000	EA	Tee - Plastic - 1 1/2 H x 1 1/2 H x 1 1/4 H
**	010121-01-000	EA	Bushing - Plastic - 1 1/2 S x 1 1/4 H
**	010133-01-000	EA	Trap Adapter - Plastic - 1 1/2 H x MPT
	052954-01-000	EA	Adapter - Nose Cone - 5/8 or 1/2 - Plastic
**	010201-01-000	EA	Sewer Hose - 3" x 8' w/Clamp
**	050780-01-000	EA	Coupler Rubber - 3" x 3"
	062415-01-000	EA	Cap - Sewer - 3"
	062416-01-000	EA	Hose Adapter - 3"
	062417-01-000	EA	Adapter - Termination - 3"
	062418-02-000	EA	Valve - 3" - w/o Handle
	062419-02-000	EA	Handle - Extension - w/6" Adapter
	062421-01-000	EA	Valve - 1 1/2" - w/Handle
**	011066-01-000	EA	P-Trap - 1 1/4" - Plastic
	010071-01-000	EA	Tee - Plastic - 1 1/2" x H x H x H
	010072-01-000	EA	Tee - Plastic - 1 1/2" H x 1 1/4 H x 1 1/2 H
	052956-01-000	EA	Tee - Plastic - 1/2 F x 1/2 MPT x 1/2 F
	052958-01-000	EA	Tee - Plastic - 1/2 F x 1/2 F x 1/2 F
**	053335-01-000	EA	P-Trap - Plastic - 1 1/4 H x H - w/Union
**	011091-01-000	EA	Waste - Continuous - Double Sink - 11 7/8"
	061607-01-000	EA	Grommet - Holding Tank Coupler - 1 1/2"
	061607-02-000	EA	Grommet - Holding Tank Coupler - 3"
	010000-01-000	EA	Elbow - Plastic - 1/8 BD x 1 1/4 x 45° H x H
	010006-01-000	EA	Elbow - Plastic - 1/8 BD x 1 1/2 x 45° H x H
	010051-01-000	EA	Elbow - ST - Plastic - 1/8 BD x 1 1/2 x 45°
	010219-01-000	EA	Elbow - 1 1/4 Barb x 1 1/4 MPT x 90°
	034250-01-000	EA	Elbow - Plastic - 1/4 BD x 1 1/2 x 90° x H x H
	052957-01-000	EA	Elbow - Plastic - 1/2 F x 3/8 MPT
	052957-02-000	EA	Elbow - Plastic - 1/2 F x 1/2 MPT
	065120-01-000	EA	Elbow - Plastic - Swivel - .50"
	070924-01-000	EA	Elbow - Plastic - Swivel - 1/2 MPT x 1/2 FP
	010123-01-000	EA	Bushing - Plastic - 2S x 1 1/2 H
	033302-02-000	EA	Adapter Asm. - SWVC Strain - 1 1/2
	072346-01-000	EA	Valve Asm. - 3" Ell - w/2" Socket
	039800-01-000	FT	Tubing - Polybutyl - 1/2 O.D. (Water Line)
	044928-01-000	FT	Flexible Tubing - 1 1/4 I.D.
	004020-01-000	QT	Adhesive - ABS Cement
	037845-01-000	FT	Tape - Butyl - 3/16" - Bead - Black
	062422-01-000	EA	Adapter - Hose Offset - Reducer - 3" x 1 1/2"
	052962-01-000	EA	Valve - Stool - 90° x 1/2 F x 3/8 MPT
	010147-01-000	EA	Flange - Closet - 4" F x 3" FPT
	010224-01-000	EA	Adapter - Plastic - 3/8 MPT x 3/8 Barb
	007108-01-000	EA	Hose - Heater - 5/8"
	010194-01-000	FT	Pipe - Black - Plastic - 1.25" - ABS
	010195-01-000	FT	Pipe - Black - Plastic - 1.5" - ABS
	010197-01-000	FT	Pipe - Black - 3" - ABS
**	039818-01-000	EA	Riser Asm. - 3/8" O.D. x 24" Tube
**	039818-04-000	EA	Riser Asm. - 3/8" O.D. x 72" Tube
**	039818-05-000	EA	Riser Asm. - 3/8" O.D. x 48" Tube
**	071292-01-000	EA	Regulator - Water Pressure
**	The illustrated parts breakdown for this item is provided on the Common Items Fiche.		

## WATER & SEWAGE GROUP (CONTINUED)

### HOLDING TANKS AND WATER HEATERS

Key	Part Number	U/M	Description
	067333-02-000	EA	Tank Asm. - Water - 51 Gallon - w/Fittings
	067333-01-000	EA	Tank Asm. - Water - 51 Gallon - w/o Fittings
**	064997-01-000	EA	Tank Asm. - Holding - 20 Gallon - w/o Fittings - Waste Water
**	064998-01-000	EA	Tank Asm. - Holding - 33 Gallon - w/o Fittings - Sewage
**	051391-01-000	EA	Water Heater - w/o Motor Aid - G6A3
**	051393-01-000	EA	Water Heater - w/Motor Aid - GH6-3E
**	The illustrated parts breakdown for this item is provided on the Common Items Fiche.		

## 1983 WINNEBAGO TABLE OF CONTENTS

WC420RG	A-1 - B-22
WC424RB	B-23 - E-4
WCF26RH	E-5 - G-8
WCF26RB	G-9 - I-14

## 1983 WCF26RB INDEX

Floor Plan	G-9 - G-10
Accessories Group	G-11 - G-13
Bath Group	G-14 - G-15
Chassis Group	G-16 - G-17
Curtain, Cushion & Pad Group	G-18 - G-24
Dinette Group	H-1 - H-4
Driver's Compartment Group	H-5 - H-7
Electrical Group	H-8 - H-10
Exterior Body Group	H-11 - H-15
Galley Group	H-16 - H-17
Heating & Air Conditioning Group	H-18 - H-19
Interior Finish Group	H-20 - H-22
LP Group	H-23
Lounge Group	H-24
Water & Sewage Group	I-1 - I-2
Window, Vent & Exterior Door Group	I-3 - I-14

## WINDOW, VENT & EXTERIOR DOOR GROUP

### WINDOWS AND ACCESS DOORS

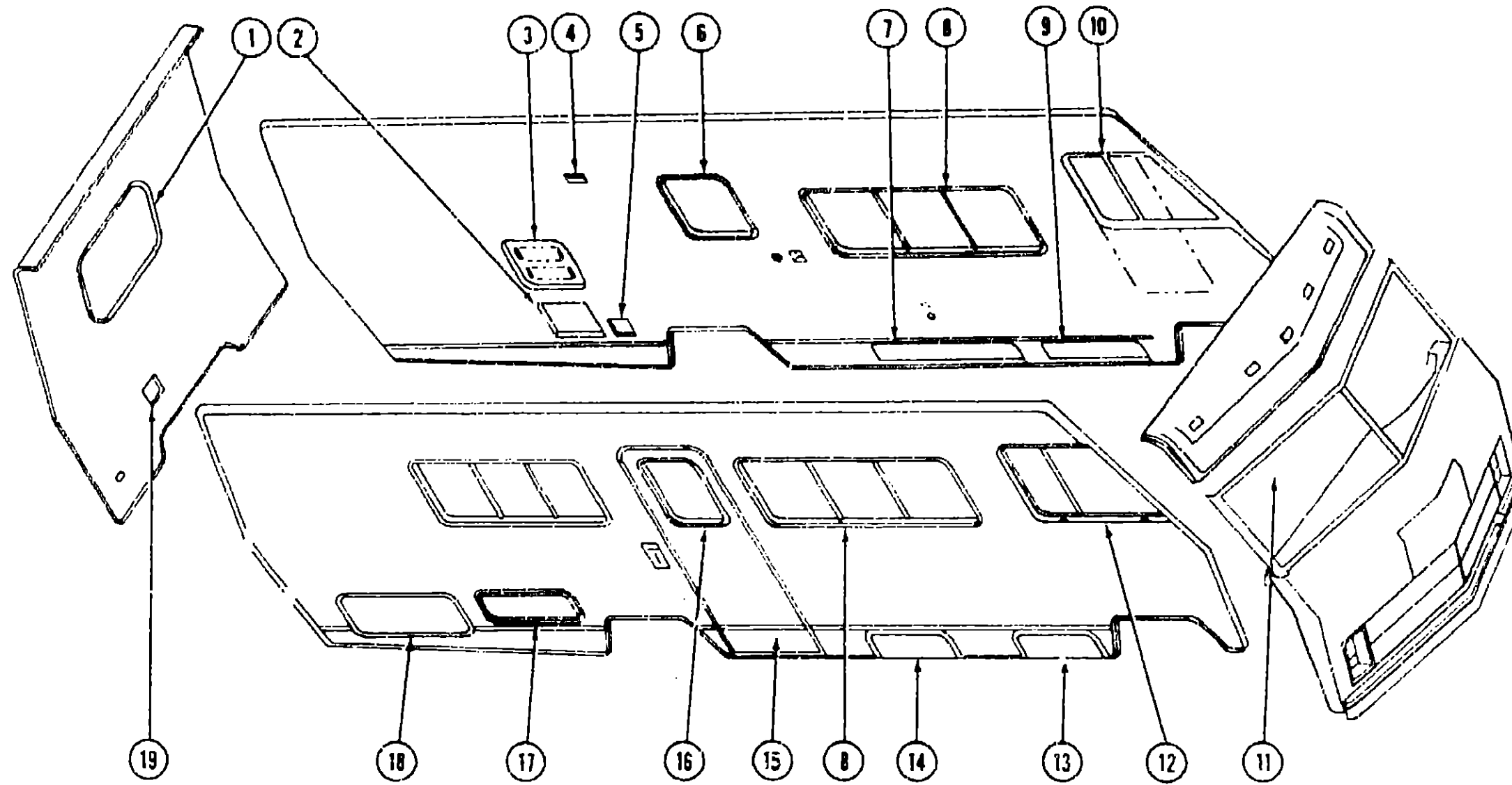

Key	Part Number	U/M	Description
1	020751-03-000	EA	Window Asm. - Rear Escape - 23" x 29"
2	052009-01-000	EA	Door Asm. - Water Heater - Off White
3	069762-02-000	EA	Door Asm. - Refrigerator Access - Off White w/Twist Lock
4	049352-01-000	EA	Vent - Stovehood - Outside - Off White
5	NOTE	EA	Door Asm. - Power Cord (See Access Door)
6	048631-04-000	EA	Window Asm. - 20" x 25" - Black
7	M33333-53-P01	EA	Door Asm. - Luggage - 48" x 9" w/Key Lock
7	M33333-56-P01	EA	Door Asm. - LP Dual Fuel - 48" x 9" w/Twist Lock
8	066785-03-000	EA	Window Asm. - Single Slider - 25" x 65"
9	M33333-55-000	EA	Door Asm. - Spare Tire Compartment - 34.5" x 9" w/Key Lock
10	059046-02-000	EA	Window Asm. - Left Front Slant Slider - 23" x 39"

Key	Part Number	U/M	Description
11	057459-01-000	EA	Glass - Windshield - Flat
12	059046-01-000	EA	Window Asm. - Right Front Slant Slider - 23" x 39"
13	M33333-54-P01	EA	Door Asm. - Access - 25.3" x 9" w/Key Lock
14	M33333-57-P01	EA	Door Asm. - Access - 25.3" x 9" w/Twist Lock
15	M01126-01-P01	EA	Door Asm. - Radius Entry w/Screen Door
16	041875-09-000	EA	Window Asm. - Picture - 17" x 25"
17	059727-01-000	EA	Door Asm. - Storage - Insulated - 10.36" x 29.9" w/Key Lock
18	047233-02-000	EA	Door Asm. - Luggage - 13.5" x 35.5" - Off White w/Key Lock
18	M00685-07-000	EA	Door Asm. - Generator - Off White w/o Baffle
19	NOTE	EA	Door Asm. - Fuel Fill (See Access Doors)

## 1983 WINNEBAGO TABLE OF CONTENTS

WC420RG  
WC424RB  
WCF26RH  
WCF26RB

A-1 - B-22  
B-23 - E-4  
E-5 - G-8  
G-9 - I-14

## 1983 WCF26RB INDEX

Floor Plan	G-9 - G-10
Accessories Group	G-11 - G-13
Bath Group	G-14 - G-15
Chassis Group	G-16 - G-17
Curtain, Cushion & Pad Group	G-18 - G-24
Dinette Group	H-1 - H-4
Driver's Compartment Group	H-5 - H-7
Electrical Group	H-8 - H-10
Exterior Body Group	H-11 - H-15
Galley Group	H-16 - H-17
Heating & Air Conditioning Group	H-18 - H-19
Interior Finish Group	H-20 - H-22
LP Group	H-23
Lounge Group	H-24
Water & Sewage Group	I-1 - I-2
Window, Vent & Exterior Door Group	I-3 - I-14

# WINDOW, VENT & EXTERIOR DOOR GROUP (CONTINUED)

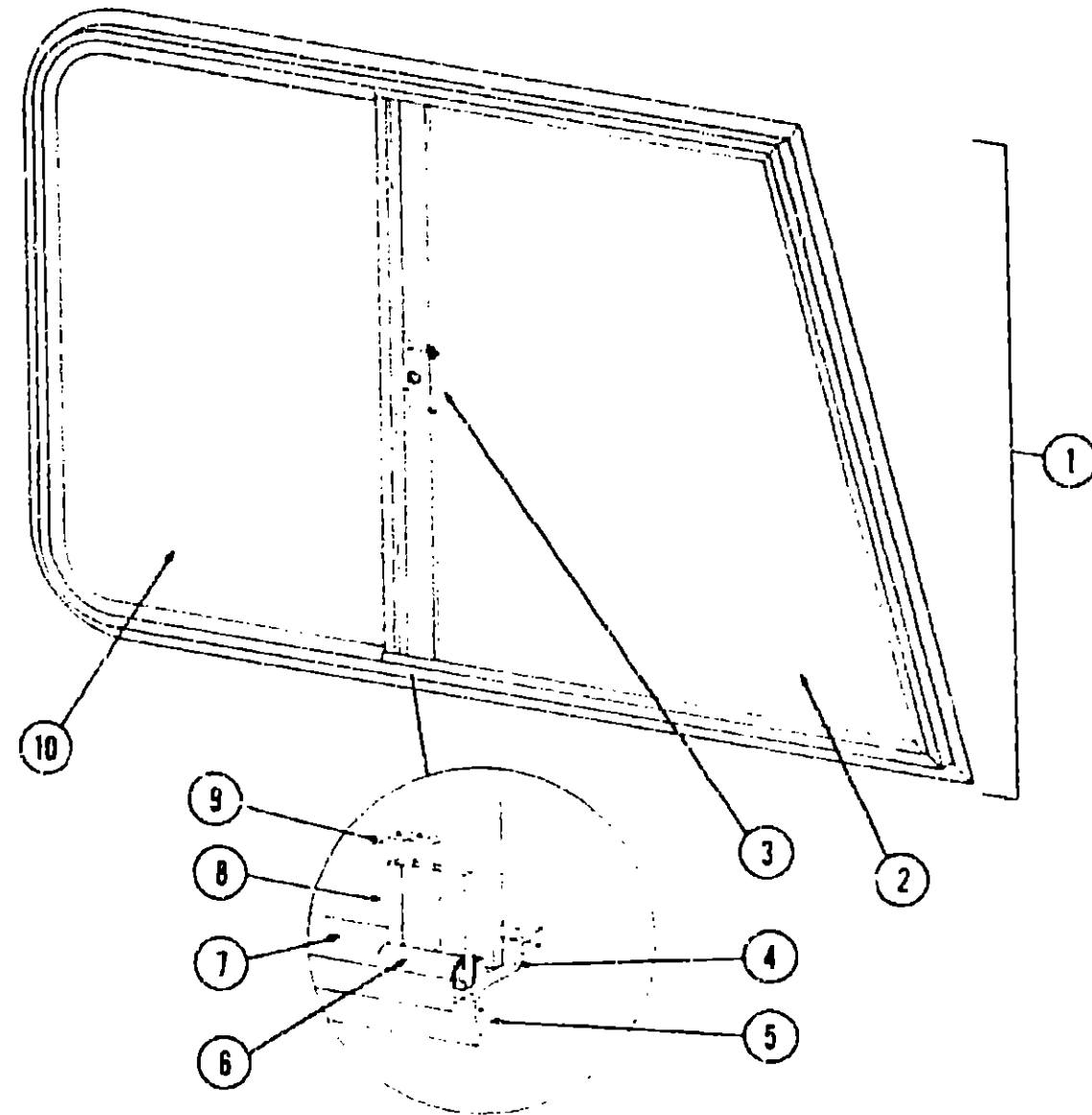

Key	Part Number	U/M	Description
1	059046-01-000	EA	Window Asm. - Right Front Slant Slider - 23" x 39" - Black (w/o inside frame)
1	059046-02-000	EA	Window Asm. - Left Front Slant Slider - 23" x 39" - Black (w/o inside frame)
2	057656-01-000	EA	Glass - 3/16" x 24.88" x 25.30" - Stationary
3	047369-01-700	EA	Latch - Window - Plastic w/Fastener
•	023320-01-000	EA	Pad - Foam - 3/8" Dia. (used with plastic latch)
4	042077-01-000	FT	Channel - Weatherstrip - Glass Run - 3/16" Glass
5	069640-02-000	FT	Tape - 1/2" x 1/8" x 20' - Gray - 3M
6	050216-02-000	FT	Spline - Glass - 1/8" Material - Black
7	041928-02-000	FT	Seal - Window Channel - 3/16" Glass - Black
8	002389-03-206	EA	Holder - Glass Seal - Black - 24.13"
9	057544-04-000	EA	Mullion - Window - Slant Slider
10	057657-01-000	EA	Glass - 3/16" x 24.88" x 14.70" - Sliding
•	073740-01-000	FT	Seal - Fin - Pile - .460"
•	059042-03-000	EA	Inside Frame - Right Front Slant Slider - Beige (not included in assembly)
•	059042-04-000	EA	Inside Frame - Left Front Slant Slider - Beige (not included in assembly)
•	023713-02-000	EA	Cover - Weephole - Black
•	055164-05-000	EA	Slider Screen Asm. - Right or Left - Black
•	016310-03-000	EA	Handle - Slider Screen - Black
•	002292-01-000	SF	Screen - Window - 20" - Gray
•	002298-01-000	FT	Spline - Gray - .130" Dia.
•	Not illustrated		

# WINDOW, VENT & EXTERIOR DOOR GROUP (CONTINUED)

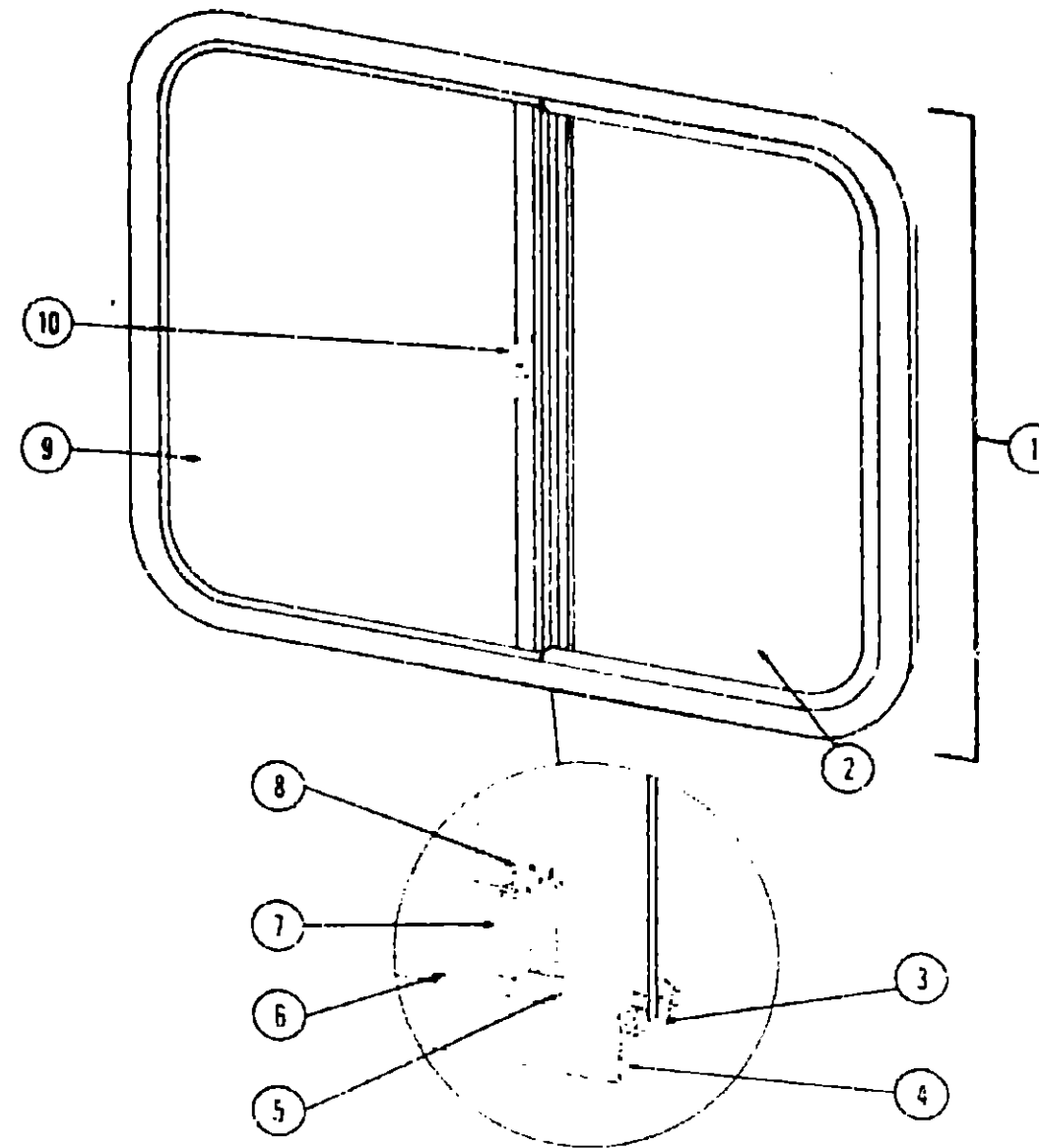

Key	Part Number	U/M	Description
1	048631-04-000	EA	Window Asm. - Left - Single Slider - 20" x 25" - Black (w/o inside frame)
•	042147-12-000	EA	Inside Frame - Beige (not included in assembly)
2	002241-02-000	EA	Glass - Stationary - 1/8" x 12.3" x 19"
3	002324-02-000	FT	Channel - Weatherstrip - Glass
4	069640-01-000	FT	Tape - 1/4" Bead x 20' - Gray - 3M
5	057374-02-000	FT	Extr. Vinyl - Window Seal - Black
6	002309-02-000	FT	Spline - Glass - 1/8" Material - Black
7	M69886-03-011	EA	Extr. Holder - Glass Seal - 18.19" - Black
8	041894-12-000	EA	Mullion - Slider Window - 20" - Black
9	047820-01-000	EA	Glass - Sliding - w/Hole - 1/8" x 13.68" x 19"
10	047369-01-000	EA	Latch - Window - Plastic - w/Fastener
•	002293-01-000	SF	Screen - Window - 26" - Gray
•	002298-01-000	FT	Spline - .130" Dia. - Gray (Screen)
•	073740-01-000	FT	Seal - Fin - Pile - .460"
•	Not illustrated		

## 1983 WINNEBAGO TABLE OF CONTENTS

WC420RG  
WC424RB  
WCF26RH  
WCF26RB

A-1 - B-22  
B-23 - E-4  
E-5 - G-8  
G-9 - I-14

## 1983 WCF26RB INDEX

Floor Plan	G-9 - G-10
Accessories Group	G-11 - G-13
Bath Group	G-14 - G-15
Chassis Group	G-16 - G-17
Curtain, Cushion & Pad Group	G-18 - G-24
Dinette Group	H-1 - H-4
Driver's Compartment Group	H-5 - H-7
Electrical Group	H-8 - H-10
Exterior Body Group	H-11 - H-15
Galley Group	H-16 - H-17
Heating & Air Conditioning Group	H-18 - H-19
Interior Finish Group	H-20 - H-22
LP Group	H-23
Lounge Group	H-24
Water & Sewage Group	I-1 - I-2
Window, Vent & Exterior Door Group	I-3 - I-14

# WINDOW, VENT & EXTERIOR DOOR GROUP (CONTINUED)

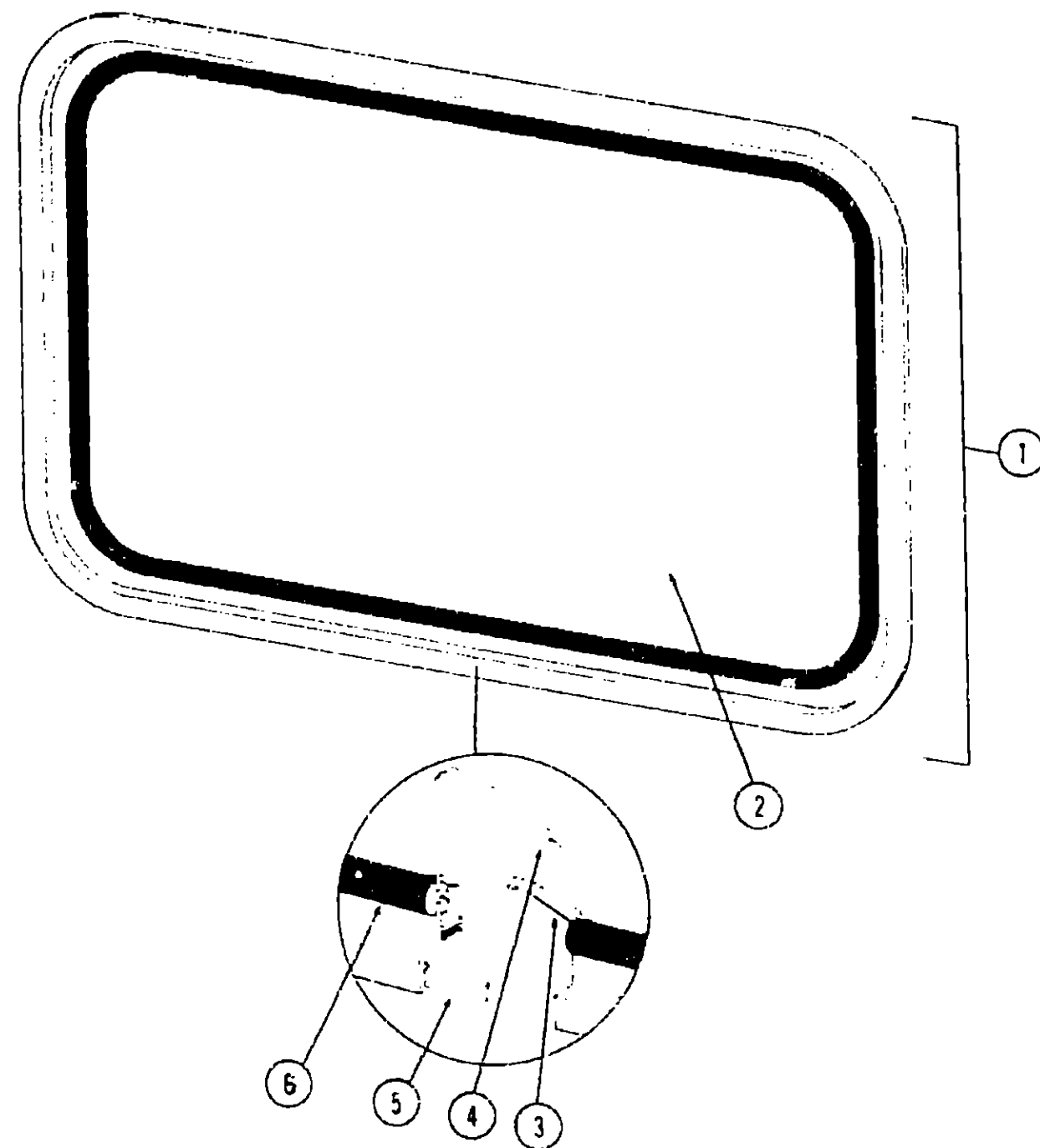

Key	Part Number	U/M	Description
1	020751-03-000	EA	Window Asm. - Rear Escape - 23" x 29" - Black (w/o inside frame)
2	002174-01-000	EA	Glass - 1/8" x 19.6" x 25/9"
3	002265-01-000	FT	Filler - Weatherstrip - Black
4	020395-01-000	EA	Pull Ring - Escape Window
5	053767-02-000	FT	Tape - 3/16" Bead x 25' - Gray
6	002282-01-000	FT	Weatherstrip - .125" Window
.	006199-01-000	EA	Label - Exit - Escape Window
.	Not illustrated		

# WINDOW, VENT & EXTERIOR DOOR GROUP (CONTINUED)

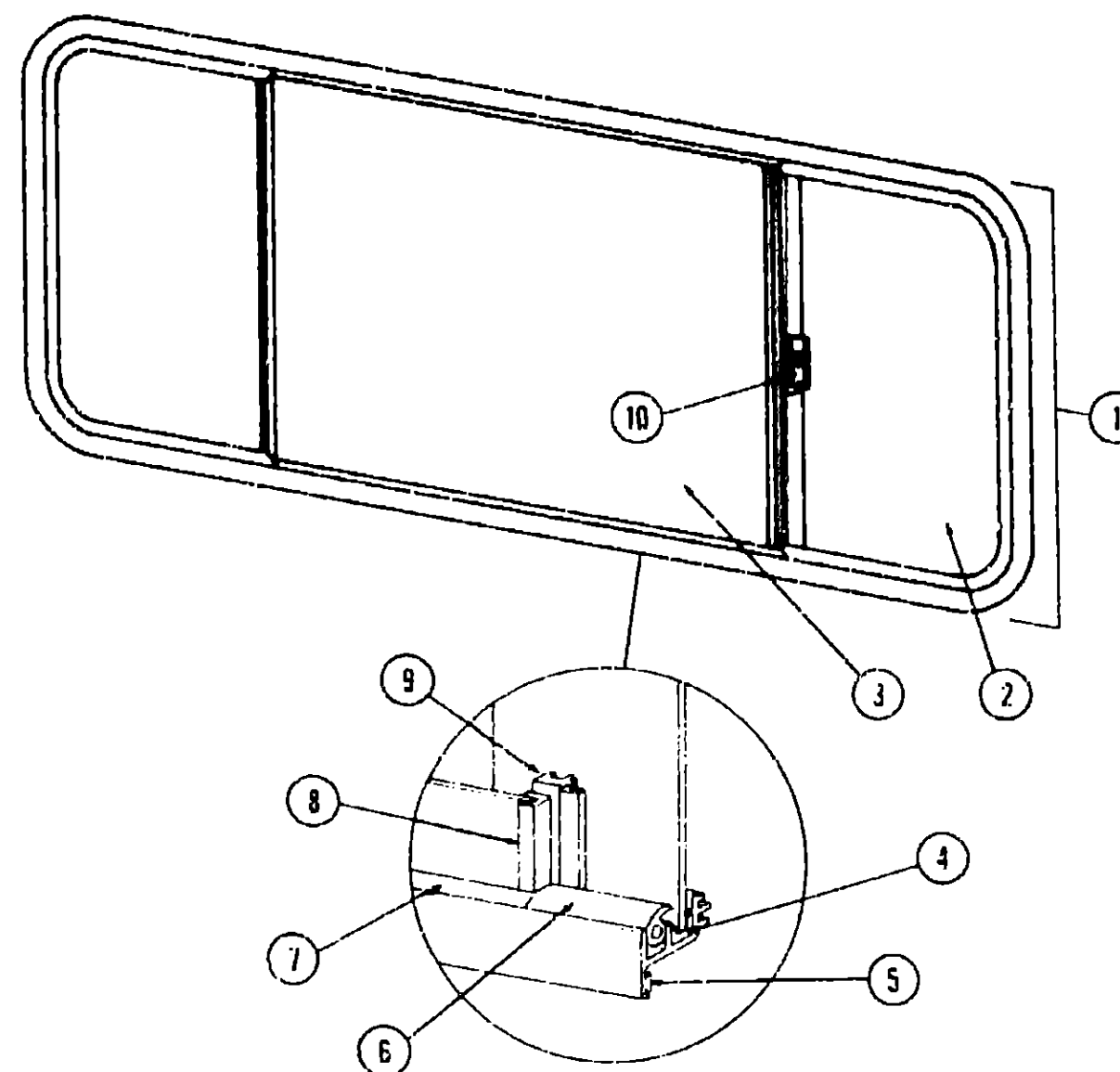

Key	Part Number	U/M	Description
1	066785-03-000	EA	Window Asm. - Single Slider - 25" x 65"
.	067609-06-000	EA	Inside Frame - Beige (not included in assembly)
2	066726-02-000	EA	Glass - Stationary - 1/8" x 21.3" x 24"
3	066727-02-000	EA	Glass - Sliding - 1/8" x 12" x 24"
4	002324-02-000	FT	Channel - Weatherstrip - Glass
5	069640-01-000	FT	Tape - 1/4" Bead x 20' - Gray - 3M
6	057374-02-000	FT	Extr. Vinyl - Window Seal - Black
7	002309-02-000	FT	Spline - Glass - 1/8" Material - Black
8	069886-03-001	EA	Extr. Holder - Glass Seal - 23.9" - Black
9	069896-02-000	EA	Mullion - Slider Window - Black
10	047369-01-700	EA	Latch - Window - Plastic - w/Fastener
.	002293-01-000	SF	Screen - Window - 26" - Gray
.	002298-01-000	FT	Spline - .130" Dia. - Gray (Screen)
.	073740-01-000	FT	Seal - Fin - Pile - .460"
.	Not illustrated		

## 1983 WINNEBAGO TABLE OF CONTENTS

WC420RG	A-1 - B-22
WC424RB	B-23 - E-4
WCF26RH	E-5 - G-8
WCF26HB	G-9 - I-14

## 1983 WCF26RB INDEX

Floor Plan	G-9 - G-10
Accessories Group	G-11 - G-13
Bath Group	G-14 - G-15
Chassis Group	G-16 - G-17
Curtain, Cushion & Pad Group	G-18 - G-24
Dinette Group	H-1 - H-4
Driver's Compartment Group	H-5 - H-7
Electrical Group	H-8 - H-10
Exterior Body Group	H-11 - H-15
Galley Group	H-16 - H-17
Heating & Air Conditioning Group	H-18 - H-19
Interior Finish Group	H-20 - H-22
LP Group	H-23
Lounge Group	H-24
Water & Sewage Group	I-1 - I-2
Window, Vent & Exterior Door Group	I-3 - I-14



# WINDOW, VENT & EXTERIOR DOOR GROUP (CONTINUED)

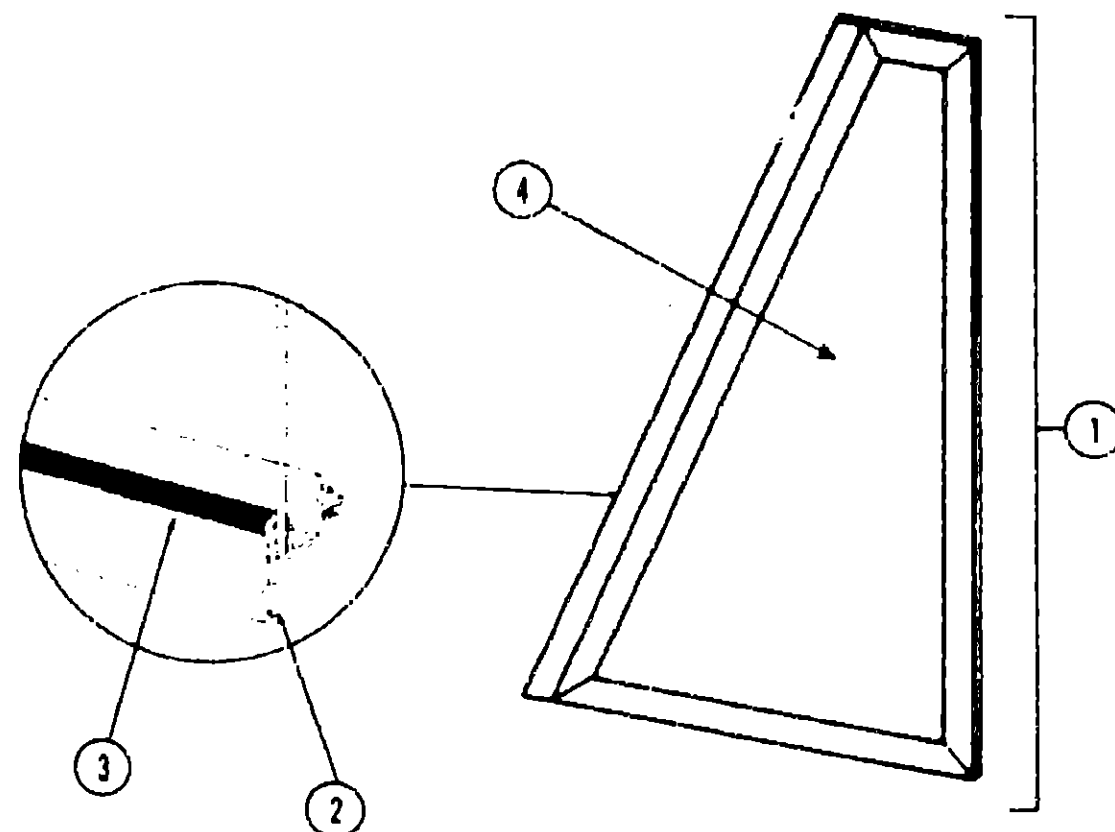

Key	Part Number	U/M	Description
1	062896-01-000	EA	Window Asm. - Stationary - Drivers Slant - 14" x 25.32"
2	069640-01-000	FT	Tape - 1/4" Bead x 20' - Gray - 3M
3	002309-02-000	FT	Spline - Glass - 1/8" - Black
4	057656-02-000	EA	Glass - 3/16" x 24.88" x 13.66"
*	063420-02-000	EA	Inside Frame - Front Slant Window - Beige (not included in assembly)
*	Not illustrated		

# WINDOW, VENT & EXTERIOR DOOR GROUP (CONTINUED)

## ACCESS DOORS

Key	Part Number	U/M	Description
	059727-01-000	EA	Door Asm. - Insulated - 10.38" x 29.9" - Off White w/Key Lock
	047233-02-000	EA	Door Asm. - Luggage - 13.5" x 35.5" - Off White w/Key Lock
	052009-01-000	EA	Door Asm. - Water Heater - Off White
	069762-02-000	EA	Door Asm. - Refrigerator Access - Off White w/Twist Lock
	M33333-56-P01	EA	Door Asm. - LP Dual Fuel - 48" x 9" - w/Twist Lock
	M33333-53-P01	EA	Door Asm. - Luggage - 48" x 9" - w/Key Lock
	M33333-54-P01	EA	Door Asm. - Access - 25.3" x 9" - w/Key Lock
	M33333-55-P01	EA	Door Asm. - Spare Tire Compartment - 34.5" x 9" - w/Key Lock
	M00685-07-000	EA	Door Asm. - Generator - Off White w/o Baffle
	052423-01-000	EA	Door - Fuel Fill - Off White
	052424-01-000	EA	Jamb - Power Cord/Fuel Fill Door - Off White
	063742-01-000	EA	Door - Power Cord - Off White
	054543-01-000	EA	Hatch - Power Cord Door
	042441-01-000	EA	Lock Asm. - Key Type - Gas Fill
	052950-03-700	EA	Lock Asm. - Twist Type - Straight Cam (Power Cord Door)
	047305-01-000	EA	Lock Asm. - Key Type w/Clip - Metal
	052950-01-700	EA	Lock Asm. - Twist Type w/Clip - White Plastic
	052181-01-000	EA	Baffle - Generator Door
	016945-02-000	EA	Holder Asm. - Battery and Luggage Door
	054530-01-000	EA	Door Holder

## WINDSHIELD

Key	Part Number	U/M	Description
	057459-01-000	EA	Glass - Windshield - Flat
	058272-01-000	EA	Frame Asm. - Windshield
	038886-01-000	EA	Tape - Butyl - .31" x .31" x 148"

## VENTS

Key	Part Number	U/M	Description
	065103-02-000	EA	Cover - Refrigerator Vent - 9.88" x 20.5" - Plastic
	065103-01-000	EA	Frame Asm. - Refrigerator Vent - 8.17" x 22.94" - Plastic
	071290-02-000	EA	Cover - Refrigerator Vent - 11 5/8" x 24 3/4" - Galv. Steel
	071290-01-000	EA	Frame Asm. - Refrigerator Vent - 7.5" x 25.5" - Galv. Steel
	049352-01-000	EA	Vent - Stovehood - Outside - Off White
**	048789-01-000	EA	Vent Asm. - Roof - Powered - w/o Screen - Alum.
**	048835-01-000	EA	Vent Asm. - Roof - Non Powered - w/o Screen - Alum.
	016335-04-000	EA	Screen Asm. - Roof Vent - Non Powered - Off White
	048695-04-000	EA	Screen Asm. - Roof Vent - Powered - Off White
** The illustrated parts breakdown for this item is provided on the Common Items Fiche.			

## 1983 WINNEBAGO TABLE OF CONTENTS

WC420RG	A-1 - B-22
WC424RB	B-23 - E-4
WCF26RH	E-5 - G-8
WCF26RB	G-9 - I-14

## 1983 WCF26RB INDEX

Floor Plan	G-9 - G-10
Accessories Group	G-11 - G-13
Bath Group	G-14 - G-15
Chassis Group	G-16 - G-17
Curtain, Cushion & Pad Group	G-18 - G-24
Dinette Group	H-1 - H-4
Driver's Compartment Group	H-5 - H-7
Electrical Group	H-8 - H-10
Exterior Body Group	H-11 - H-15
Galley Group	H-16 - H-17
Heating & Air Conditioning Group	H-18 - H-19
Interior Finish Group	H-20 - H-22
LP Group	H-23
Lounge Group	H-24
Water & Sewage Group	I-1 - I-2
Window, Vent & Exterior Door Group	I-3 - I-14

# WINDOW, VENT & EXTERIOR DOOR GROUP (CONTINUED)

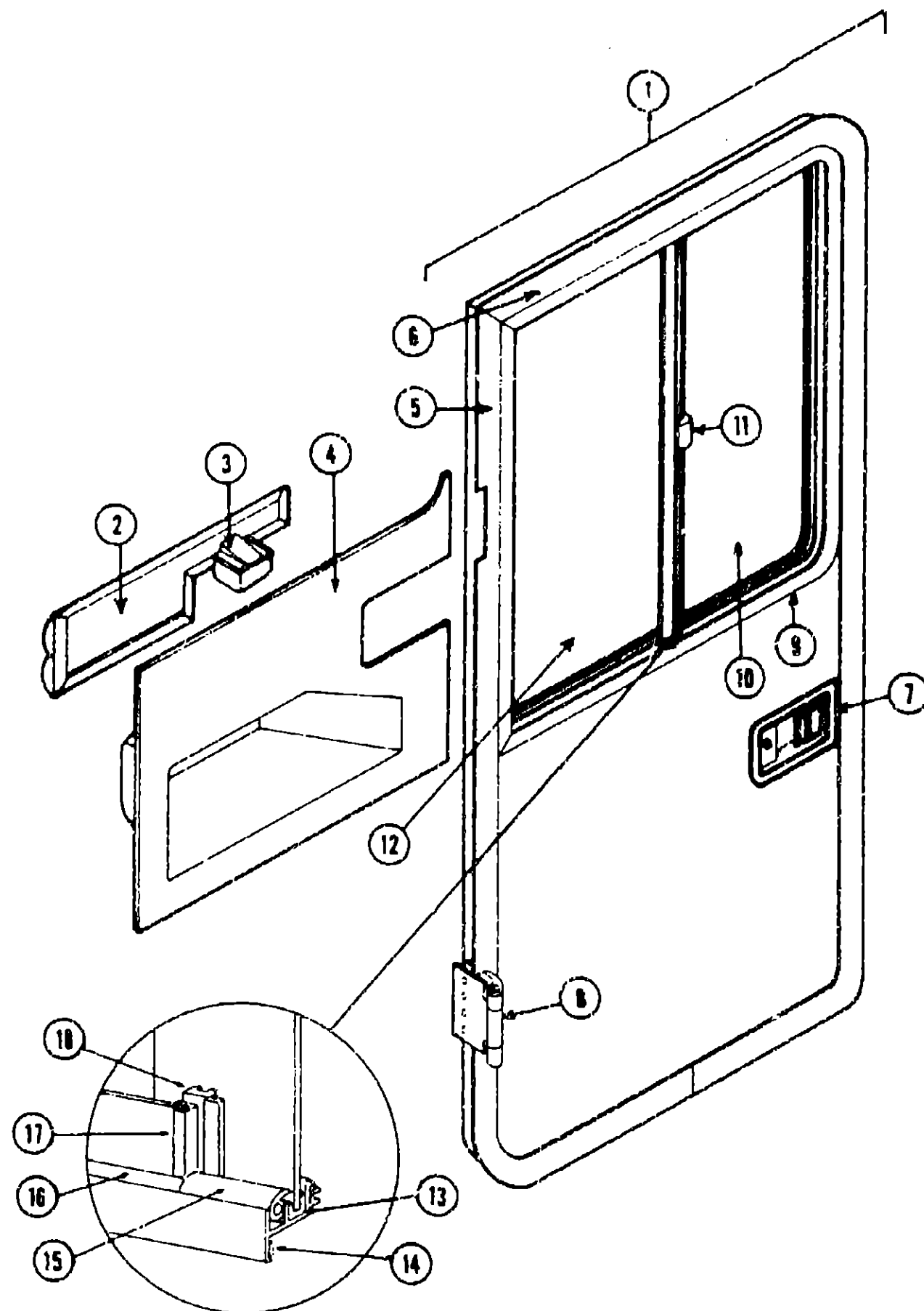

## DRIVER DOOR

Key	Part Number	U/M	Description
1	063991-05-P01	EA	Door Asm. - Driver - Off White
2	064088-02-000	EA	Pad Asm. - Trim - Upper - Beige Vinyl - Drivers Door
3	061400-03-000	EA	Assist Strap - 12" - Beige Vinyl
4	046886-01-000	EA	Assist Asm. - Flush Mount - Chrome
5	064499-02-000	EA	Panel - Driver Door - Inner - Light Oak Plastic
6	063350-02-000	EA	Trim - Door Frame - Front - Off White
7	063351-02-000	EA	Trim - Door Frame - Off White
8	045017-06-000	EA	Paddle - Door Lock - Exterior
9	045017-01-700	EA	Lock Cylinder w/Keys - Lynor
10	039979-02-000	EA	Inside Plate - Door Lock - w/Inside Handle
11	039549-02-000	EA	Latch Claw - Entry Door Lock
12	038738-01-000	EA	Deadbolt - Entrance Door Lock
13	039539-01-000	EA	Strike Bolt - Entrance Door (Jamb Mount)
14	063124-02-000	EA	Plate - Striker - 8 1/4" x 1" - Black
15	062879-01-000	EA	Jamb - Driver Door
16	064199-05-000	EA	Trim - Door Jamb - Rear - w/Drip Cap - Off White
17	064184-01-000	EA	Drip Cap - Driver Door
18	063358-05-000	EA	Trim - Door Jamb - Front - Off White
19	063768-01-000	EA	Sill Plate - Driver Door
20	063993-02-000	EA	Hinge Asm. - Driver Door - Off White
21	063993-04-000	EA	Hinge Asm. - Driver Door - Black
22	064580-01-000	EA	Check Strap - Driver Door - Seat Belt Webbing
23	064219-01-000	EA	Retainer - Driver Door Check Strap
24	063886-03-000	EA	Assist Handle - Driver Door - Beige - Steel Tube (2 required per door)
25	064075-01-000	EA	Bulb Seal - Driver Door - 145"
26	062982-01-000	EA	Window Asm. - Driver Door - Single Slider - 23" x 25.5" - Black (w/o inside frame)
27	057657-02-000	EA	Glass - 3/16" x 24.88" x 12" - Sliding
28	047369-01-700	EA	Latch - Window - Plastic w/Fastener
29	002188-04-000	EA	Glass - 3/16" x 24.88" x 12" - Stationary
30	042077-01-000	FT	Channel - Weatherstrip - Glass Run - 1/8" Glass
31	069640-01-000	FT	Tape - 1/4" Bead x 20' - Gray - 3M
32	041928-02-000	FT	Seal - Window Channel - Black
33	050215-02-000	FT	Spline - Glass - Black
34	002389-03-206	EA	Holder - Glass Seal - Black - 24.13"
35	002298-01-000	FT	Weatherstrip - Glass Seal
36	057644-05-000	EA	Mullion - Slider Window - Black
37	063422-02-000	EA	Inside Frame - Driver Door Window - Beige (not included in assembly)
38	023713-02-000	EA	Cover - Weephole - Black Plastic
39	055164-05-000	EA	Screen Asm. - Slider
40	002292-01-000	SF	Screen - Window - 20" - Gray
41	002298-01-000	FT	Spline - Gray - Screen - .130" Dia
42	016310-03-000	EA	Screen Handle - Black
43	043485-02-000	FT	Screen Seal - Extr. Vinyl
44	039540-02-000	EA	Latch Asm. - Hook - Inside - Left
45	063977-04-000	EA	Step Asm. - Upper - Door
46	Not illustrated		

## 1983 WINNEBAGO TABLE OF CONTENTS

WC420RG	A-1 - B-22
WC424RB	B-23 - E-4
WCF26RH	E-5 - G-8
WCF26RB	G-9 - I-14

## 1983 WCF26RB INDEX

Floor Plan	G-9 - G-10
Accessories Group	G-11 - G-13
Bath Group	G-14 - G-15
Chassis Group	G-16 - G-17
Curtain, Cushion & Pad Group	G-18 - G-24
Dinette Group	H-1 - H-4
Driver's Compartment Group	H-5 - H-7
Electrical Group	H-8 - H-10
Exterior Body Group	H-11 - H-15
Galley Group	H-16 - H-17
Heating & Air Conditioning Group	H-18 - H-19
Interior Finish Group	H-20 - H-22
LP Group	H-23
Lounge Group	H-24
Water & Sewage Group	I-1 - I-2
Window, Vent & Exterior Door Group	I-3 - I-14

# WINDOW, VENT & EXTERIOR DOOR GROUP (CONTINUED)

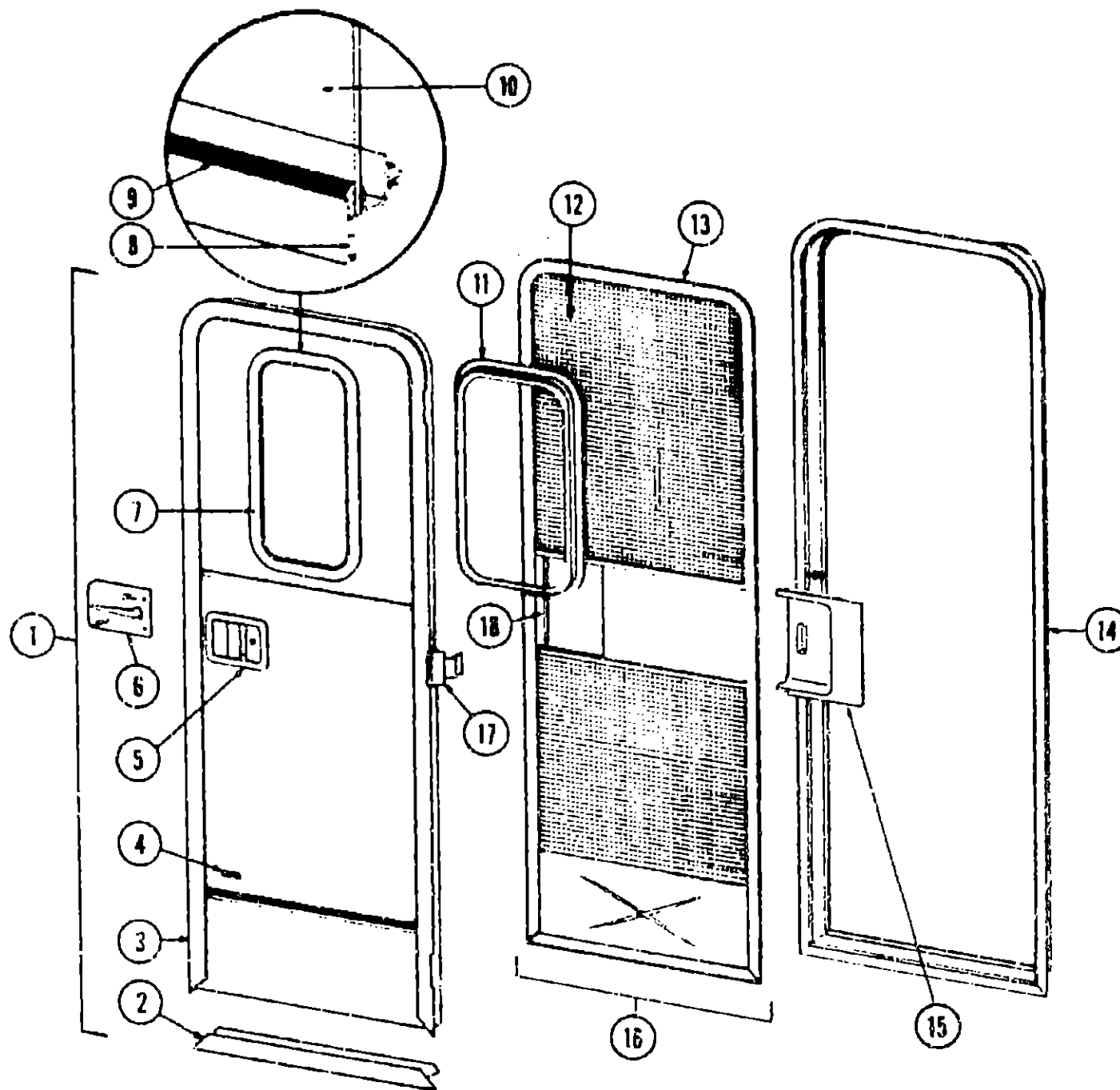

Key	Part Number	U/M	Description
1	M01126-01-P01	EA	Door Asm. - Radius Entry w/Screen Door
2	039737-01-000	EA	Frame - Entry Door (Bottom Portion Only)
3	039736-01-000	EA	Frame - Entry door (Except Bottom Portion)
4	054530-01-000	EA	Holder Asm. - Entry Door
5	045017-05-000	EA	Paddle Asm. - Door Lock - Exterior
6	045017-01-700	EA	Lock Cylinder w/Keys - Lynor
7	039539-01-000	EA	Striker Bolt - Entry Door
8	039540-01-000	EA	Latch Claw - Entry Door
9	039738-01-000	EA	Dead Bolt - Entry Door
10	039979-01-000	EA	Plate - Lock - Inside - Including Inside Handle
11	052186-01-000	EA	Lock Asm. - Complete - Lynor
12	041875-09-000	EA	Window Asm. - Picture - 17" x 25" - Black (w/o inside frame)
13	069640-01-000	FT	Tape - 1/4" Bead x 20' - Gray - 3M
14	002309-02-000	FT	Spline - Glass - 1/8" Black
15	002181-06-000	EA	Glass - Picture Window - 1/8" x 16 25" x 24" - Gray
16	067609-03-000	EA	Inside Frame - Window - 17" x 25" - Beige (not included in assembly)
17	002293-01-000	SF	Screen - Window - 26" - Gray
18	056795-01-000	FT	Seal Tape - 1/8" x 3/8" - Press On
19	053171-01-000	EA	Jamb Asm. - Entry Door

## 1983 WINNEBAGO TABLE OF CONTENTS

WC420RG	A-1 - B-22
WC424RB	B-23 - E-4
WCF26RH	E-5 - G-8
WCF26RB	G-9 - I-14

## 1983 WCF26RB INDEX

Floor Plan	G-9 - G-10
Accessories Group	G-11 - G-13
Bath Group	G-14 - G-15
Chassis Group	G-16 - G-17
Curtain, Cushion & Pad Group	G-18 - G-24
Dinette Group	H-1 - H-4
Driver's Compartment Group	H-5 - H-7
Electrical Group	H-8 - H-10
Exterior Body Group	H-11 - H-15
Galley Group	H-16 - H-17
Heating & Air Conditioning Group	H-18 - H-19
Interior Finish Group	H-20 - H-22
LP Group	H-23
Lounge Group	H-24
Water & Sewage Group	I-1 - I-2
Window, Vent & Exterior Door Group	I-3 - I-14

Key	Part Number	U/M	Description
15	015580-02-000	EA	Slider - Screen Door - Light Oak Plastic
16	053170-05-000	EA	Door Asm. - Screen w/Light Oak Trim
17	039520-01-000	EA	Hinge - Entry Door (3 used per door)
18	015581-02-000	EA	Cap - Screen Door - Light Oak Plastic
19	049176-01-000	EA	Hedlok II - 3/4" Diameter - Screw Mount (Retains screen door to entry door)
20	009016-01-000	EA	Catch - Elbow - Spring Loaded - Screen Door
21	039963-01-000	EA	Catch Asm. - Single Roller w/Strike - Screen Door
22	051390-01-000	FT	Seal - Bulb - Rubber
23	039800-03-000	FT	Tubing - Polybutyl - 3/8" O.D. Jamb
24	058025-02-000	EA	Clip - Roller Latch Catch
25	073517-01-000	EA	Drip Cap - Off White
26	075802-01-000	EA	Seal - Mocket - Entrance
27	075739-01-000	EA	Stiffener - Entrance Door - Off White
28	075673-01-000	FT	Seal - Pile - Adhesive Back
29	075671-01-000	FT	Seal - Sponge - Lazy "T" Shaped
30	002294-01-000	FT	Spline - Black - .135 x .138 (Screen Door)
31	063638-01-000	EA	Strike - Screen Door
32	Not illustrated		