

1983
WC621RB

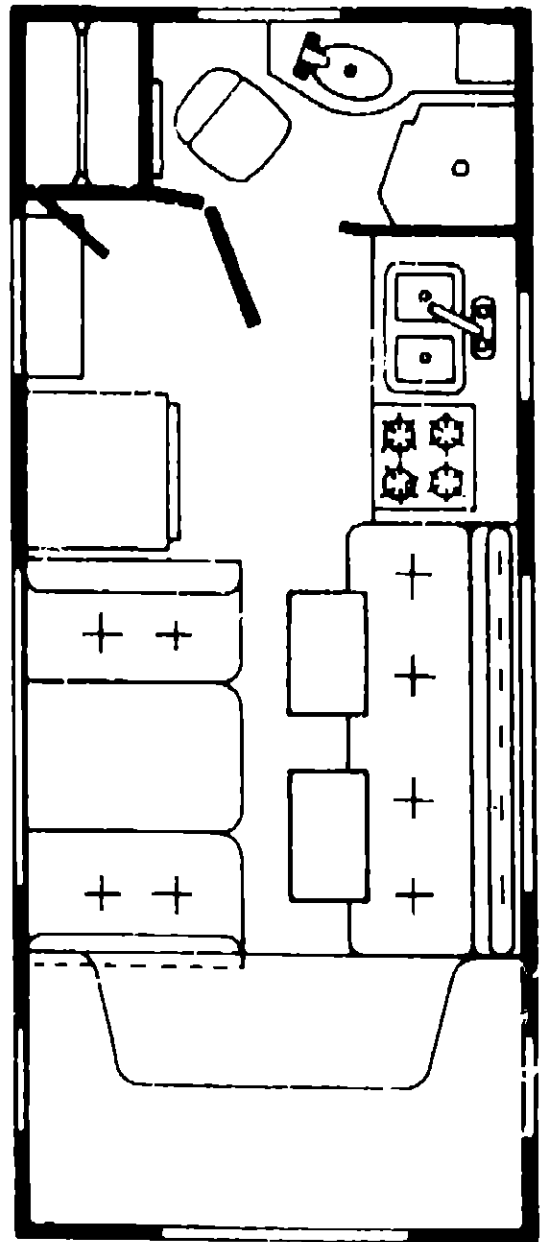
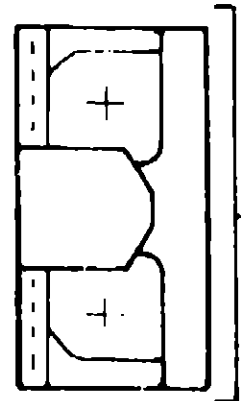

1983 WINNEBAGO
TABLE OF CONTENTS

WC621RB	A-1 - B-16
WC723RH	B-17 - D-8
WC723RB	D-9 - E-24
WC823RH	F-1 - G-16
WC823RB	G-17 - I-8

1983 WC621RB INDEX

Floor Plan	A-1 - A-2
Accessories Group	A-3 - A-5
Bath Group	A-6
Chassis Group	A-7
Curtain, Cushion & Pad Group	A-8 - A-13
Dinette Group	A-14
Driver's Compartment Group	A-15 - A-16
Electrical Group	A-17 - A-19
Exterior Body Group	A-20 - A-24
Galley Group	B-1
Heating & Air Conditioning Group	B-2
Interior Finish Group	B-3 - B-4
LP Group	B-5
Lounge Group	B-6
Water & Sewage Group	B-7 - B-8
Window, Vent & Exterior Door Group	B-9 - B-16

ACCESSORIES GROUP

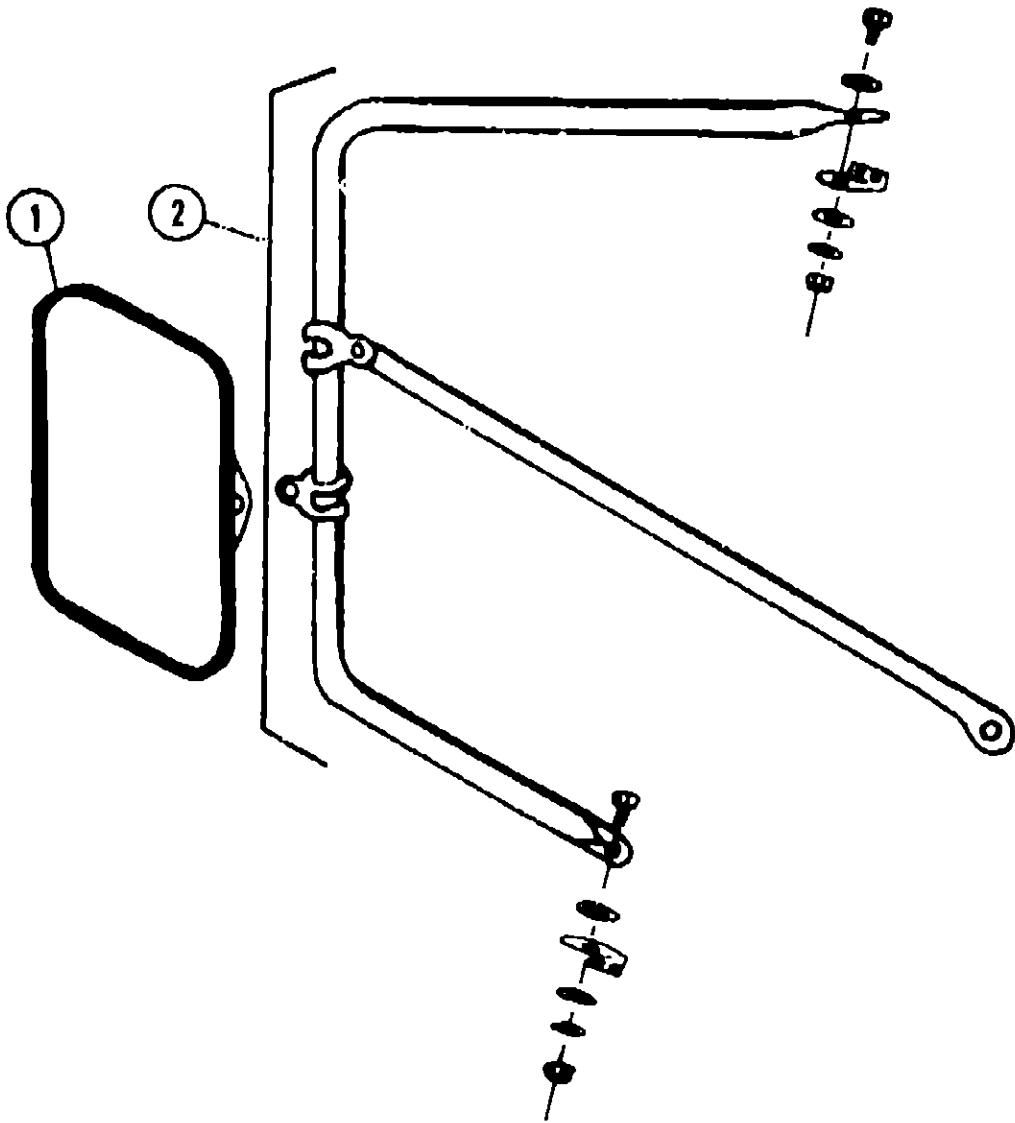

Key	Part Number	U/M	Description
1	049347-01-000	EA	Mirror Head - 7 1/2" x 10 1/2" - Stainless Steel
2	062047-01-000	EA	Arm - West Coast Mirror

GENERATOR AND COMPONENTS

Key	Part Number	U/M	Description
	054427-01-000	EA	Generator - 3.0 kw - Onan
	701629-02-000	EA	Package - Onan Installation
	057652-01-000	EA	Muffler - Generator - AJ

ACCESSORIES GROUP (CONTINUED)

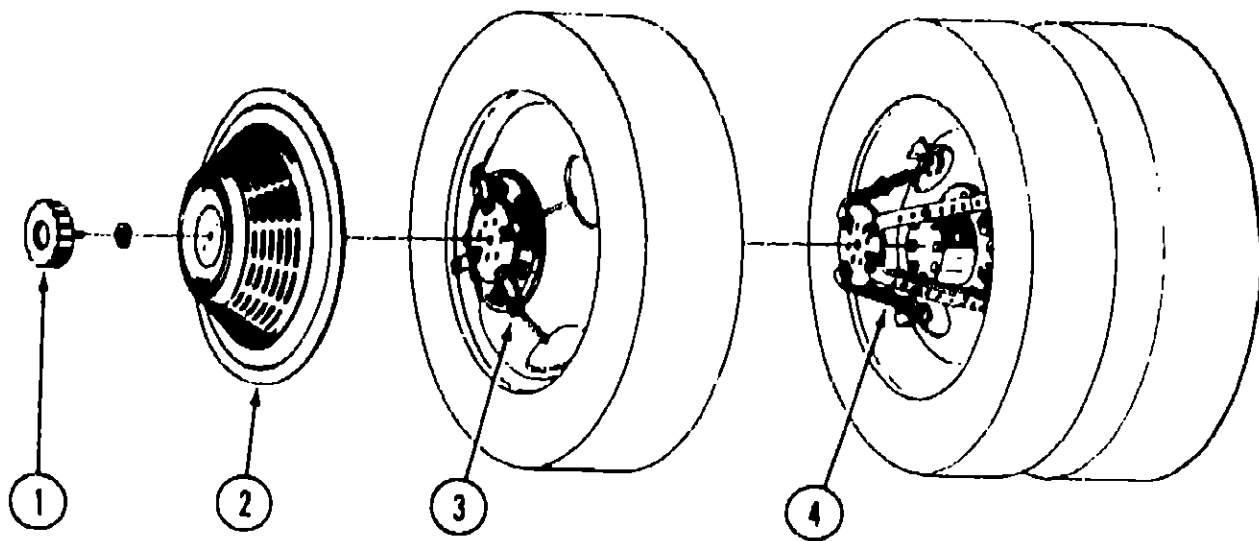

WHEEL COVER AND MOUNTING HARDWARE

Key	Part Number	U/M	Description
1	064082-02-000	EA	Retaining Nut - Delmet - Wheel Cover
2	073426-01-700	EA	Wheel Cover - Bolt On - 16" or 16.5" - Delmet (1)
3	073426-04-700	EA	Retention Bracket Asm. - Wheel Cover Support - Heavy Duty - Front (1)
4	073426-01-701	EA	Retention Bracket Asm. - Wheel Cover Support - Heavy Duty - Rear (1)
.	073426-04-000	EA	Retention Bracket Asm. - Wheel Cover Support - Heavy Duty (Set/4)
.	031396-04-000	EA	Wheel Cover - 16" - Clip On.
.	Not illustrated		
..	The illustrated parts breakdown for this item is provided on the Common Items Fiche.		

RADIOS AND RELATED COMPONENTS

Key	Part Number	U/M	Description
	064785-01-000	EA	Radio - AM - Audiovox
	064787-01-000	EA	Radio - AM/FM/MPX - w/Cassette
	007004-01-000	EA	Antenna - Radio - Cab Mount
	048153-01-000	EA	Antenna - CB - Camper Style
	064791-01-000	EA	Speaker - Recessed - 5 1/4" x 10 oz.
	073431-01-000	EA	Speaker - Recessed - 5 1/4" - 3 Way
	064792-01-000	EA	Grille - Speaker - 5 1/4"
	073430-01-000	EA	Radio - AM/FM/MPX - w/Cassette - Electrically Tuned
	073432-01-000	EA	Amplifier - 4 x 15 Watts
	073433-01-000	EA	Adapter - Radio to Amplifier
	064790-01-000	EA	Speaker - 4 x 6 - Oval - 12 Watts
	073741-01-000	EA	Speaker - 4 x 6 - Oval - 20 Watts
	066037-01-P07	EA	Speaker Box - Left
	066037-02-P07	EA	Speaker Box - Right
	074979-01-000	EA	Speaker Cover - Plastic

1983 WINNEBAGO
TABLE OF CONTENTS

WC821RB	A-1 - B-16
WC723RH	B-17 - D-8
WC723RB	D-9 - E-24
WC823RH	F-1 - G-16
WC823RB	G-17 - I-8

1983 WC821RB INDEX

Floor Plan	A-1 - A-2
Accessories Group	A-3 - A-5
Bath Group	A-6
Chassis Group	A-7
Curtain, Cushion & Pad Group	A-8 - A-13
Dinette Group	A-14
Driver's Compartment Group	A-15 - A-16
Electrical Group	A-17 - A-19
Exterior Body Group	A-20 - A-24
Galley Group	B-1
Heating & Air Conditioning Group	B-2
Interior Finish Group	B-3 - B-4
I.P Group	B-5
Lounge Group	B-6
Water & Sewage Group	B-7 - B-8
Window, Vent & Exterior Door Group	B-9 - B-16

ACCESSORIES GROUP (CONTINUED)

MISCELLANEOUS ACCESSORIES

Key	Part Number	U/M	Description
	054185-19-000	EA	Owners Manual - Itasca & Winnebago
	008053-01-000	EA	Antenna - TV Braund Delux
	008093-01-000	EA	Jack - TV - Brown (Antenna)
	017518-01-000	EA	Mud Flap - Black - 14" x 18" w/Holes
	041944-03-000	EA	Fire Extinguisher - w/Bracket - 5 BC
	052771-02-000	EA	Oven - Microwave - Magic Chef MW207
	053286-03-000	EA	Bracket Asm. - Microwave - Right
	053286-04-000	EA	Bracket Asm. - Microwave - Left
	067125-01-000	EA	Standoff (Support) Rack & Ladder
	067181-01-000	EA	Ladder Asm.
	067203-03-000	EA	Rack Asm. - Luggage
	067130-01-000	EA	Ladder Step
	067186-01-000	EA	End Cap - Ladder Step
	064093-01-000	EA	Luggage Carrier Assembly - 14" x 30" x 60"
	039881-01-000	EA	Catch and Strike - Luggage Carrier
	007038-01-000	EA	Door Mat - Black Rubber - 10.5" x 26"
..	069829-01-000	EA	Speed Control - Electric
	072374-01-000	EA	Clock - Batt. Gold Face - 7" x 7"
	072373-01-000	EA	Weather Center - 7" x 7"
	069580-01-000	EA	Lug Wrench - 1" x 1 1/4" x 18.3"
	069580-02-000	EA	Leverage Lug Bar Wrench - 22"
	064477-03-000	EA	Cover - Spare Tire - Plastic - Beige
..	064082-02-000	EA	Nut - Spare Tire Cover

The illustrated parts breakdown for this item is provided on the Common Items Fiche.

BATH GROUP

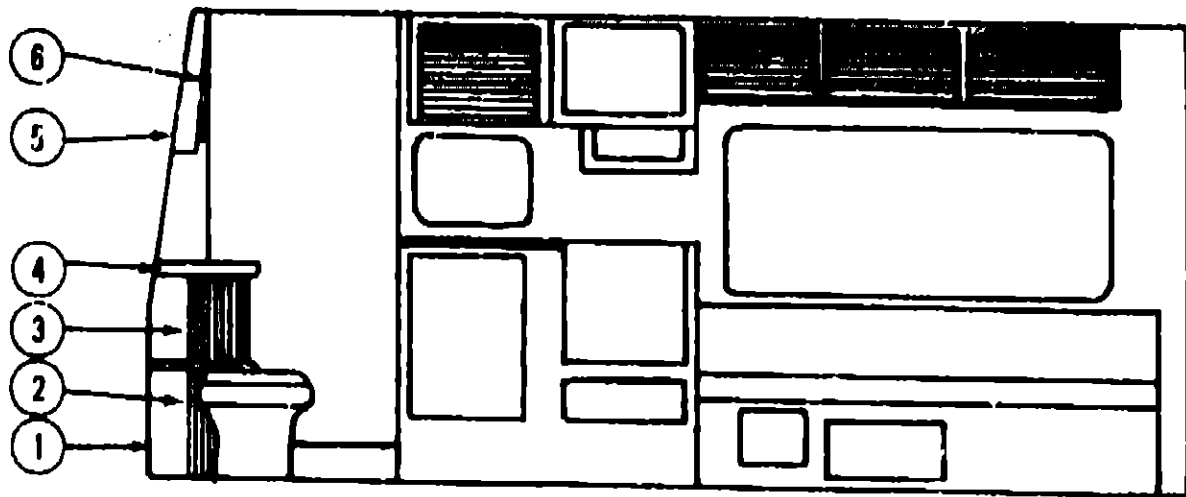

BATH CABINETRY AND HARDWARE

Key	Part Number	U/M	Description
1	M73615-01-P07	EA	Cabinet Asm. - Vanity - w/o Countertop & Doors
2	063224-22-P07	EA	Door Asm. - Rolled - 13.1" x 30" Lower
3	063224-21-P07	EA	Door Asm. - Rolled - 12.8" x 30" Upper
4	067401-01-P07	EA	Countertop Asm. - Vanity Cabinet - Pelomino
5	M67100-02-P07	EA	Cabinet Asm. - Medicine
6	M71646-01-P07	EA	Door Asm. - w/Mirror - w/o Hardware
..	072232-03-P07	EA	Pad Asm. - End Panel - Medicine Cabinet
..	M68593-03-P07	EA	Door Asm. - Bath - 23.5" x 74"
..	060852-49-P07	EA	Door Asm. - Vanity Cabinet - 19.8" x 15.1" - w/o Hardware
..	069852-67-P07	EA	Door Asm. - Wardrobe Cabinet - 43.1" x 16.5" - w/o Hardware
..	069859-07-P07	EA	Door Asm. - Wardrobe Cabinet - 15" x 56.2" w/Mirror - w/o Hardware
..	058713-01-000	EA	Sink - Oval - Ivory Plastic
..	033580-01-000	EA	Towel Ring
..	009133-01-000	EA	Towel Bar - 12" Plastic
..	023449-01-000	EA	Support - Towel Rack - Chrome
..	M59913-10-P07	EA	Drawer Asm. - Wardrobe - 16.2" x 23.6" - w/o Hardware
..	058331-02-000	EA	Mirror - Medicine Cabinet Door - 12" x 36"
..	058331-03-000	EA	Mirror - Wardrobe Door
..	057898-01-000	EA	Hidden Latch
..	058335-02-000	EA	Bath Door Latch
..	009134-01-000	EA	Holder - Tissue & Towel Bar
..	011056-02-000	EA	Faucet - Lavatory - CSA
..	011056-01-000	EA	Faucet - Lavatory - US
..	011083-01-000	EA	Plug w/Chain - 1 1/4"
..	011048-02-000	EA	Shower Head - w/60" Hose
..	011070-01-000	EA	Tailpiece - 1 1/4" x 6" - Brass
..	066435-01-000	EA	Shower Pan
..	011059-03-000	EA	Faucet - Shower USA
..	039341-02-000	EA	Toilet - Thetford Aqua Magic - Ivory
..	Not illustrated		

The illustrated parts breakdown for this item is provided on the Common Items Fiche.

1983 WINNEBAGO TABLE OF CONTENTS

WC621RB	A-1 - B-16
WC723RH	B-17 - D-8
WC723RB	D-9 - E-24
WC823RH	F-1 - G-16
WC823RB	G-17 - I-8

1983 WC621RB INDEX

Floor Plan	A-1 - A-2
Accessories Group	A-3 - A-5
Bath Group	A-6
Chassis Group	A-7
Curtain, Cushion & Pad Group	A-8 - A-13
Dinette Group	A-14
Driver's Compartment Group	A-15 - A-16
Electrical Group	A-17 - A-19
Exterior Body Group	A-20 - A-24
Galley Group	B-1
Heating & Air Conditioning Group	B-2
Interior Finish Group	B-3 - B-4
LP Group	B-5
Lounge Group	B-6
Water & Sewage Group	B-7 - B-8
Window, Vent & Exterior Door Group	B-9 - B-16

CHASSIS GROUP

Key	Part Number	U/M	Description
	059859-01-000	EA	Wheel Well - Plastic - Rear - Left or Right
	081411-01-000	EA	Tail Pipe Extension - 2" O.D. x 10"
	007125-05-000	EA	Clamp Asm. - Muffler - 2" Dia.
	084551-02-000	EA	Tray - Luggage Compartment
	085386-01-000	EA	Tray - Battery
	051897-02-000	EA	Bracket - Battery Tie Down
	049912-01-000	EA	Step Asm. Assist - Cab
	017516-01-000	EA	Mud Flap - 14" x 18" - w/Holes
	084089-01-000	EA	Splashguard - Front - Black Rubber
	045012-01-000	EA	Bumper - Front - Chrome
	084379-01-000	EA	Bumper - Rear - Chrome
	081189-01-000	EA	Bracket Asm. - Rear Bumper Mount - Left
	081189-02-000	EA	Bracket Asm. - Rear Bumper Mount - Right
	084213-01-000	EA	Box - Power Cord
	049407-01-000	EA	Tire - 8.75 x 16.5 - 8 Ply - Black Tubeless
	082400-02-000	EA	Wheel - 8.00 x 16.5 - Chevy
	047441-01-000	EA	Battery Terminal - Horizontal Lug
	007131-01-000	EA	Hanger - Tail Pipe
	084487-01-000	EA	Spare Tire Support Asm.
	040784-01-000	EA	Blad. Asm. - Windshield Wiper
	059784-02-000	EA	Controller - Wiper - Intermittent
	059784-03-000	EA	Switch - Wiper - Intermittent
	024652-01-700	EA	Step Asm. - Pullout
	059540-01-000	EA	Bracket - License Plate - Rear

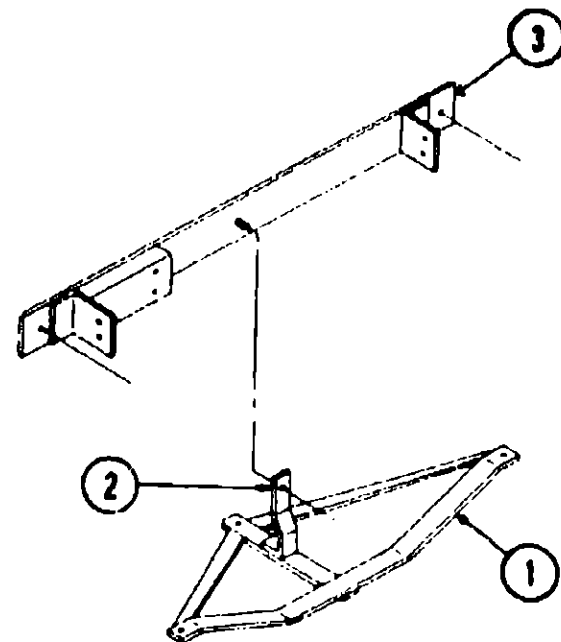

Key	Part Number	U/M	Description
1	064833-01-000	EA	Trailer Hitch Asm. - w/Support
2	064824-01-000	EA	Support - Trailer Hitch
3	065237-01-000	EA	Bracket - Bumper Mount - Rear

CURTAIN, CUSHION AND PAD GROUP

NOTICE

In order to assist our Parts Sales Dept. in providing interior software items, please include the serial number and the color code number from the vehicle certification label when ordering. This label is located on the left sidewall at the end of the dash (A-Body), or on the driver's door latch plate (C-Body).

An example of a color code number is P31, which designates an overall color scheme of a particular unit. The color listed after the item description on the microfiche, indicates the overall unit color. Order the item you desire according to unit color code.

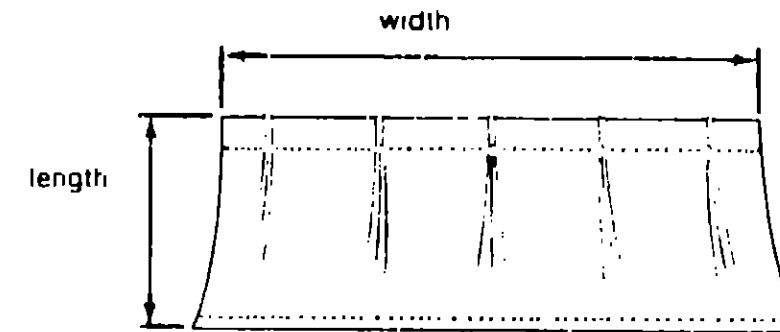

NOTE:

Use this illustration when determining length and width measurements for curtains. You will note the width measurement is taken on the top of the curtain with the curtain fully extended. The length measurement is taken from top to bottom.

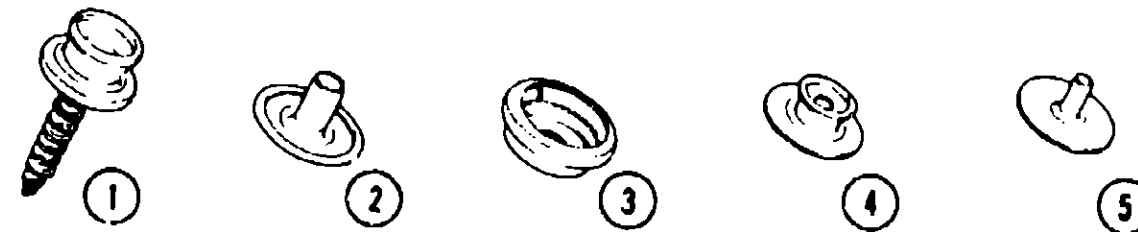

Key	Part Number	U/M	Description
1	029130-01-000	EA	Socket - Snap Fastener
2	029155-01-000	EA	Cap - Snap - .156" Dia. x .17" Barrel
3	029156-01-000	EA	Socket - Snap Fastener
4	029092-01-000	EA	Stud - Nickel Finish
5	029093-01-000	EA	Eyelet - Nickel Finish

1983 WINNEBAGO TABLE OF CONTENTS

WC621RB	A-1 - B-16
WC723RH	B-17 - D-8
WC723RB	D-9 - E-24
WC823RH	F-1 - G-18
WC823RB	G-17 - I-8

1983 WC621RB INDEX

Floor Plan	A-1 - A-2
Accessories Group	A-3 - A-5
Bath Group	A-6
Chassis Group	A-7
Curtain, Cushion & Pad Group	A-8 - A-13
Dinette Group	A-14
Driver's Compartment Group	A-15 - A-16
Electrical Group	A-17 - A-19
Exterior Body Group	A-20 - A-24
Galley Group	B-1
Heating & Air Conditioning Group	B-2
Interior Finish Group	B-3 - B-4
LP Group	B-5
Lounge Group	B-6
Water & Sewage Group	B-7 - B-8
Window, Vent & Exterior Door Group	B-9 - B-16

CURTAIN, CUSHION & PAD GROUP (CONTINUED)

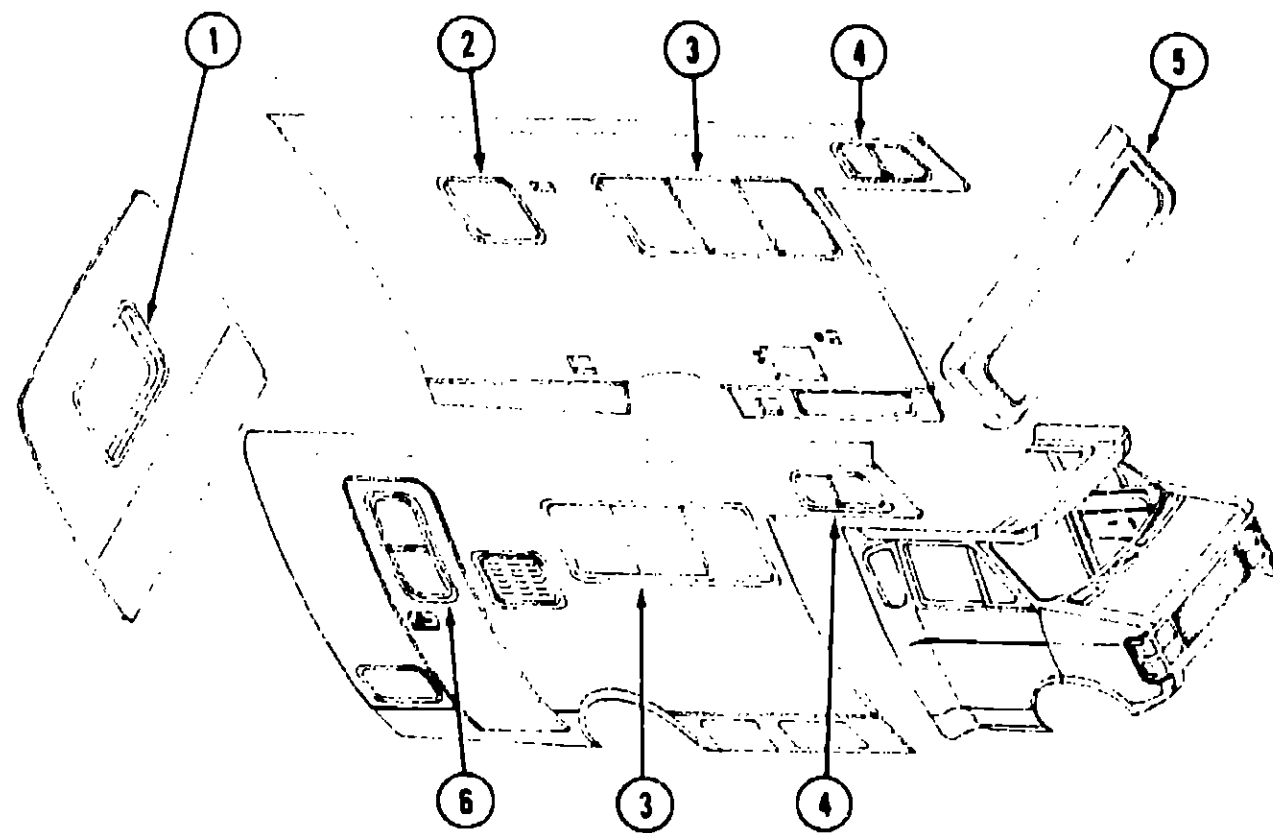

CURTAIN, VALANCE, SHADES & TIEBACKS

Key	Part Number	U/M	Description
1	073251-17-P07	EA	Curtain w/Tape Top - 28.5" x 12" - Navy (P37)
1	073251-17-P08	EA	Curtain w/Tape Top - 28.5" x 12" - Rose (P38)
1	073251-17-P09	EA	Curtain w/Tape Top - 28.5" x 12" - Rust (P39)
1	070651-28-P07	EA	Valance Asm. - 6" x 49" Pleated - Navy (P37)
1	070651-28-P08	EA	Valance Asm. - 6" x 49" Pleated - Rose (P38)
1	070651-28-P09	EA	Valance Asm. - 6" x 49" Pleated - Rust (P39)
1	067780-25-000	EA	Blind - 39" x 29" (P07, P37)
1	067780-16-000	EA	Blind - 39" x 29" (P08, P38, P09, P39)
1	065522-09-000	EA	Shade Asm. - 40.25" x 38"
2	073251-16-P07	EA	Curtain w/Tape Top - 20" x 9" - Navy (P37)
2	073251-16-P08	EA	Curtain w/Tape Top - 20" x 9" - Rose (P38)
2	073251-16-P09	EA	Curtain w/Tape Top - 20" x 9" - Rust (P39)
2	070651-27-P07	EA	Valance Asm. - 6" x 29" Pleated - Navy (P37)
2	070651-27-P08	EA	Valance Asm. - 6" x 29" Pleated - Rose (P38)
2	070651-27-P09	EA	Valance Asm. - 6" x 29" Pleated - Rust (P39)
2	067780-30-000	EA	Blind - 23" x 23" (P07, P37)
2	067780-21-000	EA	Blind - 23" x 23" (P08, P38, P09, P39)
2	065522-02-000	EA	Shade Asm. - 21.25" x 38"
3	070652-08-P07	EA	Curtain w/Darts Top - 29" x 24" - Navy (P37)
3	070652-08-P08	EA	Curtain w/Darts Top - 29" x 24" - Rose (P38)
3	070652-08-P09	EA	Curtain w/Darts Top - 29" x 24" - Rust (P39)
3	073323-06-P07	EA	Curtain - Sheers - 29" x 66" - Champagne
3	070651-25-P07	EA	Valance Asm. - 6" x 80" - Pleated - Navy (P37)
3	070651-25-P08	EA	Valance Asm. - 6" x 80" - Pleated - Rose (P38)
3	070651-25-P09	EA	Valance Asm. - 6" x 80" - Pleated - Rust (P39)
3	067780-22-000	EA	Blind - 70" x 31" (P07, P37)
3	067780-13-000	EA	Blind - 70" x 31" (P08, P38, P09, P39)
3	065522-12-000	EA	Shade Asm. - 69.25" x 38"

CURTAIN, CUSHION & PAD GROUP (CONTINUED)

CURTAIN, VALANCE, SHADES & TIEBACKS (CONT.)

Key	Part Number	U/M	Description
4	073304-17-P07	EA	Curtain w/Snap Top - 12" x 38" - Navy (P37)
4	073304-17-P08	EA	Curtain w/Snap Top - 12" x 38" - Rose (P38)
4	073304-17-P09	EA	Curtain w/Snap Top - 12" x 38" - Rust (P39)
5	073226-10-P07	EA	Curtain w/Snap Top and Bottom - 18" x 44" - Navy (P37)
5	073226-10-P08	EA	Curtain w/Snap Top and Bottom - 18" x 44" - Rose (P38)
5	073226-10-P09	EA	Curtain w/Snap Top and Bottom - 18" x 44" - Rust (P39)
.	073295-03-P07	EA	Curtain Asm. - Front Wraparound - 25" x 80"
.	073304-25-P07	EA	Curtain w/Snap Top - 60" x 88" - Privacy
6	073304-15-P07	EA	Curtain w/Snap Top - 34" x 31" - Navy (P37)
6	073304-15-P08	EA	Curtain w/Snap Top - 34" x 31" - Rose (P38)
6	073304-15-P09	EA	Curtain w/Snap Top - 34" x 31" - Rust (P39)
.	073304-16-P07	EA	Curtain w/Snap Top - Bunk Privacy - 25" x 88"
.	073260-07-P07	EA	Tie Back Asm. - Curtain - 2" x 16" - Bunk Privacy
.	073260-08-P07	EA	Tie Back Asm. - Curtain - 2" x 16"
.	073260-02-P07	EA	Tie Back Asm. - Curtain - 2" x 16" - Navy (P37)
.	073260-02-P08	EA	Tie Back Asm. - Curtain - 2" x 16" - Rose (P38)
.	073260-02-P09	EA	Tie Back Asm. - Curtain - 2" x 16" - Rust (P39)
.	057534-03-000	EA	Tie Back - Clear Plastic - 7.5"
.	Not illustrated		

CURTAIN HARDWARE

Key	Part Number	U/M	Description
	053272-01-000	EA	Track - Curtain - Alum. - 16' - w/Holes
	056116-01-000	EA	Track - Curtain - Brown Plastic
	059430-05-000	EA	Track - Curtain - Front Wraparound (2 per unit) - 36" x 43.75" - Beige
	059430-07-000	EA	Track - Curtain - Front Wraparound - 36" x 86.2" (w/Drivers Door) - Beige
	056001-01-000	EA	Bracket - Shade - Left
	056002-01-000	EA	Bracket - Shade - Right
	009107-01-000	EA	Guide - Nylon Snap - Curtain
	018031-46-000	EA	Track - Curtain - "L" Rod - Alum. Extr. - 192"
	009701-01-000	EA	Carrier - "L" Rod - Curtain
	056784-01-000	EA	Pull - Window Shade - Antique Brass
	039175-01-000	EA	Curtain Rod - Ext. 48" x 84"
	039175-02-000	EA	Bracket - Curtain Rod
	056115-02-000	YD	Tape - Clear Plastic - w/Guides
	048394-01-000	YD	Tape Hook - 1" x 25 YD - Beige
	048395-01-000	YD	Tape Loop - 1" x 25 YD - Beige
	056003-01-000	EA	Bracket - Drapery Retainer - Right
	056003-02-000	EA	Bracket - Drapery Retainer - Left
	056003-03-000	EA	Bracket - Drapery Retainer - Universal
	052327-05-008	EA	Track - Curtain - Beige - Plastic

1983 WINNEBAGO TABLE OF CONTENTS

WC621RB	A-1 - B-16
WC723RH	B-17 - D-8
WC723RB	D-9 - E-24
WC823RH	F-1 - G-16
WC823RB	G-17 - I-8

1983 WC621RB INDEX

Floor Plan	A-1 - A-2
Accessories Group	A-3 - A-5
Bath Group	A-6
Chassis Group	A-7
Curtain, Cushion & Pad Group	A-8 - A-13
Dinette Group	A-14
Driver's Compartment Group	A-15 - A-16
Electrical Group	A-17 - A-19
Exterior Body Group	A-20 - A-24
Galley Group	B-1
Heating & Air Conditioning Group	B-2
Interior Finish Group	B-3 - B-4
LP Group	B-5
Lounge Group	B-6
Water & Sewage Group	B-7 - B-8
Window, Vent & Exterior Door Group	B-9 - B-16

CORNER LOUNGE CHAIR CUSHIONS

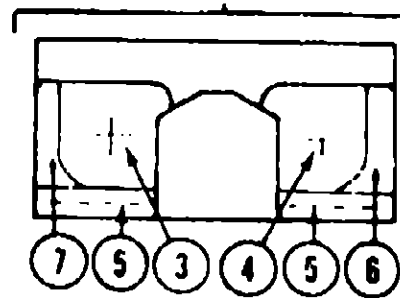
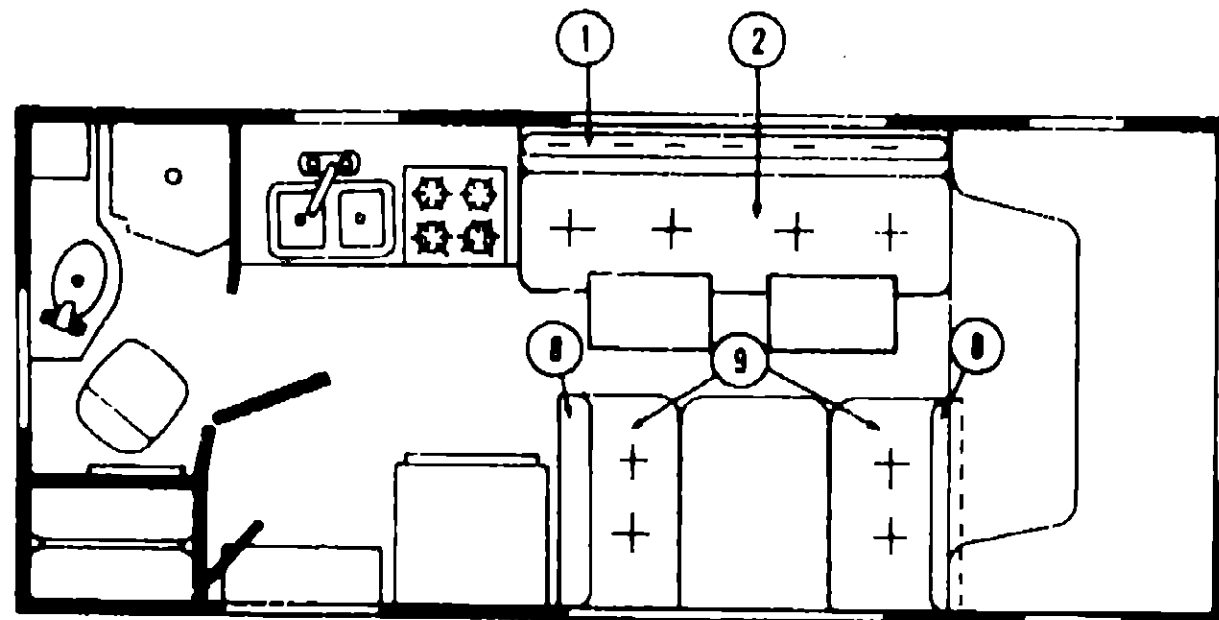

SPRUNG COUCH CUSHIONS

Key	Part Number	U/M	Description
1	073630-01-P07	EA	Cushion Asm. - Sprung Couch - Back - Navy (P37)
1	073630-01-P08	EA	Cushion Asm. - Sprung Couch - Back - Rose (P38)
1	073630-01-P09	EA	Cushion Asm. - Sprung Couch - Back - Rust (P39)
	M73630-01-P07	EA	Cover - Sprung Couch Back - Navy (P37)
	M73630-01-P08	EA	Cover - Sprung Couch Back - Rose (P38)
	M73630-01-P09	EA	Cover - Sprung Couch Back - Rust (P39)
2	073631-01-P07	EA	Cushion Asm. - Sprung Couch - Bottom - Navy (P37)
2	073631-01-P08	EA	Cushion Asm. - Sprung Couch - Bottom - Rose (P38)
2	073631-01-P09	EA	Cushion Asm. - Sprung Couch - Bottom - Rust (P39)
	M73631-01-P07	EA	Cover - Sprung Couch Bottom - Navy (P37)
	M73631-01-P08	EA	Cover - Sprung Couch Bottom - Rose (P38)
	M73631-01-P09	EA	Cover - Sprung Couch Bottom - Rust (P39)

Key	Part Number	U/M	Description
3	059743-09-P37	EA	Cushion - Lounge Chair Bottom - Navy (P07)
3	059743-09-P38	EA	Cushion - Lounge Chair Bottom - Rose (P08)
3	059743-09-P39	EA	Cushion - Lounge Chair Bottom - Rust (P09)
	059746-07-P37	EA	Cover - Lounge Chair Bottom Cushion - Navy (P07)
	059746-07-P38	EA	Cover - Lounge Chair Bottom Cushion - Rose (P08)
	059746-07-P39	EA	Cover - Lounge Chair Bottom Cushion - Rust (P09)
4	059743-08-P37	EA	Cushion - Lounge Chair Bottom Right - Navy (P07)
4	059743-08-P38	EA	Cushion - Lounge Chair Bottom Right - Rose (P08)
4	059743-08-P39	EA	Cushion - Lounge Chair Bottom Right - Rust (P09)
	059746-08-P37	EA	Cover - Lounge Chair Bottom Cushion - Right - Navy (P07)
	059746-08-P38	EA	Cover - Lounge Chair Bottom Cushion - Right - Rose (P08)
	059746-08-P39	EA	Cover - Lounge Chair Bottom Cushion - Right - Rust (P09)
5	059742-08-P07	EA	Cushion - Lounge Chair Back - Navy (P37)
5	059742-08-P08	EA	Cushion - Lounge Chair Back - Rose (P38)
5	059742-08-P09	EA	Cushion - Lounge Chair Back - Rust (P39)
	059745-06-P07	EA	Cover - Lounge Chair Back Cushion - Navy (P37)
	059745-06-P08	EA	Cover - Lounge Chair Back Cushion - Rose (P38)
	059745-06-P09	EA	Cover - Lounge Chair Back Cushion - Rust (P39)
6	059744-16-P07	EA	Cushion - Chair Wedge - Left - Navy (P37)
6	059744-16-P08	EA	Cushion - Chair Wedge - Left - Rose (P38)
6	059744-16-P09	EA	Cushion - Chair Wedge - Left - Rust (P39)
	059747-12-P07	EA	Cover - Chair Wedge - Left - Navy (P37)
	059747-12-P08	EA	Cover - Chair Wedge - Left - Rose (P38)
	059747-12-P09	EA	Cover - Chair Wedge - Left - Rust (P39)
7	059744-15-P07	EA	Cushion - Chair Wedge - Right - Navy (P37)
7	059744-15-P08	EA	Cushion - Chair Wedge - Right - Rose (P38)
7	059744-15-P09	EA	Cushion - Chair Wedge - Right - Rust (P39)
	059747-11-P07	EA	Cover - Chair Wedge Cushion - Right - Navy (P37)
	059747-11-P08	EA	Cover - Chair Wedge Cushion - Right - Rose (P38)
	059747-11-P09	EA	Cover - Chair Wedge Cushion - Right - Rust (P39)

DINETTE CUSHIONS

Key	Part Number	U/M	Description
8	072430-03-P07	EA	Cushion - Dinette Back - 19.25" x 38" x 5" - Navy (P37)
8	072430-03-P08	EA	Cushion - Dinette Back - 19.25" x 38" x 5" - Rose (P38)
8	072430-03-P09	EA	Cushion - Dinette Back - 19.25" x 38" x 5" - Rust (P39)
	M72430-03-P07	EA	Cover - Dinette Back Cushion - 19" x 38" x 5" - Navy (P37)
	M72430-03-P08	EA	Cover - Dinette Back Cushion - 19" x 38" x 5" - Rose (P38)
	M72430-03-P09	EA	Cover - Dinette Back Cushion - 19" x 38" x 5" - Rust (P39)
9	072430-04-P07	EA	Cushion - Dinette Bottom - 17.5" x 38" x 5" - Navy (P37)
9	072430-04-P08	EA	Cushion - Dinette Bottom - 17.5" x 38" x 5" - Rose (P38)
9	072430-04-P39	EA	Cushion - Dinette Bottom - 17.5" x 38" x 5" - Rust (P39)
	M72430-04-P07	EA	Cover - Dinette Bottom Cushion - 17.5" x 38" x 5" - Navy (P37)
	M72430-04-P08	EA	Cover - Dinette Bottom Cushion - 17.5" x 38" x 5" - Rose (P38)
	M72430-04-P09	EA	Cover - Dinette Bottom Cushion - 17.5" x 38" x 5" - Rust (P39)

FRONT OVERHEAD BUNK MATTRESS

Key	Part Number	U/M	Description
	073310-02-P07	EA	Mattress - Overhead Bunk - Two Fold - 19" x 34" x 75" x 4" - Navy (P37)
	073310-02-P08	EA	Mattress - Overhead Bunk - Two Fold - 19" x 34" x 75" x 4" - Rose (P38)
	073310-02-P09	EA	Mattress - Overhead Bunk - Two Fold - 19" x 34" x 75" x 4" - Rust (P39)
	M73310-02-P07	EA	Cover - Overhead Bunk Mattress - Two Fold - 19" x 34" x 75" x 4" - Navy (P37)
	M73310-02-P08	EA	Cover - Overhead Bunk Mattress - Two Fold - 19" x 34" x 75" x 4" - Rose (P38)
	M73310-02-P09	EA	Cover - Overhead Bunk Mattress - Two Fold - 19" x 34" x 75" x 4" - Rust (P39)

1983 WINNEBAGO
TABLE OF CONTENTS

WC621RB	A-1 - B-16
WC723RH	B-17 - D-8
WC723RB	D-9 - E-24
WC823HH	F-1 - G-16
WC823RB	G-17 - I-8

1983 WC621RB INDEX

Floor Plan	A-1 - A-2
Accessories Group	A-3 - A-5
Bath Group	A-6
Chassis Group	A-7
Curtain, Cushion & Pad Group	A-8 - A-13
Dinette Group	A-14
Driver's Compartment Group	A-15 - A-16
Electrical Group	A-17 - A-19
Exterior Body Group	A-20 - A-24
Galley Group	B-1
Heating & Air Conditioning Group	B-2
Interior Finish Group	B-3 - B-4
LP Group	B-5
Lounge Group	B-6
Water & Sewage Group	B-7 - B-8
Window, Vent & Exterior Door Group	B-9 - B-16

CURTAIN, CUSHION & PAD GROUP (CONTINUED)

BUCKET SEATS

Key	Part Number	U/M	Description
	073619-03-P07	EA	Seat Asm. - Single Bucket - Youth Bed - Left - Navy (P37)
	073619-03-P08	EA	Seat Asm. - Single Bucket - Youth Bed - Left - Rose (P38)
	073619-03-P09	EA	Seat Asm. - Single Bucket - Youth Bed - Left - Rust (P39)
	073619-04-P07	EA	Seat Asm. - Single Bucket - Youth Bed - Right - Navy (P37)
	073619-04-P08	EA	Seat Asm. - Single Bucket - Youth Bed - Right - Rose (P38)
	073619-04-P09	EA	Seat Asm. - Single Bucket - Youth Bed - Right - Rust (P39)
	M00784-06-P07	EA	Cover - Back - Youth Bed - Navy (P37)
	M00784-06-P08	EA	Cover - Back - Youth Bed - Rose (P38)
	M00784-06-P09	EA	Cover - Back - Youth Bed - Rust (P39)
	M00784-05-P07	EA	Cover - Bottom - Youth Bed - Navy (P37)
	M00784-05-P08	EA	Cover - Bottom - Youth Bed - Rose (P38)
	M00784-05-P09	EA	Cover - Bottom - Youth Bed - Rust (P39)
	070553-01-P07	EA	Cushion Asm. - Wedge - Youth Bed - Navy (P37)
	070554-01-P08	EA	Cushion Asm. - Wedge - Youth Bed - Rose (P38)
	070554-01-P09	EA	Cushion Asm. - Wedge - Youth Bed - Rust (P39)
	M70553-01-P07	EA	Cover - Wedge - Youth Bed - Navy (P37)
	M70553-01-P08	EA	Cover - Wedge - Youth Bed - Rose (P38)
	M70553-01-P09	EA	Cover - Wedge - Youth Bed - Rust (P39)
	071122-12-P07	EA	Armrest Asm. - Left - Navy (P37)
	071122-12-P08	EA	Armrest Asm. - Left - Rose (P38)
	071122-12-P09	EA	Armrest Asm. - Left - Rust (P39)
	071122-11-P07	EA	Armrest Asm. - Right - Navy (P37)
	071122-11-P08	EA	Armrest Asm. - Right - Rose (P38)
	071122-11-P09	EA	Armrest Asm. - Right - Rust (P39)
	071123-06-P07	EA	Cover - Armrest - Navy (P37)
	071123-06-P08	EA	Cover - Armrest - Rose (P38)
	071123-06-P09	EA	Cover - Armrest - Rust (P39)

FABRICS AND TRIMS

Key	Part Number	U/M	Description
	072333-04-000	YD	Fabric - Drapery - Wraparound
	072333-02-000	YD	Fabric - Drapery - Sheers
	072334-02-000	YD	Fabric - Drapery - Accents - Rose (P08, P38)
	072334-13-000	YD	Fabric - Drapery - Accents - Navy (P07, P37)
	072334-14-000	YD	Fabric - Drapery - Accents - Rust (P09, P39)
	069729-02-000	YD	Fabric - Drapery - Bedspread - Navy (P07, P37)
	069729-03-000	YD	Fabric - Drapery - Bedspread - Rose (P08, P38)
	069729-04-000	YD	Fabric - Drapery - Bedspread - Rust (P09, P39)
	072334-16-000	YD	Fabric - Upholstery - Navy (P07, P37)
	072334-15-000	YD	Fabric - Upholstery - Rose (P08, P38)
	072334-17-000	YD	Fabric - Upholstery - Rust (P09, P39)
	038421-01-000	YD	Ticking - Mattress - Gold
	059859-01-N01	FT	Trim Asm. - Medium Almond Vinyl
	070502-01-000	YD	Vinyl - Medium Almond
	057093-01-N07	EA	Button Asm. - Cover #60 - Nail - Vinyl
	057550-03-P07	EA	Button Asm. - Nail - #36 - Short - Vinyl
	075269-01-P07	EA	Button Asm. - Square - #65 - w/3/4" Stud - Navy (P37)
	075269-01-P08	EA	Button Asm. - Square - #65 - w/3/4" Stud - Rose (P38)
	075269-01-P09	EA	Button Asm. - Square - #65 - w/3/4" Stud - Rust (P39)
	071127-03-P07	EA	Button Asm. - Square - #65 - Navy (P37)
	071127-03-P08	EA	Button Asm. - Square - #65 - Rose (P38)
	071127-03-P09	EA	Button Asm. - Square - #65 - Rust (P39)

DINETTE GROUP

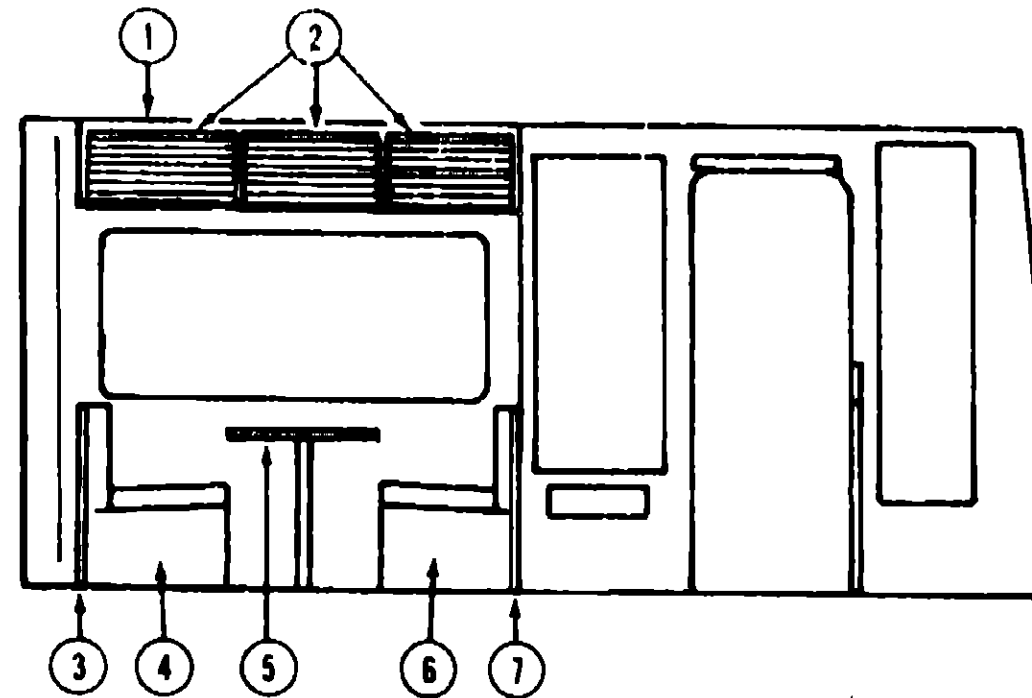

CONVENTIONAL DINETTE AND OVERHEAD CABINERY

Key	Part Number	U/M	Description
1	M96046-01-P07	EA	Cabinet Asm. - Overhead - Right Front
2	063224-08-P07	EA	Door Asm. - Dinette Overhead Cabinet - Rolled - 23.9" x 16"
3	M01151-02-P07	EA	Cabinet Asm. - Dinette Back - Left Hand
4	MU1150-02-P07	EA	Cabinet Asm. - Dinette Seat - Left Hand
5	M75195-02-P07	EA	Table Asm. - Dinette - w/o Hardware - Almond Butcher Block - w/o Cupholders
6	M01150-01-P07	EA	Cabinet Asm. - Dinette Seat - Right Hand
7	M01151-01-P07	EA	Cabinet Asm. - Dinette Back - Right Hand
	074549-06-P37	EA	Pad Asm. - Dinette Seat - Left - Navy (P07)
	074549-06-P38	EA	Pad Asm. - Dinette Seat - Left - Rose (P08)
	074549-06-P39	EA	Pad Asm. - Dinette Seat - Left - Rust (P09)
	074549-07-P37	EA	Pad Asm. - Dinette Seat - Right - Navy (P07)
	074549-07-P38	EA	Pad Asm. - Dinette Seat - Right - Rose (P08)
	074549-07-P39	EA	Pad Asm. - Dinette Seat - Right - Rust (P09)
	053200-05-000	EA	Bracket - Upper Wall Mount - 23.5" - Beige
	053201-03-000	EA	Bracket - Table Mount - 23"
	024275-05-000	EA	Rod - Table Lift - 8" x 23.5" - Beige
	024281-07-000	EA	Bracket - Lower Wall Mount - 22.12"
	024276-08-000	EA	Leg Asm. - Table - 28.38" - Beige
	064050-01-000	EA	Hinge - Table Leg - Beige
	024282-01-000	EA	Brace - Table Leg
	024283-01-000	EA	Clip - 1" O.D. Tube
	049493-03-000	EA	Catch - Table Leg - Mounts on Floor - Beige
			Not illustrated

CORNER LOUNGE CHAIRS

Key	Part Number	U/M	Description
	066235-01-L07	EA	Cabinet Asm. - Corner Lounge Chair - Right
	065924-01-L07	EA	Cabinet Asm. - Corner Lounge Chair - Left
	063224-07-N07	EA	Door Asm. - Rolled - 15.5" x 12.9" - Left or Right
	M71206-01-P07	EA	Table Asm. - Lounge - Almond
	061882-02-000	EA	Leg Asm. - Table - Pivot
	061879-02-000	EA	Leg Asm. - Table - Fixed
	024275-06-000	EA	Rod - Table Lift
	024281-08-000	EA	Bracket - Table Lift - Mounts on Table
	053200-06-000	EA	Support - Table - 14.5" - Mounts on Wall
	061880-01-000	EA	Plug - Leg Cupler
	053201-04-000	EA	Hanger Bracket - 13.5" (Mounts on Table)

1983 WINNEBAGO
TABLE OF CONTENTS

WC621RB	A-1 - B-16
WC723RH	B-17 - D-8
WC723RB	D-9 - E-24
WC823RH	F-1 - G-16
WC823RB	G-17 - I-8

1983 WC621RB INDEX

Floor Plan	A-1 - A-2
Accessories Group	A-3 - A-5
Bath Group	A-6
Chassis Group	A-7
Curtain, Cushion & Pad Group	A-8 - A-13
Dinette Group	A-14
Driver's Compartment Group	A-15 - A-16
Electrical Group	A-17 - A-19
Exterior Body Group	A-20 - A-24
Galley Group	B-1
Heating & Air Conditioning Group	B-2
Interior Finish Group	B-3 - B-4
LP Group	B-5
Lounge Group	B-6
Water & Sewage Group	B-7 - B-8
Window, Vent & Exterior Door Group	B-9 - B-16

DRIVER'S COMPARTMENT GROUP

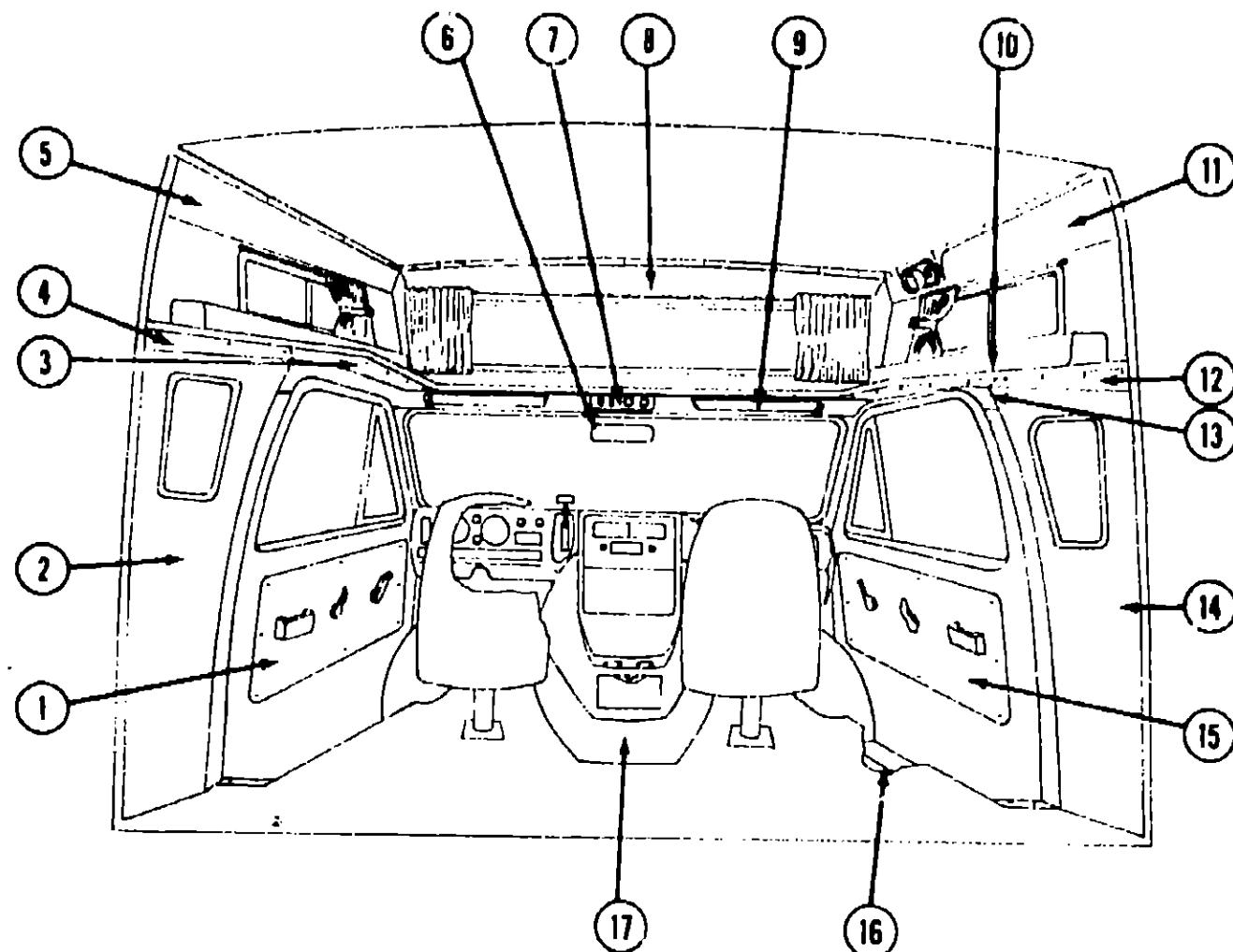

MISCELLANEOUS DRIVER'S COMPARTMENT COMPONENTS

Key	Part Number	U/M	Description
1	059492-01-P07	EA	Side Panel - Cab Door - Left - Navy (P37)
1	059492-01-P08	EA	Side Panel - Cab Door - Left - Rose (P38)
1	059492-01-P09	EA	Side Panel - Cab Door - Left - Rust (P39)
.	074139-03-P07	EA	Side Panel Lower - Cab Door - Left - Navy (P37)
.	074139-03-P08	EA	Side Panel Lower - Cab Door - Left - Rose (P38)
.	074139-03-P09	EA	Side Panel Lower - Cab Door - Left - Rust (P39)
2	052818-05-000	EA	Panel Asm. - Wingwall Transition - Inner Left Hand
3	M53719-01-P07	EA	Pad Asm. - Headliner
4	056051-01-P07	EA	Pad Asm. - Sleeper Board - Left
5	064185-02-000	EA	Panel - Left - Light Oak
6	040714-01-000	EA	Mirror - Inside - Rear View - Glare Proof
.	067490-01-000	EA	Button - Mirror - Rear View - Support
7	049360-10-000	EA	Console - Overhead - w/Cut-out (Dome Light & Hourmeter)
7	049360-11-000	EA	Console - Overhead - w/Cut-out (Dome Light & Voltmeter)
7	049360-12-000	EA	Console - Overhead - Light Oak (No Cut-Out)
.	056288-01-000	EA	Dome Light Asm.
8	054893-03-000	EA	Cap - Upper Front - Inner - Light Oak
9	056802-04-000	EA	Sunvisor Asm. - Almond - Left or Right
10	066246-01-P07	EA	Sleeper Board Asm.
11	064186-02-000	EA	Panel - Right - Light Oak
12	056051-02-P07	EA	Pad Asm. - Sleeper Board - Right
13	071615-02-P07	EA	Pad Asm. - Headliner - Right
.	071615-01-P07	EA	Pad Asm. - Headliner - Left
14	052818-06-000	EA	Panel Asm. - Wingwall Transition - Inner Right Hand

DRIVER'S COMPARTMENT GROUP (CONTINUED)

MISCELLANEOUS DRIVER'S COMPARTMENT COMPONENTS (CONT)

Key	Part Number	U/M	Description
15	059491-01-P07	EA	Side Panel - Cab Door - Right - Navy (P37)
15	059491-01-P08	EA	Side Panel - Cab Door - Right - Rose (P38)
15	059491-01-P09	EA	Side Panel - Cab Door - Right - Rust (P39)
.	074139-02-P07	EA	Side Panel Lower - Cab Door - Right - Navy (P37)
.	074139-02-P08	EA	Side Panel Lower - Cab Door - Right - Rose (P38)
.	074139-02-P09	EA	Side Panel Lower - Cab Door - Right - Rust (P39)
.	044860-01-000	EA	Step Matt - Rubber - Black - Left Hand
16	044860-02-000	EA	Step Matt - Rubber - Black - Right Hand
17	071645-01-000	EA	Motor Cover
.	Not illustrated		

BUCKET SEAT PEDESTAL AND SEAT BELTS

Key	Part Number	U/M	Description
1	069585-06-000	EA	Plate - Top - Pedestal Asm. - Single - Bucket Seat
2	069585-03-000	EA	Plate - Sub - Pedestal Asm. - Bucket Seat
3	069585-02-000	EA	Plate - Base - Pedestal Asm. - Bucket Seat
.	069585-05-000	EA	Hardware Kit - Bolt/Acorn Nut - 4 ea. - Pedestal Asm.
.	056271-02-000	EA	Belt Asm. - Seat - 2" x 72" - Black
.	041322-01-000	EA	Washer - Flat 15/32" I.D. x 2 3/8" O.D. - Seat Belt
.	007021-01-000	EA	Belt Asm. - Seat - 2" x 90" - Black
.	007222-01-000	EA	Belt Asm. - Seat - 2" x 60" - Black
.	043910-01-000	EA	Bracket Asm. - Seat Belt
.	058375-01-000	EA	Bracket - Seat Belt - Washer
.	069246-01-000	EA	Adjuster Asm. - Seat w/Lock
.	059246-02-000	EA	Adjuster Asm. - Seat w/o Lock
.	Not illustrated		

1983 WINNEBAGO TABLE OF CONTENTS

WC821RB	A-1 - B-16
WC723RH	B-17 - D-8
WC723RB	D-9 - E-24
WC823RH	F-1 - G-16
WC823RB	G-17 - I-8

1983 WC821RB INDEX

Floor Plan	A-1 - A-2
Accessories Group	A-3 - A-5
Bath Group	A-6
Chassis Group	A-7
Curtain, Cushion & Pad Group	A-8 - A-13
Dinette Group	A-14
Driver's Compartment Group	A-15 - A-16
Electrical Group	A-17 - A-19
Exterior Body Group	A-20 - A-24
Galley Group	B-1
Heating & Air Conditioning Group	B-2
Interior Finish Group	B-3 - B-4
LP Group	B-5
Lounge Group	B-6
Water & Sewage Group	B-7 - B-8
Window, Vent & Exterior Door Group	B-9 - B-16

ELECTRICAL GROUP

BULBS

Key	Part Number	U/M	Description
	037935-01-000	EA	Bulb - 1157
	037936-01-000	EA	Bulb - 1157 A
	038010-01-000	EA	Bulb - 1143
	008103-01-000	EA	Bulb - 53
	008213-01-000	EA	Bulb - 57
	008214-01-000	EA	Bulb - 87
	008215-01-000	EA	Bulb - 1003
	008216-01-000	EA	Bulb - 1034
	008217-01-000	EA	Bulb - 1073
	008218-01-000	EA	Bulb - 1141
	008219-01-000	EA	Bulb - 658
	008220-01-000	EA	Bulb - 12V - 25W
	036198-01-000	EA	Bulb - 194
	700020-01-000	EA	Bulb - 12V - 20W - 1383

FUSES AND CIRCUIT BREAKERS

Key	Part Number	U/M	Description
	056473-01-000	EA	Fuse - Slow Blow - 6 1/4 Amp
	008233-01-000	EA	Fuse - 12 Volt - 6 Amp.
	008234-01-000	EA	Fuse - 12 Volt - 10 Amp.
	008235-01-000	EA	Fuse - 12 Volt - 15 Amp.
	008236-01-000	EA	Fuse - 12 Volt - 20 Amp.
	008248-01-000	EA	Fuse - 110 Volt - 30 Amp. - AGU
	008252-01-000	EA	Fuse - 110 Volt - 50 Amp.
	008208-01-000	EA	Circuit Breaker - 12 Volt - 40 Amp.
	008211-01-000	EA	Circuit Breaker - 12 Volt - 6 Amp.
	008268-01-000	EA	Circuit Breaker - 12 Volt - 30 Amp. w/Mount
	033573-01-000	EA	Circuit Breaker - 12 Volt - 20 Amp. w/Mount
	071279-01-000	EA	Circuit Breaker - 30/15 Amp. - 120 Volt
	071279-02-000	EA	Circuit Breaker - 15/15 Amp. - 120 Volt
	071279-03-000	EA	Circuit Breaker - 15/20 Amp. - 120 Volt
	071279-04-000	EA	Circuit Breaker - 30 Amp. - 120 Volt
	071279-05-000	EA	Circuit Breaker - 20 Amp. - 120 Volt
	071279-06-000	EA	Circuit Breaker - 30/15 Amp. - 120 Volt
	071279-07-000	EA	Circuit Breaker - 20/20 Amp - 120 Volt
	071280-01-000	EA	Circuit Breaker Blank

INTERIOR LIGHTS

Key	Part Number	U/M	Description
	056288-01-000	EA	Light - Dome - Drivers Compartment
	033508-02-000	EA	Light - Dome - Ivory - 1 Bulb - US - Progressive Dynamics, Inc.
	033508-03-000	EA	Light - Dome - Ivory - 1 Bulb - CSA - Progressive Dynamics, Inc.
	033509-02-000	EA	Light - Dome - Ivory - 2 Bulb - US - Progressive Dynamics, Inc.
	033509-03-000	EA	Light - Dome - Ivory - 2 Bulb - CSA - Progressive Dynamics, Inc.
	061424-01-000	EA	Light - 12 V Receptacle - Aisle - IP
	024418-01-000	EA	Lamp Asm. - Map/Gauge/Aisle
	053346-01-000	EA	Light - High Intensity - Brown
	007309-01-000	EA	Light - Step Well
	072353-01-000	EA	Light - Reading - 360 Swivel - Single

ELECTRICAL GROUP (CONTINUED)

EXTERIOR LIGHTS

Key	Part Number	U/M	Description
	058030-01-000	EA	Tall Lamp Asm. - 3 Bulb - Chrome - Right
	058030-02-000	EA	Tall Lamp Asm. - 3 Bulb - Chrome - Left
	058030-01-700	EA	Lens - Tall Lamp - Red
	058030-01-701	EA	Lens - Tall Lamp - Back Up
	058030-01-702	EA	Lens - Tall Lamp - Amber
	042405-03-000	EA	Base - Rectangular Clearance Light
	042405-01-000	EA	Lens - Clearance Light - Red w/Reflex
	042405-04-000	EA	Lens - Clearance Light - Red w/o Reflex
	042405-02-000	EA	Lens - Clearance Light - Amber w/Reflex
	042405-05-000	EA	Lens - Clearance Light - Amber w/o Reflex
	063735-01-000	EA	Reflector - Stick On - Amber

WIRE, SWITCHES AND RECEPTACLES

Key	Part Number	U/M	Description
	008024-01-000	FT	Wire - 18.5 Bonded - Orange/White/Yellow/Blue/Brown
	008025-01-000	FT	Wire - 18.5 Bonded - Orange/White/Yellow/Blue/Green
	008028-01-000	FT	Wire - 18.5 Bonded - Blue/Red/Yellow/Orange/White
	008030-01-000	FT	Wire - 18.5 Bonded - Red/Blue/Orange/Green
	008251-01-000	EA	Holder - Fuse - Black - Screw Type
	008277-01-000	EA	Holder - Fuse - Black - Panel Mount
	008195-01-000	EA	Switch - Push Button - 12 Volt
	006077-01-000	EA	Plaque - Compressor Switch
	008054-01-000	EA	Cord - Power - 10-3 Amp. - 25' - UL
	034818-05-000	EA	Holder - Receptacle - Plastic
	039342-02-000	EA	Receptacle - Single Ivory
	039342-01-000	EA	Receptacle - Duplex Brown - T Junction
	024571-03-000	EA	Cover Plate - Receptacle - Jumbo Brown Plastic
	024571-01-000	EA	Cover Plate - Receptacle - Jumbo Steel Brown
	008294-01-000	EA	Cover Plate - Brown Steel - 4" x 4"
	008289-01-000	EA	Box - Electrical - Steel - 4" x 4"
	039343-01-000	EA	Cap - End - Receptacle
	008162-01-000	EA	Switch - Double Toggle - Spade Brown
	008163-01-000	EA	Switch - Toggle Brown
	031144-01-000	EA	Switch - Center Off - DPDT - Black 30A
	054532-01-000	EA	Housing Pin Asm. - 6 Position
	064398-01-000	EA	Housing Asm. - Trailer Receptical Plug - Female
	064450-01-000	EA	Housing Asm. - Trailer Receptical Plug - Male
	008164-01-000	EA	Cover Plate - Switch - Brown
	024924-01-000	EA	Receptacle - Power Cord
	008058-01-000	EA	Adaptor - Power Cord
	047353-01-000	EA	Cover - Receptacle - Ground Fault
	053126-02-000	EA	Receptacle - Ground Fault - Interrupter - 125 Volt - Brown
	058707-01-000	EA	Receptacle - Single - Brown - Thomas & Belts
	058708-01-000	EA	Receptacle - Duplex - Brown - Thomas & Belts
	058048-01-000	EA	Cover - Electrical - Rain Tight (Exterior)
	008157-01-000	EA	Receptacle - Single (Exterior)
	061405-02-000	EA	Plate - Receptacle - Duplex - Pewter
	059784-03-000	EA	Switch - Intermittent Wiper
	059784-02-000	EA	Controller - Intermittent Wiper
	024461-01-000	EA	Switch - Battery - STMP

1983 WINNEBAGO
TABLE OF CONTENTS

WC621RB	A-1 - B-16
WC723RH	B-17 - D-8
WC723RB	D-9 - E-24
WC823RH	F-1 - G-18
WC823RB	G-17 - I-8

1983 WC621RB INDEX

Floor Plan	A-1 - A-2
Accessories Group	A-3 - A-5
Bath Group	A-6
Chassis Group	A-7
Curtain, Cushion & Pad Group	A-8 - A-13
Dinette Group	A-14
Driver's Compartment Group	A-15 - A-16
Electrical Group	A-17 - A-19
Exterior Body Group	A-20 - A-24
Galley Group	B-1
Heating & Air Conditioning Group	B-2
Interior Finish Group	B-3 - B-4
LP Group	B-5
Lounge Group	B-6
Water & Sewage Group	B-7 - B-8
Window, Vent & Exterior Door Group	B-9 - B-16

ELECTRICAL GROUP (CONTINUED)

MISCELLANEOUS ELECTRICAL COMPONENTS

Key	Part Number	U/M	Description
	047338-01-000	EA	Isolator - Dual Battery
	047369-01-700	EA	Battery - 12 Volt - 105 Amp. Deep Cycle - Dry
	057899-01-000	EA	Battery - 12 Volt - Maintenance Free
	008168-01-000	EA	Solenoid - Dual Battery - Relay
	046775-01-000	EA	Valve - Gas - Change Over
	024459-03-000	EA	Gauge - Voltmeter - w/Bracket
	024462-01-000	EA	Switch - Battery Condition
	031035-01-000	EA	Gauge - Hourmeter - Generator
	024976-01-000	EA	Switch - Generator w/o Circuit Board
	024460-01-000	EA	Gauge - Vacuum
	024461-01-000	EA	Switch - Battery - Changeover
	048885-01-000	EA	Plaque - Switch Mounting
	039861-01-000	EA	Sending Unit - Wemac
	031720-01-000	EA	Spacer - Receptacle - Brown Plastic - CSA
	071278-01-000	EA	Control Center 32 Amp. - 120V/12V
	048812-04-000	EA	Control Panel - Basic
	048812-09-000	EA	Control Panel - Insert - w/LP Gauge - Digital Alarm - Refrigerator Alarm
	072351-01-000	EA	Control Panel Complete - Digital Alarm - LP Gauge - Refrigerator Alarm
	072351-03-000	EA	Control Panel Complete - Digital Alarm - LP Gauge
	063739-01-000	EA	Battery - 12 Volt - 90 Amp.

EXTERIOR BODY GROUP

SEALANTS, ADHESIVES AND FASTENERS

Key	Part Number	U/M	Description
	034552-08-000	EA	Sealant - Off White Silicone
	034552-04-000	EA	Sealant - Beige Silicone
	034552-02-000	EA	Sealant - Clear Silicone
	004349-01-000	EA	Sealant - Black Silicone
	069637-01-000	EA	Sealant - Weatherban 404 Tube - 3M
	004346-02-000	EA	Sealant - White Silicone
	009200-01-000	EA	Tape - Furnace - 1 1/2"
	004353-01-000	FT	Tape - Gasket - 1/8" x 3/4" - White
	002825-01-000	FT	Weather Stripping - Roof Vent
	002337-01-000	EA	Adhesive - 3M - 1300 Tube
	004005-01-000	GL	Adhesive - Swifts - Green - Glue (Sidewalls)
	004020-01-000	QT	Adhesive - ABS Cement (Plastic Fillings)
	029051-01-000	EA	Adhesive - Spray Vinyl
	000G66-08-12R	EA	Screw - #8 - 18 x 3/4" SDPH - Beige
	000G66-08-12S	EA	Screw - #8 - 18 x 3/4" SDPH - Off White
	000G66-08-12M	EA	Screw - #8 - 18 x 3/4" SDPH - Gray
	000G66-08-16R	EA	Screw - #8 - 18 x 1" SDPH - Beige
	000G66-08-16S	EA	Screw - #8 - 18 x 1" SDPH - Off White
	000G66-08-16M	EA	Screw - #8 - 18 x 1" SDPH - Gray
	000G64-08-16R	EA	Screw - #8 - 18 x 1" SDPH - SF/DR - Beige
	000G64-08-16S	EA	Screw - #8 - 18 x 1" SDPH - SF/DR - Off White
	000G64-08-16M	EA	Screw - #8 - 18 x 1" SDPH - SF/DR - Gray
	053766-01-000	EA	Bedding Compound - Tube Black - Schnee Moorehead
	069640-02-000	FT	Tape - 1/2" x 1/8" x 50' - Gray - 3M
	069640-01-000	FT	Tape - 1/4" Bead x 20' - Gray - 3M
	069640-03-000	FT	Tape - 3/4" x 1/8" x 50' - Gray - 3M
	069640-04-000	FT	Tape - 2" x 3/32" x 45' - Gray - 3M

MISCELLANEOUS EXTERNALLY MOUNTED PARTS

Key	Part Number	U/M	Description
	011129-01-000	EA	Plumbing Seal - Roof Vent - 1 1/2"
	048817-01-000	EA	Assist Handle - w/Light
	048817-01-700	EA	Lens - Assist Handle
	010230-03-000	EA	Fill - City Water - Recessed - Beige
	058808-02-000	EA	Water Fill - Lockable - Beige
	009101-01-000	EA	Door Holder - Male
	009101-02-000	EA	Door Holder - Female
..	The illustrated parts breakdown for this item is provided on the Common Items Fiche.		

1983 WINNEBAGO
TABLE OF CONTENTS

WC621RB	A-1 - B-16
WC723RH	B-17 - D-8
WC723RB	D-9 - E-24
WC823RH	F-1 - G-16
WC823RB	G-17 - I-8

1983 WC621RB INDEX

Floor Plan	A-1 - A-2
Accessories Group	A-3 - A-5
Bath Group	A-6
Chassis Group	A-7
Curtain, Cushion & Pad Group	A-8 - A-13
Dinette Group	A-14
Driver's Compartment Group	A-15 - A-16
Electrical Group	A-17 - A-19
Exterior Body Group	A-20 - A-24
Galley Group	B-1
Heating & Air Conditioning Group	B-2
Interior Finish Group	B-3 - B-4
LP Group	B-5
Lounge Group	B-6
Water & Sewage Group	B-7 - B-8
Window, Vent & Exterior Door Group	B-9 - B-16

EXTERIOR BODY GROUP (CONTINUED)

LABELS, DECALS AND EXTERIOR PAINT

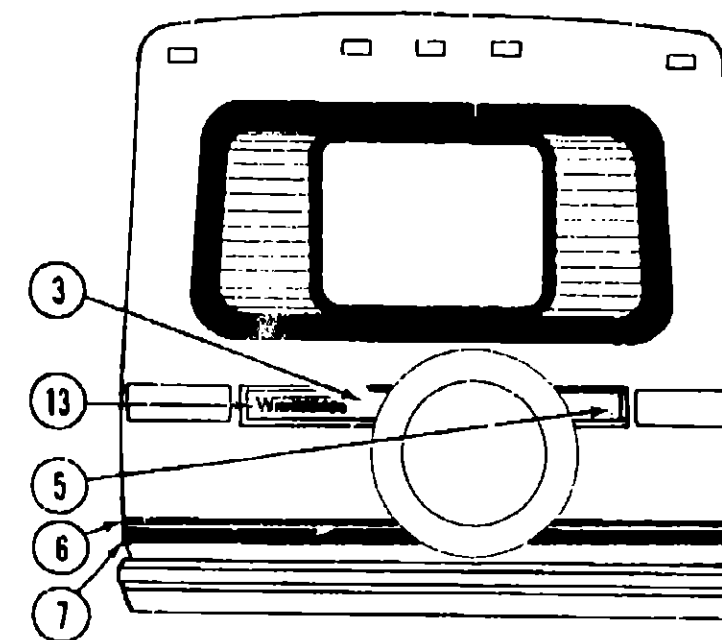
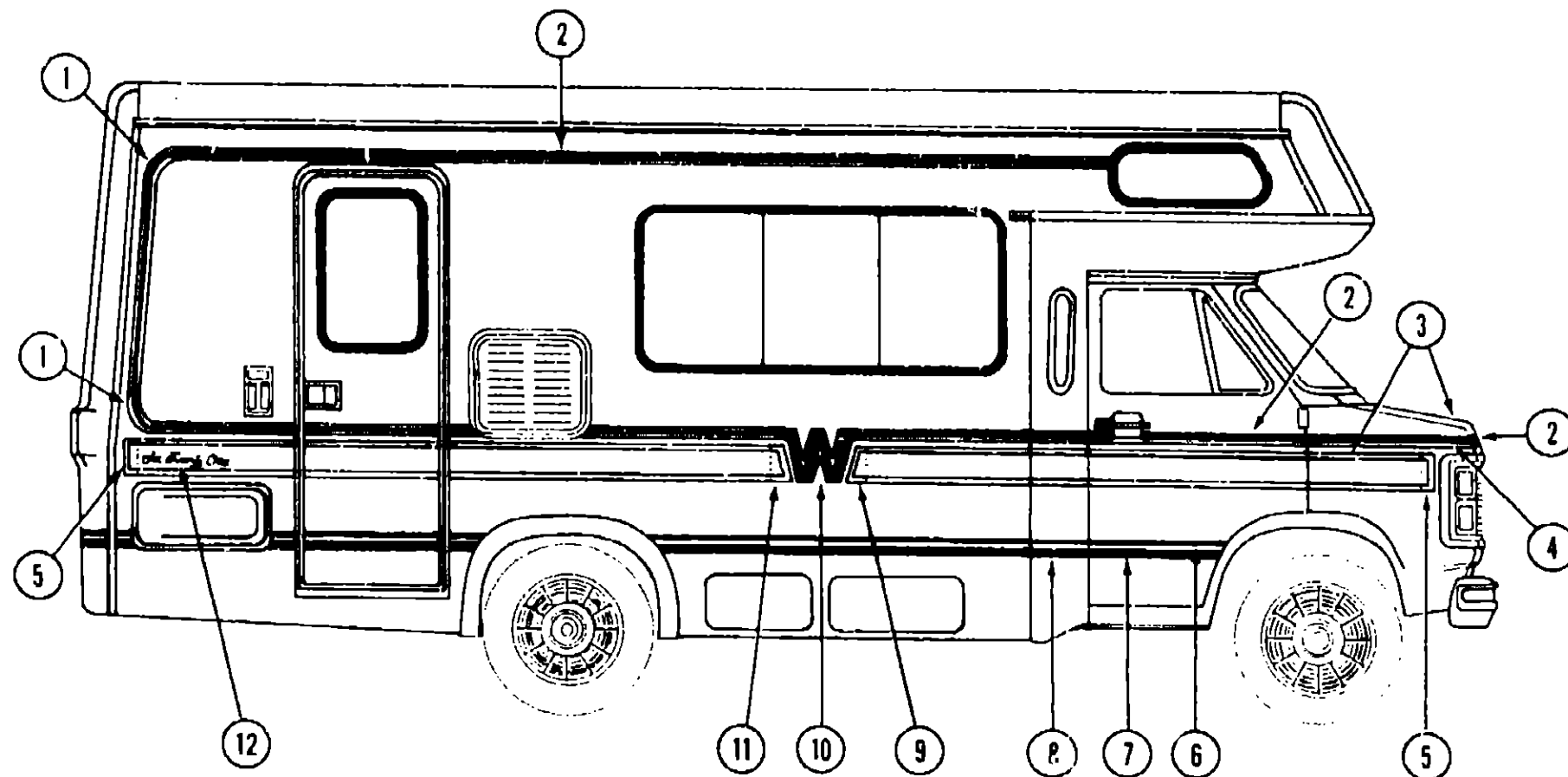

Key	Part Number	U/M	Description
1	073718-01-000	EA	Decal - 90° - Dark Brown Metallic
2	069245-08-000	FT	Decal - 1.69" - Dark Brown Metallic
3	069245-09-000	FT	Decal - 6" - Light Blue Metallic
3	069245-10-000	FT	Decal - 6" - Burgundy Metallic
3	069245-11-000	FT	Decal - 6" - Orange Metallic
•	073730-01-000	EA	Decal - 6" End - Hood - Right - Light Blue Metallic
•	073730-02-000	EA	Decal - 6" End - Hood - Left - Light Blue Metallic
•	073730-03-000	EA	Decal - 6" End - Hood - Right - Burgundy Metallic
•	073730-04-000	EA	Decal - 6" End - Hood - Left - Burgundy Metallic
•	073730-05-000	EA	Decal - 6" End - Hood - Right - Orange Metallic
•	073730-06-000	EA	Decal - 6" End - Hood - Left - Orange Metallic
•	069745-01-000	EA	Decal - Winne
•	069745-02-000	EA	Decal - Bago
4	073729-01-000	EA	Decal - Right Fender - Dark Brown Metallic
4	073729-02-000	EA	Decal - Left Fender - Dark Brown Metallic
5	073722-01-000	EA	Decal - 6" End - Light Blue Metallic
5	073722-02-000	EA	Decal - 6" End - Burgundy Metallic
5	073722-03-000	EA	Decal - 6" End - Orange Metallic
6	041273-59-000	FT	Decal - 1" - Light Blue Metallic
6	041273-60-000	FT	Decal - 1" - Burgundy Metallic
6	041273-61-000	FT	Decal - 1" - Orange Metallic
7	041273-62-000	FT	Decal - 2.5" - Dark Brown Metallic
8	073731-01-000	EA	Decal - 2.5" - Right - Dark Brown Metallic
8	073731-02-000	EA	Decal - 2.5" - Left - Dark Brown Metallic
9	073719-02-000	EA	Decal - 6" Cap - Right - Light Blue Metallic
9	073719-04-000	EA	Decal - 6" Cap - Right - Burgundy Metallic
9	073719-06-000	EA	Decal - 6" Cap - Right - Orange Metallic
10	073725-01-000	EA	Decal - W - Dark Brown Metallic

Key	Part Number	U/M	Description
11	073719-01-000	EA	Decal - 6" Cap - Left - Light Blue Metallic
11	073719-03-000	EA	Decal - 6" Cap - Left - Burgundy Metallic
11	073719-05-000	EA	Decal - 6" Cap - Left - Orange Metallic
12	067794-01-000	EA	Decal - Six Twenty One
13	050313-21-000	EA	Decal - Winnebago
•	006031-01-000	EA	Label - Potable Water Only
•	006187-01-000	EA	Label - Sewage
•	006188-01-000	EA	Label - Waste Water
•	006199-01-000	EA	Label - Exit - Escape Window
•	006028-01-000	EA	Label - Drain Cap - 2" x 3"
•	040944-01-000	EA	Label - Open - Entrance Door
•	047731-01-000	EA	Label - Emergency Exit
•	054531-01-000	EA	Label - LP Gas Only
•	061417-01-000	EA	Label - Fuel
•	050225-01-000	EA	Label - Warning - Stove Vent - US
•	006015-01-000	EA	Label - Patent Motor Home
•	006064-01-000	EA	Label - Seat - w/o Seat Belt
•	064378-01-000	EA	Label - Flying W w/Thermo Panel
•	006040-01-000	EA	Tag - Gas - Refueling Warning
•	006062-01-000	EA	Tag - Electrical - 110 V Connection
•	045681-01-000	EA	Paint - Gloss Black - Acrylic Enamel - 1 Gallon (99A Dupont)
•	045681-03-000	EA	Paint - Gloss Black - Acrylic Enamel - 16 oz. Aerosol (99A Dupont)
•	Not illustrated		

1983 WINNEBAGO TABLE OF CONTENTS

WC621RB	A-1 - B-16
WC723RH	B-17 - D-8
WC723RB	D-9 - E-24
WC823RH	F-1 - G-16
WC823RB	G-17 - I-8

1983 WC621RB INDEX

Floor Plan	A-1 - A-2
Accessories Group	A-3 - A-5
Bath Group	A-6
Chassis Group	A-7
Curtain, Cushion & Pad Group	A-8 - A-13
Dinette Group	A-14
Driver's Compartment Group	A-15 - A-16
Electrical Group	A-17 - A-19
Exterior Body Group	A-20 - A-24
Galley Group	B-1
Heating & Air Conditioning Group	B-2
Interior Finish Group	B-3 - B-4
LP Group	B-5
Lounge Group	B-6
Water & Sewage Group	B-7 - B-8
Window, Vent & Exterior Door Group	B-9 - B-16

EXTERIOR BODY GROUP (CONTINUED)

EXTERIOR BODY PANELS AND SHEET ALUMINUM

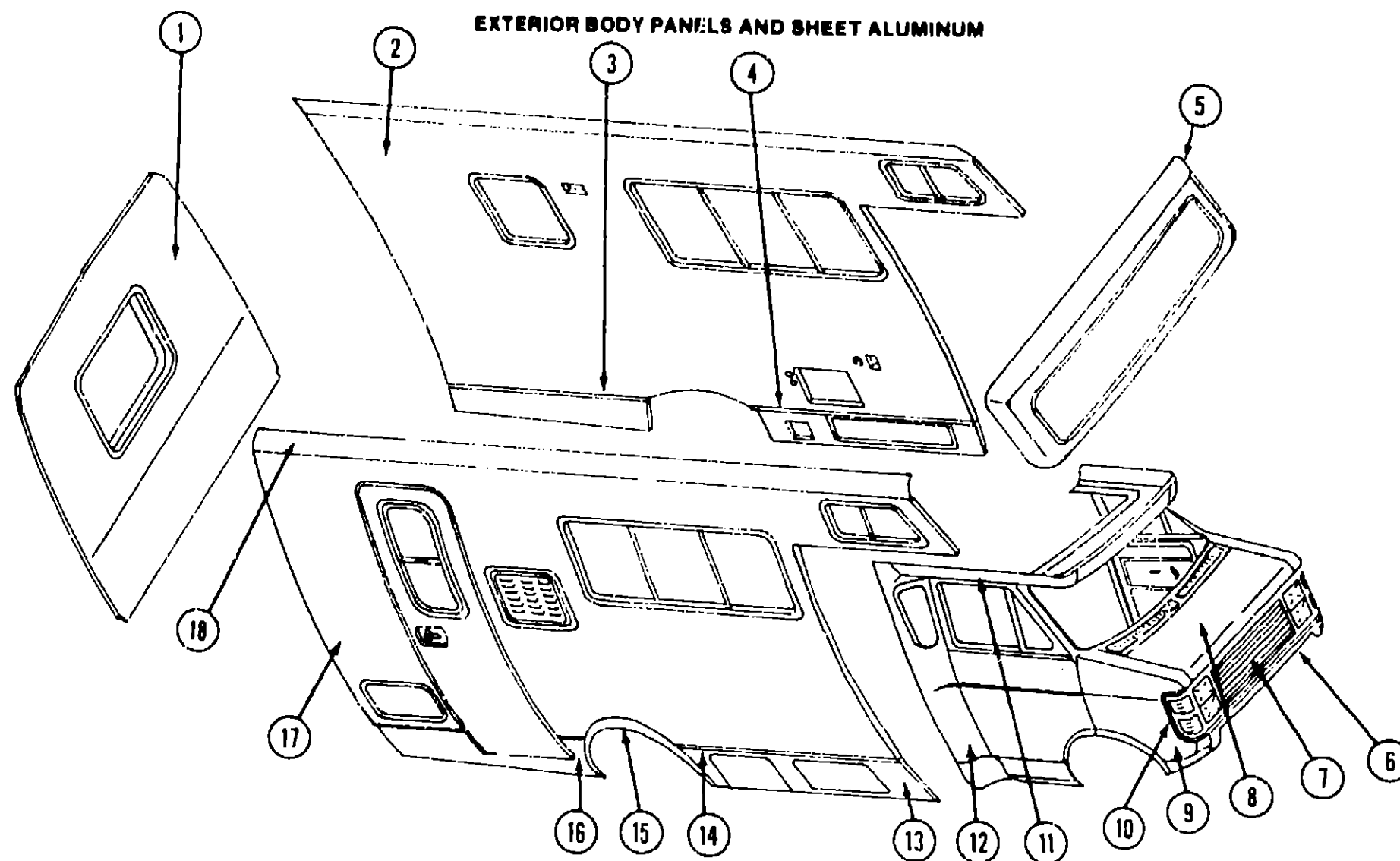

Key	Part Number	U/M	Description
1	065031-03-000	EA	Cap - Backwall - Beige - Fiberglass
2	073883-01-P07	EA	Sidewall Asm. - Left - Navy (P37)
2	073883-01-P08	EA	Sidewall Asm. - Left - Rose (P38)
2	073883-01-P09	EA	Sidewall Asm. - Left - Rust (P39)
3	064346-04-000	EA	Valance Panel Asm. - Left Rear - Beige
•	073694-01-P07	EA	Roof Asm.
•	055613-06-000	EA	Trim - Roof Front and Rear - Beige - 12' 3"
4	064317-04-000	EA	Valance Panel Asm. - Left Front - Beige
5	054854-02-000	EA	Cap - Upper Front - Outer - Beige - Fiberglass
6	054898-01-000	EA	Panel - Lower Grille - Valance
7	052847-01-000	EA	Grille Asm.
•	054901-02-000	EA	Bezel - Headlamp - Right
•	054901-01-000	EA	Bezel - Headlamp - Left
•	049185-01-000	EA	Capsule Asm. - Headlamp Rectangular - Left - High/Low Beam
•	049186-01-000	EA	Capsule Asm. - Headlamp Rectangular - Right - High/Low Beam
•	067786-01-000	EA	Capsule Asm. - Headlamp Rectangular - Left - High Beam
•	067787-01-000	EA	Capsule Asm. - Headlamp Rectangular - Right - High Beam
•	050030-01-000	EA	Housing Asm. - Headlamp
8	052395-01-000	EA	Hood
•	057896-02-000	EA	Hinge Asm. - Hood
•	054863-02-000	EA	Wheel Well Housing - Front Half - Right
•	054863-01-000	EA	Wheel Well Housing - Front Half - Left
9	052394-02-000	EA	Fender - Right Hand
•	052394-01-000	EA	Fender - Left Hand
•	058360-02-000	EA	Front End Asm. - Fiberglass - Includes Hood w/o Front Grille
•	Not illustrated		

1983 WINNEBAGO TABLE OF CONTENTS

WC621RB	A-1 - B-16
WC723RH	R-17 - D-8
WC723RB	D-9 - E-24
WC823RH	F-1 - G-16
WC823RB	G-17 - I-8

1983 WC621RB INDEX

Floor Plan	A-1 - A-2
Accessories Group	A-3 - A-5
Bath Group	A-6
Chassis Group	A-7
Curtain, Cushion, & Pad Group	A-8 - A-13
Dinette Group	A-14
Driver's Compartment Group	A-15 - A-16
Electrical Group	A-17 - A-19
Exterior Body Group	A-20 - A-24
Galley Group	B-1
Heating & Air Conditioning Group	B-2
Interior Finish Group	B-3 - B-4
LP Group	B-5
Lounge Group	B-6
Water & Sewage Group	B-7 - B-8
Window, Vent & Exterior Door Group	B-9 - B-15

GALLEY GROUP

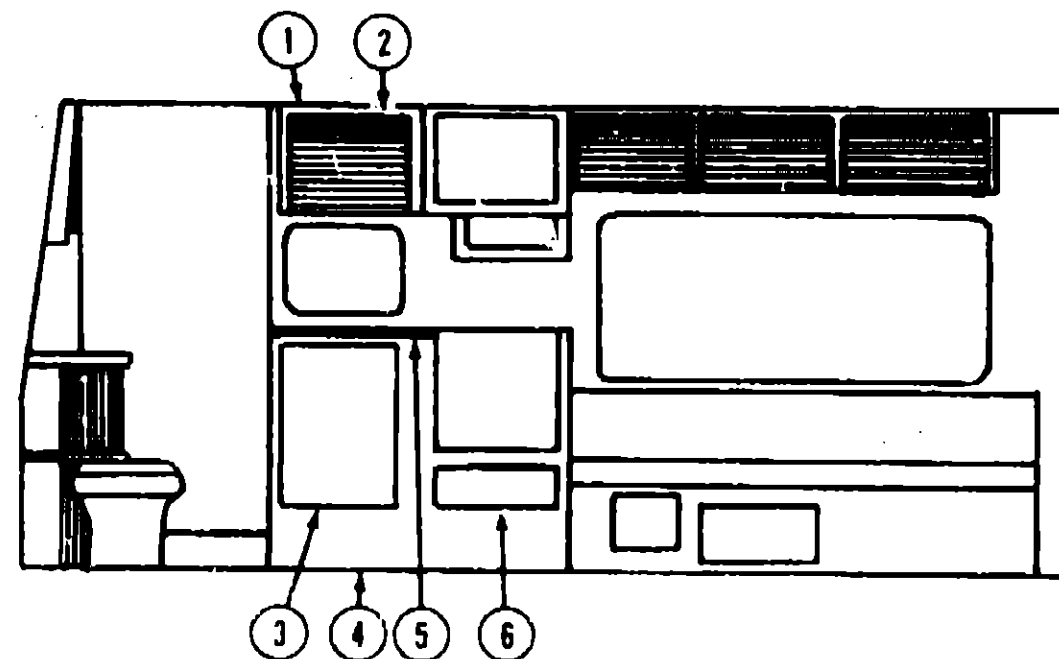

GALLEY CABINETRY

Key	Part Number	U/M	Description
1	M67170-01-P07	EA	Cabinet Asm. - Galley Overhead - w/o Microwave
•	M67171-01-P07	EA	Cabinet Asm. - Galley Overhead - w/Microwave
•	063224-09-P07	EA	Door Asm. - Galley Overhead Cabinet - Rolled - 23.9" x 22"
2	063224-17-P07	EA	Door Asm. - Galley Overhead Cabinet - Rolled - 21.9" x 22"
•	M69889-01-P07	EA	Cabinet Asm. - Refrigerator
3	069852-50-P07	EA	Door Asm. - Galley Cabinet - 18.2" x 23.1" - w/o Hardware
4	M73816-01-P07	EA	Cabinet Asm. - Galley - w/o Countertop, Doors or Hardware
5	M01136-01-P07	EA	Countertop Asm. - Galley Cabinet - Almond Loom
6	M59913-11-P07	EA	Drawer Asm. - Galley and Refrigerator Cabinet - 18.9" x 23.6" - w/o Hardware
•	Not illustrated		

GALLEY HARDWARE AND APPLIANCES

Key	Part Number	U/M	Description
•	068615-01-000	EA	Sink - Double - Stainless Steel w/Bolts
•	011053-01-000	EA	Faucet - 8" - Swing Spout - US
•	011053-02-000	EA	Faucet - 8" - Swing Spout - CSA
•	067051-01-000	EA	Stove Spatter Guard - Safety Glass
•	037888-03-000	FT	Rail - Drawer V Glide
•	066437-01-000	EA	Strainer - Sink - w/Basket
•	053424-04-P07	EA	Sink Cover - Large - Palomino
•	046954-03-000	EA	Hood - Stove - Powered w/Spice Rack - Black Face - US
•	046954-04-000	EA	Hood - Stove - Powered w/Spice Rack - Black Face - CSA
•	055282-03-000	EA	Range - 4 Burner - Small Oven - Chrome - Magic Chef
•	075217-01-000	EA	Refrigerator - 3 way - 5.9 cu. ft. Norcold
•	054450-01-000	EA	Level - Refrigerator
•	067578-03-000	EA	Bracket Asm. - Refrigerator Tie Down - Left
•	067578-04-000	EA	Bracket Asm. - Refrigerator Tie Down - Right
•	052771-02-000	EA	Oven - Microwave - Magic Chef 207-4
•	071734-01-P07	EA	Pad Asm. - Wemac Panel - Vinyl
•	074981-01-000	EA	Cutting Board - Maple

• The illustrated parts breakdown for this item is provided on the Common Items Fiche.

HEATING & AIR CONDITIONING GROUP

Key	Part Number	U/M	Description
•	074025-01-000	EA	A/C - Compressor Mount Package - 350 C.I.D.
•	072343-01-000	EA	A/C - Compressor - Sankyo 510
•	073716-01-000	EA	A/C - Condenser Asm. - 350 C.I.D. C-Body
•	056455-02-000	EA	A/C - Evaporator Asm.
•	049401-01-000	EA	Heater Asm. - Rear (Auxiliary)
•	049401-01-700	EA	Valve - Water Control (Auxiliary Heater)
•	049401-01-701	EA	Control Cable (Auxiliary Heater)
•	049401-01-702	EA	Motor Asm. (Auxiliary Heater)
•	049401-01-703	EA	Heater Core (Auxiliary Heater)
•	049401-01-704	EA	Switch (Auxiliary Heater)
•	058906-01-000	EA	Control Panel (Auxiliary Rear Heater)
•	056464-01-000	EA	Register - w/Damper - 4" Round
•	056464-02-000	EA	Register - w/o Damper - 4" Round
•	058119-04-000	EA	Control Asm. - Heater A/C
•	009198-01-000	EA	Duct - Flexible - 4" I.D. x 25'
•	031604-01-000	EA	Bonnet - Heat Register
•	069634-01-723	EA	Thermostat - Horizontal Wall Mount
•	009200-01-000	EA	Tape - Furnace - 1 1/2"
•	023146-01-000	EA	Clamp - Screw Type - 4"
•	050784-01-000	EA	Vent Package - Furnace - 3-6" Wall
•	051391-01-000	EA	Water Heater - w/o Motor Aid
•	075695-01-000	EA	Furnace - 24,000 BTU - w/Direct Ignition
•	073743-01-000	EA	Shroud Asm. - Ceiling - Inside - Roof Air - Cool Only 13,500 BTU - Coleman
•	073744-01-000	EA	Shroud Asm. - Ceiling Inside - Roof Air - Heat and Cool 13,500 BTU - Coleman
•	073742-01-000	EA	Air Conditioner - 110 Volt - Roof Air - 13,500 BTU - Rotary
•	The illustrated parts breakdown for this item is provided on the Common Items Fiche.		

1983 WINNEBAGO TABLE OF CONTENTS

WC621RB	A-1 - B-16
WC723RH	B-17 - D-8
WC723RB	D-9 - E-24
WC823RH	F-1 - G-16
WC823RB	G-17 - I-8

1983 WC621RB INDEX

Floor Plan	A-1 - A-2
Accessories Group	A-3 - A-5
Bath Group	A-6
Chassis Group	A-7
Curtain, Cushion & Pad Group	A-8 - A-13
Dinette Group	A-14
Driver's Compartment Group	A-15 - A-16
Electrical Group	A-17 - A-19
Exterior Body Group	A-20 - A-24
Galley Group	B-1
Heating & Air Conditioning Group	B-2
Interior Finish Group	B-3 - B-4
LP Group	B-5
Lounge Group	B-6
Water & Sewage Group	B-7 - B-8
Window, Vent & Exterior Door Group	B-9 - B-16

INTERIOR FINISH GROUP

PANELING AND COUNTERTOP MATERIALS

Key	Part Number	U/M	Description
	068344-05-000	SF	Paneling - 159 Elm - 48" x 96"
	072336-12-000	SF	Paneling - Jakarta Burlap - 48" x 84" (Wall)
	045983-01-000	SF	Paneling - 825 Buff - 48" x 96" (Ceiling)
	072336-17-000	SF	Paneling - Decor - Yarn Stripe - 48" x 84" (Galley) (P37)
	072336-16-000	SF	Paneling - Decor - Yarn Stripe - 48" x 84" (Galley) (P38)
	072336-18-000	SF	Paneling - Decor - Yarn Stripe - 48" x 84" (Galley) (P39)
	072336-19-000	SF	Paneling - Wicker Weave - 48" x 84" (Refrigerator Door Insert)
	057880-03-000	SF	Paneling - Wicker Weave - 48" x 84" (Style & Rail Door Insert)
	069731-03-000	SF	Plastic Laminate - Almond Butcher Block - 48" x 96"
	072337-03-000	SF	Plastic Laminate - Almond Loom - 48" x 96"
	072337-03-019	EA	Plastic Laminate - Almond Loom - 1 19" x 96"
	069731-03-019	EA	Plastic Laminate - Almond Butcher Block - 1 19" x 96"

INTERIOR MOLDINGS AND TRIMS

Key	Part Number	U/M	Description
	009812-08-000	FT	Molding - Outside Corner - 50"
	009767-06-000	FT	Wetting - Beige
	009815-03-000	FT	T-Molding - 75" - Light Brown
	022992-08-000	FT	Molding - Reverse Cove
	070504-02-000	FT	U-Channel - .82" - Light Brown
	009779-03-000	FT	U-Channel - 1 1/8" - Light Brown
	017768-05-000	FT	U-Channel - 3/16" - Light Brown
	052859-01-N01	FT	Accent Trim - Medium Almond Vinyl (Beige)
	059352-01-000	FT	Insert - Vinyl - Style and Rail Door
	047354-01-000	EA	Batt Strip - 825 Buff - 8' (Ceiling)
	069733-23-000	EA	Batt Strip - Jakarta Burlap - 8' (Wall)
	058204-01-000	EA	Batt Strip - 159 Elm - 8'
	064382-01-000	FT	Extrusion - Plastic Trim - Rolled Door
	042356-01-000	EA	Plug - Button - Mahogany - 3/8" Diameter

FABRICS AND CARPET

Key	Part Number	U/M	Description
	072333-04-000	YD	Fabric - Drapery - Wraparound
	072333-02-000	YD	Fabric - Drapery - Sheers
	072334-02-000	YD	Fabric - Drapery - Accent Rose (P38)
	072334-13-000	YD	Fabric - Drapery - Accent Navy (P37)
	072334-14-000	YD	Fabric - Drapery - Accent Rust (P39)
	069729-02-000	YD	Fabric - Drapery - Bedspread - Navy (P37)
	069729-03-000	YD	Fabric - Drapery - Bedspread - Rose (P38)
	069729-04-000	YD	Fabric - Drapery - Bedspread - Rust (P39)
	072334-16-000	YD	Fabric - Upholstery - Navy (P37)
	072334-15-000	YD	Fabric - Upholstery - Rose (P38)
	072334-17-000	YD	Fabric - Upholstery - Rust (P39)
	038421-01-000	YD	Ticking - Mattress - Gold
	072860-02-000	SY	Carpet - Navy (P37)
	069730-08-000	SY	Carpet - Rose (P38)
	068340-06-000	SY	Carpet - Rust (P39)

INTERIOR FINISH GROUP (CONTINUED)

CURTAIN HARDWARE

Key	Part Number	U/M	Description
	053272-01-001	EA	Track - Curtain - Alum 18' - w/Holes
	058116-01-000	EA	Track - Curtain - Brown Plastic
	058001-01-000	EA	Bracket - Shade - Left
	058002-01-000	EA	Bracket - Shade - Right
	009107-01-000	EA	Guide - Nylon Snap - Curtain
	018031-42-000	EA	Track - Curtain - "L" Rod - Alum Extr - 90"
	009701-01-000	EA	Carrier - "L" Rod - Curtain
	009702-01-000	EA	End Stop - "L" Rod - Curtain
	058784-01-000	EA	Pull - Window Shade - Antique Brass
	039175-01-000	EA	Curtain Rod - Ext 48" - 84"
	039175-02-000	EA	Bracket - Curtain Rod
	058115-02-000	YD	Tape - Clear Plastic - w/Guides
	048394-01-000	YD	Tape - Hook - 1" x 25 YD - Beige
	048395-01-000	YD	Tape - Loop - 1" x 25 YD - Beige
	056003-01-000	EA	Bracket - Drapery Retainer - Right
	056003-02-000	EA	Bracket - Drapery Retainer - Left
	056003-03-000	EA	Bracket - Drapery Retainer - Universal

CABINETRY AND TABLE HARDWARE

Key	Part Number	U/M	Description
	053200-05-000	EA	Bracket - Upper Wall Mount - 23 5" - Beige
..	053201-03-000	EA	Bracket - Table Mount - 23"
	024275-05-000	EA	Rod - Table Lift - 8" x 23 5" - Beige
	024281-07-000	EA	Bracket - Lower Wall Mount - 22 12" - Beige
	024276-08-000	EA	Leg Asm - Table - 29 5" - Beige
..	024282-01-000	EA	Brace - Table Leg
..	024283-01-000	EA	Clip - 1" O D Tube
	049493-03-000	EA	Catch - Table Leg - Mounts on Floor - Beige
..	057898-01-000	EA	Latch - Hidden - Cabinet Door
..	057898-02-000	EA	Strike - Hidden Latch - Cabinet Door
	009112-01-000	EA	Flange - 1" - Chrome - Closet Rod
	059753-01-000	EA	Slide - Drawer - Left
	059753-02-000	EA	Slide - Drawer - Right
..	037688-01-000	FT	Rail - Drawer Guide - Steel
..	047744-01-000	EA	Kit - Drawer Guide
	041434-01-000	EA	Hinge - Double Acting - Overhead Doors
	039873-01-000	EA	Catch & Strike - Furnace Door
	072393-04-000	EA	Slide - Drawer
	057671-01-000	EA	Screw Cover - #8 - Beige
	072369-02-000	EA	Mesh - Grill - Brass - 13 8" x 8 8"
	009021-01-000	EA	Catch - Nylon
	009021-02-000	EA	Strike - Nylon Catch
	053331-01-000	EA	Hinge - Offset Side Mount
	064781-02-000	EA	Cup Holder - Plastic
	041389-02-000	EA	Hinge - Table - Wall Mount
	024276-11-000	EA	Leg - Fold Up
	064050-01-000	EA	Hinge - Table Leg
	024282-01-000	EA	Brace - Table Leg
	024283-01-000	EA	Clip - Table Leg
	049493-03-000	EA	Catch - Table Leg - Floor

.. The illustrated parts breakdown for this item is provided on the Common Items Fiche

MISCELLANEOUS PARTS

Key	Part Number	U/M	Description
	053552-01-P07	E/	Handle Asm - Interior Assist - Medium Almond Vinyl
	041944-03-000	EA	Fire Extinguisher - w/Bracket - 5BC
	054185-19-000	EA	Owner's Manual - Itasca - Winnebago
	007038-01-000	EA	Door Mat - Black Rubber - 10 1/2" x 26"

1983 WINNEBAGO TABLE OF CONTENTS

WC621RB	A-1 - B-16
WC723RH	B-17 - D-8
WC723RB	D-9 - E-24
WC823RH	F-1 - G-16
WC823RS	G-17 - I-8

1983 WC621RB INDEX

Floor Plan	A-1 - A-2
Accessories Group	A-3 - A-5
Bath Group	A-6
Chassis Group	A-7
Curtain, Cushion & Pad Group	A-8 - A-13
Dinette Group	A-14
Driver's Compartment Group	A-15 - A-16
Electrical Group	A-17 - A-19
Exterior Body Group	A-20 - A-24
Galley Group	B-1
Heating & Air Conditioning Group	B-2
Interior Finish Group	B-3 - B-4
LP Group	B-5
Lounge Group	B-6
Water & Sewage Group	B-7 - B-8
Window, Vent & Exterior Door Group	B-9 - B-16

LP GROUP

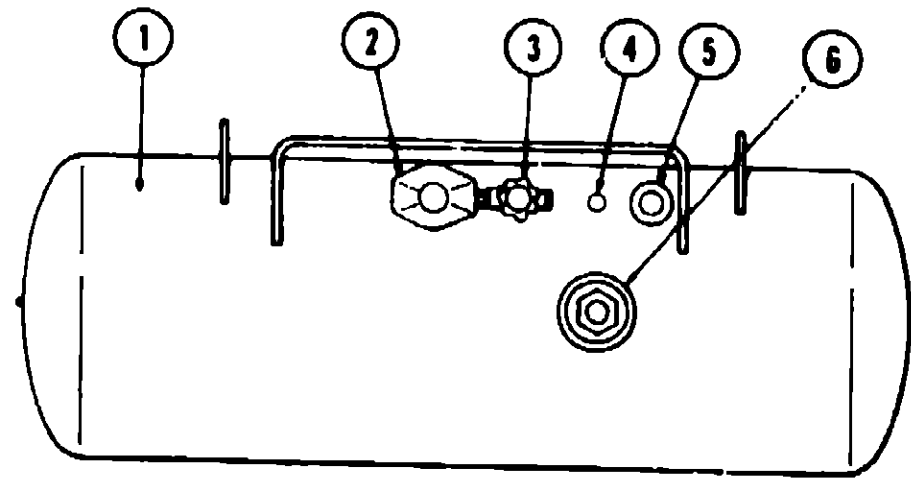

Key	Part Number	U/M	Description
1	074141-01-000	EA	Tank Asm. - LP - Frame Mount - 42 Pound - 12" x 28"
1	074142-01-000	EA	Tank Asm. - LP - Frame Mount - 80 Pound - 13" x 44"
1	074143-01-000	EA	Tank Asm. - LP - Frame Mount - 85 Pound - 14" x 40"
2	065741-01-000	EA	Detector - LP Gas Leak - Marshalltown Instruments
3	058706-01-000	EA	Cover - Regulator - 2 Stage
•	058705-01-000	EA	Regulator - Two Stage - LP Gas
4	040421-01-703	EA	Valve - Vapor Relief
5	040421-01-700	EA	Gauge - Liquid Level - 20% LP
6	040421-01-701	EA	Valve - Filler - LP
•	040421-01-702	EA	Cap - Plastic Fill Valve
7	040421-01-707	EA	Gauge - Float - w/Visible Dial - 85 Pound Tank
•	042281-01-700	EA	Gauge - Float - w/Visible Dial - 42 Pound Tank
•	040421-01-706	EA	Dial - Visible Face - Float Gauge (Tank w/o Electric Transmitter)
•	040440-01-000	EA	Dial - Transmitter - 0 - 90 Ohm (Float Gauge)
•	045703-01-000	EA	Hose Asm. - LP - 3/8" I.D. x 24"
•	047737-02-000	EA	Support - LP Tank - 89.25"
•	053112-01-000	EA	Support - LP Tank - 2" x 2" x 8"
•	Not illustrated		

WINN AIR WITH LANDI-HARTOG (C-BODY)

Key	Part Number	U/M	Description
	065279-01-000	EA	Relief Valve - Hydrostatic - Sherwood
	065287-02-000	EA	Valve - Gasoline Shut-Off
	065820-02-000	EA	Hose Asm. - High Pressure - 36"
	067290-01-001	EA	Hose - Vapor 5/8" x 51"
	068050-07-000	EA	LP Mixer (350 Engine)
	058197-01-000	EA	Instrument Asm. - LP
	068144-01-000	EA	Bracket - Angle - Converter
	068143-01-000	EA	Tube Asm. - Converter - Copper w/Flare Nuts - 5/16" x 270° Bend
	065802-01-000	EA	Gauge - LP Level w/Hardware
	068050-05-000	EA	Switch - LP/Gas Changeover
	068050-01-000	EA	Converter - LP
	068050-02-000	EA	LP Lock Off
	068050-03-000	EA	Switch - LP - Vacuum Safety

LOUNGE GROUP

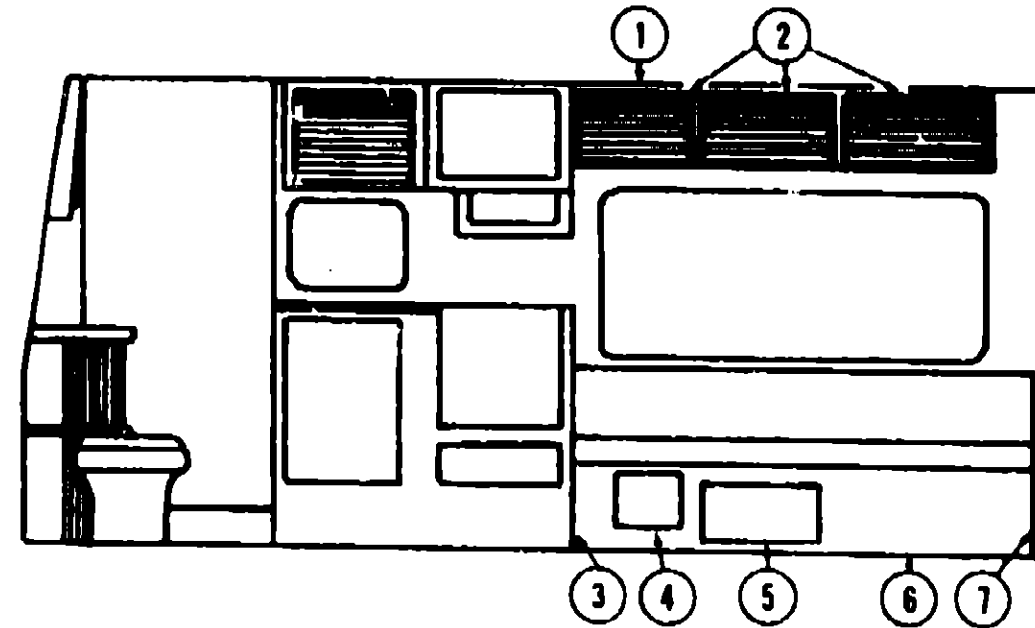

SPRUNG COUCH AND OVERHEAD CABINET

Key	Part Number	U/M	Description
1	M66042-01-P07	EA	Cabinet Asm. - Overhead - Left Front
2	063224-08-P07	EA	Door Asm. - Rolled - 23.9" x 16"
3	067029-01-P07	EA	Panel Asm. - Sprung Couch - Galley Side
4	M69856-04-P07	EA	Furnace Grill Asm. - 13.4" x 14.4" - w/o Hardware
5	M72633-01-P07	EA	Cabinet Face - Sprung Couch - w/o Door or Hardware
6	067030-01-P07	EA	Panel Asm. - Sprung Couch - Forward End
•	057468-02-000	EA	Frame Asm. - Sprung Couch - Right
•	057468-03-000	EA	Frame Asm. - Sprung Couch - Left
•	057468-04-000	EA	Frame Rail - Sprung Couch (2 per couch)
•	057469-01-000	EA	Leg Asm. - Sprung Couch (2 per couch)
•	M53248-01-P07	EA	Table Asm. - Pedestal - w/o Hardware - Almond Butcher Block
•	009040-02-000	EA	Leg - Pedestal Table - 27.5" x 2.25" O.D. - Chrome
•	009040-03-000	EA	Base - Table Leg - Mounts on Table
•	041194-01-000	EA	Base - Table Leg - Mounts in Floor
•	056093-01-P07	EA	Plug Asm. - Pedestal Table - Navy (P37)
•	056093-01-P08	EA	Plug Asm. - Pedestal Table - Rose (P38)
•	056093-01-P09	EA	Plug Asm. - Pedestal Table - Rust (P39)
•	062046-01-000	EA	Clip - Pedestal Leg
•	Not illustrated		

1983 WINNEBAGO TABLE OF CONTENTS

WC621RB	A-1 - B-16
WC723RH	B-17 - D-8
WC723RB	D-9 - E-24
WC823RH	F-1 - G-16
WC823RB	G-17 - I-3

1983 WC621RB INDEX

Floor Plan	A-1 - A-2
Accessories Group	A-3 - A-5
Bath Group	A-6
Chassis Group	A-7
Curtain, Cushion & Pad Group	A-8 - A-13
Dinette Group	A-14
Driver's Compartment Group	A-15 - A-16
Electrical Group	A-17 - A-19
Exterior Body Group	A-20 - A-24
Galley Group	B-1
Heating & Air Conditioning Group	B-2
Interior Finish Group	B-3 - B-4
LP Group	B-5
Lounge Group	B-6
Water & Sewage Group	B-7 - B-8
Window, Vent & Exterior Door Group	B-9 - B-16

WATER AND SEWAGE GROUP

PLUMBING REPAIR PARTS

Key	Part Number	U/M	Description
..	040539-01-000	EA	Kit - Repair - 3/8" O D Plastic Tube
..	040540-01-000	EA	Kit - Repair - 1/2" O.D Plastic Tube
..	040541-01-000	EA	Kit - Repair - 5/8" O D Plastic Tube
..	045729-01-000	EA	Pump - Water Flow 2 8 G P M
..	063646-01-000	EA	Pump - Water - 2 8 G P.M - Direct Drive - US
..	063646-02-000	EA	Pump - Water - 2 8 G P M - Direct Drive - CSA
..	039647-03-000	EA	Filter - Water Pump - 1/2" MPT
..	052962-01-000	EA	Valve - Stool - 90° 1/2 F x 3/8 MPT
..	039618-01-000	EA	Riser Asm. - 3/8" O D x 24" Tube
..	039618-02-000	EA	Riser Asm - 3/8" O D x 36" Tube
..	039618-04-000	EA	Riser Asm. - 3/8" O D x 72" Tube
..	039618-05-000	EA	Riser Asm - 3/8" O D x 48" Tube
..	035539-01-000	EA	Elbow - Plastic - 3/8 MPT x 3/8 Barb
..	052952-01-000	EA	Nut - Plastic - 1/2 F
..	052953-01-000	EA	Nut - Faucet - 1/2 Tube x 1/2 FPT
..	052954-01-000	EA	Adapter - Nose Cone - 3/8 or 1/2
..	052956-01-000	EA	Tee - Plastic - 1/2 F x 1/2 F x 1/2 F
..	052959-02-000	EA	Connector - Plastic - 1/2 F x 1/2 MPT
..	052959-03-000	EA	Connector - Plastic - 1/2 F x 3/8 MPT
..	052960-01-000	EA	Drain Valve - Line - 1/2 F x 1/2 F
..	052961-01-000	EA	Header - 1/2 F x 1/2 F x 1/2 F x 1/2 F
..	004020-01-000	QT	Adhesive - ABS Cement
..	010201-01-000	EA	Hose - Sewer - 3" x 8 ft w/Clamp
..	062415-01-000	EA	Cap - Sewer - 3"
..	062416-01-000	EA	Hose - Adapter - 3"
..	062417-01-000	EA	Adapter - Termination - 3"
..	062418-02-000	EA	Valve - 3" w/o Handle
..	062419-01-000	EA	Handle - Extension - w/6" Adapter
..	062421-01-000	EA	Valve - 1 1/2" - w/Handle
..	010006-01-000	EA	Elbow - Plastic - 1/8 BD 1 1/2 x 45° H x H
..	010006-01-000	EA	Elbow - Plastic - 1/4 BD 1 1/2 x 90° x Long Turn
..	010134-01-000	EA	Adapter - Plastic - 1 1/2" M x MPT
..	010154-01-000	EA	Ring - Closet - Plastic - 4" F x 3" MPT x L
..	011031-01-000	EA	Waste - Continuous - Double Sink - 11 7/8"
..	011066-01-000	EA	P-Trap - Plastic - 1 1/4"
..	010079-01-000	EA	Tee - Plastic - 1 1/2 H x 1 1/2 H x 1 1/2 H
..	010091-01-000	EA	Wye - Plastic - 3" x 45° - H x H x H
..	010121-01-000	EA	Bushing - Plastic - 1 1/2 S x 1 1/4 H
..	031126-01-000	EA	Elbow - Plastic - 1/4 BD - 3" x 90° x Long Turn
..	010133-01-000	EA	Adapter - Trap - Plastic - 1 1/2" H x MPT
..	050780-01-000	EA	Coupler - Rubber - 3" x 3"
..	010218-01-000	EA	Elbow - 1 1/4 Barb x 1 1/4 MPT - 90°
..	044928-01-000	FT	Tubing - Flex - 1 1/4" ID x 10' Long
..	061607-01-000	EA	Grommet - Rubber - Holding Tank - 1 1/2" MPS
..	061607-02-000	EA	Grommet - Rubber - Holding Tank - 3" MPS
..	010197-01-000	FT	Pipe - ABS Plastic - 3" x 240"
..	065979-01-000	EA	Compartment Asm - Sewer Hose
..	052957-02-000	EA	Elbow - Plastic - 1/2" F x 1/2" MPT
..	052957-03-000	EA	Elbow - Plastic - 1/2" F x 1/4" MPT
..	061607-01-000	EA	Grommet - Holding Tank - 1 1/2" NPS
..	061607-02-000	EA	Grommet - Holding Tank - 3" NPS
..	046524-01-000	EA	Kit - Plastic Fittings - Holding Tank
..	046524-02-000	EA	Kit - Plastic Fittings - Water Tank
..	The illustrated parts breakdown for this item is provided on the Common Items Fiche		

WATER & SEWAGE GROUP (CONTINUED)

HOLDING TANKS AND WATER HEATERS

Key	Part Number	U/M	Description
..	053520-02-000	EA	Tank Asm. - Water - 20 Gallon w/Fittings
..	053520-01-000	EA	Tank - Water - 20 Gallon w/o Fittings
..	064214-02-000	EA	Tank Asm - Water - 36 Gallon w/Fittings
..	064214-01-000	EA	Tank - Water - 36 Gallon w/o Fittings
..	054033-08-000	EA	Tank Asm - Holding - 32 Gallon - Sewage - w/Fittings
..	054033-01-000	EA	Tank - Holding - 32 Gallon - Sewage - w/o Fittings
..	064308-02-000	EA	Tank Asm - Holding - 23 Gallon - w/Fittings
..	064308-01-000	EA	Tank - Holding - 23 Gallon - w/o Fittings
..	051301-01-000	EA	Water Heater - 6 Gallon w/Motor Aid - Atwood - GH63
..	The illustrated parts breakdown for this item is provided on the Common Items Fiche		

**1983 WINNEBAGO
TABLE OF CONTENTS**

WC621RB	A-1 - B-16
WC723RH	B-17 - D-8
WC723RB	D-9 - E-24
WC823RH	F-1 - G-16
WC823RB	G-17 - I-8

1983 WC621RB INDEX

Floor Plan	A-1 - A-2
Accessories Group	A-3 - A-5
Bath Group	A-6
Chassis Group	A-7
Curtain, Cushion & Pad Group	A-8 - A-13
Dinette Group	A-14
Driver's Compartment Group	A-15 - A-16
Electrical Group	A-17 - A-19
Exterior Body Group	A-20 - A-24
Galley Group	B-1
Heating & Air Conditioning Group	B-2
Interior Finish Group	B-3 - B-4
LP Group	B-5
Lounge Group	B-6
Water & Sewage Group	B-7 - B-8
Window, Vent & Exterior Door Group	B-9 - B-16

WINDOW, VENT & EXTERIOR DOOR GROUP

WINDOWS AND ACCESS DOORS

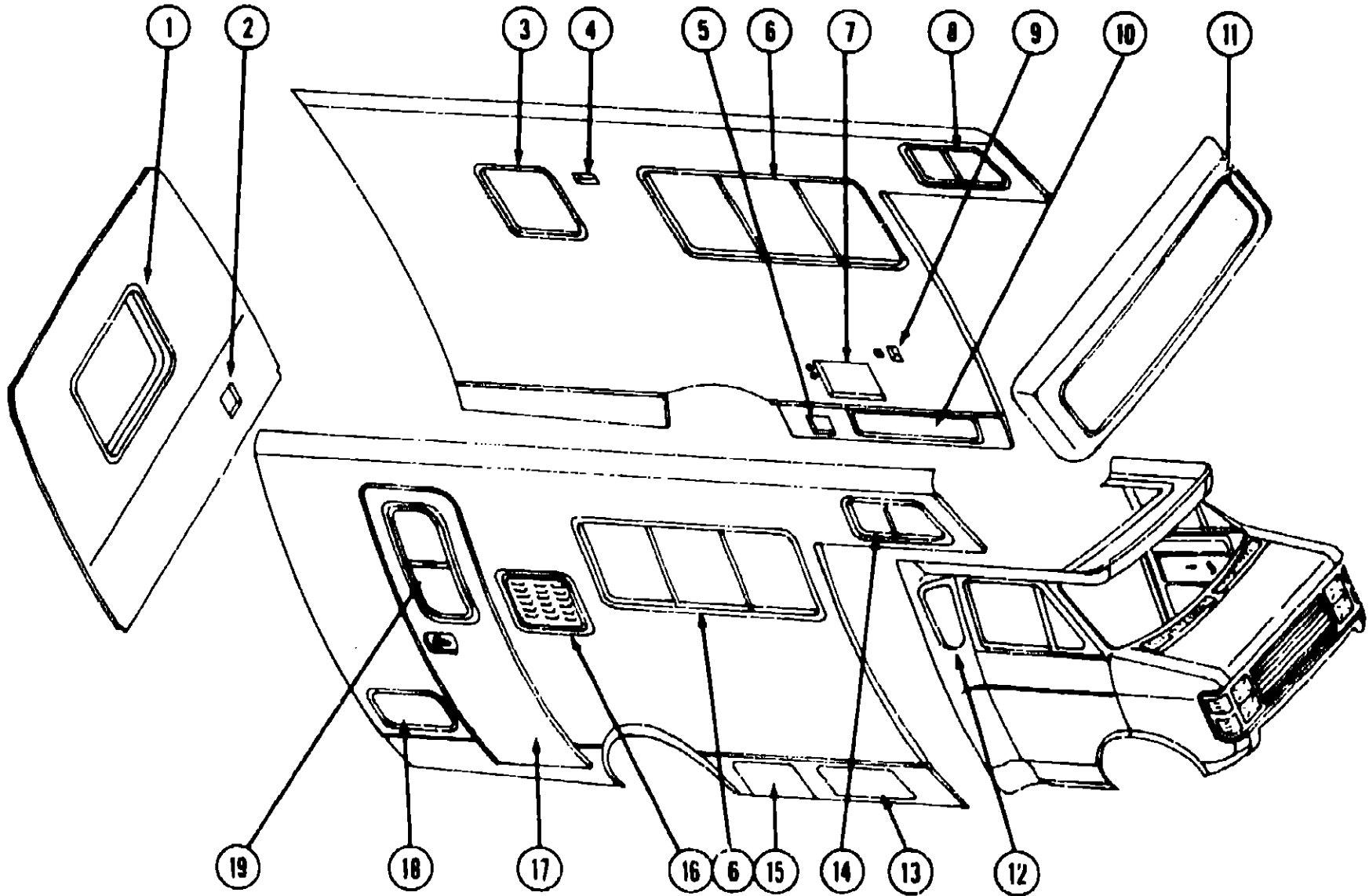

1983 WINNEBAGO
TABLE OF CONTENTS

WC621RB	A-1 - B-16
WC723RH	B-17 - D-8
WC723RB	D-9 - E-24
WC823RH	F-1 - G-16
WC823RB	G-17 - I-8

1983 WC621RB INDEX

Floor Plan	A-1 - A-2
Accessories Group	A-3 - A-5
Bath Group	A-6
Chassis Group	A-7
Curtain, Cushion & Pad Group	A-8 - A-13
Dinette Group	A-14
Driver's Compartment Group	A-15 - A-16
Electrical Group	A-17 - A-19
Exterior Body Group	A-20 - A-24
Galley Group	B-1
Heating & Air Conditioning Group	B-2
Interior Finish Group	B-3 - B-4
I.P. Group	B-5
Lounge Group	B-6
Water & Sewage Group	B-7 - B-8
Window, Vent & Exterior Door Group	B-9 - B-16

Key	Part Number	U/M	Description
1	056772-01-000	EA	Window Asm. - Rear Escape - 24" x 33" - Black Anod. (w/o inside frame)
2	061186-02-000	EA	Door - Fuel Fill
3	074853-01-000	EA	Window Asm. - Slider - 12.6" x 20.8" - Black (w/o inside frame)
4	049352-02-000	EA	Vent - Stove Hood - Outside - Beige
5	NOTE	EA	Door Asm. - Power Cord w/Hatch - Beige (See Access Doors)
6	066785-04-000	EA	Window Asm. - Single Slider - 27" x 65"
7	052009-02-000	EA	Door - Water Heater - Beige
8	056655-02-000	EA	Window Asm. - Bunk Slant Slider - Left w/o inside frame)
9	058808-02-000	EA	Fill - Water - Lockable - Beige
10	054369-07-000	EA	Door Asm. - LP Storage - 36.7" x 9.6" - Beige

Key	Part Number	U/M	Description
11	054557-01-000	EA	Glass - Upper Front Cap
12	054558-01-000	EA	Glass - Wingwall Transition Panel
13	054369-06-000	EA	Door Asm. - LP - 23.6" x 9.6" - Beige
14	056655-01-000	EA	Window Asm. - Bunk Slant Slider - Right (w/o inside frame)
15	064587-02-000	EA	Door Asm. - Battery - 11.2" x 18.6" - Beige
16	069762-03-000	EA	Door Asm. - Refrigerator Access - Beige - w/Twist Lock
17	067688-04-000	EA	Door Asm. - Fiberglass Entry - w/Latch and Hinges - Beige
18	064842-02-000	EA	Door Asm. - Luggage - 24" x 10.36" - Beige - w/Key Lock
18	064841-02-000	EA	Door Asm. - Generator - Beige - w/Twist Lock
19	066253-01-000	EA	Window Asm. - Vertical Slider - 26.9" x 17.8" (w/o inside frame)

WINDOW, VENT & EXTERIOR DOOR GROUP (CONTINUED)

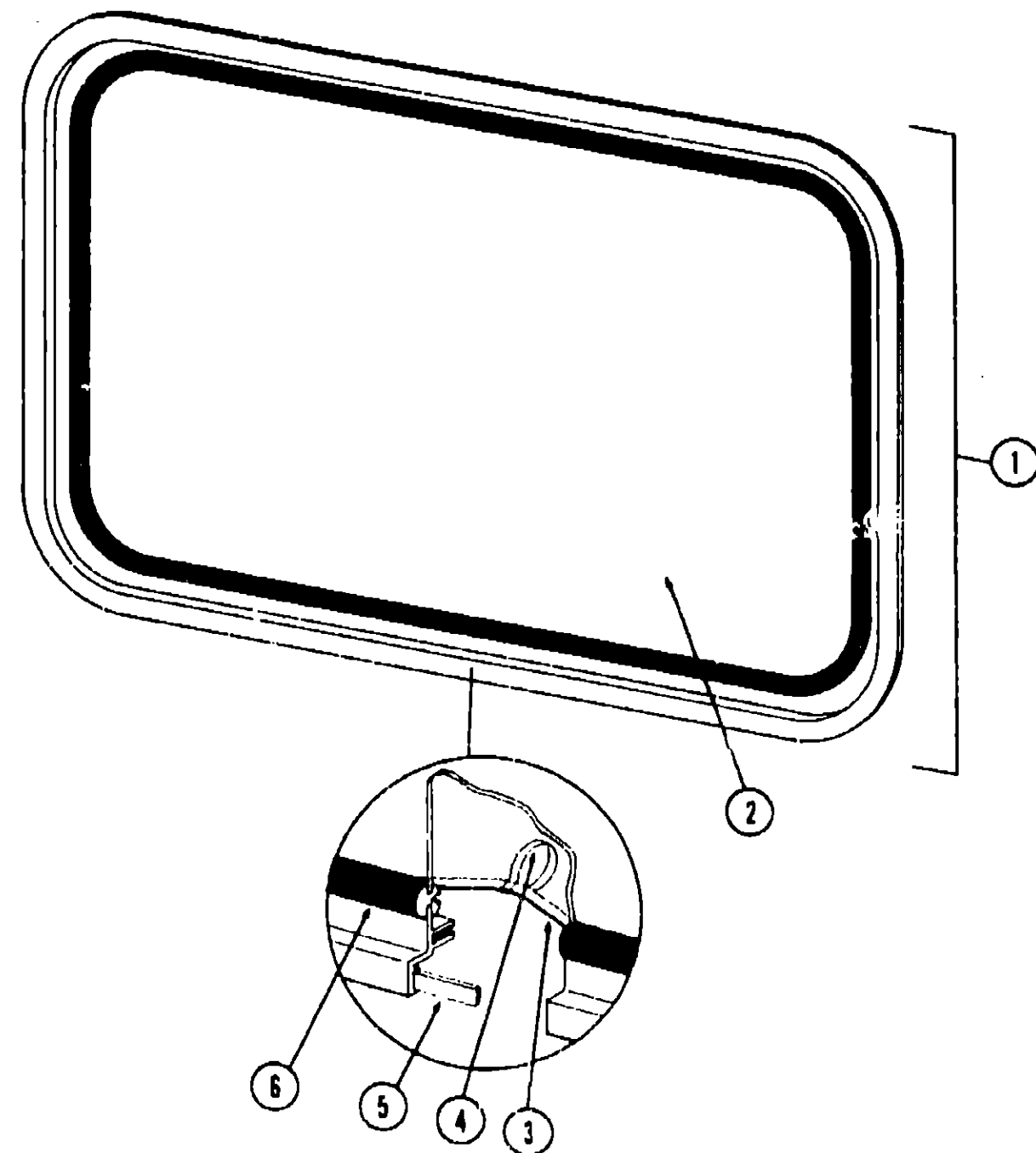

Key	Part Number	U/M	Description
1	056772-01-000	EA	Window Asm. - Rear Escape - 24" x 33" - Black Anod. (w/o inside frame)
2	041392-02-000	EA	Glass - 1/8" x 24.08" x 33.25"
3	002285-01-000	FT	Filler - Weatherstrip - Black
4	020395-01-000	EA	Pull Ring - Escape Window
5	053767-02-000	FT	Tape - 3/16" Bead x 25' - Gray
6	002282-01-000	FT	Weatherstrip - .125" Window
	056770-01-000	EA	Frame - Inside - Escape Window (not included in assembly)
	000199-01-000	EA	Label - Exit - Escape Window
			Not illustrated

WINDOW, VENT & EXTERIOR DOOR GROUP (CONTINUED)

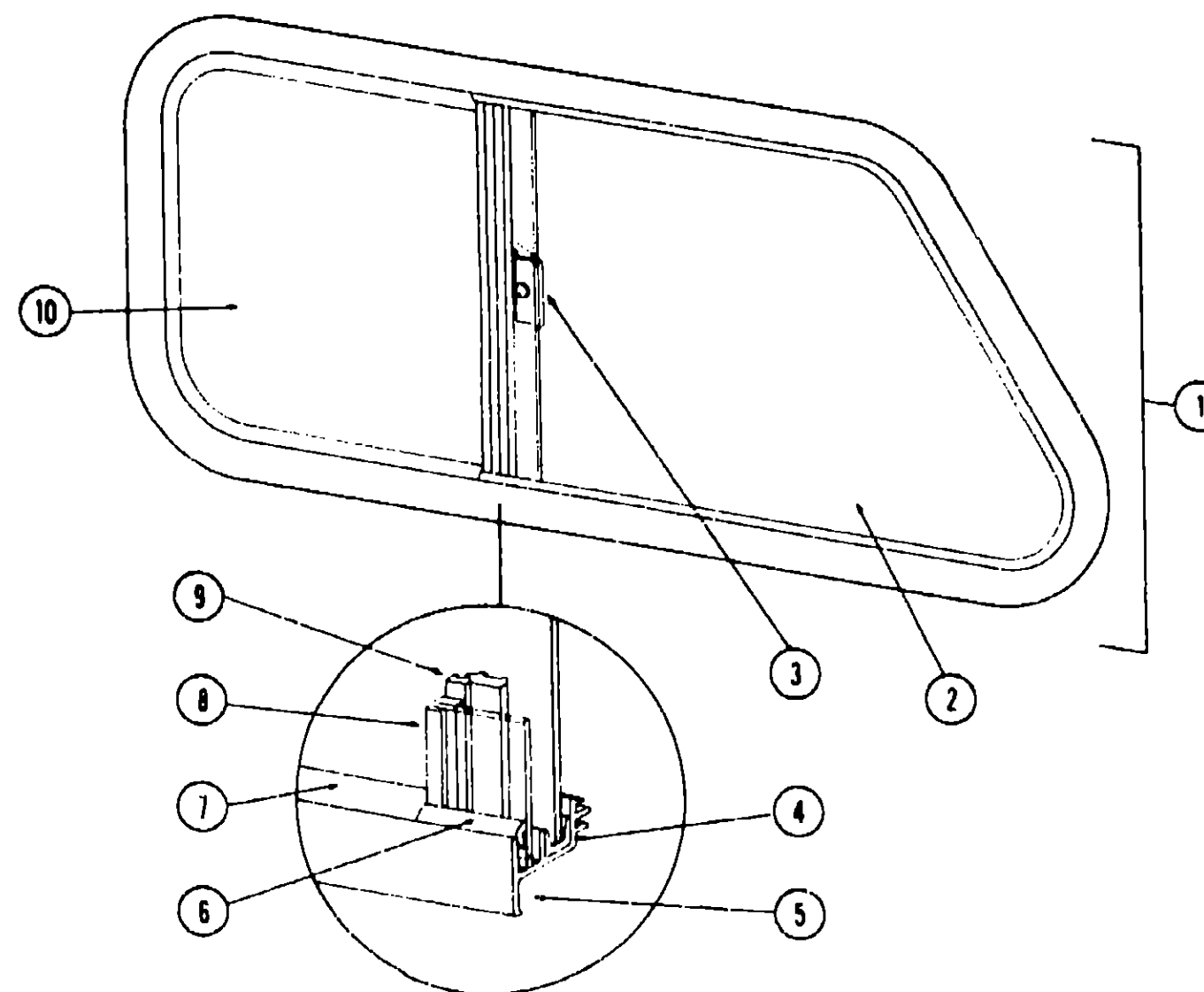

Key	Part Number	U/M	Description
1	056655-01-000	EA	Window Asm. - Bunk Slant Slider - Right (w/o inside frame)
	056655-02-000	EA	Window Asm. - Bunk Slant Slider - Left (w/o inside frame)
2	040919-02-000	EA	Glass - 1/8" x 9.54" x 16.62" - Gray - Stationary
3	047369-01-700	EA	Latch - Window - Plastic - w/Fastener
4	002324-01-000	FT	Channel - Weatherstrip - Glass Run - 1/8" Glass
5	004363-01-000	FT	Tape - Foam - 3/16" x 1/2" - Gray
6	002309-02-000	FT	Spline - Glass - 1/8" - Black
7	057374-02-000	FT	Seal - Window Channel - 1/8" Glass - Black
8	002390-03-204	EA	Holder - Glass Seal - Extr. - Anod. Black - 8.38"
9	041894-22-000	EA	Mullion - 8" - Black Anod.
10	047815-02-000	EA	Glass - 1/8" - Gray - Sliding
	056654-03-000	EA	Frame - Window - Inside - Bunk Slant - Right (not included in assembly)
	056654-04-000	EA	Frame - Window - Inside - Bunk Slant - Left (not included in assembly)
	023713-02-000	EA	Cover - Weephole - Black
	002298-01-000	FT	Spline - Gray - .130" Dia. (Screen)
	002291-01-000	SF	Screen - Gray - Window - 16"
			Not illustrated

1983 WINNEBAGO TABLE OF CONTENTS

WC621RB	A-1 - B-16
WC723RH	B-17 - D-8
WC723RB	D-9 - E-24
WC823RH	F-1 - G-16
WC823RB	G-17 - I-8

1983 WC621RB INDEX

Floor Plan	A-1 - A-2
Accessories Group	A-3 - A-5
Bath Group	A-6
Chassis Group	A-7
Curtain, Cushion & Pad Group	A-8 - A-13
Dinette Group	A-14
Driver's Compartment Group	A-15 - A-16
Electrical Group	A-17 - A-19
Exterior Body Group	A-20 - A-24
Galley Group	B-1
Heating & Air Conditioning Group	B-2
Interior Finish Group	B-3 - B-4
LP Group	B-5
Lounge Group	B-6
Water & Sewage Group	B-7 - B-8
Window, Vent & Exterior Door Group	B-9 - B-16

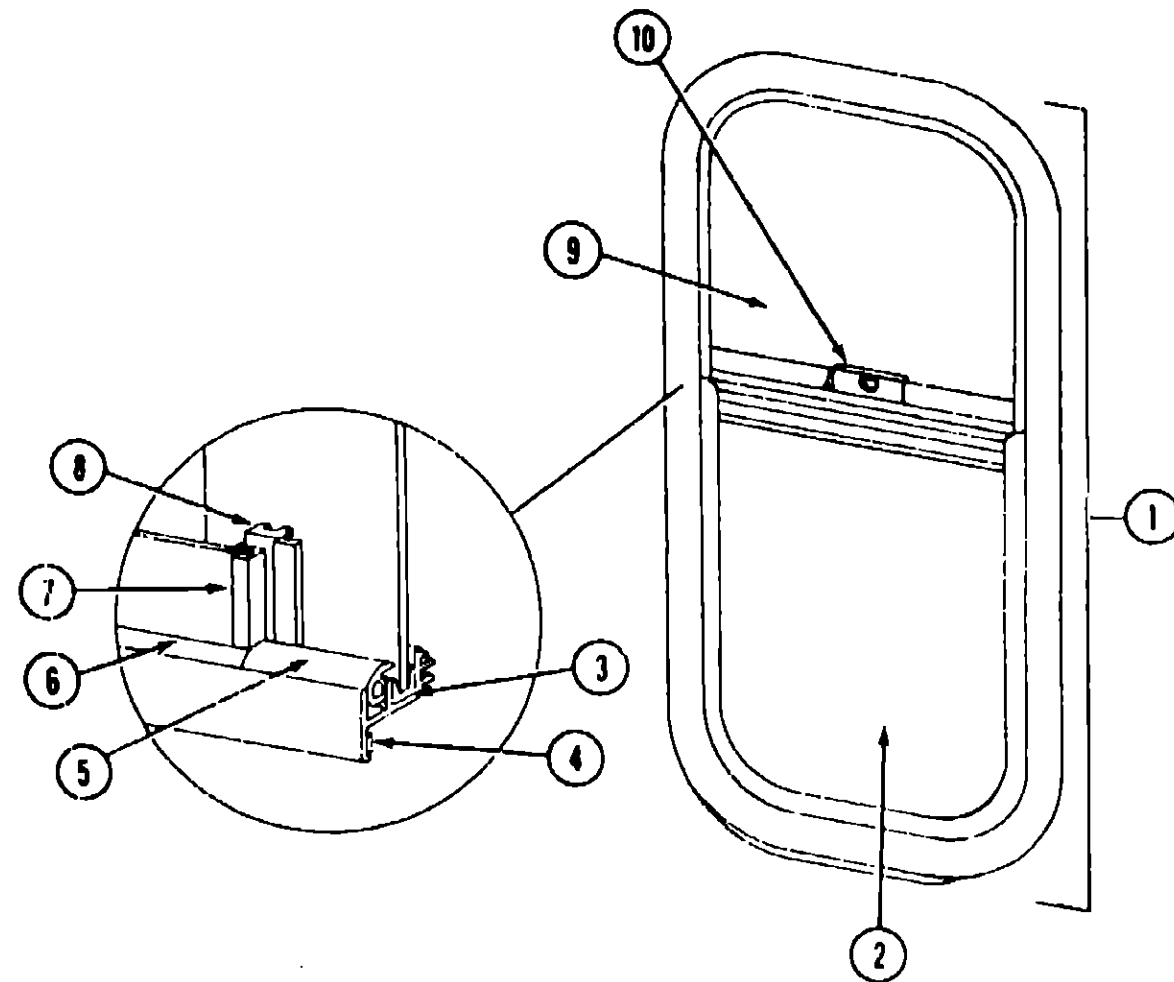

Key	Part Number	U/M	Description
1	074853-01-000	EA	Window Asm. - Vertical Slider - 13" x 23" - Black (w/o inside frame)
2	067609-15-000	EA	Inside Frame - Window - Bolge (not included in assembly)
3	074837-01-000	EA	Glass - Sliding - 1/8" x 12" x 10.9"
4	002324-02-000	FT	Channel - Weatherstrip - Glass Run - 3/16"
5	069840-01-000	FT	Tape - 1/4" Bead x 20' - Gray - 3M
6	002309-02-000	FT	Spline - Glass - 1/8" - Black
7	057374-02-000	FT	Extr. Vinyl - Window Seal - Black
8	M69886-03-012	EA	Seal Holder w/Fin Seal - 11.18" - Black
9	069886-04-000	EA	Mullion - Slider Window
10	074896-04-000	EA	Glass - Stationary - 1/8" x 12" x 10.9"
	047369-01-700	EA	Latch - Window - Plastic w/Fastener
	023320-01-000	EA	Foam Pad - 3/8" Dia. (used w/Plastic Latch)
	073740-01-000	FT	Seal - Fin - Pile - .460"
	002298-01-000	EA	Spline - Gray - .130" Dia. (Screen)
	023713-02-000	EA	Weep Hole Cover - Plastic - Black
	002291-01-000	SF	Screen - Window - 16" - Gray
	Not Illustrated		

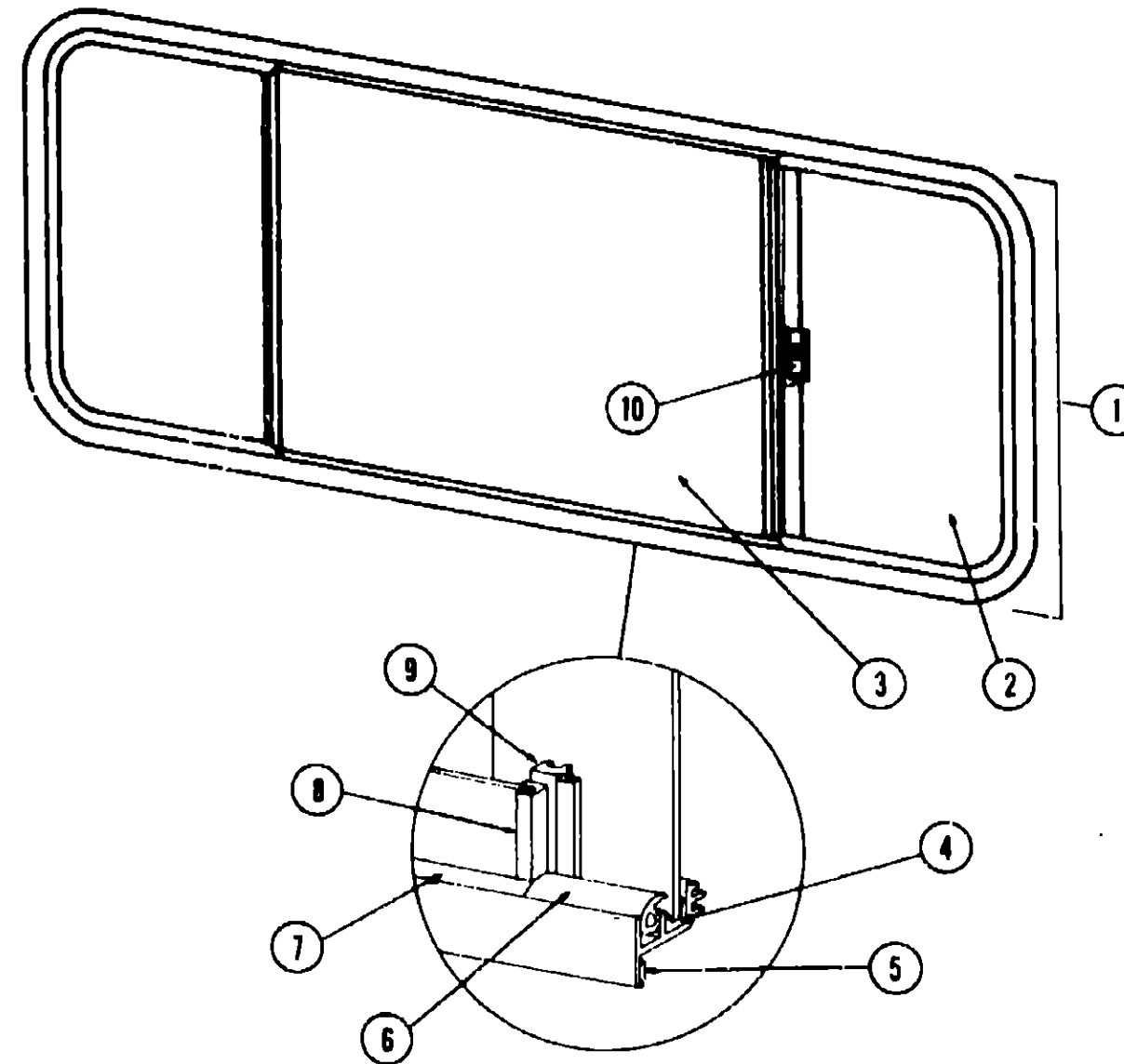

Key	Part Number	U/M	Description
1	066785-04-000	EA	Window Asm. - Single Slider - 27" x 65" (w/o inside frame)
2	067609-09-000	EA	Inside Frame (Not included in assembly)
3	066726-03-000	EA	Glass - Stationary - 1/8" x 21" x 27"
4	066727-03-000	EA	Glass - Sliding - 1/8" x 25.5" x 27"
5	002324-02-000	FT	Channel - Weatherstrip - Glass
6	053767-03-000	FT	Tape - 1/4" Bead x 20' - Gray
7	057374-02-000	FT	Extr. Vinyl - Window Seal - Black
8	002309-02-000	FT	Spline - Glass - 1/8" Material - Black
9	069886-03-004	EA	Extr. - Holder - Glass Seal - 26.25" - Black
10	069886-03-000	EA	Mullion - Slider Window - 26" - Black
	047369-01-000	EA	Latch - Window - Plastic - w/Fastener
	002293-01-000	SF	Screen - Window - 26" - Gray
	002298-01-000	FT	Spline - .130" Dia. - Gray (Screen)
	042076-01-000	FT	Seal - Fin - Pile - .34"
	Not Illustrated		

1983 WINNEBAGO TABLE OF CONTENTS

WC621RB	A-1 - B-16
WC723RH	B-17 - D-8
WC723RB	D-9 - E-24
WC823RH	F-1 - G-18
WC823RB	G-17 - I-8

1983 WC621RB INDEX

Floor Plan	A-1 - A-2
Accessories Group	A-3 - A-5
Bath Group	A-6
Chassis Group	A-7
Curtain, Cushion & Pad Group	A-8 - A-13
Dinette Group	A-14
Driver's Compartment Group	A-15 - A-16
Electrical Group	A-17 - A-19
Exterior Body Group	A-20 - A-24
Galley Group	B-1
Heating & Air Conditioning Group	B-2
Interior Finish Group	B-3 - B-4
LP Group	B-5
Lounge Group	B-6
Water & Sewage Group	B-7 - B-8
Window, Vent & Exterior Door Group	B-9 - B-16

WINDOW, VENT & EXTERIOR DOOR GROUP (CONTINUED)

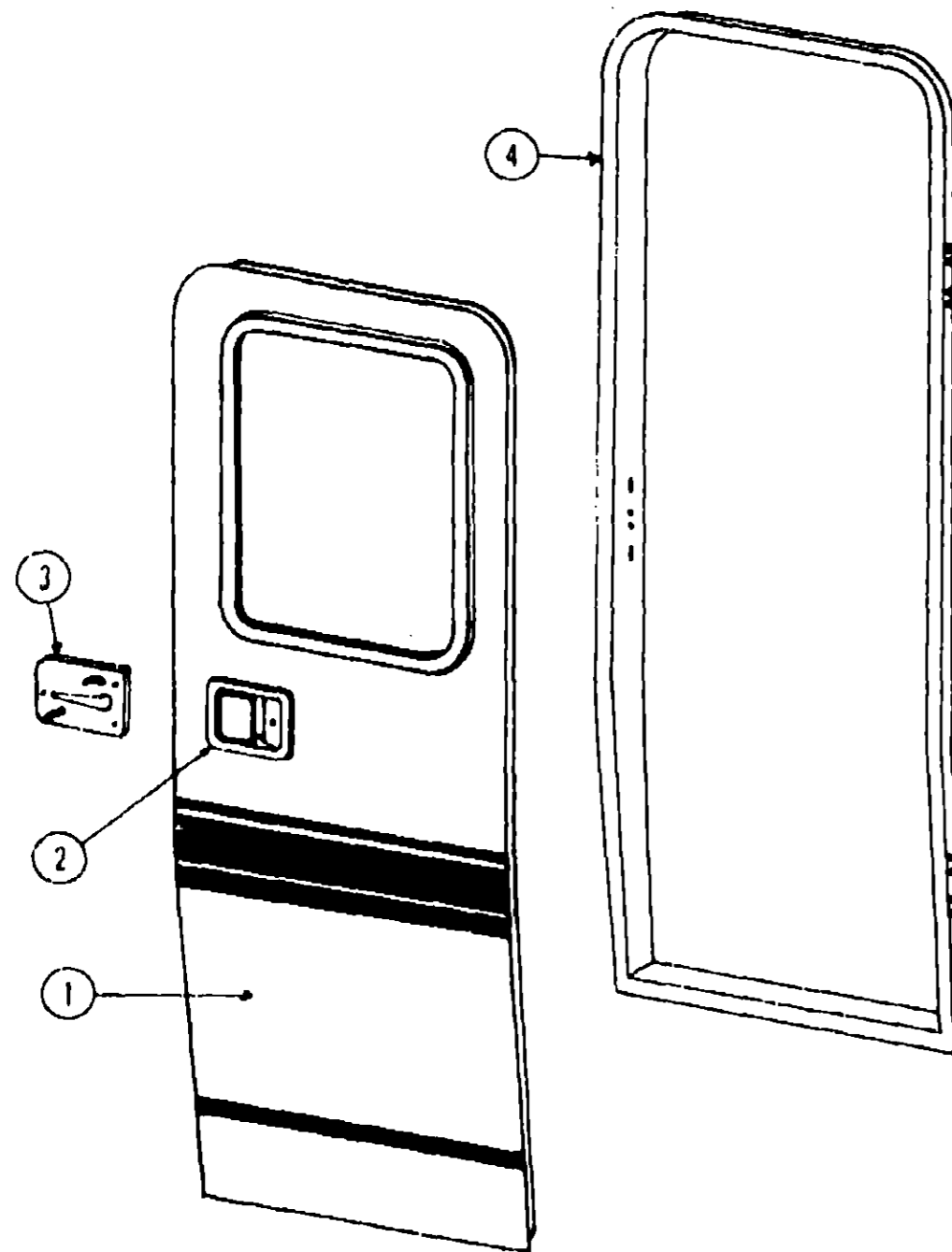

Key	Part Number	U/M	Description
1	067688-04-P07	EA	Door Asm. - Fiberglass Entry - w/Latch and Hinges - Beige
2	045017-01-000	EA	Paddle Asm. - Door Lock - Exterior
	045017-01-700	EA	Lock Cylinder w/Keys - Lynor
	039539-01-000	EA	Striker Bolt - Entry Door
	039540-01-000	EA	Latch Claw - Entry Door
3	039979-01-000	EA	Plate - Lock - Inside - Including Inside Handle
	052186-01-000	EA	Lock Asm. - Complete - Lynor
	066253-01-000	EA	Window Asm. - Vertical Slider - 26.9" x 17.6" (w/o inside frame)
	002241-04-000	EA	Glass - Vertical Slider - 1/8" x 17.5" x 13.5"
	047820-03-000	EA	Glass - Vertical Slider - 1/8" x 17.5" x 14.5"
	047369-01-700	EA	Latch - Window - Black Plastic
	067609-02-000	EA	Inside Frame - Vertical Slider
4	062545-02-000	EA	Jamb Asm. - Entry Door - Beige
	064075-01-000	FT	Seal - Entry Door Jamb - Rubber
	065043-01-000	EA	Hinge Asm. - Entry Door - Lower
	065046-01-000	EA	Hinge Asm. - Entry Door - Upper
	062409-01-000	EA	Pull - Interior - Door
	Not Illustrated		

WINDOW, VENT & EXTERIOR DOOR GROUP (CONTINUED)

ACCESS DOORS

Key	Part Number	U/M	Description
	054369-06-000	EA	Door Asm. - LP - 23.6" x 9.6" - Beige
	064567-02-000	EA	Door Asm. - Battery - 11.2" x 18.5" - Beige
	054369-07-000	EA	Door Asm. - LP Storage - 36.7" x 9.6" - Beige
	064842-02-000	EA	Door Asm. - Luggage - 24" x 10.36" - Beige - w/Key Lock
	052009-02-000	EA	Door - Water Heater - Beige
	069782-03-000	EA	Door Asm. - Refrigerator Access - Beige - w/Twist Lock
	064841-02-000	EA	Door Asm. - Generator - Beige - w/Twist Lock
	052743-02-000	EA	Baffle - Generator Door
	016945-02-000	EA	Holder Asm. - Luggage or Battery Door
	042442-01-000	EA	Lock Asm. - Twist Type (Power Cord)
	047305-01-000	EA	Lock Asm. - Key Type w/Clip (Luggage)
	042441-01-000	EA	Lock Asm. - Key Type (Gas Fill)
	061186-02-000	EA	Door - Fuel Fill
	059865-01-000	EA	Lock Asm. - Key Type - Fuel Fill & Valance Door
	009003-01-000	EA	Lock Asm. - Twist Type - Metal (Refrigerator)
	052424-02-000	EA	Door Jamb - Power Cord & Fuel Fill - Beige
	054543-02-000	EA	Door Hatch - Power Cord - Beige
	063742-02-000	EA	Door - Power Cord - Beige
	041312-01-000	FT	Door Seal - e/Section

VENTS

Key	Part Number	U/M	Description
	071290-01-000	EA	Frame - Base - Refrigerator Vent (w/o cover)
	071290-02-000	EA	Cover - Vent - Refrigerator - Plastic
	049352-02-000	EA	Vent - Stove Hood - Outside - Beige

WINDOWS

Key	Part Number	U/M	Description
	054558-01-000	EA	Glass - Wingwall Transition Panel
	058044-01-000	FT	Weatherseal - Wingwall Transition Panel
	040795-02-000	EA	Glass - Windshield - Tinted
	054557-01-000	EA	Glass - Upper Front Cap
	071422-01-000	FT	Weatherseal - Upper Front Cap

1983 WINNEBAGO TABLE OF CONTENTS

WC621RB	A-1 - B-16
WC723RH	B-17 - D-8
WC723RB	D-9 - E-24
WC823RH	F-1 - G-16
WC823RB	G-17 - I-8

1983 WC621RB INDEX

Floor Plan	A-1 - A-2
Accessories Group	A-3 - A-5
Bath Group	A-6
Chassis Group	A-7
Curtain, Cushion & Pad Group	A-8 - A-13
Dinette Group	A-14
Driver's Compartment Group	A-15 - A-16
Electrical Group	A-17 - A-19
Exterior Body Group	A-20 - A-24
Galley Group	B-1
Heating & Air Conditioning Group	B-2
Interior Finish Group	B-3 - B-4
LP Group	B-5
Lounge Group	B-6
Water & Sewage Group	B-7 - B-8
Window, Vent & Exterior Door Group	B-9 - B-16