

# 1983 IC424RB

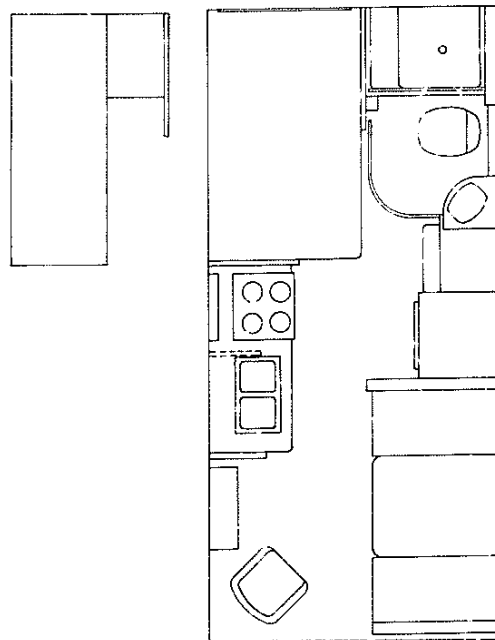

## 1983 ITASCA TABLE OF CONTENTS

IC420RG	A-1 - B-22
IC424RB	B-23 - E-4
ICF26RB	E-5 - G-12
ICN33RU	G-13 - I-20

## 1983 IC424RB INDEX

Floor Plan	B-23 - B-24
Accessories Group	C-1 - C-3
Bath Group	C-4 - C-5
Chassis Group	C-6 - C-7
Curtain, Cushion & Pad Group	C-8 - C-14
Dinette Group	C-15
Driver's Compartment Group	C-16 - C-17
Electrical Group	C-18 - C-20
Exterior Body Group	C-21 - D-3
Galley Group	D-4 - D-5
Heating & Air Conditioning Group	D-6
Interior Finish Group	D-7 - D-9
LP Group	D-10
Lounge Group	D-11
Water & Sewage Group	D-12 - D-13
Window, Vent & Exterior Door Group	D-14 - E-4

ACCESSORIES GROUP

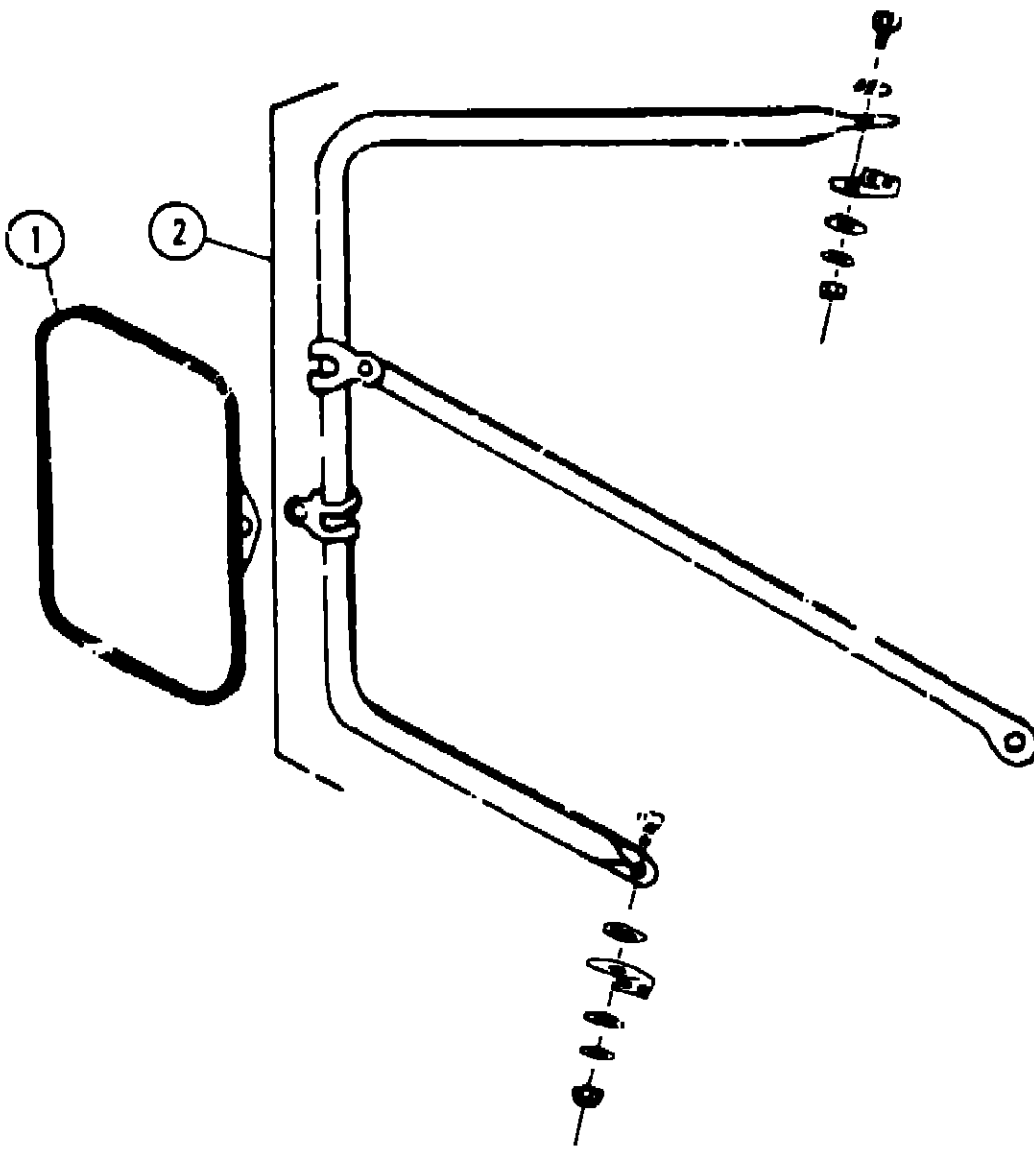

EXTERIOR MIRRORS

Key	Part Number	U/M	Description
1	049347-01-000	EA	Mirror Head - 7 1/2" x 10 1/2" - Stainless Steel
1	049347-02-000	EA	Mirror Head - 7 1/2" x 10 1/2" - Off White
2	062047-01-000	EA	Arm - West Coast Mirror - Stainless Steel
2	062047-02-000	EA	Arm - West Coast Mirror - Off White
*	006043-01-000	EA	Mirror - Convex - Adhesive Back
*	Not illustrated		

ACCESSORIES GROUP (CONTINUED)

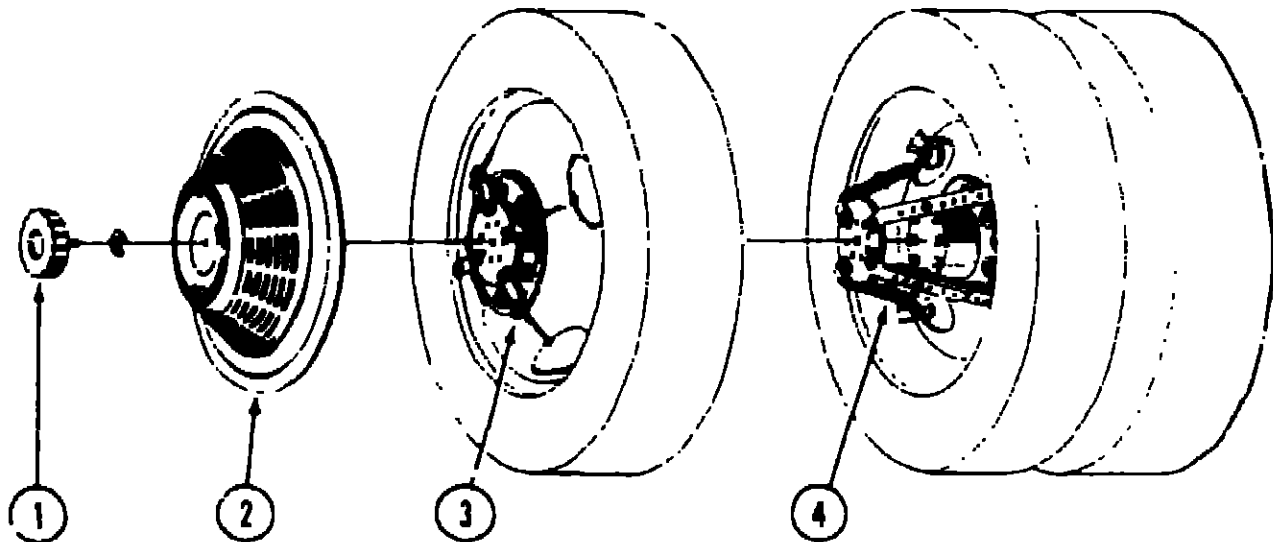

WHEEL COVER AND MOUNTING HARDWARE

Key	Part Number	U/M	Description
1	064062-02-000	EA	Retaining Nut - Delmet - Wheel Cover
2	073426-01-700	EA	Wheel Cover - Bolt On - 15" or 16 5" - Delmet (1)
3	073426-04-700	EA	Retention Bracket Asm. - Wheel Cover Support - Heavy Duty - Front (1)
4	073426-04-701	EA	Retention Bracket Asm. - Wheel Cover Support - Heavy Duty - Rear (1)
*	073426-04-000	EA	Retention Bracket Asm. - Wheel Cover Support - Heavy Duty (Set/4)
*	Not illustrated		

GENERATORS AND COMPONENTS

Key	Part Number	U/M	Description
**	054429-01-000	EA	Generator - Onan - 4.0 kw
	701629-02-000	EA	Onan Installation Package
	024732-01-001	EA	Tailpipe - 1.5" O.D. x 23"
	068322-01-000	EA	Exhaust Pipe - 90° Elbow - 1 5/8" I.D.
	067753-01-000	EA	Muffler - Generator - w/Spark Arrestor - Nelson
	740313-56-000	EA	Tray - Generator - 4.0 kw - Onan
	068046-01-000	EA	Conversion Kit - LP - Onan Generator
**	The illustrated parts breakdown for this item is provided on the Common Items Fiche.		

RADIO AND RELATED COMPONENTS

Key	Part Number	U/M	Description
	007004-01-000	EA	Antenna - Radio - Cab Mount
	031105-01-700	EA	Holder - Antenna - Radio - Upper
	064791-01-000	EA	Speaker - Recessed - 5 1/4"
	064792-01-000	EA	Grille - Speaker - 5 1/4" - w/Mesh - Brown
	074979-01-000	EA	Speaker Cover Protector - Plastic
	064787-01-100	EA	Radio - AM/FM MPX - w/Cassette - Audiovox - WIMCHI
	074482-01-000	EA	Radio - AM/FM MPX - w/Cassette - Audiovox - HCC565
	064794-01-000	EA	Trim Plate - Radio
	068002-01-000	EA	Mounting Plate - Radio
	073432-01-000	EA	Amplifier - Radio - 4 x 15 Watts
	073433-01-000	EA	Adapter - Radio to Amplifier

1983 ITASCA  
TABLE OF CONTENTS

IC42LRG	A-1 - B-22
IC424RB	B-23 - E-4
ICF26RB	E-5 - G-12
ICN33RU	G-13 - I-20

1983 IC424RB INDEX

Floor Plan	B-23 - B-24
Accessories Group	C-1 - C-3
Bath Group	C-4 - C-5
Chassis Group	C-6 - C-7
Curtain, Cushion & Pad Group	C-8 - C-14
Dinette Group	C-15
Driver's Compartment Group	C-16 - C-17
Electrical Group	C-18 - C-20
Exterior Body Group	C-21 - D-3
Galley Group	D-4 - D-5
Heating & Air Conditioning Group	D-6
Interior Finish Group	D-7 - D-9
LP Group	D-10
Lounge Group	D-11
Water & Sewage Group	D-12 - D-13
Window, Vent & Exterior Door Group	D-14 - E-4

ACCESSORIES GROUP (CONTINUED)

MISCELLANEOUS ACCESSORIES

Key	Part Number	U/M	Description
	054185-14-000	EA	Owners Manual - 1983 - Itasca & Winnebago
	006053-01-000	EA	Antenna - TV Braun & Delux
	006050-01-000	EA	Jack - TV - Ivory (Antenna)
	006054-01-000	FT	Lead Wire - TV - 22"
	017516-01-000	EA	Mud Flap - Black - 14" x 18" w/Holes
	041911-03-000	EA	Fire Extinguisher - w/Bracket - 5 BC
	052771-02-000	EA	Over - Microwave - Magic Chef MW207
	053287-07-000	EA	Bracket Asm - Microwave - Right
	053287-08-000	EA	Bracket Asm - Microwave - Left
	067203-01-000	EA	Ladder Asm
	067130-01-000	EA	Ladder Step
	076980-01-000	EA	End Cap - Ladder Step
	067125-01-000	EA	Stand Off - Rack & Ladder Asm
	067203-02-000	EA	Luggage Rack Asm
	064093-01-000	EA	Luggage Carrier Assembly - 14" x 30" x 60"
	039881-01-000	EA	Catch and Strike - Luggage Carrier
	072366-11-000	EA	Speed Control Package - Electric - Diesel - Dana
	069624-01-000	EA	Speed Control Package - Electric - Dana
	072852-01-000	EA	Smoke Detector w/9 Volt Battery
	072373-01-000	EA	Weather Center - 7" x 7" x 2"
	005069-01-000	EA	Key Case - Leather
	040069-01-000	EA	Door Mat - 10.5" x 26" - Black Rubber
	069580-01-000	EA	Lug Wrench - 1" x 1.25" x 16.3"
	069580-02-000	EA	Leverage Bar - 22" - Lug Wrench
	063708-01-000	EA	Cover - Roof Air Conditioner - Vinyl
	006113-01-000	EA	Jack - Hydraulic - 6 Ton - w/Handle
	072374-01-000	EA	Clock - 7" x 7" x 2"
	073322-01-000	EA	Tire Cover - Vinyl - 29"

BATH GROUP

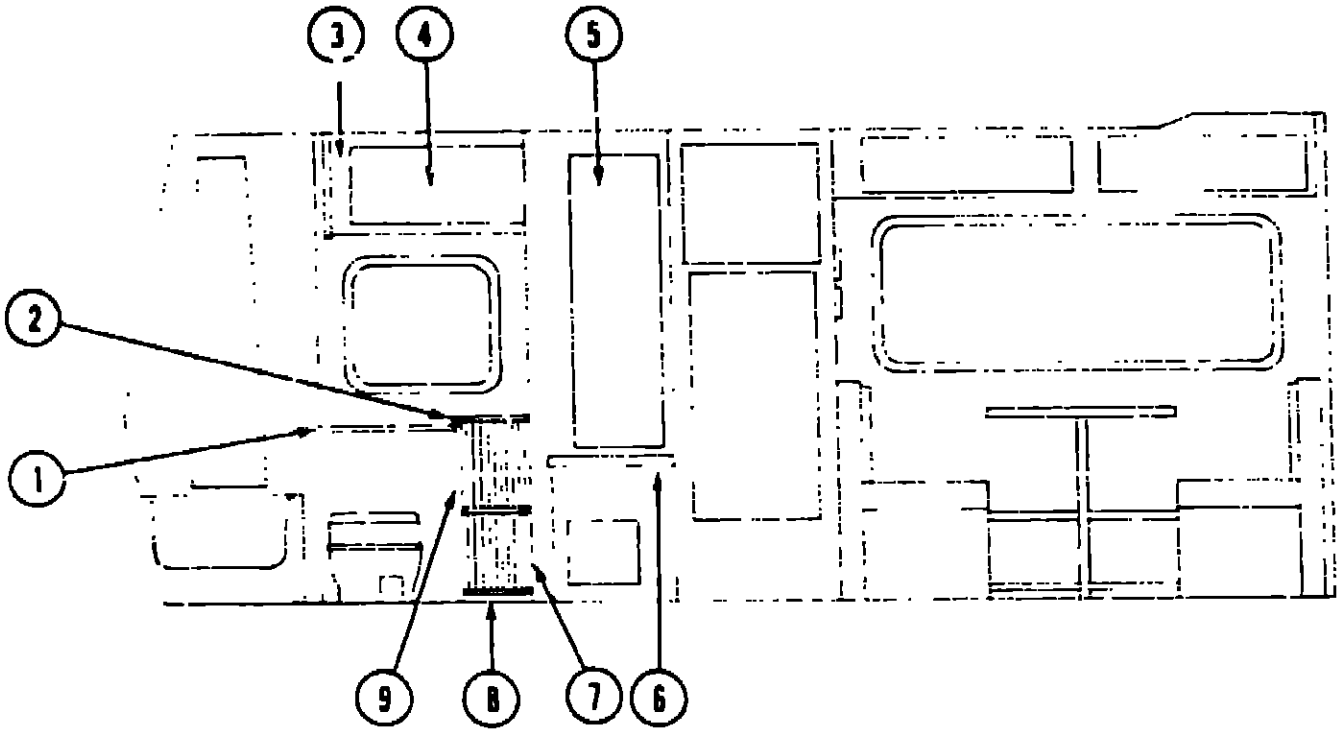

BATH CABINETRY

Key	Part Number	U/M	Description
1	M01264-01-P01	EA	Countertop Asm - Pipe Cover - Travertine
2	M00917-01-P01	EA	Countertop Asm - Lavatory Cabinet - Travertine
3	M75058-01-P01	EA	Cabinet Asm - Medicine - w/o Doors or Hardware
4	M71646-02-P01	EA	Cabinet Asm - Medicine Cabinet - w/Mirror - 16.1" x 30.1" - w/o Hardware
5	069859-03-P01	EA	Door Asm - Wardrobe - w/Mirror - 46.1" x 16.1" - w/o Hardware
6	M01268-01-P01	EA	Countertop Asm - Wardrobe - Almond
7	063224-24-P01	EA	Door Asm - Rolled - 12.4" x 20" - Lower
8	M72641-01-P01	EA	Cabinet Asm - Lavatory - w/o Countertop & Doors
9	063224-25-P01	EA	Door Asm - Rolled - 16.1" x 20" - Upper
*	073419-01-000	EA	Door Asm - Folding - 46" x 75" - Maple
			Not illustrated

1983 ITASCA  
TABLE OF CONTENTS

IC420RG	A-1 - B-22
IC424RB	B-23 - E-4
ICF20RB	E-5 - G-12
ICN33RU	G-13 - I-20

1983 IC424RB INDEX

Floor Plan	B-23 - B-24
Accessories Group	C-1 - C-3
Bath Group	C-4 - C-5
Chassis Group	C-6 - C-7
Curtain, Cushion & Pad Group	C-8 - C-14
Dinette Group	C-15
Driver's Compartment Group	C-16 - C-17
Electrical Group	C-18 - C-20
Exterior Body Group	C-21 - D-3
Galley Group	D-4 - D-5
Heating & Air Conditioning Group	D-6
Interior Finish Group	D-7 - D-9
LP Group	D-10
Lounge Group	D-11
Water & Sewage Group	D-12 - D-13
Window, Vent & Exterior Door Group	D-14 - E-4

**BATH GROUP (CONTINUED)**

**BATH HARDWARE**

Key	Part Number	U/M	Description
EA	011056-01-000	EA	Faucet - Lavatory - US
EA	011056-02-000	EA	Faucet - Lavatory - CSA
EA	021558-03-000	EA	Faucet - Tub & Shower - US
EA	021558-01-000	EA	Faucet - Tub & Shower - CSA
EA	058713-01-000	EA	Sink Oval - Ivory Plastic
EA	M01211-02-000	EA	Bathtub Asm. w. Strainer
EA	011083-01-000	EA	Tail Piece 1.25" x 5" - Plastic - w/Stopper
EA	011048-02-000	EA	Shower Head - w/60" Hose
EA	066729-01-000	EA	Strainer - Shower Pan & Tub
EA	066436-01-000	EA	Slip Nut - 1 5" Tail Piece - Bathtub
EA	011069-02-000	EA	Tail Piece - 1.5" x 1 25" x 4" - Brass
EA	069735-01-000	EA	Washer - Tail Piece - 1.5" - Plastic
EA	065435-01-000	EA	Nut - Strainer - Plastic
EA	069134-01-000	EA	Holder - Tissue
EA	069133-02-000	EA	Bar - Towel Rack - 18" - Plastic
EA	021449-01-000	EA	Support - Chrome - Towel Rack
EA	009151-01-000	EA	Warp Guard - 48"
EA	033590-01-000	EA	Towel Ring - Chrome w/Plastic Ring
EA	058315-02-000	EA	Latch - Bathroom Door - w/o Lock
EA	018631-48-000	EA	Track - Shower Curtain - 192"
EA	072630-01-000	EA	Panel - Shower - Plastic
EA	073689-02-000	EA	Track - Folding Door - 30 5" - Off White
EA	079112-01-000	EA	Flange - 1" Closet Rod
EA	057671-01-000	EA	Screw Cover (No. 8)
EA	039341-02-000	EA	Toilet - Thetford - Aqua Magic - Ivory - 8420 SH
EA	058331-04-000	EA	Mirror - Tempered Glass - 12" x 42"
EA	058331-05-000	EA	Mirror - Tempered Glass - 12" x 26"
The illustrated parts breakdown for this item is provided on the Common Items Fiche.			

**CHASSIS GROUP**

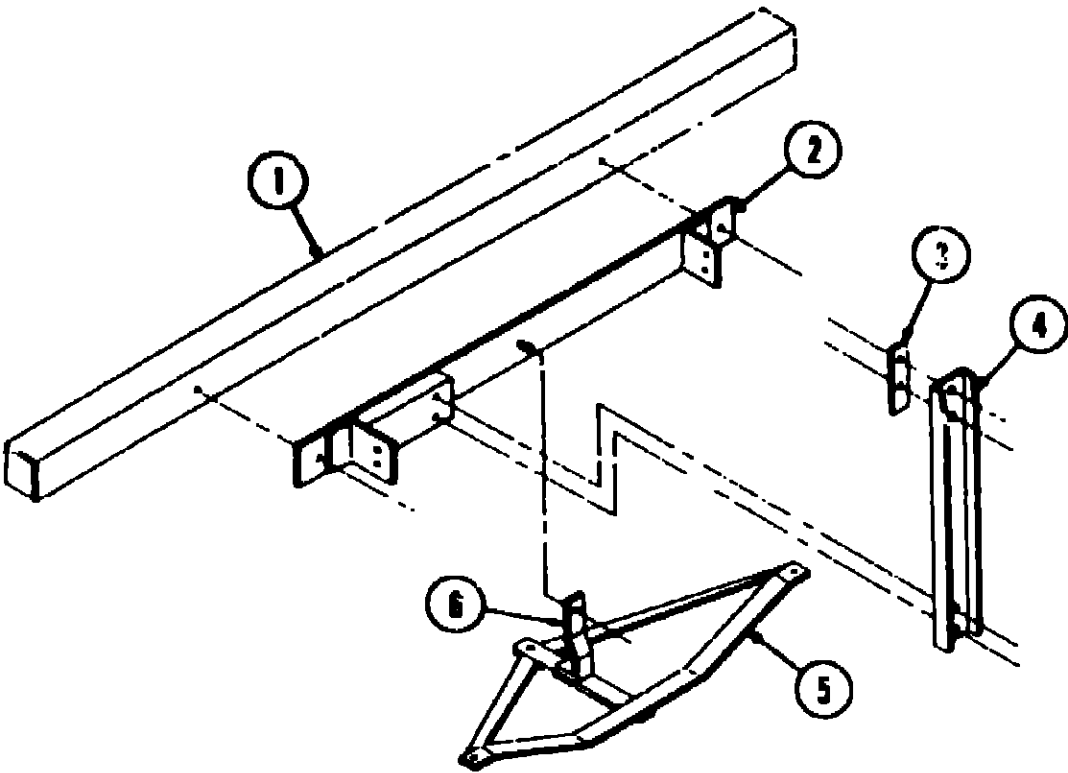

Key	Part Number	U/M	Description
1	064602-05-000	EA	Bumper Asm. - Square - 92" - Primed
2	039779-01-000	EA	Cap - Rubber - 4" x 4" - Square Bumper
3	064601-01-000	EA	Bracket - Bumper Mount
4	040974-01-000	EA	Bracket - Square Tire Retainer - 2" x 6.75"
5	064598-01-000	EA	Bracket Asm - Spare Tire Carrier
6	064833-02-000	EA	Trailer Hitch Asm.
7	064824-02-000	EA	Support - Trailer Hitch
8	041332-02-000	EA	Reflector - 6 1/2" x 3/4" - Bumper Cover
9	041332-03-000	EA	Bumper Cover - Aluminum Fits 4" Square Bumper
10	Not illustrated		

**1983 ITASCA  
TABLE OF CONTENTS**

IC420RC	A-1 - B-22
IC424RE	B-23 - E-4
ICF26RE	E-5 - G-12
ICN33RLI	G-13 - I-20

**1983 IC424RB INDEX**

Floor Plan	B-23 - B-24
Accessories Group	C-1 - C-3
Bath Group	C-4 - C-5
Chassis Group	C-6 - C-7
Curtain, Cushion & Pad Group	C-8 - C-14
Dinette Group	C-15
Driver's Compartment Group	C-16 - C-17
Electrical Group	C-18 - C-20
Exterior Body Group	C-21 - D-3
Galley Group	D-4 - D-5
Heating & Air Conditioning Group	D-6
Interior Finish Group	D-7 - D-9
LP Group	D-10
Lounge Group	D-11
Water & Sewage Group	D-12 - D-13
Window, Vent & Exterior Door Group	D-14 - E-4

Key	Part Number	U/M	Description
	068524-01-000	EA	Gas Fill - w/Vent
	064456-02-000	EA	Tube - Fuel Vent - 5" O.D. x 46"
	024611-04-000	EA	Can - Gas - Pressure - 1.50" - Chrome
	024138-01-000	FT	Hose - Fuel - 5/16" I.D. SAE 30RI
	024141-01-000	FT	Hose - Rubber - 1/2" I.D.
	007134-01-000	EA	Clamp - Hose - Spring Type 9-16"
	007131-01-000	EA	Hanger - Tail Pipe
	007111-02-000	FT	Hose - Fuel - 2" I.D. SAE 30RI (3')
	024490-01-000	EA	Power Cord Box - Plastic
	057724-01-000	EA	Wheel Well - Plastic
	052431-01-000	EA	Tray - Luggage
	007125-05-000	EA	Clamp Asm. - Muffler - 2"
	017516-01-000	EA	Mud Flap - Black - 14" x 16" w/Holes
	051697-01-000	EA	Bracket - Battery Tie Down - 6.9
	051697-02-000	EA	Bracket - Battery Tie Down - 12"
	057822-01-000	EA	Battery Tray Asm.
	063739-01-000	EA	Battery - 12 Volt - Gould
	064602-05-000	EA	Bumper Asm. - Rear Square - 92" - Primed
	064601-02-000	EA	Bracket - Bumper Mount
	039779-01-000	EA	Cap - Rubber - 4" x 4" - Square Bumper
	024652-01-700	EA	Step Asm. - Entry
	047441-01-000	EA	Battery Terminal - Horizontal Lug
	077479-01-000	EA	Boot - Battery Terminal - Double Cable
	037291-01-000	EA	Tire - 8.00 x 15.5 - 8 Ply Poly
	062400-02-000	EA	Rim - Wheel - 16.5 x 6.00
	072363-01-000	EA	Water Detector Probe - Fuel Line
	072364-01-000	EA	Water Detector Module - Fuel Line
	069580-01-000	EA	Lug Wrench - 1" x 1.25" x 16.3"
	069580-02-000	EA	Leverage Bar - 22" - Lug Wrench
	006113-01-000	EA	Jack - Hydraulic - 6 Ton - w/Handle
	052165-C3-000	EA	Shock Cord - Rubber - 24" (Spare Tire)

NOTICE

In order to assist our Parts Sales Dept. in providing interior software items, please include the serial number and the color code number from the vehicle certification label when ordering. This label is located on the left sidewall, at the end of the dash (A-Body), or on the driver's door latch plate (C-Body).

An example of a color code number is P31, which designates an overall color scheme of a particular unit. The color listed after the item description on the microfiche, indicates the overall unit color. Order the item you desire according to unit color code.

A variation exists in color code numbers on all 1983 units manufactured before Nov. 8 with rear innerspring beds. When ordering bedspread or matching curtains for units manufactured before Nov. 8, 1983, use the color code PU1. On a vehicle manufactured after that date, use the individual color code number listed on the vehicle certification label.

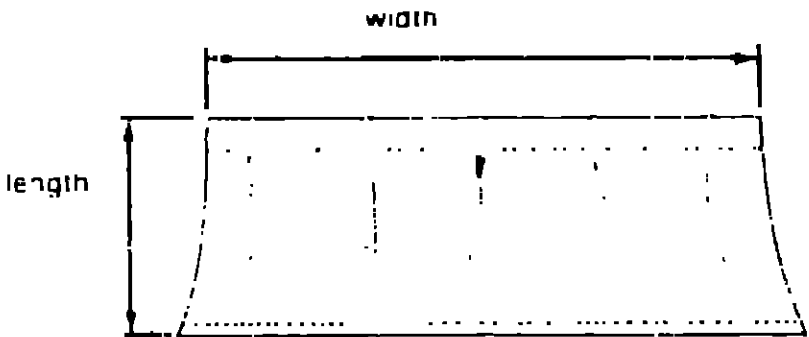

**NOTE**  
Use this illustration when determining length and width measurements for curtains. You will note the width measurement is taken on the top of the curtain with the curtain fully extended. The length measurement is taken from top to bottom.

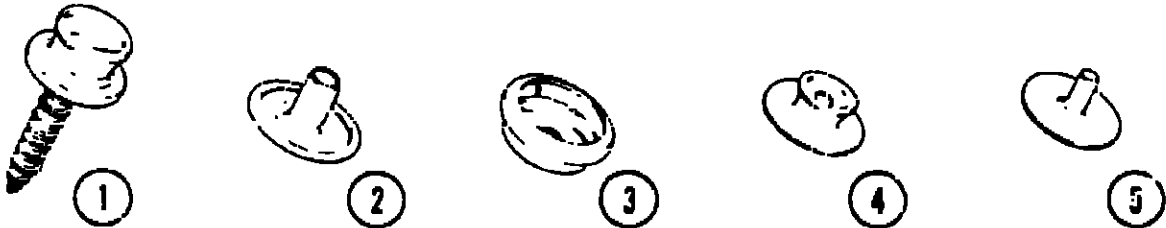

Key	Part Number	U/M	Description
1	029130-01-000	EA	Socket - Snap Fastener
2	029155-01-000	EA	Cap - Snap - .156" Dia. x .17" Barrel
3	029156-01-000	EA	Socket - Snap Fastener
4	029092-01-000	EA	Stud - Nickel Finish
5	029093-01-000	EA	Eyelet - Nickel Finish

1983 ITASCA  
TABLE OF CONTENTS

IC420RG	A-1 - B-22
IC424RB	B-23 - E-4
ICF26R3	E-5 - G-12
ICN33RU	G-13 - I-20

1983 IC424RB INDEX

Floor Plan	B-23 - B-24
Accessories Group	C-1 - C-3
Bath Group	C-4 - C-5
Chassis Group	C-6 - C-7
Curtain, Cushion & Pad Group	C-8 - C-14
Dinette Group	C-15
Driver's Compartment Group	C-16 - C-17
Electrical Group	C-18 - C-20
Exterior Body Group	C-21 - D-3
Galley Group	D-4 - D-5
Heating & Air Conditioning Group	D-6
Interior Finish Group	D-7 - D-9
LP Group	D-10
Lounge Group	D-11
Water & Sewage Group	D-12 - D-13
Window, Vent & Exterior Door Group	D-14 - E-4

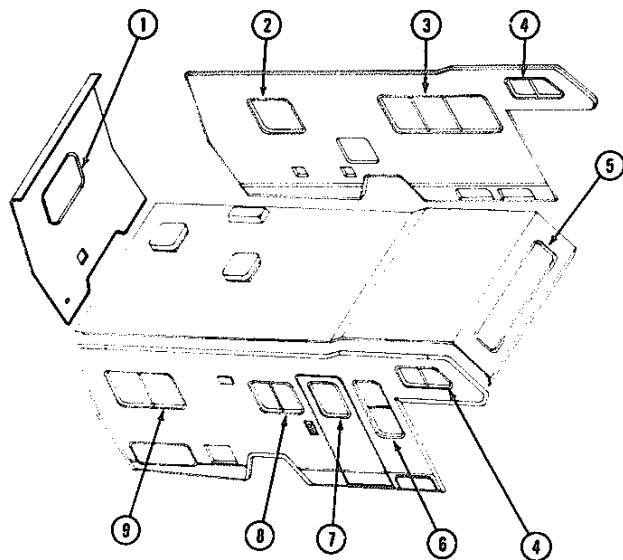

CURTAINS, VALANCES, SHADES AND TIEBACKS

Key	Part Number	U/M	Description
1	070852-12-P01	EA	Curtain w/Darts - 29" x 15" - Bedspread
1	070852-12-P34	EA	Curtain w/Darts - 29" x 15" - Bedspread - Blue
1	070852-12-P35	EA	Curtain w/Darts - 29" x 15" - Bedspread - Brown
1	070852-12-P36	EA	Curtain w/Darts - 29" x 15" - Bedspread - Burgundy
1	073323-10-P01	EA	Curtain w/Rod Top - Sheer - 29" x 30"
1	070851-13-P01	EA	Valance Asm. - 6" x 44" - Pleated - Bedspread
1	070851-19-P34	EA	Valance Asm. - 6" x 44" - Pleated - Bedspread - Blue
1	070851-19-P35	EA	Valance Asm. - 6" x 44" - Pleated - Bedspread - Brown
1	070851-19-P36	EA	Valance Asm. - 6" x 44" - Pleated - Bedspread - Burgundy
1	065522-08-000	EA	Shade Asm. - Vinyl - 33.25" x 38"
**	073251-09-P34	EA	Curtain w/Tape Top - 26" x 8" (P35, P36)
**	073227-08-P34	EA	Valance Asm. - 5" x 25" - Stapled - Blue
**	073227-08-P35	EA	Valance Asm. - 5" x 25" - Stapled - Brown
**	073227-08-P36	EA	Valance Asm. - 5" x 25" - Stapled - Burgundy
**	065522-01-003	EA	Shade Asm. - Vinyl - 15.5" x 38"
2	073251-04-P34	EA	Curtain w/Tape Top - 25" x 12" (P35, P36)
2	073227-02-P34	EA	Valance Asm. - 5" x 34" - Stapled - Blue
2	073227-02-P35	EA	Valance Asm. - 5" x 34" - Stapled - Brown
2	073227-02-P36	EA	Valance Asm. - 5" x 34" - Stapled - Burgundy
2	065522-04-000	EA	Shade Asm. - Vinyl - 27.25" x 38"

CURTAINS, VALANCES, SHADES AND TIEBACKS (CONT.)

Key	Part Number	U/M	Description
3	073251-03-P34	EA	Curtain w/Tape Top - 28" x 24" (P35, P36)
3	073323-02-P01	EA	Curtain w/Rod Top - Sheer - 27.5" x 68"
3	073227-01-P34	EA	Valance Asm. - 5" x 80" - Stapled - Blue
3	073227-01-P35	EA	Valance Asm. - 5" x 80" - Stapled - Brown
3	073227-01-P36	EA	Valance Asm. - 5" x 80" - Stapled - Burgundy
3	065522-12-000	EA	Shade Asm. - Vinyl - 69.25" x 38"
4	073304-11-P34	EA	Curtain w/Snaps - 15.5" x 42" (P35, P36)
5	073226-05-P34	EA	Curtain w/Snaps - 17.5" x 42" (P35, P36)
6	073251-19-P34	EA	Curtain w/Tape Top - 40" x 9" (P35, P36)
6	073323-09-P01	EA	Curtain w/Rod Top - Sheer - 39" x 15"
6	073227-10-P34	EA	Valance Asm. - 5" x 30" - Stapled - Blue
6	073227-10-P35	EA	Valance Asm. - 5" x 30" - Stapled - Brown
6	073227-10-P36	EA	Valance Asm. - 5" x 30" - Stapled - Burgundy
6	065522-15-000	EA	Shade Asm. - Vinyl - 19" x 52"
7	073304-05-P34	EA	Curtain w/Snaps - 29" x 37" (P35, P36)
8	073251-05-P04	EA	Curtain w/Tape Top - 21.5" x 9"
8	073227-11-P34	EA	Valance Asm. - 5" x 38.5" - Stapled - Blue
8	073227-11-P35	EA	Valance Asm. - 5" x 38.5" - Stapled - Brown
8	073227-11-P36	EA	Valance Asm. - 5" x 38.5" - Stapled - Burgundy
8	065522-16-000	EA	Shade Asm. - Vinyl - 28.50" x 30"
9	070652-06-P01	EA	Curtain w/Darts - 27" x 19" - Bedspread
9	070652-06-P34	EA	Curtain w/Darts - 27" x 19" - Bedspread - Blue
9	070652-06-P35	EA	Curtain w/Darts - 27" x 19" - Bedspread - Brown
9	070652-06-P36	EA	Curtain w/Darts - 28" x 19" - Bedspread - Burgundy
9	073323-08-P01	EA	Curtain w/Rod Top - Sheer - 27.5" x 45"
9	070651-34-P01	EA	Valance Asm. - 6" x 58" - Pleated - Bedspread
9	070651-34-P34	EA	Valance Asm. - 6" x 58" - Pleated - Bedspread - Blue
9	070651-34-P35	EA	Valance Asm. - 6" x 58" - Pleated - Bedspread - Brown
9	070651-34-P36	EA	Valance Asm. - 6" x 58" - Pleated - Bedspread - Burgundy
9	065522-14-000	EA	Shade Asm. - Vinyl - 47.25" x 38"
**	073251-07-P34	EA	Curtain w/Tape Top - 21" x 24" (P35, P36)
**	073323-03-P01	EA	Curtain w/Rod Top - Sheer - 20" x 42"
**	073227-03-P34	EA	Valance Asm. - 6.5" x 50" - Stapled - Blue
**	073227-03-P35	EA	Valance Asm. - 6.5" x 50" - Stapled - Brown
**	073227-03-P36	EA	Valance Asm. - 6.5" x 50" - Stapled - Burgundy
**	065522-09-000	EA	Shade Asm. - Vinyl - 40.25" x 38"
*	073295-02-P34	EA	Curtain w/Snaps - Front Wraparound - 23" x 64"
			(2 required) (P35, P36)
*	073304-24-P04	EA	Curtain w/Snaps - Bunk Privacy - 70" x 96"
*	073304-26-P34	EA	Curtain w/Snap Top - Room Divider - 54" x 40" (P35, P36)
*	073260-09-P04	EA	Tie Back Asm. - 2" x 18" - Privacy
*	073260-04-P34	EA	Tie Back Asm. - 3" x 14" - Blue
*	073260-04-P35	EA	Tie Back Asm. - 3" x 14" - Brown
*	073260-04-P36	EA	Tie Back Asm. - 3" x 14" - Burgundy
*	057534-01-000	EA	Tie Back Asm. - 6" - Clear Plastic
*	057534-03-000	EA	Tie Back Asm. - 7.5" - Clear Plastic
**			Not illustrated
**			Parts for bunkhouse option (Not illustrated)

1983 ITASCA  
TABLE OF CONTENTS

IC420RG	A-1 - B-22
IC424RB	B-23 - E-4
ICF26RB	E-5 - G-12
ICN33RU	G-13 - I-20

## 1983 IC424RB INDEX

Floor Plan	B-23 - B-24
Accessories Group	C-1 - C-3
Bath Group	C-4 - C-5
Chassis Group	C-6 - C-7
Curtain, Cushion & Pad Group	C-8 - C-14
Dinette Group	C-15
Driver's Compartment Group	C-16 - C-17
Electrical Group	C-18 - C-20
Exterior Body Group	C-21 - D-3
Galley Group	D-4 - D-5
Heating & Air Conditioning Group	D-6
Interior Finish Group	D-7 - D-9
LP Group	D-10
Lounge Group	D-11
Water & Sewage Group	D-12 - D-13
Window, Vent & Exterior Door Group	D-14 - E-4

CURTAIN, CUSHION & PAD GROUP (CONTINUED)

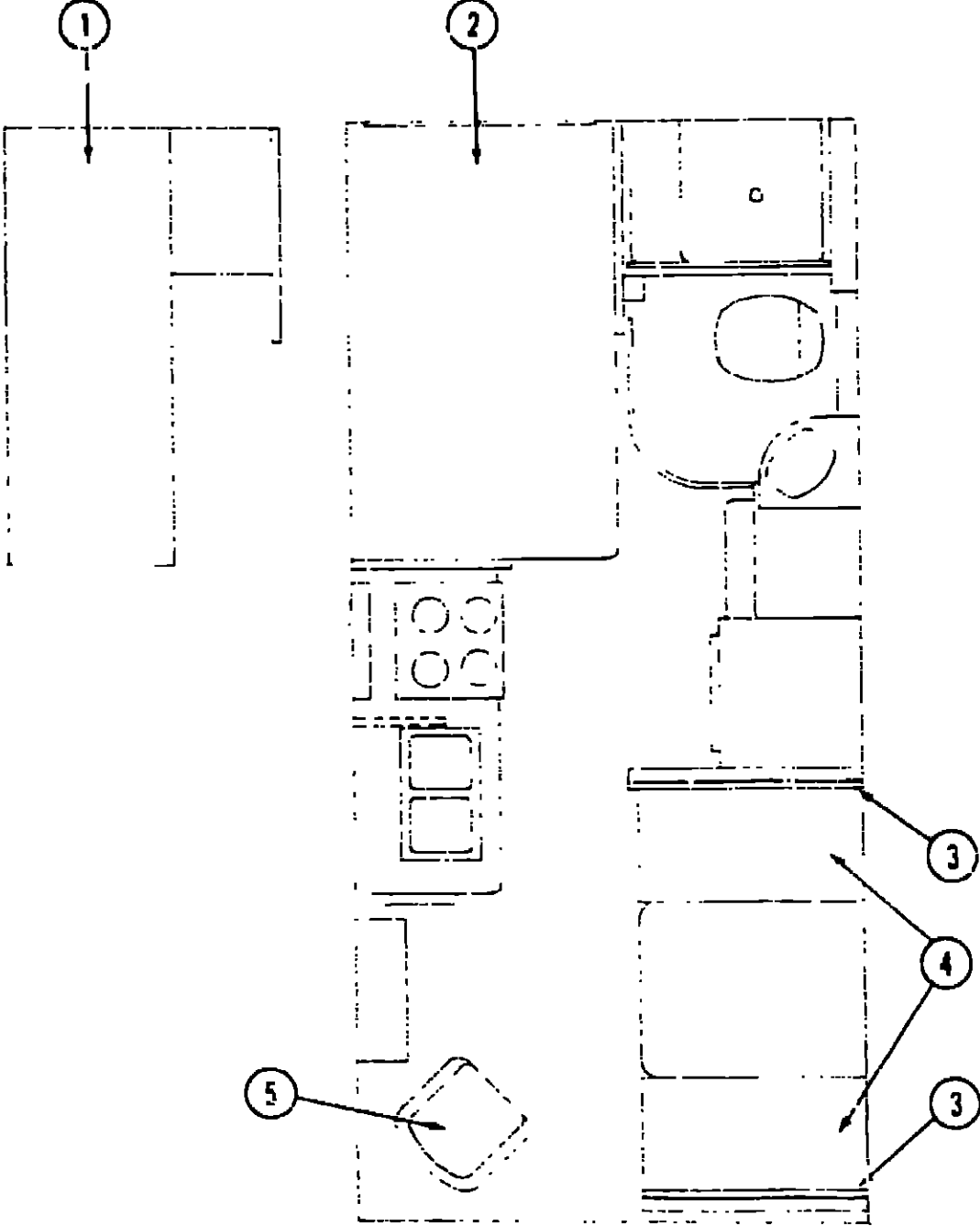

REAR BUNK CUSHIONS				
Key	Part Number	U/M	Description	
1	073519-01-P34	EA	Mattress Cushion Asm. - Rear Bunk - 29" x 75.5" x 4.5" - Blue	
1	073519-01-P35	EA	Mattress Cushion Asm. - Rear Bunk - 29" x 75.5" x 4.5" - Brown	
1	073519-01-P36	EA	Mattress Cushion Asm. - Rear Bunk - 29" x 75.5" x 4.5" - Burgundy	
	M73519-01-P34	EA	Cover - Rear Bunk Cushion - 29" x 75.5" x 4.5" - Blue	
	M73519-01-P35	EA	Cover - Rear Bunk Cushion - 29" x 75.5" x 4.5" - Brown	
	M73519-01-P36	EA	Cover - Rear Bunk Cushion - 29" x 75.5" x 4.5" - Burgundy	

DOUBLE BED MATTRESS				
Key	Part Number	U/M	Description	
2	058709-03-000	EA	Mattress - Inner Spring - Sealy - 48" x 75"	
	070653-02-P31	EA	Bedspread - Double Fitted	
	070653-02-P34	EA	Bedspread - Double Fitted - Blue	
	070653-02-P35	EA	Bedspread - Double Fitted - Brown	
	070653-02-P36	EA	Bedspread - Double Fitted - Burgundy	
	070654-01-P01	EA	Pillow Sham - 20" x 26"	
	070654-01-P34	EA	Pillow Sham - 20" x 26" - Blue	
	070654-01-P35	EA	Pillow Sham - 20" x 26" - Brown	
	070654-01-P36	EA	Pillow Sham - 20" x 26" - Burgundy	

DINETTE CUSHIONS				
Key	Part Number	U/M	Description	
3	072430-05-P34	EA	Cushion - Dinette Back - 19.2" x 38" x 5" - Blue	
3	072430-05-P35	EA	Cushion - Dinette Back - 19.2" x 38" x 5" - Brown	
3	072430-05-P36	EA	Cushion - Dinette Back - 19.2" x 38" x 5" - Burgundy	
	M72430-05-P34	EA	Cover - Dinette Back Cushion - 19.2" x 38" x 5" - Blue	
	M72430-05-P35	EA	Cover - Dinette Back Cushion - 19.2" x 38" x 5" - Brown	
	M72430-05-P36	EA	Cover - Dinette Back Cushion - 19.2" x 38" x 5" - Burgundy	
4	072430-06-P34	EA	Cushion - Dinette Bottom - 17.5" x 38" x 5" - Blue	
4	072430-06-P35	EA	Cushion - Dinette Bottom - 17.5" x 38" x 5" - Brown	
4	072430-06-P36	EA	Cushion - Dinette Bottom - 17.5" x 38" x 5" - Burgundy	
	M72430-06-P34	EA	Cover - Dinette Bottom Cushion - 17.5" x 38" x 5" - Blue	
	M72430-06-P35	EA	Cover - Dinette Bottom Cushion - 17.5" x 38" x 5" - Brown	
	M72430-06-P36	EA	Cover - Dinette Bottom Cushion - 17.5" x 38" x 5" - Burgundy	

SWIVEL CHAIRS				
Key	Part Number	U/M	Description	
5	073518-01-P34	EA	Chair Asm. w/Pillow Back - Swivel - Blue	
5	073518-01-P35	EA	Chair Asm. w/Pillow Back - Swivel - Brown	
5	073518-01-P36	EA	Chair Asm. w/Pillow Back - Swivel - Burgundy	
•	075174-01-P34	EA	Skirt Asm. - Swivel Chair - Blue	
•	075174-01-P35	EA	Skirt Asm. - Swivel Chair - Brown	
•	075174-01-P36	EA	Skirt Asm. - Swivel Chair - Burgundy	
•	035036-01-000	EA	Plate - Tilt and Swivel - Swivel Chair	
•	035036-02-000	EA	Base w/ Legs - Swivel Chair	
•	Not illustrated			

1983 ITASCA  
TABLE OF CONTENTS

IC420RG	A-1 - B-22
IC424RB	B-23 - E-4
ICF26RB	E-5 - G-12
ICN33RU	G-13 - I-20

1983 IC424RB INDEX

Floor Plan	B-23 - B-24
Accessories Group	C-1 - C-3
Bath Group	C-4 - C-5
Chassis Group	C-6 - C-7
Curtain, Cushion & Pad Group	C-8 - C-14
Dinette Group	C-15
Driver's Compartment Group	C-16 - C-17
Electrical Group	C-18 - C-20
Exterior Body Group	C-21 - D-3
Galley Group	D-4 - D-5
Heating & Air Conditioning Group	D-6
Interior Finish Group	D-7 - D-9
LP Group	D-10
Lounge Group	D-11
Water & Sewage Group	D-12 - D-13
Window, Vent & Exterior Door Group	D-14 - E-4

**CURTAIN, CUSHION & PAD GROUP (CONTINUED)**

**FRONT OVERHEAD BUNK CUSHIONS**

Key	Part Number	U/M	Description
	073310-03-P34	EA	Mattress Cushion Asm. - Front Bunk - Two Fold - 24 5" x 29 5" x 76" x 4" - Blue
	073310-03-P35	EA	Mattress Cushion Asm. - Front Bunk - Two Fold - 24 5" x 29 5" x 76" x 4" - Brown
	073310-03-P36	EA	Mattress Cushion Asm. - Front Bunk - Two Fold - 24 5" x 29 5" x 76" x 4" - Burgundy
	M73310-03-P34	EA	Cover - Front Bunk Cushion - Two Fold - 24 5" x 29 5" x 76" x 4" - Blue
	M73310-03-P35	EA	Cover - Front Bunk Cushion - Two Fold - 24 5" x 29 5" x 76" x 4" - Brown
	M73310-03-P36	EA	Cover - Front Bunk Cushion - Two Fold - 24 5" x 29 5" x 76" x 4" - Burgundy

**BUCKET SEATS**

Key	Part Number	U/M	Description
	072460-01-P34	EA	Seat Asm. - Youth Bed w/Left Armrest - Blue
	072460-01-P35	EA	Seat Asm. - Youth Bed w/Left Armrest - Brown
	072460-01-P36	EA	Seat Asm. - Youth Bed w/Left Armrest - Burgundy
	072460-02-P34	EA	Seat Asm. - Youth Bed w/Right Armrest - Blue
	072460-02-P35	EA	Seat Asm. - Youth Bed w/Right Armrest - Brown
	072460-02-P36	EA	Seat Asm. - Youth Bed w/Right Armrest - Burgundy
	070553-02-P34	EA	Cushion - Youth Bed Wedge - Blue
	070553-02-P35	EA	Cushion - Youth Bed Wedge - Brown
	070553-02-P36	EA	Cushion - Youth Bed Wedge - Burgundy
	M00784-05-P34	EA	Cover - Seat Asm. - Bottom - Right or Left - Blue
	M00784-05-P35	EA	Cover - Seat Asm. - Bottom - Right or Left - Brown
	M00784-05-P36	EA	Cover - Seat Asm. - Bottom - Right or Left - Burgundy
	M00784-06-P34	EA	Cover - Seat Asm. - Back - Right or Left - Blue
	M00784-06-P35	EA	Cover - Seat Asm. - Back - Right or Left - Brown
	M00784-06-P36	EA	Cover - Seat Asm. - Back - Right or Left - Burgundy
	071122-11-P34	EA	Armrest Asm. - Right - Blue
	071122-11-P35	EA	Armrest Asm. - Right - Brown
	071122-11-P36	EA	Armrest Asm. - Right - Burgundy
	071122-12-P34	EA	Armrest Asm. - Left - Blue
	071122-12-P35	EA	Armrest Asm. - Left - Brown
	071122-12-P36	EA	Armrest Asm. - Left - Burgundy
	071123-06-P34	EA	Cover - Armrest - Right or Left - Blue
	071123-06-P35	EA	Cover - Armrest - Right or Left - Brown
	071123-06-P36	EA	Cover - Armrest - Right or Left - Burgundy
	069651-01-P34	EA	Seat Asm. - Single Bucket - Low Back - Blue
	069651-01-P35	EA	Seat Asm. - Single Bucket - Low Back - Brown
	069651-01-P36	EA	Seat Asm. - Single Bucket - Low Back - Burgundy
	M00605-01-P34	EA	Cover - Back - Single Bucket - Low Back - Blue
	M00605-01-P35	EA	Cover - Back - Single Bucket - Low Back - Brown
	M00605-01-P36	EA	Cover - Back - Single Bucket - Low Back - Burgundy
	M00604-01-P34	EA	Cover - Bottom - Single Bucket - Low Back - Blue
	M00604-01-P35	EA	Cover - Bottom - Single Bucket - Low Back - Brown
	M00604-01-P36	EA	Cover - Bottom - Single Bucket - Low Back - Burgundy

**CURTAIN, CUSHION & PAD GROUP (CONTINUED)**

**FABRICS, TRIMS AND PADS**

Key	Part Number	U/M	Description
	072333-06-000	YD	Fabric - Draper,
	072333-02-000	YD	Fabric - Drapery - Sheers
	072334-31-000	YD	Fabric - Drapery - Accent - Blue (P34)
	072334-32-000	YD	Fabric - Drapery/Accent - Brown (P35)
	072334-30-000	YD	Fabric - Drapery/Accent - Burgundy (P36)
	072334-34-000	YD	Fabric w/Pattern - Upholstery - Blue (P34)
	072334-35-000	YD	Fabric w/Pattern - Upholstery - Brown (P35)
	072334-33-000	YD	Fabric w/Pattern - Upholstery - Burgundy (P36)
	069729-01-000	YD	Fabric - Bedspread - (P01)
	069729-02-000	YD	Fabric - Bedspread - Blue (P34)
	069729-04-000	YD	Fabric - Bedspread - Brown (P35)
	069729-03-000	YD	Fabric - Bedspread - Burgundy (P36)
	038421-01-000	YD	Fabric - Mattress Ticking
	072872-01-000	YD	Trim - Drapery
	052859-01-P01	FT	Trim Asm. - Accent
	070502-01-000	YD	Vinyl - Non-Expanded - 12 Gauge Film
	057550-03-N07	EA	Button Asm. - Nail - #36 - 7/8" Shank - Vinyl
	057550-05-N07	EA	Button Asm. - Nail - #36 - 3/8" Shank - Vinyl
	057093-01-N07	EA	Button Asm. - Covered #60 - Nail - Vinyl
	071127-03-P34	EA	Button Asm. - Square #65 - Blue (P34)
	071127-03-P35	EA	Button Asm. - Square #65 - Brown (P35)
	071127-03-P36	EA	Button Asm. - Square #65 - Burgundy (P36)
	075269-01-P34	EA	Button Asm. - Square #65 - w/3/4" Stud - Blue (P34)
	075269-01-P35	EA	Button Asm. - Square #65 - w/3/4" Stud - Brown (P35)
	075269-01-P36	EA	Button Asm. - Square #65 - w/3/4" Stud - Burgundy (P36)
	071846-01-P01	EA	Pad Asm. - End Cap - Dinette Overhead - Right - Vinyl
	071847-05-P01	EA	Pad Asm. - End Cap - Galley Overhead - Left - Vinyl
	071847-10-P01	EA	Pad Asm. - End Cap - Shirt Closet - Vinyl
	074549-01-P34	EA	Pad Asm. - Dinette - Right - Blue
	074549-01-P35	EA	Pad Asm. - Dinette - Right - Brown
	074549-01-P36	EA	Pad Asm. - Dinette - Right - Burgundy
	074549-02-P34	EA	Pad Asm. - Dinette - Left - Blue
	074549-02-P35	EA	Pad Asm. - Dinette - Left - Brown
	074549-02-P36	EA	Pad Asm. - Dinette - Left - Burgundy

**CURTAIN HARDWARE**

Key	Part Number	U/M	Description
	056116-01-000	EA	Track - Curtain - Brown Plastic
	053272-04-200	EA	Track - Curtain - 89" - Off White
	052327-05-009	EA	Track - Curtain - 76" - Beige
	018031-48-000	EA	Track - Curtain - "L" Rod - Alum. Extr. - 192"
	056001-01-000	EA	Bracket - Shade - Left
	056002-01-000	EA	Bracket - Shade - Right
	056003-01-000	EA	Bracket - Drapery Retainer - Right
	056003-02-000	EA	Bracket - Drapery Retainer - Left
	056003-03-000	EA	Bracket - Drapery Retainer - Universal
	009107-01-000	EA	Guide - Nylon Snap - Curtain
	056784-01-000	EA	Pull - Window Shade - Antique Brass
	039175-01-000	EA	Curtain Rod - Extension 48" - 84"
	039175-03-000	EA	Curtain Rod - Extension 28" - 48"
	039175-04-000	EA	Curtain Rod - Extension 16" - 28"
	039175-02-000	EA	Bracket - Curtain Rod
	056115-01-000	YD	Tape - Clear Plastic - w/Guides
	048394-01-000	YD	Tape Hook - 1" x 25 YD - Beige
	048395-01-000	YD	Tape Loop - 1" x 25 YD - Beige
	009701-01-000	EA	Carrier - Curtain - "L" Rod
	009702-01-000	EA	End - Stop - Curtain - "L" Rod

**1983 ITASCA  
TABLE OF CONTENTS**

IC420RG	A-1 - B-22
IC424RB	B-23 - E-4
ICF26RB	E-5 - G-12
ICN33RU	G-13 - I-20

**1983 IC424RB INDEX**

Floor Plan	B-23 - B-24
Accessories Group	C-1 - C-3
Bath Group	C-4 - C-5
Chassis Group	C-6 - C-7
Curtain, Cushion & Pad Group	C-8 - C-14
Dinette Group	C-15
Driver's Compartment Group	C-16 - C-17
Electrical Group	C-18 - C-20
Exterior Body Group	C-21 - D-3
Galley Group	D-4 - D-5
Heating & Air Conditioning Group	D-6
Interior Finish Group	D-7 - D-9
LP Group	D-10
Lounge Group	D-11
Water & Sewage Group	D-12 - D-13
Window, Vent & Exterior Door Group	D-14 - E-4



DINETTE GROUP

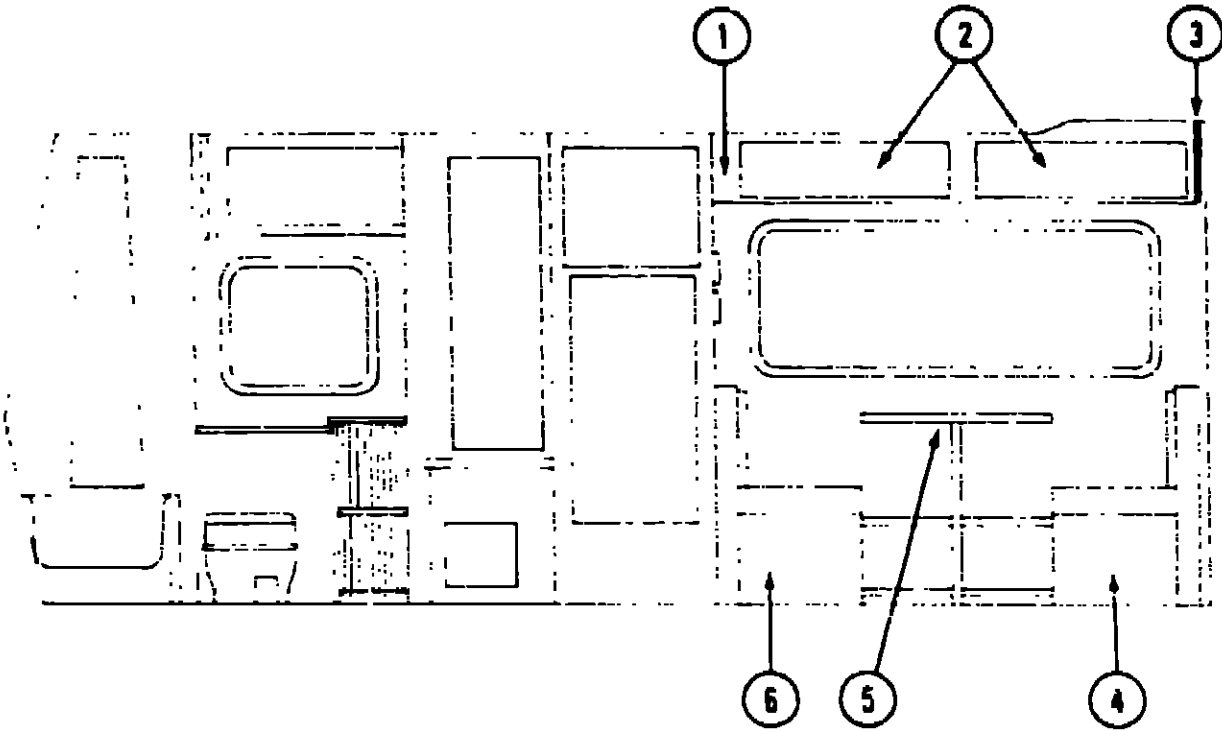

CONVENTIONAL DINETTE AND OVERHEAD CABINERY

Key	Part Number	U/M	Description
1	074969-01-P01	EA	Cabinet Asm. - Dinette Overhead - w/o Doors or Hardware
2	069852-46-P01	EA	Door Asm. - Dinette Overhead - 35 1" x 10 2" - w/o Hardware
3	071847-09-P01	EA	Pad Asm. - End Cap - Dinette Overhead - Right - Almond Vinyl
4	M01266-01-P01	EA	Cabinet Asm. - Dinette Seat - Right - w/o Door or Hardware
•	M01265-01-P01	EA	Cabinet Asm. - Dinette Back - Right
5	M75155-01-P01	EA	Table Asm. - Dinette - w/o Hardware - Almond
6	M01266-02-P01	EA	Cabinet Asm. - Dinette Seat - Left - w/o Door or Hardware
•	M01265-02-P01	EA	Cabinet Asm. - Dinette Back - Left
•	053200-05-000	EA	Bracket - Upper Wall Mount - 23.5" - Beige
•	053201-03-000	EA	Bracket - Table Mount - 23"
•	024275-05-000	EA	Rod - Table Lift - 8" x 23.5" - Beige
•	024281-07-000	EA	Bracket - Lower Wall Mount - 22.12" - Beige
•	024276-08-000	EA	Leg Asm. - Table - Beige - 29 5"
•	064050-01-000	EA	Hinge - Table Leg
•	024282-01-000	EA	Brace - Table Leg
•	024283-01-000	EA	Clip - 1" O D Tube
•	049493-03-000	EA	Catch - Table Leg - Mounts on Floor - Beige
•	064781-02-000	EA	Cup Holder - 3 47" O D x 2.75" I.D x 15" - Beige Plastic
•	Not illustrated		
•	The illustrated parts breakdown for this item is provided on the Common Items Fiche.		

DRIVER'S COMPARTMENT GROUP

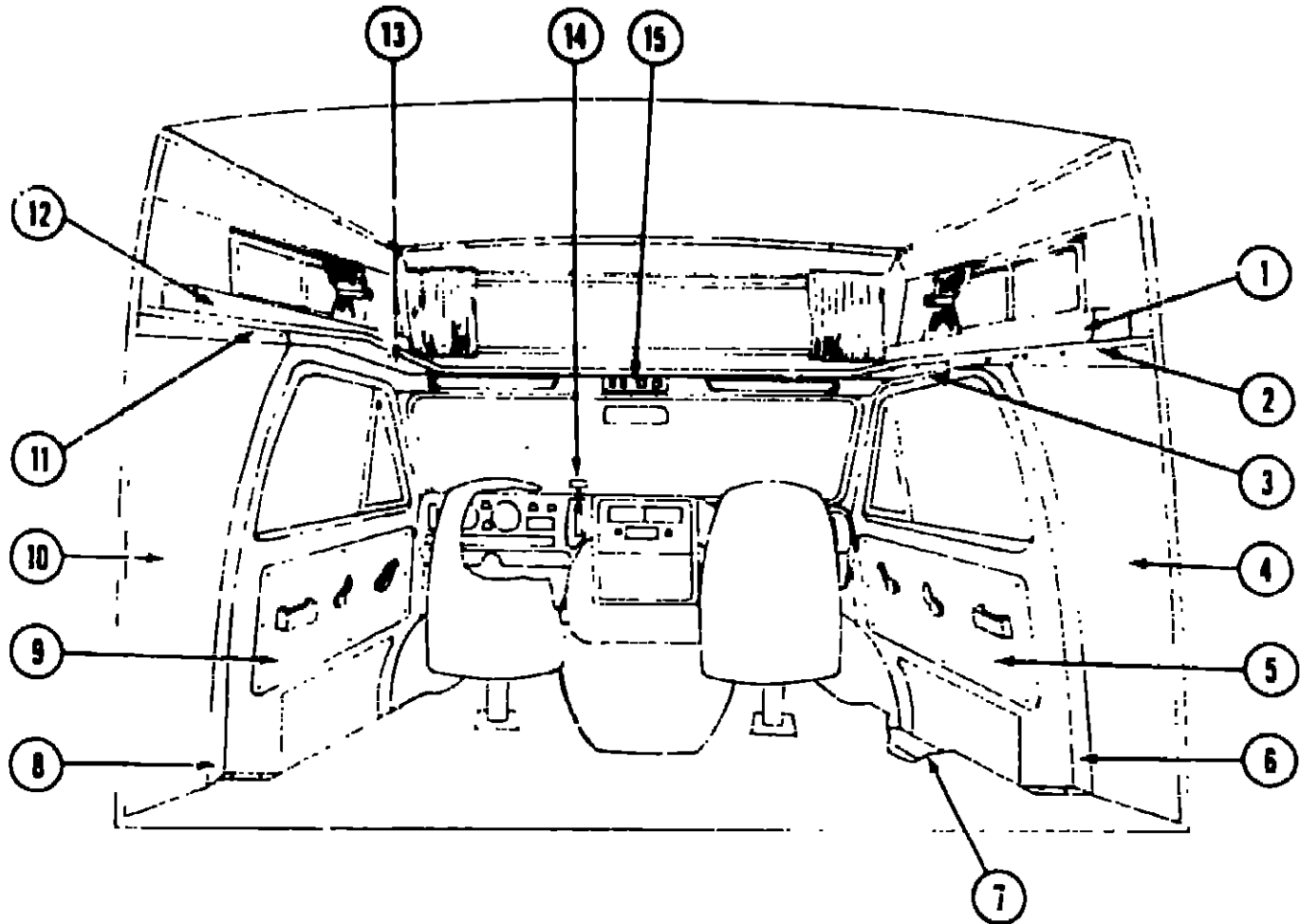

MISCELLANEOUS DRIVER'S COMPARTMENT COMPONENTS

Key	Part Number	U/M	Description
1	057775-02-P01	EA	Cabinet Asm. - Head Board - Right
2	M56379-02-P01	EA	Panel Asm. - Sleeper Board
3	054014-02-P01	EA	Trim Asm. - Over Door - Right - Beige Vinyl
•	054014-01-P01	EA	Trim Asm. - Over Door - Left - Beige Vinyl
4	075766-01-P01	EA	Panel Asm. - Wingwall Transition - Inner Right Hand
5	056567-02-P01	EA	Side Panel - Cab Door - Right - Beige Vinyl
6	053955-02-P01	EA	Panel Asm. - Side - Right
7	044860-02-000	EA	Door Step Matt - Rubber - Black - Right Hand
•	044860-01-000	EA	Door Step Matt - Rubber - Black - Left Hand
8	053955-01-P01	EA	Panel Asm. - Side - Gas - Left
•	053955-03-P01	EA	Panel Asm. - Side - Diesel - Left
9	056580-02-P01	EA	Side Panel - Cab Door - Left - Beige Vinyl
10	075766-02-P01	EA	Panel Asm. - Wingwall Transition - Inner Left Hand
11	052859-01-P01	FT	Accent Trim - Beige Vinyl
12	057775-01-P01	EA	Cabinet Asm. - Head Board - Left
13	053719-01-P01	EA	Headliner Asm. - Beige Vinyl
14	701631-01-000	EA	Shifting Knob and Button - Transmission Control
•	701632-01-000	EA	Retainer - Shifting Knob - Transmission Control
15	049360-11-000	EA	Console - Overhead (Voltmeter, Battery Switch and Light)
•	049360-13-000	EA	Console - Overhead (Dome Light)
•	049360-10-000	EA	Console - Overhead (Hourmeter, Generator Switch and Light)
•	M01298-01-000	EA	Console - Overhead - Blank
•	056288-01-000	EA	Dome Light Asm.
•	024461-01-000	EA	Switch - Battery
•	024462-01-000	EA	Switch - Battery Condition
•	024976-01-000	EA	Switch - Generator w/o Circuit Board
•	024459-03-000	EA	Gauge - Voltmeter
•	031035-01-000	EA	Gauge - Generator Hourmeter
•	055279-01-000	EA	Control Asm. - Heater A/C - 3 Speed
•	Not illustrated		

1983 ITASCA  
TABLE OF CONTENTS

IC420RG  
IC424RB  
ICF26RB  
ICN33RU

A-1 - B-22  
B-23 - E-4  
E-5 - G-12  
G-13 - I-20

1983 IC424RB INDEX

Floor Plan	B-23 - B-24
Accessories Group	C-1 - C-3
Bath Group	C-4 - C-5
Chassis Group	C-6 - C-7
Curtain, Cushion & Pad Group	C-8 - C-14
Dinette Group	C-15
Driver's Compartment Group	C-16 - C-17
Electrical Group	C-18 - C-20
Exterior Body Group	C-21 - D-3
Galley Group	D-4 - D-5
Heating & Air Conditioning Group	D-6
Interior Finish Group	D-7 - D-9
LP Group	D-10
Lounge Group	D-11
Water & Sewage Group	D-12 - D-13
Window, Vent & Exterior Door Group	D-14 - E-4

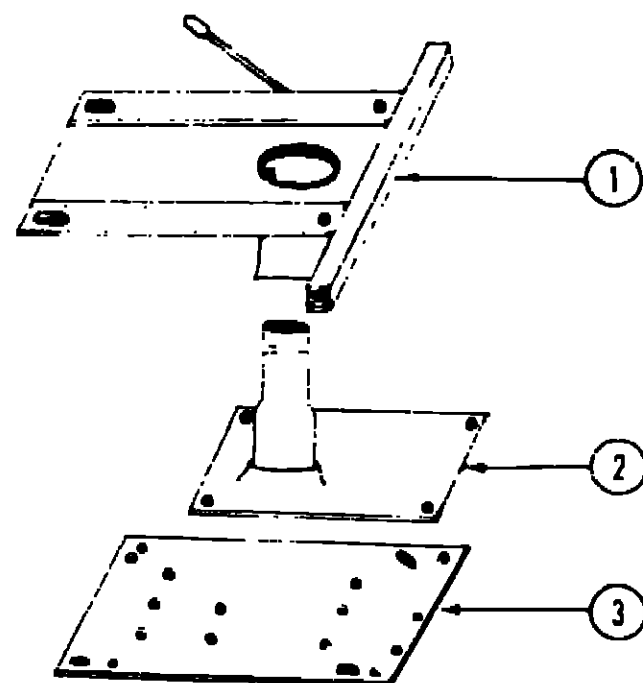

BUCKET SEAT FEDESTAL AND SEAT BELTS

Key	Part Number	U/M	Description
1	069585-06-000	EA	Plate - Top - Pedestal Asm - Single - Bucket Seat
2	069585-03-000	EA	Plate - Sub - Pedestal Asm - Bucket Seat
3	069585-02-000	EA	Plate - Base - Pedestal Asm - Bucket Seat
	069585-05-000	EA	Hardware Kit - Bolt, Acorn Nut - 4 ea. - Pedestal Asm
	007019-01-000	EA	Belt Asm - Seat - 2" x 84" - Black
	041322-01-000	EA	Washer - Flat 15/32" I D x 2 3/8" O D - Seat Belt
	007021-01-000	EA	Belt Asm - Seat - 2" x 90" - Black
	007222-01-000	EA	Belt Asm - Seat - 2" x 60" - Black
	043910-01-000	EA	Bracket Asm - Seat Belt
	058375-01-000	EA	Bracket - Seat Belt - Washer
	069246-01-000	EA	Adjuster Asm. - Seat - w Lock
	069246-02-000	EA	Adjuster Asm. - Seat - w/o Lock
	056271-02-000	EA	Belt Asm. - Seat - 2" x 72" - Black
	068601-01-000	EA	Recliner Drive - Single Bucket - Driver
	068601-02-000	EA	Recliner Drive - Single Bucket - Passenger
	Not illustrated		

ELECTRICAL GROUP

BULBS

Key	Part Number	U/M	Description
	037935-01-000	EA	Bulb - 1157
	063914-01-000	EA	Bulb - 1139
	008103-01-000	EA	Bulb - 53
	008213-01-000	EA	Bulb - 57
	008214-01-000	EA	Bulb - 67
	006215-01-000	EA	Bulb - 1003
	008216-01-000	EA	Bulb - 1034
	008217-01-000	EA	Bulb - 1073
	008218-01-000	EA	Bulb - 1141
	008220-01-000	EA	Bulb - 12V - 25W
	036192-01-000	EA	Bulb - 194
	067479-01-000	EA	Bulb - 1076 - 12V - 1.80 Amp
	056288-02-000	EA	Bulb - J431808

FUSES AND CIRCUIT BREAKER

Key	Part Number	U/M	Description
	056473-02-000	EA	Fuse - Slow Blow - 5 Amp. - 32 Volt Capacity
	056473-01-000	EA	Fuse - Slow Blow - 6 1/4 Amp
	008233-01-000	EA	Fuse - 12 Volt - 6 Amp
	008234-01-000	EA	Fuse - 12 Volt - 10 Amp
	046893-01-000	EA	Fuse - 12 Volt - 13 Amp.
	008235-01-000	EA	Fuse - 12 Volt - 15 Amp
	008236-01-000	EA	Fuse - 12 Volt - 20 Amp.
	008248-01-000	EA	Fuse - 110 Volt - 30 Amp. - AGU
	008252-01-000	EA	Fuse - 110 Volt - 50 Amp
	062901-02-000	EA	Fuse - Automotive - 5 Amp.
	062901-05-000	EA	Fuse - Automotive - 15 Amp.
	008208-01-000	EA	Circuit Breaker - 12 Volt - 40 Amp.
	008211-01-000	EA	Circuit Breaker - 12 Volt - 6 Amp.
	008268-01-000	EA	Circuit Breaker - 12 Volt - 30 Amp. w/Mount
	033573-02-000	EA	Circuit Breaker - 12 Volt - 15 Amp w/Mount
	033573-01-000	EA	Circuit Breaker - 12 Volt - 20 Amp w/Mount
	040051-01-000	EA	Circuit Breaker - 110 Volt - 20 Amp. TQL
	071279-01-000	EA	Circuit Breaker - 120 Volt - 15/30 Amp. 120 Volt
	006273-03-000	EA	Circuit Breaker - 15/20 Amp. TQL
	008299-01-000	EA	Circuit Breaker - 115 Amp. TQL
	008297-01-000	EA	Circuit Breaker - 120 Amp. TQL
	008293-01-000	EA	Circuit Breaker - 130 Amp TQL
	071279-02-000	EA	Circuit Breaker - 15/15 Amp. - 120 Volt
	071279-03-000	EA	Circuit Breaker - 15/20 Amp - 120 Volt
	071279-04-000	EA	Circuit Breaker - 30 Amp - 120 Volt
	071279-05-000	EA	Circuit Breaker - 20 Amp - 120 Volt
	071280-01-000	EA	Circuit Breaker Blank

1983 ITASCA  
TABLE OF CONTENTS

IC420RG	A-1 - B-22
IC424RB	B-23 - E-4
ICF24RB	E-5 - G-12
ICN73RU	G-13 - I-20

1983 IC424RB INDEX

Floor Plan	B-23 - B-24
Accessories Group	C-1 - C-3
Bath Group	C-4 - C-5
Chassis Group	C-6 - C-7
Curtain, Cushion & Pad Group	C-8 - C-14
Dinette Group	C-15
Driver's Compartment Group	C-16 - C-17
Electrical Group	C-18 - C-20
Exterior Body Group	C-21 - D-3
Galley Group	D-4 - D-5
Heating & Air Conditioning Group	D-6
Interior Finish Group	D-7 - D-9
LP Group	D-10
Lounge Group	D-11
Water & Sewage Group	D-12 - D-13
Window, Vent & Exterior Door Group	D-14 - E-4

ELECTRICAL GROUP (CONTINUED)

WIRE, SWITCHES AND RECEPTACLES

Key	Part Number	U/M	Description
	008024-01-000	FT	Wire - 18 5 Bonded - Orange White Yellow Blue/Brown
	008025-01-000	FT	Wire - 18 5 Bonded - Orange White Yellow Blue/Green
	008028-01-000	FT	Wire - 18 5 Bonded - Blue Red Yellow Orange White
	008030-01-000	FT	Wire - 18 4 Bonded - Red/Blue Orange Green
	008250-02-000	EA	Fuse Holder - In Line - 15 Amp
	008277-01-000	EA	Holder - Fuse - Black - Panel Mount
	006077-01-000	EA	Plaque - Compressor Switch
	046885-01-000	EA	Plaque - Mounting Switch
	008054-01-000	EA	Cord - Power - 10-3 30 Amp - 25' - UL
	008052-01-000	EA	Cord - Power - 10-3 30 Amp - 25' - CSA
	024571-03-000	EA	Cover Plate - Receptacle - Jumbo Plastic - Brown
	024571-04-000	EA	Cover Plate - Receptacle - Jumbo Plastic - Ivory
	008158-01-000	EA	Cover Plate - Receptacle - Single - Plastic - Brown
	008164-01-000	EA	Cover Plate - Switch - Brown
	006050-01-000	EA	TV Jack - Ivory
	058028-01-000	EA	Connector - Pigtail - Clear - Nylon
	008162-01-000	EA	Switch - Double Toggle - Spade Brown
	008163-01-000	EA	Switch - Toggle Brown
	008195-01-000	EA	Switch - Push Button - 12 Volt
	056264-01-000	EA	Switch - Leaf Actuator
	024462-01-000	EA	Switch - Battery Condition
	024976-01-000	EA	Switch - Generator w/o Circuit Board
	063912-01-000	EA	Relay - Canister Spot w/ Ground
	069238-01-000	EA	Cover - Electrical - 4 x 4 Box
	008058-01-000	EA	Adapter - Power Cord
	024924-02-000	EA	Receptacle - Power Cord
	053126-01-000	EA	Receptacle - Ground Fault Interrupter - 125 Volt - Ivory
	053126-02-000	EA	Receptacle - Ground Fault Interrupter - 125 Volt - Brown
	058707-01-000	EA	Receptacle - Single - Brown
	055709-01-000	EA	Receptacle - Duplex - Brown
	058708-02-000	EA	Receptacle - Duplex - Ivory
	008157-01-000	EA	Receptacle - Duplex - Brown (Exterior Backwall)
	058049-01-000	EA	Cover - Electrical Box - 4 5" x 2.75" - Rain Tight (Exterior)
	008294-01-000	EA	Cover - Steel - Flat Blank 4" x 4"
	008288-01-000	EA	Box - Electrical - Plastic - 3" x 3 5"
	008289-01-000	EA	Box - Electrical - Steel - 4 x 4 - 1/2 & 3/4 UL
	058049-01-000	EA	Box - Electrical - 2" x 3" x 2 25" - Steel
	064398-01-000	EA	Housing Asm - Trailer Receptacle
	064399-01-000	EA	Housing Asm - Trailer Pin
	064450-01-000	EA	Housing Asm - Trailer Plug
	035417-01-000	EA	Terminal - Pin Receptacle - .125 Dia
	054532-01-000	EA	Housing Pin - 6 Position
	031968-01-000	EA	Contact - Plug - Brass - Tin Plated
	035290-17-000	EA	Cable Asm - Battery - 1 AWG Strand - 282"
	054865-01-000	EA	Wire Asm - Generator Switch

ELECTRICAL GROUP (CONTINUED)

EXTERIOR LIGHTS

Key	Part Number	U/M	Description
	007309-01-000	EA	Light - Step Well
	058032-01-000	EA	Tail Lamp Asm - 2 Bulb - Chrome - Right/Left
	059036-01-000	EA	Bracket - Tail Lamp
	059540-01-000	EA	Bracket - License Plate
	062742-04-000	EA	Wedge - Tail Lamp w/ License Plate - Off White - Left
	062740-04-000	EA	Wedge - Tail Lamp - Off White - Right
	042405-03-000	EA	Base - Rectangular Clearance Light
	042405-01-000	EA	Lens - Clearance Light - Red w/ Reflex
	042405-04-000	EA	Lens - Clearance Light - Red w/o Reflex
	042405-02-000	EA	Lens - Clearance Light - Amber w/ Reflex
	042405-05-000	EA	Lens - Clearance Light - Amber w/o Reflex
	058330-01-000	EA	Lamp Asm - Parking
	058330-02-000	EA	Socket Asm - Parking Lamp w/ Wire
	048817-01-000	EA	Assist Handle Asm w/ Light

INTERIOR LIGHTS

Key	Part Number	U/M	Description
	033508-02-000	EA	Light - Dome - Ivory - 1 Bulb - US - Progressive Dynamics, Inc
	033508-03-000	EA	Light - Dome - Ivory - 1 Bulb - CSA - Progressive Dynamics, Inc
	033509-02-000	EA	Light - Dome - Ivory - 2 Bulb - US - Progressive Dynamics, Inc
	033509-03-000	EA	Light - Dome - Ivory - 2 Bulb - CSA - Progressive Dynamics, Inc
	061424-01-000	EA	Light - 12 V Receptacle - Aisle - IP
	053346-01-000	EA	Light - High Intensity - Brown
	007309-01-000	EA	Light - Step Well
	072353-01-000	EA	Light - Reading - Single - 360° Swivel - Silver
	072353-02-000	EA	Light - Reading - Double - 360° Swivel - Silver
	056288-01-000	EA	Light - Dome (Drivers Compartment)

MISCELLANEOUS ELECTRICAL COMPONENTS

Key	Part Number	U/M	Description
	047336-03-000	EA	Isolator - Dual Battery - 70 Amp
	063739-01-000	EA	Battery - 12 Volt - 60 Amp. Gould
	008188-01-000	EA	Solenoid - Dual Battery - Relay
	039950-01-702	EA	Circuit Board - Control Center
	024459-03-000	EA	Gauge - Voltmeter - w/o Bracket
	031035-01-000	EA	Gauge - Hourmeter - Generator
	024460-03-000	EA	Gauge - Vacuum - w/o Bracket
	039861-01-000	EA	Sending Unit Kit - Wemac
	048812-12-000	EA	Refrigerator Sensor - Refrigerator Alarm
	048812-04-000	EA	Control Panel - Basic
	048812-09-000	EA	Control Panel - Insert - w LP Gauge - Digital Alarm - Refrigerator Alarm
	072351-03-000	EA	Control Panel Complete - Digital Alarm - LP Gauge
	072351-01-000	EA	Control Panel Complete - Digital Alarm - LP Gauge - Refrigerator Alarm
	022755-01-000	EA	Cover - Control Panel - Plastic
	067762-01-000	EA	Converter - 40 Amp w/ Charger
	024461-01-000	EA	Switch - Dual Battery
	071278-01-000	EA	Control Center - 32 Amp
	052367-01-000	EA	Lighter Asm - Cigarette

1983 ITASCA  
TABLE OF CONTENTS

IC420RG	A-1 - B-22
IC424RB	B-23 - F-4
ICF25RB	E-5 - G-12
ICN33RU	G-13 - I-20

1983 IC424RB INDEX

Floor Plan	B-1 - B-24
Accessories Group	C-1 - C-3
Bath Group	C-4 - C-5
Chassis Group	C-6 - C-7
Curtain, Cushion & Pad Group	C-8 - C-14
Dinette Group	C-15
Driver's Compartment Group	C-16 - C-17
Electrical Group	C-18 - C-20
Exterior Body Group	C-21 - D-3
Galley Group	D-4 - D-5
Heating & Air Conditioning Group	D-6
Interior Finish Group	D-7 - D-9
LP Group	D-10
Lounge Group	D-11
Water & Sewage Group	D-12 - D-13
Window, Vent & Exterior Door Group	D-14 - F-4

# **EXTERIOR BODY GROUP** **EXTERIOR BODY PANELS AND SHEET ALUMINUM**

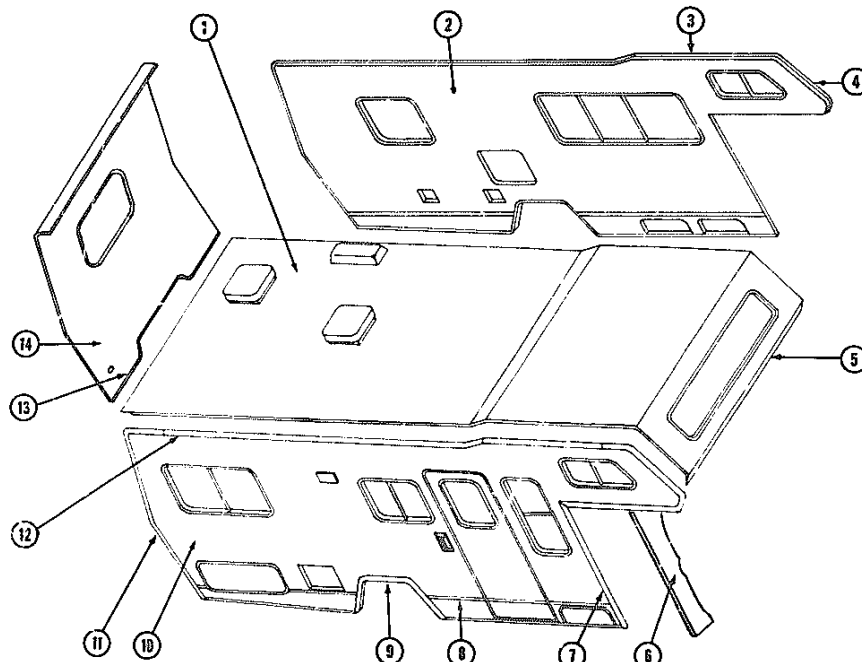

Key	Part Number	U/M	Description
1	M74959-01-P01	EA	Roof Asm.
*	058146-01-700	EA	Roof Section - Cab Over to First Seam
2	M74957-01-P01	EA	Sidewall Asm. - Left
3	056240-04-000	EA	Trim - Contour - Upper Front - Left - Off White
*	056240-03-000	EA	Trim - Contour - Upper Front - Right - Off White
4	375147-02-100	EA	Trim - Contour - Sleeper - Left - Off White
*	075147-01-C	EA	Trim - Contour - Sleeper - Right - Off White
5	039644-05-000	EA	Trim - Sleeper Board - Front - Off White
6	074961-01-P01	EA	Wingwall Asm. - Right
*	074961-02-P01	EA	Wingwall Asm. - Left
7	035476-15-000	EA	Trim - Wingwall Transition - Right - Off White
*	035476-16-000	EA	Trim - Wingwall Transition - Left - Off White
8	059576-05-000	EA	Feature Strip - Extr. - w/o Insert - 14' - Off White
*	001030-02-003	EA	Insert - Feature Strip - 17' - Stucco - Off White
*	009731-01-000	EA	End Cap - Feature Strip
9	075189-01-000	EA	Trim - Wheel Well - Rear Right - Off White Plastic
*	075189-02-000	EA	Trim - Wheel Well - Rear Left - Off White Plastic
*	052671-05-000	EA	Trim - Wheel Well - Rear - Right or Left
10	M74955-01-P34	EA	Sidewall Asm. - Right
10	M74855-01-P35	EA	Sidewall Asm. - Right
10	M74377-01-P36	EA	Sidewall Asm. - Right
*	M74955-02-P34	EA	Sidewall Asm. - Bunk House - Right

C-21

## **1983 ITASCA** **TABLE OF CONTENTS**

IC420RG	A-1 - B-22
IC424RB	B-23 - E-4
ICF26RB	E-5 - G-12
ICN33RU	G-13 - I-20

## **1983 IC424RB INDEX**

Floor Plan	B-23 - B-24
Accessories Group	C-1 - C-3
Bath Group	C-4 - C-5
Chassis Group	C-6 - C-7
Curtain, Cushion & Pad Group	C-8 - C-14
Dinette Group	C-15
Driver's Compartment Group	C-16 - C-17
Electrical Group	C-18 - C-20
Exterior Body Group	C-21 - D-3
Galley Group	D-4 - D-5
Heating & Air Conditioning Group	D-6
Interior Finish Group	D-7 - D-9
LP Group	D-10
Lounge Group	D-11
Water & Sewage Group	D-12 - D-13
Window, Vent & Exterior Door Group	D-14 - E-4

C-22

Key	Part Number	U/M	Description
*	M74955-02-P35	EA	Sidewall Asm. - Bunk House - Right
*	M74955-02-P36	EA	Sidewall Asm. - Bunk House - Right
11	039964-01-000	EA	Trim - Contour - Right Rear - Off White
*	039964-02-000	EA	Trim - Contour - Left Rear - Off White
12	042170-09-000	EA	Trim - Contour - Upper Rear Right - Off White
*	042170-10-000	EA	Trim - Contour - Upper Rear Left - Off White
13	074966-01-000	EA	Trim - Backwall - Lower - Left or Right
14	074960-01-P01	EA	Backwall Asm. - w/Double Bed
14	074960-02-P01	EA	Backwall Asm. - w/Bunk Bed
*	002365-02-001	EA	U-Channel - Extrusion - 1" x 18"
*	002776-02-001	EA	U-Channel - Extrusion - 1.75" x 16"
*	039155-28-006	EA	Alum. - Off White - Mesa II - .024" x 48" x 360"
*	039155-28-003	EA	Alum. - Off White - Mesa II - .024" x 36" x 360"
*	039155-28-007	EA	Alum. - Off White - Mesa II - .024" x 12" x 360"
*	039155-06-001	EA	Alum. - Off White - Grey, Round Design - 48" x 96"
*	001018-01-024	EA	Alum. - Off White - No Design - 48" x 96"
*	044487-01-001	EA	Alum. - Mill Finish - N. Design (Roof) - 96" x 360"
*	000868-01-000	SF	Styrofoam - .75" x 24" x 96"
*	000870-01-000	SF	Styrofoam - 1.5" x 24" x 96"
*			Not illustrated

EXTERIOR BODY GROUP (CONTINUED)

LABELS, DECALS AND EXTERIOR PAINT

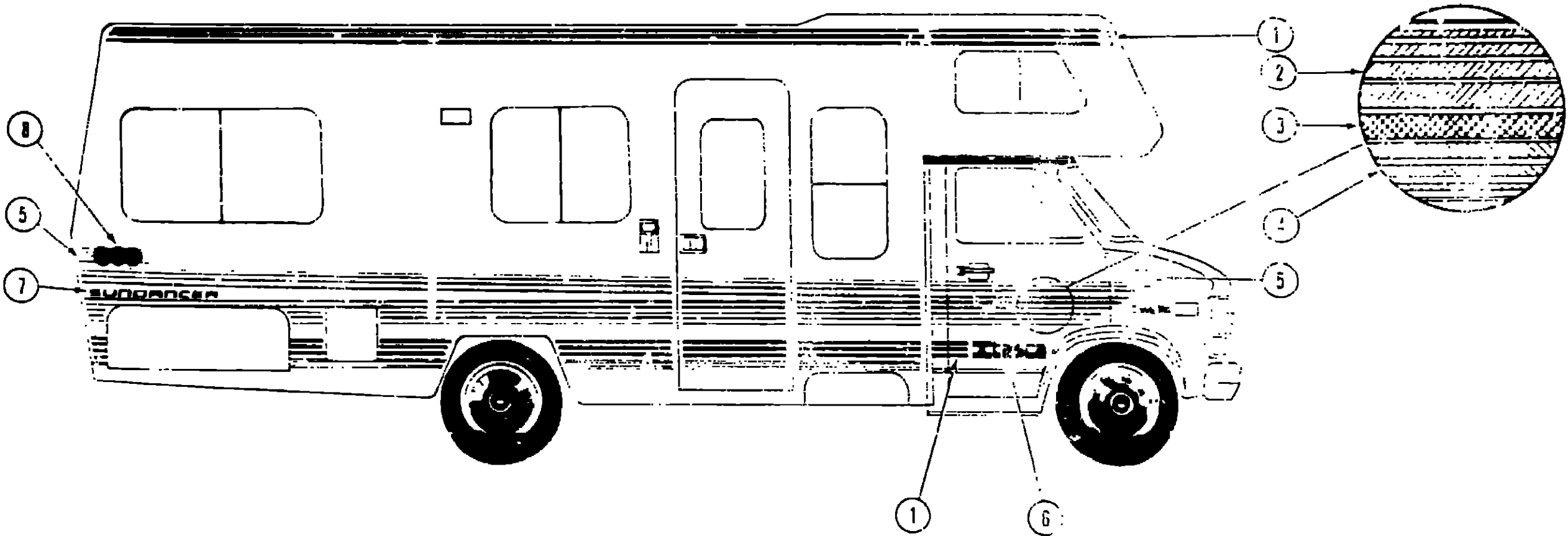

1983 ITASCA  
TABLE OF CONTENTS

IC426RG  
IC424RB  
IC726PB  
ICN33-11

A-1 - B-22  
B-23 - E-4  
E-5 - G-12  
G-13 - I-20

Key	Part Number	U/M	Description
1	069245-05-000	FT	Film - Multi-Stripe - 3.70" x 150" - Gold - Light Blue Metallic Black (P34)
1	069245-06-000	FT	Film - Multi-Stripe - 3.70" x 150" - Gold - Red Brown Metallic Black (P35)
1	069245-07-000	FT	Film - Multi-Stripe - 3.70" x 150" - Gold - Burgundy Metallic Black (P36)
2	073704-01-000	FT	Film - Multi-Stripe - 4.31" x 150" - Gold Metallic
3	041273-54-000	FT	Decal - Striping - 1.25" - Black
4	073703-01-000	FT	Film - Multi-Stripe - 3.06" x 150" - Light Blue Metallic (P34)
4	073703-02-000	FT	Film - Multi-Stripe - 3.06" x 150" - Red Brown Metallic (P35)
4	073703-03-000	FT	Film - Multi-Stripe - 3.06" x 150" - Burgundy Metallic (P36)
5	041273-55-000	FT	Decal Striping - 10" - Gold Metallic
6	069227-04-000	EA	Decal - Logo - "Itasca" - 3.70" x 15.82"
7	073710-01-000	EA	Decal - Logo - "Sundancer" - 29" x 1.5"
8	073706-01-000	EA	Decal - Triple Sun Segmented
•	006031-01-000	EA	Label - Potable Water Only
•	006187-01-000	EA	Label - Sewage
•	006188-01-000	EA	Label - Waste Water
•	006199-01-000	EA	Label - Exit - Escape Window
•	006026-01-000	EA	Label - Drain Cap - 2" x 3"
•	040944-01-000	EA	Label - Oper - Entrance Door
•	047731-01-000	EA	Label - Emergency Exit
•	054531-01-000	EA	Label - LP Gas Only
•	056259-01-000	EA	Label - Safety Check List

Key	Part Number	U/M	Description
•	061417-01-000	EA	Label - Fuel
•	063225-01-000	EA	Label - Warning - Stove Vent - US
•	006015-01-000	EA	Label - Potent Motor Home
•	006064-01-000	EA	Label - Seat - w/o Seat Belt
•	061378-01-000	EA	Label - Flying W/ w Thermo Panel
•	006195-01-000	EA	Label - Electrical Test
•	006196-01-000	EA	Label - Gas Test
•	006197-01-000	EA	Label - Water Test
•	023769-01-000	EA	Label - Warning - LPG - Canada
•	057467-04-000	EA	Label - Exterior Loading Limit
•	068383-01-000	EA	Label - Diesel Fuel
•	006038-01-000	EA	Label - Thermo Panel - 2 1/4" x 2 1/4"
•	065950-01-000	EA	Logo - LP Power - 9.25" x 18.75"
•	065952-01-000	EA	Logo - Winnebago LPG
•	006040-01-000	EA	Tag - Gas - Refueling Warning
•	006062-01-000	EA	Tag - Electrical - 110 V Connection
•	072863-01-000	EA	Nameplate - Diesel - 6.2 L
•	041561-03-000	EA	Paint - Off White - Acrylic Enamel - 16 oz. Aerosol
•	045661-03-000	EA	Paint - Gloss Black - Acrylic Enamel - 16 oz. Aerosol (99A Dupont)
•	Not Illustrated		

1983 IC424RB INDEX

Floor Plan	B-23 - B-24
Accessories Group	C-1 - C-2
Bath Group	C-4 - C-5
Chassis Group	C-6 - C-7
Curtain Cushion & Pad Group	C-8 - C-14
Dinette Group	C-15
Driver's Compartment Group	C-16 - C-17
Electrical Group	C-18 - C-20
Exterior Body Group	C-21 - D-3
Galley Group	D-4 - D-5
Heating & Air Conditioning Group	D-6
Interior Finish Group	D-7 - D-9
LP Group	D-10
Lounge Group	D-11
Water & Sewage Group	D-12 - D-13
Window Vent & Exterior Door Group	D-14 - E-4

EXTERIOR BODY GROUP (CONTINUED)

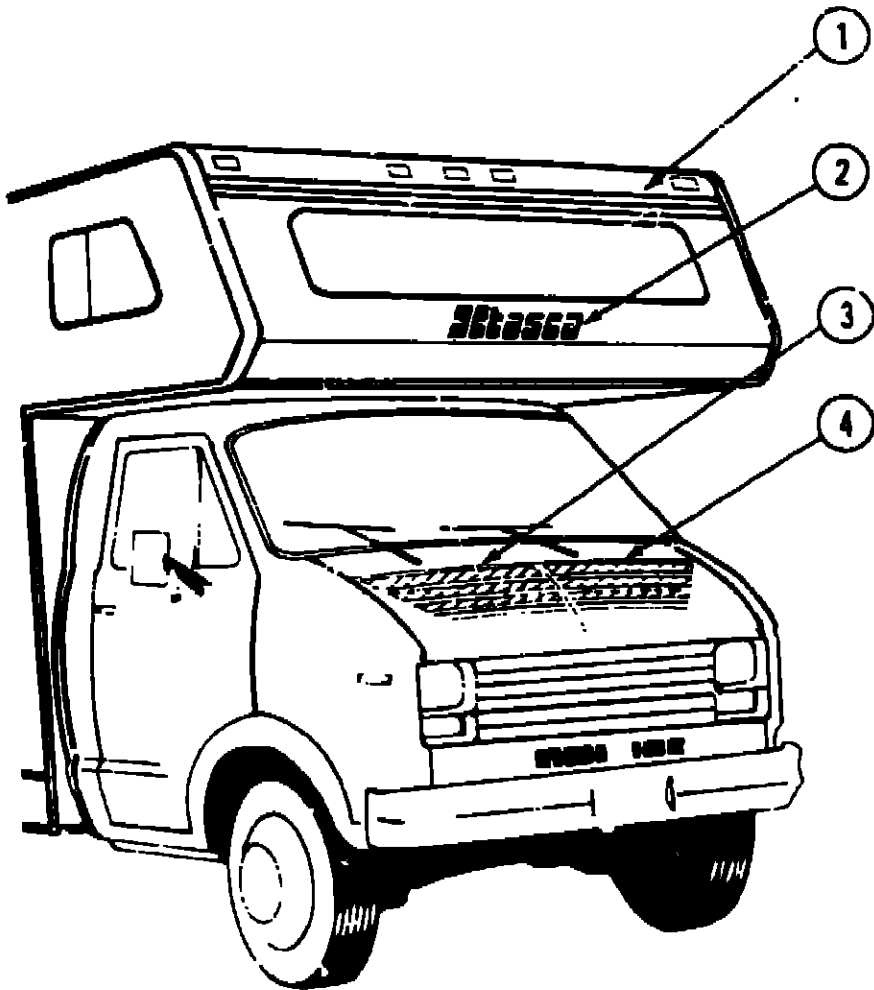

FRONT DECALS

Key	Part Number	U/M	Description
1	069245-05-000	FT	Film - Multi-Stripe - 3.70" x 150' - Gold/Light Blue Metallic/Black (P34)
1	069245-06-000	FT	Film - Multi-Stripe - 3.70" x 150' - Gold/Red/Brown Metallic/Black (P35)
1	069245-07-000	FT	Film - Multi-Stripe - 3.70" x 150' - Gold/Burgundy Metallic/Black (P36)
2	069227-04-000	EA	Decal - Logo - "Itasca" - 3.70" x 15.82"
3	073711-01-000	EA	Decal - Hood - Right - Gold Metallic/Black
4	073711-02-000	EA	Decal - Hood - Left - Gold Metallic/Black

EXTERIOR BODY GROUP (CONTINUED)

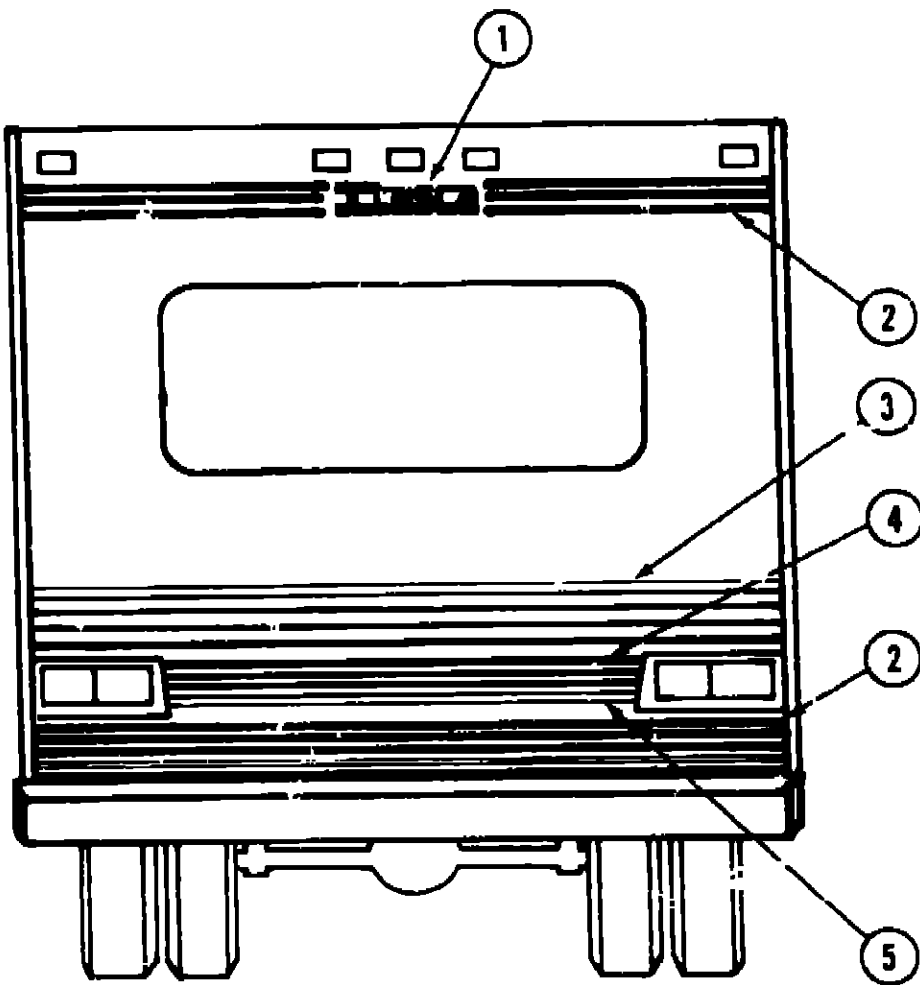

REAR DECALS

Key	Part Number	U/M	Description
1	069227-04-000	EA	Decal - Logo - "Itasca" - 3.70" x 15.82"
2	069245-05-000	FT	Film - Multi-Stripe - 3.70" x 150' - Gold/Light Blue Metallic/Black (P34)
2	069245-06-000	FT	Film - Multi-Stripe - 3.70" x 150' - Gold/Red/Brown Metallic/Black (P35)
2	069245-07-000	FT	Film - Multi-Stripe - 3.70" x 150' - Gold/Burgundy Metallic/Black (P36)
3	073704-01-000	FT	Film - Multi-Stripe - 4.31" x 150' - Gold Metallic
4	041273-54-000	FT	Decal - Striping - 1.25" - Black
5	073703-01-000	FT	Film - Multi-Stripe - 3.06" x 150' - Light Blue Metallic (P34)
5	073703-02-000	FT	Film - Multi-Stripe - 3.06" x 150' - Red/Brown Metallic (P35)
5	073703-03-000	FT	Film - Multi-Stripe - 3.06" x 150' - Burgundy Metallic (P36)

1983 ITASCA  
TABLE OF CONTENTS

IC420RG	A-1 - B-22
IC424RB	B-23 - E-4
ICF26RB	E-5 - G-12
ICN33RU	G-13 - I-20

1983 IC424RB INDEX

Floor Plan	B-23 - B-24
Accessories Group	C-1 - C-3
Bath Group	C-4 - C-5
Chassis Group	C-6 - C-7
Curtain, Cushion & Pad Group	C-8 - C-14
Dinette Group	C-15
Driver's Compartment Group	C-16 - C-17
Electrical Group	C-18 - C-20
Exterior Body Group	C-21 - D-3
Galley Group	D-4 - D-5
Heating & Air Conditioning Group	D-6
Interior Finish Group	D-7 - D-9
LP Group	D-10
Lounge Group	D-11
Water & Sewage Group	D-12 - D-13
Window, Vent & Exterior Door Group	D-14 - E-4

EXTERIOR BODY GROUP (CONTINUED)

SEALANTS, ADHESIVES AND FASTENERS

Key	Part Number	U/M	Description
	034552-05-000	EA	Sealant - Off White Silicone
	034552-04-000	EA	Sealant - Beige Silicone
	034552-02-000	EA	Sealant - Clear Silicone
	069637-01-000	EA	Sealant - Weatherban 404 Tube - 3M
	004348-02-000	EA	Sealant - White Silicone
	009200-01-000	EA	Tape - Furnace - 1.5"
	004353-01-000	FT	Tape - Gasket - .125" x .75" - White
	002825-01-000	FT	Weather Stripping - Roof Vent
	002337-01-000	EA	Adhesive - 3M - 1300 Tube
	004005-01-000	GL	Adhesive - Swifts - Glue (Sidewalls)
	004020-01-000	QT	Adhesive - ABS Cement (Plastic Fittings)
	000G66-08-12R	EA	Screw #8 - 18 x .75" SDPH - Beige
	000G66-08-16S	EA	Screw #8 - 18 x .75" SDPH - Off White
	000G64-08-16R	EA	Screw #8 - 18 x 1" SDPH - Beige
	000G64-08-16S	EA	Screw #8 - 18 x 1" SDPH - Off White
	000G64-08-16M	EA	Screw #8 - 18 x 1" SDPH - Gray
	053766-01-000	EA	Bedding Compound - Tube Black - Schnee Morehead
	053766-02-000	EA	Bedding Compound - Tube White - Schnee Morehead
	035628-01-000	EA	Fastener - Blind Well Nut
	069640-01-000	FT	Tape - .25" Bead x 20' - Gray - 3M
	069640-02-000	FT	Tape - .5" x .125" x 30' - Gray - 3M
	069640-03-000	FT	Tape - .75" x .125" x 30' - Gray - 3M
	069640-04-000	FT	Tape - 2" x .09" x 45' - Gray - 3M
	069640-05-000	FT	Tape - 2.5" x .09" x 50' - Gray - 3M
	038886-01-000	EA	Tape - Butyl - 31" x 31" x 148" - Windshield

MISCELLANEOUS EXTERNALLY MOUNTED PARTS

Key	Part Number	U/M	Description
**	011129-01-000	EA	Plumbing Seal - Roof Vent - 1.5"
	048817-01-000	EA	Assist Handle - w/Light
	048817-01-000	EA	Lens - Assist Handle
	010230-02-000	EA	Fill - City Water - Recessed - Off White
	058808-01-000	EA	Water Fill - Lockable - White
	063303-04-000	EA	Shroud - Fuel Fill
	072447-01-000	EA	Shroud - Fuel Fill - Lower
	072309-02-000	EA	Shroud - Fill Neck
**	The illustrated parts breakdown for this item is provided on the Common Items Fiche		

GALLEY GROUP

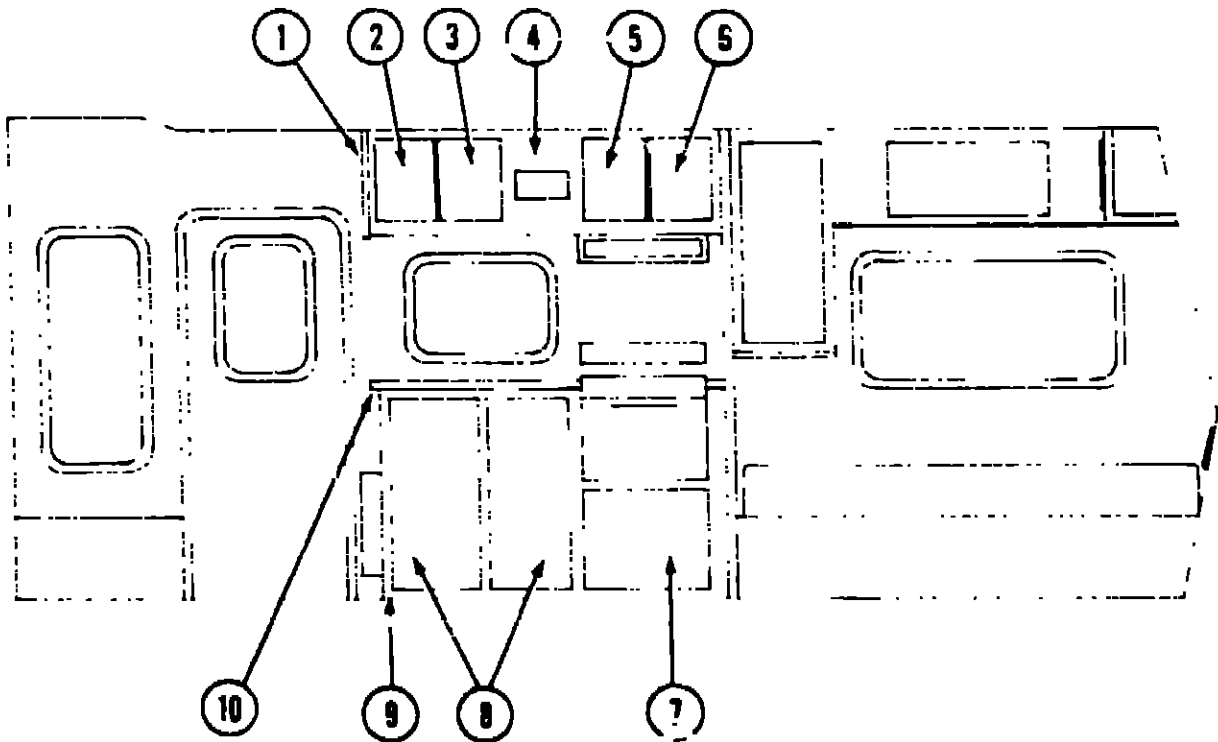

1983 ITASCA  
TABLE OF CONTENTS

IC420RG	A-1 - B-22
IC424RB	B-23 - E-4
ICF26PB	E-5 - G-12
ICN33RU	G-13 - I-20

GALLEY CABINETRY

Key	Part Number	U/M	Description
1	071847-05-P01	EA	Pad End - Galley Overhead Cabinet - Almond Vinyl
2	073521-04-P01	EA	Door Asm - Galley Overhead - 15.80" x 10.70" - w/o Hardware - Left
3	073521-03-P01	EA	Door Asm - Galley Overhead - 15.80" x 10.70" - w/o Hardware - Right
4	074973-01-P01	EA	Cabinet Asm - Galley Overhead - w/o Doors or Hardware
5	073521-06-P01	EA	Door Asm - Galley Overhead - 15.80" x 11.60" - w/o Hardware - Left
6	073521-05-P01	EA	Door Asm - Galley Overhead - 15.80" x 11.60" - w/o Hardware - Right
*	073521-08-P01	EA	Door Asm - Refrigerator Cabinet - 17.7" x 12.6" - w/o Hardware - Left
*	073521-07-P01	EA	Door Asm - Refrigerator Cabinet - 17.7" x 12.6" - w/o Hardware - Right
7	072718-01-P01	EA	Door Asm - Galley - Furnace - 17.6" x 22" - w/o Hardware
*	072369-03-000	FT	Mesh Insert - Furnace Door - 17.9" x 6.7" - Gold
8	069852-40-P01	EA	Door Asm - Galley Cabinet - 14.3" x 33.4" - w/o Hardware
9	M74989-01-P01	EA	Cabinet Asm - Galley - w/o Countertop, Doors, Drawers or Hardware
10	M01267-01-P01	EA	Countertop Asm - Galley - Almond
*	077404-01-000	EA	Drawer - Plastic - 20" x 12.7"
*	Not illustrated		

1983 IC424RB INDEX

Floor Plan	B-23 - B-24
Accessories Group	C-1 - C-3
Bath Group	C-4 - C-5
Chassis Group	C-6 - C-7
Curtain, Cushion & Pad Group	C-8 - C-14
Dinette Group	C-15
Driver's Compartment Group	C-16 - C-17
Electrical Group	C-18 - C-20
Exterior Body Group	C-21 - D-3
Galley Group	D-4 - D-5
Heating & Air Conditioning Group	D-6
Interior Finish Group	D-7 - D-9
LP Group	D-10
Lounge Group	D-11
Water & Sewage Group	D-12 - D-13
Window, Vent & Exterior Door Group	D-14 - E-4

**GALLEY GROUP (CONTINUED)**

**GALLEY HARDWARE AND APPLIANCES**

Key	Part Number	U/M	Description
	053424-04-P01	EA	Sink Cover - Large - Almond
	068615-01-000	EA	Sink - Stainless Steel - Double w/Bolts
**	011053-01-000	EA	Faucet - Swing Spout - 8" - US
**	011053-02-000	EA	Faucet - Swing Spout - 8" - C S A
	066437-01-000	EA	Strainer w/Basket - Sink
**	011053-01-700	EA	Aerator - Swing Spout Faucet
	058334-01-000	EA	Wastebasket - 9 3/4" x 7" x 10" - White Rubbermaid
	058478-01-000	EA	Support - Wastebasket - Metal - Door Mount
	066529-01-P01	EA	Table Asm - Drop Leaf - Almond
	009049-01-000	EA	Support - Drop Leaf Table
	058841-01-P01	EA	Cover - Wastebasket - Almond
	075217-01-000	EA	Refrigerator - AC/DC/Gas - Norcold 8'
	064473-02-000	EA	Refrigerator - AC/DC/Gas - Norcold 6'
	052771-02-000	EA	Microwave Oven - Magic Chef - M #207
	053287-07-000	EA	Bracket Asm. - Microwave - Right
	053287-08-000	EA	Bracket Asm - Microwave - Left
	055282-03-000	EA	Range - 4 Burner - Small Oven - Magic Chef
	749045-01-740	EA	Cover - Stovetop - Bifold - Chrome - Magic Chef
**	049930-03-000	EA	Hood - Stove - w/Black Face - Powered - US
**	053333-01-000	EA	Hood - Stove - w/Black Face - Non-Powered
**	052932-01-J30	EA	Hinge Kit - Cabinet Door - Antique Brass
	009059-01-000	EA	Hinge - 2" - Gold
	074490-02-R10	EA	Spice Rack - Oak
	074491-02-R10	EA	Magazine Rack - Oak
	074981-01-000	EA	Cutting Board - Maple
**	057898-01-000	EA	Latch - Hidden - Cabinet Door
**	057898-02-000	EA	Strike - Hidden Latch - Cabinet Door
	047744-01-000	EA	Kit - Drawer Guide - Plastic
	054450-01-000	EA	Level - Refrigerator
**	The illustrated parts breakdown for this item is provided on the Common Items Fiche		

**HEATING AND AIR CONTIONING GROUP**

**FURNACES AND ROOF AIR CONDITIONER**

Key	Part Number	U/M	Description
	075696-01-000	EA	Furnace - 34,000 BTU - w/Direct Ignition - NT-34S
	075695-01-000	EA	Furnace - 24,000 BTU - w/Direct Ignition - NT-24S
	009198-01-000	FT	Duct - Flexible - 4" I.D. x 25'
	056464-01-000	EA	Register - 4" Dia. - Plastic - w/Damper
	056464-02-000	EA	Register - 4" Dia. - Plastic - w/o Damper
	009200-01-000	EA	Tape - Furnace - 1 1/2"
	023146-01-000	EA	Clamp - Screw Type - 4"
	069633-01-705	EA	Vent Package - Furnace - Suburban
	069634-01-723	EA	Thermostat - Wall Mount - Suburban
	073743-01-000	EA	Shroud Asm. - Ceiling - Inside - Roof Air Cool Only - 13,500 BTU - Coleman
	073744-01-000	EA	Shroud Asm. - Ceiling - Inside - Roof Air Heat and Cool - 13,500 BTU - Coleman
	073742-01-000	EA	Air Conditioner - 110 Volt - Roof Mount - 13,500 BTU Rotary

**AUTOMOTIVE HEATER AND AIR CONDITIONER**

Key	Part Number	U/M	Description
	074025-01-000	EA	A/C - Compressor Mount Package - 350 C.I.D
	072343-01-000	EA	A/C - Compressor Clutch - Sankyo 510
	073716-01-000	EA	A/C - Condenser Asm. - "C" - Tube O
	074027-01-000	EA	A/C - Evaporator Asm. - Cutaway
	056779-01-000	EA	A/C - Clutch - 7" Drive
	031376-01-000	EA	Control Asm - Heater - 3 Speed
	055279-01-000	EA	Control Asm - Heater A/C - 3 Speed
	055280-01-000	EA	Switch - Fan - 3 Speed - Control Asm. - Heater & A/C
	007076-01-700	FT	Hose - Flexible PVC - 2" I D
	007108-01-000	FT	Hose - Heater - 5/8" I.D. SAE 20R3
	007281-01-700	FT	Hose - Flexible PVC - 2 1/2" I D
	062401-04-000	EA	Clamp - Worm Drive - 69" - 1 25" I D.
	033258-01-000	EA	Hose - Refrigerant - .50" I D x 34 50"
	031960-01-000	EA	Hose - Refrigerant - 3/4" I D x 30"
	031961-02-000	EA	Hose - Refrigerant - 3/8" I D x 19"
	049401-01-000	EA	Heater Asm - Rear - Auxiliary
	049401-01-700	EA	Valve - Water Control (Aux Heater)
	049401-01-701	EA	Control Cable (Aux Heater)
	040401-01-702	EA	Motor Asm (Aux Heater)
	049401-01-703	EA	Heater Core (Aux Heater)
	049401-01-704	EA	Switch (Aux Heater)
	058905-02-000	EA	Control Panel - Beige - (Auxiliary Rear Heater)
	058906-01-000	EA	Control Panel - Brown (Auxiliary Rear Heater)

**1983 ITASCA  
TABLE OF CONTENTS**

IC420RG	A-1 - B-22
IC424RB	B-23 - E-4
ICF26RB	E-5 - G-12
ICN33RU	G-13 - I-20

**1983 IC424RB INDEX**

Floor Plan	B-23 - B-24
Accessories Group	C-1 - C-3
Bath Group	C-4 - C-5
Chassis Group	C-6 - C-7
Curtain, Cushion & Pad Group	C-8 - C-14
Dinette Group	C-15
Driver's Compartment Group	C-16 - C-17
Electrical Group	C-18 - C-20
Exterior Body Group	C-21 - D-3
Galley Group	D-4 - D-5
Heating & Air Conditioning Group	D-6
Interior Finish Group	D-7 - D-9
LP Group	D-10
Lounge Group	D-11
Water & Sewage Group	D-12 - D-13
Window, Vent & Exterior Door Group	D-14 - E-4



## INTERIOR FINISH GROUP

### PANELING AND COUNTERTOP MATERIALS

Key	Part Number	U/M	Description
	068344-04-000	SF	Paneling - Birch - 48" x 84" (28 SF) (Wall)
	045963-01-000	SF	Paneling - 825 Buff - 48" x 96" (32 SF) (Ceiling)
	072336-10-000	SF	Paneling - Decor - French Glory - 48" x 84" (28 SF) (Galley) (P34)
	072336-09-000	SF	Paneling - Decor - French Glory - 48" x 84" (28 SF) (Galley) (P35, P36)
	072336-06-000	SF	Paneling - Decor - Willows - 48" x 84" (28 SF) (Bath)
	057880-04-000	SF	Pluswood Board - Birch (Door Asm.)
	057880-03-000	SF	Pluswood Board - Wicker Weave/Lakarti Burlap (Headboard Asm.)
	069731-02-000	SF	Plastic Laminate - Almond - 48" x 96" (32 SF) (Galley)
	069731-02-019	EA	Plastic Laminate - Almond - 1.19" x 96"
	072337-02-000	SF	Plastic Laminate - Travertine - 48" x 96" (32 SF) (Bath)
	072337-02-019	EA	Plastic Laminate - Travertine - 1.19" x 96"

### INTERIOR MOLDINGS AND TRIMS

Key	Part Number	U/M	Description
	024700-17-000	EA	Cover - Sidewall Roll Bar - Beige
	042430-01-000	EA	Molding - Shelf - Wood
	009812-10-000	FT	Molding - Outside Corner - 50" - Birch
	009812-08-000	FT	Molding - Outside Corner - 50" - Teak
	009809-10-000	FT	Molding - Outside - 1" - Birch
	009767-05-000	FT	Welting - Light Brown
	009767-06-000	FT	Welting - Beige
	009815-03-000	FT	T-Molding - .75" - Light Brown
	022992-01-000	FT	Molding - Reverse Cove - White
	022992-08-000	FT	Molding - Reverse Cove - Champagne White
	070504-01-000	FT	U-Channel - .065" - Light Brown
	070504-02-000	FT	U-Channel - .815" - Light Brown
	009778-03-000	FT	U-Channel - 1" - Light Brown
	009779-03-000	FT	U-Channel - 1.125" - Light Brown
	072872-01-000	YD	Trim - Drapery - Jute/Beige
	052859-01-P01	FT	Trim Asm - Accent - Almond Vinyl (Beige)
	059352-01-000	FT	Insert - Vinyl - Style and Rail Door
	072389-03-000	FT	Mesh - Expanded Alum. - 17.9" x 6.7" - Gold
	047354-01-000	EA	Batt Strip - 825 Buff - 1/2" (Ceiling)
	064386-01-000	EA	Batt Strip - Birch - 8" (Wall)
	069733-22-000	EA	Batt Strip - French Glory - 8" (Galley) (P34)
	069733-21-000	EA	Batt Strip - French Glory - 8" (Galley) (P35 P36)
	069733-18-000	EA	Batt Strip - Willow - 1" (Bath)
	064382-01-000	FT	Extrusion - Plastic Trim - Rolled Door
	042356-01-000	EA	Plug - Button - Mahogany - 3/8" Diameter

## INTERIOR FINISH GROUP (CONTINUED)

### FABRICS AND CARPET

Key	Part Number	U/M	Description
	072333-02-000	YD	Fabric - Drapery - Ivory (Sheers)
	072333-06-000	YD	Fabric - Drapery - Ecru
	072334-31-000	YD	Fabric - Upholstery/Accent - Blue Smoke (P34)
	072334-32-000	YD	Fabric - Upholstery/Accent - Saddle (P35)
	072334-30-000	YD	Fabric - Upholstery/Accent - Mulberry (P36)
	072334-34-000	YD	Fabric w/Pattern - Upholstery - Blue (P34)
	072334-35-000	YD	Fabric w/Pattern - Upholstery - Brown (P35)
	072334-33-000	YD	Fabric w/Pattern - Upholstery - Burgundy (P36)
	069729-01-000	YD	Fabric - Bedspread - Pumice 16 - (P01)
	069729-02-000	YD	Fabric - Bedspread - Wedgewood (P34)
	069729-03-000	YD	Fabric - Bedspread - Raisin (P35)
	069729-04-000	YD	Fabric - Bedspread - Sandalwood (P36)
	038421-01-000	YD	Fabric - Mattress Ticking
	070502-01-000	YD	Vinyl - Non-Expanded - 12 Gauge Film - Medium Almond (Beige)
	072860-04-000	SY	Carpet - Steel Blue (P34)
	072860-03-000	SY	Carpet - Special Brown (P35)
	068340-05-000	SY	Carpet - Winesap (Burgundy) (P36)

### CURTAIN HARDWARE

Key	Part Number	U/M	Description
	052327-05-009	EA	Track - Curtain - Beige Alum. - 76" w/Holes
	056116-01-000	EA	Track - Curtain - Brown Plastic
	053272-04-209	EA	Track - Curtain - 89" - Off White
	018031-48-000	EA	Track - Curtain - "L" Rod - Alum. Extr. - 192"
	056001-01-000	EA	Bracket - Shade - Left
	056002-01-000	EA	Bracket - Shade - Right
	056003-01-000	EA	Bracket - Drapery Retainer - Right
	056003-02-000	EA	Bracket - Drapery Retainer - Left
	056003-03-000	EA	Bracket - Drapery Retainer - Universal
	009107-01-000	EA	Guide - Nylon Snap - Curtain
	056784-01-000	EA	Pull - Window Shade - Antique Brass
	039175-01-000	EA	Curtain Rod - Ext. 48" - 84"
	039175-03-000	EA	Curtain Rod - Ext. 28" - 48"
	039175-04-000	EA	Curtain Rod - Ext. 16" - 28"
	039175-02-000	EA	Bracket - Curtain Rod
	056115-01-000	YD	Tape - Clear Plastic - w/Guides
	048394-01-000	YD	Tape Hook - 1" x 25 YD - Beige
	048395-01-000	YD	Tape Loop - 1" x 25 YD - Beige

### MISCELLANEOUS PARTS

Key	Part Number	U/M	Description
	053552-01-P01	EA	Handle Asm. - Interior Assist - Medium Almond Vinyl
	041944-03-000	EA	Fire Extinguisher - w/Bracket - 5BC
	054185-19-000	EA	Owner's Manual - 1983 Itasca & Winnebago
	040069-01-000	EA	Door Mat - Black Rubber - 10 1/2" x 26"

## 1983 ITASCA TABLE OF CONTENTS

IC420RG	A-1 - B-22
IC424RB	B-23 - E-4
ICF26RB	E-5 - G-12
ICN33RU	G-13 - I-20

## 1983 IC424RB INDEX

Floor Plan	B-23 - B-24
Accessories Group	C-1 - C-3
Bath Group	C-4 - C-5
Chassis Group	C-6 - C-7
Curtain, Cushion & Pad Group	C-8 - C-14
Dinette Group	C-15
Driver's Compartment Group	C-16 - C-17
Electrical Group	C-18 - C-20
Exterior Body Group	C-21 - D-3
Galley Group	D-4 - D-5
Heating & Air Conditioning Group	D-6
Interior Finish Group	D-7 - D-9
LP Group	D-10
Lounge Group	D-11
Water & Sewage Group	D-12 - D-13
Window, Vent & Exterior Door Group	D-14 - E-4

INTERIOR FINISH GROUP (CONTINUED)

CABINETRY AND TABLE HARDWARE

Key	Part Number	U/M	Description
	053200-05-000	EA	Bracket - Upper Wall Mount - Beige - 23.5"
**	053201-03-000	EA	Bracket - Table Mount - 23"
	024275-05-000	EA	Rod - Table Lift - 8" x 23.5" - Beige
	024281-07-000	EA	Bracket - Lower Wall Mount - Beige - 22.12"
	024276-06-000	EA	Leg Asm. - Table - Beige - 29.5"
	064050-01-000	EA	Hinge - Table Leg
	024282-01-000	EA	Brace - Table Leg
**	024283-01-000	EA	Clip - 1" O.D. Tube
**	049493-03-000	EA	Catch - Table Leg - Mounts on Floor - Beige
**	057898-01-000	EA	Latch - Hidden - Cabinet Door
**	057898-02-000	EA	Strike - Hidden Latch - Cabinet Door
	009112-01-000	EA	Flange - 1" - Chrome - Closet Rod
	072394-01-000	EA	Slide - Drawer - w/Tab - 20.75"
	072394-02-000	EA	Slide - Drawer - w/o Tab - 20.75"
	077409-01-000	EA	Slide - Drawer - Plastic - 20.75"
	009049-01-000	EA	Table Support - Drop Leaf
	009059-01-000	EA	Hinge - 2" - Gold
**	037688-01-000	FT	Rail - Drawer - V Guide
**	047744-01-000	EA	Kit - Drawer Glide
	057671-01-000	EA	Screw Cover - #8 - Off White
	072369-03-000	EA	Mesh - Grille - Brass - 17.9" x 6.7
	009040-02-000	EA	Leg - Pedestal Table - 27.5" x 2.25" O.D. - Chrome
	009040-03-000	EA	Base - Table Leg - Mounts on Table
	041194-01-000	EA	Base - Table Leg - Mounts in Floor
	062046-01-000	EA	Clip - Leg Pedestal
	058335-02-000	EA	Latch - Bathroom Door w/o Lock
	009050-01-000	EA	Warp Guard - 64"
	009051-01-000	EA	Warp Guard - 48"
	009021-01-000	EA	Catch - Nylon - Furnace Door
	009021-02-000	EA	Strike - Nylon Catch - Furnace Door
**	052932-01-M10	EA	Hinge Kit - Cabinet Door - Antique Brass
**	041939-01-000	EA	Hinge Kit - Double Acting - Overhead Door
**	The illustrated parts breakdown for this item is provided on the Common Items Fiche.		

LP GROUP

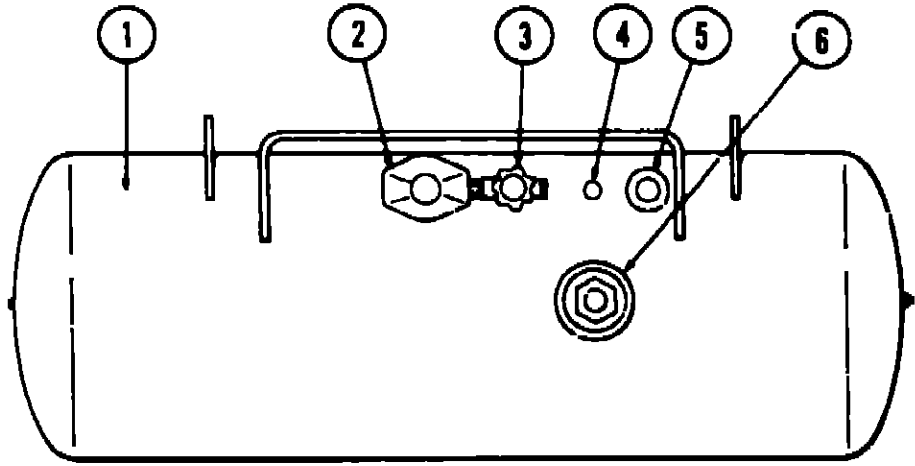

1983 ITASCA  
TABLE OF CONTENTS

IC420RG	A-1 - B-22
IC424RB	B-23 - E-4
ICF26RB	E-5 - G-12
ICN33RU	G-13 - I-20

Key	Part Number	U/M	Description
	074143-02-000	EA	Tank Asm. - LP - Frame Mount - 85 Pound - 14" x 40"
1	074142-01-000	EA	Tank Asm. - LP - Frame Mount - 80 Pound - 13" x 44"
1	074141-01-000	EA	Tank Asm. - LP - Frame Mount - 42 Pound - 12" x 28"
*	065741-01-000	EA	Detector - LP Gas Leak - Marshalltown Instruments
2	058706-01-000	EA	Cover - Regulator - Two Stage
*	058705-01-000	EA	Regulator - Two Stage - LP Gas
3	040421-01-703	EA	Valve - Vapor Relief
4	040421-01-700	EA	Gauge - Liquid Level - 20% LP
5	040421-01-701	EA	Valve - Filler - LP
*	040421-01-702	EA	Cap - Plastic Fill Valve
6	040421-01-707	EA	Gauge - Float - w/Visible Dial
*	040421-01-706	EA	Dial - Visible Face - Float Gauge (Tank w/o Electric Transmitter)
*	040440-01-000	EA	Dial - Transmitter - 0 - 90 Ohm (Float Gauge)
*	045703-01-000	EA	Hose Asm. - LP - 3/8" I.D. x 24" - US
*	045703-02-000	EA	Hose Asm. - LP - 3/8" I.D. x 24" - CSA
*	045703-03-000	EA	Hose Asm. - LP - 3/8" I.D. x 18" - US
*	045703-04-000	EA	Hose Asm. - LP - 3/8" I.D. x 14" - CSA
*	047737-02-000	EA	Support - LP Tank - 89.25"
*	047737-03-000	EA	Support - LP Tank - 30.50"
*	053112-02-000	EA	Bracket - LP Support
*	068046-01-000	EA	Conversion Kit - LP - Onan Generator
*	Not illustrated		

WINN AIR WITH LANDI-HARTOG (C-BODY)

Key	Part Number	U/M	Description
	065287-02-000	EA	Valve - Gasoline Shut-Off
	068050-07-000	EA	LP Mixer (350 Engine)
	065802-01-000	EA	Gauge - LP Level w/Hardware
	068050-05-000	EA	Switch - LP/Gas Changeover
	068050-01-000	EA	Converter - LP
	068050-02-000	EA	LP Lock Off
	068050-03-000	EA	Switch - LP - Vacuum Safety

1983 IC424RB INDEX

Floor Plan	B-23 - B-24
Accessories Group	C-1 - C-3
Bath Group	C-4 - C-5
Chassis Group	C-6 - C-7
Curtain, Cushion & Pad Group	C-8 - C-14
Dinette Group	C-15
Driver's Compartment Group	C-16 - C-17
Electrical Group	C-18 - C-20
Exterior Body Group	C-21 - D-3
Galley Group	D-4 - D-5
Heating & Air Conditioning Group	D-6
Interior Finish Group	D-7 - D-9
LP Group	D-10
Lounge Group	D-11
Water & Sewage Group	D-12 - D-13
Window, Vent & Exterior Door Group	D-14 - E-4

## LOUNGE GROUP

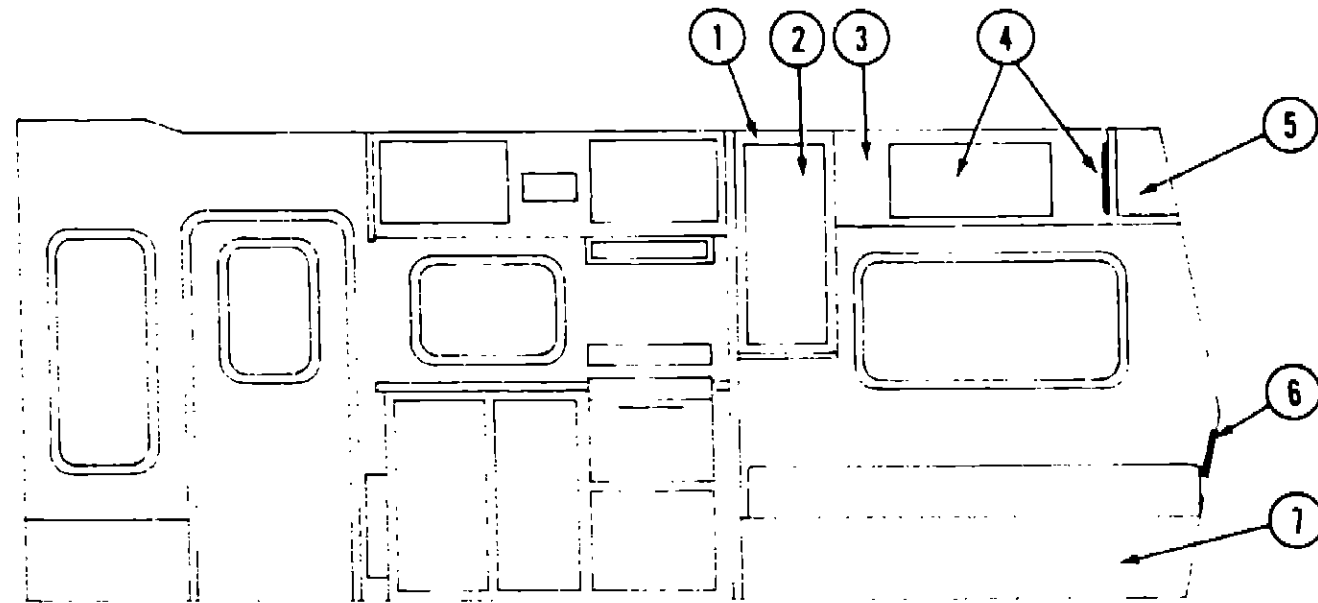

### DOUBLE BED AND SIDE BUNKS

Key	Part Number	U/M	Description
1	M75051-01-P01	EA	Cabinet Asm. - Overhead Shirt Closet - w/o Doors or Hardware
2	069852-40-P01	EA	Door Asm. - Shirt Closet - 14.3" x 33.4" - w/o Hardware
3	071847-10-P01	EA	Pad Asm. - End Cap - Shirt Closet - Vinyl
4	075061-01-P01	EA	Cabinet Asm. - Overhead Rear Right - w/o Doors or Hardware
5	069852-05-P01	EA	Door Asm. - Overhead Cabinet - 11.5" x 28.2" - w/o Hardware
6	075057-01-P01	EA	Cabinet Asm. - Overhead Rear - w/o Doors or Hardware
7	072969-01-P01	EA	Headboard Asm. - Double Bed
8	M75062-01-P01	EA	Cabinet Asm. - Double Bed - Bottom - w/o Door or Hardware
9	M01280-01-P01	EA	Cabinet Asm. - Double Bed Top
10	069852-59-P01	EA	Door Asm. - Double Bed - 19.8" x 10.7" - w/o Hardware
11	075063-01-P01	EA	Cabinet Asm. - Side Bunk Base
12	M73124-01-P01	EA	Cabinet Asm. - Nightstand - w/o Countertop (Bunk House)
13	M00972-01-P01	EA	Countertop Asm. - Nightstand Cabinet - Almond
14	M70621-07-P01	EA	Drawer Asm. - Nightstand Cabinet - 15" x 20.2" - w/o Hardware
15	Not illustrated		

## WATER AND SEWAGE GROUP

### PLUMBING AND REPAIR PARTS

Key	Part Number	U/M	Description
	045729-01-000	EA	Pump - Water - 2.8 G.P.M. - Direct Drive - Shurflo - US
	045729-02-000	EA	Pump - Water - 2.8 G.P.M. - Direct Drive - Shurflo - CSA
	039647-02-000	EA	Filter - Water Pump - 1/2" MPT
	039647-03-000	EA	Filter - Water Pump - 1/2" Flare
	052959-02-000	EA	Connector - Plastic - 1/2 F x 1/2 MPT
	052959-03-000	EA	Connector - 1/2 F x 3/8 MPT - Plastic
	052960-01-000	EA	Drain Valve - 1/2 F x 1/2 F - Plastic
	052961-01-000	EA	Header - 1/2 F x 1/2 F x 1/2 F x 1/2 F
**	046524-02-000	EA	Kit - Water Tank Fittings - Blank Tank
**	046524-01-000	EA	Kit - Holding Tank Fittings - Blank Tank
**	010079-01-000	EA	Tee - Plastic - 1 1/2 H x 1 1/2 H x 1 1/4 H
**	010121-01-000	EA	Bushing - Plastic - 1 1/2 S x 1 1/4 H
**	010133-01-000	EA	Trap Adapter - Plastic - 1 1/2 H x MPT
	052954-01-000	EA	Adapter - Nose Cone - 3/8 or 1/2 - Plastic
**	010201-01-000	EA	Sewer Hose - 3" x 8' w/Clamp
**	050780-01-000	EA	Coupler Rubber - 3" x 3"
	062415-01-000	EA	Cap - Sewer - 3"
	062416-01-000	EA	Hose Adapter - 3"
	062417-01-000	EA	Adapter - Termination - 3"
	062418-02-000	EA	Valve - 3" - w/o Handle
	062419-02-000	EA	Handle - Extension - w/6" Adapter
	062421-01-000	EA	Valve - 1 1/2" - w/Handle
**	011066-01-000	EA	P-Trap - 1 1/4" - Plastic
	010071-01-000	EA	Tee - Plastic - 1 1/2" x H x H x H
	010072-01-000	EA	Tee - Plastic - 1 1/2" H x 1 1/4 H x 1 1/2 H
	046172-01-000	EA	Tee - Plastic - 3/8 B x 3/8 B x 3/8 MPT
	052955-01-000	EA	Tee - Plastic - 1/2 F x 1/2 F x 1/2 MPT
	052956-01-000	EA	Tee - Plastic - 1/2 F x 1/2 MPT x 1/2 F
	052958-01-000	EA	Tee - Plastic - 1/2 F x 1/2 F x 1/2 F
**	053335-01-000	EA	P-Trap - Plastic - 1 1/4 H x H - w/Union
**	011091-01-000	EA	Waste - Continuous - Double Sink - 11 7/8"
	061607-01-000	EA	Grommet - Holding Tank Coupler - 1 1/2"
	061607-02-000	EA	Grommet - Holding Tank Coupler - 3"
	071015-14-000	EA	Grommet - .38" I.D. x .125" O.D.
	010000-01-000	EA	Elbow - Plastic - 1/8 BD x 1 1/4 x 45° H x H
	010006-01-000	EA	Elbow - Plastic - 1/8 BD x 1 1/2 x 45° H x H
	010008-01-000	EA	Elbow - Plastic - 1/4 BD x 1 1/2 x 90° Left
	010051-01-000	EA	Elbow - ST - Plastic - 1/8 BD x 1 1/2 x 45°
	010219-01-000	EA	Elbow - 1 1/4 Barb x 1 1/4 MPT x 90°
	031111-01-000	EA	Elbow - Plastic - 1/4 BD x 1 1/4 x 90° Left
	034250-01-000	EA	Elbow - Plastic - 1/4 BD x 1 1/2 x 90° x H x H
	035539-01-000	EA	Elbow - Plastic - 3/8 MPT x 3/8 Barb
	052957-01-000	EA	Elbow - Plastic - 1/2 F x 3/8 MPT
	052957-02-000	EA	Elbow - Plastic - 1/2 F x 1/2 MPT
	059536-01-000	EA	Elbow - 1 1/4 - Slip Joint Ends
	065120-01-000	EA	Elbow - Plastic - Swivel - .50"
	070924-01-000	EA	Elbow - Plastic - Swivel - 1/2 MPT x 1/2 FP
	010123-01-000	EA	Bushing - Plastic - 2S x 1 1/2 H
	031602-02-000	EA	Adapter - Plastic - 1 1/2 H x FPT
	033302-02-000	EA	Adapter Asm. - SWVC Strain - 1 1/2
	072346-01-000	EA	Valve Asm. - 3" Ell - w/2" Socket
	039800-01-000	FT	Tubing - Polybutyl - 1/2 O.D. (Water Line)
	014928-01-000	FT	Flexible Tubing - 1 1/4 I.D.
	004020-01-000	QT	Adhesive - ABS Cement
	037845-01-000	FT	Tape - Butyl - 3/16" Bead - Black
	062422-01-000	EA	Adapter - Hose Offset - Reducer - 3" x 1 1/2"
	052962-01-000	EA	Valve - Stool - 90° x 1/2 F x 3/8 MPT
	010147-01-000	EA	Flange - Closet - 4" F x 3" FPT
	010224-01-000	EA	Adapter - Plastic - 3/8 MPT x 3/8 Barb

## 1983 ITASCA TABLE OF CONTENTS

IC420RG	A-1 - B-22
IC424RB	B-23 - E-4
ICF26RB	E-5 - G-12
ICN33RU	G-13 - I-20

## 1983 IC424RB INDEX

Floor Plan	B-23 - B-24
Accessories Group	C-1 - C-3
Bath Group	C-4 - C-5
Chassis Group	C-6 - C-7
Curtain, Cushion & Pad Group	C-8 - C-14
Dinette Group	C-15
Driver's Compartment Group	C-16 - C-17
Electrical Group	C-18 - C-20
Exterior Body Group	C-21 - D-3
Galley Group	D-4 - D-5
Heating & Air Conditioning Group	D-6
Interior Finish Group	D-7 - D-9
LP Group	D-10
Lounge Group	D-11
Water & Sewage Group	D-12 - D-13
Window, Vent & Exterior Door Group	D-14 - E-4

WATER & SEWAGE GROUP (CONTINUED)

PLUMBING AND REPAIR PARTS (CONT.)

Key	Part Number	U/M	Description
	007108-01-000	EA	Hose - Heater - 5/8"
	010194-01-000	FT	Pipe - Black - Plastic - 1.25" - ABS
	010195-01-000	FT	Pipe - Black - Plastic - 1.5" - ABS
	010197-01-000	FT	Pipe - Black - 3" - ABS
**	039818-01-000	EA	Riser Asm. - 3/8" O.D. x 24" Tube
**	039818-04-000	EA	Riser Asm. - 3/8" O.D. x 72" Tube
**	039818-05-000	EA	Riser Asm. - 3/8" O.D. x 48" Tube
	071292-01-000	EA	Regulator - Water Pressure
**	The illustrated parts breakdown for this item is provided on the Common Items Fiche.		

HOLDING TANKS AND WATER HEATERS

Key	Part Number	U/M	Description
	M01275-01-000	EA	Tank Asm. - Water - 16 Gallon - w/Fittings
	074510-01-000	EA	Tank - Water - 16 Gallon - w/o Fittings
	M01275-02-000	EA	Tank Asm. - Water - 20 Gallon - w/Fittings
	053520-01-000	EA	Tank - Water - 20 Gallon - w/o Fittings
	074861-01-000	EA	Tank - Waste Water - 35 Gallon - w/o Fittings
	074870-01-000	EA	Tank - Sewage - 30 Gallon - w/o Fittings
**	051391-01-000	EA	Water Heater - w/o Motor Aid - G6A-3
**	051393-01-000	EA	Water Heater - w/Motor Aid - GH6-3E
**	The illustrated parts breakdown for this item is provided on the Common Items Fiche.		

WINDOW, VENT & EXTERIOR DOOR GROUP

ACCESS DOOR

Key	Part Number	U/M	Description
	047233-02-000	EA	Door Asm. - Luggage - 13.5" x 35.5" - Off White - w/Key Lock
	052009-01-000	EA	Door Asm. - Water Heater - Off White
	069762-02-000	EA	Door Asm. - Refrigerator Access - Off White - w/Twist Type Lock
	M00685-07-000	EA	Door Asm. - Generator - 13.5" x 35.5" - Off White - w/o Baffle
	033333-62-000	EA	Door Asm. - Access - 21.7" x 9" - Off White
	033333-61-000	EA	Door Asm. - LP - 25.3" x 9" - Off White - w/Twist Lock
	052423-01-000	EA	Door - Fuel Fill - Off White
	052424-01-000	EA	Jamb - Power Cord/Fuel Fill Door - Off White
	063742-01-000	EA	Door - Power Cord - Off White
	054543-01-000	EA	Hatch - Power Cord Door
	042441-01-000	EA	Lock Asm. - Key Type - Gas Fill
	052950-03-700	EA	Lock Asm. - Twist Type - Straight Cam (Power Cord Door)
	047305-01-000	EA	Lock Asm. - Key Type w/Clip - Metal - (Luggage)
	052950-01-700	EA	Lock Asm. - Twist Type w/Clip - White Plastic
	009003-01-000	EA	Lock Asm. - Twist Type - w/Clip (LP Door)
	009118-01-000	EA	Lock - Twist - w/Nut
	052951-01-000	EA	Clip - Twist - Lock Retainer
	052181-01-000	EA	Baffle - Generator Door
	054530-01-000	EA	Door Holder

VENTS

Key	Part Number	U/M	Description
	065103-02-000	EA	Cover - Refrigerator Vent - 9.88" x 20.5" - Plastic
	065103-01-000	EA	Frame Asm. - Refrigerator Vent - 8.17" x 22.94" - Plastic
	071290-02-000	EA	Cover - Refrigerator Vent - 11 5/8" x 24 3/4" - Galvanized Steel
	071290-01-000	EA	Frame Asm. - Refrigerator Vent - 7.5" x 26.5" - Galvanized Steel
	049252-01-000	EA	Vent - Stovehood - Outside - Off White
**	046789-01-000	EA	Vent Asm. - Roof - Powered - w/o Screen - Alum.
**	048835-01-000	EA	Vent Asm. - Roof - Non Powered - w/o Screen - Alum.
	064469-02-000	EA	Vent Asm. - Roof - Powered - w/o Screen - 14" x 14" - CSA
	054535-01-000	EA	Vent - Mechanical Trap Arm
**	The illustrated parts breakdown for this item is provided on the Common Items Fiche.		

1983 ITASCA  
TABLE OF CONTENTS

IC420RG	A-1 - B-22
IC424RB	B-23 - E-4
ICF26RB	E-5 - G-12
ICN33RU	G-12 - I-20

1983 IC424RB INDEX

Floor Plan	B-23 - B-24
Accessories Group	C-1 - C-3
Bath Group	C-4 - C-5
Chassis Group	C-6 - C-7
Curtain, Cushion & Pad Group	C-8 - C-14
Dinette Group	C-15
Driver's Compartment Group	C-16 - C-17
Electrical Group	C-18 - C-20
Exterior Body Group	C-21 - D-3
Galley Group	D-4 - D-5
Heating & Air Conditioning Group	D-6
Interior Finish Group	D-7 - D-9
LP Group	D-10
Lounge Group	D-11
Water & Sewage Group	D-12 - D-13
Window, Vent & Exterior Door Group	D-14 - E-4

# WINDOW, VENT & EXTERIOR DOOR GROUP (CONTINUED)

## WINDOWS AND ACCESS DOORS

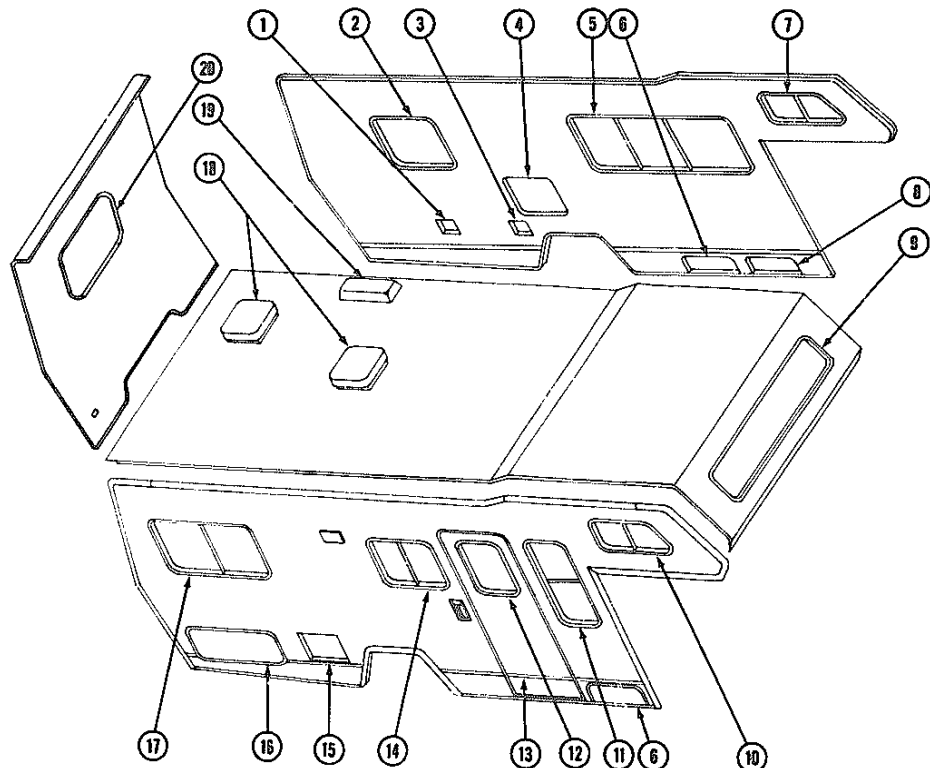

Key	Part Number	U/M	Description
1	NOTE		
2	042959-03-000	EA	Door Asm. - Fuel Fill (See Access Doors)
3	NOTE		
4	069762-02-000	EA	Door Asm. - Power Cord (See Access Doors)
5	066785-03-000	EA	Door Asm. - Refrigerator Access - Off White - w/Twist Lock
6	033333-62-000	EA	Window Asm. - Single Slider - 25" x 65" - Black (w/o inside frame)
7	048632-04-000	EA	Door Asm. - Access - 9" x 21.7" - Off White
8	033333-61-000	EA	Window Asm. - Bunk - Slanted Slider - Left - Black (w/o inside frame)
9	041936-01-000	EA	Door Asm. - LP - 25.3" x 9" - Off White - w/Twist Lock
10	048632-03-000	EA	Window Asm. - Front Picture - 14" x 69" - Black (w/o inside frame)
11	074348-01-000	EA	Window Asm. - Bunk - Slanted Slider - Right - Black (w/o inside frame)
12	041875-09-000	EA	Window Asm. - Vertical Slider - Black (w/o inside frame)
13	M71136-13-000	EA	Window Asm. - Picture - 17" x 25" - Black (w/o inside frame)
14	048631-03-000	EA	Door Asm. - Radius Entry w/Screen Door
			Window Asm. - Right Single Slider - 20" x 25" - Black

D-15

Key	Part Number	U/M	Description
15	052009-01-000	EA	Door Asm. - Water Heater - Off White
16	047233-02-000	EA	Door Asm. - Luggage - 13.5" x 35.5" - Off White - w/Key Lock
16	M00885-07-000	EA	Door Asm. - Generator 13.5" x 35.5" - Off White - w/o Baffle
17	048631-19-000	EA	Window Asm. - Right Single Slider - 25" x 44" - Black (w/o inside frame)
**	045556-06-000	EA	Window Asm. - Right Single Slider - 15" x 37" - Black (w/o inside frame)
18	048835-01-000	EA	Vent Asm. - Roof - Non Powered - w/o Screen - Alum.
18	048789-01-000	EA	Vent Asm. - Roof - Powered - w/o Screen - Alum.
18	064469-02-000	EA	Vent Asm. - Roof - Powered - w/o Screen - 14" x 14" - CSA
19	071290-02-000	EA	Cover - Refrigerator Vent - 11 5/8" x 24 3/4" - Galvanized Steel
20	071290-01-000	EA	Frame Asm. - Refrigerator Vent - 7.5" x 26.5" - Galvanized Steel
20	020751-03-000	EA	Window Asm. - Rear Escape - 23" x 29" - Black (w/o inside frame)
**	041875-02-000	EA	Window Asm. - Picture - 13" x 23" - Black (w/o inside frame)
*	Not Illustrated		
**	Parts for bunkhouse option (Not illustrated)		

D-16

## 1983 ITASCA TABLE OF CONTENTS

IC420RG  
IC424RB  
ICF26RB  
ICN33RU

A-1 - B-22  
B-23 - E-4  
E-5 - G-12  
G-13 - I-20

## 1983 IC424RB INDEX

Floor Plan	B-23 - B-24
Accessories Group	C-1 - C-3
Bath Group	C-4 - C-5
Chassis Group	C-6 - C-7
Curtain, Cushion & Pad Group	C-8 - C-14
Dinette Group	C-15
Driver's Compartment Group	C-16 - C-17
Electrical Group	C-18 - C-20
Exterior Body Group	C-21 - D-3
Galley Group	D-4 - D-5
Heating & Air Conditioning Group	D-6
Interior Finish Group	D-7 - D-9
LP Group	D-10
Lounge Group	D-11
Water & Sewage Group	D-12 - D-13
Window, Vent & Exterior Door Group	D-14 - E-4

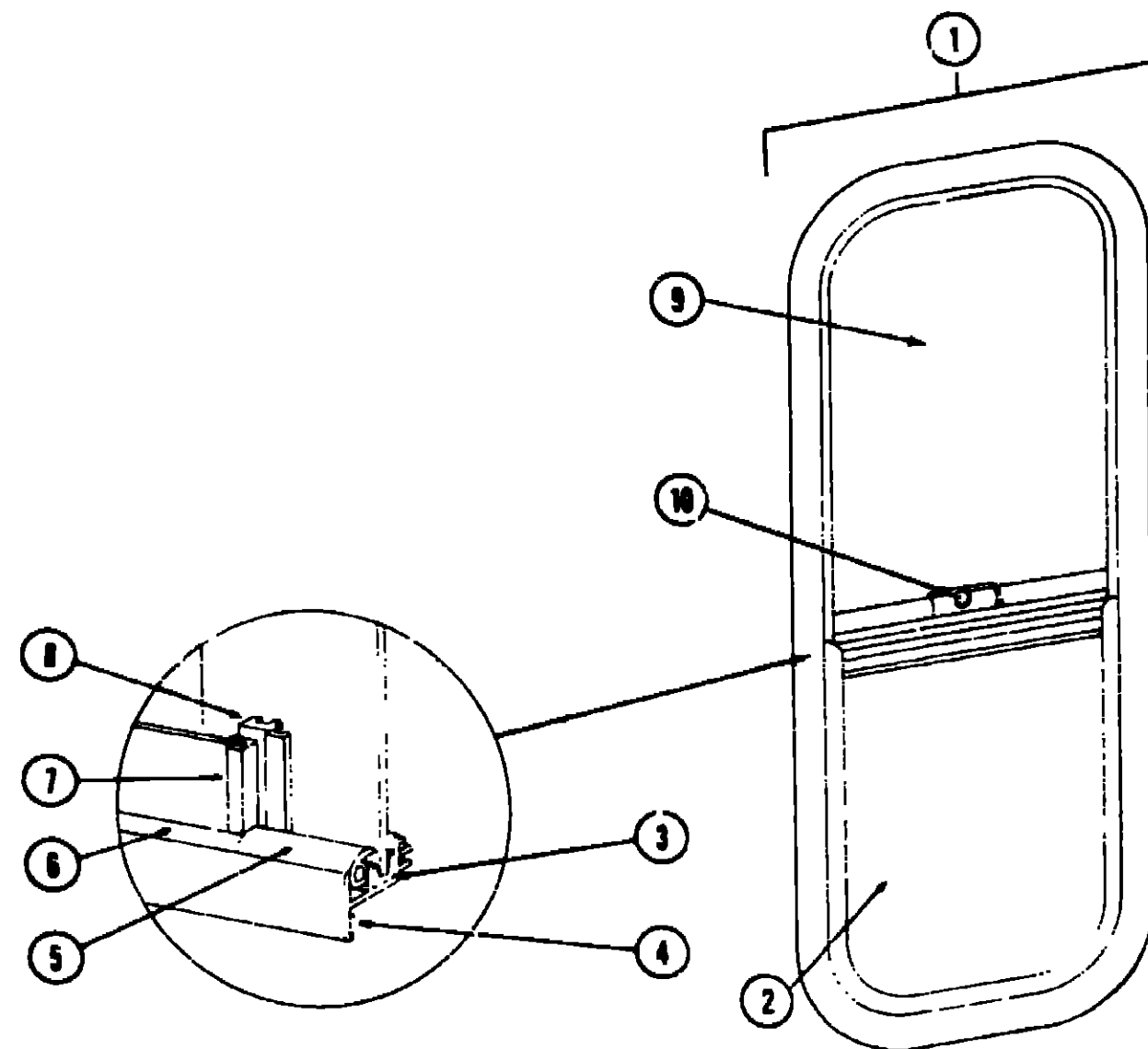

Key	Part Number	U/M	Description
1	074348-01-000	EA	Window Asm - Vertical Slider - Black (w/o inside frame)
2	067609-10-000	EA	Inside Frame - Beige (not included in assembly)
3	002208-02-000	EA	Glass - Sliding - 1/8" x 14.4" x 19"
4	002324-02-000	FT	Channel - Weatherstrip - Glass
5	069640-01-000	FT	Tape - 1/4" Bead x 20' - Gray - 3M
6	057374-02-000	FT	Extr. Vinyl - Window Seal - Black
7	002309-02-000	FT	Spline - Glass - 1/8" Material - Black
8	M69886-03-007	EA	Seal Holder w/Fin Seal - 13.60"
9	069896-06-000	EA	Mullion - Slider Window - Black
10	048324-02-000	EA	Glass - Stationary - 1/8" x 14.4" x 19"
1	047369-01-700	EA	Latch - Window - Plastic w/Fastener
2	002291-01-000	SF	Screen - Window - 16" - Gray
3	002299-01-000	FT	Spline - .130" Dia. - Gray (Screen)
4	073740-01-000	FT	Seal - Fin - Pile - .460"
5	Not illustrated		

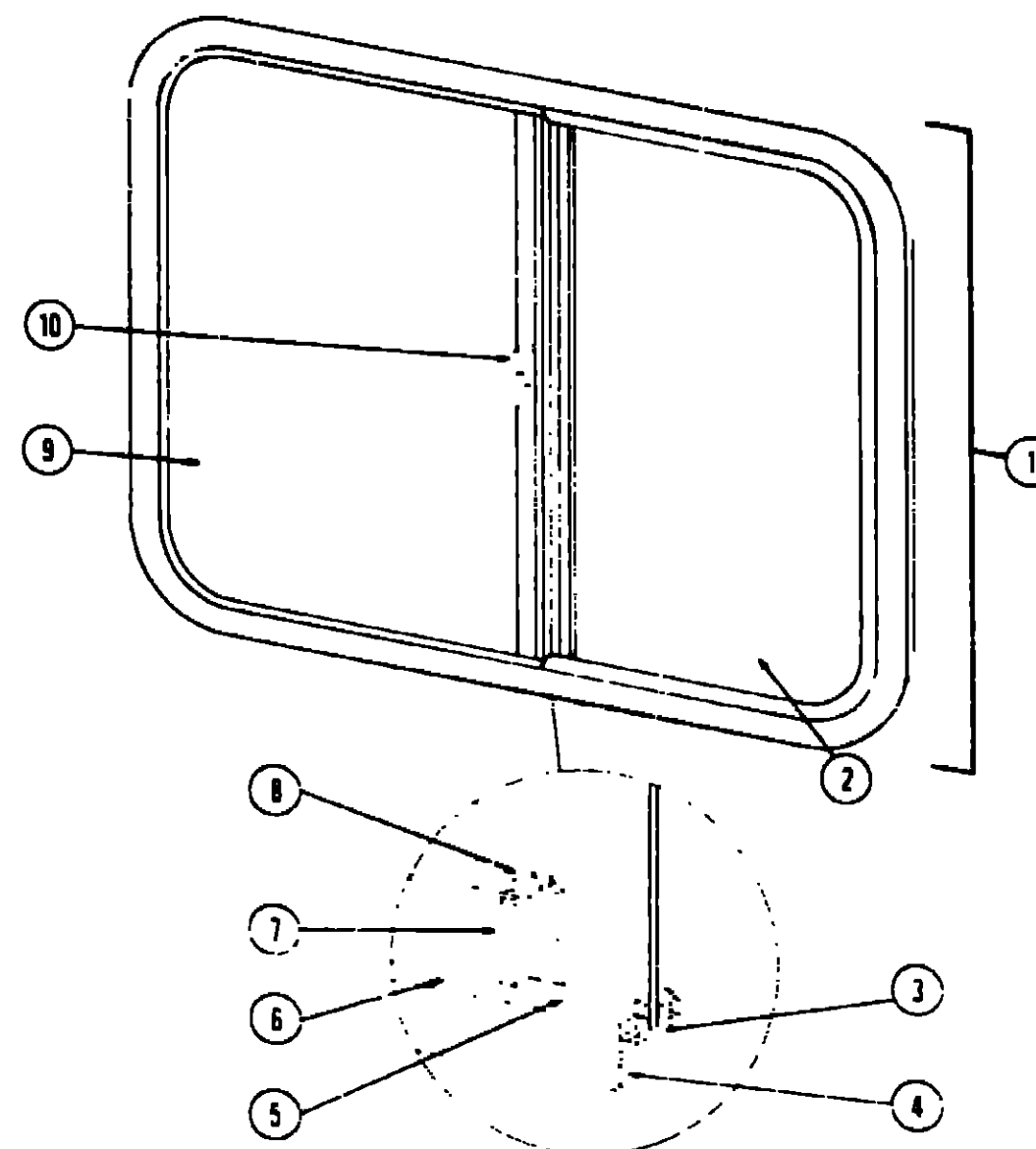

Key	Part Number	U/M	Description
1	048631-03-000	EA	Window Asm. - Right Single Slider - 20" x 25" - Black (w/o inside frame)
2	042147-12-000	EA	Inside Frame - Beige (not included in assembly)
3	047820-01-000	EA	Glass - Sliding w/Hole 1/8" x 13.68" x 19"
4	041894-12-000	EA	Mullion - Slider Window - Black
5	002324-02-000	FT	Channel - Weatherstrip - Glass
6	069640-01-000	FT	Tape - 1/4" Bead x 20' - Gray - 3M
7	057374-02-000	FT	Extr. Vinyl - Window Seal - Black
8	002309-02-000	FT	Spline - Glass - 1/8" Material - Black
9	M69886-03-011	EA	Extr. - Holder - Glas Seal - 18.19" - Black
10	002241-02-000	EA	Glass - Stationary - 1/8" x 12.3" x 19"
1	047369-01-000	EA	Latch - Window - Plastic - w/Fastener
2	002293-01-000	SF	Screen - Window - 26" - Gray
3	002298-01-000	FT	Spline - .130" Dia. - Gray (Screen)
4	073740-01-000	FT	Seal - Fin - Pile - .460"
5	Not illustrated		

# 1983 ITASCA TABLE OF CONTENTS

IC420RG  
IC424RB  
ICF26RB  
ICN33RU

A-1 - B-22  
B-23 - E-4  
E-5 - G-12  
G-13 - I-20

## 1983 IC424RB INDEX

Floor Plan	B-23 - B-24
Accessories Group	C-1 - C-3
Bath Group	C-4 - C-5
Chassis Group	C-6 - C-7
Curtain, Cushion & Pad Group	C-8 - C-14
Dinette Group	C-15
Driver's Compartment Group	C-16 - C-17
Electrical Group	C-18 - C-20
Exterior Body Group	C-21 - D-3
Galley Group	D-4 - D-5
Heating & Air Conditioning Group	D-6
Interior Finish Group	D-7 - D-9
LP Group	D-10
Lounge Group	D-11
Water & Sewage Group	D-12 - D-13
Window, Vent & Exterior Door Group	D-14 - E-4

# WINDOW, VENT & EXTERIOR DOOR GROUP (CONTINUED)

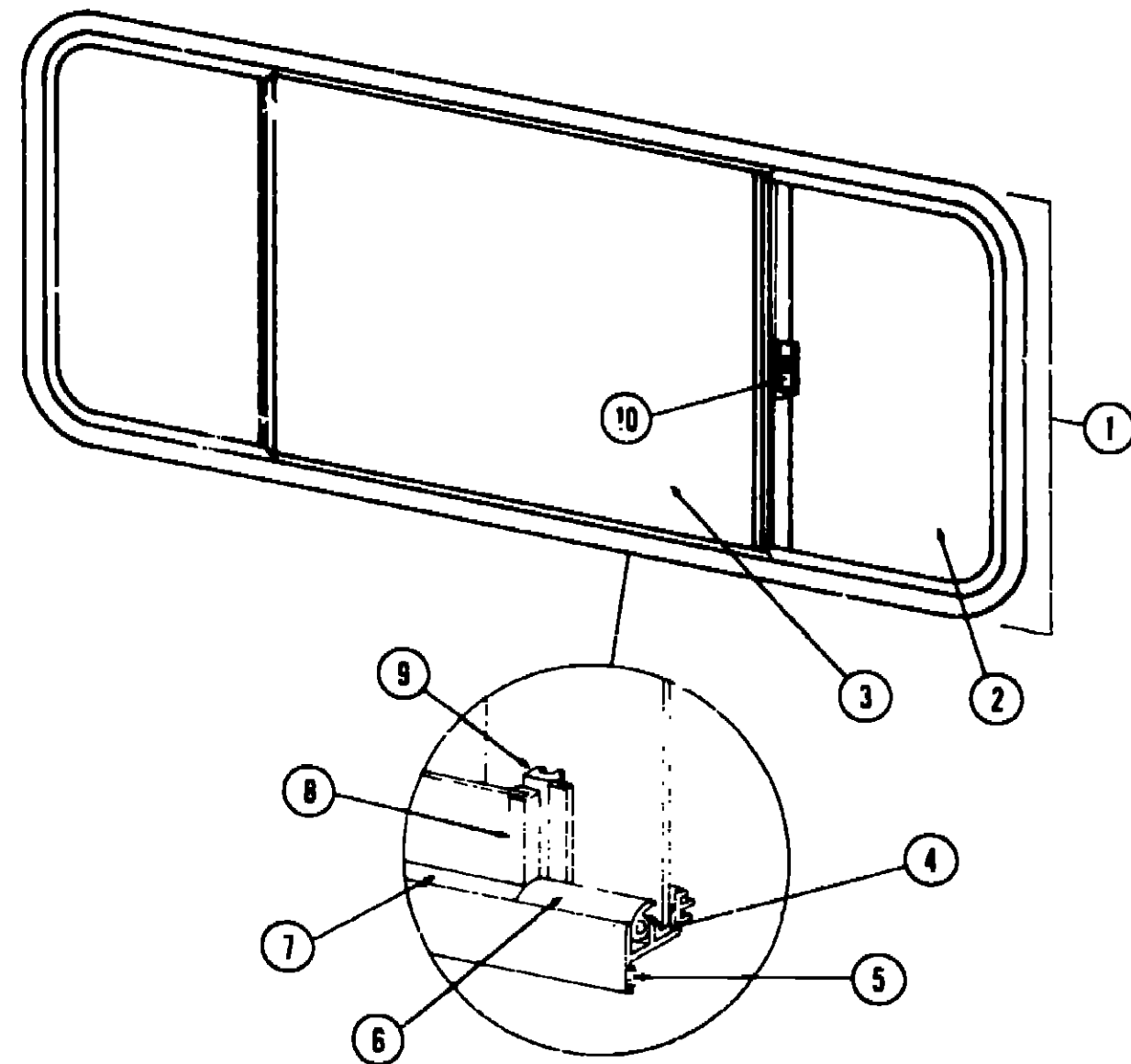

Key	Part Number	U/M	Description
1	066785-03-000	EA	Window Asm. - Single Slider - 25" x 65" (w/o inside frame)
-	067609-06-000	EA	Inside Frame - Beige (not included in assembly)
2	066726-02-000	EA	Glass - Stationary - 1/8" x 21 3/4" x 24"
3	066727-02-000	EA	Glass - Sliding - 1/8" x 12" x 24"
4	002324-02-000	FT	Channel - Weatherstrip - Glass
5	069640-01-000	FT	Tape - 1/4" Bead x 20' - Gray - 3M
6	057374-02-000	FT	Extr. Vinyl - Window Seal - Black
7	002309-02-000	FT	Spline - Glass - 1/8" Material - Black
8	M69886-03-003	EA	Extr. Holder - Glass Seal - 23 9" - Black
9	069896-02-000	EA	Mullion - Slider Window - Black
10	047369-01-700	EA	Latch - Window - Plastic - w/Fastener
-	002293-01-000	SF	Screen - Window - 26" - Gray
-	002298-01-000	FT	Spline - 130" Dia. - Gray (Screen)
-	073740-01-000	FT	Seal - Fin - Pile - 460"
-	Not illustrated		

# WINDOW, VENT & EXTERIOR DOOR GROUP (CONTINUED)

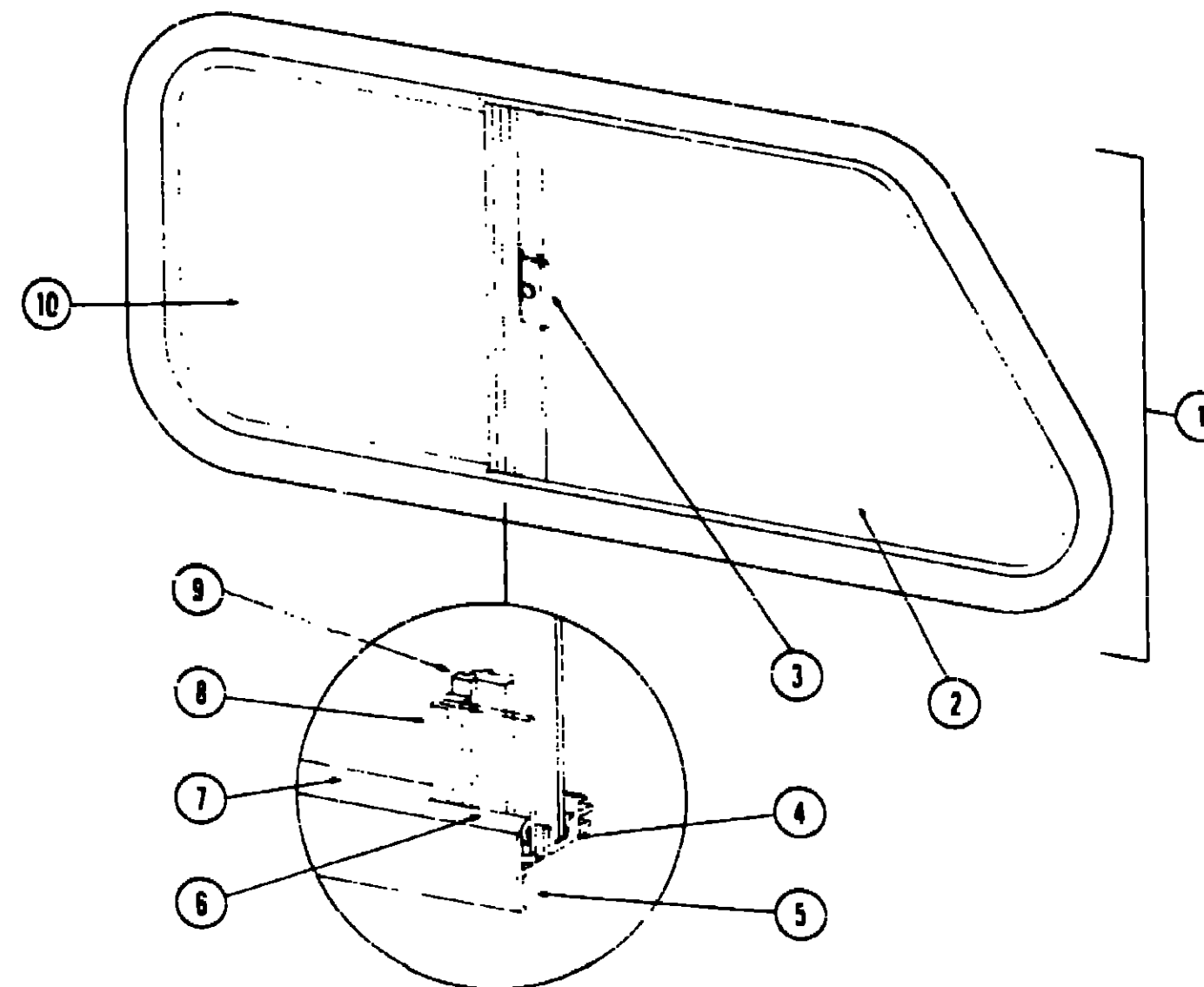

Key	Part Number	U/M	Description
1	048632-04-000	EA	Window Asm. - Bunk - Slanted Slider - Left - Black (w/o inside frame)
1	048632-03-000	EA	Window Asm. - Bunk - Slanted Slider - Right - Black (w/o inside frame)
2	040919-01-000	EA	Glass - 1/8" x 11.98" x 10.42" - Gray - Stationary
3	047369-01-700	EA	Latch - Window - Plastic w/Fastener
-	023320-01-000	EA	Foam Pad - 3/8" Dia. (used with plastic latch)
4	002324-02-000	FT	Channel - Weatherstrip - Glass Run - 3/16" Glass
5	069640-01-000	FT	Tape - 1/4" Bead x 20' - Gray - 3M
6	002309-02-000	FT	Spline - Glass - 1/8" - Black
7	024096-02-000	FT	Seal - Window Channel - Black
8	M69886-03-005	EA	Holder - Glass Seal - Extr. - Black - 11.23"
9	069896-04-000	EA	Mullion - Black
10	047815-01-000	EA	Glass - 1/8" x 11.98" x 11.81" - Gray - Sliding
-	040916-05-000	EA	Inside Frame - Window - Bunk Slant - Left - Beige (not included in assembly)
-	040916-06-000	EA	Inside Frame - Window - Bunk Slant - Right - Beige (not included in assembly)
-	023713-02-000	EA	Weephole Cover - Black
-	002298-01-000	FT	Spline - Gray - 130" Dia. (Screen)
-	002291-01-000	SF	Screen - Gray - Window - 16"
-	073740-01-000	FT	Seal - Fin - Pile - 460"
-	Not illustrated		

## 1983 ITASCA TABLE OF CONTENTS

IC420RG  
IC424RB  
ICF26RB  
ICN33RU

A-1 - B-22  
B-23 - E-4  
E-5 - G-12  
G-13 - I-20

## 1983 IC424RB INDEX

Floor Plan	B-23 - B-24
Accessories Group	C-1 - C-3
Bath Group	C-4 - C-5
Chassis Group	C-6 - C-7
Curtain, Cushion & Pad Group	C-8 - C-14
Dinette Group	C-15
Driver's Compartment Group	C-16 - C-17
Electrical Group	C-18 - C-20
Exterior Body Group	C-21 - D-3
Galley Group	D-4 - D-5
Heating & Air Conditioning Group	D-6
Interior Finish Group	D-7 - D-9
LP Group	D-10
Lounge Group	D-11
Water & Sewage Group	D-12 - D-13
Window, Vent & Exterior Door Group	D-14 - E-4

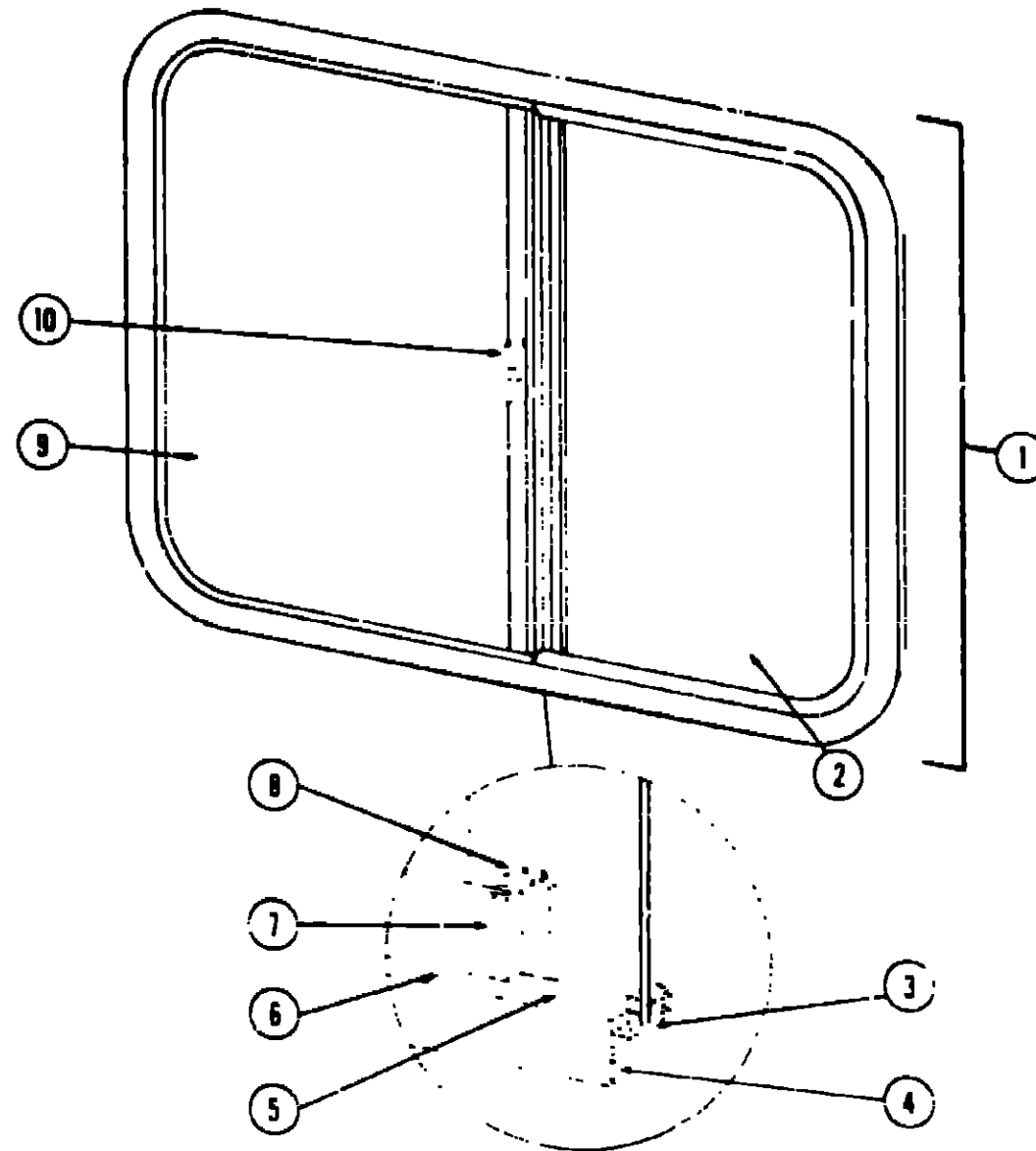

Key	Part Number	U/M	Description
1	048631-19-000	EA	Window Asm - Right Single Slider - 25" x 44" - Black (w/o inside frame)
2	047822-04-000	EA	Glass - Sliding - 1/8" x 24" x 21.03" - Gray
3	002324-02-000	FT	Channel - Weatherstrip - Glass Run - 1/8" Glass
4	069640-01-000	FT	Tape - 1/4" Bead x 20' - Gray - 3M
5	047374-02-000	FT	Seal - Window Channel - Black
6	002309-02-000	FT	Spline - Glass - 1/8" - Black
7	M69886-03-003	EA	Seal Holder w/Fin Seal - 23.19"
8	073740-01-000	FT	Seal - Fin - Pile - .460"
9	002288-01-000	FT	Weatherstrip - Glass Seal - 30 Pile
10	069896-02-000	EA	Mullion - Black
	042076-01-000	FT	Weatherstrip - Mullion - 34 Pile
	002183-03-000	EA	Glass - Stationary - 1/8" x 24" x 23.49" - Gray
	047369-01-700	EA	Latch - Window - Plastic w/Fastener
	023320-01-000	EA	Foam Pad - 3/8" Dia. (used w/plastic latch)
	067609-13-000	EA	Inside Frame - Single Slider - 24.66" x 43.44" - Beige (not included in assembly)
	023713-02-000	EA	Weephole Cover - Black Plastic
	002293-01-000	SF	Screen - Window - 26" - Gray
	002298-01-000	FT	Spline - Screen - 13" Dia. - Gray
			Not illustrated

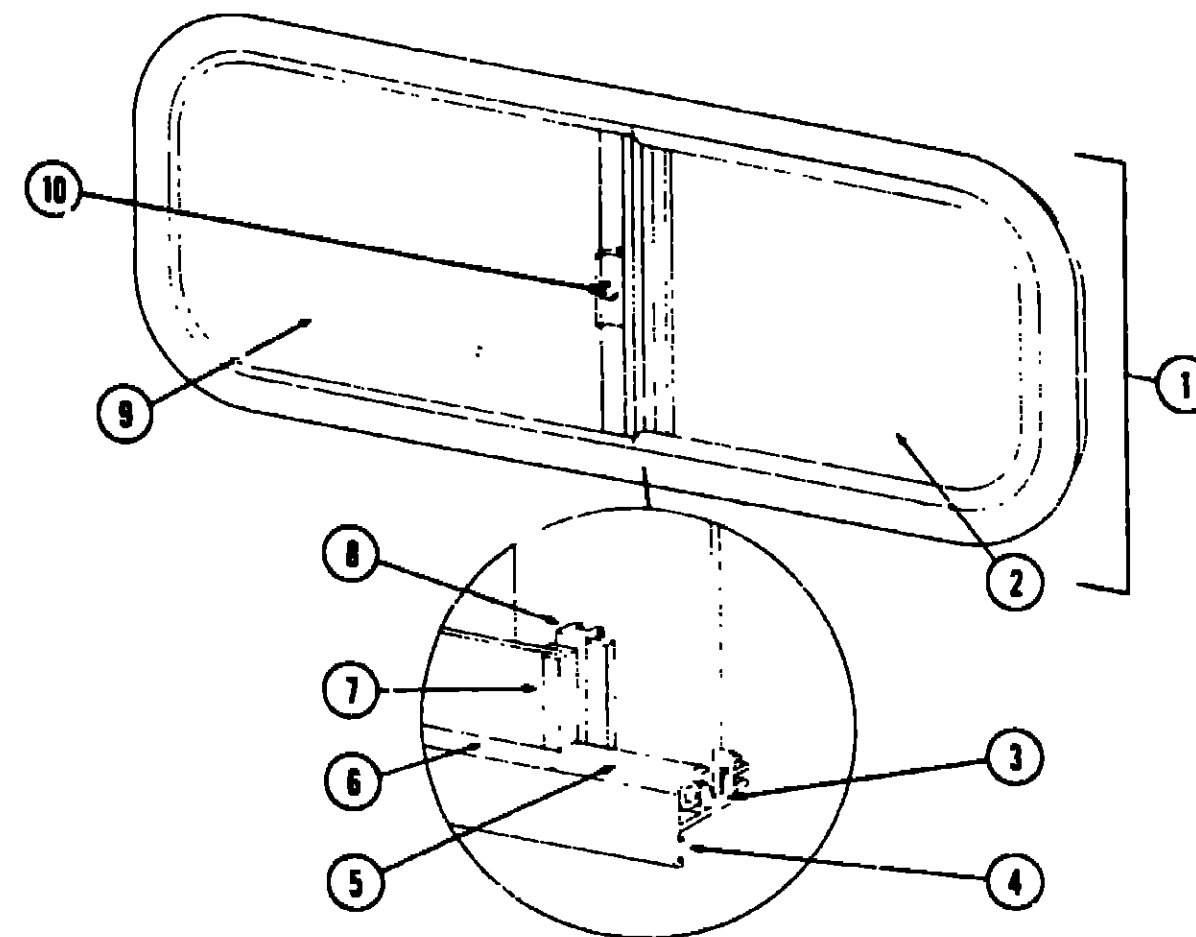

Key	Part Number	U/M	Description
1	045556-06-000	EA	Window Asm - Right Single Slider - 15" x 37" - Black (w/o inside frame)
2	048324-02-000	EA	Glass - Sliding - 1/8" x 14.4" x 19" - Gray
3	002324-02-000	FT	Channel - Weatherstrip - Glass Run - 1/8" Glass
4	004363-01-000	FT	Tape - 3/16" x 1/2" - Gray
5	057374-02-000	FT	Seal - Window Channel - 1/8" Glass - Black
6	002305-02-000	FT	Spline - Glass - 1/8" - Black
7	M69885-03-007	EA	Seal Holder w/Fin Seal - 13.60" - Black
8	069896-06-000	EA	Mullion - Slider Window - Black
9	002208-02-000	EA	Glass - Stationary - 1/8" x 14.4" x 19" - Gray
10	047369-01-700	EA	Latch - Window - Plastic w/Fastener
	023320-01-000	EA	Pad - Foam - 3/8" Dia. (used with plastic latch)
	067609-10-000	EA	Inside Frame - Single Slider Window - Beige - 15" x 37" (not included in assembly)
	023813-02-000	EA	Weephole Cover - Plastic - Black
	002298-01-000	FT	Spline - Gray - .130" Dia (Screen)
	002291-01-000	SF	Screen - Window - 16" - Gray
	073740-01-000	FT	Seal Fin - Pile .460"
			Not illustrated

## 1983 ITASCA TABLE OF CONTENTS

IC420RG  
IC424RB  
ICF26RB  
ICN33RU

A-1 - B-22  
B-23 - E-4  
E-5 - G-12  
G-13 - I-20

## 1983 IC424RB INDEX

Floor Plan	B-23 - B-24
Accessories Group	C-1 - C-3
Bath Group	C-4 - C-5
Chassis Group	C-6 - C-7
Curtain, Cushion & Pad Group	C-8 - C-14
Dinette Group	C-15
Driver's Compartment Group	C-16 - C-17
Electrical Group	C-18 - C-20
Exterior Body Group	C-21 - D-3
Galley Group	D-4 - D-5
Heating & Air Conditioning Group	D-6
Interior Finish Group	D-7 - D-9
LP Group	D-10
Lounge Group	D-11
Water & Sewage Group	D-12 - D-13
Window, Vent & Exterior Door Group	D-14 - E-4



# WINDOW, VENT & EXTERIOR DOOR GROUP (CONTINUED)

# WINDOW, VENT & EXTERIOR DOOR GROUP (CONTINUED)

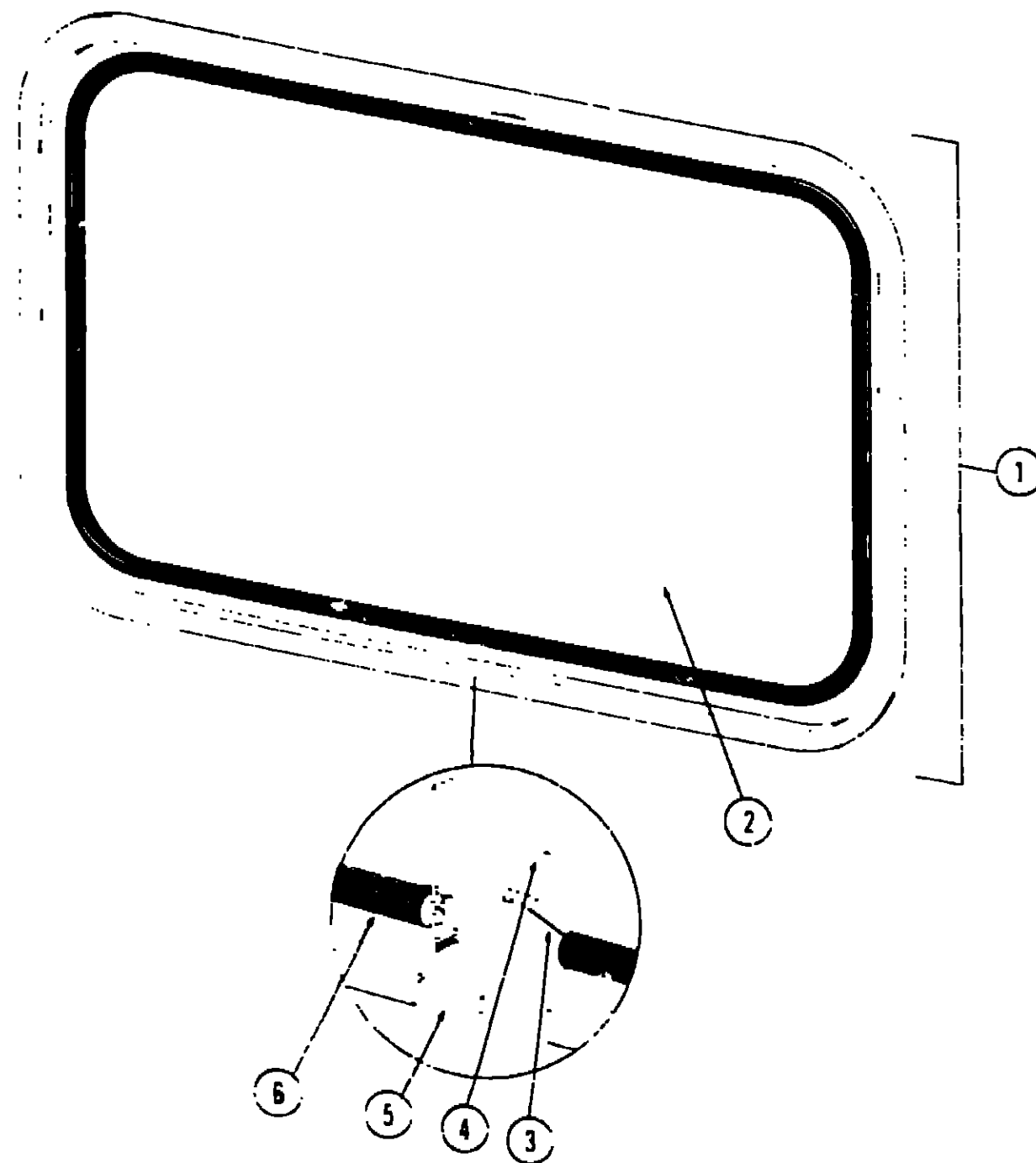

Key	Part Number	U/M	Description
1	020751-03-000	EA	Window Asm. - Rear Escape - 23" x 29" - Black (w/o inside frame)
2	002174-01-000	EA	Glass - 1/8" x 19.6" x 25.92"
3	002285-01-000	FT	Filler - Weatherstrip - Black
4	020395-01-000	EA	Pull Ring - Escape Window
5	053767-02-000	FT	Tape - 3/16" Bead x 25' - Gray
6	002282-01-000	FT	Weatherstrip - 125" Window
.	020749-05-000	EA	Inside Frame - Escape Window - Beige (not included in assembly)
.	006199-01-000	EA	Label - Exit - Escape Window
.	Not illustrated		

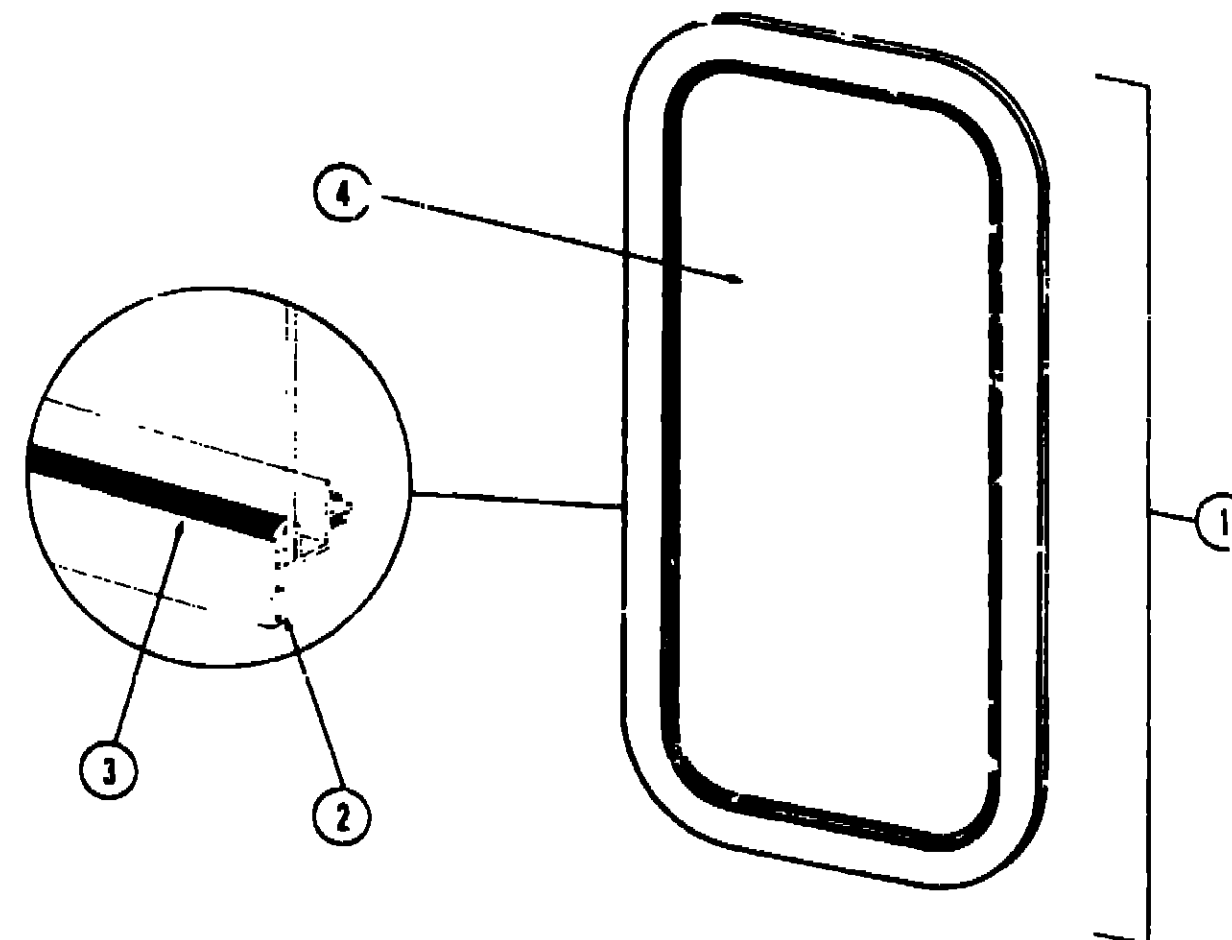

Key	Part Number	U/M	Description
1	041875-02-000	EA	Window Asm. - Picture - 13" x 23" - Black (w/o inside frame)
2	053767-02-000	FT	Tape - 3/16" Bead x 25' - Schnee Morehead
3	002309-02-000	FT	Spline - Glass - 1/8" - Black
4	002181-01-000	EA	Glass - 1/5" x 12" x 22"
.	041696-15-000	EA	Inside Frame - Window - Beige (not included in assembly)
.	Not illustrated		

## 1983 ITASCA TABLE OF CONTENTS

IC420RG  
IC424RB  
ICF26RB  
ICN33RU

A-1 - B-22  
B-23 - E-4  
E-5 - G-12  
G-13 - I-20

## 1983 IC424RB INDEX

Floor Plan	B-23 - B-24
Accessories Group	C-1 - C-3
Bath Group	C-4 - C-5
Chassis Group	C-6 - C-7
Curtain, Cushion & Pad Group	C-8 - C-14
Dinette Group	C-15
Driver's Compartment Group	C-16 - C-17
Electrical Group	C-18 - C-20
Exterior Body Group	C-21 - D-3
Galley Group	D-4 - D-5
Heating & Air Conditioning Group	D-6
Interior Finish Group	D-7 - D-9
LP Group	D-10
Lounge Group	D-11
Water & Sewage Group	D-12 - D-13
Window, Vent & Exterior Door Group	D-14 - E-4

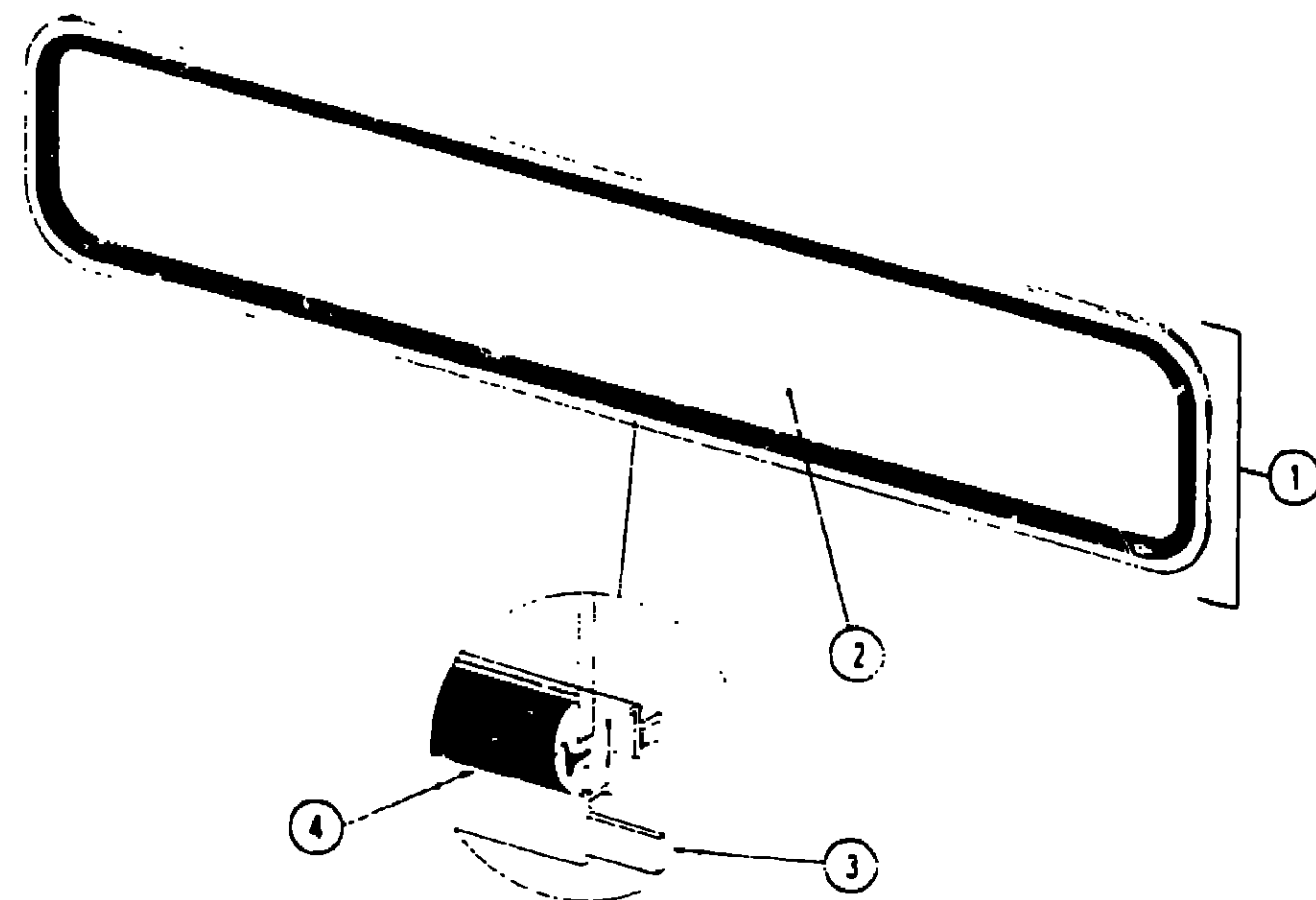

Key	Part Number	U/M	Description
1	041936-01-000	EA	Window Asm. - Front Picture - 14" x 63" - Black (w/o inside frame)
2	002200-02-000	EA	Glass - TP - Picture Window
3	069640-01-000	FT	Tape - 1/4" Bead x 20' - Gray - 3M
4	002281-01-000	FT	Weatherstrip - Self Seal - .06" Panel x 3/16" - Black
5	037845-01-000	FT	Tape - Butyl - Window - 3/16" Bead - Black
6	042027-07-000	EA	Inside Frame - Picture Window - Beige (not included in assembly)
	Not illustrated		

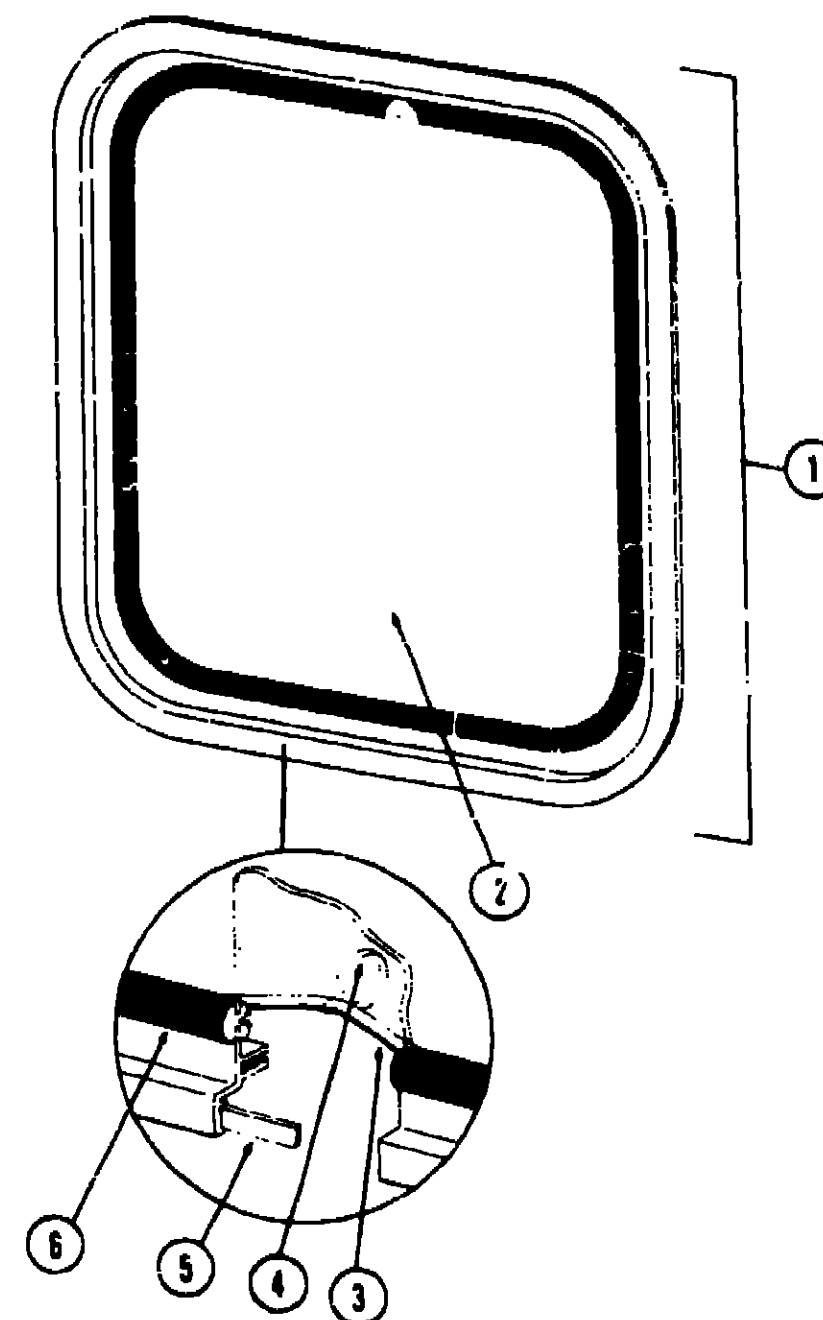

Key	Part Number	U/M	Description
1	042959-03-000	EA	Window Asm. - Rear Escape - 22.5" x 24.5" - Black (w/o inside frame)
2	041392-03-000	EA	Glass - 1/8" x 19.6" x 21.65"
3	002285-01-000	FT	Filler - Weatherstrip - Black
4	020395-01-000	EA	Pull Ring - Escape Window
5	004363-01-000	FT	Tape - Foam - 3/16" x 1/2" - Gray
6	002282-01-000	FT	Weatherstrip - .125" Window
	072842-01-000	EA	Inside Frame - Escape Window - Beige (not included in assembly)
	006199-01-000	EA	Label - Exit - Escape Window
	Not illustrated		

# 1983 ITASCA TABLE OF CONTENTS

IC420RG	A-1 - B-22
IC424RB	B-23 - E-4
ICF26RB	E-5 - G-12
ICV33RU	G-13 - I-20

## 1983 IC424RB INDEX

Floor Plan	B-23 - B-24
Accessories Group	C-1 - C-3
Bath Group	C-4 - C-5
Chassis Group	C-6 - C-7
Curtain, Cushion & Pad Group	C-8 - C-14
Dinette Group	C-15
Driver's Compartment Group	C-16 - C-17
Electrical Group	C-18 - C-20
Exterior Body Group	C-21 - D-3
Galley Group	D-4 - D-5
Heating & Air Conditioning Group	D-6
Interior Finish Group	D-7 - D-9
LP Group	D-10
Lounge Group	D-11
Water & Sewage Group	D-12 - D-13
Window, Vent & Exterior Door Group	D-14 - E-4

# WINDOW, VENT & EXTERIOR DOOR GROUP (CONTINUED)

## ENTRANCE & SCREEN DOOR

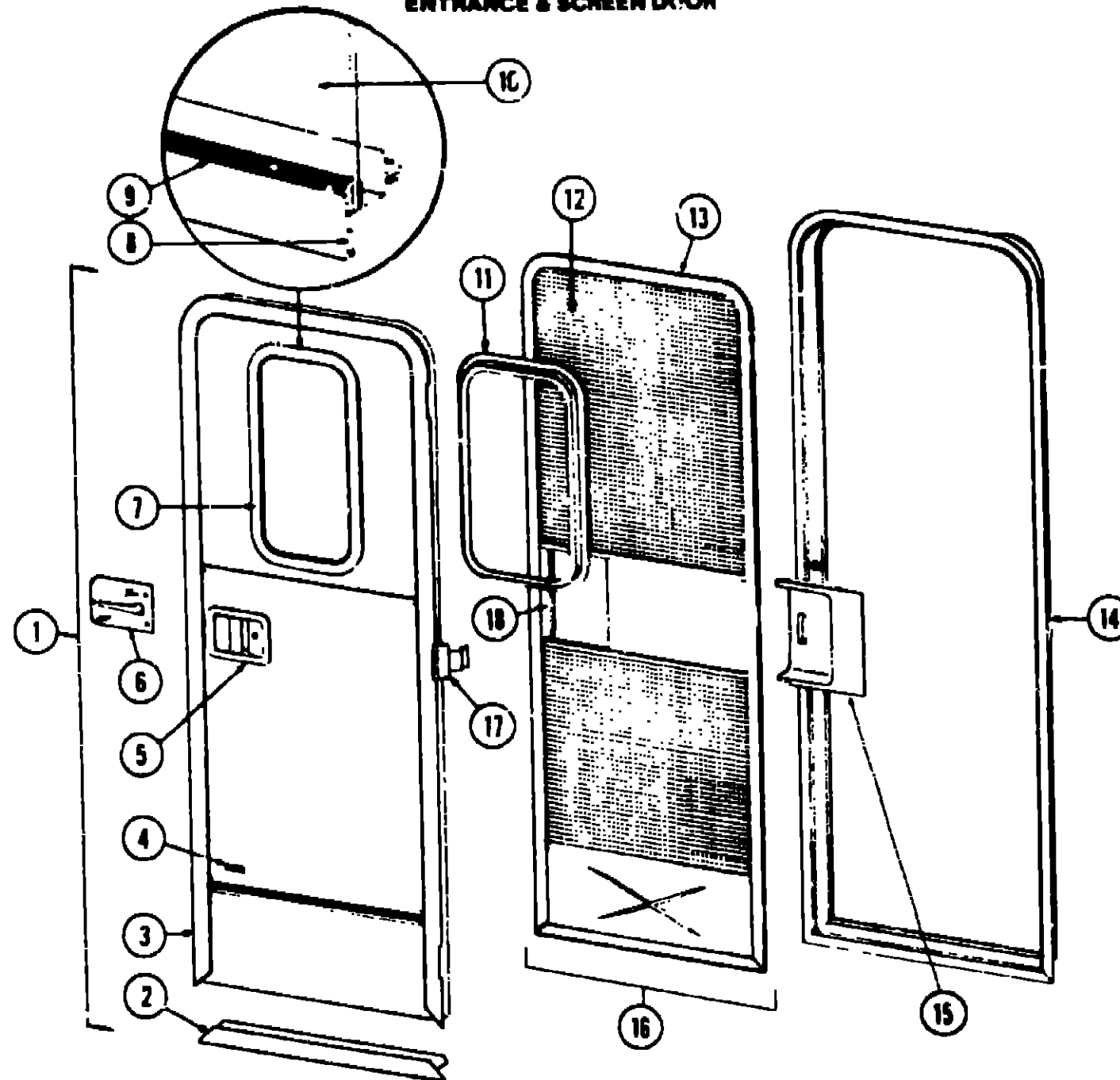

Key	Part Number	U/M	Description
1	M71136-13-000	EA	Door Asm. - Radius Entry w/Screen Door
2	039737-01-000	EA	Frame - Entry Door (Bottom Portion Only)
3	039736-01-000	EA	Frame - Entry door (Except Bottom Portion)
4	054530-01-000	EA	Holder Asm. - Entry Door
5	045017-05-000	EA	Paddle Asm. - Door Lock - Exterior
6	045017-05-700	EA	Lock Cylinder w/Keys - Lynor
7	039539-01-000	EA	Striker Bolt - Entry Door
8	039540-01-000	EA	Latch Claw - Entry Door
9	039738-01-000	EA	Dead Bolt - Entry Door
10	039979-01-000	EA	Plate - Lock - Inside - Including Inside Handle
11	052186-01-000	EA	Lock Asm. - Complete - Lynor
12	041875-09-000	EA	Window Asm. - Picture - 17" x 25" - Black (w/o inside frame)
13	069640-01-000	FT	Tape - 1/4" Bead x 20' - Gray - 3M
14	002309-02-000	FT	Spline - Glass - 1/8" Black
15	002191-06-000	EA	Glass - Picture Window - 1/8" x 16.25" x 24" - Gray
16	067609-03-000	EA	Inside Frame - Window - 17" x 25" - Beige (not included in assembly)
17	002293-01-000	SF	Screen - Window - 26" - Gray
18	056795-01-000	FT	Seal Tape - 1/8" x 3/8" - Press On
19	053171-01-000	EA	Jamb Asm. - Entry Door

E-3

Key	Part Number	U/M	Description
15	015580-02-000	EA	Slider - Screen Door - Light Oak Plastic
16	053170-05-000	EA	Door Asm. - Screen w/Light Oak Trim
17	039520-01-000	EA	Hinge - Entry Door (3 used per door)
18	015581-02-000	EA	Cap - Screen Door - Light Oak Plastic
19	049176-01-000	EA	Hed'ok II - 3/4" Diameter - Screw Mount (Retains screen door to entry door)
20	009016-01-000	EA	Catch - Elbow - Spring Loaded - Screen Door
21	039863-01-000	EA	Catch Asm. - Single Roller w/Strike - Screen Door
22	051390-01-000	FT	Seal - Bulb - Rubber
23	039800-03-000	FT	Tubing - Polybutyl - 3/8" O.D. Jamb
24	058025-02-000	EA	Clip - Roller Latch Catch
25	044582-02-000	EA	Drip Cap - Off White
26	075802-01-000	EA	Seal - Mocket - Entrance
27	075739-01-000	EA	Stiffener - Entrance Door - Off White
28	075673-01-000	FT	Seal - Pile - Adhesive Back
29	075671-01-000	FT	Seal - Sponge - Lazy "T" Shaped
30	002294-01-000	FT	Spline - Black - .135 x .138 (Screen Door)
31	063638-01-000	EA	Strike - Screen Door
32	063729-04-000	EA	Rivnut - 10 - 32 UNF - .010 - .080
33	Not illustrated		

## 1983 ITASCA TABLE OF CONTENTS

IC420RG	A-1 - B-22
IC424RB	B-23 - E-4
ICF26RB	E-5 - G-12
ICN33RU	G-13 - I-20

## 1983 IC424RB INDEX

Floor Plan	B-23 - B-24
Accessories Group	C-1 - C-3
Bath Group	C-4 - C-5
Chassis Group	C-6 - C-7
Curtain, Cushion & Pad Group	C-8 - C-14
Dinette Group	C-15
Driver's Compartment Group	C-16 - C-17
Electrical Group	C-18 - C-20
Exterior Body Group	C-21 - D-3
Galley Group	D-4 - D-5
Heating & Air Conditioning Group	D-6
Interior Finish Group	D-7 - D-9
LP Group	D-10
Lounge Group	D-11
Water & Sewage Group	D-12 - D-13
Window, Vent & Exterior Door Group	D-14 - E-4

E-4