

10. USE WITH FAUCET 000221451 / 342498-01-CHT, 000278525 / 355289-01-CHT, AND 000282964 / 356515-01-CHT.
9. ALL CRIMP FITTINGS TO 3/4" PEX TUBING REQUIRE 3/4" CLAMP 000156247 / 326668-01-000.
8. ALL CRIMP FITTINGS TO 1/2" PEX TUBING REQUIRE 1/2" CLAMP 000156249 / 326670-01-000.
7. ALL CRIMP FITTINGS TO 5/8" FLEX TUBING REQUIRE 5/8" CLAMP 000156248 / 326669-01-000.
6. LABEL HOT AND COLD SUPPLY TUBES AND TAPE FITTING TO TUBE BEFORE CABINET SET TO PREVENT MOVEMENT.
5. ADD PIPE WRAP (LADDER SCRAP 110157-02-000) INSULATION.
4. ADD TEFLON TAPE 010405-02-000.
3. ALL TUBING TO BE SECURED AT 1200 INTERVALS MAXIMUM WITH CLAMP 010495-01-000 AND SCREW 000G67-10-12U OR EQUIVALENT.
2. TUBING TO BE INSTALLED WITH SUFFICIENT SLOPE TO PROVIDE DRAINAGE TO NEAREST VALVE.
1. PLASTIC FITTINGS TO BE SEALED WITH SEALANT 084456-01-000.

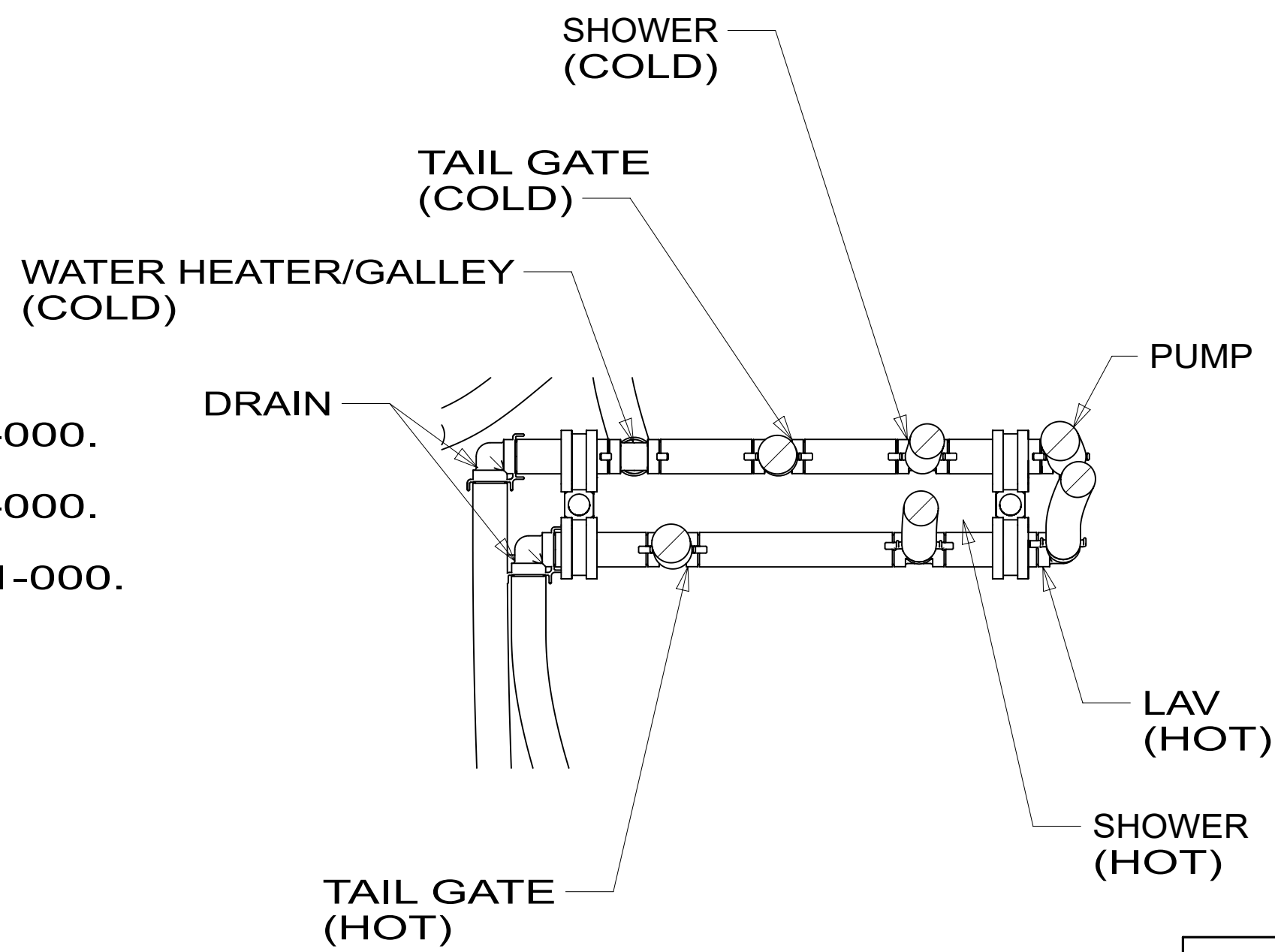

265 CODES/STANDARDS-CSA/CMVSS  
1B1 CODES/STANDARDS USA



DSNR:		ALL DIMENSIONS ARE IN MILLIMETERS	
DfTR:		MATERIAL:	
UNSPECIFIED TOLERANCES:			
WHOLE DIM (X)	: 3		
ONE-PLACE (X.X)	: 1.5		
TWO-PLACE (X.XX)	: 0.50		
ANGLE	: 1°		
REFER TO ES0018 FOR FASTENER TIGHTENING GUIDELINES		WEIGHT: (LBS)	FIRST USED: (REF)
			22 E29V
DESCRIPTION: WATER SYSTEM INSTL			
SHEET: 1 OF 4	ITEM/PART NO: 000217959 / 34132501000	REV	

FOR WATER CALLOUTS SEE DWG NO. 000209446 / 303369-01-000

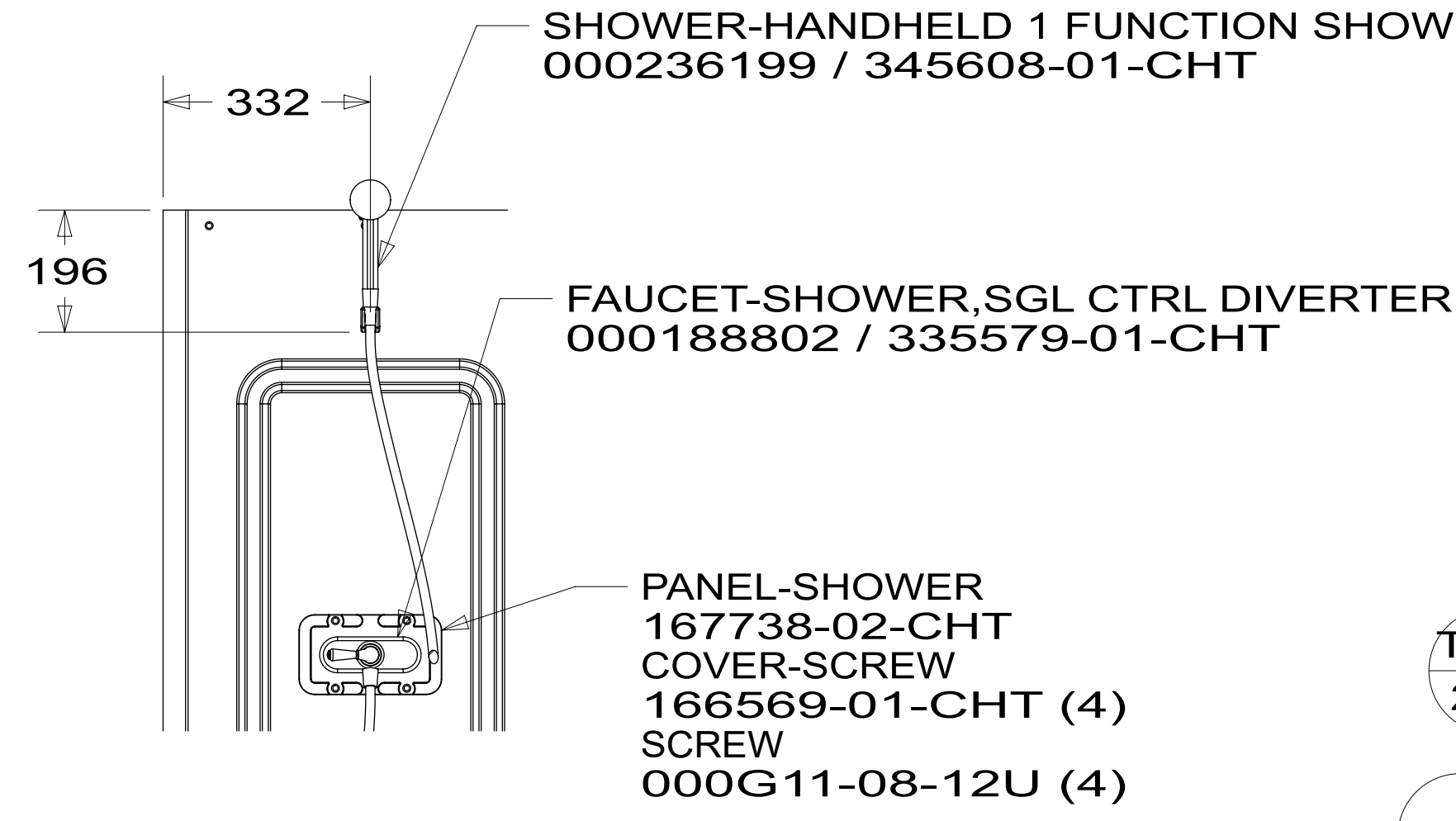

SECTION BD-BD

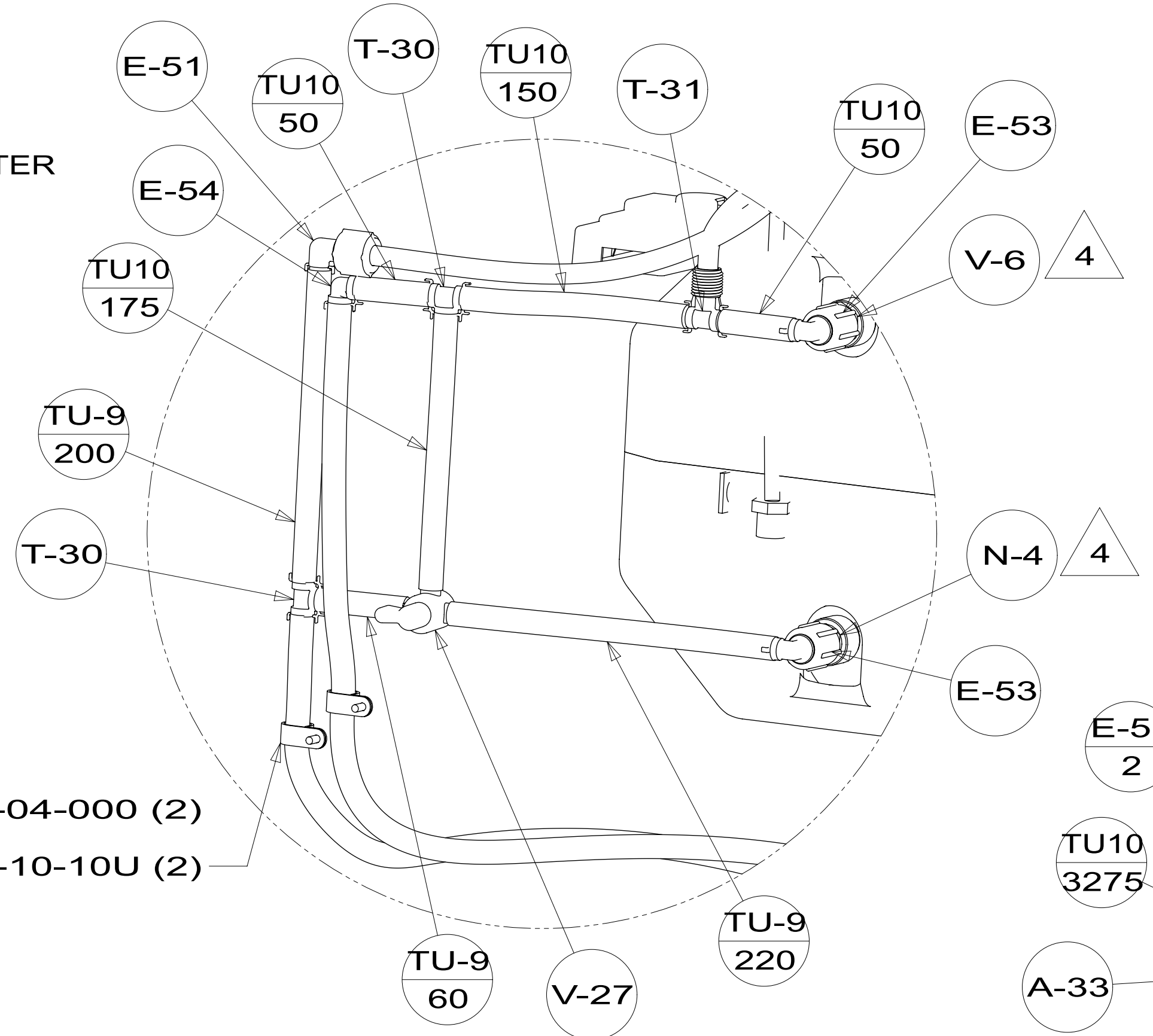

DETAIL BB  
(SHOWN W/OUT CABINETS)

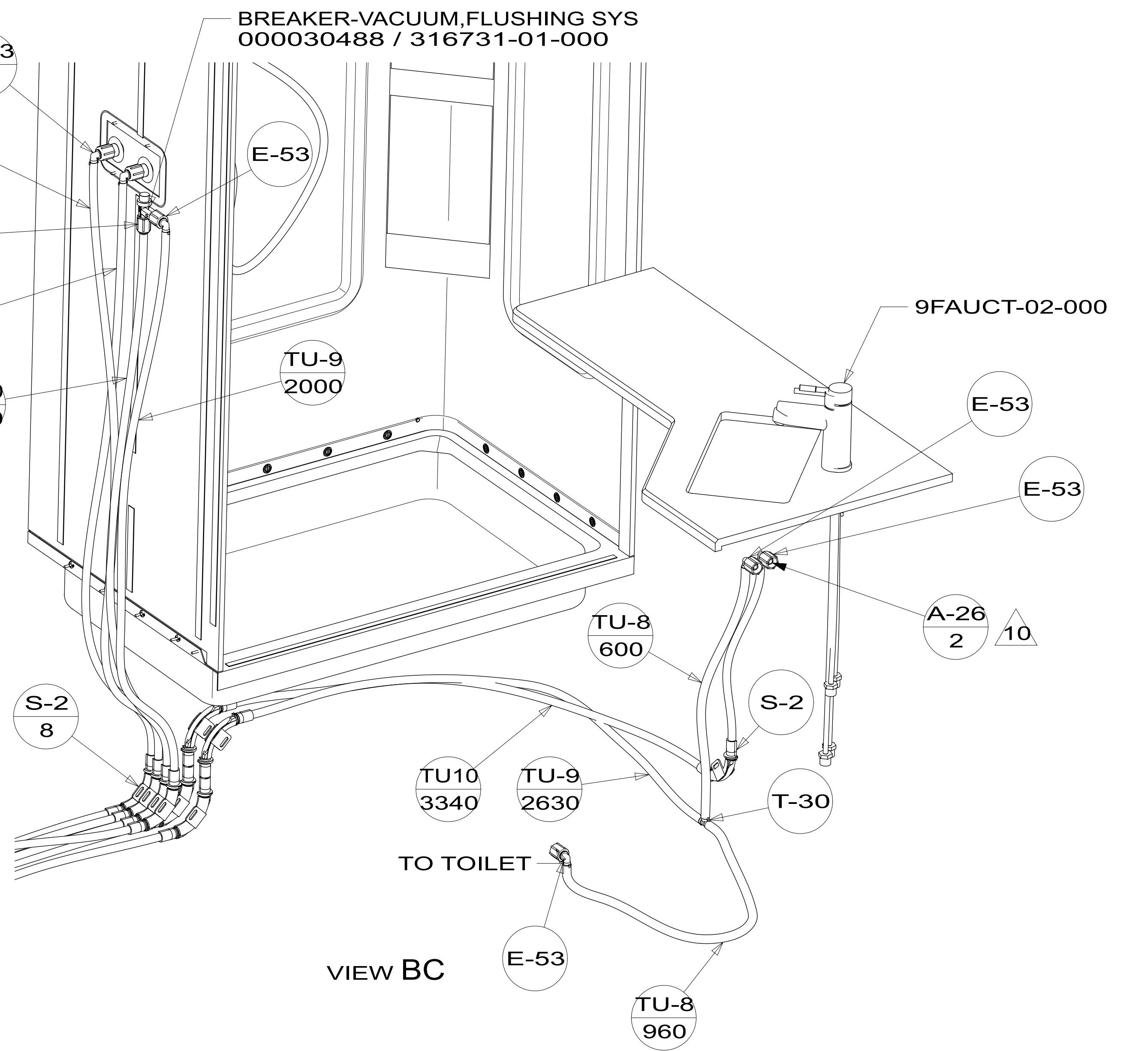

VIEW BC

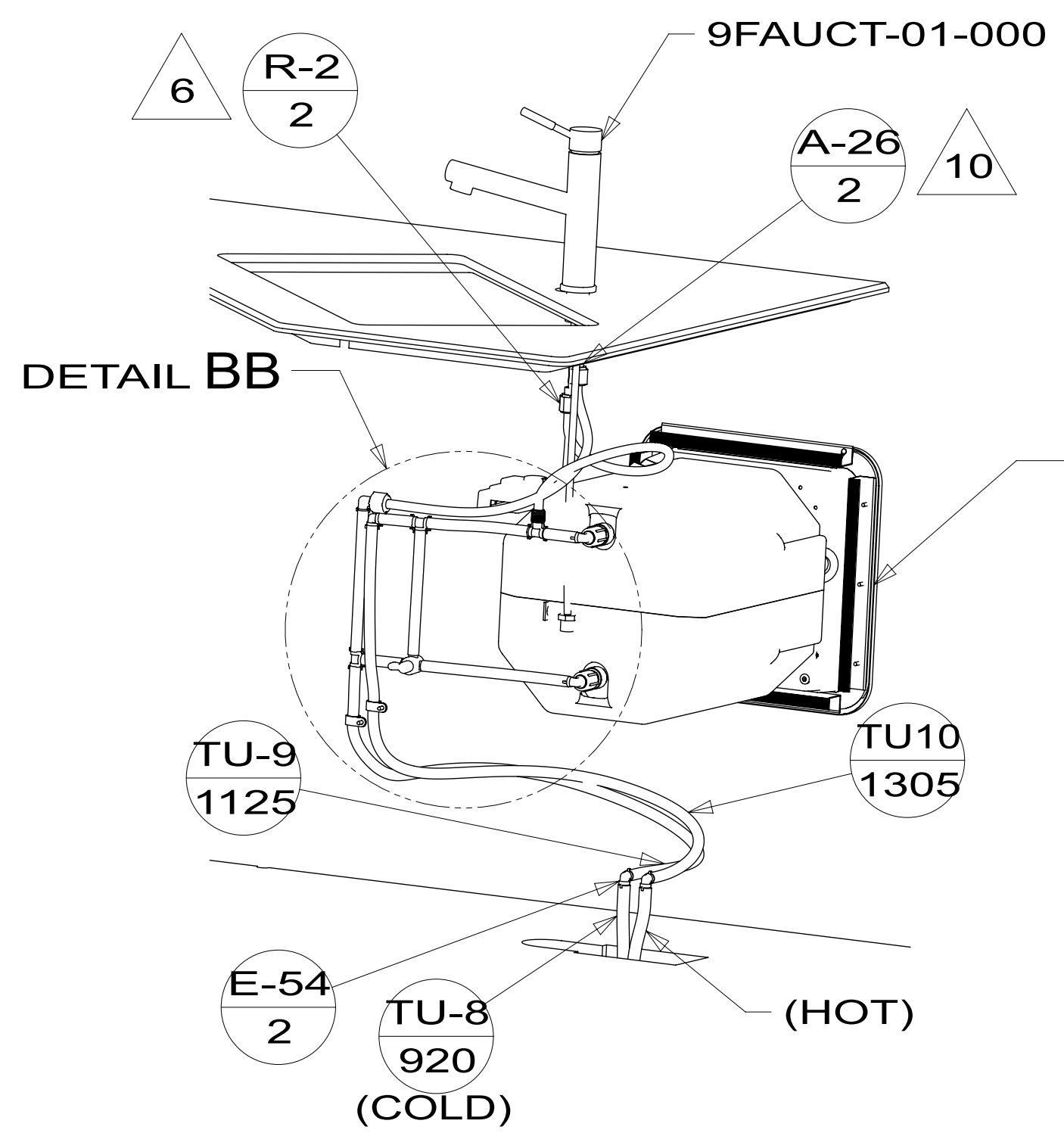

VIEW BA

DESCRIPTION: <b>WATER SYSTEM INSTL</b>		
SHEET: 2 OF 4	ITEM/PART NO: 000217959 / 34132501000	REV

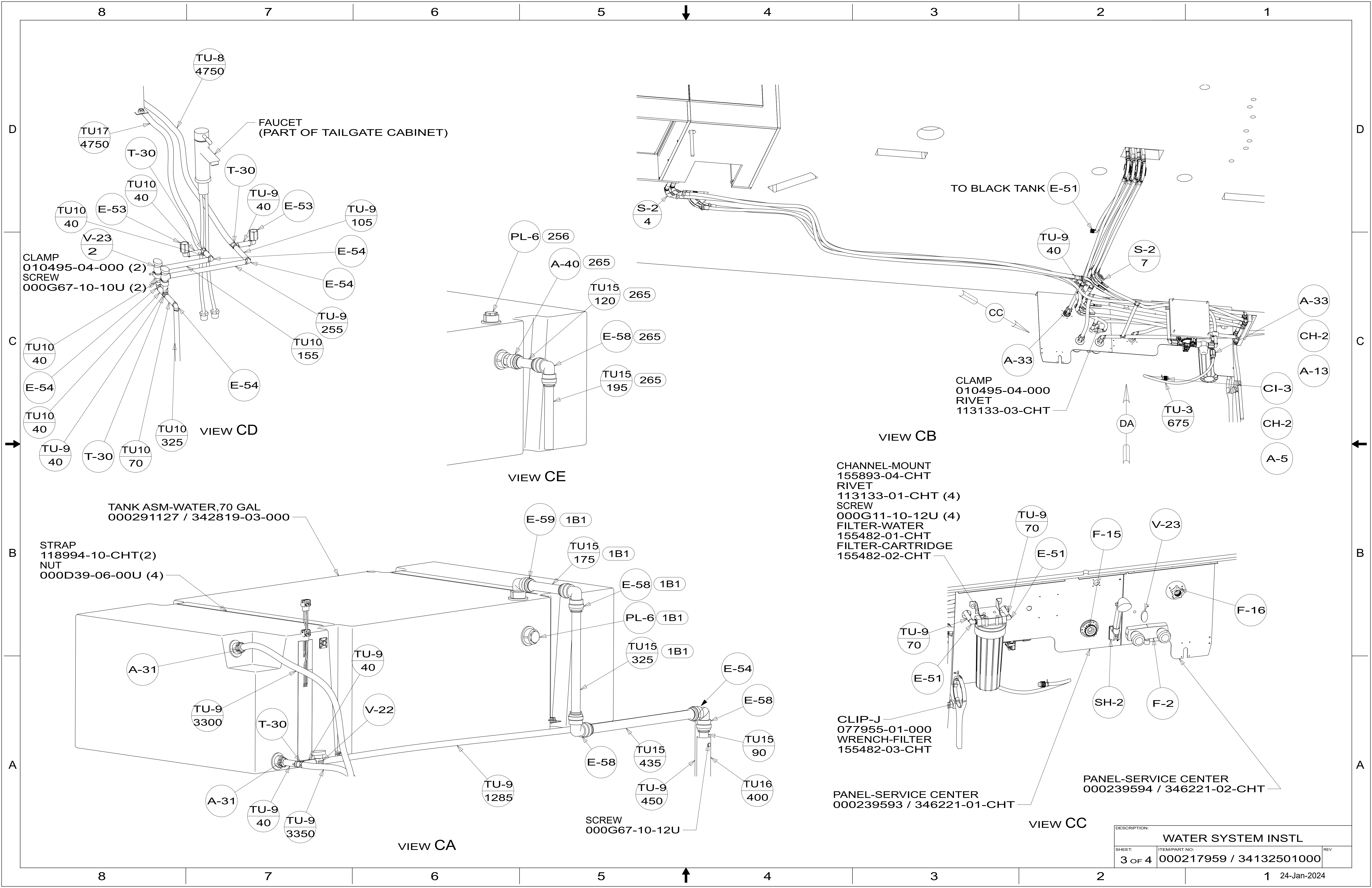

DESCRIPTION:		
WATER SYSTEM INSTL		
SHEET:	ITEM/PART NO.:	REV
3 OF 4	000217959 / 34132501000	

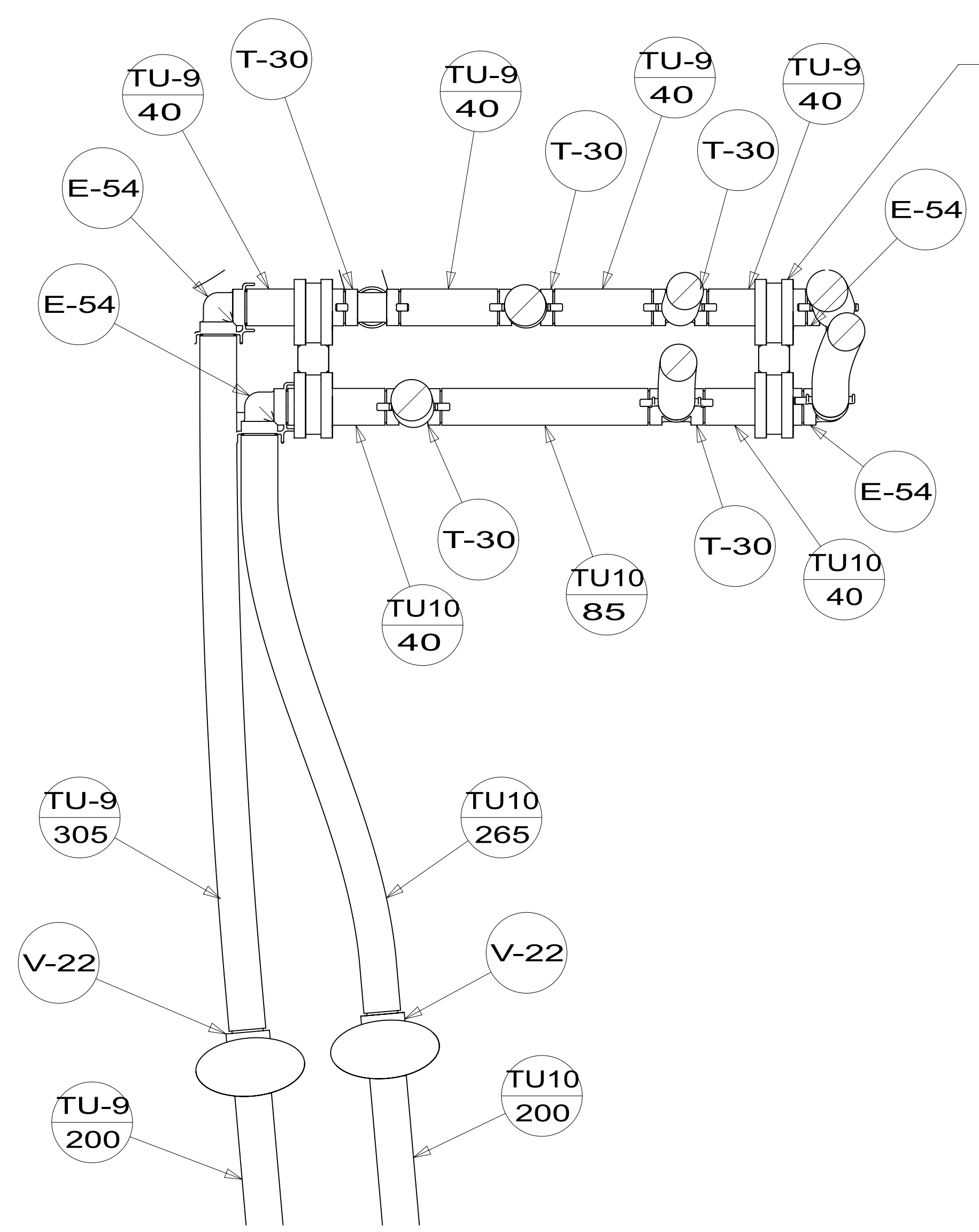

SECTION DD-DD

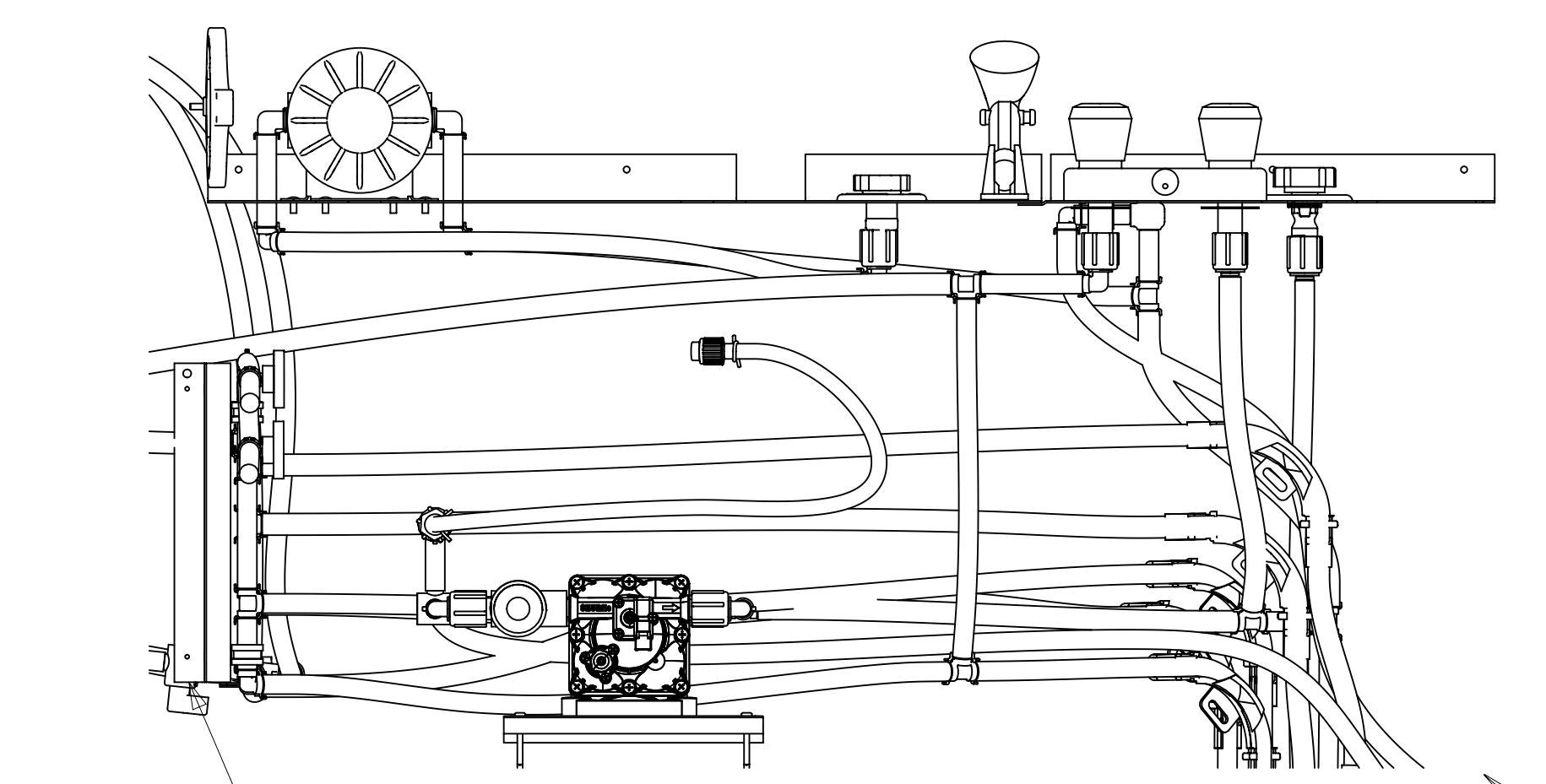

ANGLE ASM  
000256883 / 350545-01-XXX  
VIEW DA

CLAMP  
010497-01-000 (4)  
SCREW  
000G67-10-12U (2)

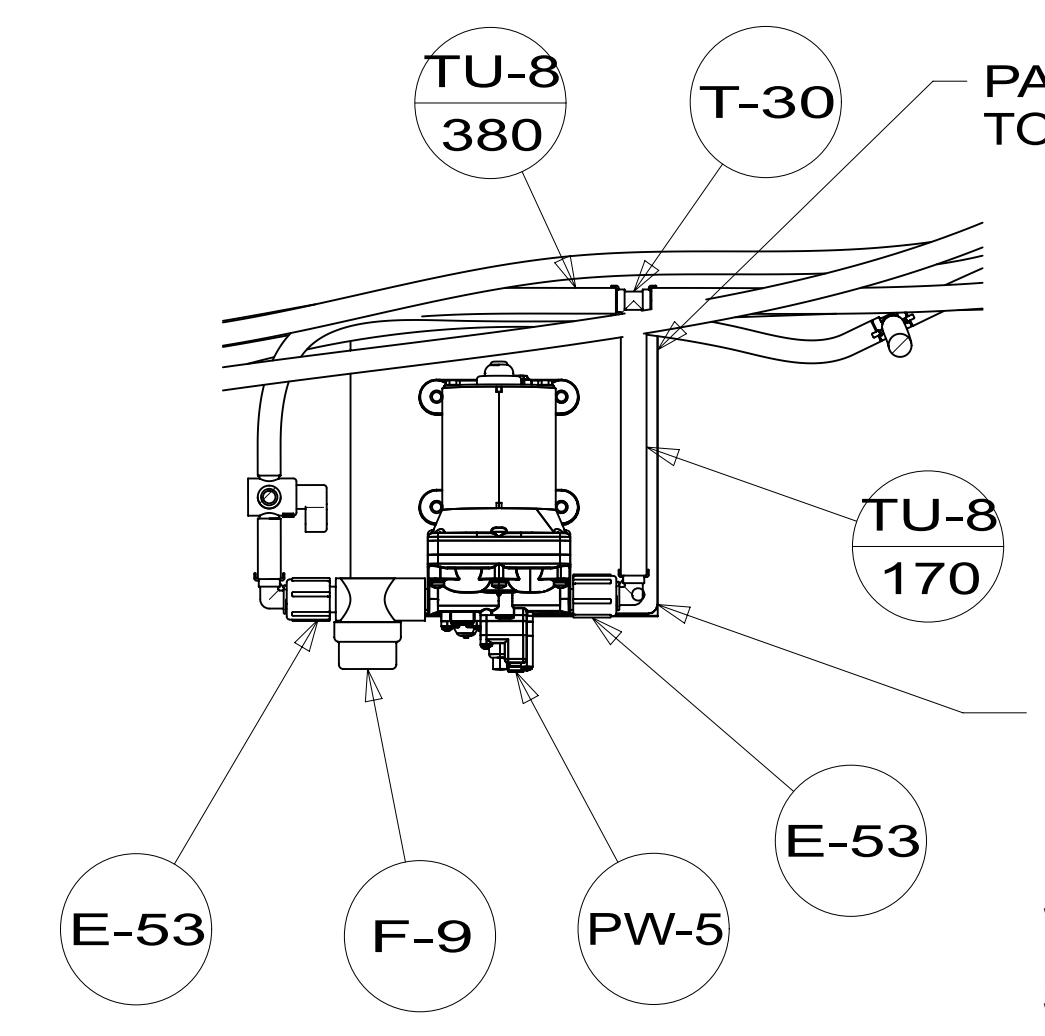

SECTION DB-DB

PANEL FLUSH WITH  
TOP OF COMPARTMENT

PANEL-WATER PUMP  
149477-04-CHT  
FOAM  
140364-01-CHT  
SCREW  
000G39-08-24U (4)  
SCREW  
000G39-08-16U (4)

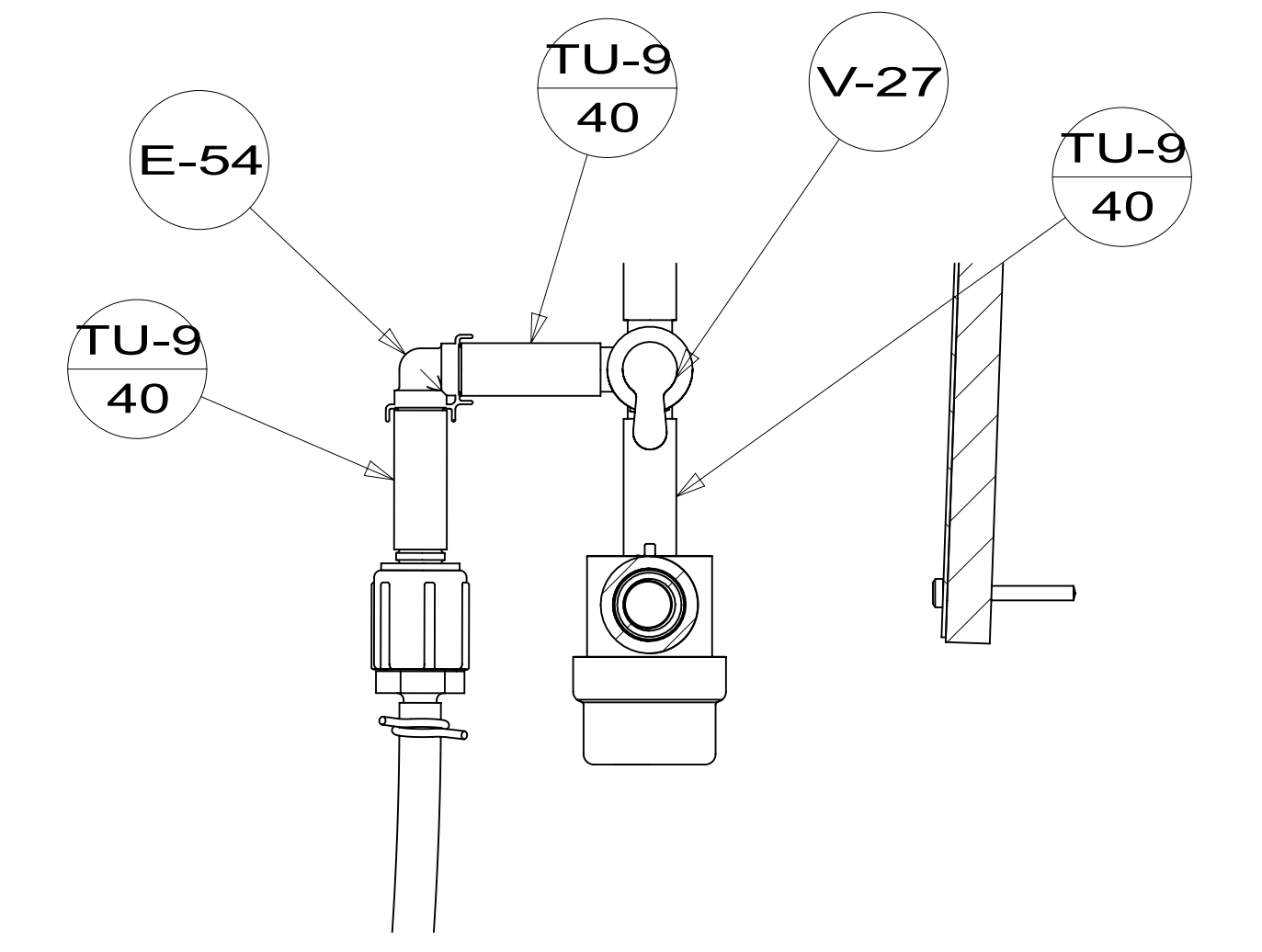

SECTION DC-DC

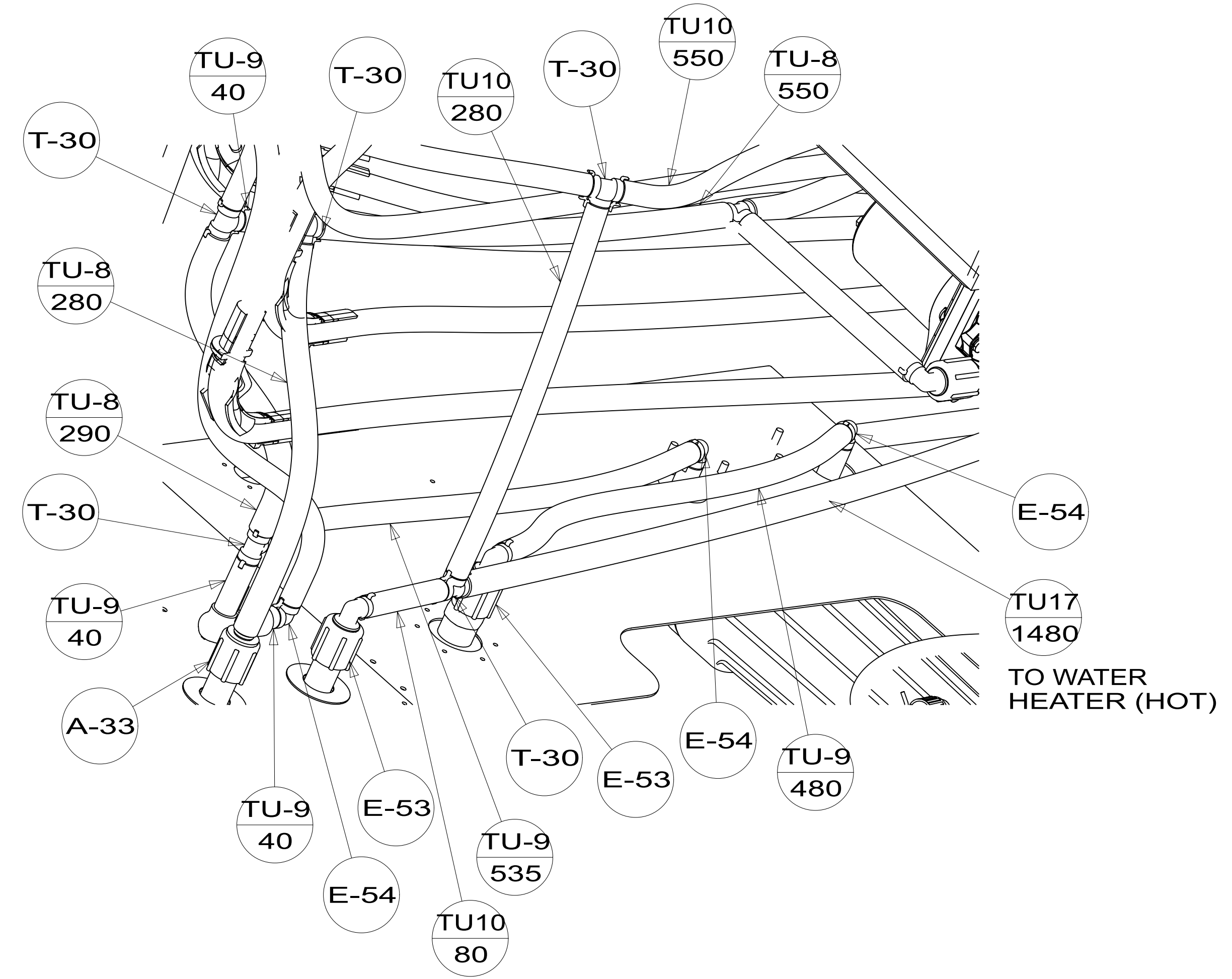

VIEW DE

DESCRIPTION:		
WATER SYSTEM INSTL		
SHEET:	ITEM/PART NO.:	REV
4 OF 4	000217959 / 34132501000	