

8 7 6 5 4 3 2 1

D

D

C

C

B

B

A

A

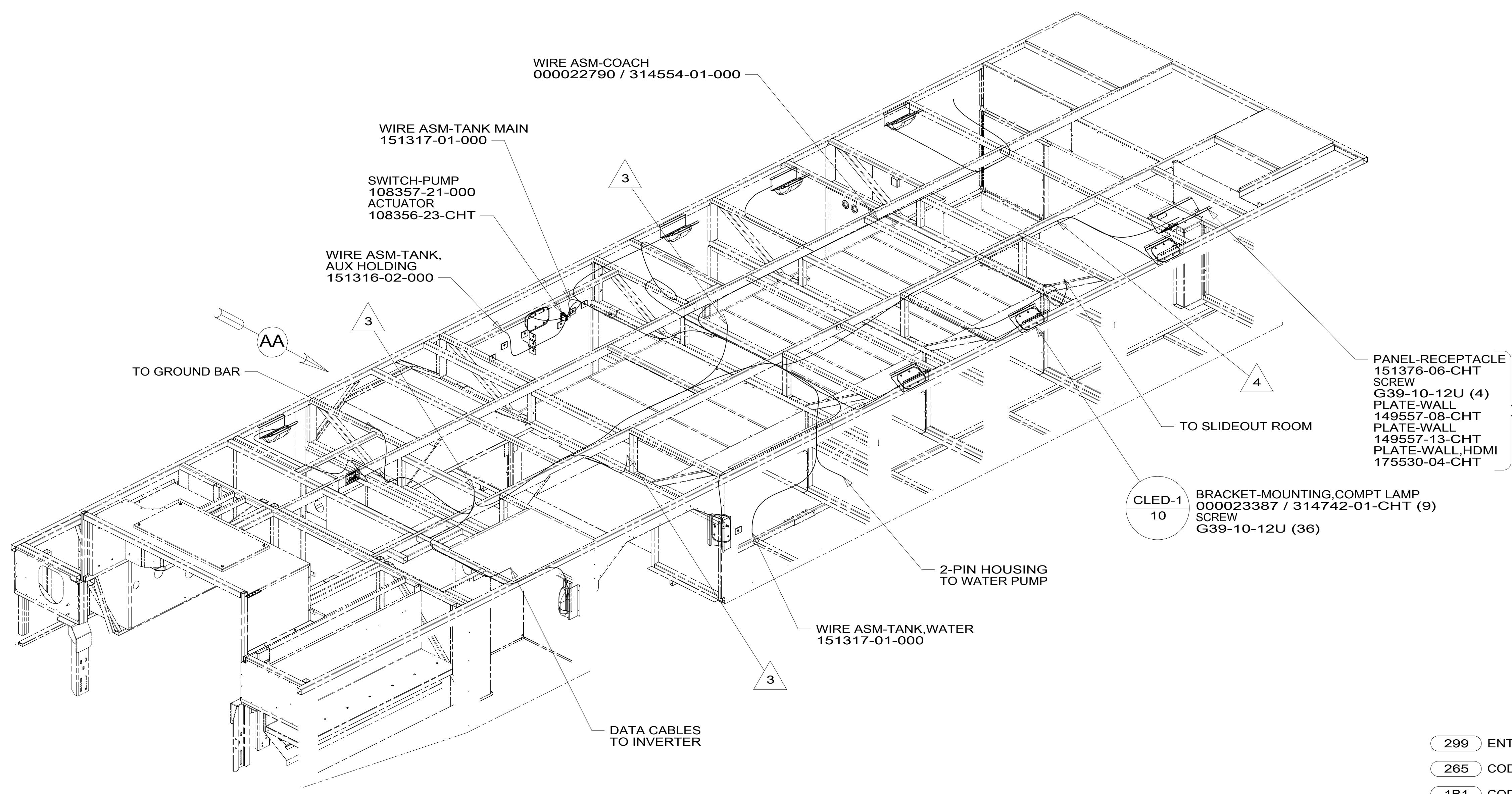

- 4 ROUTE WIRES BELOW FLOOR.
- 3 WIRE PASSES THROUGH FLOOR IN THIS AREA.
2. ROUTE TANK SENSOR WIRES SO THEY DO NOT PASS OVER SENSORS. USE WIRE TIE MOUNT 155366-01-000 AND WIRE TIE 8343-01-000 AS NEEDED. TANK SURFACE MUST BE CLEANED USING ISOPROPYL ALCOHOL AND PRIMED WITH PRIMER 94.
1. AT MINIMUM ALL WIRES TO BE SUPPORTED AND SECURED PER CODE REQUIREMENTS. USE CLAMP 10495 OR 10497 OR WIRE TIE 8343 OR 108046 AND SCREW G67-XX-XXX OR G56-XX-XXX AS APPROPRIATE FOR INSTALLATION.

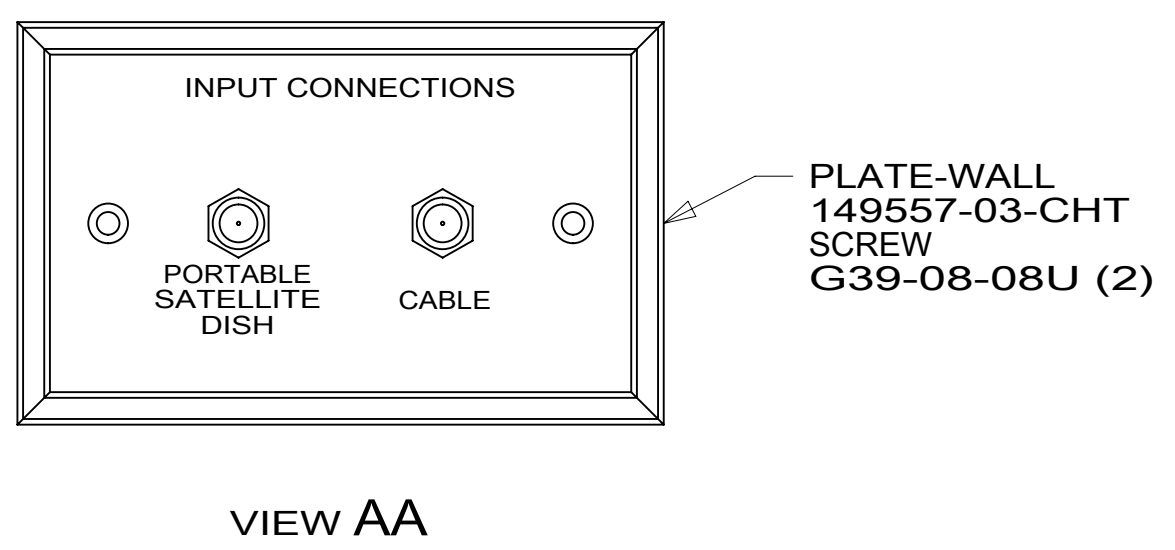

FOR ELECTRICAL TORQUE SPECIFICATIONS SEE DWG NO. 128783-01-000

X-X FOR ELECTRICAL CALLOUTS SEE DWG NO. 121339-01-000

- 299 PANEL-RECEPTACLE 151376-06-CHT SCREW G39-10-12U (4) PLATE-WALL 149557-08-CHT PLATE-WALL 149557-13-CHT PLATE-WALL,HDMI 175530-04-CHT

- CLED-1 10 BRACKET-MOUNTING, COMPT LAMP SCREW G39-10-12U (36)

- 299 ENTERTAINMENT CENTER EXT.W/O
- 265 CODES/STANDARDS-CSA/CMVSS
- 1B1 CODES/STANDARDS USA

1B1 265

COPYRIGHT 2016 WINNEBAGO INDUSTRIES, INC.

DSNR:		ALL DIMENSIONS ARE IN MILLIMETERS	
DFFR:			
UNSPECIFIED TOLERANCES:		MATERIAL:	
WHOLE DIM (X)	3		
ONE-PLACE (X.X)	1.5		
TWO-PLACE (X.XX)	0.50		
ANGLE	1°		
REFER TO ES0018 FOR FASTENER TIGHTENING GUIDELINES		WEIGHT: (LBS)	FIRST USED:
			19 L36G
DESCRIPTION: WIRING INSTL-BODY, 12V			
SHEET: 1 OF 8	ITEM/PART NO: 000166644 / 32980701000	REV:	
REF:		1	16-Apr-2019

8 7 6 5 4 3 2 1

8 7 6 5 4 3 2 1

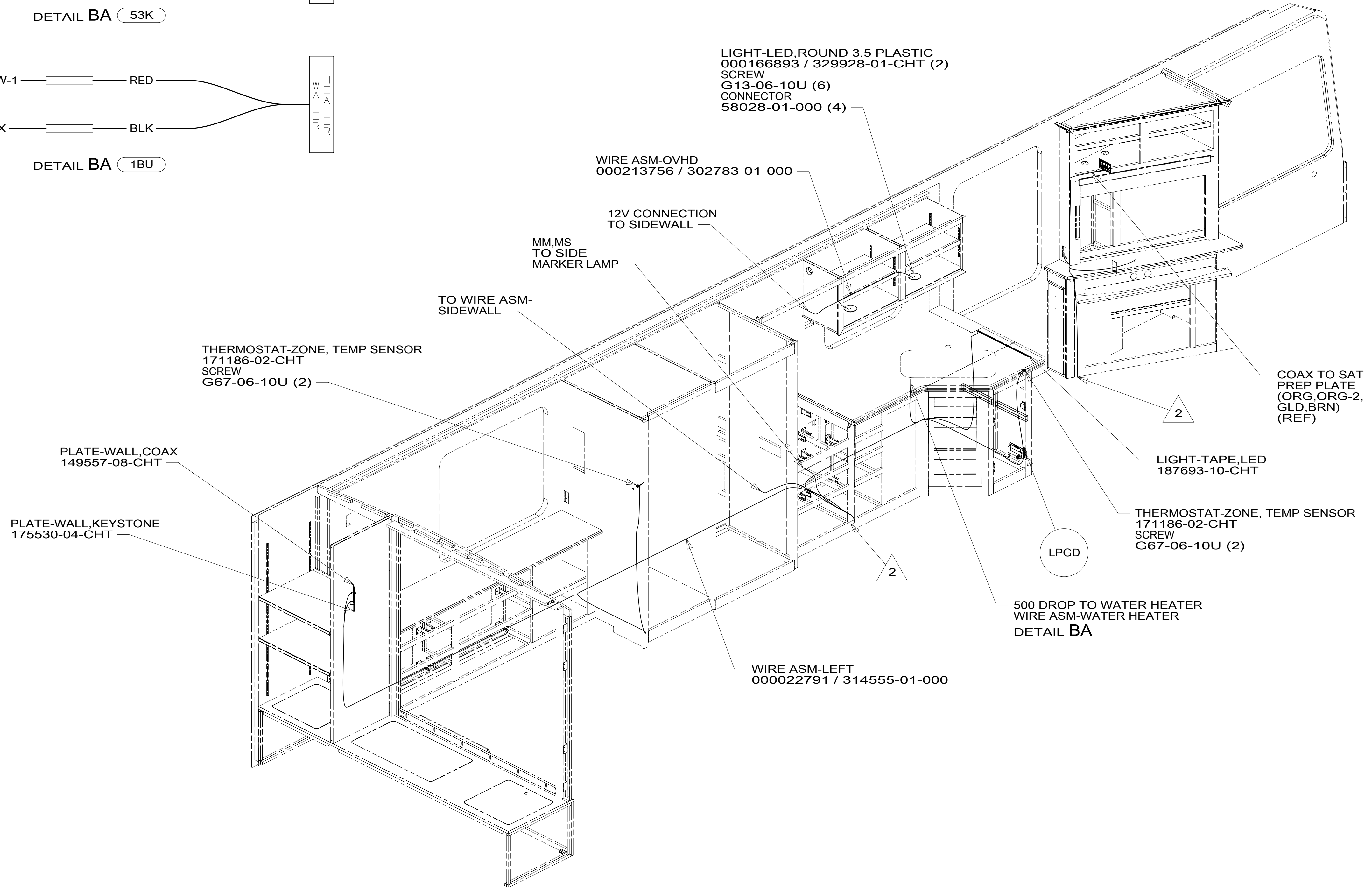
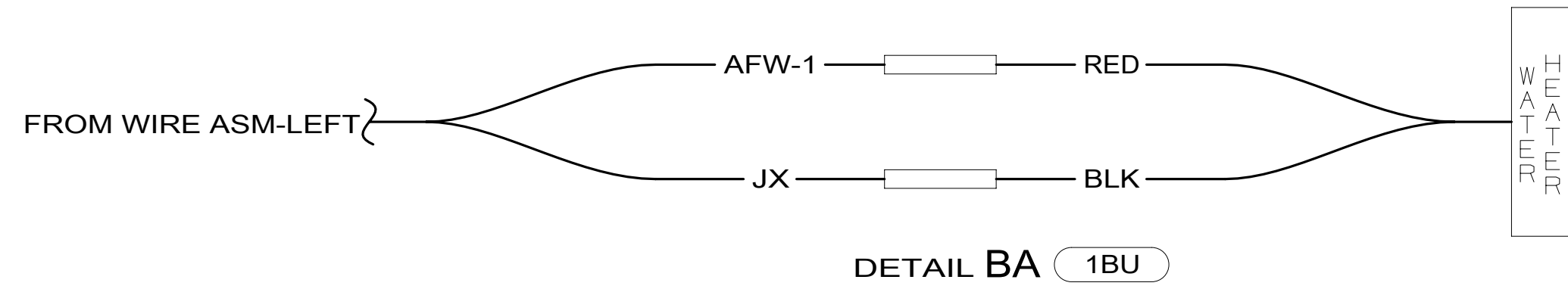
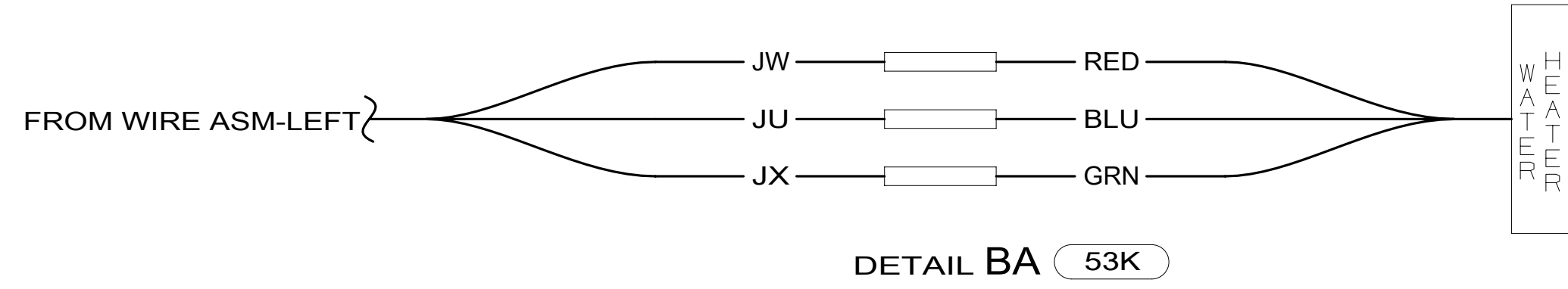

2 WIRE PASSES THROUGH FLOOR IN THIS AREA.

1. AT MINIMUM ALL WIRES TO BE SUPPORTED AND SECURED PER CODE REQUIREMENTS. USE CLAMP 10495 OR 10497 OR WIRE TIE 8343 OR 108046 AND SCREW G67-XX-XXX OR G56-XX-XXX AS APPROPRIATE FOR INSTALLATION.

NOTES:

FOR ELECTRICAL TORQUE SPECIFICATIONS SEE DWG NO. 128783-01-000

FOR ELECTRICAL CALLOUTS SEE DWG NO. 121339-01-000

- 1BU WTR HTR TKLS W/RECIRCUL PUMP
- 53K WTR HTR-10GAL/ELECTRIC/LPGAS
- 265 CODES/STANDARDS-CSA/CMVSS
- 1B1 CODES/STANDARDS USA

DESCRIPTION:		1B1 265	
WIRING INSTL-BODY, 12V			
SHEET:	ITEM/PART NO.:	REV:	
2 OF 8	000166644 / 32980701000		

8 7 6 5 4 3 2 1 16-Apr-2019

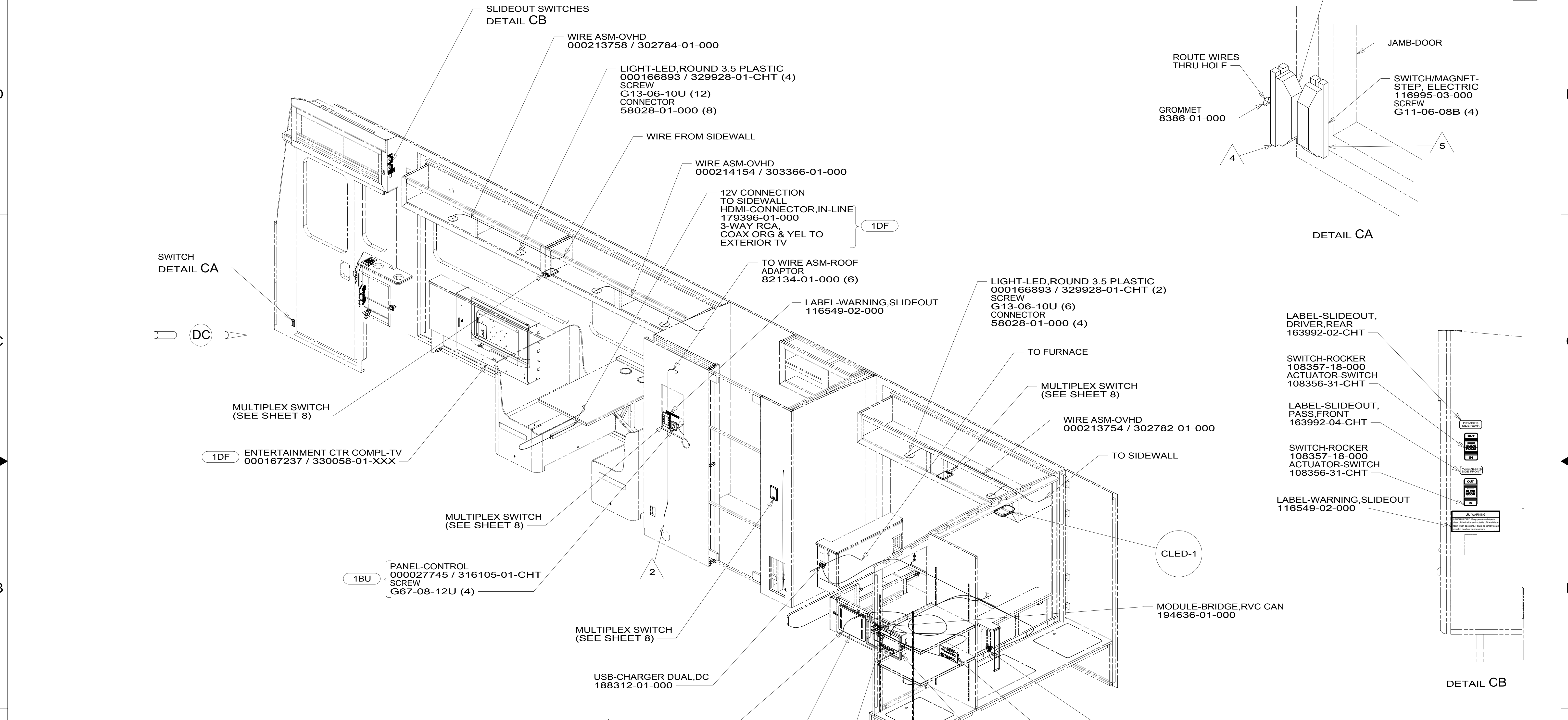
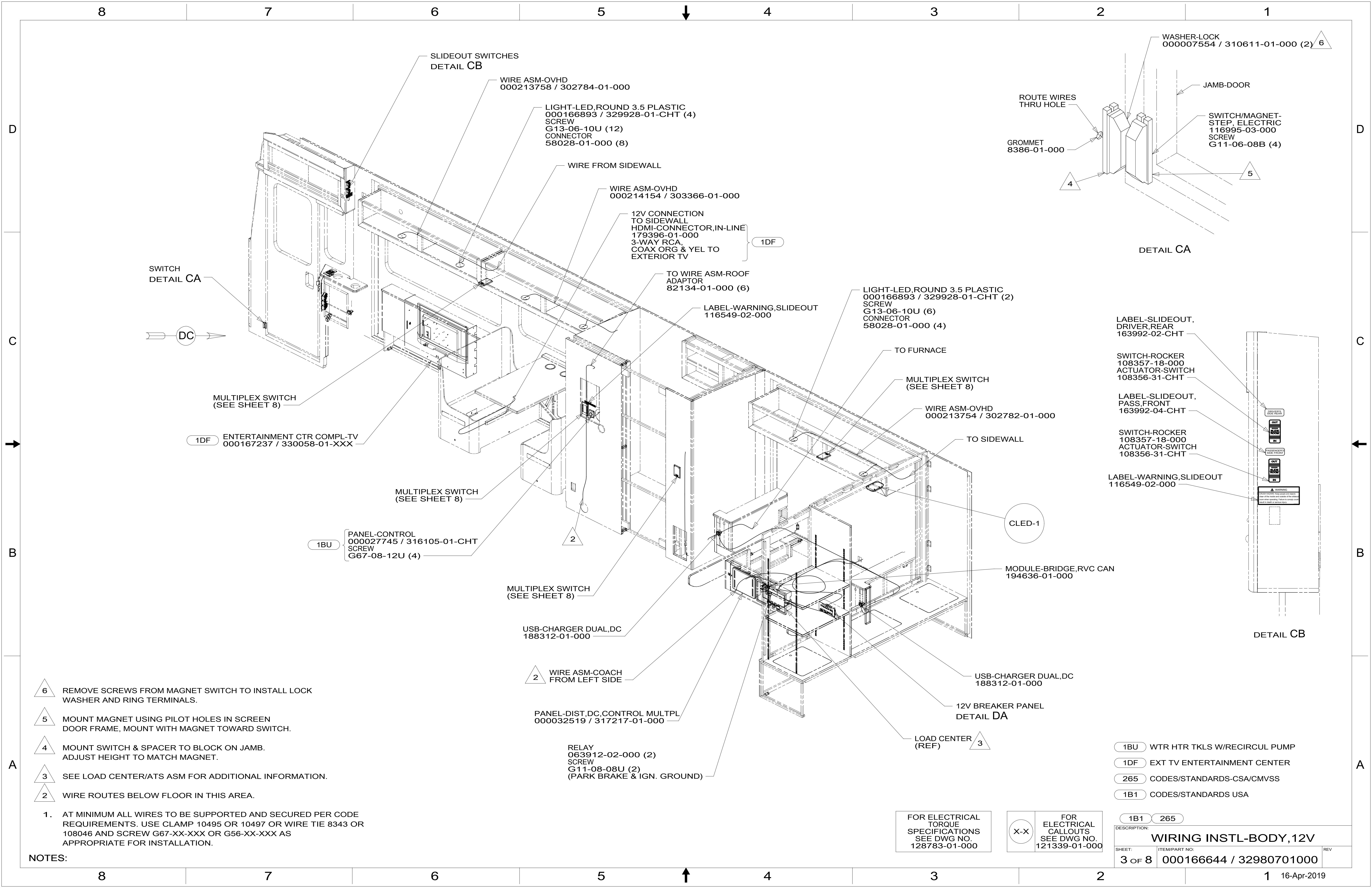

- 6 REMOVE SCREWS FROM MAGNET SWITCH TO INSTALL LOCK WASHER AND RING TERMINALS.
- 5 MOUNT MAGNET USING PILOT HOLES IN SCREEN DOOR FRAME, MOUNT WITH MAGNET TOWARD SWITCH.
- 4 MOUNT SWITCH & SPACER TO BLOCK ON JAMB. ADJUST HEIGHT TO MATCH MAGNET.
- 3 SEE LOAD CENTER/ATS ASM FOR ADDITIONAL INFORMATION.
- 2 WIRE ROUTES BELOW FLOOR IN THIS AREA.

1. AT MINIMUM ALL WIRES TO BE SUPPORTED AND SECURED PER CODE REQUIREMENTS. USE CLAMP 10495 OR 10497 OR WIRE TIE 8343 OR 108046 AND SCREW G67-XX-XXX OR G56-XX-XXX AS APPROPRIATE FOR INSTALLATION.

NOTES:

FOR ELECTRICAL TORQUE SPECIFICATIONS SEE DWG NO. 128783-01-000

FOR ELECTRICAL CALLOUTS SEE DWG NO. 121339-01-000

- 1BU WTR HTR TKLS W/RECIRCUL PUMP
- 1DF EXT TV ENTERTAINMENT CENTER
- 265 CODES/STANDARDS-CSA/CMVSS
- 1B1 CODES/STANDARDS USA

DESCRIPTION: WIRING INSTL-BODY, 12V	
SHEET: 3 OF 8	ITEM/PART NO.: 000166644 / 32980701000
REV 16-Apr-2019	

8 7 6 5 4 3 2 1

CIRCUIT BREAKER
93654-02-000 (8)
(15 AMP)
SCREW
G52-06-04U (8)
WASHER
OME02B-04-071 (8)

HOUSE 12V CIRCUIT BREAKERS
(PUSH TO RESET)

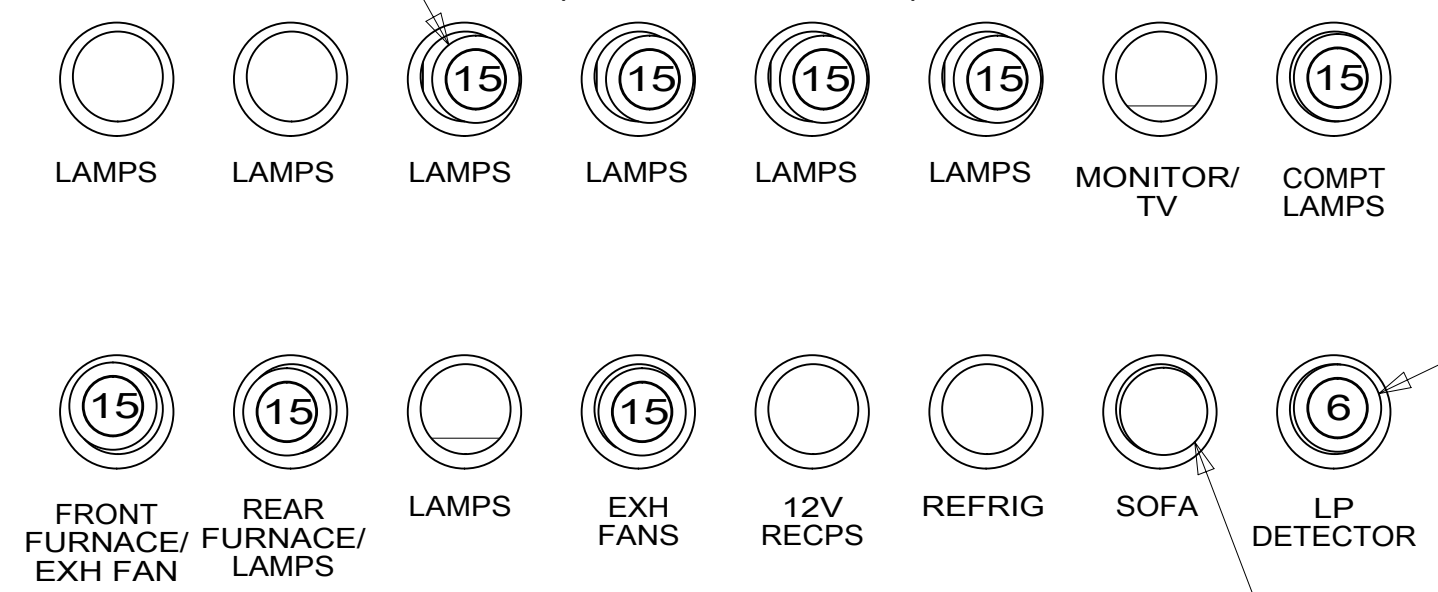
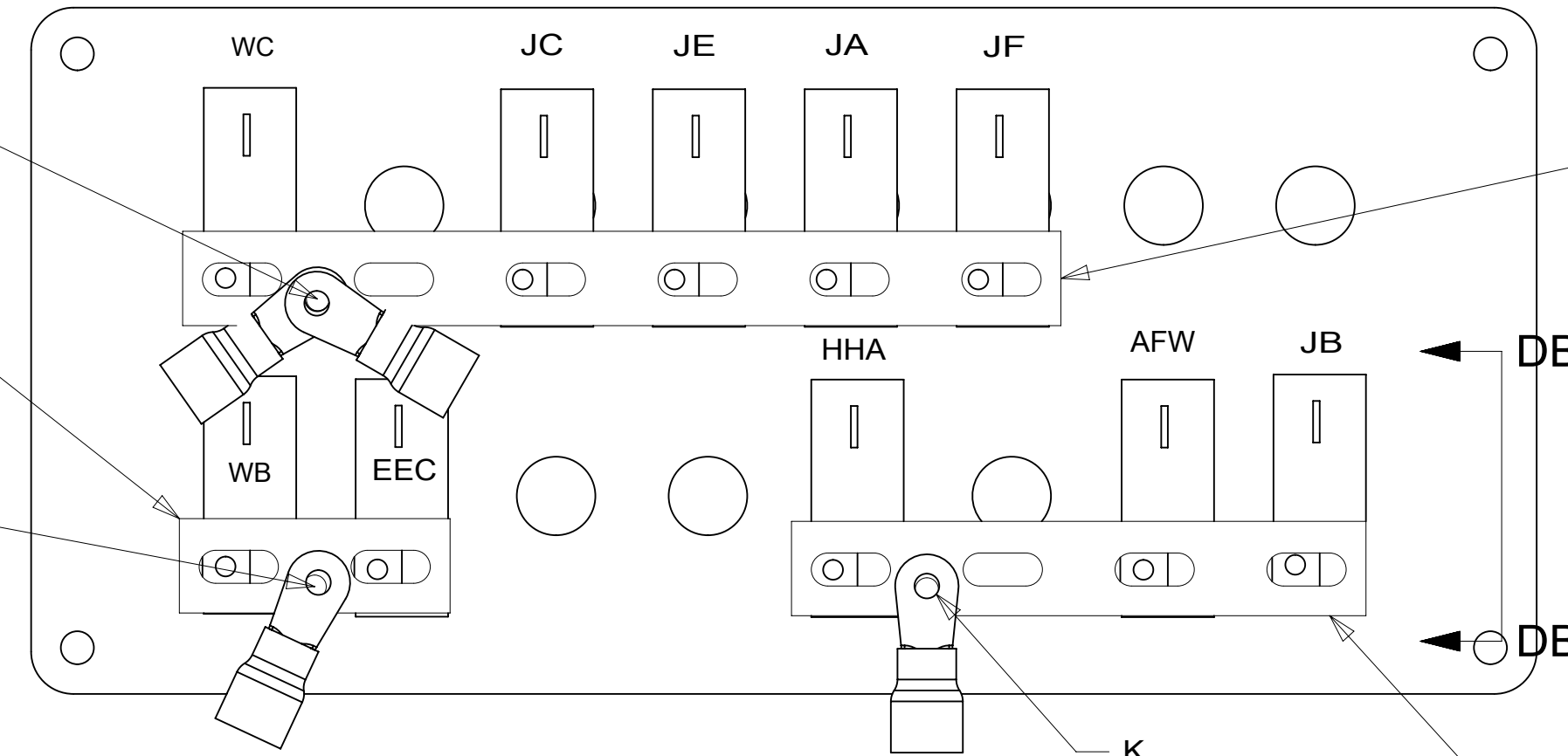

PLATE
139067-05-CHT
LABEL
92547-13-000
SCREW
G11-10-12U (4)

CIRCUIT BREAKER
93654-01-000
(6 AMP)
SCREW
G52-06-04U
WASHER
OME02B-04-071

CIRCUIT BREAKER
182283-01-000
(20 AMP)
SCREW
G52-06-04U
WASHER
OME02B-04-071

DETAIL DA
(FRONT VIEW)



J
6 BLK
FROM WIRE
ASM-CHASSIS
SCREW
G39-08-06U

BUSS BAR
141744-01-000
SCREW
G39-08-06U

J-1
6 BLK
(FROM WIRE
ASM-CHASSIS)

BUSS BAR
141744-05-000
SCREW
G39-08-06U

K
6 BLK
FROM WIRE
ASM-CHASSIS
SCREW
G39-08-06U

BUSS BAR
141744-03-000
SCREW
G39-08-06U

DETAIL DA
(BACK VIEW)

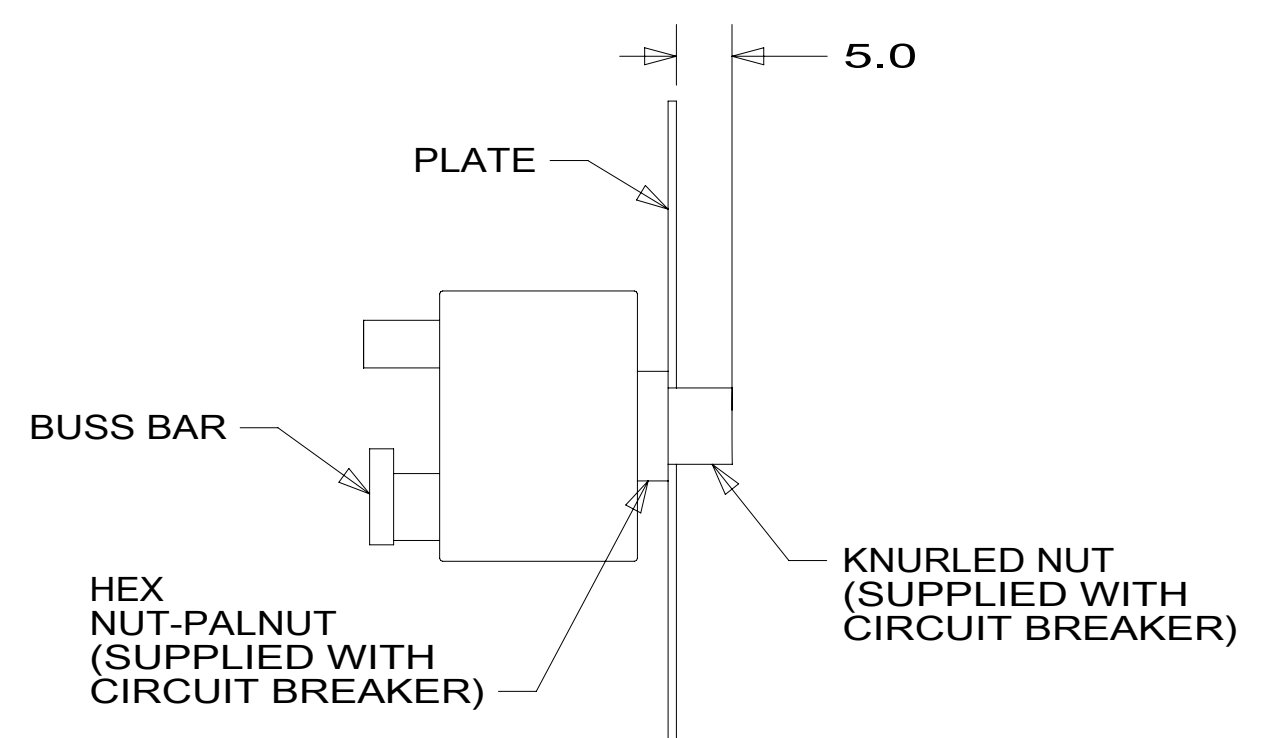

VIEW DB-DB

PLATE-SWITCH
176859-10-CHT
SCREW
G11-10-12U (4)
PANEL-SWITCH
MOUNTING,3-WAY
174834-01-CHT (2)

SWITCH-STEP COVER
174757-08-CHT

SWITCH-DOME LIGHT
145638-04-CHT

MULTIPLEX-SWITCH
(SEE SHEET 8)

SWITCH-PATIO
AWNING CONTROL
174757-03-CHT

SWITCH-AWNING POWER
174757-19-CHT

SWITCH-BLANK
145754-01-CHT

SWITCH-BLANK
145754-01-CHT

SWITCH-AUTO LEVEL
174757-04-CHT

SWITCH-CHASSIS
BATT DISC
174757-06-CHT
WIRE ASM-THERM
186796-01-000

SWITCH-ENTRY STEP
174757-27-CHT

SWITCH-COACH
BATT DISC
174757-07-CHT
WIRE ASM-THERM
186796-01-000

DETAIL DC

PLATE-SWITCH
000210580 / 303169-01-CHT
SCREW
G11-10-12U (6)

RELAYS
(AWNING IGNITION LOCKOUT,
PATIO AWNING)
063912-02-000 (3)
SCREW
G11-08-08U (3)

SWITCH-DOOR AWNING
174757-09-CHT

USB-CHARGER DUAL,DC
188312-01-000

PANEL-SWITCH
MOUNTING,3-WAY
174834-02-CHT

PANEL-SWITCH
MOUNTING,3-WAY
174834-02-CHT

PLATE-SWITCH
000210580 / 303169-01-CHT
SCREW
G11-10-12U (6)

265 CODES/STANDARDS-CSA/CMVSS

1B1 CODES/STANDARDS USA

1B1 265

FOR ELECTRICAL
TORQUE
SPECIFICATIONS
SEE DWG NO.
128783-01-000

X-X
FOR ELECTRICAL
CALLOUTS
SEE DWG NO.
121339-01-000

DESCRIPTION: WIRING INSTL-BODY, 12V		
SHEET: 4 OF 8	ITEM/PART NO: 000166644 / 32980701000	REV
16-Apr-2019		

D

D

C

C

B

B

A

A

8 7 6 5 4 3 2 1

8 7 6 5 4 3 2 1



D

D

C

C

B

B

A

A

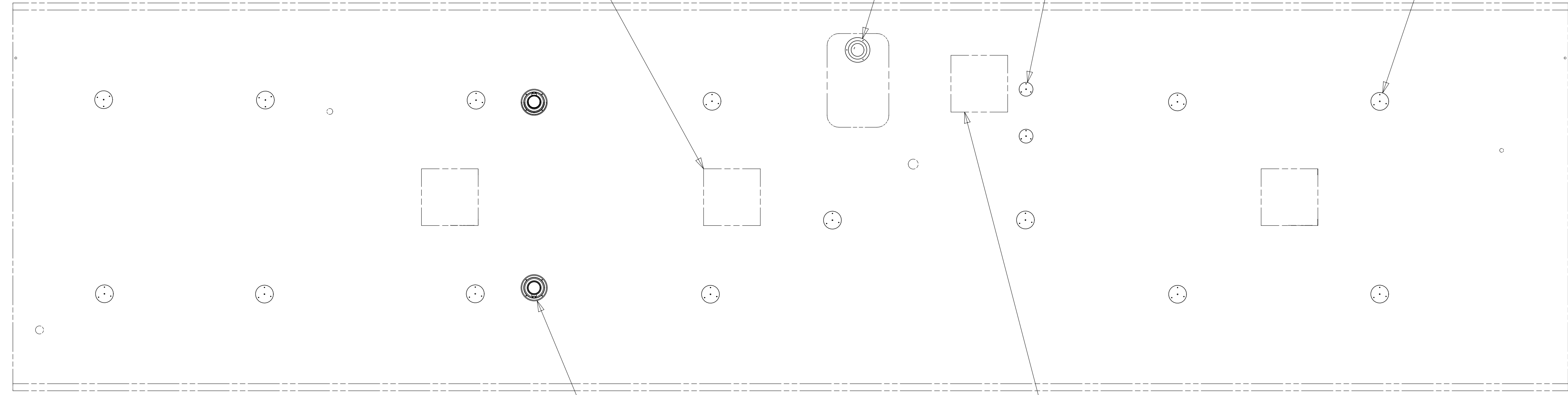

WIRE ASM-VENT FAN
000018695 / 313682-01-000

LSH-3

LIGHT-LED,ROUND 3.5 PLASTIC
000166893 / 329928-01-CHT (2)
SCREW
G13-06-10U (6)
CONNECTOR
58028-01-000 (4)

LIGHT-LED,ROUND 4.5 PLASTIC
000166889 / 329926-01-CHT (14)
SCREW
G13-06-16U (42)
CONNECTOR
58028-01-000 (28)

SPEAKER-5-1/4"
180783-01-CHT (2)
SCREW
G11-08-12U (8) } 571

WIRE ASM-VENT FAN
000018695 / 313682-01-000

8 7 6 5 4 3 2 1



- 571 RADIO SPEAKERS
- 265 CODES/STANDARDS-CSA/CMVSS
- 1B1 CODES/STANDARDS USA

FOR ELECTRICAL
TORQUE
SPECIFICATIONS
SEE DWG NO.
128783-01-000

X-X
FOR
ELECTRICAL
CALLOUTS
SEE DWG NO.
121339-01-000

DESCRIPTION:		1B1 265	
WIRING INSTL-BODY, 12V			
SHEET:	ITEM/PART NO.:	REV	
5 OF 8	000166644 / 32980701000		

8

7

6

5

4

3

2

1

THE SATELLITE DISH AND WIRE CONNECTIONS ARE TO BE PLACED ON THE CENTERLINE OF THE MOTORHOME FACING FORWARD.

SEPARATE CABLES AND INSTALL WIRE COVER OVER HOLE IN ROOF ASM WITH CABLES EXITING ON PASSENGERS SIDE.

WHEN APPLYING ROOF SEALANT TO SATELLITE DISH, PLACE ROOF SEALANT HERE (APPROX. 75MM WIDE) AND PUSH THE CABLES INTO THE SEALANT TO STABILIZE THEM.

CONNECT CABLE ASM-COAX FROM ROOF ASM TO COAX CABLES ON SATELLITE DISH AND CONNECT 10' CABLE-DATA FROM ROOF ASM TO DATA CABLE FROM SATELLITE DISH AND PLACE ALL CONNECTIONS BACK INTO ROOF ASM.

ANTENNA-SATELLITE
000169776 / 330860-01-000
SCREW
G39-08-12U (9)
(FOR SATELLITE DISH)
G67-10-12U (8)
(FOR ENTRY PLATE SUPPLIED WITH DISH)

1 787 DA-4
DETAIL GA

ANTENNA-TV, OMNIDIRECTIONAL
000171487 / 331386-01-CHT
SCREW
G67-10-16U (4)

DETAIL GA

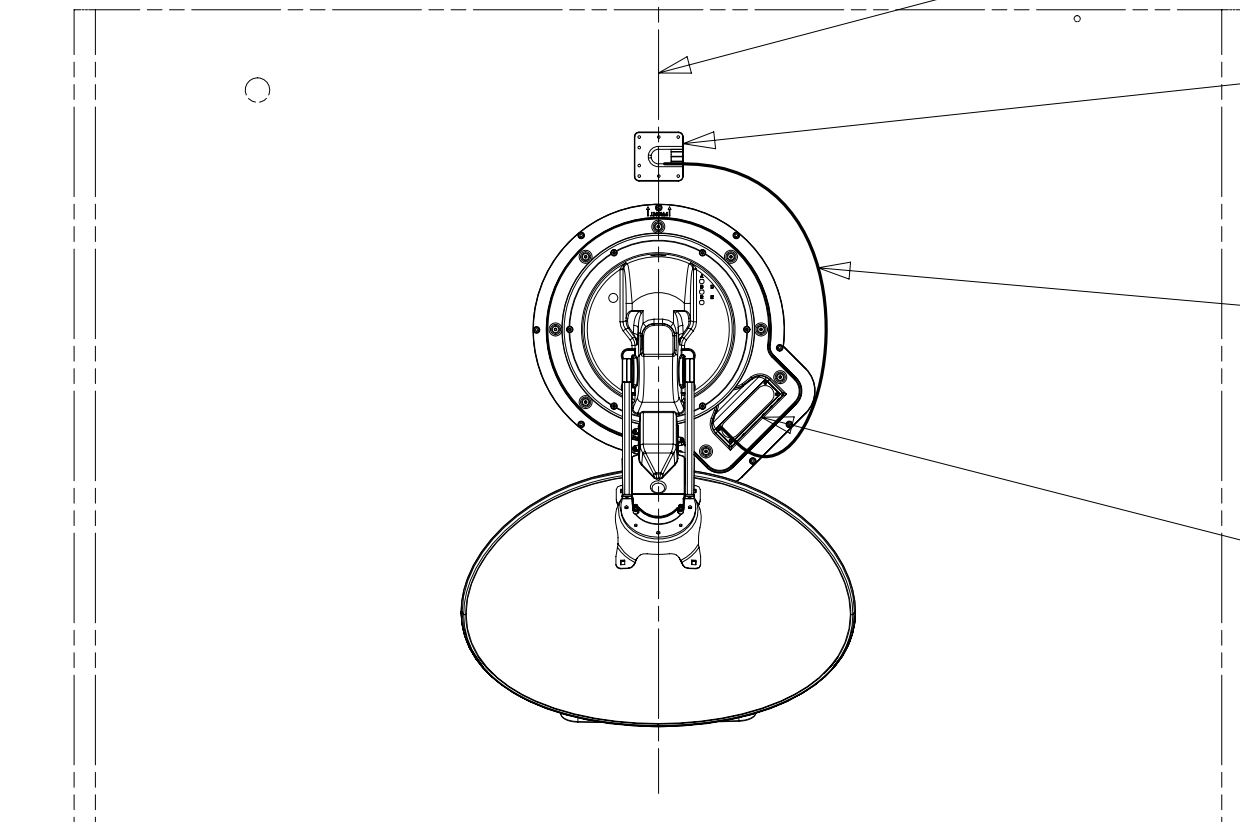
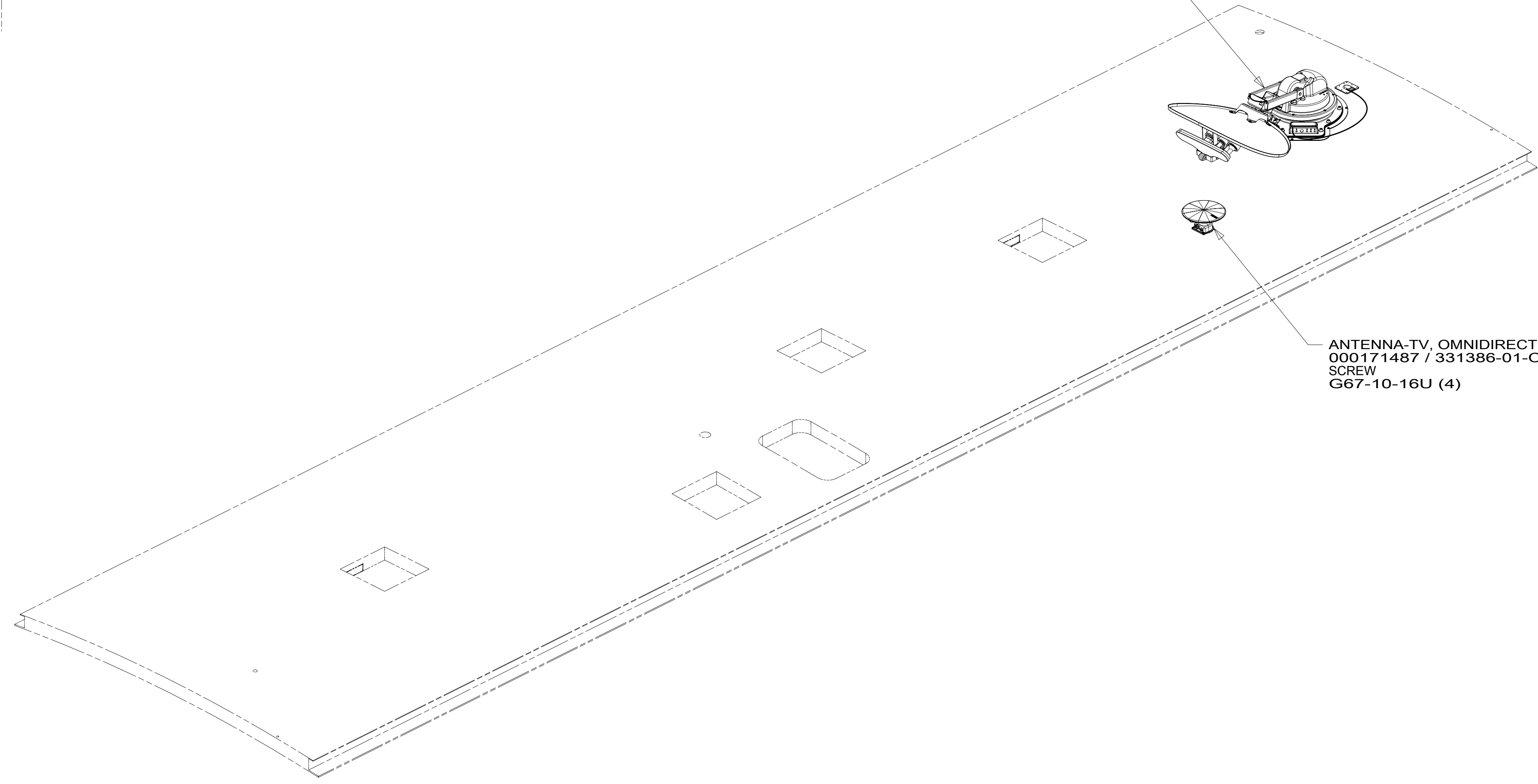

- 787 SAT ANT, AUTO DISH NETWORK
- 787 SAT TV ANT, AUTO DIRECTV
- 265 CODES/STANDARDS-CSA/CMVSS
- 1B1 CODES/STANDARDS USA

1 SEE MANUFACTURER'S INSTALLATION FOR ADDITIONAL INFORMATION.

FOR ELECTRICAL TORQUE SPECIFICATIONS SEE DWG NO. 128783-01-000

FOR ELECTRICAL CALLOUTS SEE DWG NO. 121339-01-000

DESCRIPTION:		1B1 265	
WIRING INSTL-BODY, 12V			
SHEET:	ITEM/PART NO.:	REV	
6 OF 8	000166644 / 32980701000		

NOTES:

8

7

6

5

4

3

2

1

16-Apr-2019

8 7 6 5 4 3 2 1

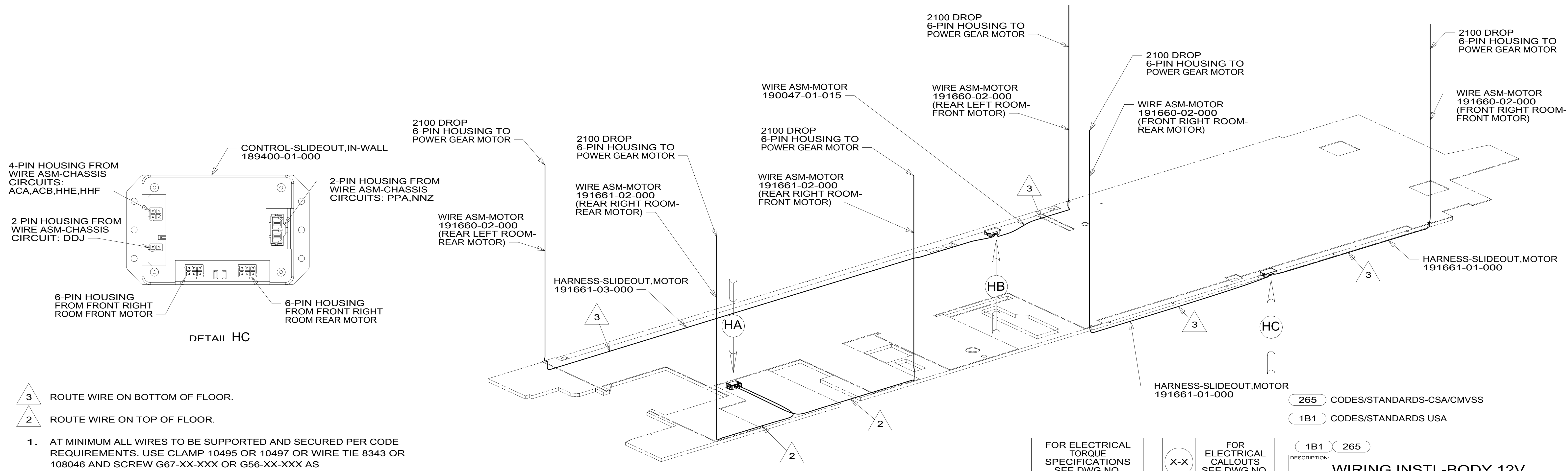
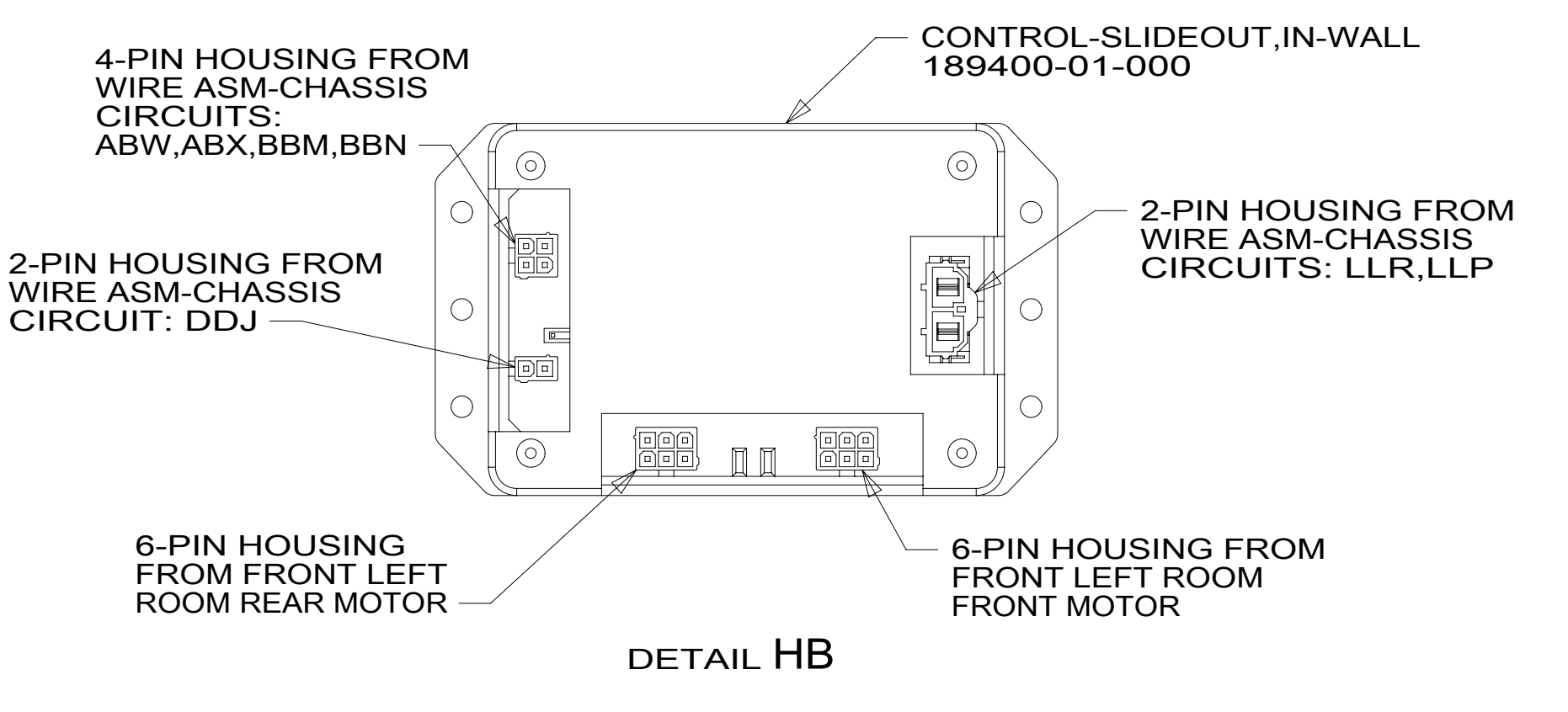
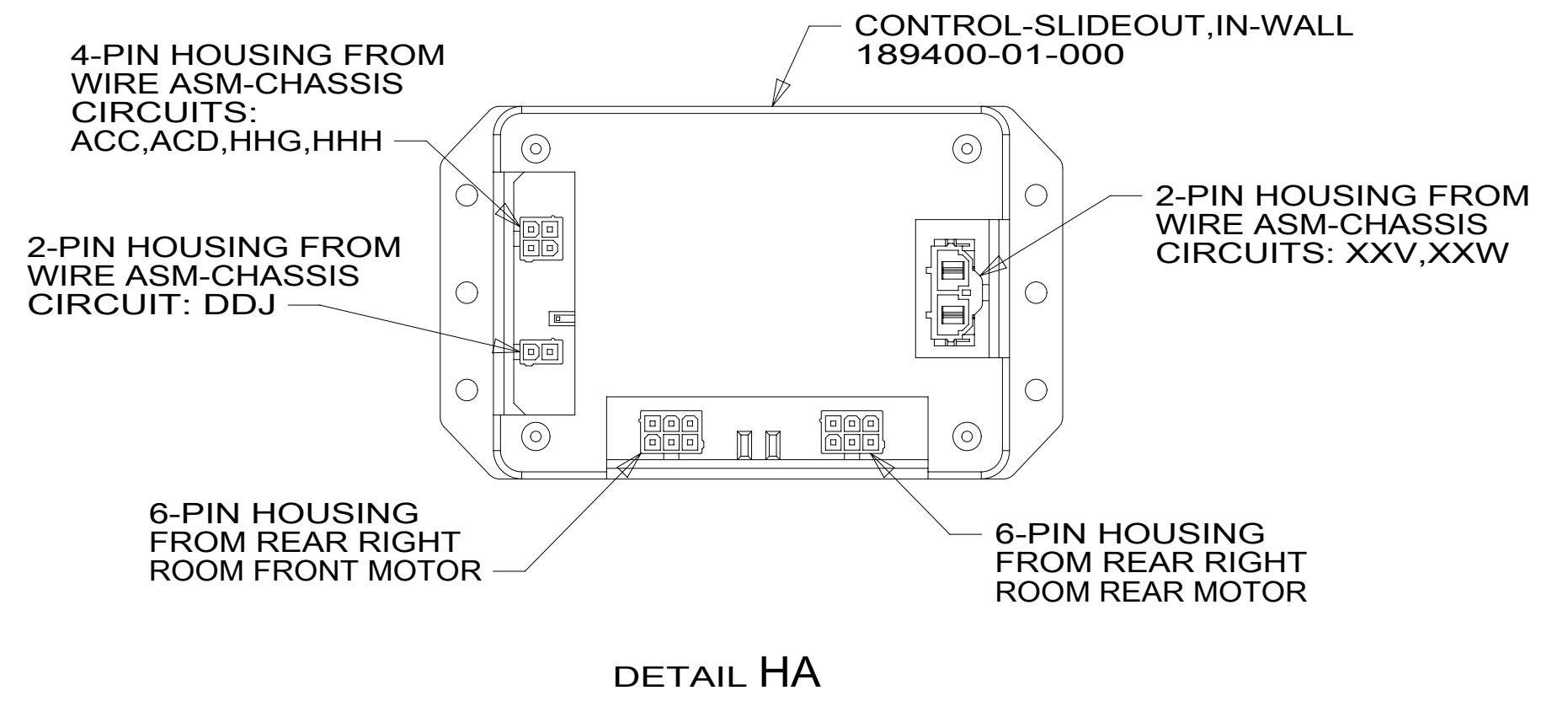
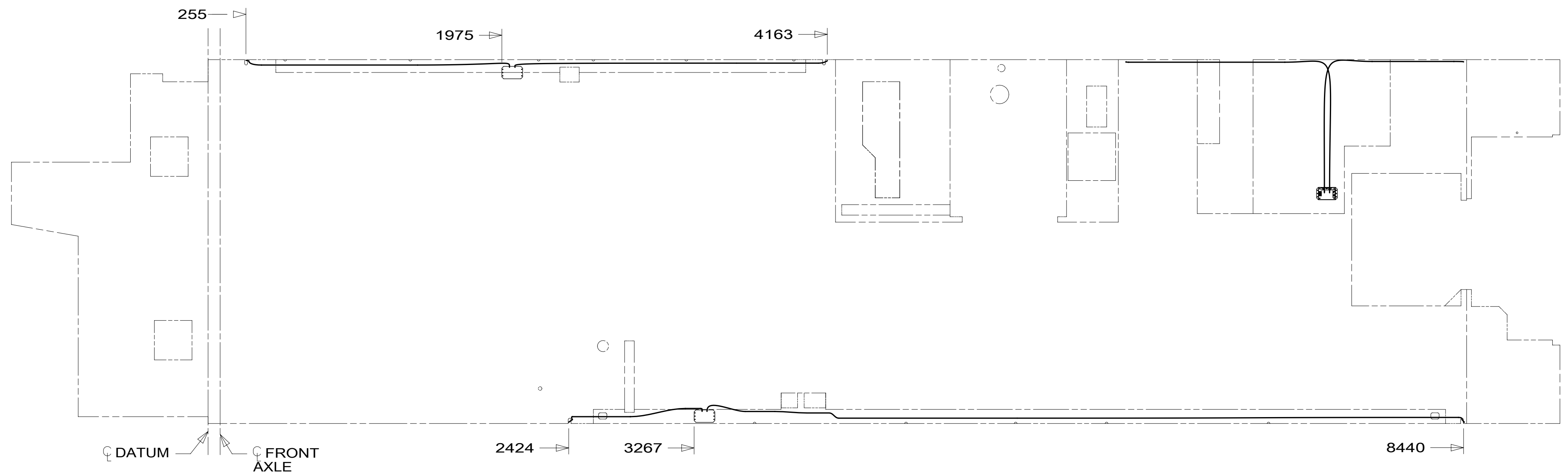

- 3 ROUTE WIRE ON BOTTOM OF FLOOR.
- 2 ROUTE WIRE ON TOP OF FLOOR.

1. AT MINIMUM ALL WIRES TO BE SUPPORTED AND SECURED PER CODE REQUIREMENTS. USE CLAMP 10495 OR 10497 OR WIRE TIE 8343 OR 108046 AND SCREW G67-XX-XXX OR G56-XX-XXX AS APPROPRIATE FOR INSTALLATION.

NOTES:

FOR ELECTRICAL TORQUE SPECIFICATIONS SEE DWG NO. 128783-01-000

FOR ELECTRICAL CALLOUTS SEE DWG NO. 121339-01-000

265 CODES/STANDARDS-CSA/CMVSS
1B1 CODES/STANDARDS USA

DESCRIPTION:	1B1 265	
WIRING INSTL-BODY, 12V		
SHEET:	ITEM/PART NO.:	REV:
7 OF 8	000166644 / 32980701000	

8 7 6 5 4 3 2 1 16-Apr-2019

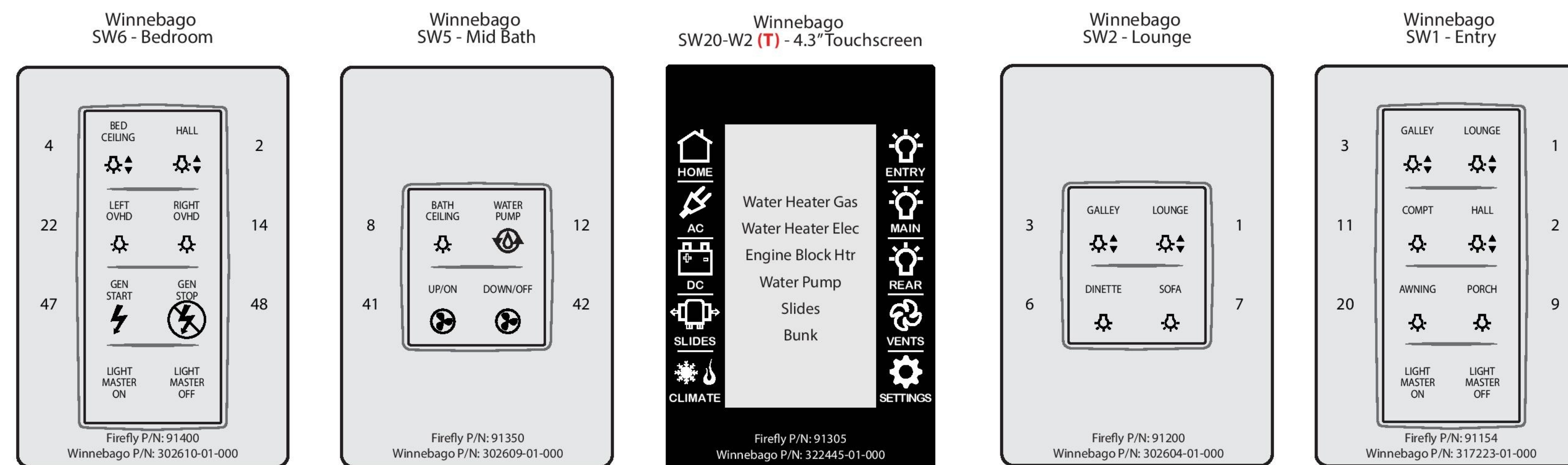
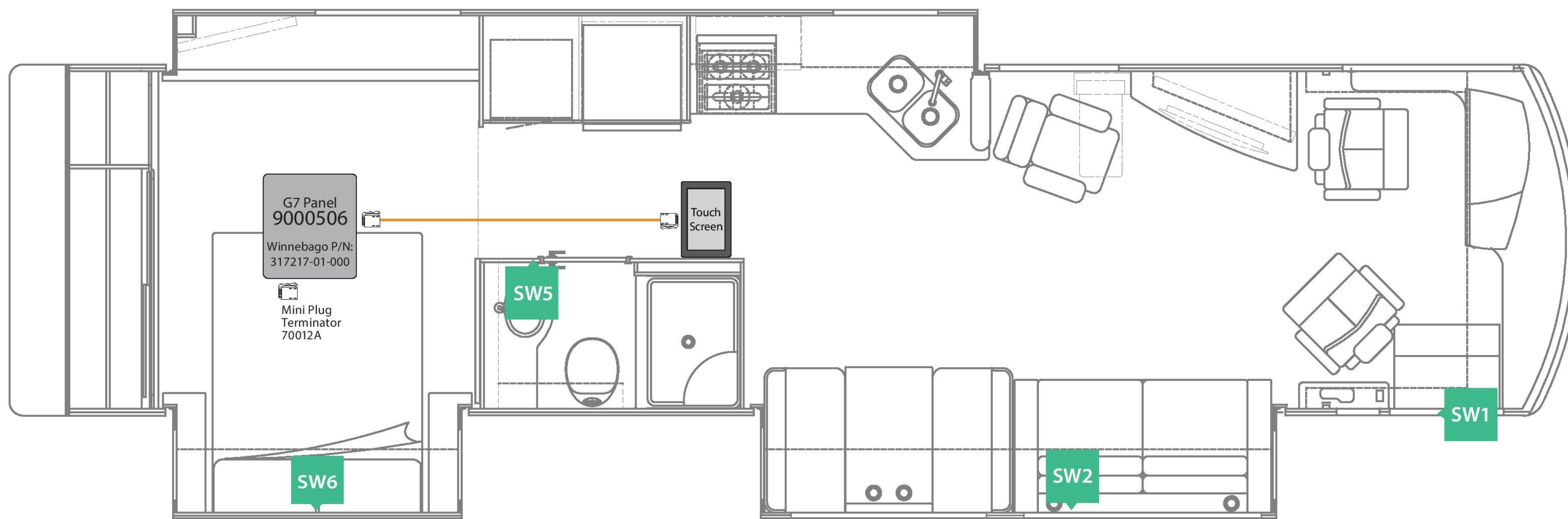

KIT*: Firefly P/N: 90851AC
 Winnebago P/N: 322448-01-000
 * Kits may not include all components shown on print.

WINNEBAGO - L36G - V3			DI: AD/MD	Network Legend Trunk Cable Drop Cable Switch Position	Drop Cable Connections Black Red Blue White
Network Wiring Diagram and Switch Panel Layout			PI: AD/AA		
SSP-17 & 4.3" Screen (6v9)	Rev. 0v1	05/10/17			

NOTES:
 1. ALL SWITCH PANELS ARE PART OF KIT # 000118590 / 322448-01-000.

FOR ELECTRICAL TORQUE SPECIFICATIONS SEE DWG NO. 128783-01-000

FOR ELECTRICAL CALLOUTS SEE DWG NO. 121339-01-000

265 CODES/STANDARDS-CSA/CMVSS
 1B1 CODES/STANDARDS USA

DESCRIPTION:	1B1 265
WIRING INSTL-BODY, 12V	
SHEET: 8 OF 8	ITEM/PART NO: 000166644 / 32980701000
REV	