

VIEW AA

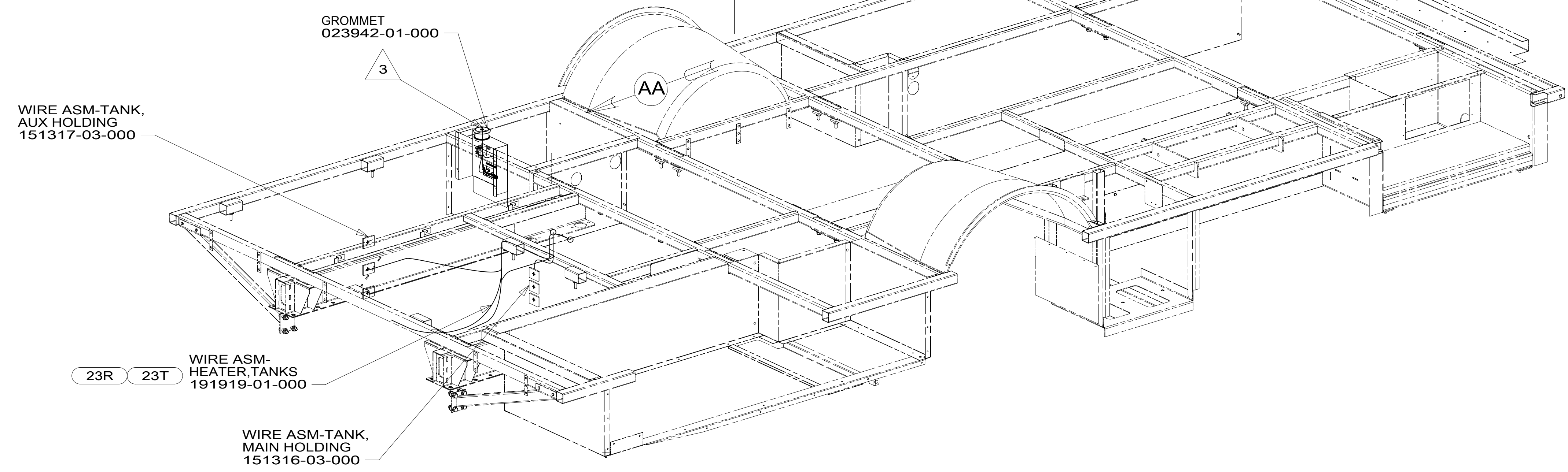
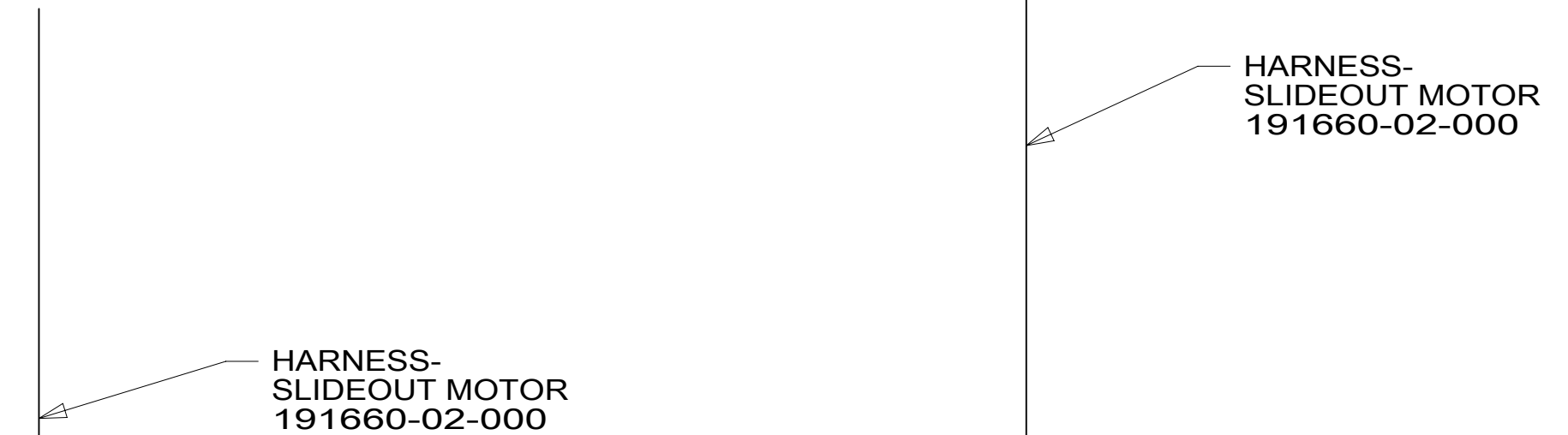

- 3 WIRE PASSES THROUGH FLOOR IN THIS AREA.
- 2 SPLICE YELLOW TO RED AND WHITE TO BLACK.

1. AT MINIMUM ALL WIRES TO BE SUPPORTED AND SECURED PER CODE REQUIREMENTS. USE CLAMP 10495 OR 10497 OR WIRE TIE 8343 OR 108046 AND SCREW G67-XX-XXX OR G56-XX-XXX AS APPROPRIATE FOR INSTALLATION.

NOTES:

- 23T DRAINAGE SYSTEM-HEATED
- 23R DRAINAGE SYSTEM/HEAT-PREWIRE
- 265 CODES/STANDARDS-CSA/CMVSS
- 1B1 CODES/STANDARDS USA

- 1B1 265



DSNR:	ALL DIMENSIONS ARE IN MILLIMETERS	
DIFTR:		
UNSPECIFIED TOLERANCES:	MATERIAL:	
WHOLE DIM (X) :	3	
ONE-PLACE (X.X) :	1.5	
TWO-PLACE (X.XX) :	0.50	
ANGLE :	1°	
REFER TO ES0018 FOR FASTENER TIGHTENING GUIDELINES	WEIGHT: (LBS)	FIRST USED:
		19 423F

FOR ELECTRICAL TORQUE SPECIFICATIONS SEE DWG NO. 128783-01-000

FOR ELECTRICAL CALLOUTS SEE DWG NO. 121339-01-000

DESCRIPTION:
WIRING INSTL-BODY, 12V

SHEET: 1 OF 6 ITEM/PART NO: 000155522 / 32641201000 REF: 1 07-Sep-2018

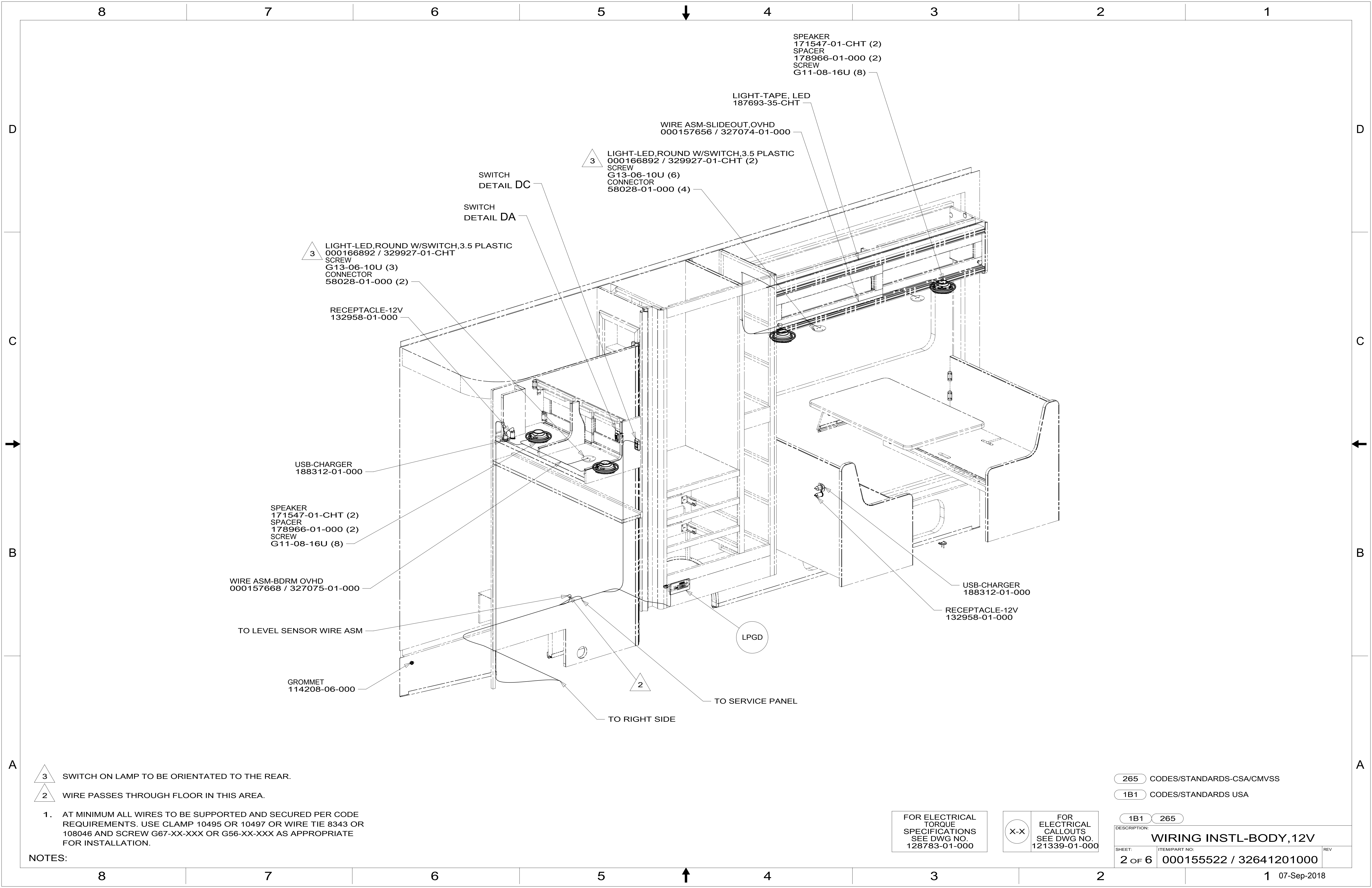

3 SWITCH ON LAMP TO BE ORIENTATED TO THE REAR.

2 WIRE PASSES THROUGH FLOOR IN THIS AREA.

1. AT MINIMUM ALL WIRES TO BE SUPPORTED AND SECURED PER CODE REQUIREMENTS. USE CLAMP 10495 OR 10497 OR WIRE TIE 8343 OR 108046 AND SCREW G67-XX-XXX OR G56-XX-XXX AS APPROPRIATE FOR INSTALLATION.

NOTES:

265 CODES/STANDARDS-CSA/CMVSS

1B1 CODES/STANDARDS USA

1B1 265

DESCRIPTION:

WIRING INSTL-BODY, 12V

SHEET: 2 OF 6

ITEM/PART NO: 000155522 / 32641201000

REV

FOR ELECTRICAL TORQUE SPECIFICATIONS SEE DWG NO. 128783-01-000

X-X

FOR ELECTRICAL CALLOUTS SEE DWG NO. 121339-01-000

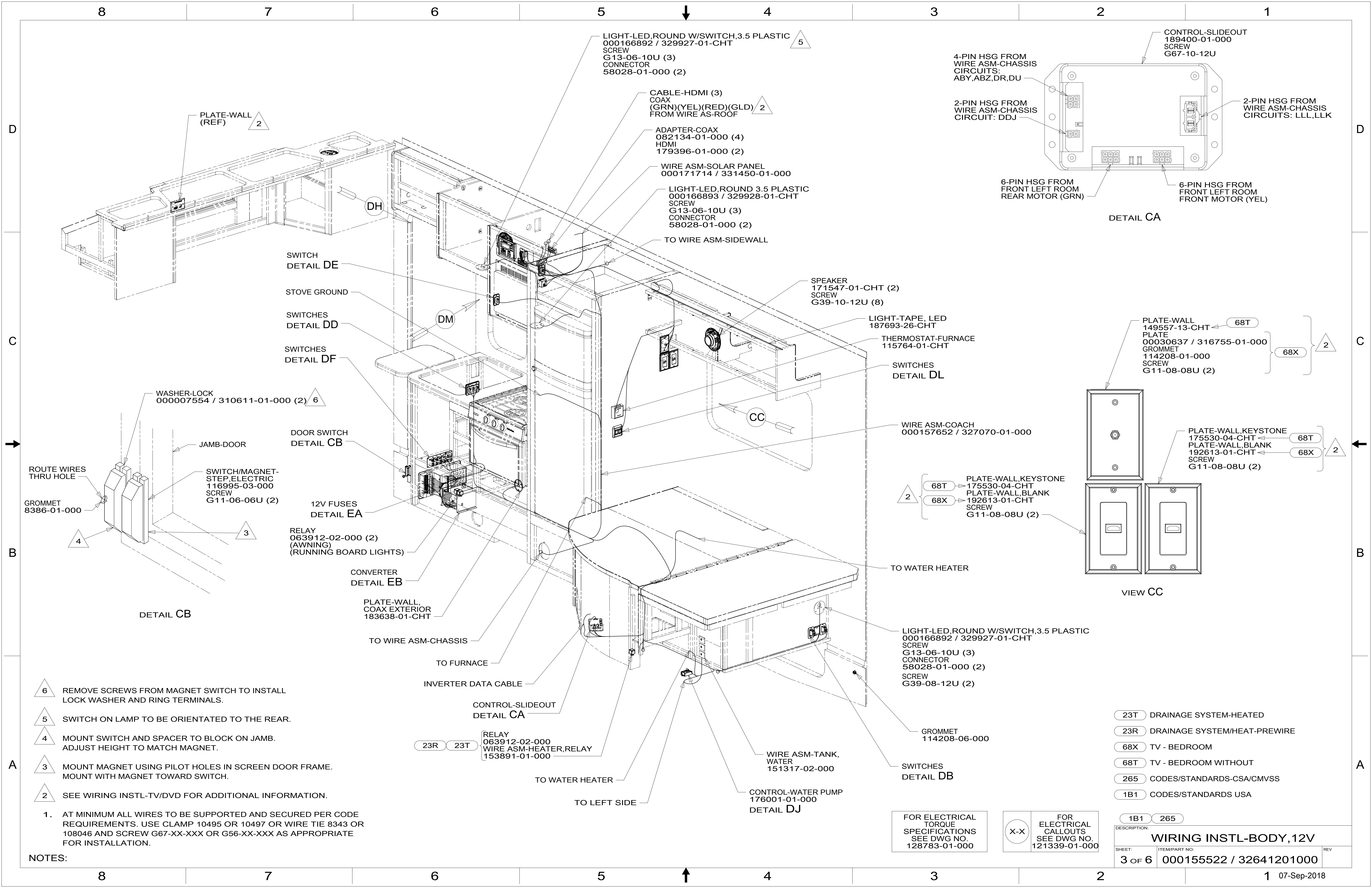

LIGHT-LED,ROUND W/SWITCH,3.5 PLASTIC
000166892 / 329927-01-CHT
SCREW
G13-06-10U (3)
CONNECTOR
58028-01-000 (2)

4-PIN HSG FROM
WIRE ASM-CHASSIS
CIRCUITS:
ABY,ABZ,DR,DU

CONTROL-SLIDEOUT
189400-01-000
SCREW
G67-10-12U

2-PIN HSG FROM
WIRE ASM-CHASSIS
CIRCUITS: LLL,LLK

6-PIN HSG FROM
FRONT LEFT ROOM
REAR MOTOR (GRN)

6-PIN HSG FROM
FRONT LEFT ROOM
FRONT MOTOR (YEL)

DETAIL CA

CABLE-HDMI (3)
COAX
(GRN)(YEL)(RED)(GLD) / 2
FROM WIRE AS-ROOF

ADAPTER-COAX
082134-01-000 (4)
HDMI
179396-01-000 (2)

WIRE ASM-SOLAR PANEL
000171714 / 331450-01-000

LIGHT-LED,ROUND 3.5 PLASTIC
000166893 / 329928-01-CHT
SCREW
G13-06-10U (3)
CONNECTOR
58028-01-000 (2)

TO WIRE ASM-SIDEWALL

SPEAKER
171547-01-CHT (2)
SCREW
G39-10-12U (8)

LIGHT-TAPE, LED
187693-26-CHT

THERMOSTAT-FURNACE
115764-01-CHT

SWITCHES
DETAIL DL

WIRE ASM-COACH
000157652 / 327070-01-000

68T PLATE-WALL,KEYSTONE
175530-04-CHT
68X PLATE-WALL,BLANK
192613-01-CHT
SCREW
G11-08-08U (2)

68T PLATE-WALL
149557-13-CHT
68X PLATE
00030637 / 316755-01-000
GROMMET
114208-01-000
SCREW
G11-08-08U (2)

68T PLATE-WALL,KEYSTONE
175530-04-CHT
68X PLATE-WALL,BLANK
192613-01-CHT
SCREW
G11-08-08U (2)

VIEW CC

TO WATER HEATER

LIGHT-LED,ROUND W/SWITCH,3.5 PLASTIC
000166892 / 329927-01-CHT
SCREW
G13-06-10U (3)
CONNECTOR
58028-01-000 (2)
SCREW
G39-08-12U (2)

GROMMET
114208-06-000

SWITCHES
DETAIL DB

WIRE ASM-TANK,
WATER
151317-02-000

CONTROL-WATER PUMP
176001-01-000
DETAIL DJ

TO WATER HEATER

TO LEFT SIDE

RELAY
063912-02-000
WIRE ASM-HEATER,RELAY
153891-01-000

CONTROL-SLIDEOUT
DETAIL CA

TO FURNACE

INVERTER DATA CABLE

TO WIRE ASM-CHASSIS

PLATE-WALL,
COAX EXTERIOR
183638-01-CHT

CONVERTER
DETAIL EB

RELAY
063912-02-000 (2)
(AWNING)
(RUNNING BOARD LIGHTS)

12V FUSES
DETAIL EA

DOOR SWITCH
DETAIL CB

JAMB-DOOR

SWITCH/MAGNET-
STEP ELECTRIC
116995-03-000
SCREW
G11-06-06U (2)

DETAIL CB

WASHER-LOCK
000007554 / 310611-01-000 (2) 6

ROUTE WIRES
THRU HOLE

GROMMET
8386-01-000

SWITCH
DETAIL DE

STOVE GROUND

SWITCHES
DETAIL DD

SWITCHES
DETAIL DF

PLATE-WALL
(REF) 2

PLATE-WALL
(REF) 2

- NOTES:
1. AT MINIMUM ALL WIRES TO BE SUPPORTED AND SECURED PER CODE REQUIREMENTS. USE CLAMP 10495 OR 10497 OR WIRE TIE 8343 OR 108046 AND SCREW G67-XX-XXX OR G56-XX-XXX AS APPROPRIATE FOR INSTALLATION.
 2. SEE WIRING INSTL-TV/DVD FOR ADDITIONAL INFORMATION.
 3. MOUNT MAGNET USING PILOT HOLES IN SCREEN DOOR FRAME. MOUNT WITH MAGNET TOWARD SWITCH.
 4. MOUNT SWITCH AND SPACER TO BLOCK ON JAMB. ADJUST HEIGHT TO MATCH MAGNET.
 5. SWITCH ON LAMP TO BE ORIENTATED TO THE REAR.
 6. REMOVE SCREWS FROM MAGNET SWITCH TO INSTALL LOCK WASHER AND RING TERMINALS.

- 23T DRAINAGE SYSTEM-HEATED
- 23R DRAINAGE SYSTEM/HEAT-PREWIRE
- 68X TV - BEDROOM
- 68T TV - BEDROOM WITHOUT
- 265 CODES/STANDARDS-CSA/CMVSS
- 1B1 CODES/STANDARDS USA

FOR ELECTRICAL
TORQUE
SPECIFICATIONS
SEE DWG NO.
128783-01-000

FOR
ELECTRICAL
CALLOUTS
SEE DWG NO.
121339-01-000

DESCRIPTION:	1B1 265	
WIRING INSTL-BODY, 12V		
SHEET:	ITEM/PART NO.:	REV
3 OF 6	000155522 / 32641201000	

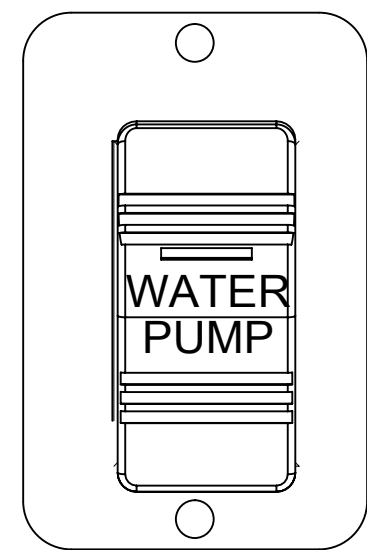

SWITCH-ROCKER
108357-21-000
ACTUATOR-SWITCH
108356-23-CHT
PLATE-SWITCH
144363-02-CHT
SCREW
G11-06-10U (2)

DETAIL DA

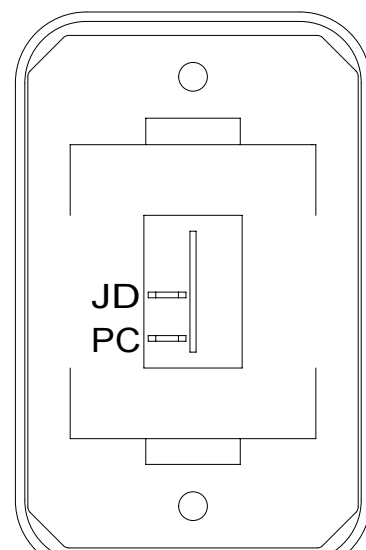

SWITCH-ROCKER
135740-01-CHT
SWITCH-BASE
135741-01-CHT
SWITCH-BEZEL
135742-01-CHT
SCREW
G11-08-08U (2)

DETAIL DE

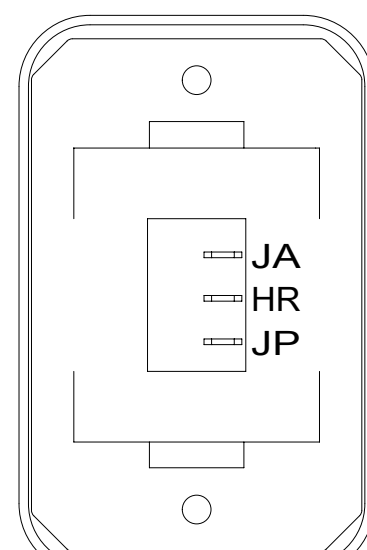

SWITCH-ROCKER
135740-06-CHT
SWITCH-BASE
135741-01-CHT
SWITCH-BEZEL
135742-01-CHT
SCREW
G11-08-08U (2)

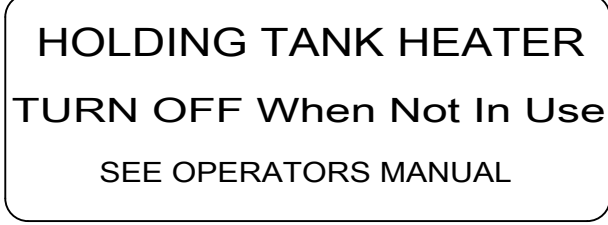

LABEL-SWITCH,
HTR,HOLDING TK
134563-01-CHT

DETAIL DG 23T 23R

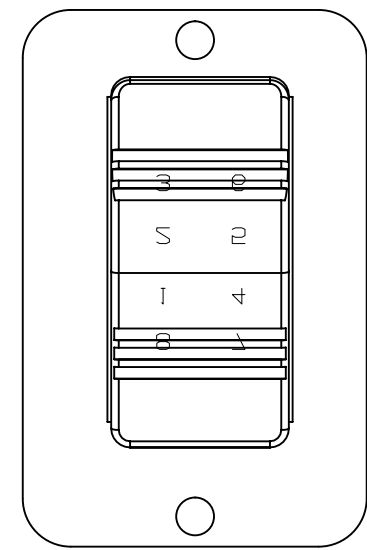

STABILIZERS
--- RETRACT ---

--- EXTEND ---
310651-01A

DETAIL DB

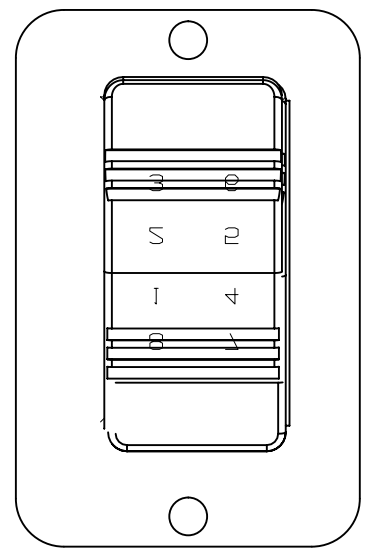

SWITCH-ROCKER
108357-06-000 (2)
ACTUATOR
108356-01-000 (2)
LABEL
000007799 / 310651-01-CHT
SWITCH-BLANK
096241-03-000 (2)
PLATE-SWITCH
144363-02-CHT (2)
SCREW
G11-08-08U (4)

64A

60T

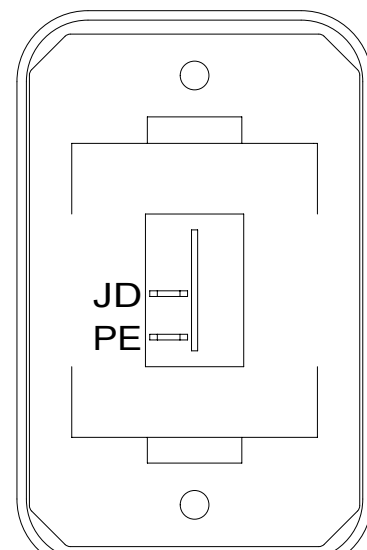

SWITCH-ROCKER
135740-01-CHT
SWITCH-BASE
135741-01-CHT
SWITCH-BEZEL
135742-01-CHT
SCREW
G11-08-08U (2)

DETAIL DC

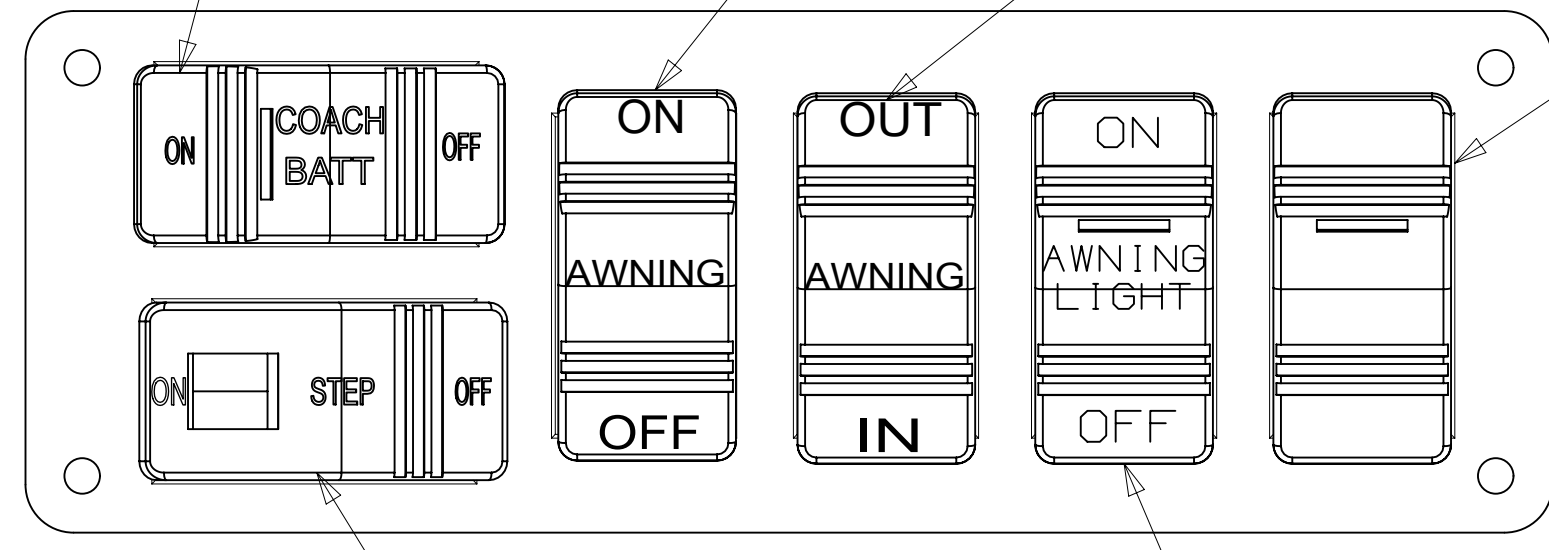

SWITCH-BATTERY
108357-18-000
ACTUATOR-SWITCH
108356-19-CHT
CIRCUITS LH,LG,
LJ-1,JC,NC
WIRE ASM-THERM
186796-01-000

SWITCH-ROCKER
108357-01-000
ACTUATOR-SWITCH
108356-22-CHT
CIRCUITS FFD,FFT

SWITCH-ROCKER
108357-06-000
ACTUATOR-SWITCH
108356-12-CHT
CIRCUITS FFN,FFP,FFR

SWITCH-ROCKER
108357-14-000
ACTUATOR-SWITCH
108356-03-000
CIRCUITS AES,AET,NC

PLATE-SWITCH
000022055 / 314395-01-CHT
SCREW
G11-06-10U (4)

SWITCH-ROCKER
108357-19-000
CIRCUITS ER,ES

SWITCH-ROCKER
108357-14-000
ACTUATOR-SWITCH
108356-28-CHT
CIRCUITS RS,ZZK,NC

DETAIL DF

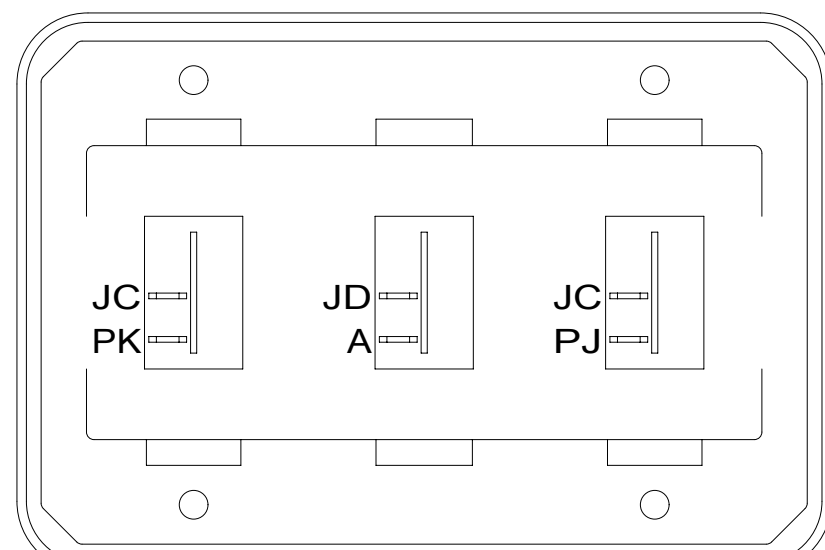

SWITCH-ROCKER
135740-01-CHT (3)
SWITCH-BASE
135741-03-CHT
SWITCH-BEZEL
135742-03-CHT
SCREW
G11-08-08U (4)

DETAIL DD

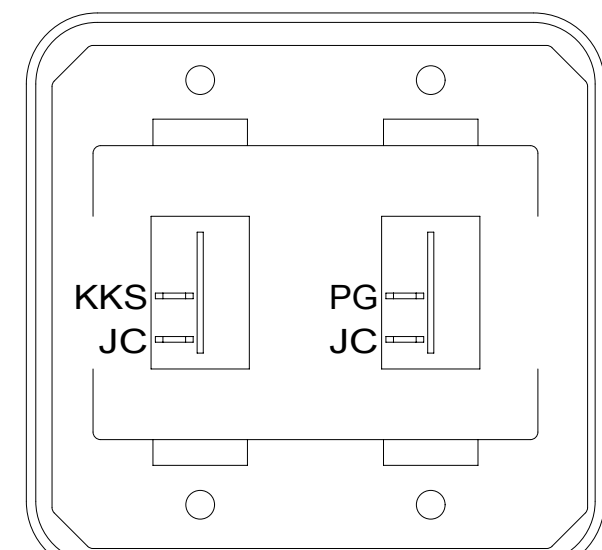

SWITCH-ROCKER
135740-01-CHT (2)
SWITCH-BASE
135741-02-CHT
SWITCH-BEZEL
135742-02-CHT
SCREW
G11-08-08U (4)

DETAIL DL

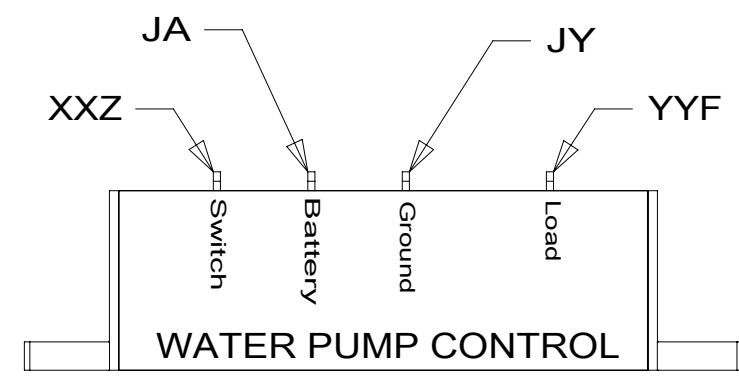

DETAIL DJ

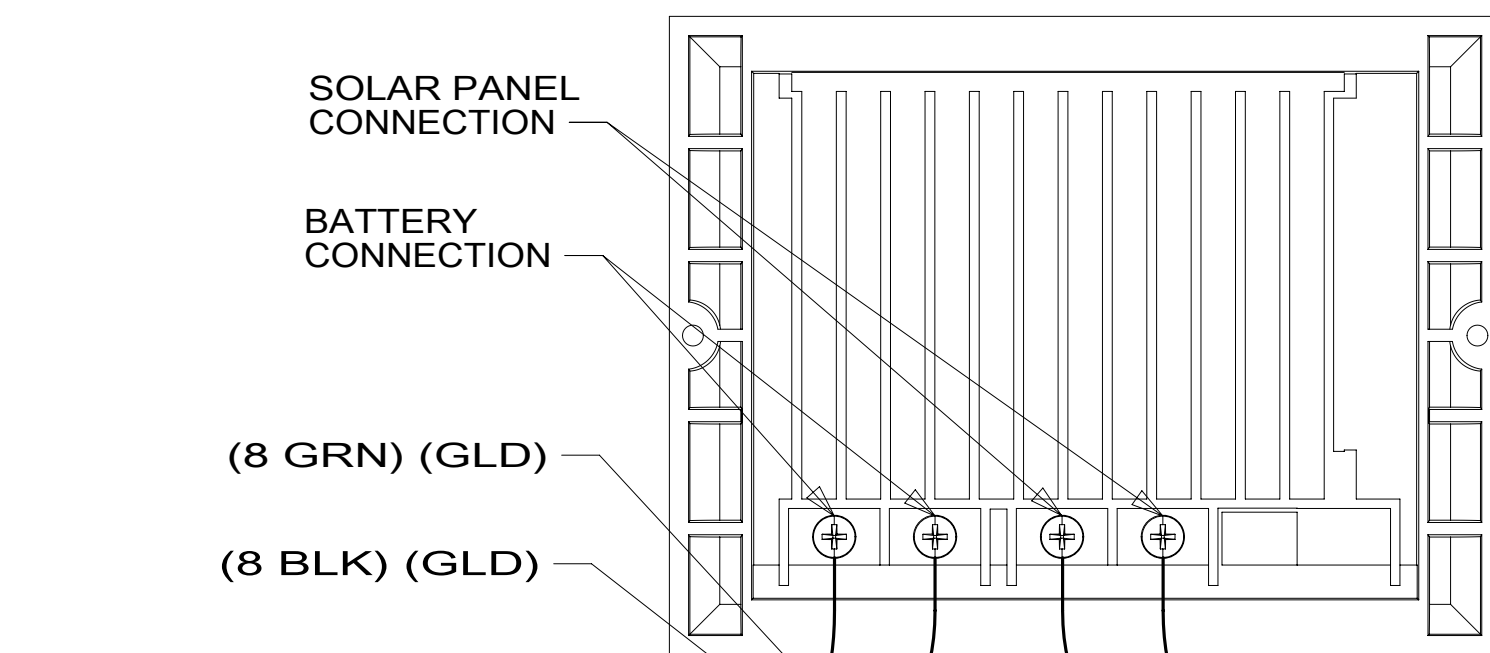

DETAIL DK

1

WIRE ASM-
SOLAR CONTROLLER

WIRE ASM-
CHASSIS

(8 GRN) (GLD)

(8 BLK) (GLD)

(8 GRN) (YEL)

(8 BLK) (YEL)

PANEL-MONITOR,LCD
175724-01-000
SCREW
G11-08-08U (4)

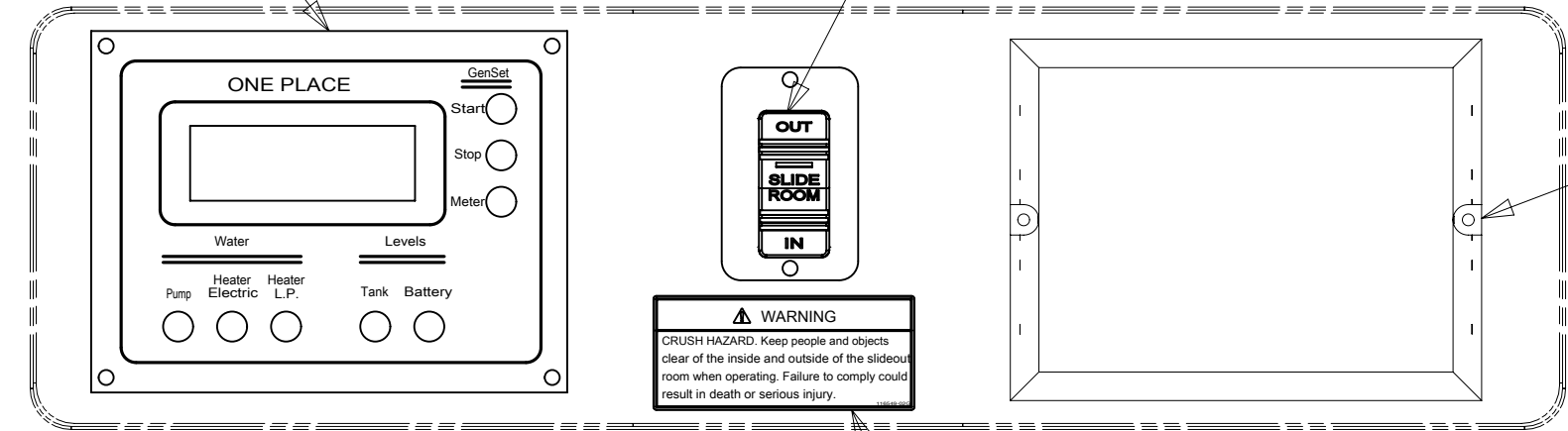

VIEW DM

SWITCH-ROCKER
108357-18-000
ACTUATOR-SWITCH
108356-31-CHT
PLATE-SWITCH
144363-02-CHT
CIRCUITS
HHH,DT,HHG

CONTROL-CHARGE,
SOLAR 30 AMP
191278-01-000
SCREW
G11-08-08U (2)
DETAIL DK

LABEL-WARNING,
SLIDEOUT
116549-02-000

LABEL-SWITCH,
HTR,HOLDING TK
(REF)

SWITCH
DETAIL DG

REMOTE PANEL-INVERTER
000037772 / 318694-01-CHT
CABLE-DATA
000038250 / 318769-01-000
SCREW
G11-06-08U (2)

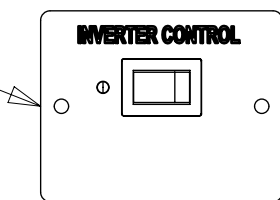

VIEW DH

1 SEE WIRING INSTL-CHASSIS FOR ADDITIONAL INFORMATION.

NOTES:

FOR ELECTRICAL
TORQUE
SPECIFICATIONS
SEE DWG NO.
128783-01-000

FOR ELECTRICAL
CALLOUTS
SEE DWG NO.
121339-01-000

- 60T JACKS-STABILIZING,ELECT W/O
- 64A JACKS-STABILIZING, ELECTRIC
- 23R DRAINAGE SYSTEM/HEAT-PREWIRE
- 23T DRAINAGE SYSTEM-HEATED
- 265 CODES/STANDARDS-CSA/CMVSS
- 1B1 CODES/STANDARDS USA

1B1 265

DESCRIPTION:
WIRING INSTL-BODY, 12V

SHEET: 4 OF 6 ITEM/PART NO: 000155522 / 32641201000 REV

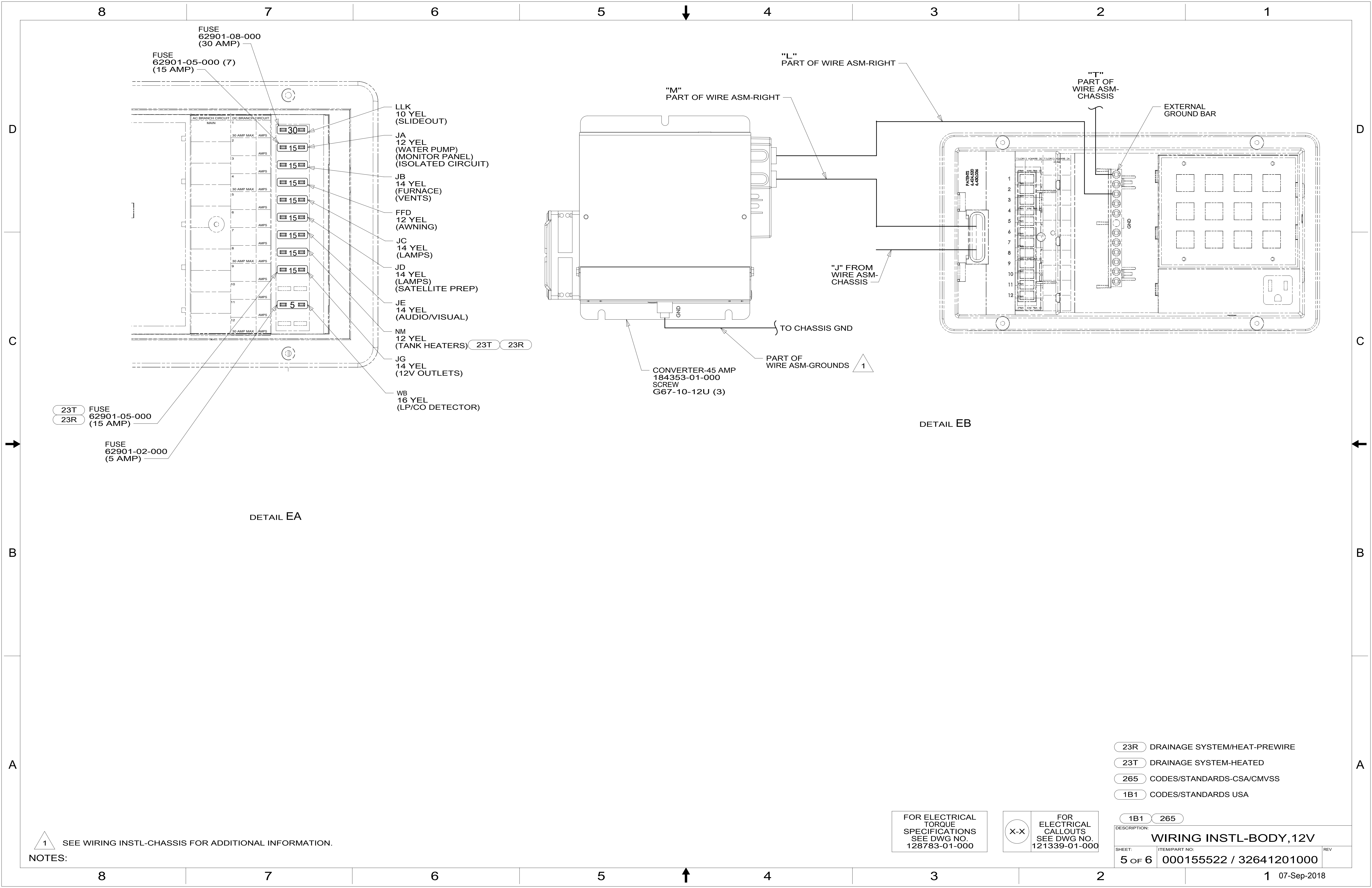

1 SEE WIRING INSTL-CHASSIS FOR ADDITIONAL INFORMATION.

FOR ELECTRICAL TORQUE SPECIFICATIONS SEE DWG NO. 128783-01-000

FOR ELECTRICAL CALLOUTS SEE DWG NO. 121339-01-000

- 23R DRAINAGE SYSTEM/HEAT-PREWIRE
- 23T DRAINAGE SYSTEM-HEATED
- 265 CODES/STANDARDS-CSA/CMVSS
- 1B1 CODES/STANDARDS USA

DESCRIPTION: 1B1 265		
WIRING INSTL-BODY, 12V		
SHEET: 5 OF 6	ITEM/PART NO: 000155522 / 32641201000	REV:

LIGHT-LED, ROUND 4.5 PLASTIC
000166889 / 329926-01-CHT (9)
SCREW
G13-06-16U (27)
CONNECTOR
58028-01-000 (18)

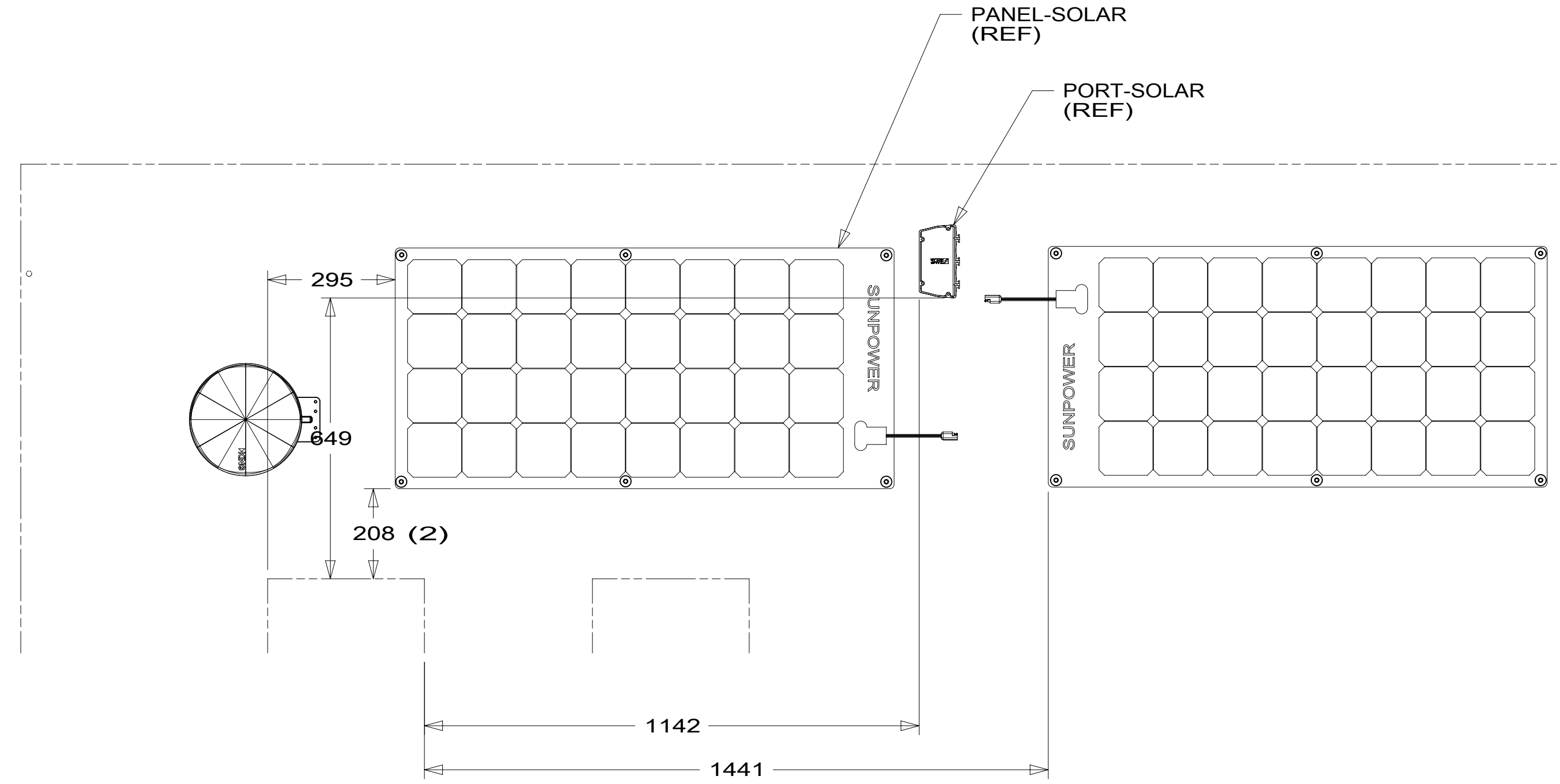
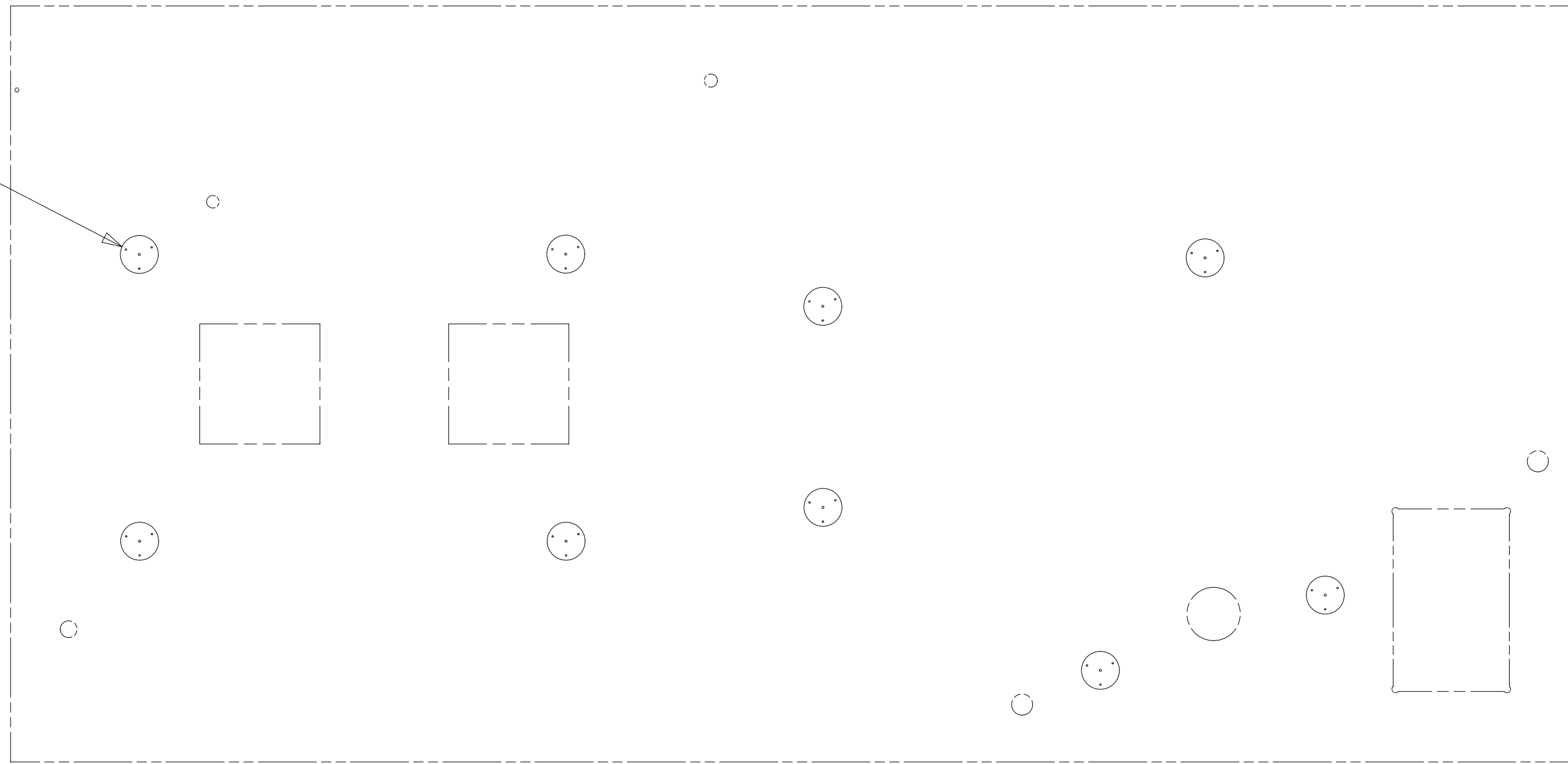

1 ANTENNA-TV, OMNIDIRECTIONAL, PORTABLE
000120035 / 323063-01-CHT
SCREW
G67-10-16U (3)
PLATE-ROOF, CABLE ENTRY
146488-01-000
SCREW
G67-10-10U (10)

PANEL-SOLAR 100 WATT, FLEXIBLE
000131101 / 325665-01-000 (2)
WASHER
077071-01-000 (12)
SCREW
000G39-10-16U (12)

PORT-SOLAR, 3 POSITION
000170803 / 331218-01-CHT
DETAIL FC

ANTENNA-RADIO, 16 RUBBER
090944-01-000
BRACKET-ANTENNA GROUND
147741-01-CHT
VIEW FA

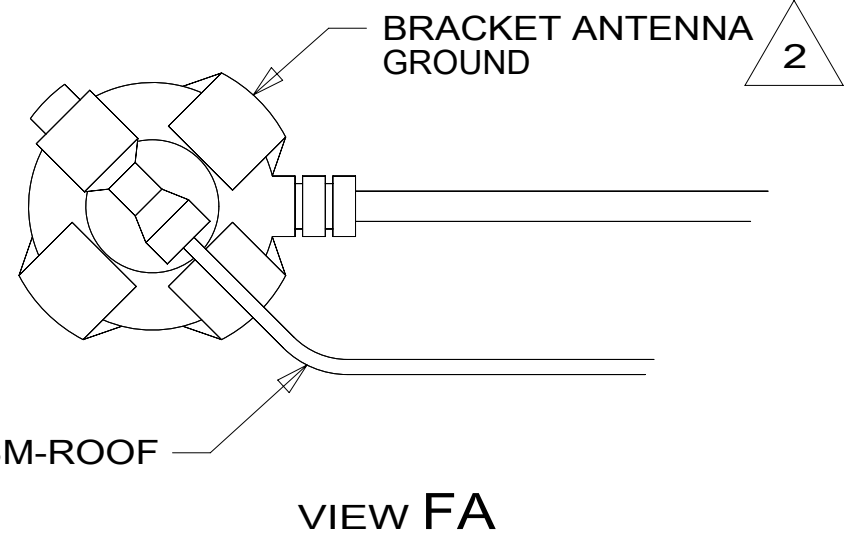
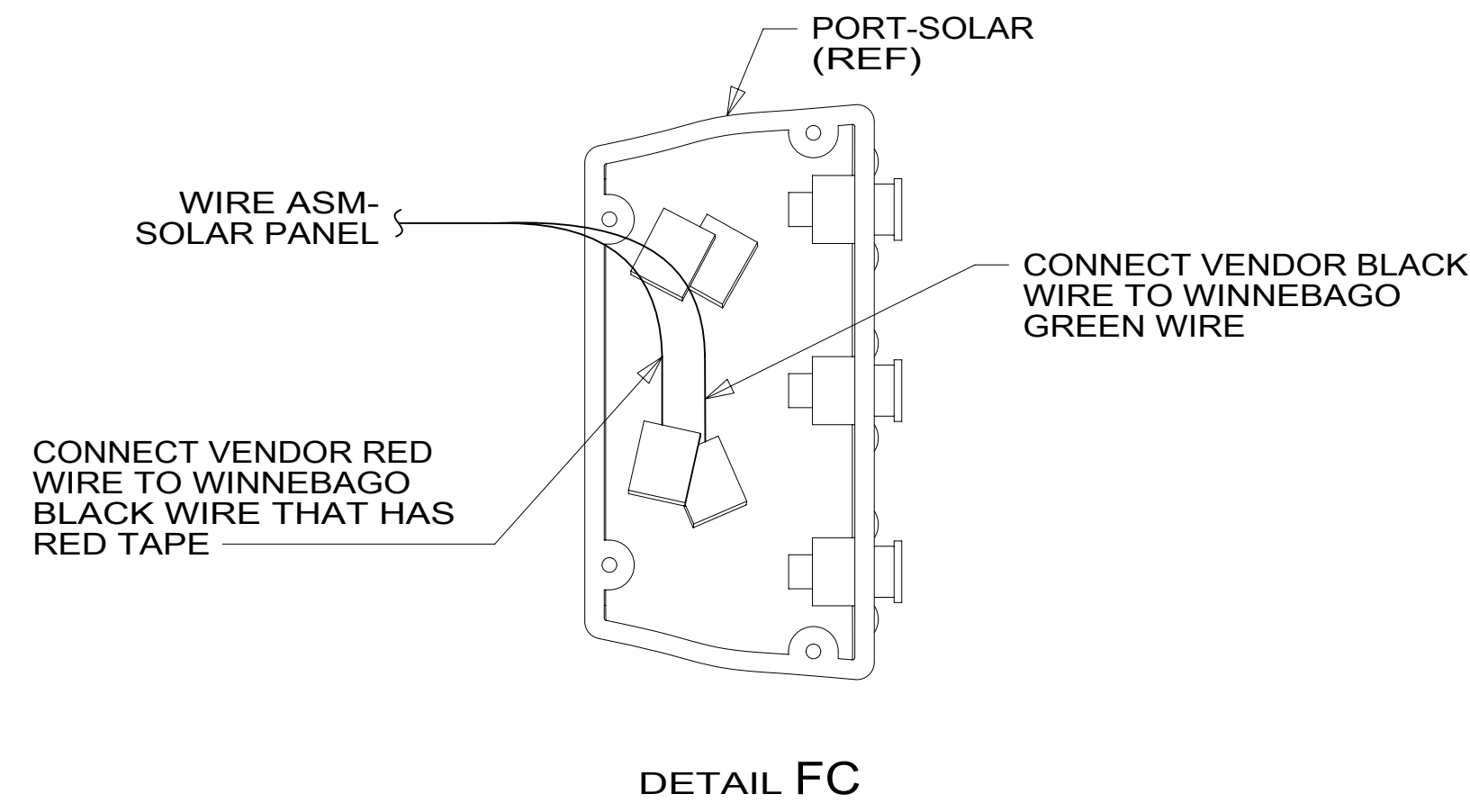
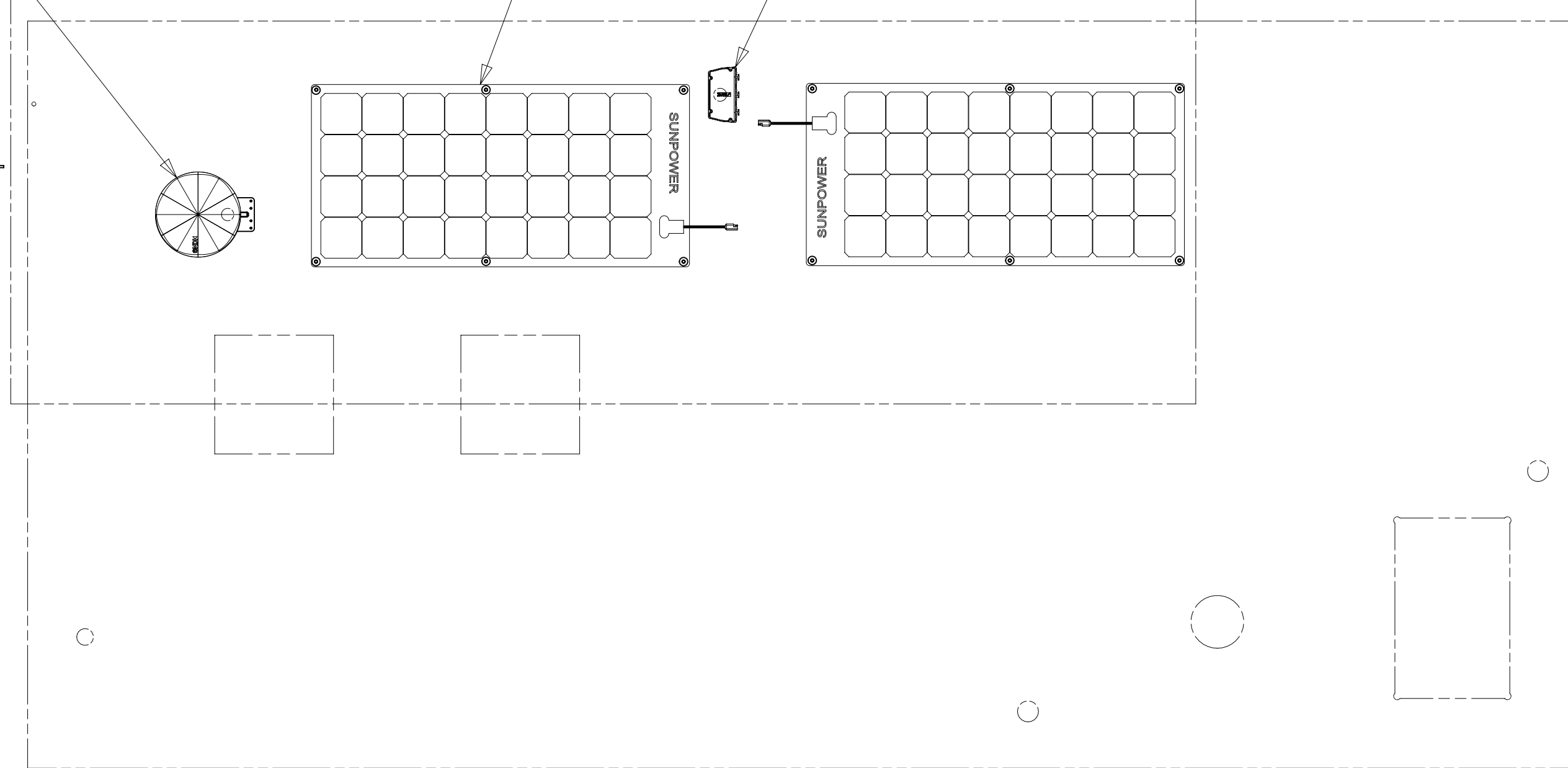

2 WRAP BRACKET LEGS AROUND ANTENNA BASE.
1 SEE ANTENNA INSTALLATION MANUAL FOR CORRECT INSTALLATION PROCEDURE.

FOR ELECTRICAL TORQUE SPECIFICATIONS SEE DWG NO. 128783-01-000

FOR ELECTRICAL CALLOUTS SEE DWG NO. 121339-01-000

265 CODES/STANDARDS-CSA/CMVSS
1B1 CODES/STANDARDS USA

DESCRIPTION:		1B1 265	
WIRING INSTL-BODY, 12V			
SHEET:	ITEM/PART NO.:	REV	
6 OF 6	000155522 / 32641201000		