

SWITCH  
174757-34-CHT

CONTROLLER-BLUE TOOTH, RGB  
000037768 / 318662-01-000  
SCREW  
000G67-08-12U (4)  
AMPLIFIER-SIGNAL, RGB LED  
000037767 / 318661-01-000  
SCREW  
000G67-08-12U (4)  
RELAY-CANISTER, SPDT W/RESIST  
063912-02-000  
SCREW  
000G67-08-12U

TO GROUND

COACH BATTERY

CIRCUIT BREAKER-10 AMP  
093654-05-000 (2)

BUSS BAR CIRCUIT BREAKER  
000125486 / 324167-01-CHT

WIRE ASM-GROUND EFFECT LIGHTING  
000124668 / 323970-01-000

VIEW AB

VIEW AC

COACH FEED

- NOTES:
- 4 CLIPS TO BE EQUALLY SPACED ALONG LED STRIP. CENTER CLIPS BETWEEN INDIVIDUAL LEDS.
  - 3 PLUG AMP INPUT INTO ZONE 2 OUTPUT FROM CONTROLLER.
  - 2. CLAMP WIRE ASM-GROUND EFFECT LIGHTING ALONG WITH WIRE ASM-CHASSIS WHERE APPLICABLE. USE TIE-WIRE 8343-04-000 TO SECURE WIRES TO FLOOR SUPPORT FRAME AT LEAST ONCE EVERY 600MM ALL OTHER PLACES.
  - 1 REST WIRE IN FRAME RAIL WHEN APPLICABLE.

FOR ELECTRICAL TORQUE SPECIFICATIONS SEE DWG NO. 128783-01-000

FOR ELECTRICAL CALLOUTS SEE DWG NO. 121339-01-000

265 CODES/STANDARDS-CSA/CMVSS  
1B1 CODES/STANDARDS USA



DSNR:		ALL DIMENSIONS ARE IN MILLIMETERS	
DIFFR:		MATERIAL:	
UNSPECIFIED TOLERANCES:		WEIGHT: (LBS)	FIRST USED:
WHOLE DIM (X)	: 3		18 P40A
ONE-PLACE (X.X)	: 1.5		
TWO-PLACE (X.XX)	: 0.50		
ANGLE	: 1°		
REFER TO ES0018 FOR FASTENER TIGHTENING GUIDELINES			
DESCRIPTION: <b>WIRING INSTL-LIGHTING,GROUND EFFECTS</b>			
SHEET:	ITEM/PART NO.:	REV:	
1 OF 3	000046262 / 32117001000		

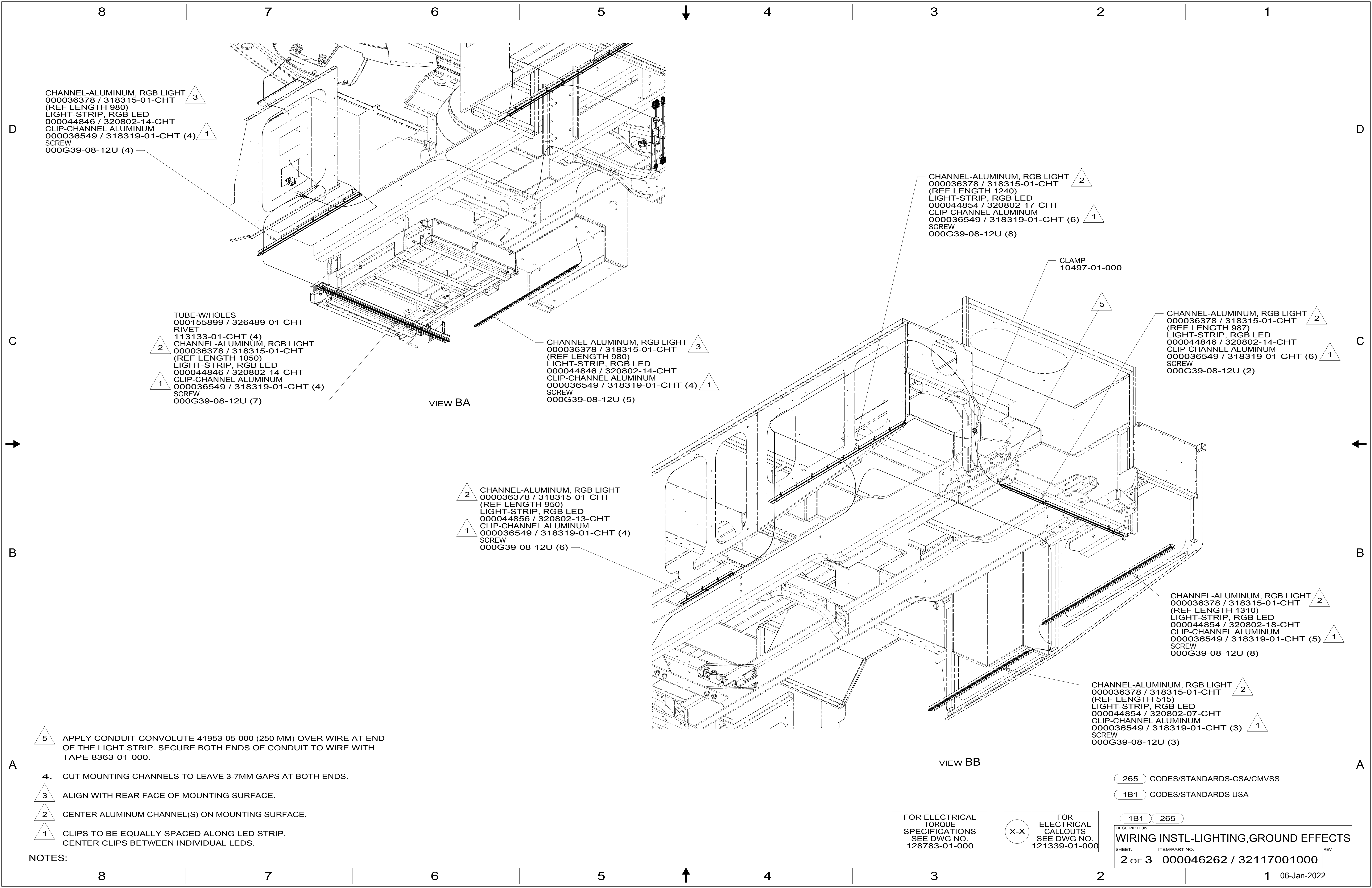

CHANNEL-ALUMINUM, RGB LIGHT  
000036378 / 318315-01-CHT (REF LENGTH 980)  
LIGHT-STRIP, RGB LED  
000044846 / 320802-14-CHT  
CLIP-CHANNEL ALUMINUM  
000036549 / 318319-01-CHT (4)  
SCREW  
000G39-08-12U (4)

TUBE-W/HOLES  
000155899 / 326489-01-CHT  
RIVET  
113133-01-CHT (4)  
CHANNEL-ALUMINUM, RGB LIGHT  
000036378 / 318315-01-CHT (REF LENGTH 1050)  
LIGHT-STRIP, RGB LED  
000044846 / 320802-14-CHT  
CLIP-CHANNEL ALUMINUM  
000036549 / 318319-01-CHT (4)  
SCREW  
000G39-08-12U (7)

CHANNEL-ALUMINUM, RGB LIGHT  
000036378 / 318315-01-CHT (REF LENGTH 980)  
LIGHT-STRIP, RGB LED  
000044846 / 320802-14-CHT  
CLIP-CHANNEL ALUMINUM  
000036549 / 318319-01-CHT (4)  
SCREW  
000G39-08-12U (5)

CHANNEL-ALUMINUM, RGB LIGHT  
000036378 / 318315-01-CHT (REF LENGTH 1240)  
LIGHT-STRIP, RGB LED  
000044854 / 320802-17-CHT  
CLIP-CHANNEL ALUMINUM  
000036549 / 318319-01-CHT (6)  
SCREW  
000G39-08-12U (8)

CHANNEL-ALUMINUM, RGB LIGHT  
000036378 / 318315-01-CHT (REF LENGTH 987)  
LIGHT-STRIP, RGB LED  
000044846 / 320802-14-CHT  
CLIP-CHANNEL ALUMINUM  
000036549 / 318319-01-CHT (6)  
SCREW  
000G39-08-12U (2)

CHANNEL-ALUMINUM, RGB LIGHT  
000036378 / 318315-01-CHT (REF LENGTH 950)  
LIGHT-STRIP, RGB LED  
000044856 / 320802-13-CHT  
CLIP-CHANNEL ALUMINUM  
000036549 / 318319-01-CHT (4)  
SCREW  
000G39-08-12U (6)

CHANNEL-ALUMINUM, RGB LIGHT  
000036378 / 318315-01-CHT (REF LENGTH 1310)  
LIGHT-STRIP, RGB LED  
000044854 / 320802-18-CHT  
CLIP-CHANNEL ALUMINUM  
000036549 / 318319-01-CHT (5)  
SCREW  
000G39-08-12U (8)

CHANNEL-ALUMINUM, RGB LIGHT  
000036378 / 318315-01-CHT (REF LENGTH 515)  
LIGHT-STRIP, RGB LED  
000044854 / 320802-07-CHT  
CLIP-CHANNEL ALUMINUM  
000036549 / 318319-01-CHT (3)  
SCREW  
000G39-08-12U (3)

5 APPLY CONDUIT-CONVOLUTE 41953-05-000 (250 MM) OVER WIRE AT END OF THE LIGHT STRIP. SECURE BOTH ENDS OF CONDUIT TO WIRE WITH TAPE 8363-01-000.

4. CUT MOUNTING CHANNELS TO LEAVE 3-7MM GAPS AT BOTH ENDS.

3 ALIGN WITH REAR FACE OF MOUNTING SURFACE.

2 CENTER ALUMINUM CHANNEL(S) ON MOUNTING SURFACE.

1 CLIPS TO BE EQUALLY SPACED ALONG LED STRIP. CENTER CLIPS BETWEEN INDIVIDUAL LEDS.

NOTES:

265 CODES/STANDARDS-CSA/CMVSS

1B1 CODES/STANDARDS USA

1B1 265

FOR ELECTRICAL TORQUE SPECIFICATIONS SEE DWG NO. 128783-01-000

FOR ELECTRICAL CALLOUTS SEE DWG NO. 121339-01-000

DESCRIPTION:  
WIRING INSTL-LIGHTING,GROUND EFFECTS

SHEET: 2 OF 3 ITEM/PART NO.: 000046262 / 32117001000 REV



8 7 6 5 4 3 2 1

D  
C  
B  
A

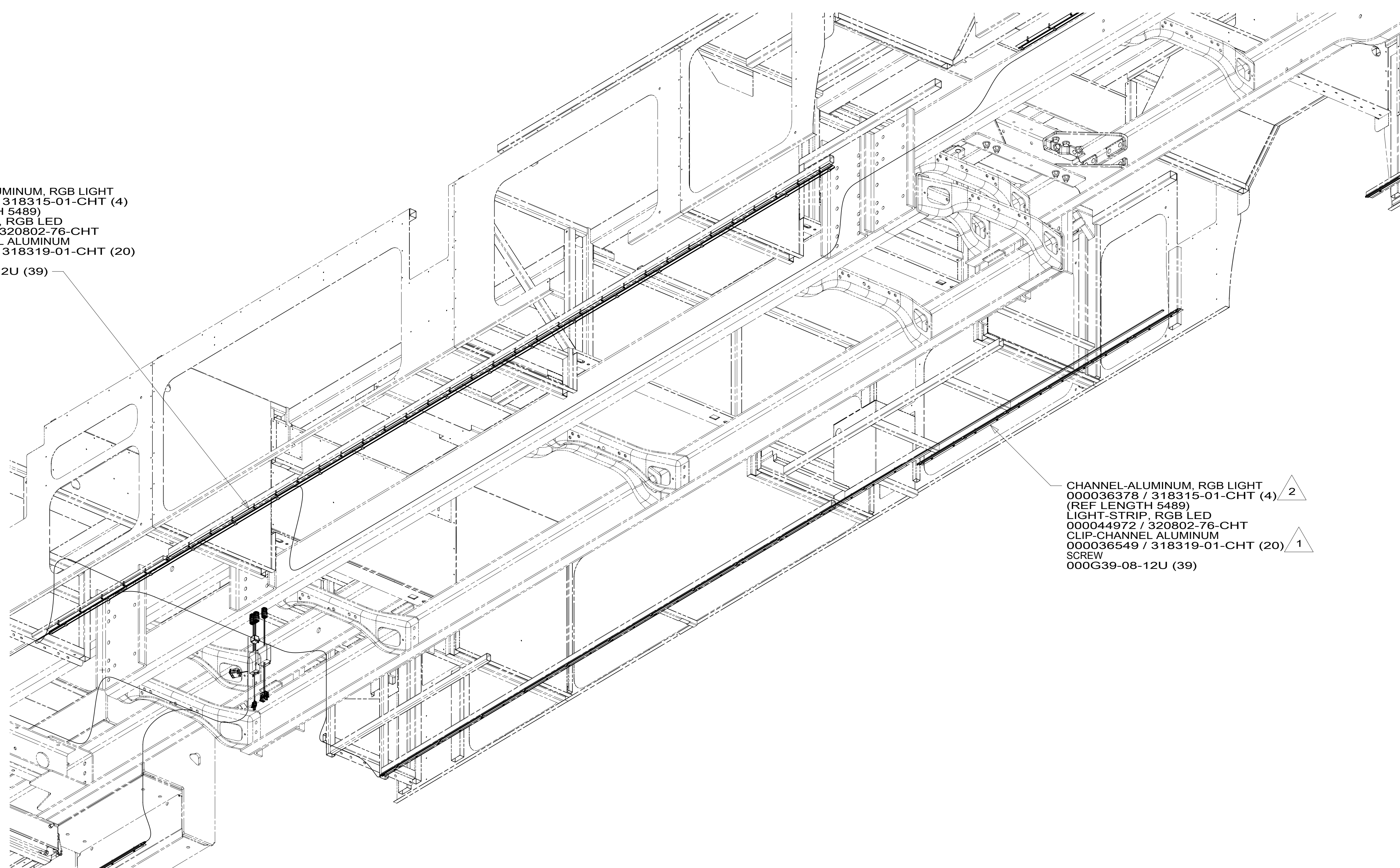

2 CHANNEL-ALUMINUM, RGB LIGHT  
000036378 / 318315-01-CHT (4)  
(REF LENGTH 5489)  
LIGHT-STRIP, RGB LED  
000044972 / 320802-76-CHT  
1 CLIP-CHANNEL ALUMINUM  
000036549 / 318319-01-CHT (20)  
SCREW  
000G39-08-12U (39)

CHANNEL-ALUMINUM, RGB LIGHT  
000036378 / 318315-01-CHT (4) 2  
(REF LENGTH 5489)  
LIGHT-STRIP, RGB LED  
000044972 / 320802-76-CHT  
CLIP-CHANNEL ALUMINUM  
000036549 / 318319-01-CHT (20) 1  
SCREW  
000G39-08-12U (39)

VIEW CA

- NOTES:
- 3. CUT MOUNTING CHANNELS TO LEAVE 3-7MM GAPS AT ENDS.
  - 2 CENTER ALUMINUM CHANNELS ON MOUNTING SURFACE.
  - 1 CLIPS TO BE EQUALLY SPACED ALONG LED STRIP.  
CENTER CLIPS BETWEEN INDIVIDUAL LEDS.

265 CODES/STANDARDS-CSA/CMVSS  
1B1 CODES/STANDARDS USA

FOR ELECTRICAL  
TORQUE  
SPECIFICATIONS  
SEE DWG NO.  
128783-01-000

FOR  
ELECTRICAL  
CALLOUTS  
SEE DWG NO.  
121339-01-000

DESCRIPTION:	1B1 265	
WIRING INSTL-LIGHTING,GROUND EFFECTS		
SHEET:	ITEM/PART NO:	REV
3 OF 3	000046262 / 32117001000	

8 7 6 5 4 3 2 1 06-Jan-2022