

8 7 6 5 4 3 2 1

D

D

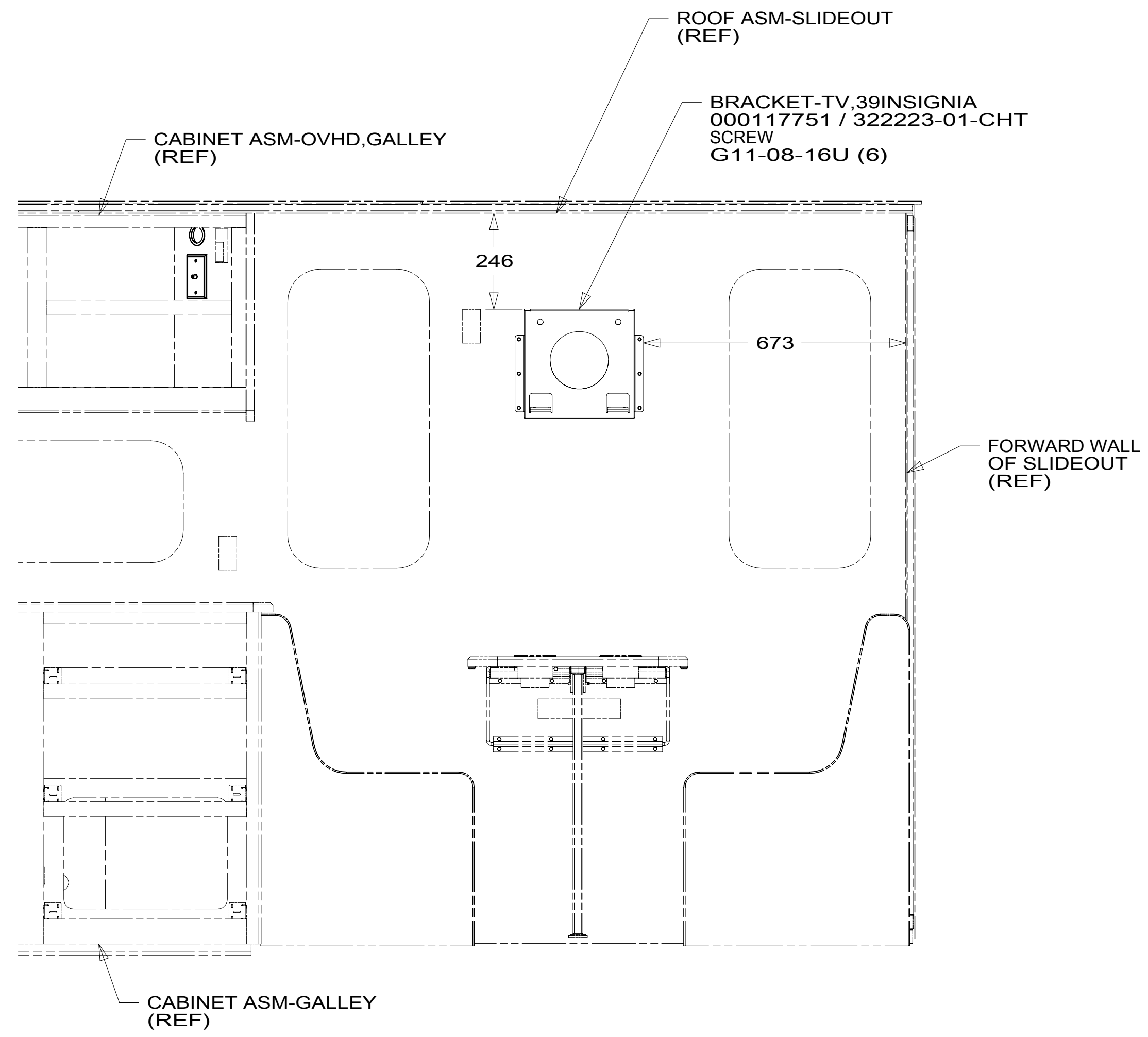
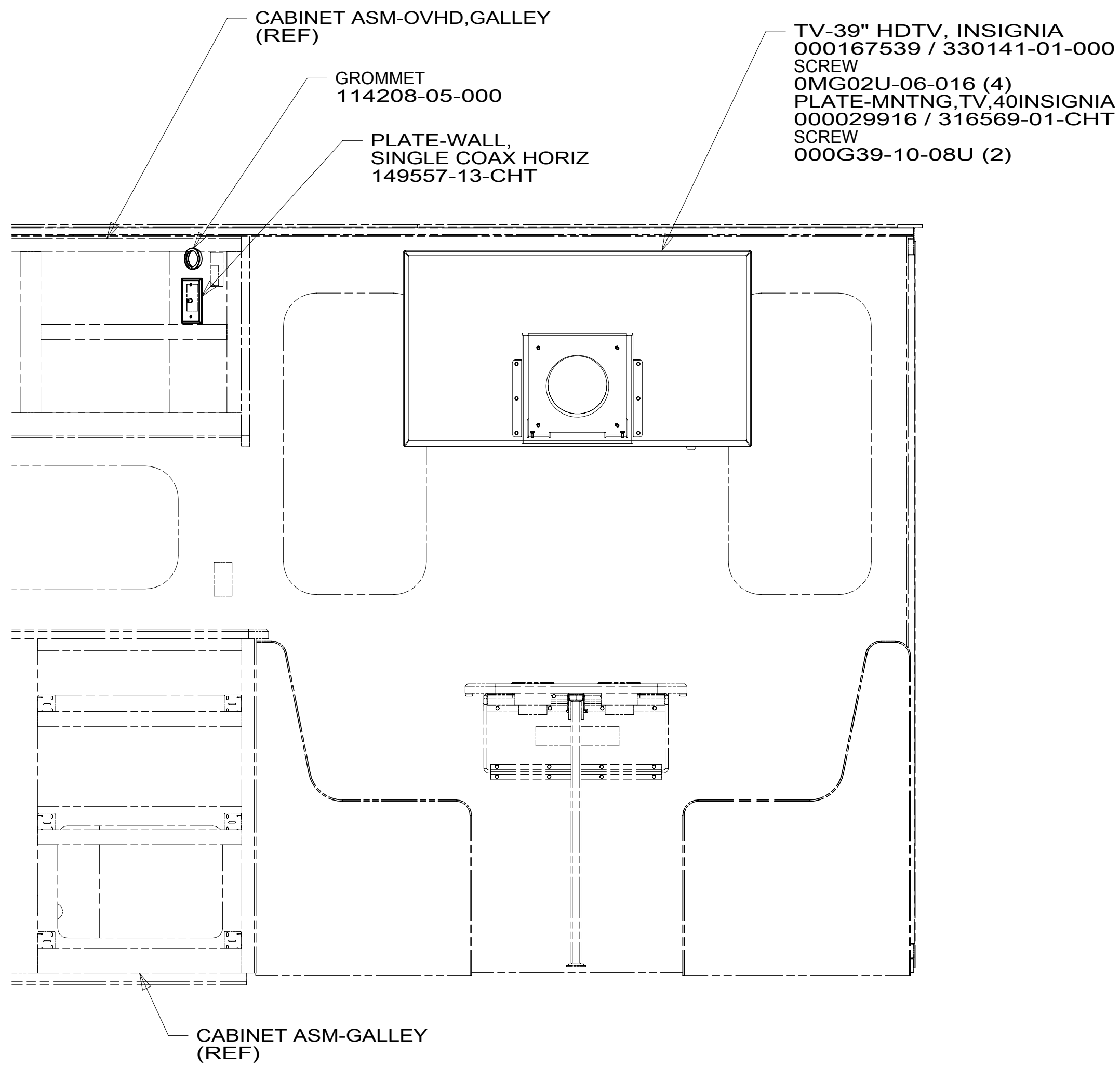

(TV NOT SHOWN)

C

C

→

←

B

B

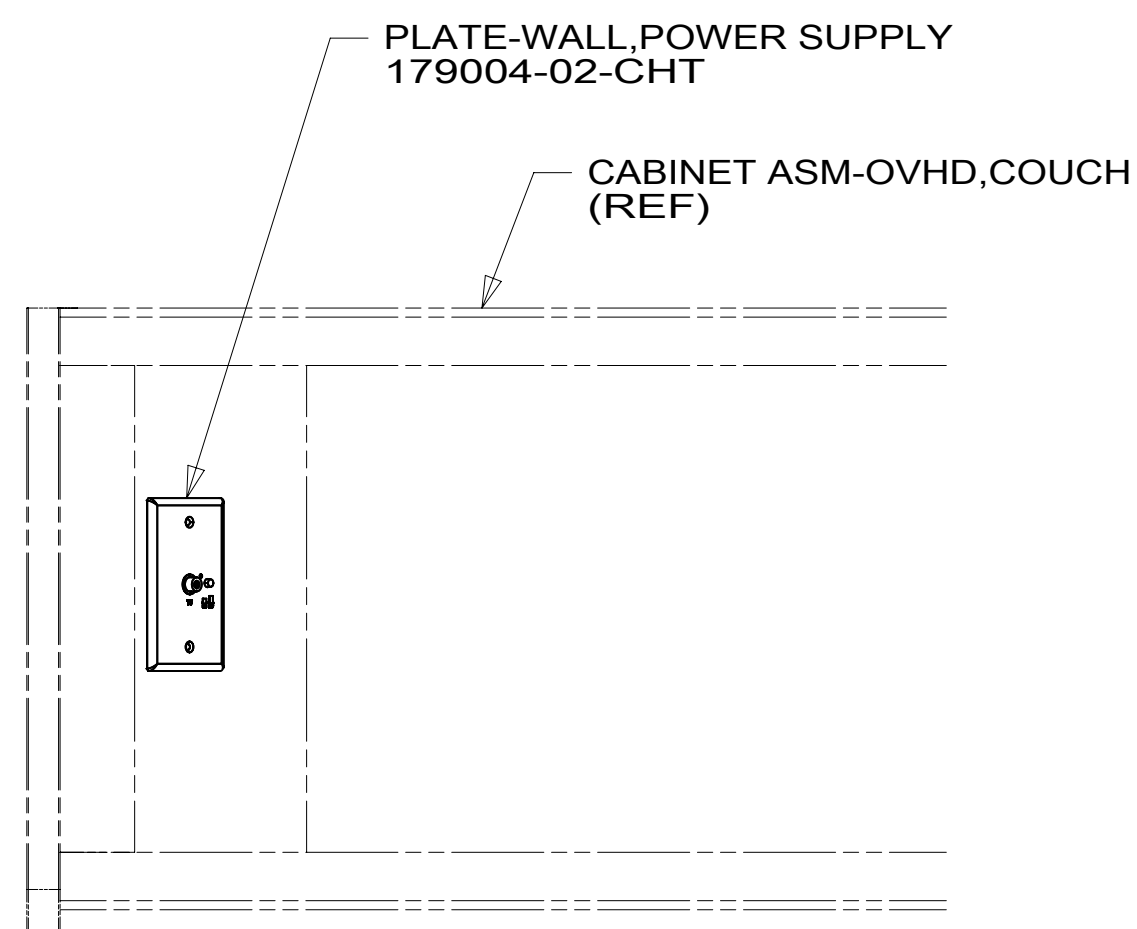

2. ALL WIRES TO BE SECURED WITH CLAMP 10495-01-000 OR CLIP 80734-01-000 EVERY 600MM. USE SCREW G67-10-12U UNLESS OTHERWISE SPECIFIED.

1. WHERE WIRES PASS THROUGH HOLES IN STEEL AND NOT OTHERWISE PROTECTED, USE GROMMET 92908-02-000.

NOTES:

FOR ELECTRICAL TORQUE SPECIFICATIONS SEE DWG NO. 128783-01-000

FOR ELECTRICAL CALLOUTS SEE DWG NO. 121339-01-000

- 68Y TV - MAIN
- 265 CODES/STANDARDS-CSA/CMVSS
- 1B1 CODES/STANDARDS USA

1B1 265 68Y



DSNR:	ALL DIMENSIONS ARE IN MILLIMETERS	
DFFR:	MATERIAL:	
UNSPECIFIED TOLERANCES:		
WHOLE DIM (X) :	3	
ONE-PLACE (X.X) :	1.5	
TWO-PLACE (X.XX) :	0.50	
ANGLE :	1°	

REFER TO ES0018 FOR FASTENER TIGHTENING GUIDELINES

WEIGHT: (LBS) FIRST USED: 18 V31P

DESCRIPTION: WIRING INSTL-TV/DVD

SHEET: 1 OF 4 ITEM/PART NO: 000115157 / 32193501000 REV

8 7 6 5 4 3 2 1

↑

A

1 25-Jul-2018

8 7 6 5 4 3 2 1



D
C
B
A

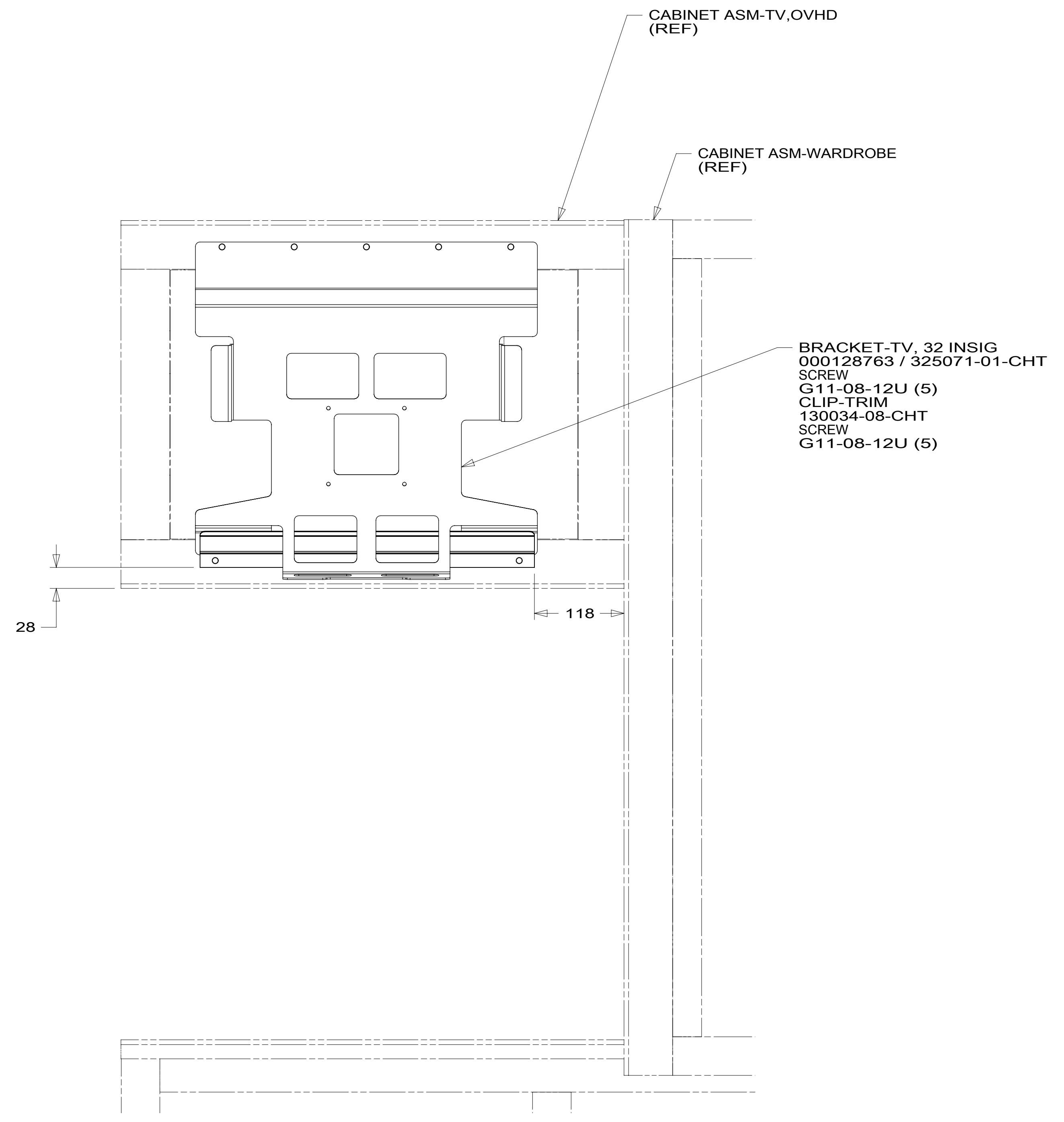
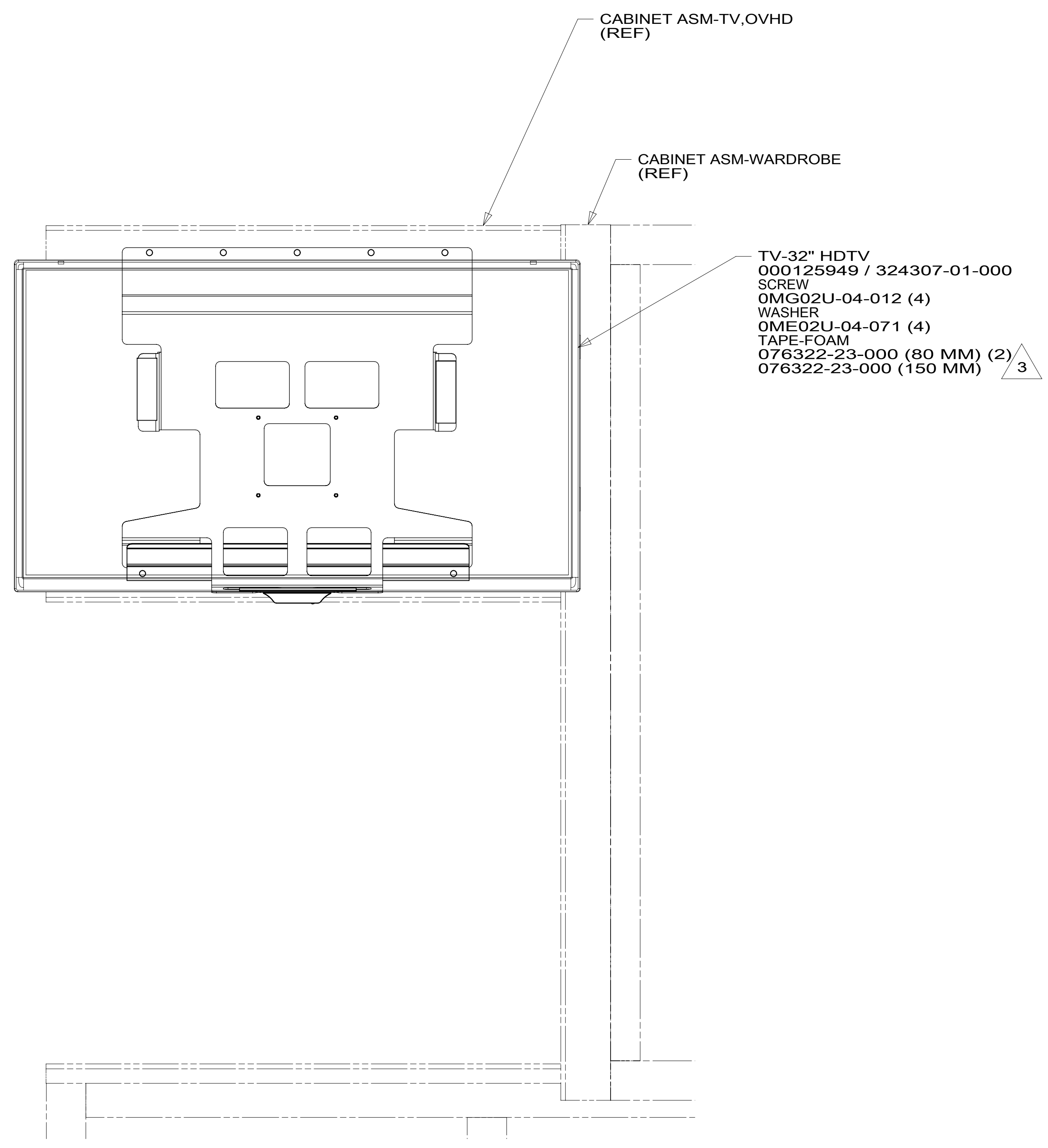

(TV NOT SHOWN)

- 3 PREP BOTH SURFACES WITH ADHESIVE-PROMOTER, 087211-01-000.
2. ALL WIRES TO BE SECURED WITH CLAMP 10495-01-000 OR CLIP 80734-01-000 EVERY 600MM. USE SCREW G67-10-12U UNLESS OTHERWISE SPECIFIED.
1. WHERE WIRES PASS THROUGH HOLES IN STEEL AND NOT OTHERWISE PROTECTED, USE GROMMET 92908-02-000.

NOTES:

- 68X TV - BEDROOM
- 265 CODES/STANDARDS-CSA/CMVSS
- 1B1 CODES/STANDARDS USA

FOR ELECTRICAL TORQUE SPECIFICATIONS SEE DWG NO. 128783-01-000

FOR ELECTRICAL CALLOUTS SEE DWG NO. 121339-01-000

DESCRIPTION:	1B1 265 68X	
WIRING INSTL-TV/DVD		
SHEET:	ITEM/PART NO:	REV
2 OF 4	000115157 / 32193501000	

8 7 6 5 4 3 2 1 25-Jul-2018

8 7 6 5 4 3 2 1

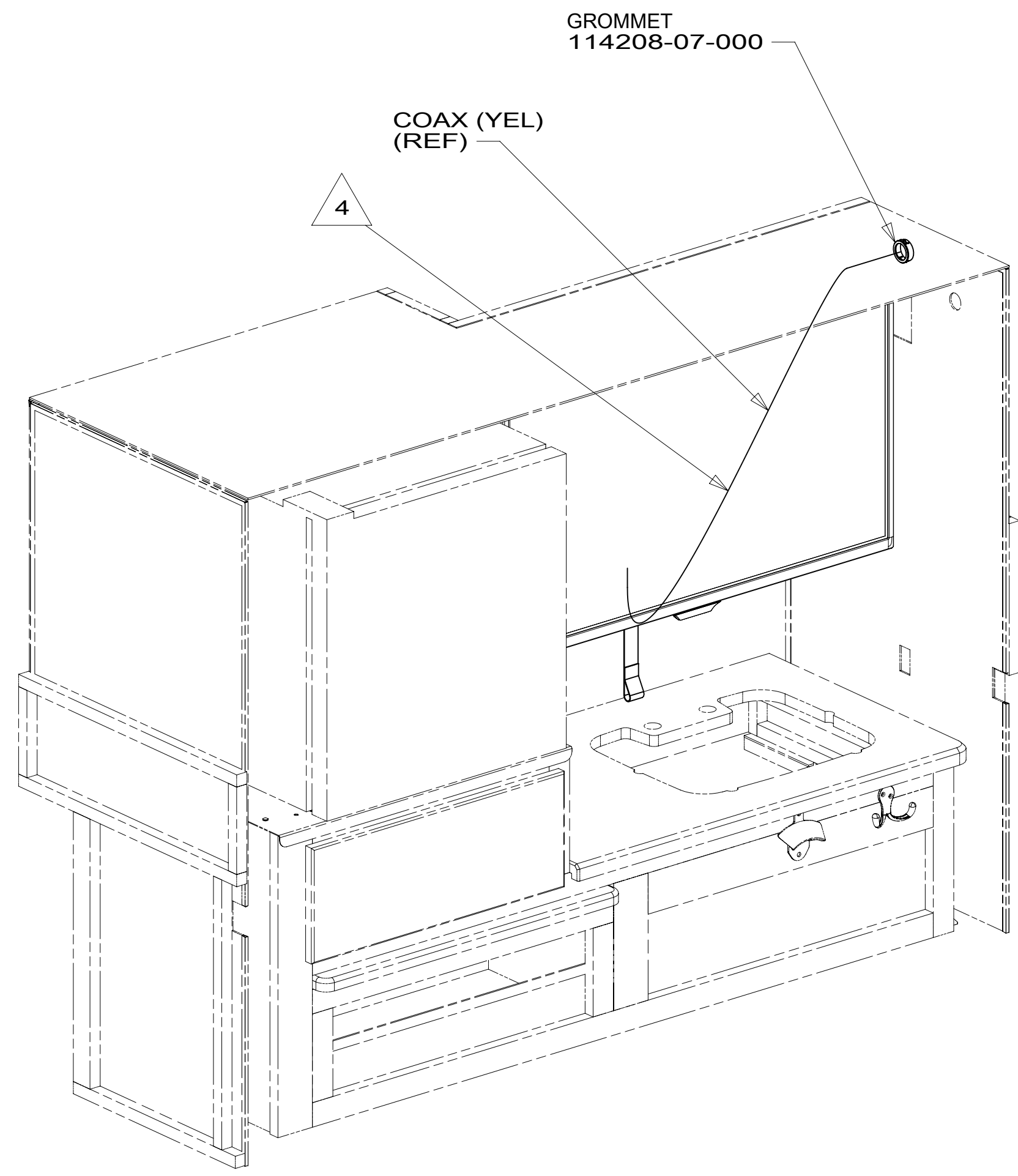

CA

- TV-32" HDTV
000125949 / 324307-01-000
- PLATE-MNTNG,TV,32" INSIGNIA
000127966 / 325048-01-CHT
- SCREW
OMG02U-04-012 (4)
- WASHER
E13-10-00U (4)
- TAPE-FOAM
076322-22-000 (80 MM) (2)
- TAPE-FOAM
076322-23-000 (150 MM) (2)

3

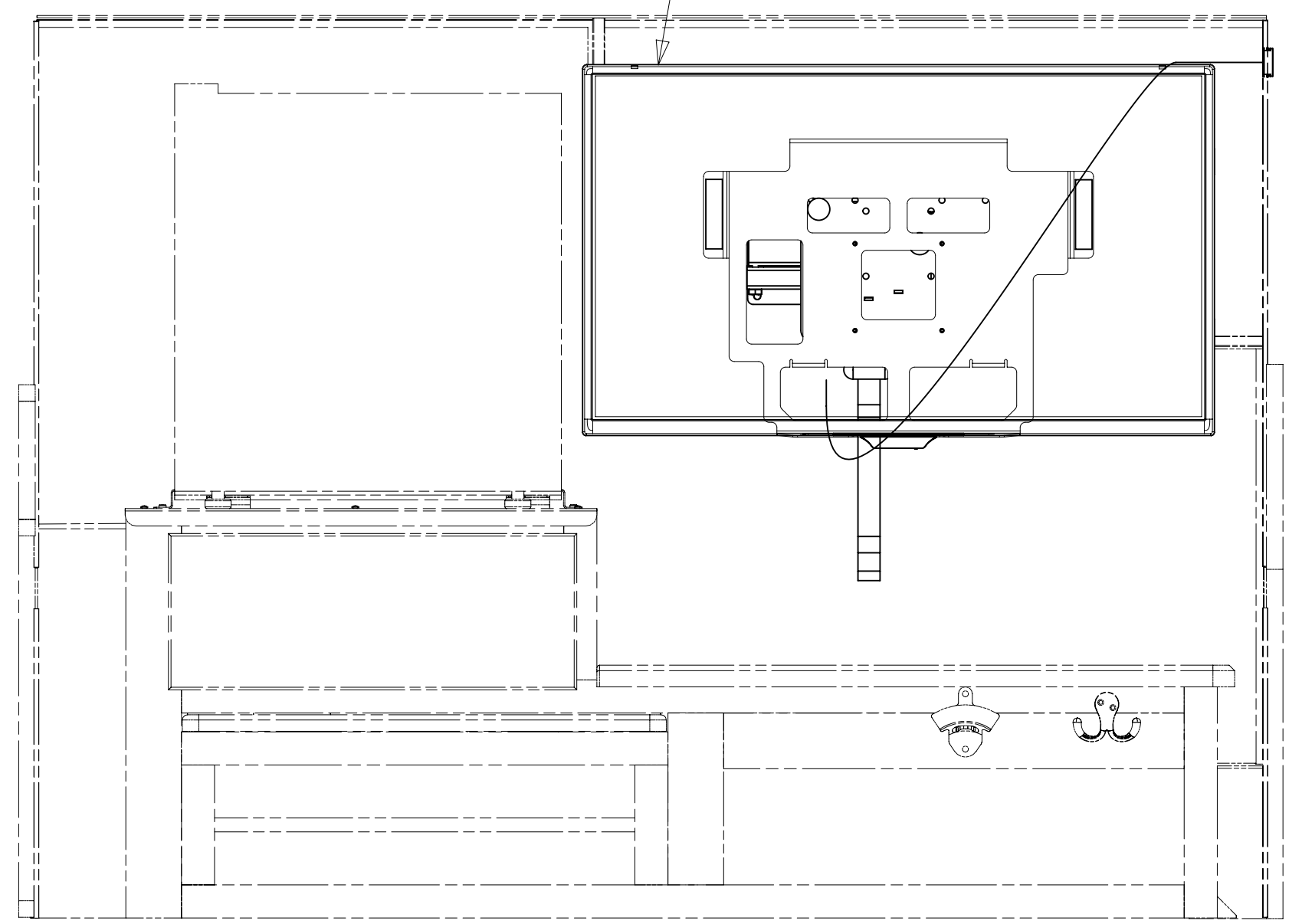

VIEW CA

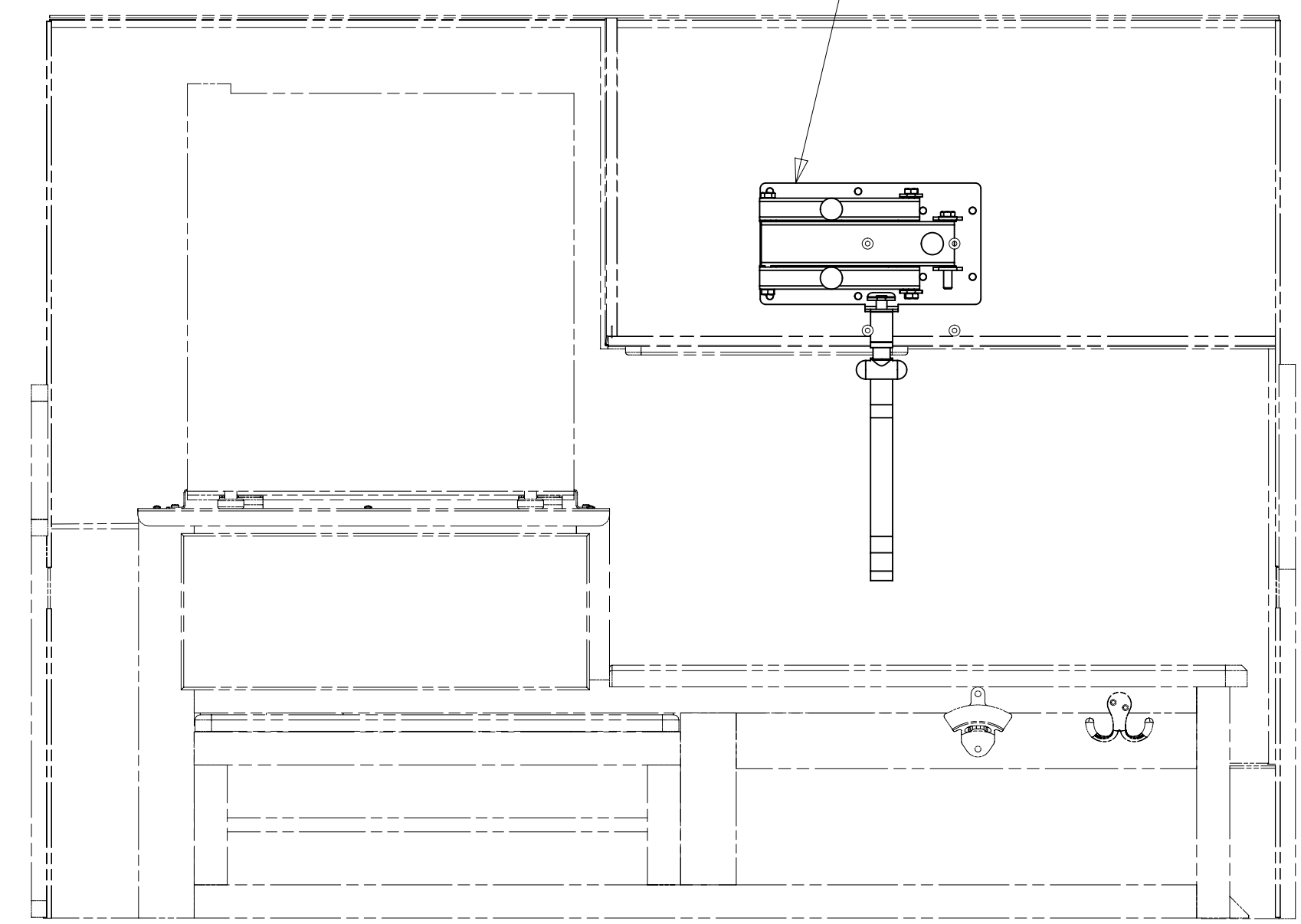

VIEW CA
(TV NOT SHOWN)

- BRACKET-TV SWING MOUNT
179241-01-CHT
- SCREW
G11-08-12U (8)

4 ROUTE COAX (YEL) AND TV POWER CORD TOGETHER, COVER WITH MINIMUM POSSIBLE DIAMETER BRAIDED SLEEVING 139049-01-.02-.03-000. SECURE BOTH ENDS WITH TAPE 8363-01-000. TIE CORDS TO TOP OF SWING ARM WITH TIE-WIRE 008343-03-000

3 PREP BOTH SURFACES WITH ADHESIVE-PROMOTER, 087211-01-000.

2. ALL WIRES TO BE SECURED WITH CLAMP 10495-01-000 OR CLIP 80734-01-000 EVERY 600MM. USE SCREW G67-10-12U UNLESS OTHERWISE SPECIFIED.

1. WHERE WIRES PASS THROUGH HOLES IN STEEL AND NOT OTHERWISE PROTECTED, USE GROMMET 92908-02-000.

NOTES:

- 9PC TAILGATE PACKAGE
- 265 CODES/STANDARDS-CSA/CMVSS
- 1B1 CODES/STANDARDS USA

FOR ELECTRICAL TORQUE SPECIFICATIONS SEE DWG NO. 128783-01-000

FOR ELECTRICAL CALLOUTS SEE DWG NO. 121339-01-000

DESCRIPTION:	1B1 265 9PC	
WIRING INSTL-TV/DVD		
SHEET:	ITEM/PART NO:	REV
3 OF 4	000115157 / 32193501000	

8 7 6 5 4 3 2 1 25-Jul-2018

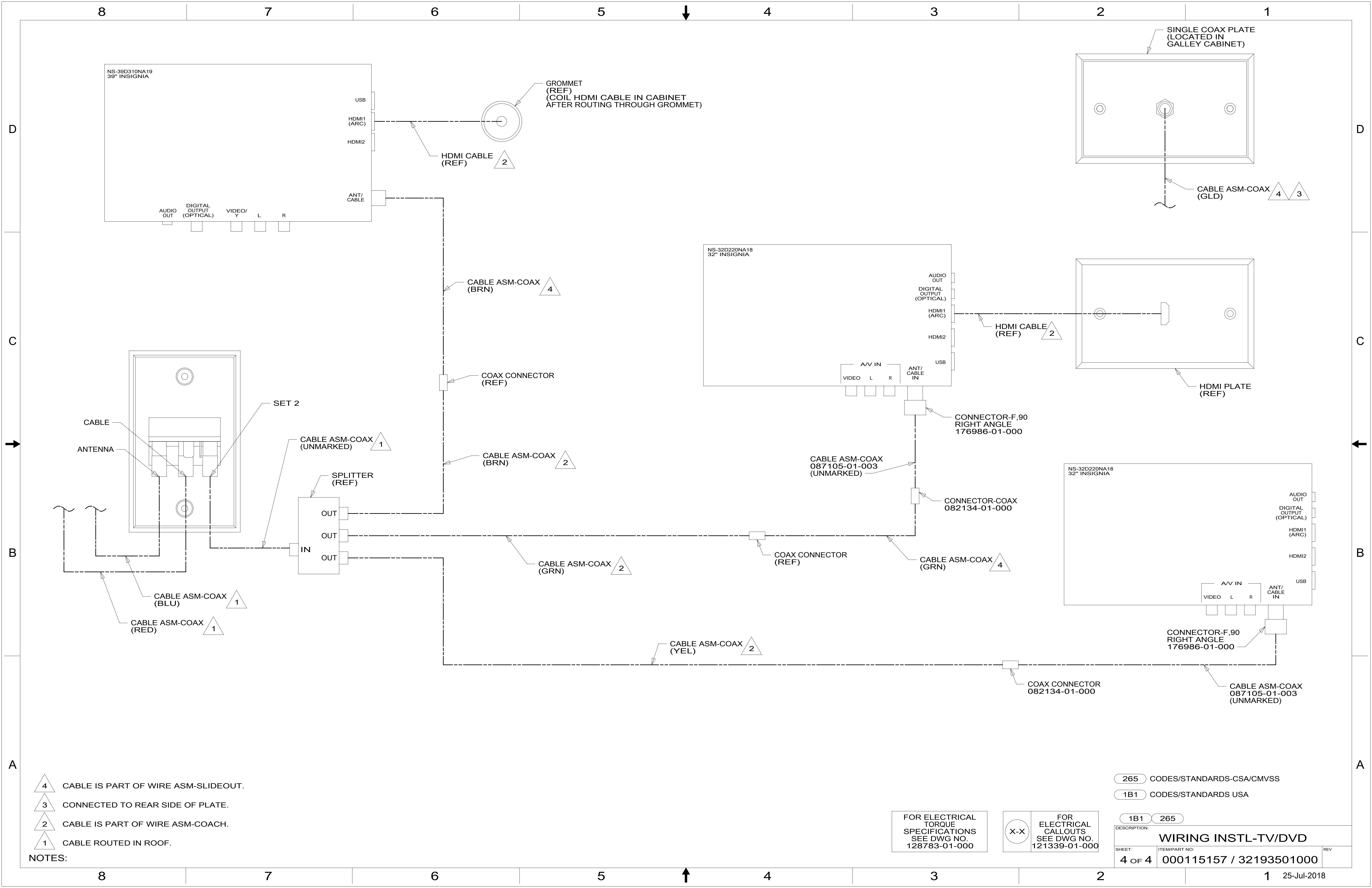

- NOTES:
- △4 CABLE IS PART OF WIRE ASM-SLIDEOUT.
 - △3 CONNECTED TO REAR SIDE OF PLATE.
 - △2 CABLE IS PART OF WIRE ASM-COACH.
 - △1 CABLE ROUTED IN ROOF.

265 CODES/STANDARDS-CSA/CMVSS
 1B1 CODES/STANDARDS USA

FOR ELECTRICAL TORQUE SPECIFICATIONS SEE DWG NO. 128783-01-000

FOR ELECTRICAL CALLOUTS SEE DWG NO. 121339-01-000

DESCRIPTION: WIRING INSTL-TV/DVD		
SHEET: 4 OF 4	ITEM/PART NO: 000115157 / 32193501000	REV