

SWITCH
174757-34-CHT

CONTROLLER-BLUE TOOTH, RGB
000037768 / 318662-01-000
SCREW
000G67-08-12U (4)
AMPLIFIER-SIGNAL, RGB LED
000037767 / 318661-01-000
SCREW
000G67-08-12U (4)
RELAY-CANISTER, SPDT W/RESIST
063912-02-000
SCREW
000G67-08-12U

TO GROUND

COACH BATTERY

CIRCUIT BREAKER-10 AMP
093654-05-000 (2)

BUSS BAR CIRCUIT BREAKER
000125486 / 324167-01-CHT

WIRE ASM-GROUND EFFECT LIGHTING
000124668 / 323970-01-000

VIEW AB

VIEW AC

COACH FEED

AA

AB

VIEW AA

BA

CA

BB

- NOTES:
- 4 CLIPS TO BE EQUALLY SPACED ALONG LED STRIP. CENTER CLIPS BETWEEN INDIVIDUAL LEDES.
 - 3 PLUG AMP INPUT INTO ZONE 2 OUTPUT FROM CONTROLLER.
 - 2. CLAMP WIRE ASM-GROUND EFFECT LIGHTING ALONG WITH WIRE ASM-CHASSIS WHERE APPLICABLE. USE TIE-WIRE 8343-04-000 TO SECURE WIRES TO FLOOR SUPPORT FRAME AT LEAST ONCE EVERY 600MM ALL OTHER PLACES.
 - 1 REST WIRE IN FRAME RAIL WHEN APPLICABLE.

FOR ELECTRICAL TORQUE SPECIFICATIONS SEE DWG NO. 128783-01-000

FOR ELECTRICAL CALLOUTS SEE DWG NO. 121339-01-000

265 CODES/STANDARDS-CSA/CMVSS
1B1 CODES/STANDARDS USA
1B1 265

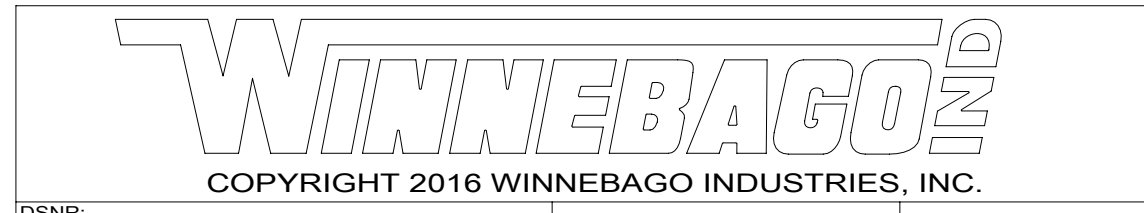

| | | | |
|---|-------------------------|-----------------------------------|-------------|
| DSNR: | | ALL DIMENSIONS ARE IN MILLIMETERS | |
| DIFFR: | | MATERIAL: | |
| UNSPECIFIED TOLERANCES: | | | |
| WHOLE DIM (X) | : 3 | | |
| ONE-PLACE (X.X) | : 1.5 | | |
| TWO-PLACE (X.XX) | : 0.50 | | |
| ANGLE | : 1° | | |
| REFER TO ES0018 FOR FASTENER TIGHTENING GUIDELINES | | WEIGHT: (LBS) | FIRST USED: |
| | | | 18 P40A |
| DESCRIPTION: WIRING INSTL-LIGHTING,GROUND EFFECTS | | | |
| SHEET: | ITEM/PART NO.: | REV: | |
| 1 OF 3 | 000046262 / 32117001000 | | |

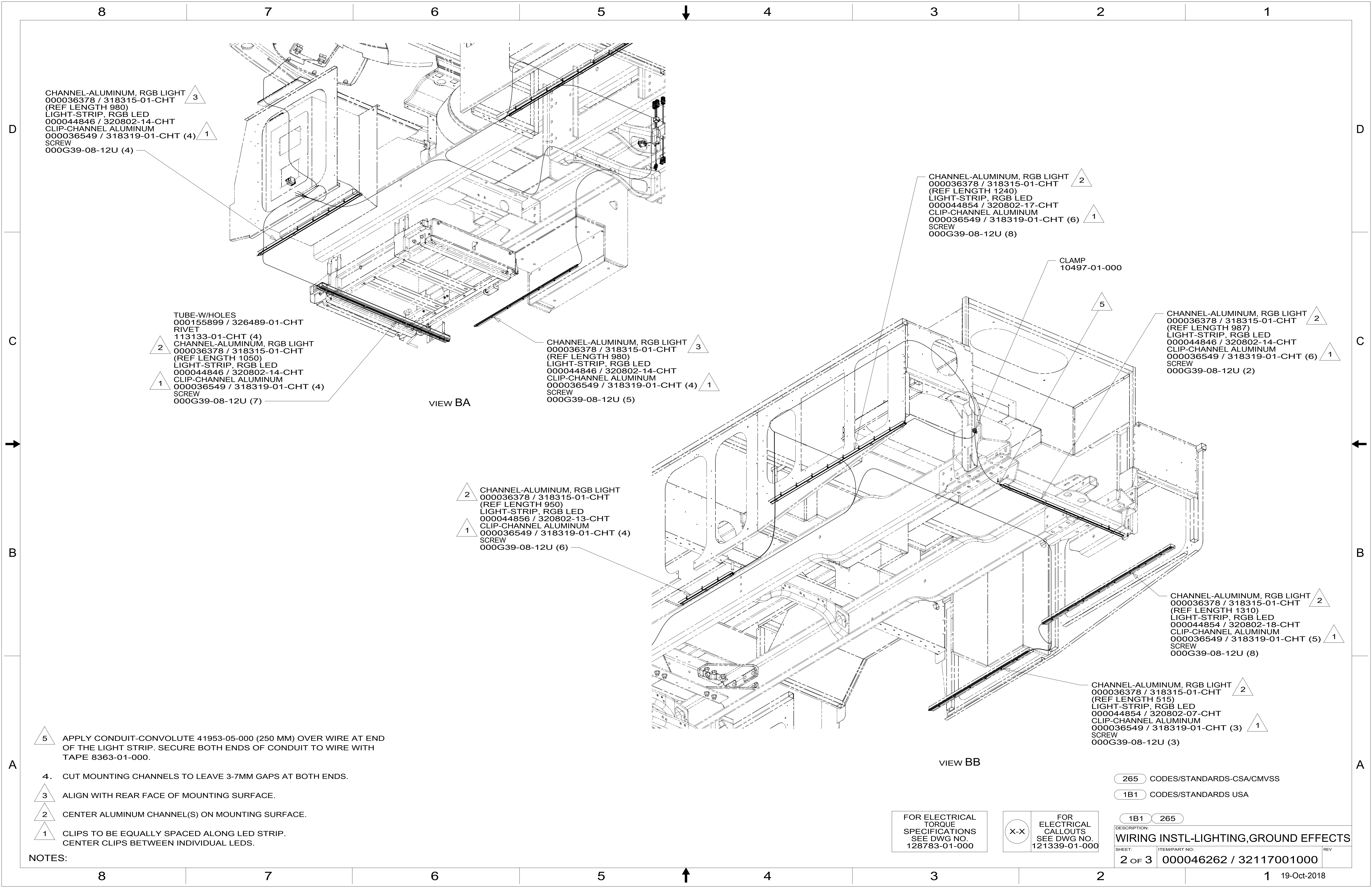

CHANNEL-ALUMINUM, RGB LIGHT
000036378 / 318315-01-CHT (REF LENGTH 980)
LIGHT-STRIP, RGB LED
000044846 / 320802-14-CHT
CLIP-CHANNEL ALUMINUM
000036549 / 318319-01-CHT (4)
SCREW
000G39-08-12U (4)

TUBE-W/HOLES
000155899 / 326489-01-CHT
RIVET
113133-01-CHT (4)
CHANNEL-ALUMINUM, RGB LIGHT
000036378 / 318315-01-CHT (REF LENGTH 1050)
LIGHT-STRIP, RGB LED
000044846 / 320802-14-CHT
CLIP-CHANNEL ALUMINUM
000036549 / 318319-01-CHT (4)
SCREW
000G39-08-12U (7)

CHANNEL-ALUMINUM, RGB LIGHT
000036378 / 318315-01-CHT (REF LENGTH 980)
LIGHT-STRIP, RGB LED
000044846 / 320802-14-CHT
CLIP-CHANNEL ALUMINUM
000036549 / 318319-01-CHT (4)
SCREW
000G39-08-12U (5)

CHANNEL-ALUMINUM, RGB LIGHT
000036378 / 318315-01-CHT (REF LENGTH 1240)
LIGHT-STRIP, RGB LED
000044854 / 320802-17-CHT
CLIP-CHANNEL ALUMINUM
000036549 / 318319-01-CHT (6)
SCREW
000G39-08-12U (8)

CHANNEL-ALUMINUM, RGB LIGHT
000036378 / 318315-01-CHT (REF LENGTH 987)
LIGHT-STRIP, RGB LED
000044846 / 320802-14-CHT
CLIP-CHANNEL ALUMINUM
000036549 / 318319-01-CHT (6)
SCREW
000G39-08-12U (2)

CHANNEL-ALUMINUM, RGB LIGHT
000036378 / 318315-01-CHT (REF LENGTH 950)
LIGHT-STRIP, RGB LED
000044856 / 320802-13-CHT
CLIP-CHANNEL ALUMINUM
000036549 / 318319-01-CHT (4)
SCREW
000G39-08-12U (6)

CHANNEL-ALUMINUM, RGB LIGHT
000036378 / 318315-01-CHT (REF LENGTH 1310)
LIGHT-STRIP, RGB LED
000044854 / 320802-18-CHT
CLIP-CHANNEL ALUMINUM
000036549 / 318319-01-CHT (5)
SCREW
000G39-08-12U (8)

CHANNEL-ALUMINUM, RGB LIGHT
000036378 / 318315-01-CHT (REF LENGTH 515)
LIGHT-STRIP, RGB LED
000044854 / 320802-07-CHT
CLIP-CHANNEL ALUMINUM
000036549 / 318319-01-CHT (3)
SCREW
000G39-08-12U (3)

5 APPLY CONDUIT-CONVOLUTE 41953-05-000 (250 MM) OVER WIRE AT END OF THE LIGHT STRIP. SECURE BOTH ENDS OF CONDUIT TO WIRE WITH TAPE 8363-01-000.

4. CUT MOUNTING CHANNELS TO LEAVE 3-7MM GAPS AT BOTH ENDS.

3 ALIGN WITH REAR FACE OF MOUNTING SURFACE.

2 CENTER ALUMINUM CHANNEL(S) ON MOUNTING SURFACE.

1 CLIPS TO BE EQUALLY SPACED ALONG LED STRIP. CENTER CLIPS BETWEEN INDIVIDUAL LEDS.

NOTES:

265 CODES/STANDARDS-CSA/CMVSS

1B1 CODES/STANDARDS USA

1B1 265

FOR ELECTRICAL TORQUE SPECIFICATIONS SEE DWG NO. 128783-01-000

FOR ELECTRICAL CALLOUTS SEE DWG NO. 121339-01-000

DESCRIPTION:
WIRING INSTL-LIGHTING,GROUND EFFECTS

SHEET: 2 OF 3 ITEM/PART NO.: 000046262 / 32117001000 REV

8 7 6 5 4 3 2 1

D
C
B
A

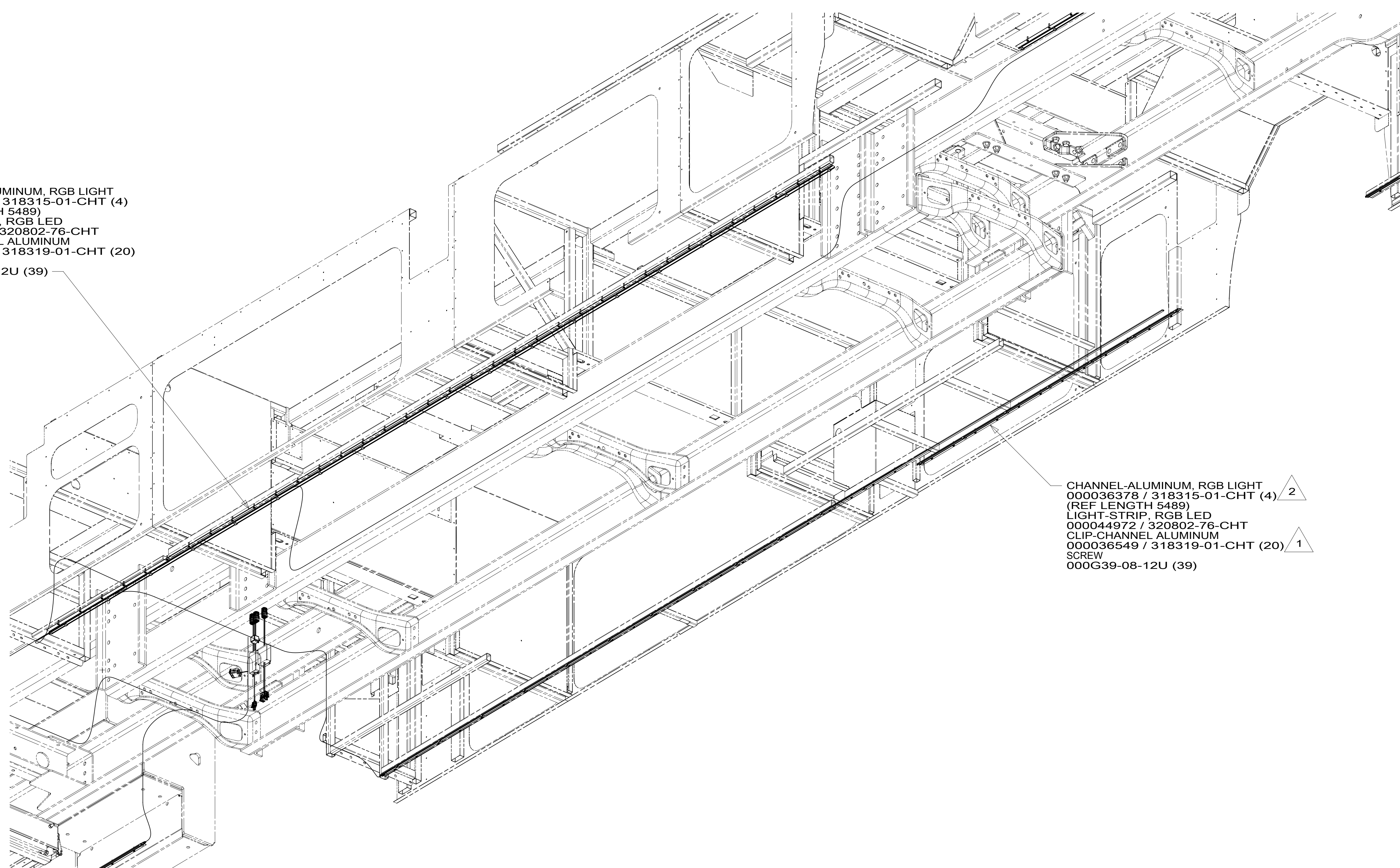

2 CHANNEL-ALUMINUM, RGB LIGHT
000036378 / 318315-01-CHT (4)
(REF LENGTH 5489)
LIGHT-STRIP, RGB LED
000044972 / 320802-76-CHT
1 CLIP-CHANNEL ALUMINUM
000036549 / 318319-01-CHT (20)
SCREW
000G39-08-12U (39)

CHANNEL-ALUMINUM, RGB LIGHT
000036378 / 318315-01-CHT (4) 2
(REF LENGTH 5489)
LIGHT-STRIP, RGB LED
000044972 / 320802-76-CHT
CLIP-CHANNEL ALUMINUM
000036549 / 318319-01-CHT (20) 1
SCREW
000G39-08-12U (39)

VIEW CA

- NOTES:
- 3. CUT MOUNTING CHANNELS TO LEAVE 3-7MM GAPS AT ENDS.
 - 2 CENTER ALUMINUM CHANNELS ON MOUNTING SURFACE.
 - 1 CLIPS TO BE EQUALLY SPACED ALONG LED STRIP.
CENTER CLIPS BETWEEN INDIVIDUAL LEDS.

265 CODES/STANDARDS-CSA/CMVSS
1B1 CODES/STANDARDS USA

FOR ELECTRICAL
TORQUE
SPECIFICATIONS
SEE DWG NO.
128783-01-000

FOR
ELECTRICAL
CALLOUTS
SEE DWG NO.
121339-01-000

| | | |
|--------------------------------------|-------------------------|-----|
| DESCRIPTION: | 1B1 | 265 |
| WIRING INSTL-LIGHTING,GROUND EFFECTS | | |
| SHEET: | ITEM/PART NO.: | REV |
| 3 OF 3 | 000046262 / 32117001000 | |

8 7 6 5 4 3 2 1 19-Oct-2018