

8 7 6 5 4 3 2 1

D

D

C

C

B

B

A

A

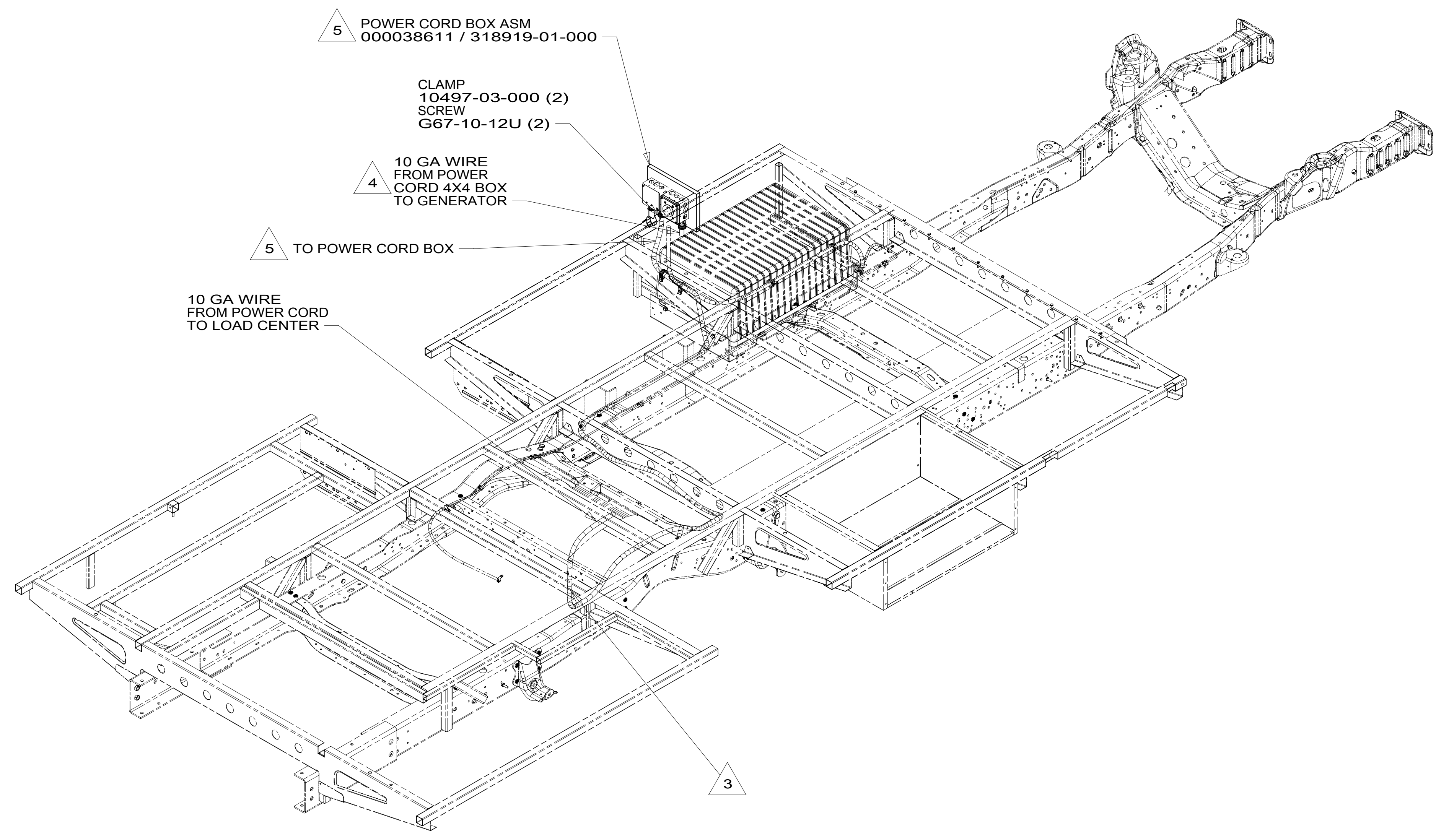

- 5 POWER CORD BOX ASM IS LOCATED ABOVE FLOOR.
 - 4 SEE GENERATOR INSTL FOR ADDITIONAL INFORMATION.
 - 3 ROUTE WIRE THRU FLOOR.
2. ALL 110V WIRE TO BE CLAMPED WITH CLAMP 10497-05-000 WITHIN 200MM OF OUTLET BOXES, USE SCREW G67-10-12B.
 1. AT MINIMUM ALL WIRES TO BE SUPPORTED AND SECURED PER CODE REQUIREMENTS. USE CLAMP 10495 OR 10497 OR WIRE TIE 8343 OR 108046 AND SCREW G67-XX-XXX OR G56-XX-XXX AS APPROPRIATE FOR INSTALLATION.

NOTES:

FOR ELECTRICAL TORQUE SPECIFICATIONS SEE DWG NO. 128783-01-000

FOR ELECTRICAL CALLOUTS SEE DWG NO. 121339-01-000

265 CODES/STANDARDS-CSA/CMVSS

1B1 CODES/STANDARDS USA

1B1 265



DSNR:		ALL DIMENSIONS ARE IN MILLIMETERS	
DIFFR:		MATERIAL:	
UNSPECIFIED TOLERANCES:			
WHOLE DIM (X)	: 3		
ONE-PLACE (X.X)	: 1.5		
TWO-PLACE (X.XX)	: 0.50		
ANGLE	: 1°		
REFER TO ES0018 FOR FASTENER TIGHTENING GUIDELINES	WEIGHT: (LBS)	FIRST USED:	18 322R

WIRING INSTL-BODY, 110V

SHEET:	ITEM/PART NO.:	REF:	REV:
1 OF 5	000038565 / 31892101000		

8 7 6 5 4 3 2 1

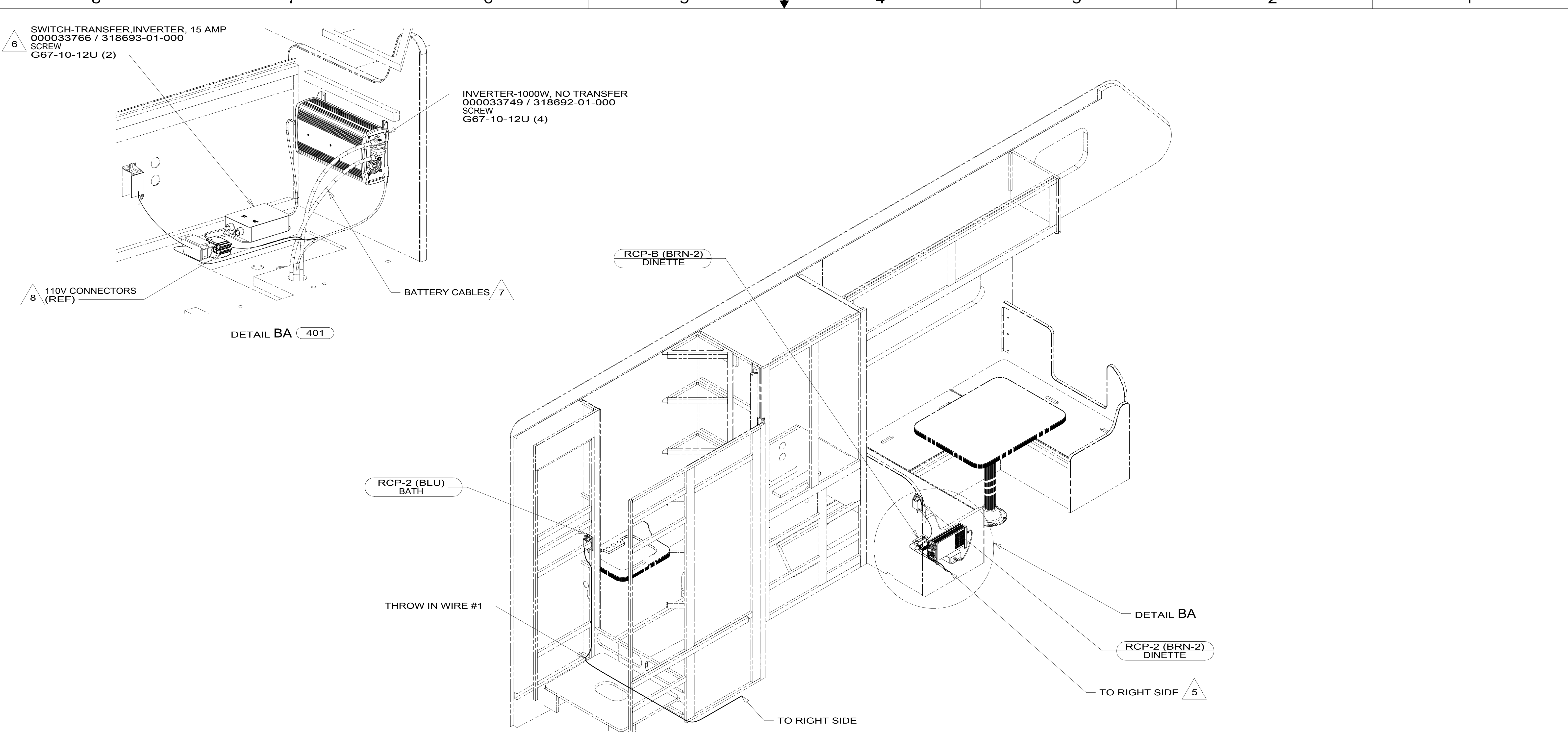

- 8 CONNECT INVERTER INPUT TO BRN WIRE, INVERTER OUTPUT TO BRN-2 WIRE.
- 7 CONNECT ORG CABLE TO RED (+) TERMINAL, BLK CABLE TO WHITE (-) TERMINAL, GROUND TO GROUND LUG.
- 6 PLUG TRANSFER SWITCH INTO 110V OUTLET IN INVERTER FRONT.
- 5 ROUTE WIRE THRU FLOOR.
- 4. FOR MORE INFORMATION SEE WIRING DIAGRAM-BODY, 110V.
- 3. ALL GROUND WIRE TO BE COVERED WITH TUBING 8041-02-000.
- 2. ALL 110V WIRE TO BE CLAMPED WITH CLAMP 10497-05-000 WITHIN 200MM OF OUTLET BOXES, USE SCREW G67-10-12B.
- 1. AT MINIMUM ALL WIRES TO BE SUPPORTED AND SECURED PER CODE REQUIREMENTS. USE CLAMP 10495 OR 10497 OR WIRE TIE 8343 OR 108046 AND SCREW G67-XX-XXX OR G56-XX-XXX AS APPROPRIATE FOR INSTALLATION.

NOTES:

- 401 INVERTER-DC/AC, 1000 WATT
- 265 CODES/STANDARDS-CSA/CMVSS
- 1B1 CODES/STANDARDS USA

FOR ELECTRICAL TORQUE SPECIFICATIONS SEE DWG NO. 128783-01-000

FOR ELECTRICAL CALLOUTS SEE DWG NO. 121339-01-000

DESCRIPTION:		1B1 265	
WIRING INSTL-BODY, 110V			
SHEET:	ITEM/PART NO.:	REV	
2 OF 5	000038565 / 31892101000		

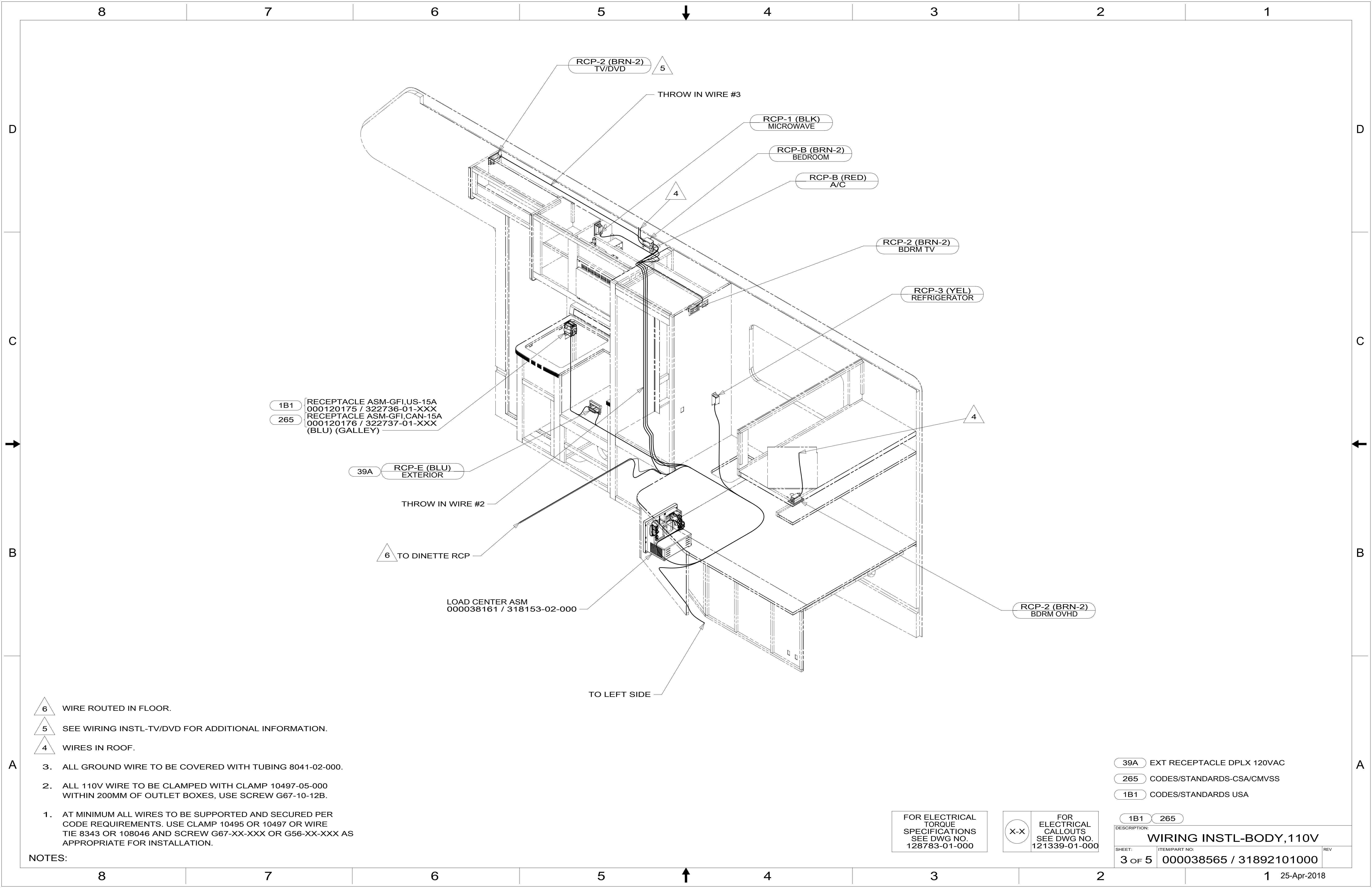

1B1 RECEPTACLE ASM-GFI,US-15A
000120175 / 322736-01-XXX
265 RECEPTACLE ASM-GFI,CAN-15A
000120176 / 322737-01-XXX
(BLU) (GALLEY)

39A RCP-E (BLU)
EXTERIOR

6 TO DINETTE RCP

LOAD CENTER ASM
000038161 / 318153-02-000

RCP-2 (BRN-2)
BDRM OVHD

- 6 WIRE ROUTED IN FLOOR.
- 5 SEE WIRING INSTL-TV/DVD FOR ADDITIONAL INFORMATION.
- 4 WIRES IN ROOF.

- NOTES:
3. ALL GROUND WIRE TO BE COVERED WITH TUBING 8041-02-000.
 2. ALL 110V WIRE TO BE CLAMPED WITH CLAMP 10497-05-000 WITHIN 200MM OF OUTLET BOXES, USE SCREW G67-10-12B.
 1. AT MINIMUM ALL WIRES TO BE SUPPORTED AND SECURED PER CODE REQUIREMENTS. USE CLAMP 10495 OR 10497 OR WIRE TIE 8343 OR 108046 AND SCREW G67-XX-XXX OR G56-XX-XXX AS APPROPRIATE FOR INSTALLATION.

- 39A EXT RECEPTACLE DPLX 120VAC
- 265 CODES/STANDARDS-CSA/CMVSS
- 1B1 CODES/STANDARDS USA

FOR ELECTRICAL
TORQUE
SPECIFICATIONS
SEE DWG NO.
128783-01-000

FOR
ELECTRICAL
CALLOUTS
SEE DWG NO.
121339-01-000

DESCRIPTION:		1B1 265	
WIRING INSTL-BODY, 110V			
SHEET:	ITEM/PART NO.:	REV:	
3 OF 5	000038565 / 31892101000		

8 7 6 5 4 3 2 1

RED	1B1	136135-07-051	
	265	136136-07-051	
YEL	1B1	136131-05-027	
	265	136134-05-027	
BLK	1B1	136135-06-053	
	265	136136-06-053	
BRN	1B1	136131-03-051	4
	265	136134-03-051	4
BRN-2	1B1	136131-19-055	4
	265	136134-19-055	4
BLU	1B1	136131-02-052	
	265	136134-02-052	
THROW IN WIRE #1	1B1	136131-02-078	
	265	136134-02-078	
THROW IN WIRE #2	1B1	136131-03-007	
	265	136134-03-007	
THROW IN WIRE #3	1B1	136131-03-035	
	265	136134-03-035	
MAIN EXTENSION CABLE ASM	1B1	164957-15-044	5
	265	164957-16-044	5
GROUND MAIN		136145-06-016	

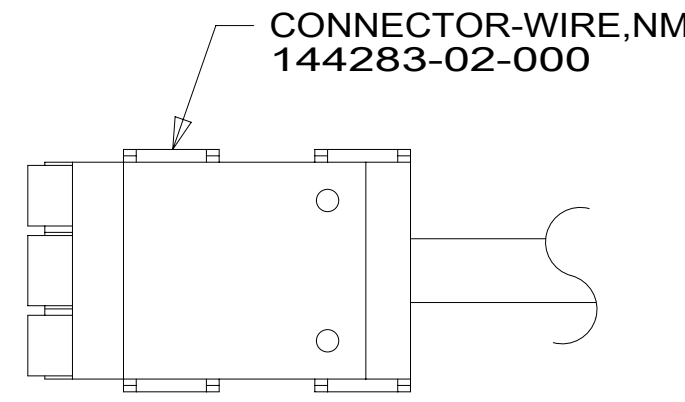

DETAIL DA

- 5 WIRE PREP TO INSTALL ON POWER CORD BOX ASM. LOAD CENTER END WILL BE INSTALLED ON LINE.
- 4 SEE DETAIL DA FOR CONNECTOR INSTALLATION.
3. SEE WIRING INSTL-BODY, 12V FOR ADDITIONAL INFORMATION.
2. SECURE WIRES TO BACKSIDE OF LOAD CENTER WITH WIRE TIE 116673-01-000.
1. ALL GROUND WIRES TO BE COVERED WITH TUBING 8041-02-000.

NOTES:

265 CODES/STANDARDS-CSA/CMVSS
 1B1 CODES/STANDARDS USA

FOR ELECTRICAL TORQUE SPECIFICATIONS SEE DWG NO. 128783-01-000

FOR ELECTRICAL CALLOUTS SEE DWG NO. 121339-01-000

DESCRIPTION: 1B1 265
WIRING INSTL-BODY, 110V

SHEET: 4 OF 5 ITEM/PART NO: 000038565 / 31892101000 REV

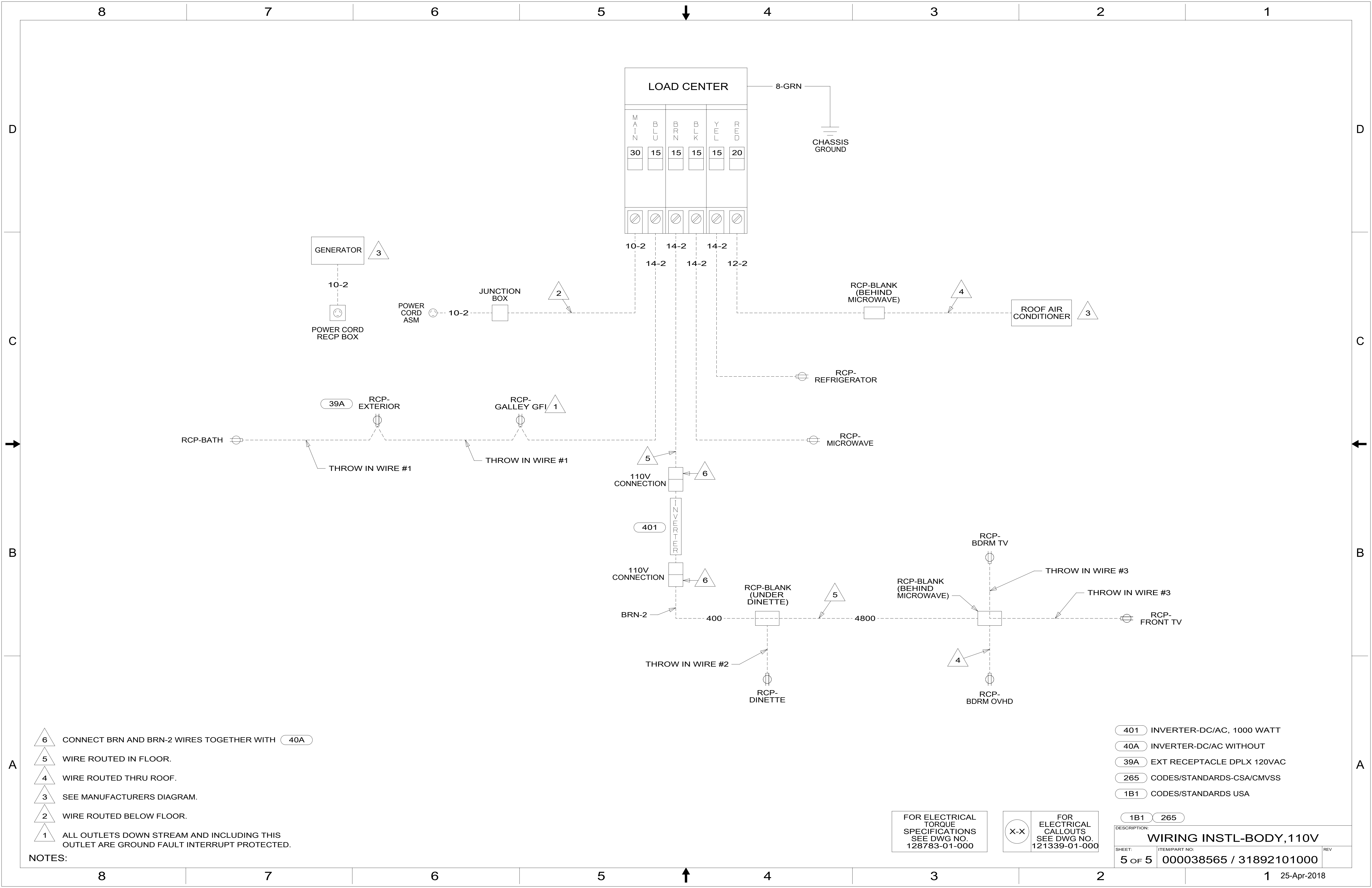

LOAD CENTER

MAIN	BLU	BRN	BLK	YEL	RED
30	15	15	15	15	20

10-2 14-2 14-2 12-2

8-GRN

CHASSIS GROUND

GENERATOR

10-2

POWER CORD RECP BOX

JUNCTION BOX

POWER CORD ASM

10-2

RCP-BLANK (BEHIND MICROWAVE)

ROOF AIR CONDITIONER

RCP-REFRIGERATOR

RCP-MICROWAVE

39A RCP-EXTERIOR

RCP-GALLEY GFI

RCP-BATH

THROW IN WIRE #1

THROW IN WIRE #1

110V CONNECTION

401

110V CONNECTION

BRN-2

RCP-BLANK (UNDER DINETTE)

400

RCP-DINETTE

THROW IN WIRE #2

RCP-BLANK (BEHIND MICROWAVE)

4800

RCP-BDRM TV

RCP-BDRM OVHD

THROW IN WIRE #3

THROW IN WIRE #3

RCP-FRONT TV

6 CONNECT BRN AND BRN-2 WIRES TOGETHER WITH 40A

5 WIRE ROUTED IN FLOOR.

4 WIRE ROUTED THRU ROOF.

3 SEE MANUFACTURERS DIAGRAM.

2 WIRE ROUTED BELOW FLOOR.

1 ALL OUTLETS DOWN STREAM AND INCLUDING THIS OUTLET ARE GROUND FAULT INTERRUPT PROTECTED.

401 INVERTER-DC/AC, 1000 WATT

40A INVERTER-DC/AC WITHOUT

39A EXT RECEPTACLE DPLX 120VAC

265 CODES/STANDARDS-CSA/CMVSS

1B1 CODES/STANDARDS USA

FOR ELECTRICAL TORQUE SPECIFICATIONS SEE DWG NO. 128783-01-000

FOR ELECTRICAL CALLOUTS SEE DWG NO. 121339-01-000

1B1 265

DESCRIPTION: **WIRING INSTL-BODY, 110V**

SHEET: 5 OF 5 ITEM/PART NO.: 000038565 / 31892101000 REV