

8 7 6 5 4 3 2 1

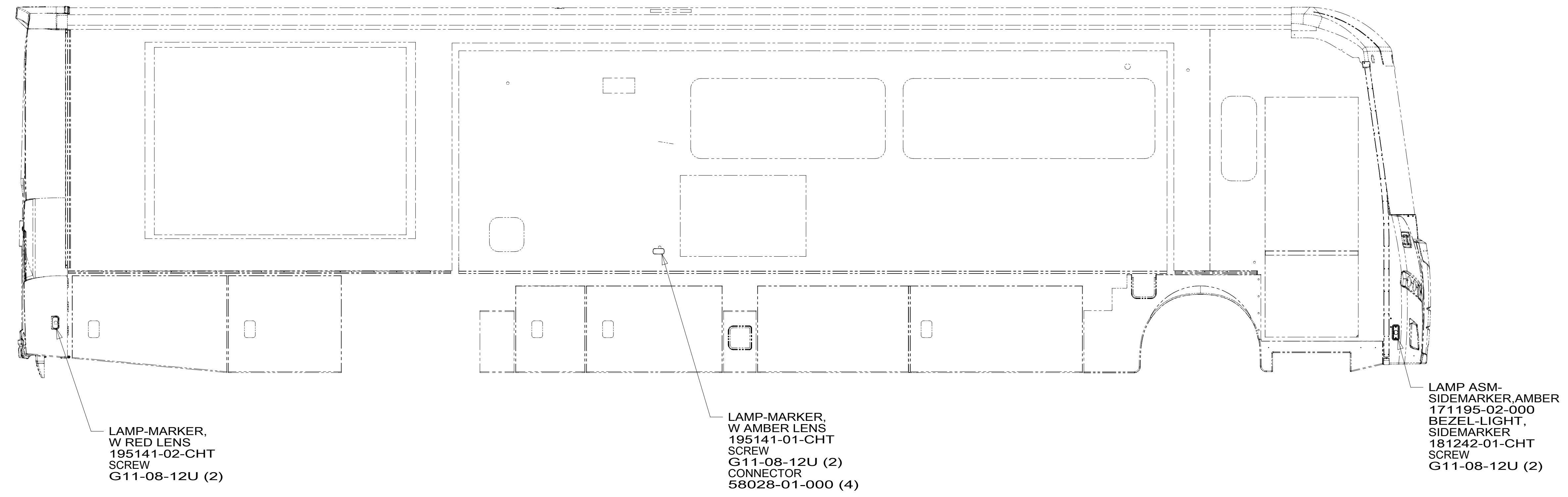

- 265 CODES/STANDARDS-CSA/CMVSS
- 1B1 CODES/STANDARDS USA
- 1B1 265

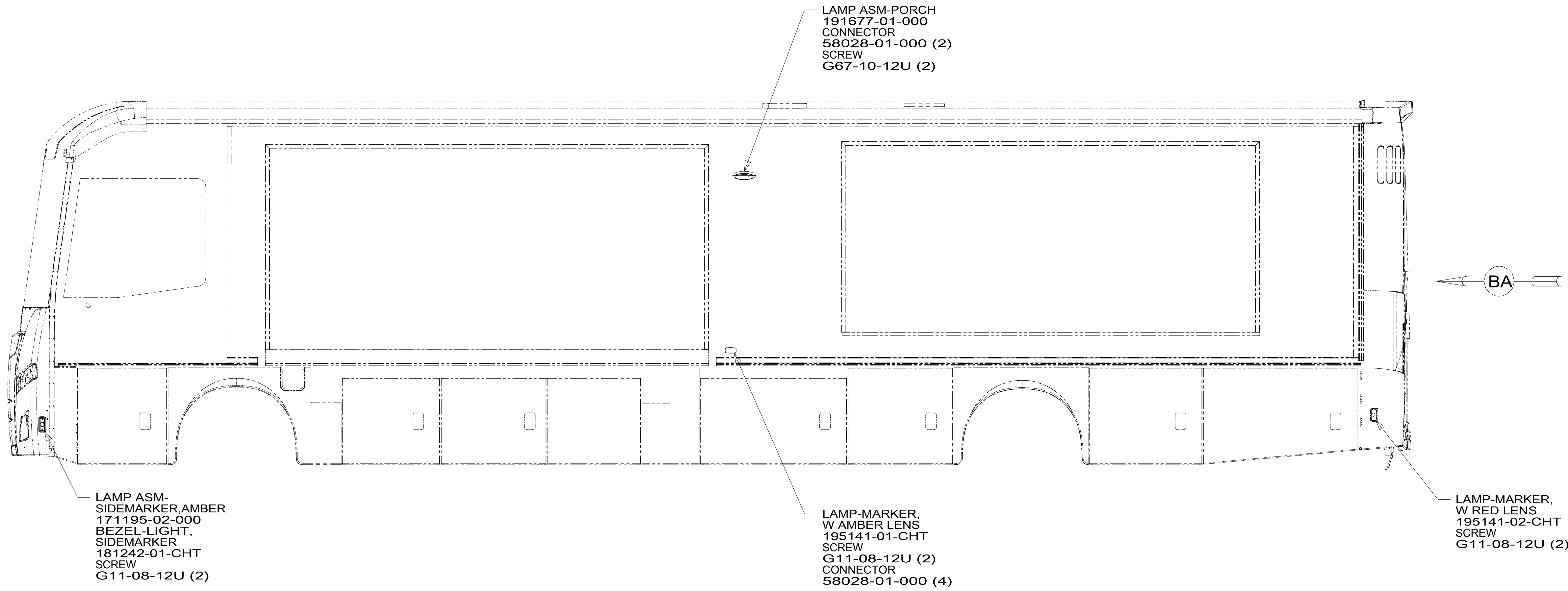

DSNR:		ALL DIMENSIONS ARE IN MILLIMETERS	
DFFR:		MATERIAL:	
UNSPECIFIED TOLERANCES:			
WHOLE DIM (X)	± 3		
ONE-PLACE (X.X)	± 1.5		
TWO-PLACE (X.XX)	± 0.50		
ANGLE	± 1°		
REFER TO ES0018 FOR FASTENER TIGHTENING GUIDELINES		WEIGHT: (LBS)	FIRST USED:
			18 P-SER

FOR ELECTRICAL TORQUE SPECIFICATIONS SEE DWG NO. 128783-01-000

FOR ELECTRICAL CALLOUTS SEE DWG NO. 121339-01-000

WIRING INSTL-EXTERIOR LAMPS

SHEET: 1 OF 3 ITEM/PART NO.: 000026376 / 31560901000 REV:

8 7 6 5 4 3 2 1

8

7

6

5

4

3

2

1

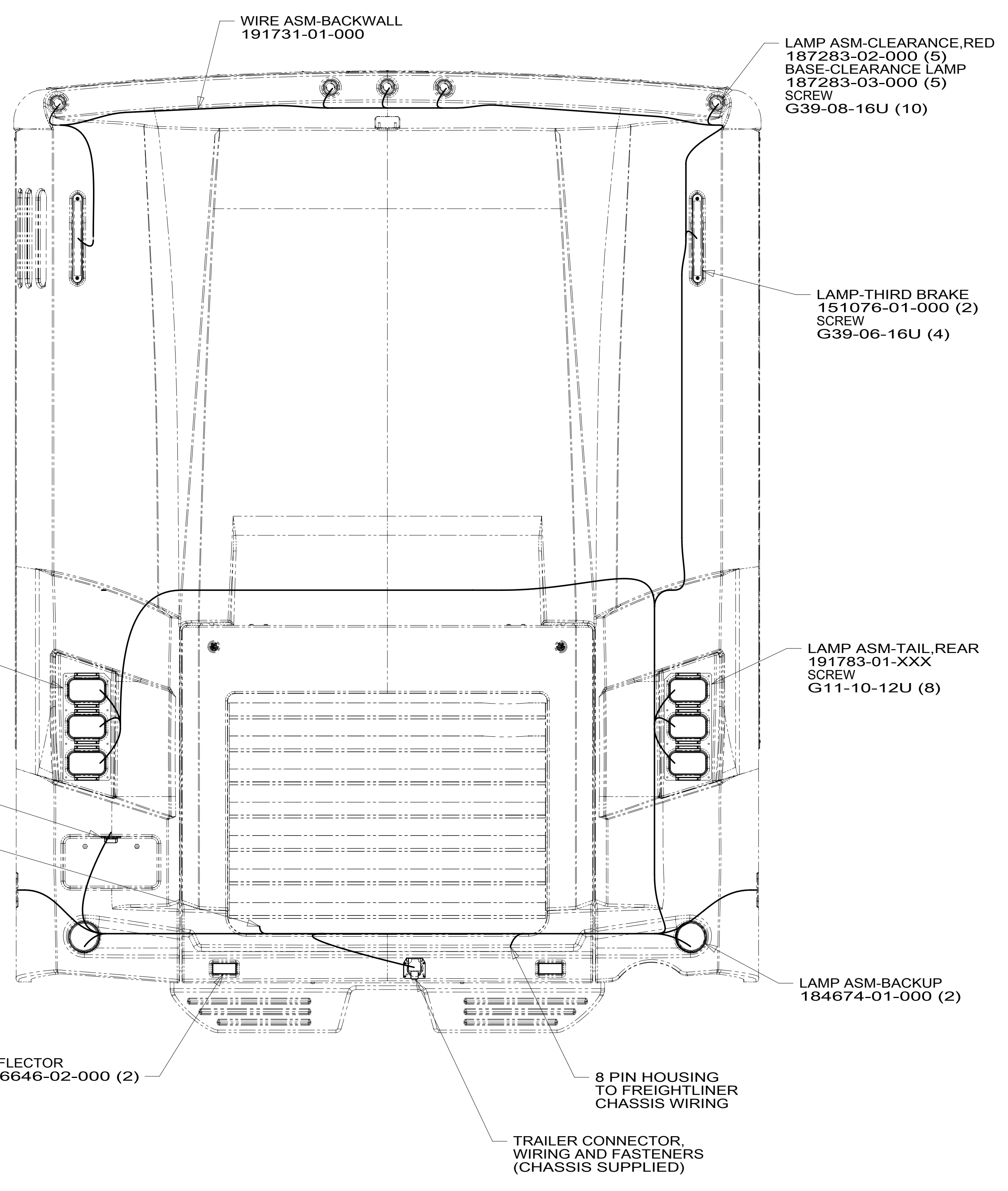

VIEW BA

1 REMOVE PAPER BACKING FROM REFLECTOR AND PREP APPLICATION SURFACE WITH ISOPROPYL ALCOHOL WIPE BEFORE INSTALLATION.

NOTES:

FOR ELECTRICAL TORQUE SPECIFICATIONS SEE DWG NO. 128783-01-000

FOR ELECTRICAL CALLOUTS SEE DWG NO. 121339-01-000

- 265 CODES/STANDARDS-CSA/CMVSS
- 1B1 CODES/STANDARDS USA

DESCRIPTION:	
1B1 265	
WIRING INSTL-EXTERIOR LAMPS	
SHEET:	ITEM/PART NO. REV
2 OF 3	000026376 / 31560901000

8

7

6

5

4

3

2

1

01-Jun-2017

8 7 6 5 4 3 2 1

D
C
B
A

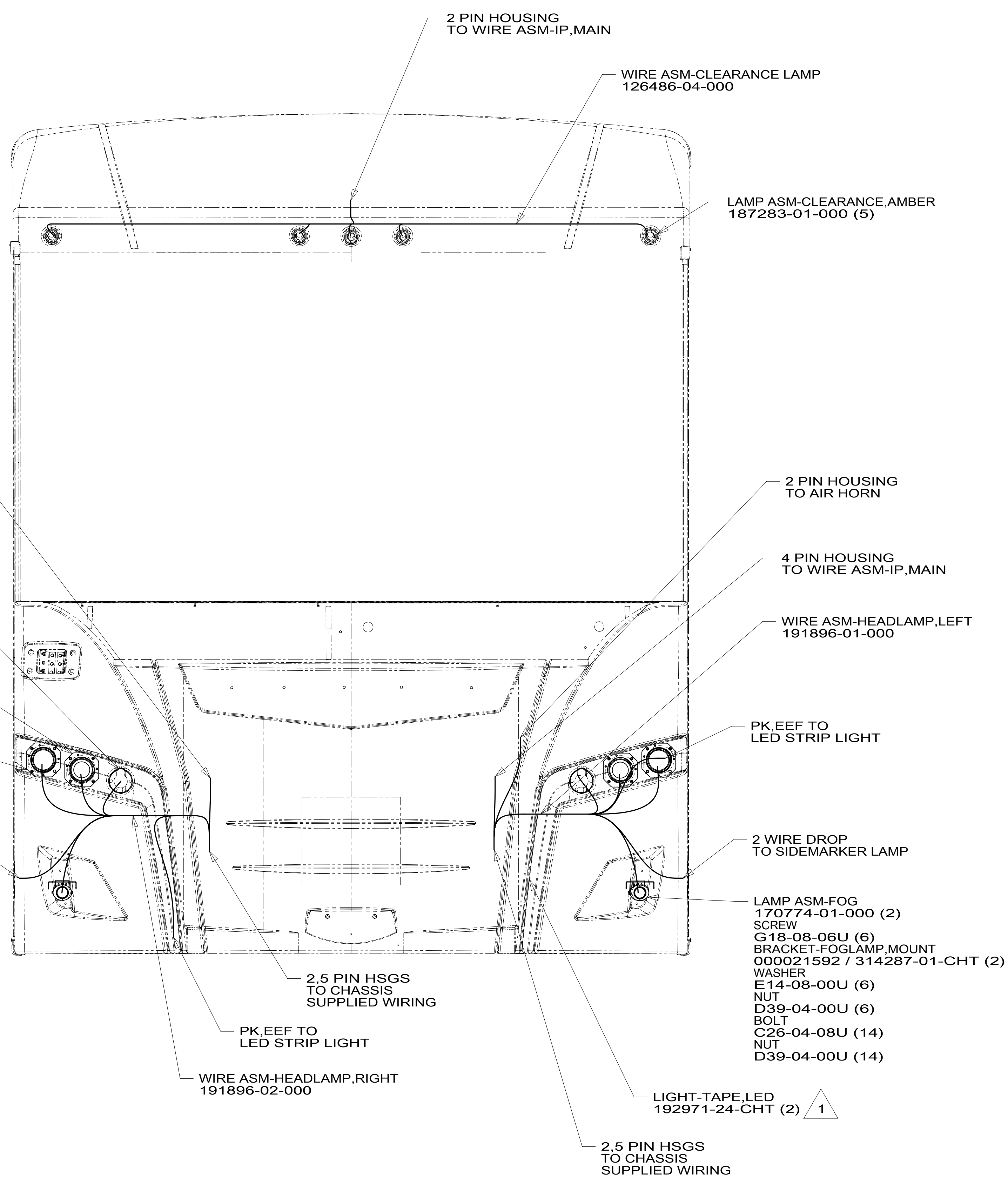

1 MOUNT TO FIBERGLASS AFTER PAINT AND CLEAR COAT. CLEAN SURFACE WITH ISOPROPYL ALCOHOL. REMOVE SMALL AREA OF TAPE LINER ON TOP AND BOTTOM OF THE BACK SIDE OF LIGHT STRIP. APPLY PRIMER 176823-01-000 TO ENDS OF LIGHT STRIP. LET DRY AND THEN APPLY ADHESIVE 176824-01-000 IN THE SAME AREA. REMOVE REMAINING TAPE LINER AND APPLY TO PAINTED FIBERGLASS SURFACE. DO NOT APPLY PRIMER OR ADHESIVE DIRECTLY ON PAINTED FIBERGLASS SURFACE.

NOTES:

VIEW CA

FOR ELECTRICAL TORQUE SPECIFICATIONS SEE DWG NO. 128783-01-000

FOR ELECTRICAL CALLOUTS SEE DWG NO. 121339-01-000

265 CODES/STANDARDS-CSA/CMVSS
1B1 CODES/STANDARDS USA

DESCRIPTION:	1B1 265	
WIRING INSTL-EXTERIOR LAMPS		
SHEET:	ITEM/PART NO.:	REV
3 OF 3	000026376 / 31560901000	

8 7 6 5 4 3 2 1 01-Jun-2017