

8 7 6 5 4 3 2 1

D

D

C

C

B

B

A

A

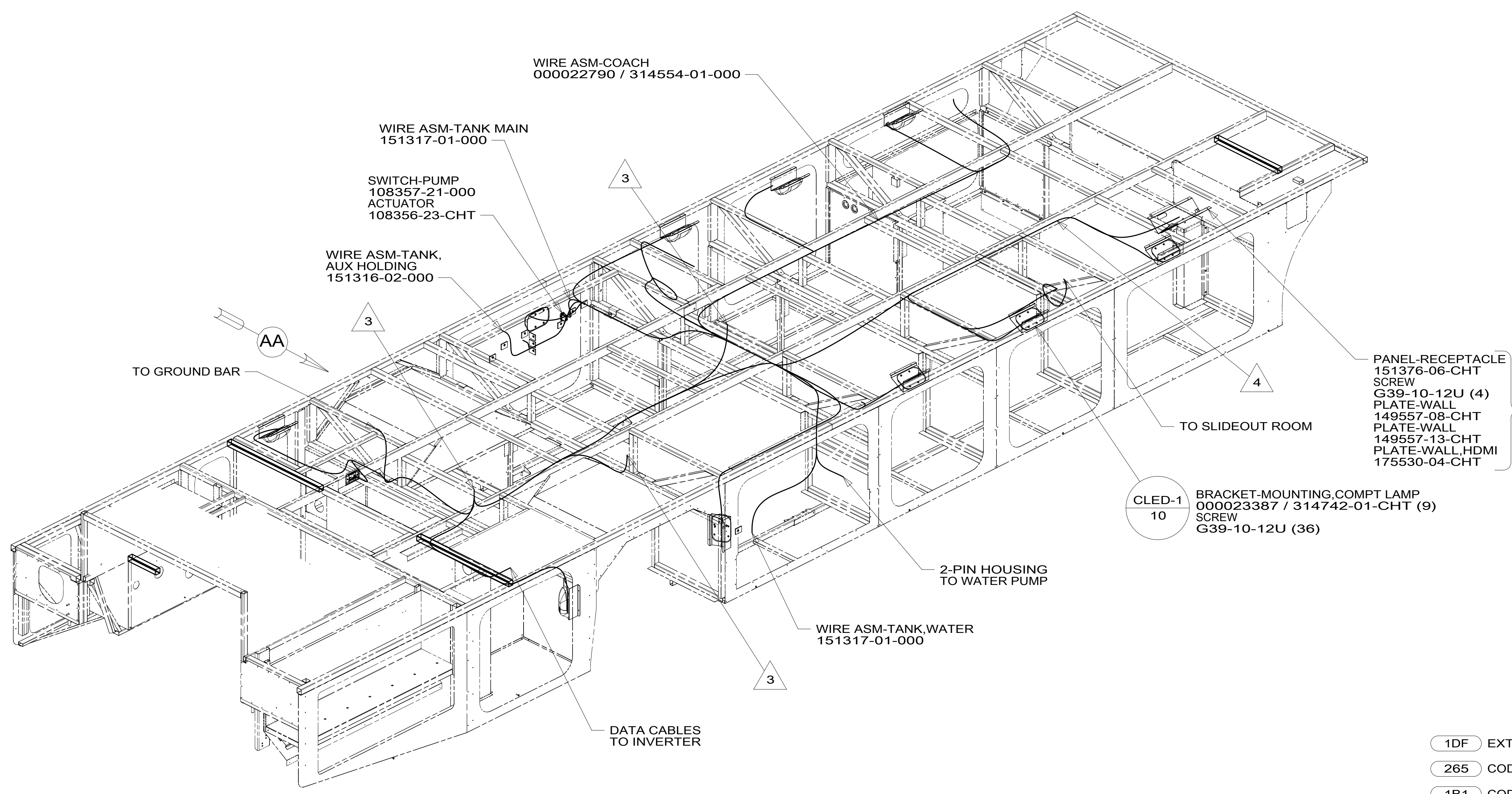

- 5 NOT USED WITH 1DF
ROUTE WIRES INTO SLIDEROOM FOR IN-WALL EXTERIOR TV.
- 4 ROUTE WIRES BELOW FLOOR.
- 3 WIRE PASSES THROUGH FLOOR IN THIS AREA.

2. ROUTE TANK SENSOR WIRES SO THEY DO NOT PASS OVER SENSORS. USE WIRE TIE MOUNT 155366-01-000 AND WIRE TIE 8343-01-000 AS NEEDED. TANK SURFACE MUST BE CLEANED USING ISOPROPYL ALCOHOL AND PRIMED WITH PRIMER 94.
1. AT MINIMUM ALL WIRES TO BE SUPPORTED AND SECURED PER CODE REQUIREMENTS. USE CLAMP 10495 OR 10497 OR WIRE TIE 8343 OR 108046 AND SCREW G67-XX-XXX OR G56-XX-XXX AS APPROPRIATE FOR INSTALLATION.

NOTES:

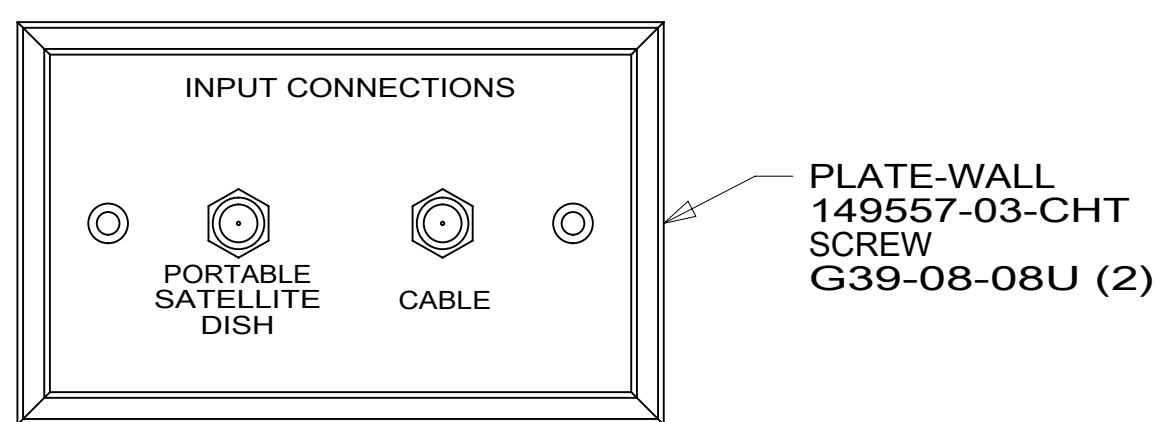

VIEW AA

FOR ELECTRICAL TORQUE SPECIFICATIONS SEE DWG NO. 128783-01-000

FOR ELECTRICAL CALLOUTS SEE DWG NO. 121339-01-000

- 1DF EXT TV ENTERTAINMENT CENTER
- 265 CODES/STANDARDS-CSA/CMVSS
- 1B1 CODES/STANDARDS USA

1B1 265

COPYRIGHT 2016 WINNEBAGO INDUSTRIES, INC.

DSNR:	ALL DIMENSIONS ARE IN MILLIMETERS
DFFR:	
UNSPECIFIED TOLERANCES:	MATERIAL:
WHOLE DIM (X) : 3	
ONE-PLACE (X.X) : 1.5	
TWO-PLACE (X.XX) : 0.50	
ANGLE : 1°	
REFER TO ES0018 FOR FASTENER TIGHTENING GUIDELINES	WEIGHT: (LBS) FIRST USED: 17 L36G
DESCRIPTION: WIRING INSTL-BODY, 12V	
SHEET: 1 OF 8	ITEM/PART NO: 000022818 / 31456501000
REF:	1 04-Dec-2017

8 7 6 5 4 3 2 1

8 7 6 5 4 3 2 1

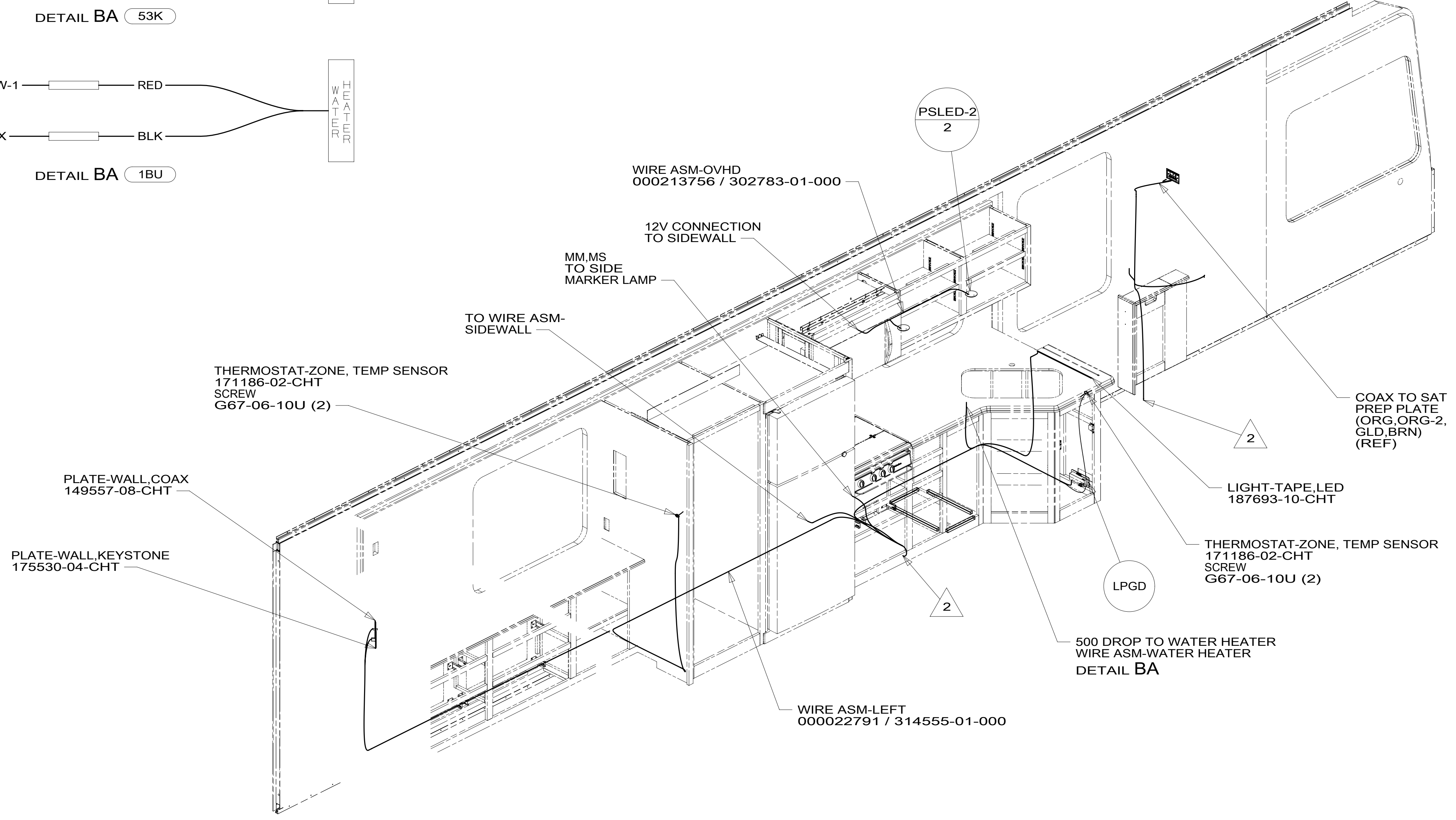
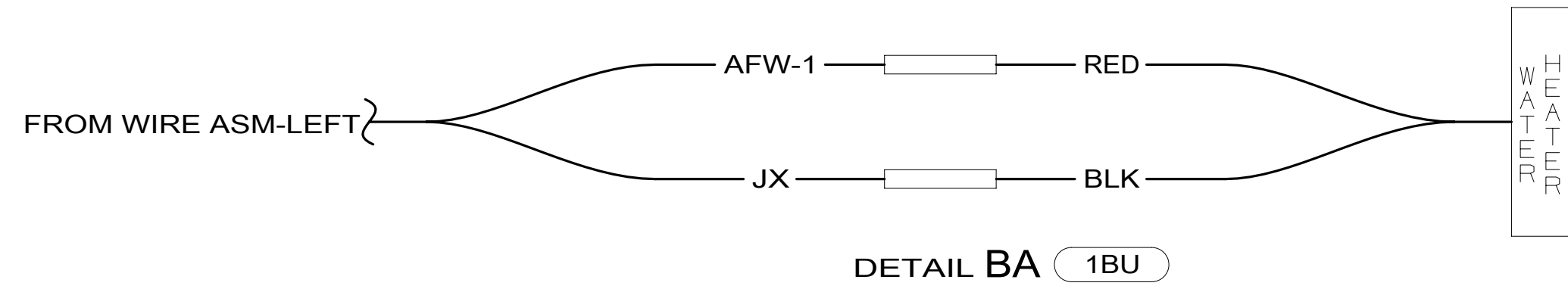
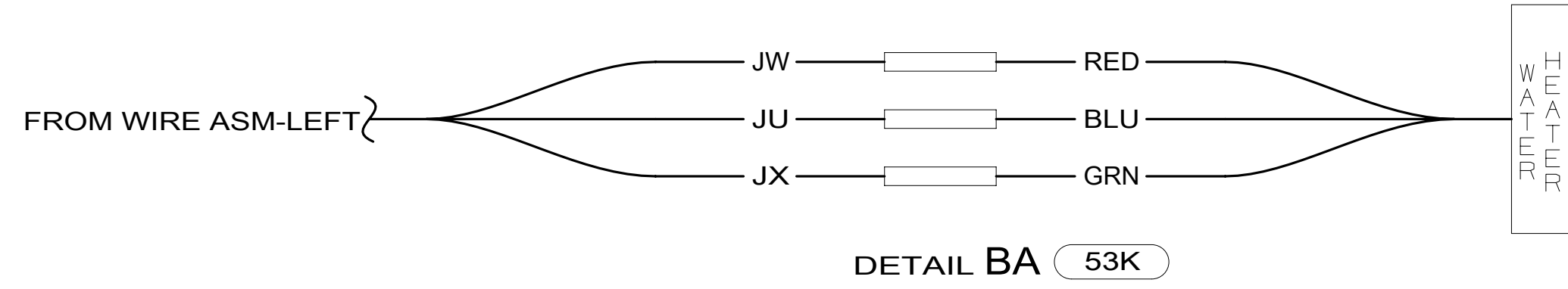

2 WIRE PASSES THROUGH FLOOR IN THIS AREA.

1. AT MINIMUM ALL WIRES TO BE SUPPORTED AND SECURED PER CODE REQUIREMENTS. USE CLAMP 10495 OR 10497 OR WIRE TIE 8343 OR 108046 AND SCREW G67-XX-XXX OR G56-XX-XXX AS APPROPRIATE FOR INSTALLATION.

NOTES:

- 1BU WTR HTR TKLS W/RECIRCUL PUMP
- 53K WTR HTR-10GAL/ELECTRIC/LPGAS
- 265 CODES/STANDARDS-CSA/CMVSS
- 1B1 CODES/STANDARDS USA

FOR ELECTRICAL TORQUE SPECIFICATIONS SEE DWG NO. 128783-01-000

FOR ELECTRICAL CALLOUTS SEE DWG NO. 121339-01-000

DESCRIPTION: 1B1 265		
WIRING INSTL-BODY, 12V		
SHEET: 2 OF 8	ITEM/PART NO: 000022818 / 31456501000	REV

8 7 6 5 4 3 2 1 04-Dec-2017

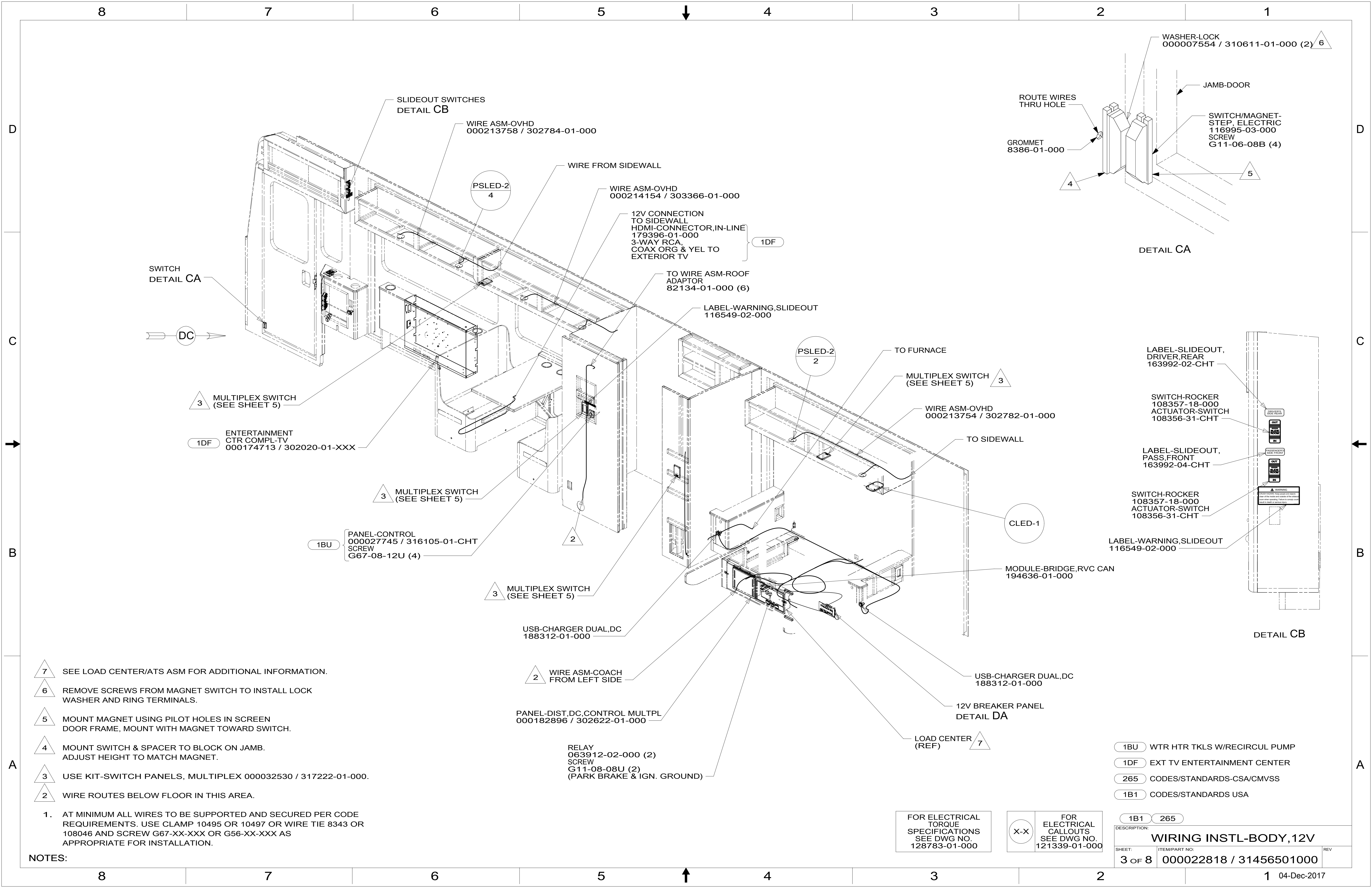

- 7 SEE LOAD CENTER/ATS ASM FOR ADDITIONAL INFORMATION.
- 6 REMOVE SCREWS FROM MAGNET SWITCH TO INSTALL LOCK WASHER AND RING TERMINALS.
- 5 MOUNT MAGNET USING PILOT HOLES IN SCREEN DOOR FRAME, MOUNT WITH MAGNET TOWARD SWITCH.
- 4 MOUNT SWITCH & SPACER TO BLOCK ON JAMB. ADJUST HEIGHT TO MATCH MAGNET.
- 3 USE KIT-SWITCH PANELS, MULTIPLEX 000032530 / 317222-01-000.
- 2 WIRE ROUTES BELOW FLOOR IN THIS AREA.

1. AT MINIMUM ALL WIRES TO BE SUPPORTED AND SECURED PER CODE REQUIREMENTS. USE CLAMP 10495 OR 10497 OR WIRE TIE 8343 OR 108046 AND SCREW G67-XX-XXX OR G56-XX-XXX AS APPROPRIATE FOR INSTALLATION.

NOTES:

RELAY
063912-02-000 (2)
SCREW
G11-08-08U (2)
(PARK BRAKE & IGN. GROUND)

FOR ELECTRICAL TORQUE SPECIFICATIONS SEE DWG NO. 128783-01-000

FOR ELECTRICAL CALLOUTS SEE DWG NO. 121339-01-000

- 1BU WTR HTR TKLS W/RECIRCUL PUMP
- 1DF EXT TV ENTERTAINMENT CENTER
- 265 CODES/STANDARDS-CSA/CMVSS
- 1B1 CODES/STANDARDS USA

DESCRIPTION: WIRING INSTL-BODY, 12V	
SHEET: 3 OF 8	ITEM/PART NO.: 000022818 / 31456501000
REV 04-Dec-2017	

8 7 6 5 4 3 2 1

CIRCUIT BREAKER
93654-02-000 (8)
(15 AMP)
SCREW
G52-06-04U (8)
WASHER
OME02B-04-071 (8)

HOUSE 12V CIRCUIT BREAKERS
(PUSH TO RESET)

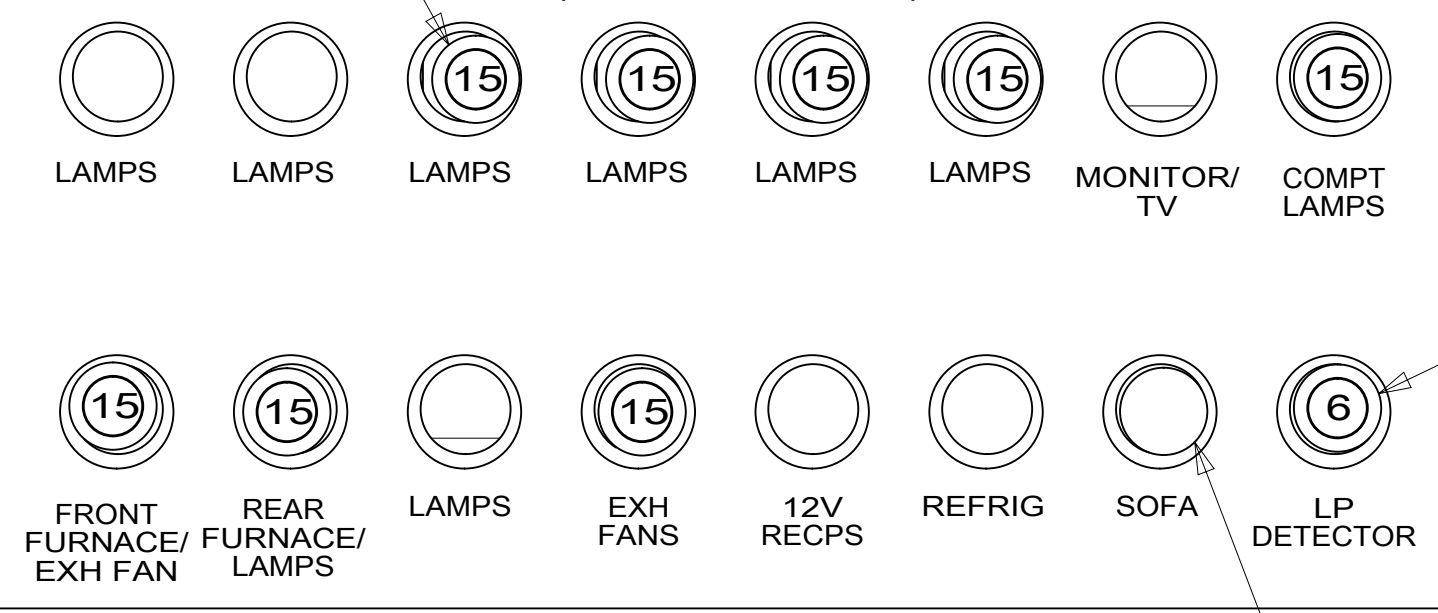
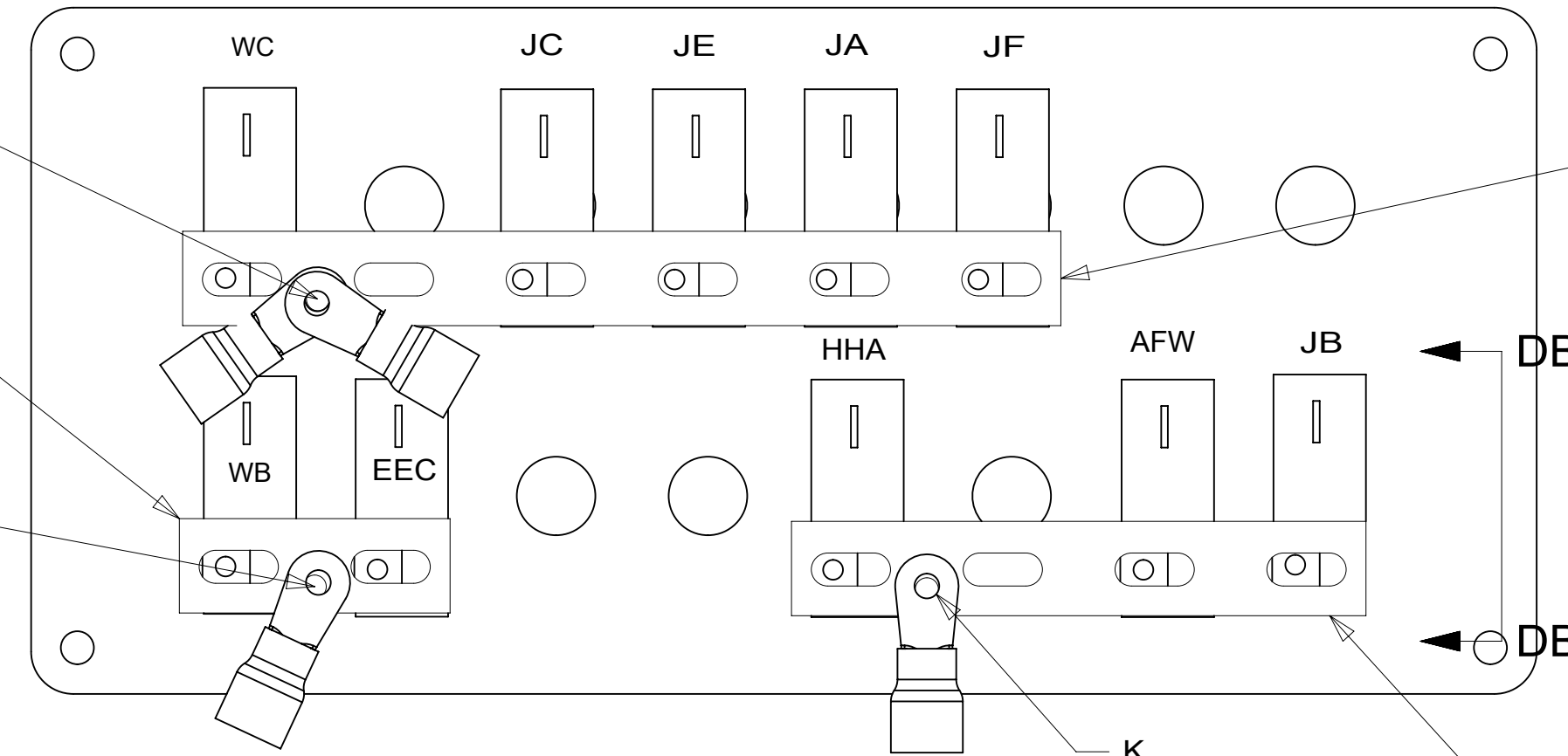

PLATE
139067-05-CHT
LABEL
92547-13-000
SCREW
G11-10-12U (4)

CIRCUIT BREAKER
93654-01-000
(6 AMP)
SCREW
G52-06-04U
WASHER
OME02B-04-071

CIRCUIT BREAKER
182283-01-000
(20 AMP)
SCREW
G52-06-04U
WASHER
OME02B-04-071

DETAIL DA
(FRONT VIEW)



J
6 BLK
FROM WIRE
ASM-CHASSIS
SCREW
G39-08-06U

BUSS BAR
141744-01-000
SCREW
G39-08-06U

J-1
6 BLK
(FROM WIRE
ASM-CHASSIS)

BUSS BAR
141744-05-000
SCREW
G39-08-06U

K
6 BLK
FROM WIRE
ASM-CHASSIS
SCREW
G39-08-06U

BUSS BAR
141744-03-000
SCREW
G39-08-06U

DETAIL DA
(BACK VIEW)

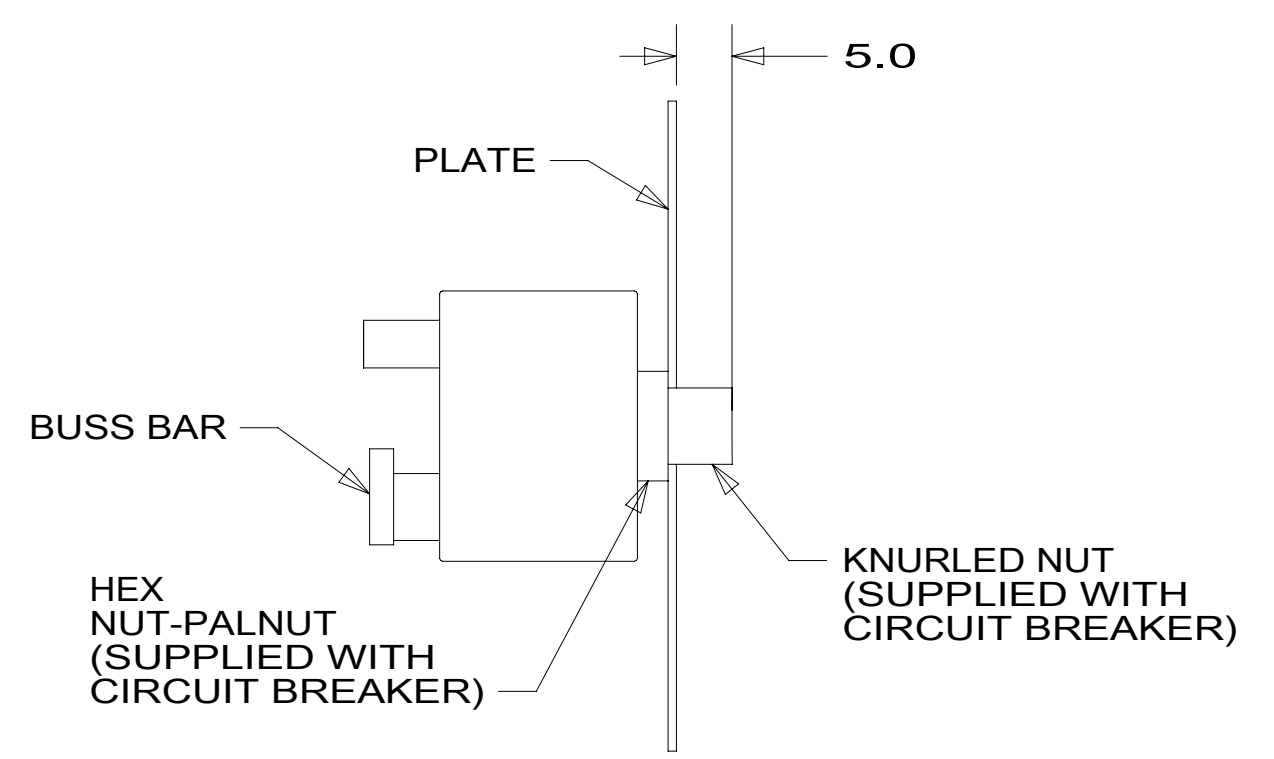

VIEW DB-DB

PLATE-SWITCH
176859-10-CHT
SCREW
G11-10-12U (4)
PANEL-SWITCH
MOUNTING,3-WAY
174834-01-CHT (2)

SWITCH-STEP COVER
174757-08-CHT

SWITCH-DOME LIGHT
145638-04-CHT

1 MULTIPLEX-SWITCH
(SEE SHEET 5)

SWITCH-PATIO
AWNING CONTROL
174757-03-CHT

SWITCH-AWNING POWER
174757-19-CHT

SWITCH-BLANK
145754-01-CHT

SWITCH-BLANK
145754-01-CHT

SWITCH-AUTO LEVEL
174757-04-CHT

SWITCH-CHASSIS
BATT DISC
174757-06-CHT
WIRE ASM-THERM
186796-01-000

SWITCH-ENTRY STEP
174757-27-CHT

SWITCH-COACH
BATT DISC
174757-07-CHT
WIRE ASM-THERM
186796-01-000

DETAIL DC

PLATE-SWITCH
000210580 / 303169-01-CHT
SCREW
G11-10-12U (6)

RELAYS
(AWNING IGNITION LOCKOUT,
PATIO AWNING)
063912-02-000 (3)
SCREW
G11-08-08U (3)

SWITCH-DOOR AWNING
174757-09-CHT

USB-CHARGER DUAL,DC
188312-01-000

PANEL-SWITCH
MOUNTING,3-WAY
174834-02-CHT

PANEL-SWITCH
MOUNTING,3-WAY
174834-02-CHT

- 15L RESIDENTIAL REFRIGERATOR PKG
- 79W REFRIGERATOR-4 DOOR
- 265 CODES/STANDARDS-CSA/CMVSS
- 1B1 CODES/STANDARDS USA

1B1 265

WIRING INSTL-BODY, 12V

DESCRIPTION:
SHEET: 4 OF 8 ITEM/PART NO: 000022818 / 31456501000 REV

FOR ELECTRICAL
TORQUE
SPECIFICATIONS
SEE DWG NO.
128783-01-000

X-X
FOR ELECTRICAL
CALLOUTS
SEE DWG NO.
121339-01-000

1 USE KIT # 000032530 / 317222-01-000.

NOTES:

8 7 6 5 4 3 2 1 04-Dec-2017

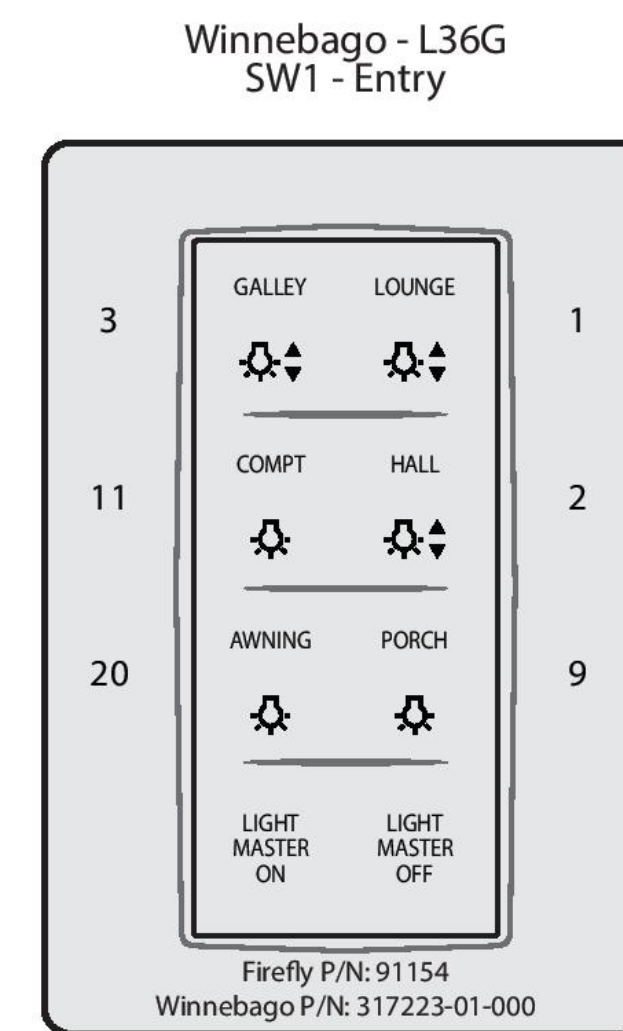
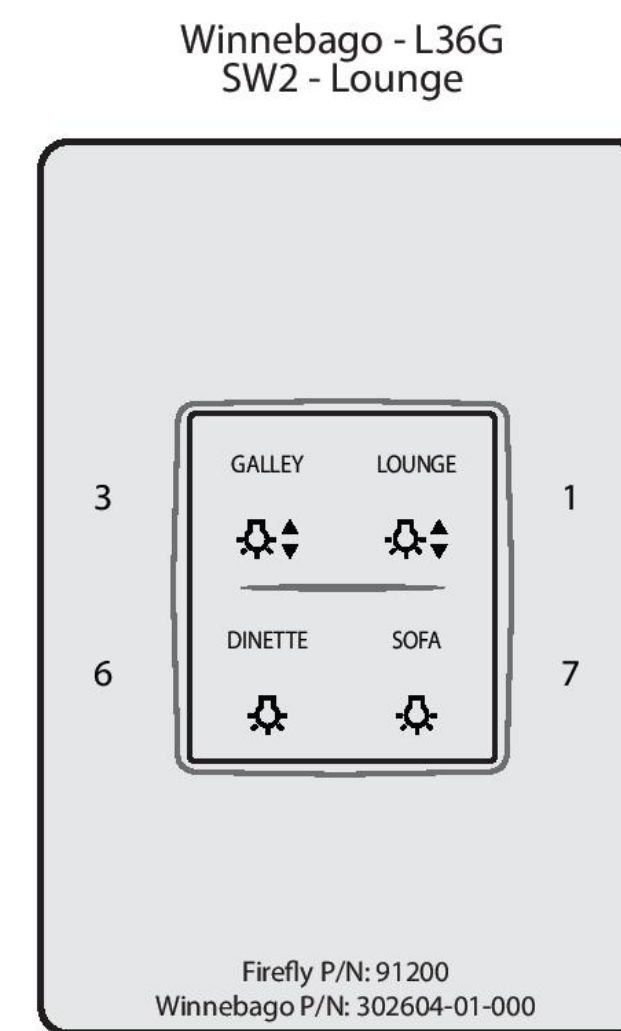
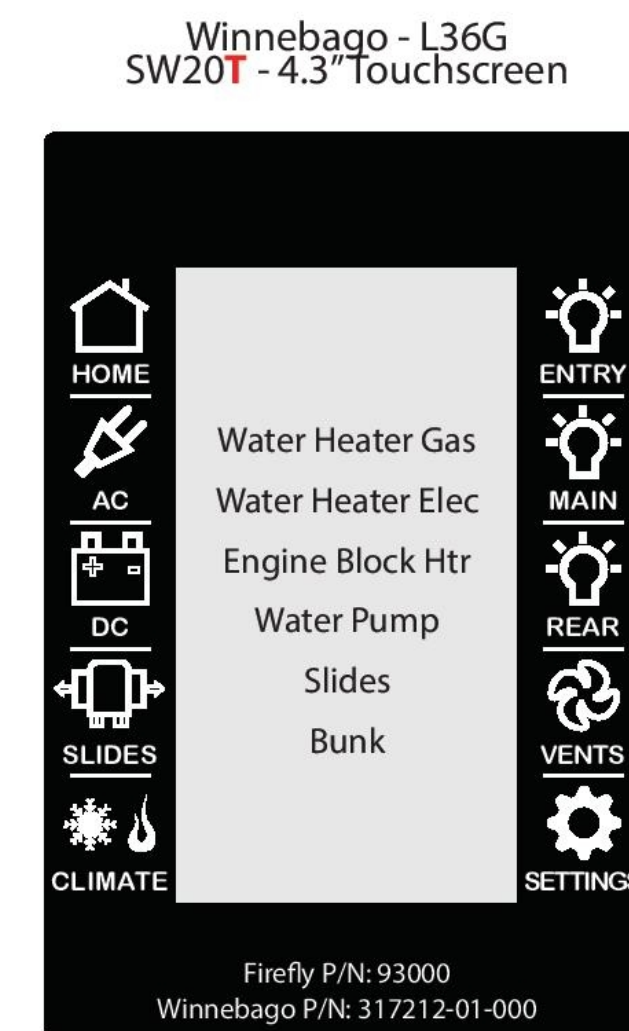
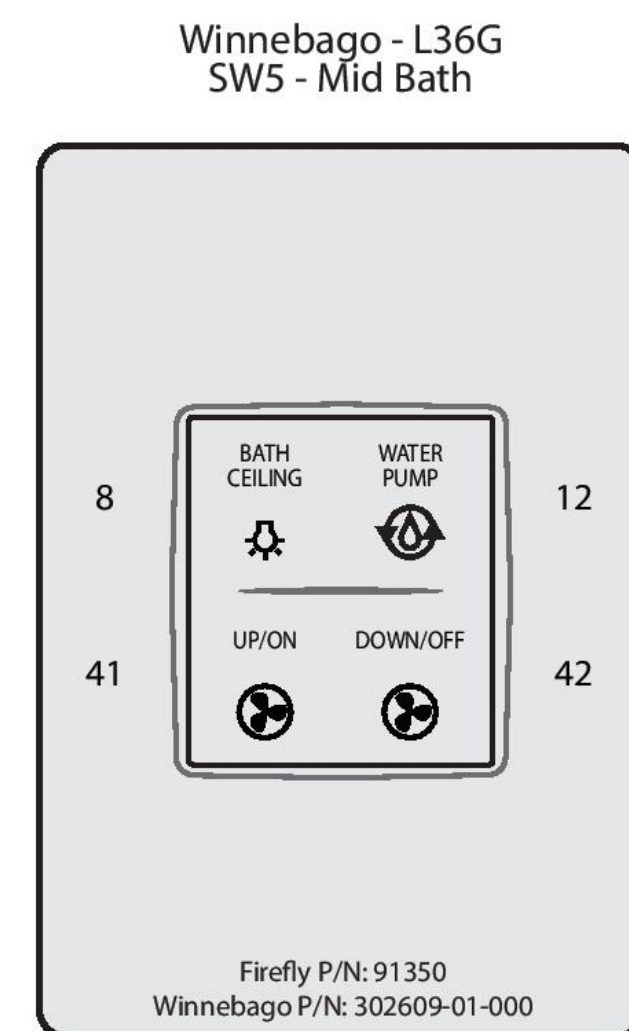
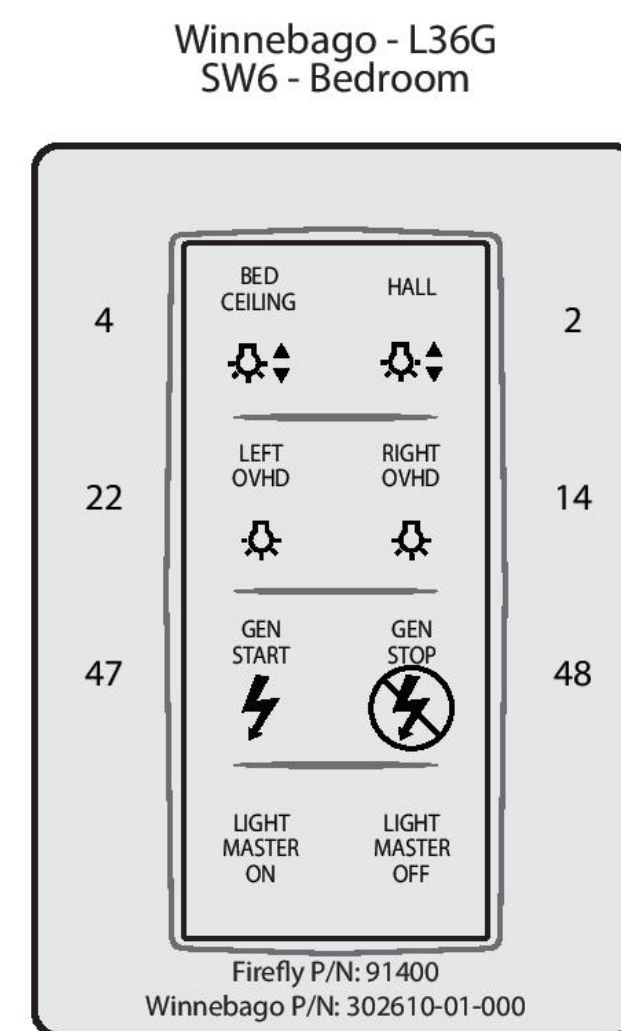
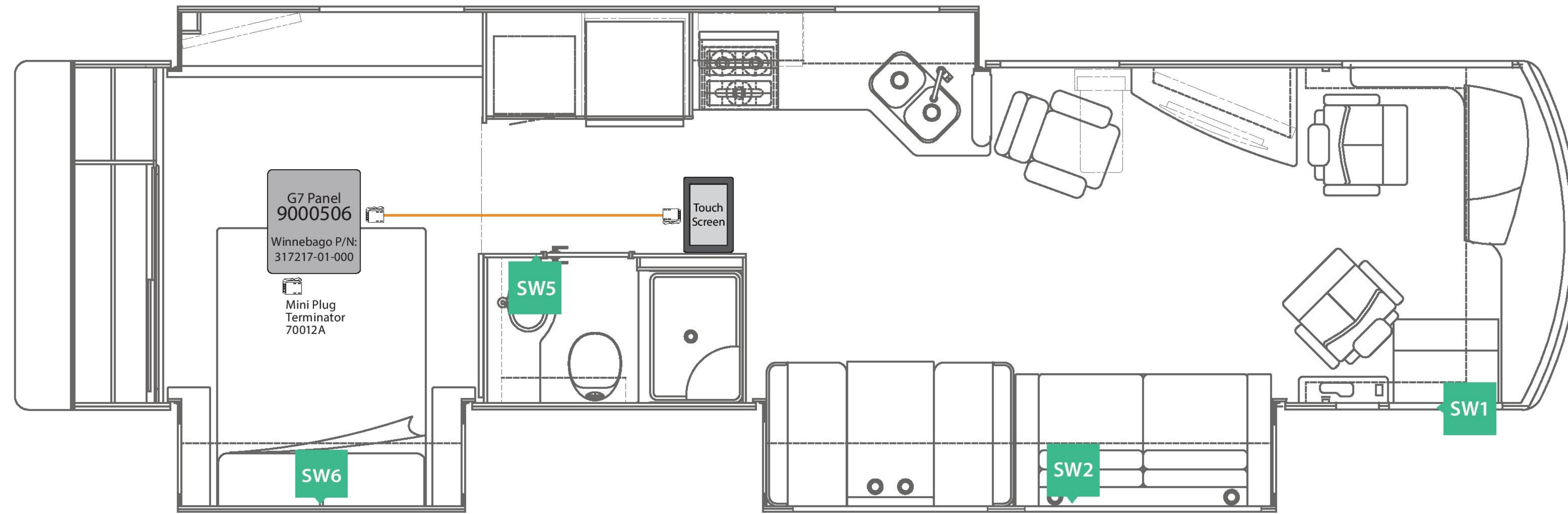

KIT*: Firefly P/N: 90851AB
Winnebago P/N: 317222-01-000
* Kits may not include all components shown on print.

WINNEBAGO - L36G - V2			DI: AD	Network Legend	
Network Wiring Diagram and Switch Panel Layout			PI: AD		
SSP-17 & 4.3" Screen (6v9)	Rev. 1v1	09/22/16		Trunk Cable	
				Drop Cable	
				Switch Position	

NOTES:
1. ALL SWITCH PANELS ARE PART OF KIT # 000032530 / 317222-01-000.

FOR ELECTRICAL TORQUE SPECIFICATIONS SEE DWG NO. 128783-01-000

FOR ELECTRICAL CALLOUTS SEE DWG NO. 121339-01-000

265 CODES/STANDARDS-CSA/CMVSS
1B1 CODES/STANDARDS USA

DESCRIPTION:	1B1 265
WIRING INSTL-BODY, 12V	
SHEET: 5 OF 8	ITEM/PART NO: 000022818 / 31456501000
REV	

8

7

6

5



4

3

2

1

D

D

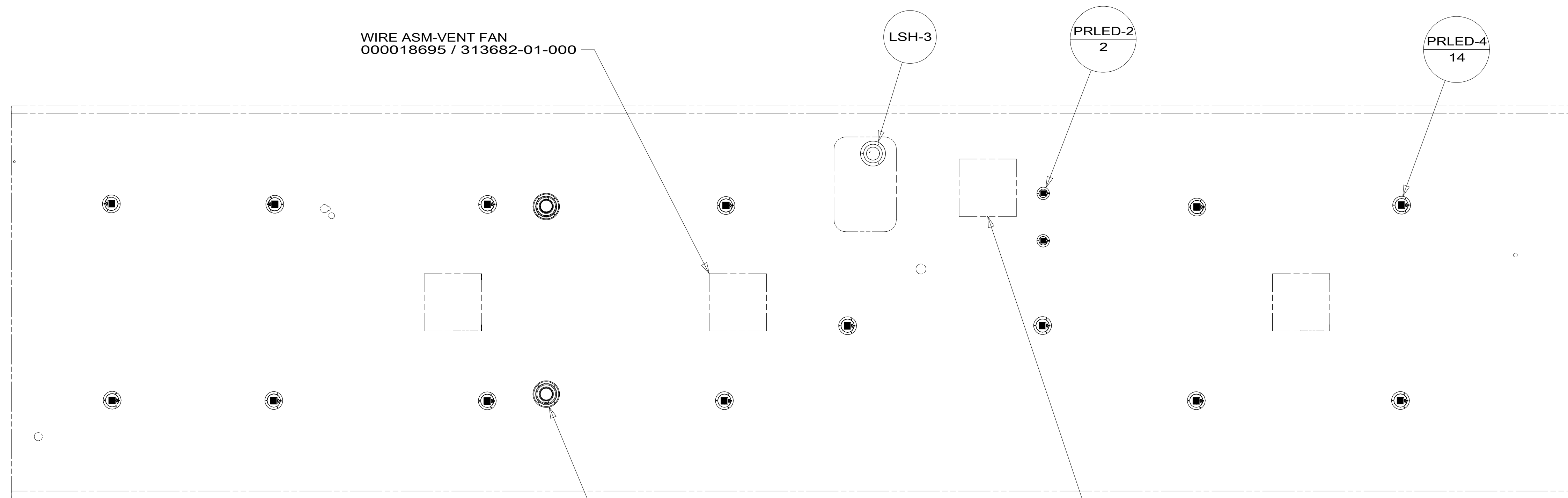

C

C



B

B

A

A

8

7

6

5



4

3

2

1

04-Dec-2017

WIRE ASM-VENT FAN
000018695 / 313682-01-000

LSH-3

PRLED-2
2

PRLED-4
14

SPEAKER-5-1/4"
180783-01-CHT (2)
SCREW
G11-08-12U (8)

571

WIRE ASM-VENT FAN
000018695 / 313682-01-000

- 571 RADIO SPEAKERS
- 265 CODES/STANDARDS-CSA/CMVSS
- 1B1 CODES/STANDARDS USA

FOR ELECTRICAL
TORQUE
SPECIFICATIONS
SEE DWG NO.
128783-01-000

X-X
FOR
ELECTRICAL
CALLOUTS
SEE DWG NO.
121339-01-000

DESCRIPTION:		1B1 265	
WIRING INSTL-BODY, 12V			
SHEET:	ITEM/PART NO.:	REV	
6 OF 8	000022818 / 31456501000		

8

7

6

5

4

3

2

1

THE SATELLITE DISH AND WIRE CONNECTIONS ARE TO BE PLACED ON THE CENTERLINE OF THE MOTORHOME FACING FORWARD.

SEPARATE CABLES AND INSTALL WIRE COVER OVER HOLE IN ROOF ASM WITH CABLES EXITING ON PASSENGERS SIDE.

WHEN APPLYING ROOF SEALANT TO SATELLITE DISH, PLACE ROOF SEALANT HERE (APPROX. 75MM WIDE) AND PUSH THE CABLES INTO THE SEALANT TO STABILIZE THEM.

CONNECT CABLE ASM-COAX FROM ROOF ASM TO COAX CABLES ON SATELLITE DISH AND CONNECT 10' CABLE-DATA FROM ROOF ASM TO DATA CABLE FROM SATELLITE DISH AND PLACE ALL CONNECTIONS BACK INTO ROOF ASM.

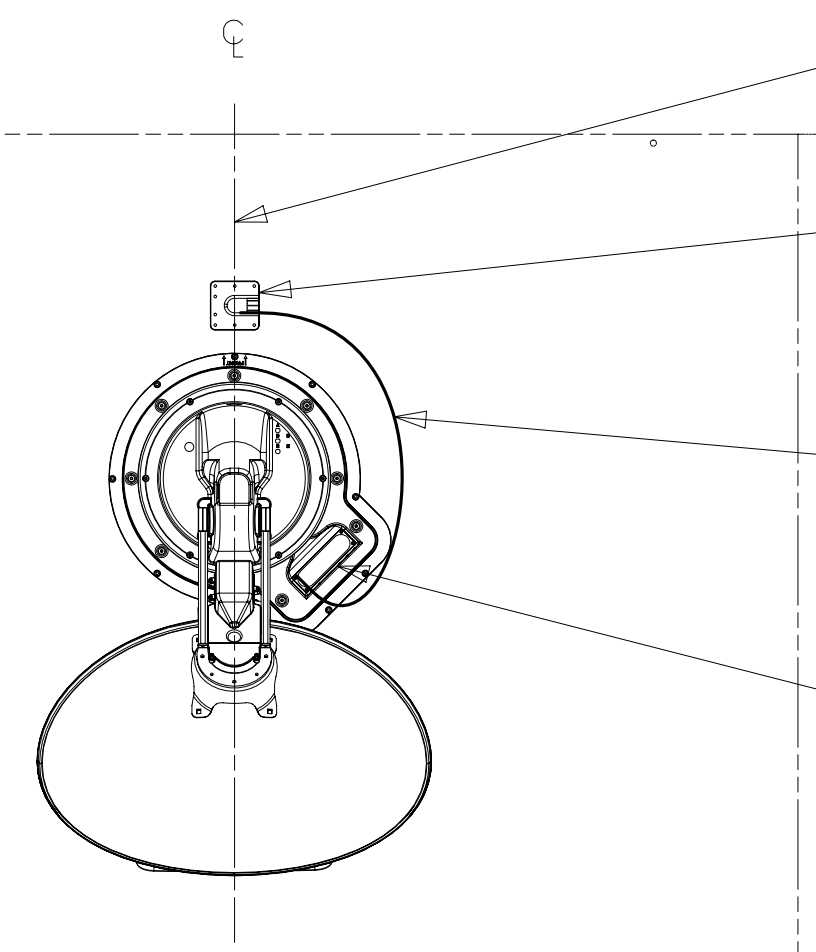

DETAIL GA

1 783 DA-4
DETAIL GA

1 193

ANTENNA-TV ROOF
000039180 / 318992-01-CHT
EXTENSION-CONNECTOR
179004-06-000
SCREW
G67-10-12U (6)

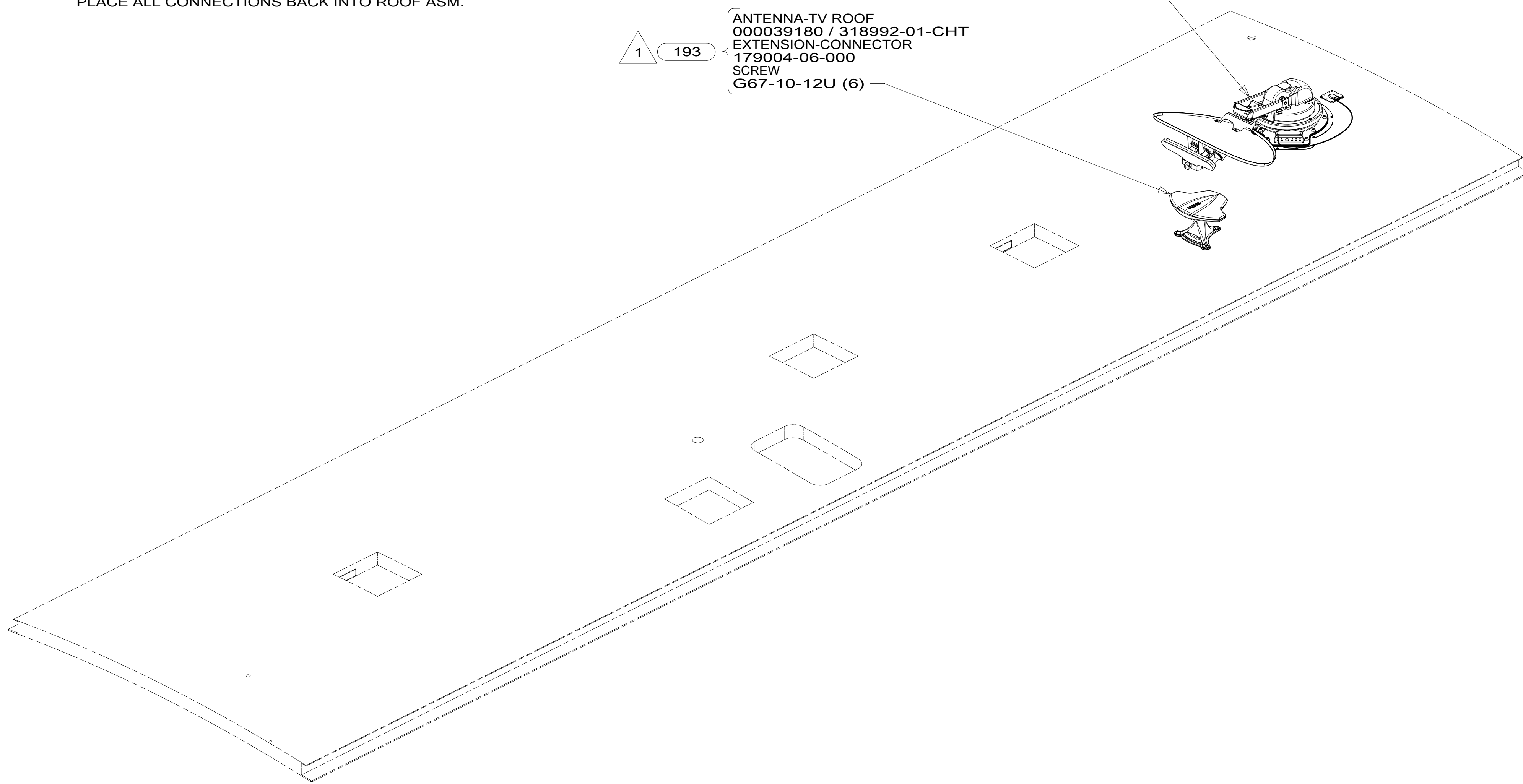

1 SEE MANUFACTURER'S INSTALLATION FOR ADDITIONAL INFORMATION.

NOTES:

FOR ELECTRICAL TORQUE SPECIFICATIONS SEE DWG NO. 128783-01-000

FOR ELECTRICAL CALLOUTS SEE DWG NO. 121339-01-000

- 783 SATELLITE HD TV SYSTEM AUTOC
- 193 TV ANTENNA-AMPLIFIED SYSTEM
- 265 CODES/STANDARDS-CSA/CMVSS
- 1B1 CODES/STANDARDS USA

1B1 265	
DESCRIPTION: WIRING INSTL-BODY, 12V	
SHEET: 7 OF 8	ITEM/PART NO: 000022818 / 31456501000
REV	

8

7

6

5

4

3

2

1

04-Dec-2017

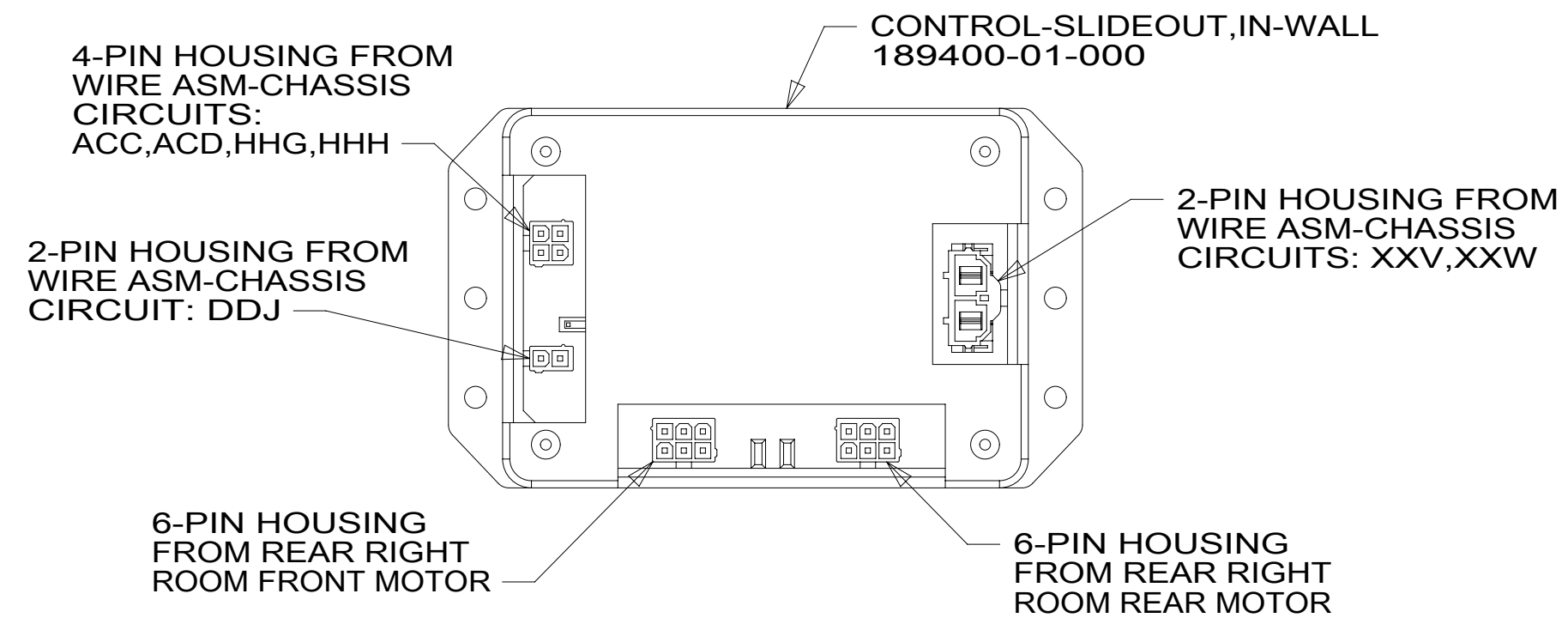
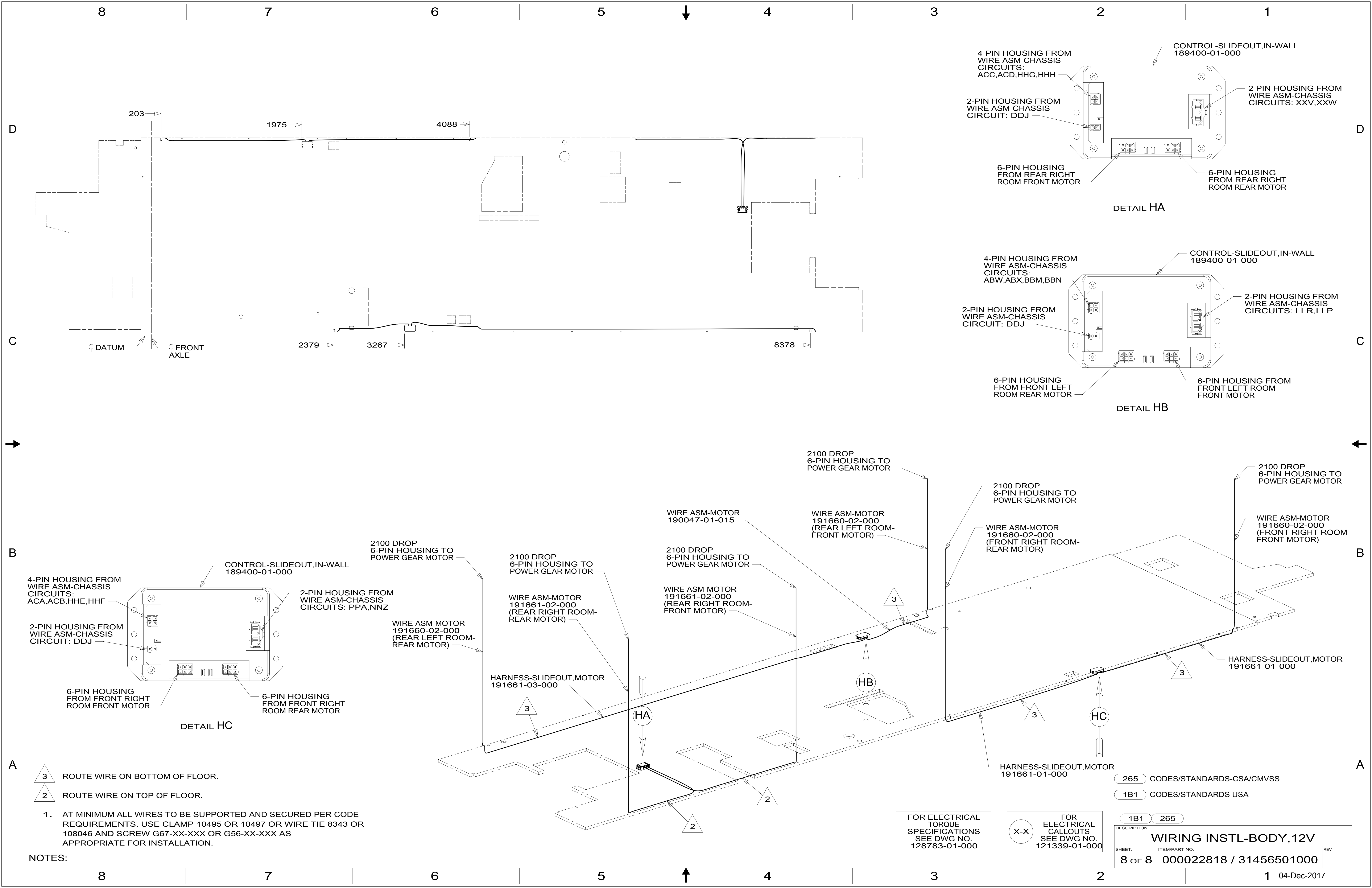

DETAIL HA

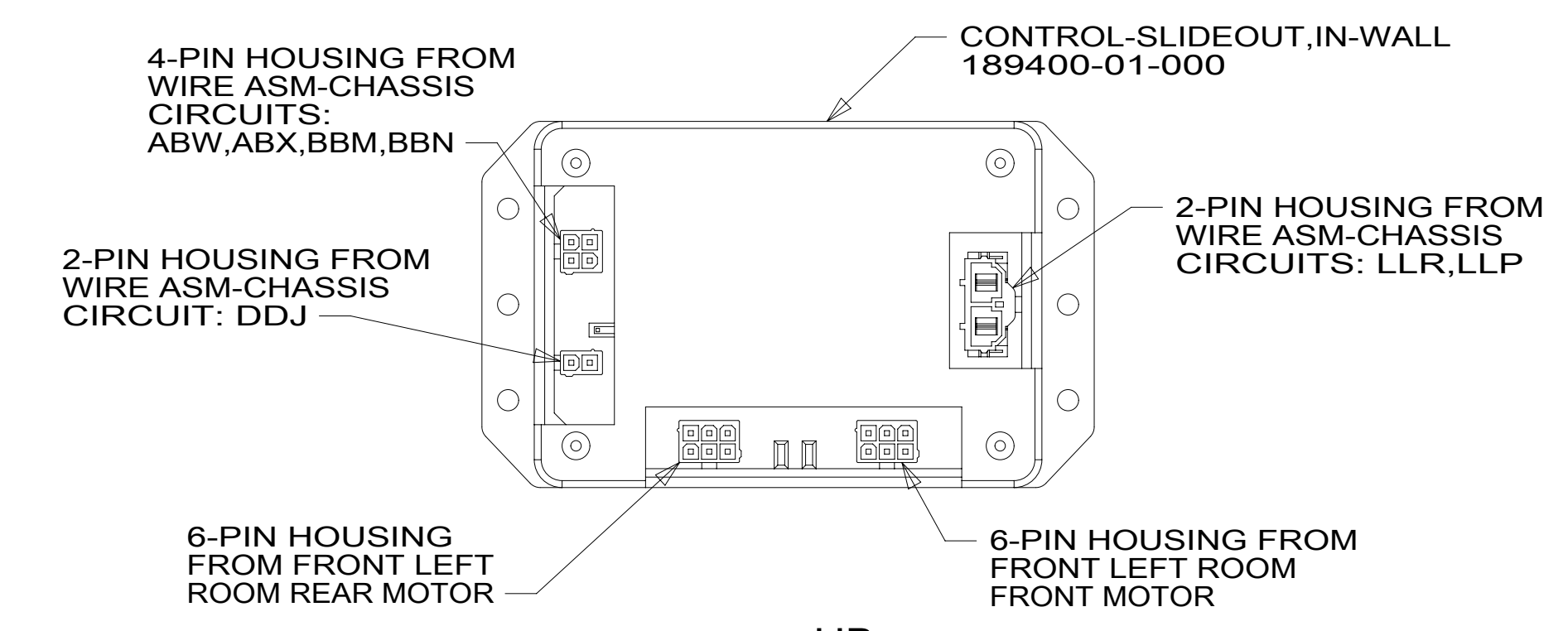

DETAIL HB

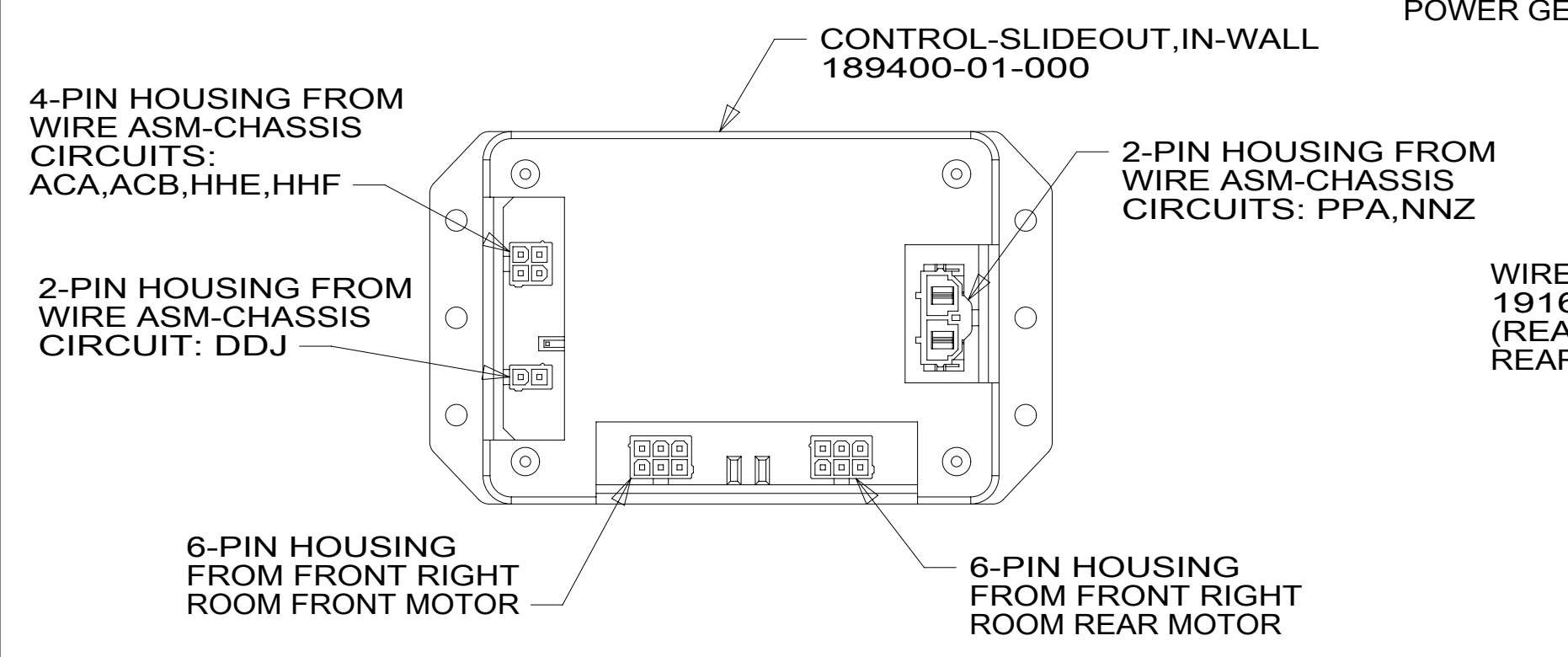

DETAIL HC

- 3 ROUTE WIRE ON BOTTOM OF FLOOR.
- 2 ROUTE WIRE ON TOP OF FLOOR.
1. AT MINIMUM ALL WIRES TO BE SUPPORTED AND SECURED PER CODE REQUIREMENTS. USE CLAMP 10495 OR 10497 OR WIRE TIE 8343 OR 108046 AND SCREW G67-XX-XXX OR G56-XX-XXX AS APPROPRIATE FOR INSTALLATION.

NOTES:

FOR ELECTRICAL TORQUE SPECIFICATIONS SEE DWG NO. 128783-01-000

X-X FOR ELECTRICAL CALLOUTS SEE DWG NO. 121339-01-000

265	CODES/STANDARDS-CSA/CMVSS
1B1	CODES/STANDARDS USA

1B1	265	
DESCRIPTION: WIRING INSTL-BODY, 12V		
SHEET: 8 OF 8	ITEM/PART NO: 000022818 / 31456501000	REV