

4 LABEL-CB PREP OPTION 104678-01-000

AMPLIFIER-PREMIUM AUDIO,J 000013506 / 312665-01-000
WIRE ASM-AMP 194217-01-000
194217-02-000
194217-03-000

CB POWER PROVISION
YELLOW +12V
WHITE GROUND
COAX ANTENNA
(SEE REVERSE SIDE ALSO)

2 PIN HOUSING CONNECTS TO WIRE ASM-CLEARANCE FRONT

5-PIN HOUSING TO WIRE ASM-ROOF

TO SUNVISOR SHADE (6) BUTT SPLICES
HHK-BLK SOLAR SHADE
HHL-BLK/GRY NIGHT SHADE
HHM-BLK
HHN-BLK/GRY
KE-BRN (2)

FAN DEFROSTER 122856-01-CHT (2)
SCREW G39-08-16E (6)
BUTT SPLICE TO AUX FANS
LE-GRN
LF-YEL
XW-BLK

57P SPEAKER 193631-01-000 (5)
SCREW G11-08-20U (20)
571 SPEAKER 171547-01-CHT (4)
SCREW G39-08-20U (16)

WIRE ASM-IP,MAIN 301873-01-000

FEMALE TERMINALS TO JACKS DOWN LAMP

TO RELAYS

RING TERMINAL (6) TO GROUND BOLT

3,4 & 6 PIN HOUSINGS TO LEVELING SYSTEM CONTROLS

6 & 2 PIN HOUSING & LEFT CAMERA CABLE TO LEFT MIRROR

BUTT SPLICE (2) TO CB PREP
DETAIL AA

4-PIN HSG TO WIRE ASM-SPEAKER,EXTENSION

BREAKER PANEL
DETAIL BA

30 PIN HOUSING TO WIRE ASM-CHASSIS

SEAL-WIRES,CAB FLOOR 134542-01-CHT (2)
SCREW G39-10-12B (6)

READ-5
2

TAPE (2) (400MM) 6

USB-CHARGER DUAL,DC 188312-01-000
DETAIL AB

2 & 6 PIN HOUSING & RIGHT CAMERA CABLE TO RIGHT MIRROR

RECEPTACLE-12V 111414-01-000

WIRE ASM-CUP HOLDER 000213562 / 302430-01-000

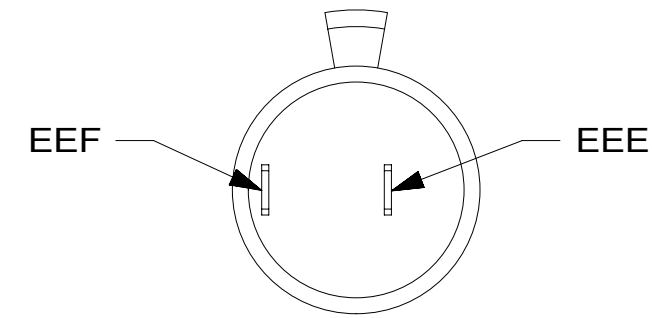

DETAIL AB

DETAIL AA

DETAIL BA

- 7 CONNECT TWO 12 PIN HOUSINGS TOGETHER WITHOUT 57P
- 6 USE TAPE 8363-03-000 TO SECURE WIRES IN A-POST.
- 5 CUT VISOR WIRING TO 300MM BEFORE CONNECTING.
- 4 EDGE OF LABEL TO HANG JUST BELOW BOTTOM OF DASH.
- 3 SPEAKER MOUNTED IN ROOF ASM.
- 2 COVER EACH SPEAKER GRILL WITH TAPE-CLEAR 114187-01-000 (600 MM).

1. WINNEBAGO WIRE ASSEMBLIES ARE SHOWN FOR CLARITY.

NOTES:

57P RADIO SPEAKERS-PREMIUM SOUND

571 RADIO SPEAKERS

265 CODES/STANDARDS-CSA/CMVSS

1B1 CODES/STANDARDS USA

1B1 265

WINNEBAGO
COPYRIGHT 2016 WINNEBAGO INDUSTRIES, INC.

| | | | |
|--|--------|-----------------------------------|-------------|
| DSNR: | | ALL DIMENSIONS ARE IN MILLIMETERS | |
| DFFR: | | MATERIAL: | |
| UNSPECIFIED TOLERANCES: | | | |
| WHOLE DIM (X) | : 3 | | |
| ONE-PLACE (X.X) | : 1.5 | | |
| TWO-PLACE (X.XX) | : 0.50 | | |
| ANGLE | : 1° | | |
| REFER TO ES0018 FOR FASTENER TIGHTENING GUIDELINES | | WEIGHT: (LBS) | FIRST USED: |
| | | | 17 J-SER |

DESCRIPTION: **WIRING INSTL-FRONT END**

| | | |
|--------|-------------------------|-----|
| SHEET: | ITEM/PART NO: | REV |
| 1 OF 8 | 000213362 / 30187201000 | |

FOR ELECTRICAL TORQUE SPECIFICATIONS SEE DWG NO. 128783-01-000

FOR ELECTRICAL CALLOUTS SEE DWG NO. 121339-01-000

BRACKET-MOUNTING 118571-07-000
NUT D11-10-00B (2)

BRACKET-FUSE PANEL
149690-02-CHT
SCREW
G11-10-08U (4)

BRACKET-CIRCUIT BREAKER
149689-01-CHT
SCREW
G11-10-08U (4)

CHASSIS SUPPLIED
FUSE PANEL 2

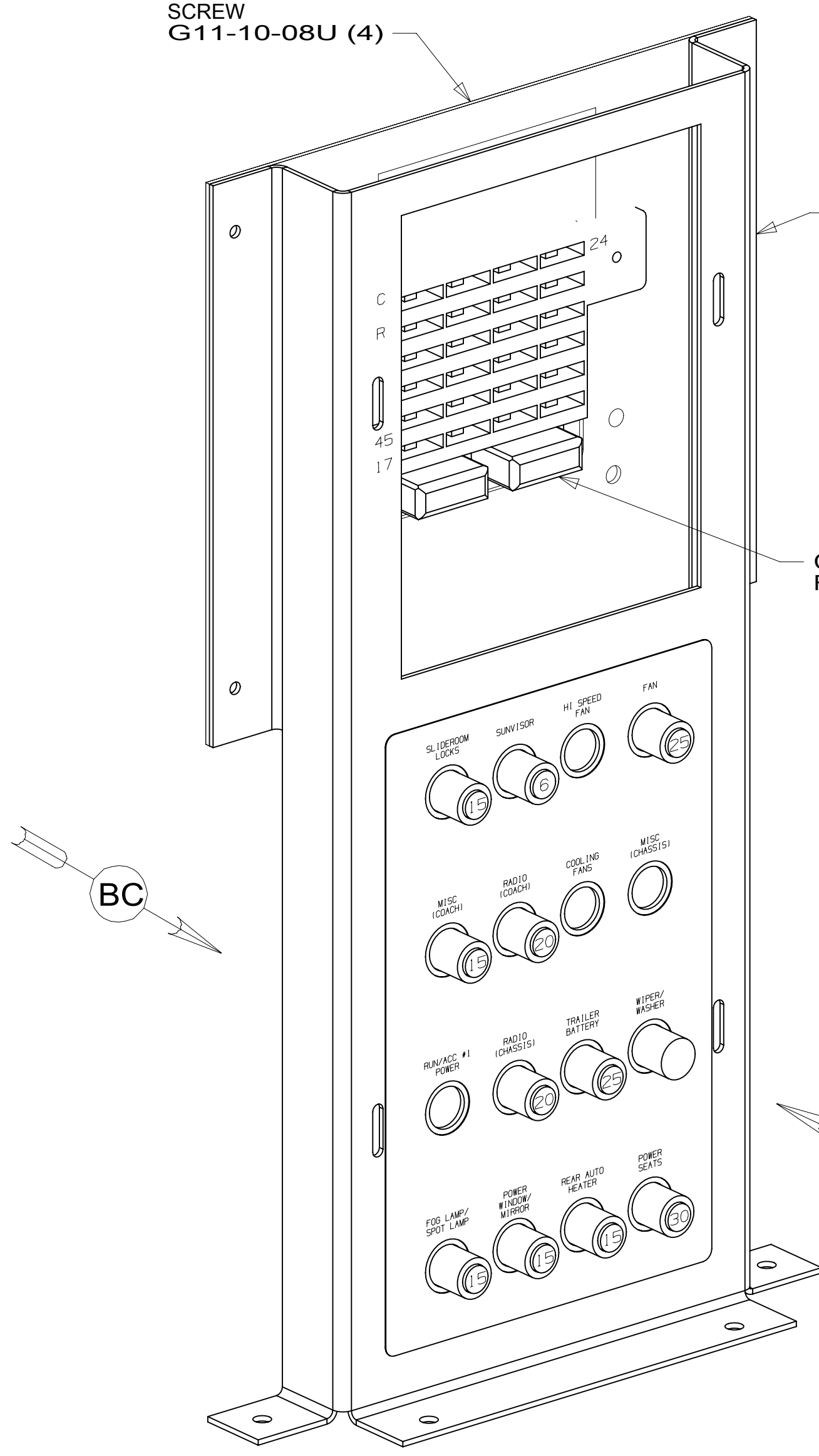

DETAIL BA

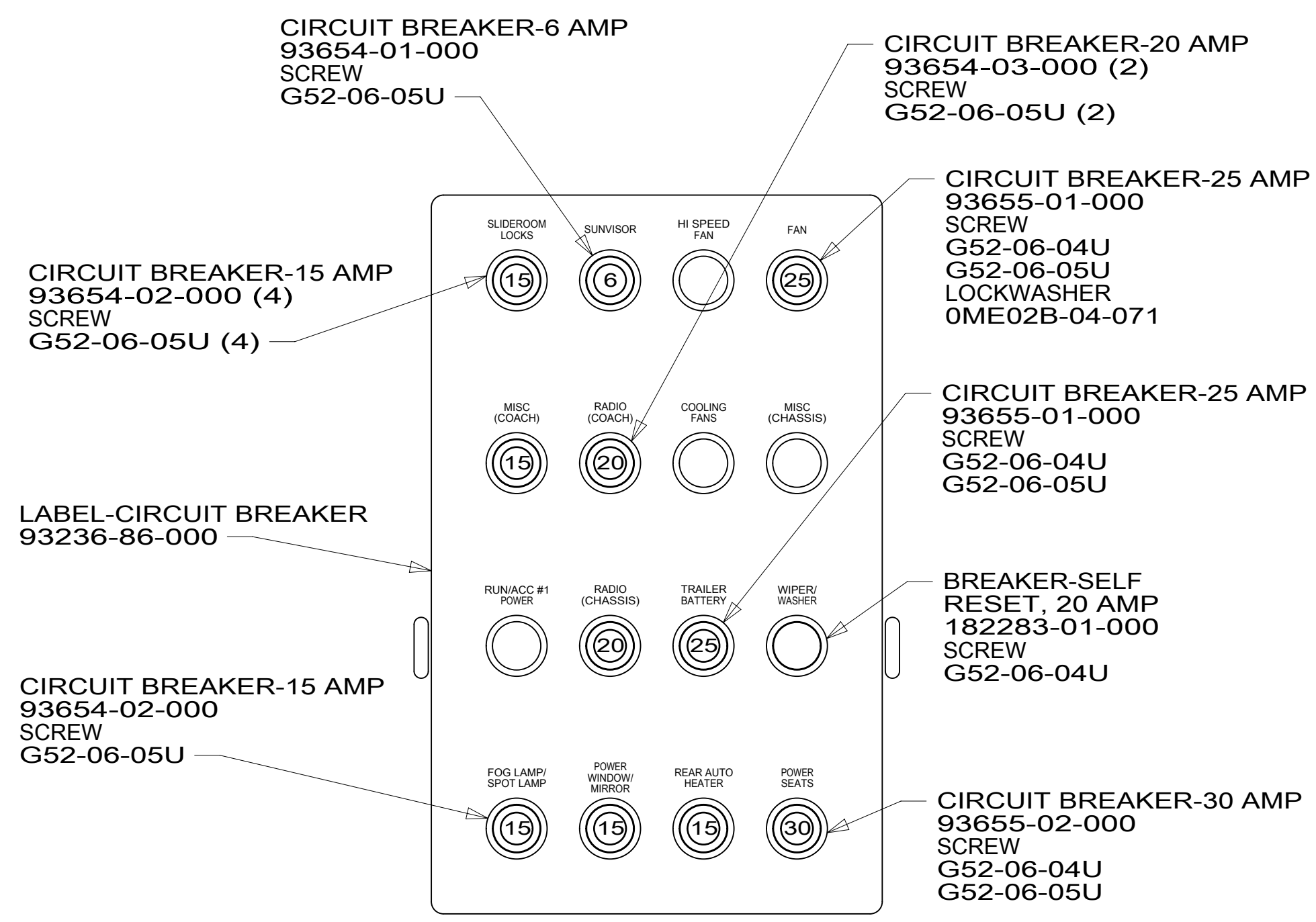

VIEW BB

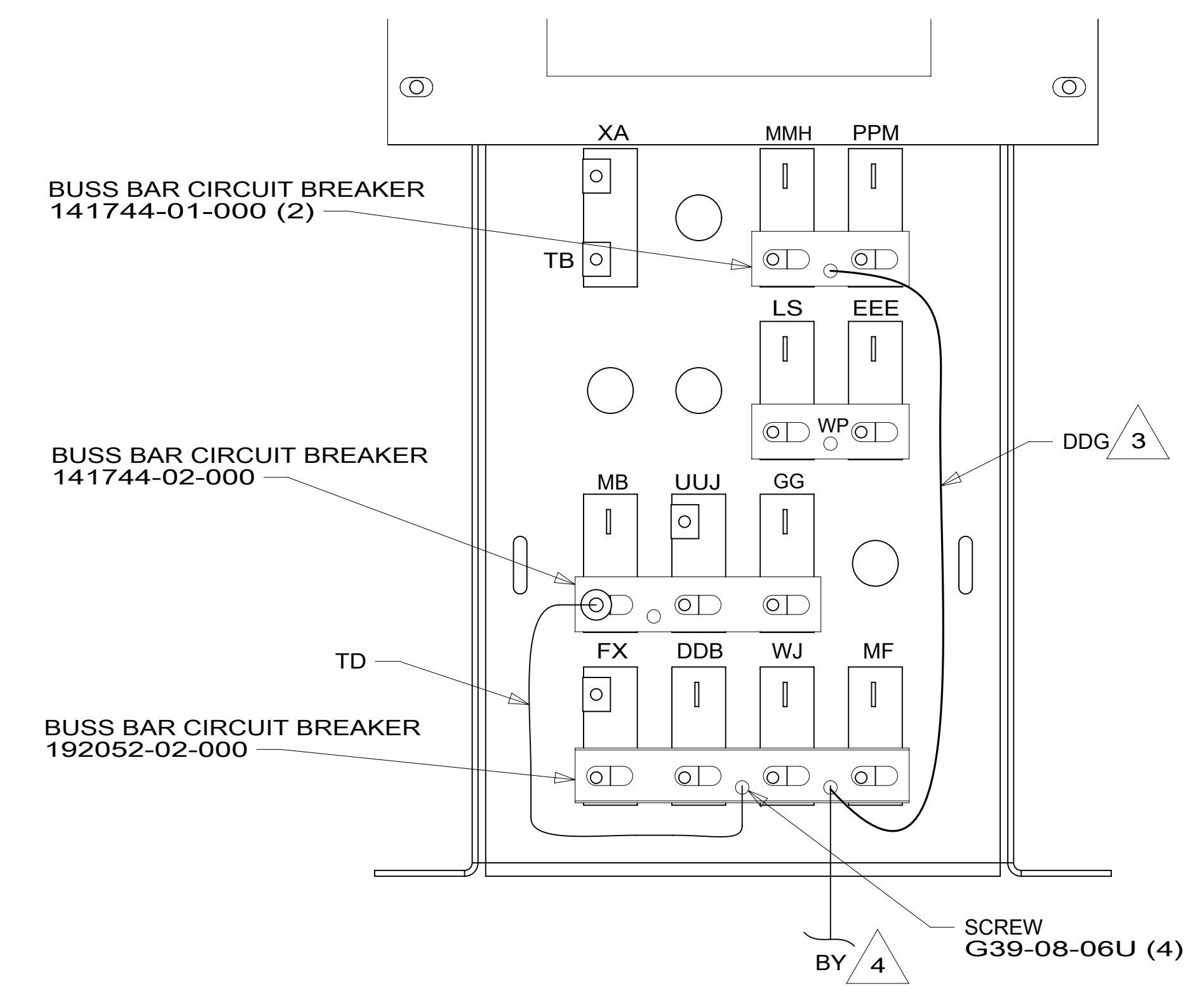

VIEW BC 1

- NOTES:
- 4 CIRCUIT IS PART OF WIRE ASM-CHASSIS.
 - 3 CONNECT DDG TO HOLE IN BUSS BAR OR TO BOTTOM LUG OF 30 AMP BREAKER.
 - 2 WORKHORSE PANEL SHOWN.
 - 1 ALL CIRCUITS ARE IN WIRE ASM-IP,MAIN.

FOR ELECTRICAL
TORQUE
SPECIFICATIONS
SEE DWG NO.
128783-01-000

FOR ELECTRICAL
CALLOUTS
SEE DWG NO.
121339-01-000

265 CODES/STANDARDS-CSA/CMVSS
1B1 CODES/STANDARDS USA

| | | |
|---|--|-----|
| DESCRIPTION: WIRING INSTL-FRONT END | | REV |
| SHEET: 2 OF 8 | ITEM/PART NO: 000213362 / 30187201000 | |

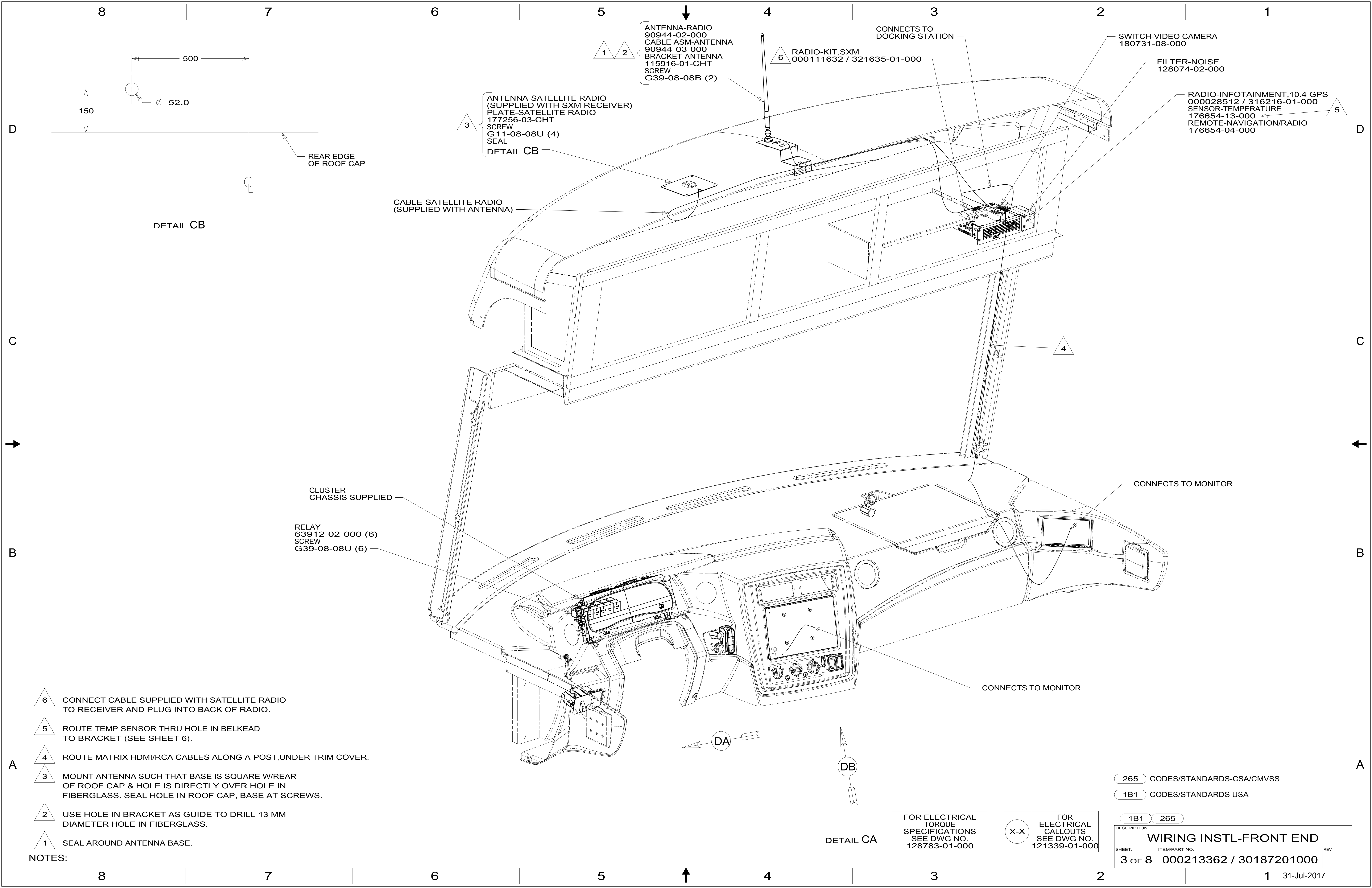

ANTENNA-RADIO
90944-02-000
CABLE ASM-ANTENNA
90944-03-000
BRACKET-ANTENNA
115916-01-CHT
SCREW
G39-08-08B (2)

RADIO-KIT,SXM
000111632 / 321635-01-000

SWITCH-VIDEO CAMERA
180731-08-000

FILTER-NOISE
128074-02-000

RADIO-INFOTAINMENT,10.4 GPS
000028512 / 316216-01-000
SENSOR-TEMPERATURE
176654-13-000
REMOTE-NAVIGATION/RADIO
176654-04-000

ANTENNA-SATELLITE RADIO
(SUPPLIED WITH SXM RECEIVER)
PLATE-SATELLITE RADIO
177256-03-CHT
SCREW
G11-08-08U (4)
SEAL
DETAIL CB

CABLE-SATELLITE RADIO
(SUPPLIED WITH ANTENNA)

CLUSTER
CHASSIS SUPPLIED

RELAY
63912-02-000 (6)
SCREW
G39-08-08U (6)

FOR ELECTRICAL
TORQUE
SPECIFICATIONS
SEE DWG NO.
128783-01-000

FOR
ELECTRICAL
CALLOUTS
SEE DWG NO.
121339-01-000

265 CODES/STANDARDS-CSA/CMVSS

1B1 CODES/STANDARDS USA

1B1 265

DESCRIPTION:
WIRING INSTL-FRONT END

SHEET: 3 OF 8 ITEM/PART NO: 000213362 / 30187201000 REV

- NOTES:
- 6 CONNECT CABLE SUPPLIED WITH SATELLITE RADIO TO RECEIVER AND PLUG INTO BACK OF RADIO.
 - 5 ROUTE TEMP SENSOR THRU HOLE IN BELKEAD TO BRACKET (SEE SHEET 6).
 - 4 ROUTE MATRIX HDMI/RCA CABLES ALONG A-POST, UNDER TRIM COVER.
 - 3 MOUNT ANTENNA SUCH THAT BASE IS SQUARE W/REAR OF ROOF CAP & HOLE IS DIRECTLY OVER HOLE IN FIBERGLASS. SEAL HOLE IN ROOF CAP, BASE AT SCREWS.
 - 2 USE HOLE IN BRACKET AS GUIDE TO DRILL 13 MM DIAMETER HOLE IN FIBERGLASS.
 - 1 SEAL AROUND ANTENNA BASE.

DETAIL CB

DETAIL CA

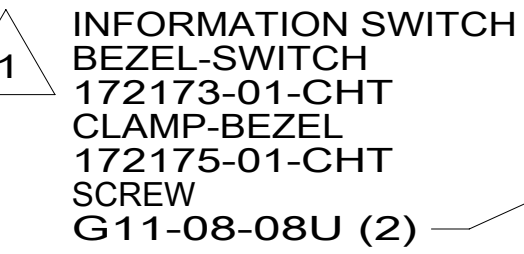
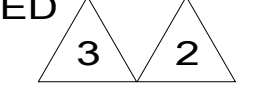
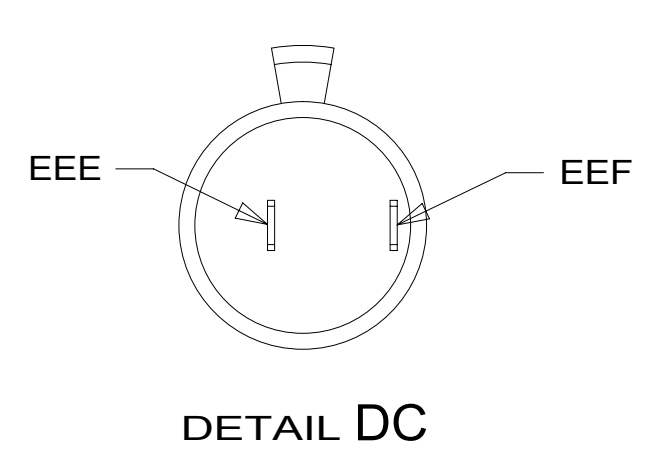
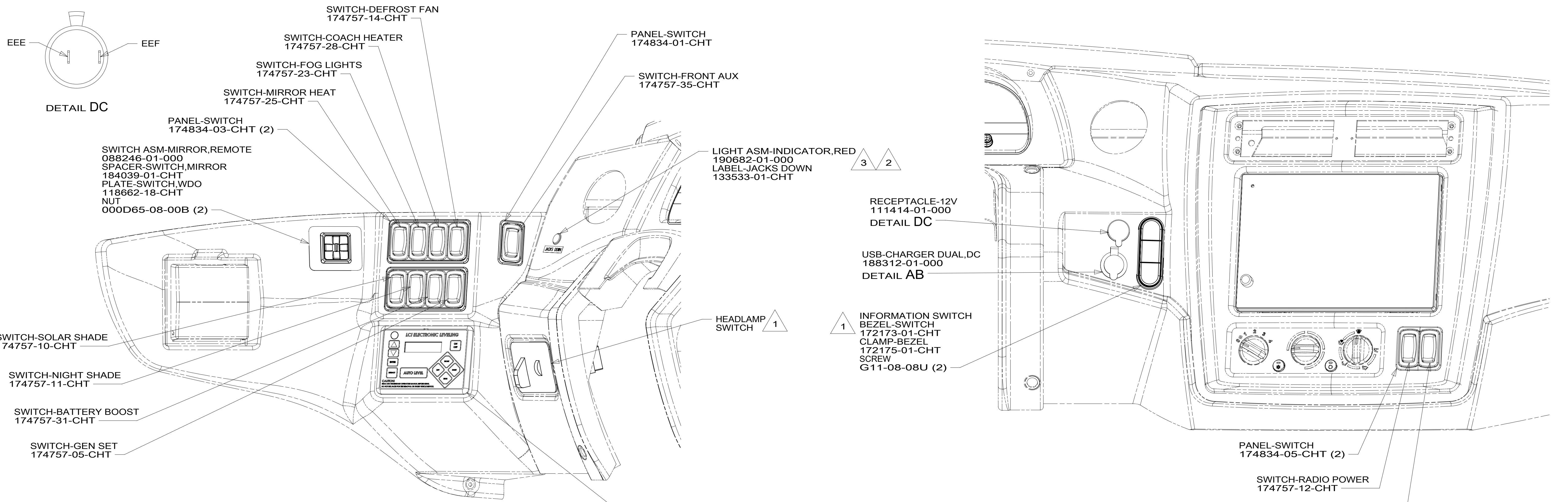

D

D

C

C

B

B

A

A

- NOTES:
- 4 WIRE IS PART OF WIRE ASM-SPEAKER, EXTENSION.
 - 3 WIRING FROM LEVELING SYSTEM. SEE LEVELING SYSTEM INSTL. FOR ADDITIONAL INFORMATION.
 - 2 CONNECT POSITIVE WIRE TO TERMINAL MARKED WITH "RED".
 - 1 CHASSIS SUPPLIED

NOTES:

- 57P
- BOX ASM-SPEAKER, VINYL WRAP
000175453 / 302121-01-XXX
 - SCREW
G11-10-16U (4)
 - SPEAKER-8 SUBWOOFER, JBL
193633-01-000
 - SCREW
G11-10-12U (4)
 - WIRE ASM-PIGTAIL, SUBWOOFER
193633-04-000
 - GRILL-SPEAKER, 8, JBL
193633-02-000
 - BRACKET-SPKR SUPPORT
000003850 / 312070-01-CHT
 - SCREW
G39-08-12U (2)

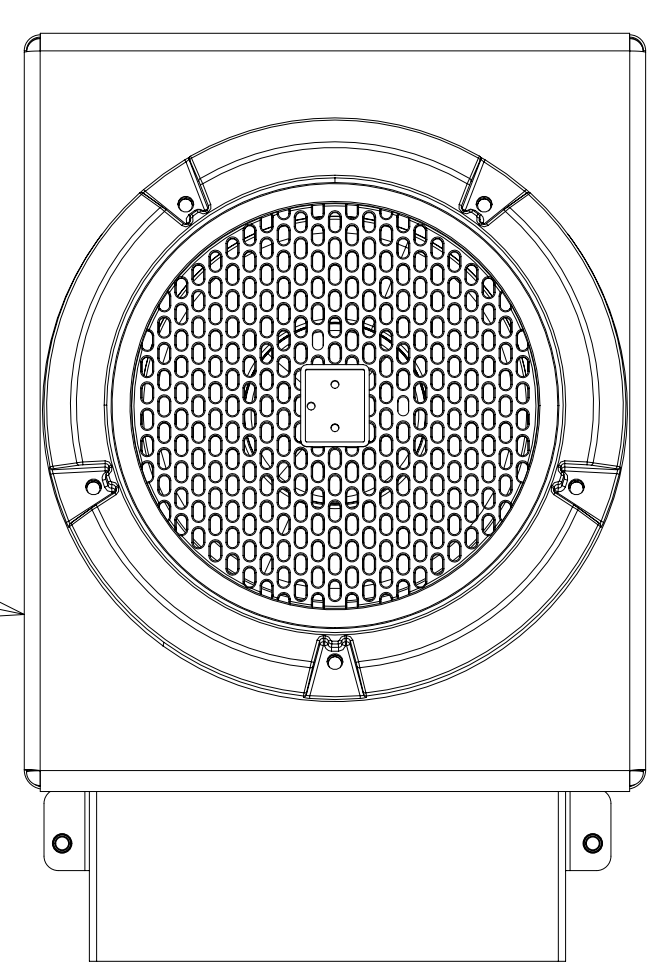

DETAIL DA

SEE LEVELING SYSTEM INSTL

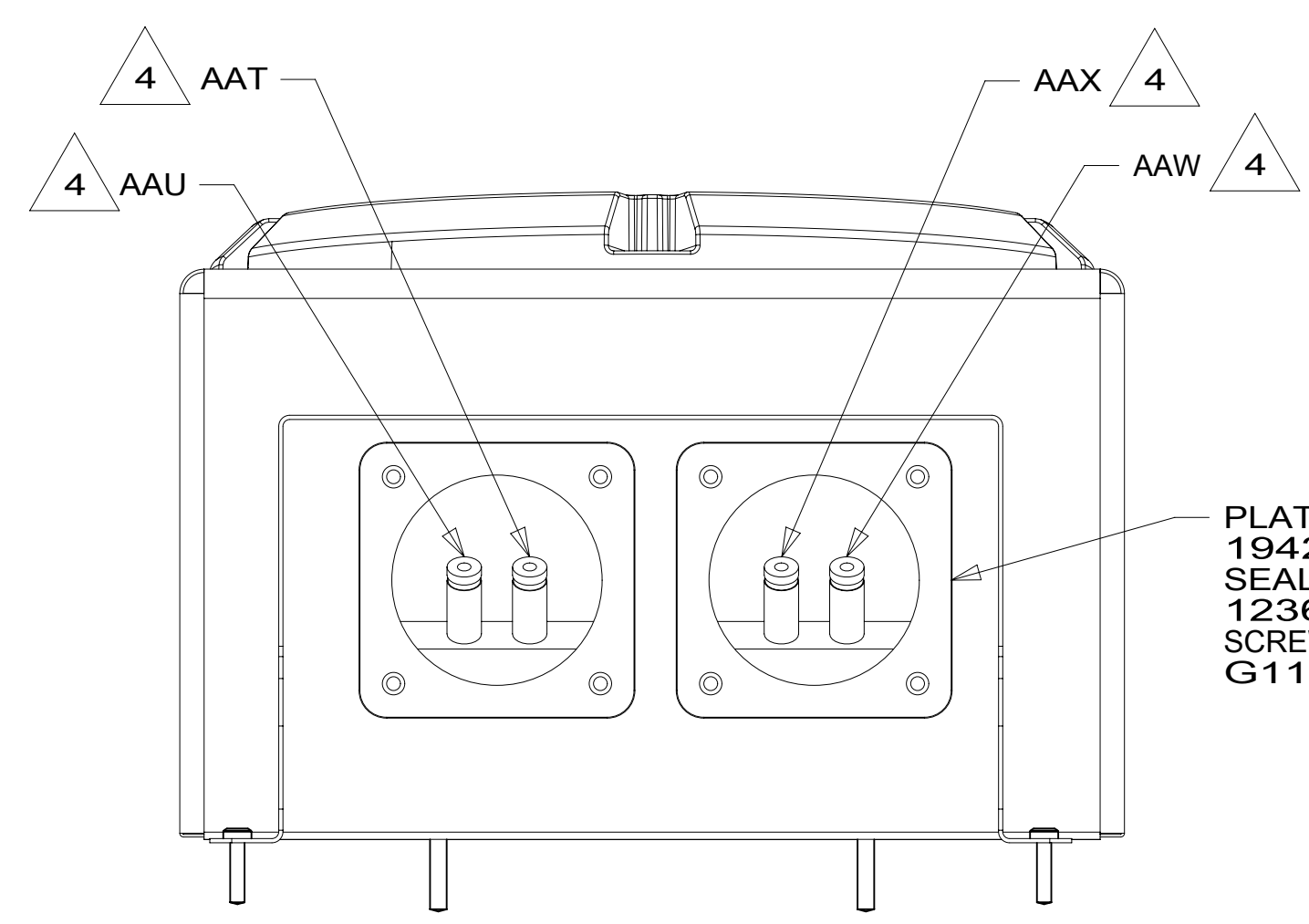

DETAIL DE (FRONT VIEW)

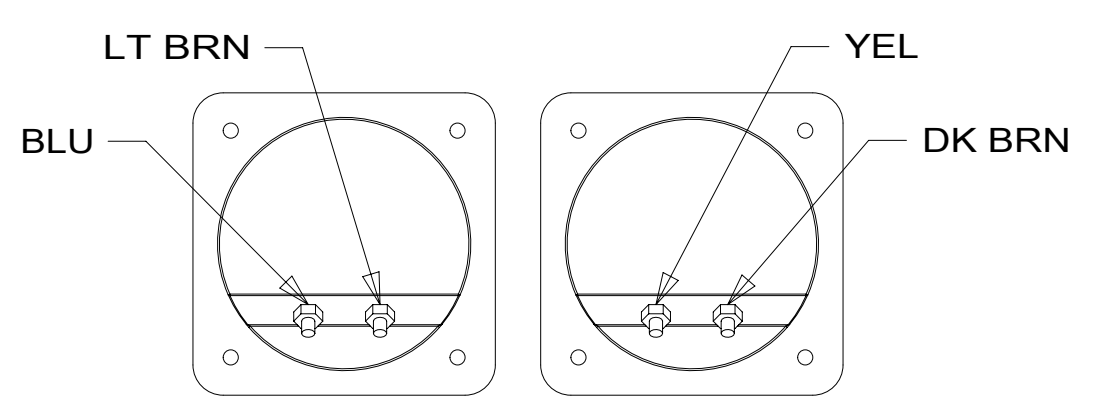

DETAIL DE (REAR VIEW)

FOR ELECTRICAL TORQUE SPECIFICATIONS SEE DWG NO. 128783-01-000

FOR ELECTRICAL CALLOUTS SEE DWG NO. 121339-01-000

- 57P RADIO SPEAKERS-PREMIUM SOUND
- 265 CODES/STANDARDS-CSA/CMVSS
- 1B1 CODES/STANDARDS USA

| | | | |
|-------------------------------|-------------------------|-----|-----|
| DESCRIPTION: | | 1B1 | 265 |
| WIRING INSTL-FRONT END | | | |
| SHEET: | ITEM/PART NO.: | REV | |
| 4 OF 8 | 000213362 / 30187201000 | | |

8 7 6 5 4 3 2 1

D
C
B
A

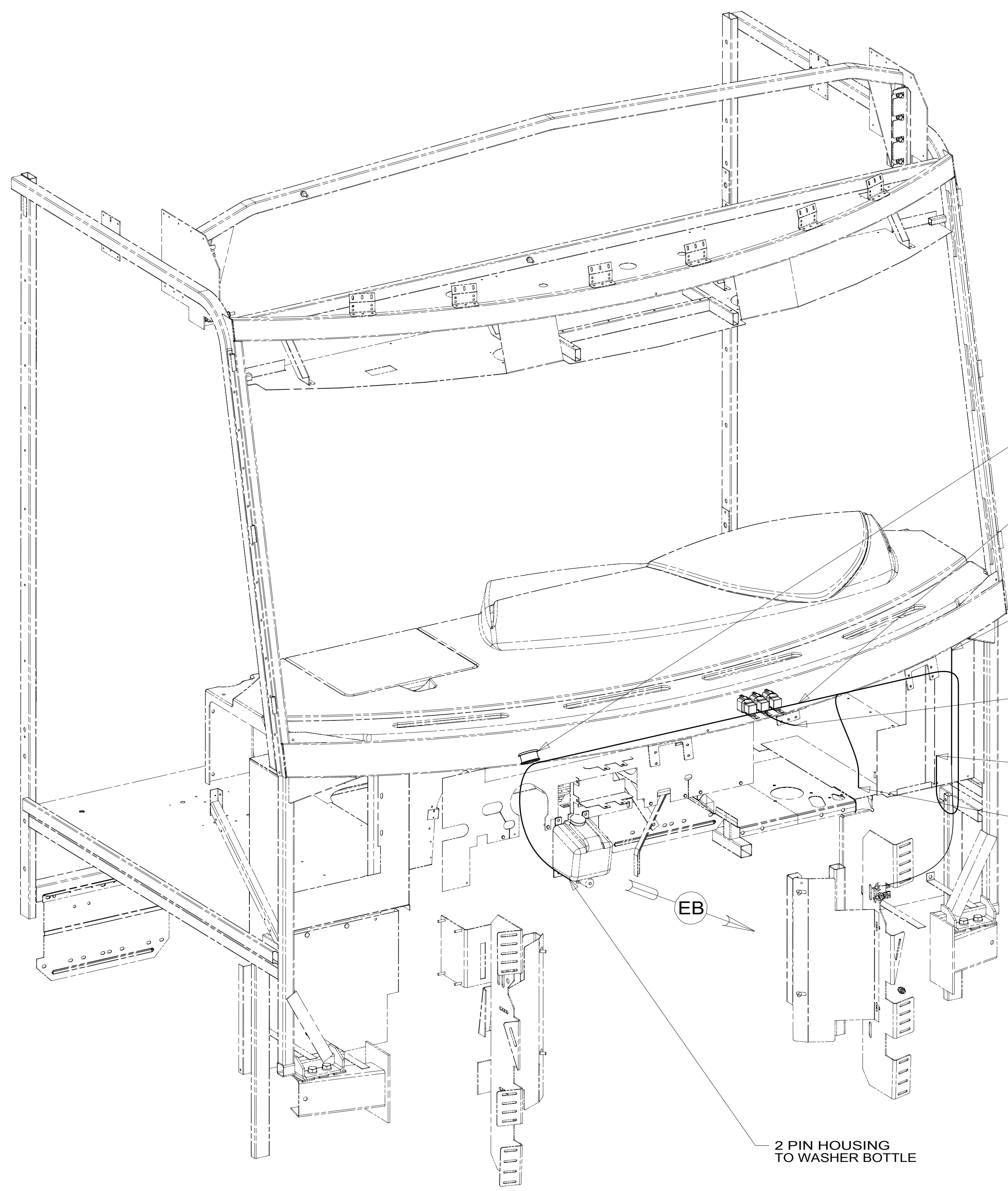

DETAIL EA

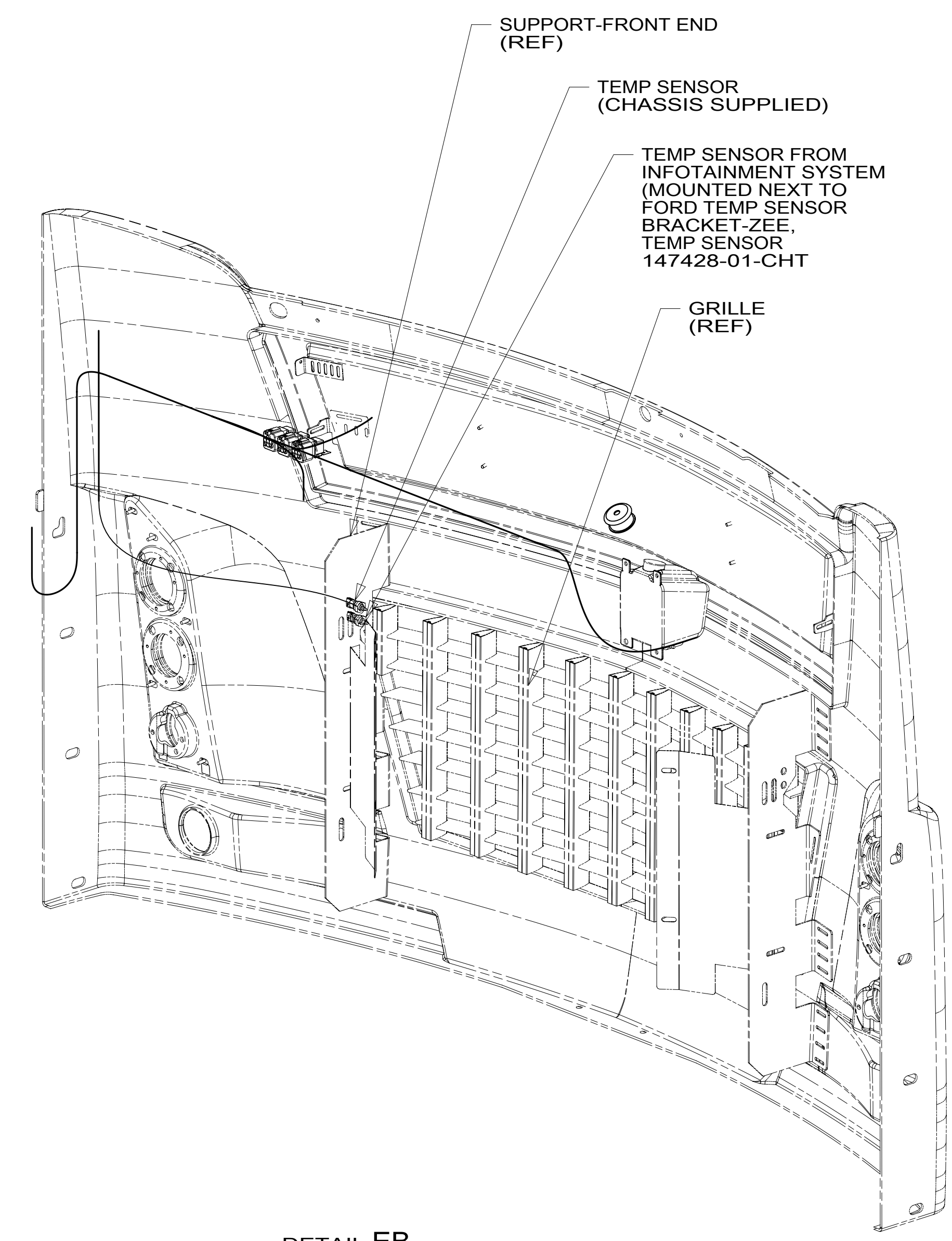

DETAIL EB

- 2 ROUTE WIRES THROUGH HOLE IN STEEL.
1. GATHER ALL EXCESS WIRE AFTER MAKING ALL CONNECTIONS. BUNDLE AND SECURE WITH WIRE TIE 8343-01-000 OR 93147-01-000.

NOTES:

FOR ELECTRICAL TORQUE SPECIFICATIONS SEE DWG NO. 128783-01-000

FOR ELECTRICAL CALLOUTS SEE DWG NO. 121339-01-000

265 CODES/STANDARDS-CSA/CMVSS
1B1 CODES/STANDARDS USA

| | | |
|-------------------------------|-------------------------|---------|
| DESCRIPTION: | | 1B1 265 |
| WIRING INSTL-FRONT END | | |
| SHEET: | ITEM/PART NO.: | REV |
| 5 OF 8 | 000213362 / 30187201000 | |

8 7 6 5 4 3 2 1 31-Jul-2017

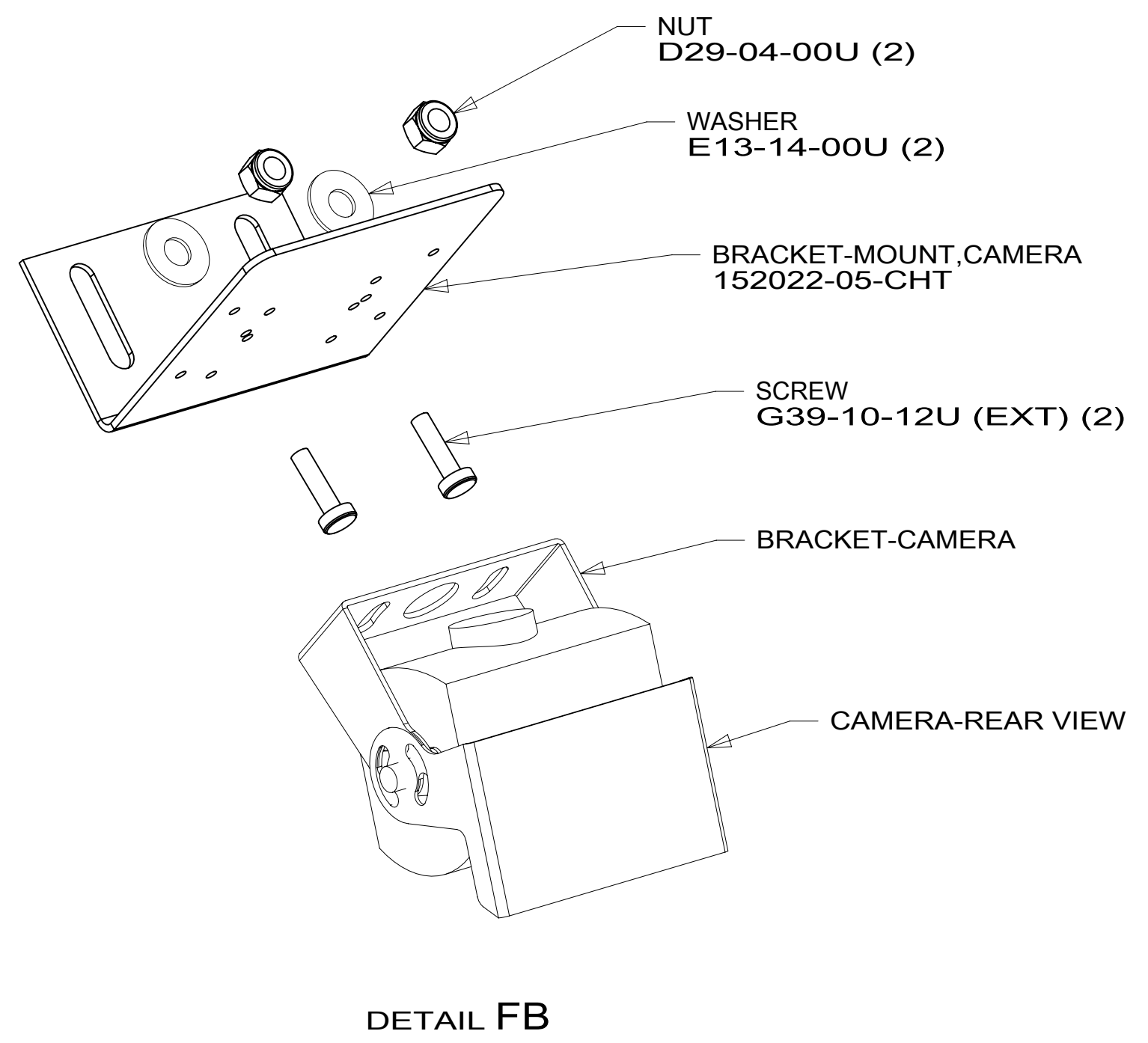
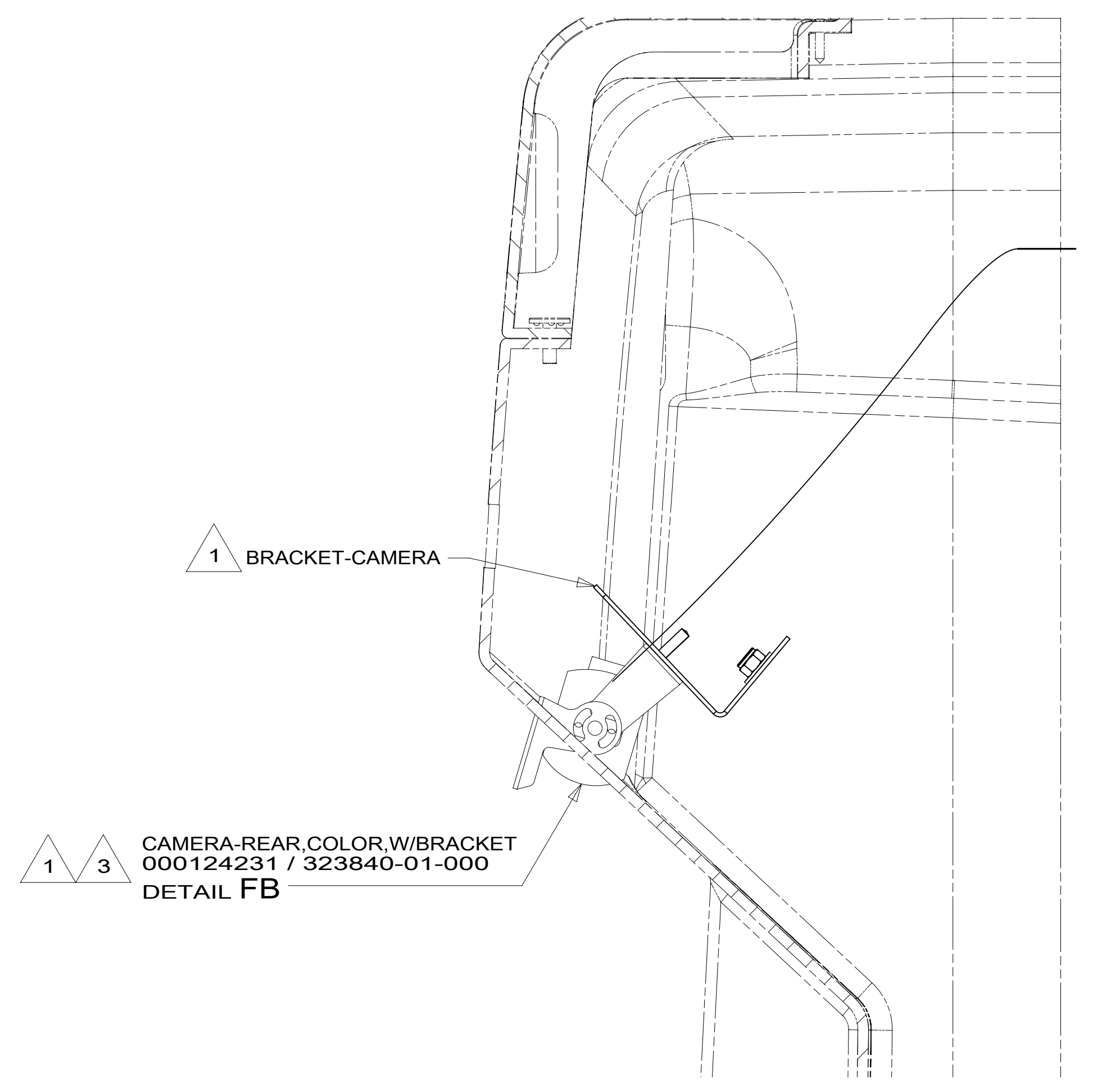
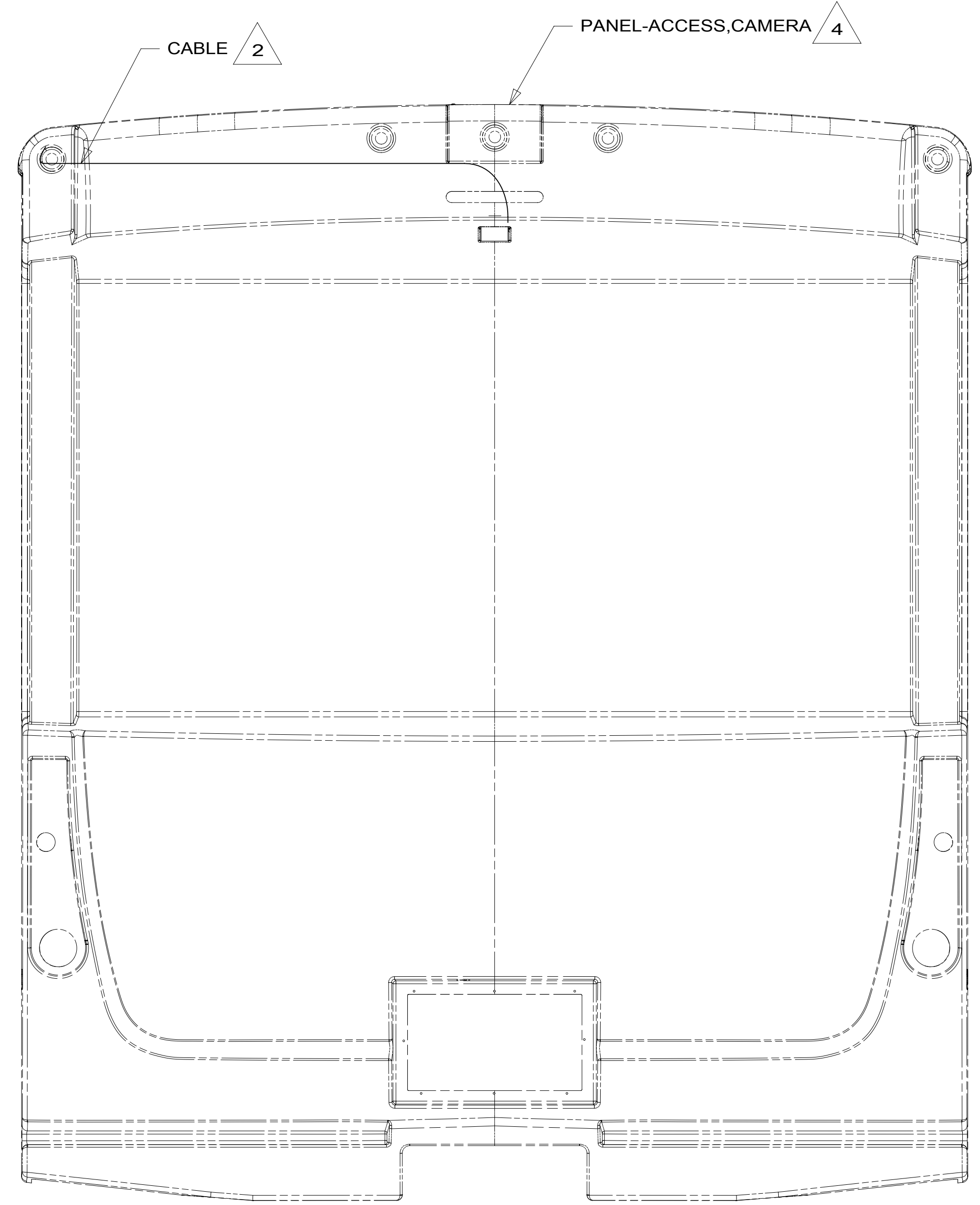
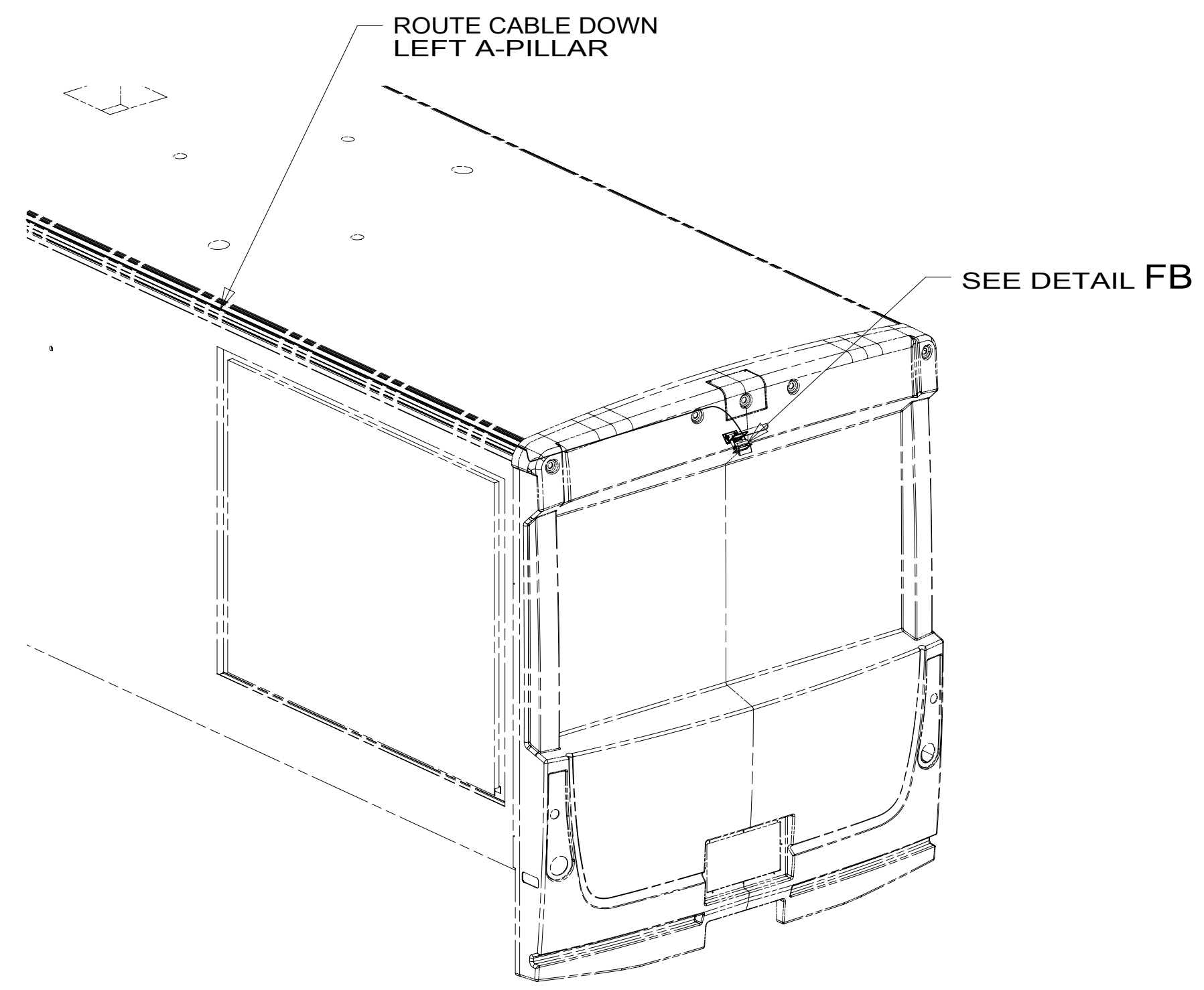

- NOTES:
- 4 SEE PANEL-REAR CAP FOR LOCATION.
 - 3 ALIGN CAMERA IN CENTER OF OPENING AND ADJUST CAMERA VIEWING SO BACKWALL IS JUST VISIBLE IN MONITOR.
 - 2 RUN CABLE THRU LEFT-HAND COVE TO REAR OF UNIT. STANDARD ON ALL UNITS.
 - 1 PARTS SUPPLIED WITH CAMERA.

FOR ELECTRICAL TORQUE SPECIFICATIONS SEE DWG NO. 128783-01-000

FOR ELECTRICAL CALLOUTS SEE DWG NO. 121339-01-000

265 CODES/STANDARDS-CSA/CMVSS
1B1 CODES/STANDARDS USA

| | |
|-------------------------------|-------------------------|
| DESCRIPTION: | |
| WIRING INSTL-FRONT END | |
| SHEET: | ITEM/PART NO. REV |
| 6 OF 8 | 000213362 / 30187201000 |

8 7 6 5 4 3 2 1

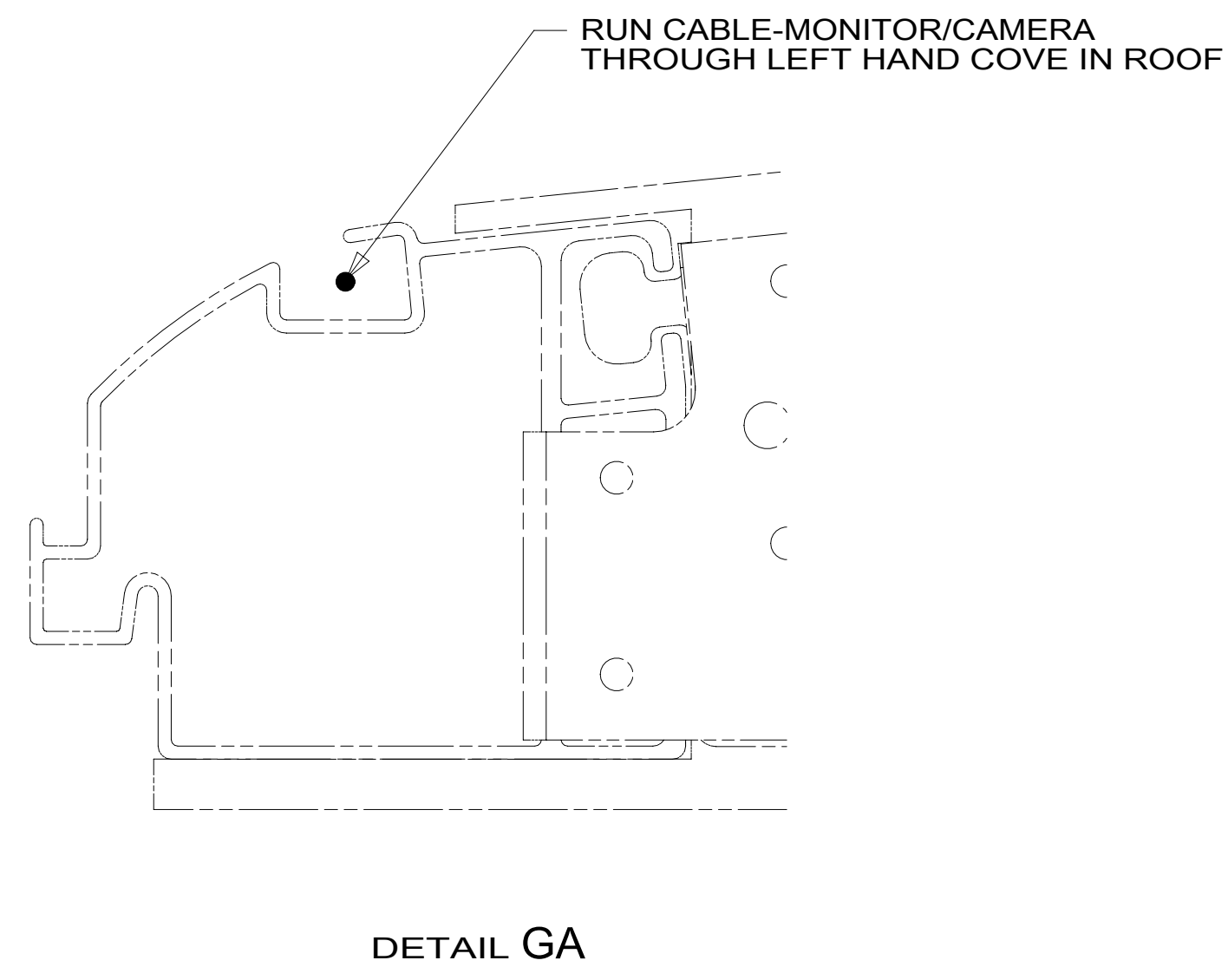

1 CABLE-MONITOR/CAMERA
180731-02-000
DETAIL GA

TO SPLITTER
DETAIL HA

FILTER-NOISE
(REF)

2 TO CAMERA-SIDE
(PART OF MIRROR)
CABLE-CAMERA
144677-21-000

2 TO CAMERA-SIDE
(PART OF MIRROR)
CABLE-CAMERA
144677-21-000

D
C
B
A

D
C
B
A

NOTES:

2 CONNECT CABLE TO SIDE MOUNTED MIRROR.

1 RUN CABLE FROM REAR CAMERA THRU LEFT HAND COVE TO FRONT OF UNIT AND DOWN LEFT A-PILLAR TO MONITOR.

FOR ELECTRICAL TORQUE SPECIFICATIONS SEE DWG NO. 128783-01-000

FOR ELECTRICAL CALLOUTS SEE DWG NO. 121339-01-000

265 CODES/STANDARDS-CSA/CMVSS
1B1 CODES/STANDARDS USA

| | |
|-------------------------------|-------------------------|
| DESCRIPTION: | |
| WIRING INSTL-FRONT END | |
| SHEET: | ITEM/PART NO.: |
| 7 OF 8 | 000213362 / 30187201000 |
| REV | |

8 7 6 5 4 3 2 1 31-Jul-2017

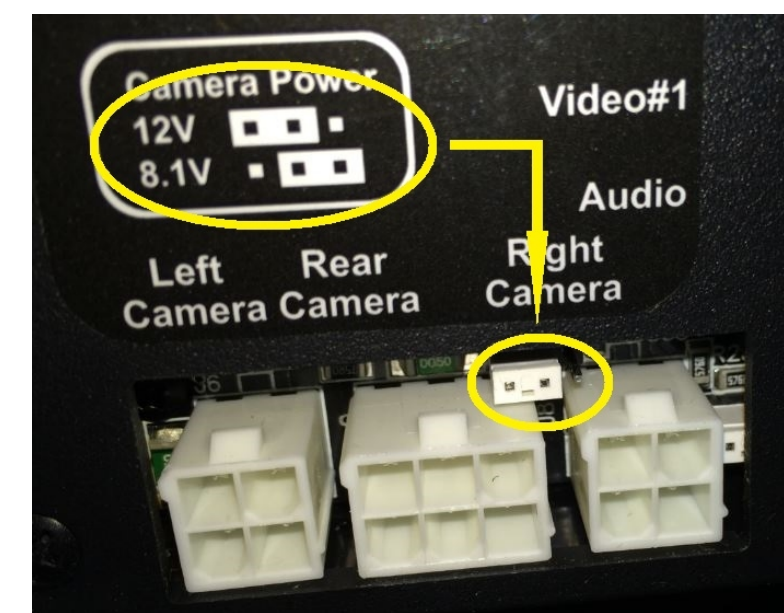
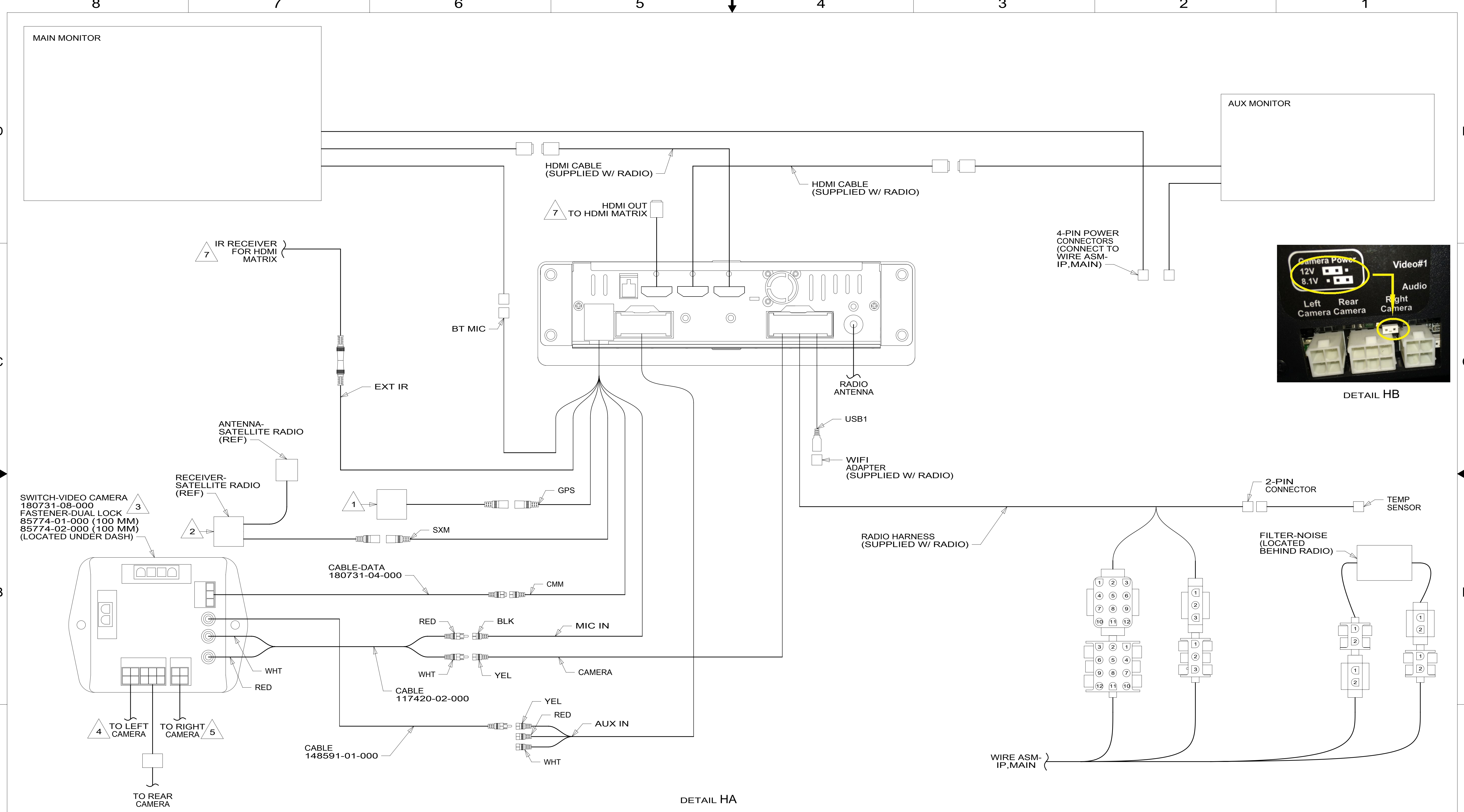

DETAIL HB

DETAIL HA

- NOTES:**
- 4 MARK LEFT CABLE WITH YELLOW TAPE 900000-07-000 NEXT TO CONNECTOR.
 - 3 ENSURE CAMERA POWER JUMPER IS IN 12 VOLT POSITION. MOVE TO 12 VOLT POSITION IF NECESSARY. SEE DEAL HB.
 - 2 WIRE TIE RECEIVER-SATELLITE RADIO AND SWITCH-VIDEO CAMERA TO DASH RADIO WIRING BEHIND THE RADIO.
 - 1 MOUNT TO DEFROST PLENUM NEAR WINDSHIELD.

- 7 SEE WIRING INSTL-TV/DVD FOR ADDITIONAL INFORMATION.
- 6. APPLY TAPE 8363-01-000 AS NECESSARY TO SECURE NON-LOCKING CONNECTIONS.
- 5 MARK RIGHT CABLE WITH WHITE TAPE 900000-08-000 NEXT TO CONNECTOR.

- 15D GPS-NAVIGATION SYSTEM
- 265 CODES/STANDARDS-CSA/CMVSS
- 1B1 CODES/STANDARDS USA

FOR ELECTRICAL TORQUE SPECIFICATIONS SEE DWG NO. 128783-01-000

FOR ELECTRICAL CALLOUTS SEE DWG NO. 121339-01-000

DESCRIPTION: **WIRING INSTL-FRONT END**

SHEET: 8 OF 8 ITEM/PART NO.: 000213362 / 30187201000 REV: 1

31-Jul-2017