

8 7 6 5 4 3 2 1

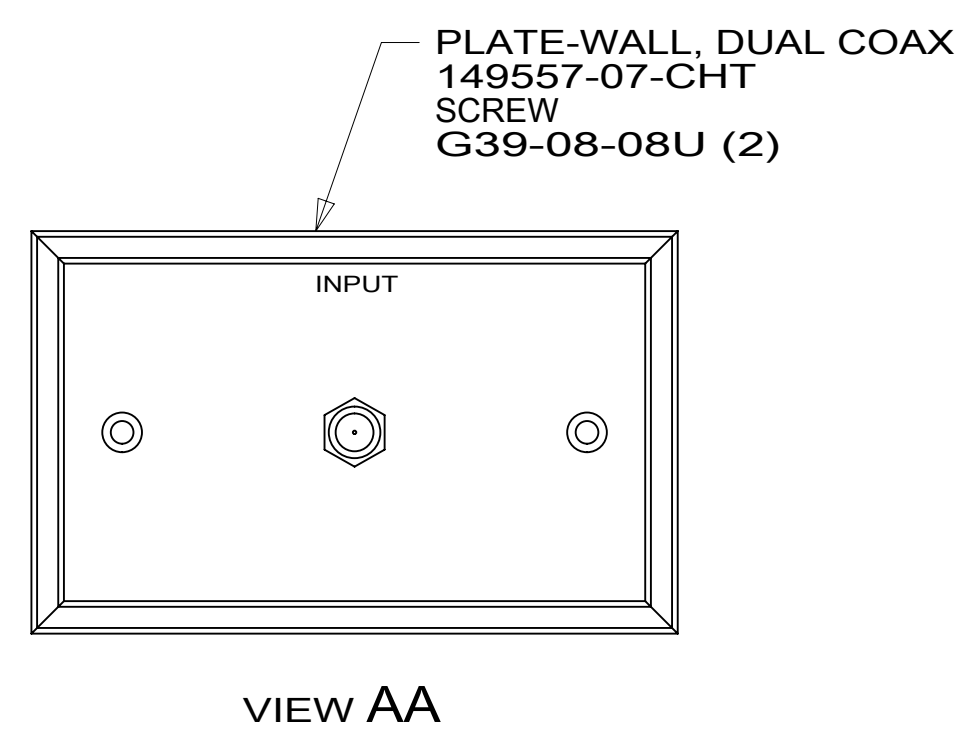
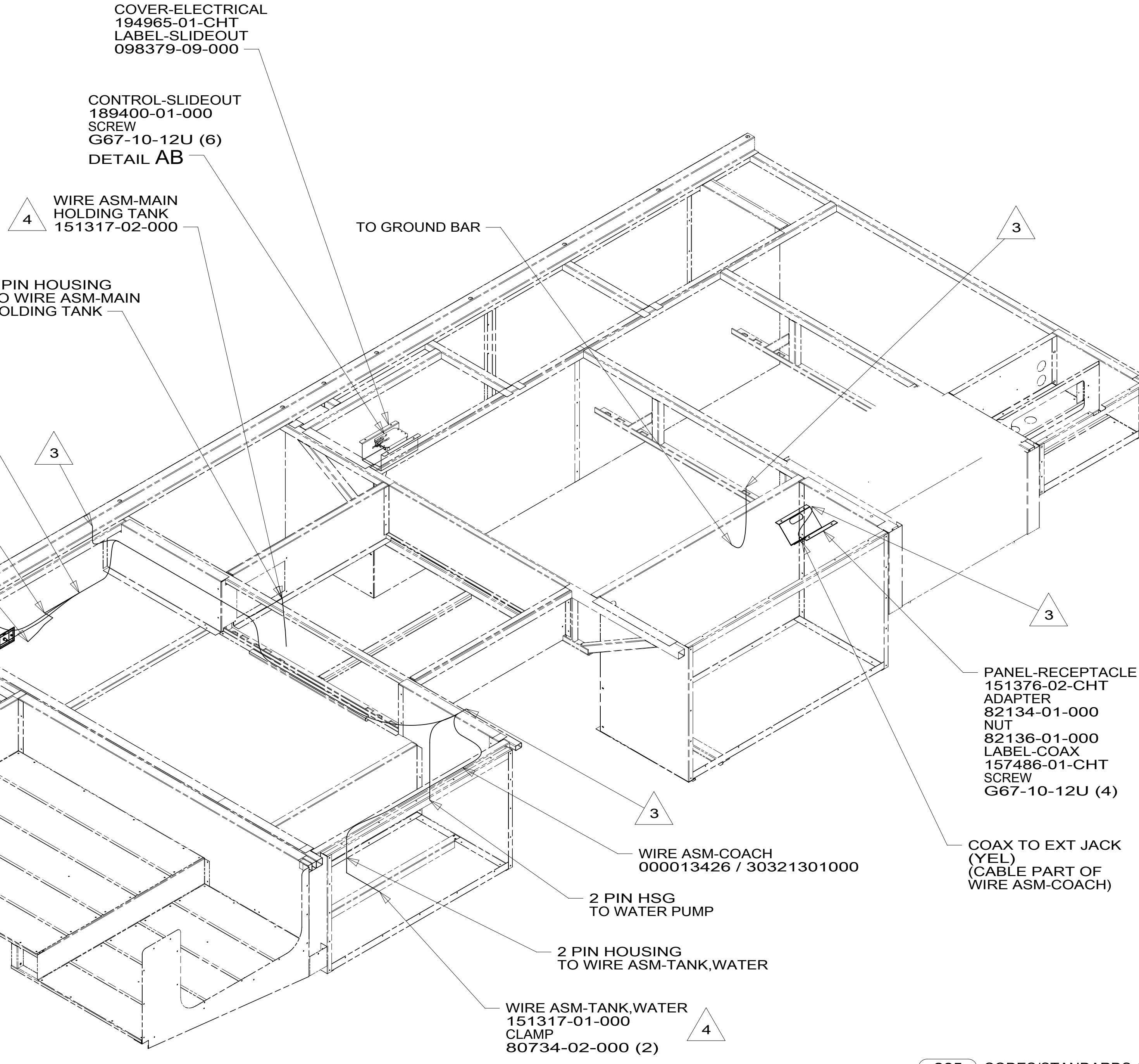
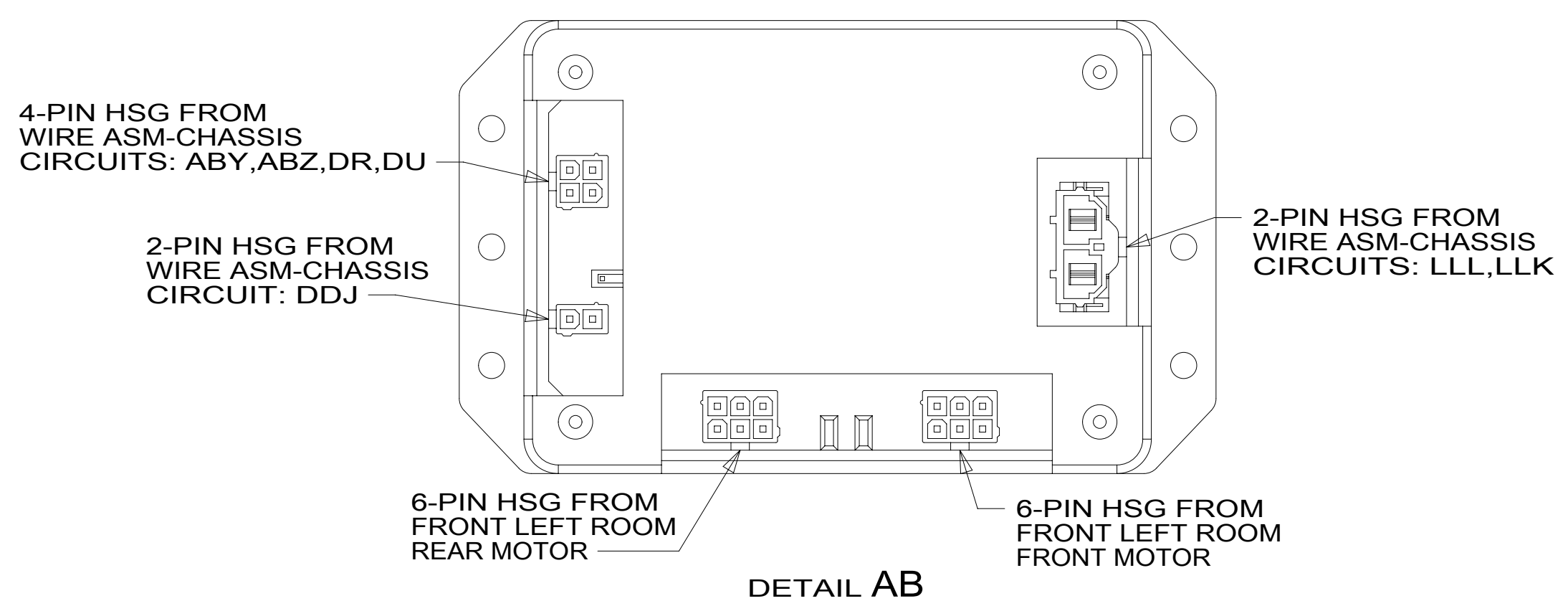

- 4 PLACE CROSS LOCATOR ON SENSORS OVER DIMPLES ON TANK.
- 3 WIRE PASSES THROUGH FLOOR IN THIS AREA.
2. ROUTE TANK SENSOR WIRES SO THEY DO NOT PASS OVER SENSORS. USE WIRE TIE MOUNT 155366-01-000 AND WIRE TIE 8343-01-000 AS NEEDED. TANK SURFACE MUST BE CLEANED USING ISOPROPYL ALCOHOL AND PRIMED WITH PRIMER 94.
1. AT MINIMUM ALL WIRES TO BE SUPPORTED AND SECURED PER CODE REQUIREMENTS. USE CLAMP 10495 OR 10497 OR WIRE TIE 8343 OR 108046 AND SCREW G67-XX-XXX OR G56-XX-XXX AS APPROPRIATE FOR INSTALLATION.

NOTES:

FOR ELECTRICAL TORQUE SPECIFICATIONS SEE DWG NO. 128783-01-000

FOR ELECTRICAL CALLOUTS SEE DWG NO. 121339-01-000

- 265 CODES/STANDARDS-CSA/CMVSS
- 1B1 CODES/STANDARDS USA
- 1B1 265



DSNR:		ALL DIMENSIONS ARE IN MILLIMETERS	
DFFR:		MATERIAL:	
UNSPECIFIED TOLERANCES:			
WHOLE DIM (X)	: 3		
ONE-PLACE (X.X)	: 1.5		
TWO-PLACE (X.XX)	: 0.50		
ANGLE	: 1°		
REFER TO ES0018 FOR FASTENER TIGHTENING GUIDELINES		WEIGHT: (LBS)	FIRST USED:
			17 E26HE
WIRING INSTL-BODY, 12V			
SHEET:	ITEM/PART NO.:	REV	
1 OF 7	000210595 / 30321101000		
REF:		1 14-Sep-2017	

8 7 6 5 4 3 2 1

8 7 6 5 4 3 2 1

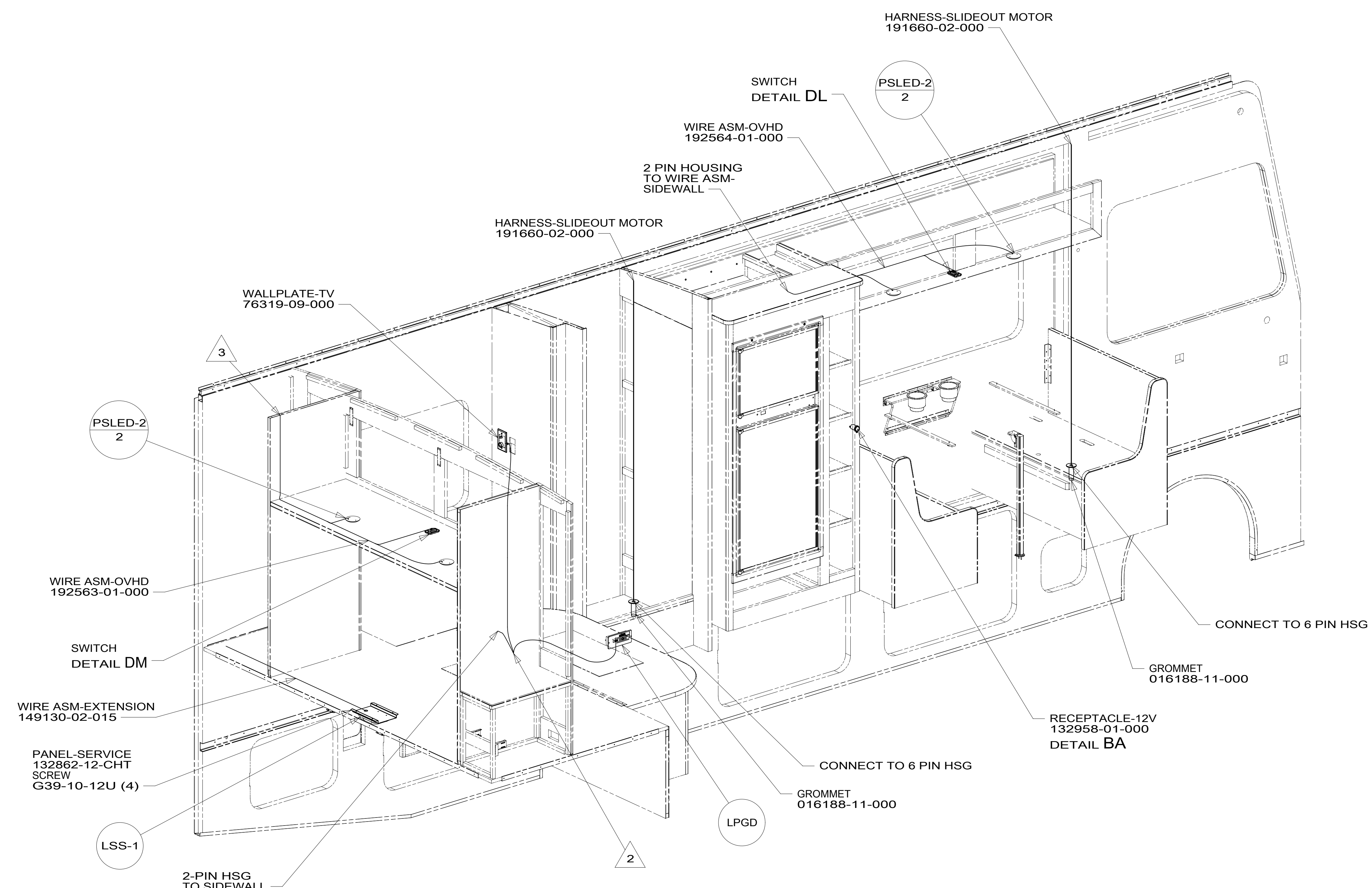
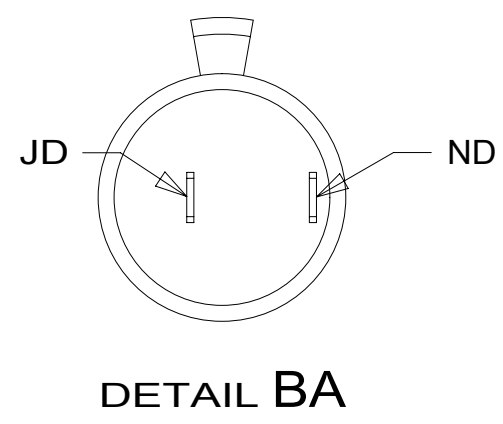

- 3 WIRE FROM ROOF.
- 2 WIRE PASSES THROUGH FLOOR IN THIS AREA.

1. AT MINIMUM ALL WIRES TO BE SUPPORTED AND SECURED PER CODE REQUIREMENTS. USE CLAMP 10495 OR 10497 OR WIRE TIE 8343 OR 108046 AND SCREW G67-XX-XXX OR G56-XX-XXX AS APPROPRIATE FOR INSTALLATION.

NOTES:

265 CODES/STANDARDS-CSA/CMVSS
 1B1 CODES/STANDARDS USA

FOR ELECTRICAL TORQUE SPECIFICATIONS SEE DWG NO. 128783-01-000

FOR ELECTRICAL CALLOUTS SEE DWG NO. 121339-01-000

DESCRIPTION:	
1B1 265	
WIRING INSTL-BODY, 12V	
SHEET:	ITEM/PART NO:
2 OF 7	000210595 / 30321101000
REV	

8 7 6 5 4 3 2 1 14-Sep-2017

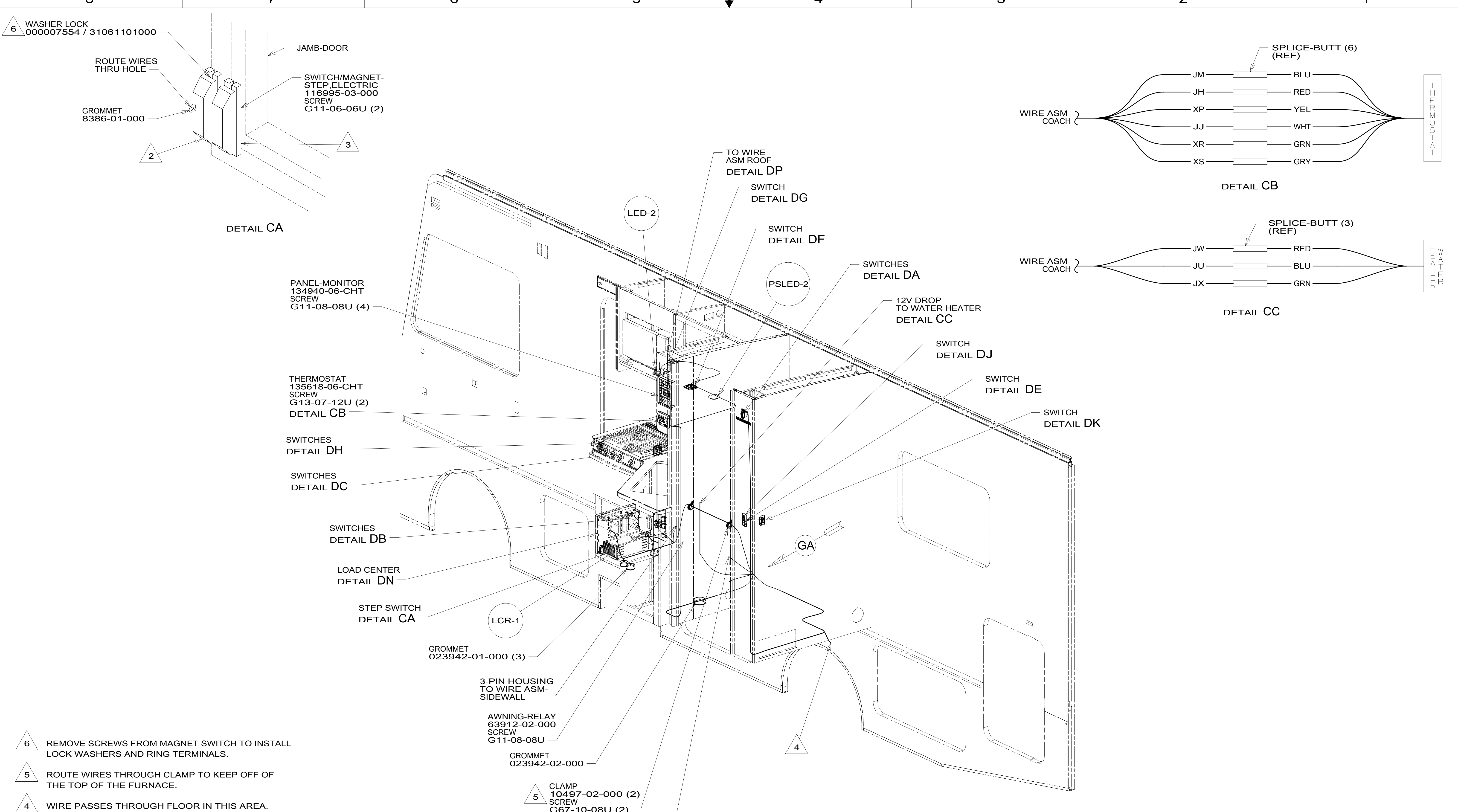

- 6 REMOVE SCREWS FROM MAGNET SWITCH TO INSTALL LOCK WASHERS AND RING TERMINALS.
- 5 ROUTE WIRES THROUGH CLAMP TO KEEP OFF OF THE TOP OF THE FURNACE.
- 4 WIRE PASSES THROUGH FLOOR IN THIS AREA.
- 3 MOUNT MAGNET TO SCREEN DOOR FRAME, MOUNT WITH MAGNET TOWARD SWITCH.
- 2 MOUNT SWITCH TO DOOR JAMB WITH TAPE 076322-21-000.

1. AT MINIMUM ALL WIRES TO BE SUPPORTED AND SECURED PER CODE REQUIREMENTS. USE CLAMP 10495 OR 10497 OR WIRE TIE 8343 OR 108046 AND SCREW G67-XX-XXX OR G56-XX-XXX AS APPROPRIATE FOR INSTALLATION.

NOTES:

FOR ELECTRICAL TORQUE SPECIFICATIONS SEE DWG NO. 128783-01-000

FOR ELECTRICAL CALLOUTS SEE DWG NO. 121339-01-000

265 CODES/STANDARDS-CSA/CMVSS
1B1 CODES/STANDARDS USA

DESCRIPTION:		1B1	265
WIRING INSTL-BODY, 12V			
SHEET:	ITEM/PART NO.:	REV	
3 OF 7	000210595 / 30321101000		

8 7 6 5 4 3 2 1

D

C

B

A

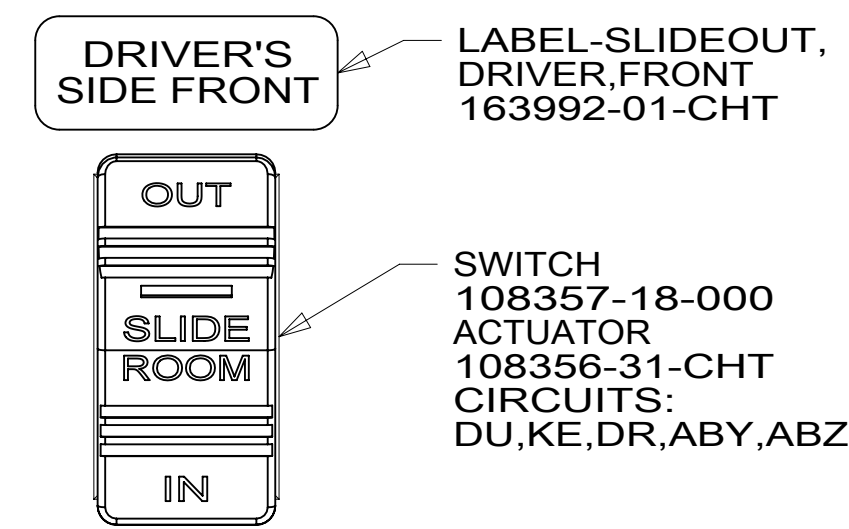

LABEL-SLIDEOUT, DRIVER FRONT 163992-01-CHT

SWITCH 108357-18-000 ACTUATOR 108356-31-CHT CIRCUITS: DU,KE,DR,ABY,ABZ

WARNING CRUSH HAZARD. Keep people and objects clear of the inside and the outside of the slideout room when operating. Failure to comply could result in death or serious injury.

LABEL-WARNING, SLIDEOUT 116549-01-000

DETAIL DA

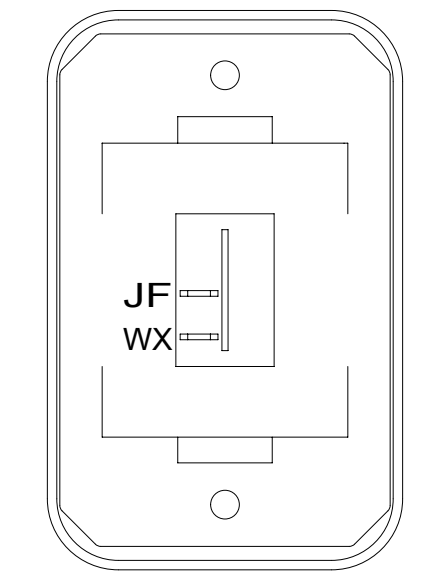

SWITCH-ROCKER 135740-01-CHT SWITCH-BASE 135741-01-CHT SWITCH-BEZEL 135742-01-CHT SCREW G11-08-08U (2)

DETAIL DE

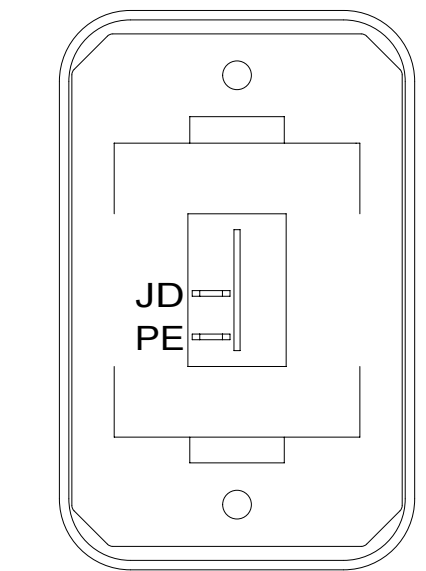

SWITCH-ROCKER 135740-01-CHT SWITCH-BASE 135741-01-CHT SWITCH-BEZEL 135742-01-CHT SCREW G11-08-08U (2)

DETAIL DJ

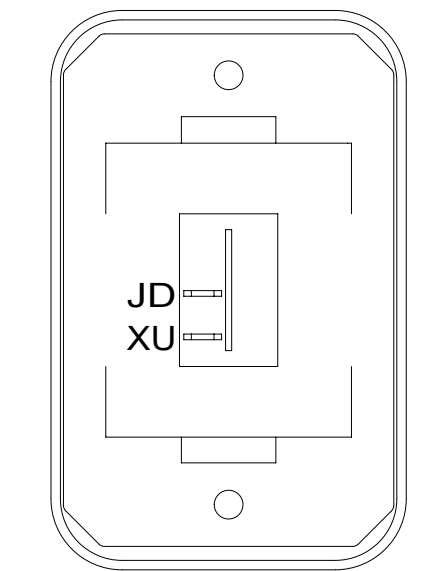

SWITCH-ROCKER 135740-01-CHT SWITCH-BASE 135741-01-CHT SWITCH-BEZEL 135742-01-CHT SCREW G11-08-08U (2)

DETAIL DL

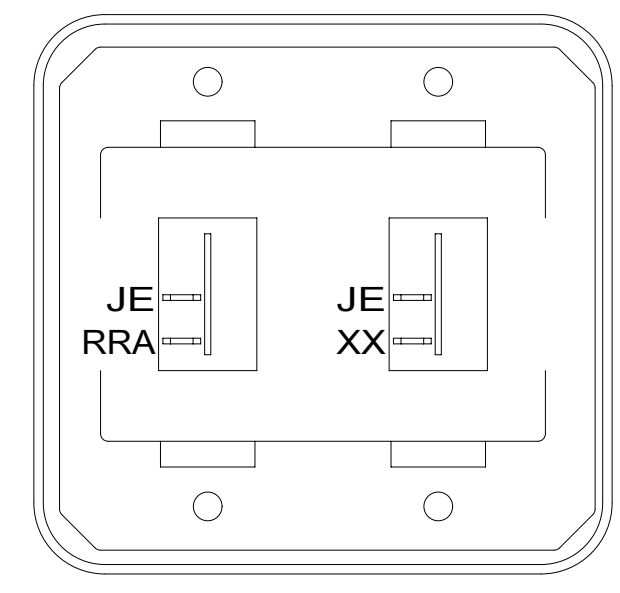

SWITCH-ROCKER 135740-01-CHT SWITCH-BASE 135741-02-CHT SWITCH-BEZEL 135742-02-CHT SCREW G11-08-08U (4)

DETAIL DF

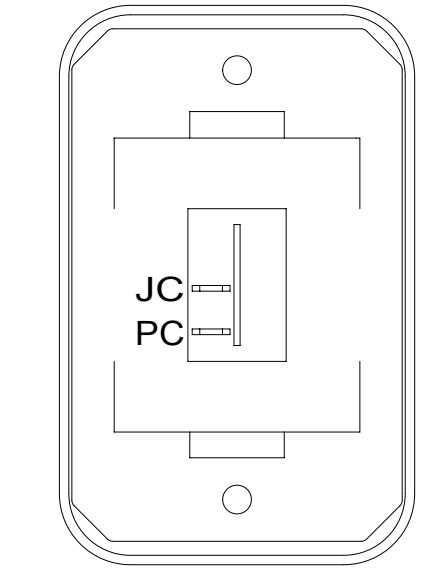

SWITCH-ROCKER 135740-01-CHT SWITCH-BASE 135741-01-CHT SWITCH-BEZEL 135742-01-CHT SCREW G11-08-08U (2)

DETAIL DK

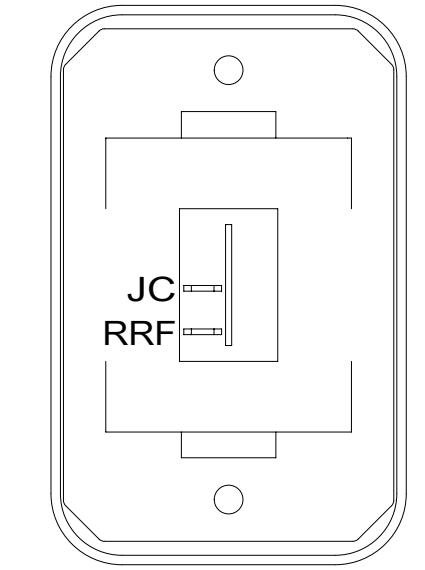

SWITCH-ROCKER 135740-01-CHT SWITCH-BASE 135741-01-CHT SWITCH-BEZEL 135742-01-CHT SCREW G11-08-08U (2)

DETAIL DM

SWITCH-AWNING 108357-06-000 ACTUATOR-SWITCH 108356-12-CHT CIRCUITS FFD,FFR,FFE FFE,JJR,FFD

SWITCH-AWNING 108357-14-000 ACTUATOR-SWITCH 108356-28-CHT CIRCUITS SP,ZZL,NE

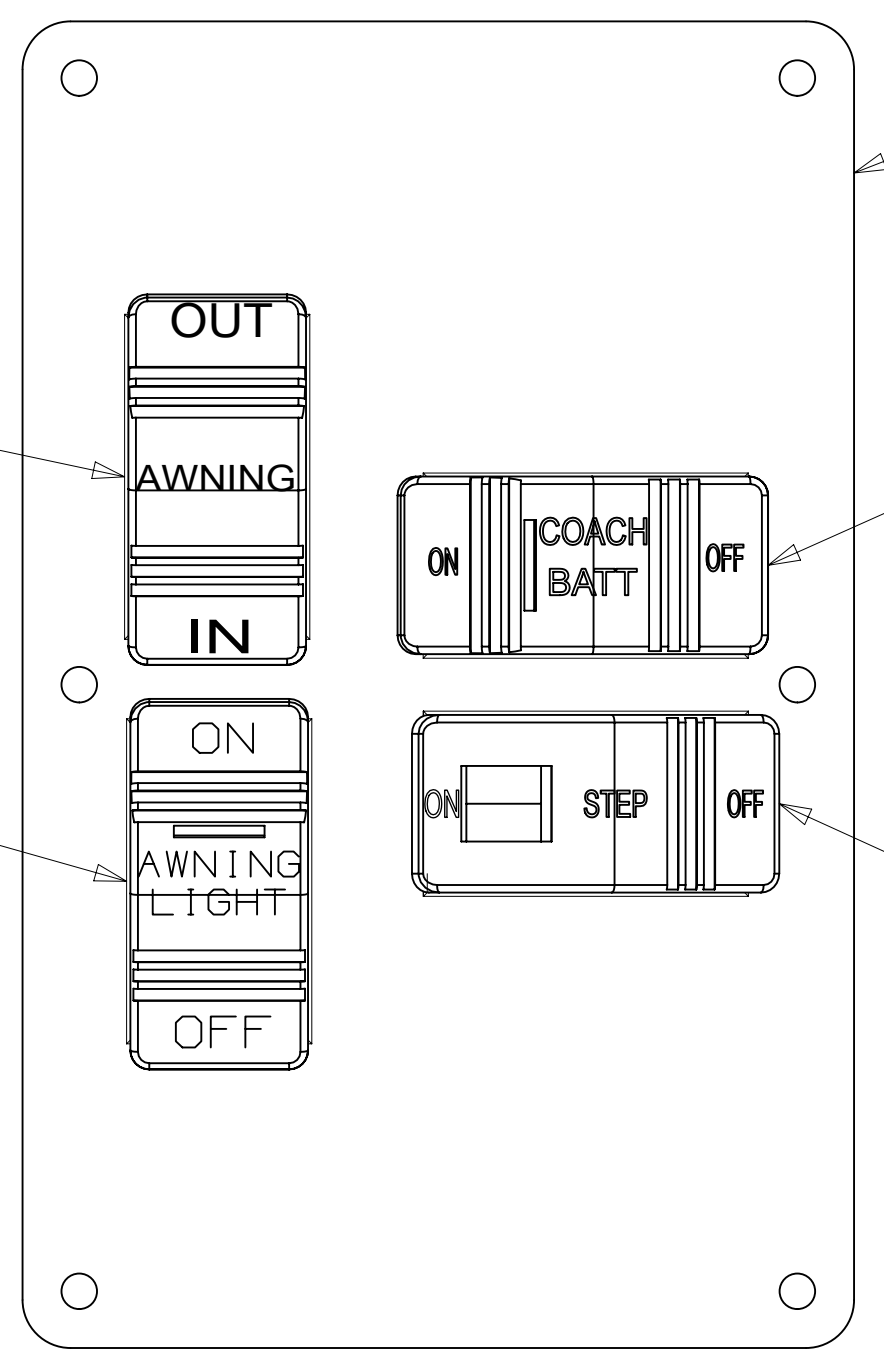
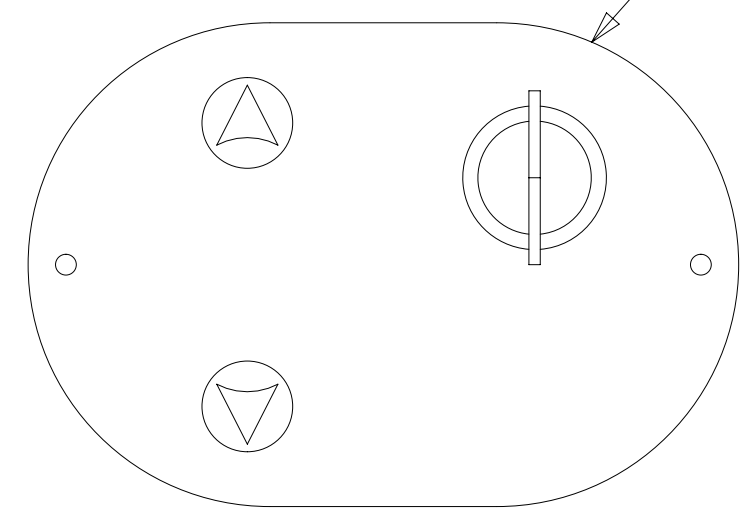

PLATE-SWITCH 158431-05-CHT SCREW G11-06-10U (6)

SWITCH-COACH BATTERY 108357-18-000 ACTUATOR-SWITCH 108356-19-CHT CIRCUITS KF,LG,LJ,LH,WC WIRE ASM-THERM 186796-01-000

SWITCH-STEP 108357-19-000 CIRCUITS ER,ES

DETAIL DB 1



DETAIL DG 45B

SWITCH-CONTROL, LOFTBED, TOUCH 189056-01-000 WIRE ASM-LOFT BED SWITCH 000122806 / 323456-01-000 SCREW 000G11-02-08U (2)

8 GRN (GROUND)

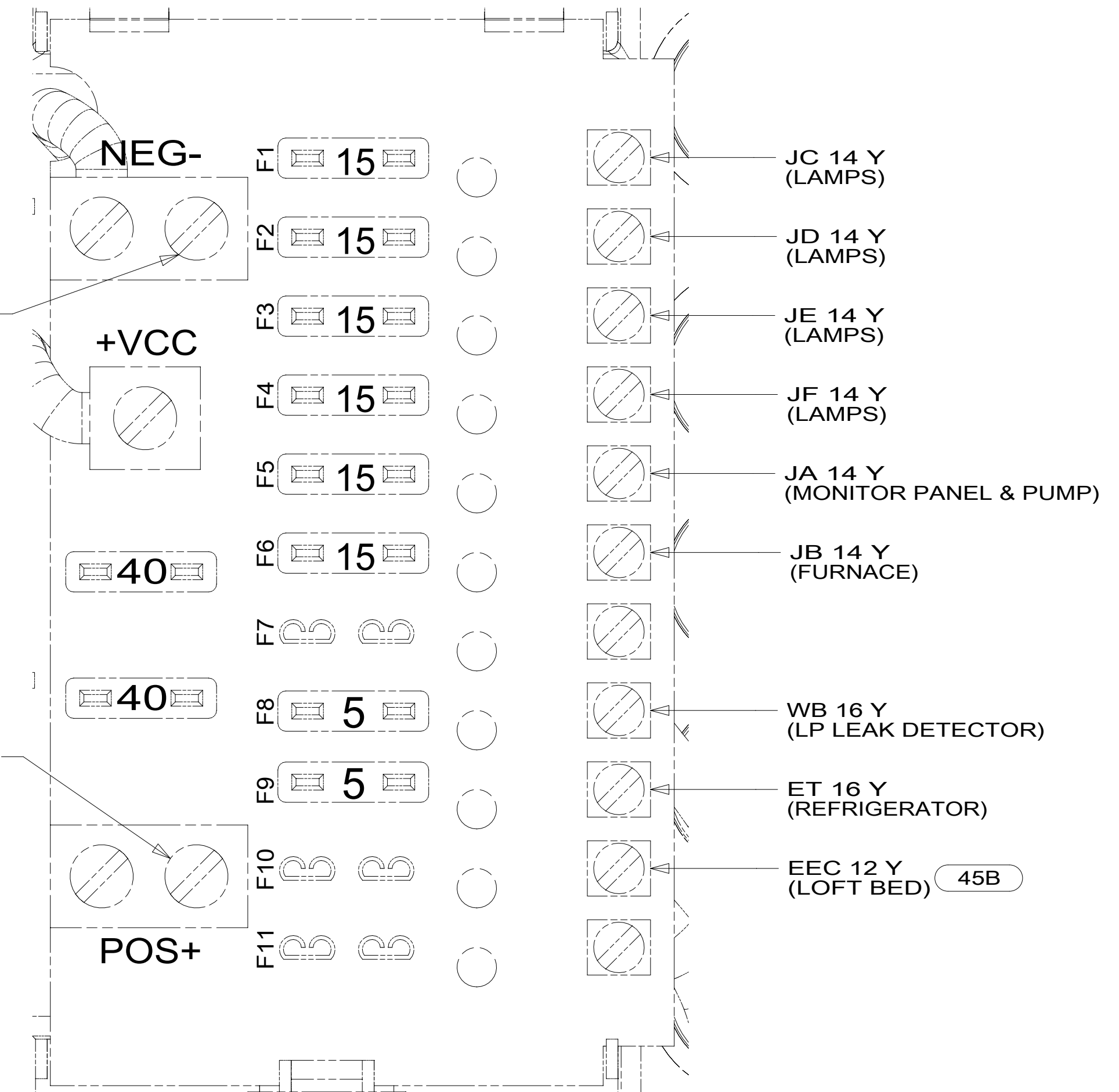

DETAIL DN

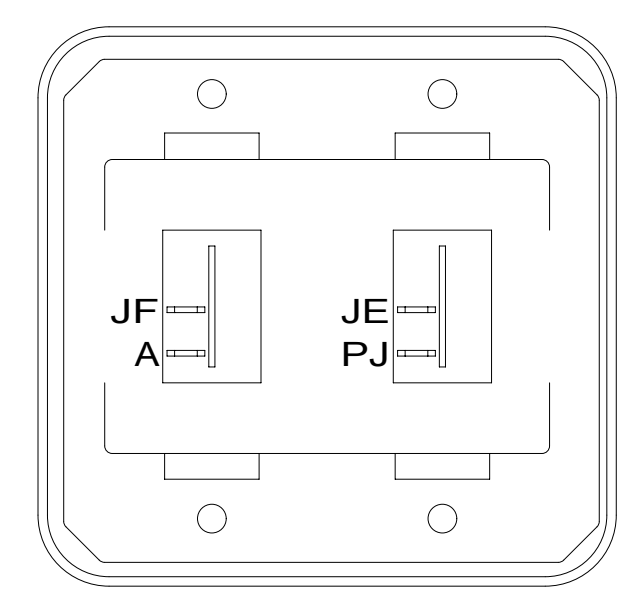

SWITCH-ROCKER 135740-01-CHT SWITCH-BASE 135741-02-CHT SWITCH-BEZEL 135742-02-CHT SCREW G11-08-08U (4)

DETAIL DC

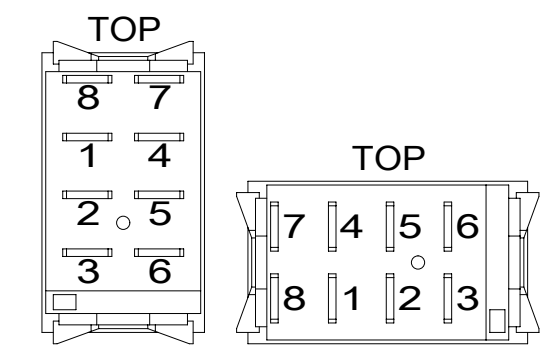

DETAIL DD

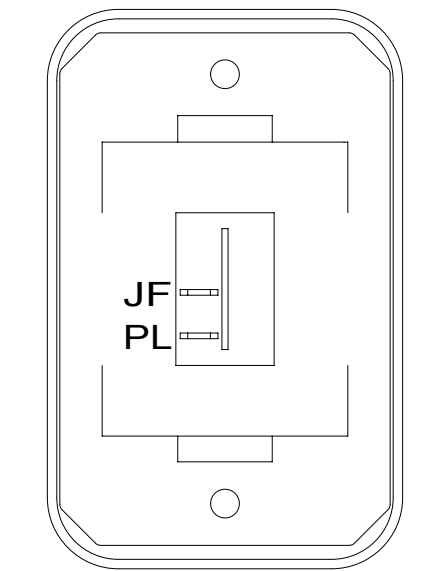

SWITCH-ROCKER 135740-01-CHT SWITCH-BASE 135741-01-CHT SWITCH-BEZEL 135742-01-CHT SCREW G11-08-08U (2)

DETAIL DH

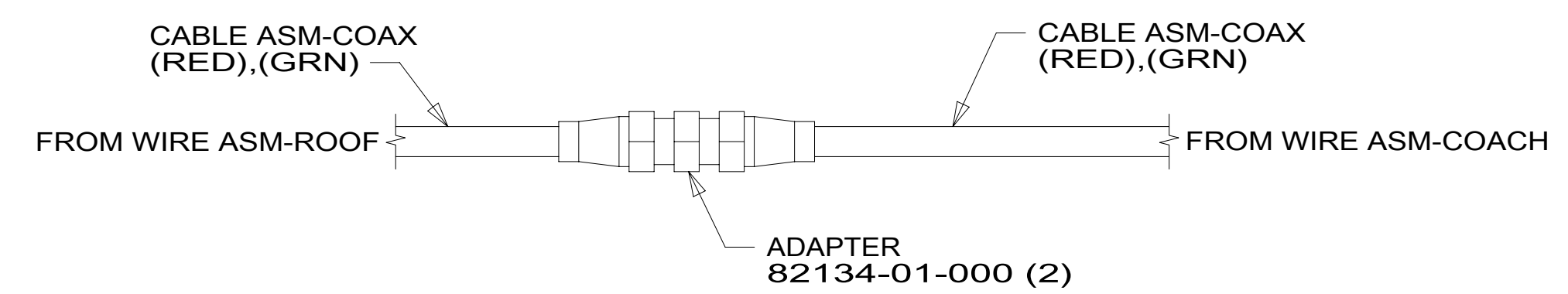

DETAIL DP

NOTES: 1 FOR SWITCH ORIENTATION SEE DETAIL DD.

FOR ELECTRICAL TORQUE SPECIFICATIONS SEE DWG NO. 128783-01-000

FOR ELECTRICAL CALLOUTS SEE DWG NO. 121339-01-000

- 45B LOFT BED
- 265 CODES/STANDARDS-CSA/CMVSS
- 1B1 CODES/STANDARDS USA

DESCRIPTION: 1B1 265		
WIRING INSTL-BODY, 12V		
SHEET: 4 OF 7	ITEM/PART NO: 000210595 / 30321101000	REV:

8 7 6 5 4 3 2 1 14-Sep-2017

8 7 6 5 4 3 2 1



D

D

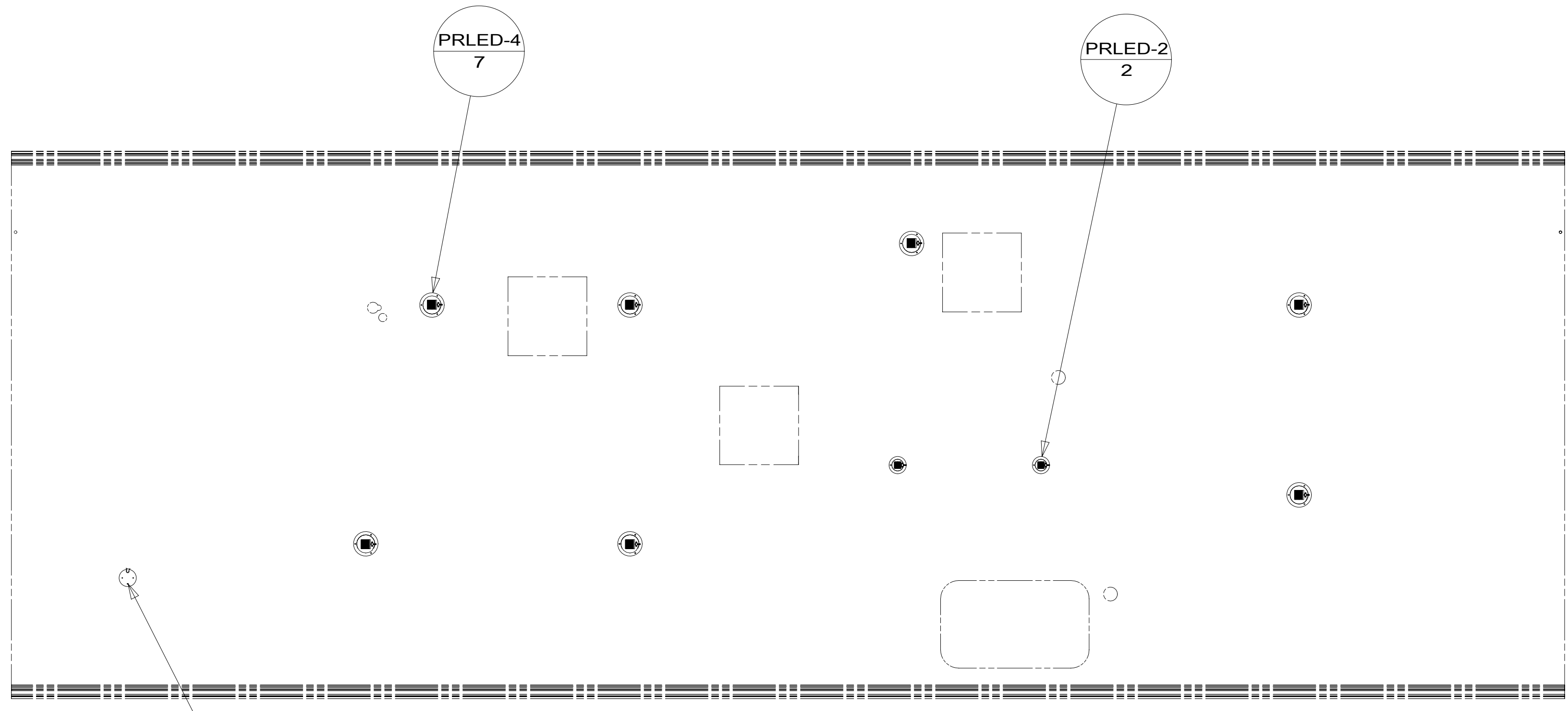

C

C



B

B

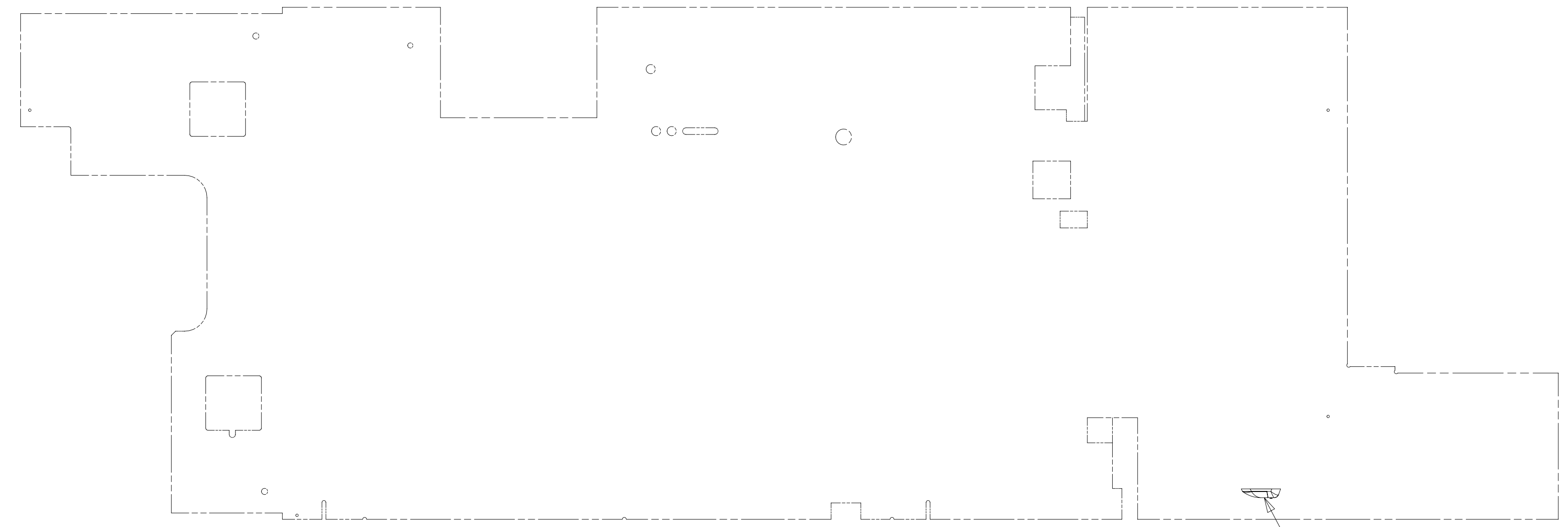

A

A

8 7 6 5 4 3 2 1 14-Sep-2017



PSSLED-2 45B

PRLED-4
7

PRLED-2
2

LSS-1

- 45B LOFT BED
- 265 CODES/STANDARDS-CSA/CMVSS
- 1B1 CODES/STANDARDS USA

FOR ELECTRICAL TORQUE SPECIFICATIONS SEE DWG NO. 128783-01-000

FOR ELECTRICAL CALLOUTS SEE DWG NO. 121339-01-000

1B1	265
DESCRIPTION: WIRING INSTL-BODY, 12V	
SHEET: 5 OF 7	ITEM/PART NO: 000210595 / 30321101000
REV	

8 7 6 5 4 3 2 1

D
C
B
A

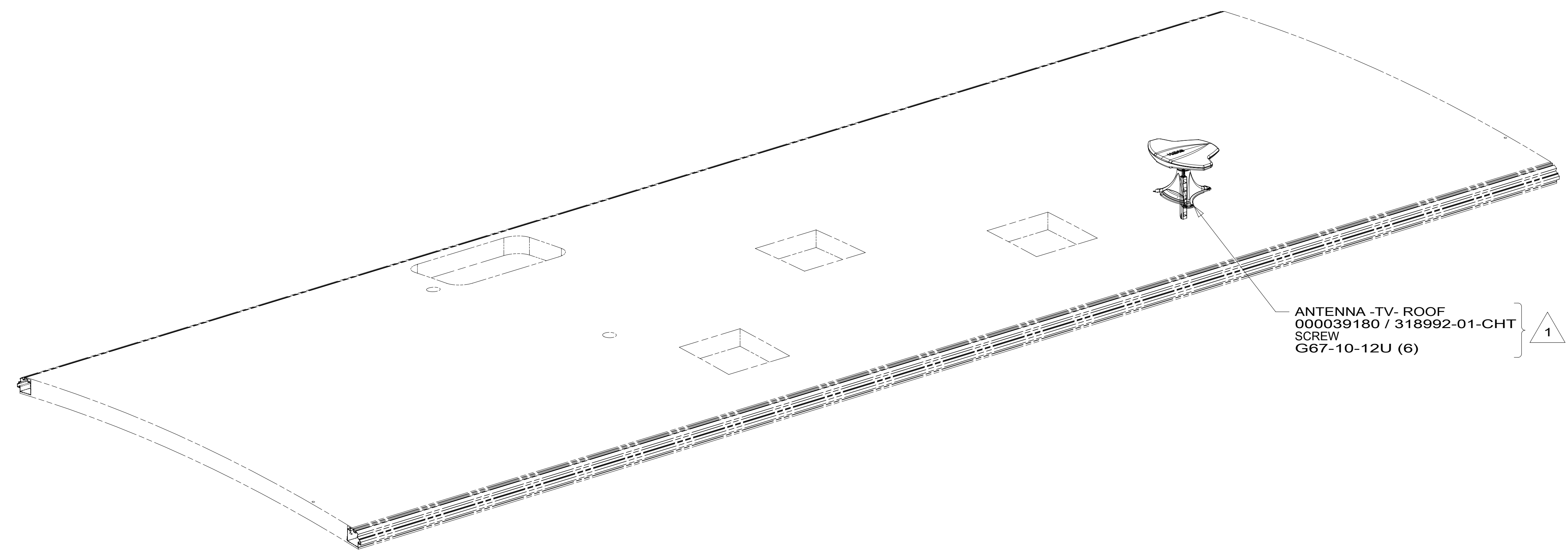

ANTENNA -TV- ROOF
 00039180 / 318992-01-CHT
 SCREW
 G67-10-12U (6) } 1

1 SEE ANTENNA INSTALLATION MANUAL FOR CORRECT
 INSTALLATION PROCEDURE.

NOTES:

FOR ELECTRICAL
 TORQUE
 SPECIFICATIONS
 SEE DWG NO.
 128783-01-000

FOR
 ELECTRICAL
 CALLOUTS
 SEE DWG NO.
 121339-01-000

265 CODES/STANDARDS-CSA/CMVSS
 1B1 CODES/STANDARDS USA

1B1 265	
DESCRIPTION: WIRING INSTL-BODY, 12V	
SHEET: 6 OF 7	ITEM/PART NO: 000210595 / 30321101000
REV	

8 7 6 5 4 3 2 1 14-Sep-2017

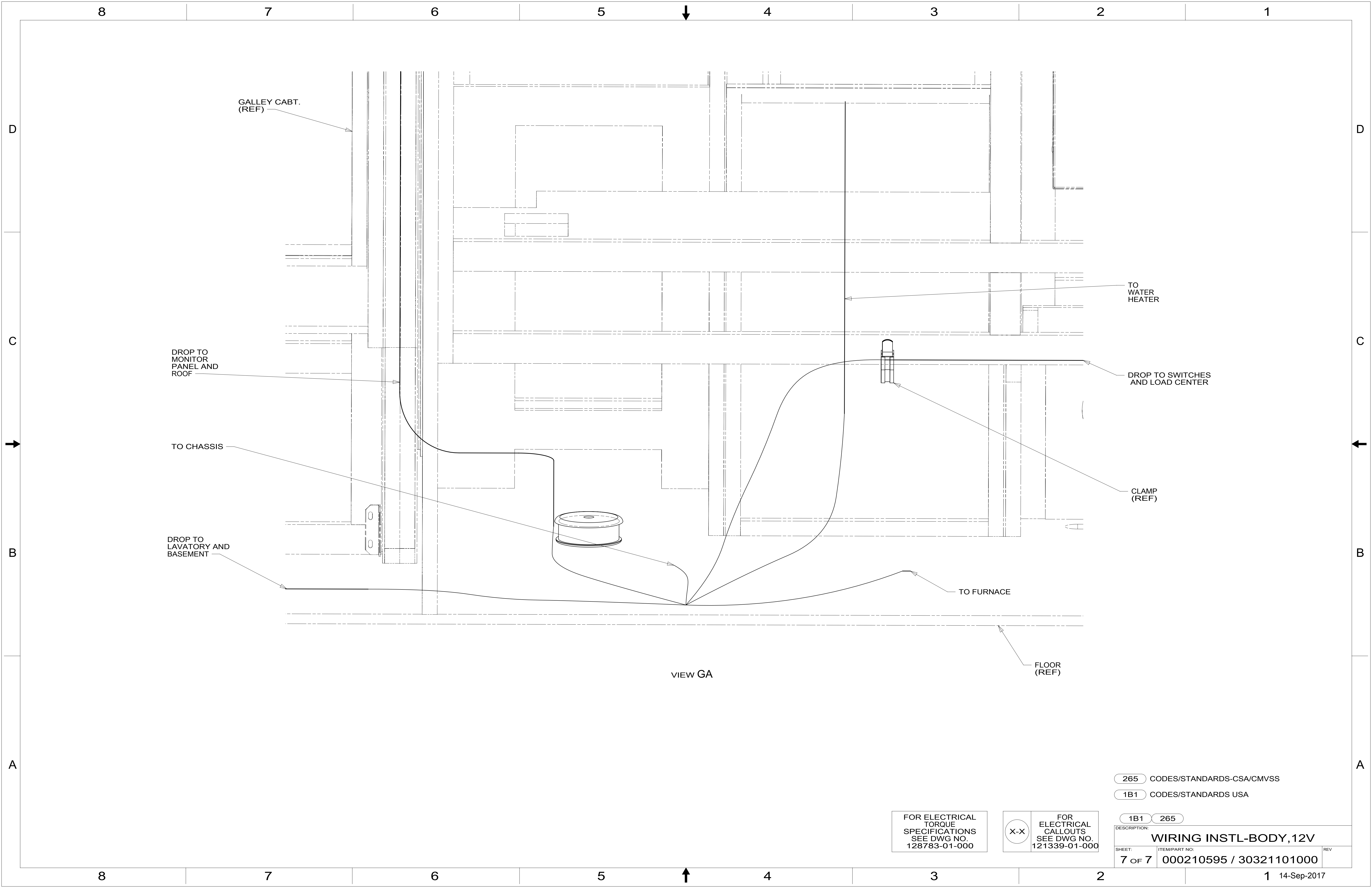

GALLEY CABT.
(REF)

DROP TO
MONITOR
PANEL AND
ROOF

TO CHASSIS

DROP TO
LAVATORY AND
BASEMENT

TO WATER
HEATER

DROP TO SWITCHES
AND LOAD CENTER

CLAMP
(REF)

TO FURNACE

FLOOR
(REF)

VIEW GA

265 CODES/STANDARDS-CSA/CMVSS

1B1 CODES/STANDARDS USA

1B1 265

FOR ELECTRICAL
TORQUE
SPECIFICATIONS
SEE DWG NO.
128783-01-000

FOR
ELECTRICAL
CALLOUTS
SEE DWG NO.
121339-01-000

DESCRIPTION:
WIRING INSTL-BODY, 12V

SHEET: 7 OF 7 ITEM/PART NO: 000210595 / 30321101000 REV

1 14-Sep-2017