

- 21M WASHER/DRYER PREP
- 21S WASHER & DRYER-PAIR

X-X
 FOR
 WATER
 CALLOUTS
 SEE DWG NO.
 000209446 /
 303369-01-000

WINNEBAGO[®]		COPYRIGHT 2018 WINNEBAGO INDUSTRIES, INC.	
DSNR:		ALL DIMENSIONS ARE IN MILLIMETERS	
DFTR:		MATERIAL:	
UNSPECIFIED TOLERANCES:			
WHOLE DIM (X) :	3		
ONE-PLACE (X.X) :	1.5		
TWO-PLACE (X.XX) :	0.50		
ANGLE :	1°		
REFER TO ES0018 FOR FASTENER TIGHTENING GUIDELINES		WEIGHT: (LBS)	FIRST USED: (REF)
			17 L38W
DESCRIPTION:			
WATER SYSTEM INSTL			
SHEET:	ITEM/PART NO.:	REV	
1 OF 5	000177063 / 30040601000		
			REF: 1 29-Aug-2018

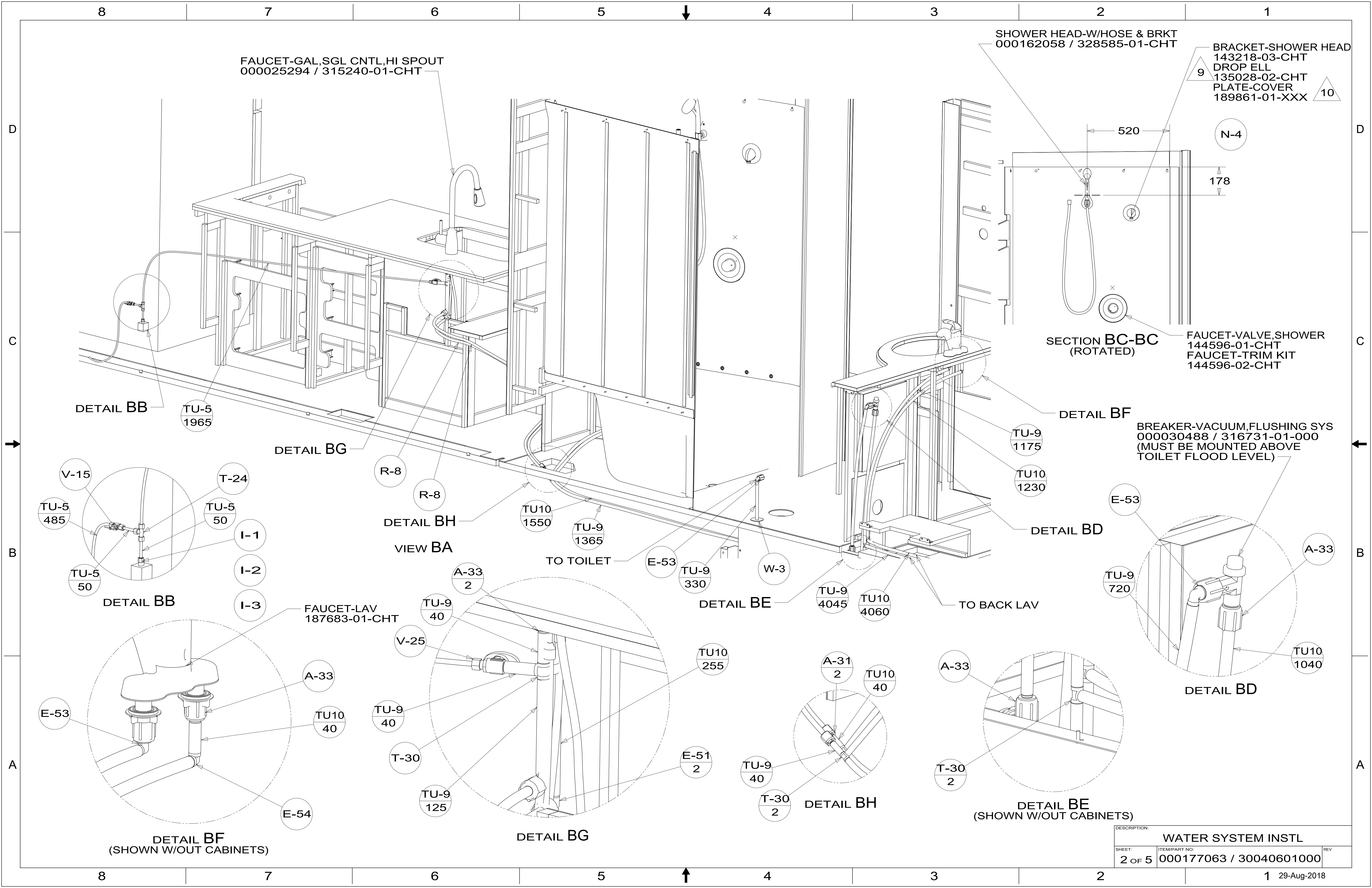

FAUCET-GAL, SGL CNTL, HI SPOUT
000025294 / 315240-01-CHT

SHOWER HEAD-W/HOSE & BRKT
000162058 / 328585-01-CHT

BRACKET-SHOWER HEAD
143218-03-CHT
DROP ELL
135028-02-CHT
PLATE-COVER
189861-01-XXX

SECTION BC-BC
(ROTATED)
FAUCET-VALVE, SHOWER
144596-01-CHT
FAUCET-TRIM KIT
144596-02-CHT

BREAKER-VACUUM, FLUSHING SYS
000030488 / 316731-01-000
(MUST BE MOUNTED ABOVE
TOILET FLOOD LEVEL)

FAUCET-LAV
187683-01-CHT

DESCRIPTION: WATER SYSTEM INSTL		
SHEET: 2 OF 5	ITEM/PART NO: 000177063 / 30040601000	REV

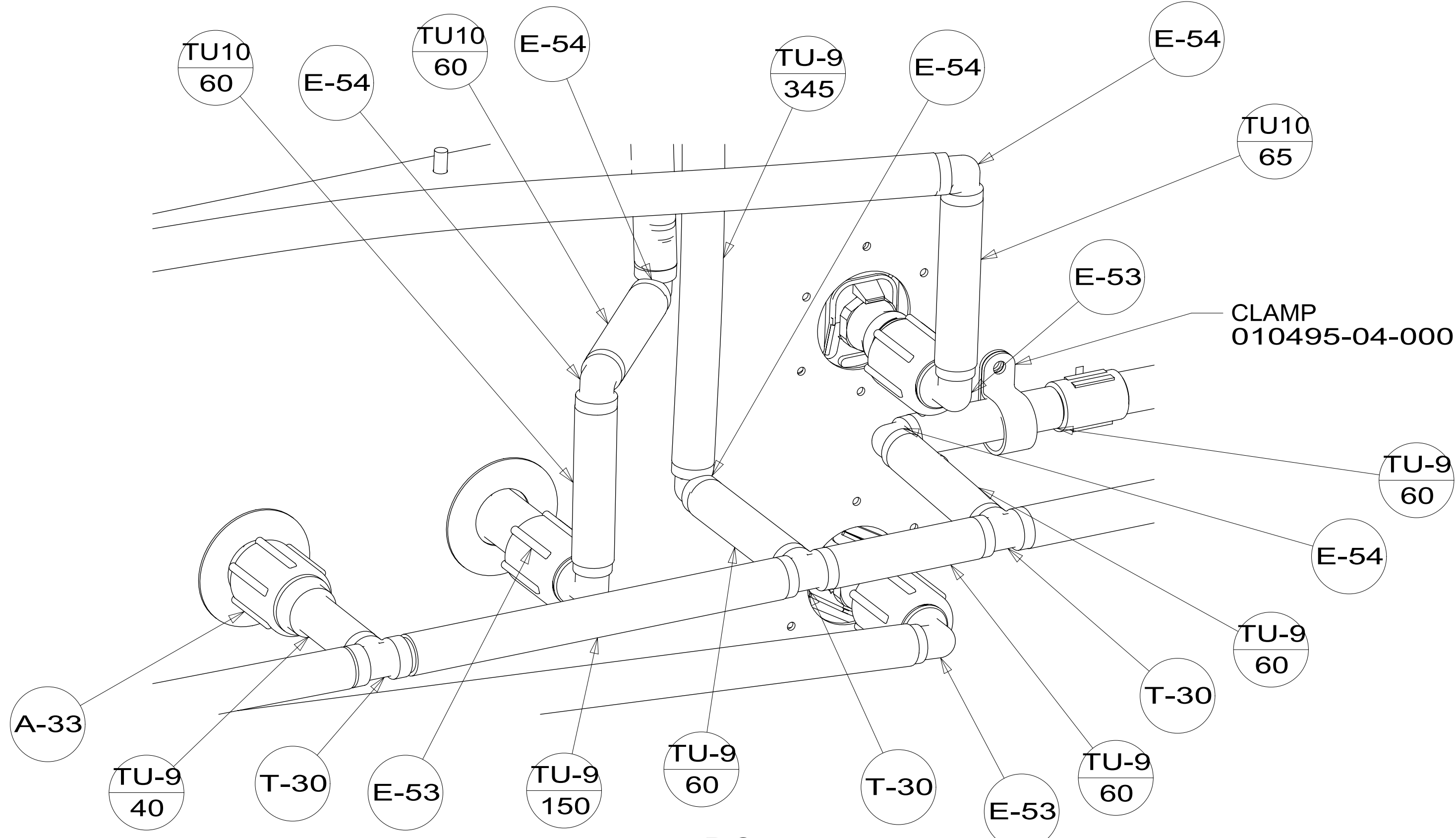

DETAIL DC

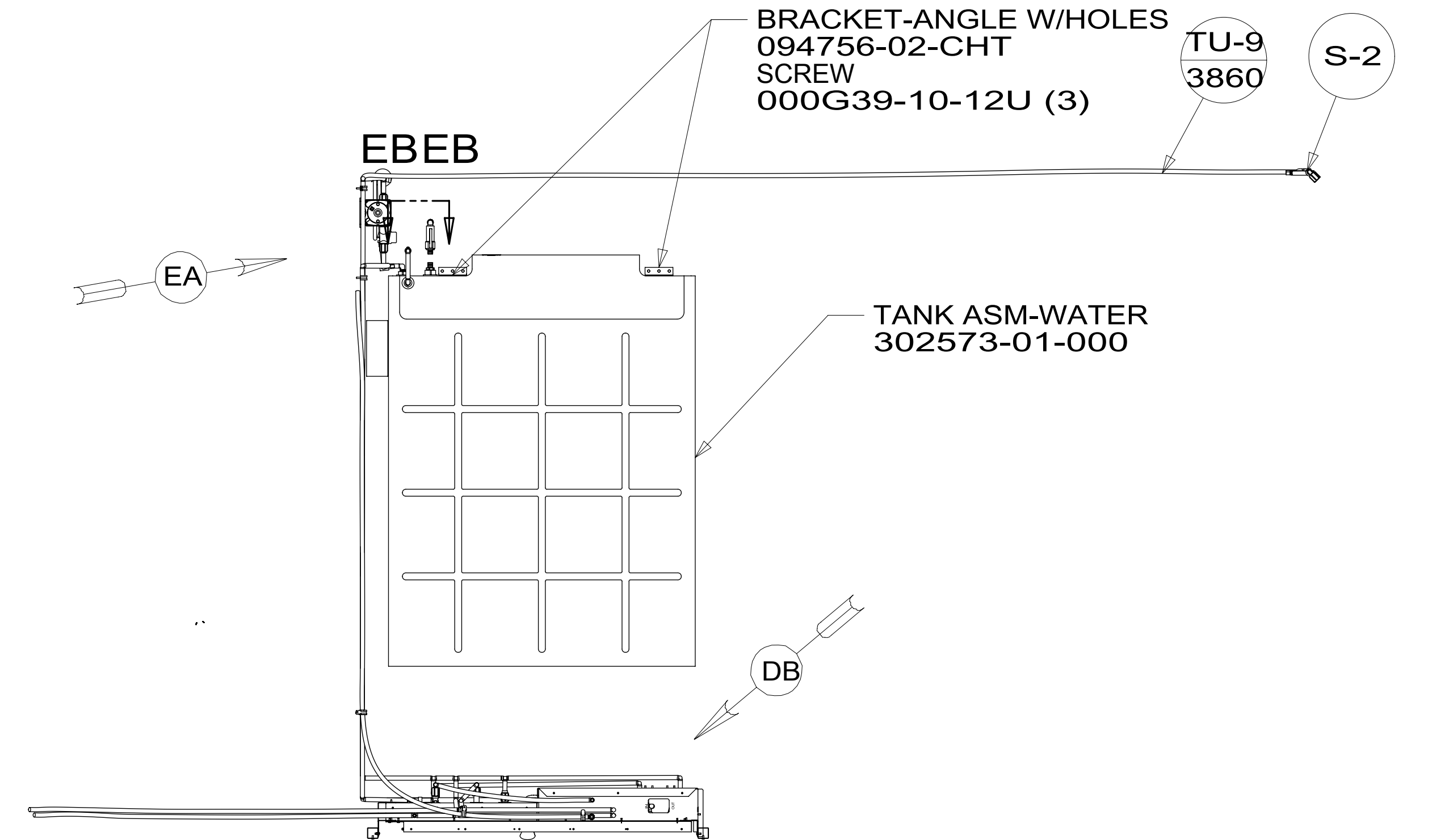

TOP VIEW SHOWING LINE UNDER FLOOR

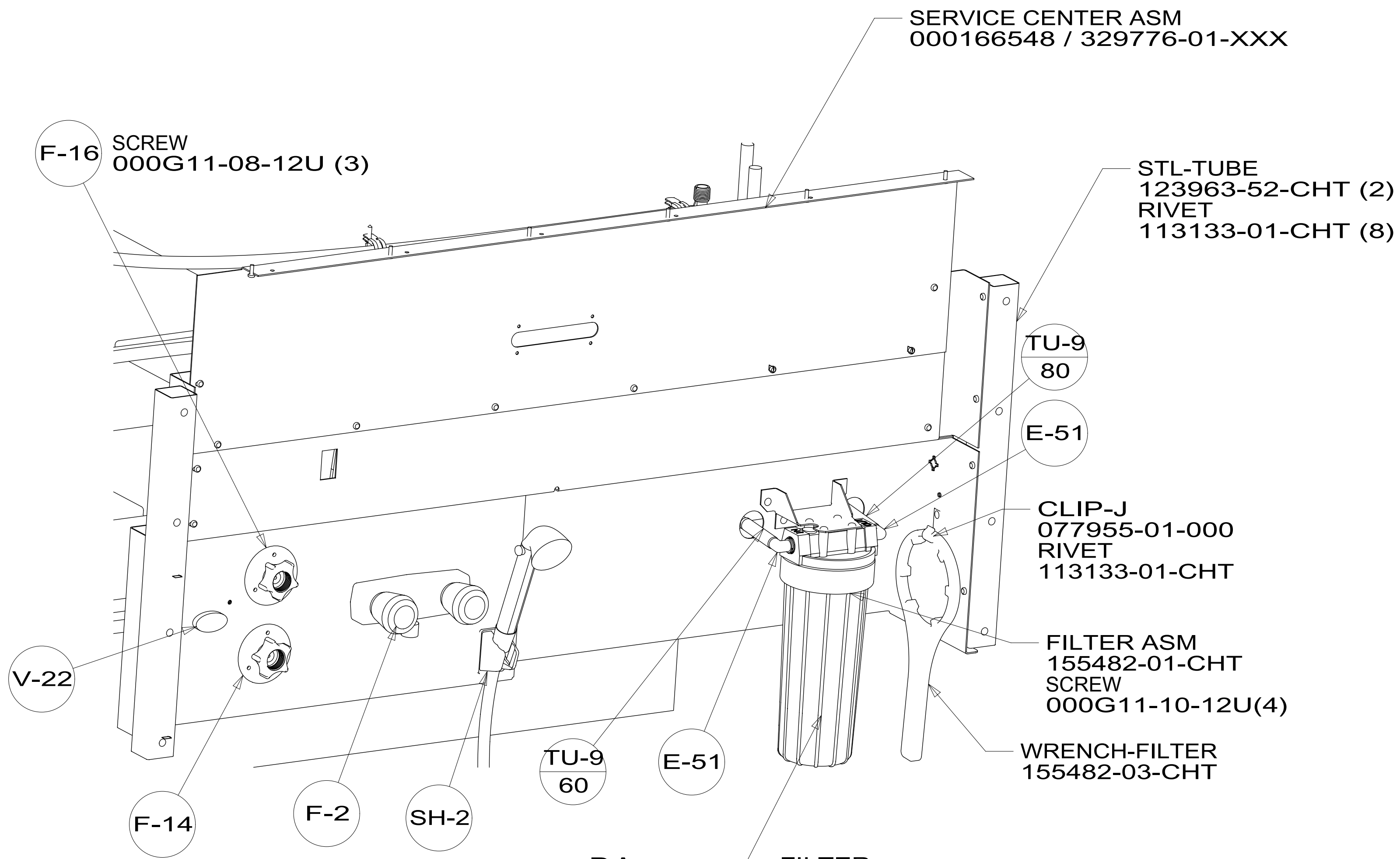

VIEW DA

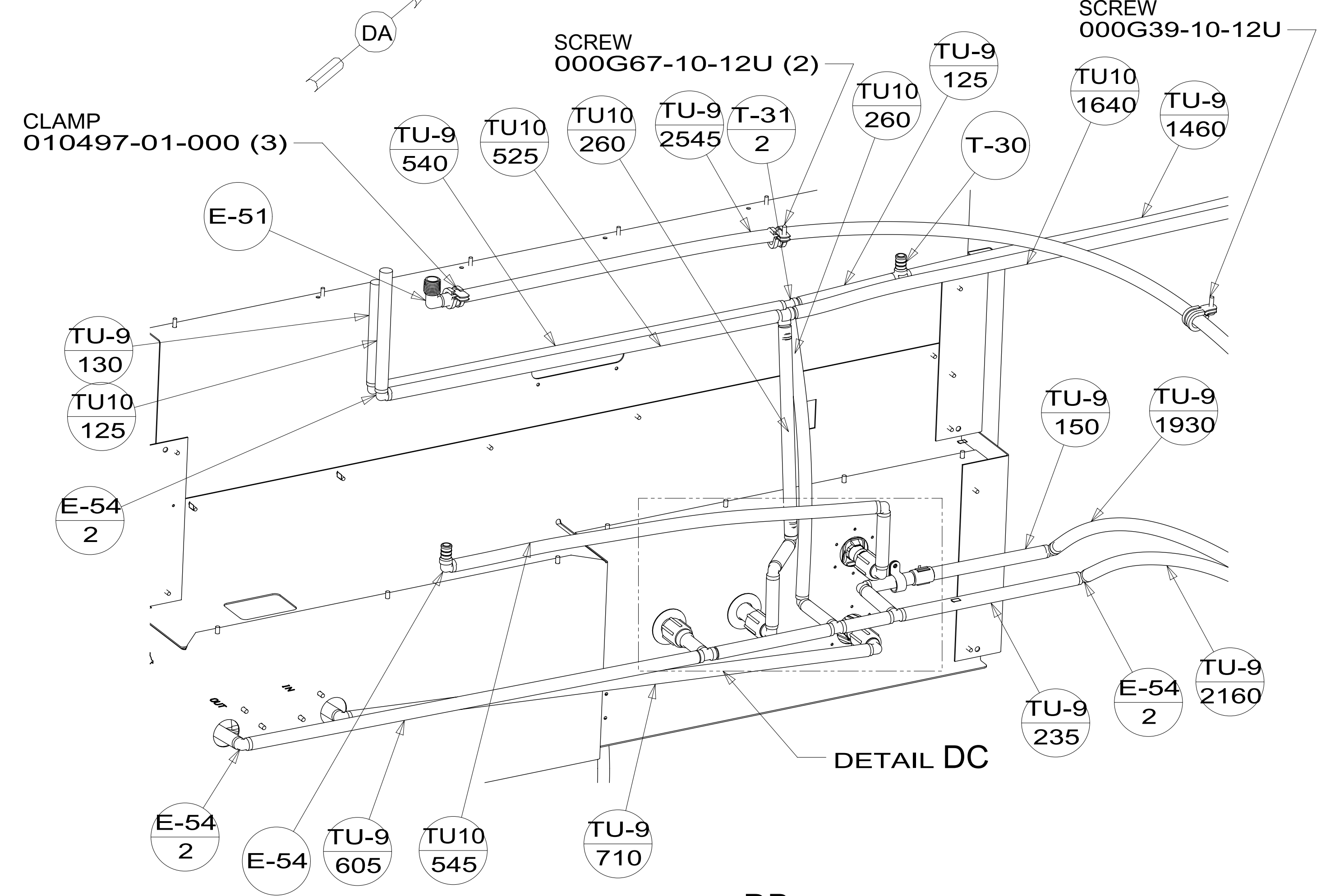

VIEW DB

DESCRIPTION:		
WATER SYSTEM INSTL		
SHEET:	ITEM/PART NO.:	REV
4 OF 5	000177063 / 30040601000	

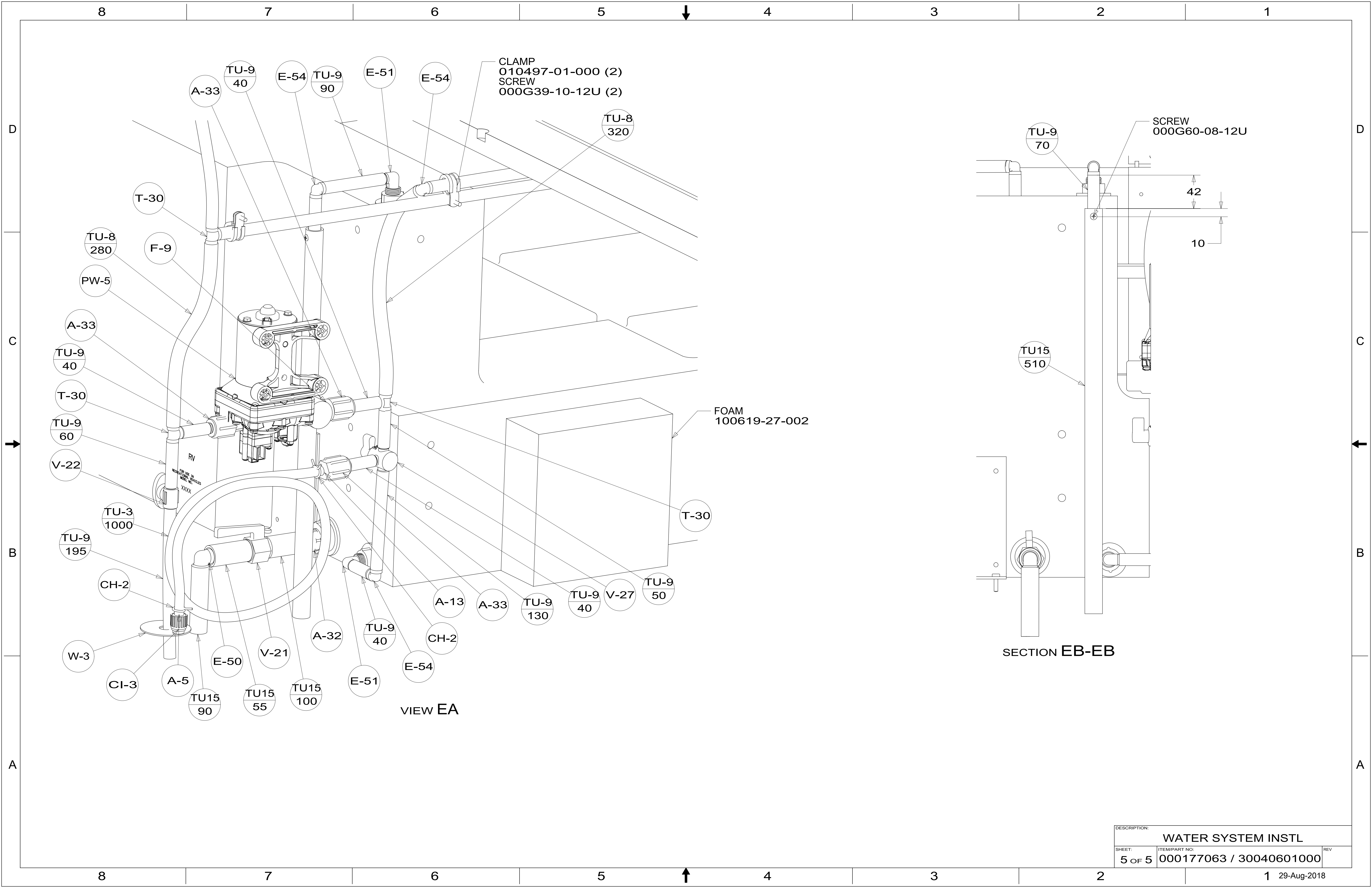

CLAMP
010497-01-000 (2)
SCREW
000G39-10-12U (2)

SCREW
000G60-08-12U

FOAM
100619-27-002

SECTION EB-EB

VIEW EA

DESCRIPTION: WATER SYSTEM INSTL		
SHEET: 5 OF 5	ITEM/PART NO: 000177063 / 30040601000	REV