

- NOTES:
- 1. AT MINIMUM ALL WIRES TO BE SUPPORTED AND SECURED PER CODE REQUIREMENTS. USE CLAMP 10495 OR 10497 OR WIRE TIE 8343 OR 108046 AND SCREW G67-XX-XXX OR G56-XX-XXX AS APPROPRIATE FOR INSTALLATION.
 - 2. SWITCH ON LAMP TO BE ORIENTED TO REAR OF CABINET.
 - 3. SEE SHEET 5 FOR ADDITIONAL INFORMATION.
 - 4. CONNECT YEL WIRE TO YEL/BLK WIRE AND WHT WIRE TO WHT WIRE.
 - 5. WIRE ROUTED ALONG DRAINAGE PIPE AND CONNECTED TO PIPE WITH TIE-WIRE 8343-04-000.
 - 6. SEE DRAINAGE SYSTEM INSTALLATION FOR ADDITIONAL INFORMATION.
 - 7. CABLE TO BE ROUTED WITH WIRE ASM-LEFT FROM BEDROOM TV TO WIRE ASM-CHASSIS.

- 8. WIRE ASM-ROUTED WITH WIRE ASM-LEFT FROM WIRE ASM-CHASSIS, SPEAKERS TO WIRE ASM-ROOF.
- 9. SEE WIRING INSTL-TV/DVD FOR ADDITIONAL INFORMATION.

- 23T DRAINAGE SYSTEM-HEATED
- 23R DRAINAGE SYSTEM/HEAT-PREWIRE
- 68X TV - BEDROOM
- 644 GREAT ALASKAN RENTAL PACKAGE
- 265 CODES/STANDARDS-CSA/CMVSS
- 1B1 CODES/STANDARDS USA

FOR ELECTRICAL TORQUE SPECIFICATIONS SEE DWG NO. 128783-01-000

FOR ELECTRICAL CALLOUTS SEE DWG NO. 121339-01-000

WINNEBAGO
COPYRIGHT 2016 WINNEBAGO INDUSTRIES, INC.

DSNR:	ALL DIMENSIONS ARE IN MILLIMETERS	
DFFR:	MATERIAL:	
UNSPECIFIED TOLERANCES:		
WHOLE DIM (X) :	3	
ONE-PLACE (X.X) :	1.5	
TWO-PLACE (X.XX) :	0.50	
ANGLE :	1°	
REFER TO ES0018 FOR FASTENER TIGHTENING GUIDELINES	WEIGHT: (LBS)	FIRST USED:
		17 331D
DESCRIPTION: WIRING INSTL-BODY, 12V		
SHEET: 1 OF 5	ITEM/PART NO: 000004680 / 31216301000	REV:
REF:		1 16-Mar-2017

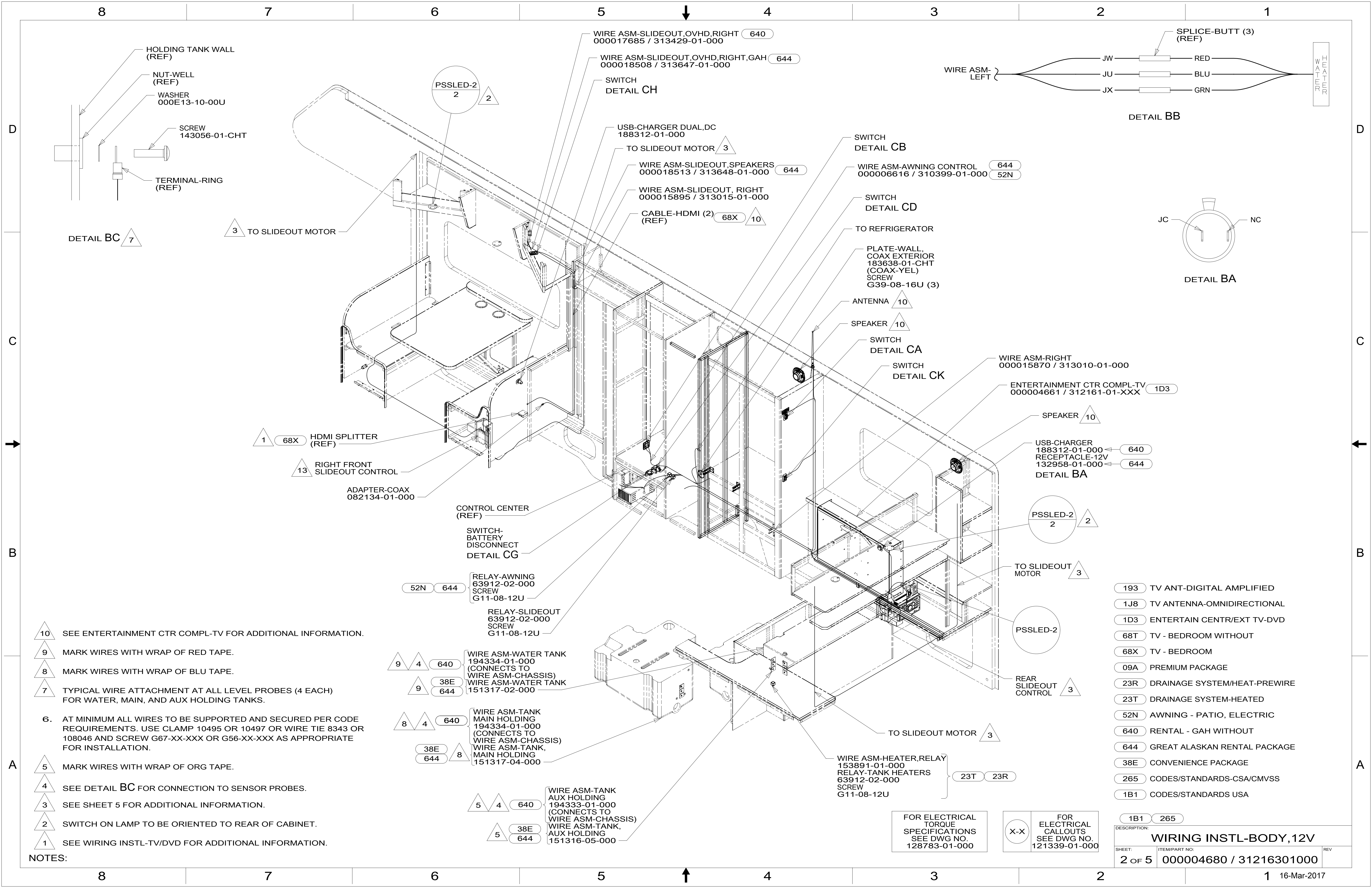

8 7 6 5 4 3 2 1

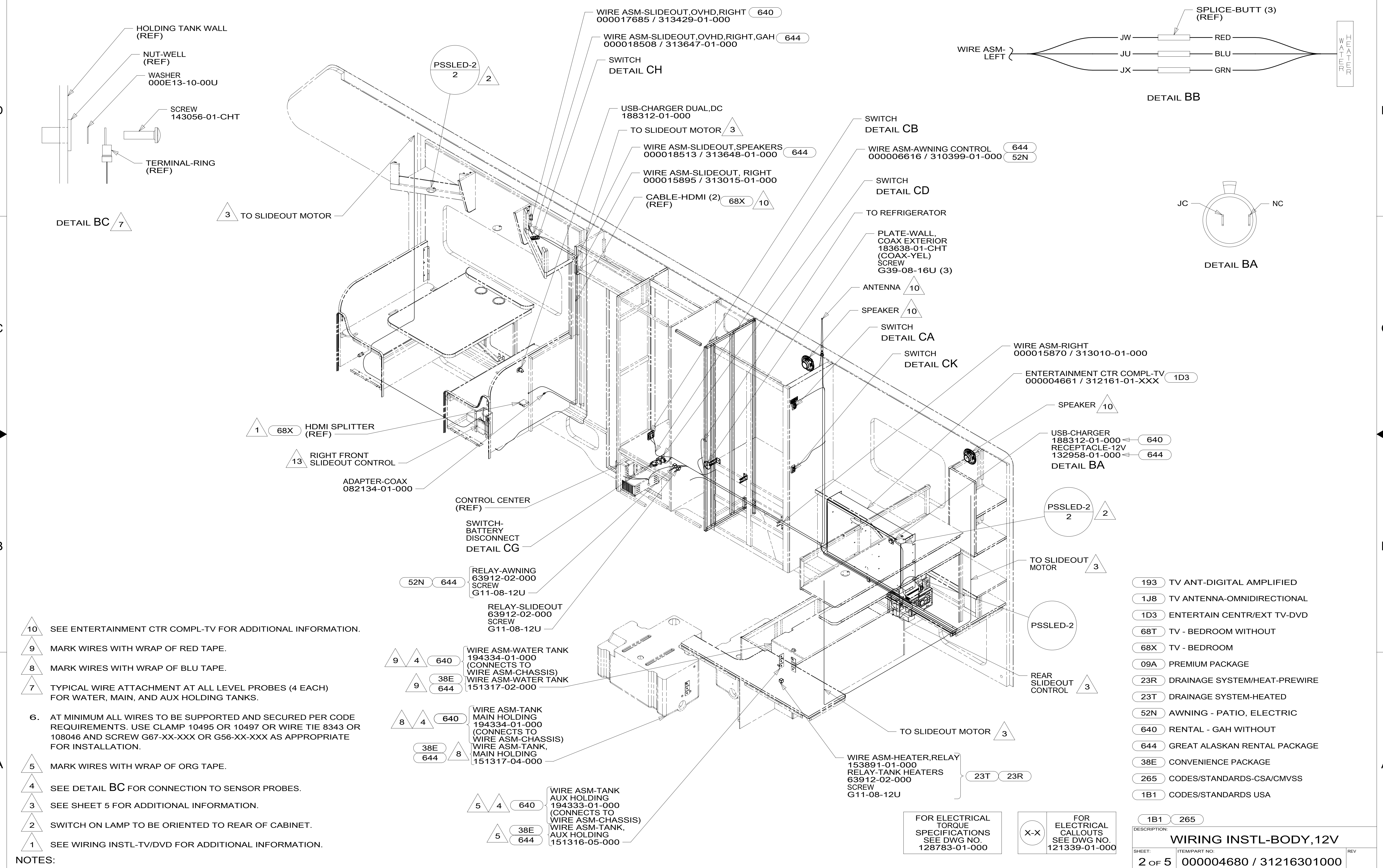

- 10 SEE ENTERTAINMENT CTR COMPL-TV FOR ADDITIONAL INFORMATION.
- 9 MARK WIRES WITH WRAP OF RED TAPE.
- 8 MARK WIRES WITH WRAP OF BLU TAPE.
- 7 TYPICAL WIRE ATTACHMENT AT ALL LEVEL PROBES (4 EACH) FOR WATER, MAIN, AND AUX HOLDING TANKS.
6. AT MINIMUM ALL WIRES TO BE SUPPORTED AND SECURED PER CODE REQUIREMENTS. USE CLAMP 10495 OR 10497 OR WIRE TIE 8343 OR 108046 AND SCREW G67-XX-XXX OR G56-XX-XXX AS APPROPRIATE FOR INSTALLATION.
- 5 MARK WIRES WITH WRAP OF ORG TAPE.
- 4 SEE DETAIL BC FOR CONNECTION TO SENSOR PROBES.
- 3 SEE SHEET 5 FOR ADDITIONAL INFORMATION.
- 2 SWITCH ON LAMP TO BE ORIENTED TO REAR OF CABINET.
- 1 SEE WIRING INSTL-TV/DVD FOR ADDITIONAL INFORMATION.

NOTES:

FOR ELECTRICAL TORQUE SPECIFICATIONS SEE DWG NO. 128783-01-000

FOR ELECTRICAL CALLOUTS SEE DWG NO. 121339-01-000

DESCRIPTION:	1B1 265	
WIRING INSTL-BODY, 12V		
SHEET:	ITEM/PART NO:	REV
2 OF 5	000004680 / 31216301000	

8 7 6 5 4 3 2 1 16-Mar-2017

WARNING
 CRUSH HAZARD. Keep people and objects clear of the inside and outside of the slideout room when operating. Failure to comply could result in death or serious injury.

LABEL-WARNING, SLIDEOUT
 116549-02-000

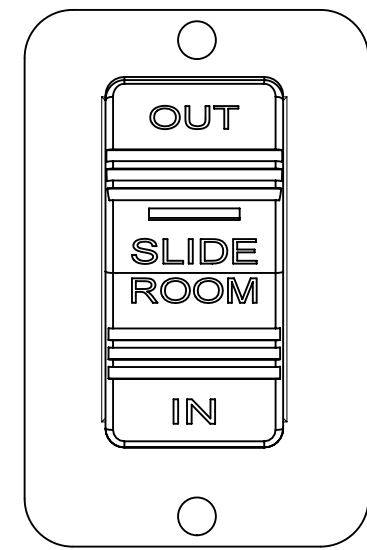

DETAIL CA

PLATE-SWITCH
 144363-02-CHT
 SWITCH
 108357-18-000
 ACTUATOR
 108356-31-CHT
 SCREW
 G11-08-08U (2)

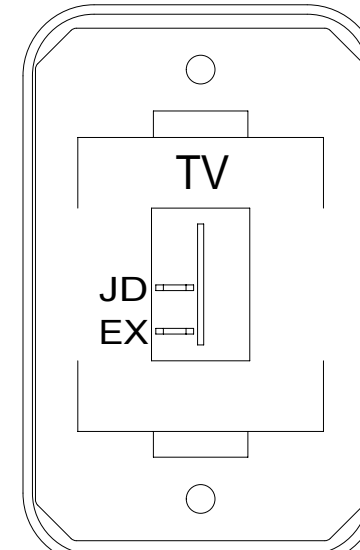

DETAIL CH

SWITCH-ROCKER
 135740-01-CHT
 SWITCH-BASE
 135741-01-CHT
 SWITCH-BEZEL
 135742-45-CHT
 SCREW
 G11-08-08U (2)

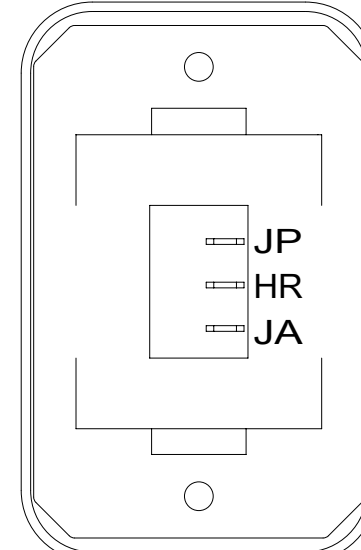

DETAIL CF 23T 23R

HOLDING TANK HEATER
 TURN OFF When Not In Use
 SEE OPERATORS MANUAL

LABEL-SWITCH, HTR, HOLDING TK
 134563-01-CHT

SWITCH-ROCKER
 135740-06-CHT
 SWITCH-BASE
 135741-01-CHT
 SWITCH-BEZEL
 135742-01-CHT
 SCREW
 G11-08-08U (2)

644 52N
 52F

SWITCH-ROCKER
 108357-06-000
 ACTUATOR-SWITCH
 108356-12-CHT
 SWITCH-BLANK
 096241-03-000

SWITCH-ROCKER
 108357-14-000
 ACTUATOR-SWITCH
 108356-28-CHT
 SWITCH-BLANK
 096241-03-000

52N 644
 52F

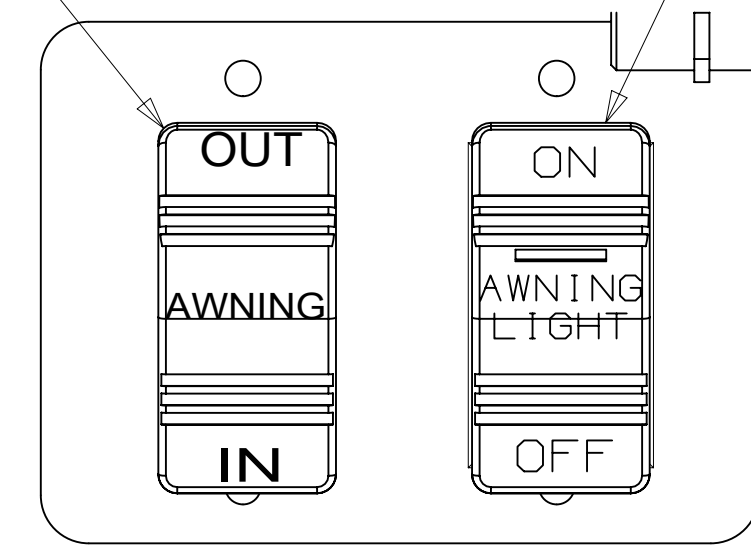

DETAIL CD

PLATE-SWITCH
 158431-17-CHT
 SCREW
 G11-06-10U (4)

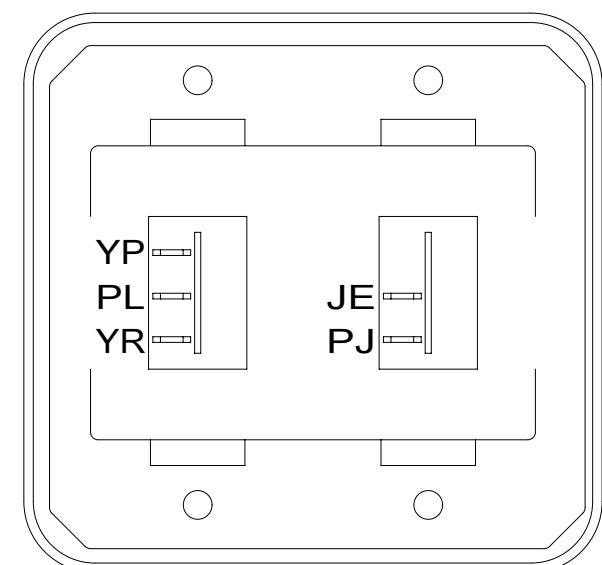

DETAIL CB

SWITCH-ROCKER
 135740-01-CHT
 135740-02-CHT
 SWITCH-BASE
 135741-02-CHT
 SWITCH-BEZEL
 135742-02-CHT
 SCREW
 G11-08-08U (4)

SWITCH-ROCKER
 108357-18-000
 ACTUATOR-SWITCH,
 SLIDE ROOM
 108356-31-CHT
 PLATE-SWITCH
 144363-02-CHT
 SCREW
 G11-08-08U (2)

LABEL-WARNING, SLIDEOUT
 116549-02-000

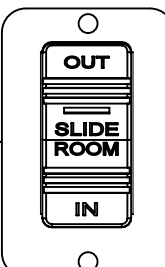

LABEL-SLIDEOUT, PASS, FRONT
 163992-04-CHT

CRUSH HAZARD: Keep people and objects clear of the inside and outside of the slideout room when operating. Failure to comply could result in death or serious injury.

SWITCH-ROCKER
 108357-18-000
 ACTUATOR-SWITCH,
 SLIDE ROOM
 108356-31-CHT
 PLATE-SWITCH
 144363-02-CHT
 SCREW
 G11-08-08U (2)

LABEL-SLIDEOUT, DRIVER, FRONT
 163992-01-CHT

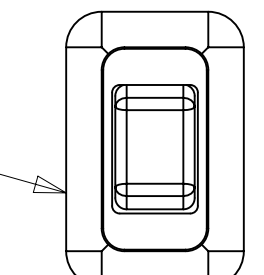

SWITCH
 DETAIL CF

HOLDING TANK HEATER
 TURN OFF When Not In Use
 SEE OPERATORS MANUAL

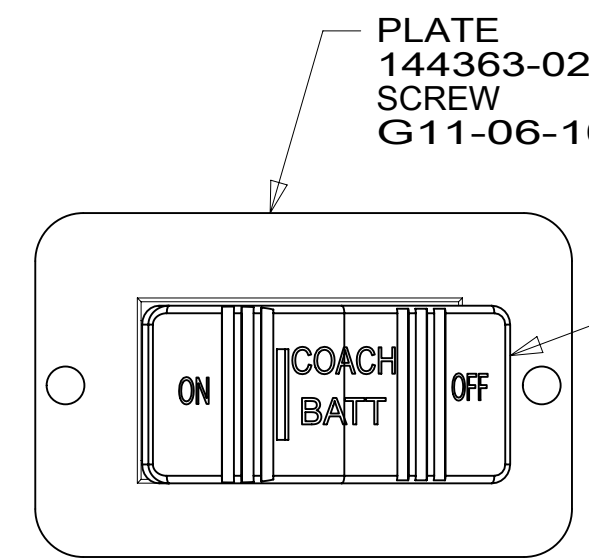

DETAIL CG

PLATE
 144363-02-CHT
 SCREW
 G11-06-10U (4)

SWITCH-BATTERY
 108357-18-000
 ACTUATOR
 108356-19-CHT
 CIRCUITS LH, LJ,
 LG, JP, JA
 WIRE ASM-THERMISTOR
 186796-01-000

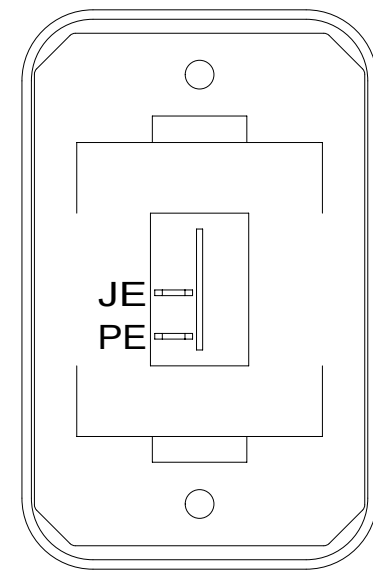

DETAIL CC

SWITCH-ROCKER
 135740-01-CHT
 SWITCH-BASE
 135741-01-CHT
 SWITCH-BEZEL
 135742-01-CHT
 SCREW
 G11-08-08U (2)

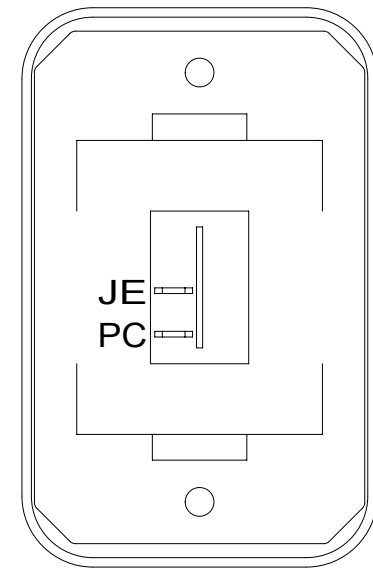

DETAIL CK

SWITCH-ROCKER
 135740-01-CHT
 SWITCH-BASE
 135741-01-CHT
 SWITCH-BEZEL
 135742-01-CHT
 SCREW
 G11-08-08U (2)

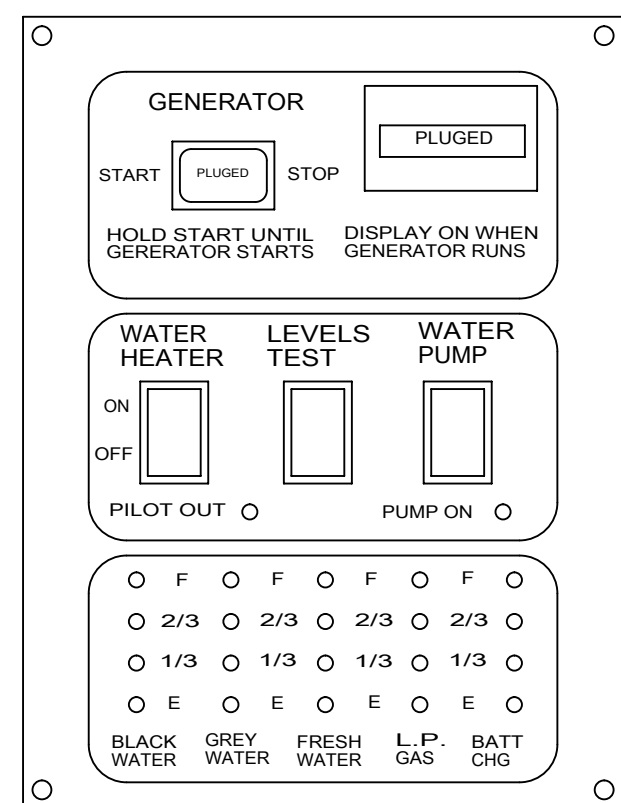

DETAIL CE

PANEL-MONITOR
 134940-02-CHT
 134940-06-CHT

640 644 38E

THERMOSTAT-
 A/C AND HEAT
 135618-06-CHT
 SCREW
 G13-07-12U (2)

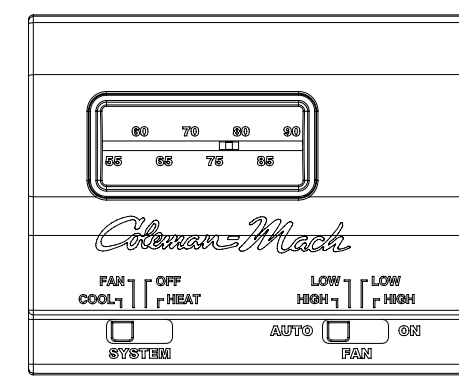

- 640 RENTAL - GAH WITHOUT
- 38E CONVENIENCE PACKAGE
- 52F AWNING-PATIO
- 52N AWNING - PATIO, ELECTRIC
- 644 GREAT ALASKAN RENTAL PACKAGE
- 23R DRAINAGE SYSTEM/HEAT-PREWIRE
- 23T DRAINAGE SYSTEM-HEATED
- 265 CODES/STANDARDS-CSA/CMVSS
- 1B1 CODES/STANDARDS USA

FOR ELECTRICAL TORQUE SPECIFICATIONS SEE DWG NO. 128783-01-000

FOR ELECTRICAL CALLOUTS SEE DWG NO. 121339-01-000

1B1 265	DESCRIPTION:
	WIRING INSTL-BODY, 12V
SHEET: 3 OF 5	ITEM/PART NO: 000004680 / 31216301000
	REV

644 SPEAKER-ROUND,CEILING
171547-01-CHT (2)
SCREW
G11-08-12U (8)

PRLED-4
9

PSSLED-2

1 193 ANTENNA-TV ROOF
000039180 / 318992-01-CHT
SCREW
G67-10-12U (6)
1 1J8 ANTENNA-TV,OMNIDIRECTIONAL
000045333 / 320902-01-CHT
SCREW
G67-10-12U (6)

644 ANTENNA-RADIO
090944-02-000
EXTENDER-SHAFT
109889-04-000
BRACKET-
ANTENNA GROUND
147741-01-CHT

ANTENNA-RADIO 1D3 2

- 1D3 ENTERTAIN CENTR/EXT TV-DVD
- 644 GREAT ALASKAN RENTAL PACKAGE
- 1J8 TV ANTENNA-OMNI DIRECTIONAL
- 193 TV ANTENNA-AMPLIFIED SYSTEM
- 265 CODES/STANDARDS-CSA/CMVSS
- 1B1 CODES/STANDARDS USA

2 SEE ENTERTAINMENT CTR COMPL-TV FOR
ADDITIONAL INFORMATION.
1 SEE ANTENNA INSTALLATION MANUAL FOR
CORRECT INSTALLATION PROCEDURE.

FOR ELECTRICAL
TORQUE
SPECIFICATIONS
SEE DWG NO.
128783-01-000

FOR
ELECTRICAL
CALLOUTS
SEE DWG NO.
121339-01-000

DESCRIPTION:		1B1 265	
WIRING INSTL-BODY, 12V			
SHEET:	ITEM/PART NO.:	REV	
4 OF 5	000004680 / 31216301000		

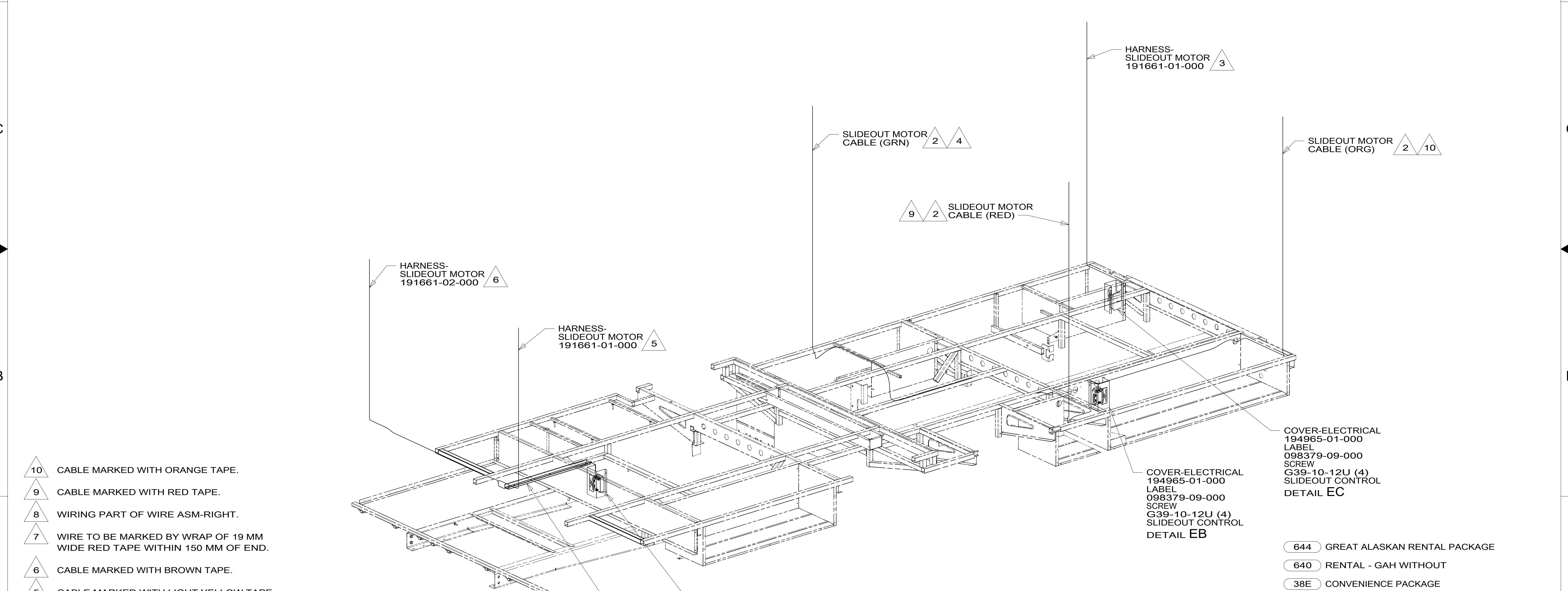
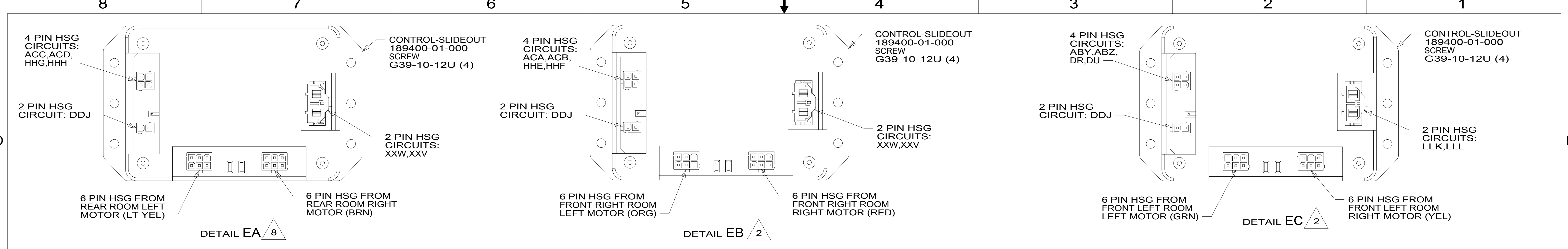

- 10 CABLE MARKED WITH ORANGE TAPE.
- 9 CABLE MARKED WITH RED TAPE.
- 8 WIRING PART OF WIRE ASM-RIGHT.
- 7 WIRE TO BE MARKED BY WRAP OF 19 MM WIDE RED TAPE WITHIN 150 MM OF END.
- 6 CABLE MARKED WITH BROWN TAPE.
- 5 CABLE MARKED WITH LIGHT YELLOW TAPE.
- 4 CABLE MARKED WITH GREEN TAPE.
- 3 CABLE MARKED WITH YELLOW TAPE.
- 2 WIRING PART OF WIRE ASM-CHASSIS.

NOTES:
 1. ROUTE TANK SENSOR WIRES SO THEY DO NOT PASS OVER SENSORS. USE WIRE TIE MOUNT 155366-01-000 AS NEEDED. TANK SURFACE MUST BE CLEANED USING ISOPROPYL ALCOHOL AND PRIME WITH PRIMER 94.

COVER-ELECTRICAL
 194965-01-000
 LABEL
 098379-09-000
 SCREW
 G39-10-12U (4)
 SLIDEOUT CONTROL
 DETAIL EA

COVER-PIPE
 152078-01-CHT

COVER-ELECTRICAL
 194965-01-000
 LABEL
 098379-09-000
 SCREW
 G39-10-12U (4)
 SLIDEOUT CONTROL
 DETAIL EB

COVER-ELECTRICAL
 194965-01-000
 LABEL
 098379-09-000
 SCREW
 G39-10-12U (4)
 SLIDEOUT CONTROL
 DETAIL EC

- 644 GREAT ALASKAN RENTAL PACKAGE
- 640 RENTAL - GAH WITHOUT
- 38E CONVENIENCE PACKAGE
- 23T DRAINAGE SYSTEM-HEATED
- 23R DRAINAGE SYSTEM/HEAT-PREWIRE
- 265 CODES/STANDARDS-CSA/CMVSS
- 1B1 CODES/STANDARDS USA

FOR ELECTRICAL TORQUE SPECIFICATIONS SEE DWG NO. 128783-01-000

FOR ELECTRICAL CALLOUTS SEE DWG NO. 121339-01-000

DESCRIPTION: WIRING INSTL-BODY, 12V	
SHEET: 5 OF 5	ITEM/PART NO.: 000004680 / 31216301000
REV 16-Mar-2017	