

REV	ZONE	REVISION RECORD	DATE	DFTR-ORIG
A	---	INITIAL RELEASE	11/04/15	3660
B	---	SHT2 CHG W.H. LENGTHS	8-5-16	1600-2314

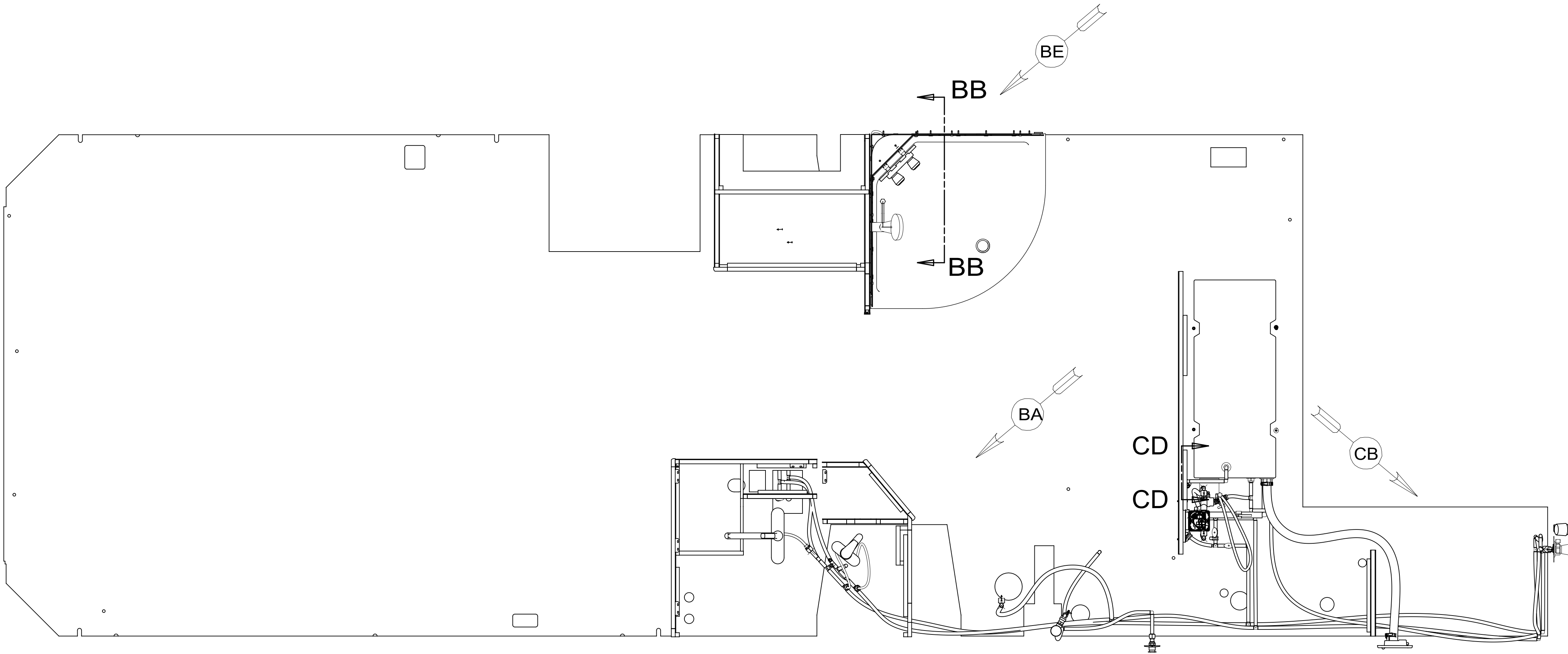

- 23V HOLDING TANK FLUSH SYSTEM
- 29B WATER PURIFIER
- 501 WATER PURIFIER WITHOUT
- 64R EXTERIOR WASH STATION
- IJ4 EXT WASH STATION-WITHOUT
- 53B WTR HTR-6 GAL ELECTRIC/LP GAS
- 1BT WATER HEATER, TANKLESS
- 54E WATER SYS WINTERIZATION PKG

- NOTES:
1. PLASTIC FITTINGS TO BE SEALED WITH SEALANT 084456-01-000.
 2. TUBING TO BE INSTALLED WITH SUFFICIENT SLOPE TO PROVIDE DRAINAGE TO NEAREST VALVE.
 3. ALL TUBING TO BE SECURED AT 1200 INTERVALS MAXIMUM WITH CLAMP 010495-01-000 AND SCREW 000G67-10-12U OR EQUIVALENT.
 4. ADD TEFLON TAPE 010405-02-000.
 5. ADD PIPE WRAP (LADDER SCRAP 110157-02-000) INSULATION.
 6. LABEL HOT AND COLD SUPPLY TUBES AND TAPE FITTING TO TUBE BEFORE CABINET SET TO PREVENT MOVEMENT.
 7. ALL CRIMP FITTINGS TO 5/8" FLEX TUBING REQUIRE 5/8" CLAMP 140171-04-000.
 8. ALL CRIMP FITTINGS TO 1/2" PEX TUBING REQUIRE 1/2" CLAMP 140171-03-000.
 9. ALL CRIMP FITTINGS TO 3/4" PEX TUBING REQUIRE 3/4" CLAMP 140171-05-000.
 10. SEAL VENT HOLE IN DOOR W/SILICONE SEALANT.

X-X

FOR
WATER
CALLOUTS
SEE DWG NO.
000209446 /
303369-01-000

WINNEBAGO[®]

COPYRIGHT 2016 WINNEBAGO INDUSTRIES, INC.

DSNR:		ALL DIMENSIONS ARE IN MILLIMETERS	
DFTR:		MATERIAL:	
UNSPECIFIED TOLERANCES:			
WHOLE DIM (X)	3		
ONE-PLACE (X.X)	1.5		
TWO-PLACE (X.XX)	0.50		
ANGLE	1°		
REFER TO ES0018 FOR FASTENER TIGHTENING GUIDELINES	WEIGHT: (LBS)	FIRST USED: (REF)	
			16 730J
DESCRIPTION: WATER SYSTEM INSTL			
SHEET:	ITEM/PART NO.:	REV	
1 OF 3	000210192 / 30150401000		

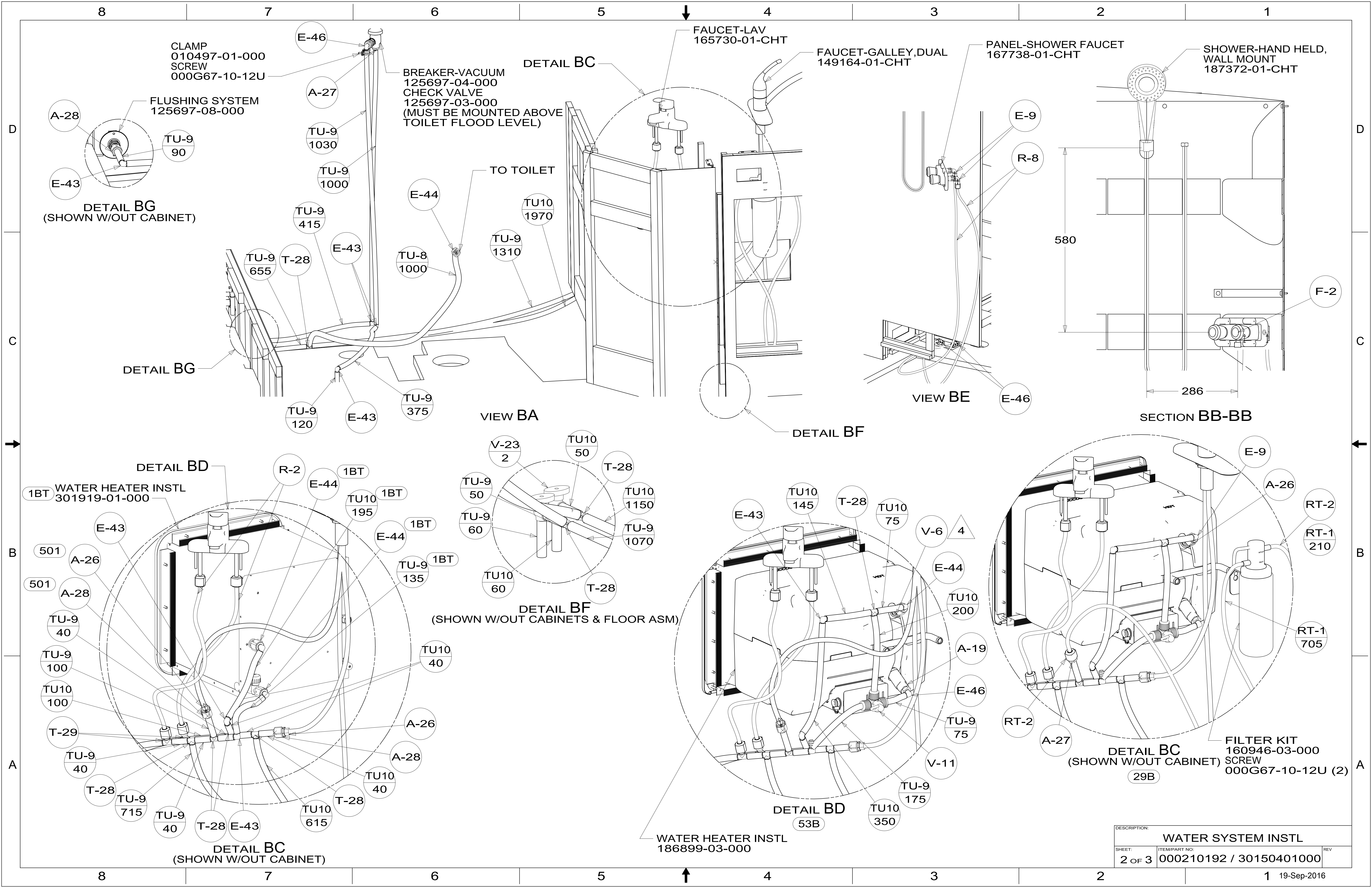

CLAMP
010497-01-000
SCREW
000G67-10-12U

FLUSHING SYSTEM
125697-08-000

BREAKER-VACUUM
125697-04-000
CHECK VALVE
125697-03-000
(MUST BE MOUNTED ABOVE
TOILET FLOOD LEVEL)

FAUCET-LAV
165730-01-CHT

FAUCET-GALLEY, DUAL
149164-01-CHT

PANEL-SHOWER FAUCET
167738-01-CHT

SHOWER-HAND HELD,
WALL MOUNT
187372-01-CHT

DETAIL BG
(SHOWN W/OUT CABINET)

TO TOILET

VIEW BE

SECTION BB-BB

VIEW BA

DETAIL BF

DETAIL BD

WATER HEATER INSTL
301919-01-000

DETAIL BF
(SHOWN W/OUT CABINETS & FLOOR ASM)

DETAIL BD
53B

WATER HEATER INSTL
186899-03-000

DETAIL BC
(SHOWN W/OUT CABINET)
29B

FILTER KIT
160946-03-000
SCREW
000G67-10-12U (2)

DETAIL BC
(SHOWN W/OUT CABINET)

DESCRIPTION: WATER SYSTEM INSTL		
SHEET: 2 OF 3	ITEM/PART NO: 000210192 / 30150401000	REV

