

8	7	6	5	4	3	2	1
DRAWING NO.	FEATURE						
300840-01	-----						
300840-11	1B1	12D					
300840-15	265	12D					

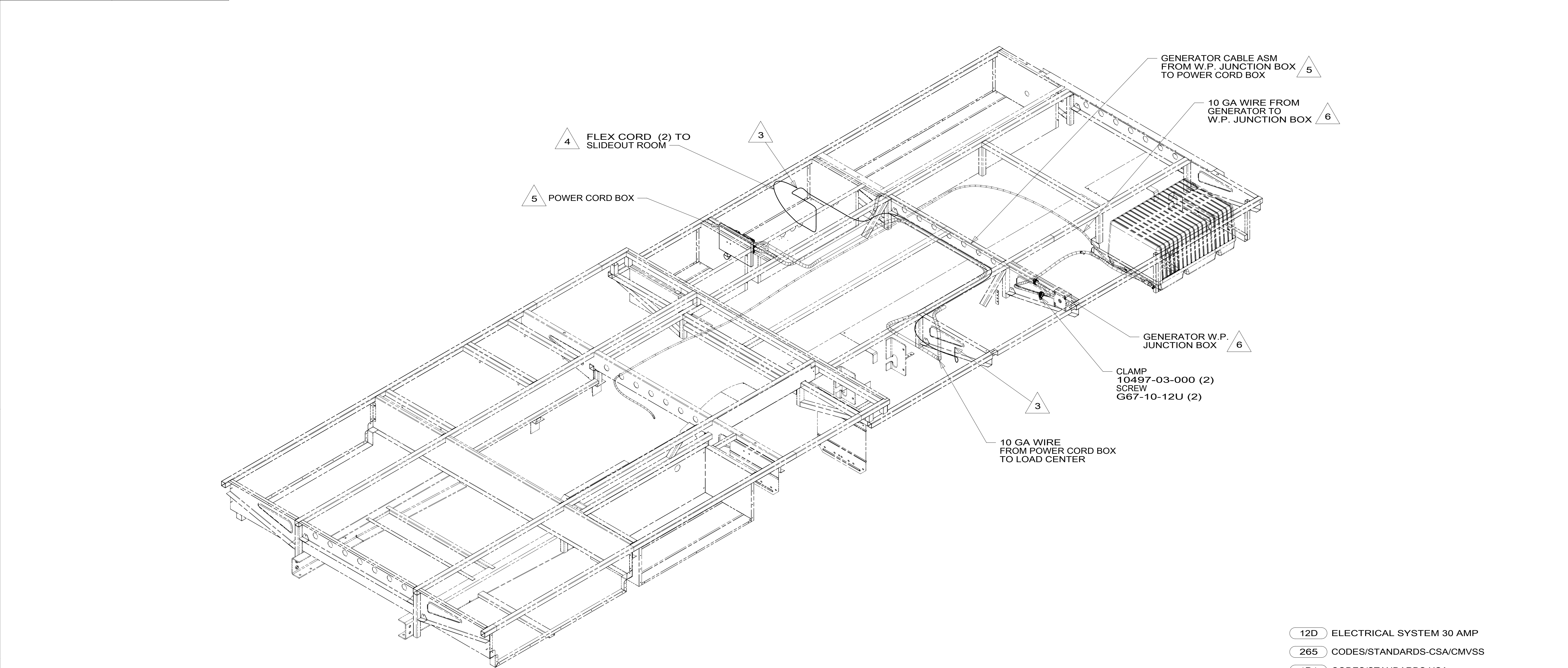

**NOTES:**

1. AT MINIMUM ALL WIRES TO BE SUPPORTED AND SECURED PER CODE REQUIREMENTS. USE CLAMP 10495 OR 10497 OR WIRE TIE 8343 OR 108046 AND SCREW G67-XX-XXX OR G56-XX-XXX AS APPROPRIATE FOR INSTALLATION.

2. ALL 110V WIRE TO BE CLAMPED WITH CLAMP 10497-05-000 WITHIN 200MM OF OUTLET BOXES, USE SCREW G67-10-12B.

6 SEE GENERATOR INSTL FOR ADDITIONAL INFORMATION.

5 SEE LOAD CENTER/ATS ASM FOR ADDITIONAL INFORMATION.

4 CORD IS PART OF WIRE ASM-CHASSIS.

3 ROUTE WIRE THRU FLOOR.

FOR ELECTRICAL TORQUE SPECIFICATIONS SEE DWG NO. 128783-01-000

FOR ELECTRICAL CALLOUTS SEE DWG NO. 121339-01-000

12D ELECTRICAL SYSTEM 30 AMP

265 CODES/STANDARDS-CSA/CMVSS

1B1 CODES/STANDARDS USA

1B1 265

**WINNEBAGO**

COPYRIGHT 2016 WINNEBAGO INDUSTRIES, INC.

DSNR:		ALL DIMENSIONS ARE IN MILLIMETERS	
DFTR:			
UNSPECIFIED TOLERANCES:			
WHOLE DIM (X)	±	3	
ONE-PLACE (X.X)	±	1.5	
TWO-PLACE (X.XX)	±	0.50	
ANGLE	±	1°	
REFER TO ES0018 FOR FASTENER TIGHTENING GUIDELINES		WEIGHT: (LBS)	FIRST USED:
DESCRIPTION:	<b>WIRING INSTL-BODY, 110V</b>		
SHEET:	ITEM/PART NO:	REF:	
1 OF 4	000177308 / 30084001000	1 20-Sep-2016	

