



**DANGER**

**Danger of electrical shock, burns or death.** Always remove all power sources before attempting any repair, service or diagnostic work. Power can be present from shore power, generator, inverter or battery. All power sources must be disabled and secured before performing any service.



**CAUTION**

If you lack the skills, tools or equipment to perform diagnostic or repair work leave such work to an authorized Winnebago Industries dealer or other qualified shop.

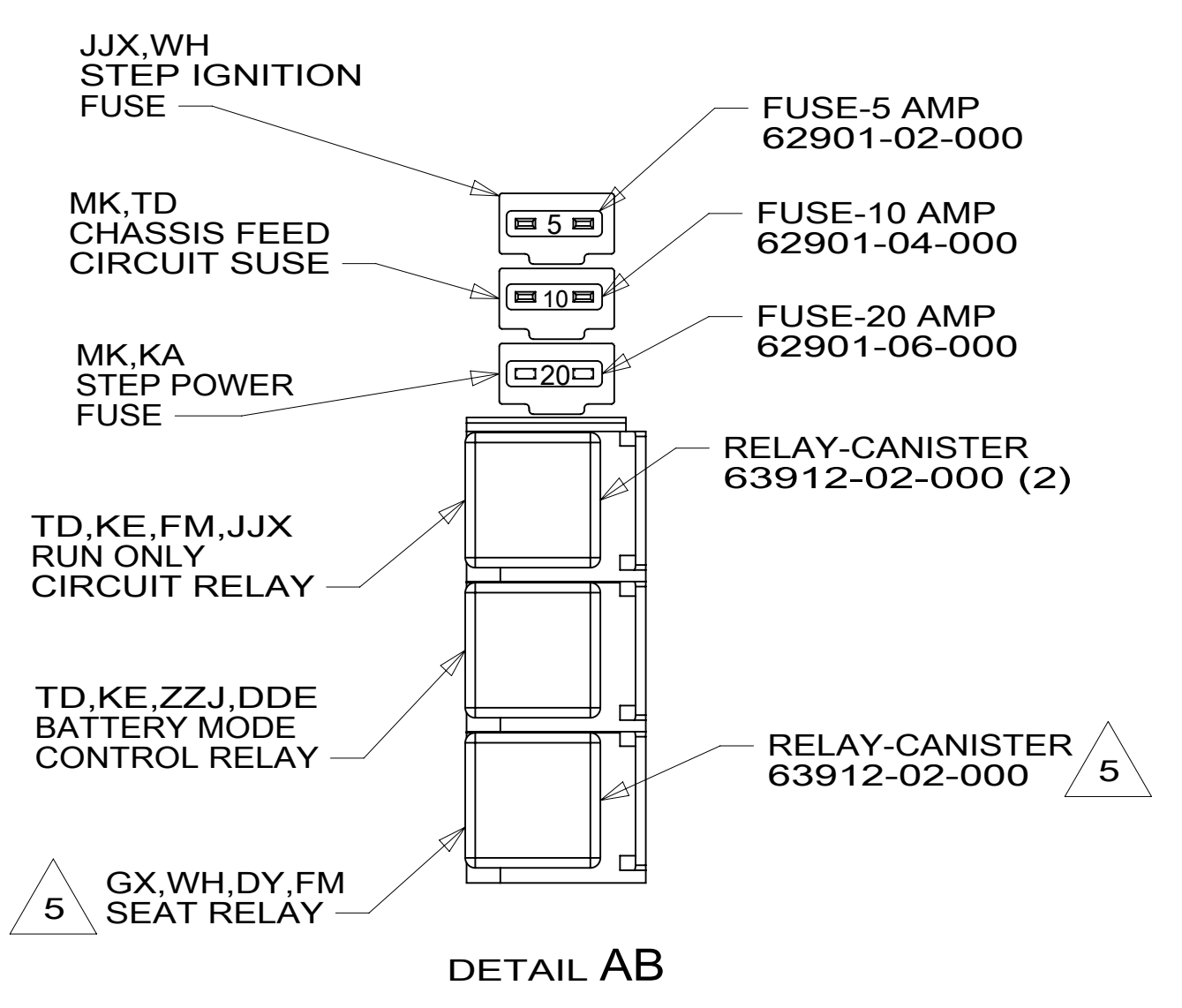
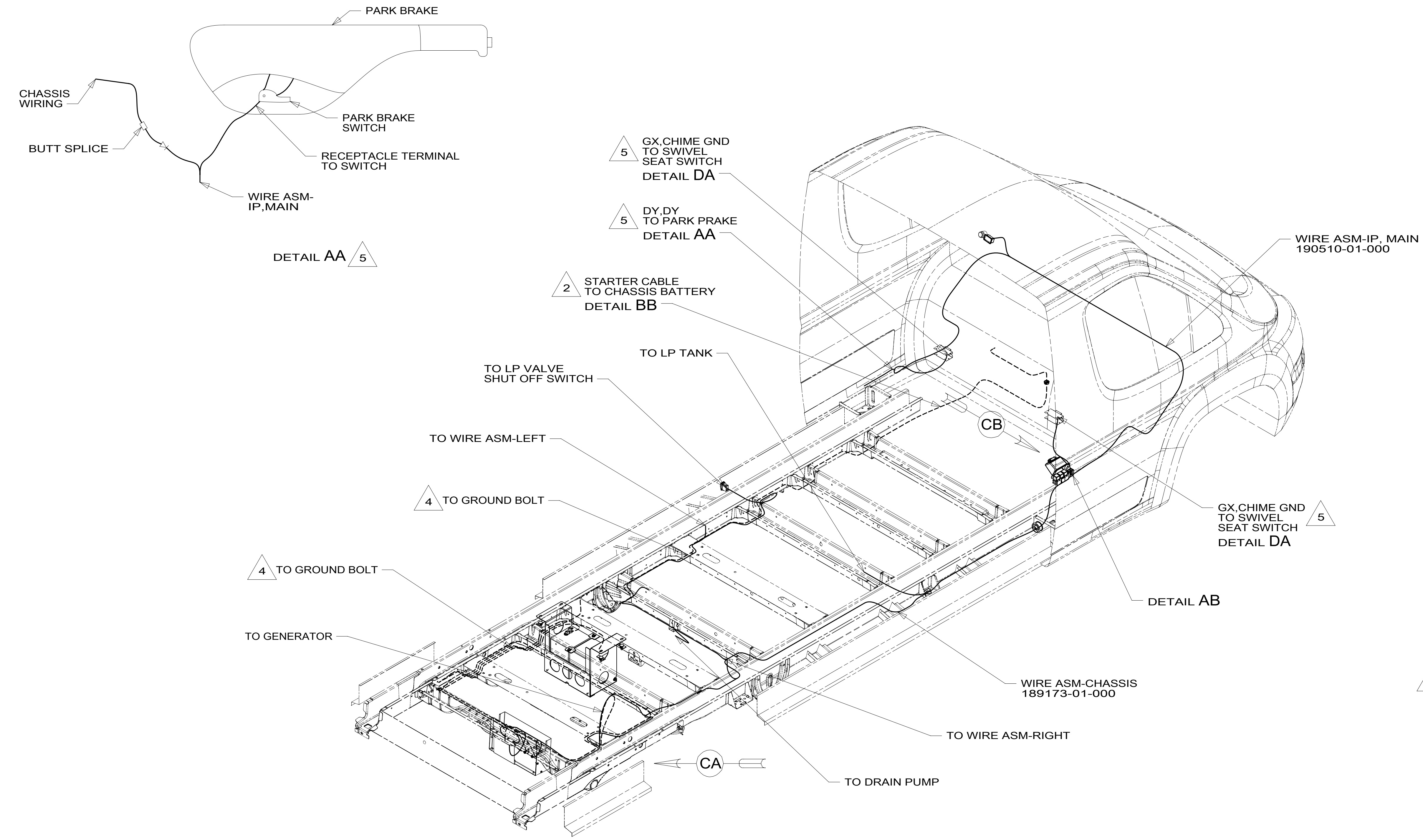

- 1MS RAM-9,350# GVWR, GAS\_VAN
- 265 CODES/STANDARDS-CSA/CMVSS
- 1B1 CODES/STANDARDS USA

**WINNEBAGO** COPYRIGHT 2014 WINNEBAGO INDUSTRIES, INC.

DFTR	ORIG. DATE
CHKR	ALL DIMENSIONS ARE IN MILLIMETERS
P.E.	
M.E.	FIRST USED
DSNR	<b>15 259G</b>

UNSPECIFIED TOLERANCES ARE:  
 WHOLE DIM (X) : 3  
 ONE-PLACE (X.X) : 1.5  
 TWO-PLACE (X.XX) : 0.50  
 ANGLE : 1°

THIRD ANGLE PROJECTION

DO NOT SCALE DRAWING REFER TO ES0018 FOR FASTENER TIGHTENING GUIDELINES

TITLE: **WIRING INSTL-CHASSIS**

SHEET **1** OF **5** PART NO **189041** REV

REF: **1** 12-Mar-2015

- NOTES:
- 5 NOT USED WITH CHASSIS SUPPLIED IGNITION INTERLOCKING SWIVEL SEAT.
  - 4 REMOVE PAINT AND UNDER COATING FROM GROUND BOLT AND NUT TO INSURE PROPER CONTACT.
  - 3 SEE WIRING INSTL-BODY, 12V FOR ADDITIONAL INFORMATION.
  - 2 SEE BATTERY INSTL. FOR ADDITIONAL INFORMATION.
  - 1. SECURE CONDUIT 41953, TAB AS REQUIRED, OVER ALL WIRES IN CONTACT WITH SHARP EDGES.

FOR ELECTRICAL TORQUE SPECIFICATIONS SEE DWG NO. 128783-01-000

X-X FOR ELECTRICAL CALLOUTS SEE DWG NO. 121339-01-000

\*189041\*

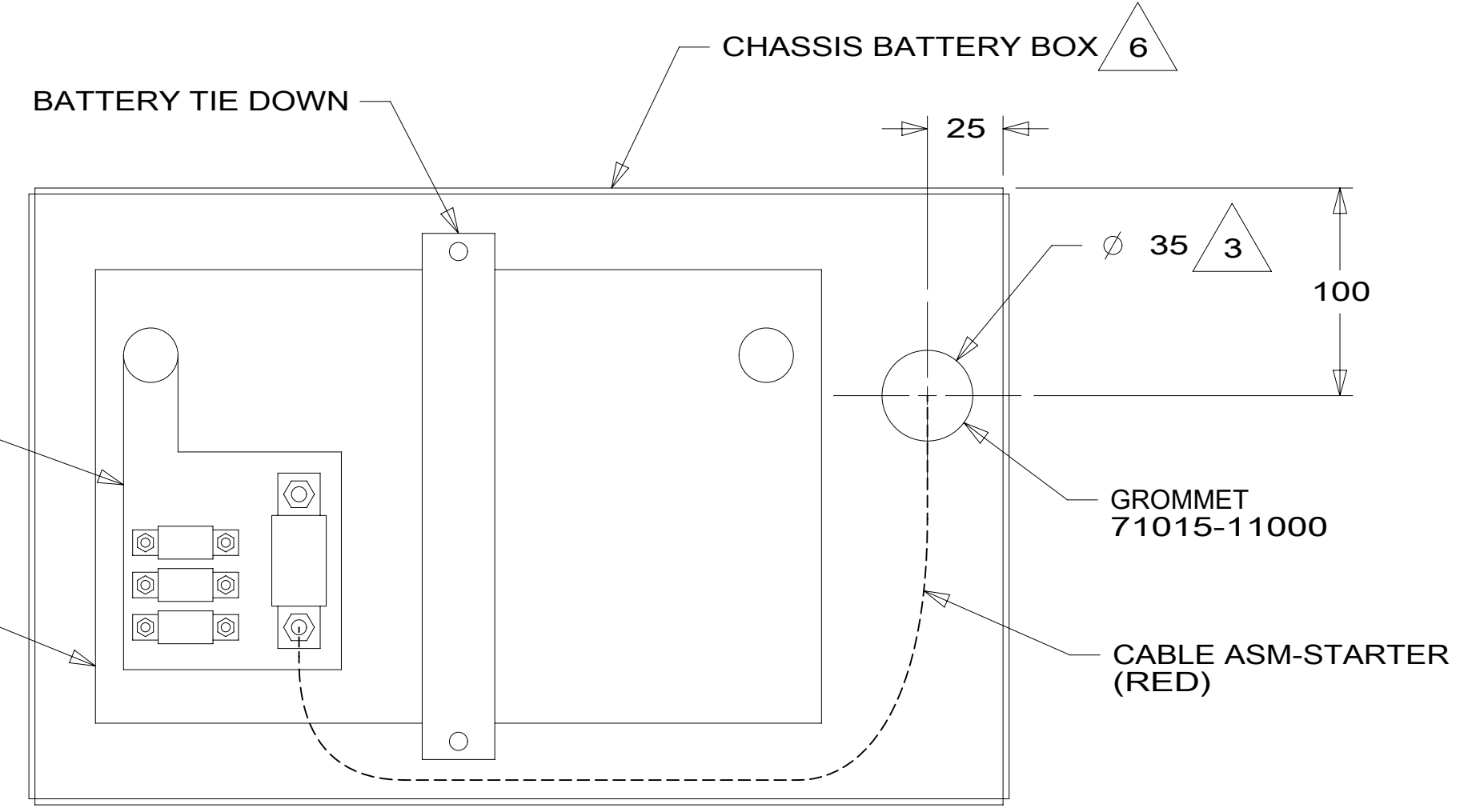
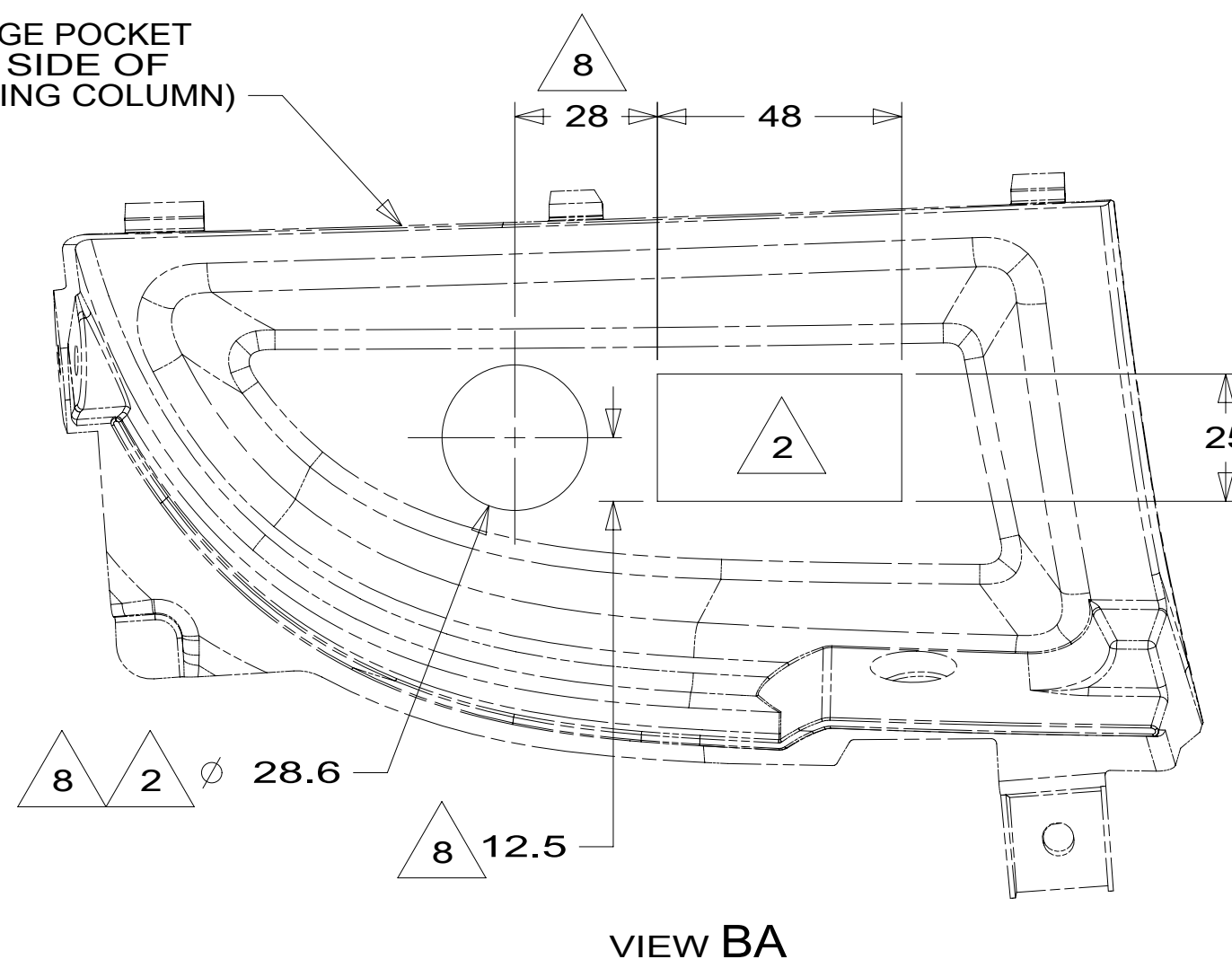
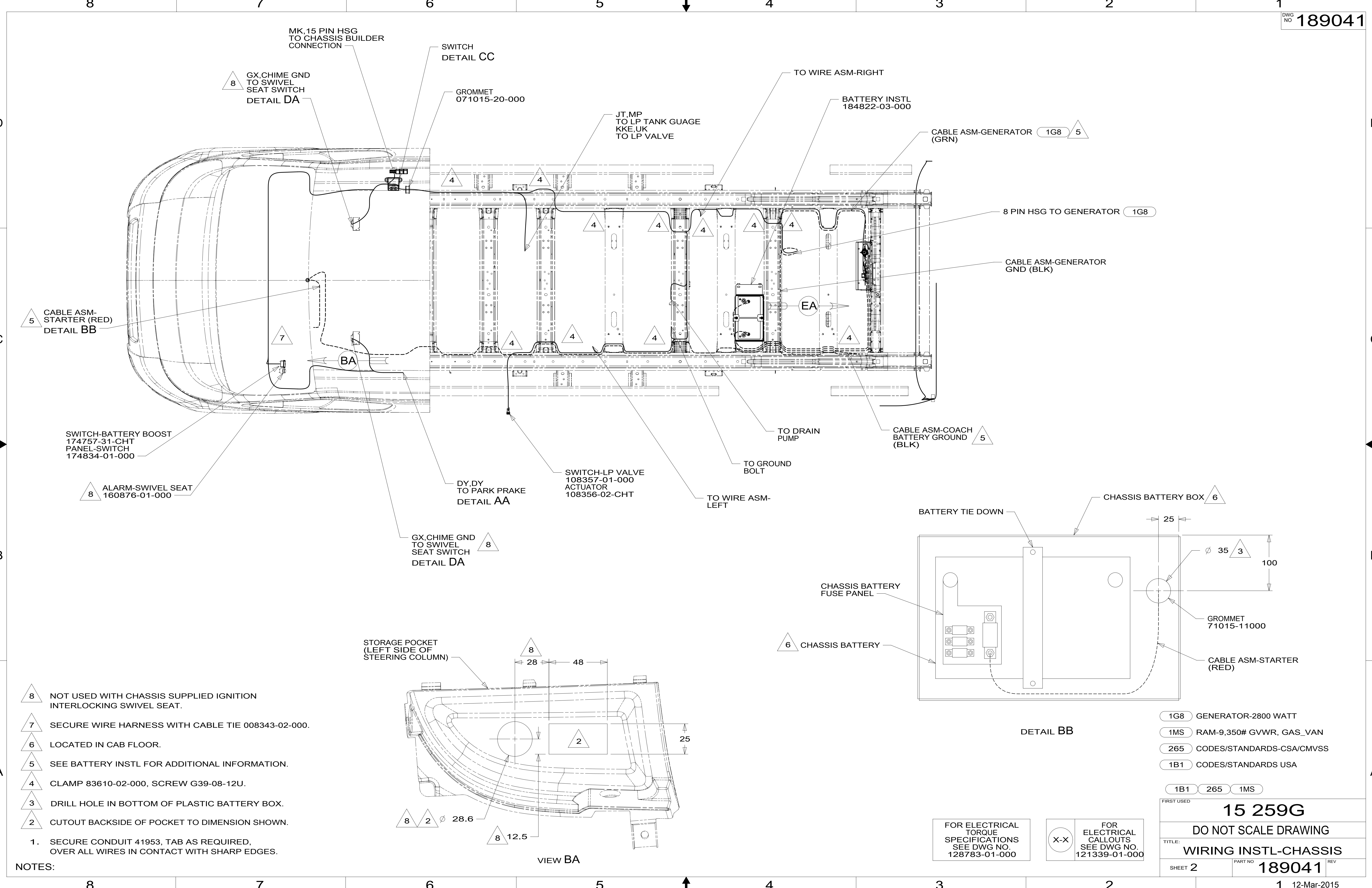

- 8 NOT USED WITH CHASSIS SUPPLIED IGNITION INTERLOCKING SWIVEL SEAT.
  - 7 SECURE WIRE HARNESS WITH CABLE TIE 008343-02-000.
  - 6 LOCATED IN CAB FLOOR.
  - 5 SEE BATTERY INSTL FOR ADDITIONAL INFORMATION.
  - 4 CLAMP 83610-02-000, SCREW G39-08-12U.
  - 3 DRILL HOLE IN BOTTOM OF PLASTIC BATTERY BOX.
  - 2 CUTOUT BACKSIDE OF POCKET TO DIMENSION SHOWN.
1. SECURE CONDUIT 41953, TAB AS REQUIRED, OVER ALL WIRES IN CONTACT WITH SHARP EDGES.

- 1G8 GENERATOR-2800 WATT
- 1MS RAM-9,350# GVWR, GAS\_VAN
- 265 CODES/STANDARDS-CSA/CMVSS
- 1B1 CODES/STANDARDS USA

FIRST USED		<b>15 259G</b>	
<b>DO NOT SCALE DRAWING</b>			
<b>TITLE: WIRING INSTL-CHASSIS</b>			
SHEET 2	PART NO	<b>189041</b>	
		REV 12-Mar-2015	

FOR ELECTRICAL TORQUE SPECIFICATIONS SEE DWG NO. 128783-01-000

FOR ELECTRICAL CALLOUTS SEE DWG NO. 121339-01-000

\*189041\*

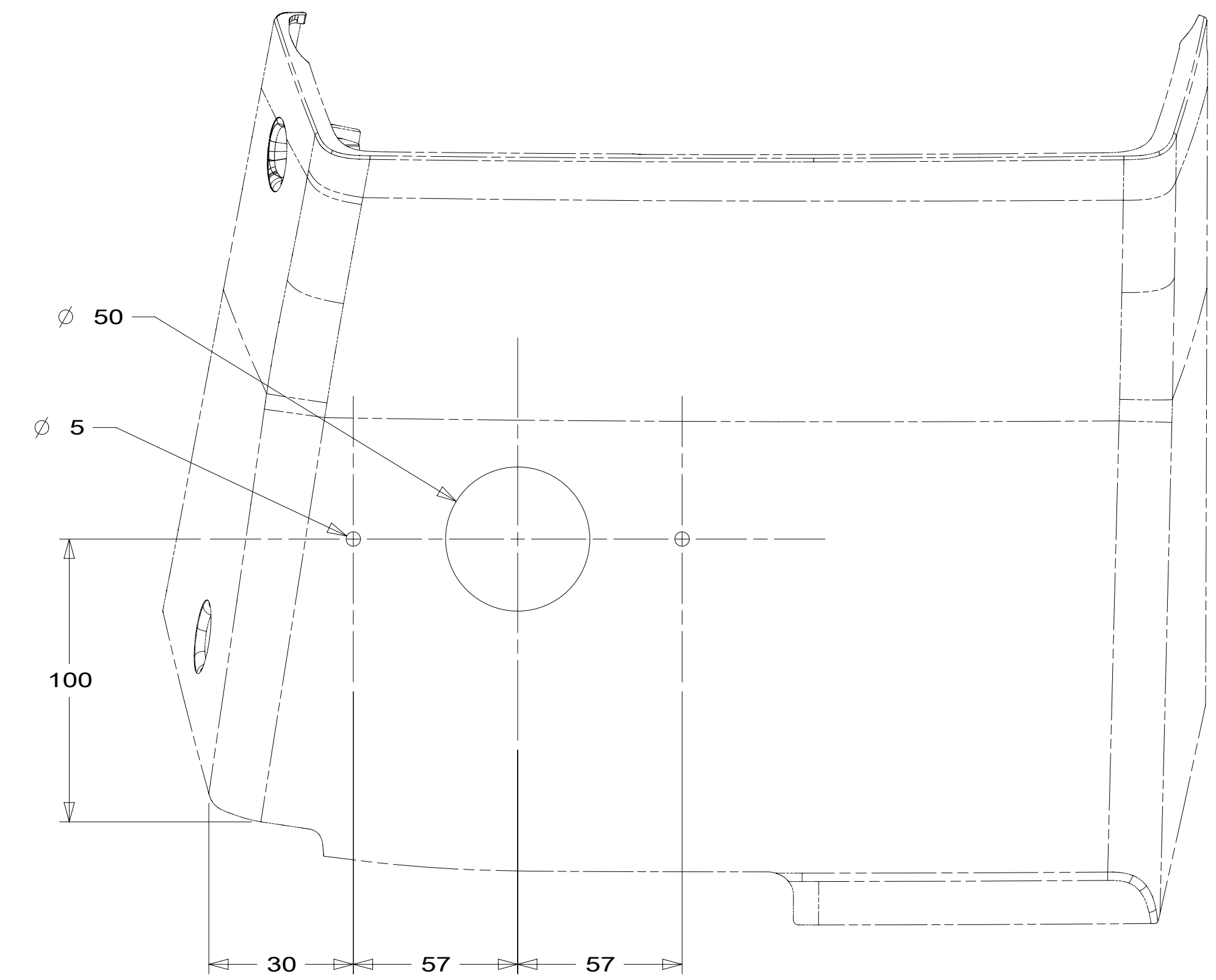
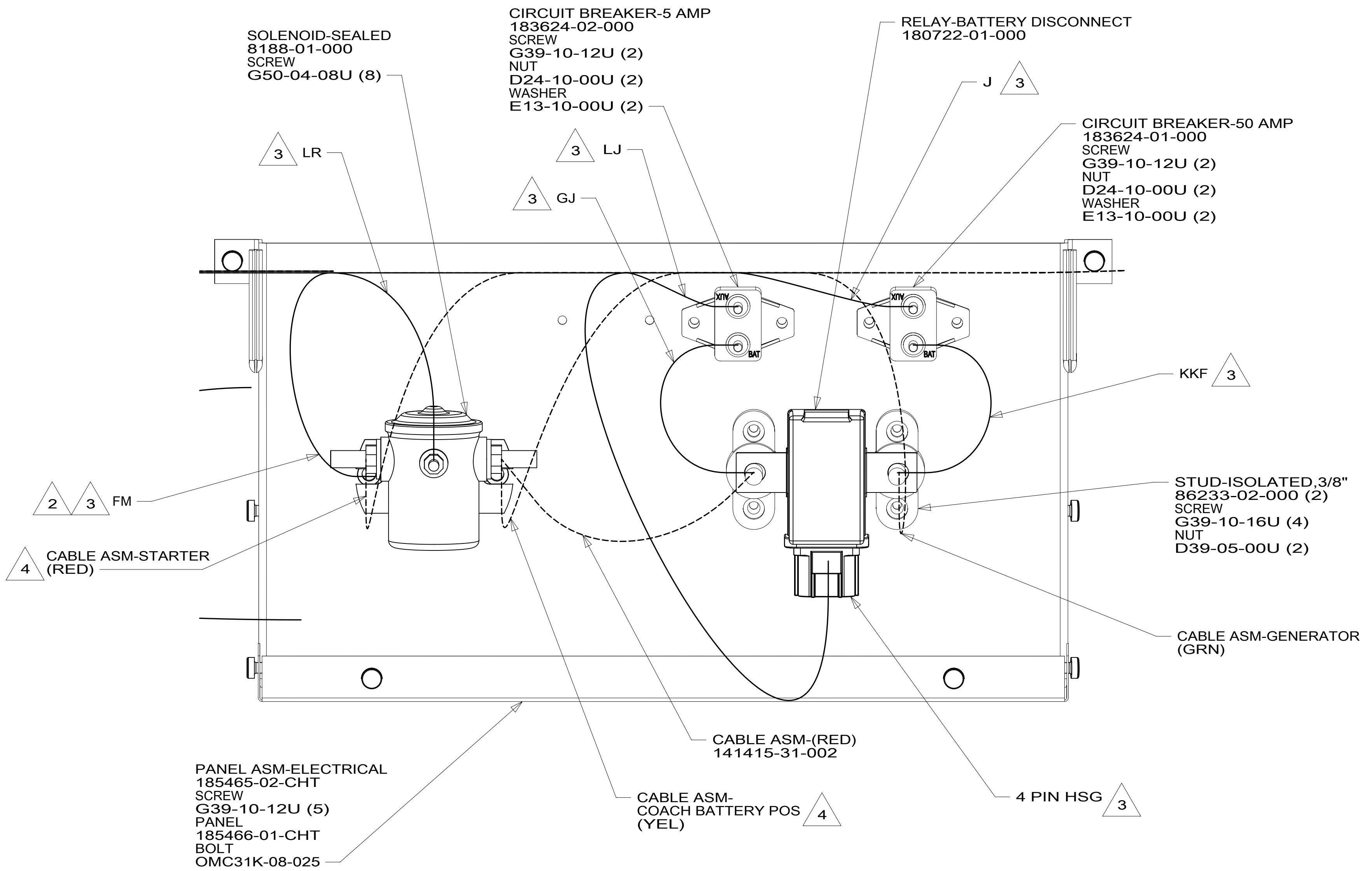

VIEW CD

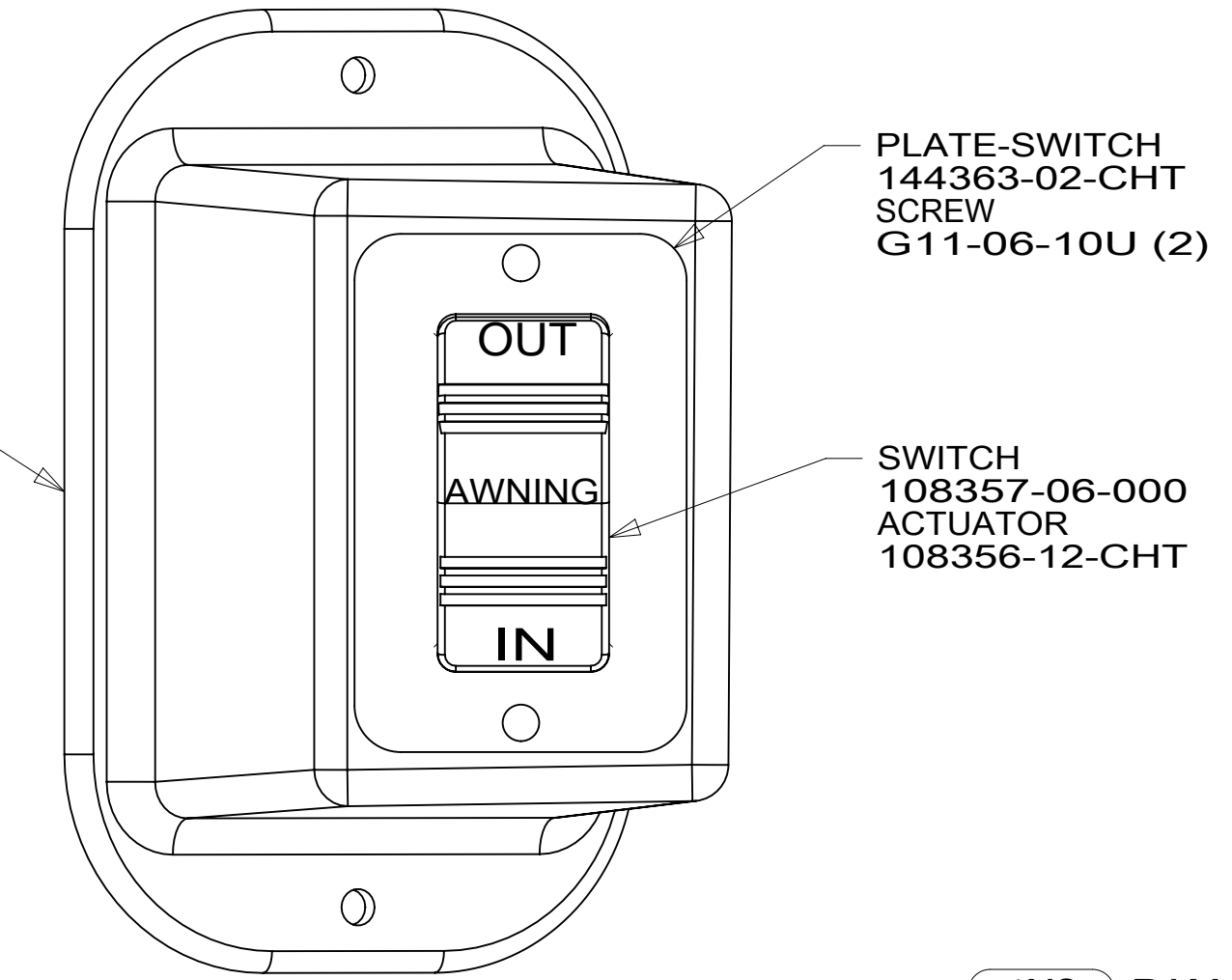
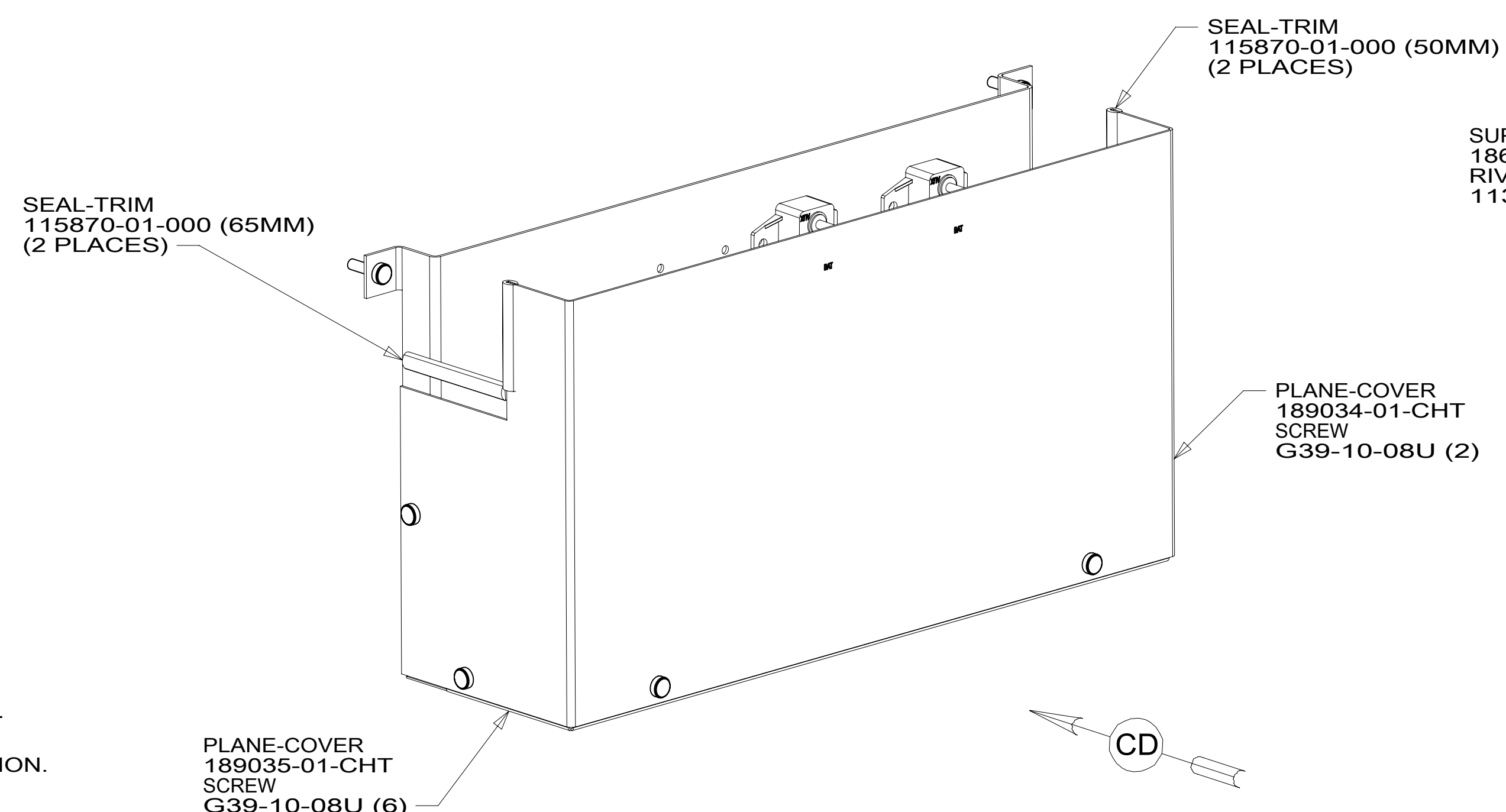

- 4 SEE BATTERY INSTL FOR ADDITIONAL INFORMATION.
- 3 SEE WIRE ASM-CHASSIS FOR ADDITIONAL INFORMATION.
- 2 SECURE WITH SOLENOID MOUNTING SCREW.

NOTES:  
1. SECURE CONDUIT 41953, TAB AS REQUIRED, OVER ALL WIRES IN CONTACT WITH SHARP EDGES.

FOR ELECTRICAL TORQUE SPECIFICATIONS SEE DWG NO. 128783-01-000

FOR ELECTRICAL CALLOUTS SEE DWG NO. 121339-01-000

- 1MS RAM-9,350# GVWR, GAS\_VAN
- 265 CODES/STANDARDS-CSA/CMVSS
- 1B1 CODES/STANDARDS USA

FIRST USED	
<b>15 259G</b>	
DO NOT SCALE DRAWING	
TITLE: <b>WIRING INSTL-CHASSIS</b>	
SHEET 3	PART NO <b>189041</b> REV
12-Mar-2015	

\*189041\*

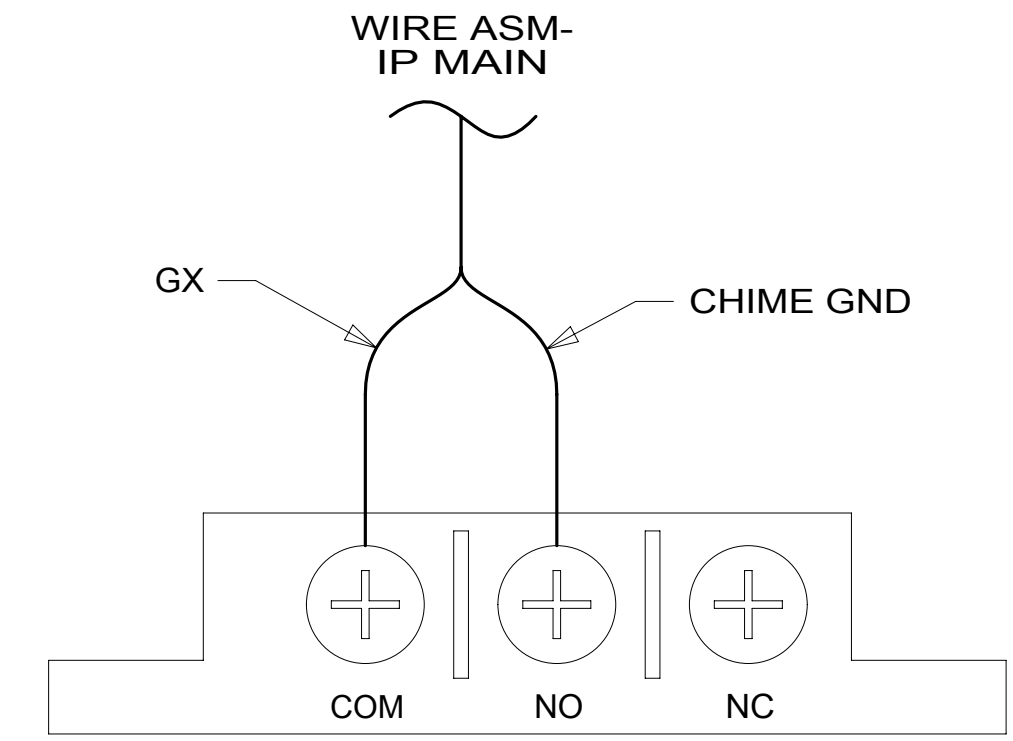

DETAIL DB 3

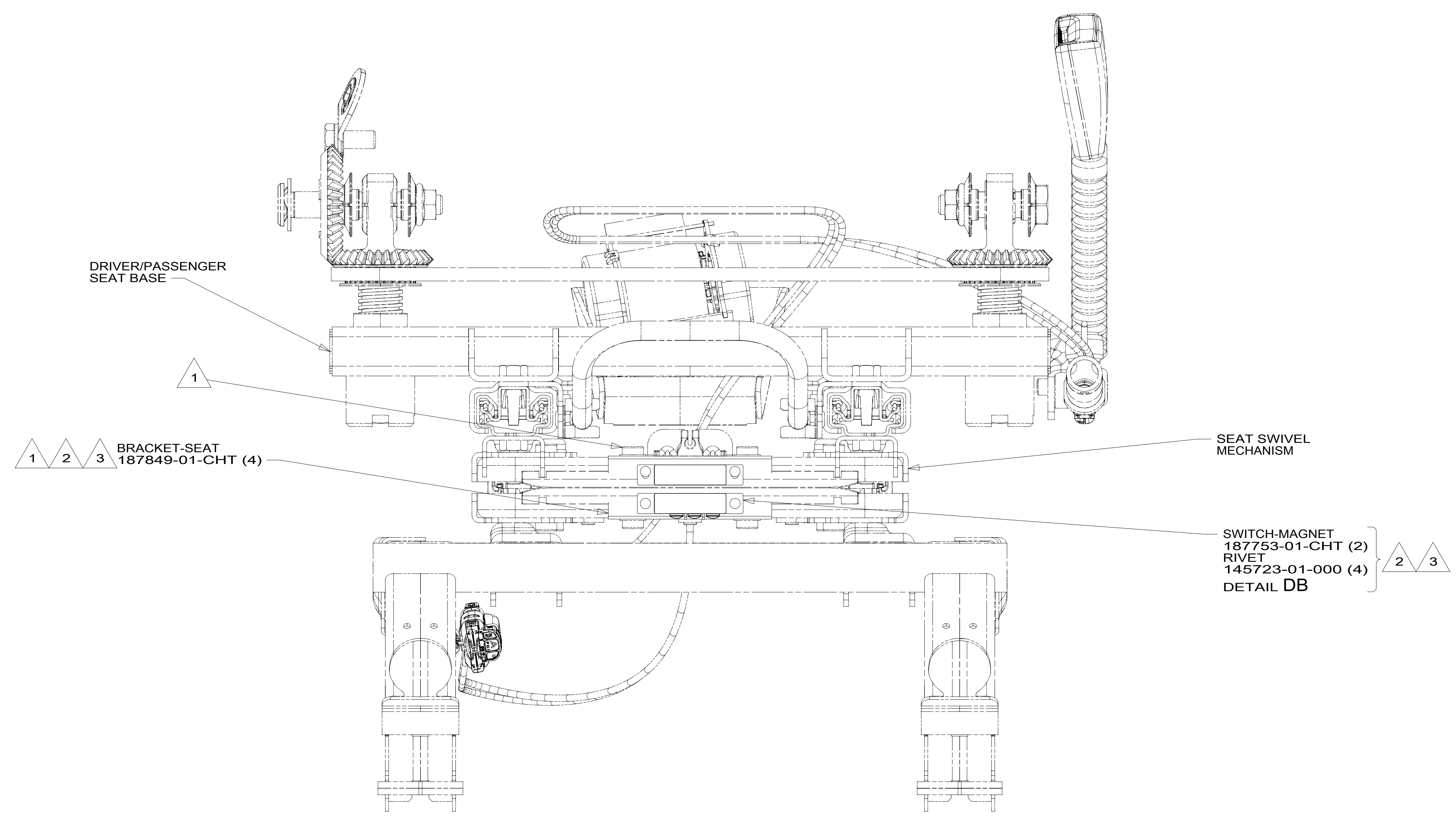

DETAIL DA 3

- NOTES:
- 3 NOT USED WITH CHASSIS SUPPLIED IGNITION INTERLOCKING SWIVEL SEAT.
  - 2 INSTALL ON BOTH THE DRIVER AND PASSENGER SEATS.
  - 1 MOUNT BRACKETS TO SEAT SWIVEL MECHANISM BY LOOSENING BOLTS ON BOTH TOP AND BOTTOM OF MECHANISM.

FOR ELECTRICAL TORQUE SPECIFICATIONS SEE DWG NO. 128783-01-000

FOR ELECTRICAL CALLOUTS SEE DWG NO. 121339-01-000

- 1MS RAM-9,350# GVWR, GAS\_VAN
- 265 CODES/STANDARDS-CSA/CMVSS
- 1B1 CODES/STANDARDS USA

FIRST USED	
<b>15 259G</b>	
<b>DO NOT SCALE DRAWING</b>	
<b>TITLE: WIRING INSTL-CHASSIS</b>	
SHEET 4	PART NO <b>189041</b> REV
1 12-Mar-2015	

\*189041\*



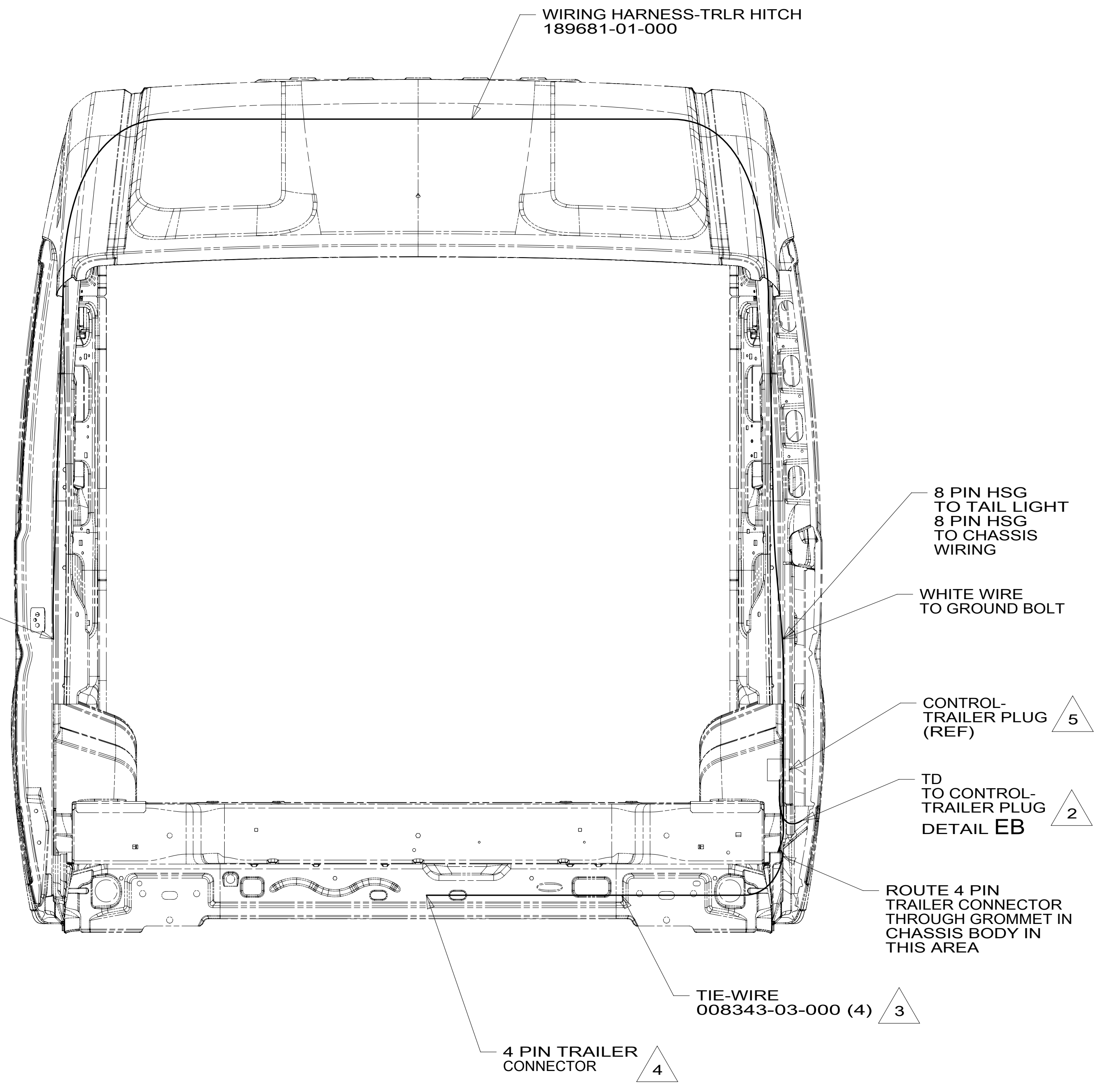
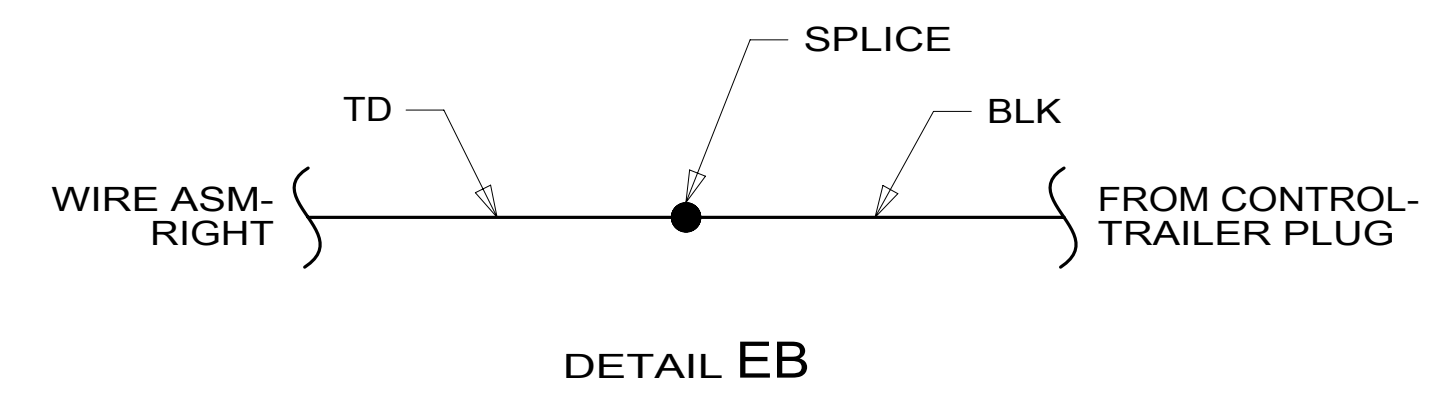

- 5 CONTROL SUPPLIED WITH WIRING HARNESS-TRLR HITCH. SECURE CONTROL IN PLACE WITH DOUBLE SIDED TAPE SUPPLIED WITH WIRING HARNESS-TRLR HITCH.
- 4 WIRE TIE 4-PIN TRAILER PLUG TO HITCH ASSEMBLY NEAR RECEIVER.
- 3 WIRE TIE TRAILER WIRING BEHIND BUMPER.
- 2 SEE WIRING INSTL-BODY, 12V FOR ADDITIONAL INFORMATION.

NOTES:  
1. SECURE CONDUIT 41953, TAB AS REQUIRED, OVER ALL WIRES IN CONTACT WITH SHARP EDGES.

VIEW EA

FOR ELECTRICAL TORQUE SPECIFICATIONS SEE DWG NO. 128783-01-000

FOR ELECTRICAL CALLOUTS SEE DWG NO. 121339-01-000

- 1MS RAM-9,350# GVWR, GAS\_VAN
- 265 CODES/STANDARDS-CSA/CMVSS
- 1B1 CODES/STANDARDS USA

1B1 265 1MS

FIRST USED	
<b>15 259G</b>	
DO NOT SCALE DRAWING	
TITLE: <b>WIRING INSTL-CHASSIS</b>	
SHEET 5	PART NO <b>189041</b> REV

\*189041\*