



**DANGER**

**Danger of electrical shock, burns or death.** Always remove all power sources before attempting any repair, service or diagnostic work. Power can be present from shore power, generator, inverter or battery. All power sources must be disabled and secured before performing any service.



**CAUTION**

If you lack the skills, tools or equipment to perform diagnostic or repair work leave such work to an authorized Winnebago Industries dealer or other qualified shop.

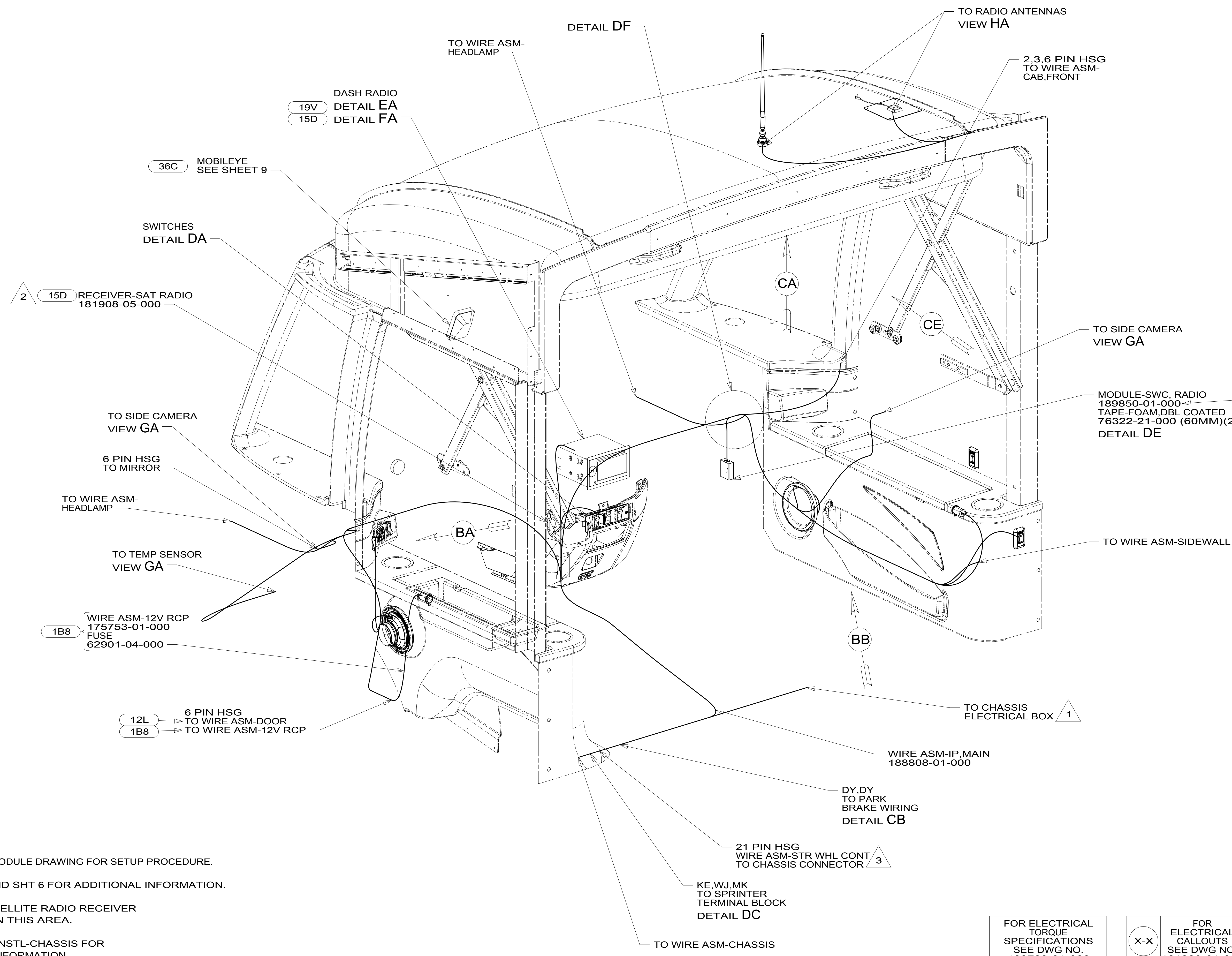

- NOTES:
- 4 REFERENCE MODULE DRAWING FOR SETUP PROCEDURE.
  - 3 SEE SHT 5 AND SHT 6 FOR ADDITIONAL INFORMATION.
  - 2 WIRE TIE SATELLITE RADIO RECEIVER TO WIRING IN THIS AREA.
  - 1 SEE WIRING INSTL-CHASSIS FOR ADDITIONAL INFORMATION

- 36C COLLISION AVOIDANCE SYSTEM
- 19V RADIO-AM/FM STEREO CD PLAYER
- 15D INFOTAINMENT CENTER/GPS
- 1B8 DOOR-DRIVER WITHOUT
- 12L DOOR-DRIVER
- 1ME MERCEDES-11,030# DIESEL,COWL
- 265 CODES/STANDARDS-CSA/CMVSS
- 1B1 CODES/STANDARDS USA

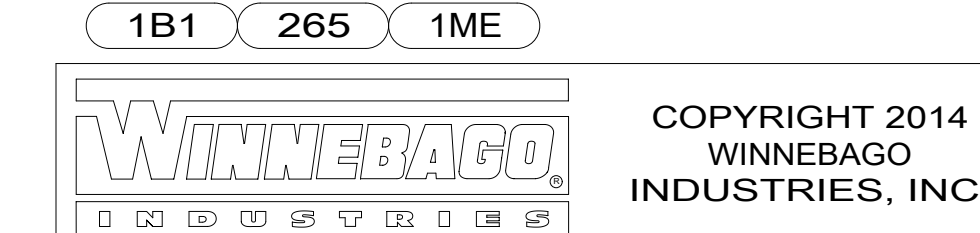

DFT	ORIG. DATE
CHKR	ALL DIMENSIONS ARE IN MILLIMETERS
P.E.	FIRST USED
M.E.	15 H-SERIES
DSNR	MATERIAL:
UNSPECIFIED TOLERANCES ARE:	
WHOLE DIM (X)	: 3
ONE-PLACE (X.X)	: 1.5
TWO-PLACE (X.XX)	: 0.50
ANGLE	: 1°
THIRD ANGLE PROJECTION	
DO NOT SCALE DRAWING REFER TO ES0018 FOR FASTENER TIGHTENING GUIDELINES	
TITLE: WIRING INSTL-FRONT END	
SHEET 1 OF 9	PART NO 188807 REV
REF:	1 26-Mar-2015

FOR ELECTRICAL TORQUE SPECIFICATIONS SEE DWG NO. 128783-01-000

X-X FOR ELECTRICAL CALLOUTS SEE DWG NO. 121339-01-000

\*188807

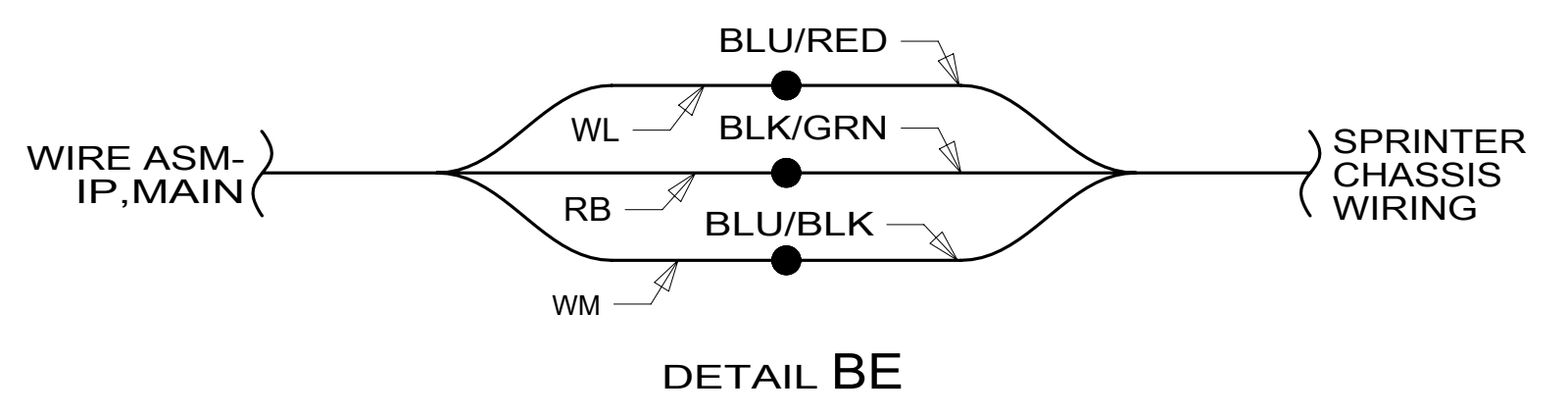
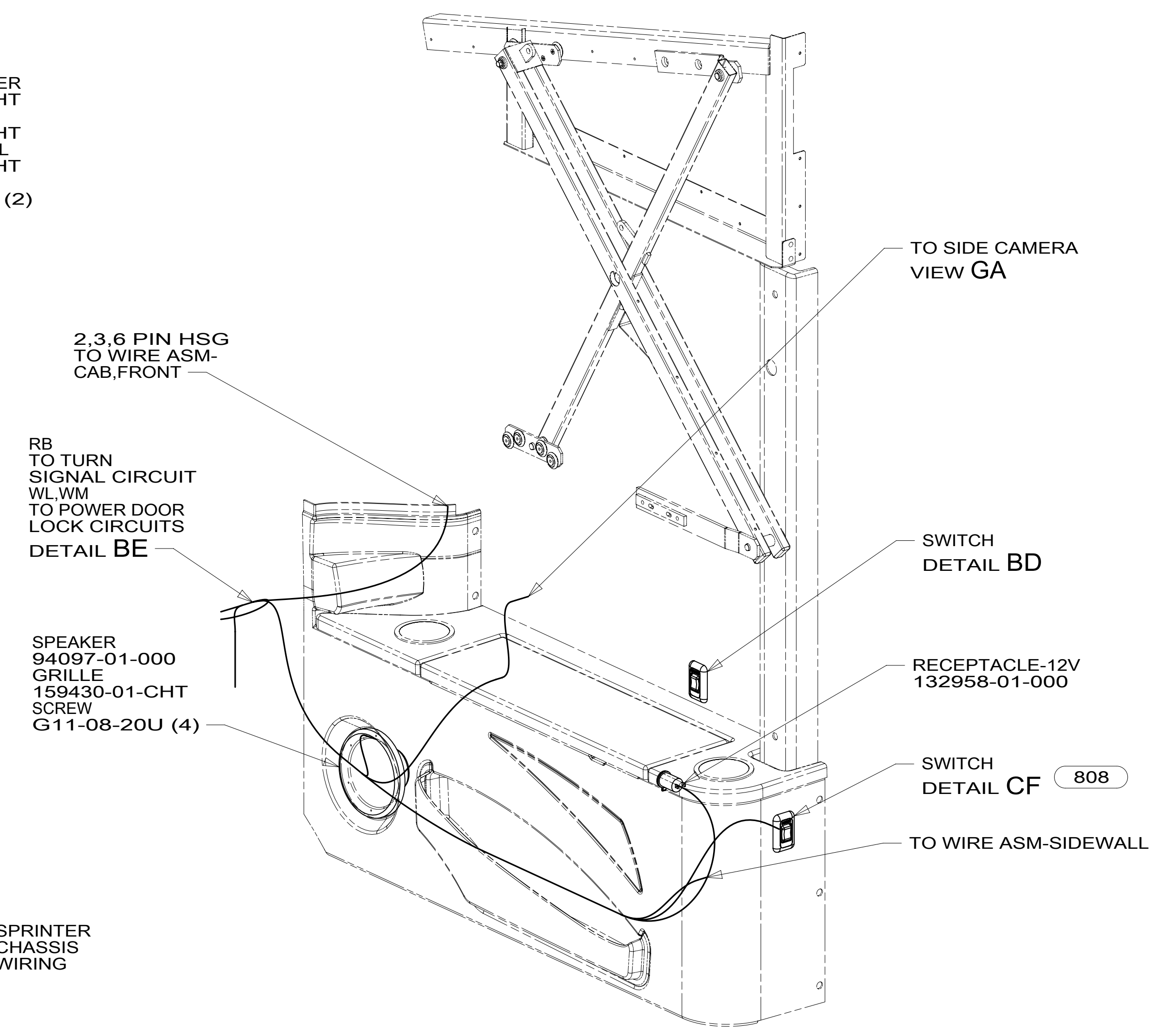
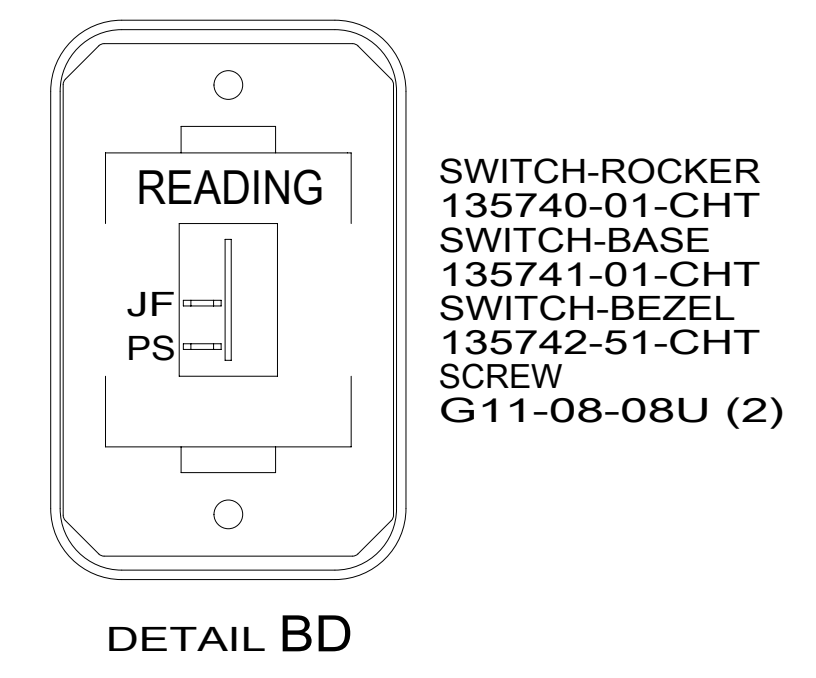
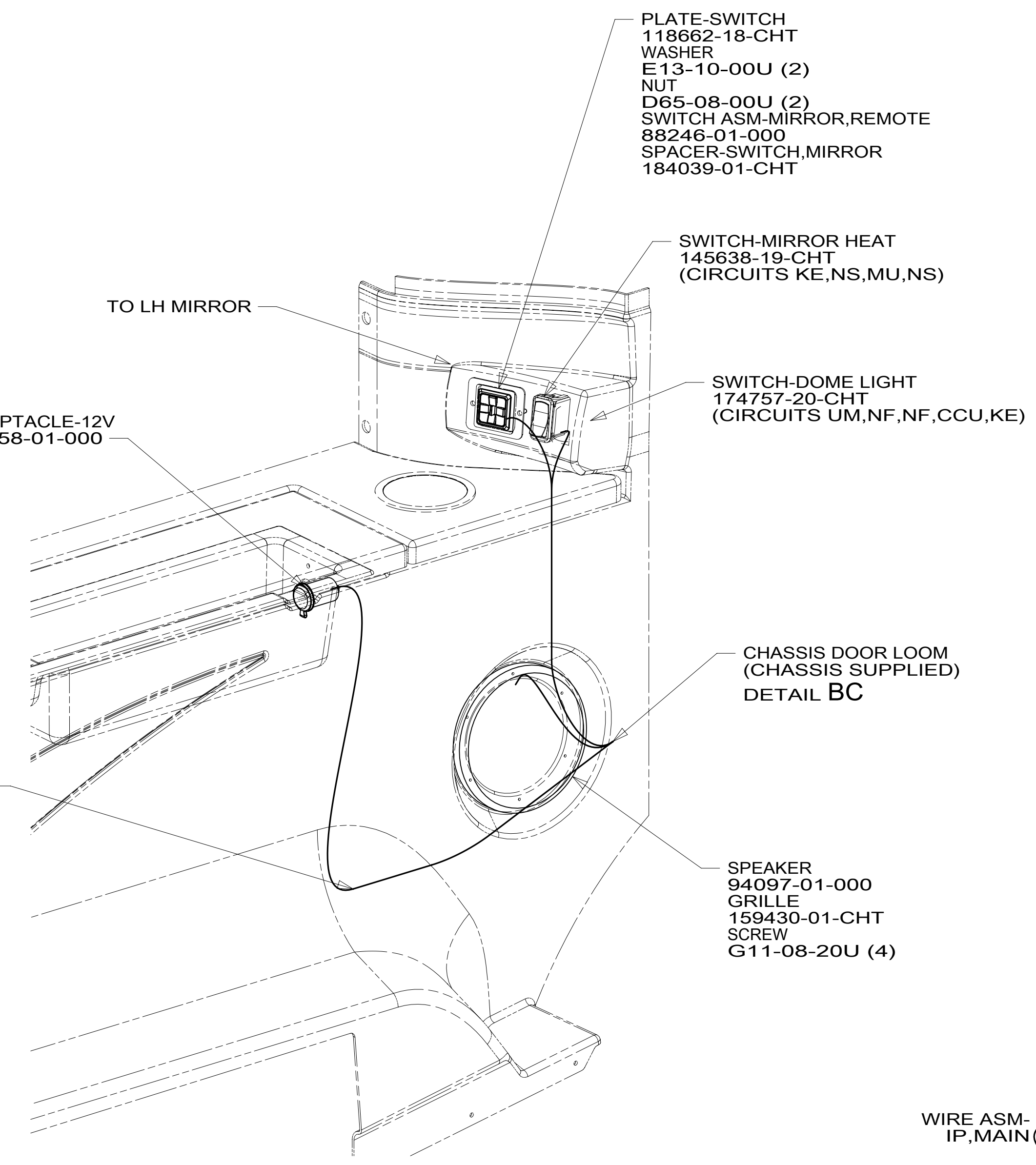

VIEW BA

VIEW BB

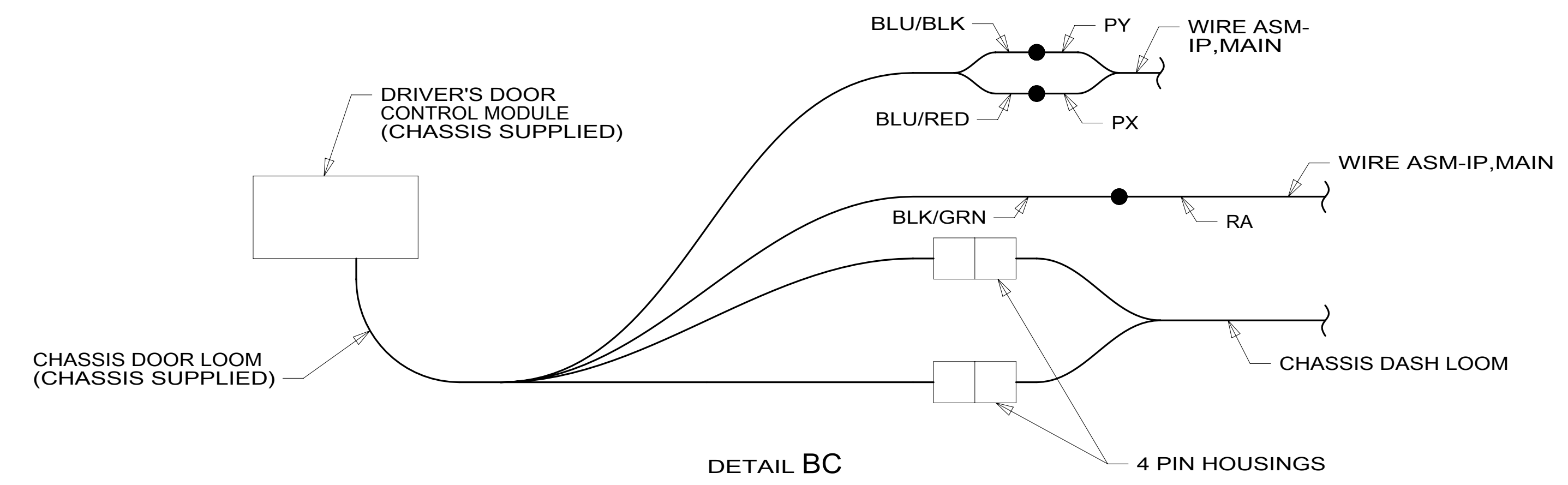

- 1B8 DOOR-DRIVER WITHOUT
- 808 CABINET, FRONT CAB OVERHEAD
- 12L DOOR-DRIVER
- 1ME MERCEDES-11,030# DIESEL,COWL
- 265 CODES/STANDARDS-CSA/CMVSS
- 1B1 CODES/STANDARDS USA

1B1	265	1ME
FIRST USED		
<b>15 H-SERIES</b>		
DO NOT SCALE DRAWING		
TITLE: <b>WIRING INSTL-FRONT END</b>		
SHEET 2	PART NO <b>188807</b>	REV
1 26-Mar-2015		

FOR ELECTRICAL  
TORQUE  
SPECIFICATIONS  
SEE DWG NO.  
128783-01-000

FOR  
ELECTRICAL  
CALLOUTS  
SEE DWG NO.  
121339-01-000

\*188807 A\*

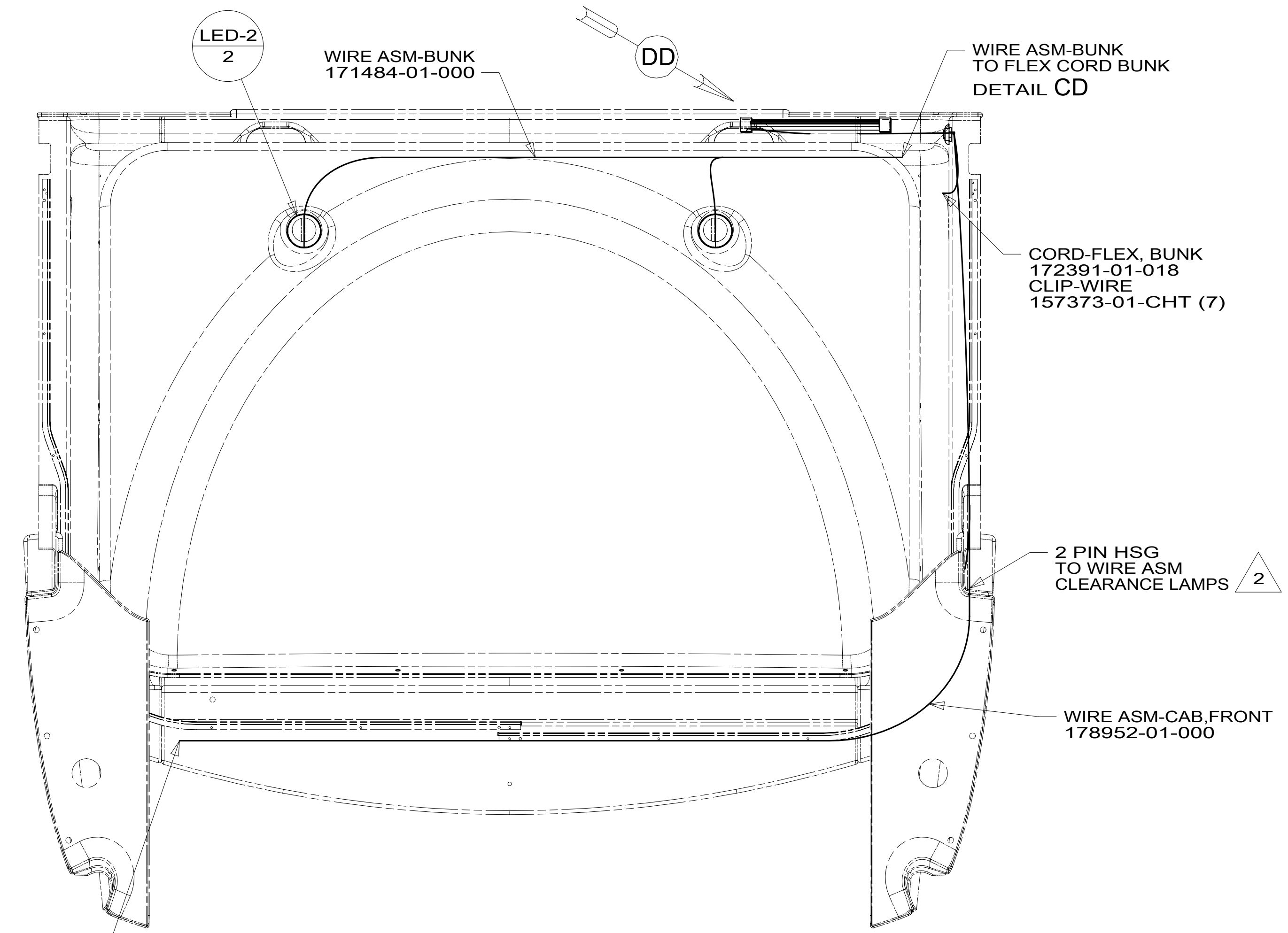

VIEW CA 50R

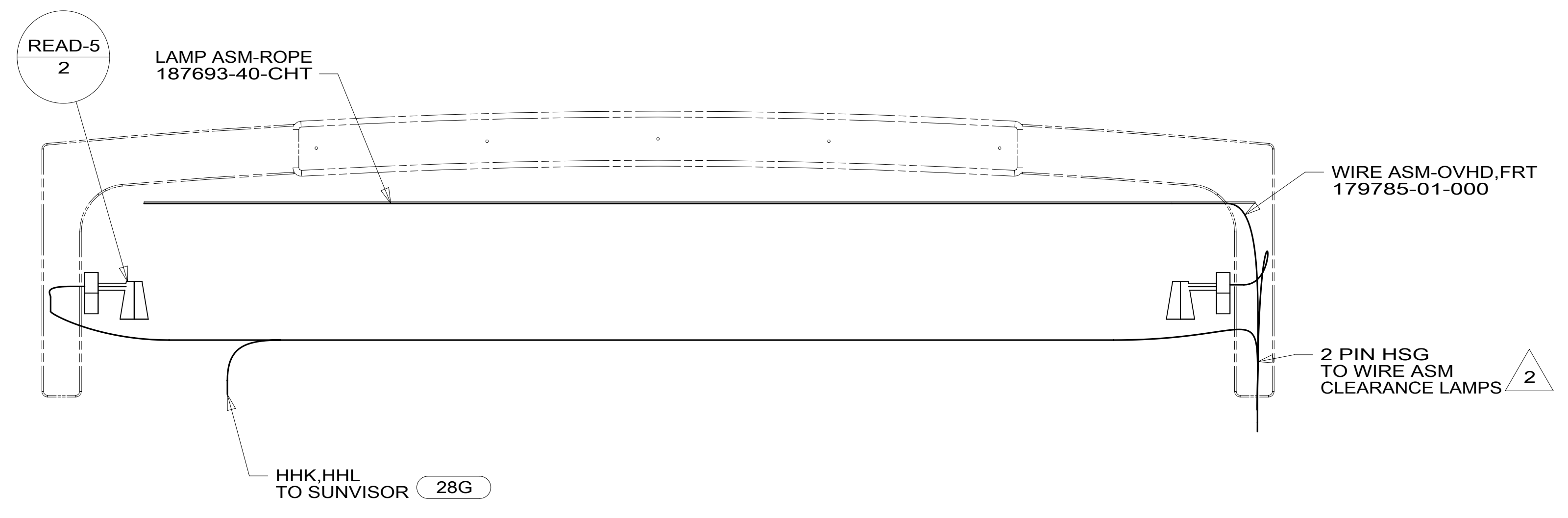

VIEW CE 808

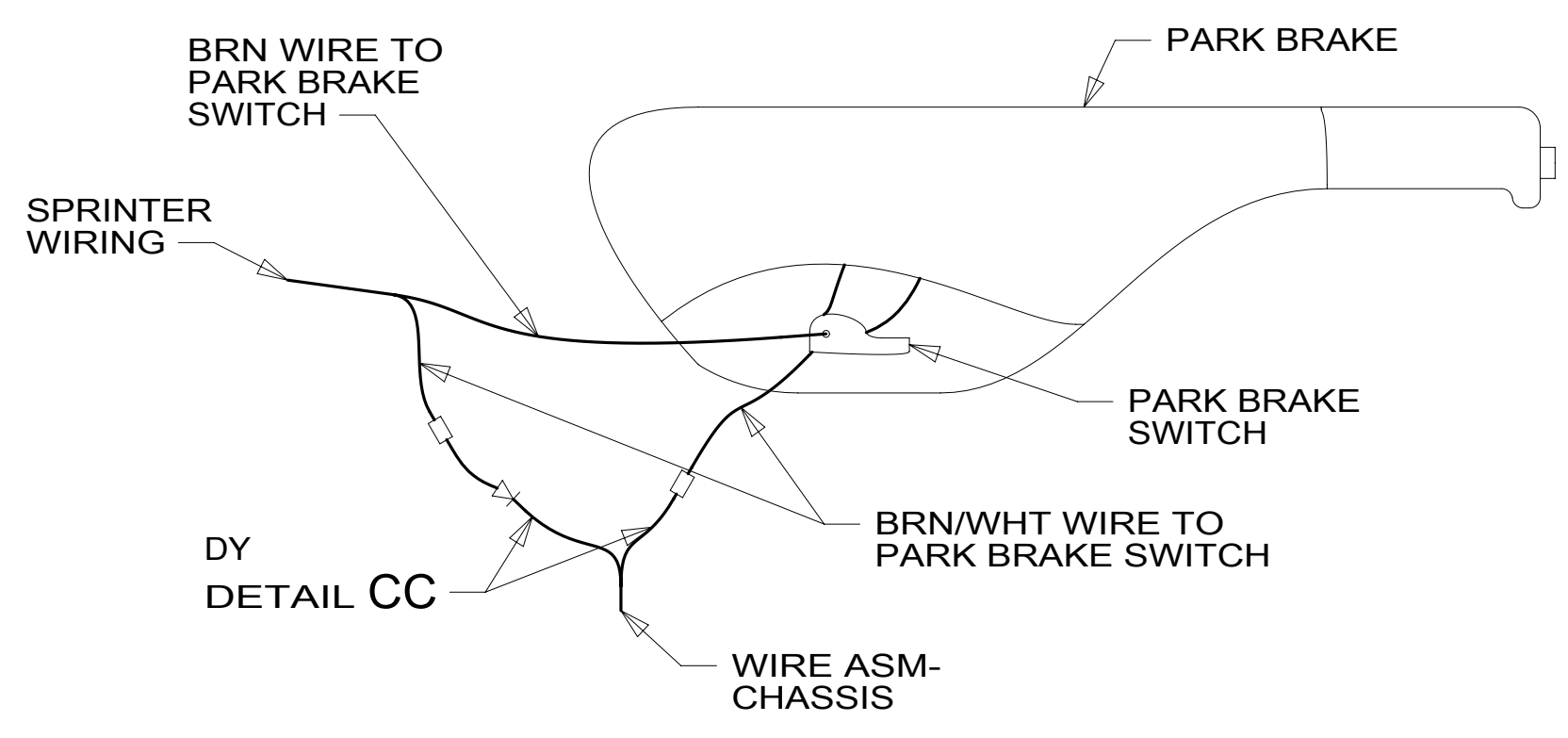

DETAIL CB

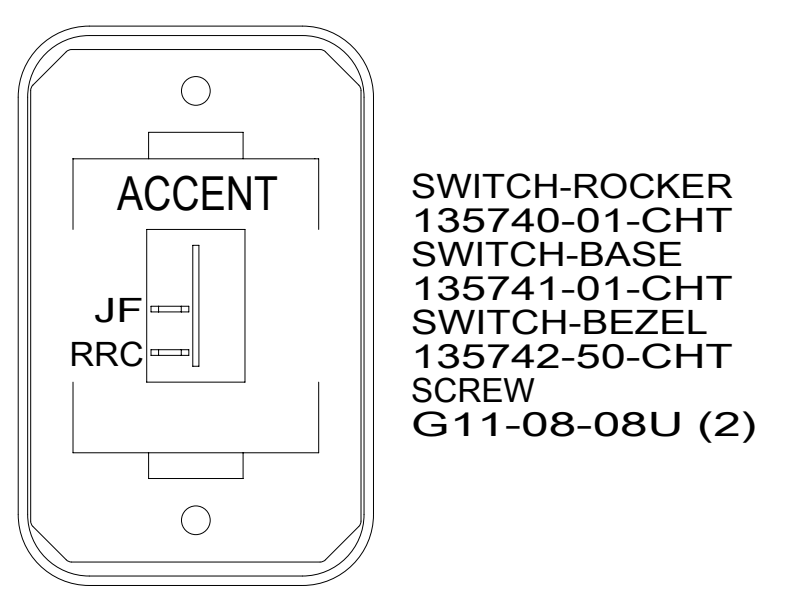

DETAIL CF 808

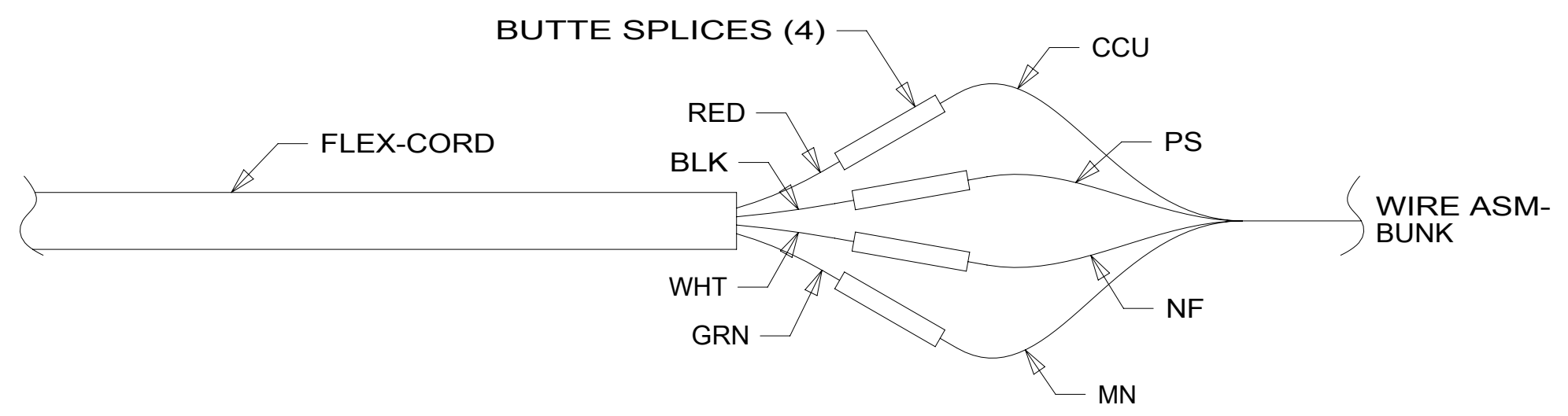

DETAIL CD 50R

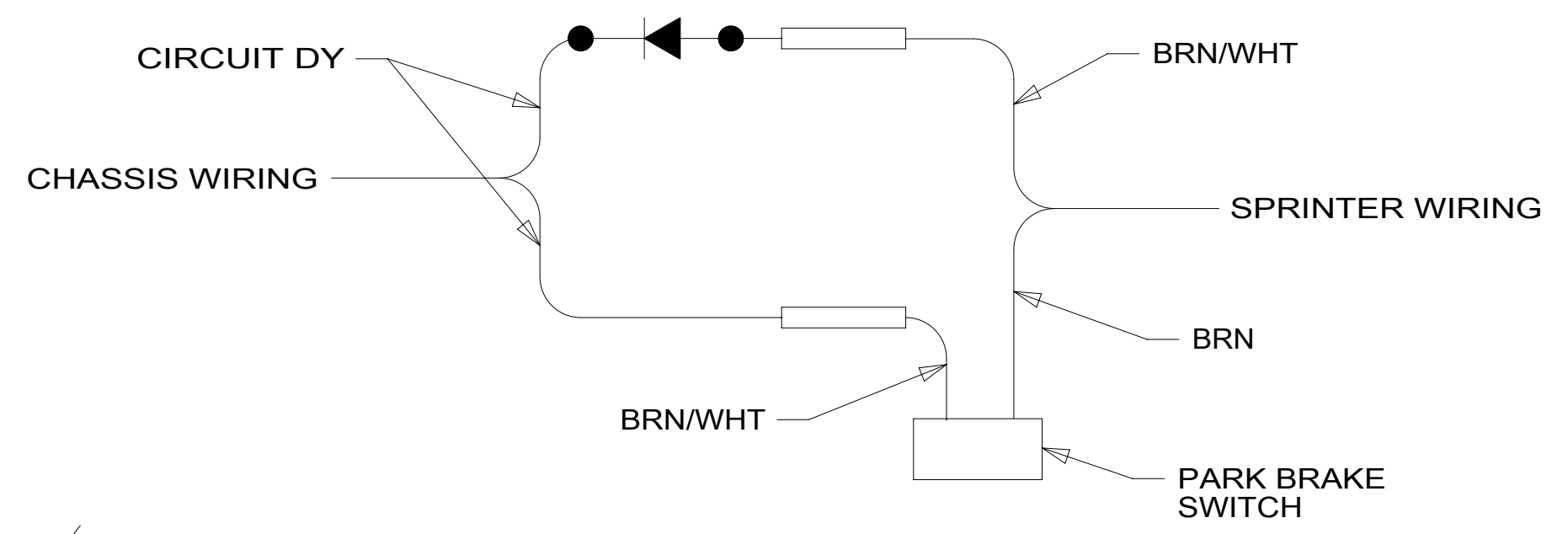

DETAIL CC 1

NOTES:  
 2 SEE WIRING INSTL-EXTERIOR LAMPS FOR ADDITIONAL INFORMATION.  
 1 CUT BRN/WHT WIRE FROM PARK BRAKE SWITCH AND RECONNECT TO CIRCUIT DY OF WIRE ASM-CHASSIS AS SHOWN.

FOR ELECTRICAL TORQUE SPECIFICATIONS SEE DWG NO. 128783-01-000

FOR ELECTRICAL CALLOUTS SEE DWG NO. 121339-01-000

- 808 CABINET, FRONT CAB OVERHEAD
- 50R FRONT BUNK-PULL DOWN
- 28G SUNVISOR-POWERED (1)
- 1ME MERCEDES-11,030# DIESEL, COWL
- 265 CODES/STANDARDS-CSA/CMVSS
- 1B1 CODES/STANDARDS USA

FIRST USED	
<b>15 H-SERIES</b>	
DO NOT SCALE DRAWING	
TITLE: <b>WIRING INSTL-FRONT END</b>	
SHEET 3	PART NO <b>188807</b> REV
1 26-Mar-2015	

\*188807



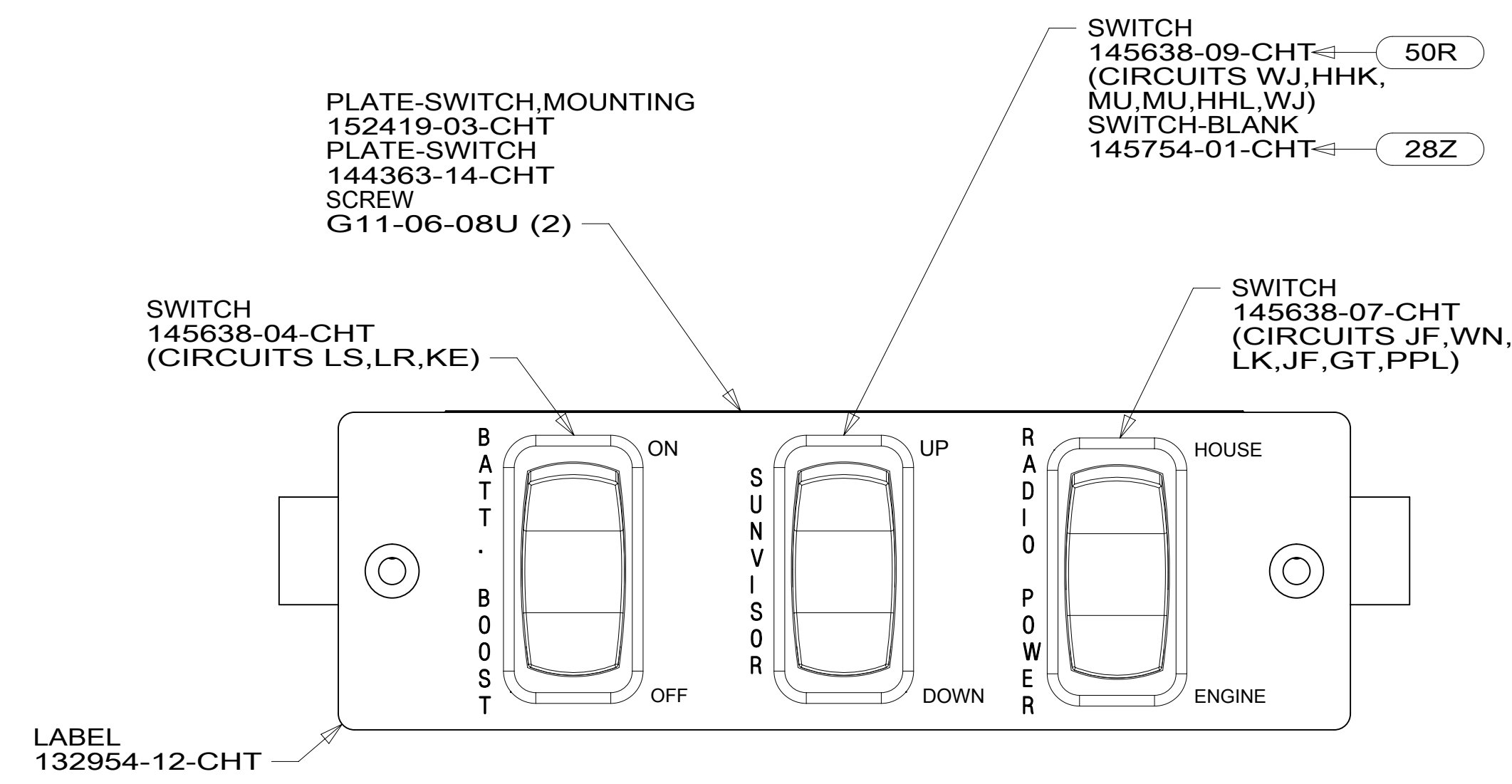

VIEW DA

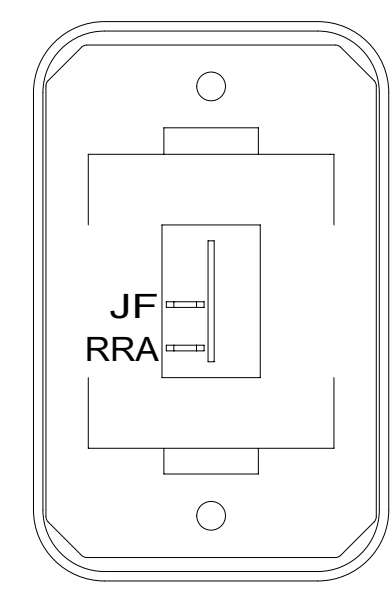

DETAIL DB

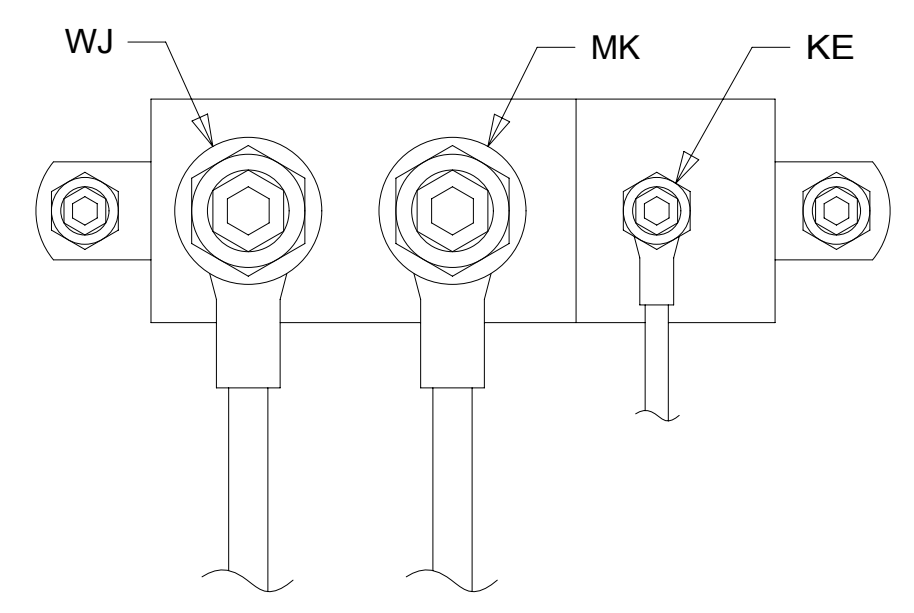

DETAIL DC 1



DETAIL DE (LOCATED UNDER DASH)

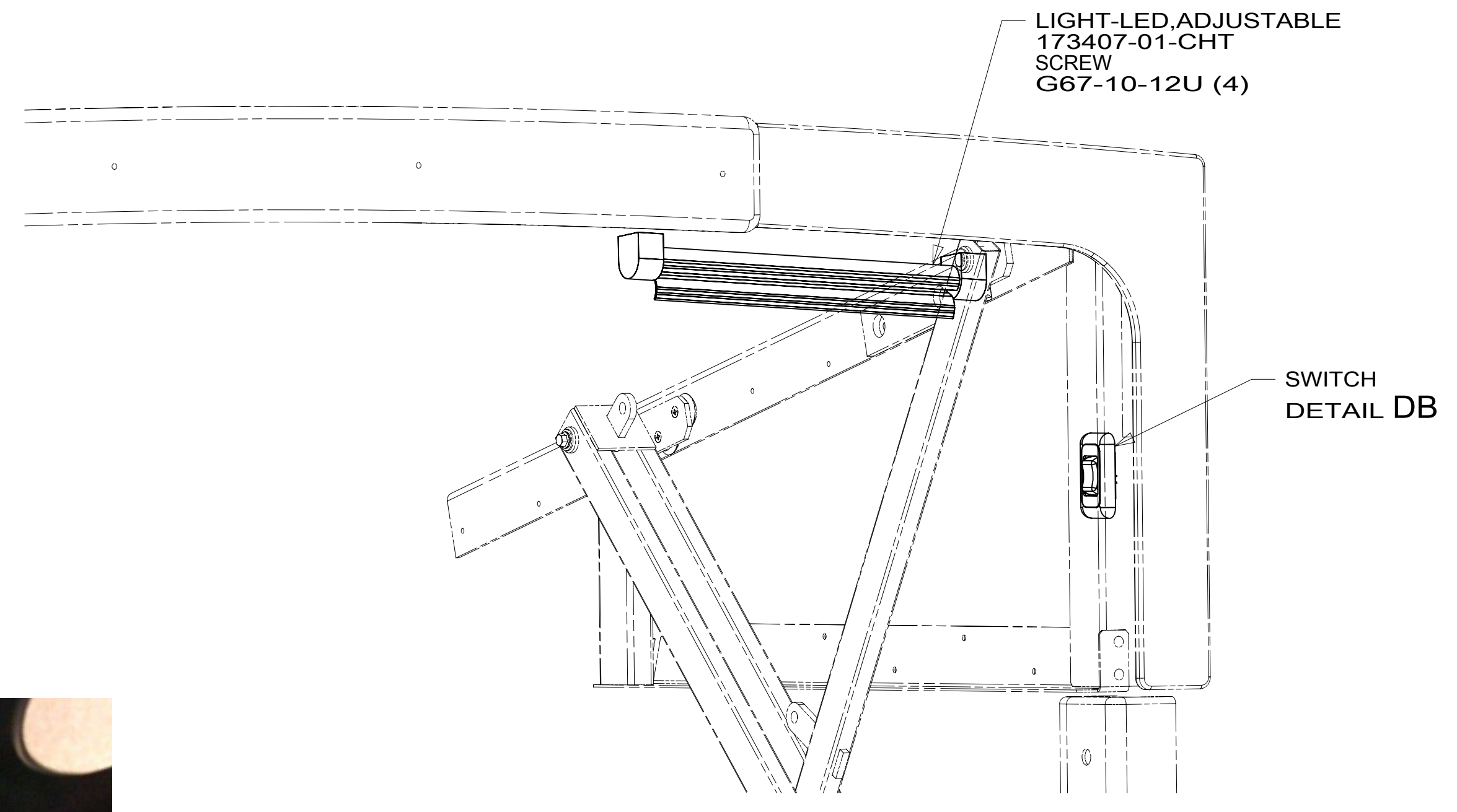

DETAIL DD 50R

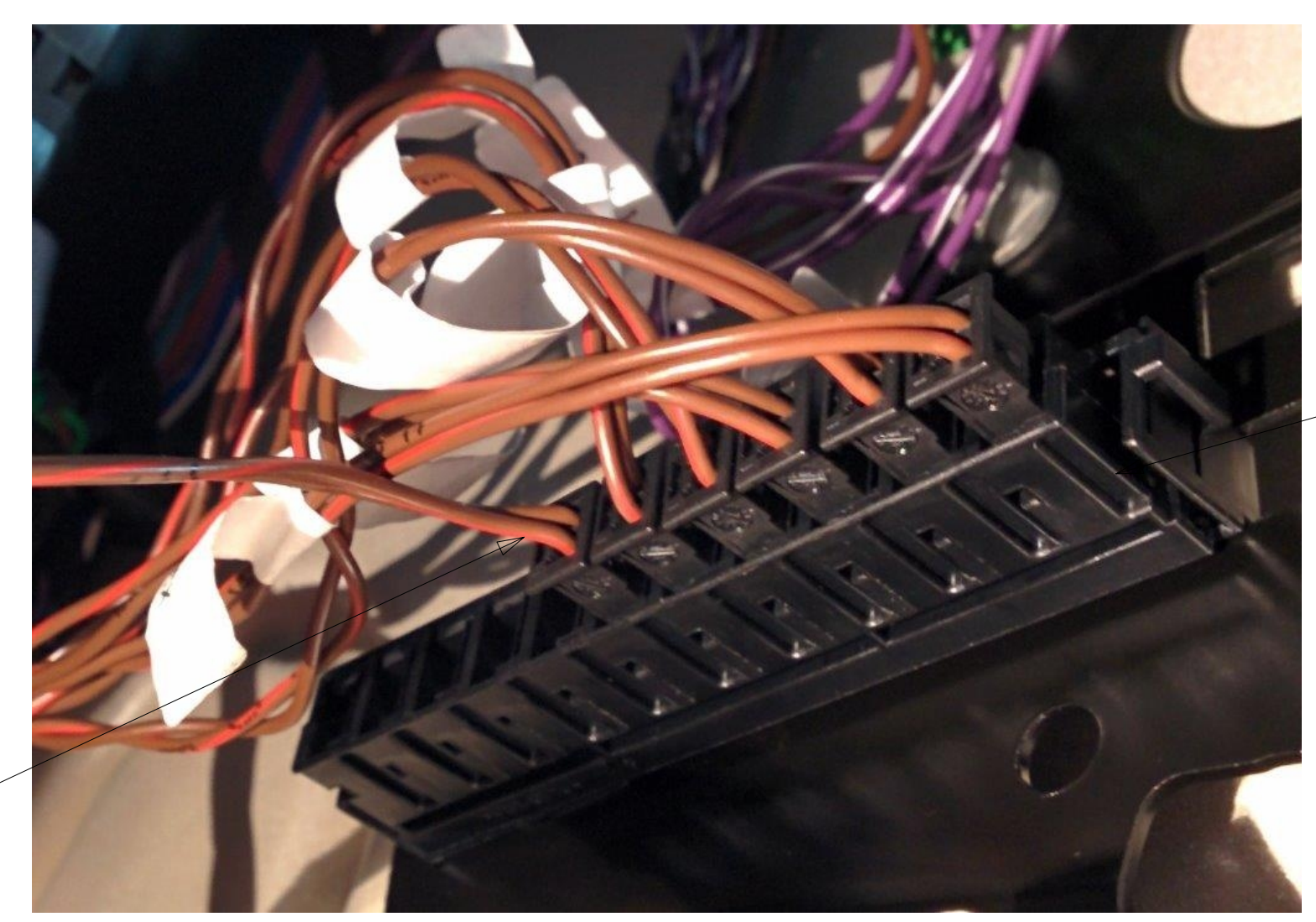

DETAIL DF

- NOTES:
- 2 PLU CHASSIS SUPPLIED 2 PIN HSG INTO CAN-BUS TERMINAL BLOCK.
  - 1 CONNECTION POINT IS LOCATED UNDER DRIVER'S SEAT.

- 28Z SUNVISORS - MANUAL(3)
- 50R FRONT BUNK-PULL DOWN
- 1ME MERCEDES-11,030# DIESEL,COWL
- 265 CODES/STANDARDS-CSA/CMVSS
- 1B1 CODES/STANDARDS USA

1B1	265	1ME
FIRST USED		
<b>15 H-SERIES</b>		
DO NOT SCALE DRAWING		
TITLE: <b>WIRING INSTL-FRONT END</b>		
SHEET 4	PART NO <b>188807</b>	REV
1 26-Mar-2015		

FOR ELECTRICAL TORQUE SPECIFICATIONS SEE DWG NO. 128783-01-000

FOR ELECTRICAL CALLOUTS SEE DWG NO. 121339-01-000

\*188807



RADIO-AM/FM/DVD, TOUCH, 2-DIN  
 183820-14-000  
 KIT-RADIO MOUNTING, DASH  
 176654-08-000  
 BRACKET-RADIO, MODIFIED  
 178610-01-000  
 APPLIQUE-RADIO  
 185341-01-CHT

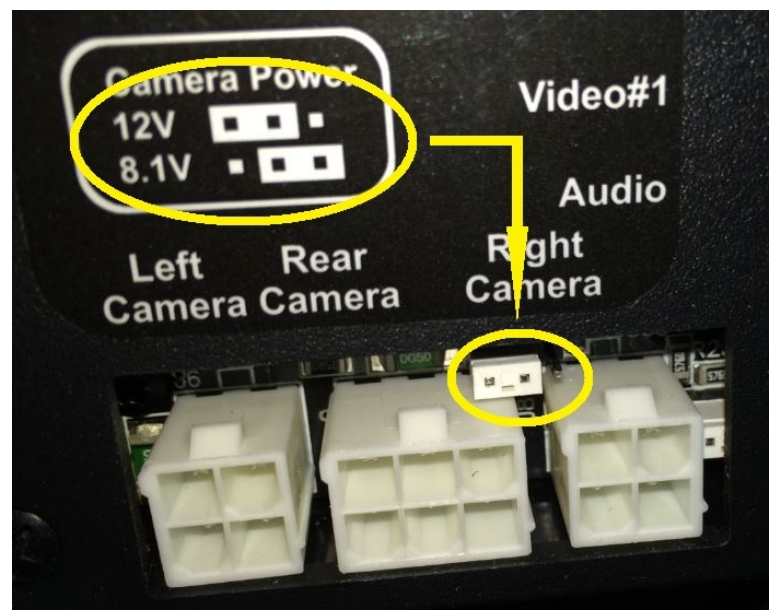
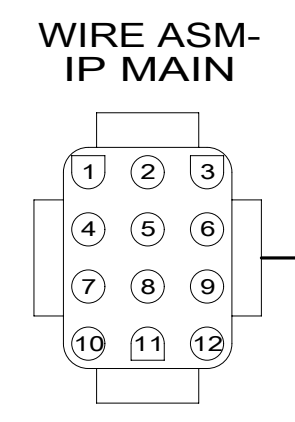
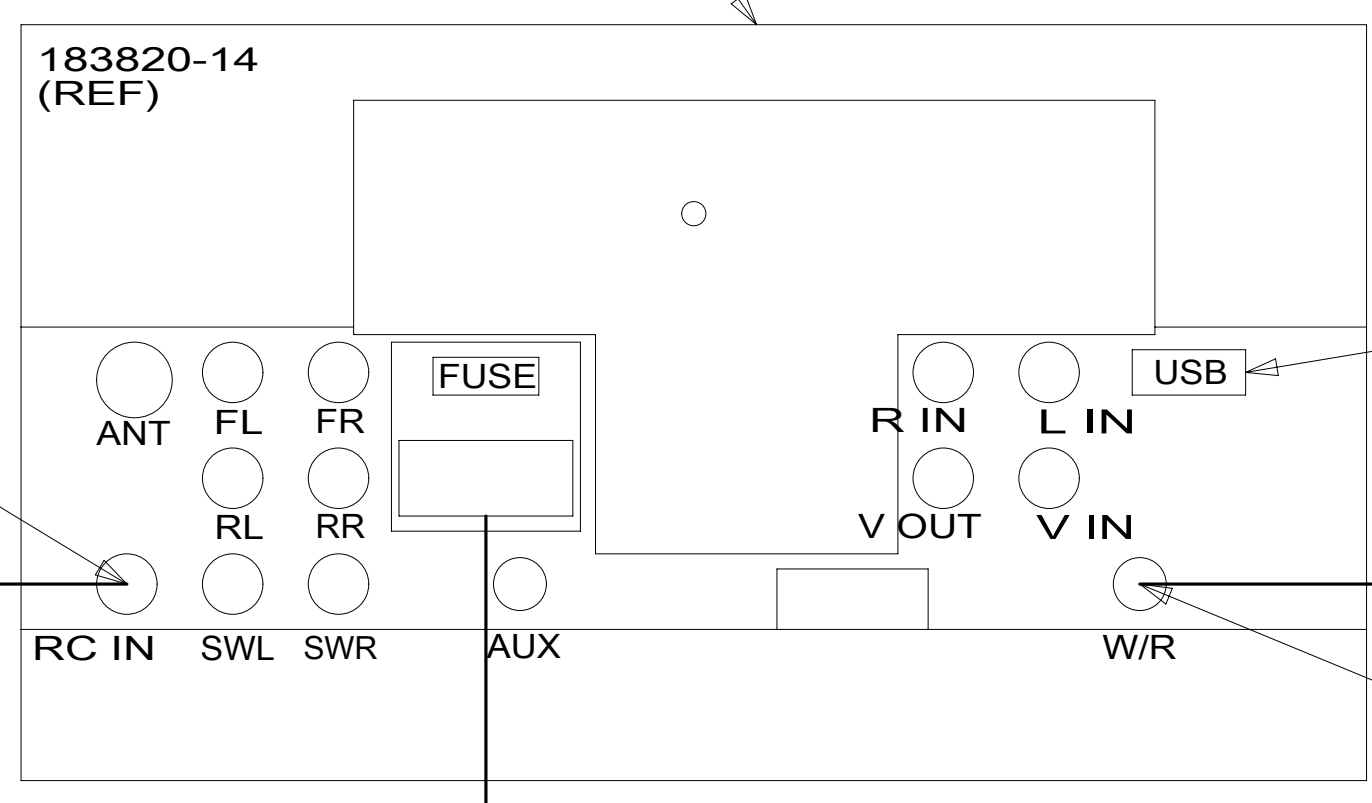

DETAIL EB

- NOTES:
- 6 ENSURE CAMERA POWER JUMPER IS IN 12 VOLT POSITION. MOVE TO 12V POSITION IF NECESSARY. SEE DETAIL EB
  - 5 MARK LEFT CABLE WITH YELLOW TAPE 900000-07-000 NEXT TO CONNECTOR.
  - 4 MARK RIGHT CABLE WITH WHITE TAPE 900000-08-000 NEXT TO CONNECTOR.
  - 3 ROUTE TEMP SENSOR CABLE ALONG WITH CAMERA CABLE TO MIRROR THEN ROUTE SENSOR CABLE BEHIND FENDER TO FRONT BUMPER. SEE SHEET 6.
  - 2 PLUG CABLE INTO LEAD ON BACK OF RADIO. DRILL 16 MM DIAMETER HOLE IN THE TRAY ABOVE THE RADIO. THE HOLE IS TO BE LOCATED ON THE PASSENGER SIDE OF THE TRAY 50 MM FROM THE END NEAREST THE WINDSHIELD. ROUTE CABLE INTO THE TRAY AND LEAVE 200 MM OF CABLE IN THE TRAY.
  - 1 SUPPLIED WITH RADIO.

DETAIL EA

FOR ELECTRICAL TORQUE SPECIFICATIONS SEE DWG NO. 128783-01-000

FOR ELECTRICAL CALLOUTS SEE DWG NO. 121339-01-000

- 19V RADIO-AM/FM STEREO CD PLAYER
- 265 CODES/STANDARDS-CSA/CMVSS
- 1B1 CODES/STANDARDS USA

FIRST USED	
<b>15 H-SERIES</b>	
DO NOT SCALE DRAWING	
TITLE: <b>WIRING INSTL-FRONT END</b>	
SHEET 5	PART NO <b>188807</b> REV
1 26-Mar-2015	

\*188807

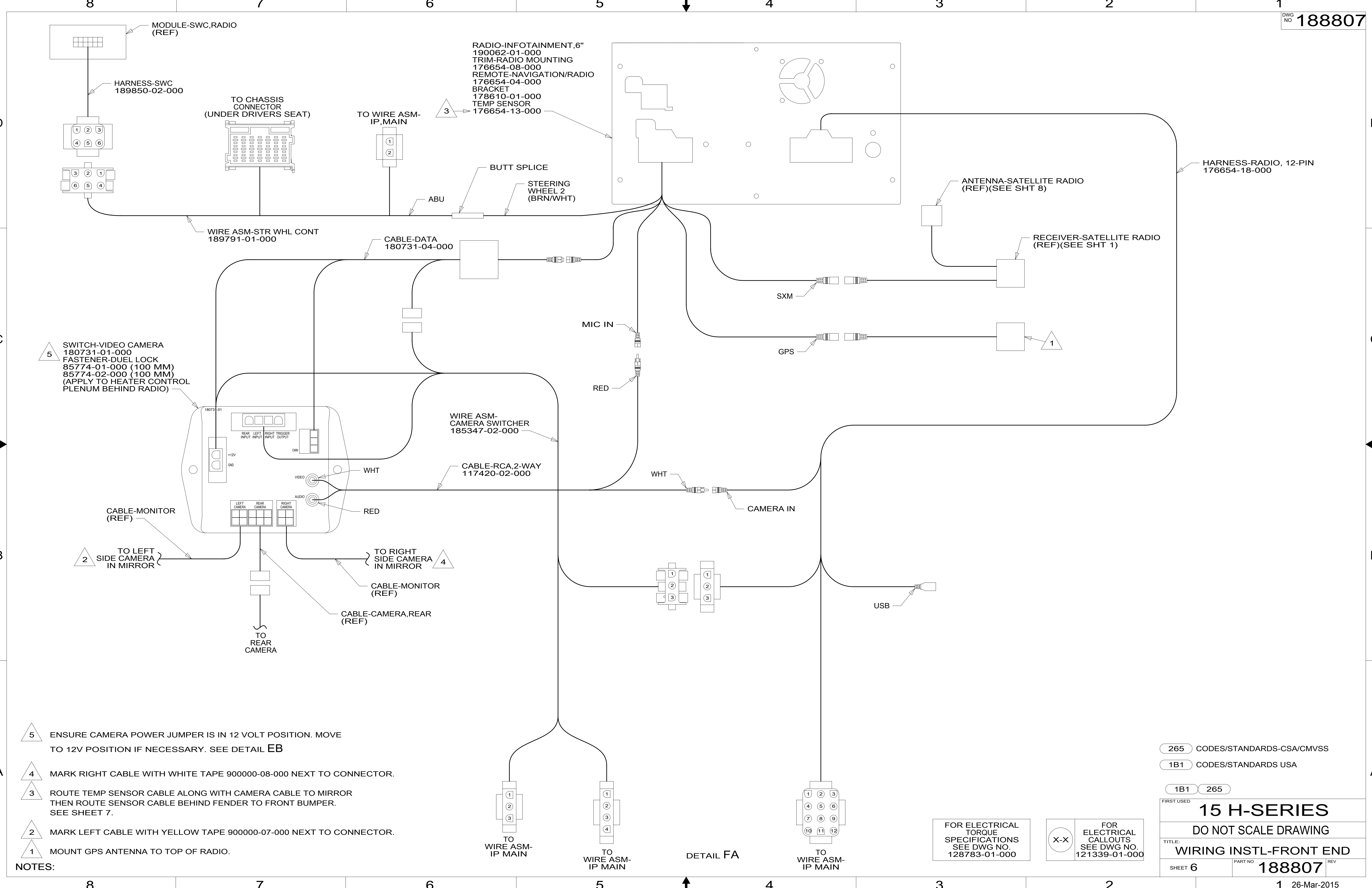

- NOTES:**
- 5 ENSURE CAMERA POWER JUMPER IS IN 12 VOLT POSITION. MOVE TO 12V POSITION IF NECESSARY. SEE DETAIL EB
  - 4 MARK RIGHT CABLE WITH WHITE TAPE 900000-08-000 NEXT TO CONNECTOR.
  - 3 ROUTE TEMP SENSOR CABLE ALONG WITH CAMERA CABLE TO MIRROR THEN ROUTE SENSOR CABLE BEHIND FENDER TO FRONT BUMPER. SEE SHEET 7.
  - 2 MARK LEFT CABLE WITH YELLOW TAPE 900000-07-000 NEXT TO CONNECTOR.
  - 1 MOUNT GPS ANTENNA TO TOP OF RADIO.

265	CODES/STANDARDS-CSA/CMVSS
1B1	CODES/STANDARDS USA
1B1	265
FIRST USED	
<b>15 H-SERIES</b>	
<b>DO NOT SCALE DRAWING</b>	
TITLE: <b>WIRING INSTL-FRONT END</b>	
SHEET 6	PART NO. <b>188807</b> REV
1 26-Mar-2015	

FOR ELECTRICAL TORQUE SPECIFICATIONS SEE DWG NO. 128783-01-000

FOR ELECTRICAL CALLOUTS SEE DWG NO. 121339-01-000

DETAIL FA

\*188807

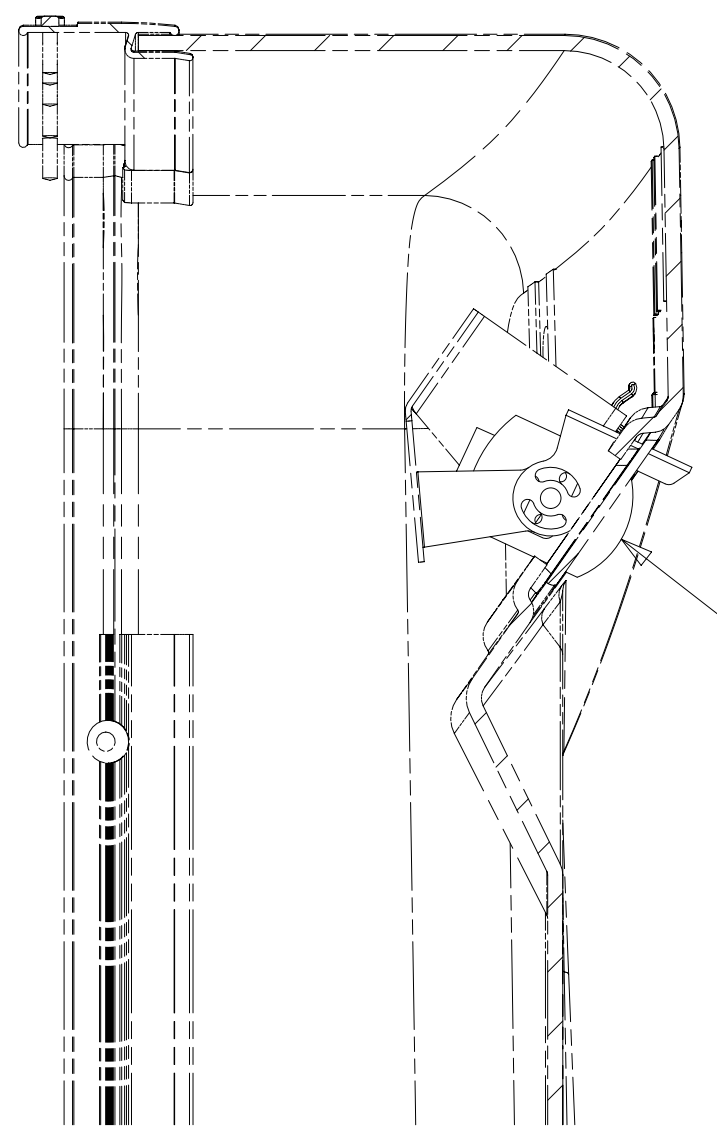
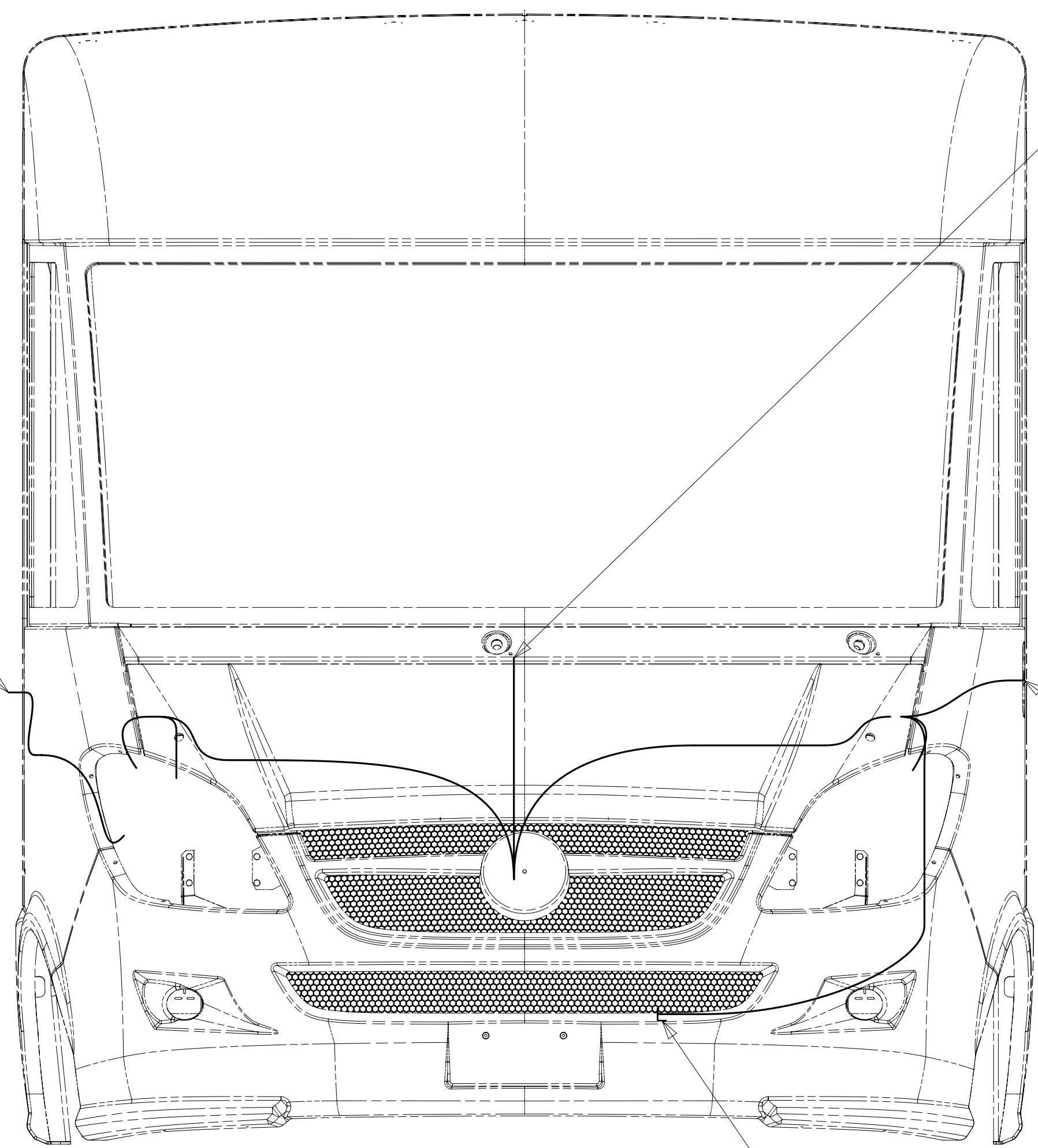
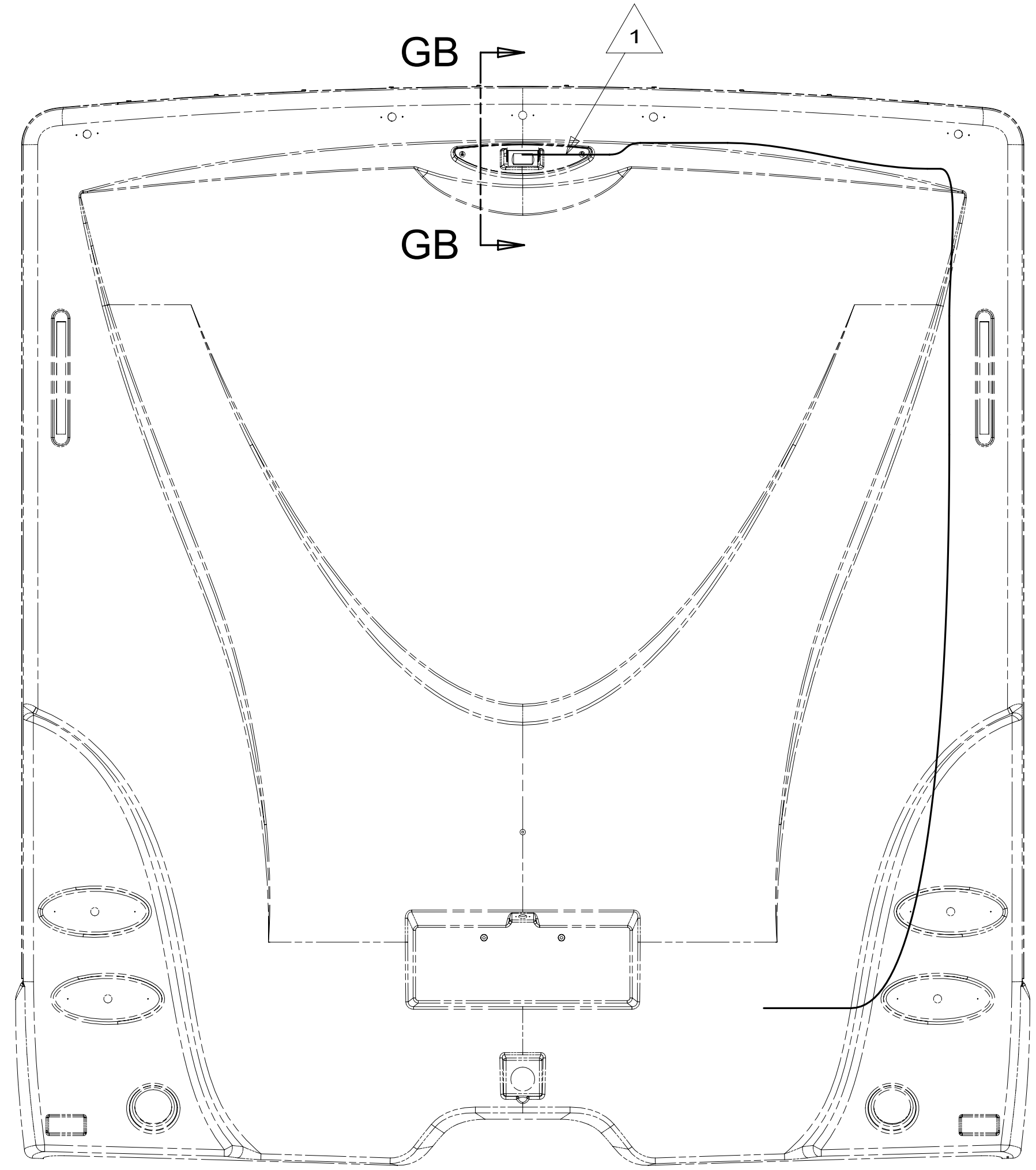

- CAMERA-REARVIEW 183822-01-000 SCREW G39-10-12U (EXT)(5) 74J & 19V
- CAMERA-REARVIEW 176654-17-CHT SCREW G39-10-12U (EXT)(4) 74J & 15D

- MONITOR DETAIL EA 19V
- MONITOR DETAIL FA 15D

- CABLE-MONITOR 144677-23-000 74C 2

- BRACKET-TEMP SENSOR 147428-01-CHT SCREW G39-08-08U (2) 3

- NOTES:
- 3 MOUNT ON TOP OF BUMPER NEXT TO CHASSIS TEMP SENSOR.
  - 2 CONNECT CAMERA CABLE TO MIRROR.
  - 1 ROUTE CAMERA CABLE UP BACKWALL TO REAR VIEW CAMERA

- 15D GPS-NAVIGATION SYSTEM
- 19V RADIO-AM/FM STEREO CD PLAYER
- 74C VIDEO CAMERA SYSTEM
- 74J REARVIEW MONITOR SYS W/AUDIO
- 265 CODES/STANDARDS-CSA/CMVSS
- 1B1 CODES/STANDARDS USA

FIRST USED	
<b>15 H-SERIES</b>	
DO NOT SCALE DRAWING	
TITLE: <b>WIRING INSTL-FRONT END</b>	
SHEET 7	PART NO <b>188807</b> REV
1 26-Mar-2015	

FOR ELECTRICAL TORQUE SPECIFICATIONS SEE DWG NO. 128783-01-000

FOR ELECTRICAL CALLOUTS SEE DWG NO. 121339-01-000

\*188807



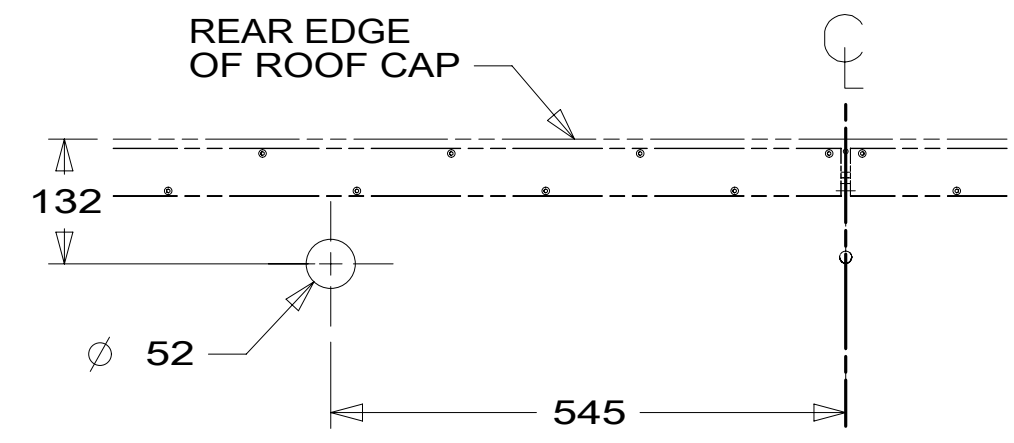

DETAIL HB 15D

ANTENNA-SATELLITE RADIO  
 181908-02-000  
 PLATE-SATELLITE RADIO  
 177256-03-CHT  
 SCREW  
 G11-08-08U (4)  
 SEAL  
 DETAIL HB

15D 3 4

ANTENNA-RADIO  
 90944-01-000  
 SCREW  
 G39-08-12U

2 6 7 8

15D CABLE ASM-SAT  
 (SUPPLIED WITH ANTENNA)

TO RADIO

CABLE ASM-ANTENNA  
 (REF)

1 9

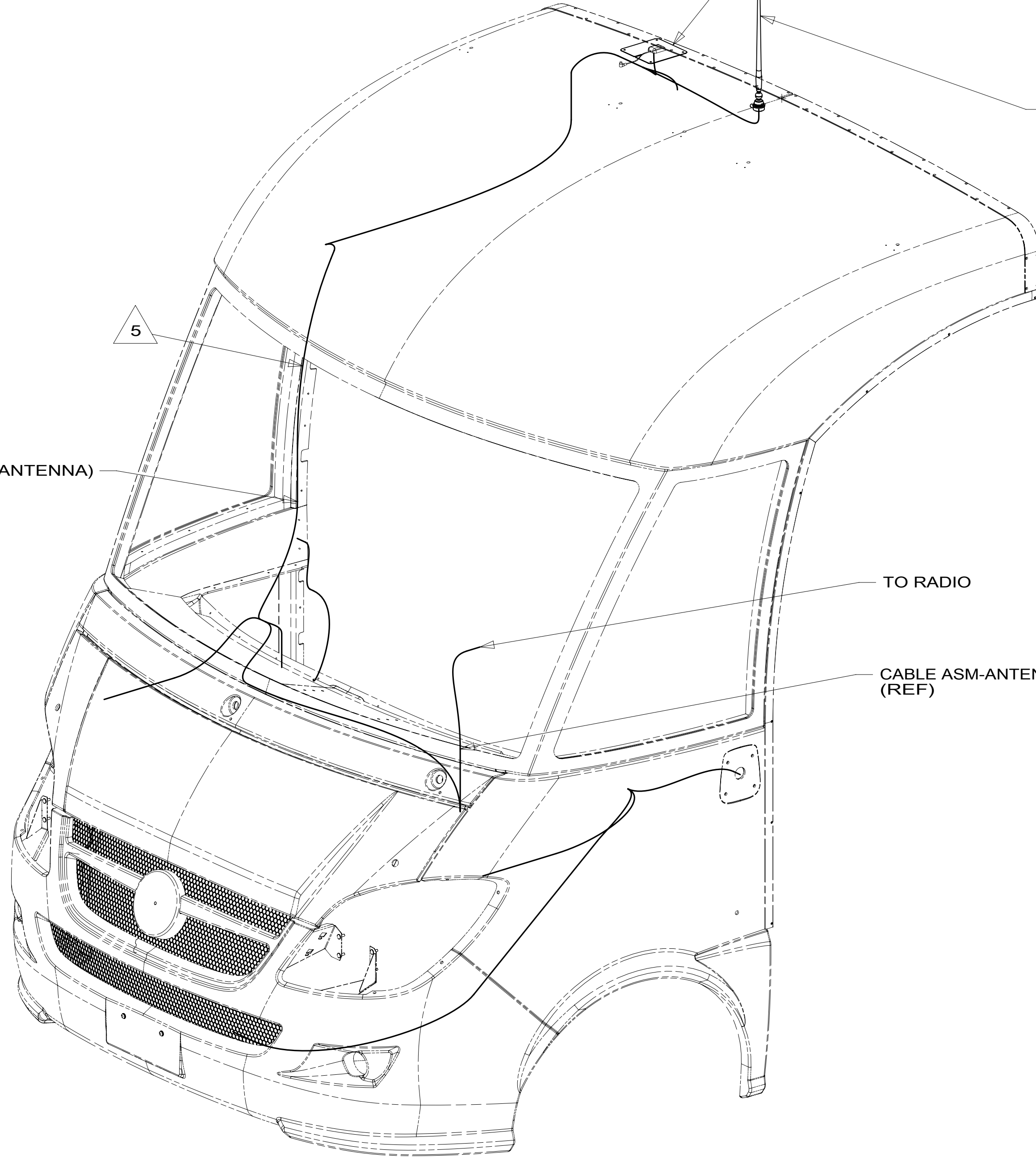

VIEW HA

- 9 CABLE IS INTEGRATED INTO WIRE ASM-IP,MAIN.
- 8 REMOVE AND REINSTALL AFTER PAINT.
- 7 CUT AND REMOVE A 75MM X 75MM AREA OF THE ALUMINUM INSULATION, CENTERED ABOUT THE RADIO ANTENNA ROOF CAP.
- 6 USE SCREW TO ATTACH ANTENNA GROUND CABLE TO CAB STEEL STRUCTURE.
- 5 ROUTE SATELLITE RADIO ANTENNA CABLE FROM PASSENGER SEAT PEDESTAL UP A-PILLAR TO ROOF CAP.
- 4 SEE WIRING INSTL-CHASSIS FOR ADDITIONAL INFORMATION.
- 3 MOUNT ANTENNA SUCH THAT BASE IS SQUARE W/REAR OF ROOF CAP & CENTER HOLE OF ANTENNA DIRECTLY OVER HOLE IN FIBERGLASS. SEAL HOLE, BASE, AND SCREWS.
- 2 SEAL AROUND ANTENNA BASE.
- 1 ROUTE RADIO ANTENNA CABLE FROM DASH RADIO UNDER DASH UP PASSENGER SIDE A-PILLAR TO ROOF CAP.

NOTES:

15D INFOTAINMENT CENTER/GPS  
 265 CODES/STANDARDS-CSA/CMVSS  
 1B1 CODES/STANDARDS USA

1B1 265

FOR ELECTRICAL TORQUE SPECIFICATIONS SEE DWG NO. 128783-01-000

FOR ELECTRICAL CALLOUTS SEE DWG NO. 121339-01-000

FIRST USED	
<b>15 H-SERIES</b>	
DO NOT SCALE DRAWING	
TITLE: <b>WIRING INSTL-FRONT END</b>	
SHEET 8	PART NO <b>188807</b> REV

\*188807\*

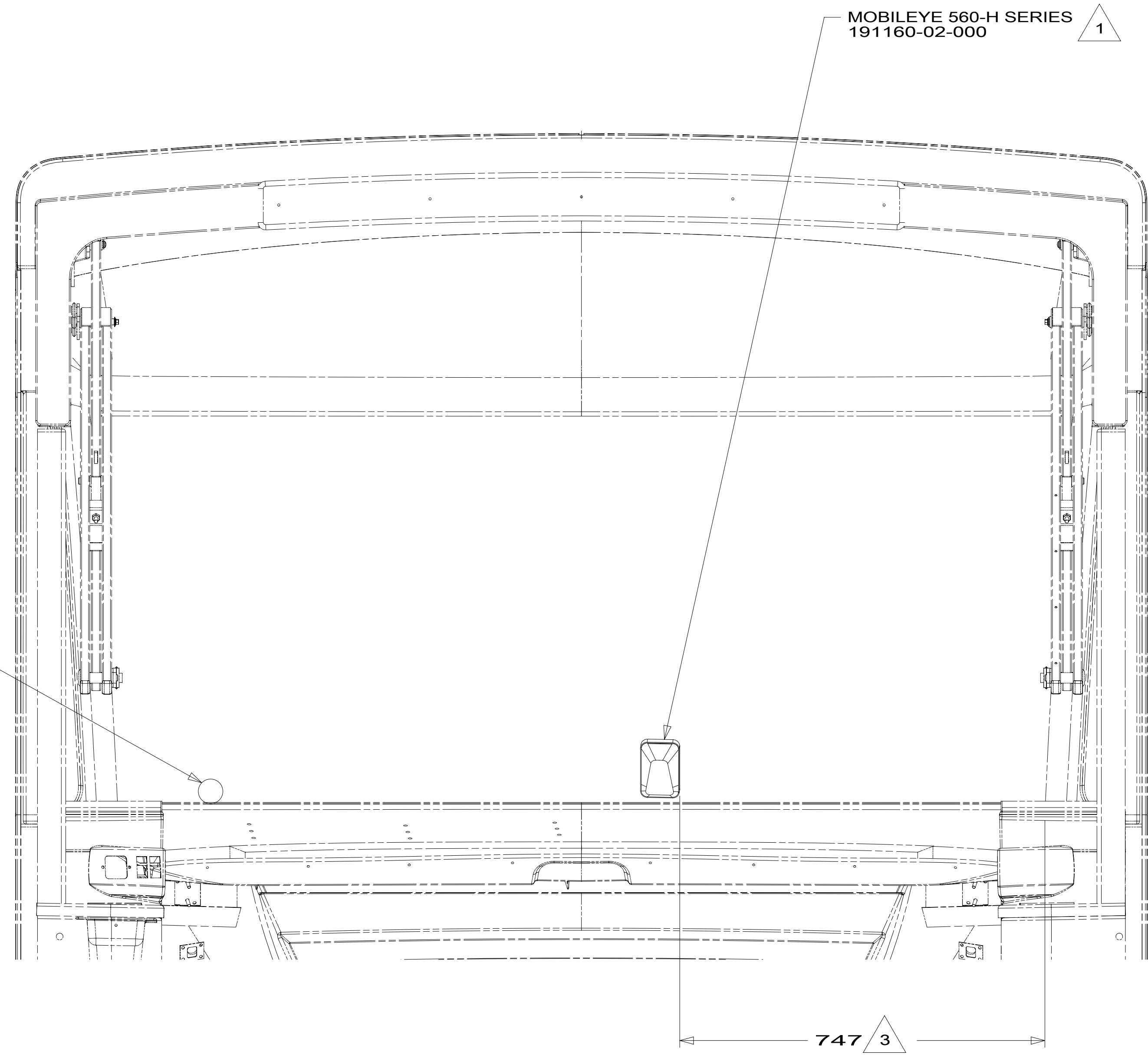

- NOTES:
- 3 MEASURE FROM BLACK EDGE OF WINDSHIELD TO SIDE OF CAMERA HOUSING.
  - 2 ATTACH TO CHASSIS SUPPLIED DASH. ROUTE CABLE UNDER PANEL-DASH,CENTER TO CENTER AND CONNECT TO MAIN MOBILEYE HARNESS BEHIND CENTER CLUSTER.
  - 1 ATTACH TO WINDSHIELD AS LOW AS POSSIBLE. ROUTE CABLE BELOW DASH TO LEFT SIDE WITH DISPLAY CABLE. THEN TO CENTER OF DASH TO CONNECT TO I.P. MAIN.

- 36C COLLISION AVOIDANCE SYSTEM
- 265 CODES/STANDARDS-CSA/CMVSS
- 1B1 CODES/STANDARDS USA

1B1 265 1ME

FIRST USED	
<b>15 H-SERIES</b>	
DO NOT SCALE DRAWING	
TITLE: <b>WIRING INSTL-FRONT END</b>	
SHEET 9	PART NO <b>188807</b> REV

FOR ELECTRICAL TORQUE SPECIFICATIONS SEE DWG NO. 128783-01-000

FOR ELECTRICAL CALLOUTS SEE DWG NO. 121339-01-000

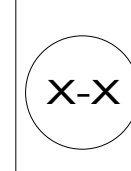

\*188807\*