



DANGER

Danger of electrical shock, burns or death. Always remove all power sources before attempting any repair, service or diagnostic work. Power can be present from shore power, generator, inverter or battery. All power sources must be disabled and secured before performing any service.



CAUTION

If you lack the skills, tools or equipment to perform diagnostic or repair work leave such work to an authorized Winnebago Industries dealer or other qualified shop.

DRAWING NO.	MODELS
187600-01	R42QL,R42HL
187600-02	R42QD,R42HD,R42GD

RELEASE	REV/DATE	DWG NO	187600
REV ZONE	REVISION RECORD	DATE	DTR-ORIG

D
C
B
A

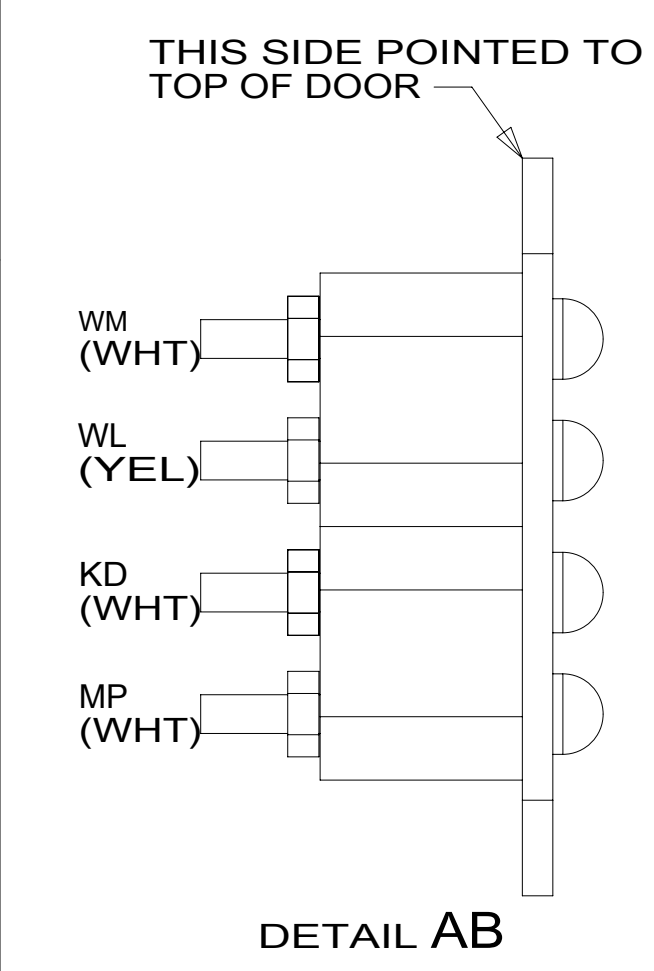
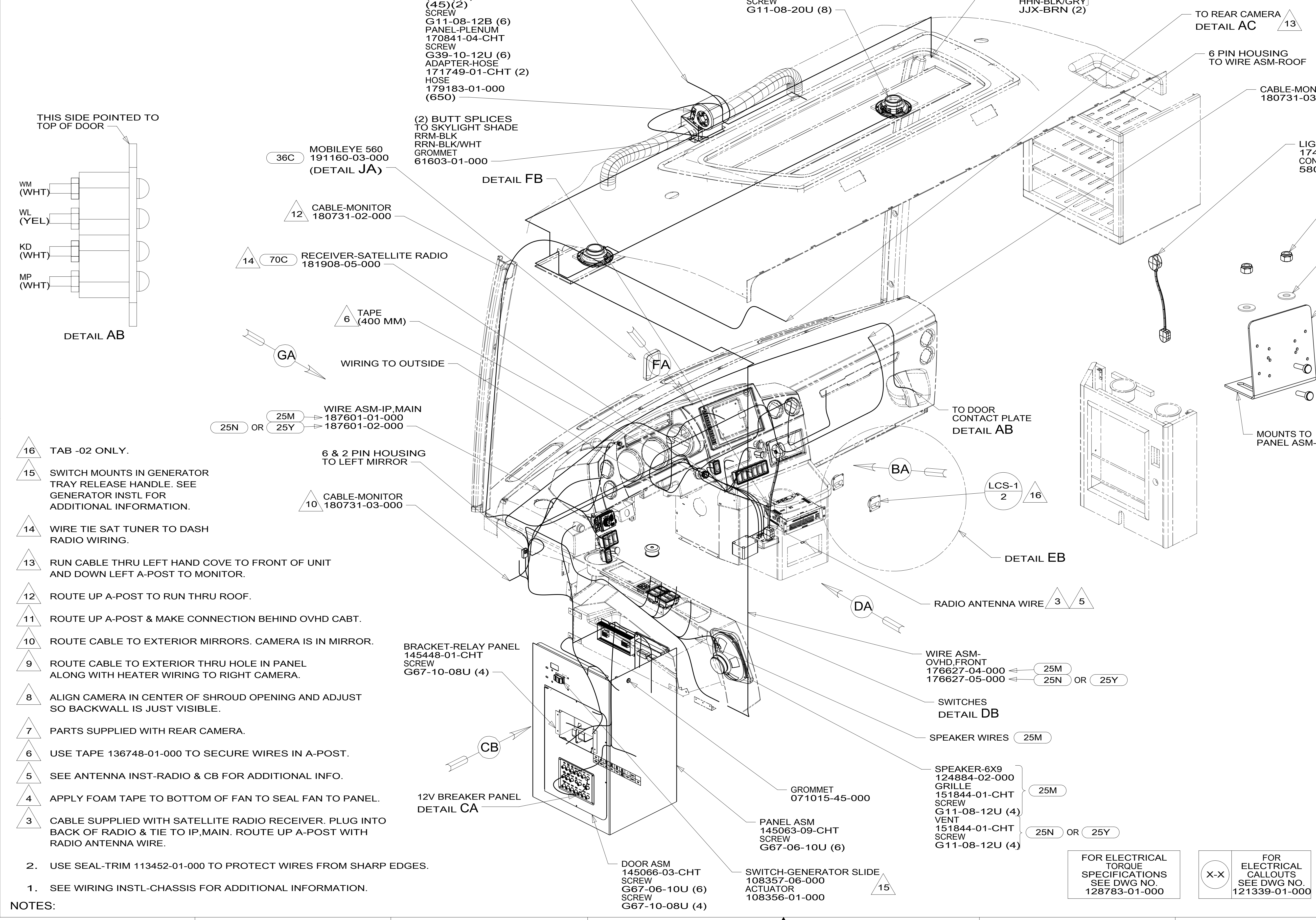

- NOTES:
- SEE WIRING INSTL-CHASSIS FOR ADDITIONAL INFORMATION.
 - USE SEAL-TRIM 113452-01-000 TO PROTECT WIRES FROM SHARP EDGES.
- 16 TAB -02 ONLY.
- 15 SWITCH MOUNTS IN GENERATOR TRAY RELEASE HANDLE. SEE GENERATOR INSTL FOR ADDITIONAL INFORMATION.
- 14 WIRE TIE SAT TUNER TO DASH RADIO WIRING.
- 13 RUN CABLE THRU LEFT HAND COVE TO FRONT OF UNIT AND DOWN LEFT A-POST TO MONITOR.
- 12 ROUTE UP A-POST TO RUN THRU ROOF.
- 11 ROUTE UP A-POST & MAKE CONNECTION BEHIND OVHD CABT.
- 10 ROUTE CABLE TO EXTERIOR MIRRORS. CAMERA IS IN MIRROR.
- 9 ROUTE CABLE TO EXTERIOR THRU HOLE IN PANEL ALONG WITH HEATER WIRING TO RIGHT CAMERA.
- 8 ALIGN CAMERA IN CENTER OF SHROUD OPENING AND ADJUST SO BACKWALL IS JUST VISIBLE.
- 7 PARTS SUPPLIED WITH REAR CAMERA.
- 6 USE TAPE 136748-01-000 TO SECURE WIRES IN A-POST.
- 5 SEE ANTENNA INST-RADIO & CB FOR ADDITIONAL INFO.
- 4 APPLY FOAM TAPE TO BOTTOM OF FAN TO SEAL FAN TO PANEL.
- 3 CABLE SUPPLIED WITH SATELLITE RADIO RECEIVER. PLUG INTO BACK OF RADIO & TIE TO IP,MAIN. ROUTE UP A-POST WITH RADIO ANTENNA WIRE.

8 7 6 5 4 3 2 1

- 36C COLLISION AVOIDANCE SYSTEM
- 25Y HOMETHEATER SOUNDBAR SYS-PRM
- 25N HOME THEATER SOUNDBAR SYSTEM
- 25M HOME THEATER SYSTEM, BLU-RAY
- 70C RADIO - SATELLITE
- 265 CODES/STANDARDS-CSA/CMVSS
- 1B1 CODES/STANDARDS USA

		COPYRIGHT 2014 WINNEBAGO INDUSTRIES, INC.	
DTR	ORIG. DATE	ALL DIMENSIONS ARE IN MILLIMETERS	
CHKR		FIRST USED	
P.E.		15 R-SERIES	
M.E.		UNSPECIFIED TOLERANCES ARE:	
DSNR		WHOLE DIM (X)	: 3
		ONE-PLACE (X.X)	: 1.5
		TWO-PLACE (X.XX)	: 0.50
		ANGLE	: 1°
		THIRD ANGLE PROJECTION	
DO NOT SCALE DRAWING		REFER TO ES0018 FOR FASTENER TIGHTENING GUIDELINES	
TITLE: WIRING INSTL-FRONT END			
SHEET 1 OF 9	PART NO 187600	REV	
REF:	1	07-Oct-2015	

8 7 6 5 4 3 2 1

FOR ELECTRICAL TORQUE SPECIFICATIONS SEE DWG NO. 128783-01-000

FOR ELECTRICAL CALLOUTS SEE DWG NO. 121339-01-000

D
C
B
A

187600

WIRE ASM-IP,MAIN

LABEL-CB PREP OPTION
104678-01-000

FUSE-5 AMP
062901-02-000

(2) BUTT SPLICES
TO CB PREP
DETAIL BB

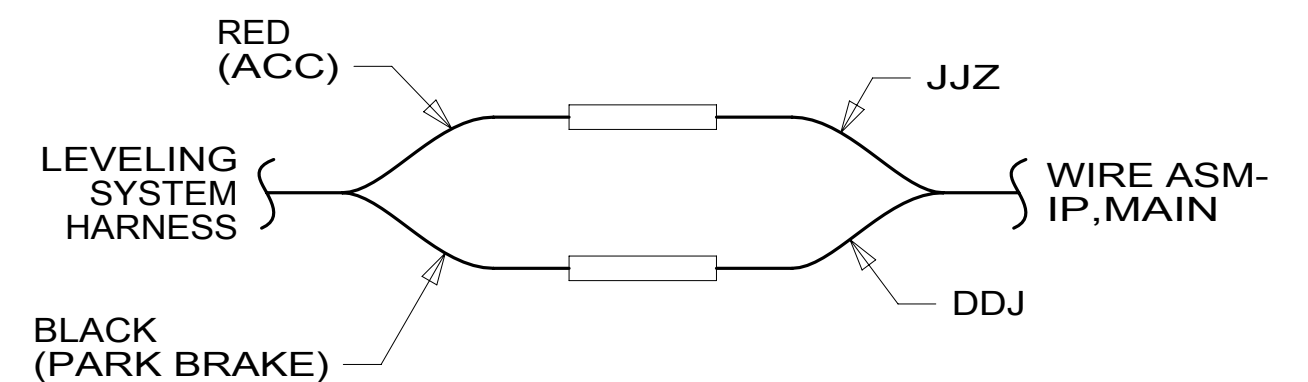

DETAIL BC

CB POWER PROVISION
YELLOW +12V
WHITE GROUND
COAX ANTENNA
(SEE REVERSE SIDE ALSO)

WHT YEL
TO CUSTOMERS
CB RADIO

DETAIL BB 579

BUTT SPLICES (2)
TO LEVELING
SYSTEM
DETAIL BC

2 PIN HOUSING
(2) BUTT SPLICES

RING TERMINALS
TO GROUND STUD

ALARM-JACKS DOWN
160876-01-000

2 PIN HOUSINGS
TO HEATER/AC CONTROLS

RADIO WIRING

TO SWITCHES
DETAIL EB

(2) SPADE TERINALS
TO LEFT SUBWOOFER

WIRE ASM-OVHD
ROUTES UP B-POST COVER

DIAGNOSTIC CONNECTOR
(CHASSIS SUPPLIED)
SCREW
G39-06-06B (4)

RADIO ANTENNA CABLE
& SAT RADIO WIRING ONLY

GROMMET
23942-01-000
FOAM
110744-03-000 (A/R)

DETAIL BA

- 579 RADIO - CB WIRE PREP
- 265 CODES/STANDARDS-CSA/CMVSS
- 1B1 CODES/STANDARDS USA

1B1 265

FIRST USED	
15 R-SERIES	
DO NOT SCALE DRAWING	
TITLE: WIRING INSTL-FRONT END	
SHEET 2	PART NO 187600 REV
1 07-Oct-2015	

FOR ELECTRICAL
TORQUE
SPECIFICATIONS
SEE DWG NO.
128783-01-000

FOR ELECTRICAL
CALLOUTS
SEE DWG NO.
121339-01-000

- NOTES:
- 2 EDGE OF LABEL TO HANG JUST BELOW BOTTOM OF DASH.
 - 1 ROUTE WIRES UP LEFT A-PILLAR.

187600

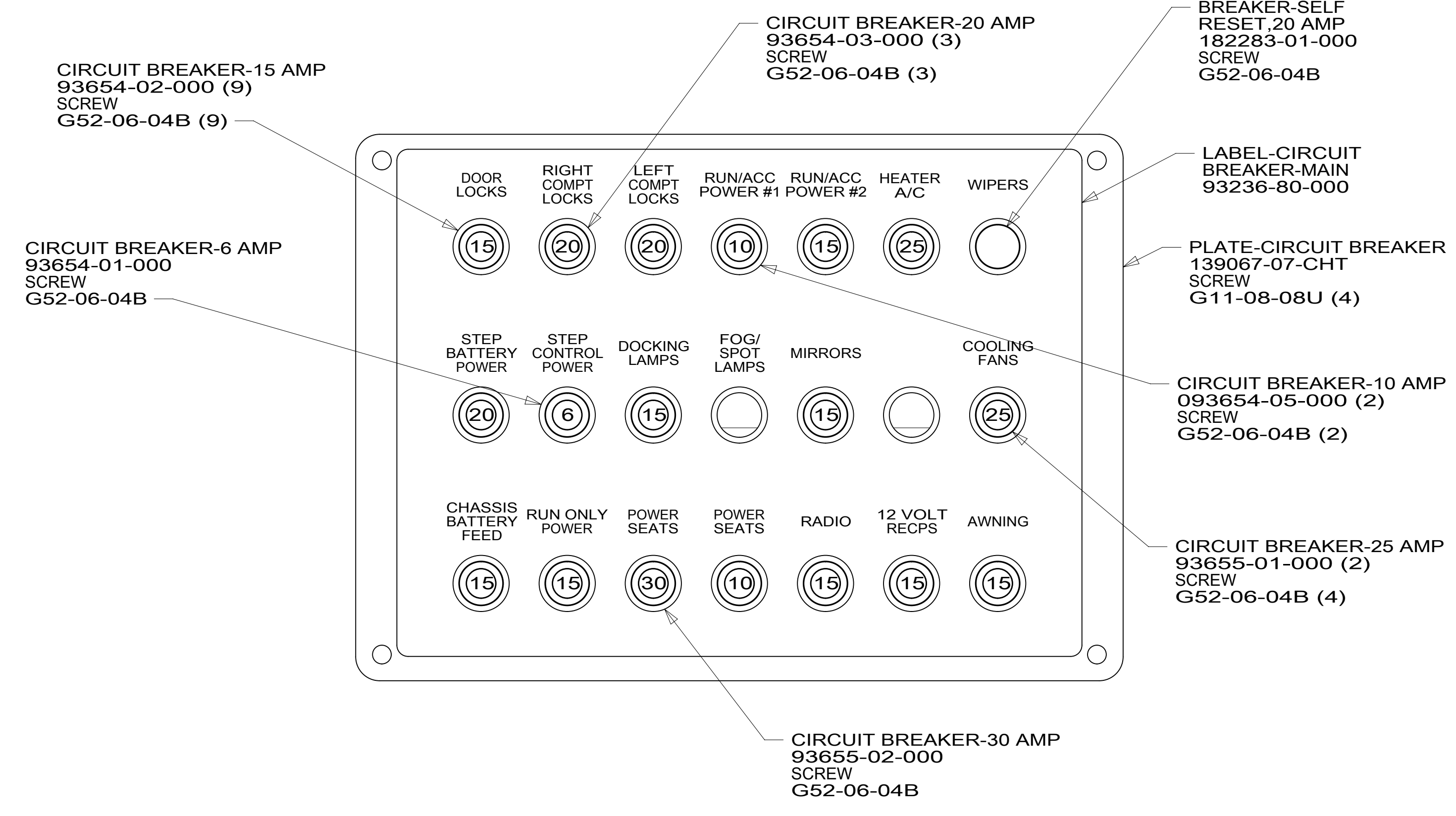
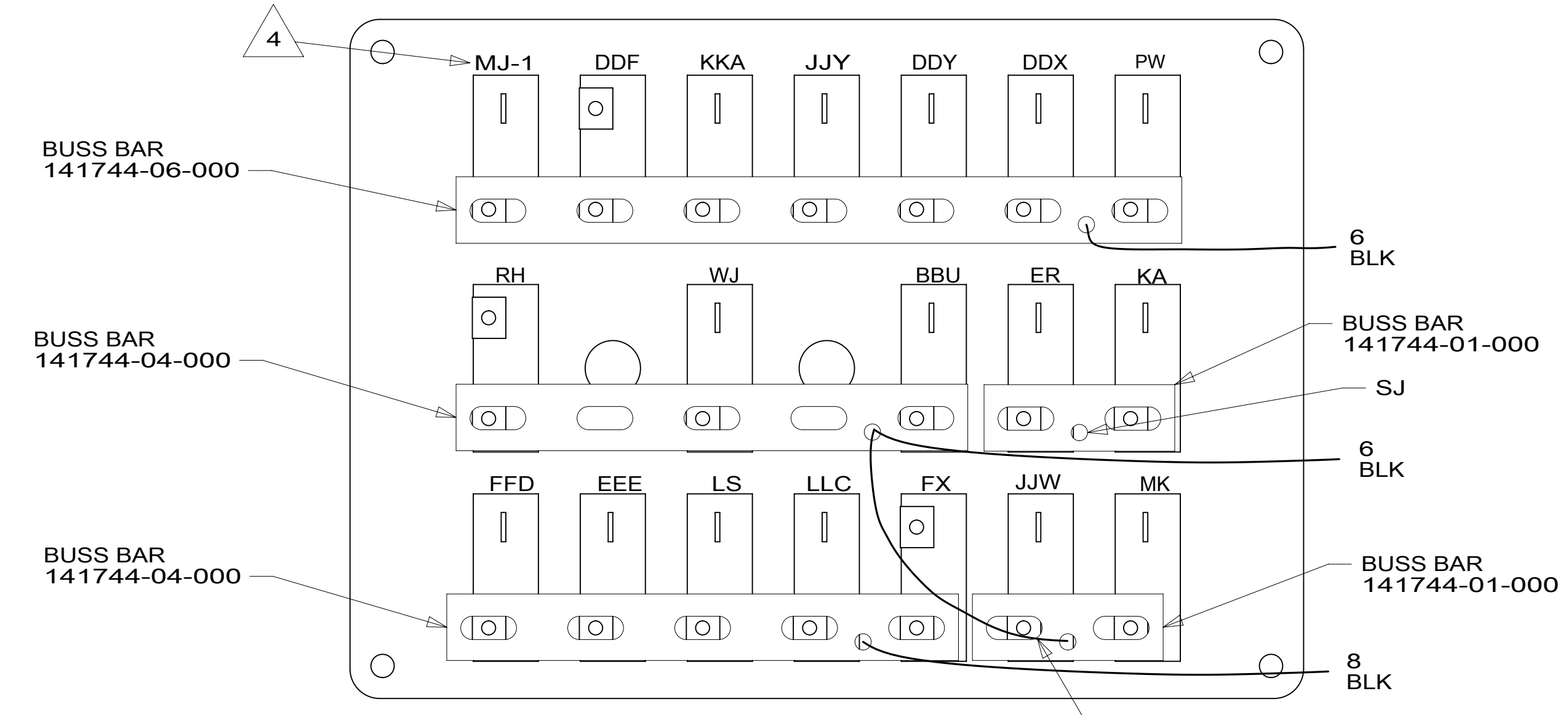
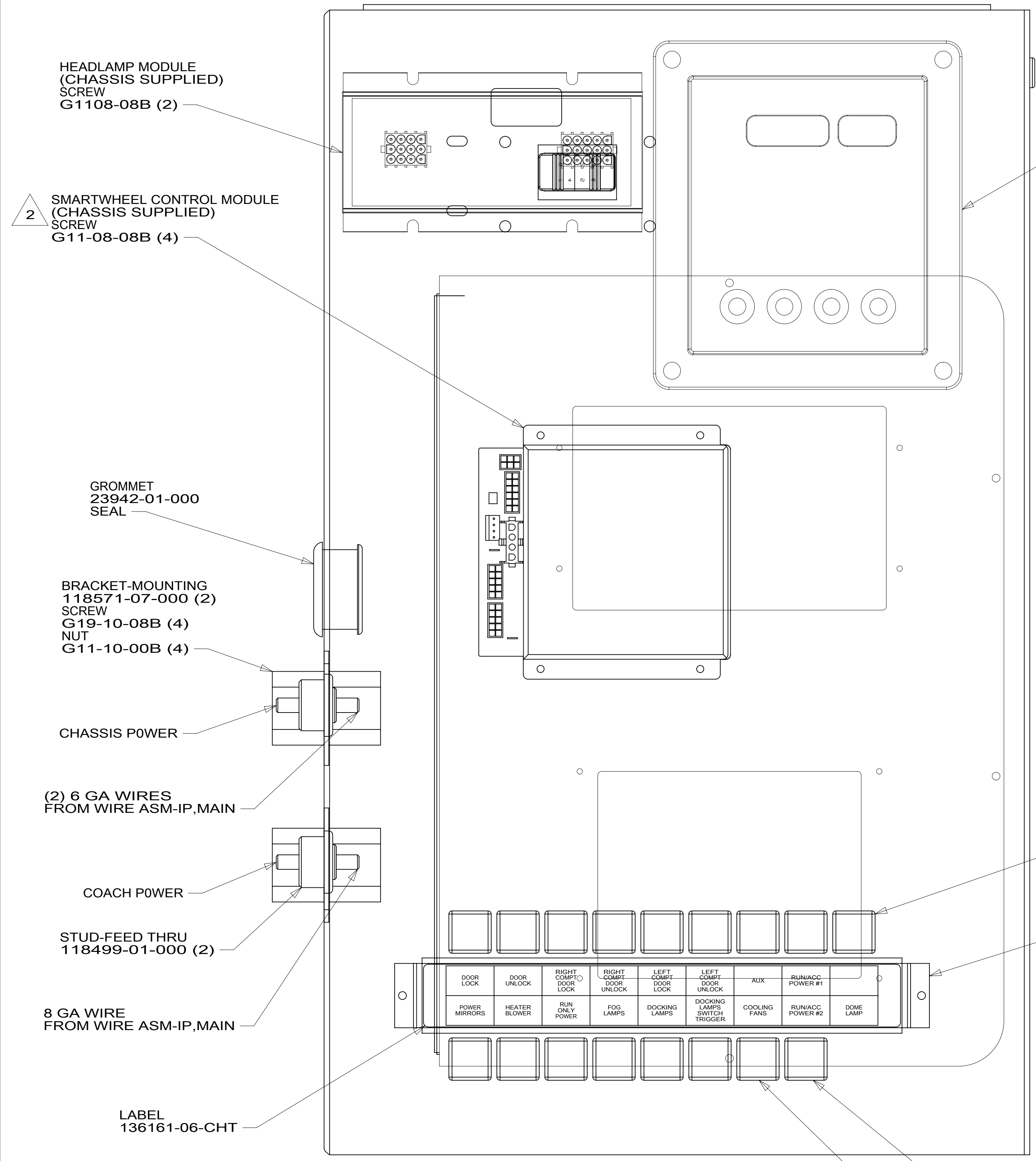

- NOTES:
- 4 FROM WIRE ASM-WIPER.
 - 3 SEAL ALL SCREWS ON EXTERIOR SIDE OF COMPARTMENT. REFER TO SEALANT MANUAL.
 - 2 CHASSIS SUPPLIED LOOM IS LABELED TO CORRESPOND WITH LABEL ON MODULE.
 - 1 CIRCUITS LABELED ON BREAKER ARE FROM WIRE ASM-IP, MAIN, UNLESS OTHERWISE SPECIFIED.

RELAY 63912-02-000 (16) SCREW G11-08-08B (16)

RELAY 63912-02-000 SCREW G11-08-08B (FOR WIRE ASM-WIPER)

FOR ELECTRICAL TORQUE SPECIFICATIONS SEE DWG NO. 128783-01-000

FOR ELECTRICAL CALLOUTS SEE DWG NO. 121339-01-000

265 CODES/STANDARDS-CSA/CMVSS
 1B1 CODES/STANDARDS USA
 1B1 265

FIRST USED

15 R-SERIES

DO NOT SCALE DRAWING

TITLE: **WIRING INSTL-FRONT END**

SHEET 3 PART NO **187600** REV

1 07-Oct-2015

187600

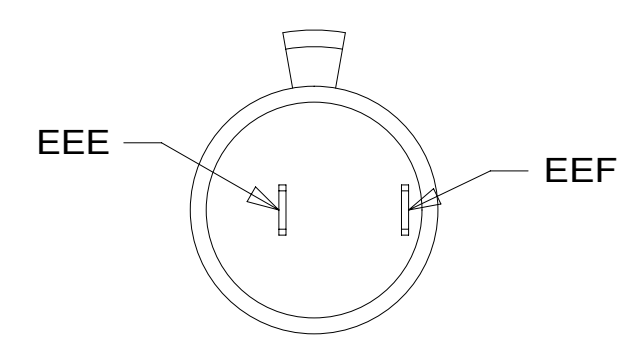

DETAIL DC

1 LIGHT ASM-INDICATOR,RED
190682-01-000

4 CLUSTER
(CHASSIS SUPPLIED)

PANEL-SWITCH
174834-01-CHT
SWITCH-DEFROST FAN
174757-14-CHT

RADIO-INFOTAINMENT
190062-02-000
SENSOR-TEMPERATURE
176654-13-000
REMOTE-NAVIGATION/RADIO
176654-04-000
LABEL
176654-06-CHT

REMOTE CONTROL
163142-13-000
RECEIVER-INFRARED
163142-11-000

SWITCH-GEN SET
174757-05-CHT

USB-CHARGER DUAL,DC
188312-01-000
(DO NOT USE PLATE)

SWITCH-ENTRY DOOR LOCK
174757-02-CHT

RECEPTACLE-12V
111414-01-000
DETAIL DC

SWITCH-RADIO POWER
174757-12-CHT

SWITCH-FRONT AUX
174757-35-CHT

PANEL-SWITCH
MOUNTING,6-WAY
174834-04-CHT

7" MONITOR BRACKET
183210-01-CHT
SCREW
G11-10-10U (4)
WASHER
E13-10-00U (4)

DVD/CARD READER

CAMERA SWITCHER
(ON FLOOR BEHIND
METAL PANEL)

12 SWITCH-HEADLAMP
(CHASSIS SUPPLIED)
MOUNT-SWITCH,HDLP,RH
167563-05-CHT
MOUNT-SWITCH,HDLP,LH
167563-06-CHT
SCREW
G39-08-08U (4)

PANEL-SWITCH
MOUNTING,3-WAY
174834-02-CHT

2 SWITCH-PEDAL ADJUST
174757-32-CHT
WIRE ASM-PEDAL ADJUST
157534-09-000
DETAIL DC

SWITCH-
DOCKING LIGHTS
174757-24-CHT

SWITCH-MIRROR HEAT
174757-25-CHT
PANEL
174834-01-CHT

10 SWITCH-IGNITION
185422-01-000

14 SWITCH
174757-39-CHT
BLANK
11 145754-01-CHT

SWITCH-AIR HORN
174757-13-CHT

RECEPTACLE-12V
111414-01-000
DETAIL DC

SWITCH-
BATTERY BOOST
174757-31-CHT

DETAIL DA

- 14 TAB -01 ONLY.
- 13 CHASSIS SUPPLIED ROCKER SWITCHES. DOME LAMP SWITCH NOT USED. SEE DETAIL DD FOR SWITCH POSITION.
- 12 CHASSIS SUPPLIED COMPOSITE SWITCH
- 11 TAB -02 ONLY.
- 10 REPLACE CHASSIS SUPPLIED IGNITION SWITCH.
- 9 APPLY LABEL OVER "WB" BUTTON. SEE DETAIL FC.
- 8 MOUNT GPS ANTENNA ON TOP OF DEFROST PLENUM.
- 7 TO BE SUPPLIED LOOSE IN WINNEBAGO OWNERS CASE.
- 6 INSTALL PER DRAWING 170205.
- 5 ROUTE TEMP SENSOR THRU HOLE IN BULKHEAD TO BRACKET (SEE SHT 7).
- 4 SEE DETAIL EA FOR GAUGE PLACEMENT.
- 3 MOUNT SWITCH SO WHEN ACTUATOR IS PUSHED LEFT, THE LETTER L IS SHOWING.
- 2 CONNECT TO MATING LABELED CONNECTOR ON CHASSIS SUPPLIED WIRING.
- 1 CONNECT POSITIVE WIRE TO TERMINAL MARKED WITH A "RED", YEL-WINNEBAGO WIRING

NOTES:

PANEL-SWITCH
MOUNTING,3-WAY
174834-02-CHT

SWITCH-EXCHANGE
BRAKE ON/OFF
174757-40-CHT

2 SWITCH-ENGINE BRK HI/MED/LOW
174757-41-CHT
WIRE ASM-ENGINE
BRAKE SWITCH
157534-12-000

2 SWITCH-TAG AIR DUMP
174757-26-CHT
WIRE ASM-TAG
AXLE SWITCH
157534-08-000

PANEL-SWITCH
MOUNTING,3-WAY
174834-02-CHT 11

SWITCH-SOLAR SHADE
174757-10-CHT 11

SWITCH-NIGHT SHADE
174757-11-CHT 11

SWITCH-BLANK
145754-01-CHT 11

SWITCH-MIRROR
CONTROLS
88246-01-000
SPACER-SWITCH,MIRROR
184039-01-CHT 3

PLATE-SWITCH
118662-25-CHT
NUT
D65-08-00U (2)
WASHER
E13-10-00U (2)

DETAIL DB



DETAIL DD

FOR ELECTRICAL
TORQUE
SPECIFICATIONS
SEE DWG NO.
128783-01-000

FOR
ELECTRICAL
CALLOUTS
SEE DWG NO.
121339-01-000

- 15D INFOTAINMENT CENTER/GPS
- 265 CODES/STANDARDS-CSA/CMVSS
- 1B1 CODES/STANDARDS USA

1B1	265
FIRST USED	
15 R-SERIES	
DO NOT SCALE DRAWING	
TITLE: WIRING INSTL-FRONT END	
SHEET 4	PART NO 187600 REV

*187600

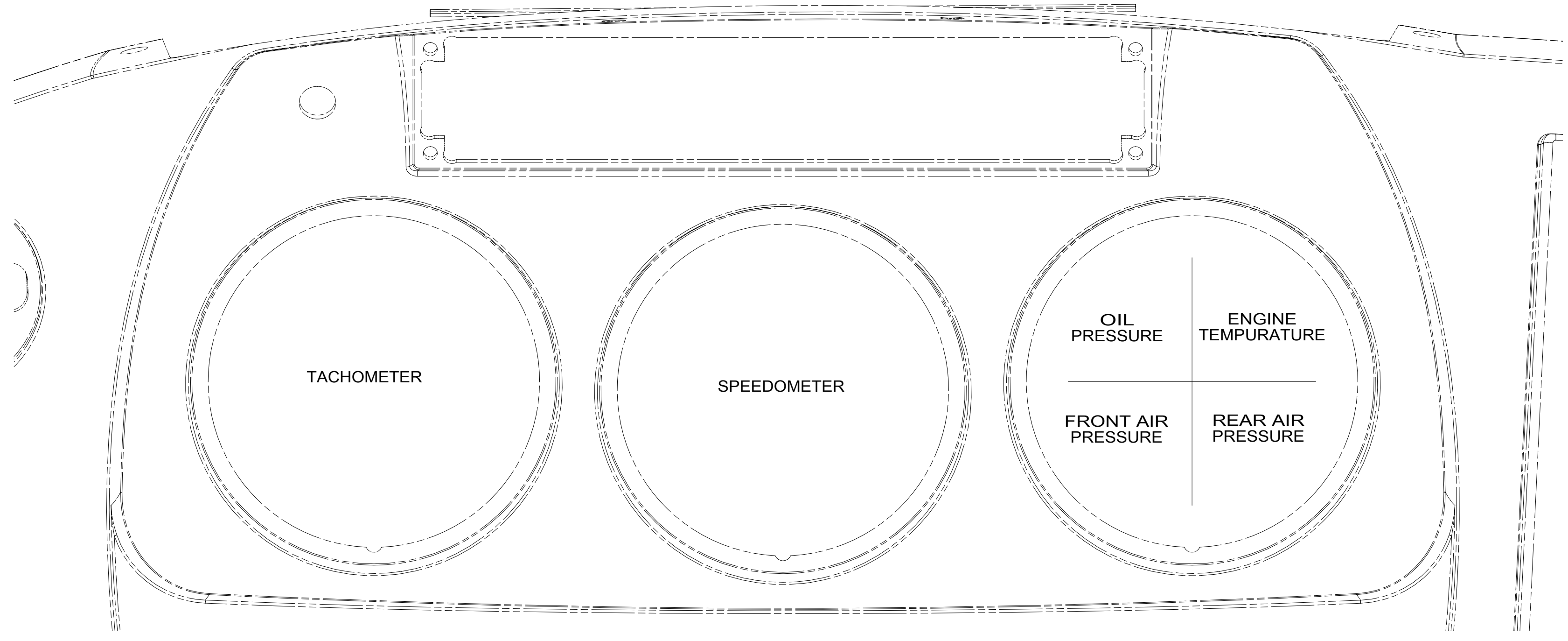

DETAIL EA 1

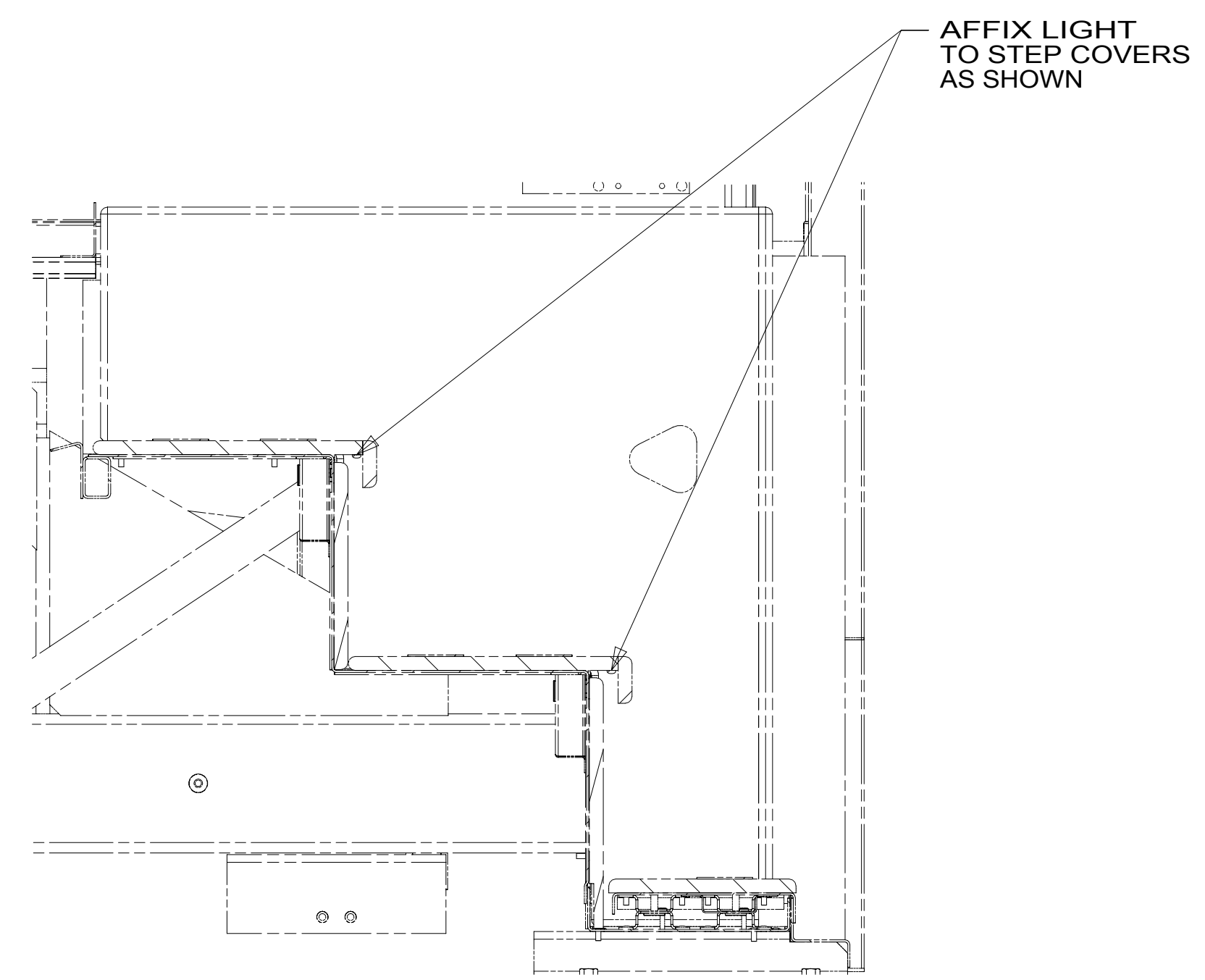

VIEW EC

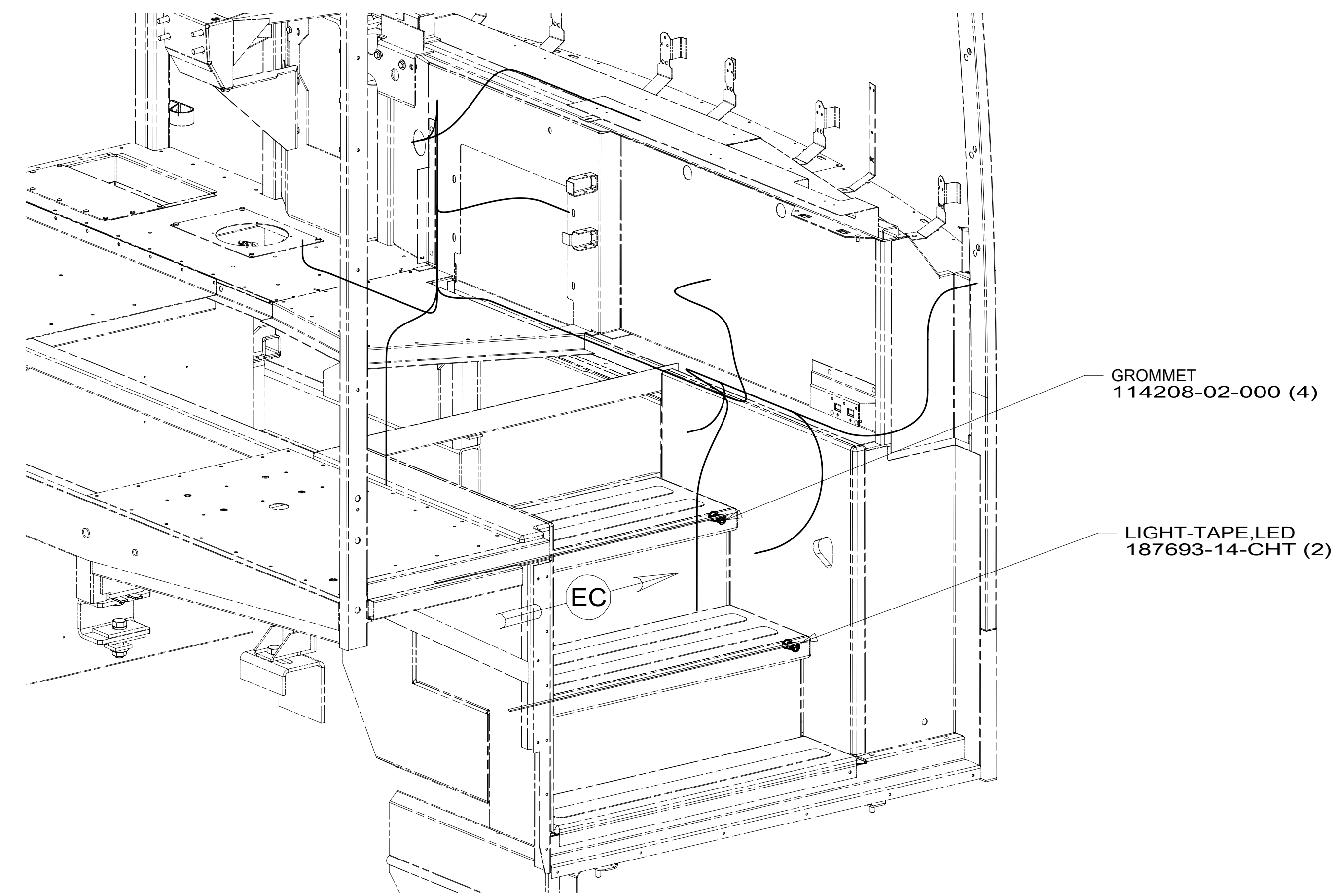

DETAIL EB 2

NOTES:
 2 TAB -01 ONLY.
 1 ALL STANDARD GAUGES, RETAINER CLIPS AND FASTENERS ARE CHASSIS SUPPLIED.

FOR ELECTRICAL TORQUE SPECIFICATIONS SEE DWG NO. 128783-01-000

FOR ELECTRICAL CALLOUTS SEE DWG NO. 121339-01-000

265 CODES/STANDARDS-CSA/CMVSS
 1B1 CODES/STANDARDS USA
 1B1 265

FIRST USED	
15 R-SERIES	
DO NOT SCALE DRAWING	
TITLE: WIRING INSTL-FRONT END	
SHEET 5	PART NO 187600 REV

187600

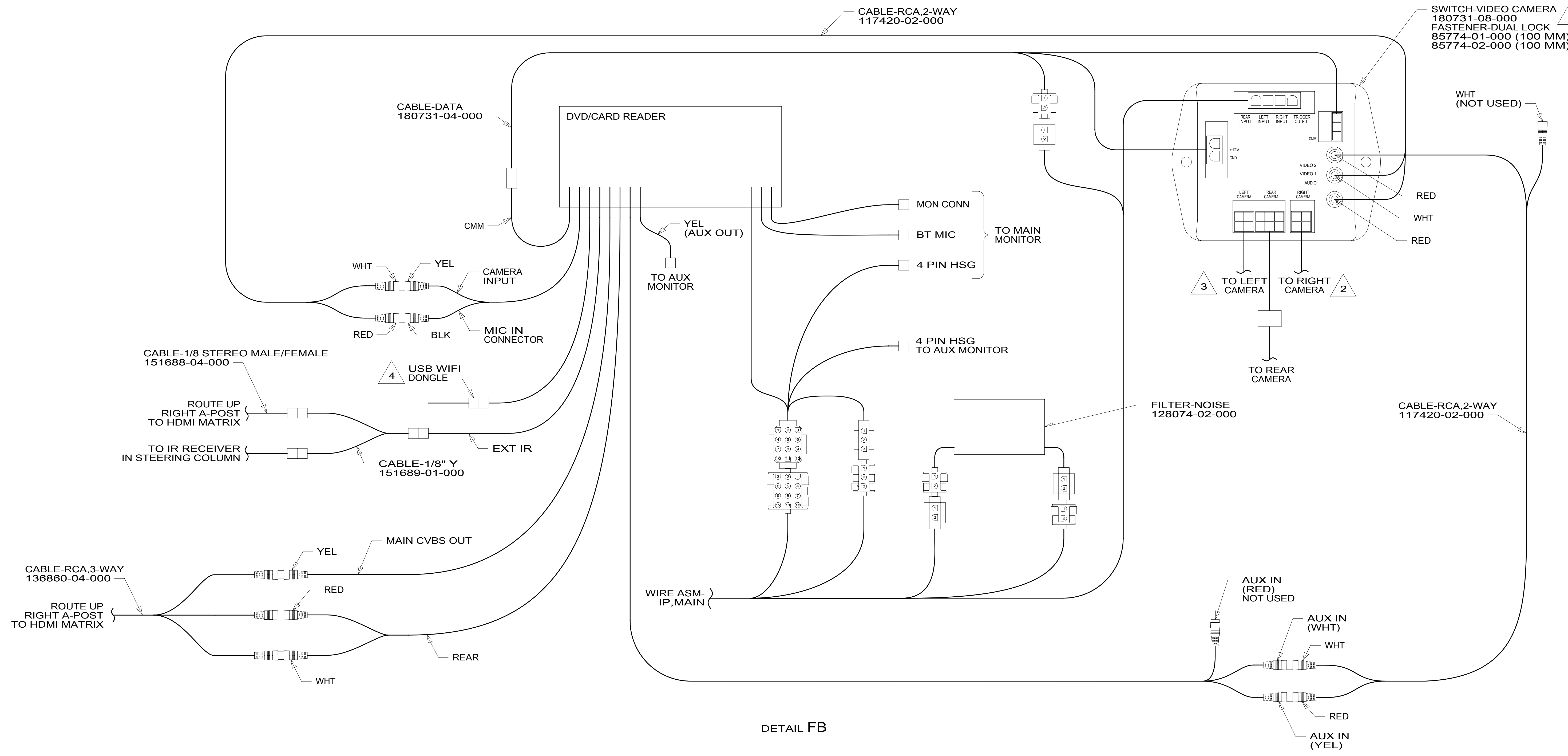

DETAIL FB

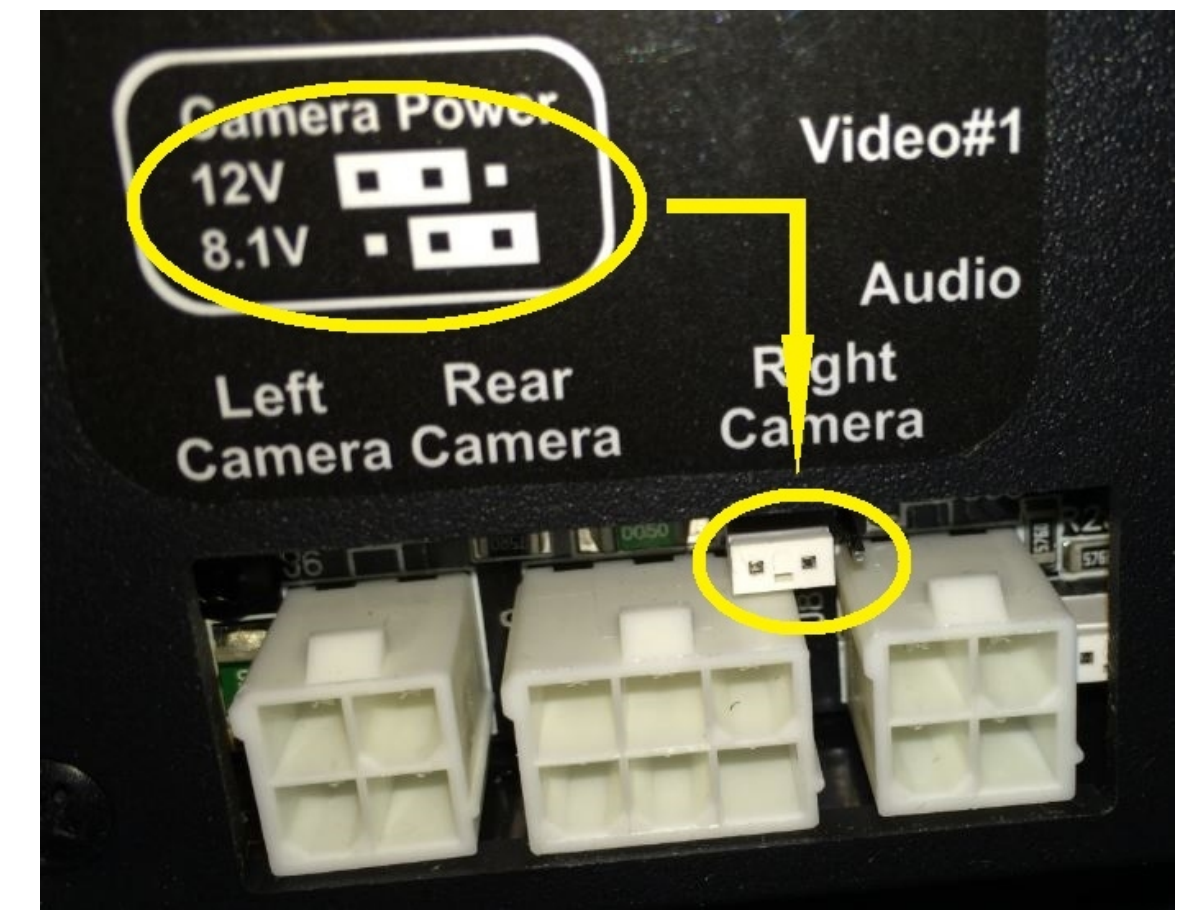

DETAIL FD

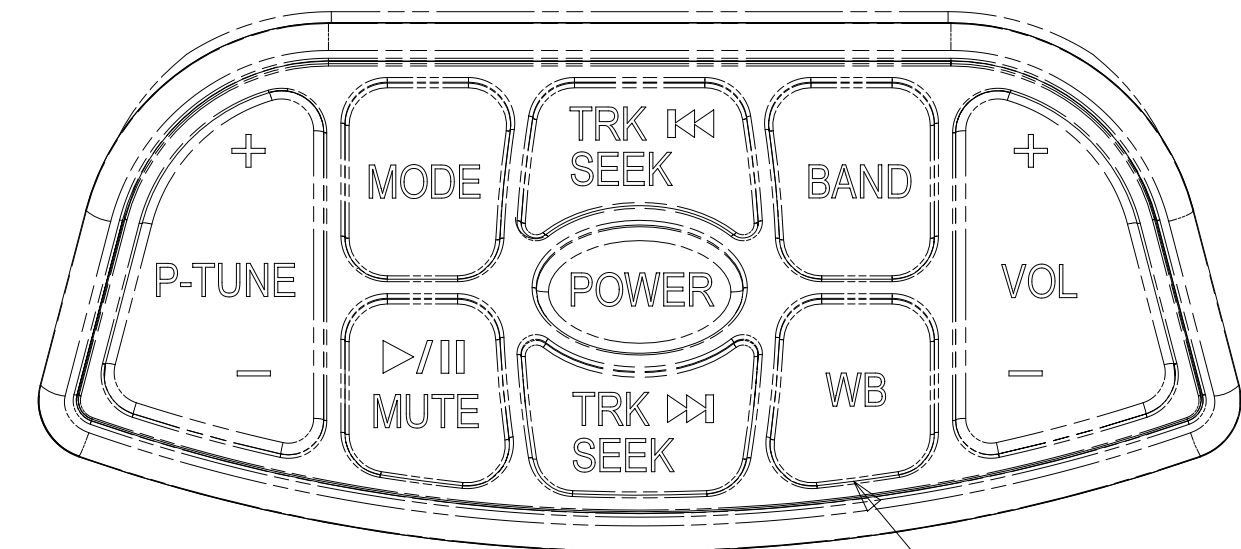

DETAIL FC

APPLY LABEL OVER THIS BUTTON

FOR ELECTRICAL TORQUE SPECIFICATIONS SEE DWG NO. 128783-01-000

FOR ELECTRICAL CALLOUTS SEE DWG NO. 121339-01-000

- 19V RADIO-AM/FM STEREO CD PLAYER
- 74L VIDEO CAMERA SYS W/COLOR MON
- 265 CODES/STANDARDS-CSA/CMVSS
- 1B1 CODES/STANDARDS USA

1B1	265	74L	19V
FIRST USED			
15 R-SERIES			
DO NOT SCALE DRAWING			
TITLE: WIRING INSTL-FRONT END			
SHEET 6	PART NO	187600	REV

- NOTES:
- 5 ENSURE CAMERA POWER JUMPER IS IN 12 VOLT POSITION. MOVE TO 12V POSITION IF NECESSARY. SEE DETAIL FD
 - 4 SUPPLIED WITH RADIO.
 - 3 MARK LEFT CABLE WITH YELLOW TAPE 900000-07-000 NEXT TO CONNECTOR.
 - 2 MARK RIGHT CABLE WITH WHITE TAPE 900000-08-000 NEXT TO CONNECTOR.
 1. APPLY TAPE 8363-01-000 AS NECESSARY TO SECURE NON-LOCKING CONNECTIONS.

*187600

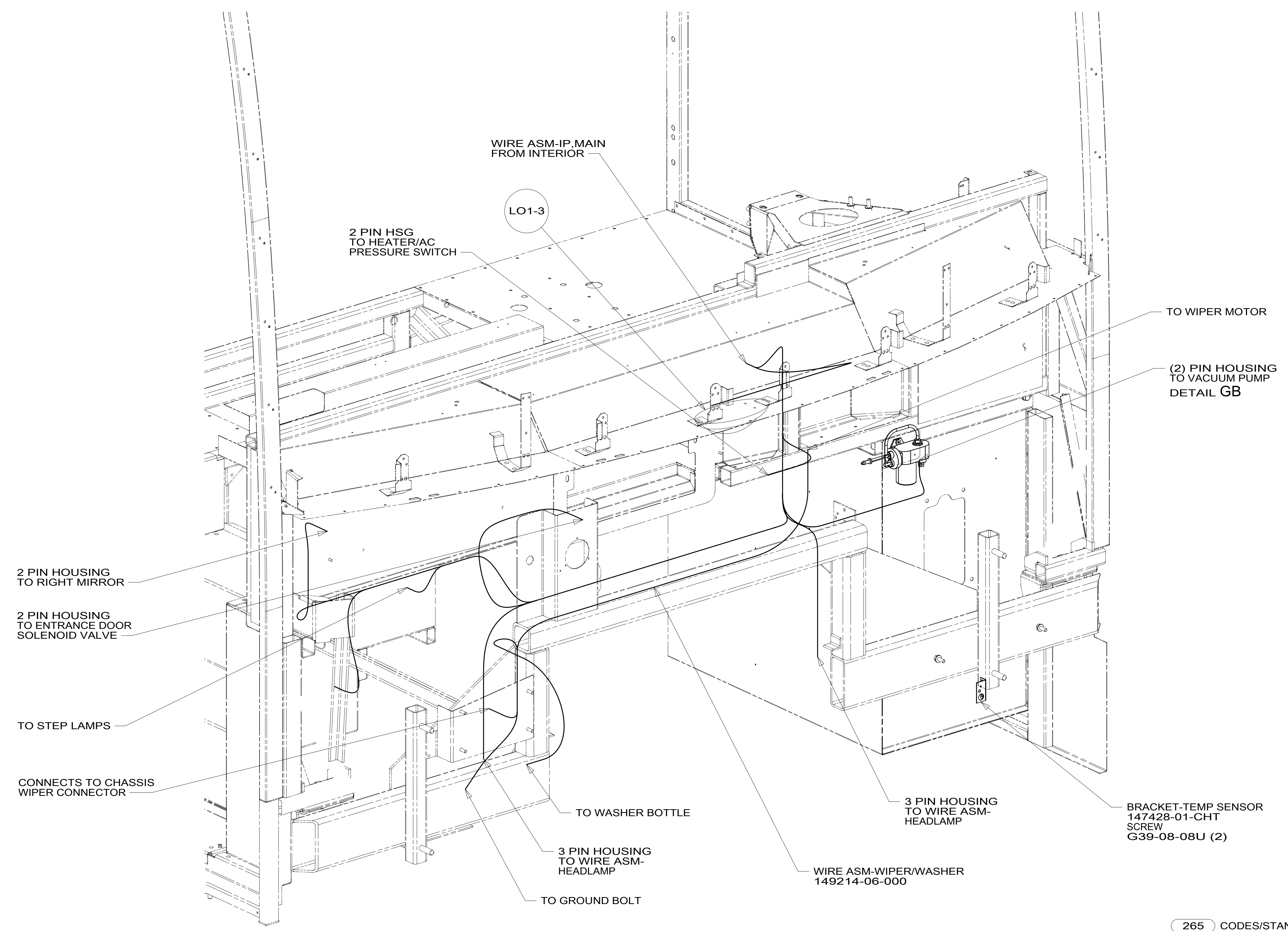
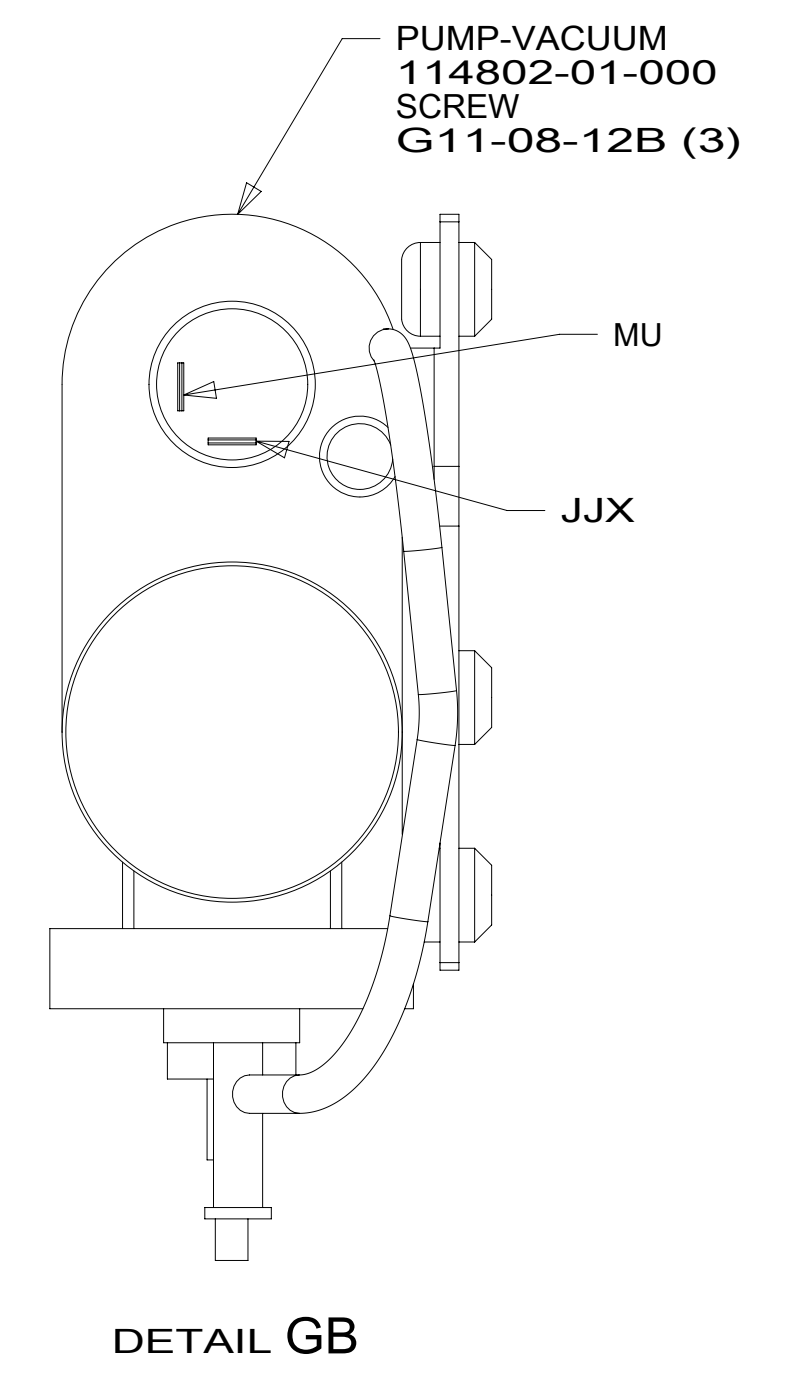

VIEW GA

- 265 CODES/STANDARDS-CSA/CMVSS
- 1B1 CODES/STANDARDS USA
- 1B1 265

FOR ELECTRICAL TORQUE SPECIFICATIONS SEE DWG NO. 128783-01-000

FOR ELECTRICAL CALLOUTS SEE DWG NO. 121339-01-000

FIRST USED

15 R-SERIES

DO NOT SCALE DRAWING

TITLE: **WIRING INSTL-FRONT END**

SHEET 7 PART NO **187600** REV

1 07-Oct-2015

187600

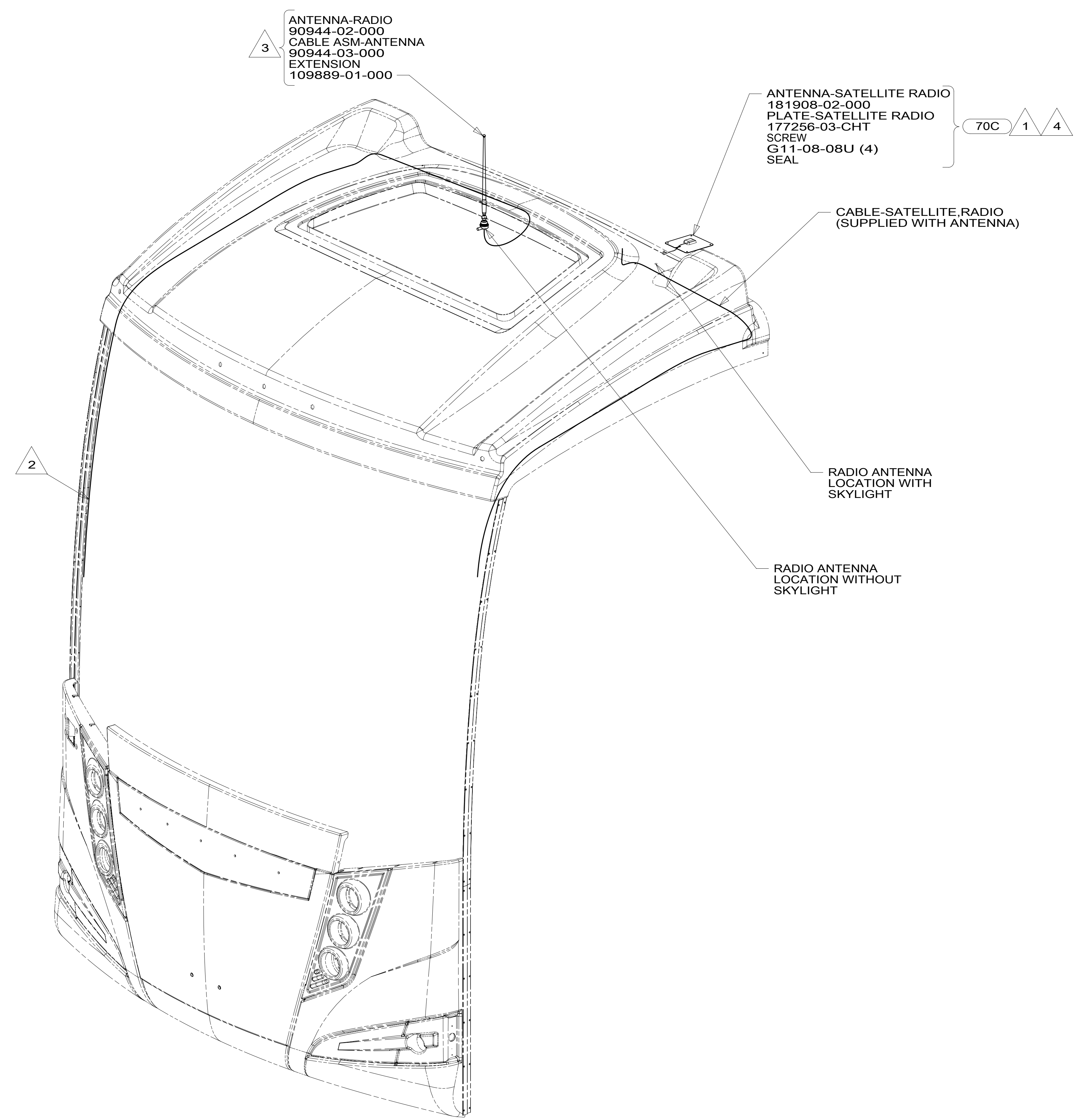

- 4 LOCATED ON ROOF ASM WITH SKYLIGHT OPTION, LOCATED ON ROOF CAP WITHOUT SKYLIGHT.
- 3 SEAL AROUND ANTENNA BASE.
- 2 ROUTE CABLE ALONG A-POST, UNDER TRIM COVER.
- 1 MOUNT ANTENNA SUCH THAT BASE IS SQUARE W/REAR OF ROOF CAP & HOLE IS DIRECTLY OVER HOLE IN FIBERGLASS. SEAL HOLE IN ROOF CAP, BASE AT SCREWS.

NOTES:

- 70C RADIO - SATELLITE
- 265 CODES/STANDARDS-CSA/CMVSS
- 1B1 CODES/STANDARDS USA

FIRST USED	
15 R-SERIES	
DO NOT SCALE DRAWING	
TITLE: WIRING INSTL-FRONT END	
SHEET 8	PART NO 187600 REV
1 07-Oct-2015	

FOR ELECTRICAL TORQUE SPECIFICATIONS SEE DWG NO. 128783-01-000

FOR ELECTRICAL CALLOUTS SEE DWG NO. 121339-01-000

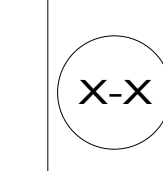

187600

MOUNT ON TOP OF DASH POD LEFT OF CLUSTER. ROUTE CABLE IN SEAM UNDER REMOVEABLE TOP.

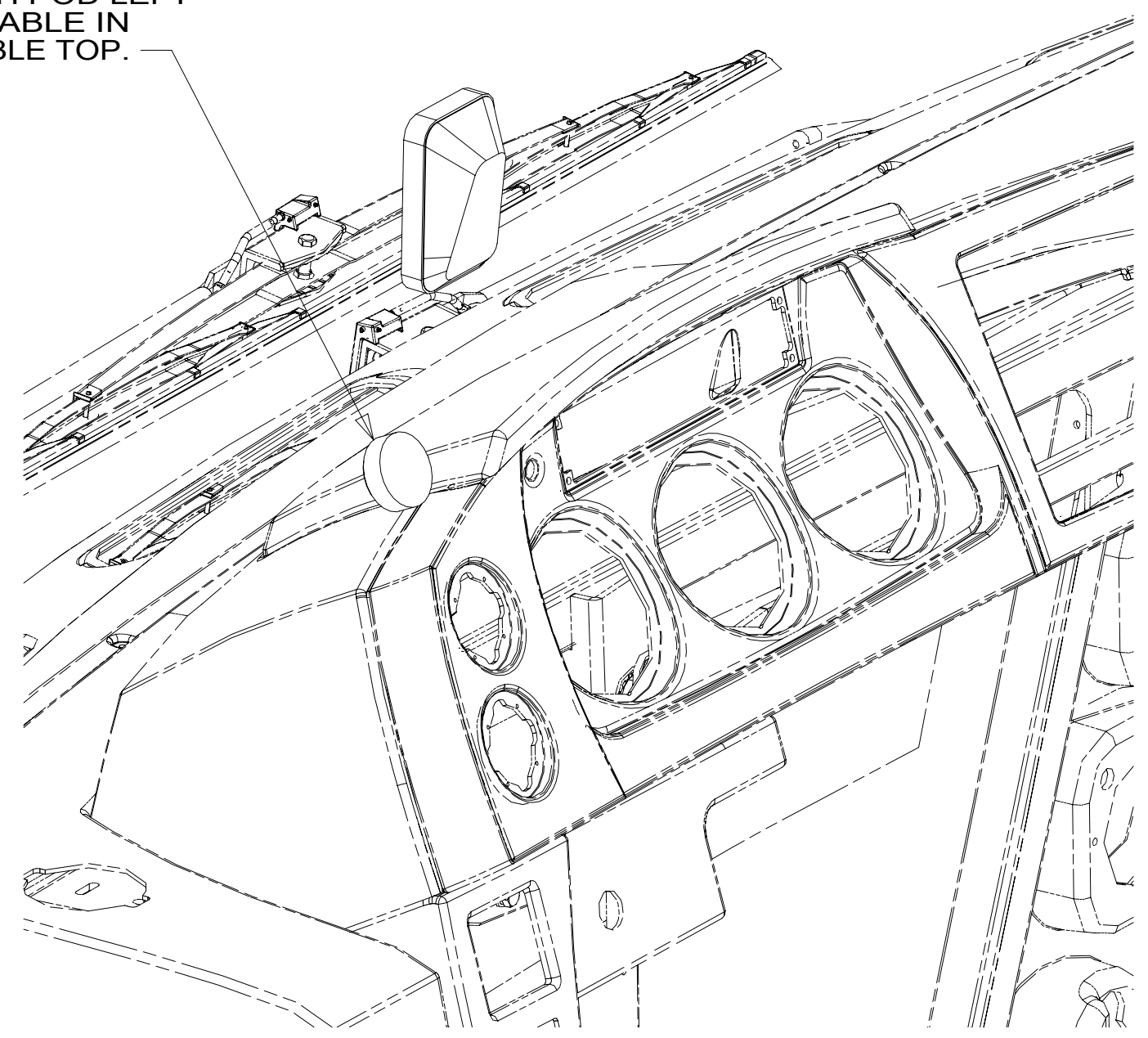

DETAIL JB

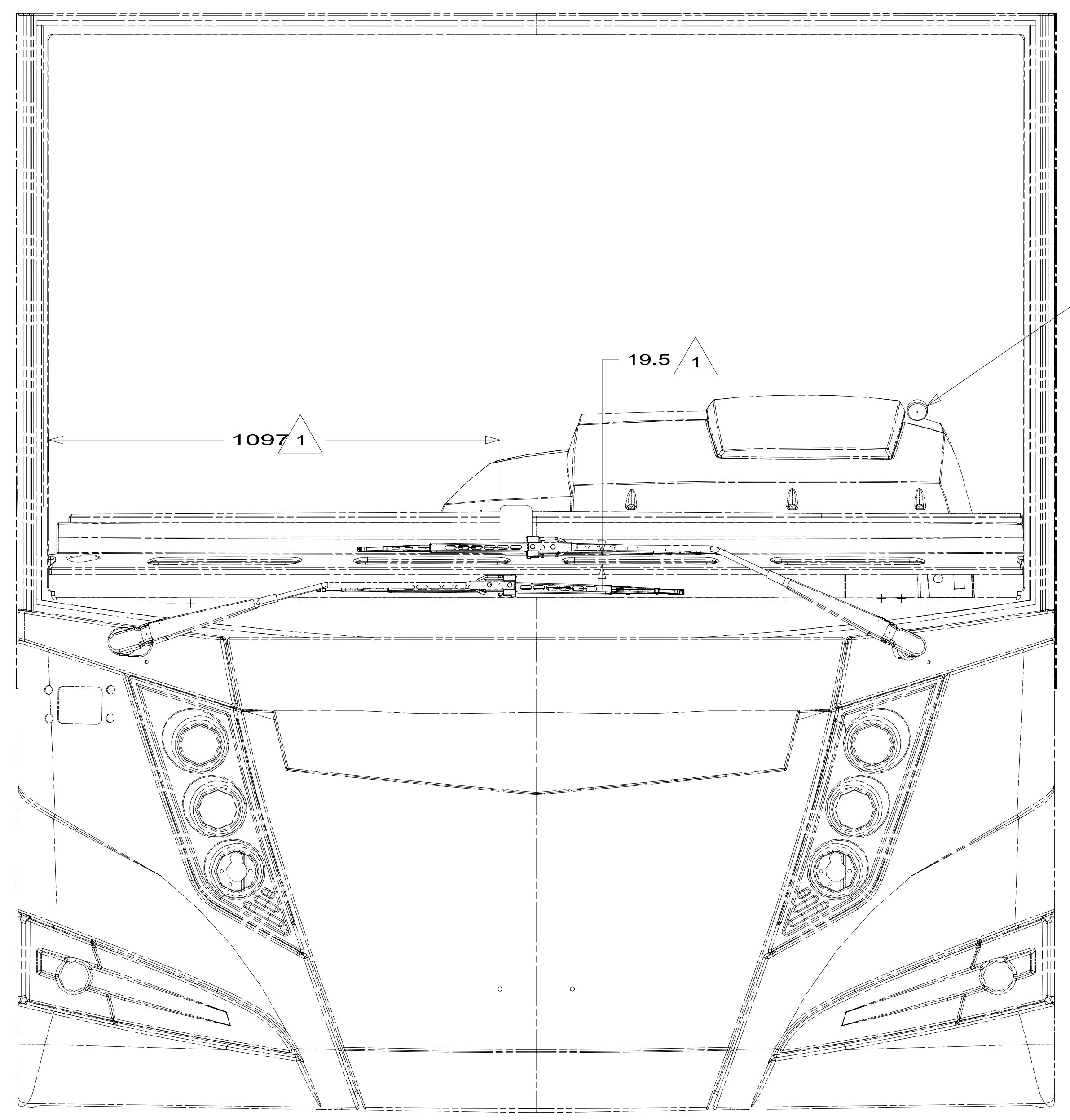

DETAIL JA

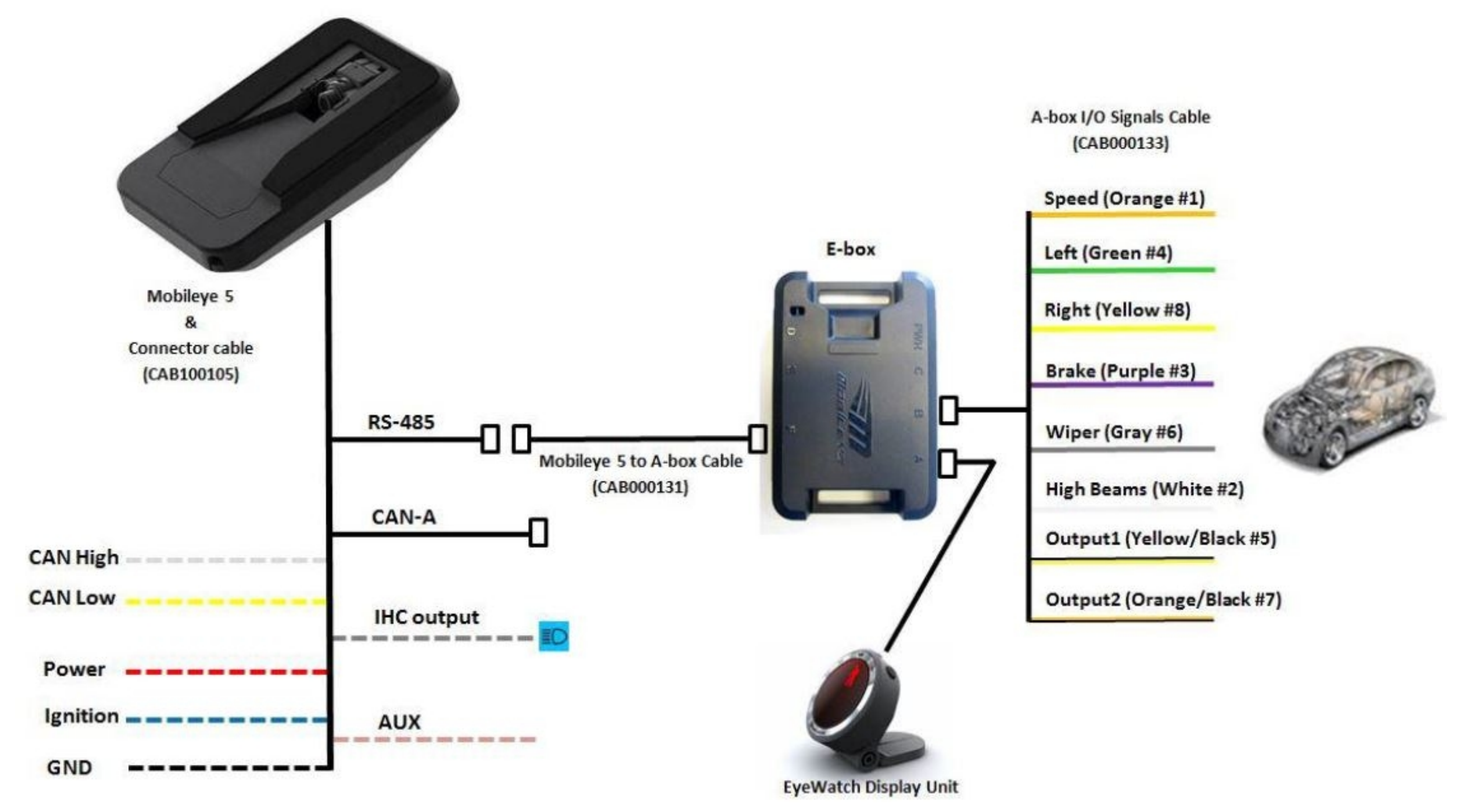

MOBILEYE CONNECTION DIAGRAM

1 ALL DIMENSIONS FROM BLACK LINE IN WINDSHIELD REF DIMENSION: CAMERA TO BE MOUNTED 50 MM RIGHT OF CENTER OF COACH AND 30 MM ABOVE DASH AT WINDSHIELD.

NOTES:

- 36C COLLISION AVOIDANCE SYSTEM
- 265 CODES/STANDARDS-CSA/CMVSS
- 1B1 CODES/STANDARDS USA

1B1 265 74L 19V

FIRST USED **15 R-SERIES**

DO NOT SCALE DRAWING

TITLE: **WIRING INSTL-FRONT END**

SHEET 9 PART NO **187600** REV

FOR ELECTRICAL TORQUE SPECIFICATIONS SEE DWG NO. 128783-01-000

FOR ELECTRICAL CALLOUTS SEE DWG NO. 121339-01-000

187600