

FRONT OF COACH

- NOTES:
1. SLOPE OF HORIZONTAL PIPING TO BE MINIMUM OF 3 PER 305 mm.
 2. SLOPE OF TRAP ARM MUST BE 6 PER 305 mm.
 3. ALL PIPE AND FITTINGS TO BE ASSEMBLED WITH SOLVENT 004020-01-000 (USA), 004020-02-000 (CAN)
 4. USE SMOOTH PLUMBERS PUTTY 167459-01-000 TO SEAL STRAINER (0.2 PER STRAINER).
 5. SEAL AROUND SHOWER WITH SILICONE.
 6. VENT PIPE MUST PROJECT 51 MIN AND 64 MAX ABOVE ROOF FOR PROPER FIT AND FUNCTION. ADD S-1 (116666-01-CHT SEAL-VENT PIPE) AROUND PIPE ON ROOF BEFORE VENT CAP IS INSTALLED.
 7. SECURE VENT PIPE TO TANK WITH CLAMP 062401-02-000.
 8. SECURE DRAINAGE PIPES TO CABINET USING WIRE TIE 108046-02-000, AND SCREW 000G67-10-12U AT INTERVALS OF NOT OF NOT MORE THAN 4 FEET APART.
 9. SEE DRAWING 061607 FOR INSTALLATION OF GROMMETS.
 10. VALVE TERMINATION TEE TO BE POSITIONED AT 10° DOWN AND OUTBOARD.

1B1 CODES/STANDARDS USA
 265 CODES/STANDARDS-CSA/CMVSS

WINNEBAGO INDUSTRIES, INC. COPYRIGHT 2014

DFT-ORIG	ORIG. DATE
CHKR	ALL DIMENSIONS ARE IN MILLIMETERS
P.E.	
M.E.	FIRST USED
DSNR	15 E26HE
UNSPECIFIED TOLERANCES ARE:	
WHOLE DIM (X)	: 3
ONE-PLACE (X.X)	: 1.5
TWO-PLACE (X.XX)	: 0.50
ANGLE	: 1°
THIRD ANGLE PROJECTION	
DO NOT SCALE DRAWING	REFER TO ES0018 FOR FASTENER TIGHTENING GUIDELINES
TITLE: DRAINAGE SYSTEM INSTL	
SHEET 1 OF 4	PART NO 190128 REV
REF:	1 09-Jul-2015

FOR DRAINAGE CALLOUTS SEE DWG NO 116229-01-000

190128

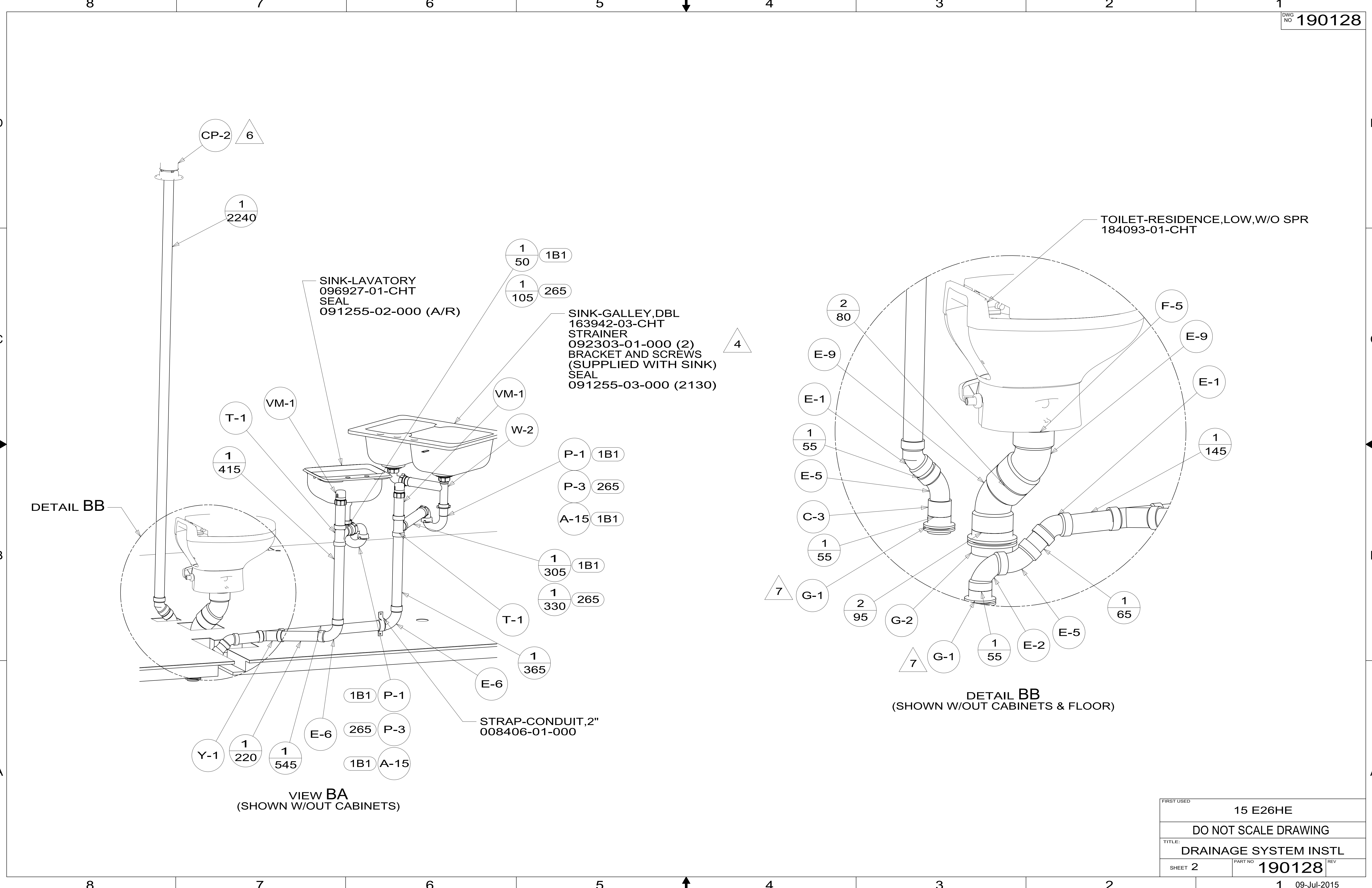

SINK-LAVATORY
096927-01-CHT
SEAL
091255-02-000 (A/R)

SINK-GALLEY, DBL
163942-03-CHT
STRAINER
092303-01-000 (2)
BRACKET AND SCREWS
(SUPPLIED WITH SINK)
SEAL
091255-03-000 (2130)

TOILET-RESIDENCE, LOW, W/O SPR
184093-01-CHT

DETAIL BB

DETAIL BB
(SHOWN W/OUT CABINETS & FLOOR)

VIEW BA
(SHOWN W/OUT CABINETS)

FIRST USED	15 E26HE	
TITLE:	DO NOT SCALE DRAWING	
TITLE:	DRAINAGE SYSTEM INSTL	
SHEET 2	PART NO 190128	REV
	1	09-Jul-2015

190128

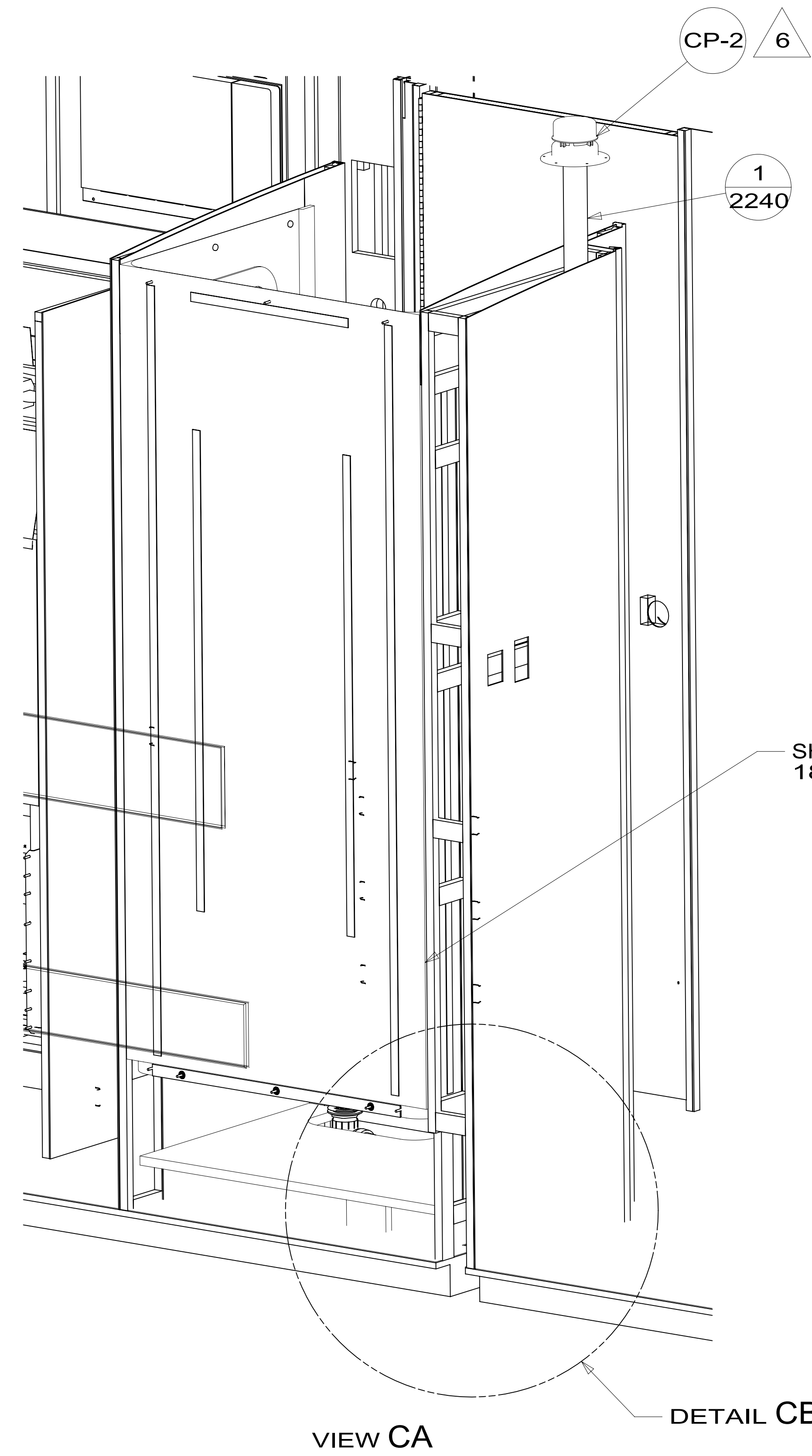

SHOWER INSTL-ENCLOSURE
189050-02-000

ADAPTER-ANGLE, WATERLESS TRAP
165406-02-000

TRAP-WATERLESS
165406-01-000

STRAINER
066440-01-000
SEALER
069640-01-000
WASHER-RUBBER
127440-02-CHT

DETAIL CB
(SHOWN W/OUT CABINETS, FLOOR, & SHOWER)

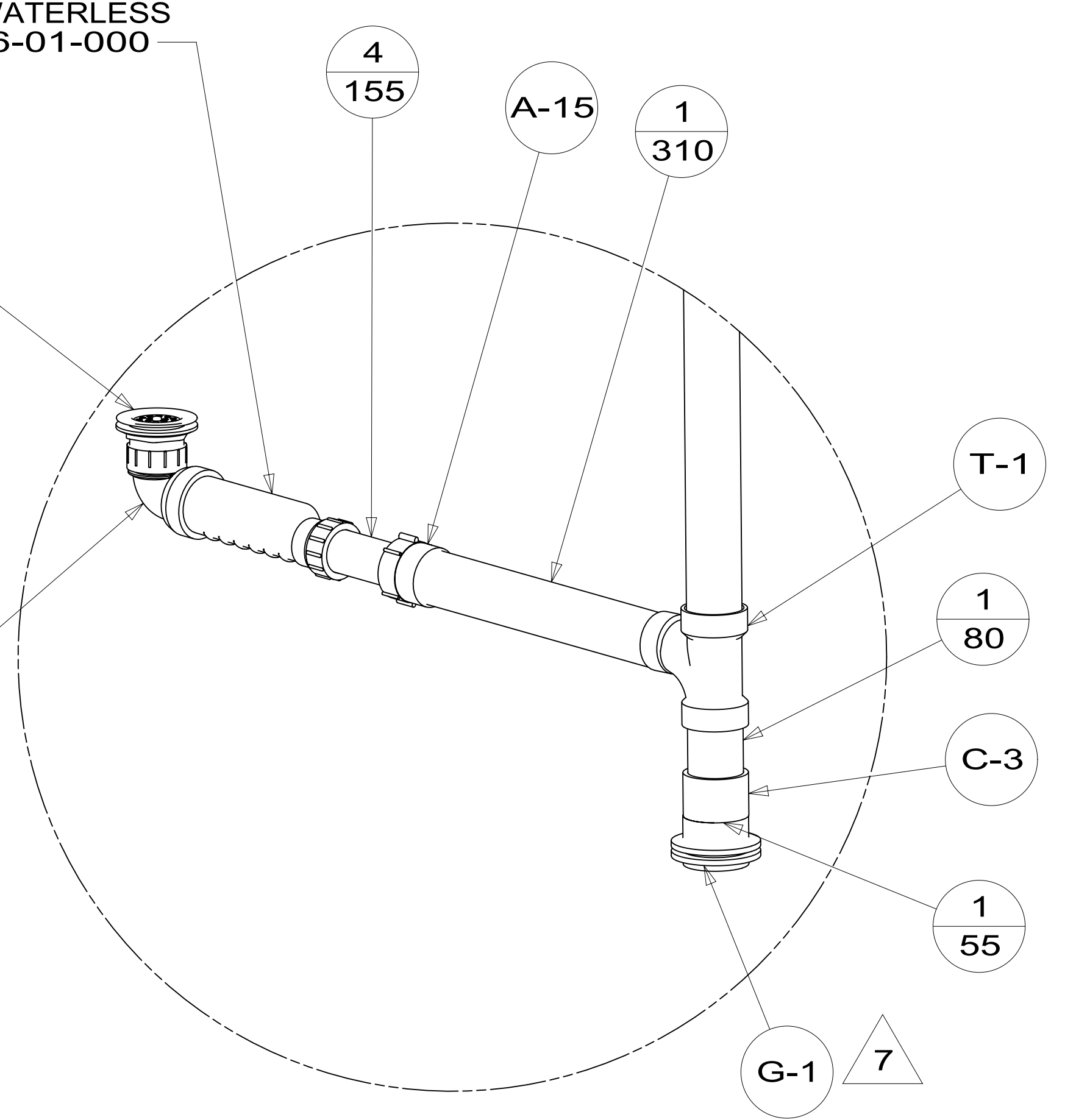

FIRST USED	15 E26HE	
TITLE:	DO NOT SCALE DRAWING	
TITLE:	DRAINAGE SYSTEM INSTL	
SHEET 3	PART NO 190128	REV
	1	09-Jul-2015

190128

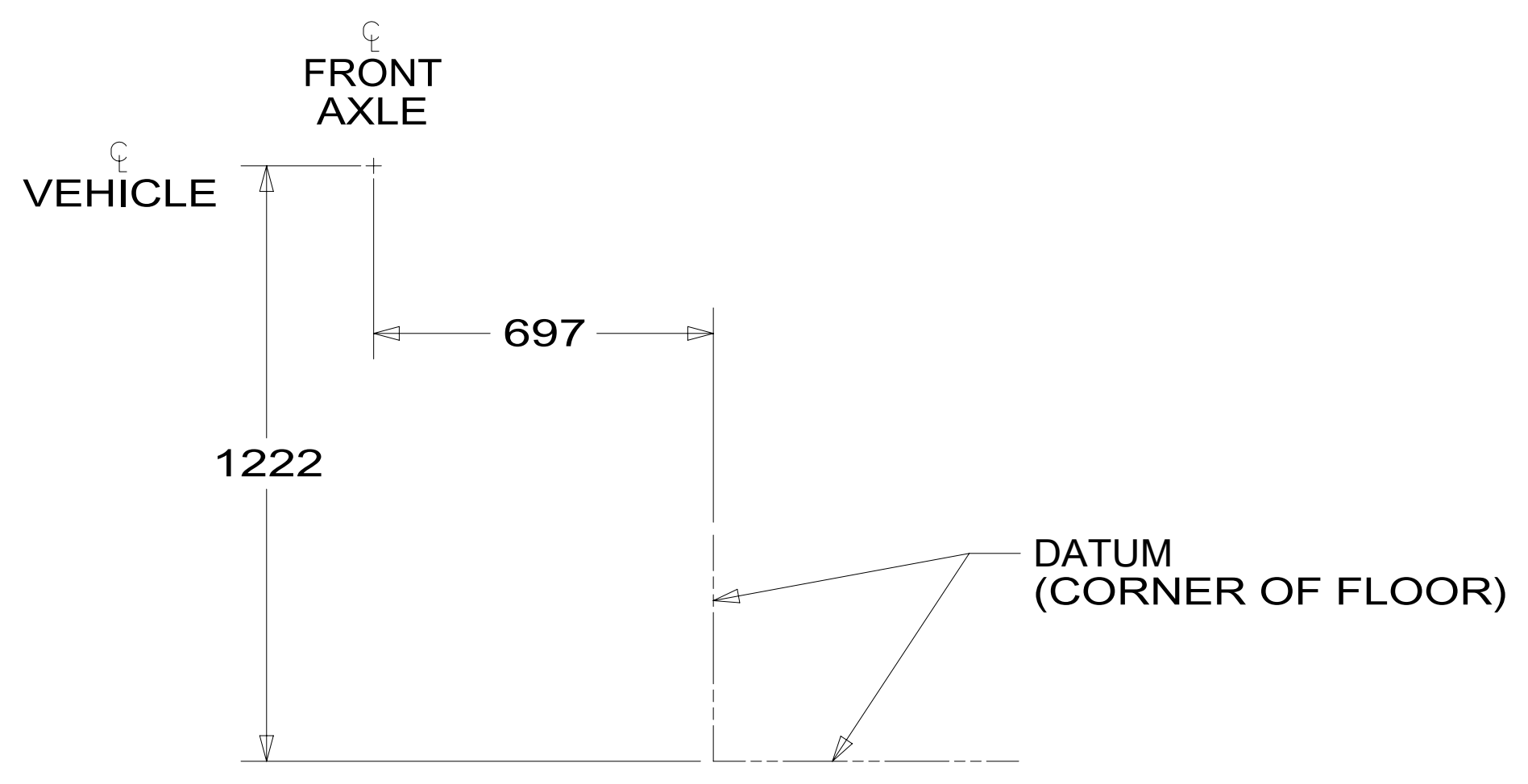

TANK ASM-HOLDING, 43 GAL
154458-02-000

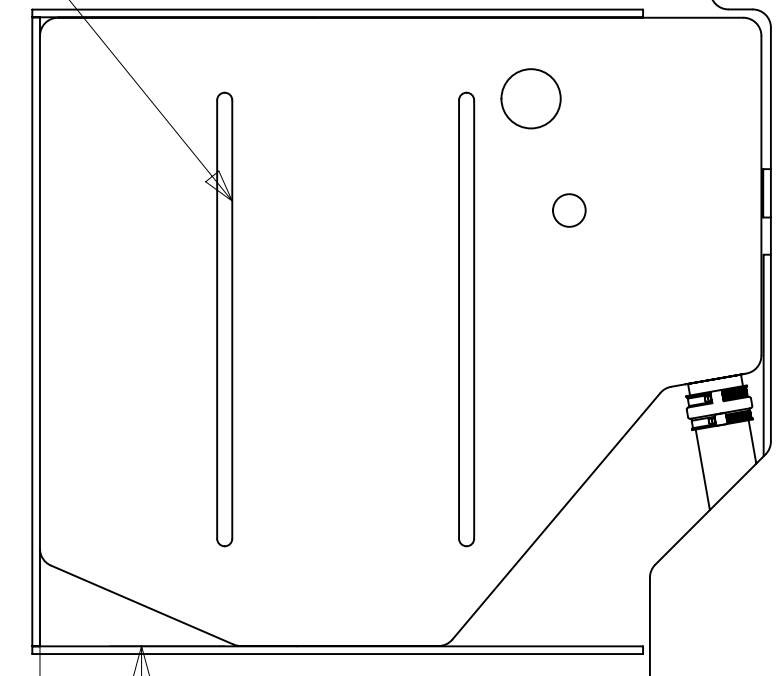

BRACKET-HOLDING TANK
126796-06-CHT

TANK ASM-HOLDING, 38 GAL
154457-05-000

STL-TUBE
123963-07-CHT

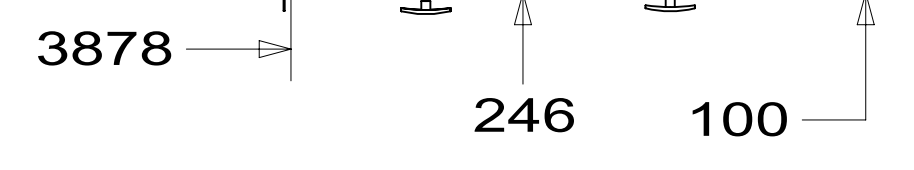

SHOWING TANKS AND DRAINS

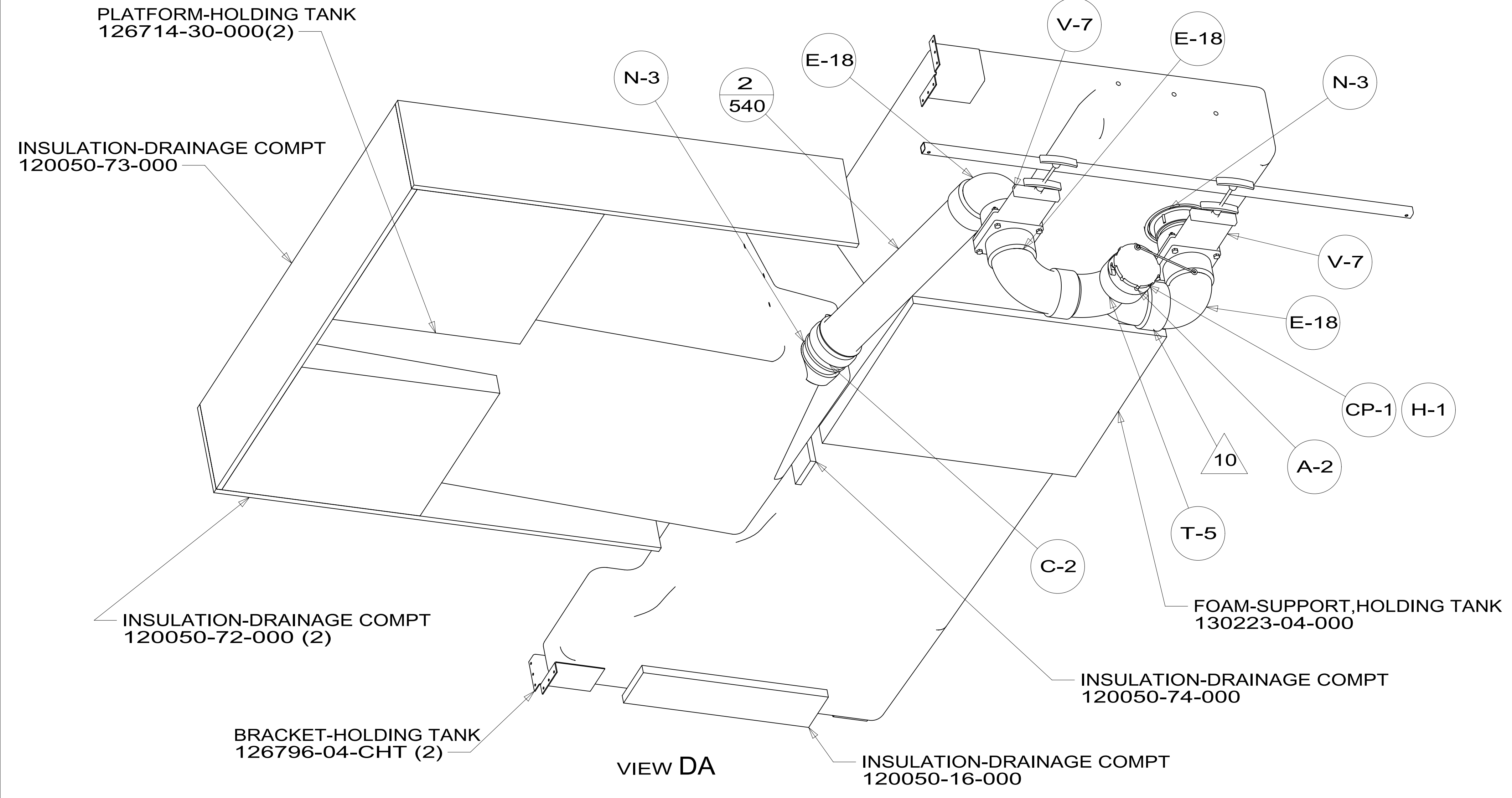
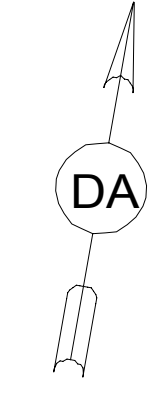

VIEW DA

FIRST USED	15 E26HE	
DO NOT SCALE DRAWING		
TITLE: DRAINAGE SYSTEM INSTL		
SHEET 4	PART NO 190128	REV
		1 09-Jul-2015

190128

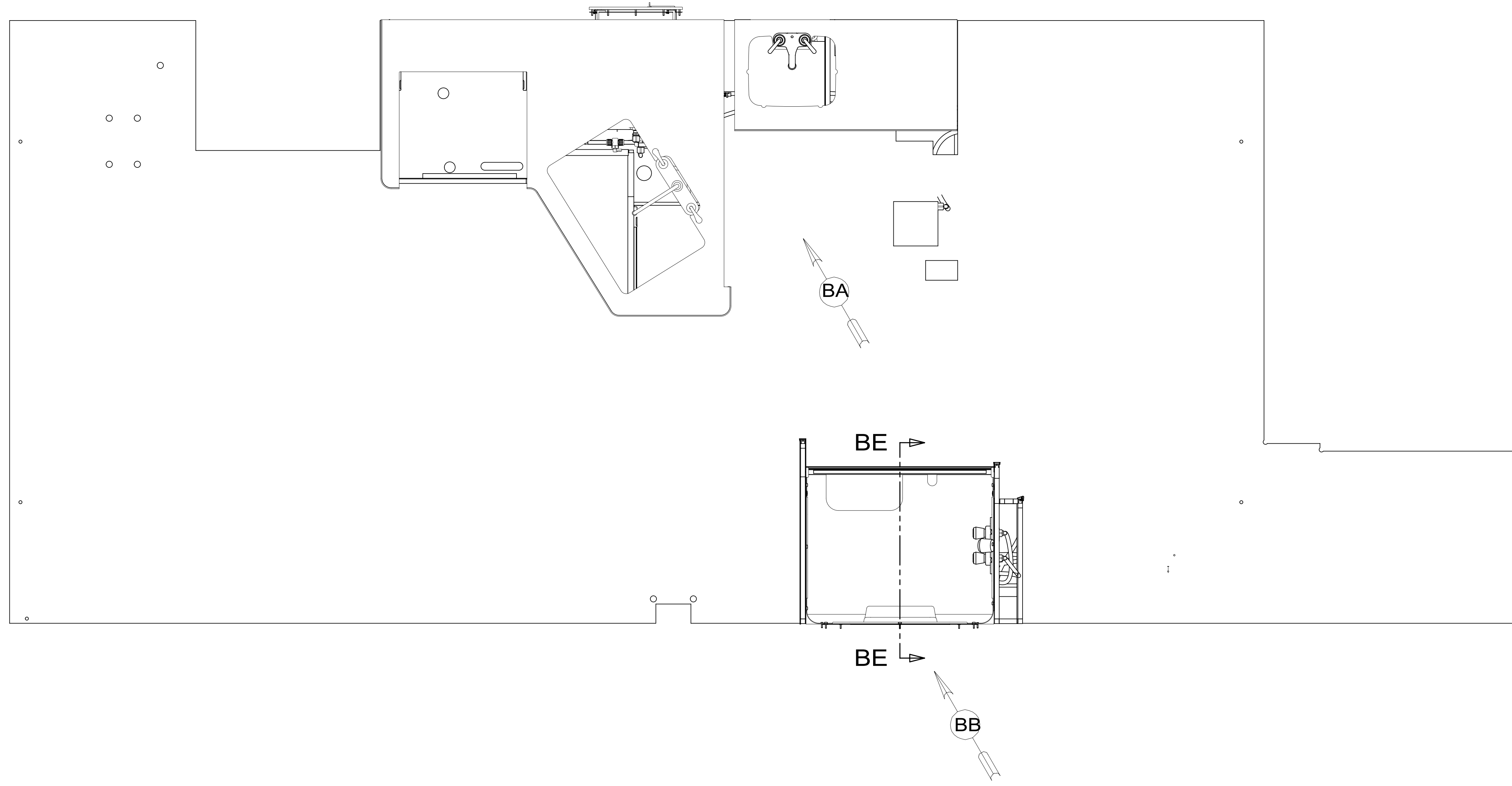

8. ALL CRIMP FITTINGS TO PEX TUBING REQUIRE 1/2" CLAMP 140171-03-000.
7. ALL CRIMP FITTINGS TO PEX TUBING REQUIRE 5/8" CLAMP 140171-04-000.
- 6 LABEL HOT AND COLD SUPPLY TUBES AND TAPE FITTING TO TUBE BEFORE CABINET SET TO PREVENT MOVEMENT.
- 5 ADD PIPE WRAP (LADDER SCRAP 110157-02-000) INSULATION.
- 4 ADD TEFLON TAPE 010405-02-000.
3. ALL TUBING TO BE SECURED AT 1200 INTERVALS MAXIMUM WITH CLAMP 010495-01-000 AND SCREW 000G67-10-12U OR EQUIVALENT.
2. TUBING TO BE INSTALLED WITH SUFFICIENT SLOPE TO PROVIDE DRAINAGE TO NEAREST VALVE.
1. PLASTIC FITTINGS TO BE SEALED WITH SEALANT 084456-01-000.

NOTES:

(X-X)
FOR WATER CALLOUTS SEE DWG NO 116230-01-000

WINNEBAGO INDUSTRIES, INC. COPYRIGHT 2014

DFTR	ORIG. DATE
CHKR	ALL DIMENSIONS ARE IN MILLIMETERS
P.E.	
M.E.	FIRST USED
DSNR	15 E26HE
UNSPECIFIED TOLERANCES ARE:	
WHOLE DIM (X)	: 3
ONE-PLACE (X.X)	: 1.5
TWO-PLACE (X.XX)	: 0.50
ANGLE	: 1°
THIRD ANGLE PROJECTION	
DO NOT SCALE DRAWING	REFER TO ES0018 FOR FASTENER TIGHTENING GUIDELINES
TITLE: WATER SYSTEM INSTL	
SHEET 1 OF 4	PART NO 190164
REF:	1 14-Jul-2015

*190164 *A

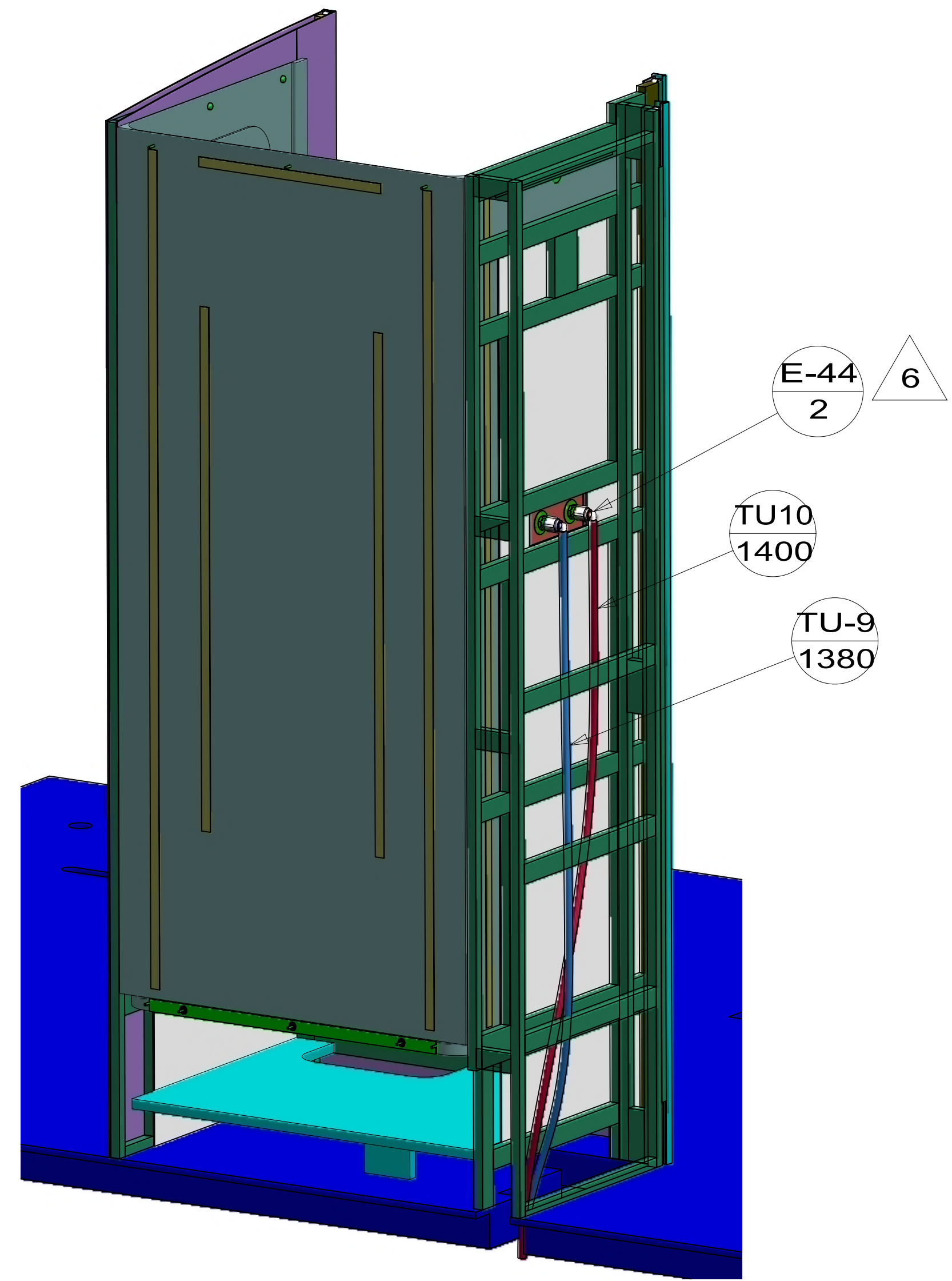
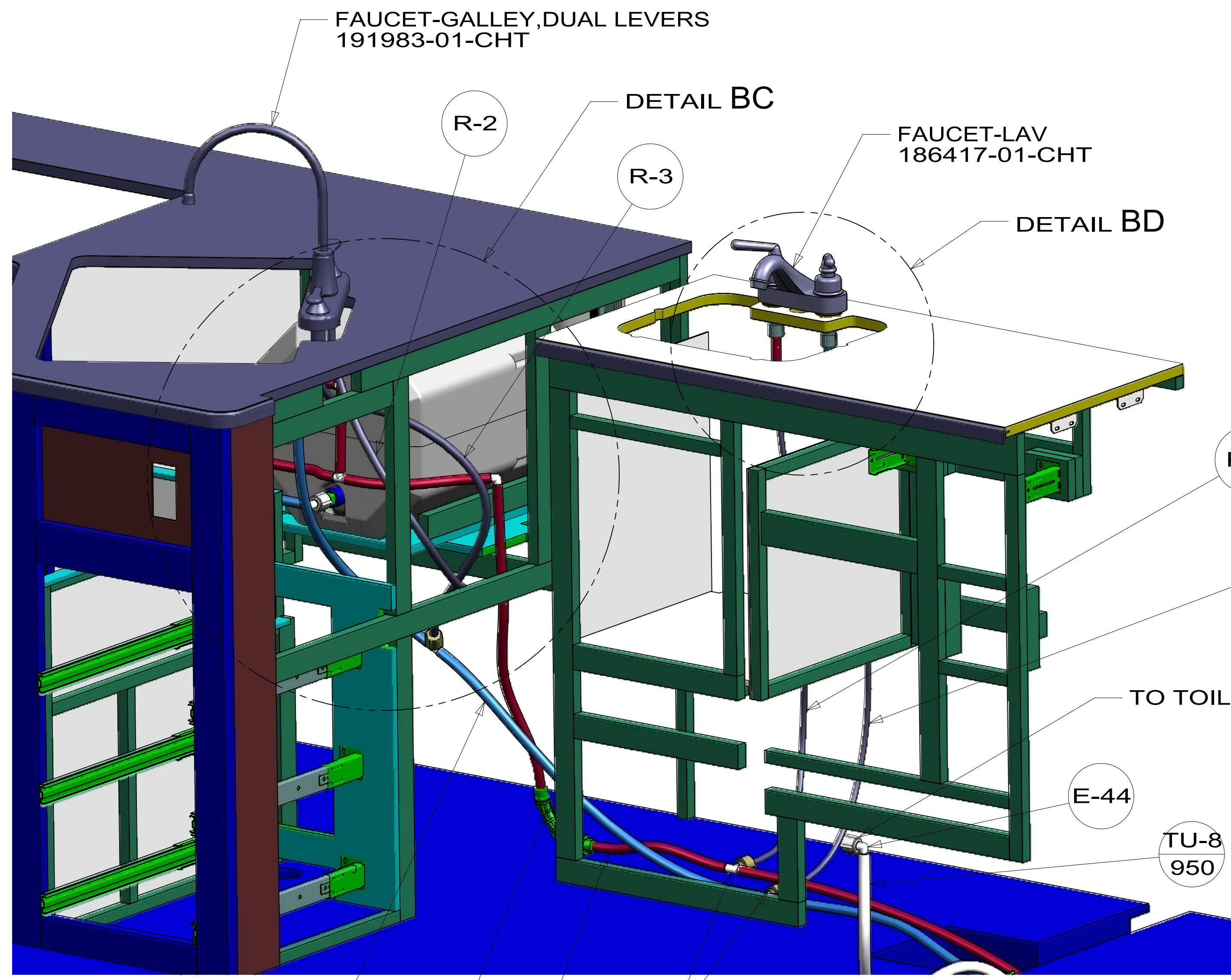

VIEW BB

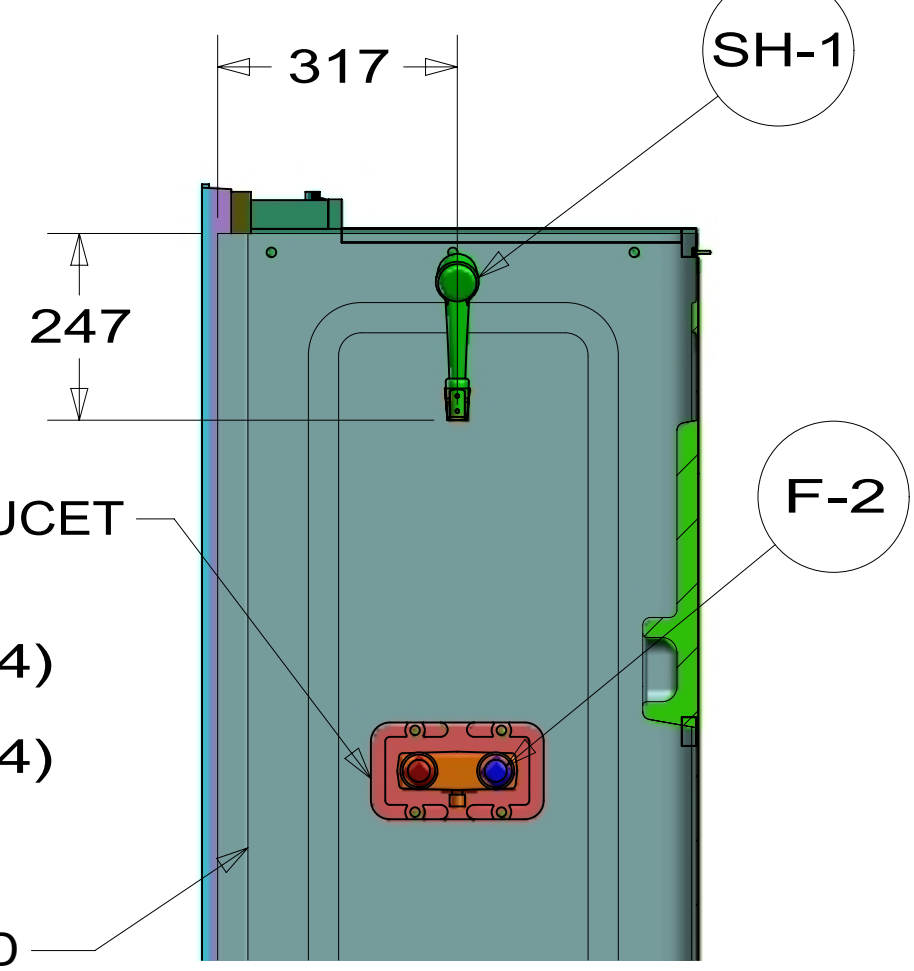

SECTION BE-BE

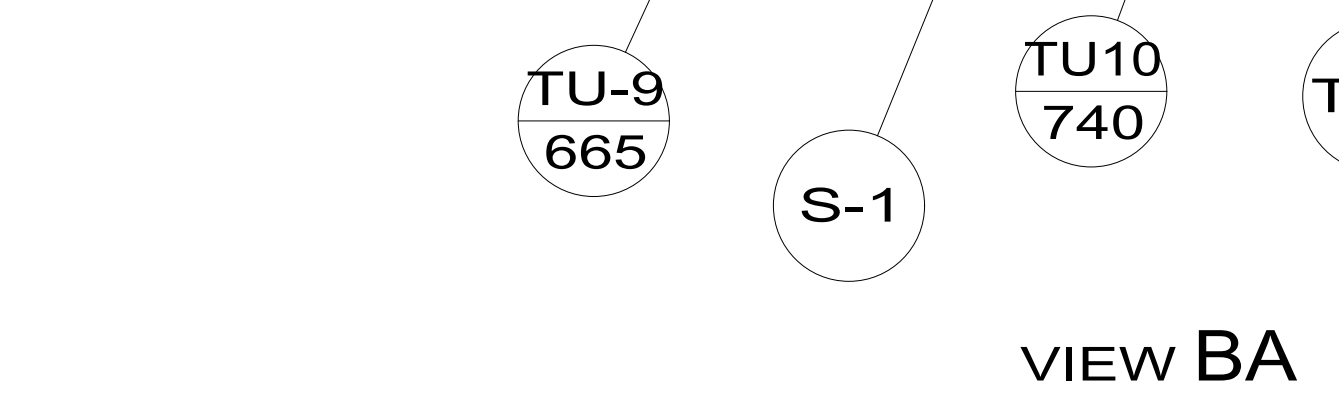

VIEW BA

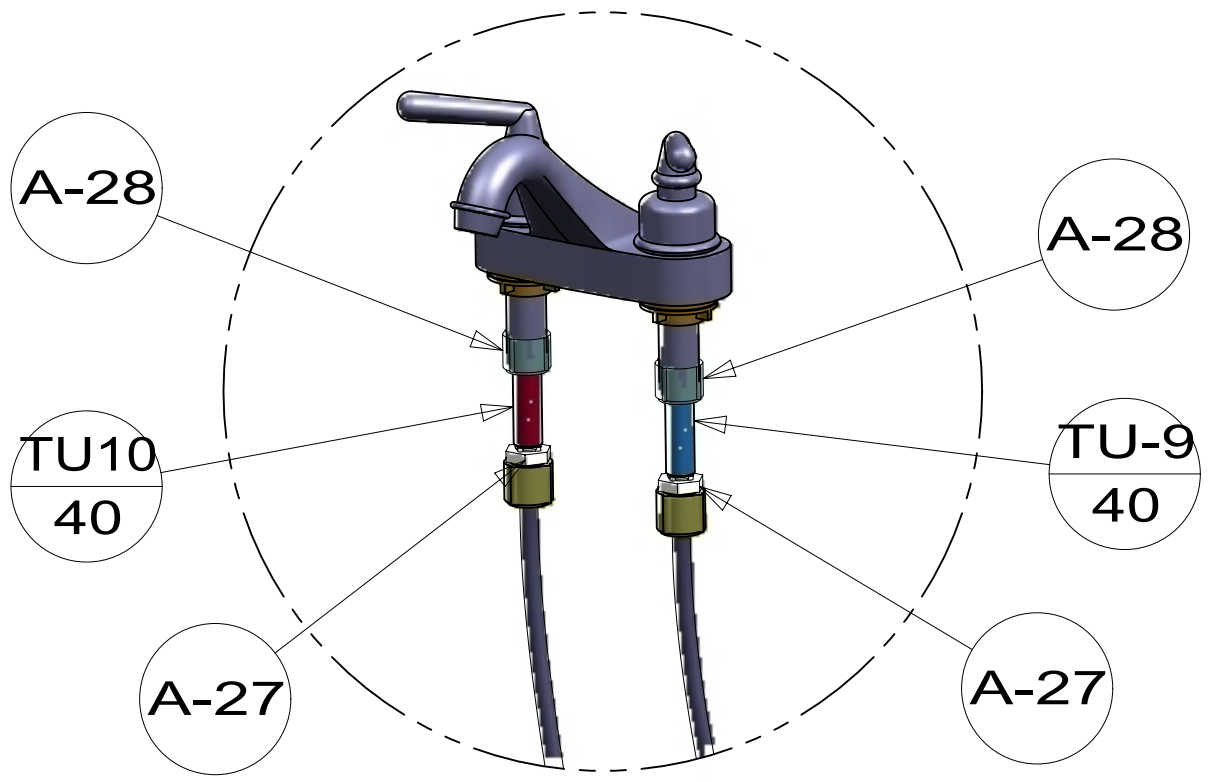

DETAIL BD (SHOWN W/OUT CABINETS)

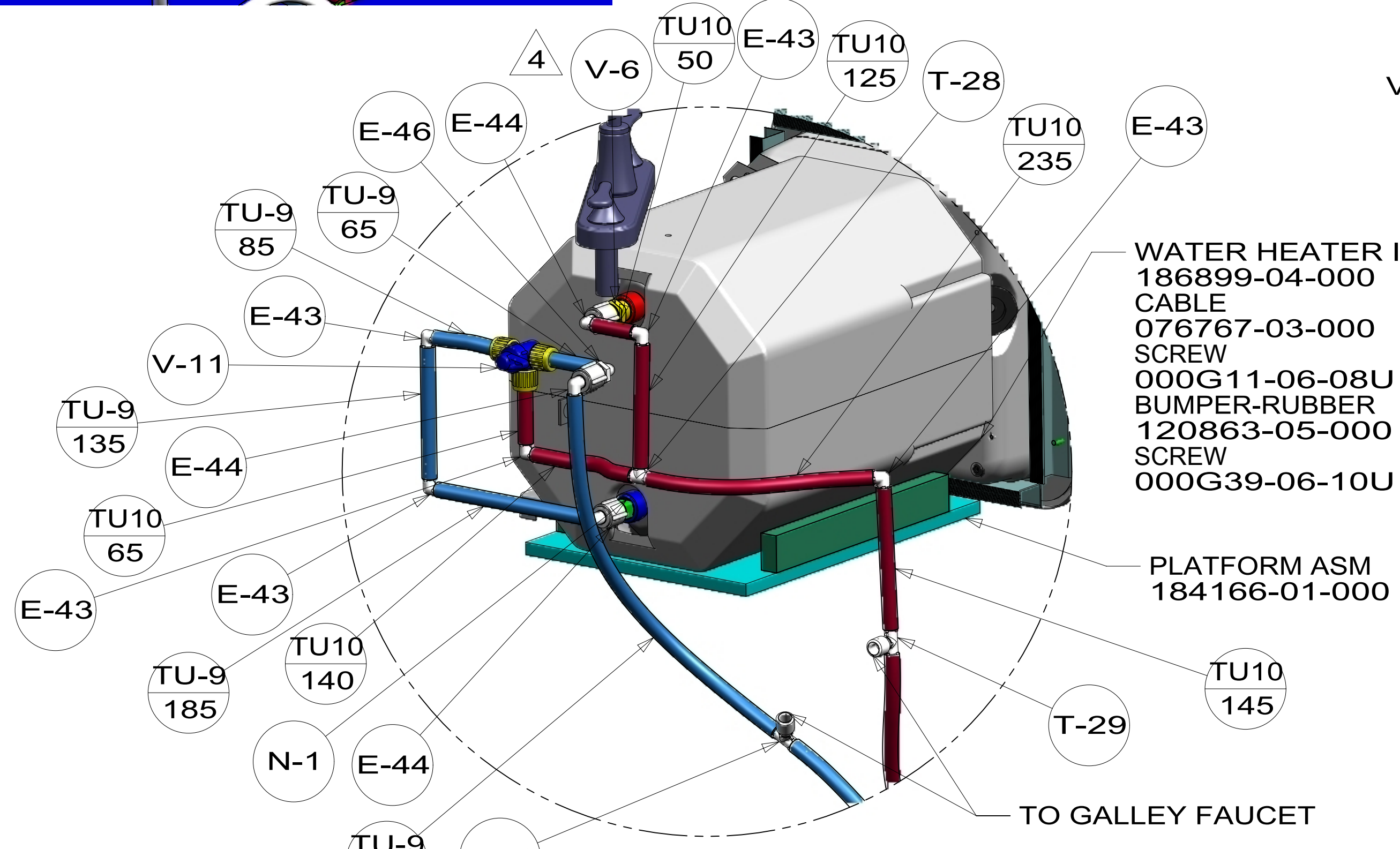

DETAIL BC (SHOWN W/OUT CABINETS & FAUCET)

- WATER HEATER INSTL-6 GAL 186899-04-000
- CABLE 076767-03-000
- SCREW 000G11-06-08U (2)
- BUMPER-RUBBER 120863-05-000 (2)
- SCREW 000G39-06-10U (2)

PLATFORM ASM 184166-01-000

- PANEL-SHOWER FAUCET 167738-02-CHT
- COVER-SCREW 166569-01-CHT (4)
- SCREW 000G11-08-12U (4)

SHOWER SURROUND (REF)

FIRST USED	15 E26HE	
DO NOT SCALE DRAWING		
TITLE:	WATER SYSTEM INSTL	
SHEET 2	PART NO	190164
	REV	1
		14-Jul-2015

190164

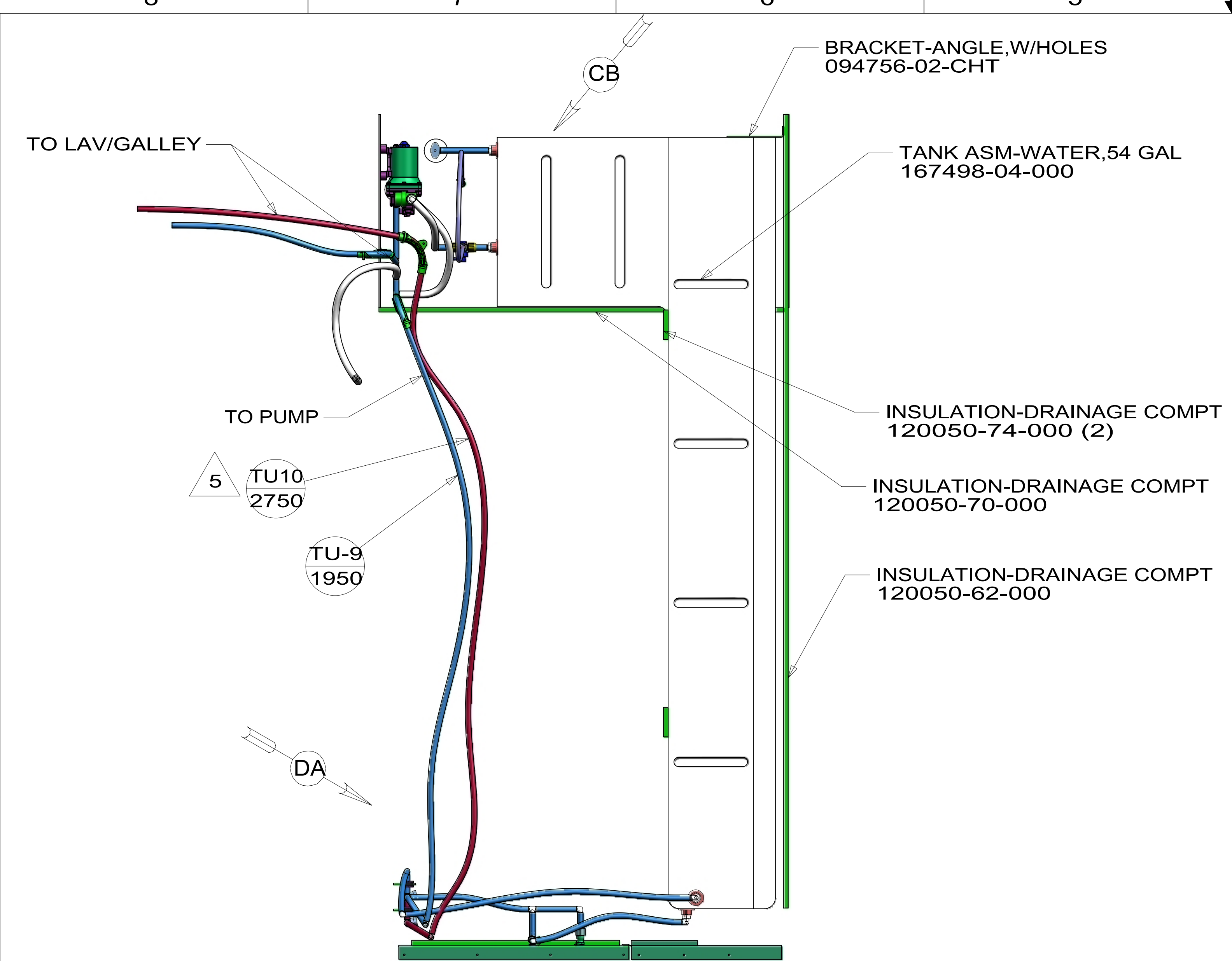

TOP VIEW
SHOWING LINES UNDER FLOOR & TANKS

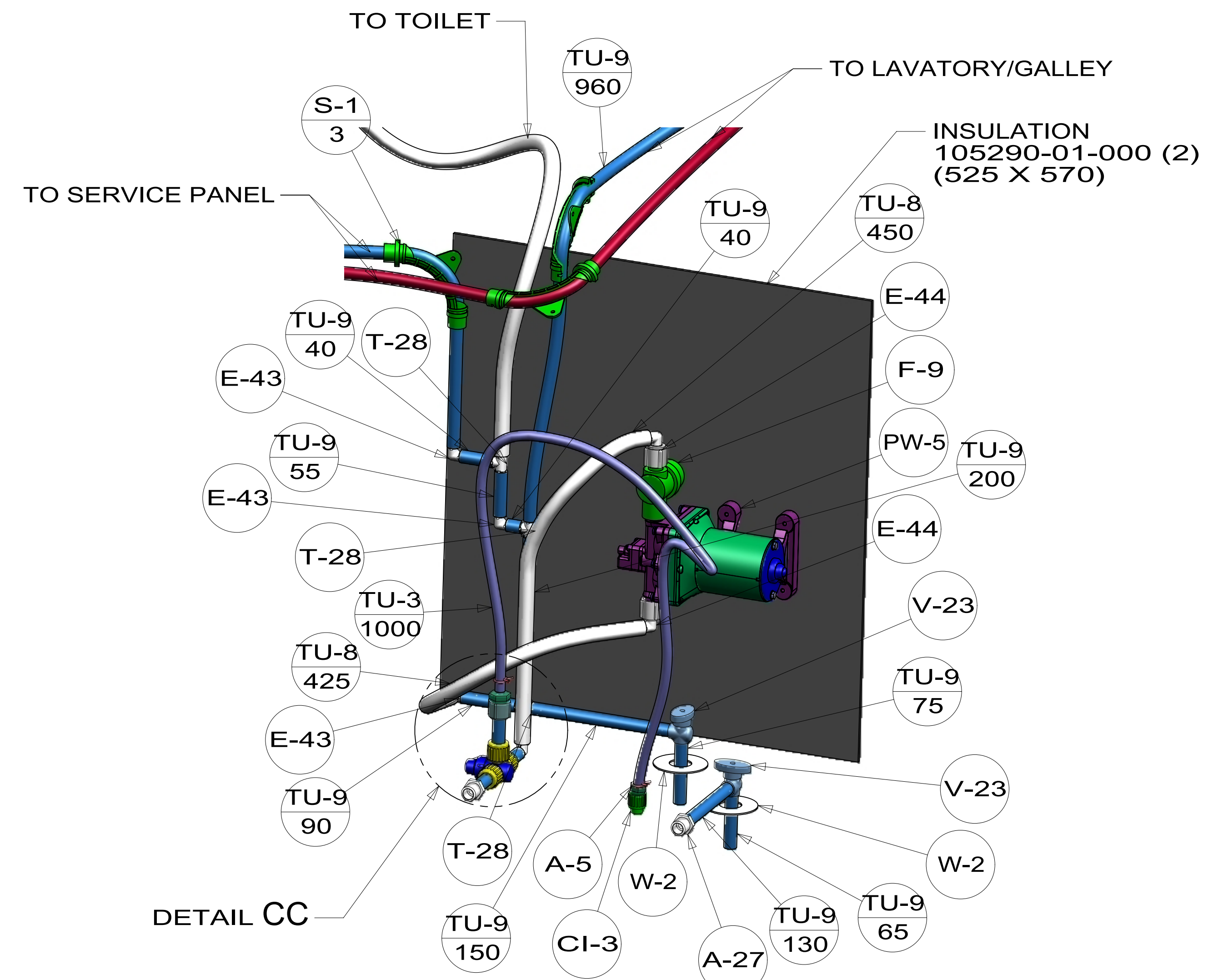

VIEW CB
(SHOWN W/OUT TANKS)

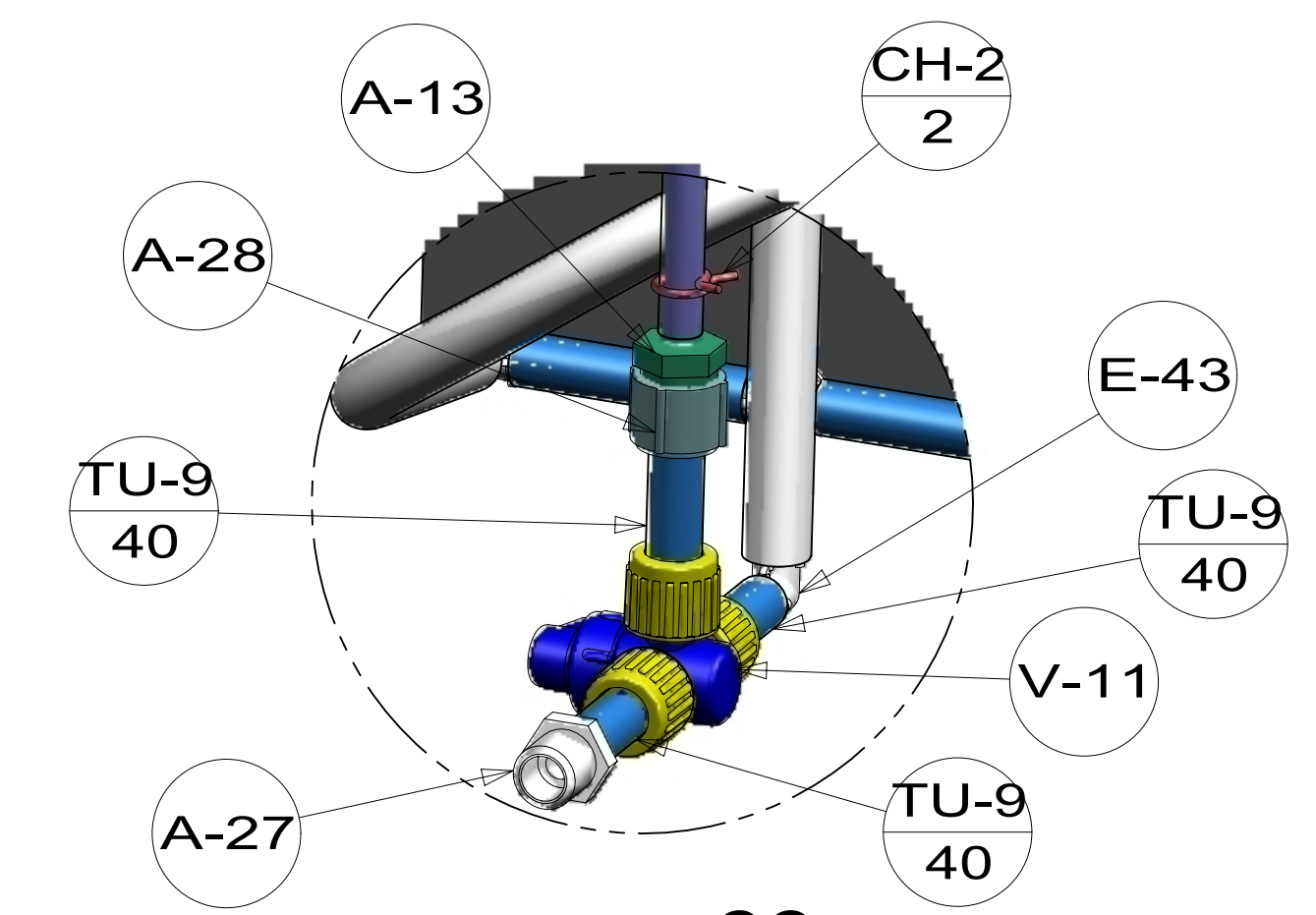
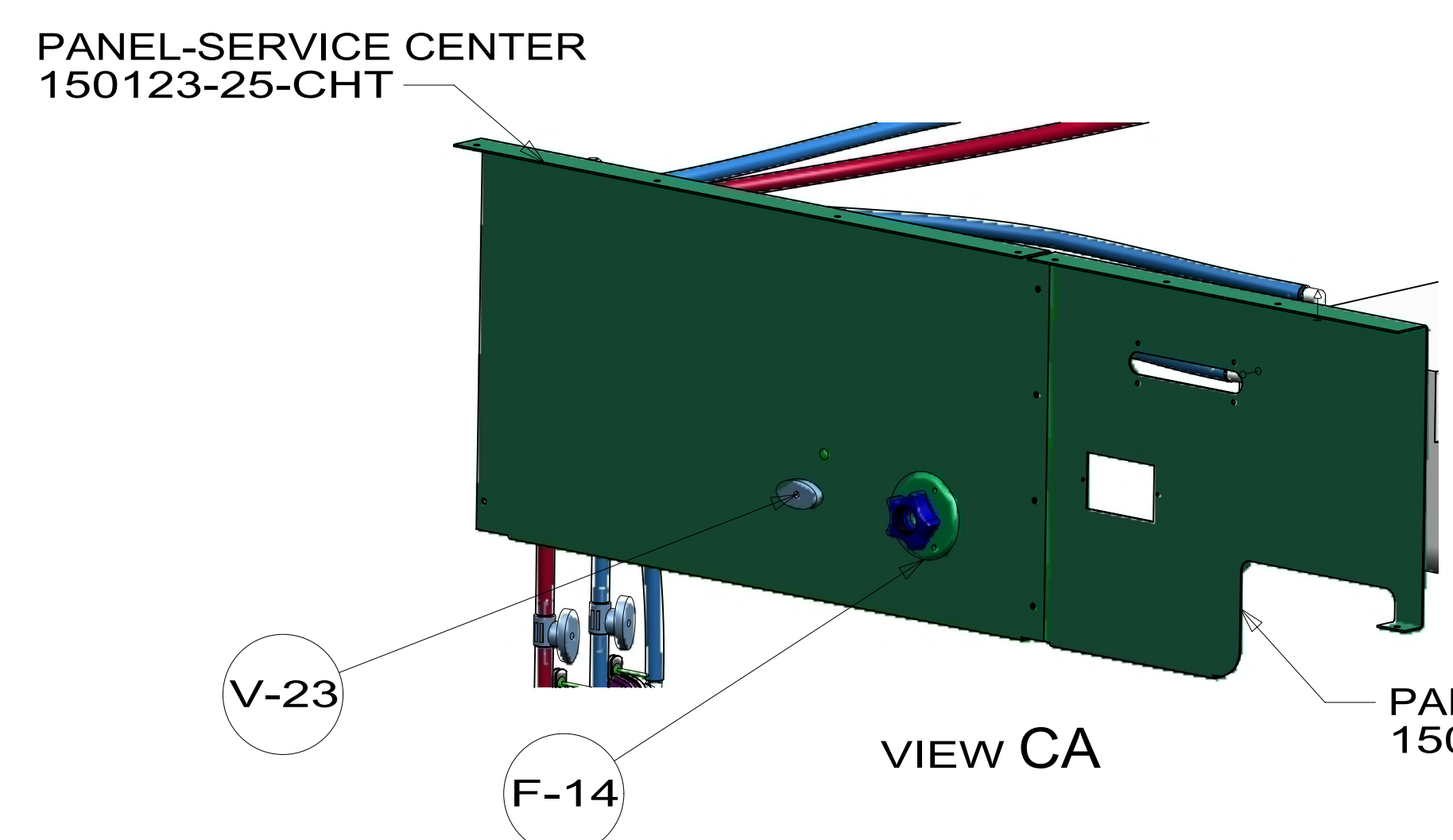

FIRST USED	15 E26HE
TITLE:	DO NOT SCALE DRAWING
SHEET 3	WATER SYSTEM INSTL
PART NO	190164
REV	1
14-Jul-2015	

190164

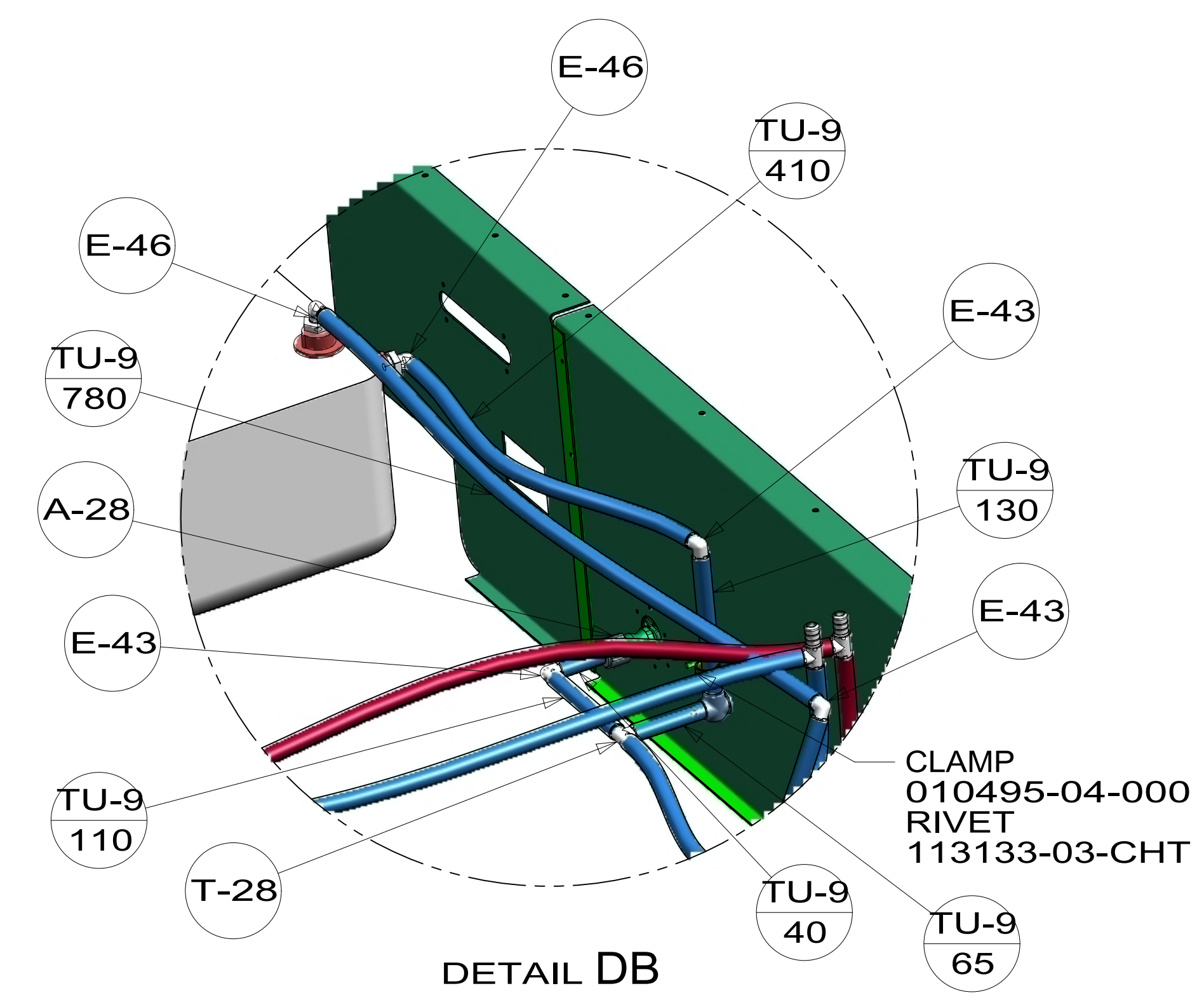
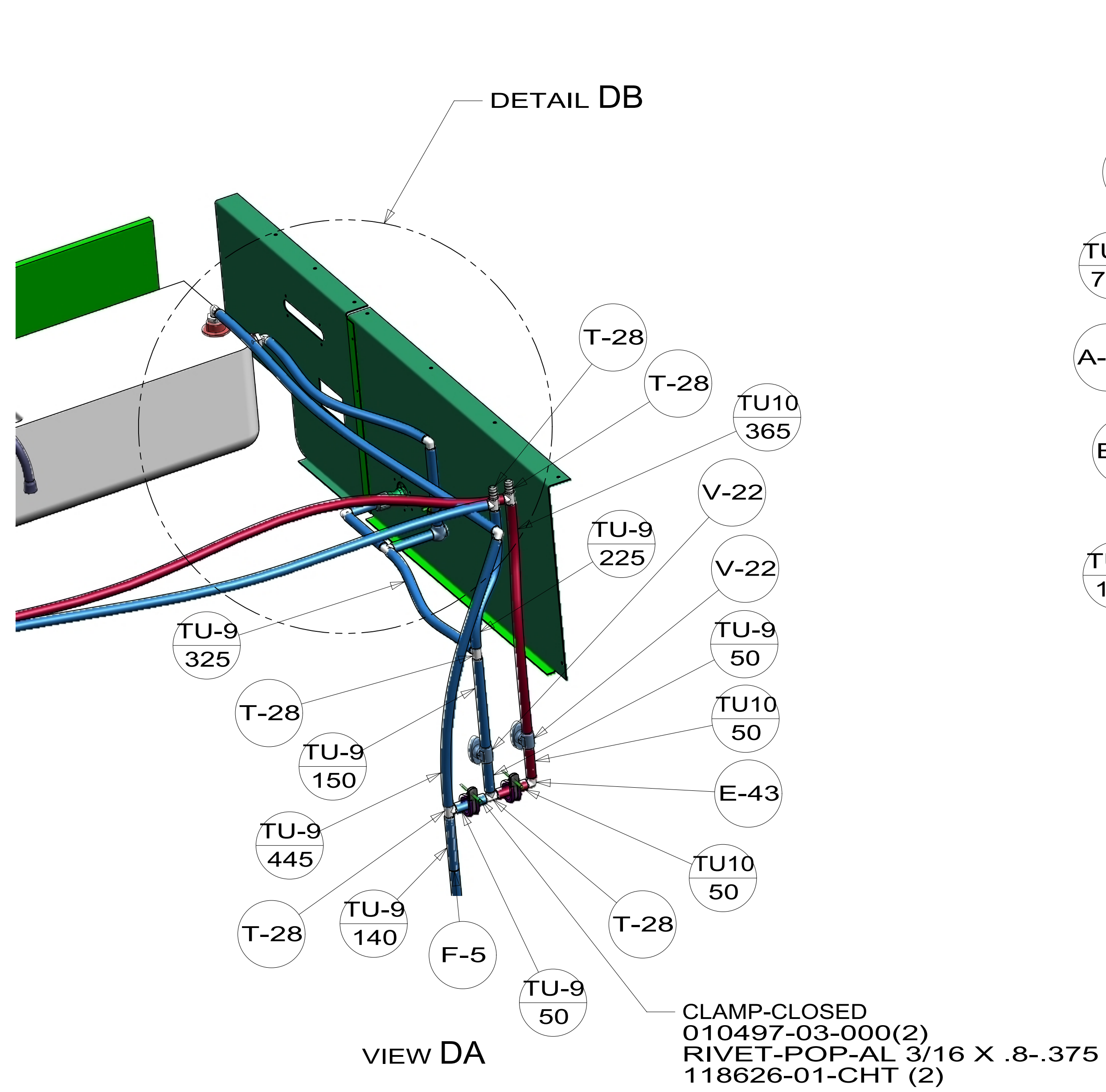

FIRST USED	15 E26HE		
TITLE:	DO NOT SCALE DRAWING		
TITLE:	WATER SYSTEM INSTL		
SHEET 4	PART NO	190164	REV
	1	14-Jul-2015	

*190164 *A