



DANGER

Danger of electrical shock, burns or death. Always remove all power sources before attempting any repair, service or diagnostic work. Power can be present from shore power, generator, inverter or battery. All power sources must be disabled and secured before performing any service.



CAUTION

If you lack the skills, tools or equipment to perform diagnostic or repair work leave such work to an authorized Winnebago Industries dealer or other qualified shop.

DRAWING NO.	MODELS	SHEET
184432-01	J33S,J38S	1,2
184432-02	J32H,J35P,J37F,J38Q	1,3

RELEASE	REV/DATE	DWG NO	184432
REV ZONE	REVISION RECORD	DATE	DFT-ORIG

D

D

C

C

B

B

A

A

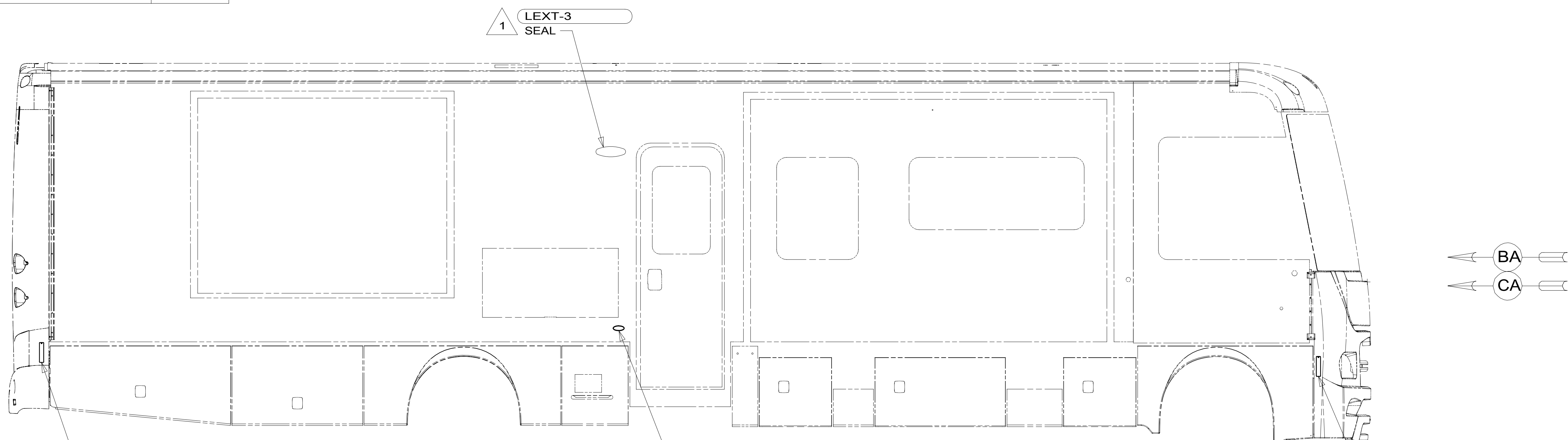

LAMP-MARKER, RED
117826-01-000
GASKET-MARKER LIGHT
117826-03-000
BULB
36196-01-000
SCREW
G39-08-16U (EXT) (2)

LAMP-MARKER, BASE
147680-01-CHT
LAMP-MARKER, LENS, AMBER
147680-02-CHT
SCREW
G11-08-12U (EXT) (2)

LAMP-MARKER, AMBER
117826-02-000
GASKET-MARKER LIGHT
117826-03-000
BULB
36196-01-000
SCREW
G39-08-16U (EXT) (2)

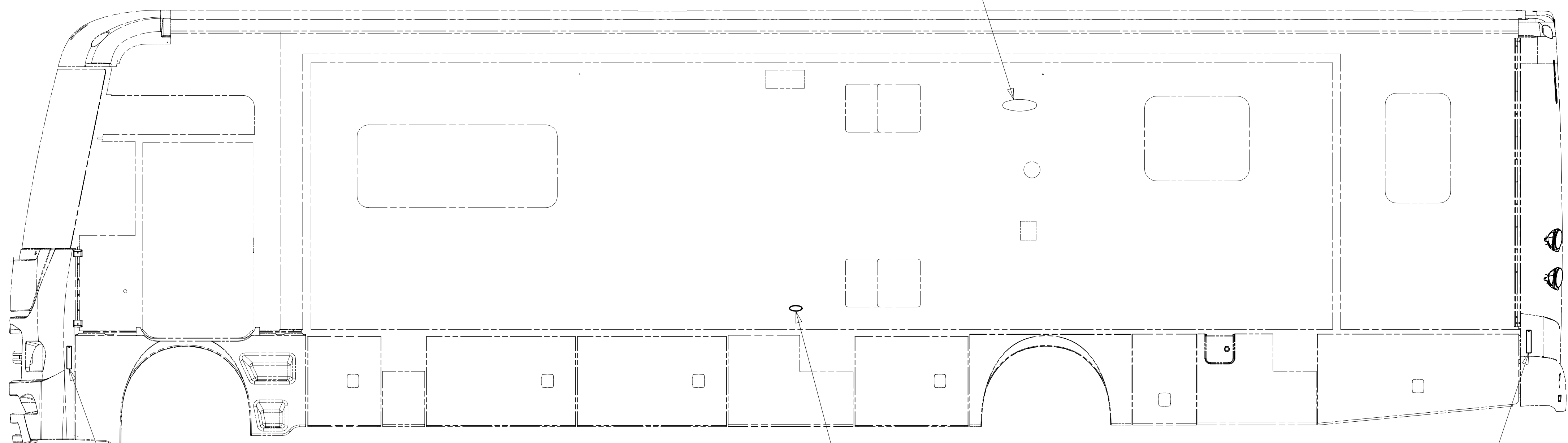

LAMP-MARKER, AMBER
117826-02-000
GASKET-MARKER LIGHT
117826-03-000
BULB
36196-01-000
SCREW
G39-08-16U (EXT) (2)

LAMP-MARKER, BASE
147680-01-CHT
LAMP-MARKER, LENS, AMBER
147680-02-CHT
SCREW
G11-08-12U (EXT) (2)

LAMP-MARKER, RED
117826-01-000
GASKET-MARKER LIGHT
117826-03-000
BULB
36196-01-000
SCREW
G39-08-16U (EXT) (2)

- 265 CODES/STANDARDS-CSA/CMVSS
- 1B1 CODES/STANDARDS USA
- 1B1 265



DFT-ORIG	ORIG. DATE
CHKR	ALL DIMENSIONS ARE IN MILLIMETERS
P.E.	
M.E.	FIRST USED
DSNR	14 J-SERIES
UNSPECIFIED TOLERANCES ARE:	
WHOLE DIM (X)	: 3
ONE-PLACE (X.X)	: 1.5
TWO-PLACE (X.XX)	: 0.50
ANGLE	: 1°
THIRD ANGLE PROJECTION	
DO NOT SCALE DRAWING	REFER TO ES0018 FOR FASTENER TIGHTENING GUIDELINES
TITLE: WIRING INSTL-EXTERIOR LAMPS	
SHEET 1 OF 3	PART NO 184432 REV

2 USED ON SHELLS.
1 NOT USED ON SHELLS.

FOR ELECTRICAL TORQUE SPECIFICATIONS SEE DWG NO. 128783-01-000

FOR ELECTRICAL CALLOUTS SEE DWG NO. 121339-01-000

NOTES:

8 7 6 5 4 3 2

REF: 1 19-Feb-2015

184432

LAMP ASM-CLEARANCE,AMBER
138996-01-000 (5)
BRACKET-LAMP CLEARANCE
138996-03-000 (5)
SCREW
G39-08-16U (10)

WIRE ASM-CLEARANCE LAMPS
126486-04-000

2 PIN HOUSING TO
WIRE ASM-IP,MAIN

HEADLAMP ASM-
PARK/TURN RH
172697-01-000
WASHER
E13-16-00U (3)
NUT
D29-05-00U (3)

LAMP ASM-FOG
170774-01-000 (2)
BRACKET
176254-01-CHT (2)
SCREW
G18-08-06U (6)
WASHER
E14-08-00U (6)
NUT
D39-04-00U (6)
BOLT
C26-04-08U (8)
NUT
D39-04-00U (8)

WIRE ASM-HEADLAMP,FD
141678-19-000 ← 16A 16L 16Z
WIRE ASM-HEADLAMP,
FRED LEFT
141678-20-000 ← 1AW 1LX 1AQ 1AT
1AX 1AY 1AZ 1AV

VIEW BA

LAMP ASM-CLEARANCE,RED
138996-02-000 (5)
BRACKET-LAMP CLEARANCE
138996-03-000 (5)
SCREW
G39-08-16U (10)

WIRE ASM-
TAILLAMPS
149622-13-000
149622-14-000

16A 16L 16Z
1AW 1LX 1AQ 1AT
1AX 1AY 1AZ 1AV

LAMP ASM-STOP/
TURN/TAIL LH
177692-02-000
NUT
0MD34F-06-000 (3)
SCREW
C22-04-08U
BRACKET-TAILLAMP
175873-02-CHT

LAMP ASM-STOP/
TURN/TAIL LH
177692-02-000
NUT
0MD34F-06-000 (3)
SCREW
C22-04-08U
BRACKET-TAILLAMP
175873-04-CHT

LAMP-LICENSE PLATE
87201-01-000
SCREW
G11-06-12U (EXT)(2)

REFLECTOR
166850-01-000 (2)
SCREW
G39-08-16U (4)

TO GROUND STUD
TP,RRJ
(LOCATED ON BACKSIDE
OF GENERATOR OUTRIGGER)
NUT-GROUND
D39-05-00B

16A 16L 16Z 2 PIN HOUSING
TO WIRE ASM-CHASSIS

FOR ELECTRICAL
TORQUE
SPECIFICATIONS
SEE DWG NO.
128783-01-000

FOR
ELECTRICAL
CALLOUTS
SEE DWG NO.
121339-01-000

LIGHT-THIRD BRAKE,LED
151076-01-000 (2)
SCREW
G39-06-16U (4)

LAMP ASM-STOP/
TURN/TAIL RH
177692-01-000
NUT
0MD34F-06-000 (3)
SCREW
C22-04-08U
BRACKET-TAILLAMP
175873-01-CHT

LAMP ASM-STOP/
TURN/TAIL RH
177692-01-000
NUT
0MD34F-06-000 (3)
SCREW
C22-04-08U
BRACKET-TAILLAMP
175873-03-CHT

LAMP-BACKUP
164943-01-000 (2)
BULB
117806-01-000 (2)
NUT-PAL
139130-01-CHT (4)

CONNECTOR-TRAILER
157593-01-000
SCREW
101618-01-000 (4)

VIEW BB

- 1AV FRED 27.5K AIR BRK/FULL SUSP
- 1AQ FRTL(FRED)27.5K 340HP 22.5WL
- 1AT FRED-AIR BRAKE/FULL AIR SUSP
- 1AX FRTL (FRED) - AIR BRAKE
- 1AY FRTL(FRED)-RR AIR SUSPENSION
- 1AZ FRTL (FRED) 26K(27.5K FCCC)
- 16Z FORD 24,000#-22.5 ALUM WHEEL
- 16L FORD 22,000#-22.5 AL WHL
- 16A FORD 26,000#-22.5 AL WHL
- 1AW FRTL(FRED)26K-340HP 22.5TIRE
- 1LX FRTL(FRED)22K-340HP 22.5TIRE
- 265 CODES/STANDARDS-CSA/CMVSS
- 1B1 CODES/STANDARDS USA

1B1 265

FIRST USED

14 J-SERIES

DO NOT SCALE DRAWING

TITLE: WIRING INSTL-EXTERIOR LAMPS

SHEET 2 PART NO 184432 REV

19-Feb-2015

- NOTES:
- 6 LAMP WILL ONLY BE USED AS A TAILLAMP.
 - 5 REMOVE PAPER BACKING FROM REFLECTOR AND PREP APPLICATION SURFACE WITH ISOPROPYL ALCOHOL WIPE BEFORE INSTALLATION.
 - 4 CLEAN PAINT OFF METAL (BOLT) BEFORE CONNECTING GROUND TO INSURE CONTACT.
 - 3 ON SHELLS THE SIDEMARKER LAMPS EXIT THE SIDEWALL HERE. SPLICE YELLOW WIRE TO CIRCUIT MM AND WHITE WIRE TO CIRCUIT TP WITH SPLICE 58028-01-000 (2).
 - 2 SECURE WIRE ASM APPROX. EVERY 450 MM TO BACKWALL BRACKETS. USE TIE-WIRE 8343-01-000 OR 93147-01-000 AS APPROPRIATE.
 - 1 GATHER ALL EXCESS WIRE AFTER MAKING ALL CONNECTIONS AND BUNDLE AND SECURE WITH TIE-WIRE 8343-01-000 OR 93147-01-000.

184432

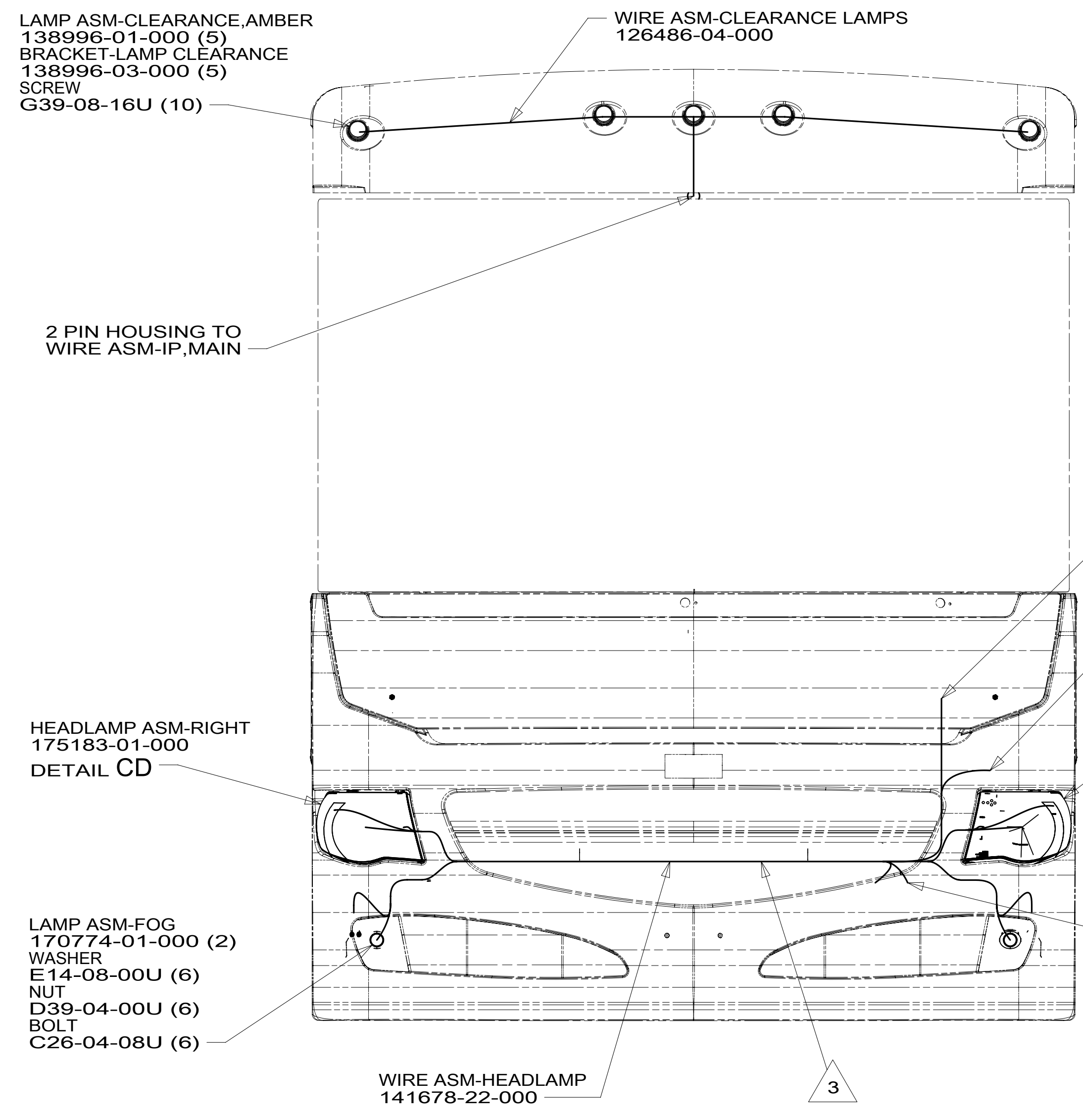

VIEW CA

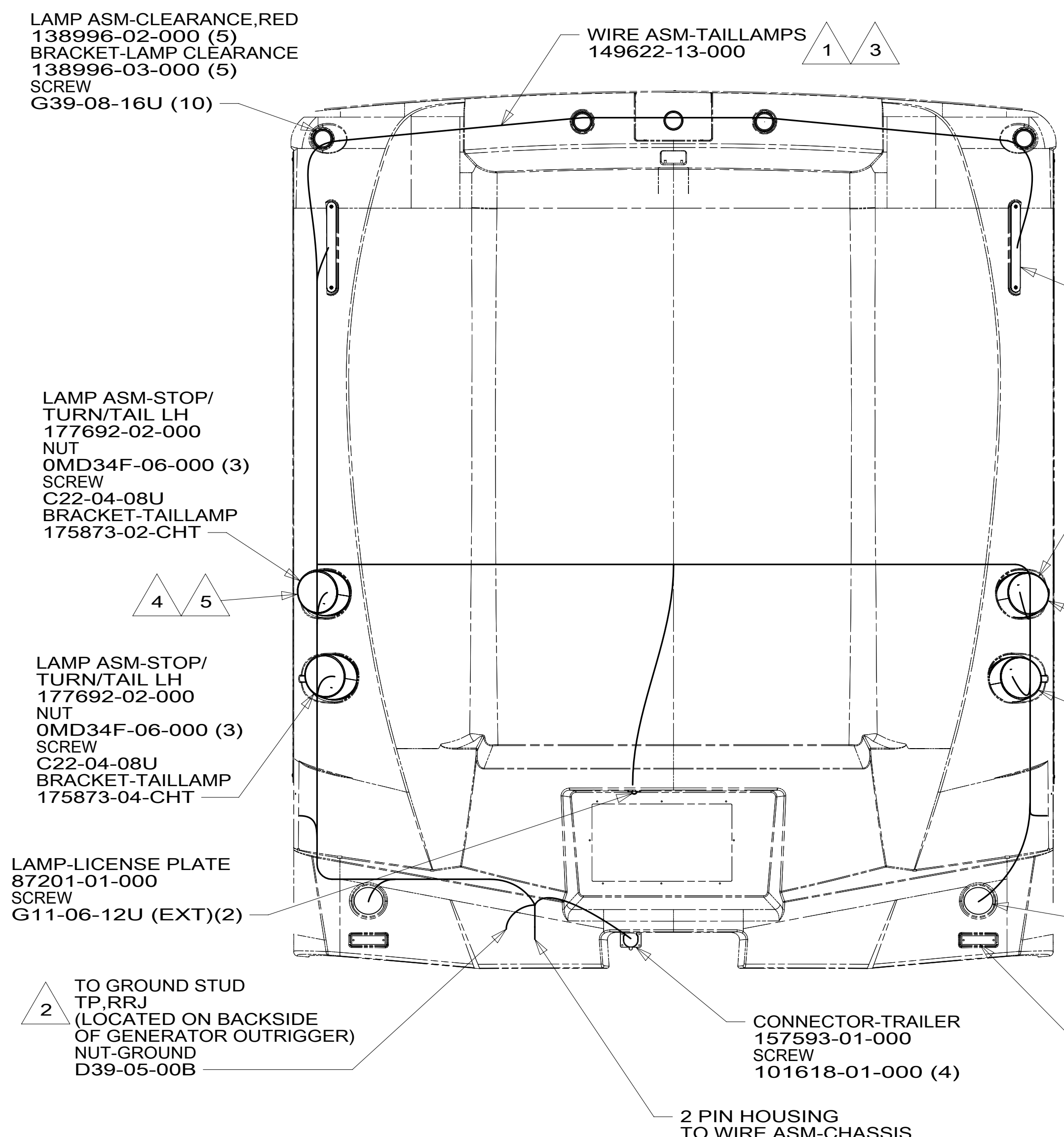

VIEW CB

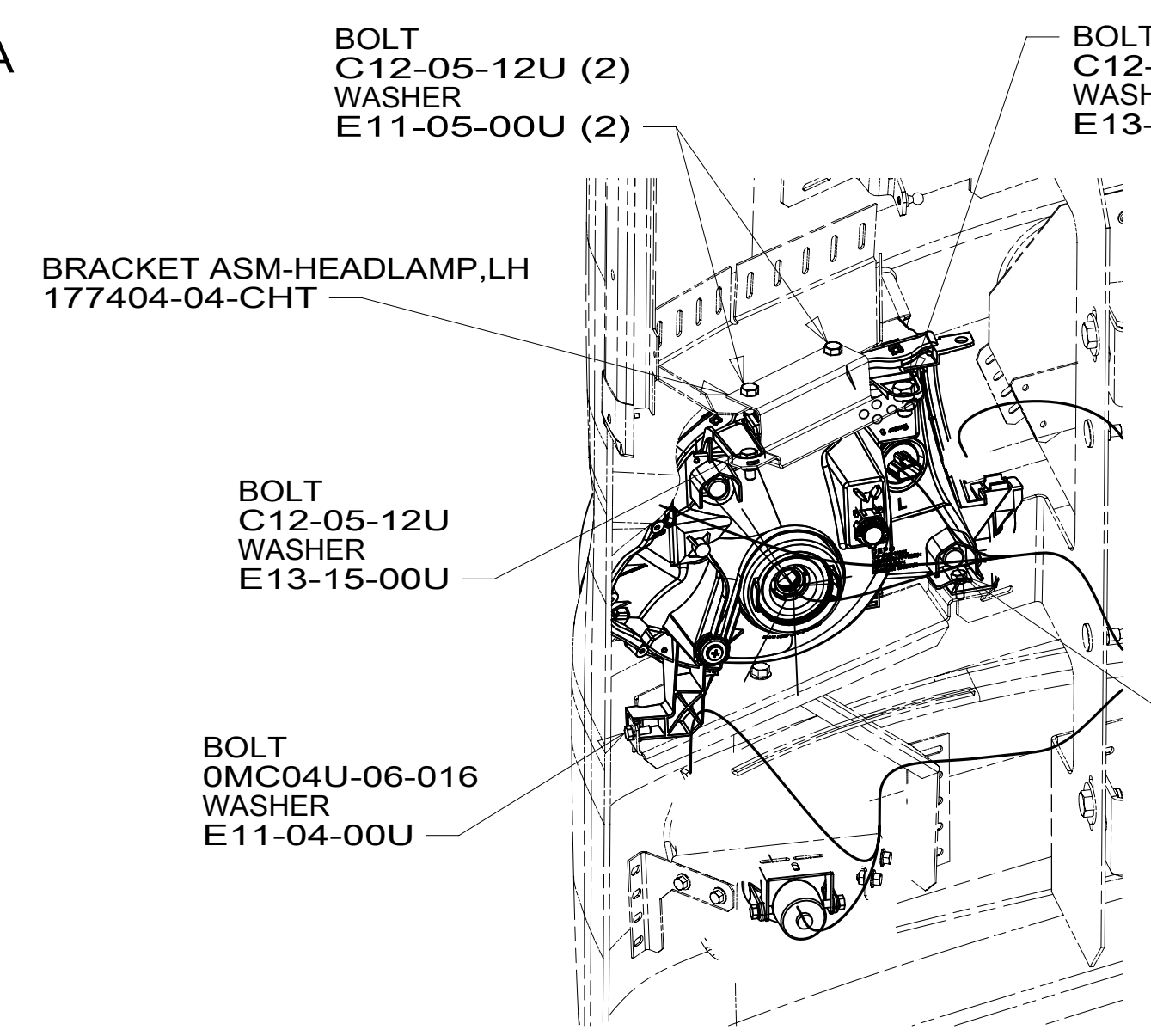

DETAIL CC

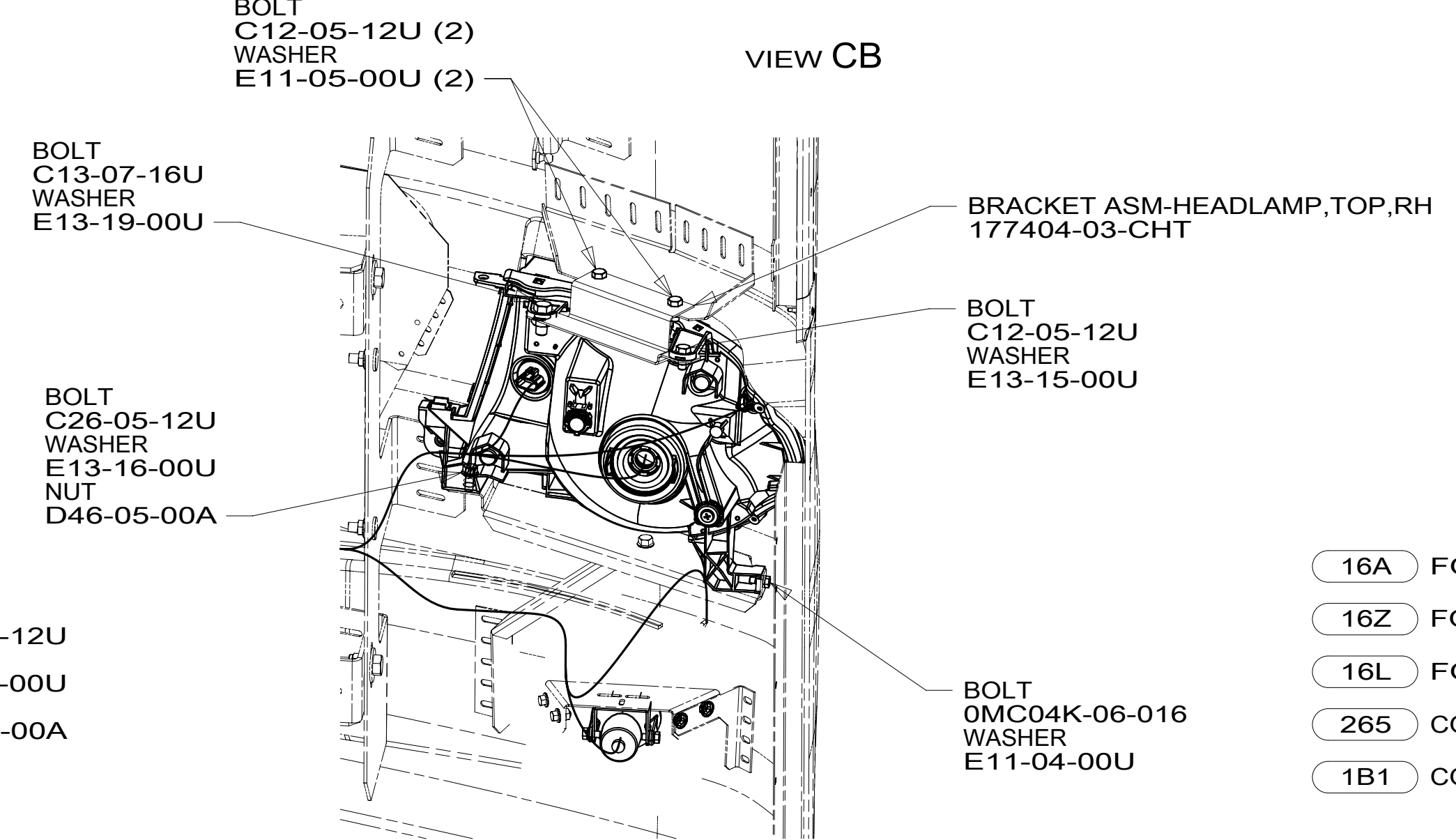

DETAIL CD

- NOTES:
- 6 REMOVE PAPER BACKING FROM REFLECTOR AND PREP APPLICATION SURFACE WITH ISOPROPYL ALCOHOL WIPE BEFORE INSTALLATION.
 - 5 LAMP WILL ONLY BE USED AS A TAILLAMP.
 - 4 ON SHELLS THE SIDEMARKER LAMPS EXIT THE SIDEWALL HERE. SPLICE YELLOW WIRE TO CIRCUIT MM AND WHITE WIRE TO CIRCUIT TP WITH SPLICE 58028-01-000 (2).
 - 3 SECURE WIRE ASM APPROX. EVERY 450 MM TO BACKWALL BRACKETS. USE TIE-WIRE 8343-01-000 OR 93147-01-000 AS APPROPRIATE.
 - 2 CLEAN PAINT OFF METAL (BOLT) BEFORE CONNECTING GROUND TO INSURE CONTACT.
 - 1 GATHER ALL EXCESS WIRE AFTER MAKING ALL CONNECTIONS AND BUNDLE AND SECURE WITH TIE-WIRE 8343-01-000 OR 93147-01-000.

FOR ELECTRICAL TORQUE SPECIFICATIONS SEE DWG NO. 128783-01-000

FOR ELECTRICAL CALLOUTS SEE DWG NO. 121339-01-000

- 16A FORD 26,000#-22.5 AL WHL
- 16Z FORD 24,000#-22.5 ALUM WHEEL
- 16L FORD 22,000#-22.5 AL WHL
- 265 CODES/STANDARDS-CSA/CMVSS
- 1B1 CODES/STANDARDS USA

1B1 265 16A 16L 16Z

FIRST USED

14 J-SERIES

DO NOT SCALE DRAWING

TITLE: WIRING INSTL-EXTERIOR LAMPS

SHEET 3 PART NO 184432 REV

19-Feb-2015

184432