



DANGER

Danger of electrical shock, burns or death. Always remove all power sources before attempting any repair, service or diagnostic work. Power can be present from shore power, generator, inverter or battery. All power sources must be disabled and secured before performing any service.



CAUTION

If you lack the skills, tools or equipment to perform diagnostic or repair work leave such work to an authorized Winnebago Industries dealer or other qualified shop.

DRAWING NO.	FEATURE
181376-01	-----
181376-11	1B1 12D
181376-15	265 12D

RELEASE	REV/DATE	DWG NO	181376
REV ZONE	REVISION RECORD	DATE	DFT-ORIG

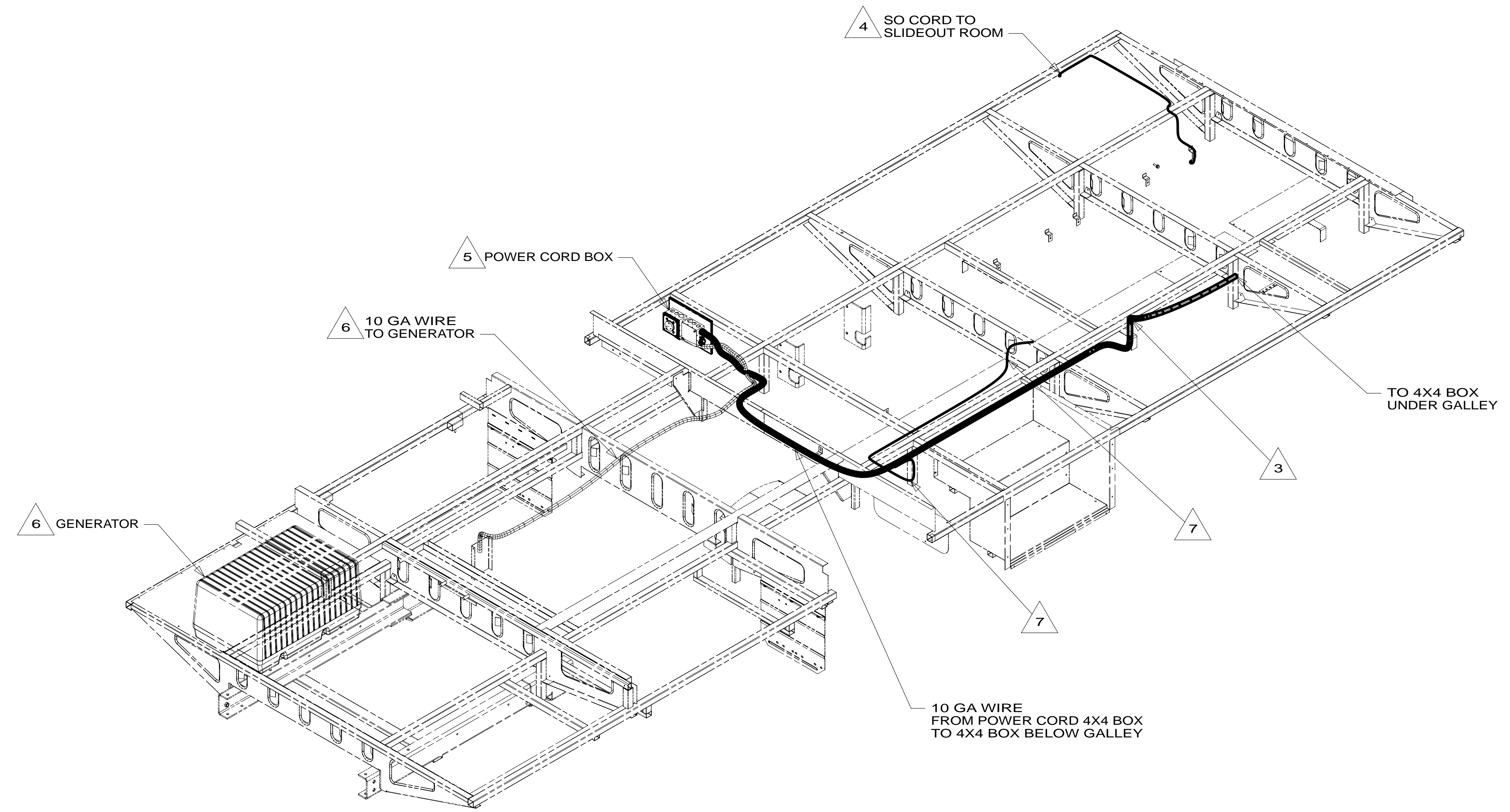

- 7 WIRE ROUTED BELOW FLOOR IN THIS AREA.
- 6 SEE GENERATOR INSTL FOR ADDITIONAL INFORMATION.
- 5 SEE LOAD CENTER/ATS ASM FOR ADDITIONAL INFORMATION.
- 4 CORD IS PART OF WIRE ASM-CHASSIS.
- 3 ROUTE WIRE THRU FLOOR.

2. ALL 110V WIRE TO BE CLAMPED WITH CLAMP 10497-05-000 WITHIN 200MM OF OUTLET BOXES, USE SCREW G67-10-12B.
1. ALL WIRES TO BE SECURED WITH CLAMP 10495 OR 10497 OR WIRE TIE 8343 OR 108046 EVERY 600MM, USE SCREW G67-XX-XXX OR G56-XX-XXX AS APPROPRIATE FOR INSTALLATION.

NOTES:

- 61B TV-26"AC,STEREO SYS,VDEO SEL
- 1MA ENTERTAINMENT SYSTEM
- 12D ELECTRICAL SYSTEM 30 AMP
- 265 CODES/STANDARDS-CSA/CMVSS
- 1B1 CODES/STANDARDS USA

1B1 265

WINNEBAGO		COPYRIGHT 2013 WINNEBAGO INDUSTRIES, INC.	
DFT-ORIG	ORIG. DATE	ALL DIMENSIONS ARE IN MILLIMETERS	
CHKR			
P.E.			
M.E.	FIRST USED	13 231W	
DSNR			
UNSPECIFIED TOLERANCES ARE:		MATERIAL:	
WHOLE DIM (X)	: 3		
ONE-PLACE (X.X)	: 1.5		
TWO-PLACE (X.XX)	: 0.50		
ANGLE	: 1'		
THIRD ANGLE PROJECTION			
DO NOT SCALE DRAWING	REFER TO ES0018 FOR FASTENER TIGHTENING GUIDELINES		
TITLE: WIRING INSTL-BODY,110V			
SHEET 1 OF 3	PART NO	181376	REV
REF:	1	26-Feb-2013	

FOR ELECTRICAL
TORQUE
SPECIFICATIONS
SEE DWG NO.
128783-01-000

FOR
ELECTRICAL
CALLOUTS
SEE DWG NO.
121339-01-000

* 181376 *

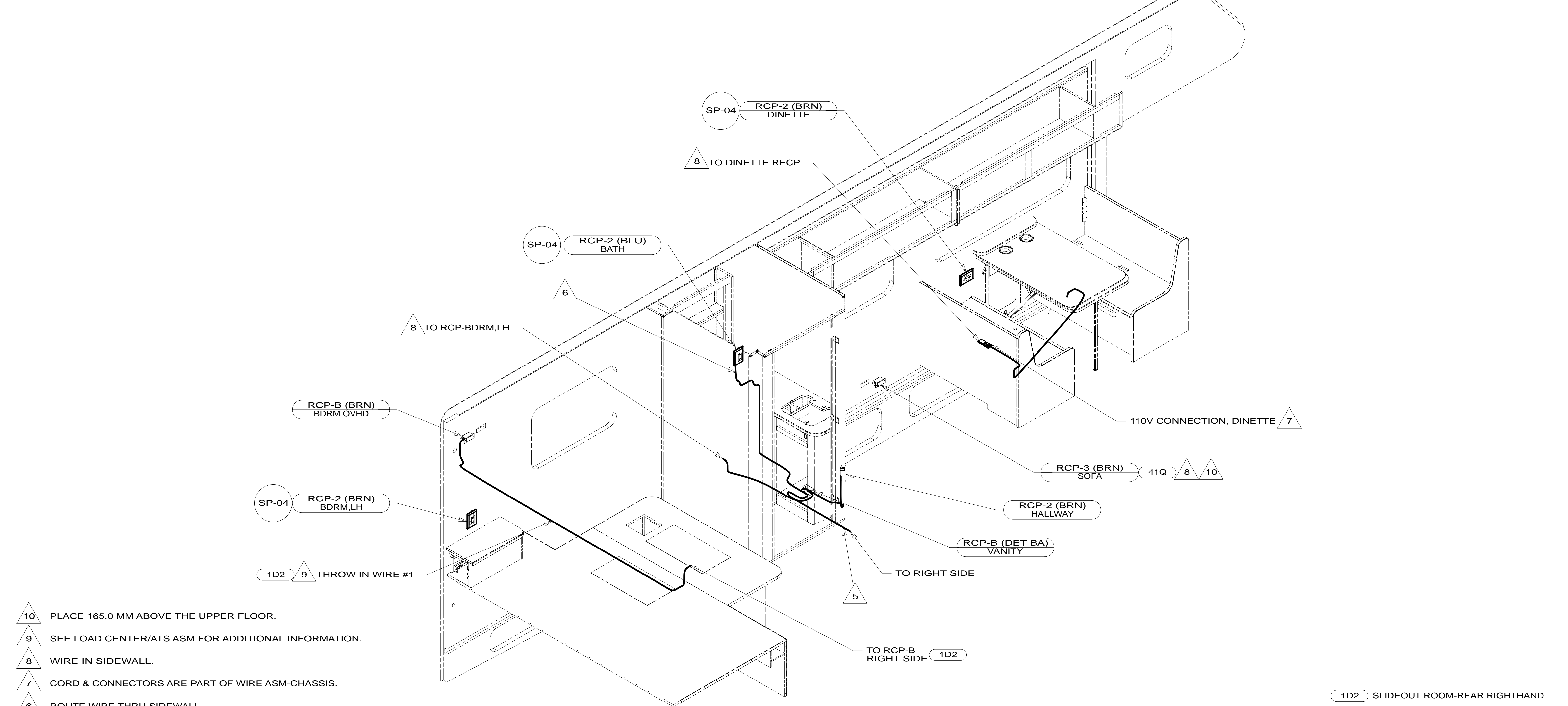
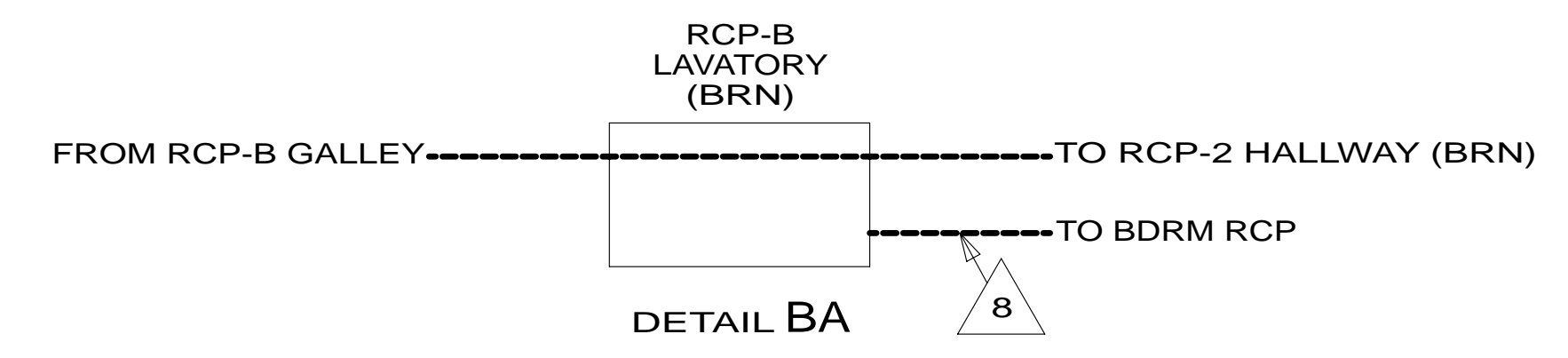

- 10 PLACE 165.0 MM ABOVE THE UPPER FLOOR.
 - 9 SEE LOAD CENTER/ATS ASM FOR ADDITIONAL INFORMATION.
 - 8 WIRE IN SIDEWALL.
 - 7 CORD & CONNECTORS ARE PART OF WIRE ASM-CHASSIS.
 - 6 ROUTE WIRE THRU SIDEWALL.
 - 5 ROUTE WIRE THRU FLOOR.
4. FOR MORE INFORMATION SEE WIRING DIAGRAM-BODY,110V.
 3. ALL GROUND WIRE TO BE COVERED WITH TUBING 8041-02-000.
 2. ALL 110V WIRE TO BE CLAMPED WITH CLAMP 10497-05-000 WITHIN 200MM OF OUTLET BOXES, USE SCREW G67-10-12B.
 1. ALL WIRES TO BE SECURED WITH CLAMP 10495 OR 10497 OR WIRE TIE 8343 OR 108046 EVERY 600MM, USE SCREW G67-XX-XXX OR G56-XX-XXX AS APPROPRIATE FOR INSTALLATION.

NOTES:

- 1D2 SLIDEOUT ROOM-REAR RIGHTHAND
- 41Q SOFA/SLEEPER-ULTRALEATHER HP
- 265 CODES/STANDARDS-CSA/CMVSS
- 1B1 CODES/STANDARDS USA

FIRST USED		13 231W	
DO NOT SCALE DRAWING			
TITLE: WIRING INSTL-BODY, 110V			
SHEET 2	PART NO	181376	REV
		1	26-Feb-2013

FOR ELECTRICAL TORQUE SPECIFICATIONS SEE DWG NO. 128783-01-000

FOR ELECTRICAL CALLOUTS SEE DWG NO. 121339-01-000

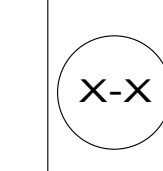

* 181376 * A

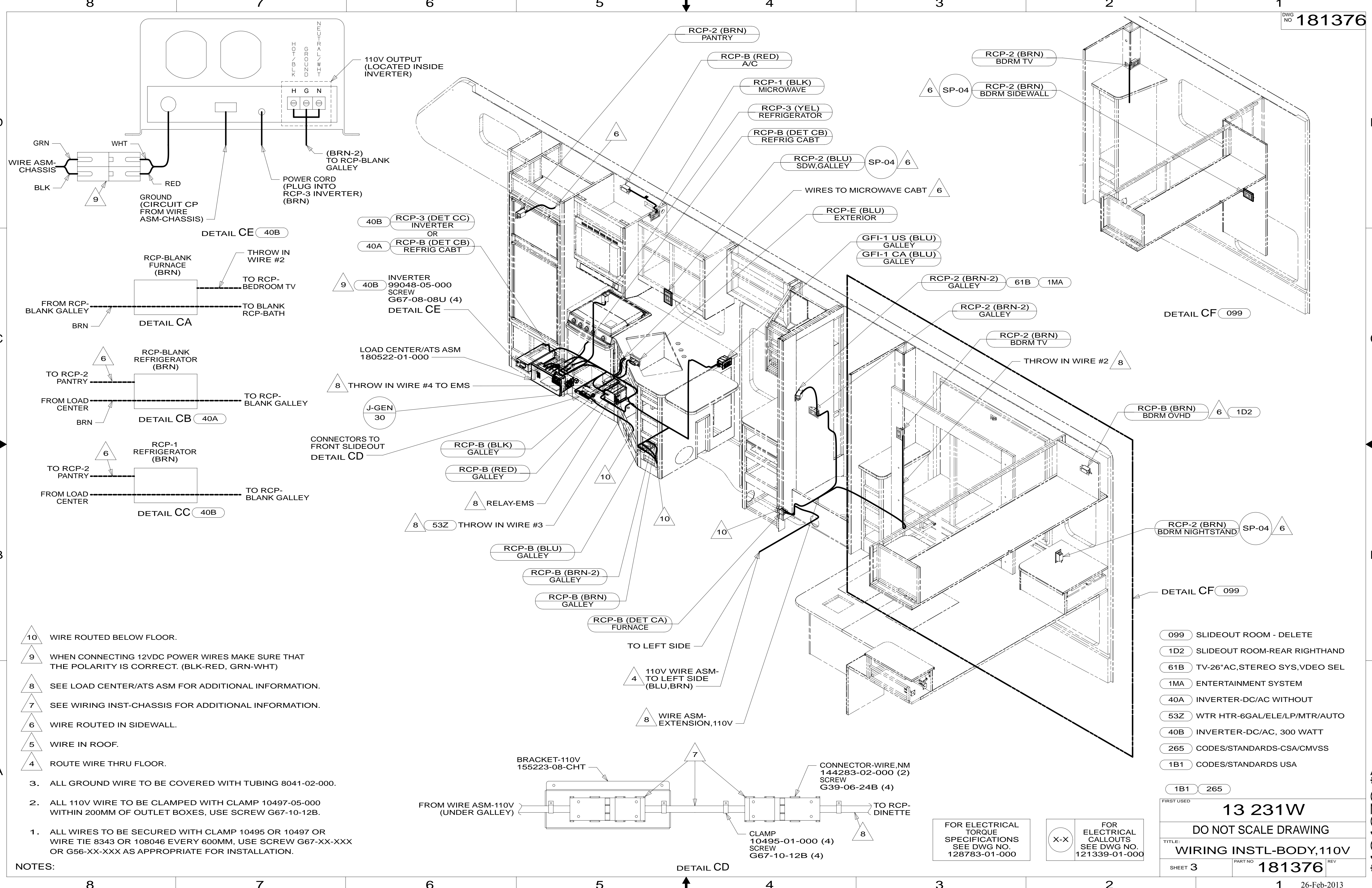

8
7
6
5
4
3
2
1

D
C
B
A

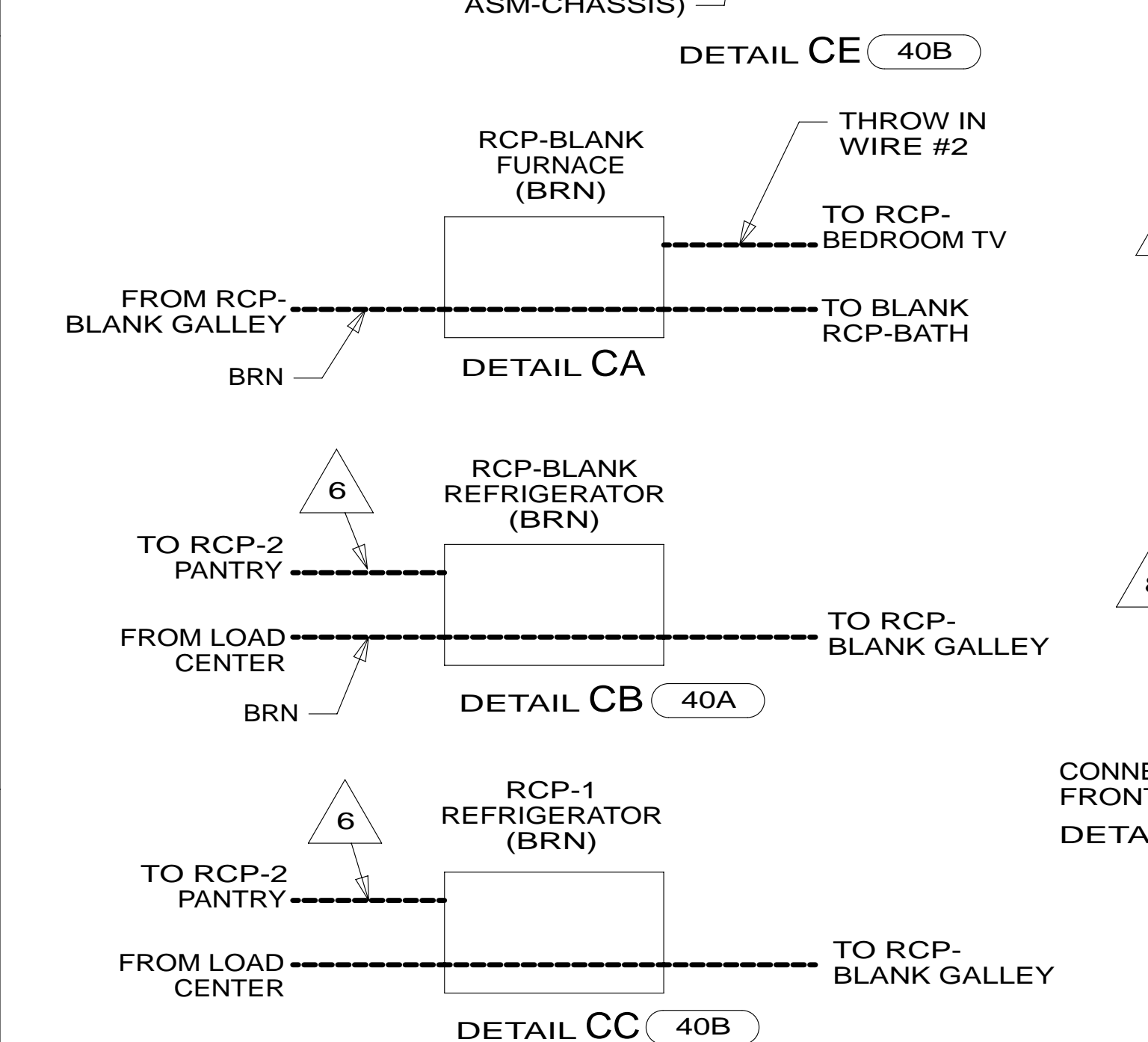
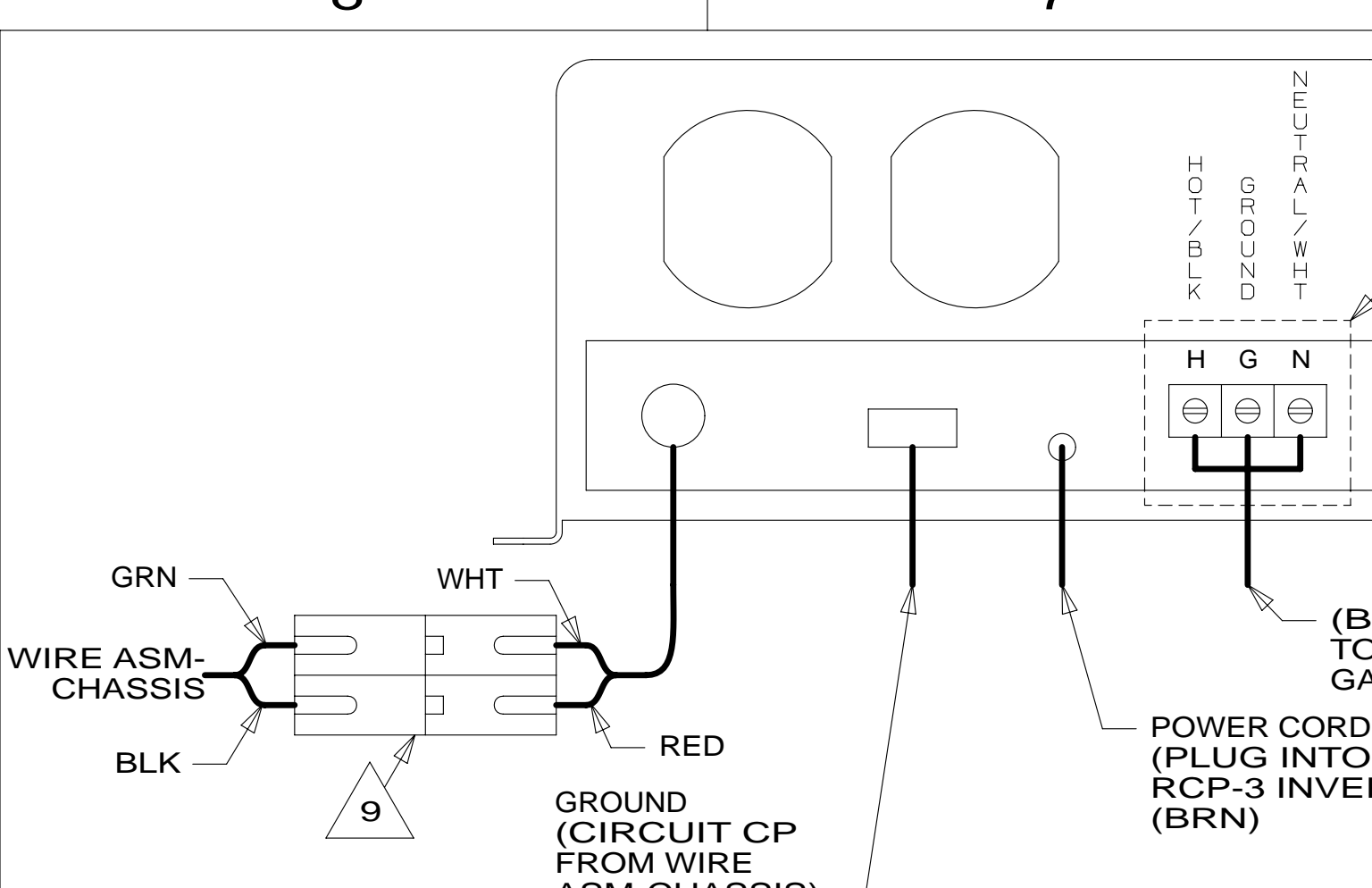

NOTES:

1. ALL WIRES TO BE SECURED WITH CLAMP 10495 OR 10497 OR WIRE TIE 8343 OR 108046 EVERY 600MM, USE SCREW G67-XX-XXX OR G56-XX-XXX AS APPROPRIATE FOR INSTALLATION.
2. ALL 110V WIRE TO BE CLAMPED WITH CLAMP 10497-05-000 WITHIN 200MM OF OUTLET BOXES, USE SCREW G67-10-12B.
3. ALL GROUND WIRE TO BE COVERED WITH TUBING 8041-02-000.

10 WIRE ROUTED BELOW FLOOR.
 9 WHEN CONNECTING 12VDC POWER WIRES MAKE SURE THAT THE POLARITY IS CORRECT. (BLK-RED, GRN-WHT)
 8 SEE LOAD CENTER/ATS ASM FOR ADDITIONAL INFORMATION.
 7 SEE WIRING INST-CHASSIS FOR ADDITIONAL INFORMATION.
 6 WIRE ROUTED IN SIDEWALL.
 5 WIRE IN ROOF.
 4 ROUTE WIRE THRU FLOOR.

110V OUTPUT (LOCATED INSIDE INVERTER)

(BRN-2) TO RCP-BLANK GALLEY

POWER CORD (PLUG INTO RCP-3 INVERTER) (BRN)

WIRE ASM-CHASSIS

GRN

WHT

RED

BLK

GROUND (CIRCUIT CP FROM WIRE ASM-CHASSIS)

DETAIL CE 40B

40B RCP-3 (DET CC) INVERTER OR RCP-B (DET CB) REFRIG CABT

40A RCP-B (DET CB) REFRIG CABT

INVERTER 99048-05-000 SCREW G67-08-08U (4) DETAIL CE

LOAD CENTER/ATS ASM 180522-01-000

THROW IN WIRE #4 TO EMS

J-GEN 30

CONNECTORS TO FRONT SLIDEOUT DETAIL CD

RCP-B (BLK) GALLEY

RCP-B (RED) GALLEY

RELAY-EMS

53Z THROW IN WIRE #3

RCP-B (BLU) GALLEY

RCP-B (BRN-2) GALLEY

RCP-B (BRN) GALLEY

RCP-B (DET CA) FURNACE

TO LEFT SIDE

110V WIRE ASM-TO LEFT SIDE (BLU, BRN)

WIRE ASM-EXTENSION, 110V

RCP-2 (BRN) PANTRY

RCP-B (RED) A/C

RCP-1 (BLK) MICROWAVE

RCP-3 (YEL) REFRIGERATOR

RCP-B (DET CB) REFRIG CABT

RCP-2 (BLU) SDW. GALLEY

WIRES TO MICROWAVE CABT

RCP-E (BLU) EXTERIOR

GFI-1 US (BLU) GALLEY

GFI-1 CA (BLU) GALLEY

RCP-2 (BRN-2) GALLEY 61B 1MA

RCP-2 (BRN-2) GALLEY

RCP-2 (BRN) BDRM TV

THROW IN WIRE #2

RCP-B (BRN) BDRM OVHD 1D2

RCP-2 (BRN) BDRM NIGHTSTAND SP-04 6

DETAIL CF 099

DETAIL CF 099

099 SLIDEOUT ROOM - DELETE

1D2 SLIDEOUT ROOM-REAR RIGHTHAND

61B TV-26"AC, STEREO SYS, VIDEO SEL

1MA ENTERTAINMENT SYSTEM

40A INVERTER-DC/AC WITHOUT

53Z WTR HTR-6GAL/ELE/LP/MTR/AUTO

40B INVERTER-DC/AC, 300 WATT

265 CODES/STANDARDS-CSA/CMVSS

1B1 CODES/STANDARDS USA

1B1 265

FIRST USED

13 231W

DO NOT SCALE DRAWING

TITLE: WIRING INSTL-BODY, 110V

SHEET 3 PART NO 181376 REV

26-Feb-2013

FOR ELECTRICAL TORQUE SPECIFICATIONS SEE DWG NO. 128783-01-000

FOR ELECTRICAL CALLOUTS SEE DWG NO. 121339-01-000

* 181376 * A