



**DANGER**

**Danger of electrical shock, burns or death.** Always remove all power sources before attempting any repair, service or diagnostic work. Power can be present from shore power, generator, inverter or battery. All power sources must be disabled and secured before performing any service.



**CAUTION**

If you lack the skills, tools or equipment to perform diagnostic or repair work leave such work to an authorized Winnebago Industries dealer or other qualified shop.

| DRAWING NO. | UNIT |
|-------------|------|
| 181240-01   | J32H |
| 181240-02   | J37F |
| 181240-03   | J35P |
| 181240-04   | J33S |
| 181240-05   | J38S |

|          |                 |                  |
|----------|-----------------|------------------|
| RELEASE  | REV/DATE<br>A   | DWG NO<br>181240 |
| REV ZONE | REVISION RECORD | DATE DFR-ORIG    |

|   |             | J32H          | J37F          | J35P          | J33S          | J38S          |
|---|-------------|---------------|---------------|---------------|---------------|---------------|
| CABLE ASM-CHASSIS GND EXT (BLK)                   | 16Z 16L 16A | 133566-12-031 | 133566-12-043 | 133566-12-031 | 133566-12-023 | 133566-12-047 |
| CHASSIS BATTERY DISCONNECT RETURN (PUR)           | 16Z 16L 16A | 141415-12-035 | 141415-12-047 | 141415-12-035 | 141415-12-024 | 141415-12-051 |
| CABLE ASM-CHASSIS BATTERY DISCONNECT SUPPLY (RED) | 16Z 16L 16A | 141415-32-013 | 141415-32-013 | 141415-32-013 | 141415-32-012 | 141415-32-012 |
| CABLE ASM-COACH BATTERY (YEL)                     |             | 141416-52-014 | 141416-52-014 | 141416-52-014 | 141416-52-008 | 141416-52-008 |
| CABLE ASM-COACH BATTERY GND (BLK)                 |             | 133567-12-006 | 133567-12-006 | 133567-12-006 | 133567-12-006 | 133567-12-006 |
| CABLE ASM-STARTER (RED)                           |             | 141416-32-033 | 141416-32-045 | 141416-32-033 | 141416-32-022 | 141416-32-049 |
| CABLE ASM-GENERATOR (GRN)                         | 321 52P     | 141415-42-075 | 141415-42-075 | 141415-42-079 | 141415-42-082 | 141415-42-070 |
| WIRE ASM-INVERTER                                 | 401         | 154845-02-012 | 154845-02-012 | 154845-02-012 | N/A           | N/A           |
| LEVELING SYSTEM POWER CABLE (BLU)                 | 60M         | 141415-29-025 | 141415-29-025 | 141415-29-025 | 141415-29-025 | 141415-29-025 |
| LEVELING SYSTEM GND CABLE (BLK)                   | 60M         | 133566-11-008 | 133566-11-008 | 133566-11-008 | 133566-11-008 | 133566-11-008 |

- 16A FORD 26,000#-22.5 AL WHL
- 52P GEN-5.5KW ONAN-GAS-MARQ GOLD
- 321 GENERATOR PREP KIT
- 60M HYDRAULIC LEVEL JACKS-AUTO
- 401 INVERTER-DC/AC, 1000 WATT
- 16Z FORD 24,000#-22.5 ALUM WHEEL
- 16L FORD 22,000#-22.5 AL WHL
- 265 CODES/STANDARDS-CSA/CMVSS
- 1B1 CODES/STANDARDS USA

1B1 265



|                             |  |
|-----------------------------|--|
| DFTR                        | ORIG. DATE   |
| CHKR                        | ALL DIMENSIONS ARE IN MILLIMETERS                  |
| P.E.                        |  |
| M.E.                        | FIRST USED   |
| DSNR                        | 13 J-SERIES  |
| UNSPECIFIED TOLERANCES ARE: |  |
| WHOLE DIM (X)               | : 3  |
| ONE-PLACE (X.X)             | : 1.5  |
| TWO-PLACE (X.XX)            | : 0.50   |
| ANGLE                       | : 1'   |
| THIRD ANGLE PROJECTION      |  |
| DO NOT SCALE DRAWING        | REFER TO ES0018 FOR FASTENER TIGHTENING GUIDELINES |
| TITLE: BATTERY INSTL,FD     |  |
| SHEET 1 OF 3                | PART NO 181240 REV                                 |

2 SEE DWG 154845-02 TO DETERMINE CABLE ASM PART NUMBERS AND STRUCTURE.

1 BATTERY CABLES MUST BE INSTALLED TO STARTER MOTOR BEFORE ENGINE WIRING HARNESS AND ROUTED IN SUCH A MANNER AS TO PREVENT ANY POSSIBLE DEGRADATION FROM THE EXHUAST SYSTEM.

FOR ELECTRICAL TORQUE SPECIFICATIONS SEE DWG NO. 128783-01-000

FOR ELECTRICAL CALLOUTS SEE DWG NO. 121339-01-000

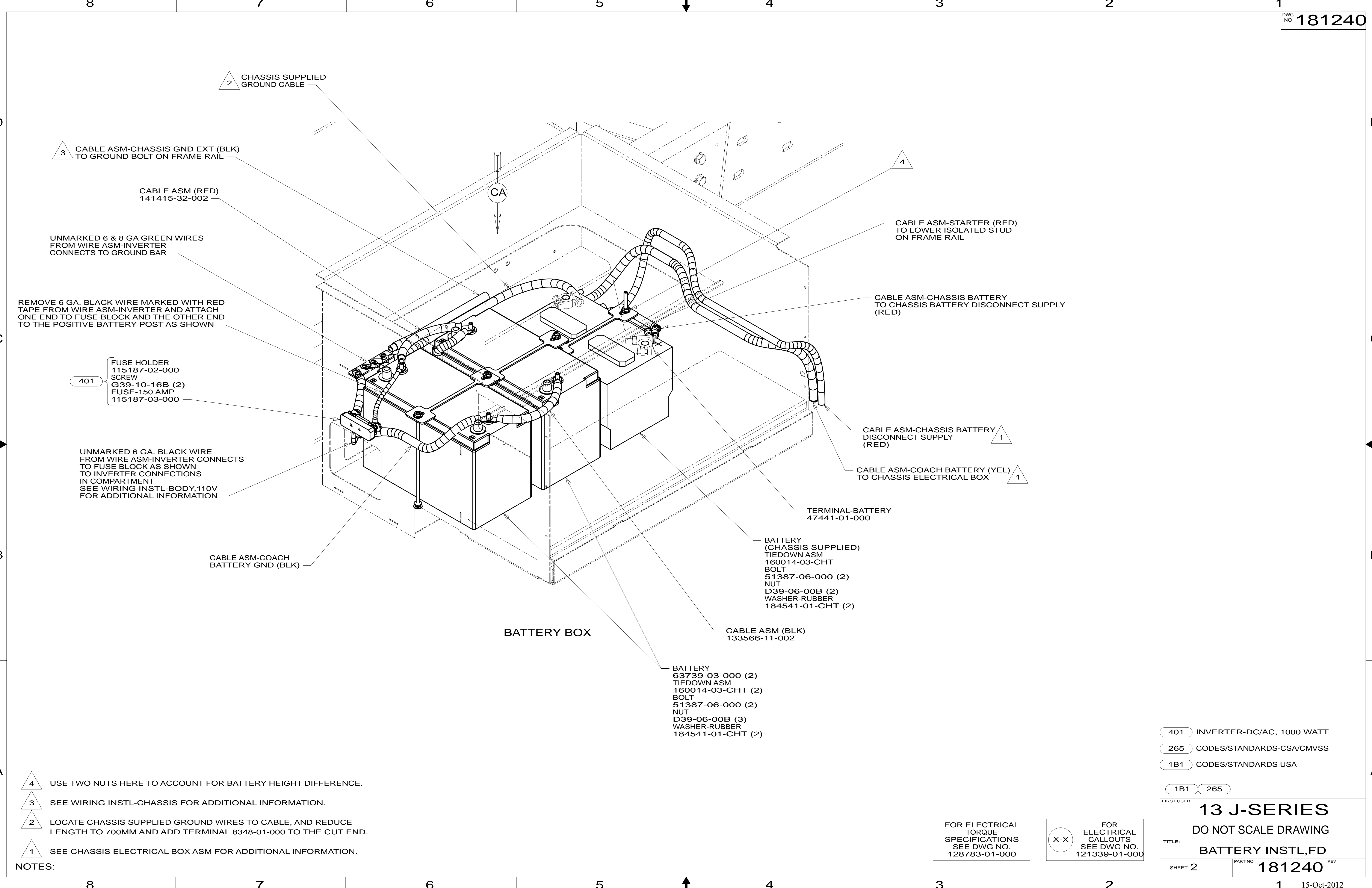

- NOTES:
- 4 USE TWO NUTS HERE TO ACCOUNT FOR BATTERY HEIGHT DIFFERENCE.
  - 3 SEE WIRING INSTL-CHASSIS FOR ADDITIONAL INFORMATION.
  - 2 LOCATE CHASSIS SUPPLIED GROUND WIRES TO CABLE, AND REDUCE LENGTH TO 700MM AND ADD TERMINAL 8348-01-000 TO THE CUT END.
  - 1 SEE CHASSIS ELECTRICAL BOX ASM FOR ADDITIONAL INFORMATION.

- 401 INVERTER-DC/AC, 1000 WATT
- 265 CODES/STANDARDS-CSA/CMVSS
- 1B1 CODES/STANDARDS USA

|                                |                           |
|--------------------------------|---------------------------|
| FIRST USED                     |                           |
| <b>13 J-SERIES</b>             |                           |
| <b>DO NOT SCALE DRAWING</b>    |                           |
| TITLE: <b>BATTERY INSTL,FD</b> |                           |
| SHEET 2                        | PART NO <b>181240</b> REV |

FOR ELECTRICAL TORQUE SPECIFICATIONS SEE DWG NO. 128783-01-000

FOR ELECTRICAL CALLOUTS SEE DWG NO. 121339-01-000

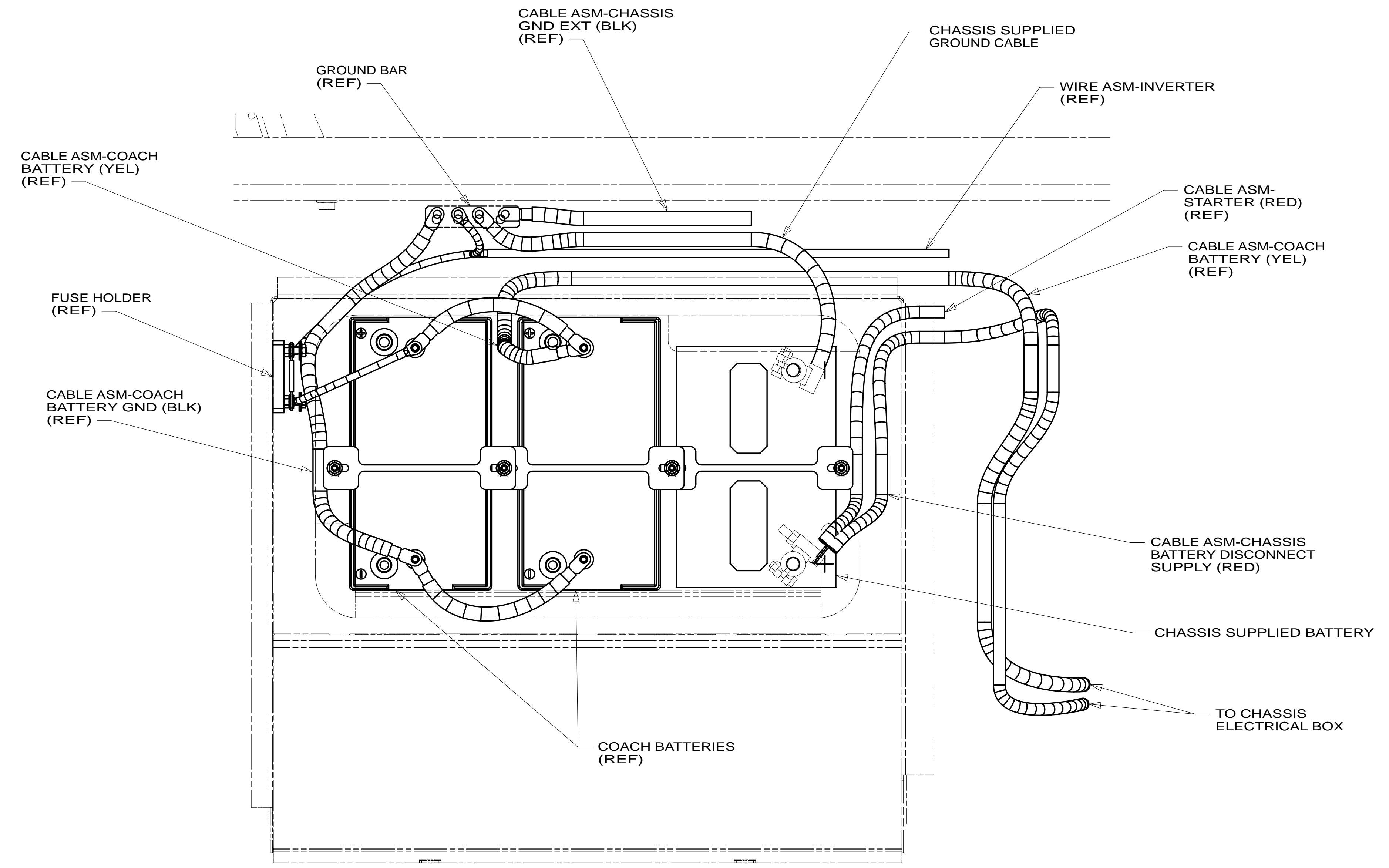

VIEW CA

- 265 CODES/STANDARDS-CSA/CMVSS
- 1B1 CODES/STANDARDS USA
- 1B1 265

|                         |                           |
|-------------------------|---------------------------|
| FIRST USED              |                           |
| <b>13 J-SERIES</b>      |                           |
| DO NOT SCALE DRAWING    |                           |
| TITLE:                  |                           |
| <b>BATTERY INSTL,FD</b> |                           |
| SHEET 3                 | PART NO <b>181240</b> REV |

FOR ELECTRICAL TORQUE SPECIFICATIONS SEE DWG NO. 128783-01-000

X-X FOR ELECTRICAL CALLOUTS SEE DWG NO. 121339-01-000