



DANGER

Danger of electrical shock, burns or death. Always remove all power sources before attempting any repair, service or diagnostic work. Power can be present from shore power, generator, inverter or battery. All power sources must be disabled and secured before performing any service.



CAUTION

If you lack the skills, tools or equipment to perform diagnostic or repair work leave such work to an authorized Winnebago Industries dealer or other qualified shop.

DRAWING NO.	MODEL	SHEET
180635-01	727K	1,2
180635-02	728T	1
180635-03	730C,730J	1,2

RELEASE	REV/DATE	DWG NO	180635
REV ZONE	REVISION RECORD	DATE	DTR-ORIG

		727K	728T 1	730C	730J
CABLE ASM-STARTER (RED)	16Y	141415-34-054	-----	141415-34-056	141415-34-056
CABLE ASM-COACH BATTERY (YEL)	16Y	141415-52-020	-----	141415-52-014	141415-52-014
CABLE ASM-COACH BATTERY GND (BLK)	16Y	133566-12-015	-----	133566-12-015	133566-12-015
CABLE ASM-GENERATOR (GRN)	16Y	141415-42-040	-----	141415-42-035	141415-42-035
CABLE ASM-GENERATOR GND (BLK)	16Y	133566-12-008	-----	133566-12-008	133566-12-008
LEVELING SYSTEM POWER CABLE (BLU)	60M	141415-22-017	-----	141415-22-020	141415-22-020
CABLE ASM INVERTER FUSE (ORG)	401	141415-64-011	-----	141415-64-011	141415-64-011
CABLE ASM INVERTER (ORG)	401	141415-64-015	-----	141415-64-011	141415-64-011
CABLE ASM INVERTER GND (BLK)	401	133566-12-011	-----	133566-12-011	133566-12-011
INVERTER GND	401	139776-02-011	-----	139776-02-011	139776-02-011

- 401 INVERTER-DC/AC, 1000 WATT
- 16Y FORD CHASSIS - 14,500#
- 60M HYDRAULIC LEVEL JACKS-AUTO
- 265 CODES/STANDARDS-CSA/CMVSS
- 1B1 CODES/STANDARDS USA

WINNEBAGO COPYRIGHT 2013 WINNEBAGO INDUSTRIES, INC.

DTR: _____ ORIG. DATE: _____

CHKR: _____

P.E.: _____ ALL DIMENSIONS ARE IN MILLIMETERS

M.E.: _____ FIRST USED: _____

DSNR: _____ **13 700-SERIES**

UNSPECIFIED TOLERANCES ARE: MATERIAL: _____

WHOLE DIM (X) : _____

ONE-PLACE (X.X) : _____

TWO-PLACE (X.XX) : _____

ANGLE : _____

THIRD ANGLE PROJECTION

DO NOT SCALE DRAWING REFER TO ES0018 FOR FASTENER TIGHTENING GUIDELINES

TITLE: **BATTERY INSTL**

SHEET **1** OF **2** PART NO **180635** REV _____

REF: **1** 18-Apr-2013

1 MODEL DROPPED FOR 2013 AND 2014.

FOR ELECTRICAL TORQUE SPECIFICATIONS SEE DWG NO. 128783-01-000

X-X FOR ELECTRICAL CALLOUTS SEE DWG NO. 121339-01-000

* 180635 *

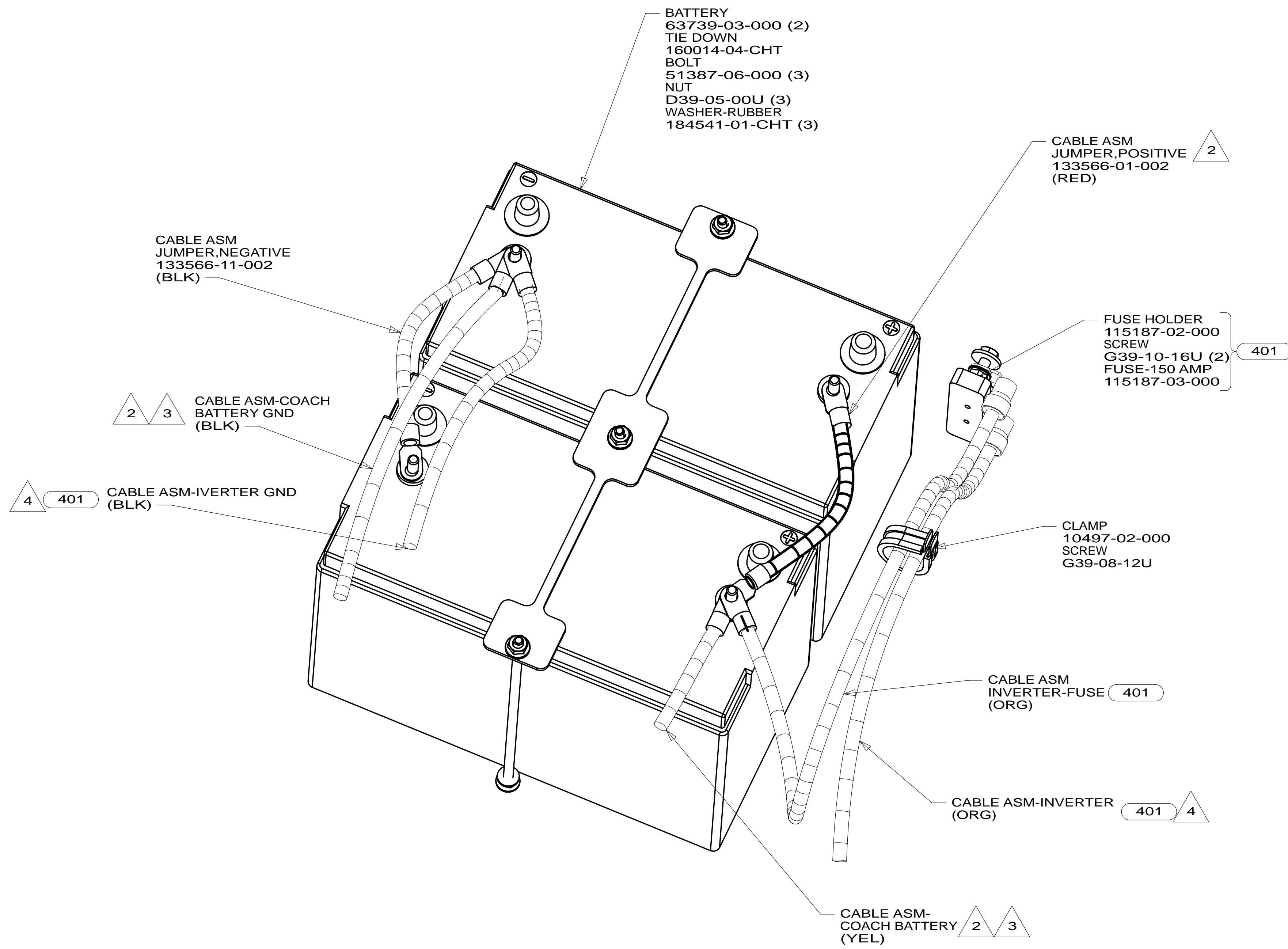

- 4 SEE WIRING INSTL-CHASSIS FOR ROUTING OF CABLE.
- 3 THE POSITIVE AND NEGATIVE BATTERY CABLES ARE TO BE TERMINATED ON OPPOSITE BATTERIES.
- 2 BATTERY CABLES ARE NOT TO BE ROUTED OVER BATTERY FILL CAPS.

NOTES:
1. SEE WIRING INSTL-CHASSIS FOR ADDITIONAL INFORMATION.

- 401 INVERTER-DC/AC, 1000 WATT
- 265 CODES/STANDARDS-CSA/CMVSS
- 1B1 CODES/STANDARDS USA

1B1 265

FIRST USED **13 700-SERIES**

DO NOT SCALE DRAWING

TITLE: **BATTERY INSTL**

SHEET 2 PART NO **180635** REV

FOR ELECTRICAL TORQUE SPECIFICATIONS SEE DWG NO. 128783-01-000

FOR ELECTRICAL CALLOUTS SEE DWG NO. 121339-01-000

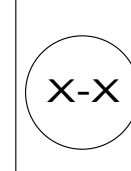

* 180635 * A