



DANGER

Danger of electrical shock, burns or death. Always remove all power sources before attempting any repair, service or diagnostic work. Power can be present from shore power, generator, inverter or battery. All power sources must be disabled and secured before performing any service.



CAUTION

If you lack the skills, tools or equipment to perform diagnostic or repair work leave such work to an authorized Winnebago Industries dealer or other qualified shop.

| | |
|-------------|--------|
| DRAWING NO. | SHEETS |
| 166036-01 | 1,2,3 |
| 166036-02 | 4,5,6 |

| | | |
|----------|-----------------|--------|
| RELEASE | REV/DATE | DWG NO |
| A | | 166036 |
| REV ZONE | REVISION RECORD | DATE |
| | | |

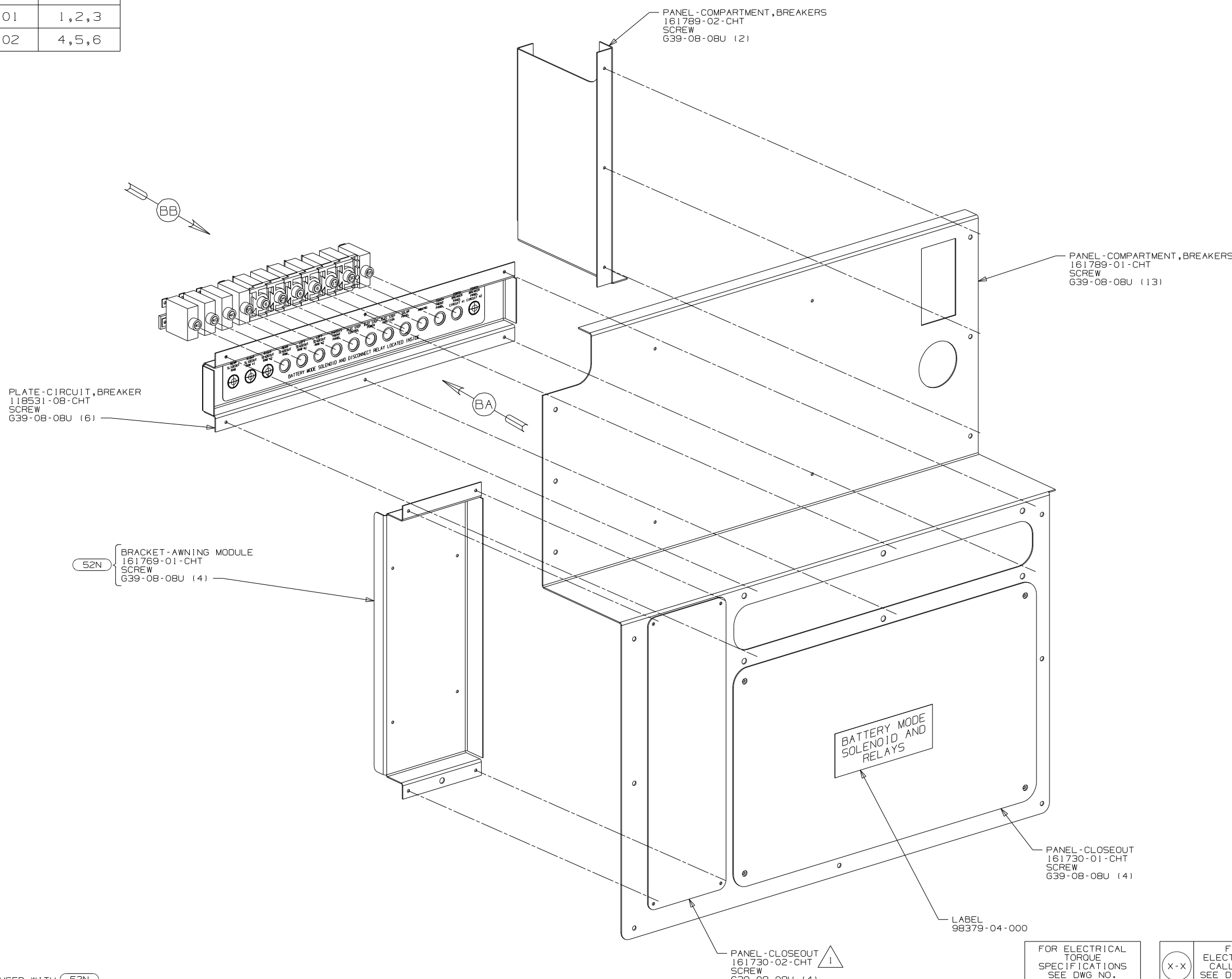

- 52N AWNING - PATIO, ELECTRIC
 - 290 SOLAR PANEL - 10 WATT
 - 102 SLIDEOUT ROOM-REAR RIGHTHAND
 - 096 SLIDEOUT ROOM - LH
 - 265 CODES/STANDARDS-CSA/CMVSS
 - 1B1 CODES/STANDARDS USA
- 1B1 265 096 102

WINNEBAGO COPYRIGHT 2008 WINNEBAGO INDUSTRIES, INC.

| | |
|------|-----------------------------------|
| DFTR | ORIG. DATE |
| CHKR | ALL DIMENSIONS ARE IN MILLIMETERS |
| P.E. | |
| M.E. | FIRST USED |
| DSNR | 09 J&K32H |

| | |
|-----------------------------|-----------|
| UNSPECIFIED TOLERANCES ARE: | MATERIAL: |
| HOLE DIM (X) | : 3 |
| ONE-PLACE (X.X) | : 1.5 |
| TWO-PLACE (X.XX) | : 0.50 |
| ANGLE | : 1° |

THIRD ANGLE PROJECTION

NOTES:
 1 NOT USED WITH 52N

FOR ELECTRICAL TORQUE SPECIFICATIONS SEE DWG NO. 128783-01-000

FOR ELECTRICAL CALLOUTS SEE DWG NO. 121339-01-000

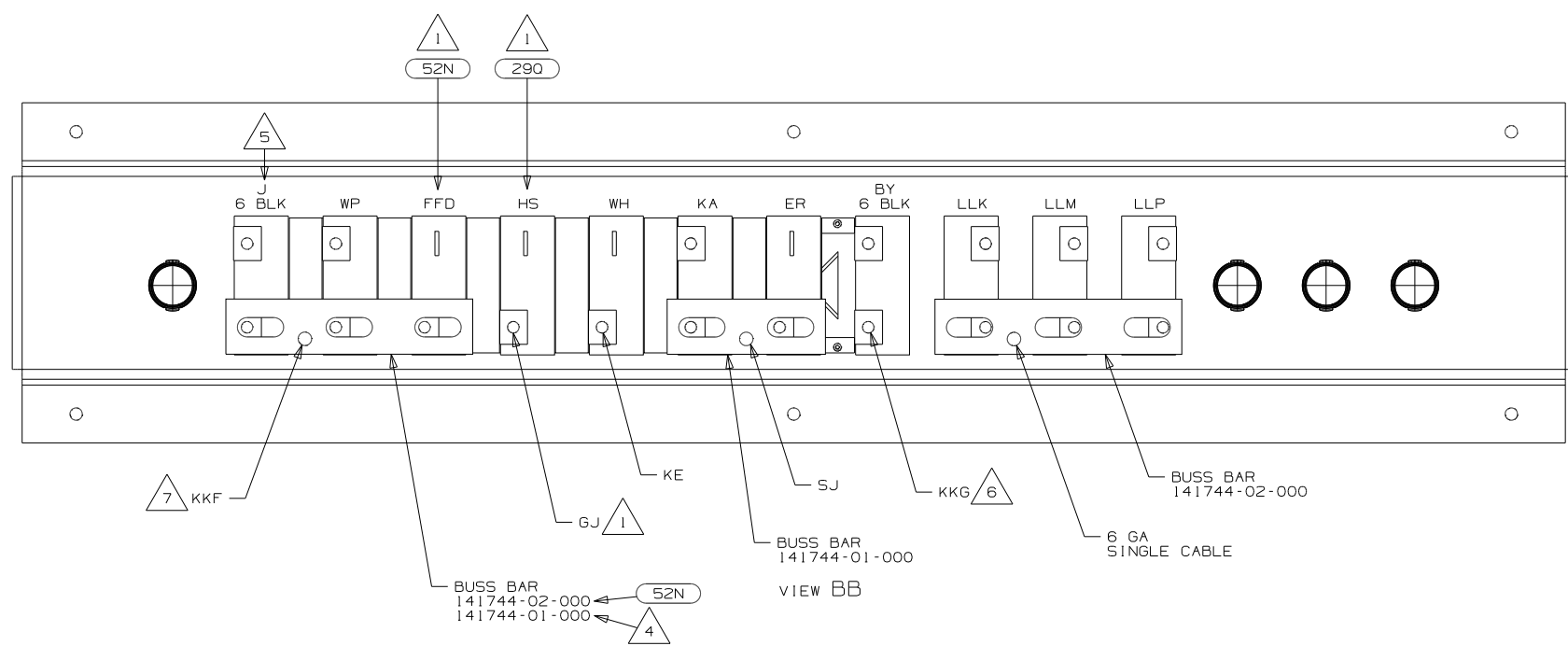
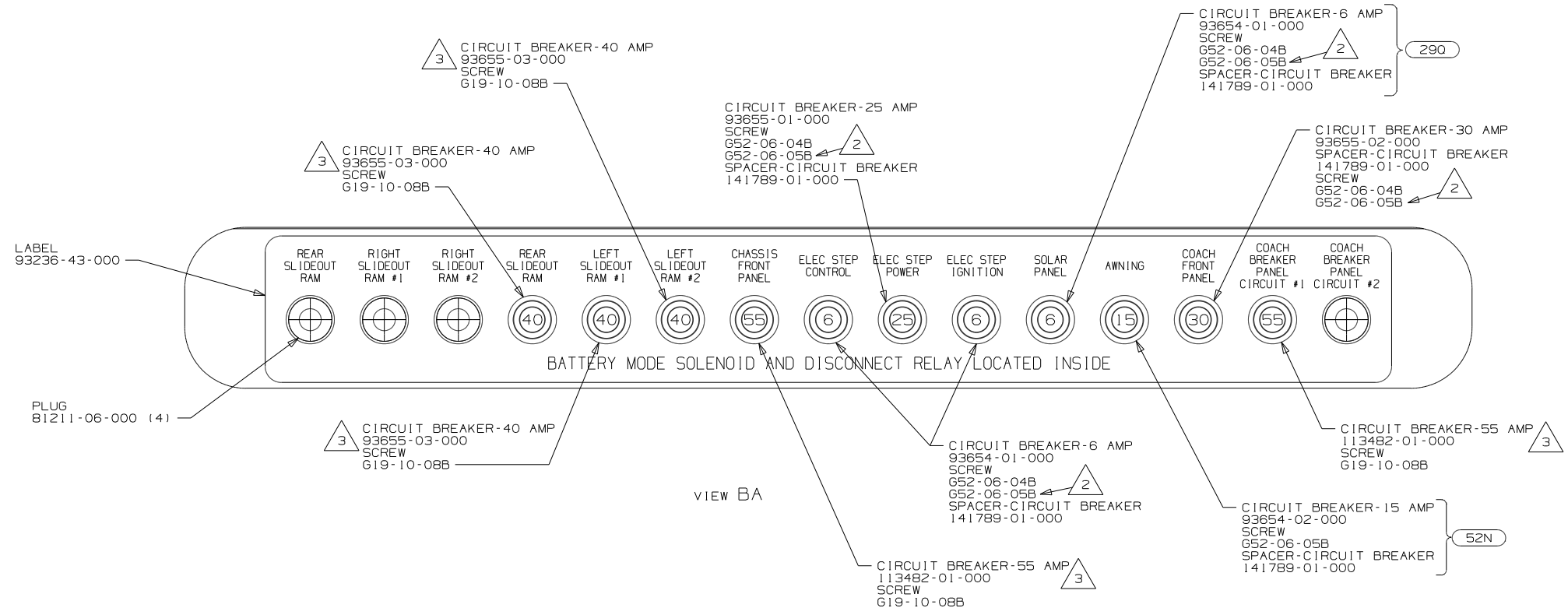

- 7 WIRE MARKED WITH 2 WRAPS OF YELLOW TAPE.
- 6 WIRE MARKED WITH PURPLE TAPE.
- 5 WIRE MARKED WITH YELLOW TAPE.
- 4 WITHOUT 52N
- 3 USE THE LONGER SCREW TO PROPERLY ATTACH BREAKER TO BUSS BAR.
- 2 REPLACE EXISTING SCREW TO PROPERLY ATTACH BREAKER TO BUSS BAR.
- 1 IF CIRCUIT NOT USED, TAPE BACK TO HARNESS.

- 52N AWNING - PATIO, ELECTRIC
- 290 SOLAR PANEL - 10 WATT
- 102 SLIDEOUT ROOM-REAR RIGHTHAND
- 09G SLIDEOUT ROOM - LH
- 265 CODES/STANDARDS-CSA/CMVSS
- 1B1 CODES/STANDARDS USA

FOR ELECTRICAL TORQUE SPECIFICATIONS SEE DWG NO. 128783-01-000

FOR ELECTRICAL CALLOUTS SEE DWG NO. 121339-01-000

| | | |
|------------|----------------------------|--------|
| FIRST USED | 09 J&K32H | |
| TITLE | DO NOT SCALE DRAWING | |
| TITLE | CHASSIS ELECTRICAL BOX ASM | |
| SHEET 2 | PART NO | 166036 |
| | REV | |

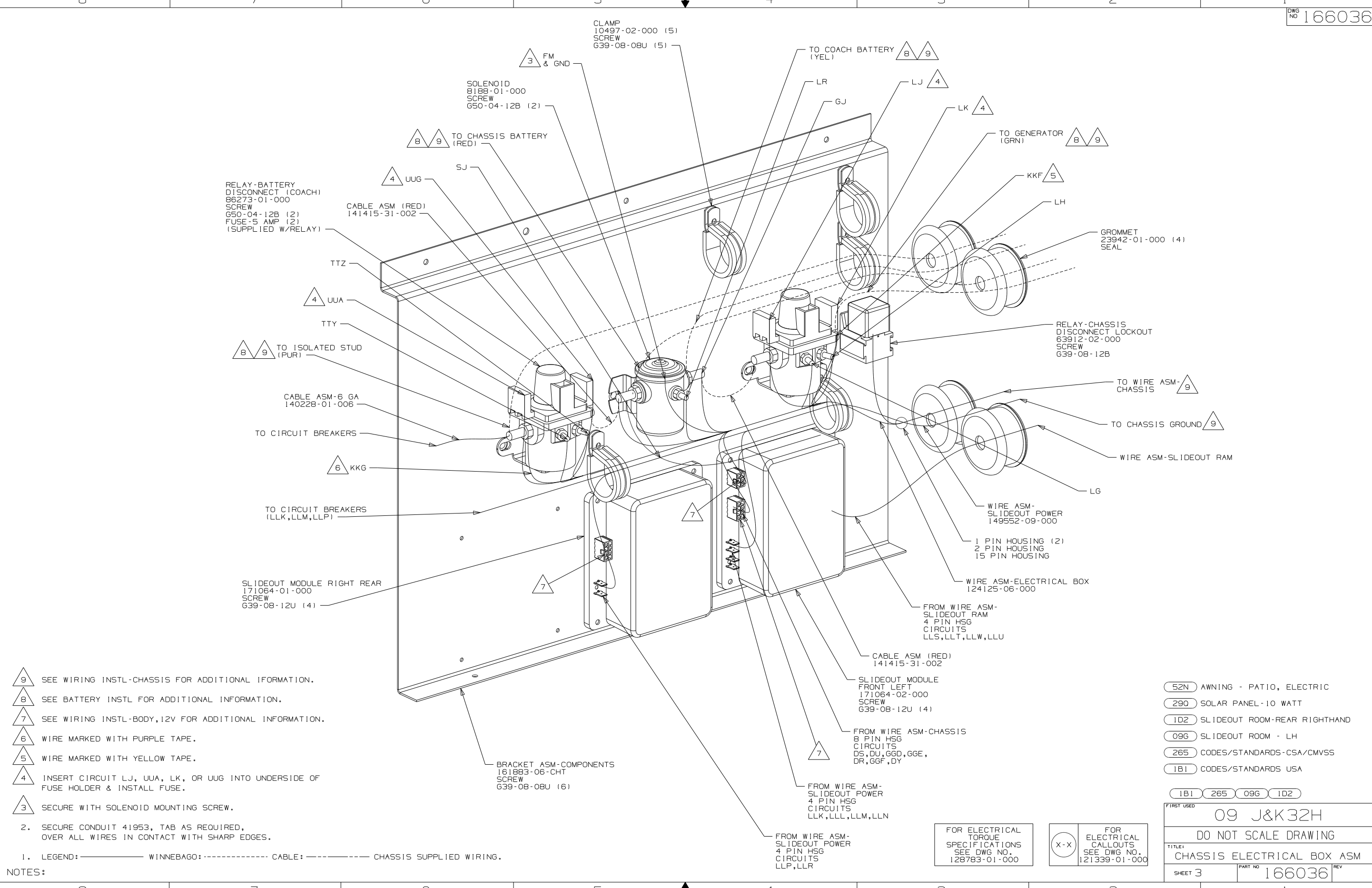

- 9 SEE WIRING INSTL-CHASSIS FOR ADDITIONAL INFORMATION.
- 8 SEE BATTERY INSTL FOR ADDITIONAL INFORMATION.
- 7 SEE WIRING INSTL-BODY,12V FOR ADDITIONAL INFORMATION.
- 6 WIRE MARKED WITH PURPLE TAPE.
- 5 WIRE MARKED WITH YELLOW TAPE.
- 4 INSERT CIRCUIT LJ, UUA, LK, OR UUG INTO UNDERSIDE OF FUSE HOLDER & INSTALL FUSE.
- 3 SECURE WITH SOLENOID MOUNTING SCREW.

2. SECURE CONDUIT 41953, TAB AS REQUIRED, OVER ALL WIRES IN CONTACT WITH SHARP EDGES.

1. LEGEND: — WINNEBAGO: - - - - - CABLE: - - - - - CHASSIS SUPPLIED WIRING.

NOTES:

- 52N AWNING - PATIO, ELECTRIC
- 290 SOLAR PANEL-10 WATT
- 102 SLIDEOUT ROOM-REAR RIGHTHAND
- 09G SLIDEOUT ROOM - LH
- 265 CODES/STANDARDS-CSA/CMVSS
- 1B1 CODES/STANDARDS USA

| | |
|----------------------------|--------------------|
| FIRST USED | |
| 09 J&K32H | |
| DO NOT SCALE DRAWING | |
| TITLE: | |
| CHASSIS ELECTRICAL BOX ASM | |
| SHEET 3 | PART NO 166036 REV |

FOR ELECTRICAL TORQUE SPECIFICATIONS SEE DWG NO. 128783-01-000

FOR ELECTRICAL CALLOUTS SEE DWG NO. 121339-01-000

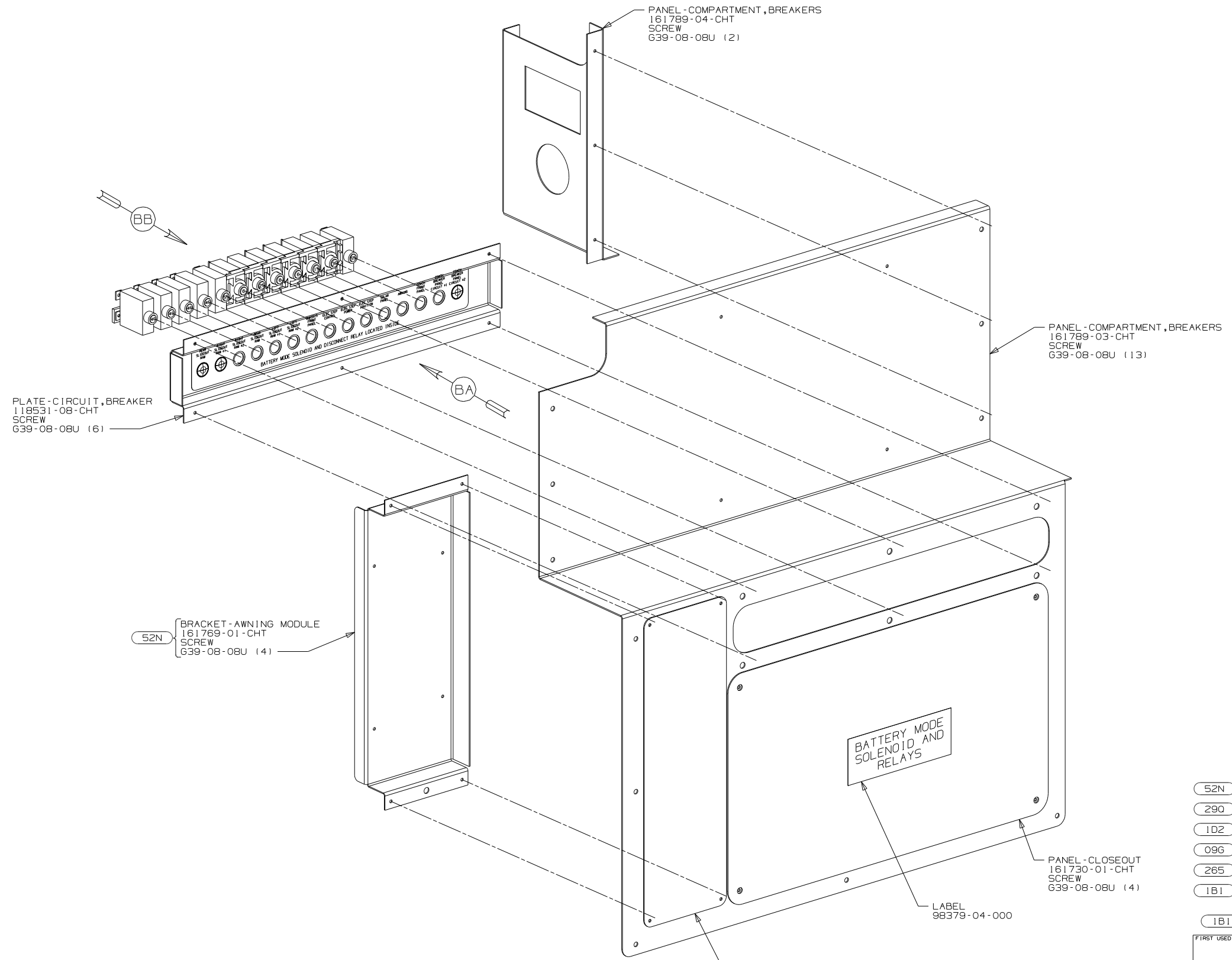

- (52N) AWNING - PATIO, ELECTRIC
- (290) SOLAR PANEL - 10 WATT
- (1D2) SLIDEOUT ROOM-REAR RIGHTHAND
- (09G) SLIDEOUT ROOM - LH
- (265) CODES/STANDARDS-CSA/CMVSS
- (1B1) CODES/STANDARDS USA

(1B1) (265) (09G) (1D2)

| | | |
|------------|----------------------------|-----|
| FIRST USED | 09 K35P | |
| TITLE | DO NOT SCALE DRAWING | |
| TITLE | CHASSIS ELECTRICAL BOX ASM | |
| SHEET 4 | PART NO | REV |
| | 166036 | |

FOR ELECTRICAL TORQUE SPECIFICATIONS SEE DWG NO. 128783-01-000

FOR ELECTRICAL CALLOUTS SEE DWG NO. 121339-01-000

NOTES:
1 NOT USED WITH (52N)

8 7 6 5 4 3 2 1

8 7 6 5 4 3 2 1

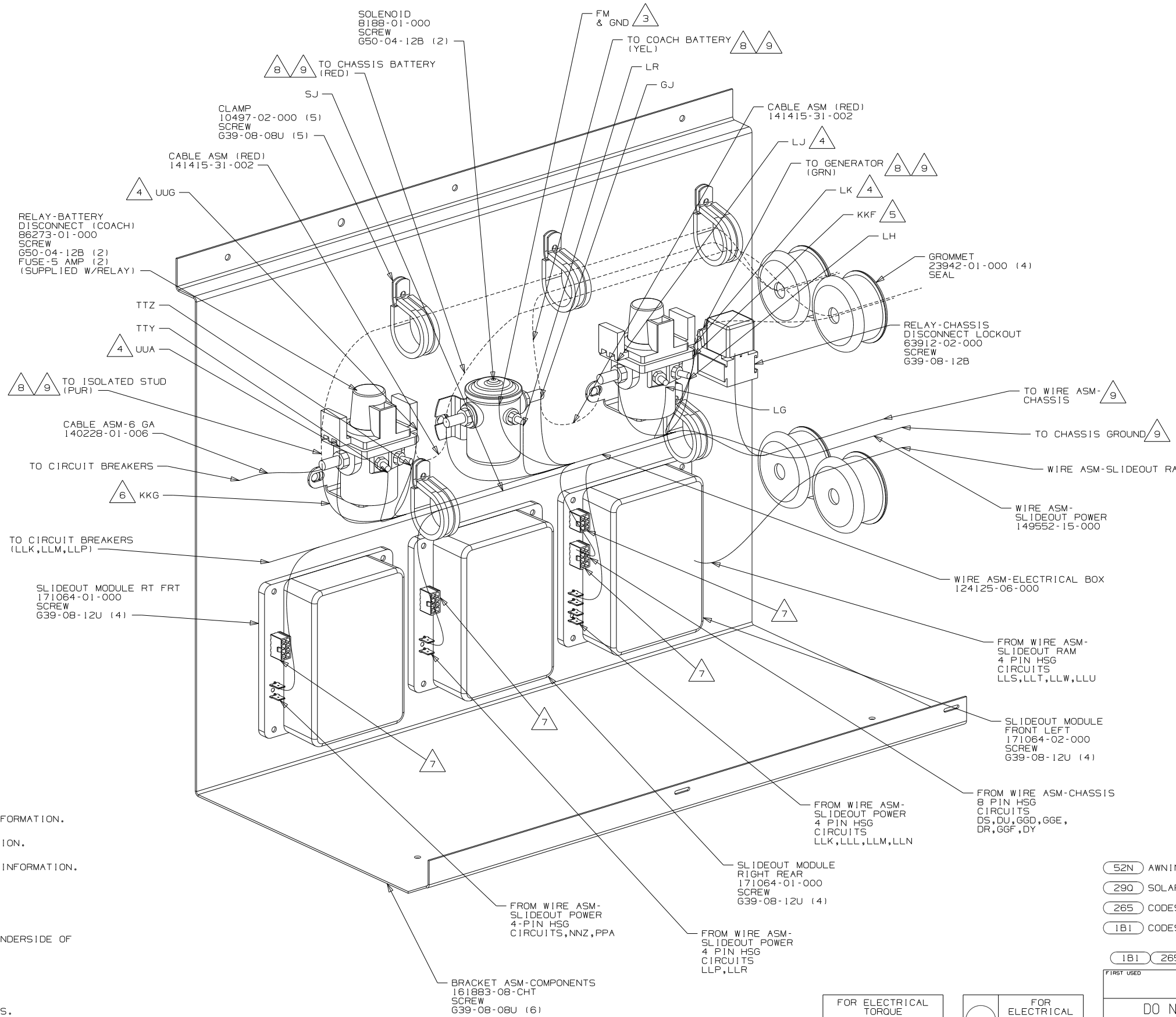

- 9 SEE WIRING INSTL-CHASSIS FOR ADDITIONAL INFORMATION.
- 8 SEE BATTERY INSTL FOR ADDITIONAL INFORMATION.
- 7 SEE WIRING INSTL-BODY,12V FOR ADDITIONAL INFORMATION.
- 6 WIRE MARKED WITH PURPLE TAPE.
- 5 WIRE MARKED WITH YELLOW TAPE.
- 4 INSERT CIRCUIT LJ, UUA, LK, OR UUG INTO UNDERSIDE OF FUSE HOLDER & INSTALL FUSE.
- 3 SECURE WITH SOLENOID MOUNTING SCREW.

2. SECURE CONDUIT 41953, TAB AS REQUIRED, OVER ALL WIRES IN CONTACT WITH SHARP EDGES.

1. LEGEND: — WINNEBAGO: - - - - - CABLE: - - - - - CHASSIS SUPPLIED WIRING.

NOTES:

- 52N AWNING - PATIO, ELECTRIC
- 290 SOLAR PANEL-10 WATT
- 265 CODES/STANDARDS-CSA/CMVSS
- 1B1 CODES/STANDARDS USA

| | | | |
|--------------------------------------|---------|---------|-----|
| FIRST USED | | 09 K35P | |
| DO NOT SCALE DRAWING | | | |
| TITLE: CHASSIS ELECTRICAL BOX ASM | | | |
| SHEET 6 | PART NO | 166036 | REV |

FOR ELECTRICAL TORQUE SPECIFICATIONS SEE DWG NO. 128783-01-000

FOR ELECTRICAL CALLOUTS SEE DWG NO. 121339-01-000