



DANGER

Danger of electrical shock, burns or death. Always remove all power sources before attempting any repair, service or diagnostic work. Power can be present from shore power, generator, inverter or battery. All power sources must be disabled and secured before performing any service.



CAUTION

If you lack the skills, tools or equipment to perform diagnostic or repair work leave such work to an authorized Winnebago Industries dealer or other qualified shop.

DRAWING NO.	FEATURE	SHEETS
159590-01	(16E)	1, 2, 3
159590-02	(1PY)	3, 4, 5

RELEASE	REV/DATE	OWG NO
A		159590
REV ZONE	REVISION RECORD	DATE
		DFTR-016

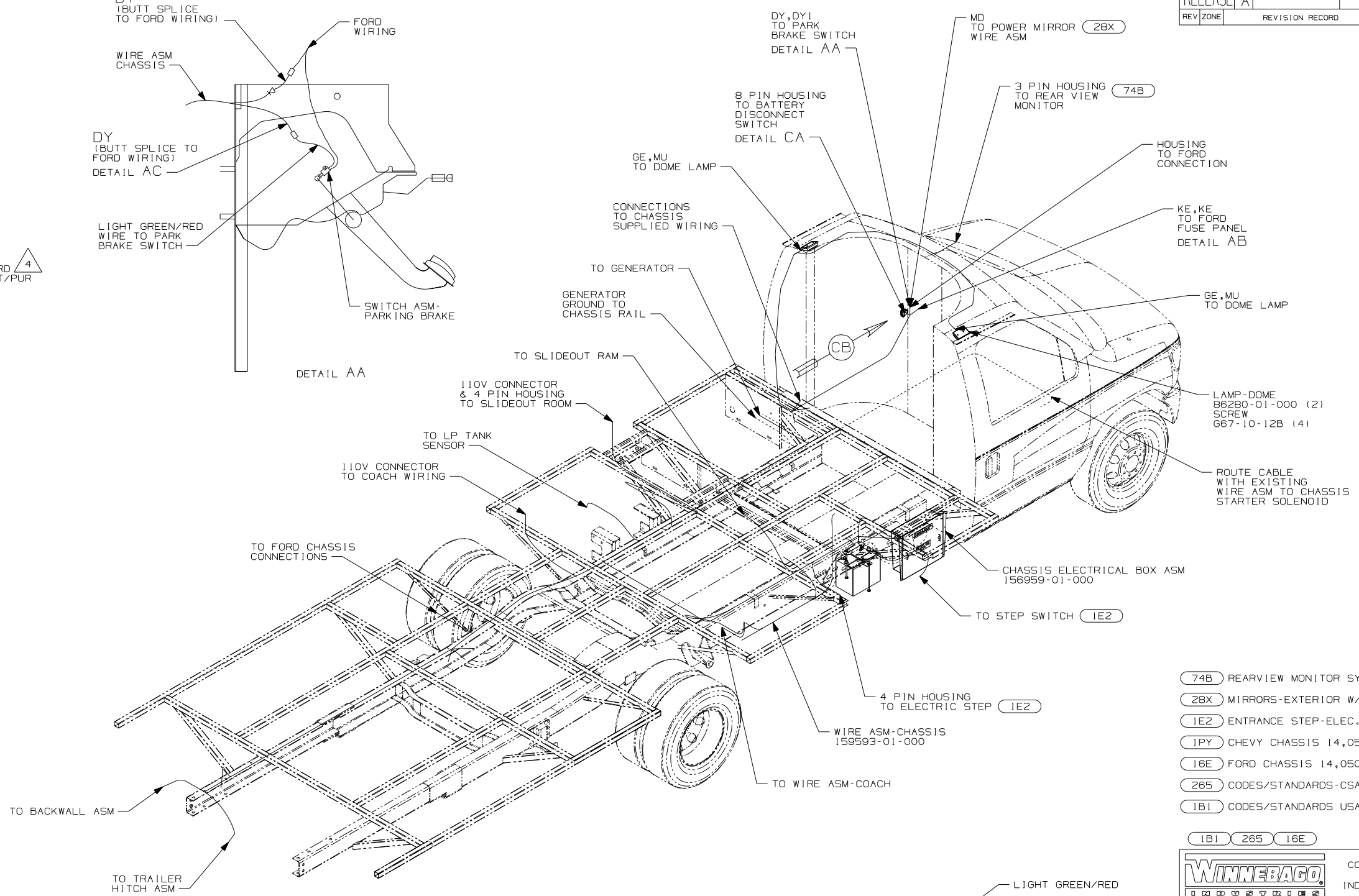
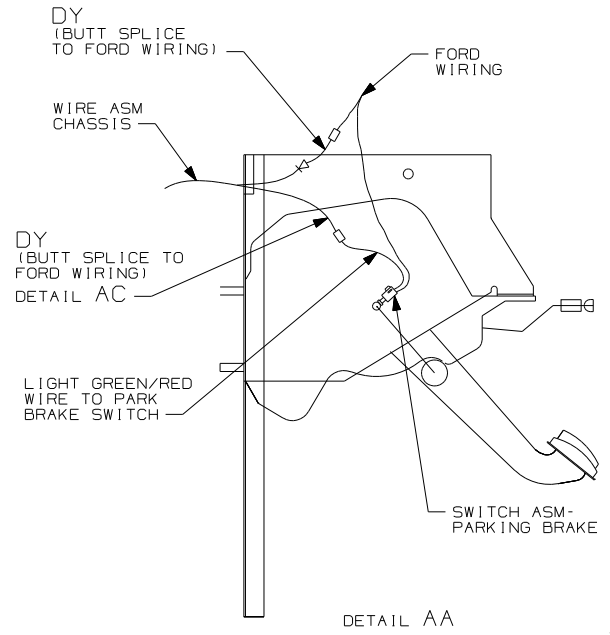
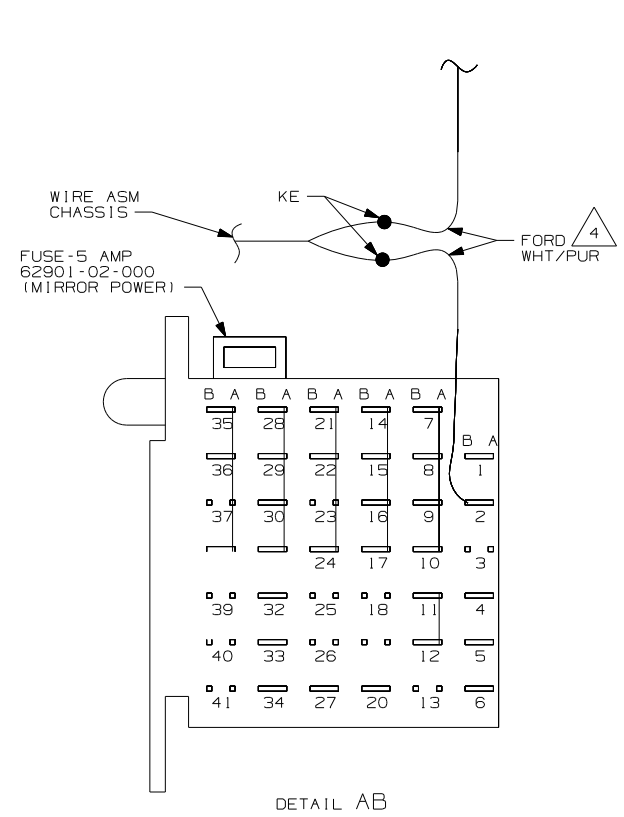

- (74B) REARVIEW MONITOR SYSTEM
- (28X) MIRRORS-EXTERIOR W/DEFROST
- (1E2) ENTRANCE STEP-ELEC.
- (1PY) CHEVY CHASSIS 14,050 LB GVWR
- (16E) FORD CHASSIS 14,050 LB.GVWR
- (265) CODES/STANDARDS-CSA/CMVSS
- (1B1) CODES/STANDARDS USA

- 5 CUT LIGHT GREEN/RED WIRE FROM PARK BRAKE SWITCH AND RECONNECT TO CIRCUIT DY OF CHASSIS ASM AS SHOWN.
- 4 CUT WIRE AND RECONNECT AS SHOWN.
3. SECURE WIRE ASM AND CABLES WITH WIRE TIE B343-01-000 OR 116673-01-000 AT NOT MORE THAN 600 MM CENTER ALONG ENTIRE ROUTED PATH.
2. SECURE CONDUIT 41953, TAB AS REQUIRED, OVER ALL WIRES IN CONTACT WITH SHARP EDGES.
1. LEGEND: — WINNEBAGO: CABLE: - - - - - CHASSIS SUPPLIED WIRING.

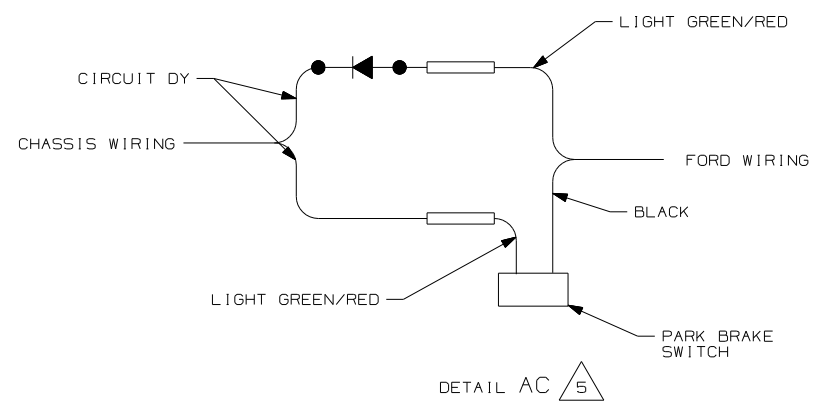

WINNEBAGO

COPYRIGHT 2006 WINNEBAGO INDUSTRIES, INC.

DFTR	ORIG. DATE
CHKR	ALL DIMENSIONS ARE IN MILLIMETERS
P.E.	
M.E.	FIRST USED
DSNR	07 226A

UNSPECIFIED TOLERANCES ARE:

WHOLE DIM (X)	: 3	X
ONE-PLACE (X.X)	: 1.5	X
TWO-PLACE (X.XX)	: 0.50	X
ANGLE	: 1°	X
THIRD ANGLE PROJECTION		X

DO NOT SCALE DRAWING

TITLE: WIRING INSTL-CHASSIS

SHEET 1 of 5 PART NO 159590 REV

REF: 1 11/23/2006

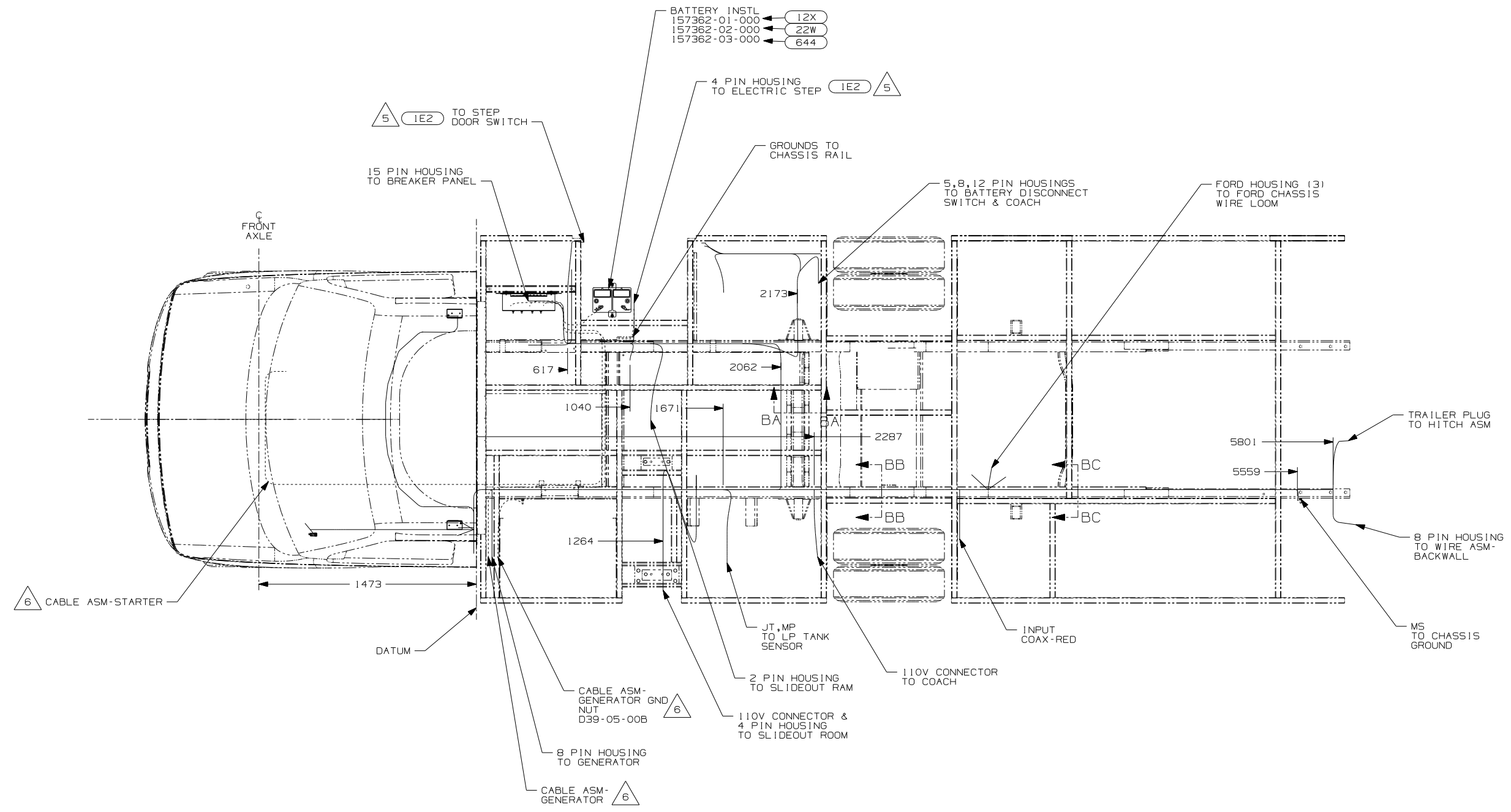

- NOTES:
- △6 SEE BATTERY INSTL FOR ADDITIONAL INFORMATION.
 - △5 SECURE THE DROP BACK TO MAIN WIRE ASM TRUNK WHEN NOT USED.
 - △4 WIRES TO BE TIED TO CROSS MEMBER USING EXISTING HOLES.
 - △3 WIRES TO BE TIED TO TOP OF RAIL USING EXISTING HOLES.
 - △2 WIRES TO BE TIED TO INSIDE OF RAIL USING EXISTING HOLES.
 - △1 CUT OFF EXCESS END OF WIRE TIE.

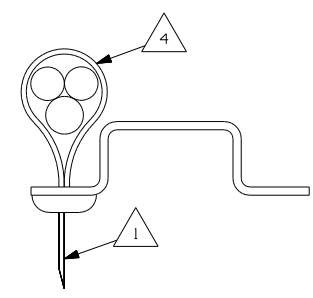

SECTION BA-BA

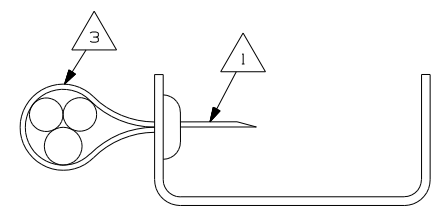

SECTION BB-BB

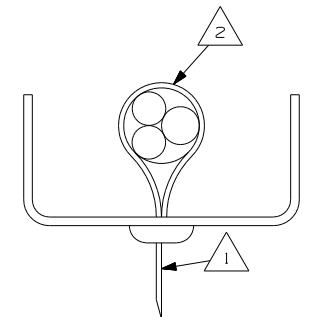

SECTION BC-BC

- △644 GREAT ALASKAN RENTAL PACKAGE
- △22W BATTERY-SECOND
- △12X BATTERY-ONE
- △1E2 ENTRANCE STEP-ELEC.
- △16E FORD CHASSIS 14,050 LB.GVWR
- △265 CODES/STANDARDS-CSA/CMVSS
- △1B1 CODES/STANDARDS USA

FIRST USED	07 226A	
TITLE	DO NOT SCALE DRAWING	
	WIRING INSTL-CHASSIS	
SHEET 2	PART NO 159590	REV

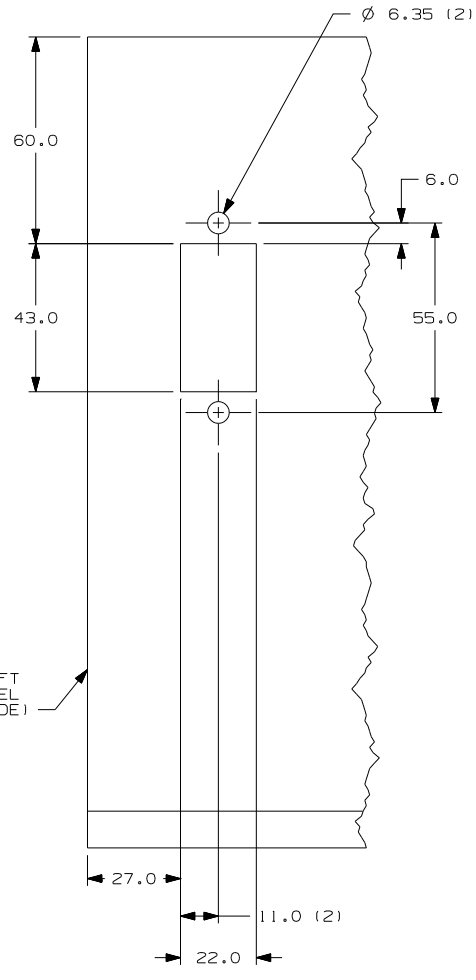

DETAIL CB (16E)

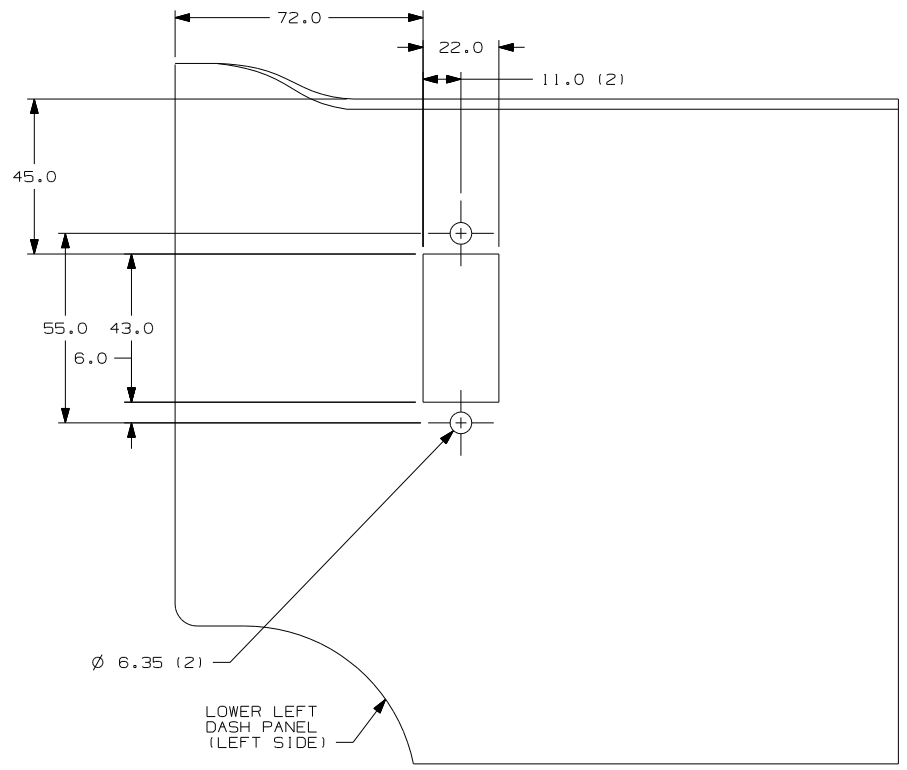

DETAIL CC (IPY)

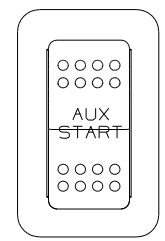

DETAIL CA (IPY) (16E)

- SWITCH-AUX START
- 108357-09-000
- ACTUATOR
- 108356-07-CHT
- PLATE-SWITCH
- 144363-07-000
- NUT
- 112722-01-000 (2)

- (IPY) CHEVY CHASSIS 14,050 LB GVWR
- (16E) FORD CHASSIS 14,050 LB.GVWR
- (265) CODES/STANDARDS-CSA/CMVSS
- (1B1) CODES/STANDARDS USA

FIRST USED		07 226A	
DO NOT SCALE DRAWING			
TITLE:			
WIRING INSTL-CHASSIS			
SHEET 3	PART NO	159590	REV

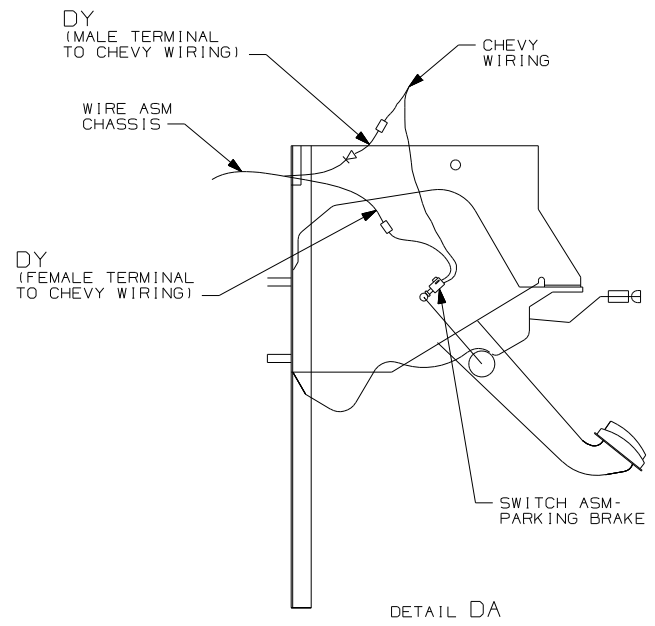

DETAIL DA

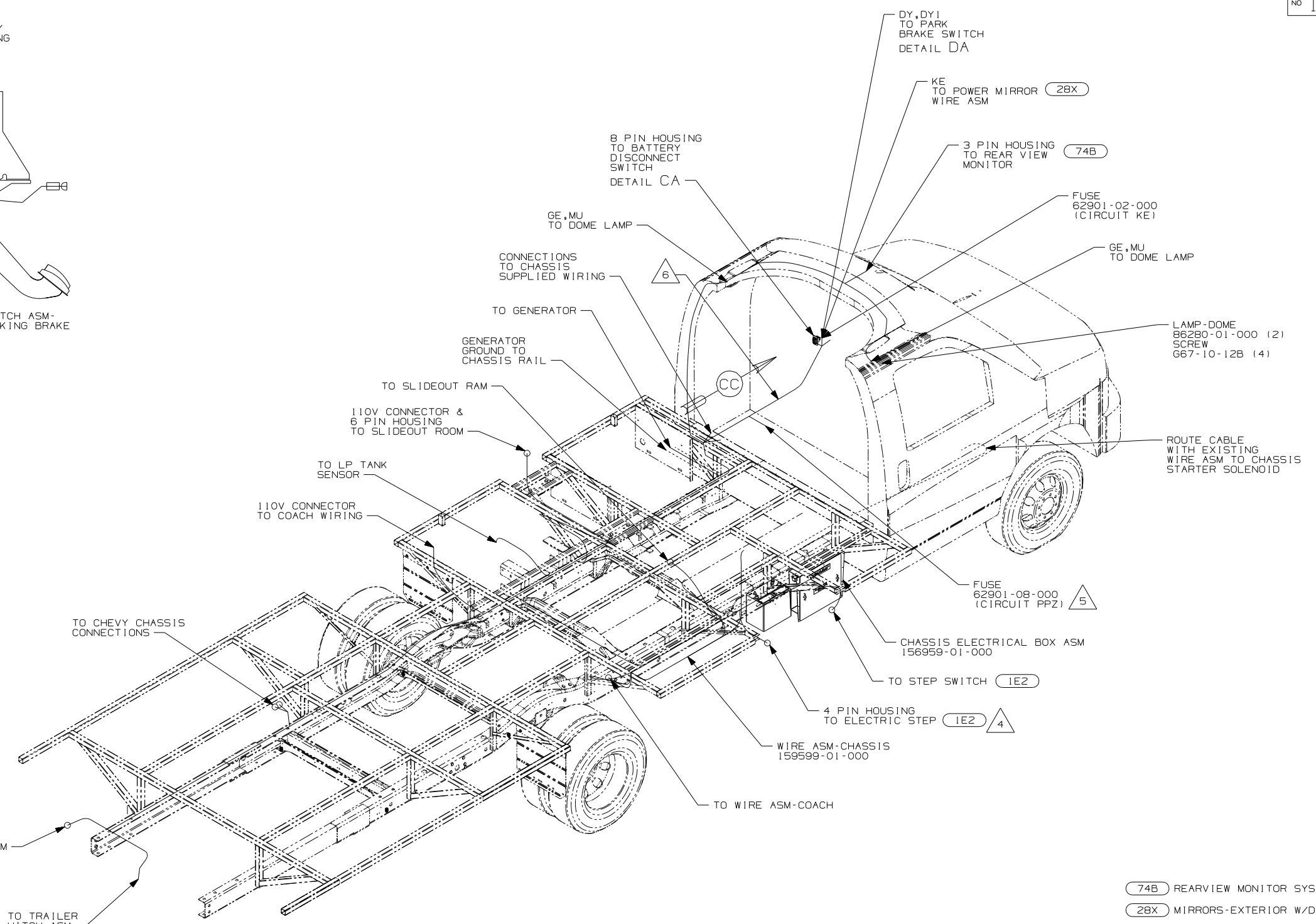

6 WIRE ASM-CHASSIS ROUTES UNDER SEAT IN THIS AREA. BETWEEN SEAT AND DASH, ROUTE WIRING UNDER FLOOR MAT AND WIRE TIE TO EXISTING CHEVY WIRING.

5 SECURE FUSEHOLDER TO MAIN HARNESS UNDER SEAT.

4 SECURE THE DROP TO MAIN HARNESS WITHOUT (1E2)

3. SECURE WIRE ASM AND CABLES WITH WIRE TIE 8343-01-000 OR 116673-01-000 AT NOT MORE THAN 600 MM CENTER ALONG ENTIRE ROUTED PATH.

2. SECURE CONDUIT 41953, TAB AS REQUIRED, OVER ALL WIRES IN CONTACT WITH SHARP EDGES.

1. LEGEND: — WINNEBAGO: CABLE: ----- CHASSIS SUPPLIED WIRING.

NOTES:

- (74B) REARVIEW MONITOR SYSTEM
- (28X) MIRRORS-EXTERIOR W/DEFROST
- (1E2) ENTRANCE STEP-ELEC.
- (IPY) CHEVY CHASSIS 14,050 LB GVWR
- (265) CODES/STANDARDS-CSA/CMVSS
- (1B1) CODES/STANDARDS USA

FIRST USED	07 226A	
TITLE	DO NOT SCALE DRAWING	
	WIRING INSTL-CHASSIS	
SHEET 4	PART NO 159590	REV

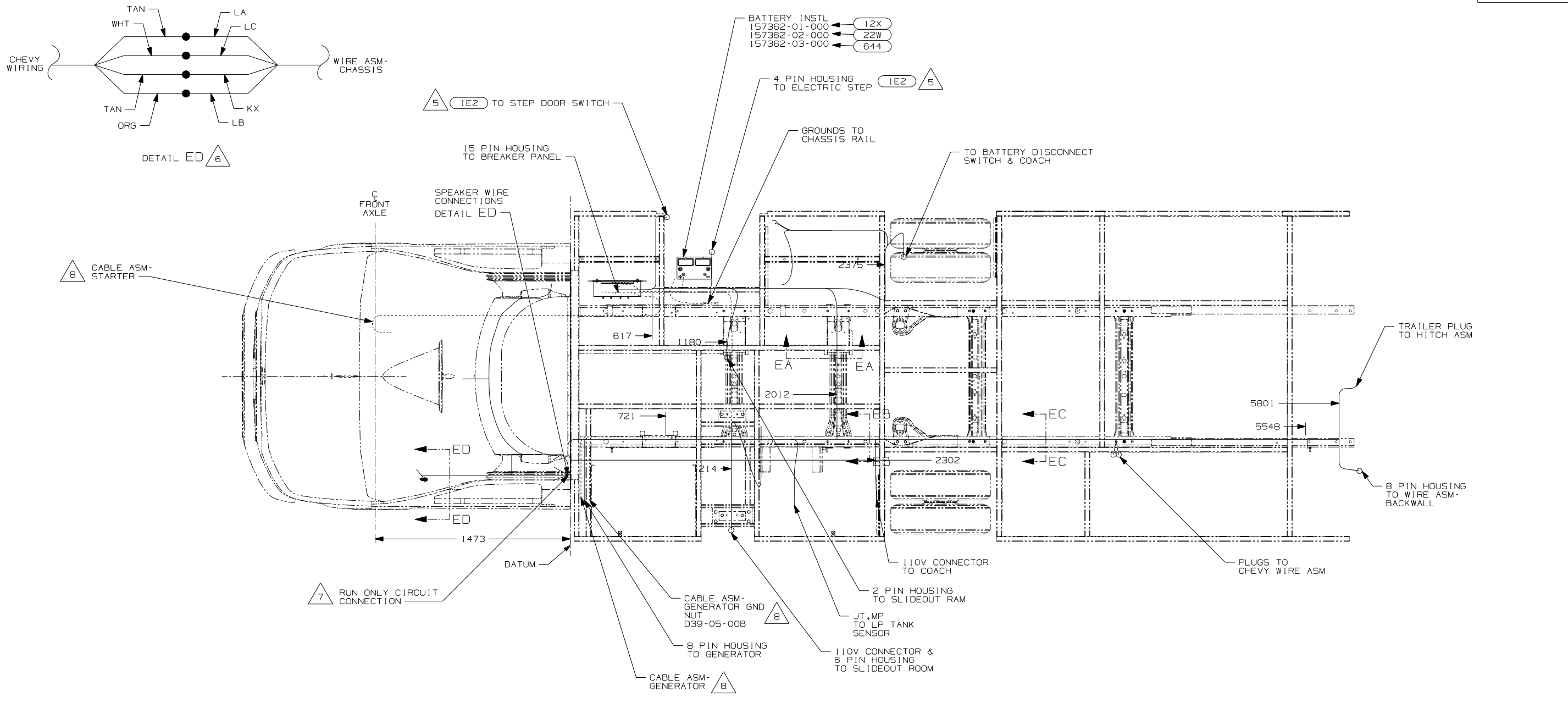

- 8 SEE BATTERY INSTL FOR ADDITIONAL INFORMATION.
- 7 CONNECT "FEED" CIRCUIT TO CHEVY BROWN WIRE AT B-POST.
- 6 BOTH POSITIVE WIRES ARE TAN. TO TEST, TURN THE RADIO FADE ALL THE WAY TO THE LEFT. CONNECT THE NEGATIVE TERMINAL OF A TEST SPEAKER TO THE WHITE WIRE. THEN ALTERNATE THE TWO TAN WIRES TO THE POSITIVE TERMINAL. WHICHEVER IS LOUDER IS THE ONE THAT CONNECTS TO CIRCUIT LA. THE OTHER TAN WIRE CONNECTS TO CIRCUIT KX.
- 5 SECURE THE DROP BACK TO MAIN WIRE ASM TRUNK WHEN NOT USED.
- 4 WIRES TO BE TIED TO CROSS MEMBER USING EXISTING HOLES.
- 3 WIRES TO BE TIED TO TOP OF RAIL USING EXISTING HOLES.
- 2 WIRES TO BE TIED TO INSIDE OF RAIL USING EXISTING HOLES.
- 1 CUT OFF EXCESS END OF WIRE TIE.

NOTES:

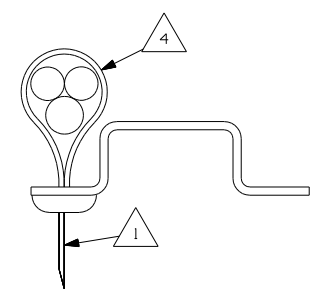

SECTION EA-EA

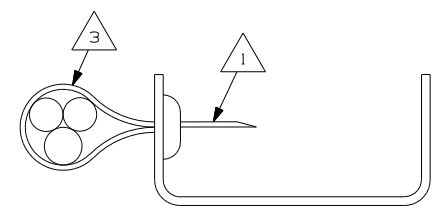

SECTION EB-EB

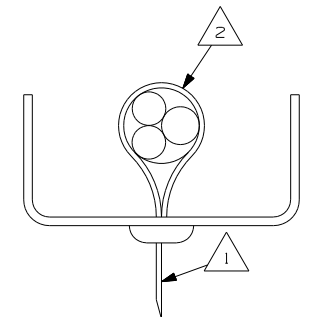

SECTION EC-EC

- 644 GREAT ALASKAN RENTAL PACKAGE
- 22W BATTERY-SECOND
- 12X BATTERY-ONE
- 1E2 ENTRANCE STEP-ELEC.
- 1PY CHEVY CHASSIS 14,050 LB GVWR
- 265 CODES/STANDARDS-CSA/CMVSS
- 1B1 CODES/STANDARDS USA

FIRST USED	07 226A	
TITLE:	DO NOT SCALE DRAWING	
	WIRING INSTL-CHASSIS	
SHEET 5	PART NO	REV
	159590	