



DANGER

Danger of electrical shock, burns or death. Always remove all power sources before attempting any repair, service or diagnostic work. Power can be present from shore power, generator, inverter or battery. All power sources must be disabled and secured before performing any service.



CAUTION

If you lack the skills, tools or equipment to perform diagnostic or repair work leave such work to an authorized Winnebago Industries dealer or other qualified shop.

DRAWING NO.	FEATURE	SHEETS
158839-01	16C 16E	1, 2, 3
158839-02	1PY	3, 4, 5

RELEASE	REV DATE	DWG NO	158839
REV ZONE	REVISION RECORD	DATE	DFTR-0018

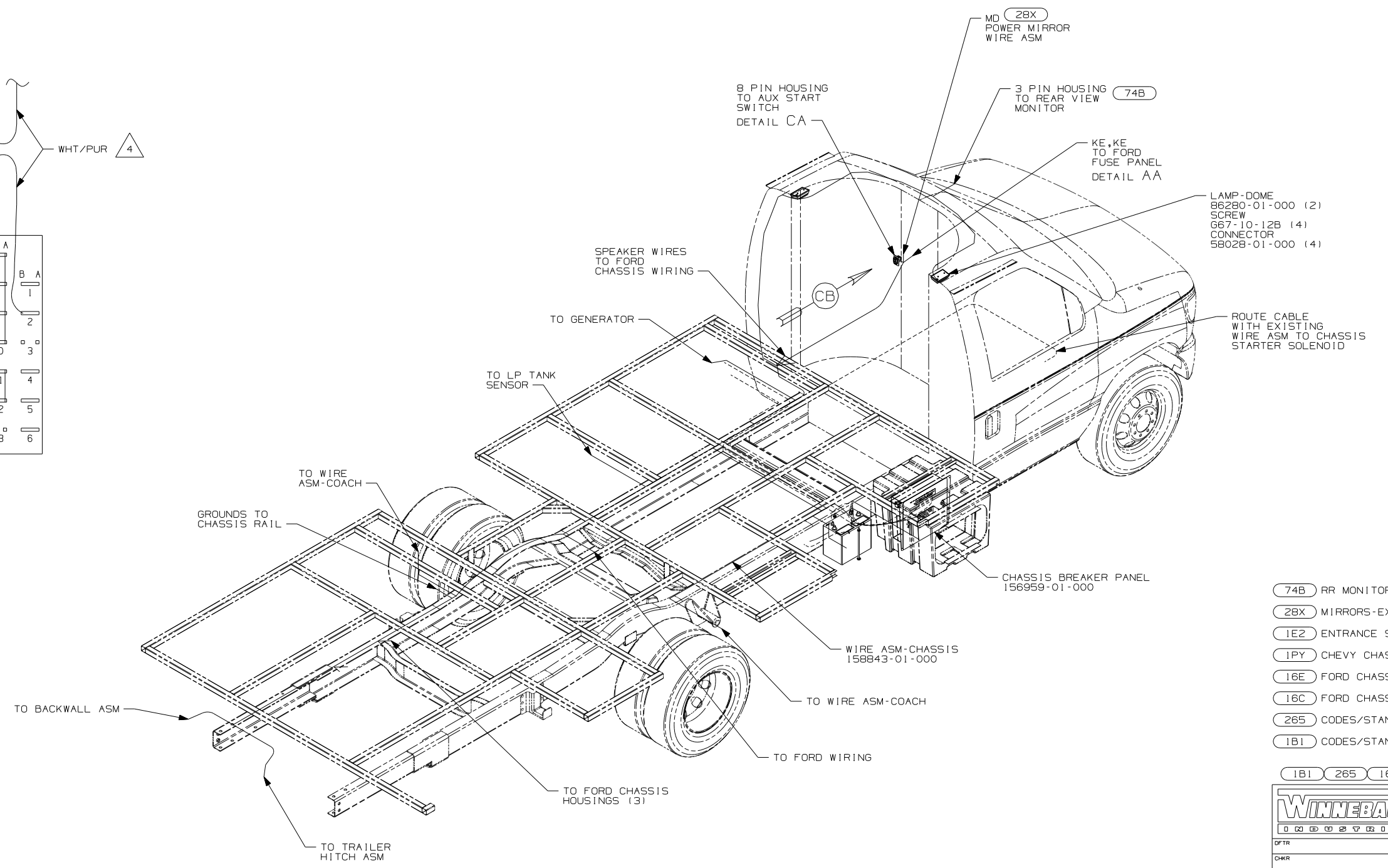
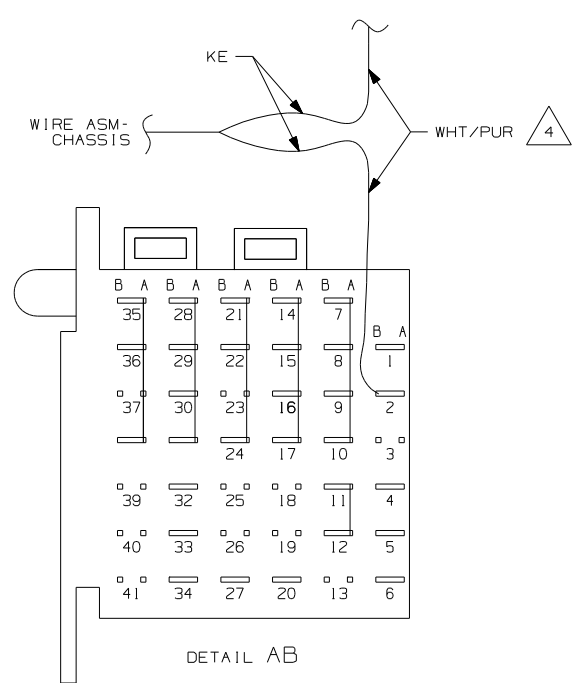

- 74B RR MONITOR SYS-SUNVISOR MNTR
 - 28X MIRRORS-EXTERIOR W/DEFROST
 - 1E2 ENTRANCE STEP-ELEC.
 - 1PY CHEVY CHASSIS 14,050 LB GVWR
 - 16E FORD CHASSIS 14,050 LB.GVWR
 - 16C FORD CHASSIS 11,500 LB.GVWR
 - 265 CODES/STANDARDS-CSA/CMVSS
 - 1B1 CODES/STANDARDS USA
- 1B1 265 16C 16E

WINNEBAGO COPYRIGHT 2006 WINNEBAGO INDUSTRIES, INC.

DFTR	ORIG. DATE
CHKR	ALL DIMENSIONS ARE IN MILLIMETERS
P.E.	
M.E.	FIRST USED
DSNR	07 224V

UNSPECIFIED TOLERANCES ARE:

WHOLE DIM (X)	: 3
ONE-PLACE (X.X)	: 1.5
TWO-PLACE (X.XX)	: 0.50
ANGLE	: 1°

THIRD ANGLE PROJECTION

DO NOT SCALE DRAWING

TITLE: WIRING INSTL-CHASSIS

SHEET 1 OF 5 PART NO 158839 REV

REF: 1 11/23/2006

4 CUT WIRE AND RECONNECT AS SHOWN.

3. USE WIRE TIES 8343-04-000 AND 116673-01-000 APPROXIMATELY 600MM ON CENTER UNLESS OTHERWISE SPECIFIED.

2. SECURE CONDUIT 41953, TAB AS REQUIRED, OVER ALL WIRES IN CONTACT WITH SHARP EDGES.

1. LEGEND: — WINNEBAGO: - - - - - CABLE: - - - - - CHASSIS SUPPLIED WIRING.

NOTES:

FOR ELECTRICAL TORQUE SPECIFICATIONS SEE DWG NO. 128783-01-000

X-X FOR ELECTRICAL CALLOUTS SEE DWG NO. 121339-01-000

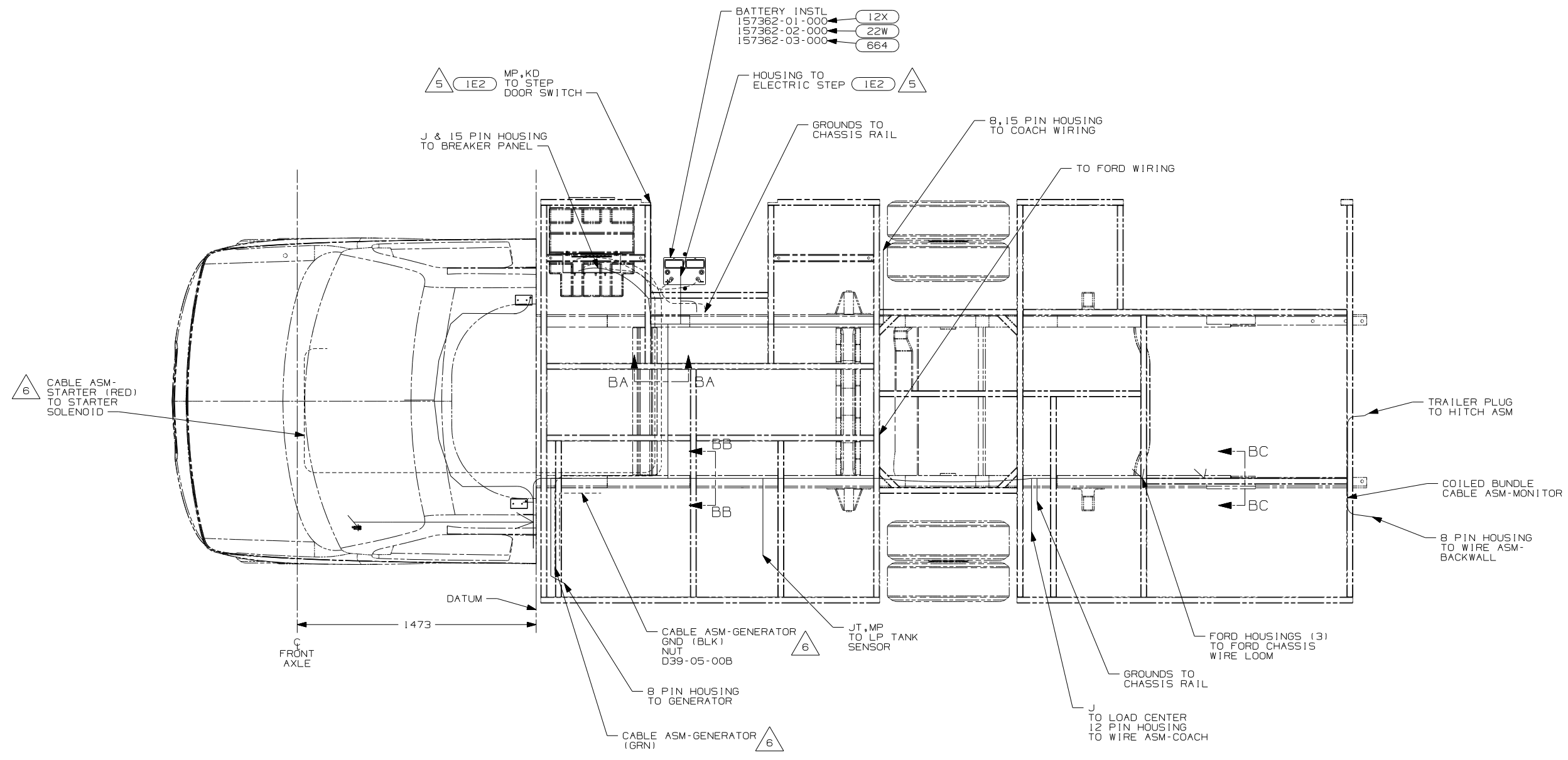

- NOTES:
- △6 SEE BATTERY INSTL FOR ADDITIONAL INFORMATION.
 - △5 SECURE THE DROP BACK TO MAIN WIRE ASM TRUNK WHEN NOT USED.
 - △4 WIRES TO BE TIED TO CROSS MEMBER USING EXISTING HOLES.
 - △3 WIRES TO BE TIED TO TOP OF RAIL USING EXISTING HOLES.
 - △2 WIRES TO BE TIED TO INSIDE OF RAIL USING EXISTING HOLES.
 - △1 CUT OFF EXCESS END OF WIRE TIE.

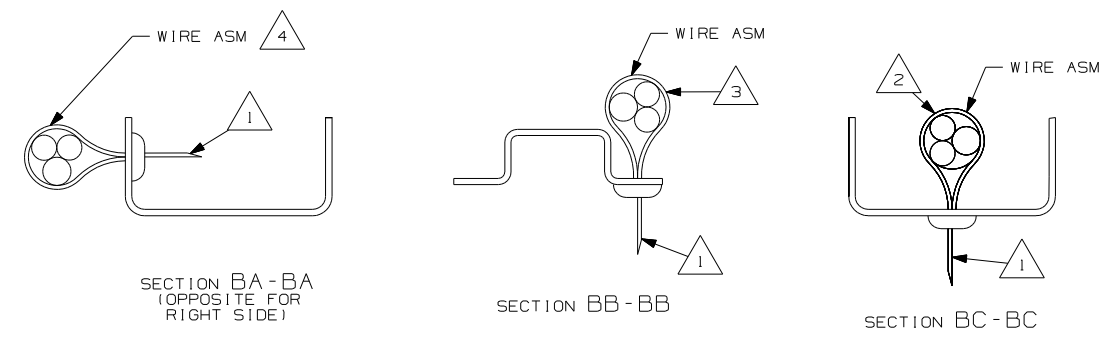

- 664 GREAT ALASKAN RENTAL PACKAGE
- 22W BATTERY-SECOND
- 12X BATTERY-ONE
- 16E FORD CHASSIS 14,050 LB.GVWR
- 265 CODES/STANDARDS-CSA/CMVSS
- 1B1 CODES/STANDARDS USA

FOR ELECTRICAL TORQUE SPECIFICATIONS SEE DWG NO. 128783-01-000

FOR ELECTRICAL CALLOUTS SEE DWG NO. 121339-01-000

FIRST USED	07 224V
DO NOT SCALE DRAWING	
TITLE:	WIRING INSTL-CHASSIS
SHEET 2	PART NO 158839 REV

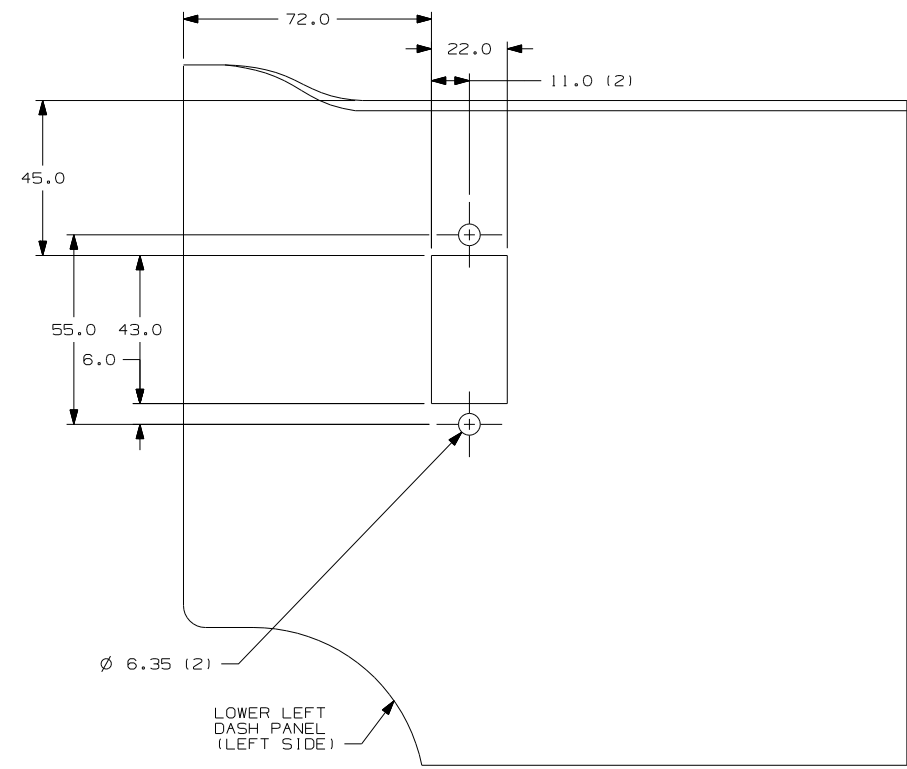

VIEW CC (IPY)

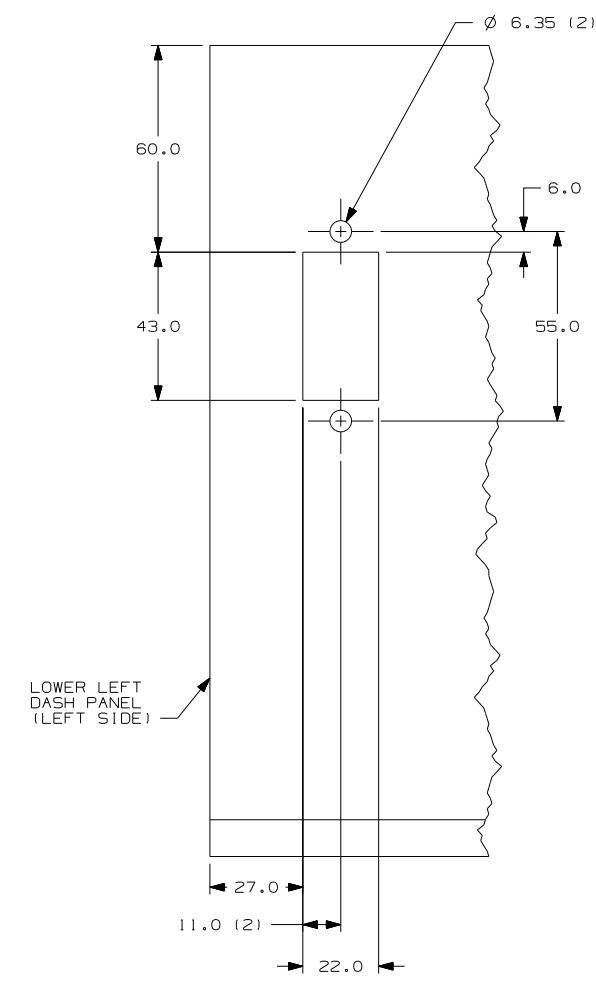

VIEW CB (I6E)

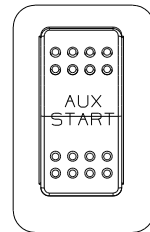

DETAIL CA (IPY) (I6E)

SWITCH-AUX START
 108357-09-000
 ACTUATOR
 108356-07-CHT
 PLATE-SWITCH
 144363-07-000
 NUT
 112722-01-000 (2)

- (IPY) CHEVY CHASSIS 14,050 LB GVWR
- (I6E) FORD CHASSIS 14,050 LB.GVWR
- (265) CODES/STANDARDS-CSA/CMVSS
- (I81) CODES/STANDARDS USA

FIRST USED	
07 224V	
DO NOT SCALE DRAWING	
TITLE: WIRING INSTL-CHASSIS	
SHEET 3	PART NO 158839 REV

FOR ELECTRICAL
 TORQUE
 SPECIFICATIONS
 SEE DWG NO.
 128783-01-000

(X-X)
 FOR
 ELECTRICAL
 CALLOUTS
 SEE DWG NO.
 121339-01-000

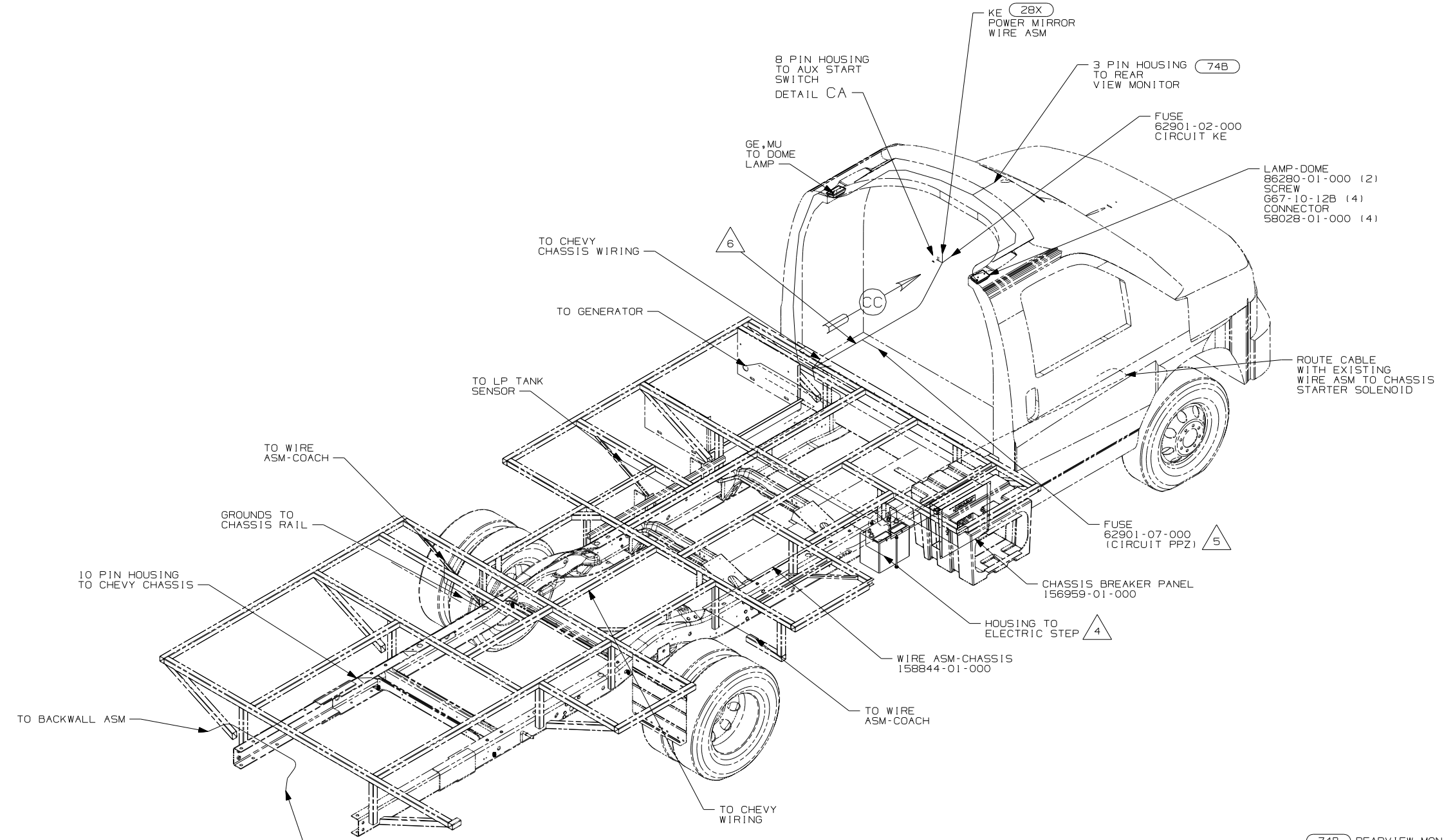

△ 6 WIRE ASM-CHASSIS ROUTES UNDER SEAT IN THIS AREA. BETWEEN SEAT AND DASH, ROUTE WIRING UNDER FLOOR MAT AND WIRE TIE TO EXISTING CHEVY WIRING.

△ 5 FUSEHOLDER TO BE SECURED TO MAIN HARNESS UNDER SEAT.

△ 4 SECURE DROP BACK ALONG RAIL WITHOUT (IE2)

3. USE WIRE TIES 8343-04-000 AND 116673-01-000 APPROXIMATELY 600MM ON CENTER UNLESS OTHERWISE SPECIFIED.

2. SECURE CONDUIT 41953, TAB AS REQUIRED, OVER ALL WIRES IN CONTACT WITH SHARP EDGES.

1. LEGEND: — WINNEBAGO: - - - - - CABLE: - - - - - CHASSIS SUPPLIED WIRING.

NOTES:

- (74B) REARVIEW MONITOR SYSTEM
- (28X) MIRRORS-EXTERIOR W/DEFROST
- (IE2) ENTRANCE STEP-ELEC.
- (IPY) CHEVY CHASSIS 14,050 LB GVWR
- (265) CODES/STANDARDS-CSA/CMVSS
- (1B1) CODES/STANDARDS USA

(1B1) (265) (IPY)

FOR ELECTRICAL TORQUE SPECIFICATIONS SEE DWG NO. 128783-01-000

(X-X) FOR ELECTRICAL CALLOUTS SEE DWG NO. 121339-01-000

FIRST USED	07 224V
TITLE	DO NOT SCALE DRAWING
WIRING INSTL-CHASSIS	
SHEET 4	PART NO 158839 REV

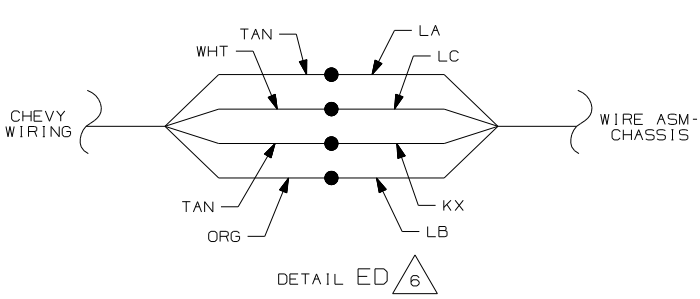

DETAIL ED 6

5 CABLE ASM-STARTER TO STARTER SOLENOID

7 RUN ONLY CIRCUIT CONNECTION

SPEAKER WIRE CONNECTIONS
DETAIL EE

FRONT AXLE

DATUM

1473

CABLE ASM-BLK NUT
D39-05-00B 5

8 PIN HOUSING TO GENERATOR

CABLE ASM-GRN 5

J & 15 PIN HOUSING TO BREAKER PANEL

MP, KD TO STEP DOOR SWITCH

BATTERY INSTL
157362-01-000 12X
157362-02-000 22W
157362-03-000 664

HOUSING TO ELECTRIC STEP

GROUNDS TO CHASSIS RAIL

8, 15 PIN HOUSINGS TO COACH WIRING

EA

EA

EB

EC

EC

J TO LOAD CTR
12 PIN HOUSING TO WIRE ASM-COACH

TRAILER PLUG TO HITCH ASM

COILED BUNDLE CABLE ASM-MONITOR

8 PIN HOUSING TO WIRE ASM-BACKWALL

10 PIN HOUSING TO CHEVY WIRING

- 7 CONNECT "FEED" CIRCUIT TO CHEVY BROWN WIRE AT B-POST.
- 6 BOTH POSITIVE WIRES ARE TAN. TO TEST, TURN THE RADIO FADE ALL THE WAY TO THE LEFT. CONNECT THE NEGATIVE TERMINAL OF A TEST SPEAKER TO THE WHITE WIRE. THEN ALTERNATE THE TWO TAN WIRES TO THE POSITIVE TERMINAL. WHICH EVER IS LOUDER IS THE ONE THAT CONNECTS TO CIRCUIT LA. THE OTHER TAN WIRE CONNECTS TO CIRCUIT KX.

- 5 SEE BATTERY INSTL FOR ADDITIONAL INFORMATION.
- 4 WIRES TO BE TIED TO CROSS MEMBER USING EXISTING HOLES.
- 3 WIRES TO BE TIED TO TOP OF RAIL USING EXISTING HOLES.
- 2 WIRES TO BE TIED TO INSIDE OF RAIL USING EXISTING HOLES.
- 1 CUT OFF EXCESS END OF WIRE TIE.

NOTES:

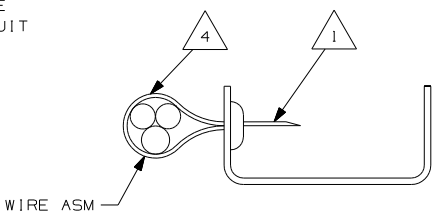

SECTION EA-EA (OPPOSITE FOR RIGHT SIDE)

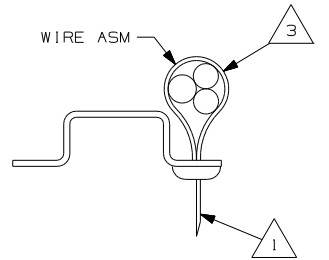

SECTION EB-EB

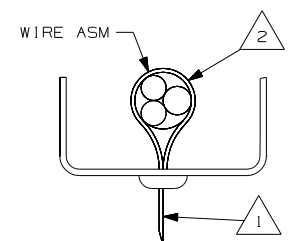

SECTION EC-EC

FOR ELECTRICAL TORQUE SPECIFICATIONS SEE DWG NO. 128783-01-000

FOR ELECTRICAL CALLOUTS SEE DWG NO. 121339-01-000

- 664 GREAT ALASKAN RENTAL PACKAGE
- 22W BATTERY-SECOND
- 22W BATTERY-SECOND
- 12X BATTERY-ONE
- 1PY CHEVY CHASSIS 14,050 LB GVWR
- 265 CODES/STANDARDS-CSA/CMVSS
- 1B1 CODES/STANDARDS USA

1B1 265 1PY

FIRST USED	07 224V
TITLE:	DO NOT SCALE DRAWING
WIRING INSTL-CHASSIS	
SHEET 5	PART NO 158839 REV