



**DANGER**

**Danger of electrical shock, burns or death.** Always remove all power sources before attempting any repair, service or diagnostic work. Power can be present from shore power, generator, inverter or battery. All power sources must be disabled and secured before performing any service.



**CAUTION**

If you lack the skills, tools or equipment to perform diagnostic or repair work leave such work to an authorized Winnebago Industries dealer or other qualified shop.

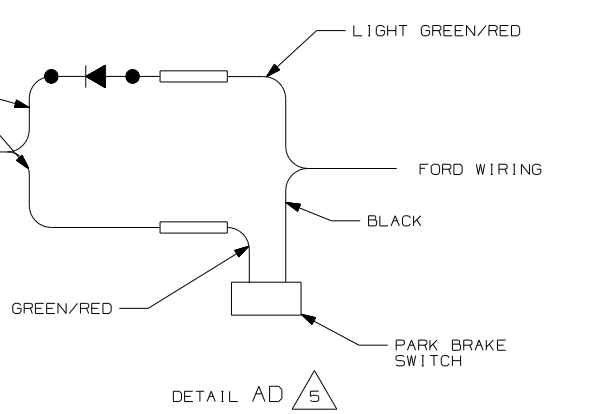
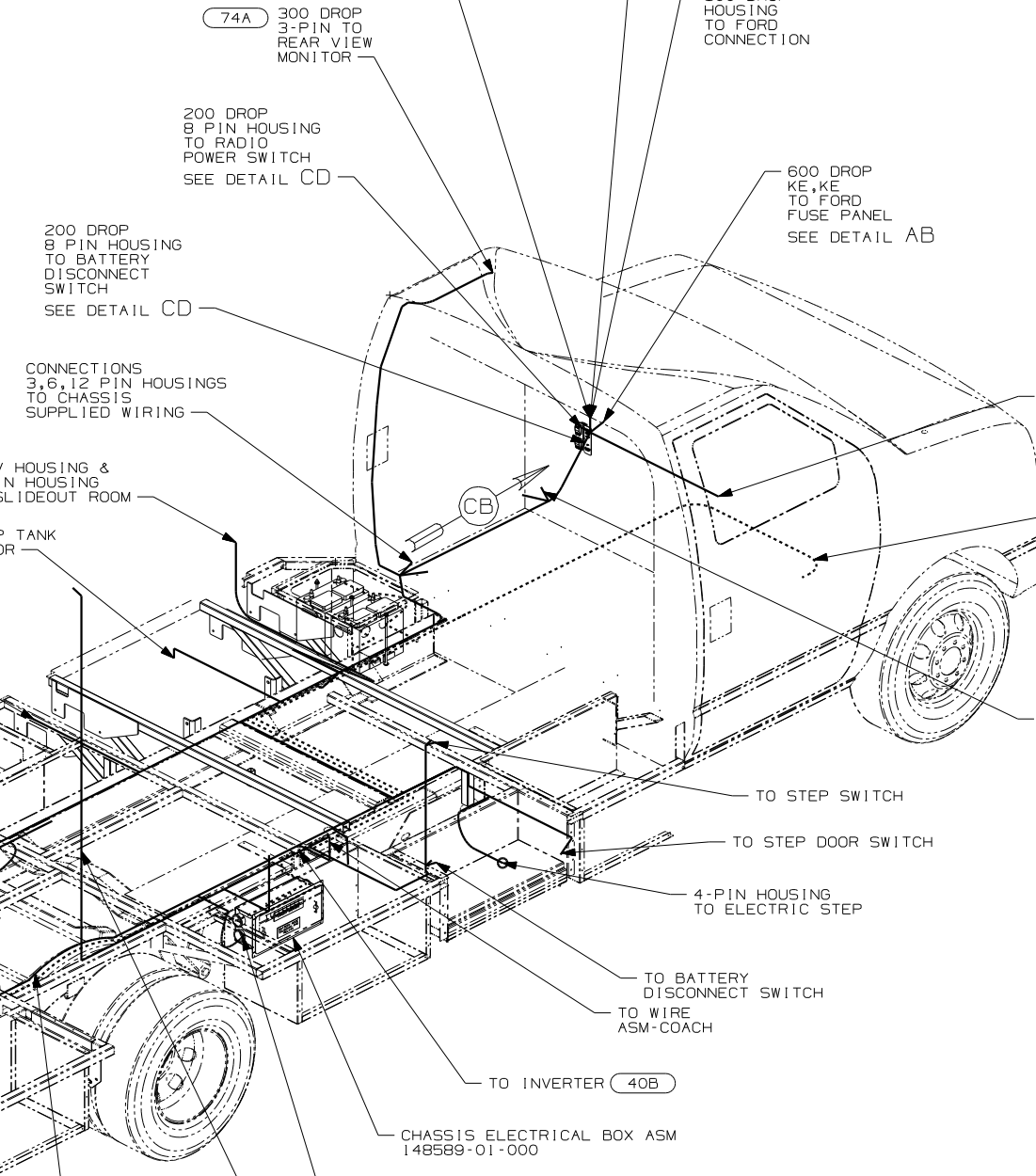
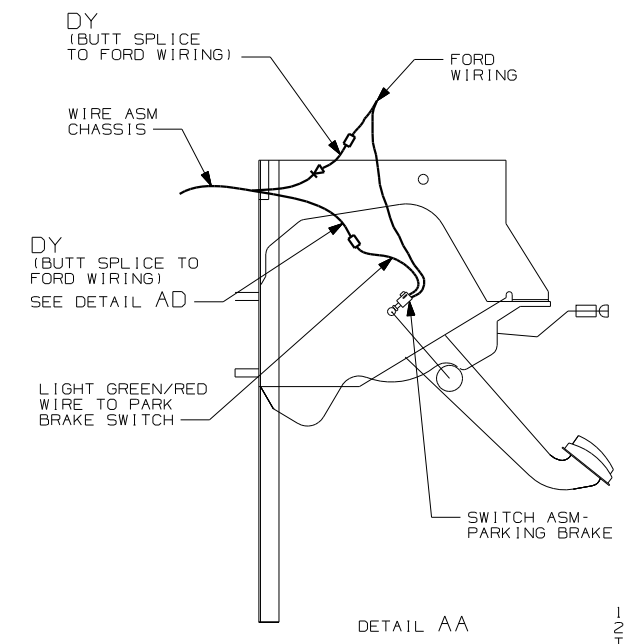
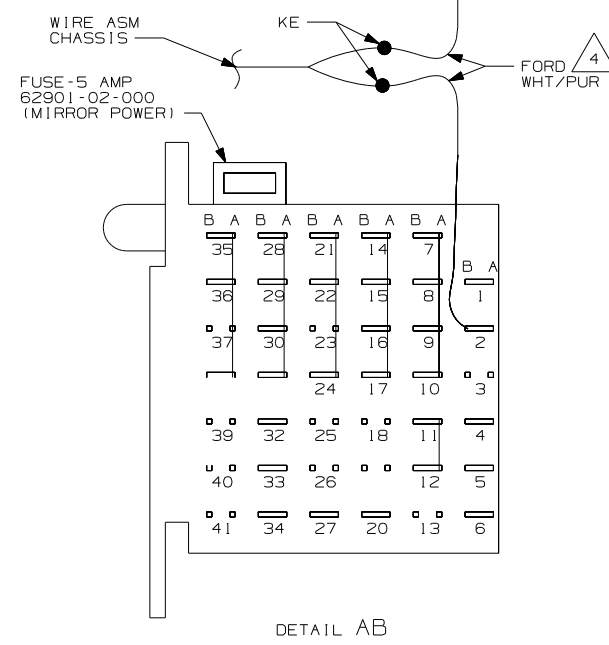
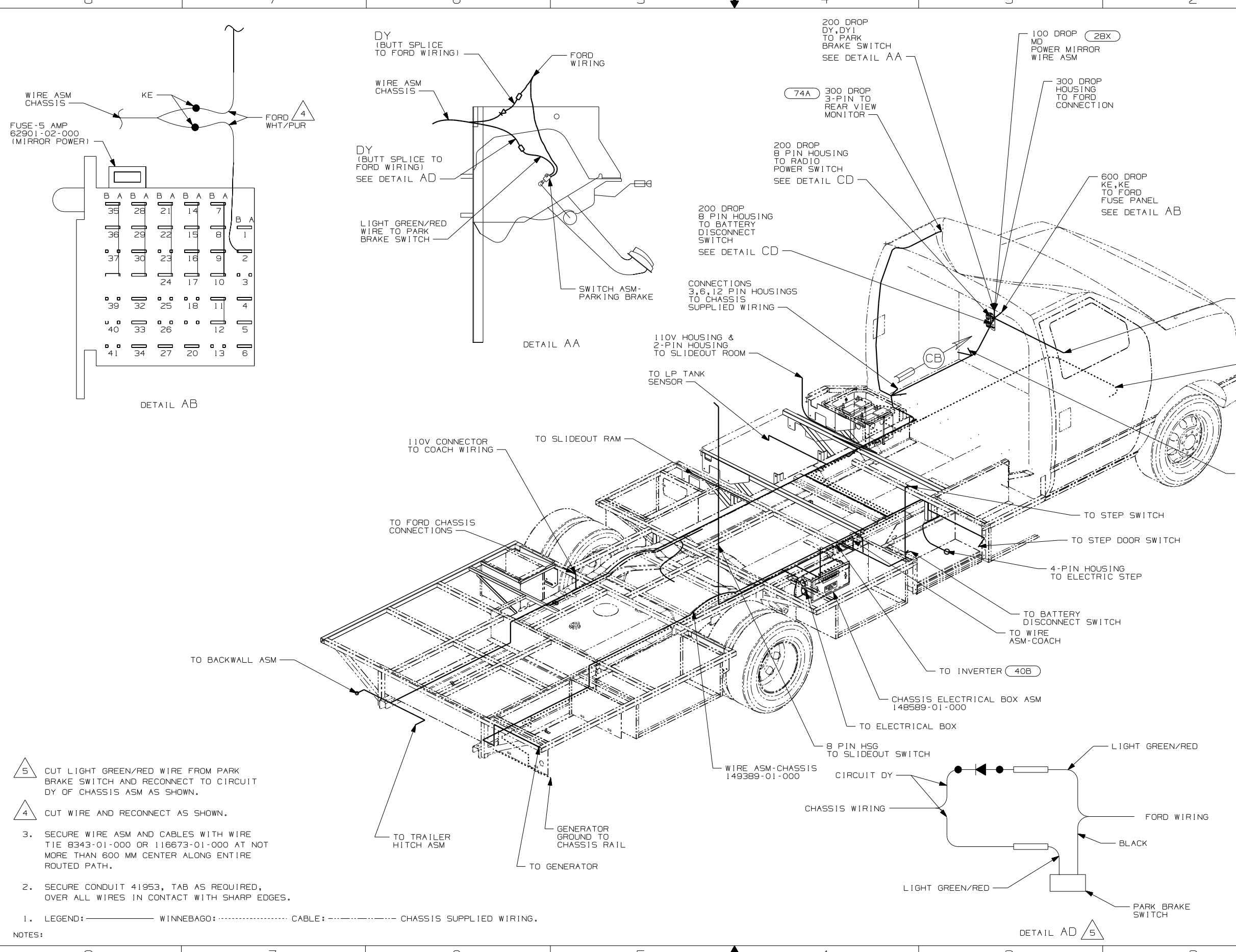

- (74A) RR MONITOR SYS-SUNVISOR MNTR
- (40B) INVERTER-DC/AC, 300 WATT
- (28X) MIRRORS-EXTERIOR W/DEFROST
- (1E2) ENTRANCE STEP-ELEC.
- (16E) FORD CHASSIS 14,050 LB.GVWR
- (265) CODES/STANDARDS-CSA/CMVSS
- (1B1) CODES/STANDARDS USA

|                             |                                      |   |  |
|-----------------------------|--------------------------------------|---|--|
| <b>WINNEBAGO</b>            |                                      | COPYRIGHT 2004<br>WINNEBAGO<br>INDUSTRIES, INC. |  |
| DFTR                        | ORIG. DATE                           |   |  |
| CHKR                        | ALL DIMENSIONS ARE<br>IN MILLIMETERS |   |  |
| P.E.                        |                                      |   |  |
| M.E.                        | FIRST USED                           | 05 726A   |  |
| DSNR                        |                                      |   |  |
| UNSPECIFIED TOLERANCES ARE: |                                      | MATERIAL:                                       |  |
| WHOLE DIM (X)               | :                                    |   |  |
| ONE-PLACE (X.X)             | :                                    |   |  |
| TWO-PLACE (X.XX)            | :                                    |   |  |
| ANGLE                       | :                                    |   |  |
| THIRD ANGLE<br>PROJECTION   |                                      |   |  |
| DO NOT SCALE DRAWING        |                                      |   |  |
| TITLE: WIRING INSTL-CHASSIS |                                      |   |  |
| SHEET 1 of 3                | PART NO                              | 149384  |  |
| REF: NONE 1 12/6/2004       |                                      |   |  |

- NOTES:**
- 5 CUT LIGHT GREEN/RED WIRE FROM PARK BRAKE SWITCH AND RECONNECT TO CIRCUIT DY OF CHASSIS ASM AS SHOWN.
  - 4 CUT WIRE AND RECONNECT AS SHOWN.
  3. SECURE WIRE ASM AND CABLES WITH WIRE TIE 8343-01-000 OR 116673-01-000 AT NOT MORE THAN 600 MM CENTER ALONG ENTIRE ROUTED PATH.
  2. SECURE CONDUIT 41953, TAB AS REQUIRED, OVER ALL WIRES IN CONTACT WITH SHARP EDGES.
  1. LEGEND: — WINNEBAGO: ..... CABLE: ----- CHASSIS SUPPLIED WIRING.

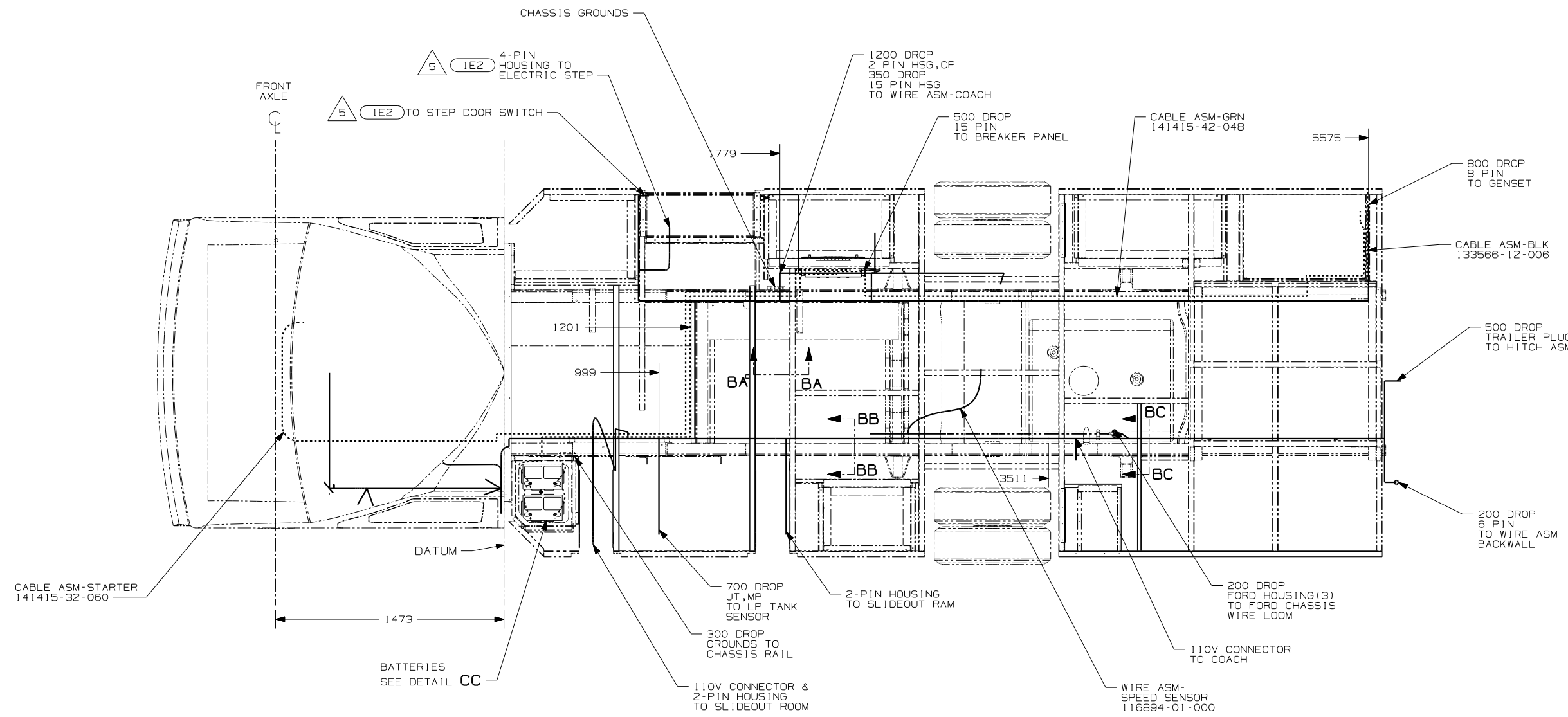

- NOTES:
- 5 SECURE THE DROP BACK TO MAIN WIRE ASM TRUNK WHEN NOT USED.
  - 4 WIRES TO BE TIED TO CROSS MEMBER USING EXISTING HOLES.
  - 3 WIRES TO BE TIED TO TOP OF RAIL USING EXISTING HOLES.
  - 2 WIRES TO BE TIED TO INSIDE OF RAIL USING EXISTING HOLES.
  - 1 CUT OFF EXCESS END OF WIRE TIE.

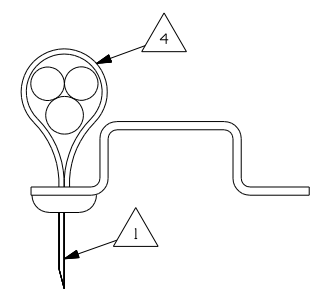

SECTION BA-BA

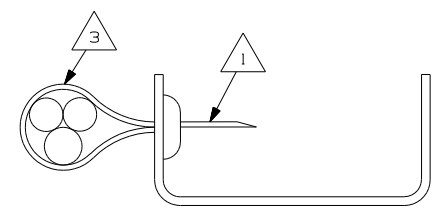

SECTION BB-BB

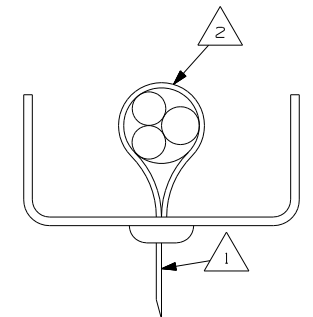

SECTION BC-BC

- 1E2 ENTRANCE STEP-ELEC.
- 16E FORD CHASSIS 14,050 LB.GVWR
- 265 CODES/STANDARDS-CSA/CMVSS
- 1B1 CODES/STANDARDS USA

|            |                      |
|------------|----------------------|
| FIRST USED | 05 726A              |
| TITLE      | DO NOT SCALE DRAWING |
|            | WIRING INSTL-CHASSIS |
| SHEET 2    | PART NO 149384       |

22W CABLE ASM-RED  
133566-01-003

22W BATTERY  
63739-01-000 (2)  
TIEDOWN  
65451-05-000 (2)  
BOLT  
51387-06-000 (3)  
NUT  
D39-05-00B (3)  
CLIP  
44364-02-000 (3)  
BOOT  
77479-01-000  
77479-02-000

CABLE ASM-BLK  
133566-12-004  
TO GROUND BOLT  
NUT  
D39-05-00B

BATTERY  
63739-01-000 (12X)  
TIEDOWN  
65451-05-000  
BOLT  
51387-06-000 (2)  
NUT  
D39-05-00B (2)  
CLIP  
44364-02-000 (2)  
BOOT  
77479-02-000

CABLE ASM-BLK 22W  
133566-11-003

DETAIL CC

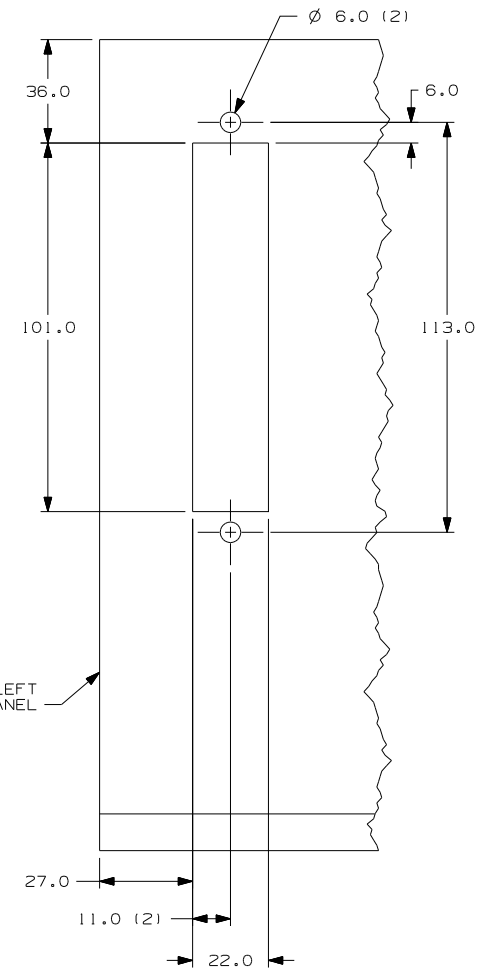

VIEW CB

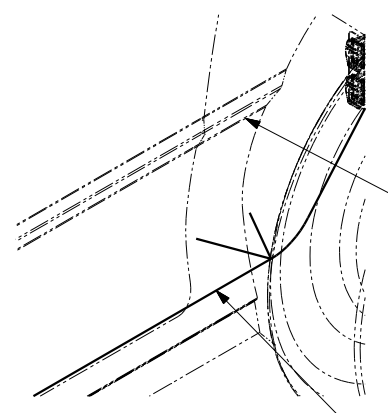

DETAIL CA

REMOVE A-PILLAR LOWER COVER  
TO ACCESS FORD CONNECTORS TO DOOR ASM.  
CONNECT RED/ORG TO WL (2 PLACES)  
CONNECT PK/BLK TO WM (2 PLACES)  
FOR POWER DOOR LOC ACTUATOR

WIRE ASM-CHASSIS (REF)

PLATE-SWITCH  
144363-12-CHT  
NUT  
112722-01-CHT (2)

SWITCH-RADIO  
108357-08-000  
ACTUATOR  
108356-02-CHT

SWITCH-BATTERY BOOST  
108357-09-000  
ACTUATOR  
108356-02-CHT

LABEL-SWITCH  
145731-01-000



DETAIL CD 16E

- 22W BATTERY-SECOND
- 12X BATTERY-ONE
- 16E FORD CHASSIS 14,050 LB. GVWR
- 265 CODES/STANDARDS-CSA/CMVSS
- 1B1 CODES/STANDARDS USA

|            |                      |
|------------|----------------------|
| FIRST USED | 05 726A              |
| TITLE      | DO NOT SCALE DRAWING |
| SHEET 3    | PART NO 149384       |

NOTES:  
1 LEAD IS MARKED WITH YELLOW TAPE.