



DANGER

Danger of electrical shock, burns or death. Always remove all power sources before attempting any repair, service or diagnostic work. Power can be present from shore power, generator, inverter or battery. All power sources must be disabled and secured before performing any service.



CAUTION

If you lack the skills, tools or equipment to perform diagnostic or repair work leave such work to an authorized Winnebago Industries dealer or other qualified shop.

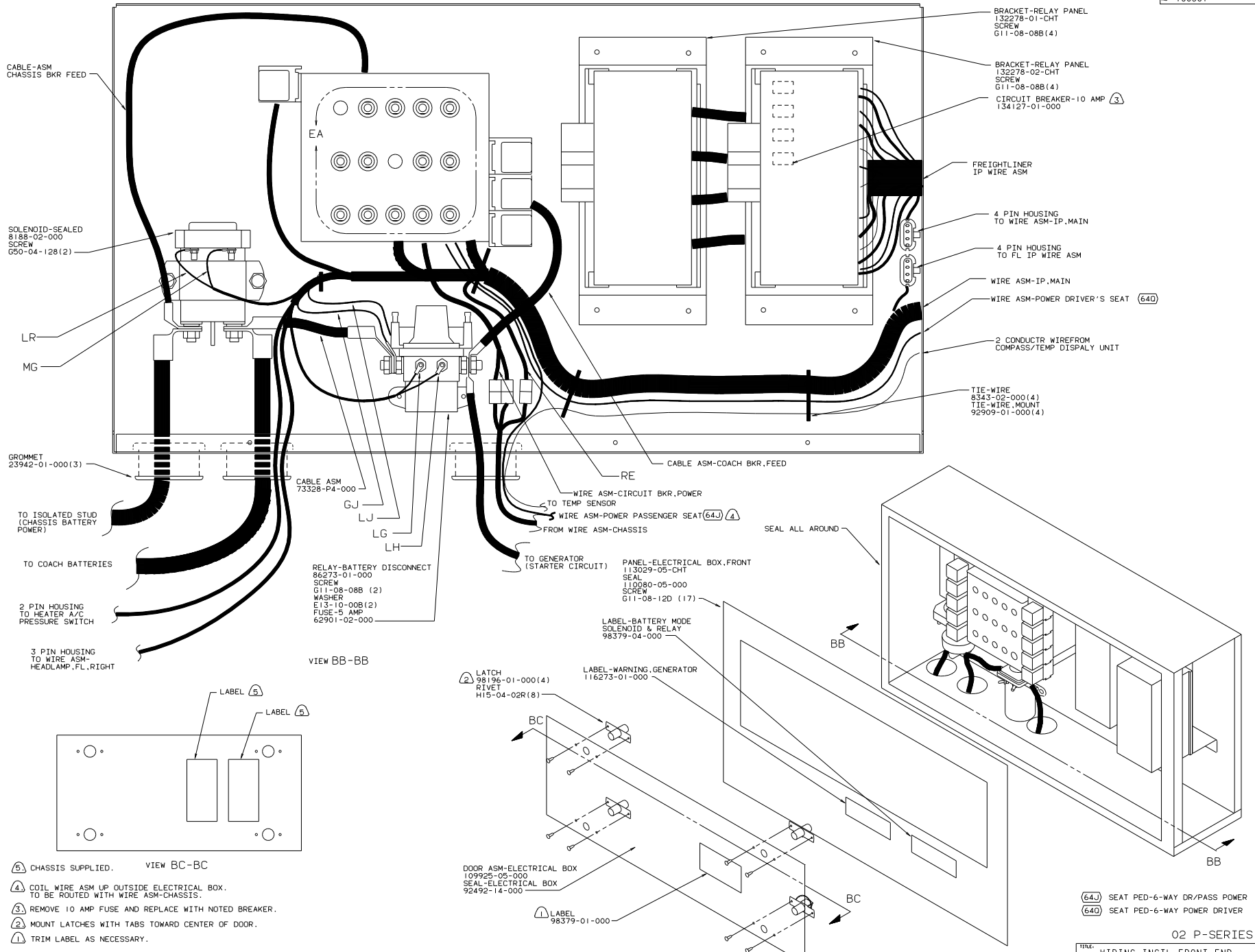

- NOTES:
- (A) CHASSIS SUPPLIED. VIEW BC-BC
 - (B) COIL WIRE ASM UP OUTSIDE ELECTRICAL BOX. TO BE ROUTED WITH WIRE ASM-CHASSIS.
 - (C) REMOVE 10 AMP FUSE AND REPLACE WITH NOTED BREAKER.
 - (D) MOUNT LATCHES WITH TABS TOWARD CENTER OF DOOR.
 - (E) TRIM LABEL AS NECESSARY.

- (64J) SEAT PED-6-WAY DR/PASS POWER
- (64D) SEAT PED-6-WAY POWER DRIVER

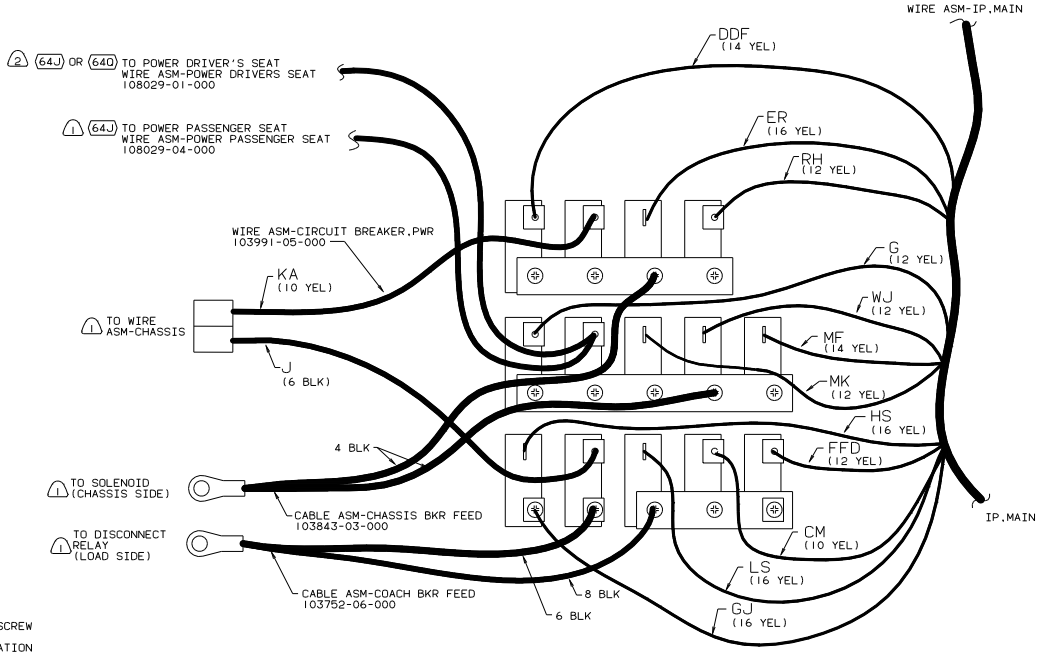
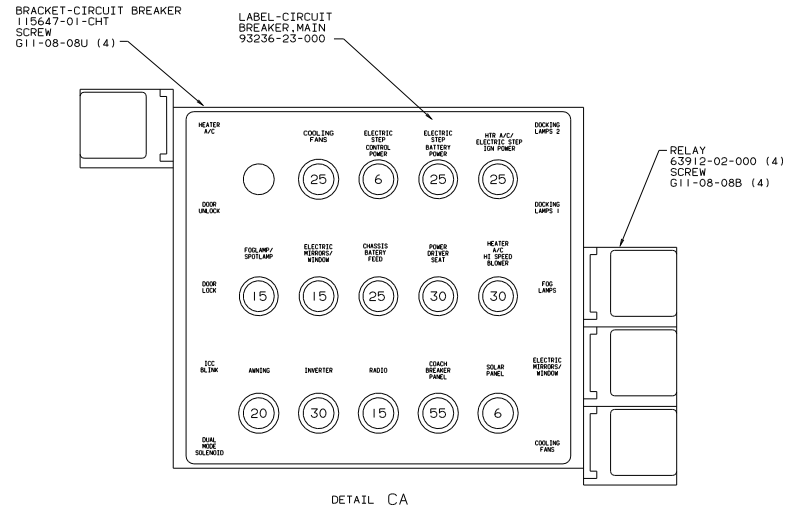
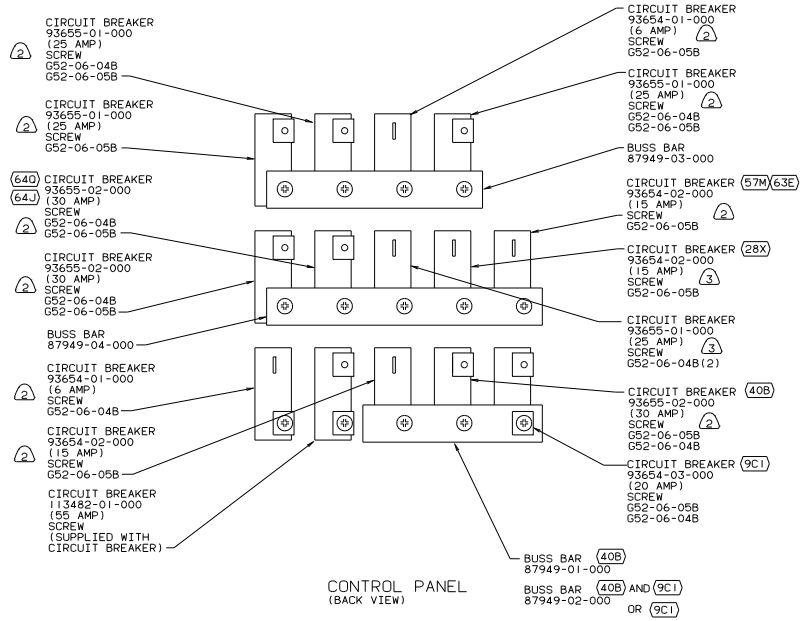

NOTES:

③ ADD LOCKWASHER OME02B-04-071 1 PER SCREW

② SEE SHTS 1 AND 2 FOR ROUTING INFORMATION

① SEE SHT 2 FOR ROUTING INFORMATION

- ⑥3F AWNING-ENTRANCE DOOR
- ⑨C1 AWNING-ELECTRIC PACKAGE
- ⑥4J SEAT PED-6-WAY DR/PASS POWER
- ⑥4D SEAT PED-6-WAY POWER DRIVER
- ⑤7M LAMPS-FOG
- ④0B INVERTER-DC/AC, 300 WATT
- ②8X MIRRORS-EXTERIOR W/DEFROST

02 P-SERIES

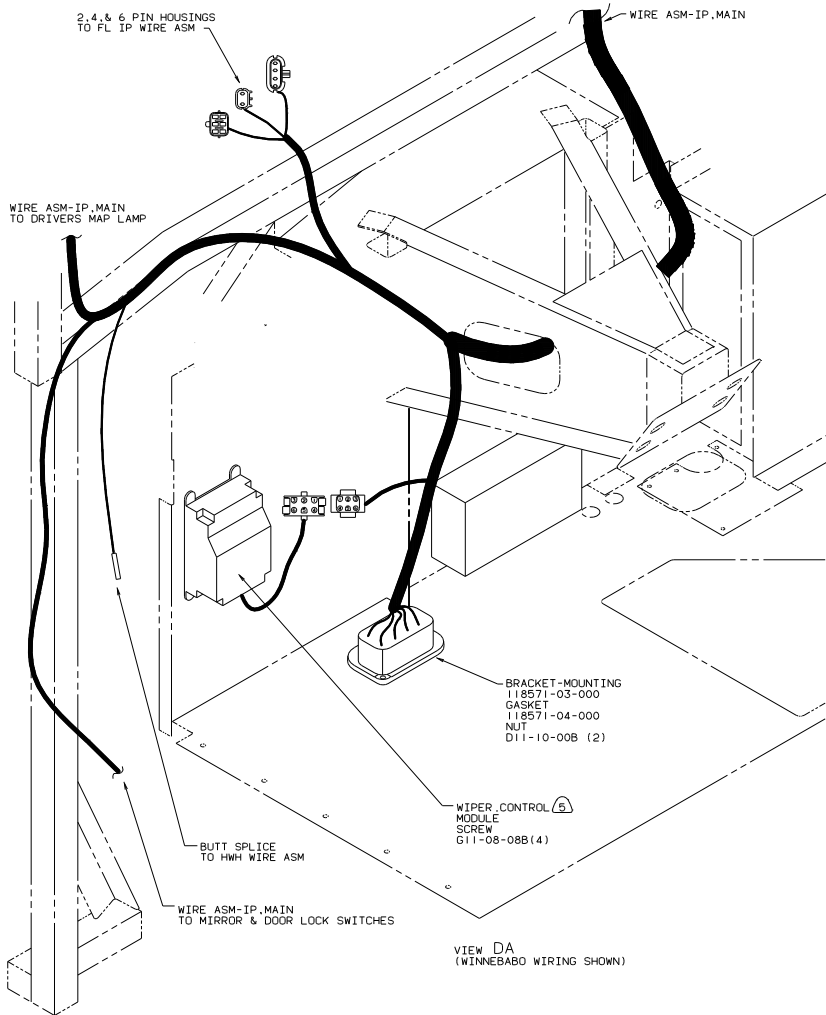

VIEW DA
(WINNEBAGO WIRING SHOWN)

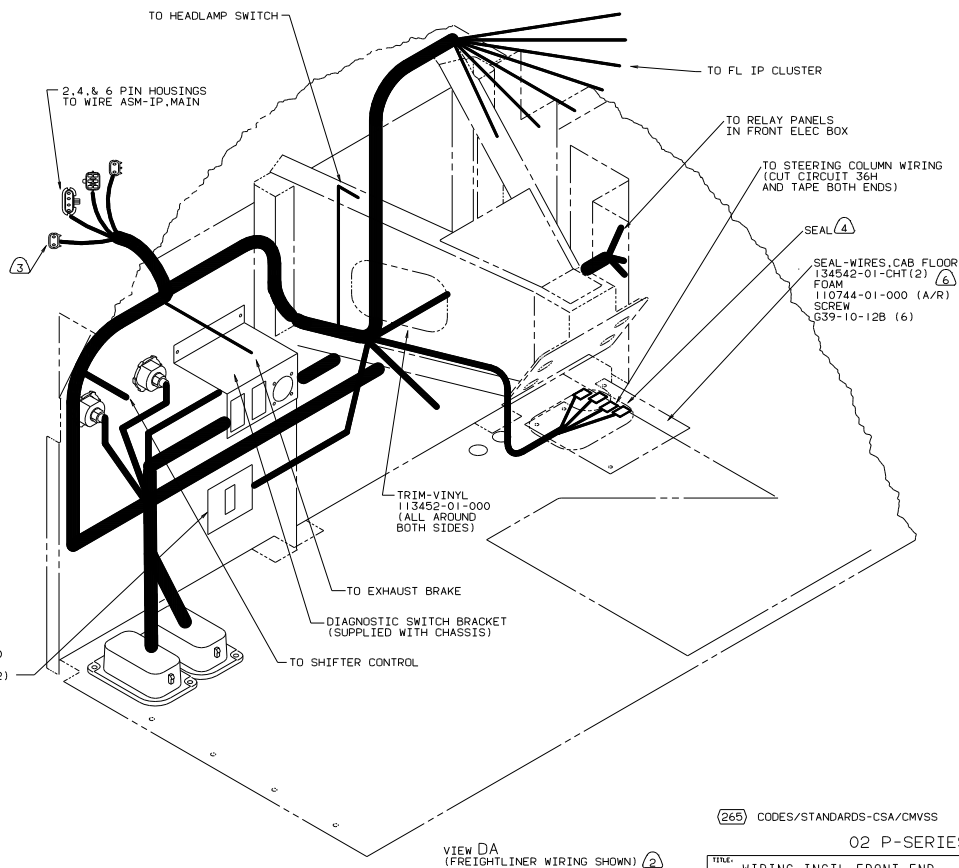

VIEW DA
(FREIGHTLINER WIRING SHOWN) (2)

- (6) PUT 1 SEAL IN FRONT OF HOLE AT CAB PREP.
- (5) SEE WIPER CONTROL INFORMATION FOR INSTALLATION INSTRUCTION
- (4) ROUTE PARK BRAKE VALVE AND AIR LINES FOR DASH GAUGES THRU HERE. COVER WITH CONVOLUTE TUBING 41963 WHERE VISIBLE.
- (3) DO NOT USE SEAT BELT 2 PIN HOUSING
- (2) FL IP WIRE ASM SHOULD BE TIED PRIOR TO INSTALLATION. SEE DETAIL HA FOR TYING INSTRUCTIONS.

1. BUNDLE AND SECURE ALL EXCESS WIRE.

NOTES:

(265) CODES/STANDARDS-CSA/CMVSS

02 P-SERIES

TITLE	
WIRING INSTL-FRONT END	
DO NOT SCALE DRAWING	SIZE
SHEET 4 OF 10	DWG NO 138561

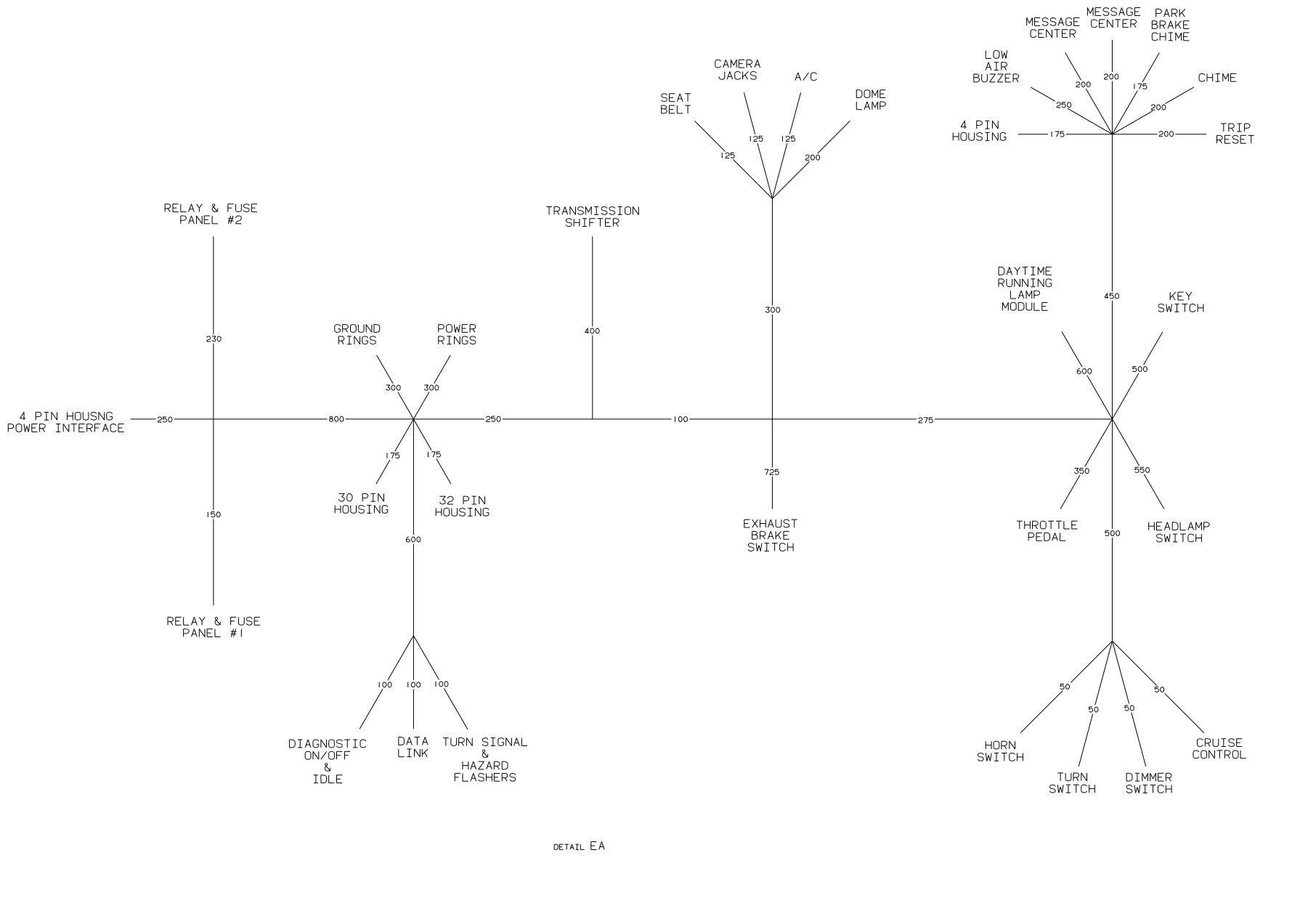

DETAIL EA

1. USE WIRE TIES TO FORM FREIGHTLINER IP WIRE INTO THIS CONFIGURATION.

NOTES:

02 P-SERIES

TITLE:		WIRING INSTL-FRONT END	
DO NOT SCALE DRAWING	DATE	DWG NO	138561
SHEET 5 OF 10	IF NO		

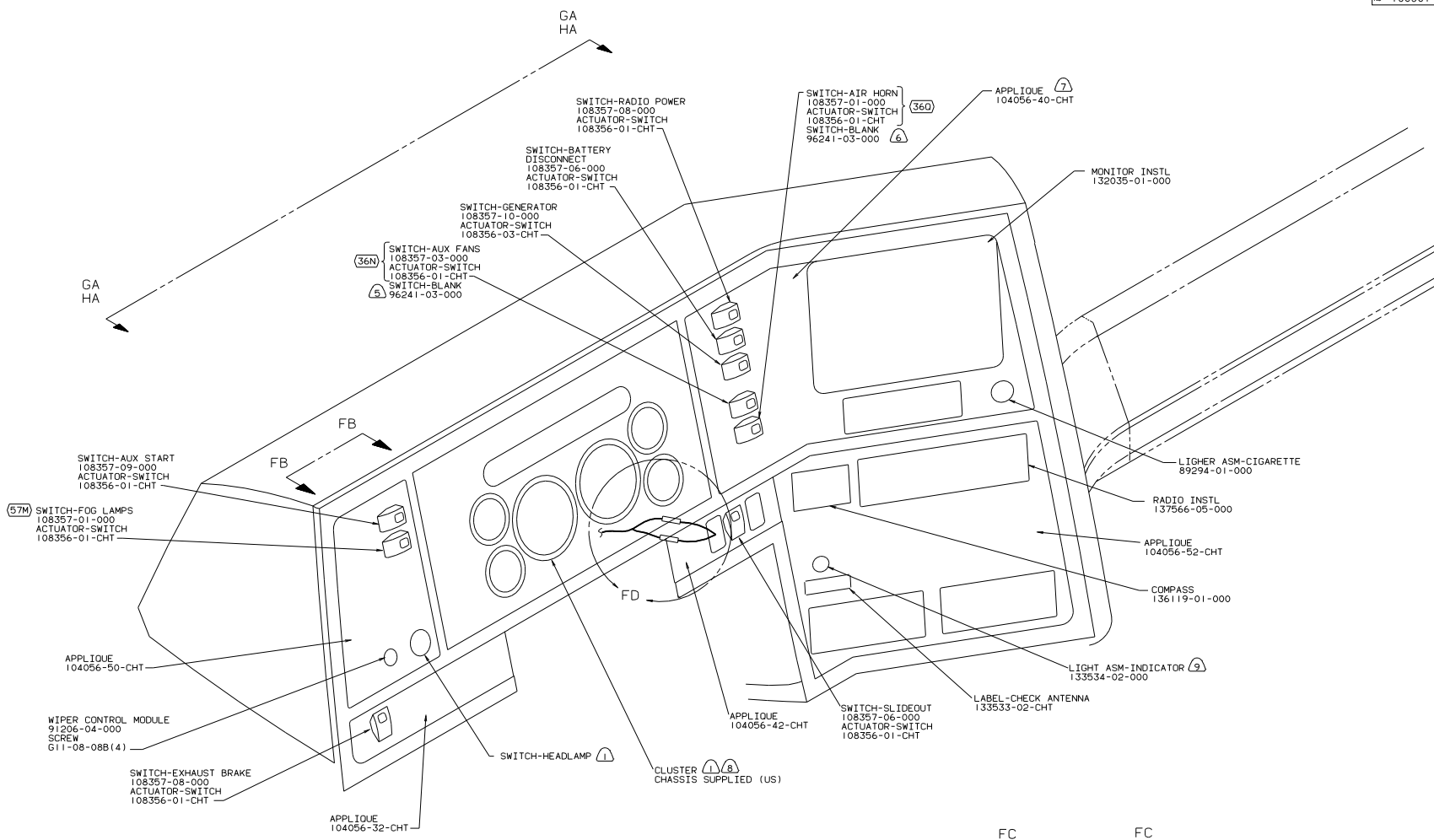

VIEW FA-FA

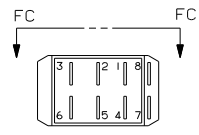

VIEW FB-FB (SWITCH MOUNTING ORIENTATION)

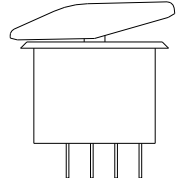

VIEW FC-FC (SWITCH ACTUATOR ORIENTATION)

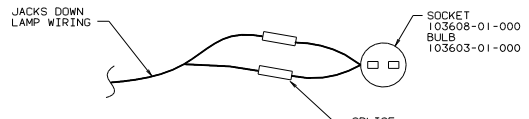

DETAIL FD

- ⑨ DRILL 19.0 DIAMETER HOLE AT LOWER DIMPLE LOCATION.
- ⑧ SEE DETAIL MA FOR INSTRUMENT CLUSTER ASSEMBLY INSTRUCTIONS.
- ⑦ COVER CLEAR LEGEND ON BEZEL WITH FILM 77031-01-000 (BLANK) OR 77031-03-000 (W/OPTION).
- ⑥ WITHOUT (360).
- ⑤ WITHOUT (36N).
- ④ SWITCHES SHOWN WITHOUT WIRE ASM-HOUSING CONNECTED.
- ③ SAME FOR ALL DASH SWITCHES EXCEPT FOG LAMPS, DOCKING LAMPS AND GENERATOR SWITCHES.
- ② SAME FOR ALL SWITCHES.
- ① CHASSIS SUPPLIED.

- (57M) LAMPS-FOG
- (360) AIR HORNS-CHROME
- (36N) FANS-DEFROSTER, AUXILIARY
- (WIN) WINNEBAGO ONLY
- (ITA) ITASCA ONLY

NOTES:

02 P-SERIES

TITLE: WIRING INSTL-FRONT END	
DO NOT SCALE DIMENSIONS	DATE: 10/68
SHEET 6 OF 10	DWG NO 138561

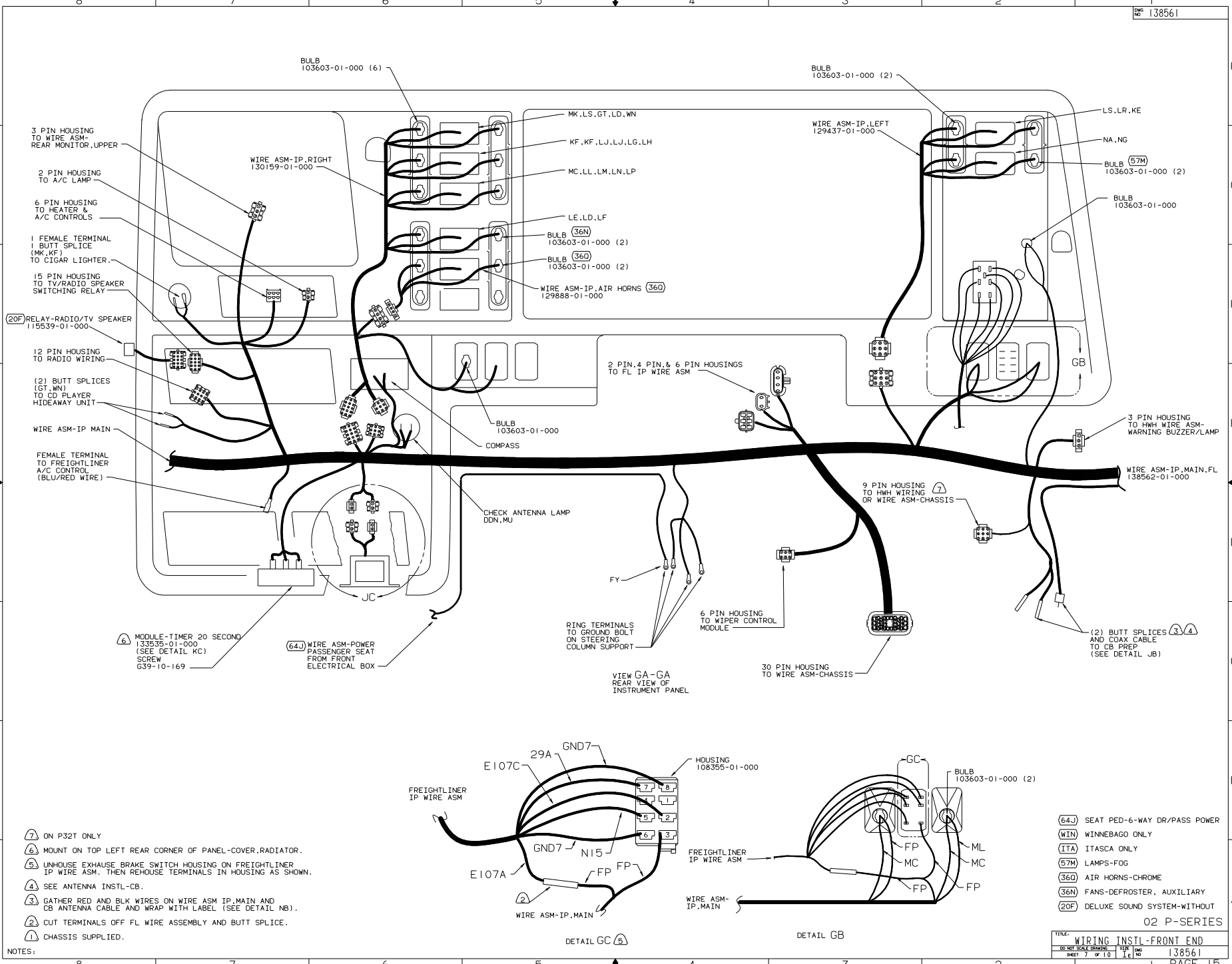

- NOTES:
- ① ON P32T ONLY
 - ② MOUNT ON TOP LEFT REAR CORNER OF PANEL-COVER, RADIATOR.
 - ③ UNHOUSE EXHAUSE BRAKE SWITCH HOUSING ON FREIGHTLINER IP WIRE ASM, THEN REHOUSE TERMINALS IN HOUSING AS SHOWN.
 - ④ SEE ANTENNA INSTL-CB.
 - ⑤ GATHER RED AND BLK WIRES ON WIRE ASM IP, MAIN AND CB ANTENNA CABLE AND WRAP WITH LABEL (SEE DETAIL KC).
 - ⑥ CUT TERMINALS OFF FL WIRE ASSEMBLY AND BUTT SPLICE.
 - ⑦ CHASSIS SUPPLIED.

- ⑥4J SEAT PED-6-WAY DR/PASS POWER
- WIN WINNEBAGO ONLY
- ITA ITASCA ONLY
- ⑤7M LAMPS-FOG
- ③60 AIR HORNS-CHROME
- ③6N FANS-DEFROSTER, AUXILIARY
- ②0F DELUXE SOUND SYSTEM-WITHOUT

02 P-SERIES

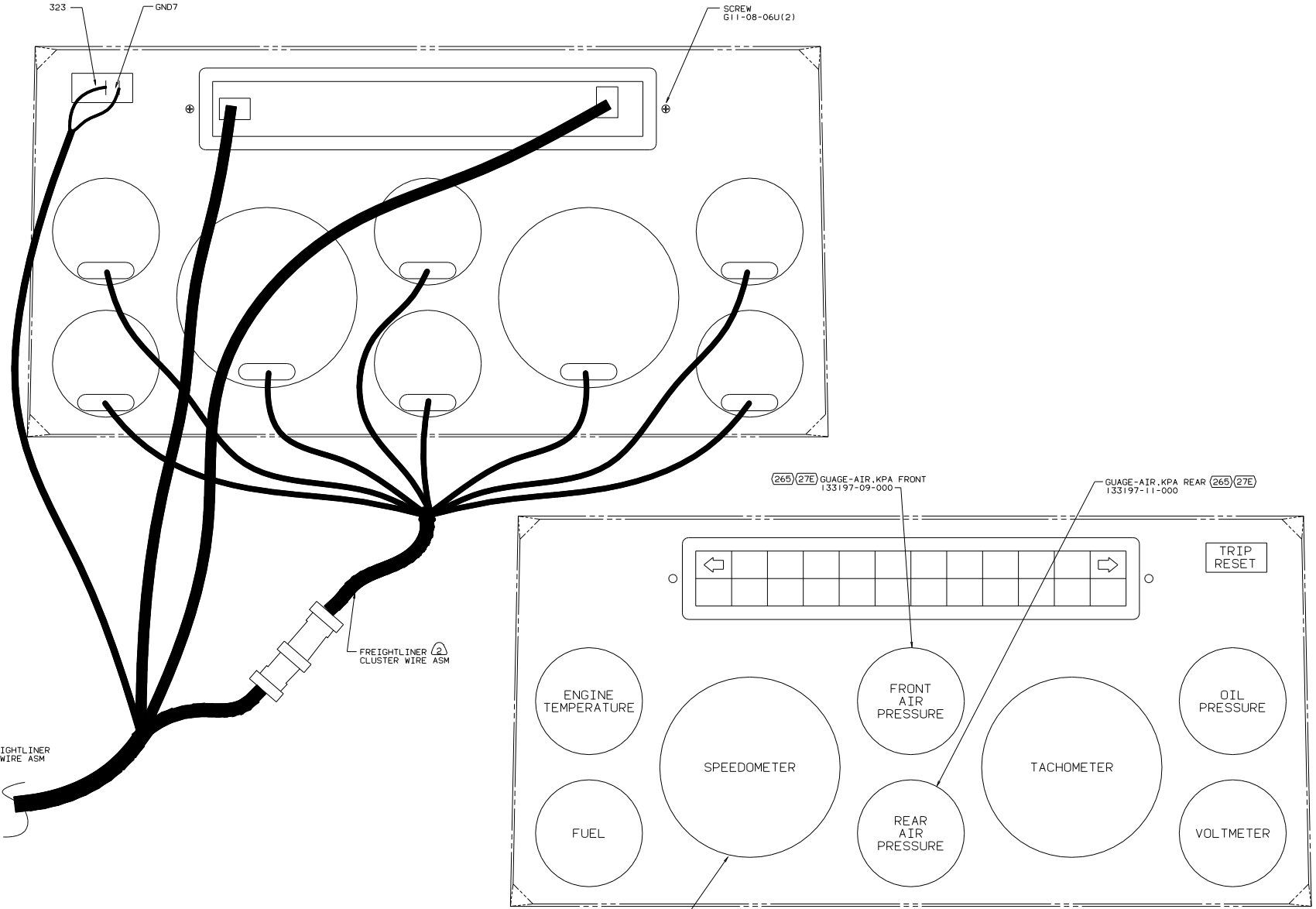

DETAIL HA

- Ⓜ ANY PLUG ON CLUSTER WIRE ASM WILL FIT ANY GAUGE
- 1. ALL GAUGES, RETAINER CLIPS AND FASTENERS ARE CHASSIS SUPPLIED UNLESS NOTED.

(27E) CODES/STANDARDS-CMVSS
 (265) CODES/STANDARDS-CSA/CMVSS

02 P-SERIES

TITLE		WIRING INSTL-FRONT END	
DO NOT SCALE DRAWING	SIZE	DWG NO 138561	
SHEET 8 OF 10	IF NO		

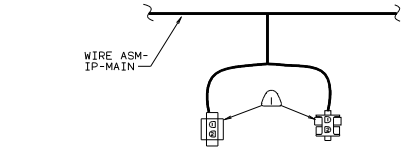
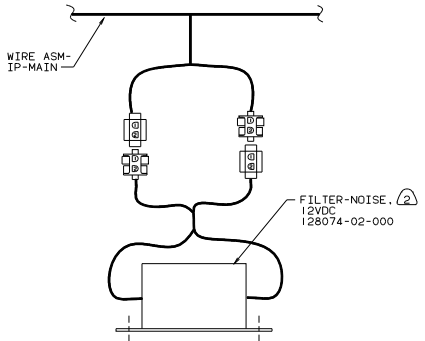
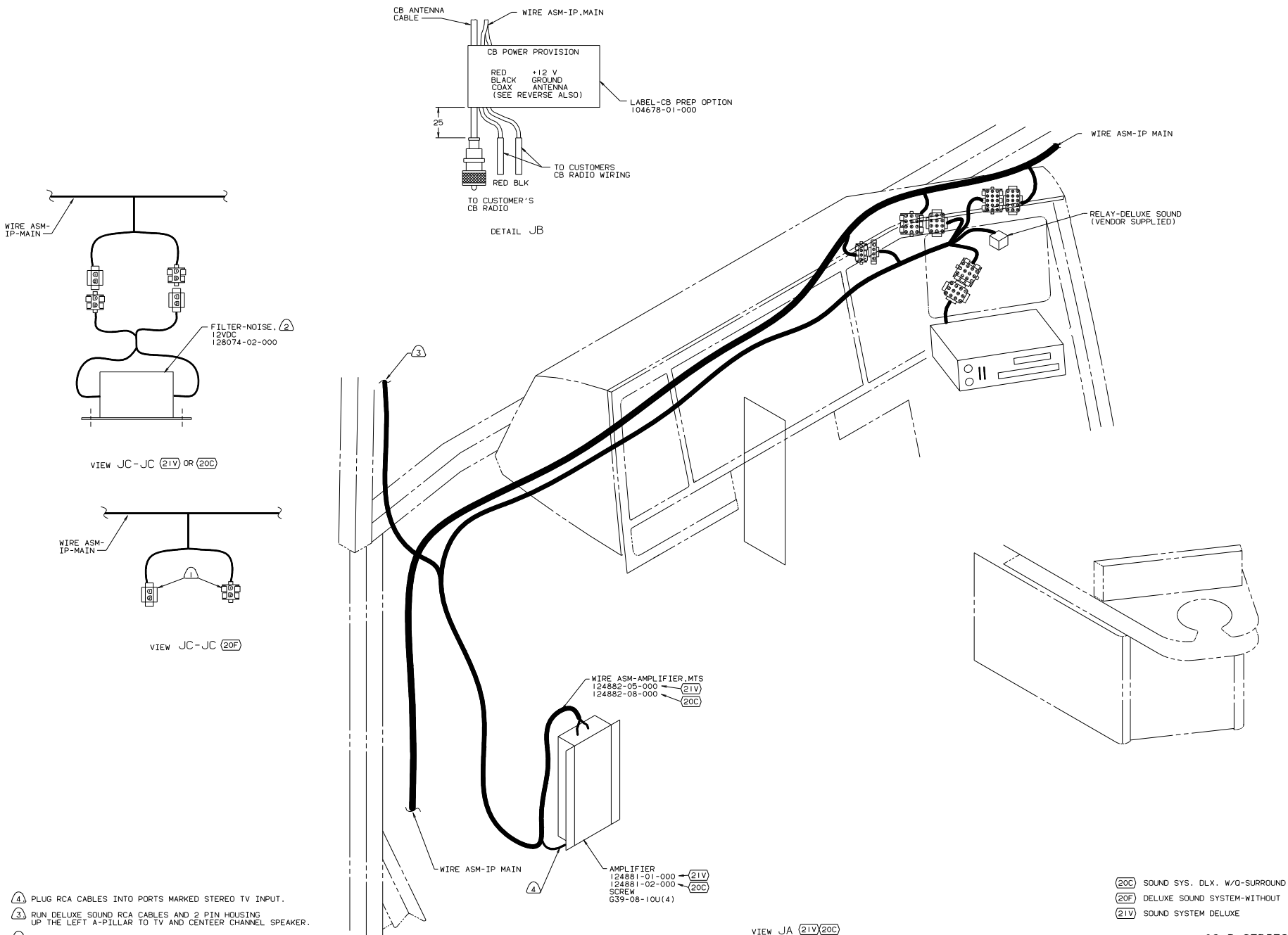

- NOTES:
- ④ PLUG RCA CABLES INTO PORTS MARKED STEREO TV INPUT.
 - ③ RUN DELUXE SOUND RCA CABLES AND 2 PIN HOUSING UP THE LEFT A-PILLAR TO TV AND CENTER CHANNEL SPEAKER.
 - ② MOUNT ON TOP LEFT REAR CORNER OF PANEL-COVER,RADIATOR.
 - ① CONNECT HOUSINGS TOGETHER.

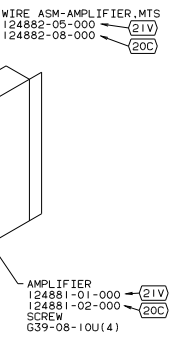

- ②0C SOUND SYS. DLX. W/O-SURROUND
- ②0F DELUXE SOUND SYSTEM-WITHOUT
- ②1V SOUND SYSTEM DELUXE

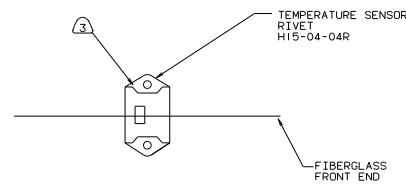
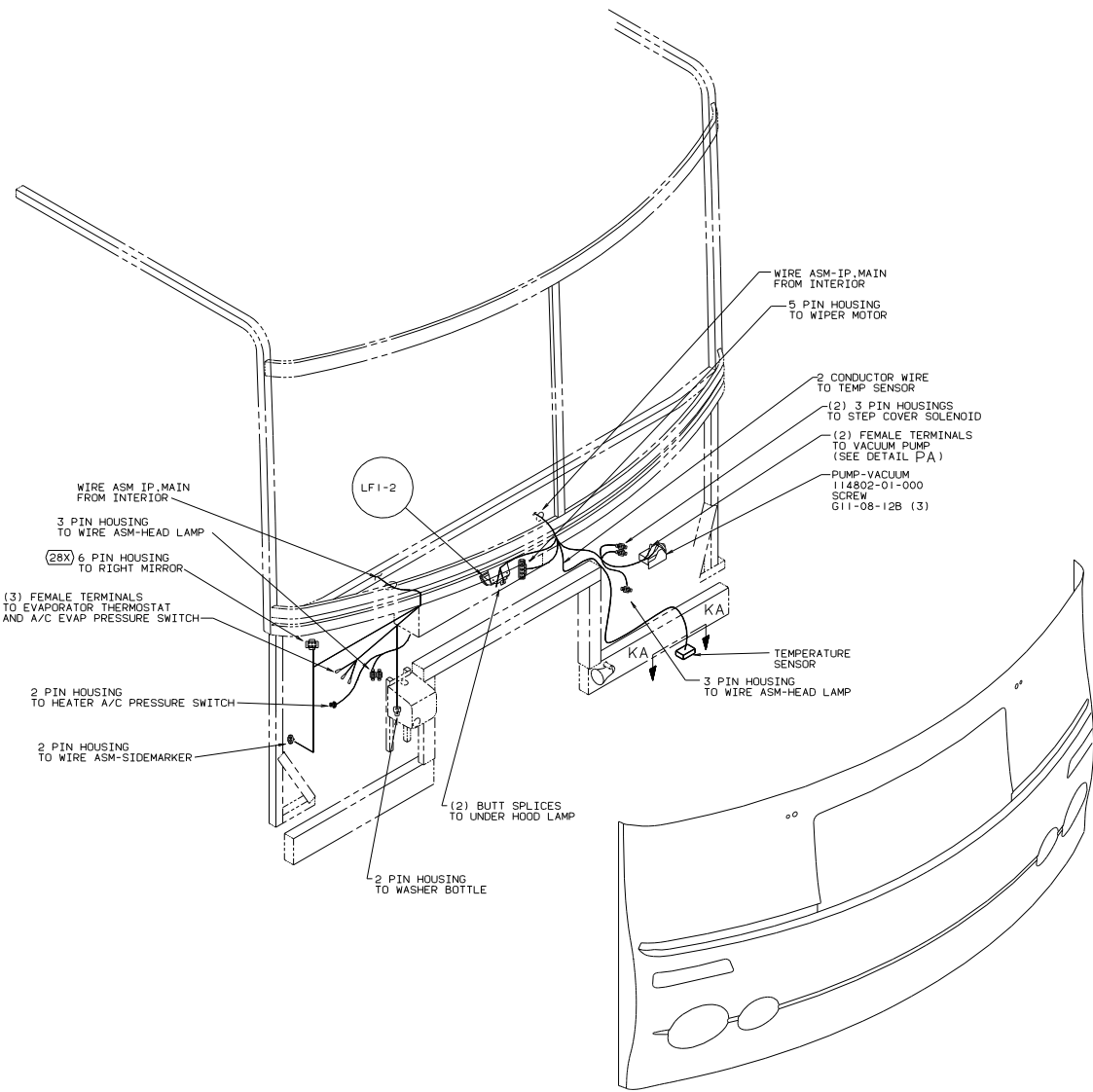

VIEW KA-KA

- (3) DRILL 4.8 DIA HOLE AND MOUNT ON LOWER FLANGE OF FRONT END.
- (28X) LAMP TO BE ASSEMBLED TO BRACKET-HEADLAMP BEFORE IT IS SCREWED TO THE FRONT END.
- (1) MOUNT ON GROUND BOLT.

NOTES:

FOR ELECTRICAL TORQUE SPECIFICATIONS SEE DWG NO. 128763-01-000

(X-X) FOR ELECTRICAL CALL-OUTS SEE DWG NO. 121339-01-000

(28X) MIRRORS-EXTERIOR W/DEFROST 02 P-SERIES

WIRING INSTL-FRONT END
 DO NOT SCALE DRAWING SHEET NO. 10 OF 10 I.F. NO. 138561